

1-30-003A-003

June 2006

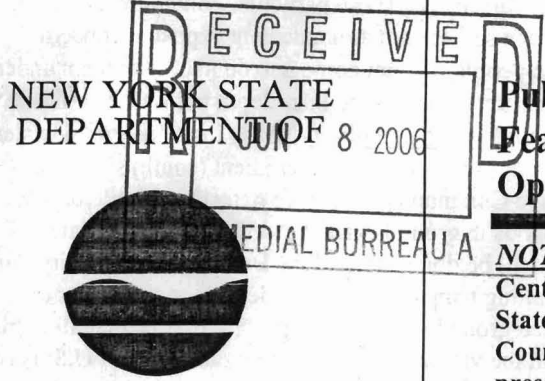

ENVIRONMENTAL  
CONSERVATION

**Public Availability Session, Remedial Investigation and Feasibility Study, Bethpage Community Park Operable Unit 3: Former Grumman Settling Ponds**

**NOTICE OF A PUBLIC AVAILABILITY SESSION:** Bethpage Community Center, June 8, 2006 from 5:30 to 9:00 P.M. Representatives from the New York State Department of Environmental Conservation (NYSDEC), the Nassau County Department of Health and Northrop Grumman Corporation will be present to discuss the remedial investigation and feasibility study (RI/FS) work plan and the overall site information available to date at the June 8<sup>th</sup> availability session.

An availability session is a gathering of program personnel and members of the public in a casual setting, without a formal presentation or agenda. Various representatives will be on hand with copies of the RI/FS work plan, reports, maps and other material to answer your questions and hear your concerns. A fact sheet and a contact list will also be distributed to attendees. You may drop in at any time between 5:30 and 9:00 p.m.

The Bethpage Community Park, located on Stewart Avenue, Bethpage in Nassau County has been undergoing a remedial investigation for environmental contamination from former site activities conducted by its previous owner, the former Grumman Aircraft Engineering Corporation, now known as the Northrop Grumman Corporation (Northrop Grumman). The NYSDEC is sending this public notice as an update on activities related to the site. There have been three significant actions in recent months:

1. The Northrop Grumman Corporation has entered into an RI/FS order on consent for the Bethpage Community Park, or Operable Unit 3 (OU 3), also known as the "Former Grumman Settling Ponds."
2. The work plan for the RI/FS has been approved; and
3. The field work for the RI/FS is now ongoing.

**SITE DESCRIPTION:** The 18-acre Bethpage Community Park is located in Bethpage, NY, on the west side of Stewart Avenue near Cherry Avenue. The Park is currently owned by the Town of Oyster Bay and includes a swimming pool, an ice-skating rink, a baseball field, tennis courts, playgrounds, picnic areas, a recharge basin and a parking lot.

**SITE HISTORY:** Grumman Aerospace (now Northrop Grumman) donated the land for the Park to the Town of Oyster Bay in 1962. Prior to this, Grumman Aerospace used portions of the site as sludge drying areas, or settling ponds, to dispose of liquid wastes. The sludge came from the solids settled out of the liquid waste. Once dried, the sludge was removed and sent offsite for landfill disposal. A portion of the site was also used for fire control training.

Prior to Northrop Grumman's investigation of the Bethpage Community Park, limited environmental investigations within the park found that contamination for surface soils were either non-detect or detected at trace level concentrations that were all lower than the current cleanup levels. Northrop Grumman notified the NYSDEC and the New York State Department of Health (NYSDOH) in early 2002 of elevated levels of PCBs found as a result of several rounds of testing in 1999 - 2001 on a Northrop Grumman access road immediately south of the park. As a follow-up to the access road sampling, Northrop Grumman proposed, and eventually implemented, additional investigation of surface and subsurface soil inside the Bethpage Community Park. The results of this testing, and the ongoing RI/FS, are described in more detail in the next sections.

**Highlights In This Update**

**1. Public Availability Session**

June 8, 2006

Bethpage Community Center  
Grumman Road  
Bethpage  
5:30- 9:00pm

**2. Current Reports can be found in the Main Document Repository**

Bethpage Public Library  
Powell Avenue  
Bethpage, NY 11714

And

**3. Document Website**

[www.dec.state.ny.us/website/der/projects/reg1/](http://www.dec.state.ny.us/website/der/projects/reg1/)

**4. For More Information on the Former Grumman Settling Ponds (Bethpage Community Park) Site:**

NYSDEC Central Office  
625 Broadway  
Albany, NY 12233-7015  
Att: Steven M. Scharf, P.E.  
Project Engineer  
(518) 402-9620  
1-800-342-9296

NYSDOH  
547 River Street  
Troy, NY 12180  
Attn: Trevor Wescott  
(518) 402-7880  
1-800-458-1158  
Extension 27880

**RECENT SITE DEVELOPMENTS:** Northrop Grumman entered into an order on consent with the NYSDEC to complete the RI/FS for both the onsite and offsite issues related to the Bethpage Community Park, also known as Operable Unit 3 or OU3, of the Northrop Grumman site. Northrop Grumman is now completing the investigation that has been ongoing to characterize the lateral and vertical extent of any potential impacts from site-related contamination. The RI/FS work plan has been approved, and fieldwork, which includes soil, groundwater and soil gas sampling, started April 10, 2006.

The Town of Oyster Bay entered into an order on consent to do an Interim Remedial Measure (IRM). An IRM(s) is usually implemented at a site so that discrete corrective actions can take place while the overall site investigation, remediation, and decision making process, moves forward. The Town of Oyster Bay IRM public availability session, will be presented separately, on June 14, 2006 at the Bethpage Community Library. The Town elected to enter into an IRM in order to proceed with their plans to construct the proposed new ice rink in the Bethpage Community Park. The data generated by the town will also be incorporated in the Northrop Grumman remedial program.

**INITIAL INVESTIGATION SUMMARY REPORT:**

Northrop Grumman finalized a second report entitled "Bethpage Community Park, Investigation Sampling Program, Field Report, December 2003." This report is available at the document repository and on-line at [www.dec.state.ny.us/website/der/projects/reg1/](http://www.dec.state.ny.us/website/der/projects/reg1/). The report summarizes all the work that Northrop Grumman has done prior to starting the current round of field work.

**1. Northrop Grumman Park Sampling Program to Date and Additional Testing Now Underway-** Northrop Grumman's first round of soil sampling took place in March 2002. Soil push-probe samples were collected from 60 locations at varying depths. Northrop Grumman collected a second round of soil samples in May 2003. This included more than 200 soil samples from soil borings within the park and groundwater samples from newly installed groundwater monitoring wells. Additional soil sampling is now underway

**2. Surface Samples -** Most of the surface soil samples for the first and second rounds of soil sampling were either non-detect, or less than one part per million (ppm) for PCBs, the value set by NYSDEC to remediate PCBs in a residential setting. Chromium was also found in some surface soil samples at concentrations below the levels of health concern. Special attention was focused on testing in bare areas because people are more likely to come into contact with the soil in these areas than in areas that are well grassed.

**3. Samples at Depth -** The at-depth soil sampling to date indicates about one in ten of the deeper (at least 8 feet) soil push-probe samples had levels of PCBs and some metals, particularly chromium, which exceed recommended soil

cleanup objectives. These particular contaminants in subsurface soil are not an immediate exposure concern because people will not come into contact with them under most circumstances due to their depth below the surface.

**4. Groundwater Sampling-** Newly installed groundwater monitoring wells on the downgradient (south) side of the Bethpage Community Park have detected volatile organic compounds in groundwater. Additional groundwater testing will be done south of the Bethpage Community Park by installing temporary wells to determine the extent of impacted groundwater. It is important to note that all public water in the vicinity of the former Grumman and U.S. Navy Bethpage facility and the surrounding community is from the Bethpage Water District (BWD). These supplies are routinely monitored and treated, if necessary, to ensure that drinking water distributed to the public meets federal, state, and county requirements.

**5. Soil Gas Sampling:** As part of the RI/FS field work, the NYSDEC now requires sampling for soil gas be included in the investigation. Soil gas results from volatile organic compounds migrating through soil pore space. This sampling will occur along Stewart Avenue, Sycamore Avenue and the Robert Plan Building (former Grumman Plant 24). The results of this testing will be evaluated to determine what the next course of action will be.

**SAMPLING AT OFF-SITE PROPERTIES NEAR THE PARK:**

Soil samples were collected in 1995 from eleven residential yards southwest of the park and tested for PCBs. PCBs were either not detectable or less than the one ppm cleanup value used by DEC to remediate PCBs in a residential setting. More recently, based on the findings of sampling on the access road and the park, additional homes that included all the homes to the south of the Northrop Grumman Access road were sampled in 2002 and 2003 by the NYSDEC, NYSDOH and the NCDH. The results indicated that three homes adjacent to Stewart Avenue exhibited surface soil concentrations that need to be addressed under the upcoming remedial program. Sampling results were sent to the property owners. The agencies will continue, as necessary, to identify and test any offsite locations that require additional investigation. Information gathered from the investigative phase will be used to screen remedial alternatives for the Bethpage Community Park.

**Citizen Participation Planning-** The public will be kept informed and involved as investigations are conducted, alternatives are evaluated and remediation gets underway. Northrop Grumman has prepared a Citizen Participation Plan, included in the RI/FS Work Plan, which outlines steps and procedures that will be followed.

**DOCUMENT REPOSITORIES:** Documents related to the investigation and potential remediation of contamination at Bethpage Community Park will be made available at the Bethpage Public Library, Powell Avenue, Bethpage. Information related to the project can also be viewed on the NYSDEC website at: [www.dec.state.ny.us/website/der/projects/reg1/](http://www.dec.state.ny.us/website/der/projects/reg1/)

**Bethpage Public Library**  
 Powell Avenue  
 Bethpage, NY 11714  
 (516) 931-3907  
 Hours: M-F 9:30-9:00  
 Sat 9:30-5:00  
 (Karen Gruskin or Lois Lovisolo-Reference Librarians)

**NYSDEC Region 1 Headquarters**  
 SUNY Campus  
 Loop Road Building 40  
 Stony Brook, NY 11790-2356  
 Attn: Bill Fonda, Citizen  
 Participation Specialist

**NYSDEC Central Office**  
 625 Broadway, 11<sup>th</sup> floor  
 Albany, NY 12233-7015  
 Attn: Steven M. Scharf, P.E.

*For More Information regarding this site please contact the following:*

NYSDEC Concerns  
 Steven M. Scharf, P.E.  
 NYSDEC  
 625 Broadway, 11<sup>th</sup> Floor  
 Albany, NY 12233-7015  
 (518) 402-9620

NYSDEC Concerns  
 Bill Fonda  
 NYSDEC-SUNY Campus  
 Loop Road Building 40  
 Stony Brook, NY 11790-2356  
 (631) 444-0350

NYSDOH Concerns  
 Trevor Wescott  
 NYSDOH  
 547 River Street  
 Troy, NY 12180  
 1-800-458-1158 Extension 2-7880

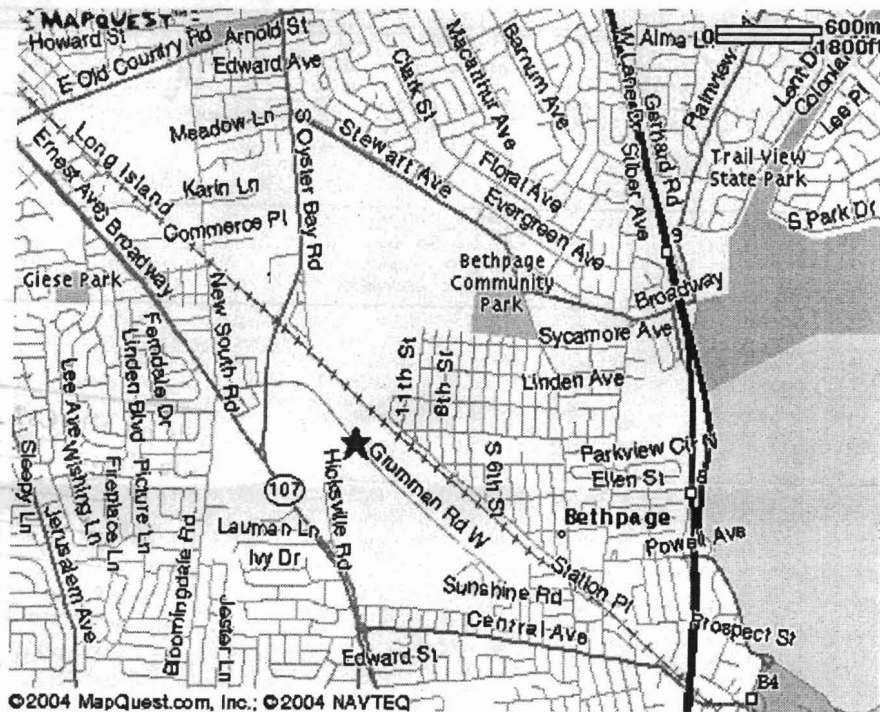

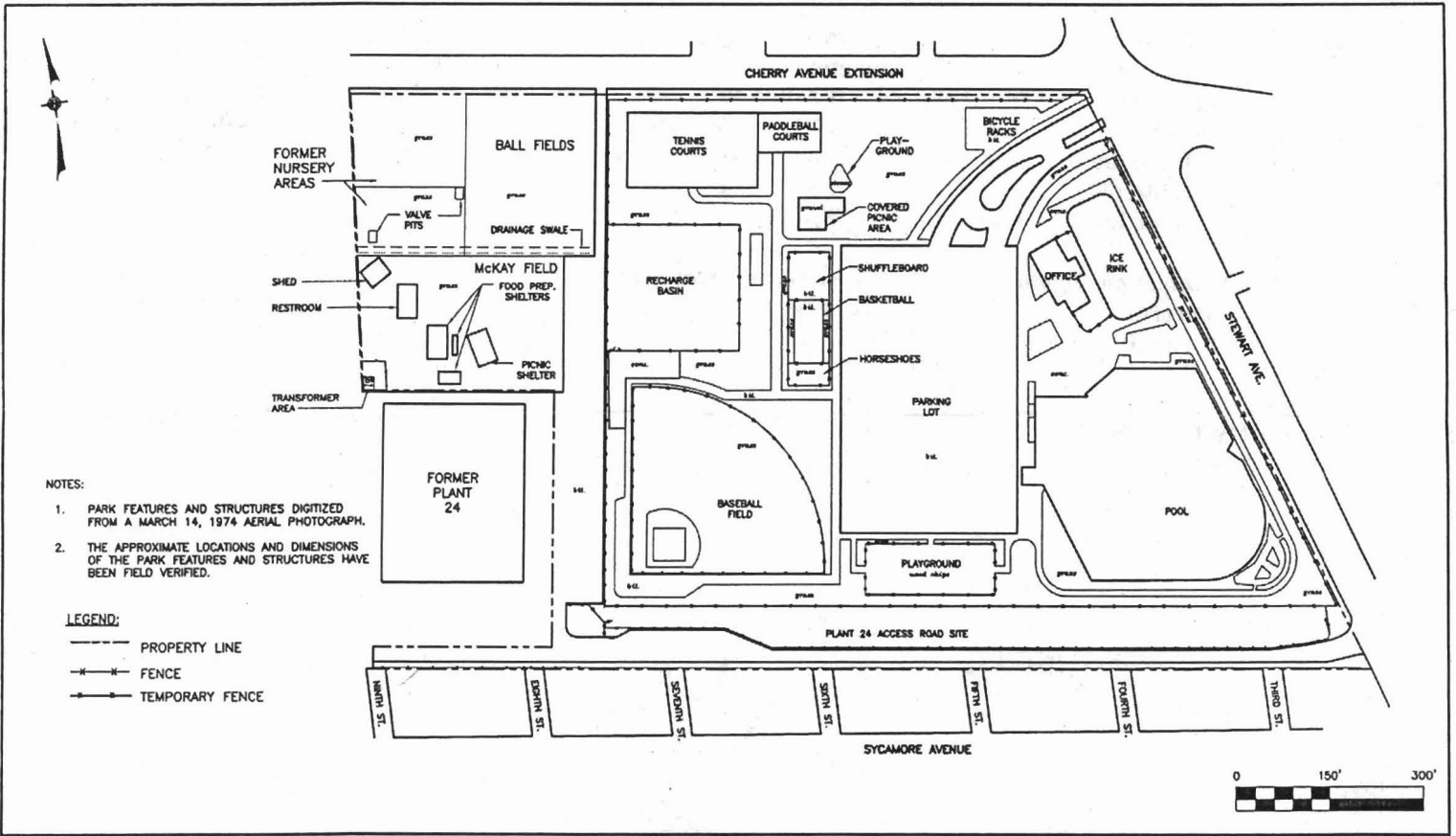

- NOTES:
1. PARK FEATURES AND STRUCTURES DIGITIZED FROM A MARCH 14, 1974 AERIAL PHOTOGRAPH.
  2. THE APPROXIMATE LOCATIONS AND DIMENSIONS OF THE PARK FEATURES AND STRUCTURES HAVE BEEN FIELD VERIFIED.

- LEGEND:
- PROPERTY LINE
  - X-X- FENCE
  - >->- TEMPORARY FENCE

TOWN OF OYSTER BAY  
 BETHPAGE COMMUNITY PARK  
 BETHPAGE, NEW YORK  
**SITE PLAN AND  
 SURROUNDING AREAS**

FIGURE 2-2

**db** Dvirka and Bartiucci  
 TOWN PLANNING ENGINEERS  
 A DIVISION OF KILLAM F. COBURN & ASSOCIATES, P.C.

File on eDOCs?  Yes  No  
 Site Name Former Gunning Settlement Parks  
 Site # 1-30-003A-003  
 County NASSAU  
 Town Oyster Bay  
 Foilable  Yes  No  
 Please Write The eDOC File Name Description PubNote 06-06