

**Steven Scharf - NGC OU3 - Petition for Reduction in Soil Gas Tracer Gas Testing**

---

**From:** "Stern, David" <DStern@arcadis-us.com>  
**To:** "Steven Scharf" <sxscharf@gw.dec.state.ny.us>  
**Date:** 5/15/2006 12:27 PM  
**Subject:** NGC OU3 - Petition for Reduction in Soil Gas Tracer Gas Testing  
**CC:** "Wolfert, Mike" <MWolfert@arcadis-us.com>, "San Giovanni, Carlo" <CSanGi...>  
**Attachments:** SGVLogs.PDF

---

Steve:

We have completed 19 soil gas borings at the site, each on different surfaces (concrete, asphalt, grass) and have been implementing the tracer gas study for each sample collected (total as required by NYSDOH guidance. The guidance does not specify how many times the study should be done, but states that it may be reduced to a 10% frequency after a successful demonstration of the collection of representative soil gas samples. We feel we have collected sufficient data to show that we are collecting representative soil gas samples and that the tracer gas study is no longer needed at the current frequency. We request agency approval for reduction of the tracer gas portion of the soil gas investigation.

Attached are copies of the soil gas logs showing successful completion of the tracer gas for your consideration. Please let me know at your earliest convenience. Feel free to call if you have questions.

<<SGVLogs.PDF>>

**David E. Stern, LEP**  
Senior Scientist  
**ARCADIS**  
88 Duryea Road  
Melville, NY 11747  
Main: (631) 249-7600  
Direct: (631) 391-5284  
Fax: (631) 249-7610  
Email: [dstern@arcadis-us.com](mailto:dstern@arcadis-us.com)  
Web: <http://www.arcadis-us.com/>

**NOTICE OF CONFIDENTIALITY**

The information contained in this e-mail message is intended only for the personal and confidential use of the recipient(s) named above. This message may be an attorney-client communication, and as such, is privileged and confidential. If the reader of this message is not the intended recipient or an agent responsible for delivering it to the intended recipient, you are hereby notified that you have received this document in error and that any review, dissemination, distribution, or copying of this message is strictly prohibited. If you have received this communication in error, please notify us immediately by e-mail, and delete the original message.



ARCADIS

# Soil Gas Sample Log

Sample ID SGP5 - (49-49.5)  
 Date 5/5/2006  
 Time 9:45am  
 Weather SUNNY, clear, 77°F  
 Atmos. Pressure 29.64

Project/No. NY001348 0806.0002  
 Sampling Personnel Mitch Waldron  
 Wind Speed: 1-3 mph  
 Precipitation?: None

### DESCRIPTION OF SAMPLE LOCATION:

Outdoor

Location Bethpage Park - Service Rd. 003  
 Est. depth to water (ft): 55'  
 Soil type: Sand & gravel  
 Odor: NO  
 Color: tan

Indoor

Location \_\_\_\_\_  
 Basement: yes / no  
 Room size ft x ft: \_\_\_\_\_  
 Floor material: cement / wood / dirt  
 Slab Thickness (ft): \_\_\_\_\_  
 Visible cracks?: yes / no  
 Sub-slab material: dirt / gravel

### PROBE INSTALLATION:

Date: 5/5/2006  
 Method: Direct Push  
 Diameter: 1 1/2"  
 Depth: 49'  
 Packing material: NDP

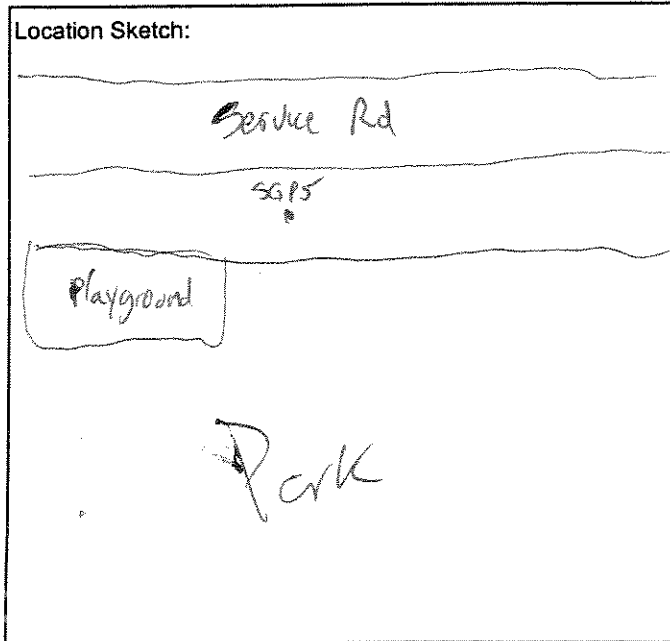

### PURGE:

Date: 5/5/2006  
 Time: 30min 10:05 - 10:40  
 Rate: 100 mL/min  
 Volume: 3L

### SAMPLE COLLECTION:

Sample Time: 30min  
 Sample Rate: 200 ml/min  
 Sample Volume: 6L  
 Sample Start Time: 10:47  
 Sample End Time: 11:17

### CONTAINER VACUUM:

Initial Canister Vacuum: 31 In  
 Final Canister Vacuum: 4 in

### CONTAINER DESCRIPTION:

Canister: 6-L Summa  
 Canister Serial Number: 3843

### ANALYTICAL METHOD:

TO15 & Emissions 12+22

Initial He in Shroud 45%  
 Final He in Shroud 40%  
 0.0 % He in purge Air  
 Final Purge = 0.0 %  
 Passed He tracer gas test



ARCADIS

# Soil Gas Sample Log

Sample ID SGP5 - (34-34.5)  
 Date 5/5/2006  
 Time 11:30  
 Weather Clear, Sunny, 76°F  
 Atmos. Pressure 29.63

Project/No. NY0013490806.0002  
 Sampling Personnel Mitch Wassman  
 Wind Speed: 3-6 mph  
 Precipitation?: No

### DESCRIPTION OF SAMPLE LOCATION:

Outdoor

Location Bethpage Park Service Road 00-3  
 Est. depth to water (ft): 55'  
 Soil type: sand & gravel  
 Odor: no  
 Color: Tan

Indoor

Location \_\_\_\_\_  
 Basement: yes / no \_\_\_\_\_  
 Room size ft x ft: \_\_\_\_\_  
 Floor material: cement / wood / dirt \_\_\_\_\_  
 Slab Thickness (ft): \_\_\_\_\_  
 Visible cracks?: yes / no \_\_\_\_\_  
 Sub-slab material: dirt / gravel \_\_\_\_\_

### PROBE INSTALLATION:

Date: 5/5/2006  
 Method: Direct Push  
 Diameter: 1 1/2"  
 Depth: 35'  
 Packing material: none

Location Sketch:  
see SGP5 - (49-49.3)

### PURGE:

Date: 5/5/2006  
 Time: 21 min 11:41 - 12:02  
 Rate: 100ml/min  
 Volume: 2L

### SAMPLE COLLECTION:

Sample Time: 30 min  
 Sample Rate: 200ml/min  
 Sample Volume: 6L  
 Sample Start Time: 12:02  
 Sample End Time: 12:31

### CONTAINER VACUUM:

Initial Canister Vacuum: -20" Hg  
 Final Canister Vacuum: -21" Hg

### CONTAINER DESCRIPTION:

Canister: 6-L Summa  
 Canister Serial Number: 2542

### ANALYTICAL METHOD:

TO15 & Freon's 12+22

Initial He in Shroud 34%  
 Final He in Shroud 29%  
 0.02% He in Purge Air 0.0  
 Passed Helium Tracer Gas test



ARCADIS

# Soil Gas Sample Log

Sample ID SGP5-(7-7.5)  
 Date 5/5/2006  
 Time 11:00pm  
 Weather Sunny, Clear 75°F  
 Atmos. Pressure 29.60

Project/No. NY0013480006.0002  
 Sampling Personnel Michael Jackson  
 Wind Speed: 1-5 mph  
 Precipitation?: None

### DESCRIPTION OF SAMPLE LOCATION:

|                                     |                                    |
|-------------------------------------|------------------------------------|
| <input checked="" type="checkbox"/> | Outdoor                            |
| <input type="checkbox"/>            | Indoor                             |
| Location                            | <u>Ballhouse Park Service Road</u> |
| Est. depth to water (ft):           | <u>55'</u>                         |
| Soil type:                          | <u>Sand &amp; gravel</u>           |
| Odor:                               | <u>None</u>                        |
| Color:                              | <u>tan</u>                         |

|                          |                      |
|--------------------------|----------------------|
| <input type="checkbox"/> | Indoor               |
| Location                 |                      |
| Basement:                | yes / no             |
| Room size ft x ft:       |                      |
| Floor material:          | cement / wood / dirt |
| Slab Thickness (ft):     |                      |
| Visible cracks?:         | yes / no             |
| Sub-slab material:       | dirt / gravel        |

### PROBE INSTALLATION:

Date: 5/5/2006  
 Method: Direct Push  
 Diameter: 1 1/2"  
 Depth: 7.5'  
 Packing material: None

Location Sketch:  
See SGP5-(49-49.5)

### PURGE:

Date: 5/5/2006  
 Time: 6 min 12:57-1:03  
 Rate: 100ml/min  
 Volume: 0.6L

### SAMPLE COLLECTION:

Sample Time: 30 min  
 Sample Rate: 200 ml/min  
 Sample Volume: 6L  
 Sample Start Time: 1:03  
 Sample End Time: 1:30

### CONTAINER VACUUM:

Initial Canister Vacuum: -28" Hg  
 Final Canister Vacuum: -2" Hg

### CONTAINER DESCRIPTION:

Canister: 6-L Summa  
 Canister Serial Number: 3014

### ANALYTICAL METHOD:

T015 Freon 12 + 22

Initial He in Shroud 35%  
 Final He in Shroud 32%  
 0.00% He in purge air  
 passed He tracer gas test



ARCADIS

# Soil Gas Sample Log

Sample ID SGP-6 (49-49.5)  
 Date 05/02/06  
 Time 10:45  
 Weather Sunny 29.87 in Hg, 69.7  
 Atmos. Pressure 29.87

Project/No. NY001348, 0806, 2  
 Sampling Personnel JHC  
MW  
 Wind Speed: 7 mph from NE  
 Precipitation?: NO

### DESCRIPTION OF SAMPLE LOCATION:

Outdoor

Location SGP-6  
 Est. depth to water (ft): 55 ft  
 Soil type: Sec Log  
 Odor: None  
 Color: Sec Log

Indoor

Location \_\_\_\_\_  
 Basement: yes / no \_\_\_\_\_  
 Room size ft x ft: \_\_\_\_\_  
 Floor material: cement / wood / dirt \_\_\_\_\_  
 Slab Thickness (ft): \_\_\_\_\_  
 Visible cracks?: yes / no \_\_\_\_\_  
 Sub-slab material: dirt / gravel \_\_\_\_\_

### PROBE INSTALLATION:

Date: 05/02/06  
 Method: Geoprobe 1.5" with PRT adapter  
 Diameter: 1.5"  
 Depth: 49.5'  
 Packing material: \_\_\_\_\_

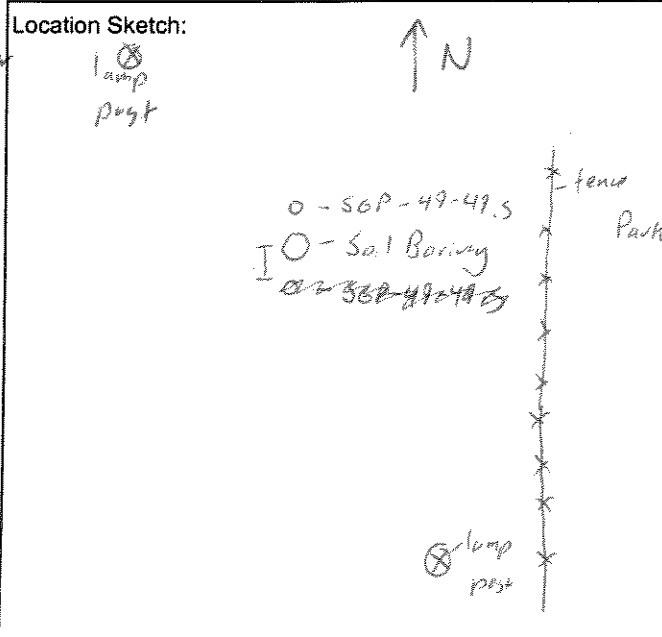

### PURGE:

Date: 05/02/06  
 Time: 10:45 - 11:15  
 Rate: 108 ml/min  
 Volume: 3000 ml

### SAMPLE COLLECTION:

Sample Time: 11:18 - 11:40  
 Sample Rate: 200 ml/min  
 Sample Volume: 6L  
 Sample Start Time: 11:18  
 Sample End Time: 11:40

### CONTAINER VACUUM:

Initial Canister Vacuum: 29 in Hg  
 Final Canister Vacuum: 4" Hg

### CONTAINER DESCRIPTION:

Canister: 6-L Summa  
 Canister Serial Number: 6321

### ANALYTICAL METHOD:

VOL - TO - 15 + Freon 12 + Freon 22

Helium - <sup>(standard)</sup> Initial - Can - 42% Final - 37%  
 Purge - ~~0.45~~ 0.35<sup>2</sup> backgron  
 0.45<sup>2</sup> purge  
 10:45 - 11:15a  
 Passed Tracer Gas Test



ARCADIS

# Soil Gas Sample Log

Sample ID SGP-6(8.0-8.5)  
 Date 05/02/06  
 Time 1:30  
 Weather Mostly Cloudy  
 Atmos. Pressure 29.80

Project/No. NY001348.0806  
 Sampling Personnel JHL  
MW  
 Wind Speed: 2 MPH from NE  
 Precipitation?: NO

### DESCRIPTION OF SAMPLE LOCATION:

Outdoor

Location SGP-6  
 Est. depth to water (ft): 55 ft  
 Soil type: See Log  
 Odor: None  
 Color: None

Indoor

Location \_\_\_\_\_  
 Basement: yes / no \_\_\_\_\_  
 Room size ft x ft: \_\_\_\_\_  
 Floor material: cement / wood / dirt \_\_\_\_\_  
 Slab Thickness (ft): \_\_\_\_\_  
 Visible cracks?: yes / no \_\_\_\_\_  
 Sub-slab material: dirt / gravel \_\_\_\_\_

### PROBE INSTALLATION:

Date: 5/2/2006  
 Method: Direct Push  
 Diameter: 1.5"  
 Depth: 8' @ 8.5'  
 Packing material: None

Location Sketch:  
See SGP 6-(49-49.5)

### PURGE:

Date: 05/02/06  
 Time: 1:27-1:33  
 Rate: 115 ml/min  
 Volume: ~700 ml (600 600ml for 1.5L)

### SAMPLE COLLECTION:

Sample Time: 1:35-2:05  
 Sample Rate: 200 ml/min  
 Sample Volume: 6L  
 Sample Start Time: 1:35  
 Sample End Time: 2:05

### CONTAINER VACUUM:

Initial Canister Vacuum: 29 in Hg  
 Final Canister Vacuum: 4" Hg

Initial  
 Helium: In Can - 43%  
 Purge - 0% 1:27-1:34  
Final  
 In Can - 42%

### CONTAINER DESCRIPTION:

Canister: 6-L Summa  
 Canister Serial Number: 6777

### ANALYTICAL METHOD:

7015 E Fractions 12622

Passed Tracer Gas test



ARCADIS

# Soil Gas Sample Log

Sample ID SGP6-(34-34.5)  
Date 5/2/2006

Project/No. NY001348-0806-0002

Sampling Personnel M. de la Cruz

DESCRIPTION OF SAMPLE LOCATION:



ARCADIS

# Soil Gas Sample Log

Sample ID SGP 7 - (7-7.5)  
 Date 5/3/2006  
 Time 1:15 pm  
 Weather clear 71°F  
 Atmos. Pressure 29.66

Project/No. NY001348.0806.0002  
 Sampling Personnel Mitch Weckman  
 Wind Speed: 5 mph  
 Precipitation?: None

### DESCRIPTION OF SAMPLE LOCATION:

Outdoor

Location Bathpage Park SGP 7  
 Est. depth to water (ft): 95'  
 Soil type: sand & gravel  
 Odor: Yes  
 Color: Tan with staining

Indoor

Location \_\_\_\_\_  
 Basement: yes / no  
 Room size ft x ft: \_\_\_\_\_  
 Floor material: cement / wood / dirt  
 Slab Thickness (ft): \_\_\_\_\_  
 Visible cracks?: yes / no  
 Sub-slab material: dirt / gravel

### PROBE INSTALLATION:

Date: 5/3/2006  
 Method: Direct Push  
 Diameter: 1.5"  
 Depth: 7.5'  
 Packing material: None

### PURGE:

Date: 5/3/2006  
 Time: 1:30 - 1:36  
 Rate: 100ml/min  
 Volume: 0.6L

### SAMPLE COLLECTION:

Sample Time: 1:40  
 Sample Rate: 200ml/min  
 Sample Volume: 6L  
 Sample Start Time: 1:40  
 Sample End Time: 2:10

### CONTAINER VACUUM:

Initial Canister Vacuum: -30  
 Final Canister Vacuum: -5

### CONTAINER DESCRIPTION:

Canister: 6-L Summa  
 Canister Serial Number: 2734

### ANALYTICAL METHOD:

TO15 & from 12 & 22

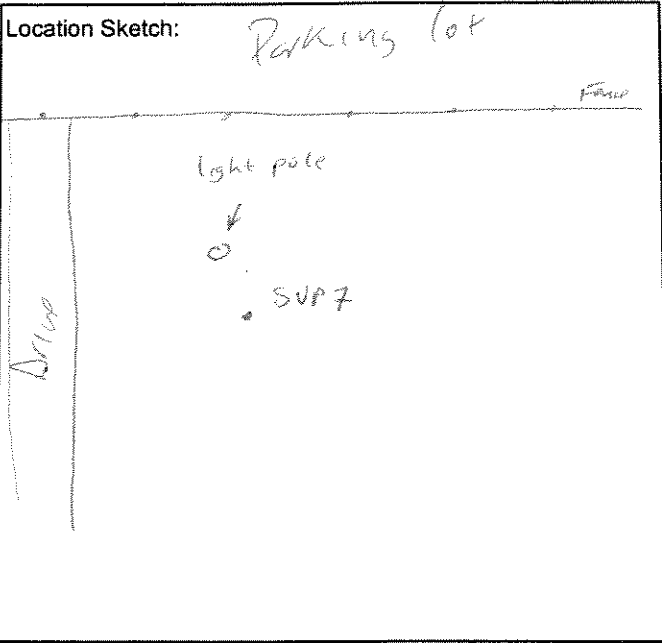

Initial He @ Top of Shroud 33%  
 Final He @ Top of Shroud 27%  
 0.0% He in Purge Air 1:30-1:36pm  
 Tracer Gas Passed





ARCADIS

# Soil Gas Sample Log

Sample ID SGP7-(34-34.5)  
 Date 5/3/2006  
 Time 12:00  
 Weather Overcast, 60°F  
 Atmos. Pressure 29.69

Project/No. N/0013480006.0002  
 Sampling Personnel Mitch Wackman  
 Wind Speed: 3-6 mph  
 Precipitation?: None

### DESCRIPTION OF SAMPLE LOCATION:

Outdoor

Location Bathpage Park SGP7  
 Est. depth to water (ft): 55'  
 Soil type: Sand & Gravel  
 Odor: Yes, strong  
 Color: Tan

Indoor

Location \_\_\_\_\_  
 Basement: yes / no  
 Room size ft x ft: \_\_\_\_\_  
 Floor material: cement / wood / dirt  
 Slab Thickness (ft): \_\_\_\_\_  
 Visible cracks?: yes / no  
 Sub-slab material: dirt / gravel

### PROBE INSTALLATION:

Date: 5/3/2006  
 Method: Direct Push  
 Diameter: 1.5"  
 Depth: 34-34.5'  
 Packing material: None

Location Sketch:  
See SGP7-(7-7.5)

### PURGE:

Date: 5/3/2006  
 Time: 12:19-12:40  
 Rate: 115 ml/min  
 Volume: 2L

### SAMPLE COLLECTION:

Sample Time: 12:40  
 Sample Rate: 200 ml/min  
 Sample Volume: 6L  
 Sample Start Time: 12:20 12:40  
 Sample End Time: 1:10

### CONTAINER VACUUM:

Initial Canister Vacuum: -35  
 Final Canister Vacuum: -5

### CONTAINER DESCRIPTION:

Canister: 6-L Summa  
 Canister Serial Number: 2602

### ANALYTICAL METHOD:

TO15 & Freon 12 & 22

Initial He @ top of can 40%  
 Final He @ Top of can 37%  
 0.0% He in Purge Air 12:19-12:40  
 Tracer Gas Passed



ARCADIS

# Soil Gas Sample Log

Sample ID SGP7-(49-49.5)  
 Date 5/3/2006  
 Time 10:30 am  
 Weather overcast; 59° E  
 Atmos. Pressure 29.73

Project/No. NY0013480806-0022  
 Sampling Personnel  Mitch Wacksmul   
 Wind Speed: 1-5 mph  
 Precipitation?: none

### DESCRIPTION OF SAMPLE LOCATION:

Outdoor

Location SGP7  
 Est. depth to water (ft): 55'  
 Soil type: Sand & gravel  
 Odor: Oil  
 Color: tan

Indoor

Location \_\_\_\_\_  
 Basement: yes / no  
 Room size ft x ft: \_\_\_\_\_  
 Floor material: cement / wood / dirt  
 Slab Thickness (ft): \_\_\_\_\_  
 Visible cracks?: yes / no  
 Sub-slab material: dirt / gravel

### PROBE INSTALLATION:

Date: 5/3/2006  
 Method: Direct Push  
 Diameter: 1.5"  
 Depth: 49-49.5'  
 Packing material: None

Location Sketch:  
see SGP7(7-7.5)

### PURGE:

Date: 5/3/2006  
 Time: 10:50-11:20  
 Rate: 100ml/min  
 Volume: 3L

*Extra Volume  
 purged due  
 to equipment  
 problems*

### SAMPLE COLLECTION:

Sample Time: 11:20  
 Sample Rate: 200ml/min  
 Sample Volume: 6L  
 Sample Start Time: 11:20  
 Sample End Time: 11:50

### CONTAINER VACUUM:

Initial Canister Vacuum: -32  
 Final Canister Vacuum: -5

### CONTAINER DESCRIPTION:

Canister: 6-L Summa  
 Canister Serial Number: 6773

### ANALYTICAL METHOD:

TO15 & Freons 12&22

*Initial He @ top of can 43%  
 Final He @ top of can 35%  
 -1 0.0% He in purge air 10:50-11:20  
 Tracer Gas Passed*



ARCADIS

# Soil Gas Sample Log

Sample ID SGPB - (49-49.5)  
 Date 5/4/2006  
 Time 10:15  
 Weather Sunny, clear, 70°F  
 Atmos. Pressure 29.77

Project/No. NY001348-0806 0001  
 Sampling Personnel Mitch Weckmann  
 Wind Speed: 1-5 mph  
 Precipitation?: None

### DESCRIPTION OF SAMPLE LOCATION:

Outdoor

Location Rethpage Park SGPB-013  
 Est. depth to water (ft): 55'  
 Soil type: sand & gravel  
 Odor: little  
 Color: Tan - Brown

Indoor

Location \_\_\_\_\_  
 Basement: yes / no  
 Room size ft x ft: \_\_\_\_\_  
 Floor material: cement / wood / dirt  
 Slab Thickness (ft): \_\_\_\_\_  
 Visible cracks?: yes / no  
 Sub-slab material: dirt / gravel

### PROBE INSTALLATION:

Date: 5/4/2006  
 Method: Direct Push  
 Diameter: 1 1/2"  
 Depth: 49.5'  
 Packing material: None

### PURGE:

Date: 5/4/2006  
 Time: 30 min 10:20-10:50  
 Rate: 100ml/min  
 Volume: 3L

### SAMPLE COLLECTION:

Sample Time: 10:50  
 Sample Rate: 200ml/min  
 Sample Volume: 6L  
 Sample Start Time: 10:50  
 Sample End Time: 11:27

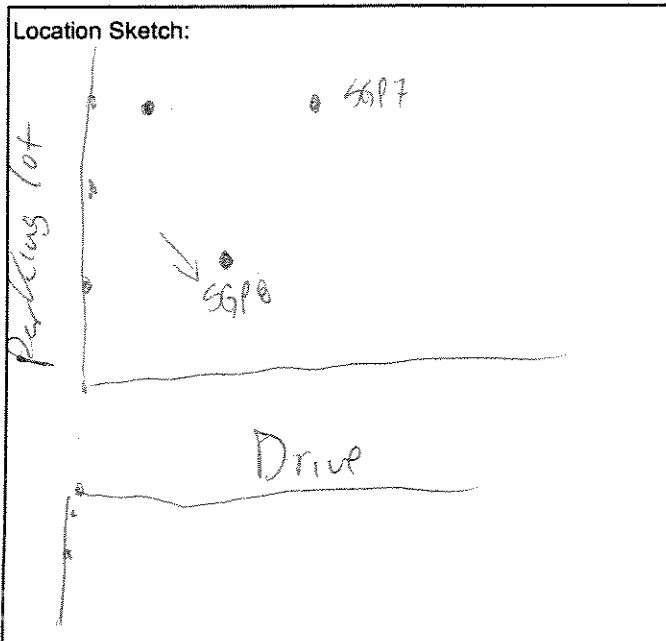

### CONTAINER VACUUM:

Initial Canister Vacuum: -28  
 Final Canister Vacuum: -5

### CONTAINER DESCRIPTION:

Canister: 6-L Summa  
 Canister Serial Number: 3093

### ANALYTICAL METHOD:

TO15 & Freons 12 + 22

Initial He in shroud 54%  
 Final He in shroud 49%  
 0.00% He in Purge Air 10:20-10:50  
 Passed Tracer-Gas Test



ARCADIS

# Soil Gas Sample Log

Sample ID SGPB-(34-34.5)  
 Date 04/5/14/2006  
 Time 12:00  
 Weather Sunny, Clear 74°F  
 Atmos. Pressure 29.69

Project/No. NX001348 0806.0002  
 Sampling Personnel Mitch Wackema  
 Wind Speed: 3-5 mph  
 Precipitation?: None

### DESCRIPTION OF SAMPLE LOCATION:

Outdoor

Location Bethpage Park SGPB-003  
 Est. depth to water (ft): 5.5'  
 Soil type: Sand & gravel  
 Odor: None  
 Color: Tan

Indoor

Location \_\_\_\_\_  
 Basement: yes / no  
 Room size ft x ft: \_\_\_\_\_  
 Floor material: cement / wood / dirt  
 Slab Thickness (ft): \_\_\_\_\_  
 Visible cracks?: yes / no  
 Sub-slab material: dirt / gravel

### PROBE INSTALLATION:

Date: 5/14/2006  
 Method: Direct Push  
 Diameter: 1.5"  
 Depth: 34.5'  
 Packing material: None

Location Sketch:  
See SGPB-(49-49.5)

### PURGE:

Date: 5/14/2006  
 Time: 12:00 to 2:00 11:54-12:17  
 Rate: 100ml/min  
 Volume: 2L

### SAMPLE COLLECTION:

Sample Time: 12:17 30min  
 Sample Rate: 200 ml/min  
 Sample Volume: 6L  
 Sample Start Time: 12:17  
 Sample End Time: 12:47

### CONTAINER VACUUM:

Initial Canister Vacuum: -30  
 Final Canister Vacuum: -5

### CONTAINER DESCRIPTION:

Canister: 6-L Summa  
 Canister Serial Number: 2792

### ANALYTICAL METHOD:

TO15 & Freons (2+2)

Initial He in Shroud 42%  
 Final He in Shroud 39%  
 0.0% He in Purge Air 11:54-12:17  
 Passed Tracer Gas



ARCADIS

# Soil Gas Sample Log

Sample ID SGPB-(7-7.5)  
 Date 5/4/2006  
 Time 1pm  
 Weather Sunny, clear, 75°F  
 Atmos. Pressure 29.63

Project/No. NY001348.0806.002  
 Sampling Personnel Mitch Jackson  
 Wind Speed: 2-4 mph  
 Precipitation?: None

### DESCRIPTION OF SAMPLE LOCATION:

|   |
|---|
| <input checked="" type="checkbox"/> Outdoor |
| Location <u>Bothways Park SGPB-023</u>      |
| Est. depth to water (ft): <u>55'</u>        |
| Soil type: <u>sand &amp; gravel</u>         |
| Odor: <u>None</u>                           |
| Color: <u>Tan - Brown</u>                   |

|   |
|---|
| <input type="checkbox"/> Indoor             |
| Location                                    |
| Basement: <u>yes / no</u>                   |
| Room size ft x ft:                          |
| Floor material: <u>cement / wood / dirt</u> |
| Slab Thickness (ft):                        |
| Visible cracks?: <u>yes / no</u>            |
| Sub-slab material: <u>dirt / gravel</u>     |

### PROBE INSTALLATION:

Date: 5/4/2006  
 Method: Direct Push  
 Diameter: 1 1/2"  
 Depth: 7.5'  
 Packing material: None

Location Sketch:  
see SGPB-(49-49.5)

### PURGE:

Date: 5/4/2006  
 Time: 6min 1:06-1:12  
 Rate: 100ml/min  
 Volume: 0.6L

### SAMPLE COLLECTION:

Sample Time: 30min  
 Sample Rate: 200ml/min  
 Sample Volume: 6L  
 Sample Start Time: 1:12  
 Sample End Time: 1:38

### CONTAINER VACUUM:

Initial Canister Vacuum: -27  
 Final Canister Vacuum: -2

### CONTAINER DESCRIPTION:

Canister: 6-L Summa  
 Canister Serial Number: 3340

### ANALYTICAL METHOD:

TO15 & Kreong 12+22

He Initial He in Shroud 31%  
 Final He in Shroud 30%  
 0.07% He in Purge Air 1:06-1:12  
 Passed Tracer gas test



ARCADIS

# Soil Gas Sample Log

Sample ID SGP9-(7-7.5)  
 Date 4/28/2006  
 Time 4:00pm  
 Weather Clear, Sunny 60°  
 Atmos. Pressure \_\_\_\_\_

Project/No. NY 001348.08.06.002  
 Sampling Personnel Mitch Jacksman  
John Corral  
 Wind Speed: \_\_\_\_\_  
 Precipitation?: \_\_\_\_\_

### DESCRIPTION OF SAMPLE LOCATION:

Outdoor

Location Bethpage Park, Parking Lot  
 Est. depth to water (ft): 55'  
 Soil type: sand & gravel  
 Odor: None  
 Color: white-brown

Indoor

Location \_\_\_\_\_  
 Basement: yes / no  
 Room size ft x ft: \_\_\_\_\_  
 Floor material: cement / wood / dirt  
 Slab Thickness (ft): \_\_\_\_\_  
 Visible cracks?: yes / no  
 Sub-slab material: dirt / gravel

### PROBE INSTALLATION:

Date: 4/28/2006  
 Method: Direct Push  
 Diameter: 1.5"  
 Depth: 8'  
 Packing material: \_\_\_\_\_

### PURGE:

Date: 4/28/2006  
 Time: 6 min  
 Rate: 100 mL/min  
 Volume: 600 mL

### SAMPLE COLLECTION:

Sample Time: 30 min  
 Sample Rate: 200 mL/min  
 Sample Volume: 6 L  
 Sample Start Time: 3:54  
 Sample End Time: 4:24

### CONTAINER VACUUM:

Initial Canister Vacuum: -30  
 Final Canister Vacuum: -5

### CONTAINER DESCRIPTION:

Canister: 6-L Summa  
 Canister Serial Number: 6843

### ANALYTICAL METHOD:

TO15 & Ecom 12422

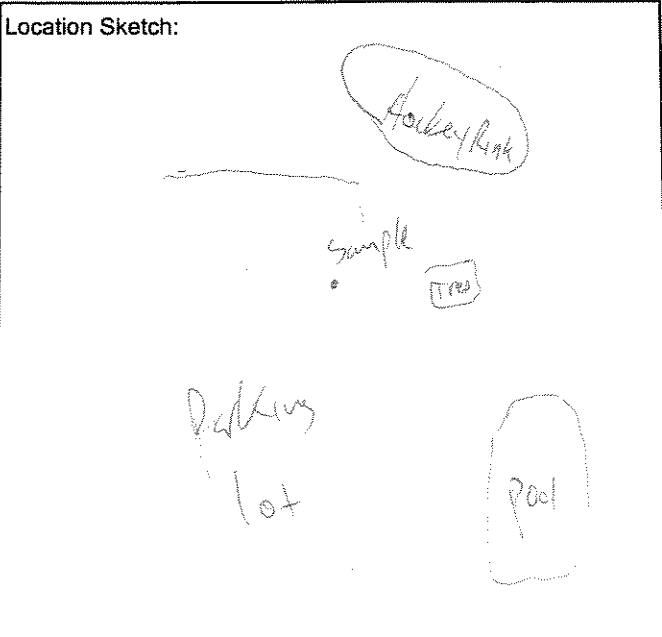

Initial He in Shroud 35%  
 Final He in Shroud 32%  
 0.05% He in purge air from 3:47-3:53  
 -Tracer Gas Passed



ARCADIS

# Soil Gas Sample Log

Sample ID: 56P9-(34-34.5)  
 Date: 5/1/2006  
 Time: 11:15  
 Weather: Sunny, windy, clear 61°F  
 Atmos. Pressure: 30.20

Project/No. NY0013R.0806.0002  
 Sampling Personnel: Mitch Wickstrom  
 Wind Speed: 5-12 mph  
 Precipitation?: None

### DESCRIPTION OF SAMPLE LOCATION:

Outdoor

Location: Bethpage Park  
 Est. depth to water (ft): 55'  
 Soil type: Sandy with gravel  
 Odor: \_\_\_\_\_  
 Color: tan

Indoor

Location: \_\_\_\_\_  
 Basement: yes / no  
 Room size ft x ft: \_\_\_\_\_  
 Floor material: cement / wood / dirt  
 Slab Thickness (ft): \_\_\_\_\_  
 Visible cracks?: yes / no  
 Sub-slab material: dirt / gravel

### PROBE INSTALLATION:

Date: 5/1/2006  
 Method: Direct Push  
 Diameter: 2.5" 1.5"  
 Depth: 34.5'  
 Packing material: \_\_\_\_\_

### PURGE:

Date: 5/1/2006  
 Time: 11:20  
 Rate: 100ml/min  
 Volume: 2L

### SAMPLE COLLECTION:

Sample Time: 11:43  
 Sample Rate: 200ml/min  
 Sample Volume: 6L  
 Sample Start Time: 11:43  
 Sample End Time: 12:13

### CONTAINER VACUUM:

Initial Canister Vacuum: -50"  
 Final Canister Vacuum: -5"

### CONTAINER DESCRIPTION:

Canister: 6-L Summa  
 Canister Serial Number: 6077

### ANALYTICAL METHOD:

TO15 & Freons 12&22

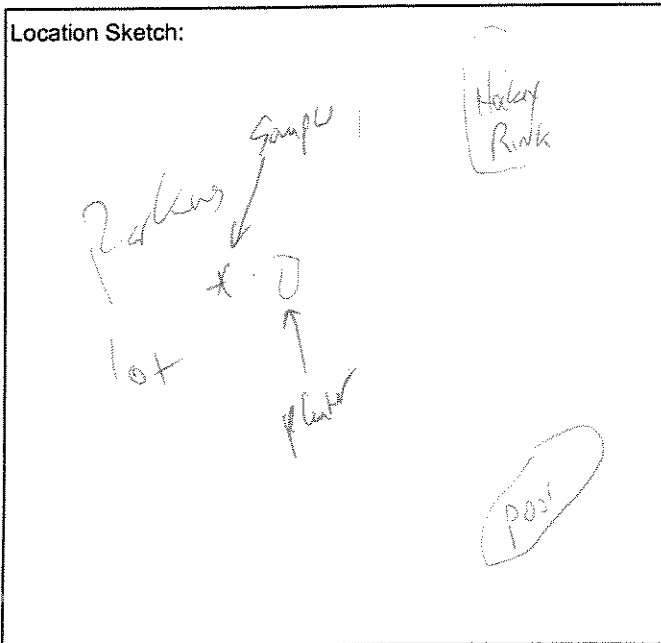

Initial He @ top of can 41%  
 Final He @ top of can 38%



ARCADIS

# Soil Gas Sample Log

Sample ID SGP9-(49-495)  
 Date 5/1/2006  
 Time 9 am  
 Weather Clear, Windy 60°F  
 Atmos. Pressure 30.22" Hg

Project/No. NY001348-0806 0002  
 Sampling Personnel Mitch Winkler  
 Wind Speed: 5-10 mph  
 Precipitation?: None

### DESCRIPTION OF SAMPLE LOCATION:

|                                     |                      |
|-------------------------------------|----------------------|
| <input checked="" type="checkbox"/> | Outdoor              |
| Location                            | <u>Bethpage Park</u> |
| Est. depth to water (ft):           | <u>55'</u>           |
| Soil type:                          | <u>Sand</u>          |
| Order                               | <u>None</u>          |

|                          |                      |
|--------------------------|----------------------|
| <input type="checkbox"/> | Indoor               |
| Location                 |                      |
| Basement:                | yes / no             |
| Room size ft x ft:       |                      |
| Floor material:          | cement / wood / dirt |
| Slab Thickness (ft):     |                      |





ARCADIS

# Soil Gas Sample Log

Sample ID SGP10-50(49-49.5)  
 Date 4/27/2006  
 Time 12:30  
 Weather Sunny, 70°F  
 Atmos. Pressure \_\_\_\_\_

Project/No. NY 001348.08062  
 Sampling Personnel Nitch Wadsworth  
John Corral  
 Wind Speed: NA  
 Precipitation?: NA

### DESCRIPTION OF SAMPLE LOCATION:

Outdoor

Location Bethpage Park  
 Est. depth to water (ft): 55'  
 Soil type: sand & gravel  
 Odor: NO  
 Color: Tan

Indoor

Location \_\_\_\_\_  
 Basement: yes / no  
 Room size ft x ft: \_\_\_\_\_  
 Floor material: cement / wood / dirt  
 Slab Thickness (ft): \_\_\_\_\_  
 Visible cracks?: yes / no  
 Sub-slab material: dirt / gravel

### PROBE INSTALLATION:

Date: 04/27/06  
 Method: Geo probe  
 Diameter: \_\_\_\_\_  
 Depth: 49.5  
 Packing material: \_\_\_\_\_

### PURGE:

Date: 04/27/06  
 Time: 12:30  
 Rate: 108 ml/min  
 Volume: 2900 ml = 1.5 Volumes

### SAMPLE COLLECTION:

Sample Time: ~~1:11~~ 30min  
 Sample Rate: 200ml/min  
 Sample Volume: 6L  
 Sample Start Time: ~~1:11~~ 1:11  
 Sample End Time: 1:38

### CONTAINER VACUUM:

Initial Canister Vacuum: 31  
 Final Canister Vacuum: 5

### CONTAINER DESCRIPTION:

Canister: 6-L Summa 5262  
 Canister Serial Number: \_\_\_\_\_

### ANALYTICAL METHOD:

TO15 & Frauns 12822

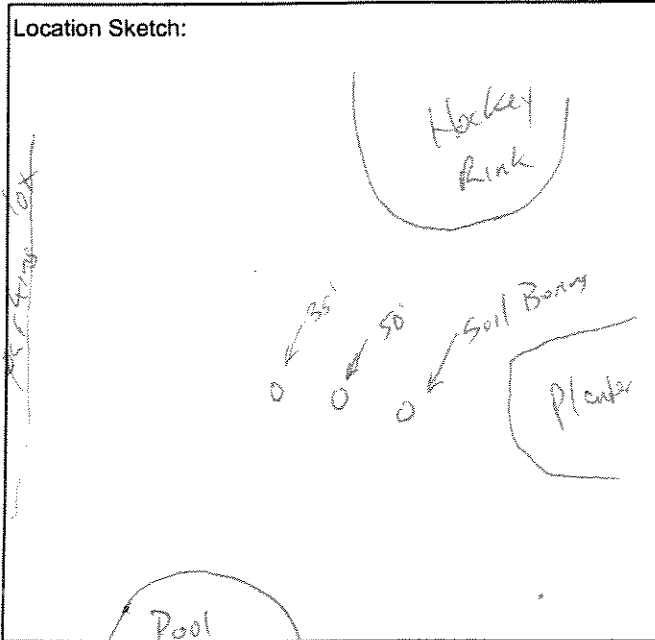

Note: 15% helium in bucket (shroud)  
 0.0% He in Purge Air 12:35-1:05  
 Tracer Gas Passed



ARCADIS

# Soil Gas Sample Log

Sample ID SGP10-8.0-7.5  
 Date 04/27/06  
 Time 3:40  
 Weather \_\_\_\_\_  
 Atmos. Pressure \_\_\_\_\_

Project/No. NY001348.0806.2  
 Sampling Personnel John Corral  
Mitch Wackman  
 Wind Speed: \_\_\_\_\_  
 Precipitation?: \_\_\_\_\_

### DESCRIPTION OF SAMPLE LOCATION:

Outdoor

Location \_\_\_\_\_

Est. depth to water (ft): 5.5 ft

Soil type: Sand

Odor: \_\_\_\_\_

Color: \_\_\_\_\_

Indoor

Location \_\_\_\_\_

Basement: yes / no

Room size ft x ft: \_\_\_\_\_

Floor material: cement / wood / dirt

Slab Thickness (ft): \_\_\_\_\_

Visible cracks?: yes / no

Sub-slab material: dirt / gravel

### PROBE INSTALLATION:

Date: 04/27/06  
 Method: Geoprobe  
 Diameter: 1.5"  
 Depth: 7.5-8.0  
 Packing material: Grout

Location Sketch:

See sample SGP10-(4.9-4.5)

### PURGE:

Date: 04/27/06  
 Time: 3:34-3:40  
 Rate: 100 ml/ml.3  
 Volume: 600ml (463 = 1.5 Volumes)

### SAMPLE COLLECTION:

Sample Time: 3:40-

Sample Rate: \_\_\_\_\_

Sample Volume: 6L

Sample Start Time: 3:40

Sample End Time: \_\_\_\_\_

### CONTAINER VACUUM:

Initial Canister Vacuum: 32

Final Canister Vacuum: 5

### CONTAINER DESCRIPTION:

Canister: 6-L Summa

Canister Serial Number: 5938

### ANALYTICAL METHOD:

Note = Initial Helium = >20 in Can  
 = 0.05 in purge 3:34

Final Helium = 5% in Can  
 = 0.00 in purge 3:40

Tracer Gas Passed



ARCADIS

# Soil Gas Sample Log

Sample ID SGP-10-(34-34.5)  
 Date 04/27/06  
 Time 2:15  
 Weather Sunny  
 Atmos. Pressure unk

Project/No. NY001348.0006.0007  
 Sampling Personnel John Coord  
Mitch Wheelwright  
 Wind Speed: unk  
 Precipitation?: None

### DESCRIPTION OF SAMPLE LOCATION:

|                                     |                          |
|-------------------------------------|--------------------------|
| <input checked="" type="checkbox"/> | Outdoor                  |
| Location                            | <u>Bethpage Park</u>     |
| Est. depth to water (ft):           | <u>55'</u>               |
| Soil type:                          | <u>sand &amp; gravel</u> |
| Odor:                               | <u>None</u>              |
| Color:                              | <u>Tan</u>               |

|                          |                      |
|--------------------------|----------------------|
| <input type="checkbox"/> | Indoor               |
| Location                 | _____                |
| Basement:                | yes / no             |
| Room size ft x ft:       | _____                |
| Floor material:          | cement / wood / dirt |
| Slab Thickness (ft):     | _____                |
| Visible cracks?:         | yes / no             |
| Sub-slab material:       | dirt / gravel        |

### PROBE INSTALLATION:

Date: 04/27/06  
 Method: Geoprobe  
 Diameter: 1.5  
 Depth: 34-34.5  
 Packing material: Grout the hole

Location Sketch:

See Sample SGP10-(49-49.5)

### PURGE:

Date: 04/27/06  
 Time: 2:17 - 2:38  
 Rate: 102 ml/min  
 Volume: 2025 ml

### SAMPLE COLLECTION:

Sample Time: 2:40 - 3:12  
 Sample Rate: \_\_\_\_\_  
 Sample Volume: 6L  
 Sample Start Time: 2:40  
 Sample End Time: 3:12

### CONTAINER VACUUM:

Initial Canister Vacuum: 31  
 Final Canister Vacuum: 5 (Note 2 when Valve closed)

### CONTAINER DESCRIPTION:

Canister: 6-L Summa  
 Canister Serial Number: 3400  
cont # 24153

### ANALYTICAL METHOD:

TO15 & Eron 12&17

Note: <sup>7</sup> 17% Helium in Can (shroud)  
 Note: <sup>7</sup> 0.08% from Pump Air 2:17-2:38pm  
 Tracer Gas Passed



ARCADIS

# Soil Gas Sample Log

Sample ID SGP11 (7-7.5)  
 Date 5/5/2006  
 Time 1:30pm  
 Weather Sunny clear 75°F  
 Atmos. Pressure 29.59

Project/No. NY0013480806.0002  
 Sampling Personnel Mich. Weckesman  
 Wind Speed: 1.5 mph  
 Precipitation?: None

### DESCRIPTION OF SAMPLE LOCATION:

Outdoor

Location Bethpage Park Service Rd - 015  
 Est. depth to water (ft): 53'  
 Soil type: Sand & Gravel  
 Odor: None  
 Color: tan

Indoor

Location \_\_\_\_\_  
 Basement: yes / no \_\_\_\_\_  
 Room size ft x ft: \_\_\_\_\_  
 Floor material: cement / wood / dirt \_\_\_\_\_  
 Slab Thickness (ft): \_\_\_\_\_  
 Visible cracks?: yes / no \_\_\_\_\_  
 Sub-slab material: dirt / gravel \_\_\_\_\_

### PROBE INSTALLATION:

Date: 5/5/2006  
 Method: 7015 Direct Push  
 Diameter: 1.5"  
 Depth: 7.5'  
 Packing material: None

### PURGE:

Date: 5/5/2006  
 Time: 6 min 1:44 - 1:50  
 Rate: 100ml/min  
 Volume: 0.6 L

### SAMPLE COLLECTION:

Sample Time: 30 min  
 Sample Rate: 200ml/min  
 Sample Volume: 6 L  
 Sample Start Time: 1:50  
 Sample End Time: 2:20

### CONTAINER VACUUM:

Initial Canister Vacuum: -28  
 Final Canister Vacuum: -2

### CONTAINER DESCRIPTION:

Canister: 6-L Summa  
 Canister Serial Number: 2962

### ANALYTICAL METHOD:

T015 & Freons 12+22

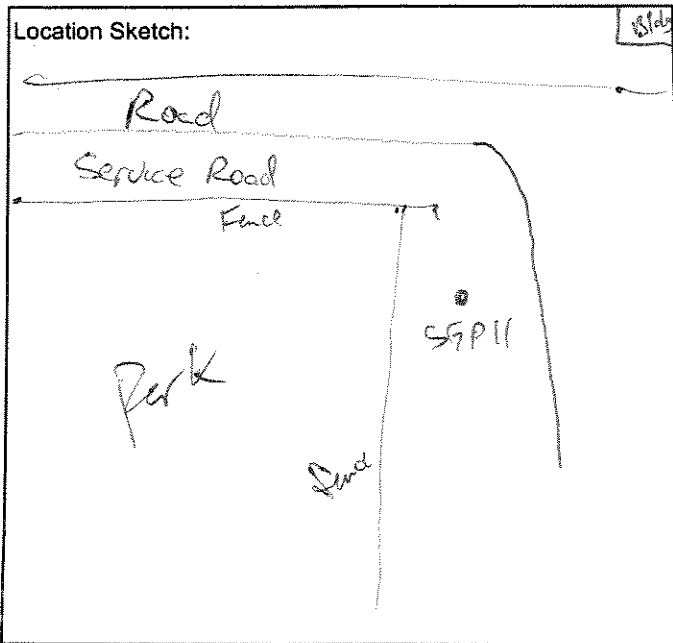

Initial He in Shroud 34%  
 Final He in Shroud  
 0.00% He in Pure Air  
 Passed He tracer gas test