



ARCADIS

# Soil Gas Sample Log

Sample ID SGP5 - (49-49.5)  
 Date 5/5/2006  
 Time 9:45am  
 Weather SUNNY, clear, 77°F  
 Atmos. Pressure 29.64

Project/No. NY001348 0806.0002  
 Sampling Personnel Mitch Waldron  
 Wind Speed: 1-3 mph  
 Precipitation?: None

### DESCRIPTION OF SAMPLE LOCATION:

Outdoor

Location Bethpage Park - Service Rd. 005  
 Est. depth to water (ft): 55'  
 Soil type: Sand & gravel  
 Odor: NO  
 Color: tan

Indoor

Location \_\_\_\_\_  
 Basement: yes / no  
 Room size ft x ft: \_\_\_\_\_  
 Floor material: cement / wood / dirt  
 Slab Thickness (ft): \_\_\_\_\_  
 Visible cracks?: yes / no  
 Sub-slab material: dirt / gravel

### PROBE INSTALLATION:

Date: 5/5/2006  
 Method: Direct Push  
 Diameter: 1 1/2"  
 Depth: 49'  
 Packing material: NDP

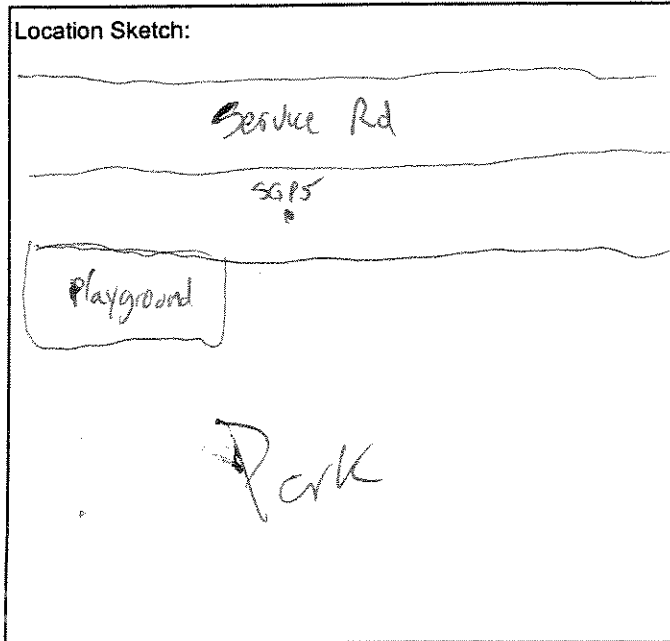

### PURGE:

Date: 5/5/2006  
 Time: 30 min 10:05 - 10:40  
 Rate: 100 mL/min  
 Volume: 3L

### SAMPLE COLLECTION:

Sample Time: 30 min  
 Sample Rate: 200 ml/min  
 Sample Volume: 6L  
 Sample Start Time: 10:47  
 Sample End Time: 11:17

### CONTAINER VACUUM:

Initial Canister Vacuum: 31 In  
 Final Canister Vacuum: 4 in

### CONTAINER DESCRIPTION:

Canister: 6-L Summa  
 Canister Serial Number: 3843

### ANALYTICAL METHOD:

TO15 & Emissions 12+22

Initial He in Shroud 45%  
 Final He in Shroud 40%  
 0.0 % He in Purge Air  
 Final Purge = 0.0%  
 Passed He tracer gas test



ARCADIS

# Soil Gas Sample Log

Sample ID SGP5 - (34-34.5)  
 Date 5/5/2006  
 Time 11:30  
 Weather Clear, Sunny, 76°F  
 Atmos. Pressure 29.63

Project/No. NY0013490806.0002  
 Sampling Personnel Mitch Wassman  
 Wind Speed: 3-6 mph  
 Precipitation?: No

### DESCRIPTION OF SAMPLE LOCATION:

Outdoor

Location Bethpage Park Service Road 00-3  
 Est. depth to water (ft): 55'  
 Soil type: sand & gravel  
 Odor: no  
 Color: Tan

Indoor

Location \_\_\_\_\_  
 Basement: yes / no \_\_\_\_\_  
 Room size ft x ft: \_\_\_\_\_  
 Floor material: cement / wood / dirt \_\_\_\_\_  
 Slab Thickness (ft): \_\_\_\_\_  
 Visible cracks?: yes / no \_\_\_\_\_  
 Sub-slab material: dirt / gravel \_\_\_\_\_

### PROBE INSTALLATION:

Date: 5/5/2006  
 Method: Direct Push  
 Diameter: 1 1/2"  
 Depth: 35'  
 Packing material: none

Location Sketch:  
see SGP5 - (49-49.3)

### PURGE:

Date: 5/5/2006  
 Time: 21 min 11:41 - 12:02  
 Rate: 100ml/min  
 Volume: 2L

### SAMPLE COLLECTION:

Sample Time: 30 min  
 Sample Rate: 200ml/min  
 Sample Volume: 6L  
 Sample Start Time: 12:02  
 Sample End Time: 12:31

### CONTAINER VACUUM:

Initial Canister Vacuum: -20" Hg  
 Final Canister Vacuum: -21" Hg

### CONTAINER DESCRIPTION:

Canister: 6-L Summa  
 Canister Serial Number: 2542

### ANALYTICAL METHOD:

TO15 & Freon's 12+22

Initial He in Shroud 34%  
 Final He in Shroud 29%  
 0.02% He in Purge Air 0.0  
 Passed Helium Tracer Gas test



ARCADIS

# Soil Gas Sample Log

Sample ID SGP5-(7-7.5)  
 Date 5/5/2006  
 Time 11:00pm  
 Weather Sunny, Clear 75°F  
 Atmos. Pressure 29.60

Project/No. NY0013480006.0002  
 Sampling Personnel Michael Vackswald  
 Wind Speed: 1-5 mph  
 Precipitation?: None

### DESCRIPTION OF SAMPLE LOCATION:

<input checked="" type="checkbox"/>	Outdoor
<input type="checkbox"/>	Indoor
Location	<u>Ballhouse Park Service Road</u>
Est. depth to water (ft):	<u>55'</u>
Soil type:	<u>Sand &amp; gravel</u>
Odor:	<u>None</u>
Color:	<u>tan</u>

<input type="checkbox"/>	Indoor
Location	
Basement:	yes / no
Room size ft x ft:	
Floor material:	cement / wood / dirt
Slab Thickness (ft):	
Visible cracks?:	yes / no
Sub-slab material:	dirt / gravel

### PROBE INSTALLATION:

Date: 5/5/2006  
 Method: Direct Push  
 Diameter: 1 1/2"  
 Depth: 7.5'  
 Packing material: None

Location Sketch:  
See SGP5-(49-49.5)

### PURGE:

Date: 5/5/2006  
 Time: 6 min 12:57-1:03  
 Rate: 100ml/min  
 Volume: 0.6L

### SAMPLE COLLECTION:

Sample Time: 30 min  
 Sample Rate: 200 ml/min  
 Sample Volume: 6L  
 Sample Start Time: 1:03  
 Sample End Time: 1:30

### CONTAINER VACUUM:

Initial Canister Vacuum: -28" Hg  
 Final Canister Vacuum: -2" Hg

### CONTAINER DESCRIPTION:

Canister: 6-L Summa  
 Canister Serial Number: 2014

### ANALYTICAL METHOD:

T015 Freons 12+22

Initial He in Shroud 35%  
 Final He in Shroud 32%  
 0.00% He in purge air  
 passed He tracer gas test



ARCADIS

# Soil Gas Sample Log

Sample ID SGP-6 (49-49.5)  
 Date 05/02/06  
 Time 10:45  
 Weather Sunny 29.87 in Hg, 69.7  
 Atmos. Pressure 29.87

Project/No. NY001348, 0806, 2  
 Sampling Personnel JHC  
MW  
 Wind Speed: 7 Mph from NE  
 Precipitation?: NO

### DESCRIPTION OF SAMPLE LOCATION:

Outdoor

Location SGP-6  
 Est. depth to water (ft): 55 ft  
 Soil type: Sec Log  
 Odor: None  
 Color: Sec Log

Indoor

Location \_\_\_\_\_  
 Basement: yes / no \_\_\_\_\_  
 Room size ft x ft: \_\_\_\_\_  
 Floor material: cement / wood / dirt \_\_\_\_\_  
 Slab Thickness (ft): \_\_\_\_\_  
 Visible cracks?: yes / no \_\_\_\_\_  
 Sub-slab material: dirt / gravel \_\_\_\_\_

### PROBE INSTALLATION:

Date: 05/02/06  
 Method: Geoprobe 1.5" with PRT adapter  
 Diameter: 1.5"  
 Depth: 49.5'  
 Packing material: \_\_\_\_\_

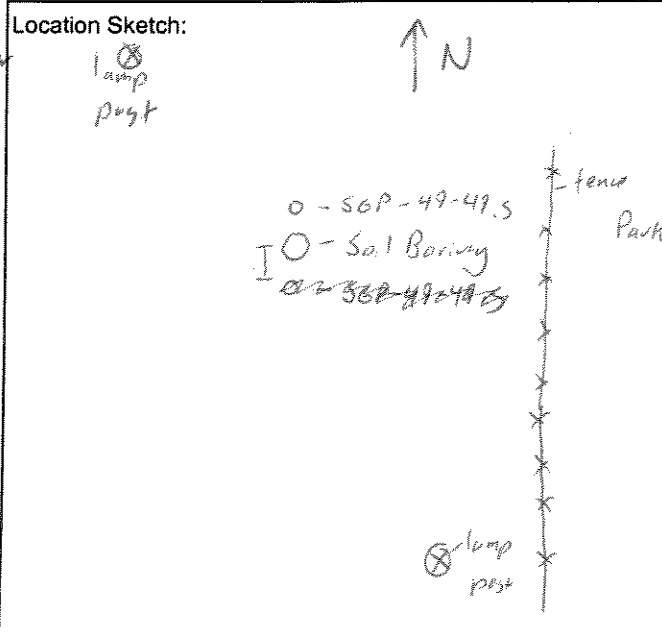

### PURGE:

Date: 05/02/06  
 Time: 10:45 - 11:15  
 Rate: 108 ml/min  
 Volume: 3000 ml

### SAMPLE COLLECTION:

Sample Time: 11:18 - 11:40  
 Sample Rate: 200 ml/min  
 Sample Volume: 6L  
 Sample Start Time: 11:18  
 Sample End Time: 11:40

### CONTAINER VACUUM:

Initial Canister Vacuum: 29 in Hg  
 Final Canister Vacuum: 4" Hg

### CONTAINER DESCRIPTION:

Canister: 6-L Summa  
 Canister Serial Number: 6321

### ANALYTICAL METHOD:

VOL - TO - 15 + Freon 12 + Freon 22

Helium - <sup>(Standard)</sup> Initial - Can - 42% Final - 37%  
 Purge - ~~0.45~~ 0.35<sup>2</sup> background  
 0.45<sup>2</sup> purge  
 10:45 - 11:15a  
 Passed Tracer Gas Test



ARCADIS

# Soil Gas Sample Log

Sample ID SGP-6(8.0-8.5)  
 Date 05/02/06  
 Time 1:30  
 Weather Mostly Cloudy  
 Atmos. Pressure 29.80

Project/No. NY001348.0806  
 Sampling Personnel JHL  
MW  
 Wind Speed: 2 MPH from NE  
 Precipitation?: NO

### DESCRIPTION OF SAMPLE LOCATION:

Outdoor

Location SGP-6  
 Est. depth to water (ft): 55 ft  
 Soil type: See Log  
 Odor: None  
 Color: None

Indoor

Location \_\_\_\_\_  
 Basement: yes / no  
 Room size ft x ft: \_\_\_\_\_  
 Floor material: cement / wood / dirt  
 Slab Thickness (ft): \_\_\_\_\_  
 Visible cracks?: yes / no  
 Sub-slab material: dirt / gravel

### PROBE INSTALLATION:

Date: 5/2/2006  
 Method: Direct Push  
 Diameter: 1.5"  
 Depth: 8' @ 8.5'  
 Packing material: None

Location Sketch:  
See SGP 6-(49-49.5)

### PURGE:

Date: 05/02/06  
 Time: 1:27-1:33  
 Rate: 115 ml/min  
 Volume: ~700 ml (600 600ml for 1.5L)

### SAMPLE COLLECTION:

Sample Time: 1:35-2:05  
 Sample Rate: 200 ml/min  
 Sample Volume: 6L  
 Sample Start Time: 1:35  
 Sample End Time: 2:05

### CONTAINER VACUUM:

Initial Canister Vacuum: 29 in Hg  
 Final Canister Vacuum: 4" Hg

Initial  
 Helium: In Can - 43%  
Purge - 0% 1:27-1:34  
Final  
In Can - 42%

### CONTAINER DESCRIPTION:

Canister: 6-L Summa  
 Canister Serial Number: 6777

### ANALYTICAL METHOD:

7015 E Prons 12622

Passed Tracer Gas test



ARCADIS

# Soil Gas Sample Log

Sample ID SGP6-(34-345)  
Date 5/2/2006

Project/No. NY001348-0806-0002

Sampling Personnel M. de la Cruz



ARCADIS

# Soil Gas Sample Log

Sample ID SGP 7 - (7-7.5)  
 Date 5/3/2006  
 Time 1:15 pm  
 Weather clear 71°F  
 Atmos. Pressure 29.66

Project/No. NY001348.0806.0002  
 Sampling Personnel Mitch Weckman  
 Wind Speed: 5 mph  
 Precipitation?: None

### DESCRIPTION OF SAMPLE LOCATION:

Outdoor

Location Bathpage Park SGP 7  
 Est. depth to water (ft): 95'  
 Soil type: sand & gravel  
 Odor: Yes  
 Color: Tan with staining

Indoor

Location \_\_\_\_\_  
 Basement: yes / no  
 Room size ft x ft: \_\_\_\_\_  
 Floor material: cement / wood / dirt  
 Slab Thickness (ft): \_\_\_\_\_  
 Visible cracks?: yes / no  
 Sub-slab material: dirt / gravel

### PROBE INSTALLATION:

Date: 5/3/2006  
 Method: Direct Push  
 Diameter: 1.5"  
 Depth: 7.5'  
 Packing material: None

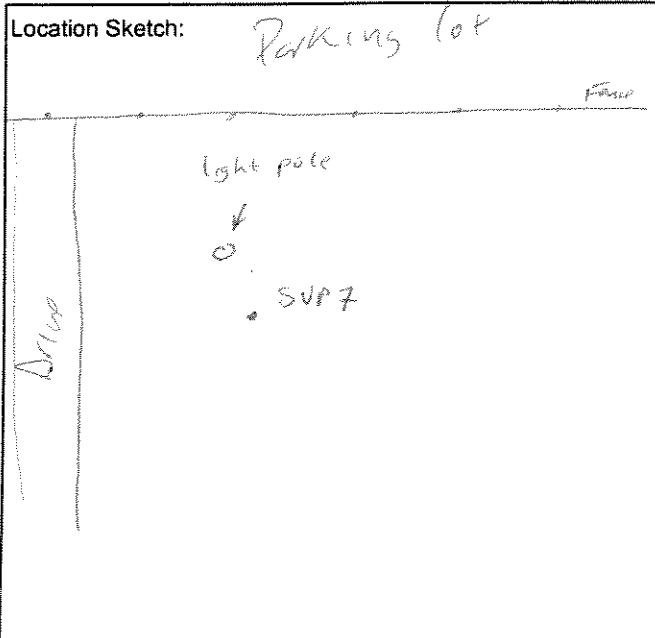

### PURGE:

Date: 5/3/2006  
 Time: 1:30 - 1:36  
 Rate: 100ml/min  
 Volume: 0.6L

### SAMPLE COLLECTION:

Sample Time: 1:40  
 Sample Rate: 200ml/min  
 Sample Volume: 6L  
 Sample Start Time: 1:40  
 Sample End Time: 2:10

### CONTAINER VACUUM:

Initial Canister Vacuum: -30  
 Final Canister Vacuum: -5

### CONTAINER DESCRIPTION:

Canister: 6-L Summa  
 Canister Serial Number: 2734

### ANALYTICAL METHOD:

TO15 & from 12 & 22

Initial He @ Top of Shroud 33%

Final He @ Top of Shroud 27%

0.0% He in Purge Air 1:30-1:36pm

Tracer Gas Passed



ARCADIS

# Soil Gas Sample Log

Sample ID SGP7-(34-34.5)  
 Date 5/3/2006  
 Time 12:00  
 Weather Overcast, 60°F  
 Atmos. Pressure 29.69

Project/No. N/0013480006.0002  
 Sampling Personnel Mitch Wackman  
 Wind Speed: 3-6 mph  
 Precipitation?: None

### DESCRIPTION OF SAMPLE LOCATION:

Outdoor

Location Bathpage Park SGP7  
 Est. depth to water (ft): 55'  
 Soil type: Sand & Gravel  
 Odor: Yes, strong  
 Color: Tan

Indoor

Location \_\_\_\_\_  
 Basement: yes / no  
 Room size ft x ft: \_\_\_\_\_  
 Floor material: cement / wood / dirt  
 Slab Thickness (ft): \_\_\_\_\_  
 Visible cracks?: yes / no  
 Sub-slab material: dirt / gravel

### PROBE INSTALLATION:

Date: 5/3/2006  
 Method: Direct Push  
 Diameter: 1.5"  
 Depth: 34-34.5'  
 Packing material: None

Location Sketch:  
See SGP7-(7-7.5)

### PURGE:

Date: 5/3/2006  
 Time: 12:19-12:40  
 Rate: 115 ml/min  
 Volume: 2L

### SAMPLE COLLECTION:

Sample Time: 12:40  
 Sample Rate: 200 ml/min  
 Sample Volume: 6L  
 Sample Start Time: 12:20 12:40  
 Sample End Time: 1:10

### CONTAINER VACUUM:

Initial Canister Vacuum: -35  
 Final Canister Vacuum: -5

### CONTAINER DESCRIPTION:

Canister: 6-L Summa  
 Canister Serial Number: 2602

### ANALYTICAL METHOD:

TO15 & Freon 12 & 22

Initial He @ top of can 40%  
 Final He @ Top of can 37%  
 0.0% He in Purge Air 12:19-12:40  
 Tracer Gas Passed





ARCADIS

# Soil Gas Sample Log

Sample ID SGP7-(49-49.5)  
 Date 5/3/2006  
 Time 10:30 am  
 Weather overcast; 59° E  
 Atmos. Pressure 29.73

Project/No. NY0013480806-0022  
 Sampling Personnel  Mitch Wacksmal   
 Wind Speed: 1-5 mph  
 Precipitation?: none

### DESCRIPTION OF SAMPLE LOCATION:

Outdoor

Location SGP7  
 Est. depth to water (ft): 55'  
 Soil type: Sand & gravel  
 Odor: Oil  
 Color: tan

Indoor

Location \_\_\_\_\_  
 Basement: yes / no  
 Room size ft x ft: \_\_\_\_\_  
 Floor material: cement / wood / dirt  
 Slab Thickness (ft): \_\_\_\_\_  
 Visible cracks?: yes / no  
 Sub-slab material: dirt / gravel

### PROBE INSTALLATION:

Date: 5/3/2006  
 Method: Direct Push  
 Diameter: 1.5"  
 Depth: 49-49.5'  
 Packing material: None

Location Sketch:  
see SGP7(7-7.5)

### PURGE:

Date: 5/3/2006  
 Time: 10:50-11:20  
 Rate: 100ml/min  
 Volume: 3L

*Extra Volume  
 purged due  
 to equipment  
 problems*

### SAMPLE COLLECTION:

Sample Time: 11:20  
 Sample Rate: 200ml/min  
 Sample Volume: 6L  
 Sample Start Time: 11:20  
 Sample End Time: 11:50

### CONTAINER VACUUM:

Initial Canister Vacuum: -32  
 Final Canister Vacuum: -5

### CONTAINER DESCRIPTION:

Canister: 6-L Summa  
 Canister Serial Number: 6773

### ANALYTICAL METHOD:

TO15 & Freons 12&22

*Initial He @ top of can 43%  
 Final He @ top of can 35%  
 -1 0.0% He in purge air 10:50-11:20  
 Tracer Gas Passed*



ARCADIS

# Soil Gas Sample Log

Sample ID SGPB - (49-49.5)  
 Date 5/4/2006  
 Time 10:15  
 Weather Sunny, clear, 70°F  
 Atmos. Pressure 29.77

Project/No. NY001348-0806 0001  
 Sampling Personnel Mitch Weckmann  
 Wind Speed: 1-5 mph  
 Precipitation?: None

### DESCRIPTION OF SAMPLE LOCATION:

Outdoor

Location Rothpage Park SGPB-013  
 Est. depth to water (ft): 55'  
 Soil type: sand & gravel  
 Odor: little  
 Color: Tan - Brown

Indoor

Location \_\_\_\_\_  
 Basement: yes / no  
 Room size ft x ft: \_\_\_\_\_  
 Floor material: cement / wood / dirt  
 Slab Thickness (ft): \_\_\_\_\_  
 Visible cracks?: yes / no  
 Sub-slab material: dirt / gravel

### PROBE INSTALLATION:

Date: 5/4/2006  
 Method: Direct Push  
 Diameter: 1 1/2"  
 Depth: 49.5'  
 Packing material: None

### PURGE:

Date: 5/4/2006  
 Time: 30 min 10:20-10:50  
 Rate: 100ml/min  
 Volume: 3L

### SAMPLE COLLECTION:

Sample Time: 10:50  
 Sample Rate: 200ml/min  
 Sample Volume: 6L  
 Sample Start Time: 10:50  
 Sample End Time: 11:27

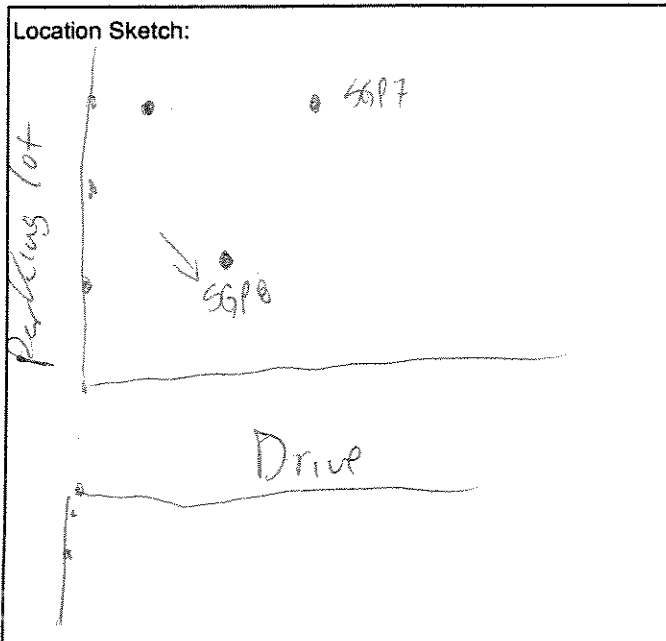

### CONTAINER VACUUM:

Initial Canister Vacuum: -28  
 Final Canister Vacuum: -5

### CONTAINER DESCRIPTION:

Canister: 6-L Summa  
 Canister Serial Number: 3093

### ANALYTICAL METHOD:

TO15 & Freons 12 + 22

Initial He in shroud 54%  
 Final He in shroud 49%  
 0.00% He in Purge Air 10:20-10:50  
 Passed Tracer-Gas Test



ARCADIS

# Soil Gas Sample Log

Sample ID SGPB-(34-34.5)  
 Date 04/5/14/2006  
 Time 12:00  
 Weather Sunny, Clear 74°F  
 Atmos. Pressure 29.69

Project/No. NX001348 0806.0002  
 Sampling Personnel Mitch Wackema  
 Wind Speed: 3-5 mph  
 Precipitation?: None

### DESCRIPTION OF SAMPLE LOCATION:

Outdoor

Location Bethpage Park SGPB-003  
 Est. depth to water (ft): 5.5'  
 Soil type: Sand & gravel  
 Odor: None  
 Color: Tan

Indoor

Location \_\_\_\_\_  
 Basement: yes / no  
 Room size ft x ft: \_\_\_\_\_  
 Floor material: cement / wood / dirt  
 Slab Thickness (ft): \_\_\_\_\_  
 Visible cracks?: yes / no  
 Sub-slab material: dirt / gravel

### PROBE INSTALLATION:

Date: 5/14/2006  
 Method: Direct Push  
 Diameter: 1.5"  
 Depth: 34.5'  
 Packing material: None

Location Sketch:  
See SGPB-(49-49.5)

### PURGE:

Date: 5/14/2006  
 Time: 12:00 to 2:00 11:54-12:17  
 Rate: 100ml/min  
 Volume: 2L

### SAMPLE COLLECTION:

Sample Time: 12:17 30min  
 Sample Rate: 200 ml/min  
 Sample Volume: 6L  
 Sample Start Time: 12:17  
 Sample End Time: 12:47

### CONTAINER VACUUM:

Initial Canister Vacuum: -30  
 Final Canister Vacuum: -5

### CONTAINER DESCRIPTION:

Canister: 6-L Summa  
 Canister Serial Number: 2792

### ANALYTICAL METHOD:

TO15 & Freon (2+2)

Initial He in Shroud 42%  
 Final He in Shroud 39%  
 0.0% He in Purge Air 11:54-12:17  
 Passed Tracer Gas



ARCADIS

# Soil Gas Sample Log

Sample ID SGPB-(7-7.5)  
 Date 5/4/2006  
 Time 1pm  
 Weather Sunny, clear, 75°F  
 Atmos. Pressure 29.63

Project/No. NY001348.0806.002  
 Sampling Personnel Mitch Jackson  
 Wind Speed: 2-4 mph  
 Precipitation?: None

### DESCRIPTION OF SAMPLE LOCATION:

<input checked="" type="checkbox"/>	Outdoor
<input type="checkbox"/>	Indoor
Location	<u>Bothways Park SGPB-023</u>
Est. depth to water (ft):	<u>55'</u>
Soil type:	<u>sand &amp; gravel</u>
Odor:	<u>None</u>
Color:	<u>Tan - Brown</u>

<input type="checkbox"/>	Indoor
Location	
Basement:	<u>yes / no</u>
Room size ft x ft:	
Floor material:	<u>cement / wood / dirt</u>
Slab Thickness (ft):	
Visible cracks?:	<u>yes / no</u>
Sub-slab material:	<u>dirt / gravel</u>

### PROBE INSTALLATION:

Date: 5/4/2006  
 Method: Direct Push  
 Diameter: 1 1/2"  
 Depth: 7.5'  
 Packing material: None

Location Sketch:  
see SGPB-(49-49.5)

### PURGE:

Date: 5/4/2006  
 Time: 6min 1:06-1:12  
 Rate: 100ml/min  
 Volume: 0.6L

### SAMPLE COLLECTION:

Sample Time: 30min  
 Sample Rate: 200ml/min  
 Sample Volume: 6L  
 Sample Start Time: 1:12  
 Sample End Time: 1:38

### CONTAINER VACUUM:

Initial Canister Vacuum: -27  
 Final Canister Vacuum: -2

### CONTAINER DESCRIPTION:

Canister: 6-L Summa  
 Canister Serial Number: 3340

### ANALYTICAL METHOD:

TO15 & Kreong 12+22

*He Initial He in Shroud 31%  
 Final He in Shroud 30%  
 0.07% He in Purge Air 1:06-1:12  
 Passed Tracer gas test*



ARCADIS

# Soil Gas Sample Log

Sample ID SGP9-(7-7.5)  
 Date 4/28/2006  
 Time 4:00pm  
 Weather Clear, Sunny 60°  
 Atmos. Pressure \_\_\_\_\_

Project/No. NY 001348.08.06.002  
 Sampling Personnel Mitch Jacksman  
John Corral  
 Wind Speed: \_\_\_\_\_  
 Precipitation?: \_\_\_\_\_

### DESCRIPTION OF SAMPLE LOCATION:

Outdoor

Location Bethpage Park, Parking Lot  
 Est. depth to water (ft): 55'  
 Soil type: sand & gravel  
 Odor: None  
 Color: white - brown

Indoor

Location \_\_\_\_\_  
 Basement: yes / no  
 Room size ft x ft: \_\_\_\_\_  
 Floor material: cement / wood / dirt  
 Slab Thickness (ft): \_\_\_\_\_  
 Visible cracks?: yes / no  
 Sub-slab material: dirt / gravel

### PROBE INSTALLATION:

Date: 4/28/2006  
 Method: Direct Push  
 Diameter: 1.5"  
 Depth: 8'  
 Packing material: \_\_\_\_\_

### PURGE:

Date: 4/28/2006  
 Time: 6 min  
 Rate: 100 mL/min  
 Volume: 600 mL

### SAMPLE COLLECTION:

Sample Time: 30 min  
 Sample Rate: 200 mL/min  
 Sample Volume: 6 L  
 Sample Start Time: 3:54  
 Sample End Time: 4:24

### CONTAINER VACUUM:

Initial Canister Vacuum: -30  
 Final Canister Vacuum: -5

### CONTAINER DESCRIPTION:

Canister: 6-L Summa  
 Canister Serial Number: 6843

### ANALYTICAL METHOD:

TO15 & Ecom 12422

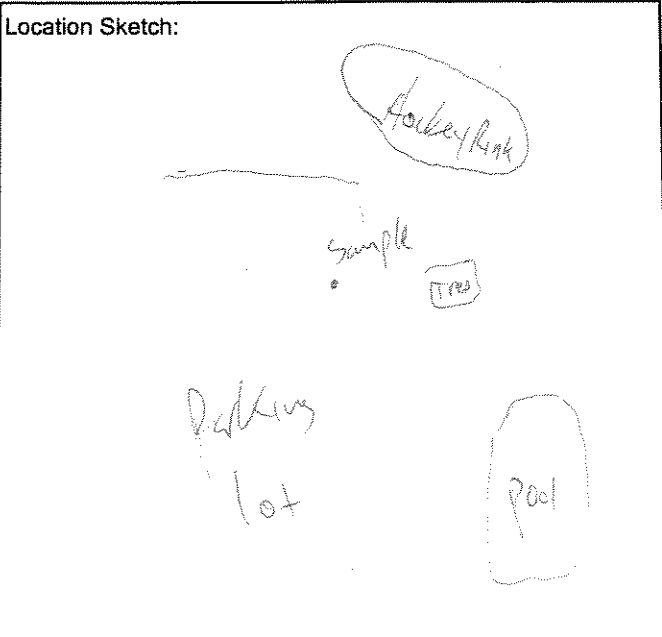

Initial He in Shroud 35%  
 Final He in Shroud 32%  
 0.05% He in purge air from 3:47-3:53  
 -Tracer Gas Passed



ARCADIS

# Soil Gas Sample Log

Sample ID: 56P9-(34-34.5)  
 Date: 5/1/2006  
 Time: 11:15  
 Weather: Sunny, windy, clear 61°F  
 Atmos. Pressure: 30.20

Project/No. NY013R-0806-0002  
 Sampling Personnel: Mitch Wickman  
 Wind Speed: 5-12 mph  
 Precipitation?: Now

### DESCRIPTION OF SAMPLE LOCATION:

Outdoor

Location: Bethpage Park  
 Est. depth to water (ft): 55'  
 Soil type: Sandy with gravel  
 Odor: \_\_\_\_\_  
 Color: tan

Indoor

Location: \_\_\_\_\_  
 Basement: yes / no  
 Room size ft x ft: \_\_\_\_\_  
 Floor material: cement / wood / dirt  
 Slab Thickness (ft): \_\_\_\_\_  
 Visible cracks?: yes / no  
 Sub-slab material: dirt / gravel

### PROBE INSTALLATION:

Date: 5/1/2006  
 Method: Direct Push  
 Diameter: 2.5" 1.5"  
 Depth: 34.5'  
 Packing material: \_\_\_\_\_

### PURGE:

Date: 5/1/2006  
 Time: 11:20  
 Rate: 100ml/min  
 Volume: 2L

### SAMPLE COLLECTION:

Sample Time: 11:43  
 Sample Rate: 200ml/min  
 Sample Volume: 6L  
 Sample Start Time: 11:43  
 Sample End Time: 12:13

### CONTAINER VACUUM:

Initial Canister Vacuum: -50"  
 Final Canister Vacuum: -5"

### CONTAINER DESCRIPTION:

Canister: 6-L Summa  
 Canister Serial Number: 6077

### ANALYTICAL METHOD:

TO15 & Freons 12&22

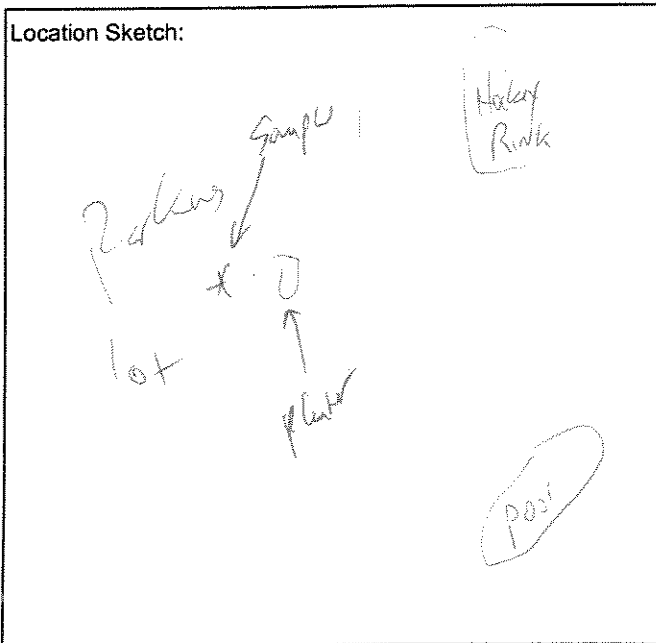

Initial He @ top of can 41%  
 Final He @ top of can 38%



ARCADIS

# Soil Gas Sample Log

Sample ID SGP9-(49-495)  
 Date 5/1/2006  
 Time 9 am  
 Weather Clear, Windy 60°F  
 Atmos. Pressure 30.22" Hg

Project/No. NY001348-0806 0002  
 Sampling Personnel Mitch Winkler  
 Wind Speed: 5-10 mph  
 Precipitation?: None

### DESCRIPTION OF SAMPLE LOCATION:

<input checked="" type="checkbox"/>	Outdoor
Location	<u>Bethpage Park</u>
Est. depth to water (ft):	<u>55'</u>
Soil type:	<u>Sand</u>
Order	<u>None</u>

<input type="checkbox"/>	Indoor
Location	
Basement:	yes / no
Room size ft x ft:	
Floor material:	cement / wood / dirt
Slab Thickness (ft):	



ARCADIS

# Soil Gas Sample Log

Sample ID SGP10-50(49-49.5)  
 Date 4/27/2006  
 Time 12:30  
 Weather Sunny, 70°F  
 Atmos. Pressure \_\_\_\_\_

Project/No. NY 001348.08062  
 Sampling Personnel Mich Wadsworth  
John Corral  
 Wind Speed: NA  
 Precipitation?: NA

### DESCRIPTION OF SAMPLE LOCATION:

Outdoor

Location Bethpage Park  
 Est. depth to water (ft): 55'  
 Soil type: sand & gravel  
 Odor: NO  
 Color: Tan

Indoor

Location \_\_\_\_\_  
 Basement: yes / no  
 Room size ft x ft: \_\_\_\_\_  
 Floor material: cement / wood / dirt  
 Slab Thickness (ft): \_\_\_\_\_  
 Visible cracks?: yes / no  
 Sub-slab material: dirt / gravel

### PROBE INSTALLATION:

Date: 04/27/06  
 Method: Geo probe  
 Diameter: \_\_\_\_\_  
 Depth: 49.5  
 Packing material: \_\_\_\_\_

### PURGE:

Date: 04/27/06  
 Time: 12:30  
 Rate: 108 ml/min  
 Volume: 2900 ml = 1.5 Volumes

### SAMPLE COLLECTION:

Sample Time: ~~1:11~~ 30min  
 Sample Rate: 200ml/min  
 Sample Volume: 6L  
 Sample Start Time: ~~1:11~~ 1:11  
 Sample End Time: 1:38

### CONTAINER VACUUM:

Initial Canister Vacuum: 31  
 Final Canister Vacuum: 5

### CONTAINER DESCRIPTION:

Canister: 6-L Summa 5262  
 Canister Serial Number: \_\_\_\_\_

### ANALYTICAL METHOD:

TO15 & Frauns 12822

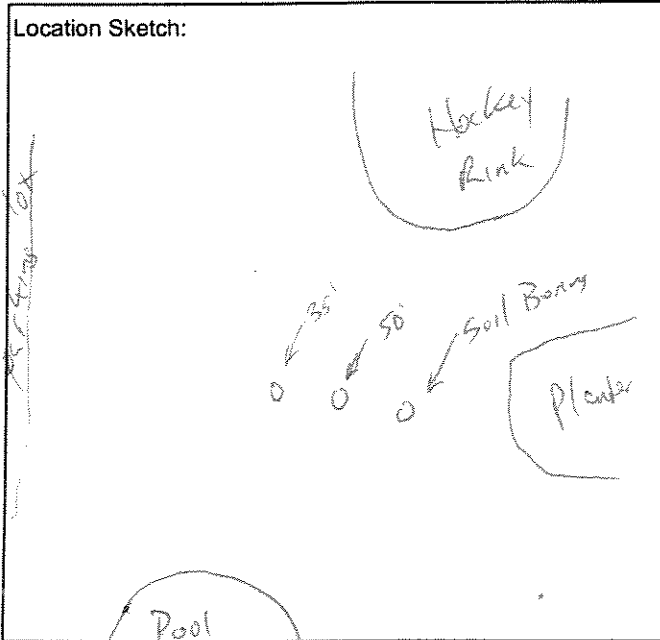

Note: 15% helium in bucket (shroud)  
 0.0% He in Purge Air 12:35-1:05  
 Tracer Gas Passed





ARCADIS

# Soil Gas Sample Log

Sample ID SGP10-8.0-7.5  
 Date 04/27/06  
 Time 3:40  
 Weather \_\_\_\_\_  
 Atmos. Pressure \_\_\_\_\_

Project/No. NY001348.0806.2  
 Sampling Personnel John Corral  
Mitch Wackman  
 Wind Speed: \_\_\_\_\_  
 Precipitation?: \_\_\_\_\_

### DESCRIPTION OF SAMPLE LOCATION:

Outdoor

Location \_\_\_\_\_

Est. depth to water (ft): 5.5 ft

Soil type: Sand

Odor: \_\_\_\_\_

Color: \_\_\_\_\_

Indoor

Location \_\_\_\_\_

Basement: yes / no

Room size ft x ft: \_\_\_\_\_

Floor material: cement / wood / dirt

Slab Thickness (ft): \_\_\_\_\_

Visible cracks?: yes / no

Sub-slab material: dirt / gravel

### PROBE INSTALLATION:

Date: 04/27/06  
 Method: Geoprobe  
 Diameter: 1.5"  
 Depth: ~~8.0~~ 7.5-8.0  
 Packing material: Grout

Location Sketch:

See sample SGP10 - (4.9-4.5)

### PURGE:

Date: 04/27/06  
 Time: 3:34-3:40  
 Rate: 100 ml/ml.3  
 Volume: 600 ml (463 = 1.5 Volumes)

### SAMPLE COLLECTION:

Sample Time: 3:40-

Sample Rate: \_\_\_\_\_

Sample Volume: 6L

Sample Start Time: 3:40

Sample End Time: \_\_\_\_\_

### CONTAINER VACUUM:

Initial Canister Vacuum: 32

Final Canister Vacuum: 5

### CONTAINER DESCRIPTION:

Canister: 6-L Summa

Canister Serial Number: 5938

### ANALYTICAL METHOD:

\_\_\_\_\_

Note = Initial Helium = >20 in Can  
 = 0.05 in purge 3:34

Final Helium = 5% in Can  
 = 0.00 in purge 3:40

Tracer Gas Passed



ARCADIS

# Soil Gas Sample Log

Sample ID SGP-10-(34-34.5)  
 Date 04/27/06  
 Time 2:15  
 Weather Sunny  
 Atmos. Pressure unk

Project/No. NY001348.0006.0007  
 Sampling Personnel John Coord  
Mitch Wheelwright  
 Wind Speed: unk  
 Precipitation?: None

### DESCRIPTION OF SAMPLE LOCATION:

<input checked="" type="checkbox"/>	Outdoor
Location	<u>Bethpage Park</u>
Est. depth to water (ft):	<u>55'</u>
Soil type:	<u>sand &amp; gravel</u>
Odor:	<u>None</u>
Color:	<u>Tan</u>

<input type="checkbox"/>	Indoor
Location	_____
Basement:	yes / no
Room size ft x ft:	_____
Floor material:	cement / wood / dirt
Slab Thickness (ft):	_____
Visible cracks?:	yes / no
Sub-slab material:	dirt / gravel

### PROBE INSTALLATION:

Date: 04/27/06  
 Method: Geoprobe  
 Diameter: 1.5  
 Depth: 34-34.5  
 Packing material: Grout the hole

Location Sketch:

See Sample SGP10-(49-49.5)

### PURGE:

Date: 04/27/06  
 Time: 2:17-2:38  
 Rate: 102 ml/min  
 Volume: 2025 ml

### SAMPLE COLLECTION:

Sample Time: 2:40-3:12  
 Sample Rate: \_\_\_\_\_  
 Sample Volume: 6L  
 Sample Start Time: 2:40  
 Sample End Time: 3:12

### CONTAINER VACUUM:

Initial Canister Vacuum: 31  
 Final Canister Vacuum: 5 (Note 2 when Valve closed)

### CONTAINER DESCRIPTION:

Canister: 6-L Summa  
 Canister Serial Number: 3400  
cont # 24153

### ANALYTICAL METHOD:

TO15 & Eron 12&17

Note: <sup>7</sup> 17% Helium in Can (shroud)  
 Note: <sup>7</sup> 0.08% from Pump Air 2:17-2:38pm  
 Tracer Gas Passed



ARCADIS

# Soil Gas Sample Log

Sample ID SGP11 (7-7.5)  
 Date 5/5/2006  
 Time 1:30pm  
 Weather Sunny clear 75°F  
 Atmos. Pressure 29.59

Project/No. NY0013480806.0002  
 Sampling Personnel Mich. Weckesman  
 Wind Speed: 1.5 mph  
 Precipitation?: None

### DESCRIPTION OF SAMPLE LOCATION:

Outdoor

Location Bethpage Park Service Rd - 015  
 Est. depth to water (ft): 53'  
 Soil type: Sand & Gravel  
 Odor: None  
 Color: tan

Indoor

Location \_\_\_\_\_  
 Basement: yes / no \_\_\_\_\_  
 Room size ft x ft: \_\_\_\_\_  
 Floor material: cement / wood / dirt \_\_\_\_\_  
 Slab Thickness (ft): \_\_\_\_\_  
 Visible cracks?: yes / no \_\_\_\_\_  
 Sub-slab material: dirt / gravel \_\_\_\_\_

### PROBE INSTALLATION:

Date: 5/5/2006  
 Method: 7015 Direct Push  
 Diameter: 1.5"  
 Depth: 7.5'  
 Packing material: None

### PURGE:

Date: 5/5/2006  
 Time: 6 min 1:44 - 1:50  
 Rate: 100ml/min  
 Volume: 0.6 L

### SAMPLE COLLECTION:

Sample Time: 30 min  
 Sample Rate: 200ml/min  
 Sample Volume: 6 L  
 Sample Start Time: 1:50  
 Sample End Time: 2:20

### CONTAINER VACUUM:

Initial Canister Vacuum: -28  
 Final Canister Vacuum: -2

### CONTAINER DESCRIPTION:

Canister: 6-L Summa  
 Canister Serial Number: 2962

### ANALYTICAL METHOD:

T015 & Freons 12+22

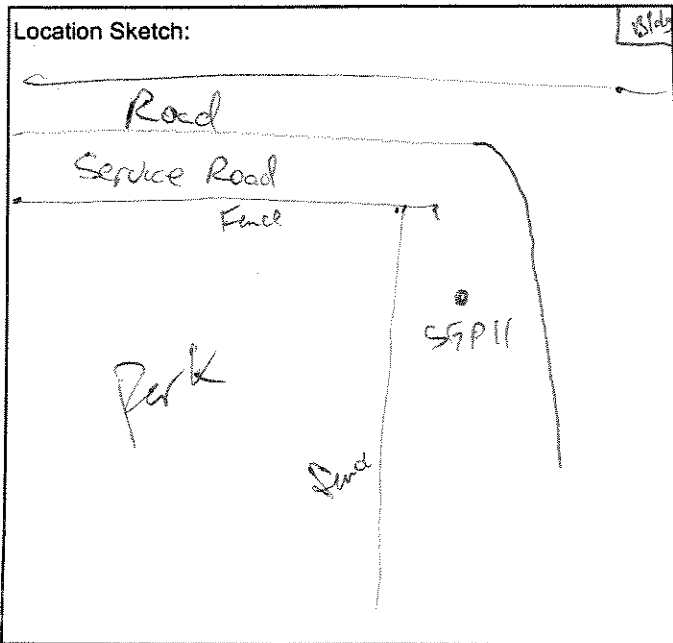

Initial He in Shroud 34%  
 Final He in Shroud  
 0.00% He in Pure Air  
 Passed He tracer gas test