



Steven M. Scharf, P.E.
Project Engineer
New York State Department of Environmental Conservation
Division of Environmental Remediation
Remedial Action, Bureau A
625 Broadway
Albany, New York 12233-7015

Subject:
April 2007 Monthly Progress Report,
Northrop Grumman Systems Corporation,
Operable Unit 3,
NYSDEC Site ID # 1-30-003A,
Bethpage, New York.

Dear Steve:

In accordance with Section III of Administrative Order on Consent (AOC) Index # W1-0018-04-01, this letter reports the activities for Operable Unit 3 (OU3) performed by Northrop Grumman Systems Corporation (Northrop Grumman) during the month of April 2007; activities planned for May 2007 are also discussed. This report represents the 13th OU3 monthly progress report since the AOC between Northrop Grumman and the New York State Department of Environmental Conservation (NYSDEC) was signed on June 24, 2005. Tables 1 and 2 provide recent validated analytical results from soil and soil gas samples, respectively, obtained on and near the Park. Figure 1 shows completed on-site sample locations.

OU3 Activities Conducted During April 2007

- Prepared and submitted the March 2007 AOC Monthly Progress Report.
- Continued coordination and planning for Phase 3 Remedial Investigation (RI), including:
 - Attended Town of Oyster Bay (Town) bi-weekly meetings for soil Interim Remedial Measure (IRM)/redevelopment project. Reviewed available Town information toward overall RI and IRM planning.

ARCADIS of New York, Inc.
Two Huntington Quadrangle
Suite 1S10
Melville
New York 11747
Tel 631.249.7600
Fax 631.249.7610
www.arcadis-us.com

ENVIRONMENT

Date:
May 11, 2007

Contact:
David Stern

Phone:
631-391-5284

Email:
dstern@arcadis-us.com

Our ref:
NY001464.0907.00003

Imagine the result

- In accordance with the approved Phase 3 RI Work Plan and as follow up to results from the Soil Gas IRM Work Plan sampling, prepared work plan for additional on-site soil gas point drilling and sampling west of the Park.
- Based on results obtained per the February Work Plan prepared in accordance with the approved Phase 3 RI Work Plan, prepared and submitted specifications for additional off-site vertical profile borings (VPBs).
- Prepared letter to NYSDEC indicating plans to bifurcate the OU3 project into two projects in effort to expedite preparation of the RI Report for the Park and nearby areas.
- Prepared for on-site soil boring program.
- Continued coordination and planning for OU3 Interim Remedial Measures (IRMs), including:
 - Continued preliminary scoping and initiated quantitative analysis in support of Groundwater IRM.
 - Assessed soil and soil gas quality obtained west of the site, per the Soil Gas IRM Work Plan, in planning for the Soil Gas IRM, and in support of development of work plan for additional soil gas sampling.
 - Initiated scope development of additional component of Soil Gas IRM to be located west of the Park.
 - Continued with development of conceptual design of the Soil Gas IRM.
 - Initiated bid process preparation for Soil Gas IRM.
- Conducted Phase 3 RI and IRM field activities, including:
 - Initiated and completed drilling of shallow and deep on-site soil borings in and near the ballfield, in accordance with the scope and specifications submitted per the approved Phase 3 RI Work Plan.
 - Continued drilling, installation, and development of off-site monitoring wells, per the Phase 3 RI Work Plan, as provided to NYSDEC in February 2007.
 - Continued monthly groundwater/perched water monitoring in on-site piezometers and selected wells.

- Initiated drilling and sampling of off-site VPBs, per the Phase 3 RI Work Plan, as provided to NYSDEC in April 2007.
- Completed on- and off-site soil gas point drilling and sampling, per the NYSDEC-approved Soil Gas IRM Work Plan.
- Continued RI and IRM data review/evaluation, including:
 - Continued review and validation of analytical results for samples collected.
 - Continued analysis and evaluation (via EVS software and other) of soil, soil gas, CPT/MIP, and groundwater data toward development of a revised conceptual site model (CSM).
 - Continued to review RI data and determine the location of data gaps.
 - Continued data analysis and reduction for Soil Gas IRM PCTs.
 - Continued to validate RI data and update draft tables and figures with latest data.

OU3 Activities Expected During May 2007

- Prepare and submit April 2007 Monthly Progress Report.
- Continue Phase 3 RI planning/coordination activities, including:
 - Continue to attend Town IRM progress meetings to work toward continuing coordination of the Northrop Grumman OU3 RI and Town IRM activities.
 - Submit work plan for additional on-site soil gas point drilling and sampling west of Park.
- Continue Phase 3 RI field activities, including:
 - Initiate on-site soil gas point drilling and sampling west of Park, per the May 2007 work plan, with NYSDEC approval.
 - Continue monthly groundwater/perched water monitoring in on-site piezometers and selected wells.
 - Continue drilling, installation, and development of off-site monitoring wells, per Phase 3 RI Work Plan.

- Continue drilling and groundwater sampling of off-site VPBs, per the April 2007 submittal per the Phase 3 RI Work Plan.
- RI data review/evaluation, as follows:
 - Continue evaluation of soil, soil gas, CPT/MIP, and groundwater data toward possible revisions to the CSM, assessment of data gaps, and support of planning for IRMs.
 - Continue to validate and tabulate analytical data received from laboratory toward preparation of RI Report.
 - Continue to prepare selected tables and figures of analytical results and interpretations toward preparation of RI Report.
- Conduct planning, implementation, and data review/evaluation for on-site IRMs:
 - Continue data analysis/reduction from Soil Gas IRM PCTs.
 - Continue development of conceptual design for Soil Gas IRM.
 - Continue bid process preparation for Soil Gas IRM.
 - Continue development of scope and quantitative analysis in support of Groundwater IRM.

Feel free to call us if you have any questions.

Sincerely,

ARCADIS of New York, Inc.



Carlo San Giovanni
Project Manager

Enclosures

Copies:

M. Wolfert, ARCADIS

D. Stern, ARCADIS

File, ARCADIS

M. Hofgren, Dvirka & Bartilucci

L. Leskovjan, Northrop Grumman

J. Cofman, Northrop Grumman

ARCADIS

Table 1. Concentrations of Volatile Organic Compounds in On-Site Soil Borings, Former Settling Ponds (OU3 - Bethpage Community Park), Bethpage, New York.

CONSTITUENT (ug/kg)	Site ID: Sample Depth (ft bls): Sample Date:	K-8SB 22-24 2/24/2007	K-8SB 24-26 2/24/2007	K-8SB 26-28 2/24/2007	K-8SB 28-30 2/24/2007	K-8SB 30-32 2/24/2007
<u>Volatile Organic Compounds</u>						
1,1,1-Trichloroethane		< 5.1	< 5.1	< 5.1	< 5.2	< 5.1
1,1,2,2-Tetrachloroethane		< 5.1	< 5.1	< 5.1	< 5.2	< 5.1
1,1,2-Trichloroethane		< 5.1	< 5.1	< 5.1	< 5.2	< 5.1
1,1-Dichloroethane		< 5.1	< 5.1	< 5.1	< 5.2	< 5.1
1,1-Dichloroethylene		< 5.1	< 5.1	< 5.1	< 5.2	< 5.1
1,2-Dichloroethane		< 5.1	< 5.1	< 5.1	< 5.2	< 5.1
1,2-Dichloropropane		< 5.1	< 5.1	< 5.1	< 5.2	< 5.1
1,3-Butadiene		--	--	--	--	--
2-Butanone		< 51	< 51	< 51	< 52	< 51
2-Hexanone		< 51	< 51	< 51	< 52	< 51
4-Methyl-2-Pentanone		< 51	< 51	< 51	< 52	< 51
Acetone		2.1 J	< 51	< 51	< 52	< 51
Benzene		< 5.1	< 5.1	< 5.1	< 5.2	< 5.1
Bromodichloromethane		< 5.1	< 5.1	< 5.1	< 5.2	< 5.1
Bromoform		< 5.1	< 5.1	< 5.1	< 5.2	< 5.1
Bromomethane		< 5.1	< 5.1	< 5.1	< 5.2	< 5.1
Carbon Disulfide		< 51	< 51	< 51	< 52	< 51
Carbon Tetrachloride		< 5.1	< 5.1	< 5.1	< 5.2	< 5.1
Chlorobenzene		< 5.1	< 5.1	< 5.1	< 5.2	< 5.1
Chlorodifluoromethane		--	--	--	--	--
Chloroethane		< 5.1	< 5.1	< 5.1	< 5.2	< 5.1
Chloroform		< 5.1	< 5.1	< 5.1	< 5.2	< 5.1
Chloromethane		< 5.1	< 5.1	< 5.1	< 5.2	< 5.1
cis-1,2-Dichloroethene		< 5.1	< 5.1	< 5.1	< 5.2	< 5.1
cis-1,3-Dichloropropene		< 5.1	< 5.1	< 5.1	< 5.2	< 5.1
Dibromochloromethane		< 5.1	< 5.1	< 5.1	< 5.2	< 5.1
Dichlorodifluoromethane		< 5.1	< 5.1	< 5.1	< 5.2	< 5.1
Ethylbenzene		< 5.1	< 5.1	< 5.1	< 5.2	< 5.1
Freon 113		< 5.1	< 5.1	< 5.1	< 5.2	< 5.1
Methylene Chloride		0.32 J	< 5.1	< 5.1	< 5.2	< 5.1
Styrene		< 5.1	< 5.1	< 5.1	< 5.2	< 5.1
Tetrachloroethene		< 5.1	< 5.1	< 5.1	< 5.2	< 5.1
Toluene		< 5.1	< 5.1	< 5.1	< 5.2	< 5.1
trans-1,2-Dichloroethene		< 5.1	< 5.1	< 5.1	< 5.2	< 5.1
trans-1,3-Dichloropropene		< 5.1	< 5.1	< 5.1	< 5.2	< 5.1
Trichloroethylene		< 5.1	< 5.1	< 5.1	< 5.2	< 5.1
Trichlorotrifluoroethene		--	--	--	--	--
Vinyl Chloride		< 5.1	< 5.1	< 5.1	< 5.2	< 5.1
m,p-Xylenes		< 5.1	< 5.1	< 5.1	< 5.2	< 5.1
o-Xylene		< 5.1	< 5.1	< 5.1	< 5.2	< 5.1
Xylene (total)		--	--	--	--	--
TVOC		2.4	0	0	0	0

Footnotes on last page.

Table 1. Concentrations of Volatile Organic Compounds in On-Site Soil Borings, Former Settling Ponds (OU3 - Bethpage Community Park), Bethpage, New York.

CONSTITUENT (ug/kg)	Site ID: Sample Depth (ft bls): Sample Date:	K-8SB 32-34 2/24/2007	K-8SB 34-36 2/24/2007	K-8SB 36-38 2/24/2007	K-8SB 38-40 2/24/2007	K-8SB 40-42 2/24/2007
<u>Volatile Organic Compounds</u>						
1,1,1-Trichloroethane		< 5.1	< 5.1	< 5.3	< 5.6	< 5.6
1,1,1,2-Tetrachloroethane		< 5.1	< 5.1	< 5.3	< 5.6	< 5.6
1,1,1,2-Trichloroethane		< 5.1	< 5.1	< 5.3	< 5.6	< 5.6
1,1-Dichloroethane		< 5.1	< 5.1	< 5.3	< 5.6	< 5.6
1,1-Dichloroethylene		< 5.1	< 5.1	< 5.3	< 5.6	< 5.6
1,2-Dichloroethane		< 5.1	< 5.1	< 5.3	< 5.6	< 5.6
1,2-Dichloropropane		< 5.1	< 5.1	< 5.3	< 5.6	< 5.6
1,3-Butadiene		--	--	--	--	--
2-Butanone		< 51	< 51	< 53	< 56	< 56
2-Hexanone		< 51	< 51	< 53	< 56	< 56
4-Methyl-2-Pentanone		< 51	< 51	< 53	< 56	< 56
Acetone		< 51	< 51	< 53	< 56	< 56
Benzene		< 5.1	< 5.1	< 5.3	< 5.6	< 5.6
Bromodichloromethane		< 5.1	< 5.1	< 5.3	< 5.6	< 5.6
Bromoform		< 5.1	< 5.1	< 5.3	< 5.6	< 5.6
Bromomethane		< 5.1	< 5.1	< 5.3	< 5.6	< 5.6
Carbon Disulfide		< 51	< 51	< 53	< 56	< 56
Carbon Tetrachloride		< 5.1	< 5.1	< 5.3	< 5.6	< 5.6
Chlorobenzene		< 5.1	< 5.1	< 5.3	< 5.6	< 5.6
Chlorodifluoromethane		--	--	--	--	--
Chloroethane		< 5.1	< 5.1	< 5.3	< 5.6	< 5.6
Chloroform		< 5.1	< 5.1	< 5.3	< 5.6	< 5.6
Chloromethane		< 5.1	< 5.1	< 5.3	< 5.6	< 5.6
cis-1,2-Dichloroethene		< 5.1	< 5.1	< 5.3	< 5.6	< 5.6
cis-1,3-Dichloropropene		< 5.1	< 5.1	< 5.3	< 5.6	< 5.6
Dibromochloromethane		< 5.1	< 5.1	< 5.3	< 5.6	< 5.6
Dichlorodifluoromethane		< 5.1	< 5.1	< 5.3	< 5.6	< 5.6
Ethylbenzene		< 5.1	< 5.1	< 5.3	< 5.6	< 5.6
Freon 113		< 5.1	< 5.1	< 5.3	< 5.6	< 5.6
Methylene Chloride		< 5.1	< 5.1	< 5.3	< 5.6	< 5.6
Styrene		< 5.1	< 5.1	< 5.3	< 5.6	< 5.6
Tetrachloroethene		< 5.1	< 5.1	< 5.3	< 5.6	< 5.6
Toluene		< 5.1	< 5.1	< 5.3	< 5.6	< 5.6
trans-1,2-Dichloroethene		< 5.1	< 5.1	< 5.3	< 5.6	< 5.6
trans-1,3-Dichloropropene		< 5.1	< 5.1	< 5.3	< 5.6	< 5.6
Trichloroethylene		< 5.1	< 5.1	< 5.3	< 5.6	< 5.6
Trichlorotrifluoroethene		--	--	--	--	--
Vinyl Chloride		< 5.1	< 5.1	< 5.3	< 5.6	< 5.6
m,p-Xylenes		< 5.1	< 5.1	< 5.3	< 5.6	< 5.6
o-Xylene		< 5.1	< 5.1	< 5.3	< 5.6	< 5.6
Xylene (total)		--	--	--	--	--
TVOC		0	0	0	0	0

Footnotes on last page.

ARCADIS

Table 1. Concentrations of Volatile Organic Compounds in On-Site Soil Borings, Former Settling Ponds (OU3 - Bethpage Community Park), Bethpage, New York.

CONSTITUENT (ug/kg)	Site ID: Sample Depth (ft bls): Sample Date:	K-8SB REP(40-42) 2/24/2007	K-8SB 42-44 2/24/2007	K-8SB 44-46 2/24/2007	K-8SB 46-48 2/24/2007	K-8SB 48-50 2/24/2007
<u>Volatile Organic Compounds</u>						
1,1,1-Trichloroethane		< 5.5	< 5.3	< 5.2	< 5.6	< 5.5
1,1,2,2-Tetrachloroethane		< 5.5	< 5.3	< 5.2	< 5.6	< 5.5
1,1,2-Trichloroethane		< 5.5	< 5.3	< 5.2	< 5.6	< 5.5
1,1-Dichloroethane		< 5.5	< 5.3	< 5.2	< 5.6	< 5.5
1,1-Dichloroethylene		< 5.5	< 5.3	< 5.2	< 5.6	< 5.5
1,2-Dichloroethane		< 5.5	< 5.3	< 5.2	< 5.6	< 5.5
1,2-Dichloropropane		< 5.5	< 5.3	< 5.2	< 5.6	< 5.5
1,3-Butadiene		--	--	--	--	--
2-Butanone		< 55	< 53	< 52	< 56	< 55
2-Hexanone		< 55	< 53	< 52	< 56	< 55
4-Methyl-2-Pentanone		< 55	< 53	< 52	< 56	< 55
Acetone		< 55	< 53	2.9 J	< 56	< 55
Benzene		< 5.5	< 5.3	< 5.2	< 5.6	< 5.5
Bromodichloromethane		< 5.5	< 5.3	< 5.2	< 5.6	< 5.5
Bromoform		< 5.5	< 5.3	< 5.2	< 5.6	< 5.5
Bromomethane		< 5.5	< 5.3	< 5.2	< 5.6	< 5.5
Carbon Disulfide		< 55	< 53	< 52	< 56	< 55
Carbon Tetrachloride		< 5.5	< 5.3	< 5.2	< 5.6	< 5.5
Chlorobenzene		< 5.5	< 5.3	< 5.2	< 5.6	< 5.5
Chlorodifluoromethane		--	--	--	--	--
Chloroethane		< 5.5	< 5.3	< 5.2	< 5.6	< 5.5
Chloroform		< 5.5	< 5.3	< 5.2	< 5.6	< 5.5
Chloromethane		< 5.5	< 5.3	< 5.2	< 5.6	< 5.5
cis-1,2-Dichloroethene		< 5.5	< 5.3	< 5.2	< 5.6	< 5.5
cis-1,3-Dichloropropene		< 5.5	< 5.3	< 5.2	< 5.6	< 5.5
Dibromochloromethane		< 5.5	< 5.3	< 5.2	< 5.6	< 5.5
Dichlorodifluoromethane		< 5.5	< 5.3	< 5.2	< 5.6	< 5.5
Ethylbenzene		< 5.5	< 5.3	< 5.2	< 5.6	< 5.5
Freon 113		< 5.5	< 5.3	< 5.2	< 5.6	< 5.5
Methylene Chloride		< 5.5	< 5.3	< 5.2	< 5.6	< 5.5
Styrene		< 5.5	< 5.3	< 5.2	< 5.6	< 5.5
Tetrachloroethene		< 5.5	< 5.3	< 5.2	< 5.6	< 5.5
Toluene		< 5.5	< 5.3	< 5.2	< 5.6	< 5.5
trans-1,2-Dichloroethene		< 5.5	< 5.3	< 5.2	< 5.6	< 5.5
trans-1,3-Dichloropropene		< 5.5	< 5.3	< 5.2	< 5.6	< 5.5
Trichloroethylene		< 5.5	< 5.3	< 5.2	< 5.6	< 5.5
Trichlorotrifluoroethene		--	--	--	--	--
Vinyl Chloride		< 5.5	< 5.3	< 5.2	< 5.6	< 5.5
m,p-Xylenes		< 5.5	< 5.3	< 5.2	< 5.6	< 5.5
o-Xylene		< 5.5	< 5.3	< 5.2	< 5.6	< 5.5
Xylene (total)		--	--	--	--	--
TVOC		0	0	2.9	0	0

Footnotes on last page.

ARCADIS

Table 1. Concentrations of Volatile Organic Compounds in On-Site Soil Borings, Former Settling Ponds (OU3 - Bethpage Community Park), Bethpage, New York.

CONSTITUENT (ug/kg)	Site ID:	K-8SB	K-8SB	K-8SB	L-7SB	L-7SB
	Sample Depth (ft bls):	50-52	52-54	54-56	20-22	22-24
	Sample Date:	2/24/2007	2/24/2007	2/24/2007	2/24/2007	2/24/2007
<u>Volatile Organic Compounds</u>						
1,1,1-Trichloroethane		< 5.6	< 6.1	< 6.3	< 5.1	< 5.1
1,1,1,2,2-Tetrachloroethane		< 5.6	< 6.1	< 6.3	< 5.1	< 5.1
1,1,1,2-Trichloroethane		< 5.6	< 6.1	< 6.3	< 5.1	< 5.1
1,1-Dichloroethane		< 5.6	< 6.1	< 6.3	< 5.1	< 5.1
1,1-Dichloroethene		< 5.6	< 6.1	< 6.3	< 5.1	< 5.1
1,2-Dichloroethane		< 5.6	< 6.1	< 6.3	< 5.1	< 5.1
1,2-Dichloropropane		< 5.6	< 6.1	< 6.3	< 5.1	< 5.1
1,3-Butadiene		--	--	--	--	--
2-Butanone		< 56	< 61	< 63	< 51	< 51
2-Hexanone		< 56	< 61	< 63	< 51	< 51
4-Methyl-2-Pentanone		< 56	< 61	< 63	< 51	< 51
Acetone		< 56	< 61	< 63	< 51	3.9 J
Benzene		< 5.6	< 6.1	< 6.3	< 5.1	< 5.1
Bromodichloromethane		< 5.6	< 6.1	< 6.3	< 5.1	< 5.1
Bromoform		< 5.6	< 6.1	< 6.3	< 5.1	< 5.1
Bromomethane		< 5.6	< 6.1	< 6.3	< 5.1	< 5.1
Carbon Disulfide		< 56	< 61	< 63	< 51	< 51
Carbon Tetrachloride		< 5.6	< 6.1	< 6.3	< 5.1	< 5.1
Chlorobenzene		< 5.6	< 6.1	< 6.3	< 5.1	< 5.1
Chlorodifluoromethane		--	--	--	--	--
Chloroethane		< 5.6	< 6.1	< 6.3	< 5.1	< 5.1
Chloroform		< 5.6	< 6.1	< 6.3	< 5.1	< 5.1
Chloromethane		< 5.6	< 6.1	< 6.3	< 5.1	< 5.1
cis-1,2-Dichloroethene		< 5.6	< 6.1	9.5	< 5.1	< 5.1
cis-1,3-Dichloropropene		< 5.6	< 6.1	< 6.3	< 5.1	< 5.1
Dibromochloromethane		< 5.6	< 6.1	< 6.3	< 5.1	< 5.1
Dichlorodifluoromethane		< 5.6	< 6.1	< 6.3	< 5.1	< 5.1
Ethylbenzene		< 5.6	< 6.1	< 6.3	< 5.1	< 5.1
Freon 113		< 5.6	< 6.1	< 6.3	< 5.1	< 5.1
Methylene Chloride		< 5.6	< 6.1	< 6.3	< 5.1	< 5.1
Styrene		< 5.6	< 6.1	< 6.3	< 5.1	< 5.1
Tetrachloroethene		< 5.6	< 6.1	< 6.3	< 5.1	< 5.1
Toluene		< 5.6	< 6.1	< 6.3	< 5.1	< 5.1
trans-1,2-Dichloroethene		< 5.6	< 6.1	< 6.3	< 5.1	< 5.1
trans-1,3-Dichloropropene		< 5.6	< 6.1	< 6.3	< 5.1	< 5.1
Trichloroethene		< 5.6	< 6.1	3.5 J	< 5.1	< 5.1
Trichlorotrifluoroethene		--	--	--	--	--
Vinyl Chloride		< 5.6	< 6.1	< 6.3	< 5.1	< 5.1
m,p-Xylenes		< 5.6	< 6.1	< 6.3	< 5.1	< 5.1
o-Xylene		< 5.6	< 6.1	< 6.3	< 5.1	< 5.1
Xylene (total)		--	--	--	--	--
TVOC		0	0	13	0	3.9

Footnotes on last page.

ARCADIS

Table 1. Concentrations of Volatile Organic Compounds in On-Site Soil Borings, Former Settling Ponds (OU3 - Bethpage Community Park), Bethpage, New York.

CONSTITUENT (ug/kg)	Site ID: Sample Depth (ft bls): Sample Date:	L-7SB 24-26 2/24/2007	L-7SB 26-28 2/24/2007	L-7SB 28-30 2/24/2007	L-7SB 30-32 2/24/2007	L-7SB 32-34 2/24/2007
<u>Volatile Organic Compounds</u>						
1,1,1-Trichloroethane		< 5.7	< 5.1	< 5.1	< 5.1	< 5.2
1,1,1,2-Tetrachloroethane		< 5.7	< 5.1	< 5.1	< 5.1	< 5.2
1,1,1,2-Trichloroethane		< 5.7	< 5.1	< 5.1	< 5.1	< 5.2
1,1-Dichloroethane		< 5.7	< 5.1	< 5.1	< 5.1	< 5.2
1,1-Dichloroethylene		< 5.7	< 5.1	< 5.1	< 5.1	< 5.2
1,2-Dichloroethane		< 5.7	< 5.1	< 5.1	< 5.1	< 5.2
1,2-Dichloropropane		< 5.7	< 5.1	< 5.1	< 5.1	< 5.2
1,3-Butadiene		--	--	--	--	--
2-Butanone		< 5.7	< 5.1	< 5.1	< 5.1	< 5.2
2-Hexanone		< 5.7	< 5.1	< 5.1	< 5.1	< 5.2
4-Methyl-2-Pentanone		< 5.7	< 5.1	< 5.1	< 5.1	< 5.2
Acetone		< 5.7	< 5.1	< 5.1	< 5.1	< 5.2
Benzene		< 5.7	< 5.1	< 5.1	< 5.1	< 5.2
Bromodichloromethane		< 5.7	< 5.1	< 5.1	< 5.1	< 5.2
Bromoform		< 5.7	< 5.1	< 5.1	< 5.1	< 5.2
Bromomethane		< 5.7	< 5.1	< 5.1	< 5.1	< 5.2
Carbon Disulfide		< 5.7	< 5.1	< 5.1	< 5.1	< 5.2
Carbon Tetrachloride		< 5.7	< 5.1	< 5.1	< 5.1	< 5.2
Chlorobenzene		< 5.7	< 5.1	< 5.1	< 5.1	< 5.2
Chlorodifluoromethane		--	--	--	--	--
Chloroethane		< 5.7	< 5.1	< 5.1	< 5.1	< 5.2
Chloroform		< 5.7	< 5.1	< 5.1	< 5.1	< 5.2
Chloromethane		< 5.7	< 5.1	< 5.1	< 5.1	< 5.2
cis-1,2-Dichloroethene		< 5.7	< 5.1	< 5.1	< 5.1	< 5.2
cis-1,3-Dichloropropene		< 5.7	< 5.1	< 5.1	< 5.1	< 5.2
Dibromochloromethane		< 5.7	< 5.1	< 5.1	< 5.1	< 5.2
Dichlorodifluoromethane		< 5.7	< 5.1	< 5.1	< 5.1	< 5.2
Ethylbenzene		< 5.7	< 5.1	< 5.1	< 5.1	< 5.2
Freon 113		< 5.7	< 5.1	< 5.1	< 5.1	< 5.2
Methylene Chloride		< 5.7	< 5.1	< 5.1	< 5.1	< 5.2
Styrene		< 5.7	< 5.1	< 5.1	< 5.1	< 5.2
Tetrachloroethene		< 5.7	< 5.1	< 5.1	< 5.1	< 5.2
Toluene		< 5.7	< 5.1	< 5.1	< 5.1	< 5.2
trans-1,2-Dichloroethene		< 5.7	< 5.1	< 5.1	< 5.1	< 5.2
trans-1,3-Dichloropropene		< 5.7	< 5.1	< 5.1	< 5.1	< 5.2
Trichloroethylene		< 5.7	< 5.1	< 5.1	< 5.1	< 5.2
Trichlorotrifluoroethene		--	--	--	--	--
Vinyl Chloride		< 5.7	< 5.1	< 5.1	< 5.1	< 5.2
m,p-Xylenes		< 5.7	< 5.1	< 5.1	< 5.1	< 5.2
o-Xylene		< 5.7	< 5.1	< 5.1	< 5.1	< 5.2
Xylene (total)		--	--	--	--	--
TVOC		0	0	0	0	0

Footnotes on last page.

Table 1. Concentrations of Volatile Organic Compounds in On-Site Soil Borings, Former Settling Ponds (OU3 - Bethpage Community Park), Bethpage, New York.

CONSTITUENT (ug/kg)	Site ID:	L-7SB	L-7SB	L-7SB	L-7SB	L-7SB
	Sample Depth (ft bls):	34-36	36-38	38-40	REP(38-40)	40-42
	Sample Date:	2/24/2007	2/24/2007	2/24/2007	2/24/2007	2/24/2007
<u>Volatile Organic Compounds</u>						
1,1,1-Trichloroethane		< 5.2	< 5.2	< 6	< 5.5	< 5.7
1,1,1,2,2-Tetrachloroethane		< 5.2	< 5.2	< 6	< 5.5	< 5.7
1,1,1,2-Trichloroethane		< 5.2	< 5.2	< 6	< 5.5	< 5.7
1,1-Dichloroethane		< 5.2	< 5.2	< 6	< 5.5	< 5.7
1,1-Dichloroethene		< 5.2	< 5.2	< 6	< 5.5	< 5.7
1,2-Dichloroethane		< 5.2	< 5.2	< 6	< 5.5	< 5.7
1,2-Dichloropropane		< 5.2	< 5.2	< 6	< 5.5	< 5.7
1,3-Butadiene		--	--	--	--	--
2-Butanone		< 5.2	< 5.2	< 60	< 55	< 57
2-Hexanone		< 5.2	< 5.2	< 60	< 55	< 57
4-Methyl-2-Pentanone		< 5.2	< 5.2	< 60	< 55	< 57
Acetone		6.3 J	< 5.2	6.8 J	6.9 J	4.8 J
Benzene		< 5.2	< 5.2	< 6	< 5.5	< 5.7
Bromodichloromethane		< 5.2	< 5.2	< 6	< 5.5	< 5.7
Bromoform		< 5.2	< 5.2	< 6	< 5.5	< 5.7
Bromomethane		< 5.2	< 5.2	< 6	< 5.5	< 5.7
Carbon Disulfide		< 5.2	< 5.2	3.4 J	3.2 J	2.2 J
Carbon Tetrachloride		< 5.2	< 5.2	< 6	< 5.5	< 5.7
Chlorobenzene		< 5.2	< 5.2	< 6	< 5.5	< 5.7
Chlorodifluoromethane		--	--	--	--	--
Chloroethane		< 5.2	< 5.2	< 6	< 5.5	< 5.7
Chloroform		< 5.2	< 5.2	< 6	< 5.5	< 5.7
Chloromethane		< 5.2	< 5.2	< 6	< 5.5	< 5.7
cis-1,2-Dichloroethene		< 5.2	< 5.2	< 6	< 5.5	< 5.7
cis-1,3-Dichloropropene		< 5.2	< 5.2	< 6	< 5.5	< 5.7
Dibromochloromethane		< 5.2	< 5.2	< 6	< 5.5	< 5.7
Dichlorodifluoromethane		< 5.2	< 5.2	< 6	< 5.5	< 5.7
Ethylbenzene		< 5.2	< 5.2	< 6	< 5.5	< 5.7
Freon 113		< 5.2	< 5.2	< 6	< 5.5	< 5.7
Methylene Chloride		< 5.2	< 5.2	< 6	< 5.5	< 5.7
Styrene		< 5.2	< 5.2	< 6	< 5.5	< 5.7
Tetrachloroethene		< 5.2	< 5.2	< 6	< 5.5	< 5.7
Toluene		< 5.2	< 5.2	< 6	< 5.5	< 5.7
trans-1,2-Dichloroethene		< 5.2	< 5.2	< 6	< 5.5	< 5.7
trans-1,3-Dichloropropene		< 5.2	< 5.2	< 6	< 5.5	< 5.7
Trichloroethene		< 5.2	< 5.2	< 6	< 5.5	< 5.7
Trichlorotrifluoroethene		--	--	--	--	--
Vinyl Chloride		< 5.2	< 5.2	< 6	< 5.5	< 5.7
m,p-Xylenes		< 5.2	< 5.2	< 6	< 5.5	< 5.7
o-Xylene		< 5.2	< 5.2	< 6	< 5.5	< 5.7
Xylene (total)		--	--	--	--	--
TVOC		6.3	0	10.2	10.1	7

Footnotes on last page.

ARCADIS

Table 1. Concentrations of Volatile Organic Compounds in On-Site Soil Borings, Former Settling Ponds (OU3 - Bethpage Community Park), Bethpage, New York.

CONSTITUENT (ug/kg)	Site ID: Sample Depth (ft bls): Sample Date:	L-7SB 42-44 2/24/2007	L-7SB 44-46 2/24/2007	L-7SB 46-48 2/24/2007	L-7SB 48-50 2/24/2007	L-7SB 50-52 2/24/2007
<u>Volatile Organic Compounds</u>						
1,1,1-Trichloroethane		< 6.2	< 6.3	< 6.3	< 5.8	< 5.9
1,1,2,2-Tetrachloroethane		< 6.2	< 6.3	< 6.3	< 5.8	< 5.9
1,1,2-Trichloroethane		< 6.2	< 6.3	< 6.3	< 5.8	< 5.9
1,1-Dichloroethane		< 6.2	2.3 J	3.6 J	< 5.8	< 5.9
1,1-Dichloroethylene		< 6.2	< 6.3	< 6.3	< 5.8	< 5.9
1,2-Dichloroethane		< 6.2	< 6.3	< 6.3	< 5.8	< 5.9
1,2-Dichloropropane		< 6.2	< 6.3	< 6.3	< 5.8	< 5.9
1,3-Butadiene		--	--	--	--	--
2-Butanone		< 6.2	< 6.3	< 6.3	< 5.8	< 5.9
2-Hexanone		< 6.2	< 6.3	< 6.3	< 5.8	< 5.9
4-Methyl-2-Pentanone		< 6.2	< 6.3	< 6.3	< 5.8	< 5.9
Acetone		7.1 J	6.6 J	6.3 J	< 5.8	< 5.9
Benzene		< 6.2	< 6.3	< 6.3	< 5.8	< 5.9
Bromodichloromethane		< 6.2	< 6.3	< 6.3	< 5.8	< 5.9
Bromoform		< 6.2	< 6.3	< 6.3	< 5.8	< 5.9
Bromomethane		< 6.2	< 6.3	< 6.3	< 5.8	< 5.9
Carbon Disulfide		< 6.2	< 6.3	< 6.3	< 5.8	1.7 J
Carbon Tetrachloride		< 6.2	< 6.3	< 6.3	< 5.8	< 5.9
Chlorobenzene		< 6.2	< 6.3	< 6.3	< 5.8	< 5.9
Chlorodifluoromethane		--	--	--	--	--
Chloroethane		< 6.2	< 6.3	< 6.3	< 5.8	< 5.9
Chloroform		< 6.2	< 6.3	< 6.3	< 5.8	< 5.9
Chloromethane		< 6.2	< 6.3	< 6.3	< 5.8	< 5.9
cis-1,2-Dichloroethene		9.8	15	39	7.5	4.8 J
cis-1,3-Dichloropropene		< 6.2	< 6.3	< 6.3	< 5.8	< 5.9
Dibromochloromethane		< 6.2	< 6.3	< 6.3	< 5.8	< 5.9
Dichlorodifluoromethane		< 6.2	< 6.3	< 6.3	< 5.8	< 5.9
Ethylbenzene		3.1 J	4.9 J	5.5 J	< 5.8	< 5.9
Freon 113		< 6.2	< 6.3	< 6.3	< 5.8	< 5.9
Methylene Chloride		< 6.2	< 6.3	< 6.3	< 5.8	< 5.9
Styrene		< 6.2	< 6.3	< 6.3	< 5.8	< 5.9
Tetrachloroethene		< 6.2	< 6.3	< 6.3	< 5.8	< 5.9
Toluene		< 6.2	< 6.3	< 6.3	< 5.8	< 5.9
trans-1,2-Dichloroethene		< 6.2	< 6.3	< 6.3	< 5.8	< 5.9
trans-1,3-Dichloropropene		< 6.2	< 6.3	< 6.3	< 5.8	< 5.9
Trichloroethylene		11	4.9 J	23	5.8	5.4 J
Trichlorotrifluoroethene		--	--	--	--	--
Vinyl Chloride		1.4 J	8.3	19	2.6 J	1.7 J
m,p-Xylenes		< 6.2	< 6.3	< 6.3	< 5.8	< 5.9
o-Xylene		< 6.2	1.8 J	2.2 J	< 5.8	< 5.9
Xylene (total)		--	--	--	--	--
TVOC		32.4	39.7	96.4	15.9	13.6

Footnotes on last page.

Table 1. Concentrations of Volatile Organic Compounds in On-Site Soil Borings, Former Settling Ponds (OU3 - Bethpage Community Park), Bethpage, New York.

CONSTITUENT (ug/kg)	Site ID: Sample Depth (ft bls): Sample Date:	L-7SB 52-54 2/24/2007	L-7SB 54-56 2/24/2007	N-3SB 20-22 2/23/2007	N-3SB 22-24 2/23/2007	N-3SB 24-26 2/23/2007
<u>Volatile Organic Compounds</u>						
1,1,1-Trichloroethane		< 6.2	< 5.8	< 5.3	< 5.3	< 5.1
1,1,1,2-Tetrachloroethane		< 6.2	< 5.8	< 5.3	< 5.3	< 5.1
1,1,1,2-Trichloroethane		< 6.2	< 5.8	< 5.3	< 5.3	< 5.1
1,1-Dichloroethane		< 6.2	< 5.8	< 5.3	< 5.3	< 5.1
1,1-Dichloroethylene		< 6.2	< 5.8	< 5.3	< 5.3	< 5.1
1,2-Dichloroethane		< 6.2	< 5.8	< 5.3	< 5.3	< 5.1
1,2-Dichloropropane		< 6.2	< 5.8	< 5.3	< 5.3	< 5.1
1,3-Butadiene		--	--	--	--	--
2-Butanone		< 62	< 58	< 53	< 53	< 51
2-Hexanone		< 62	< 58	< 53	< 53	< 51
4-Methyl-2-Pentanone		< 62	< 58	< 53	< 53	< 51
Acetone		7.8 J	7 J	7.7 J	5.3 J	4.2 J
Benzene		< 6.2	< 5.8	< 5.3	< 5.3	< 5.1
Bromodichloromethane		< 6.2	< 5.8	< 5.3	< 5.3	< 5.1
Bromoform		< 6.2	< 5.8	< 5.3	< 5.3	< 5.1
Bromomethane		< 6.2	< 5.8	< 5.3	< 5.3	< 5.1
Carbon Disulfide		< 62	2 J	< 53	< 53	< 51
Carbon Tetrachloride		< 6.2	< 5.8	< 5.3	< 5.3	< 5.1
Chlorobenzene		< 6.2	< 5.8	< 5.3	< 5.3	< 5.1
Chlorodifluoromethane		--	--	--	--	--
Chloroethane		< 6.2	< 5.8	< 5.3	< 5.3	< 5.1
Chloroform		< 6.2	< 5.8	< 5.3	< 5.3	< 5.1
Chloromethane		< 6.2	< 5.8	< 5.3	< 5.3	< 5.1
cis-1,2-Dichloroethene		4.3 J	3.5 J	< 5.3	< 5.3	< 5.1
cis-1,3-Dichloropropene		< 6.2	< 5.8	< 5.3	< 5.3	< 5.1
Dibromochloromethane		< 6.2	< 5.8	< 5.3	< 5.3	< 5.1
Dichlorodifluoromethane		< 6.2	< 5.8	< 5.3	< 5.3	< 5.1
Ethylbenzene		< 6.2	< 5.8	< 5.3	< 5.3	< 5.1
Freon 113		< 6.2	< 5.8	< 5.3	< 5.3	< 5.1
Methylene Chloride		< 6.2	< 5.8	< 5.3	< 5.3	< 5.1
Styrene		< 6.2	< 5.8	< 5.3	< 5.3	< 5.1
Tetrachloroethene		< 6.2	< 5.8	< 5.3	< 5.3	< 5.1
Toluene		< 6.2	< 5.8	5.3	3.7 J	< 5.1
trans-1,2-Dichloroethene		< 6.2	< 5.8	< 5.3	< 5.3	< 5.1
trans-1,3-Dichloropropene		< 6.2	< 5.8	< 5.3	< 5.3	< 5.1
Trichloroethylene		4.6 J	3 J	< 5.3	< 5.3	< 5.1
Trichlorotrifluoroethene		--	--	--	--	--
Vinyl Chloride		< 6.2	1.3 J	< 5.3	< 5.3	< 5.1
m,p-Xylenes		< 6.2	< 5.8	< 5.3	< 5.3	< 5.1
o-Xylene		< 6.2	< 5.8	< 5.3	< 5.3	< 5.1
Xylene (total)		--	--	--	--	--
TVOC		16.7	16.8	13	9	4.2

Footnotes on last page.

ARCADIS

Table 1. Concentrations of Volatile Organic Compounds in On-Site Soil Borings, Former Settling Ponds (OU3 - Bethpage Community Park), Bethpage, New York.

CONSTITUENT (ug/kg)	Site ID: Sample Depth (ft bls): Sample Date:	N-3SB 26-28 2/23/2007	N-3SB 28-30 2/23/2007	N-3SB 30-32 2/23/2007	N-3SB 32-34 2/23/2007	N-3SB 34-36 2/23/2007
<u>Volatile Organic Compounds</u>						
1,1,1-Trichloroethane		< 5.2	< 5.2	< 5.3	< 5.4	< 5.4
1,1,2,2-Tetrachloroethane		< 5.2	< 5.2	< 5.3	< 5.4	< 5.4
1,1,2-Trichloroethane		< 5.2	< 5.2	< 5.3	< 5.4	< 5.4
1,1-Dichloroethane		< 5.2	< 5.2	< 5.3	< 5.4	< 5.4
1,1-Dichloroethylene		< 5.2	< 5.2	< 5.3	< 5.4	< 5.4
1,2-Dichloroethane		< 5.2	< 5.2	< 5.3	< 5.4	< 5.4
1,2-Dichloropropane		< 5.2	< 5.2	< 5.3	< 5.4	< 5.4
1,3-Butadiene		--	--	--	--	--
2-Butanone		< 5.2	< 5.2	< 5.3	< 5.4	< 5.4
2-Hexanone		< 5.2	< 5.2	< 5.3	< 5.4	< 5.4
4-Methyl-2-Pentanone		< 5.2	< 5.2	< 5.3	< 5.4	< 5.4
Acetone		< 5.2	3.7 J	< 5.3	< 5.4	< 5.4
Benzene		< 5.2	< 5.2	< 5.3	< 5.4	< 5.4
Bromodichloromethane		< 5.2	< 5.2	< 5.3	< 5.4	< 5.4
Bromoform		< 5.2	< 5.2	< 5.3	< 5.4	< 5.4
Bromomethane		< 5.2	< 5.2	< 5.3	< 5.4	< 5.4
Carbon Disulfide		< 5.2	< 5.2	< 5.3	< 5.4	< 5.4
Carbon Tetrachloride		< 5.2	< 5.2	< 5.3	< 5.4	< 5.4
Chlorobenzene		< 5.2	< 5.2	< 5.3	< 5.4	< 5.4
Chlorodifluoromethane		--	--	--	--	--
Chloroethane		< 5.2	< 5.2	< 5.3	< 5.4	< 5.4
Chloroform		< 5.2	< 5.2	< 5.3	< 5.4	< 5.4
Chloromethane		< 5.2	< 5.2	< 5.3	< 5.4	< 5.4
cis-1,2-Dichloroethene		< 5.2	< 5.2	< 5.3	< 5.4	< 5.4
cis-1,3-Dichloropropene		< 5.2	< 5.2	< 5.3	< 5.4	< 5.4
Dibromochloromethane		< 5.2	< 5.2	< 5.3	< 5.4	< 5.4
Dichlorodifluoromethane		< 5.2	< 5.2	< 5.3	< 5.4	< 5.4
Ethylbenzene		< 5.2	< 5.2	< 5.3	< 5.4	< 5.4
Freon 113		< 5.2	< 5.2	< 5.3	< 5.4	< 5.4
Methylene Chloride		< 5.2	< 5.2	< 5.3	< 5.4	< 5.4
Styrene		< 5.2	< 5.2	< 5.3	< 5.4	< 5.4
Tetrachloroethene		< 5.2	< 5.2	< 5.3	< 5.4	< 5.4
Toluene		< 5.2	< 5.2	< 5.3	< 5.4	< 5.4
trans-1,2-Dichloroethene		< 5.2	< 5.2	< 5.3	< 5.4	< 5.4
trans-1,3-Dichloropropene		< 5.2	< 5.2	< 5.3	< 5.4	< 5.4
Trichloroethylene		< 5.2	< 5.2	< 5.3	< 5.4	< 5.4
Trichlorotrifluoroethene		--	--	--	--	--
Vinyl Chloride		< 5.2	< 5.2	< 5.3	< 5.4	< 5.4
m,p-Xylenes		< 5.2	< 5.2	< 5.3	< 5.4	< 5.4
o-Xylene		< 5.2	< 5.2	< 5.3	< 5.4	< 5.4
Xylene (total)		--	--	--	--	--
TVOC		0	3.7	0	0	0

Footnotes on last page.

ARCADIS

Table 1. Concentrations of Volatile Organic Compounds in On-Site Soil Borings, Former Settling Ponds (OU3 - Bethpage Community Park), Bethpage, New York.

CONSTITUENT (ug/kg)	Site ID: Sample Depth (ft bls): Sample Date:	N-3SB 36-38 2/23/2007	N-3SB 38-40 2/23/2007	N-3SB 40-42 2/23/2007	N-3SB 42-44 2/23/2007	N-3SB 44-46 2/23/2007
<u>Volatile Organic Compounds</u>						
1,1,1-Trichloroethane		< 5.4	< 5.4	< 5.2	< 5.3	< 5.4
1,1,2,2-Tetrachloroethane		< 5.4	< 5.4	< 5.2	< 5.3	< 5.4
1,1,2-Trichloroethane		< 5.4	< 5.4	< 5.2	< 5.3	< 5.4
1,1-Dichloroethane		< 5.4	< 5.4	< 5.2	< 5.3	< 5.4
1,1-Dichloroethylene		< 5.4	< 5.4	< 5.2	< 5.3	< 5.4
1,2-Dichloroethane		< 5.4	< 5.4	< 5.2	< 5.3	< 5.4
1,2-Dichloropropane		< 5.4	< 5.4	< 5.2	< 5.3	< 5.4
1,3-Butadiene		--	--	--	--	--
2-Butanone		< 5.4	< 5.4	< 5.2	< 5.3	< 5.4
2-Hexanone		< 5.4	< 5.4	< 5.2	< 5.3	< 5.4
4-Methyl-2-Pentanone		< 5.4	< 5.4	< 5.2	< 5.3	< 5.4
Acetone		< 5.4	4.2 J	< 5.2	4.5 J	< 5.4
Benzene		< 5.4	< 5.4	< 5.2	< 5.3	< 5.4
Bromodichloromethane		< 5.4	< 5.4	< 5.2	< 5.3	< 5.4
Bromoform		< 5.4	< 5.4	< 5.2	< 5.3	< 5.4
Bromomethane		< 5.4	< 5.4	< 5.2	< 5.3	< 5.4
Carbon Disulfide		< 5.4	< 5.4	< 5.2	< 5.3	< 5.4
Carbon Tetrachloride		< 5.4	< 5.4	< 5.2	< 5.3	< 5.4
Chlorobenzene		< 5.4	< 5.4	< 5.2	< 5.3	< 5.4
Chlorodifluoromethane		--	--	--	--	--
Chloroethane		< 5.4	< 5.4	< 5.2	< 5.3	< 5.4
Chloroform		< 5.4	< 5.4	< 5.2	< 5.3	< 5.4
Chloromethane		< 5.4	< 5.4	< 5.2	< 5.3	< 5.4
cis-1,2-Dichloroethene		< 5.4	< 5.4	< 5.2	< 5.3	< 5.4
cis-1,3-Dichloropropene		< 5.4	< 5.4	< 5.2	< 5.3	< 5.4
Dibromochloromethane		< 5.4	< 5.4	< 5.2	< 5.3	< 5.4
Dichlorodifluoromethane		< 5.4	< 5.4	< 5.2	< 5.3	< 5.4
Ethylbenzene		< 5.4	< 5.4	< 5.2	< 5.3	< 5.4
Freon 113		< 5.4	< 5.4	< 5.2	< 5.3	< 5.4
Methylene Chloride		< 5.4	< 5.4	< 5.2	< 5.3	< 5.4
Styrene		< 5.4	< 5.4	< 5.2	< 5.3	< 5.4
Tetrachloroethene		< 5.4	< 5.4	< 5.2	< 5.3	< 5.4
Toluene		< 5.4	< 5.4	< 5.2	< 5.3	< 5.4
trans-1,2-Dichloroethene		< 5.4	< 5.4	< 5.2	< 5.3	< 5.4
trans-1,3-Dichloropropene		< 5.4	< 5.4	< 5.2	< 5.3	< 5.4
Trichloroethylene		< 5.4	< 5.4	< 5.2	< 5.3	< 5.4
Trichlorotrifluoroethene		--	--	--	--	--
Vinyl Chloride		< 5.4	< 5.4	< 5.2	< 5.3	< 5.4
m,p-Xylenes		< 5.4	< 5.4	< 5.2	< 5.3	< 5.4
o-Xylene		< 5.4	< 5.4	< 5.2	< 5.3	< 5.4
Xylene (total)		--	--	--	--	--
TVOC		0	4.2	0	4.5	0

Footnotes on last page.

ARCADIS

Table 1. Concentrations of Volatile Organic Compounds in On-Site Soil Borings, Former Settling Ponds (OU3 - Bethpage Community Park), Bethpage, New York.

CONSTITUENT (ug/kg)	Site ID: Sample Depth (ft bls): Sample Date:	N-3SB 46-48 2/23/2007	N-3SB 48-50 2/23/2007	N-3SB 50-52 2/23/2007	N-3SB REP(50-52) 2/23/2007	N-3SB 52-54 2/23/2007
<u>Volatile Organic Compounds</u>						
1,1,1-Trichloroethane		< 5.5	< 5.6	< 5.4	< 5.5	< 6
1,1,2,2-Tetrachloroethane		< 5.5	< 5.6	< 5.4	< 5.5	< 6
1,1,2-Trichloroethane		< 5.5	< 5.6	< 5.4	< 5.5	< 6
1,1-Dichloroethane		< 5.5	< 5.6	< 5.4	< 5.5	< 6
1,1-Dichloroethylene		< 5.5	< 5.6	< 5.4	< 5.5	< 6
1,2-Dichloroethane		< 5.5	< 5.6	< 5.4	< 5.5	< 6
1,2-Dichloropropane		< 5.5	< 5.6	< 5.4	< 5.5	< 6
1,3-Butadiene		--	--	--	--	--
2-Butanone		< 55	< 56	< 54	< 55	< 60
2-Hexanone		< 55	< 56	< 54	< 55	< 60
4-Methyl-2-Pentanone		< 55	< 56	< 54	< 55	< 60
Acetone		< 55	4.8 J	< 54	< 55	< 60
Benzene		< 5.5	< 5.6	< 5.4	< 5.5	< 6
Bromodichloromethane		< 5.5	< 5.6	< 5.4	< 5.5	< 6
Bromoform		< 5.5	< 5.6	< 5.4	< 5.5	< 6
Bromomethane		< 5.5	< 5.6	< 5.4	< 5.5	< 6
Carbon Disulfide		< 55	< 56	< 54	< 55	< 60
Carbon Tetrachloride		< 5.5	< 5.6	< 5.4	< 5.5	< 6
Chlorobenzene		< 5.5	< 5.6	< 5.4	< 5.5	< 6
Chlorodifluoromethane		--	--	--	--	--
Chloroethane		< 5.5	< 5.6	< 5.4	< 5.5	< 6
Chloroform		< 5.5	< 5.6	< 5.4	< 5.5	< 6
Chloromethane		< 5.5	< 5.6	< 5.4	< 5.5	< 6
cis-1,2-Dichloroethene		< 5.5	< 5.6	< 5.4	< 5.5	< 6
cis-1,3-Dichloropropene		< 5.5	< 5.6	< 5.4	< 5.5	< 6
Dibromochloromethane		< 5.5	< 5.6	< 5.4	< 5.5	< 6
Dichlorodifluoromethane		< 5.5	< 5.6	< 5.4	< 5.5	< 6
Ethylbenzene		< 5.5	< 5.6	< 5.4	< 5.5	< 6
Freon 113		< 5.5	< 5.6	< 5.4	< 5.5	< 6
Methylene Chloride		< 5.5	< 5.6	< 5.4	< 5.5	< 6
Styrene		< 5.5	< 5.6	< 5.4	< 5.5	< 6
Tetrachloroethene		< 5.5	< 5.6	< 5.4	< 5.5	< 6
Toluene		< 5.5	< 5.6	< 5.4	< 5.5	< 6
trans-1,2-Dichloroethene		< 5.5	< 5.6	< 5.4	< 5.5	< 6
trans-1,3-Dichloropropene		< 5.5	< 5.6	< 5.4	< 5.5	< 6
Trichloroethylene		< 5.5	< 5.6	< 5.4	< 5.5	< 6
Trichlorotrifluoroethene		--	--	--	--	--
Vinyl Chloride		< 5.5	< 5.6	< 5.4	< 5.5	< 6
m,p-Xylenes		< 5.5	< 5.6	< 5.4	< 5.5	< 6
o-Xylene		< 5.5	< 5.6	< 5.4	< 5.5	< 6
Xylene (total)		--	--	--	--	--
TVOC		0	4.8	0	0	0

Footnotes on last page.

Table 1. Concentrations of Volatile Organic Compounds in On-Site Soil Borings, Former Settling Ponds (OU3 - Bethpage Community Park), Bethpage, New York.

CONSTITUENT (ug/kg)	Site ID: Sample Depth (ft bls): Sample Date:	N-3SB 54-56 2/23/2007	N-5SB 10-12 2/20/2007	N-5SB 12-14 2/20/2007	N-5SB 14-16 2/20/2007	N-5SB 16-18 2/20/2007
<u>Volatile Organic Compounds</u>						
1,1,1-Trichloroethane		< 6.2	< 5.2	< 5.1	< 5.1	< 5.1
1,1,1,2-Tetrachloroethane		< 6.2	< 5.2	< 5.1	< 5.1	< 5.1
1,1,1,2-Trichloroethane		< 6.2	< 5.2	< 5.1	< 5.1	< 5.1
1,1-Dichloroethane		< 6.2	< 5.2	< 5.1	< 5.1	< 5.1
1,1-Dichloroethylene		< 6.2	< 5.2	< 5.1	< 5.1	< 5.1
1,2-Dichloroethane		< 6.2	< 5.2	< 5.1	< 5.1	< 5.1
1,2-Dichloropropane		< 6.2	< 5.2	< 5.1	< 5.1	< 5.1
1,3-Butadiene		--	--	--	--	--
2-Butanone		< 62	< 52	< 51	< 51	< 51
2-Hexanone		< 62	< 52	< 51	< 51	< 51
4-Methyl-2-Pentanone		< 62	< 52	< 51	< 51	< 51
Acetone		< 62	< 52	< 51	< 51	< 51
Benzene		< 6.2	< 5.2	< 5.1	< 5.1	< 5.1
Bromodichloromethane		< 6.2	< 5.2	< 5.1	< 5.1	< 5.1
Bromoform		< 6.2	< 5.2	< 5.1	< 5.1	< 5.1
Bromomethane		< 6.2	< 5.2	< 5.1	< 5.1	< 5.1
Carbon Disulfide		< 62	< 52	< 51	< 51	< 51
Carbon Tetrachloride		< 6.2	< 5.2	< 5.1	< 5.1	< 5.1
Chlorobenzene		< 6.2	< 5.2	< 5.1	< 5.1	< 5.1
Chlorodifluoromethane		--	--	--	--	--
Chloroethane		< 6.2	< 5.2	< 5.1	< 5.1	< 5.1
Chloroform		< 6.2	< 5.2	< 5.1	< 5.1	< 5.1
Chloromethane		< 6.2	< 5.2	< 5.1	< 5.1	< 5.1
cis-1,2-Dichloroethene		< 6.2	< 5.2	< 5.1	< 5.1	< 5.1
cis-1,3-Dichloropropene		< 6.2	< 5.2	< 5.1	< 5.1	< 5.1
Dibromochloromethane		< 6.2	< 5.2	< 5.1	< 5.1	< 5.1
Dichlorodifluoromethane		< 6.2	< 5.2	< 5.1	< 5.1	< 5.1
Ethylbenzene		< 6.2	< 5.2	< 5.1	< 5.1	< 5.1
Freon 113		< 6.2	< 5.2	< 5.1	< 5.1	< 5.1
Methylene Chloride		< 6.2	< 5.2	< 5.1	< 5.1	< 5.1
Styrene		< 6.2	< 5.2	< 5.1	< 5.1	< 5.1
Tetrachloroethene		< 6.2	< 5.2	< 5.1	< 5.1	< 5.1
Toluene		< 6.2	< 5.2	< 5.1	< 5.1	< 5.1
trans-1,2-Dichloroethene		< 6.2	< 5.2	< 5.1	< 5.1	< 5.1
trans-1,3-Dichloropropene		< 6.2	< 5.2	< 5.1	< 5.1	< 5.1
Trichloroethylene		< 6.2	< 5.2	< 5.1	< 5.1	< 5.1
Trichlorotrifluoroethene		--	--	--	--	--
Vinyl Chloride		< 6.2	< 5.2	< 5.1	< 5.1	< 5.1
m,p-Xylenes		< 6.2	< 5.2	< 5.1	< 5.1	< 5.1
o-Xylene		< 6.2	< 5.2	< 5.1	< 5.1	< 5.1
Xylene (total)		--	--	--	--	--
TVOC		0	0	0	0	0

Footnotes on last page.

ARCADIS

Table 1. Concentrations of Volatile Organic Compounds in On-Site Soil Borings, Former Settling Ponds (OU3 - Bethpage Community Park), Bethpage, New York.

CONSTITUENT (ug/kg)	Site ID:	N-5SB	N-5SB	N-5SB	N-5SB	N-5SB
	Sample Depth (ft bls):	18-20	20-22	22-24	24-26	26-28
	Sample Date:	2/20/2007	2/20/2007	2/20/2007	2/20/2007	2/20/2007
<u>Volatile Organic Compounds</u>						
1,1,1-Trichloroethane		< 5.1	< 5.1	< 5.1	< 5.2	< 5.1
1,1,1,2,2-Tetrachloroethane		< 5.1	< 5.1	< 5.1	< 5.2	< 5.1
1,1,2-Trichloroethane		< 5.1	< 5.1	< 5.1	< 5.2	< 5.1
1,1-Dichloroethane		< 5.1	< 5.1	< 5.1	< 5.2	< 5.1
1,1-Dichloroethylene		< 5.1	< 5.1	< 5.1	< 5.2	< 5.1
1,2-Dichloroethane		< 5.1	< 5.1	< 5.1	< 5.2	< 5.1
1,2-Dichloropropane		< 5.1	< 5.1	< 5.1	< 5.2	< 5.1
1,3-Butadiene		--	--	--	--	--
2-Butanone		< 5.1	< 5.1	< 5.1	< 5.2	< 5.1
2-Hexanone		< 5.1	< 5.1	< 5.1	< 5.2	< 5.1
4-Methyl-2-Pentanone		< 5.1	< 5.1	< 5.1	< 5.2	< 5.1
Acetone		< 5.1	< 5.1	< 5.1	< 5.2	< 5.1
Benzene		< 5.1	< 5.1	< 5.1	< 5.2	< 5.1
Bromodichloromethane		< 5.1	< 5.1	< 5.1	< 5.2	< 5.1
Bromoform		< 5.1	< 5.1	< 5.1	< 5.2	< 5.1
Bromomethane		< 5.1	< 5.1	< 5.1	< 5.2	< 5.1
Carbon Disulfide		< 5.1	< 5.1	< 5.1	< 5.2	< 5.1
Carbon Tetrachloride		< 5.1	< 5.1	< 5.1	< 5.2	< 5.1
Chlorobenzene		< 5.1	< 5.1	< 5.1	< 5.2	< 5.1
Chlorodifluoromethane		--	--	--	--	--
Chloroethane		< 5.1	< 5.1	< 5.1	< 5.2	< 5.1
Chloroform		< 5.1	< 5.1	< 5.1	< 5.2	< 5.1
Chloromethane		< 5.1	< 5.1	< 5.1	< 5.2	< 5.1
cis-1,2-Dichloroethene		< 5.1	< 5.1	< 5.1	< 5.2	< 5.1
cis-1,3-Dichloropropene		< 5.1	< 5.1	< 5.1	< 5.2	< 5.1
Dibromochloromethane		< 5.1	< 5.1	< 5.1	< 5.2	< 5.1
Dichlorodifluoromethane		< 5.1	< 5.1	< 5.1	< 5.2	< 5.1
Ethylbenzene		< 5.1	< 5.1	< 5.1	< 5.2	< 5.1
Freon 113		< 5.1	< 5.1	< 5.1	< 5.2	< 5.1
Methylene Chloride		< 5.1	< 5.1	< 5.1	< 5.2	< 5.1
Styrene		< 5.1	< 5.1	< 5.1	< 5.2	< 5.1
Tetrachloroethene		< 5.1	< 5.1	< 5.1	< 5.2	< 5.1
Toluene		< 5.1	< 5.1	< 5.1	0.88 J	< 5.1
trans-1,2-Dichloroethene		< 5.1	< 5.1	< 5.1	< 5.2	< 5.1
trans-1,3-Dichloropropene		< 5.1	< 5.1	< 5.1	< 5.2	< 5.1
Trichloroethylene		< 5.1	< 5.1	< 5.1	2.9 J	< 5.1
Trichlorotrifluoroethene		--	--	--	--	--
Vinyl Chloride		< 5.1	< 5.1	< 5.1	< 5.2	< 5.1
m,p-Xylenes		< 5.1	< 5.1	< 5.1	< 5.2	< 5.1
o-Xylene		< 5.1	< 5.1	< 5.1	< 5.2	< 5.1
Xylene (total)		--	--	--	--	--
TVOC		0	0	0	3.78	0

Footnotes on last page.

Table 1. Concentrations of Volatile Organic Compounds in On-Site Soil Borings, Former Settling Ponds (OU3 - Bethpage Community Park), Bethpage, New York.

CONSTITUENT (ug/kg)	Site ID: Sample Depth (ft bls): Sample Date:	N-5SB 28-30 2/20/2007	N-5SB 30-32 2/20/2007	N-5SB REP(30-32) 2/22/2007	N-5SB 32-34 2/20/2007	N-5SB 34-36 2/20/2007
<u>Volatile Organic Compounds</u>						
1,1,1-Trichloroethane		< 5.2	< 5.2	< 5.2	< 5.3	< 5.3
1,1,1,2-Tetrachloroethane		< 5.2	< 5.2	< 5.2	< 5.3	< 5.3
1,1,2-Trichloroethane		< 5.2	< 5.2	< 5.2	< 5.3	< 5.3
1,1-Dichloroethane		< 5.2	< 5.2	< 5.2	< 5.3	< 5.3
1,1-Dichloroethylene		< 5.2	< 5.2	< 5.2	< 5.3	< 5.3
1,2-Dichloroethane		< 5.2	< 5.2	< 5.2	< 5.3	< 5.3
1,2-Dichloropropane		< 5.2	< 5.2	< 5.2	< 5.3	< 5.3
1,3-Butadiene		--	--	--	--	--
2-Butanone		< 5.2	< 5.2	< 5.2	< 5.3	< 5.3
2-Hexanone		< 5.2	< 5.2	< 5.2	< 5.3	< 5.3
4-Methyl-2-Pentanone		< 5.2	< 5.2	< 5.2	< 5.3	< 5.3
Acetone		< 5.2	< 5.2	< 5.2	< 5.3	4.9 J
Benzene		< 5.2	< 5.2	< 5.2	< 5.3	< 5.3
Bromodichloromethane		< 5.2	< 5.2	< 5.2	< 5.3	< 5.3
Bromoform		< 5.2	< 5.2	< 5.2	< 5.3	< 5.3
Bromomethane		< 5.2	< 5.2	< 5.2	< 5.3	< 5.3
Carbon Disulfide		< 5.2	< 5.2	< 5.2	< 5.3	< 5.3
Carbon Tetrachloride		< 5.2	< 5.2	< 5.2	< 5.3	< 5.3
Chlorobenzene		< 5.2	< 5.2	< 5.2	< 5.3	< 5.3
Chlorodifluoromethane		--	--	--	--	--
Chloroethane		< 5.2	< 5.2	< 5.2	< 5.3	< 5.3
Chloroform		< 5.2	< 5.2	< 5.2	< 5.3	< 5.3
Chloromethane		< 5.2	< 5.2	< 5.2	< 5.3	< 5.3
cis-1,2-Dichloroethene		< 5.2	< 5.2	< 5.2	< 5.3	< 5.3
cis-1,3-Dichloropropene		< 5.2	< 5.2	< 5.2	< 5.3	< 5.3
Dibromochloromethane		< 5.2	< 5.2	< 5.2	< 5.3	< 5.3
Dichlorodifluoromethane		< 5.2	< 5.2	< 5.2	< 5.3	< 5.3
Ethylbenzene		< 5.2	< 5.2	< 5.2	< 5.3	< 5.3
Freon 113		< 5.2	< 5.2	< 5.2	< 5.3	< 5.3
Methylene Chloride		< 5.2	< 5.2	< 5.2	< 5.3	< 5.3
Styrene		< 5.2	< 5.2	< 5.2	< 5.3	< 5.3
Tetrachloroethene		< 5.2	< 5.2	< 5.2	< 5.3	< 5.3
Toluene		< 5.2	< 5.2	< 5.2	< 5.3	< 5.3
trans-1,2-Dichloroethene		< 5.2	< 5.2	< 5.2	< 5.3	< 5.3
trans-1,3-Dichloropropene		< 5.2	< 5.2	< 5.2	< 5.3	< 5.3
Trichloroethylene		< 5.2	< 5.2	< 5.2	< 5.3	< 5.3
Trichlorotrifluoroethene		--	--	--	--	--
Vinyl Chloride		< 5.2	< 5.2	< 5.2	< 5.3	< 5.3
m,p-Xylenes		< 5.2	< 5.2	< 5.2	< 5.3	< 5.3
o-Xylene		< 5.2	< 5.2	< 5.2	< 5.3	< 5.3
Xylene (total)		--	--	--	--	--
TVOC		0	0	0	0	4.9

Footnotes on last page.

ARCADIS

Table 1. Concentrations of Volatile Organic Compounds in On-Site Soil Borings, Former Settling Ponds (OU3 - Bethpage Community Park), Bethpage, New York.

CONSTITUENT (ug/kg)	Site ID: Sample Depth (ft bls): Sample Date:	N-5SB 36-38 2/22/2007	N-5SB 38-40 2/22/2007	N-5SB 40-42 2/22/2007	N-5SB 42-44 2/22/2007	N-5SB 44-46 2/22/2007
<u>Volatile Organic Compounds</u>						
1,1,1-Trichloroethane		< 5.7	< 6	50	2.9 J	< 6.3
1,1,1,2-Tetrachloroethane		< 5.7	< 6	< 32	< 6.4 J	< 6.3
1,1,2-Trichloroethane		< 5.7	< 6	< 32	< 6.4	< 6.3
1,1-Dichloroethane		< 5.7	< 6	110	27	< 6.3
1,1-Dichloroethylene		< 5.7	< 6	8.5 J	< 6.4	< 6.3
1,2-Dichloroethane		< 5.7	< 6	17 J	2.3 J	< 6.3
1,2-Dichloropropane		< 5.7	< 6	< 32	< 6.4	< 6.3
1,3-Butadiene		--	--	--	--	--
2-Butanone		< 57	< 60	< 320	< 64	< 63
2-Hexanone		< 57	< 60	< 320	< 64 J	< 63
4-Methyl-2-Pentanone		< 57	< 60	320	76 J	< 63
Acetone		4.9 J	9.4 J	37 J	32 J	7.5 J
Benzene		< 5.7	< 6	< 32	< 6.4	< 6.3
Bromodichloromethane		< 5.7	< 6	< 32	< 6.4	< 6.3
Bromoform		< 5.7	< 6	< 32	< 6.4	< 6.3
Bromomethane		< 5.7	< 6	< 32	< 6.4	< 6.3
Carbon Disulfide		< 57	< 60	< 320	< 64	< 63
Carbon Tetrachloride		< 5.7	< 6	< 32	< 6.4	< 6.3
Chlorobenzene		< 5.7	< 6	< 32	< 6.4 J	< 6.3
Chlorodifluoromethane		--	--	--	--	--
Chloroethane		< 5.7	< 6	< 32	< 6.4	< 6.3
Chloroform		< 5.7	< 6	11 J	< 6.4	< 6.3
Chloromethane		< 5.7	< 6	< 32	< 6.4	< 6.3
cis-1,2-Dichloroethene		2.4 J	5.7 J	2100 D	85	< 6.3
cis-1,3-Dichloropropene		< 5.7	< 6	< 32	< 6.4	< 6.3
Dibromochloromethane		< 5.7	< 6	< 32	< 6.4	< 6.3
Dichlorodifluoromethane		< 5.7	< 6	< 32	< 6.4	< 6.3
Ethylbenzene		< 5.7	< 6	< 32	< 6.4 J	< 6.3
Freon 113		< 5.7	< 6	< 32	< 6.4	< 6.3
Methylene Chloride		< 5.7	< 6	49	25	< 6.3
Styrene		< 5.7	< 6	< 32	< 6.4	< 6.3
Tetrachloroethene		< 5.7	< 6	16 J	< 6.4 J	< 6.3
Toluene		< 5.7	< 6	11 J	3.4 J	< 6.3
trans-1,2-Dichloroethene		< 5.7	< 6	19 J	< 6.4	< 6.3
trans-1,3-Dichloropropene		< 5.7	< 6	< 32	< 6.4	< 6.3
Trichloroethylene		18	18	2500 D	13	< 6.3
Trichlorotrifluoroethene		--	--	--	--	--
Vinyl Chloride		< 5.7	< 6	< 32	1.9 J	< 6.3
m,p-Xylenes		< 5.7	< 6	< 32	< 6.4 J	< 6.3
o-Xylene		< 5.7	< 6	< 32	< 6.4 J	< 6.3
Xylene (total)		--	--	--	--	--
TVOC		25.3	33.1	5,248.5	268.5	7.5

Footnotes on last page.

Table 1. Concentrations of Volatile Organic Compounds in On-Site Soil Borings, Former Settling Ponds (OU3 - Bethpage Community Park), Bethpage, New York.

CONSTITUENT (ug/kg)	Site ID: Sample Depth (ft bls): Sample Date:	N-5SB 46-48 2/22/2007	N-5SB 48-50 2/22/2007	N-5SB 50-52 2/22/2007	N-5SB 52-54 2/22/2007	N-5SB 54-56 2/22/2007
Volatile Organic Compounds						
1,1,1-Trichloroethane		< 5.5	< 5.8	< 5.3	< 5.8	< 6.1
1,1,1,2-Tetrachloroethane		< 5.5	< 5.8	< 5.3	< 5.8	< 6.1
1,1,2-Trichloroethane		< 5.5	< 5.8	< 5.3	< 5.8	< 6.1
1,1-Dichloroethane		3.6 J	< 5.8	< 5.3	< 5.8	< 6.1
1,1-Dichloroethylene		< 5.5	< 5.8	< 5.3	< 5.8	< 6.1
1,2-Dichloroethane		< 5.5	< 5.8	< 5.3	< 5.8	< 6.1
1,2-Dichloropropane		< 5.5	< 5.8	< 5.3	< 5.8	< 6.1
1,3-Butadiene		--	--	--	--	--
2-Butanone		< 55	< 58	< 53	< 58	< 61
2-Hexanone		< 55	< 58	< 53	< 58	< 61
4-Methyl-2-Pentanone		11 J	< 58	< 53	< 58	< 61
Acetone		24 J	9.1 J	9.5 J	< 58	4.3 J
Benzene		< 5.5	< 5.8	< 5.3	< 5.8	< 6.1
Bromodichloromethane		< 5.5	< 5.8	< 5.3	< 5.8	< 6.1
Bromoform		< 5.5	< 5.8	< 5.3	< 5.8	< 6.1
Bromomethane		< 5.5	< 5.8	< 5.3	< 5.8	< 6.1
Carbon Disulfide		1.4 J	< 58	< 53	< 58	< 61
Carbon Tetrachloride		< 5.5	< 5.8	< 5.3	< 5.8	< 6.1
Chlorobenzene		< 5.5	< 5.8	< 5.3	< 5.8	< 6.1
Chlorodifluoromethane		--	--	--	--	--
Chloroethane		< 5.5	< 5.8	< 5.3	< 5.8	< 6.1
Chloroform		< 5.5	< 5.8	< 5.3	< 5.8	< 6.1
Chloromethane		< 5.5	< 5.8	< 5.3	< 5.8	< 6.1
cis-1,2-Dichloroethene		38	< 5.8	< 5.3	3.3 J	4.3 J
cis-1,3-Dichloropropene		< 5.5	< 5.8	< 5.3	< 5.8	< 6.1
Dibromochloromethane		< 5.5	< 5.8	< 5.3	< 5.8	< 6.1
Dichlorodifluoromethane		< 5.5	< 5.8	< 5.3	< 5.8	< 6.1
Ethylbenzene		< 5.5	< 5.8	< 5.3	< 5.8	< 6.1
Freon 113		< 5.5	< 5.8	< 5.3	< 5.8	< 6.1
Methylene Chloride		3.3 J	< 5.8	< 5.3	< 5.8	< 6.1
Styrene		< 5.5	< 5.8	< 5.3	< 5.8	< 6.1
Tetrachloroethene		< 5.5	< 5.8	< 5.3	< 5.8	< 6.1
Toluene		2 J	< 5.8	< 5.3	< 5.8	< 6.1
trans-1,2-Dichloroethene		< 5.5	< 5.8	< 5.3	< 5.8	< 6.1
trans-1,3-Dichloropropene		< 5.5	< 5.8	< 5.3	< 5.8	< 6.1
Trichloroethylene		32	< 5.8	< 5.3	< 5.8	2 J
Trichlorotrifluoroethene		--	--	--	--	--
Vinyl Chloride		< 5.5	< 5.8	< 5.3	< 5.8	< 6.1
m,p-Xylenes		< 5.5	< 5.8	< 5.3	< 5.8	< 6.1
o-Xylene		< 5.5	< 5.8	< 5.3	< 5.8	< 6.1
Xylene (total)		--	--	--	--	--
TVOC		115.3	9.1	9.5	3.3	10.6

Footnotes on last page.

Table 1. Concentrations of Volatile Organic Compounds in On-Site Soil Borings, Former Settling Ponds (OU3 - Bethpage Community Park), Bethpage, New York.

CONSTITUENT (ug/kg)	Site ID: Sample Depth (ft bls): Sample Date:	N-6SB 10-12 2/22/2007	N-6SB 12-14 2/22/2007	N-6SB 14-16 2/22/2007	N-6SB 16-18 2/22/2007	N-6SB 18-20 2/22/2007
<u>Volatile Organic Compounds</u>						
1,1,1-Trichloroethane		< 5.2	< 5.3	< 5.4	< 5.4	< 5.1
1,1,2,2-Tetrachloroethane		< 5.2	< 5.3	< 5.4	< 5.4	< 5.1
1,1,2-Trichloroethane		< 5.2	< 5.3	< 5.4	< 5.4	< 5.1
1,1-Dichloroethane		< 5.2	< 5.3	< 5.4	< 5.4	< 5.1
1,1-Dichloroethylene		< 5.2	< 5.3	< 5.4	< 5.4	< 5.1
1,2-Dichloroethane		< 5.2	< 5.3	< 5.4	< 5.4	< 5.1
1,2-Dichloropropane		< 5.2	< 5.3	< 5.4	< 5.4	< 5.1
1,3-Butadiene		--	--	--	--	--
2-Butanone		< 5.2	< 5.3	< 5.4	< 5.4	< 5.1
2-Hexanone		< 5.2	< 5.3	< 5.4	< 5.4	< 5.1
4-Methyl-2-Pentanone		< 5.2	< 5.3	< 5.4	< 5.4	< 5.1
Acetone		< 5.2	< 5.3	< 5.4	5.9 J	< 5.1
Benzene		< 5.2	< 5.3	< 5.4	< 5.4	< 5.1
Bromodichloromethane		< 5.2	< 5.3	< 5.4	< 5.4	< 5.1
Bromoform		< 5.2	< 5.3	< 5.4	< 5.4	< 5.1
Bromomethane		< 5.2	< 5.3	< 5.4	< 5.4	< 5.1
Carbon Disulfide		< 5.2	< 5.3	< 5.4	< 5.4	< 5.1
Carbon Tetrachloride		< 5.2	< 5.3	< 5.4	< 5.4	< 5.1
Chlorobenzene		< 5.2	< 5.3	< 5.4	< 5.4	< 5.1
Chlorodifluoromethane		--	--	--	--	--
Chloroethane		< 5.2	< 5.3	< 5.4	< 5.4	< 5.1
Chloroform		< 5.2	< 5.3	< 5.4	< 5.4	< 5.1
Chloromethane		< 5.2	< 5.3	< 5.4	< 5.4	< 5.1
cis-1,2-Dichloroethene		< 5.2	< 5.3	< 5.4	< 5.4	< 5.1
cis-1,3-Dichloropropene		< 5.2	< 5.3	< 5.4	< 5.4	< 5.1
Dibromochloromethane		< 5.2	< 5.3	< 5.4	< 5.4	< 5.1
Dichlorodifluoromethane		< 5.2	< 5.3	< 5.4	< 5.4	< 5.1
Ethylbenzene		< 5.2	< 5.3	< 5.4	< 5.4	< 5.1
Freon 113		< 5.2	< 5.3	< 5.4	< 5.4	< 5.1
Methylene Chloride		< 5.2	< 5.3	< 5.4	< 5.4	< 5.1
Styrene		< 5.2	< 5.3	< 5.4	< 5.4	< 5.1
Tetrachloroethene		< 5.2	< 5.3	< 5.4	< 5.4	< 5.1
Toluene		< 5.2	< 5.3	< 5.4	< 5.4	< 5.1
trans-1,2-Dichloroethene		< 5.2	< 5.3	< 5.4	< 5.4	< 5.1
trans-1,3-Dichloropropene		< 5.2	< 5.3	< 5.4	< 5.4	< 5.1
Trichloroethylene		< 5.2	1.4 J	1.2 J	2.3 J	< 5.1
Trichlorotrifluoroethene		--	--	--	--	--
Vinyl Chloride		< 5.2	< 5.3	< 5.4	< 5.4	< 5.1
m,p-Xylenes		< 5.2	< 5.3	< 5.4	< 5.4	< 5.1
o-Xylene		< 5.2	< 5.3	< 5.4	< 5.4	< 5.1
Xylene (total)		--	--	--	--	--
TVOC		0	1.4	1.2	8.2	0

Footnotes on last page.

ARCADIS

Table 1. Concentrations of Volatile Organic Compounds in On-Site Soil Borings, Former Settling Ponds (OU3 - Bethpage Community Park), Bethpage, New York.

CONSTITUENT (ug/kg)	Site ID: Sample Depth (ft bls): Sample Date:	N-6SB 20-22 2/22/2007	N-6SB 22-24 2/22/2007	N-6SB 24-26 2/22/2007	N-6SB 26-28 2/22/2007	N-6SB 28-30 2/22/2007
<u>Volatile Organic Compounds</u>						
1,1,1-Trichloroethane		< 5.1	< 5.2	< 5.2	< 5.2	< 5.3
1,1,1,2-Tetrachloroethane		< 5.1	< 5.2	< 5.2	< 5.2	< 5.3
1,1,2-Trichloroethane		< 5.1	< 5.2	< 5.2	< 5.2	< 5.3
1,1-Dichloroethane		< 5.1	< 5.2	< 5.2	< 5.2	< 5.3
1,1-Dichloroethylene		< 5.1	< 5.2	< 5.2	< 5.2	< 5.3
1,2-Dichloroethane		< 5.1	< 5.2	< 5.2	< 5.2	< 5.3
1,2-Dichloropropane		< 5.1	< 5.2	< 5.2	< 5.2	< 5.3
1,3-Butadiene		--	--	--	--	--
2-Butanone		< 5.1	< 5.2	< 5.2	< 5.2	< 5.3
2-Hexanone		< 5.1	< 5.2	< 5.2	< 5.2	< 5.3
4-Methyl-2-Pentanone		< 5.1	< 5.2	< 5.2	< 5.2	< 5.3
Acetone		< 5.1	< 5.2	< 5.2	4.4 J	7.7 J
Benzene		< 5.1	< 5.2	< 5.2	< 5.2	< 5.3
Bromodichloromethane		< 5.1	< 5.2	< 5.2	< 5.2	< 5.3
Bromoform		< 5.1	< 5.2	< 5.2	< 5.2	< 5.3
Bromomethane		< 5.1	< 5.2	< 5.2	< 5.2	< 5.3
Carbon Disulfide		< 5.1	< 5.2	< 5.2	< 5.2	< 5.3
Carbon Tetrachloride		< 5.1	< 5.2	< 5.2	< 5.2	< 5.3
Chlorobenzene		< 5.1	< 5.2	< 5.2	< 5.2	< 5.3
Chlorodifluoromethane		--	--	--	--	--
Chloroethane		< 5.1	< 5.2	< 5.2	< 5.2	< 5.3
Chloroform		< 5.1	< 5.2	< 5.2	< 5.2	< 5.3
Chloromethane		< 5.1	< 5.2	< 5.2	< 5.2	< 5.3
cis-1,2-Dichloroethene		< 5.1	< 5.2	< 5.2	< 5.2	< 5.3
cis-1,3-Dichloropropene		< 5.1	< 5.2	< 5.2	< 5.2	< 5.3
Dibromochloromethane		< 5.1	< 5.2	< 5.2	< 5.2	< 5.3
Dichlorodifluoromethane		< 5.1	< 5.2	< 5.2	< 5.2	< 5.3
Ethylbenzene		< 5.1	< 5.2	< 5.2	< 5.2	< 5.3
Freon 113		< 5.1	< 5.2	< 5.2	< 5.2	< 5.3
Methylene Chloride		< 5.1	< 5.2	< 5.2	< 5.2	< 5.3
Styrene		< 5.1	< 5.2	< 5.2	< 5.2	< 5.3
Tetrachloroethene		< 5.1	< 5.2	< 5.2	< 5.2	< 5.3
Toluene		< 5.1	< 5.2	< 5.2	< 5.2	< 5.3
trans-1,2-Dichloroethene		< 5.1	< 5.2	< 5.2	< 5.2	< 5.3
trans-1,3-Dichloropropene		< 5.1	< 5.2	< 5.2	< 5.2	< 5.3
Trichloroethylene		< 5.1	< 5.2	< 5.2	< 5.2	< 5.3
Trichlorotrifluoroethene		--	--	--	--	--
Vinyl Chloride		< 5.1	< 5.2	< 5.2	< 5.2	< 5.3
m,p-Xylenes		< 5.1	< 5.2	< 5.2	< 5.2	< 5.3
o-Xylene		< 5.1	< 5.2	< 5.2	< 5.2	< 5.3
Xylene (total)		--	--	--	--	--
TVOC		0	0	0	4.4	7.7

Footnotes on last page.

Table 1. Concentrations of Volatile Organic Compounds in On-Site Soil Borings, Former Settling Ponds (OU3 - Bethpage Community Park), Bethpage, New York.

CONSTITUENT (ug/kg)	Site ID: Sample Depth (ft bls): Sample Date:	N-6SB 30-32 2/22/2007	N-6SB 32-34 2/22/2007	N-6SB 34-36 2/22/2007	N-6SB 36-38 2/23/2007	N-6SB REP(36-38) 2/23/2007
Volatile Organic Compounds						
1,1,1-Trichloroethane		< 5.5	< 5.6	< 6.1	< 6.1	< 6.1
1,1,2,2-Tetrachloroethane		< 5.5	< 5.6	< 6.1	< 6.1	< 6.1
1,1,2-Trichloroethane		< 5.5	< 5.6	< 6.1	< 6.1	< 6.1
1,1-Dichloroethane		< 5.5	< 5.6	< 6.1	< 6.1	< 6.1
1,1-Dichloroethylene		< 5.5	< 5.6	< 6.1	< 6.1	< 6.1
1,2-Dichloroethane		< 5.5	< 5.6	< 6.1	< 6.1	< 6.1
1,2-Dichloropropane		< 5.5	< 5.6	< 6.1	< 6.1	< 6.1
1,3-Butadiene		--	--	--	--	--
2-Butanone		< 55	< 56	< 61	< 61	< 61
2-Hexanone		< 55	< 56	< 61	< 61	< 61
4-Methyl-2-Pentanone		< 55	< 56	< 61	< 61	< 61
Acetone		< 55	< 56	< 61	6.2 J	9.4 J
Benzene		< 5.5	< 5.6	< 6.1	< 6.1	< 6.1
Bromodichloromethane		< 5.5	< 5.6	< 6.1	< 6.1	< 6.1
Bromoform		< 5.5	< 5.6	< 6.1	< 6.1	< 6.1
Bromomethane		< 5.5	< 5.6	< 6.1	< 6.1	< 6.1
Carbon Disulfide		< 55	< 56	< 61	< 61	< 61
Carbon Tetrachloride		< 5.5	< 5.6	< 6.1	< 6.1	< 6.1
Chlorobenzene		< 5.5	< 5.6	< 6.1	< 6.1	< 6.1
Chlorodifluoromethane		--	--	--	--	--
Chloroethane		< 5.5	< 5.6	< 6.1	< 6.1	< 6.1
Chloroform		< 5.5	< 5.6	< 6.1	< 6.1	< 6.1
Chloromethane		< 5.5	< 5.6	< 6.1	< 6.1	< 6.1
cis-1,2-Dichloroethene		< 5.5	< 5.6	< 6.1	< 6.1	< 6.1
cis-1,3-Dichloropropene		< 5.5	< 5.6	< 6.1	< 6.1	< 6.1
Dibromochloromethane		< 5.5	< 5.6	< 6.1	< 6.1	< 6.1
Dichlorodifluoromethane		< 5.5	< 5.6	< 6.1	< 6.1	< 6.1
Ethylbenzene		< 5.5	< 5.6	< 6.1	< 6.1	< 6.1
Freon 113		< 5.5	< 5.6	< 6.1	< 6.1	< 6.1
Methylene Chloride		< 5.5	< 5.6	< 6.1	< 6.1	< 6.1
Styrene		< 5.5	< 5.6	< 6.1	< 6.1	< 6.1
Tetrachloroethene		< 5.5	< 5.6	< 6.1	< 6.1	< 6.1
Toluene		< 5.5	< 5.6	< 6.1	< 6.1	< 6.1
trans-1,2-Dichloroethene		< 5.5	< 5.6	< 6.1	< 6.1	< 6.1
trans-1,3-Dichloropropene		< 5.5	< 5.6	< 6.1	< 6.1	< 6.1
Trichloroethylene		1.8 J	1.5 J	1.7 J	< 6.1	< 6.1
Trichlorotrifluoroethene		--	--	--	--	--
Vinyl Chloride		< 5.5	< 5.6	< 6.1	< 6.1	< 6.1
m,p-Xylenes		< 5.5	< 5.6	< 6.1	< 6.1	< 6.1
o-Xylene		< 5.5	< 5.6	< 6.1	< 6.1	< 6.1
Xylene (total)		--	--	--	--	--
TVOC		1.8	1.5	1.7	6.2	9.4

Footnotes on last page.

ARCADIS

Table 1. Concentrations of Volatile Organic Compounds in On-Site Soil Borings, Former Settling Ponds (OU3 - Bethpage Community Park), Bethpage, New York.

CONSTITUENT (ug/kg)	Site ID: Sample Depth (ft bls): Sample Date:	N-6SB 38-40 2/23/2007	N-6SB 40-42 2/23/2007	N-6SB 42-44 2/23/2007	N-6SB 44-46 2/23/2007	N-6SB 46-48 2/23/2007
<u>Volatile Organic Compounds</u>						
1,1,1-Trichloroethane		< 5.6	< 5.8	< 6.1	< 5.8	< 5.8
1,1,2,2-Tetrachloroethane		< 5.6	< 5.8	< 6.1	< 5.8	< 5.8
1,1,2-Trichloroethane		< 5.6	< 5.8	< 6.1	< 5.8	< 5.8
1,1-Dichloroethane		< 5.6	< 5.8	< 6.1	< 5.8	< 5.8
1,1-Dichloroethlene		< 5.6	< 5.8	< 6.1	< 5.8	< 5.8
1,2-Dichloroethane		< 5.6	< 5.8	< 6.1	< 5.8	< 5.8
1,2-Dichloropropane		< 5.6	< 5.8	< 6.1	< 5.8	< 5.8
1,3-Butadiene		--	--	--	--	--
2-Butanone		< 56	< 58	< 61	< 58	< 58
2-Hexanone		< 56	< 58	< 61	< 58	< 58
4-Methyl-2-Pentanone		< 56	< 58	< 61	< 58	< 58
Acetone		< 56	5.6 J	< 61	5.4 J	5.4 J
Benzene		< 5.6	< 5.8	< 6.1	< 5.8	< 5.8
Bromodichloromethane		< 5.6	< 5.8	< 6.1	< 5.8	< 5.8
Bromoform		< 5.6	< 5.8	< 6.1	< 5.8	< 5.8
Bromomethane		< 5.6	< 5.8	< 6.1	< 5.8	< 5.8
Carbon Disulfide		< 56	< 58	< 61	< 58	< 58
Carbon Tetrachloride		< 5.6	< 5.8	< 6.1	< 5.8	< 5.8
Chlorobenzene		< 5.6	< 5.8	< 6.1	< 5.8	< 5.8
Chlorodifluoromethane		--	--	--	--	--
Chloroethane		< 5.6	< 5.8	< 6.1	< 5.8	< 5.8
Chloroform		< 5.6	< 5.8	< 6.1	< 5.8	< 5.8
Chloromethane		< 5.6	< 5.8	< 6.1	< 5.8	< 5.8
cis-1,2-Dichloroethene		< 5.6	< 5.8	< 6.1	< 5.8	< 5.8
cis-1,3-Dichloropropene		< 5.6	< 5.8	< 6.1	< 5.8	< 5.8
Dibromochloromethane		< 5.6	< 5.8	< 6.1	< 5.8	< 5.8
Dichlorodifluoromethane		< 5.6	< 5.8	< 6.1	< 5.8	< 5.8
Ethylbenzene		< 5.6	< 5.8	< 6.1	< 5.8	< 5.8
Freon 113		< 5.6	< 5.8	< 6.1	< 5.8	< 5.8
Methylene Chloride		< 5.6	< 5.8	< 6.1	< 5.8	< 5.8
Styrene		< 5.6	< 5.8	< 6.1	< 5.8	< 5.8
Tetrachloroethene		< 5.6	< 5.8	< 6.1	< 5.8	< 5.8
Toluene		< 5.6	< 5.8	< 6.1	< 5.8	< 5.8
trans-1,2-Dichloroethene		< 5.6	< 5.8	< 6.1	< 5.8	< 5.8
trans-1,3-Dichloropropene		< 5.6	< 5.8	< 6.1	< 5.8	< 5.8
Trichloroethlene		< 5.6	< 5.8	< 6.1	< 5.8	< 5.8
Trichlorotrifluoroethene		--	--	--	--	--
Vinyl Chloride		< 5.6	< 5.8	< 6.1	< 5.8	< 5.8
m,p-Xylenes		< 5.6	< 5.8	< 6.1	< 5.8	< 5.8
o-Xylene		< 5.6	< 5.8	< 6.1	< 5.8	< 5.8
Xylene (total)		--	--	--	--	--
TVOC		0	5.6	0	5.4	5.4

Footnotes on last page.

ARCADIS

Table 1. Concentrations of Volatile Organic Compounds in On-Site Soil Borings, Former Settling Ponds (OU3 - Bethpage Community Park), Bethpage, New York.

CONSTITUENT (ug/kg)	Site ID: Sample Depth (ft bls): Sample Date:	N-6SB 48-50 2/23/2007	N-6SB 50-52 2/23/2007	N-6SB 52-54 2/23/2007	N-6SB 54-56 2/23/2007	N-8SB 20-22 2/23/2007
<u>Volatile Organic Compounds</u>						
1,1,1-Trichloroethane		< 5.5	< 5.7	< 5.8	< 5.9	< 5.1
1,1,2,2-Tetrachloroethane		< 5.5	< 5.7	< 5.8	< 5.9	< 5.1
1,1,2-Trichloroethane		< 5.5	< 5.7	< 5.8	< 5.9	< 5.1
1,1-Dichloroethane		< 5.5	< 5.7	< 5.8	< 5.9	< 5.1
1,1-Dichloroethylene		< 5.5	< 5.7	< 5.8	< 5.9	< 5.1
1,2-Dichloroethane		< 5.5	< 5.7	< 5.8	< 5.9	< 5.1
1,2-Dichloropropane		< 5.5	< 5.7	< 5.8	< 5.9	< 5.1
1,3-Butadiene		--	--	--	--	--
2-Butanone		< 55	< 57	< 58	< 59	< 51
2-Hexanone		< 55	< 57	< 58	< 59	< 51
4-Methyl-2-Pentanone		< 55	< 57	< 58	< 59	< 51
Acetone		13 J	< 57	< 58	< 59	3.3 J
Benzene		< 5.5	< 5.7	< 5.8	< 5.9	0.4 J
Bromodichloromethane		< 5.5	< 5.7	< 5.8	< 5.9	< 5.1
Bromoform		< 5.5	< 5.7	< 5.8	< 5.9	< 5.1
Bromomethane		< 5.5	< 5.7	< 5.8	< 5.9	< 5.1
Carbon Disulfide		< 55	< 57	< 58	< 59	< 51
Carbon Tetrachloride		< 5.5	< 5.7	< 5.8	< 5.9	< 5.1
Chlorobenzene		< 5.5	< 5.7	< 5.8	< 5.9	0.31 J
Chlorodifluoromethane		--	--	--	--	--
Chloroethane		< 5.5	< 5.7	< 5.8	< 5.9	< 5.1
Chloroform		< 5.5	< 5.7	< 5.8	< 5.9	< 5.1
Chloromethane		< 5.5	< 5.7	< 5.8	< 5.9	< 5.1
cis-1,2-Dichloroethene		< 5.5	< 5.7	4.9 J	< 5.9	< 5.1
cis-1,3-Dichloropropene		< 5.5	< 5.7	< 5.8	< 5.9	< 5.1
Dibromochloromethane		< 5.5	< 5.7	< 5.8	< 5.9	< 5.1
Dichlorodifluoromethane		< 5.5	< 5.7	< 5.8	< 5.9	< 5.1
Ethylbenzene		< 5.5	< 5.7	< 5.8	< 5.9	< 5.1
Freon 113		< 5.5	< 5.7	< 5.8	< 5.9	< 5.1
Methylene Chloride		< 5.5	< 5.7	< 5.8	< 5.9	< 5.1
Styrene		< 5.5	< 5.7	< 5.8	< 5.9	< 5.1
Tetrachloroethene		< 5.5	< 5.7	< 5.8	< 5.9	< 5.1
Toluene		< 5.5	< 5.7	< 5.8	< 5.9	0.4 J
trans-1,2-Dichloroethene		< 5.5	< 5.7	< 5.8	< 5.9	< 5.1
trans-1,3-Dichloropropene		< 5.5	< 5.7	< 5.8	< 5.9	< 5.1
Trichloroethylene		< 5.5	< 5.7	1.8 J	< 5.9	0.39 J
Trichlorotrifluoroethene		--	--	--	--	--
Vinyl Chloride		< 5.5	< 5.7	< 5.8	< 5.9	< 5.1
m,p-Xylenes		< 5.5	< 5.7	< 5.8	< 5.9	< 5.1
o-Xylene		< 5.5	< 5.7	< 5.8	< 5.9	< 5.1
Xylene (total)		--	--	--	--	--
TVOC		13	0	6.7	0	4.8

Footnotes on last page.

Table 1. Concentrations of Volatile Organic Compounds in On-Site Soil Borings, Former Settling Ponds (OU3 - Bethpage Community Park), Bethpage, New York.

CONSTITUENT (ug/kg)	Site ID: Sample Depth (ft bls): Sample Date:	N-8SB 22-24 2/23/2007	N-8SB 24-26 2/23/2007	N-8SB 26-28 2/23/2007	N-8SB 28-30 2/23/2007	N-8SB 30-32 2/23/2007
<u>Volatile Organic Compounds</u>						
1,1,1-Trichloroethane		< 5.2	< 5.2	< 5.1	< 5.2	< 5.2
1,1,2,2-Tetrachloroethane		< 5.2	< 5.2	< 5.1	< 5.2	< 5.2
1,1,2-Trichloroethane		< 5.2	< 5.2	< 5.1	< 5.2	< 5.2
1,1-Dichloroethane		< 5.2	< 5.2	< 5.1	< 5.2	< 5.2
1,1-Dichloroethylene		< 5.2	< 5.2	< 5.1	< 5.2	< 5.2
1,2-Dichloroethane		< 5.2	< 5.2	< 5.1	< 5.2	< 5.2
1,2-Dichloropropane		< 5.2	< 5.2	< 5.1	< 5.2	< 5.2
1,3-Butadiene		--	--	--	--	--
2-Butanone		< 5.2	< 5.2	< 5.1	< 5.2	< 5.2
2-Hexanone		< 5.2	< 5.2	< 5.1	< 5.2	< 5.2
4-Methyl-2-Pentanone		< 5.2	< 5.2	< 5.1	< 5.2	< 5.2
Acetone		4.8 J	3 J	2.8 J	3 J	3.3 J
Benzene		< 5.2	< 5.2	< 5.1	< 5.2	< 5.2
Bromodichloromethane		< 5.2	< 5.2	< 5.1	< 5.2	< 5.2
Bromoform		< 5.2	< 5.2	< 5.1	< 5.2	< 5.2
Bromomethane		< 5.2	< 5.2	< 5.1	< 5.2	< 5.2
Carbon Disulfide		< 5.2	< 5.2	< 5.1	< 5.2	< 5.2
Carbon Tetrachloride		< 5.2	< 5.2	< 5.1	< 5.2	< 5.2
Chlorobenzene		< 5.2	< 5.2	< 5.1	< 5.2	< 5.2
Chlorodifluoromethane		--	--	--	--	--
Chloroethane		< 5.2	< 5.2	< 5.1	< 5.2	< 5.2
Chloroform		< 5.2	< 5.2	< 5.1	< 5.2	< 5.2
Chloromethane		< 5.2	< 5.2	< 5.1	< 5.2	< 5.2
cis-1,2-Dichloroethene		< 5.2	< 5.2	< 5.1	< 5.2	< 5.2
cis-1,3-Dichloropropene		< 5.2	< 5.2	< 5.1	< 5.2	< 5.2
Dibromochloromethane		< 5.2	< 5.2	< 5.1	< 5.2	< 5.2
Dichlorodifluoromethane		< 5.2	< 5.2	< 5.1	< 5.2	< 5.2
Ethylbenzene		< 5.2	< 5.2	< 5.1	< 5.2	< 5.2
Freon 113		< 5.2	< 5.2	< 5.1	< 5.2	< 5.2
Methylene Chloride		< 5.2	< 5.2	< 5.1	< 5.2	< 5.2
Styrene		< 5.2	< 5.2	< 5.1	< 5.2	< 5.2
Tetrachloroethene		< 5.2	< 5.2	< 5.1	< 5.2	< 5.2
Toluene		< 5.2	< 5.2	< 5.1	< 5.2	< 5.2
trans-1,2-Dichloroethene		< 5.2	< 5.2	< 5.1	< 5.2	< 5.2
trans-1,3-Dichloropropene		< 5.2	< 5.2	< 5.1	< 5.2	< 5.2
Trichloroethylene		< 5.2	< 5.2	< 5.1	< 5.2	< 5.2
Trichlorotrifluoroethene		--	--	--	--	--
Vinyl Chloride		< 5.2	< 5.2	< 5.1	< 5.2	< 5.2
m,p-Xylenes		< 5.2	< 5.2	< 5.1	< 5.2	< 5.2
o-Xylene		< 5.2	< 5.2	< 5.1	< 5.2	< 5.2
Xylene (total)		--	--	--	--	--
TVOC		4.8	3	2.8	3	3.3

Footnotes on last page.

ARCADIS

Table 1. Concentrations of Volatile Organic Compounds in On-Site Soil Borings, Former Settling Ponds (OU3 - Bethpage Community Park), Bethpage, New York.

CONSTITUENT (ug/kg)	Site ID: Sample Depth (ft bls): Sample Date:	N-8SB REP(30-32) 2/23/2007	N-8SB 32-34 2/23/2007	N-8SB 34-36 2/23/2007	N-8SB 36-38 2/23/2007	N-8SB 38-40 2/23/2007
<u>Volatile Organic Compounds</u>						
1,1,1-Trichloroethane		< 5.2	< 5.3	< 5.4	< 5.2	< 5.6
1,1,2,2-Tetrachloroethane		< 5.2	< 5.3	< 5.4	< 5.2	< 5.6
1,1,2-Trichloroethane		< 5.2	< 5.3	< 5.4	< 5.2	< 5.6
1,1-Dichloroethane		< 5.2	< 5.3	< 5.4	< 5.2	< 5.6
1,1-Dichloroethylene		< 5.2	< 5.3	< 5.4	< 5.2	< 5.6
1,2-Dichloroethane		< 5.2	< 5.3	< 5.4	< 5.2	< 5.6
1,2-Dichloropropane		< 5.2	< 5.3	< 5.4	< 5.2	< 5.6
1,3-Butadiene		--	--	--	--	--
2-Butanone		< 52	< 53	< 54	< 52	< 56
2-Hexanone		< 52	< 53	< 54	< 52	< 56
4-Methyl-2-Pentanone		< 52	< 53	< 54	< 52	< 56
Acetone		2.5 J	3 J	4.1 J	3.9 J	6.4 J
Benzene		< 5.2	< 5.3	< 5.4	< 5.2	< 5.6
Bromodichloromethane		< 5.2	< 5.3	< 5.4	< 5.2	< 5.6
Bromoform		< 5.2	< 5.3	< 5.4	< 5.2	< 5.6
Bromomethane		< 5.2	< 5.3	< 5.4	< 5.2	< 5.6
Carbon Disulfide		< 52	< 53	< 54	< 52	< 56
Carbon Tetrachloride		< 5.2	< 5.3	< 5.4	< 5.2	< 5.6
Chlorobenzene		< 5.2	< 5.3	< 5.4	< 5.2	< 5.6
Chlorodifluoromethane		--	--	--	--	--
Chloroethane		< 5.2	< 5.3	< 5.4	< 5.2	< 5.6
Chloroform		< 5.2	< 5.3	< 5.4	< 5.2	< 5.6
Chloromethane		< 5.2	< 5.3	< 5.4	< 5.2	< 5.6
cis-1,2-Dichloroethene		< 5.2	< 5.3	< 5.4	< 5.2	< 5.6
cis-1,3-Dichloropropene		< 5.2	< 5.3	< 5.4	< 5.2	< 5.6
Dibromochloromethane		< 5.2	< 5.3	< 5.4	< 5.2	< 5.6
Dichlorodifluoromethane		< 5.2	< 5.3	< 5.4	< 5.2	< 5.6
Ethylbenzene		< 5.2	< 5.3	< 5.4	< 5.2	< 5.6
Freon 113		< 5.2	< 5.3	< 5.4	< 5.2	< 5.6
Methylene Chloride		< 5.2	< 5.3	< 5.4	< 5.2	< 5.6
Styrene		< 5.2	< 5.3	< 5.4	< 5.2	< 5.6
Tetrachloroethene		< 5.2	< 5.3	< 5.4	< 5.2	< 5.6
Toluene		< 5.2	< 5.3	< 5.4	< 5.2	0.45 J
trans-1,2-Dichloroethene		< 5.2	< 5.3	< 5.4	< 5.2	< 5.6
trans-1,3-Dichloropropene		< 5.2	< 5.3	< 5.4	< 5.2	< 5.6
Trichloroethylene		< 5.2	< 5.3	< 5.4	< 5.2	0.75 J
Trichlorotrifluoroethene		--	--	--	--	--
Vinyl Chloride		< 5.2	< 5.3	< 5.4	< 5.2	< 5.6
m,p-Xylenes		< 5.2	< 5.3	< 5.4	< 5.2	< 5.6
o-Xylene		< 5.2	< 5.3	< 5.4	< 5.2	< 5.6
Xylene (total)		--	--	--	--	--
TVOC		2.5	3	4.1	3.9	7.6

Footnotes on last page.

Table 1. Concentrations of Volatile Organic Compounds in On-Site Soil Borings, Former Settling Ponds (OU3 - Bethpage Community Park), Bethpage, New York.

CONSTITUENT (ug/kg)	Site ID: Sample Depth (ft bls): Sample Date:	N-8SB 40-42 2/23/2007	N-8SB 42-44 2/23/2007	N-8SB 44-46 2/23/2007	N-8SB 46-48 2/23/2007	N-8SB 48-50 2/23/2007
<u>Volatile Organic Compounds</u>						
1,1,1-Trichloroethane		< 5.3	< 5.9	< 5.5	< 5.2	< 5.3
1,1,2,2-Tetrachloroethane		< 5.3	< 5.9	< 5.5	< 5.2	< 5.3
1,1,2-Trichloroethane		< 5.3	< 5.9	< 5.5	< 5.2	< 5.3
1,1-Dichloroethane		< 5.3	< 5.9	< 5.5	< 5.2	< 5.3
1,1-Dichloroethylene		< 5.3	< 5.9	< 5.5	< 5.2	< 5.3
1,2-Dichloroethane		< 5.3	< 5.9	< 5.5	< 5.2	< 5.3
1,2-Dichloropropane		< 5.3	< 5.9	< 5.5	< 5.2	< 5.3
1,3-Butadiene		--	--	--	--	--
2-Butanone		< 53	< 59	< 55	< 52	< 53
2-Hexanone		< 53	< 59	< 55	< 52	< 53
4-Methyl-2-Pentanone		< 53	< 59	< 55	< 52	< 53
Acetone		3.8 J	3.9 J	3.6 J	4.2 J	4.4 J
Benzene		< 5.3	< 5.9	< 5.5	< 5.2	< 5.3
Bromodichloromethane		< 5.3	< 5.9	< 5.5	< 5.2	< 5.3
Bromoform		< 5.3	< 5.9	< 5.5	< 5.2	< 5.3
Bromomethane		< 5.3	< 5.9	< 5.5	< 5.2	< 5.3
Carbon Disulfide		< 53	< 59	< 55	< 52	< 53
Carbon Tetrachloride		< 5.3	< 5.9	< 5.5	< 5.2	< 5.3
Chlorobenzene		< 5.3	< 5.9	< 5.5	< 5.2	< 5.3
Chlorodifluoromethane		--	--	--	--	--
Chloroethane		< 5.3	< 5.9	< 5.5	< 5.2	< 5.3
Chloroform		< 5.3	< 5.9	< 5.5	< 5.2	< 5.3
Chloromethane		< 5.3	< 5.9	< 5.5	< 5.2	< 5.3
cis-1,2-Dichloroethene		< 5.3	< 5.9	< 5.5	< 5.2	< 5.3
cis-1,3-Dichloropropene		< 5.3	< 5.9	< 5.5	< 5.2	< 5.3
Dibromochloromethane		< 5.3	< 5.9	< 5.5	< 5.2	< 5.3
Dichlorodifluoromethane		< 5.3	< 5.9	< 5.5	< 5.2	< 5.3
Ethylbenzene		< 5.3	< 5.9	< 5.5	< 5.2	< 5.3
Freon 113		< 5.3	< 5.9	< 5.5	< 5.2	< 5.3
Methylene Chloride		< 5.3	< 5.9	< 5.5	< 5.2	< 5.3
Styrene		< 5.3	< 5.9	< 5.5	< 5.2	< 5.3
Tetrachloroethene		< 5.3	< 5.9	< 5.5	< 5.2	< 5.3
Toluene		< 5.3	< 5.9	< 5.5	< 5.2	< 5.3
trans-1,2-Dichloroethene		< 5.3	< 5.9	< 5.5	< 5.2	< 5.3
trans-1,3-Dichloropropene		< 5.3	< 5.9	< 5.5	< 5.2	< 5.3
Trichloroethylene		< 5.3	< 5.9	< 5.5	< 5.2	< 5.3
Trichlorotrifluoroethene		--	--	--	--	--
Vinyl Chloride		< 5.3	< 5.9	< 5.5	< 5.2	< 5.3
m,p-Xylenes		< 5.3	< 5.9	< 5.5	< 5.2	< 5.3
o-Xylene		< 5.3	< 5.9	< 5.5	< 5.2	< 5.3
Xylene (total)		--	--	--	--	--
TVOC		3.8	3.9	3.6	4.2	4.4

Footnotes on last page.

ARCADIS

Table 1. Concentrations of Volatile Organic Compounds in On-Site Soil Borings, Former Settling Ponds (OU3 - Bethpage Community Park), Bethpage, New York.

CONSTITUENT (ug/kg)	Site ID: Sample Depth: Sample Date:	N-8SB 50-52 2/23/2007	N-8SB 52-54 2/23/2007	N-8SB 54-56 2/23/2007	P-5SB 20-22 2/23/2007	P-5SB 22-24 2/23/2007
<u>Volatile Organic Compounds</u>						
1,1,1-Trichloroethane		< 5.6	< 6.1	< 6.2	< 5.2	< 5.2
1,1,2,2-Tetrachloroethane		< 5.6	< 6.1	< 6.2	< 5.2	< 5.2
1,1,2-Trichloroethane		< 5.6	< 6.1	< 6.2	< 5.2	< 5.2
1,1-Dichloroethane		< 5.6	< 6.1	< 6.2	< 5.2	< 5.2
1,1-Dichloroethylene		< 5.6	< 6.1	< 6.2	< 5.2	< 5.2
1,2-Dichloroethane		< 5.6	< 6.1	< 6.2	< 5.2	< 5.2
1,2-Dichloropropane		< 5.6	< 6.1	< 6.2	< 5.2	< 5.2
1,3-Butadiene		--	--	--	--	--
2-Butanone		< 56	< 61	< 62	< 52	< 52
2-Hexanone		< 56	< 61	< 62	< 52	< 52
4-Methyl-2-Pentanone		< 56	< 61	< 62	< 52	< 52
Acetone		3.5 J	4.4 J	4.4 J	4.5 J	4.9 J
Benzene		< 5.6	< 6.1	< 6.2	< 5.2	< 5.2
Bromodichloromethane		< 5.6	< 6.1	< 6.2	< 5.2	< 5.2
Bromoform		< 5.6	< 6.1	< 6.2	< 5.2	< 5.2
Bromomethane		< 5.6	< 6.1	< 6.2	< 5.2	< 5.2
Carbon Disulfide		< 56	< 61	< 62	< 52	< 52
Carbon Tetrachloride		< 5.6	< 6.1	< 6.2	< 5.2	< 5.2
Chlorobenzene		< 5.6	< 6.1	< 6.2	< 5.2	< 5.2
Chlorodifluoromethane		--	--	--	--	--
Chloroethane		< 5.6	< 6.1	< 6.2	< 5.2	< 5.2
Chloroform		< 5.6	< 6.1	< 6.2	< 5.2	< 5.2
Chloromethane		< 5.6	< 6.1	< 6.2	< 5.2	< 5.2
cis-1,2-Dichloroethene		< 5.6	< 6.1	< 6.2	110	4 J
cis-1,3-Dichloropropene		< 5.6	< 6.1	< 6.2	< 5.2	< 5.2
Dibromochloromethane		< 5.6	< 6.1	< 6.2	< 5.2	< 5.2
Dichlorodifluoromethane		< 5.6	< 6.1	0.5 J	< 5.2	< 5.2
Ethylbenzene		< 5.6	< 6.1	< 6.2	< 5.2	< 5.2
Freon 113		< 5.6	< 6.1	< 6.2	< 5.2	< 5.2
Methylene Chloride		< 5.6	< 6.1	< 6.2	< 5.2	< 5.2
Styrene		< 5.6	< 6.1	< 6.2	< 5.2	< 5.2
Tetrachloroethene		< 5.6	< 6.1	0.7 J	< 5.2	< 5.2
Toluene		< 5.6	0.48 J	0.42 J	< 5.2	< 5.2
trans-1,2-Dichloroethene		< 5.6	< 6.1	< 6.2	4.1 J	< 5.2
trans-1,3-Dichloropropene		< 5.6	< 6.1	< 6.2	< 5.2	< 5.2
Trichloroethylene		0.64 J	2 J	< 6.2	25	1.3 J
Trichlorotrifluoroethene		--	--	--	--	--
Vinyl Chloride		< 5.6	< 6.1	< 6.2	2.8 J	< 5.2
m,p-Xylenes		< 5.6	< 6.1	< 6.2	< 5.2	< 5.2
o-Xylene		< 5.6	< 6.1	< 6.2	< 5.2	< 5.2
Xylene (total)		--	--	--	--	--
TVOC		4.14	6.88	6.02	146.4	10.2

Footnotes on last page.

ARCADIS

Table 1. Concentrations of Volatile Organic Compounds in On-Site Soil Borings, Former Settling Ponds (OU3 - Bethpage Community Park), Bethpage, New York.

CONSTITUENT (ug/kg)	Site ID: Sample Depth: Sample Date:	P-5SB 24-26 2/23/2007	P-5SB 26-28 2/23/2007	P-5SB 30-32 2/23/2007	P-5SB 32-34 2/23/2007	P-5SB 34-36 2/23/2007
<u>Volatile Organic Compounds</u>						
1,1,1-Trichloroethane		< 5.2	< 5.1	< 5.3	< 5.3	< 5.5
1,1,2,2-Tetrachloroethane		< 5.2	< 5.1	< 5.3	< 5.3	< 5.5
1,1,2-Trichloroethane		< 5.2	< 5.1	< 5.3	< 5.3	< 5.5
1,1-Dichloroethane		< 5.2	< 5.1	< 5.3	< 5.3	< 5.5
1,1-Dichloroethylene		< 5.2	0.32 J	< 5.3	< 5.3	< 5.5
1,2-Dichloroethane		< 5.2	< 5.1	< 5.3	< 5.3	< 5.5
1,2-Dichloropropane		< 5.2	< 5.1	< 5.3	< 5.3	< 5.5
1,3-Butadiene		--	--	--	--	--
2-Butanone		< 52	< 51	< 53	< 53	< 55
2-Hexanone		< 52	< 51	< 53	< 53	< 55
4-Methyl-2-Pentanone		< 52	< 51	< 53	< 53	< 55
Acetone		18 J	5.7 J	31 J	8 J	15 J
Benzene		< 5.2	< 5.1	< 5.3	< 5.3	< 5.5
Bromodichloromethane		< 5.2	< 5.1	< 5.3	< 5.3	< 5.5
Bromoform		< 5.2	< 5.1	< 5.3	< 5.3	< 5.5
Bromomethane		< 5.2	< 5.1	< 5.3	< 5.3	< 5.5
Carbon Disulfide		2.6 J	< 51	0.42 J	< 53	< 55
Carbon Tetrachloride		< 5.2	< 5.1	< 5.3	< 5.3	< 5.5
Chlorobenzene		< 5.2	< 5.1	< 5.3	< 5.3	< 5.5
Chlorodifluoromethane		--	--	--	--	--
Chloroethane		< 5.2	< 5.1	< 5.3	< 5.3	< 5.5
Chloroform		< 5.2	< 5.1	< 5.3	< 5.3	< 5.5
Chloromethane		< 5.2	< 5.1	< 5.3	< 5.3	< 5.5
cis-1,2-Dichloroethene		320 D	3.4 J	84	0.91 J	2.6 J
cis-1,3-Dichloropropene		< 5.2	< 5.1	< 5.3	< 5.3	< 5.5
Dibromochloromethane		< 5.2	< 5.1	< 5.3	< 5.3	< 5.5
Dichlorodifluoromethane		< 5.2	< 5.1	< 5.3	< 5.3	< 5.5
Ethylbenzene		1.8 J	< 5.1	1.3 J	< 5.3	< 5.5
Freon 113		< 5.2	< 5.1	< 5.3	< 5.3	< 5.5
Methylene Chloride		< 5.2	< 5.1	< 5.3	< 5.3	< 5.5
Styrene		< 5.2	< 5.1	< 5.3	< 5.3	< 5.5
Tetrachloroethene		3.7 J	< 5.1	1.7 J	< 5.3	< 5.5
Toluene		5.5	0.34 J	2.4 J	< 5.3	< 5.5
trans-1,2-Dichloroethene		12	< 5.1	0.86 J	< 5.3	< 5.5
trans-1,3-Dichloropropene		< 5.2	< 5.1	< 5.3	< 5.3	< 5.5
Trichloroethylene		58	0.9 J	24	< 5.3	< 5.5
Trichlorotrifluoroethene		--	--	--	--	--
Vinyl Chloride		9	< 5.1	< 5.3	< 5.3	< 5.5
m,p-Xylenes		4.1 J	< 5.1	2.9 J	< 5.3	< 5.5
o-Xylene		4.9 J	< 5.1	3.6 J	< 5.3	< 5.5
Xylene (total)		--	--	--	--	--
TVOC		430.6	10.66	145.68	8.91	17.6

Footnotes on last page.

ARCADIS

Table 1. Concentrations of Volatile Organic Compounds in On-Site Soil Borings, Former Settling Ponds (OU3 - Bethpage Community Park), Bethpage, New York.

CONSTITUENT (ug/kg)	Site ID: Sample Depth: Sample Date:	P-5SB 36-38 2/23/2007	P-5SB 38-40 2/23/2007	P-5SB 40-42 2/23/2007	P-5SB 42-44 2/23/2007	P-5SB 44-46 2/23/2007
<u>Volatiles Organic Compounds</u>						
1,1,1-Trichloroethane		< 5.6	< 5.4	< 5.5	< 5.3	< 5.8
1,1,1,2-Tetrachloroethane		< 5.6	< 5.4	< 5.5	< 5.3	< 5.8
1,1,1,2-Trichloroethane		< 5.6	< 5.4	< 5.5	< 5.3	< 5.8
1,1-Dichloroethane		< 5.6	< 5.4	< 5.5	< 5.3	< 5.8
1,1-Dichloroethylene		< 5.6	< 5.4	< 5.5	< 5.3	< 5.8
1,2-Dichloroethane		< 5.6	< 5.4	< 5.5	< 5.3	< 5.8
1,2-Dichloropropane		< 5.6	< 5.4	< 5.5	< 5.3	< 5.8
1,3-Butadiene		--	--	--	--	--
2-Butanone		< 56	< 54	< 55	< 53	< 58
2-Hexanone		< 56	< 54	< 55	< 53	< 58
4-Methyl-2-Pentanone		< 56	< 54	< 55	< 53	< 58
Acetone		11 J	4.9 J	6.7 J	5.9 J	11 J
Benzene		< 5.6	< 5.4	< 5.5	< 5.3	< 5.8
Bromodichloromethane		< 5.6	< 5.4	< 5.5	< 5.3	< 5.8
Bromoform		< 5.6	< 5.4	< 5.5	< 5.3	< 5.8
Bromomethane		< 5.6	< 5.4	< 5.5	< 5.3	< 5.8
Carbon Disulfide		< 56	< 54	< 55	< 53	< 58
Carbon Tetrachloride		< 5.6	< 5.4	< 5.5	< 5.3	< 5.8
Chlorobenzene		< 5.6	< 5.4	< 5.5	< 5.3	< 5.8
Chlorodifluoromethane		--	--	--	--	--
Chloroethane		< 5.6	< 5.4	< 5.5	< 5.3	< 5.8
Chloroform		< 5.6	< 5.4	< 5.5	< 5.3	< 5.8
Chloromethane		< 5.6	< 5.4	< 5.5	< 5.3	< 5.8
cis-1,2-Dichloroethene		2.1 J	< 5.4	< 5.5	< 5.3	0.67 J
cis-1,3-Dichloropropene		< 5.6	< 5.4	< 5.5	< 5.3	< 5.8
Dibromochloromethane		< 5.6	< 5.4	< 5.5	< 5.3	< 5.8
Dichlorodifluoromethane		< 5.6	< 5.4	< 5.5	< 5.3	< 5.8
Ethylbenzene		< 5.6	< 5.4	< 5.5	< 5.3	< 5.8
Freon 113		< 5.6	< 5.4	< 5.5	< 5.3	< 5.8
Methylene Chloride		< 5.6	< 5.4	< 5.5	< 5.3	< 5.8
Styrene		< 5.6	< 5.4	< 5.5	< 5.3	< 5.8
Tetrachloroethene		< 5.6	< 5.4	< 5.5	< 5.3	< 5.8
Toluene		< 5.6	< 5.4	< 5.5	< 5.3	< 5.8
trans-1,2-Dichloroethene		< 5.6	< 5.4	< 5.5	< 5.3	< 5.8
trans-1,3-Dichloropropene		< 5.6	< 5.4	< 5.5	< 5.3	< 5.8
Trichloroethylene		< 5.6	< 5.4	< 5.5	< 5.3	< 5.8
Trichlorotrifluoroethene		--	--	--	--	--
Vinyl Chloride		< 5.6	< 5.4	< 5.5	< 5.3	< 5.8
m,p-Xylenes		< 5.6	< 5.4	< 5.5	< 5.3	< 5.8
o-Xylene		< 5.6	< 5.4	< 5.5	< 5.3	< 5.8
Xylene (total)		--	--	--	--	--
TVOC		13.1	4.9	6.7	5.9	11.67

Footnotes on last page.

Table 1. Concentrations of Volatile Organic Compounds in On-Site Soil Borings, Former Settling Ponds (OU3 - Bethpage Community Park), Bethpage, New York.

CONSTITUENT (ug/kg)	Site ID: Sample Depth: Sample Date:	P-5SB 46-48 2/23/2007	P-5SB 48-50 2/23/2007	P-5SB 50-52 2/23/2007	P-5SB 52-54 2/23/2007	P-5SB 54-56 2/23/2007
Volatile Organic Compounds						
1,1,1-Trichloroethane		< 5.4	< 5.6	< 5.6	< 5.7	< 6.1
1,1,2,2-Tetrachloroethane		< 5.4	< 5.6	< 5.6	< 5.7	< 6.1
1,1,2-Trichloroethane		< 5.4	< 5.6	< 5.6	< 5.7	< 6.1
1,1-Dichloroethane		< 5.4	< 5.6	< 5.6	< 5.7	< 6.1
1,1-Dichloroethylene		< 5.4	< 5.6	< 5.6	< 5.7	< 6.1
1,2-Dichloroethane		< 5.4	< 5.6	< 5.6	< 5.7	< 6.1
1,2-Dichloropropane		< 5.4	< 5.6	< 5.6	< 5.7	< 6.1
1,3-Butadiene		--	--	--	--	--
2-Butanone		< 5.4	< 5.6	< 5.6	< 5.7	< 6.1
2-Hexanone		< 5.4	< 5.6	< 5.6	< 5.7	< 6.1
4-Methyl-2-Pentanone		0.94 J	1.2 J J	< 5.6	< 5.7	< 6.1
Acetone		4.4 J	15 J	8.5 J	6.5 J	11 J
Benzene		< 5.4	< 5.6	< 5.6	< 5.7	< 6.1
Bromodichloromethane		< 5.4	< 5.6	< 5.6	< 5.7	< 6.1
Bromoform		< 5.4	< 5.6	< 5.6	< 5.7	< 6.1
Bromomethane		< 5.4	< 5.6	< 5.6	< 5.7	< 6.1
Carbon Disulfide		< 5.4	< 5.6	< 5.6	< 5.7	< 6.1
Carbon Tetrachloride		< 5.4	< 5.6	< 5.6	< 5.7	< 6.1
Chlorobenzene		< 5.4	< 5.6	< 5.6	< 5.7	< 6.1
Chlorodifluoromethane		--	--	--	--	--
Chloroethane		< 5.4	< 5.6	< 5.6	< 5.7	< 6.1
Chloroform		< 5.4	< 5.6	< 5.6	< 5.7	< 6.1
Chloromethane		< 5.4	< 5.6	< 5.6	< 5.7	< 6.1
cis-1,2-Dichloroethene		0.56 J	4.4 J	0.85 J	1 J	36
cis-1,3-Dichloropropene		< 5.4	< 5.6	< 5.6	< 5.7	< 6.1
Dibromochloromethane		< 5.4	< 5.6	< 5.6	< 5.7	< 6.1
Dichlorodifluoromethane		< 5.4	< 5.6	< 5.6	< 5.7	< 6.1
Ethylbenzene		< 5.4	< 5.6	< 5.6	< 5.7	< 6.1
Freon 113		< 5.4	< 5.6	< 5.6	< 5.7	< 6.1
Methylene Chloride		< 5.4	< 5.6	< 5.6	< 5.7	< 6.1
Styrene		< 5.4	< 5.6	< 5.6	< 5.7	< 6.1
Tetrachloroethene		< 5.4	< 5.6	< 5.6	< 5.7	< 6.1
Toluene		< 5.4	0.42 J	< 5.6	< 5.7	< 6.1
trans-1,2-Dichloroethene		< 5.4	< 5.6	< 5.6	< 5.7	< 6.1
trans-1,3-Dichloropropene		< 5.4	< 5.6	< 5.6	< 5.7	< 6.1
Trichloroethylene		< 5.4	5.1 J	0.5 J	< 5.7	2.7 J
Trichlorotrifluoroethene		--	--	--	--	--
Vinyl Chloride		< 5.4	< 5.6	< 5.6	< 5.7	< 6.1
m,p-Xylenes		< 5.4	< 5.6	< 5.6	< 5.7	< 6.1
o-Xylene		< 5.4	< 5.6	< 5.6	< 5.7	< 6.1
Xylene (total)		--	--	--	--	--
TVOC		5.9	24.92	9.85	7.5	49.7

Footnotes on last page.

Table 1. Concentrations of Volatile Organic Compounds in On-Site Soil Borings, Former Settling Ponds (OU3 - Bethpage Community Park), Bethpage, New York.

Bold value indicates a detection.

ug/kg	Microgram per kilogram (dry weight basis)
J	Estimated Value
D	Constituent quantified at a secondary dilution
ft bls	feet below land surface
TVOC	Total Volatile Organic Compounds
REP	Replicate
SB	Soil Boring
--	Not Analyzed; chlorodifluoromethane reported as a tentatively identified compound.

ARCADIS

Table 2. Concentrations of Volatile Organic Compounds in Soil Gas, Northrop Grumman, Former Settling Ponds (OU3 - Bethpage Community Park), Bethpage, New York

CONSTITUENT (ug/m3)	Site ID: Sample ID: Sample Date: Depth (ft bls):	SGP-11 7 - 7.5 5/5/2006 7-7.5	SGP-11A 7.5-8 3/21/2007 7.5-8	SGP-11A 19.5-20 3/21/2007 19.5-20	SGP-11A 39.5-40 3/23/2007 39.5-40	SGP-11B 7.5-8 3/20/2007 7.5-8
<u>Volatile Organic Compounds</u>						
1,1,1-Trichloroethane		980	440	500	500	370
1,1,1,2,2-Tetrachloroethane		<110	<28	<64	<67	<64
1,1,2-Trichloroethane		<87	<28	<64	<67	<64
1,1-Dichloroethane		<65	<28	77	190	15
1,1-Dichloroethene		<63	<28	<64	<67	<64
1,2-Dichloroethane		<65	<28	<64	<67	<64
1,2-Dichloroethene		370	--	--	--	--
1,2-Dichloropropane		<74	<28	<64	<67	<64
1,3-Butadiene		<88	<28	<64	<67	29
2-Butanone (MEK)		<120	<28	<64	<67	16
2-Hexanone		<160	<28	<64	<67	<64
4-Methyl-2-pentanone		<160	<28	<64	<67	<64
Acetone		<950	<280	<640	<670	75
Benzene		<51	<28	<64	<67	15
Bromodichloromethane		<110	<28	<64	<67	<64
Bromoform		<170	<28	<64	<67	<64
Bromomethane		<62	<28	<64	<67	<64
Carbon Disulfide		180	<28	<64	<67	15
Carbon Tetrachloride		<100	<28	<64	<67	<64
Chlorobenzene		<74	<28	<64	<67	<64
Chlorodifluoromethane		<140	--	--	--	--
Chloroethane		<110	<28	<64	<67	<64
Chloroform		<78	<28	<64	<67	15
Chloromethane		<83	<28	<64	<67	<64
cis-1,2-Dichloroethene		370	150	790	2,000	95
cis-1,3-Dichloropropene		<73	<28	<64	<67	<64
Dibromochloromethane		<140	<28	<64	<67	<64
Dichlorodifluoromethane		<200	--	--	--	--
Ethylbenzene		<69	<28	<64	<67	<64
Freon 113		<120	<28	<64	<67	<64
Methylene chloride		<140	<28	<64	<67	<64
Styrene		<68	<28	<64	<67	<64
Tetrachloroethene		<110	70	160	270	69
Toluene		<60	<28	<64	<67	17
trans-1,2-Dichloroethene		<63	<28	<64	68	7.3
trans-1,3-Dichloropropene		<73	<28	<64	<67	<64
Trichloroethene		11,000	5,500	9,800	17,000	2,300
Trichlorotrifluoroethane		<41	<28	<64	<67	6.6
Vinyl Chloride		<69	<64	<67	<64	<61
<i>m,p</i> -Xylenes		<170	<28	<64	<67	<64
<i>o</i> -Xylene		<69	<28	<64	<67	<64
Xylene (total)		<28	--	--	--	--
TVOCs		12,900	6,160	11,327	20,028	3,045

M

Bold Detected compound.
 ug/m3 micrograms per meter cubed
 M matrix interference, noted in case narrative
 -- Not Analyzed; chlorodifluoromethane reported as a tentatively identified compound.
 TVOC Total Volatile Organic Compounds
 ft bls feet below land surface

ARCADIS

Table 2. Concentrations of Volatile Organic Compounds in Soil Gas, Northrop Grumman, Former Settling Ponds (OU3 - Bethpage Community Park), Bethpage, New York

CONSTITUENT (ug/m3)	Site ID: Sample ID: Sample Date: Depth (ft bls):	SGP-11C 7-7.5 3/22/2007 7-7.5	SGP-11D 6.8-7.2 3/23/2007 6.8-7.2	SGP-11D 19.5-20 3/23/2007 19.5-20	SGP-11D 44.5-45 3/22/2007 44.5-45
<u>Volatile Organic Compounds</u>					
1,1,1-Trichloroethane		390	230	320	37
1,1,2,2-Tetrachloroethane		<61	<9.5	<66	<1.2
1,1,2-Trichloroethane		<61	<9.5	<66	<1.2
1,1-Dichloroethane		<61	<9.5	<66	3.3
1,1-Dichloroethene		<61	<9.5	<66	<1.2
1,2-Dichloroethane		<61	<9.5	<66	<1.2
1,2-Dichloroethene		--	--	--	--
1,2-Dichloropropane		<61	<9.5	<66	<1.2
1,3-Butadiene		<61	<9.5	<66	77
2-Butanone (MEK)		<61	<9.5	<66	120
2-Hexanone		<61	<9.5	<66	15
4-Methyl-2-pentanone		<61	<9.5	<66	4.4
Acetone		<610	<95	<660	490
Benzene		<61	<9.5	<66	46
Bromodichloromethane		<61	<9.5	<66	<1.2
Bromoform		<61	<9.5	<66	<1.2
Bromomethane		<61	<9.5	<66	1.5
Carbon Disulfide		<61	<9.5	<66	35
Carbon Tetrachloride		<61	<9.5	<66	1.8
Chlorobenzene		<61	<9.5	<66	2.7
Chlorodifluoromethane		--	--	--	--
Chloroethane		<61	<9.5	<66	<1.2
Chloroform		<61	22	<66	4.2
Chloromethane		<61	<9.5	<66	2
cis-1,2-Dichloroethene		630	30	840	94
cis-1,3-Dichloropropene		<61	<9.5	<66	<1.2
Dibromochloromethane		<61	<9.5	<66	<1.2
Dichlorodifluoromethane		--	--	--	--
Ethylbenzene		<61	<9.5	<66	14
Freon 113		<61	<9.5	<66	2.3
Methylene chloride		<61	<9.5	<66	<1.2
Styrene		<61	<9.5	<66	3.2
Tetrachloroethene		89	23	110	8.1
Toluene		<61	<9.5	<66	65
trans-1,2-Dichloroethene		<61	<9.5	<66	4.3
trans-1,3-Dichloropropene		<61	<9.5	<66	<1.2
Trichloroethene		6,700	1,700	7,600	620
Trichlorotrifluoroethane		<61	<9.5	<66	1.7
Vinyl Chloride		<9.5	<66	<1.2	<1.2
<i>m,p</i> -Xylenes		<61	<9.5	<66	43
<i>o</i> -Xylene		<61	<9.5	<66	19
Xylene (total)		--	--	--	--
TVOCs		7,809	2,005	8,870	1,715

Bold Detected compound.
 ug/m3 micrograms per meter cubed
 M matrix interference, noted in case narrative
 -- Not Analyzed; chlorodifluoromethane reported as a tentatively identified compound.
 TVOC Total Volatile Organic Compounds
 ft bls feet below land surface

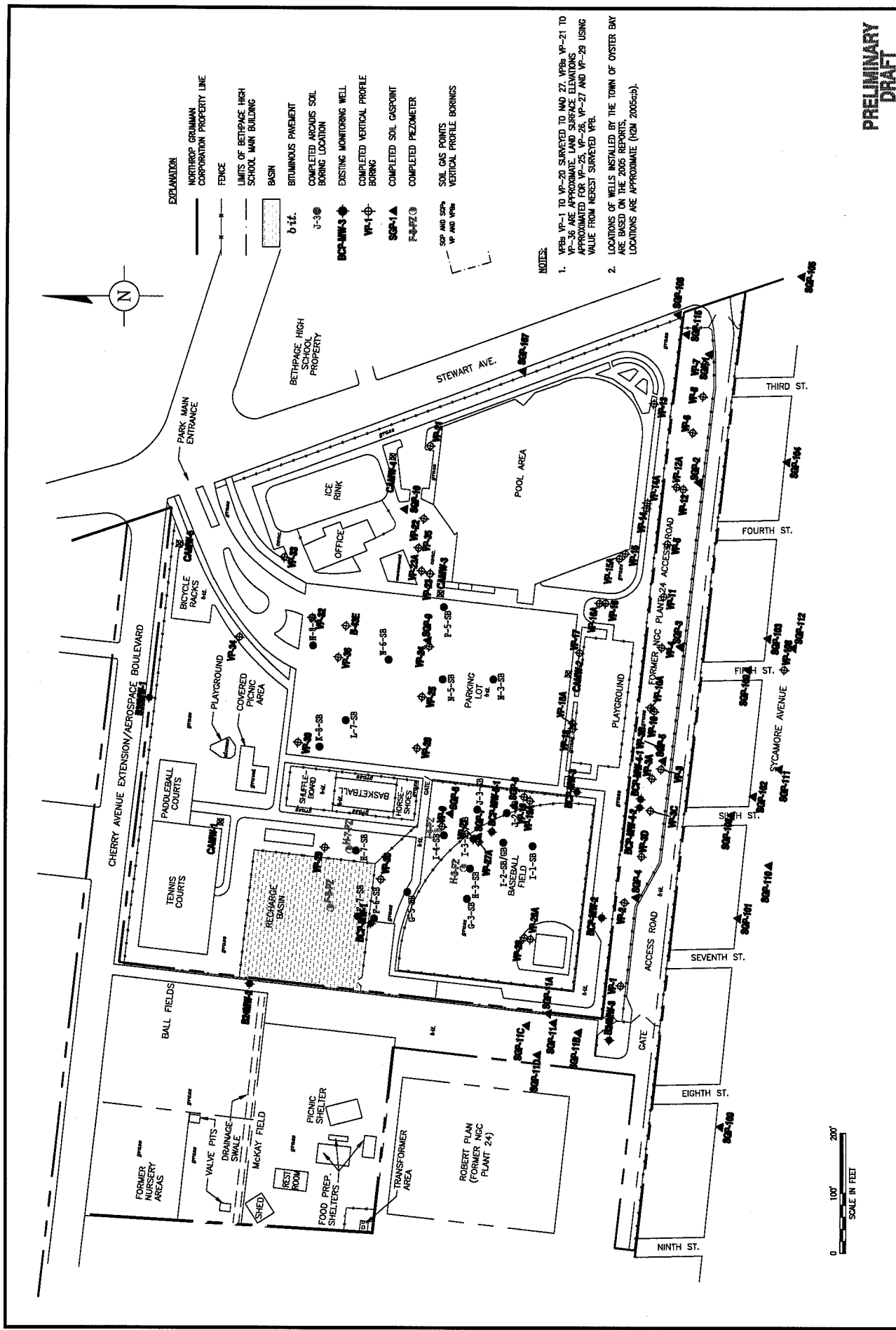

EXPLANATION	SYMBOL
NORTHROP GRUMMAN CORPORATION PROPERTY LINE	---
FENCE	--- ---
LIMITS OF BETHPAGE HIGH SCHOOL MAIN BUILDING	---
BASIN	▭
BRITANNIUM PAVEMENT	▨
COMPLETED ARCADIS SOIL BORING LOCATION	⊕
EXISTING MONITORING WELL	⊕
COMPLETED VERTICAL PROFILE BORING	⊕
COMPLETED SOIL GAS POINT	⊕
COMPLETED PIEZOMETER	⊕
SOIL GAS POINTS	⊕
VERTICAL PROFILE BORINGS	⊕

NOTES:

- VPs VP-1 TO VP-20 SURVEYED TO MD 27. VPs VP-21 TO VP-36 ARE APPROXIMATE LAND SURFACE ELEVATIONS APPROXIMATED FOR VP-25, VP-26, VP-27 AND VP-29 USING VALUE FROM NEAREST SURVEYED VP.
- LOCATIONS OF WELLS INSTALLED BY THE TOWN OF OYSTER BAY ARE BASED ON THE 2005 REPORTS. LOCATIONS ARE APPROXIMATE (H2M 2005c4d).

PRELIMINARY DRAFT

PROJECT TITLE OPERABLE UNIT 3 FORMER GRUMMAN SETTLING PONDS BETHPAGE, NEW YORK	PROJECT MANAGER C. SAN GIOVANNI	DEPARTMENT MANAGER M. WOLPERT	LEAD DESIGN PROF. M. REIDL	CHECKED BY M. REIDL
SHEET TITLE SITE PLAN ON-SITE SAMPLE LOCATIONS	SHEET NUMBER 00004	TASK/PHASE NUMBER 00004	PROJECT NUMBER NY001464.0807	DRAWN BY A. SANCHEZ
SCALE 1"=100'	REVISION DESCRIPTION BY/DO	NO. ISSUED DATE	DRAWING NUMBER 1	PROJECT NUMBER NY001464.0807