



ARCADIS of New York, Inc.
Two Huntington Quadrangle
Suite 1S10
Melville
New York 11747
Tel 631.249.7600
Fax 631.249.7610
www.arcadis-us.com

Mr. Steven M. Scharf, P.E.
Project Engineer
New York State Department of Environmental Conservation
Division of Environmental Remediation
Remedial Action, Bureau A
625 Broadway
Albany, New York 12233-7015

ENVIRONMENT

Subject:
June 2007 Monthly Progress Report,
Northrop Grumman Systems Corporation,
Operable Unit 3,
NYSDEC Site ID # 1-30-003A,
Bethpage, New York.

Date:
July 10, 2007

Contact:
David Stern

Dear Steve:

Phone:
631-391-5284

In accordance with Section III of Administrative Order on Consent (AOC) Index # W1-0018-04-01, this letter reports the activities for Operable Unit 3 (OU3) performed by Northrop Grumman Systems Corporation (Northrop Grumman) during the month of June 2007; activities planned for July 2007 are also discussed. This report is the 15th OU3 monthly progress report since the AOC between Northrop Grumman and the New York State Department of Environmental Conservation (NYSDEC) was signed on June 24, 2005. Table 1 provides validated analytical results from groundwater samples that were analyzed for perchlorate. Figures 1 and 2 show completed on- and off-site sample locations, respectively.

Email:
dstern@arcadis-us.com

Our ref:
NY001464.0907.00003

OU3 Activities Conducted During June 2007

- Prepared and submitted the May 2007 AOC Monthly Progress Report.
- Supported NYSDEC public meeting held June 27, 2007.
- Continued coordination and planning for Phase 3 Remedial Investigation (RI), including:
 - Planning in support of potential implementation of contingency off-site VPBs.

Imagine the result

- Continued coordination and planning for OU3 Interim Remedial Measures (IRMs), including:
 - Continued data analysis/reduction from Soil Gas IRM PCTs.
 - Continued development of 75 percent design for Soil Gas IRM.
 - Continued bid process preparation for Soil Gas IRM.
 - Continued development of scope and quantitative analysis in support of Groundwater IRM.
- Conducted Phase 3 RI and IRM field activities, including:
 - Completed soil gas point drilling and sampling west of Park, per the May 2007 work plan.
 - Continued monthly groundwater/perched water monitoring in piezometers and selected wells.
 - Continued drilling and groundwater sampling of off-site VPBs, per the April 2007 submittal per the Phase 3 RI Work Plan.
 - Initiated and completed western area PCT.
 - Continued drilling, installation, and development of off-site monitoring wells, per the Phase 3 RI Work Plan, as provided to NYSDEC in February 2007.
- Continued RI and IRM data review/evaluation, including:
 - Continued preparation of on-site RI Report.
 - Continued review and validation of analytical results for samples collected.
 - Continued analysis and evaluation (via EVS software and other) of data toward development of a revised conceptual site model (CSM).
 - Continued to review RI data and determine the location of data gaps.
 - Continued groundwater and soil treatability testing toward evaluation of remedial technologies for the Groundwater IRM.
 - Continued data analysis and reduction for Soil Gas IRM PCTs.

- Continued to implement Triad Approach™ to RI decision-making through the continued update of draft tables and figures with latest data.

OU3 Activities Expected During July 2007

- Prepare and submit June 2007 Monthly Progress Report.
- Continue coordination and planning for Phase 3 Remedial Investigation (RI), including:
 - Planning in support of potential implementation of contingency off-site VPBs.
- Continue Phase 3 RI and IRM field activities, including:
 - Conduct measurement of water levels and groundwater sampling of existing on-site monitoring wells and piezometers as part of on-site RI comprehensive sampling event.
 - Continue drilling and groundwater sampling of off-site VPBs, per the April 2007 submittal per the Phase 3 RI Work Plan.
- RI data review/evaluation, as follows:
 - Continue preparation of on-site RI Report.
 - Continue evaluation of data toward possible revisions to the CSM, assessment of data gaps, and support of planning for IRMs.
 - Continue to validate and tabulate analytical data received from laboratory.
 - Continue to implement Triad Approach™ to RI decision-making through the continued update of draft tables and figures with latest data.
- Conduct planning, implementation, and data review/evaluation for on-site IRMs as follows:
 - Continue data analysis/reduction from Soil Gas IRM PCTs.
 - Complete and submit 75 percent design for Soil Gas IRM.
 - Continue bid process preparation for Soil Gas IRM.
 - Continue groundwater and soil treatability testing toward evaluation of remedial technologies for the Groundwater IRM.

ARCADIS

Mr. Steve Scharf
NYSDEC
July 10, 2007

- o Continued development of scope and quantitative analysis in support of Groundwater IRM.

Feel free to call us if you have any questions.

Sincerely,

ARCADIS of New York, Inc.

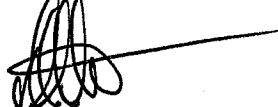

David E. Stern
Senior Scientist/Hydrogeologist



Michael F. Wolfert
Project Director

Copies:

C. San Giovanni, ARCADIS
File, ARCADIS

M. Hofgren, Dvirka & Bartilucci

L. Leskovjan, Northrop Grumman

J. Cofman, Northrop Grumman

Bethpage Public Library – Public Repository

Table 1. Concentrations of Perchlorate in Groundwater, Former Grumman Settling Ponds (OU3 - Bethpage Community Park), Bethpage, New York.

Sample ID	Depth (ft. bls)	Date	Concentration (ug/L)
Monitoring Wells			
B24MW3	--	1/12/2007	<0.58
B30-MW-1	--	4/14/2006	1.8
BCP-MW-2	--	4/12/2006	0.40 J
BCP-MW-3	--	4/12/2006	2.6
BCPMW4-1	--	1/12/2007	0.64 J
BCPMW4-2	--	1/11/2007	0.47
BCPMW5-1	--	1/10/2007	0.71
CAMW-1	--	4/14/2006	0.40 J
CAMW-2	--	4/12/2006	0.37 J
CAMW-3	--	4/12/2006	0.90 J
CAMW-4	--	4/12/2006	3
CAMW-5	--	4/14/2006	0.75 J
HN-40I	--	4/13/2006	1.6
HN-40S	--	4/13/2006	2
HN-42I	--	4/13/2006	2.6
HN-42S	--	4/13/2006	3.1
Piezometers			
H-3-PZ	--	1/11/2007	<1.5
H-7-PZ	--	1/11/2007	<2.9
I-4 PZ	--	1/10/2007	<1.5
Vertical Profile Borings			
VP-19A	60-65	5/12/2006	0.6 J
VP-19A	70-75	5/12/2006	1.9
VP-3A	52-57	5/3/2006	1.3
VP-3A	60-65	5/3/2006	0.72 J
VP-3B	53-58	5/5/2006	0.93 J
VP-3B	60-65	5/4/2006	0.87 J
VP-3B	70-75	5/4/2006	<1
VP-3C	54-59	5/2/2006	1.4
VP-3C	60-65	5/2/2006	0.66 J
VP-3C	70-75	5/2/2006	<1
VP-100	46-51	9/15/2006	<10
VP-100	55-60	9/15/2006	<5
VP-100	75-80	9/14/2006	<4
VP-100	105-110	9/14/2006	<4
VP-100	125-130	9/13/2006	<4
VP-100	145-150	9/13/2006	<4
VP-100	160-165	9/12/2006	<4
VP-100	180-185	9/12/2006	<4
VP-100	190-195	9/12/2006	<4
VP-100	200-205	9/11/2006	<4
VP-100	210-215	9/11/2006	<4
VP-100	220-225	9/11/2006	<4
VP-100	230-235	9/8/2006	<4
VP-100	240-245	9/8/2006	<4
VP-100	250-255	9/7/2006	<4

Footnotes on last page.

Table 1. Concentrations of Perchlorate in Groundwater, Former Grumman Settling Ponds (OU3 - Bethpage Community Park), Bethpage, New York.

Sample ID	Depth (ft. bls)	Date	Concentration (ug/L)
Vertical Profile Borings			
VP-100	270-275	9/7/2006	<4
VP-100	290-295	9/6/2006	<4
VP-100	310-315	9/6/2006	<4
VP-100	330-335	9/5/2006	4.3
VP-100	350-355	9/5/2006	<4
VP-100	371-376	9/1/2006	<4
VP-100	394-399	9/1/2006	4.7
VP-101	60	6/27/2006	<10
VP-101	80	6/27/2006	<10
VP-101	100	6/28/2006	<10
VP-101	120	6/28/2006	<10
VP-101	140	6/28/2006	<10
VP-101	167	6/29/2006	<10
VP-101	320	7/6/2006	<10
VP-101	340	7/6/2006	<10
VP-101	360	7/7/2006	11
VP-101	387	7/10/2006	3 J
VP-101	400	7/10/2006	<10
VP-101	420	7/11/2006	6.2
VP-101	440	7/11/2006	<10
VP-101	460	7/11/2006	<10
VP-101	507	7/13/2006	<1
VP-102	45-50	10/13/2006	<5
VP-102	65-70	10/13/2006	0.68 J
VP-102	85-90	10/13/2006	1.2
VP-102	105-110	10/12/2006	0.77 J
VP-102	125-130	10/12/2006	3.3
VP-102	135-140	10/11/2006	1.6
VP-102	150-155	10/11/2006	3.4
VP-102	160-165	10/11/2006	1.5
VP-102	170-175	10/10/2006	1.7
VP-102	180-185	10/10/2006	<1
VP-102	190-195	10/6/2006	<1
VP-102	200-205	10/6/2006	0.67 J
VP-102	220-225	10/5/2006	0.76 J
VP-102	240-245	10/5/2006	0.4 J
VP-102	250-255	10/4/2006	0.46 J
VP-102	260-265	10/4/2006	1.3
VP-102	290-295	10/2/2006	0.65 J
VP-102	300-305	9/29/2006	<1
VP-102	310-315	9/29/2006	<1
VP-102	325-330	9/28/2006	<1
VP-102	345-350	9/28/2006	<1
VP-102	365-370	9/27/2006	0.98 J
VP-102	370-375	10/3/2006	0.59 J
VP-102	380-385	10/3/2006	0.71 J
VP-103	60	10/10/2006	<10
VP-103	80	10/10/2006	<10

Footnotes on last page.

Table 1. Concentrations of Perchlorate in Groundwater, Former Grumman Settling Ponds (OU3 - Bethpage Community Park), Bethpage, New York.

Sample ID	Depth (ft. bls)	Date	Concentration (ug/L)
Vertical Profile Borings			
VP-103	100	10/10/2006	2.2 J
VP-103	120	10/10/2006	<20
VP-103	140	10/11/2006	<10
VP-103	165	10/11/2006	<10
VP-103	185	10/11/2006	0.93 J
VP-103	200	10/12/2006	<20
VP-103	220	10/12/2006	<20
VP-103	240	10/12/2006	<20
VP-103	260	10/12/2006	<2
VP-103	320	10/16/2006	<2
VP-103	345	10/16/2006	<10
VP-103	360	10/17/2006	<1
VP-103	380	10/17/2006	<1
VP-103	420	10/18/2006	<5
VP-103	440	10/18/2006	<5
VP-103	460	10/18/2006	<10
VP-103	480	10/18/2006	<20
VP-103	500	10/19/2006	<20
VP-103	525	10/19/2006	<10
VP-103	545	10/20/2006	6.9
VP-103	560	10/20/2006	<10
VP-103	580	10/23/2006	<10
VP-103	600	10/23/2006	<10
VP-103	620	10/23/2006	<5
VP-103	640	10/24/2006	3.7 J
VP-103	660	10/24/2006	6 J
VP-104	60	7/28/2006	<4.0
VP-104	80	7/28/2006	<4.0
VP-104	100	7/31/2006	<4.0
VP-104	120	7/31/2006	<4.0
VP-104	140	7/31/2006	<4.0
VP-104	160	7/31/2006	<4.0
VP-104	180	8/1/2006	<4.0
VP-104	200	8/1/2006	<4.0
VP-104	220	8/1/2006	<4.0
VP-104	240	8/1/2006	<4.0
VP-104	260	8/2/2006	<4.0
VP-104	280	8/2/2006	<4.0
VP-104	300	8/2/2006	<4.0
VP-104	320	8/3/2006	<4.0
VP-104	340	8/3/2006	<4.0
VP-104	360	8/3/2006	<4.0
VP-104	380	8/7/2006	<4.0
VP-104	400	8/7/2006	<4.0
VP-104	420	8/7/2006	<4.0
VP-104	460	8/8/2006	<4.0
VP-104	480	8/8/2006	<4.0

Footnotes on last page.

Table 1. Concentrations of Perchlorate in Groundwater, Former Grumman Settling Ponds (OU3 - Bethpage Community Park), Bethpage, New York.

Sample ID	Depth (ft. bls)	Date	Concentration (ug/L)
Vertical Profile Borings			
VP-104	500	8/8/2006	<4.0
VP-104	520	8/14/2006	<4.0
VP-104	540	8/14/2006	<4.0
VP-104	560	8/14/2006	<4.0
VP-104	740	8/22/2006	<4.0
VP-104	820	8/24/2006	<4
VP-104	840	8/24/2006	<4
VP-104	860	8/25/2006	<4
VP-104	880	8/25/2006	<4
VP-105	45-50	8/2/2006	<4.0
VP-105	55-60	8/2/2006	<4.0
VP-105	65-70	8/2/2006	<4.0
VP-105	75-80	8/2/2006	<4.0
VP-105	85-90	8/1/2006	<4.0
VP-105	95-100	8/1/2006	<4.0
VP-105	102-107	8/1/2006	<4.0
VP-105	115-120	7/31/2006	<4.0
VP-105	125-130	7/31/2006	<4.0
VP-105	135-140	7/31/2006	<4.0
VP-105	145-150	7/28/2006	<4.0
VP-105	155-160	7/28/2006	<4.0
VP-105	165-170	7/28/2006	<4.0
VP-107	45-50	7/25/2006	<4.0
VP-107	55-60	7/25/2006	<4.0
VP-107	65-70	7/25/2006	<4.0
VP-107	75-80	7/25/2006	<4.0
VP-107	85-90	7/25/2006	<4.0
VP-107	95-100	7/21/2006	<4.0
VP-107	105-110	7/21/2006	<4.0
VP-107	119-124	7/21/2006	<4.0
VP-107	135-140	7/20/2006	<4.0
VP-107	148-153	7/20/2006	<4.0
VP-107	165-170	7/20/2006	<4.0
VP-108	45-50	7/13/2006	<1
VP-108	55-60	7/13/2006	1.6
VP-108	65-70	7/13/2006	1.7
VP-108	75-80	7/13/2006	1.2
VP-108	85-90	7/13/2006	1.2
VP-108	95-100	7/13/2006	1.2
VP-108	105-110	7/13/2006	1.3
VP-108	115-120	7/13/2006	1.4
VP-108	125-130	7/13/2006	1.6
VP-108	135-140	7/13/2006	1.3
VP-108	145-150	7/13/2006	1.3
VP-109	44-49	2/5/2007	9.4
VP-109	55-60	2/5/2007	0.79 J
VP-109	65-70	2/5/2007	1

Footnotes on last page.

Table 1. Concentrations of Perchlorate in Groundwater, Former Grumman Settling Ponds (OU3 - Bethpage Community Park), Bethpage, New York.

Sample ID	Depth (ft. bls)	Date	Concentration (ug/L)
Vertical Profile Borings			
VP-109	75-80	2/5/2007	1.1
VP-109	85-90	2/2/2007	1.1
VP-109	95-100	2/2/2007	0.43 J
VP-109	105-110	2/2/2007	0.84 J
VP-109	115-120	2/1/2007	0.4 J
VP-109	125-130	2/1/2007	<1
VP-109	135-140	1/31/2007	0.68 J
VP-109	145-150	1/31/2007	0.36 J
VP-109	155-160	1/31/2007	0.5 J
VP-109	165-170	1/30/2007	0.77 J
VP-109	175-180	1/30/2007	0.51 J
VP-109	185-190	1/30/2007	0.62 J
VP-109	195-200	1/29/2007	0.85 J
VP-109	205-210	1/29/2007	0.38 J
VP-109	215-220	1/26/2007	<1
VP-109	225-230	1/25/2007	<1
VP-109	235-240	1/25/2007	<1
VP-109	247-252	1/24/2007	0.57 J
VP-109	255-260	1/24/2007	0.73 J
VP-109	265-270	1/23/2007	<2
VP-109	275-280	1/23/2007	<2
VP-109	288-293	1/22/2007	<1
VP-110	40-45	2/22/2007	<1
VP-110	50-55	2/22/2007	<1
VP-110	60-65	2/21/2007	<1
VP-110	70-75	2/21/2007	<1
VP-110	80-85	2/21/2007	<1
VP-110	90-95	2/21/2007	<1
VP-110	100-105	2/21/2007	<1
VP-110	110-115	2/20/2007	0.69 J
VP-110	120-125	2/20/2007	0.95 J
VP-110	140-145	2/20/2007	0.59 J
VP-110	150-155	2/20/2007	1.3
VP-110	160-165	2/20/2007	1.2
VP-110	170-175	2/16/2007	1.4
VP-110	180-185	2/16/2007	0.78 J
VP-110	190-195	2/16/2007	0.71 J
VP-110	200-205	2/13/2007	0.91 J
VP-110	210-215	2/13/2007	1
VP-110	220-225	2/13/2007	1
VP-110	230-235	2/9/2007	1.6
VP-110	240-245	2/9/2007	1.9
VP-110	250-255	2/7/2007	2.5
VP-110	260-265	2/7/2007	2.2
VP-110	270-275	2/7/2007	1.7
VP-110	283-288	2/6/2007	1.4
VP-110	295-300	2/6/2007	0.97 J

Footnotes on last page.

Table 1. Concentrations of Perchlorate in Groundwater, Former Grumman Settling Ponds (OU3 - Bethpage Community Park), Bethpage, New York.

Sample ID	Depth (ft. bls)	Date	Concentration (ug/L)
Vertical Profile Borings			
VP-110	315-320	2/6/2007	1.6
VP-110	325-330	2/5/2007	1.3
VP-110	333-338	2/5/2007	3.9
VP-110	344-349	2/1/2007	3
VP-110	352-357	2/1/2007	1.6
VP-110	362-367	1/31/2007	2.9
VP-110	372-377	1/31/2007	1.3
VP-110	382-387	1/30/2007	1.4
VP-111	51	4/17/2007	0.84
VP-111	71	4/17/2007	1.7
VP-111	91	4/17/2007	1.1
VP-111	111	4/17/2007	1.3
VP-111	131	4/18/2007	2.1
VP-111	151	4/18/2007	2
VP-111	171	4/18/2007	1.9
VP-111	191	4/19/2007	1.9
VP-111	211	4/19/2007	1.4
VP-111	231	4/19/2007	1.5
VP-111	251	4/19/2007	1.1
VP-111	271	4/20/2007	1.1
VP-111	291	4/20/2007	0.9
VP-111	311	4/20/2007	2
VP-111	331	4/20/2007	2.4
VP-111	351	4/23/2007	2.4
VP-111	371	4/23/2007	2.6
VP-111	391	4/24/2007	1.8
VP-111	411	4/24/2007	2.2
VP-111	431	4/24/2007	3.6
VP-111	451	4/24/2007	1.8
VP-111	471	4/25/2007	1.4
VP-111	491	4/25/2007	4.1
VP-111	511	4/25/2007	4.8
VP-111	571	4/27/2007	4.1
VP-111	591	4/27/2007	2.6
VP-111	616	4/30/2007	2
VP-111	631	5/1/2007	< 0.20
VP-112	60	5/23/2007	0.48
VP-112	80	5/23/2007	3
VP-112	100	5/23/2007	0.93
VP-112	120	5/24/2007	3.7
VP-112	140	5/24/2007	0.86
VP-112	165	5/24/2007	1.1
VP-112	185	5/30/2007	1.2
VP-112	200	5/30/2007	2.6
VP-112	220	5/31/2007	3.4
VP-112	240	5/31/2007	3.5
VP-112	260	5/31/2007	3.3
VP-112	280	5/31/2007	0.93

Footnotes on last page.

Table 1. Concentrations of Perchlorate in Groundwater, Former Grumman Settling Ponds (OU3 - Bethpage Community Park), Bethpage, New York.

Sample ID	Depth (ft. bls)	Date	Concentration (ug/L)
Vertical Profile Borings			
VP-112	300	6/1/2007	0.75
VP-112	320	6/1/2007	0.73
VP-112	340	6/1/2007	0.78
VP-112	360	6/4/2007	0.98
VP-112	380	6/4/2007	0.74
VP-112	410	6/5/2007	0.76
VP-112	420	6/6/2007	0.91
VP-112	440	6/6/2007	0.78
VP-112	470	6/7/2007	1.7
VP-112	480	6/7/2007	1.2
VP-112	500	6/7/2007	1.5
VP-112	520	6/7/2007	1.9
VP-112	545	6/8/2007	3.8
VP-112	560	6/8/2007	3
VP-112	580	6/8/2007	5.3
VP-112	600	6/11/2007	5.2
VP-112	620	6/13/2007	1.9
VP-112	660	6/14/2007	0.9
VP-112	680	6/14/2007	0.2
VP-112	700	6/14/2007	< 0.20

Notes:

1. Results validated following protocols specified in March 2006 RI/FS Work Plan (ARCADIS G&M, Inc. 2006).
2. Samples analyzed for perchlorate using USEPA Method 314.0

Bold value indicates detection.

ug/l Microgram per Liter
 J Estimated Value
 ft. bls feet below land surface

Acad Version : R17.0a (LMS Tech) Data\Time : Mon, 07 May 2007 - 2:48pm User Name : alsanchez
 Path Name : C:\PROJECT\Northrop_Grumman\Cada\03\2007\PLAN_VIEW\ON-SITE_Locations.dwg
 Current Plot Style : BkColor Layout Tab: ON-SITE

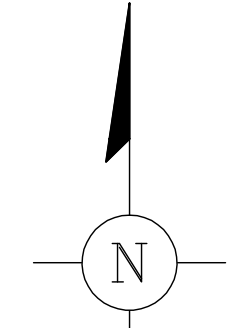
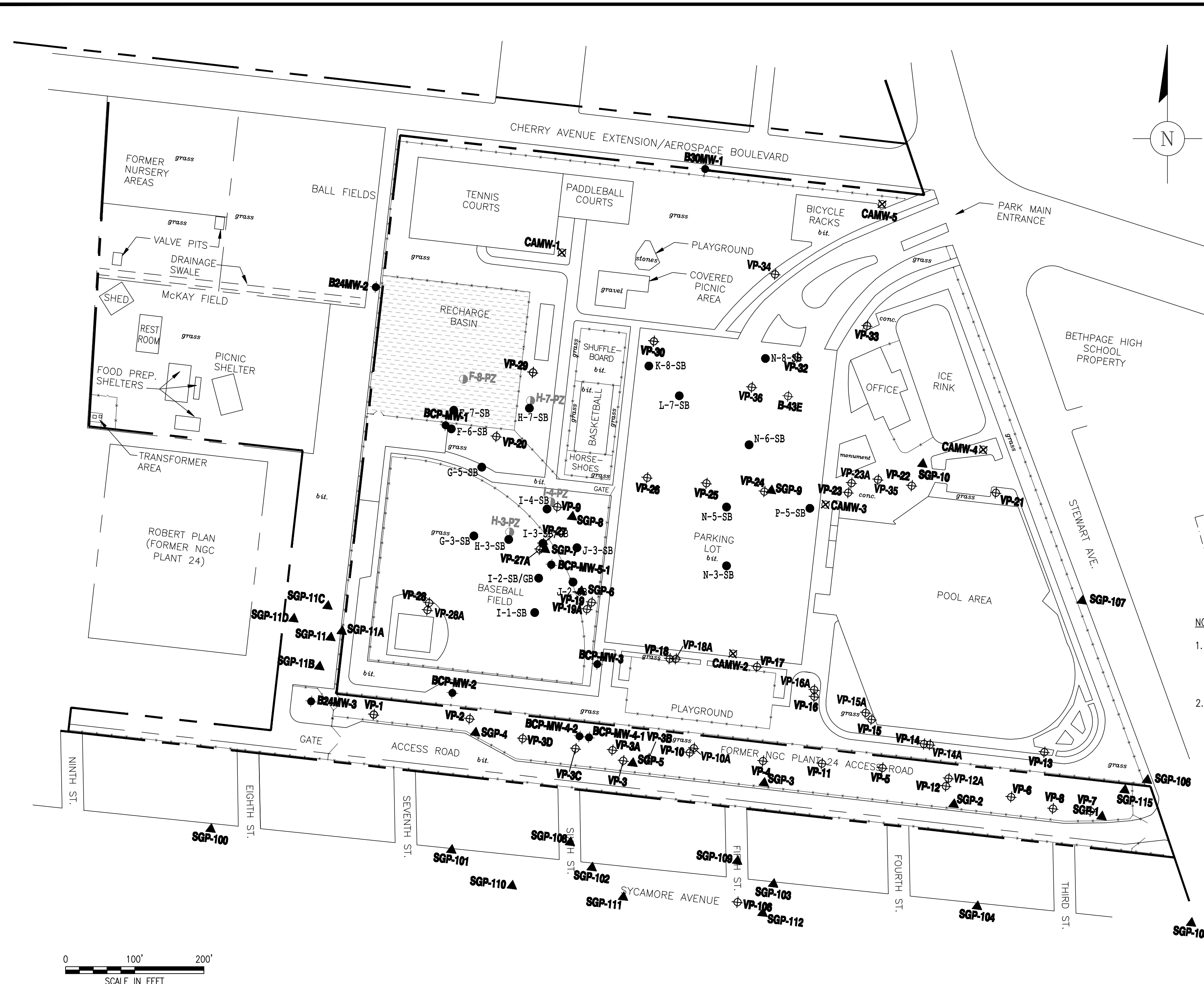

- EXPLANATION**
- NORTHROP GRUMMAN CORPORATION PROPERTY LINE
 - - - FENCE
 - - - LIMITS OF BETHPAGE HIGH SCHOOL MAIN BUILDING
 - ▭ BASIN
 - bit. BITUMINOUS PAVEMENT
 - J-3 ● COMPLETED ARCADIS SOIL BORING LOCATION
 - BCP-MW-3 EXISTING MONITORING WELL
 - ⊕ VP-1 COMPLETED VERTICAL PROFILE BORING
 - ▲ SGP-1 COMPLETED SOIL GASPOINT
 - F-8-PZ COMPLETED PIEZOMETER
 - ▽ SGP AND SGPs
 - ◇ VP AND VPs

- NOTES:**
1. VPs VP-1 TO VP-20 SURVEYED TO NAD 27. VPs VP-21 TO VP-36 ARE APPROXIMATE. LAND SURFACE ELEVATIONS APPROXIMATED FOR VP-25, VP-26, VP-27 AND VP-29 USING VALUE FROM NEREST SURVEYED VP.
 2. LOCATIONS OF WELLS INSTALLED BY THE TOWN OF OYSTER BAY ARE BASED ON THE 2005 REPORTS, LOCATIONS ARE APPROXIMATE (H2M 2005a;b).

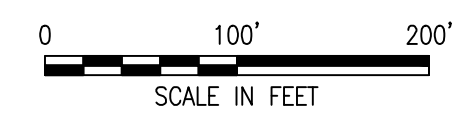

PRELIMINARY DRAFT

NO.	ISSUED DATE	REVISION DESCRIPTION	BY/CKD

SEAL

ARCADIS

Two Huntington Quadrangle
 Suite 1S10
 Melville, NY 11747
 Tel: 631-249-7600 Fax: 631-249-7610
 www.arcadis-us.com

PROJECT TITLE

OPERABLE UNIT 3
 FORMER GRUMMAN
 SETTLING PONDS
 BETHPAGE, NEW YORK

PROJECT MANAGER
C. SAN GIOVANNI

SHEET TITLE

DEPARTMENT MANAGER
M. WOLFERT

SITE PLAN
 ON-SITE SAMPLE LOCATIONS

LEAD DESIGN PROF.

TASK/PHASE NUMBER
00004

PROJECT NUMBER
NY001464.0807

CHECKED BY
M. REINDL

DRAWN BY
A. SANCHEZ

DRAWING NUMBER
1

Acad Version : R17.0s (LMS TBase)\Time : Mon, 09 Jul 2007 10:50:55pm
 User Name : dsanchez Path Name : G:\APROJECT\Northrop Grumman\Cadd\OU3\2007\OFF-SITE\Completed Loca..._Off-Site.dwg
 Current Plotstyle : BxCColor Layout Tab: OU3

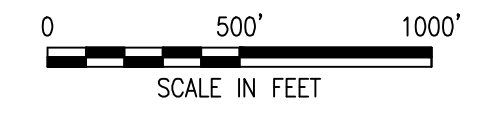
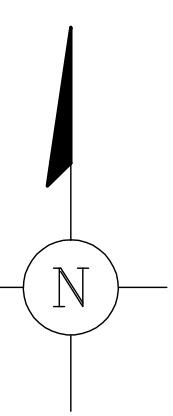
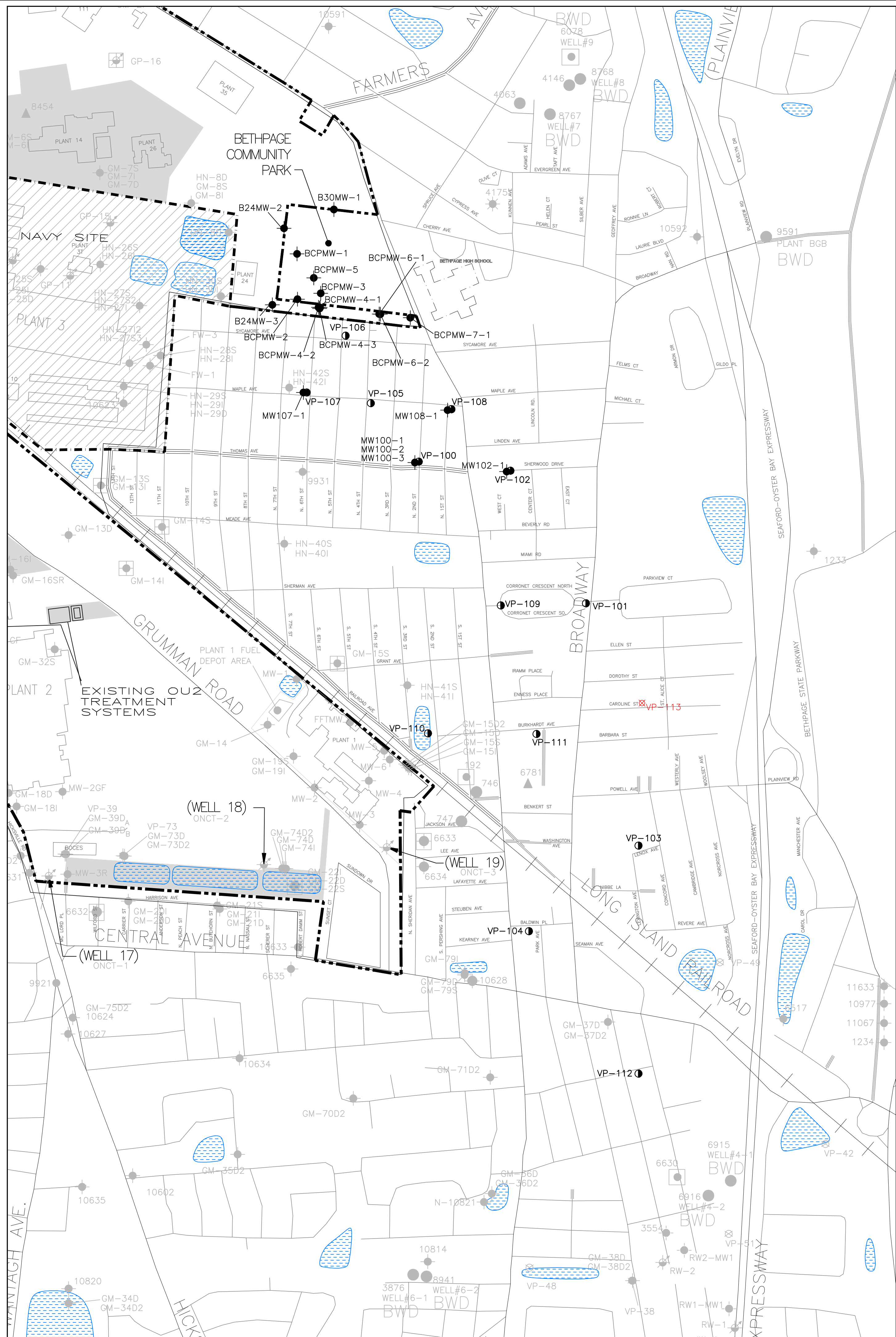

EXPLANATION

- PROPERTY BOUNDARY OF THE FORMER GRUMMAN AEROSPACE SITE
- PROPERTY BOUNDARY OF U.S. NAVY SITE
- ++++ LONG ISLAND RAILROAD
- DENOTES NORTHROP GRUMMAN OWNED PROPERTY
- ▨ DENOTES U.S. NAVY OWNED PROPERTY (AS OF 2003)
- RECHARGE BASIN
- - - LIMITS OF BETHPAGE HIGH SCHOOL MAIN BUILDING
- 10592 ● OBSERVATION, MONITORING WELL (GRAY - SHOWN FOR REFERENCE) (BLACK - PROPOSED TO BE SAMPLED IN PHASE 2 RI)
- 6781 ▲ INDUSTRIAL WELL
- 9591 ● PUBLIC SUPPLY WELL
- 4175 ● IRRIGATION WELL
- WELL-12 ● NORTHROP GRUMMAN OR NAVY PRODUCTION WELL
- GP-11 ■ ABANDONED PRODUCTION WELL
- VP-49 ● COMPLETED OU2 VERTICAL PROFILE BORING
- VP-100 ● COMPLETED OU3 VERTICAL PROFILE BORING
- VP-111 ● PROPOSED OU3 VERTICAL PROFILE BORING
- VP-113 ● PROPOSED OU3 CONTINGENCY VERTICAL PROFILE BORING
- BCPMW-2 ● COMPLETED MONITORING WELLS
- MW100-1 ● PROPOSED MONITORING WELLS
- BWD BETHPAGE WATER DISTRICT
- VPB VERTICAL PROFILE BORING
- RI REMEDIAL INVESTIGATION
- OU2 OPERABLE UNIT 2
- OU3 OPERABLE UNIT 3

GENERAL NOTES:

1. THIS FIGURE INCLUDES LOCATIONS OF PUBLIC SUPPLY WELLS BASED ON INFORMATION RECEIVED BY ARCADIS IN RESPONSE TO A SEPTEMBER 2001 LETTER TO WATER DISTRICTS.
2. BASIN LOCATIONS OBTAINED FROM USGS TOPOGRAPHIC MAPS (HUNTINGTON, HICKSVILLE, FREEPORT AND AMITYVILLE QUADRANGLES) AND INFORMATION PROVIDED BY NORTHROP GRUMMAN.
3. NORTHROP GRUMMAN PROPERTY HOLDINGS BASED ON DATA PROVIDED IN JUNE 2003.
4. LOCATIONS OF MONITORING WELLS INSTALLED BY DVIKA & BARTILUCCI (D&B) AT PLANT 1 (i.e., MW-1 TO MW-6) ARE APPROXIMATE BASED ON D&B SITE PLAN, PROVIDED ON DECEMBER 19, 2002.
5. LOCATIONS OF MONITORING WELLS INSTALLED BY DVIKA & BARTILUCCI (D&B) AT BETHPAGE COMMUNITY PARK ARE APPROXIMATE BASED ON DATA PROVIDED BY D&B SITE PLAN, DATED DECEMBER 2003.

NO.	ISSUED DATE	REVISION DESCRIPTION	BY/COD
1	05-31-07	NYSDEC MGT.	MR
0	04-09-07	PHASE 3 VP LOCATIONS	MR

KEYPLAN

PROJECT TITLE

**OPERABLE UNIT 3
NORTHROP GRUMMAN
SYSTEMS CORPORATION
BETHPAGE, NEW YORK**

SHEET TITLE

**SITE PLAN
SHOWING OFF-SITE
MONITORING WELLS AND
VERTICAL PROFILE BORINGS**

ARCADIS
OF NEW YORK, INC.

Two Huntington Quadrangle
 Suite 1810
 Melville, NY 11747
 Tel: 631-248-7600 Fax: 631-248-7610
 www.arcadis-us.com

PROJECT MANAGER C. SAN GIOVANNI	DEPARTMENT MANAGER M. WOLFERT
LEAD DESIGN PROF.	CHECKED BY M. REINDL
TASK/PHASE NUMBER 00004	DRAWN BY A. SANCHEZ
PROJECT NUMBER NY001464.0807	DRAWING NUMBER 2

ALL COORDINATES REFERENCED TO
NORTH AMERICAN DATUM 1929