

Table 1. Summary of Completed Oxidant Demand Treatability Study Sample Collection Program, Former Grumman Settling Ponds (Operable Unit 3 - Bethpage Community Park), Bethpage, New York. ⁽¹⁾

| Location ID | Total Depth (ft bls) | Sample Interval ⁽²⁾ (ft bls) | <u>Media Tested</u> | |
|---|----------------------|---|---------------------|----------------------------|
| | | | Soil ⁽³⁾ | Groundwater ⁽³⁾ |
| <u>Soil Borings</u> | | | | |
| VP-1ST | 69 | 65 - 67 67 - 69 | • • | -- -- |
| VP-3ST | 70 | 68 - 70 | • | -- |
| VP-5ST | 67 | 65 - 67 | • | -- |
| VP-5ST | 72 | 70 - 72 | • | -- |
| <u>Existing Monitoring Wells</u> | | | | |
| BCPMW4-2 | 88.5 | 68.5 - 83.5 | -- | • |
| BCPMW6-2 | 143 | 133 - 143 | -- | • |

Notes:

- ⁽¹⁾ Samples tested for persulfate (Na₂S₂O₈) and permanganate (KMnO₄) demand.
- ⁽²⁾ Soil sample(s) from individual soil borings composited on-site and at the laboratory.
- ⁽³⁾ Soil and groundwater samples submitted to ARCADIS Treatability Laboratory, located in Durham, North Carolina, for persulfate demand test and Carus Chemical Company for permanganate demand test.

Definitions

- ft bls feet below land surface
- Sample Collected
- Sample Not Collected

Acad Version : R17.0a (LMS Tech) User Name : alsanchez
 Data Time : Mon, 07 May 2007 - 2:48pm
 Path Name : C:\PROJECT\Northrop_Grumman\Cada\03\2007\PLAN_VIEW\ON-SITE_Locations.dwg
 Current Plot Style : ByColor
 Layout Tab: ON-SITE

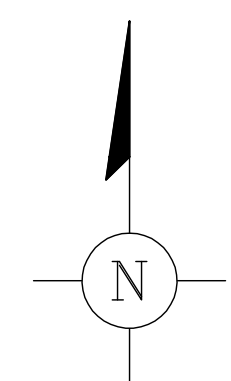
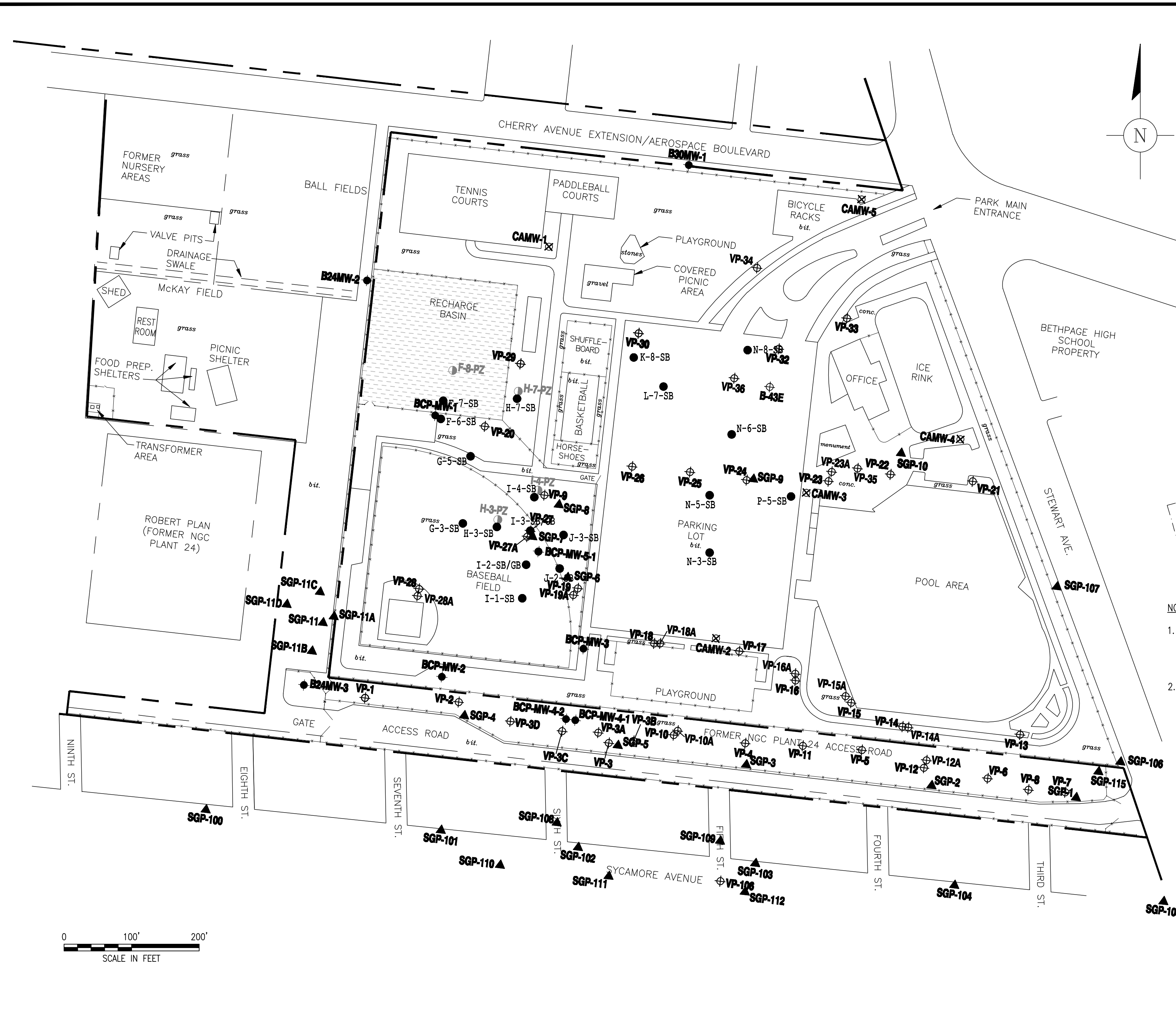

- EXPLANATION**
- NORTHROP GRUMMAN CORPORATION PROPERTY LINE
 - FENCE
 - LIMITS OF BETHPAGE HIGH SCHOOL MAIN BUILDING
 - BASIN
 - bit.* BITUMINOUS PAVEMENT
 - COMPLETED ARCADIS SOIL BORING LOCATION
 - EXISTING MONITORING WELL
 - COMPLETED VERTICAL PROFILE BORING
 - COMPLETED SOIL GASPOINT
 - COMPLETED PIEZOMETER
 - SOIL GAS POINTS
 - VERTICAL PROFILE BORINGS

- NOTES:**
1. VPBs VP-1 TO VP-20 SURVEYED TO NAD 27. VPBs VP-21 TO VP-36 ARE APPROXIMATE. LAND SURFACE ELEVATIONS APPROXIMATED FOR VP-25, VP-26, VP-27 AND VP-29 USING VALUE FROM NEREST SURVEYED VPB.
 2. LOCATIONS OF WELLS INSTALLED BY THE TOWN OF OYSTER BAY ARE BASED ON THE 2005 REPORTS, LOCATIONS ARE APPROXIMATE (H2M 2005a;b).



PRELIMINARY DRAFT

| | | | | | | | | |
|-------------------------------------|-----------------|----------------------|---|--|----------------------------------|---------------------------------|-------------------------|----------------------------|
| © 2007 ARCADIS OF NEW YORK, INC. | | | PROJECT TITLE OPERABLE UNIT 3 FORMER GRUMMAN SETTLING PONDS BETHPAGE, NEW YORK | PROJECT MANAGER C. SAN GIOVANNI | DEPARTMENT MANAGER M. WOLFERT | LEAD DESIGN PROF. | CHECKED BY M. REINDL | |
| | NO. ISSUED DATE | REVISION DESCRIPTION | BY/CKD | SHEET TITLE SITE PLAN ON-SITE SAMPLE LOCATIONS | TASK/PHASE NUMBER 00004 | PROJECT NUMBER NY001464.0807 | DRAWN BY A. SANCHEZ | DRAWING NUMBER 1 |
| | SEAL | | | Two Huntington Quadrangle Suite 1S10 Melville, NY 11747 Tel: 631-249-7600 Fax: 631-249-7610 www.arcadis-us.com | | | | |