



Mr. Steven M. Scharf, P.E.
Project Engineer
New York State Department of Environmental Conservation (NYSDEC)
Division of Environmental Remediation
Remedial Action, Bureau A
625 Broadway
Albany, New York 12233-7015

Subject:
February 2011 Monthly Progress Report
Northrop Grumman Systems Corporation
Operable Unit 3, NYSDEC Site ID # 1-30-003A,
Bethpage, New York

Dear Steve:

In accordance with Section III of Administrative Order on Consent (AOC) Index # W1-0018-04-01, this letter reports Operable Unit 3 (OU3) activities performed by Northrop Grumman Systems Corporation (Northrop Grumman) during the month of February 2011. Activities planned for March 2011 are also described.

OU3 Activities Conducted During February 2011

RI/FS

- Submitted the final Site Area Remedial Investigation (RI) Report to the NYSDEC
- Submitted the final Study Area RI Report to the NYSDEC

Soil Gas IRM

- Continued Operation, Maintenance, and Monitoring (OM&M) of the Soil Gas Interim Remedial Measure (IRM)
- Submitted the Soil Gas IRM Annual OM&M Report to the NYSDEC

ARCADIS of New York, Inc.
Two Huntington Quadrangle
Suite 1S10
Melville
New York 11747
Tel 631.249.7600
Fax 631.249.7610
www.arcadis-us.com

ENVIRONMENT

Date:
March 10, 2011

Contact:
David Stern

Phone:
631-391-5284

Email:
David.Stern@arcadis-us.com

Our ref:
NY001496.0711.RPTA5

Imagine the result

Groundwater IRM

- Continued OM&M of the Groundwater IRM

Other

- Performed the February 2011 monthly monitoring of Monitoring Well MW116-5. Validated analytical data for Monitoring Well MW116-5 from the November and December 2010 sampling events are provided in Table 1. Monitoring Well MW116-5 is shown on Figure 1.
- Submitted the January 2011 AOC Monthly Progress Report to the NYSDEC

OU3 Activities Scheduled During March 2011

R/FS

- Submit the final Site Area Feasibility Study (FS) Report to the NYSDEC
- Submit the final Study Area FS Report to NYSDEC

Soil Gas IRM

- Continue routine OM&M of the Soil Gas IRM

Groundwater IRM

- Continue routine OM&M of the Groundwater IRM
- Submit the Groundwater IRM Annual OM&M Report to the NYSDEC

Other

- Perform the March 2011 monitoring of Monitoring Well MW116-5
- Submit the February 2011 AOC Monthly Progress Report to the NYSDEC



Mr. Steve Scharf
NYSDEC
March 10, 2011

Feel free to call us if you have any questions.

Sincerely,

ARCADIS of New York, Inc.

A handwritten signature in black ink, appearing to read "D. Stern", with a long horizontal line extending to the right.

David E. Stern
Senior Scientist/Associate Project Manager
Enclosures

Copies:

J. Cofman, Northrop Grumman
K. Smith, Northrop Grumman
E. Hannon, Northrop Grumman
C. Stein – USEPA
M. Poetzch – USEPA
C. Henry, EMAGIN
Bethpage Public Library – Public Repository
C. San Giovanni, ARCADIS
M. Wolfert, ARCADIS
File, ARCADIS



Table 1. Concentrations of Volatile Organic Compounds in Groundwater Samples Collected from Monitoring Well MW116-5, Northrop Grumman Systems Corporation, Bethpage, New York.

Location ID:	MW-116-5	MW-116-5
Sample Date:	11/22/2010	12/17/2010
Constituent Name (units in ug/L)		
1,1,1-Trichloroethane	< 50	< 50
1,1,2,2-Tetrachloroethane	< 50	< 50
1,1,2-Trichloroethane	< 50	3.1J
1,1-Dichloroethane	< 50	< 50
1,1-Dichloroethene	4.0J	4.5J
1,2-Dichloroethane	15J	16J
1,2-Dichloropropane	4.3J	3.3J
2-Butanone	< 500	< 500
2-Hexanone	< 500	< 500
4-methyl-2-pentanone	< 500	< 500
Acetone	< 500	< 500
Benzene	< 7.0	< 7.0
Bromodichloromethane	< 50	< 50
Bromoform	< 50	< 50
Bromomethane	< 50	< 50
Carbon Disulfide	< 50	< 50
Carbon Tetrachloride	< 50	< 50
Chlorobenzene	< 50	< 50
Chlorodifluoromethane (Freon 22)	< 50	< 50
Chloroethane	< 50	< 50
Chloroform	28J	31J
Chloromethane	< 50	< 50
cis-1,2-dichloroethene	230	250
cis-1,3-dichloropropene	< 50	< 50
Dibromochloromethane	< 50	< 50
Dichlorodifluoromethane (Freon 12)	< 50	< 50
Ethylbenzene	< 50	< 50
Methyl tert-Butyl Ether	< 50	< 50
Methylene Chloride	< 50	< 50
Styrene	< 50	< 50
Tetrachloroethene	< 50	< 50
Toluene	< 50	< 50
trans-1,2-dichloroethene	4.8J	4.7J
trans-1,3-dichloropropene	< 50	< 50
Trichloroethylene	1800	1800
Trichlorofluoromethane (CFC-11)	< 50	< 50
Trichlorotrifluoroethane (Freon 113)	< 50	< 50
Vinyl Chloride	< 20	< 20
Xylene-o	< 50	< 50
Xylenes - m,p	< 50	< 50
TVOCs	2100	2100

Notes and Abbreviations on last page.



Table 1. Concentrations of Volatile Organic Compounds in Groundwater Samples Collected from Monitoring Well MW116-5, Northrop Grumman Systems Corporation, Bethpage, New York.

Notes and Abbreviations:

Results validated following protocols specified in March 2006 RI/FS Work Plan (ARCADIS G&M, Inc. 2006).

Samples analyzed for the TCL VOCs using NYSDEC ASP Method 2000 OLM4.2.

TVOCs are rounded to two significant figures.

Bold value indicates a detection.

RI/FS	Remedial Investigation/Feasibility Study
NYSDEC	New York State Department of Environmental Conservation
TCL	Target compound list
VOC	Volatile Organic Compound
TVOC	Total Volatile Organic Compounds
ASP	Analytical services protocol
ug/L	Micrograms per liter
B	Compound detected in associated blank sample
J	Value is estimated
R	Value is rejected
D	Value from a secondary dilution

XREFS: IMAGES: PROJECTNAME: NY001493.0809.00008
 offsite

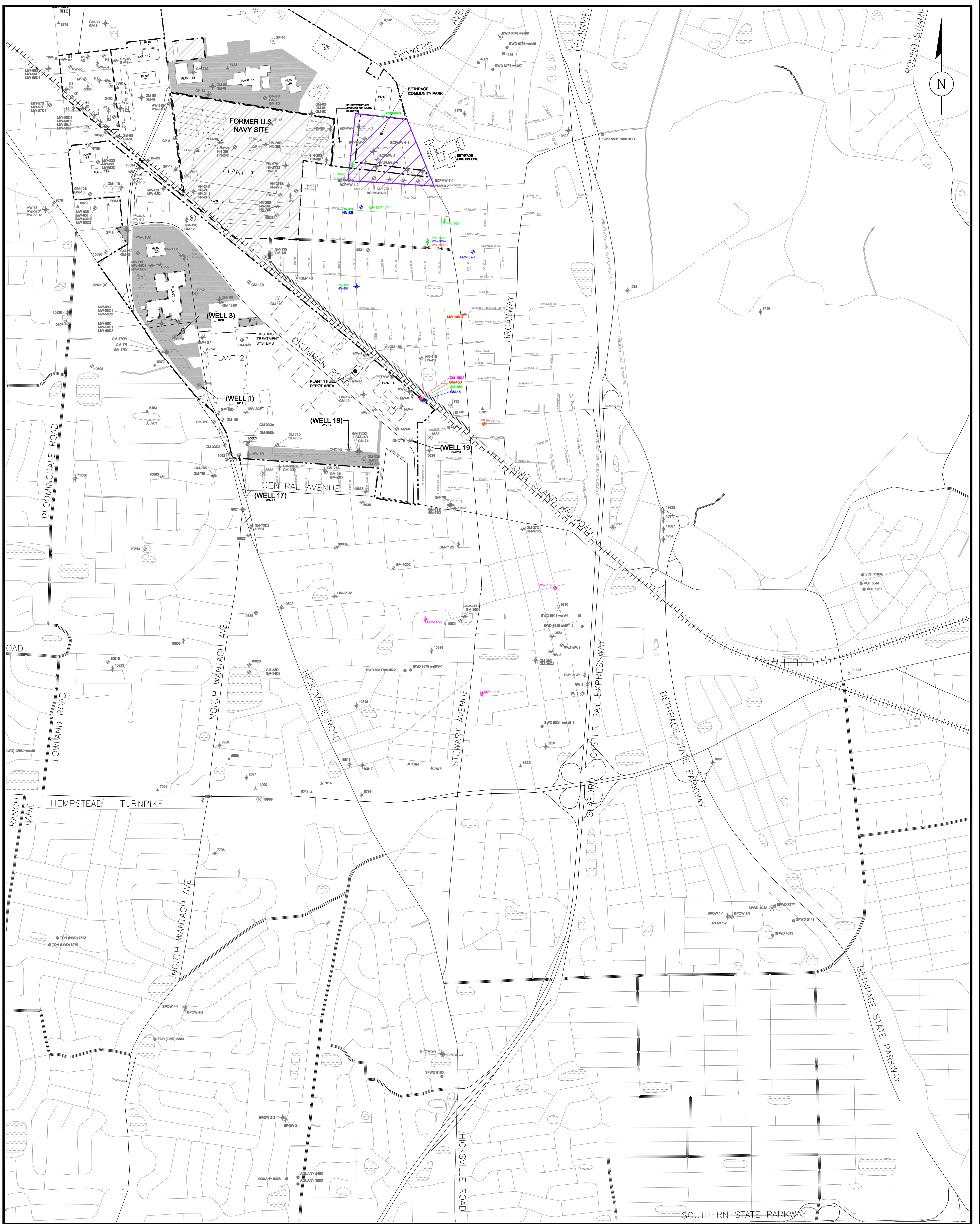

EXPLANATION:

- | | | | |
|-------|--|---|--|
| ----- | PROPERTY BOUNDARY OF THE FORMER GRUMMAN AEROSPACE PROPERTY | + | OBSERVATION, MONITORING WELL |
| ----- | PROPERTY BOUNDARY OF THE FORMER U.S. NAVY PROPERTY | ▲ | INDUSTRIAL WELL |
| ----- | PROPERTY BOUNDARY OF THE FORMER OCC PROPERTY | ● | PUBLIC SUPPLY WELL |
| +++++ | LONG ISLAND RAILROAD | * | IRRIGATION WELL |
| ■ | DENOTES NORTHROP GRUMMAN OWNED PROPERTY | * | INJECTION WELL |
| ▨ | DENOTES FORMER U.S. NAVY OWNED PROPERTY | ⚡ | NORTHROP GRUMMAN OR NAVY PRODUCTION WELL |
| ▨ | RECHARGE BASIN | ⊗ | ABANDONED WELL |
| ▨ | SITE AREA | | |

DESIGNATION OF HYDROGEOLOGIC ZONE FOR MONITORING WELL SCREENED INTERVALS (ARCADIS 2003)

- SHALLOW
- INTERMEDIATE
- DEEP
- DEEP2

NOTES:

- HYDROGEOLOGIC ZONE BASED ON MODEL LAYER ELEVATIONS PRESENTED IN COMPREHENSIVE GROUNDWATER MODEL (ARCADIS 2003).

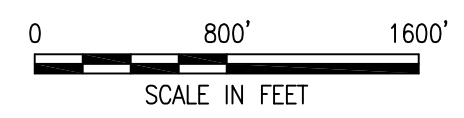

NORTHROP GRUMMAN SYSTEMS CORPORATION
 OPERABLE UNIT 3
 (FORMER GRUMMAN SETTLING PONDS)
 BETHPAGE, NEW YORK

STUDY AREA SHOWING
 MONITORING WELL LOCATIONS



FIGURE

1

ALL COORDINATES REFERENCED TO NORTH AMERICAN DATUM 1983