



Technical Memorandum

150 BOUSH STREET, SUITE 701 · NORFOLK, VIRGINIA 23510 · [MAIN] 757-640-6956 · [FAX] 225-952-3058

TO: Brian Murray, P.G., P.M.P.

FROM: Monica L. Smeal, P.E.

DATE: April 21, 2020

RE: NWIRP Bethpage Site 1 Documentation Samples

CC:

Melvin Acree – NAVFAC

Chris Shukis, P.E. – NAVFAC

Leo Tancreti – NAVFAC

William L. Deane, Jr., P.E. – APTIM

Timothy Collins – APTIM

The selected remedy for NWIRP Bethpage Site 1 as outlined in the Operable Unit 4 Record of Decision (Navy, 2018) includes excavation and either on-site reuse or off-site disposal of polychlorinated biphenyl (PCB)-contaminated soils and installation of a reduced permeability cover.

Based on historical investigative in-situ soil sampling, soils are present at concentrations up to 58 parts per million (ppm) in soil along the eastern boundary of the site (Tetra Tech, 2015). The Site 1 excavation boundaries extend to the curb of 11th Street, and there is a potential for PCB-contaminated soil to remain near the site boundary.

This technical memorandum is intended to detail the procedure for documenting the levels of contamination of soils that fall at the boundary of the current delineated excavation boundaries along 11th Street.

1.0 Current Excavation Boundaries

The current Site 1 excavation boundaries at all designed depths are detailed on Drawing C-108 of the Final Remedial Design (Tetra Tech, 2019). PCB-contaminated soil will be excavated to a depth of two feet below ground surface (bgs) up to the curb of 11th Street. An additional area, approximately 244 square feet, will be excavated to a depth of ten feet bgs. The eastern corner of this excavation is in the northern portion of Site 1 approximately 10 feet east of 11th Street.

2.0 Proposed Sidewall Samples

As depicted in Figure 4-3 of the 2015 Remedial Investigation (RI) addendum (Tetra Tech, 2015), PCBs are present up to 58 ppm along the eastern boundary of the site. Based on this initial site sampling and lack of confirmation samples, New York State Department of Environmental Conservation (NYSDEC) has requested that soil samples be collected to assess excavation limits and confirm the quality of soil left in place (Draft Final RAWP Review – NYSDEC, included in Appendix F of the Final RAWP [APTIM, 2019a]).

To document the quality of soil left in place post-excavation of the design limits, sidewall samples will be collected along the eastern perimeter of Site 1. APTIM will collect discrete grab documentation samples along

the eastern perimeter of the zero- to two-foot excavation area at the approximate RI Addendum soil boring locations listed in the table below (Tetra Tech, 2015). Additionally, APTIM will collect two documentation samples from the eastern sidewalls of the two- to ten-foot excavation area at the location of soil boring BPS1-SB3031 at a depth of five feet bgs. Sample locations are shown on Figure 1.

Soil samples will be analyzed for PCBs utilizing method SW-846 3550C/8082A according to the approved Sampling and Analysis Plan (APTIM, 2019b). Field quality control samples will be collected in accordance with the approved Sampling and Analysis Plan (APTIM, 2019b) and are listed in the table below.

Documentation Sample Locations

Excavation Area	2015 RI Addendum Soil Boring Locations	APTIM Sample ID	Sample Depth (ft bgs)
0-2 ft bgs	BPS1-SB3047	NWIRP-S1-DOC-001	0-2
	BPS1-SB3031	NWIRP-S1-DOC-002 NWIRP-S1-DOC-003 ¹	0-2
	BPS1-SB3051	NWIRP-S1-DOC-004	0-2
	BPS1-SB3032	NWIRP-S1-DOC-005	0-2
	BPS1-SB3033	NWIRP-S1-DOC-006	0-2
	BPS1-SB3034	NWIRP-S1-DOC-007	0-2
	BPS1-SB3035	NWIRP-S1-DOC-008	0-2
	BPS1-SB3036	NWIRP-S1-DOC-009 NWIRP-S1-DOC-010 ¹	0-2
2-10 ft bgs	BPS1-SB3031	NWIRP-S1-DOC-011	5
		NWIRP-S1-DOC-012 ²	5

¹Field Duplicate Sample

²Marix Spike/Matrix Spike Duplicate Sample – Triple Volume

3.0 List of Figures

Figure 1 Proposed Documentation Sample Locations – 11th Street

4.0 References

APTIM. 2019a. Final Remedial Action Work Plan, Site 1 – Former Drum Marshalling Area Remedial Action for Contaminated Soil, Naval Weapons Industrial Reserve Plant, Bethpage, New York.

APTIM. 2019b. Final Sampling and Analysis Plan/Quality Assurance Plan, Site 1 – Former Drum Marshalling Area Remedial Action for Contaminated Soil, Naval Weapons Industrial Reserve Plant, Bethpage, New York.

Navy. 2018. Record of Decision Operable Unit 4 Naval Weapons Industrial Reserve Plant, Bethpage, New York.

Tetra Tech, Inc. 2015. RI Addendum Soil, Groundwater, and Soil Vapor, Site 1 Former Drum Marshalling Area, NWIRP Bethpage, New York.

Tetra Tech, Inc. 2019. Final Remedial Design for Site 1 – Former Drum Marshalling Area, Naval Weapons Industrial Reserve Plant, Bethpage, New York.

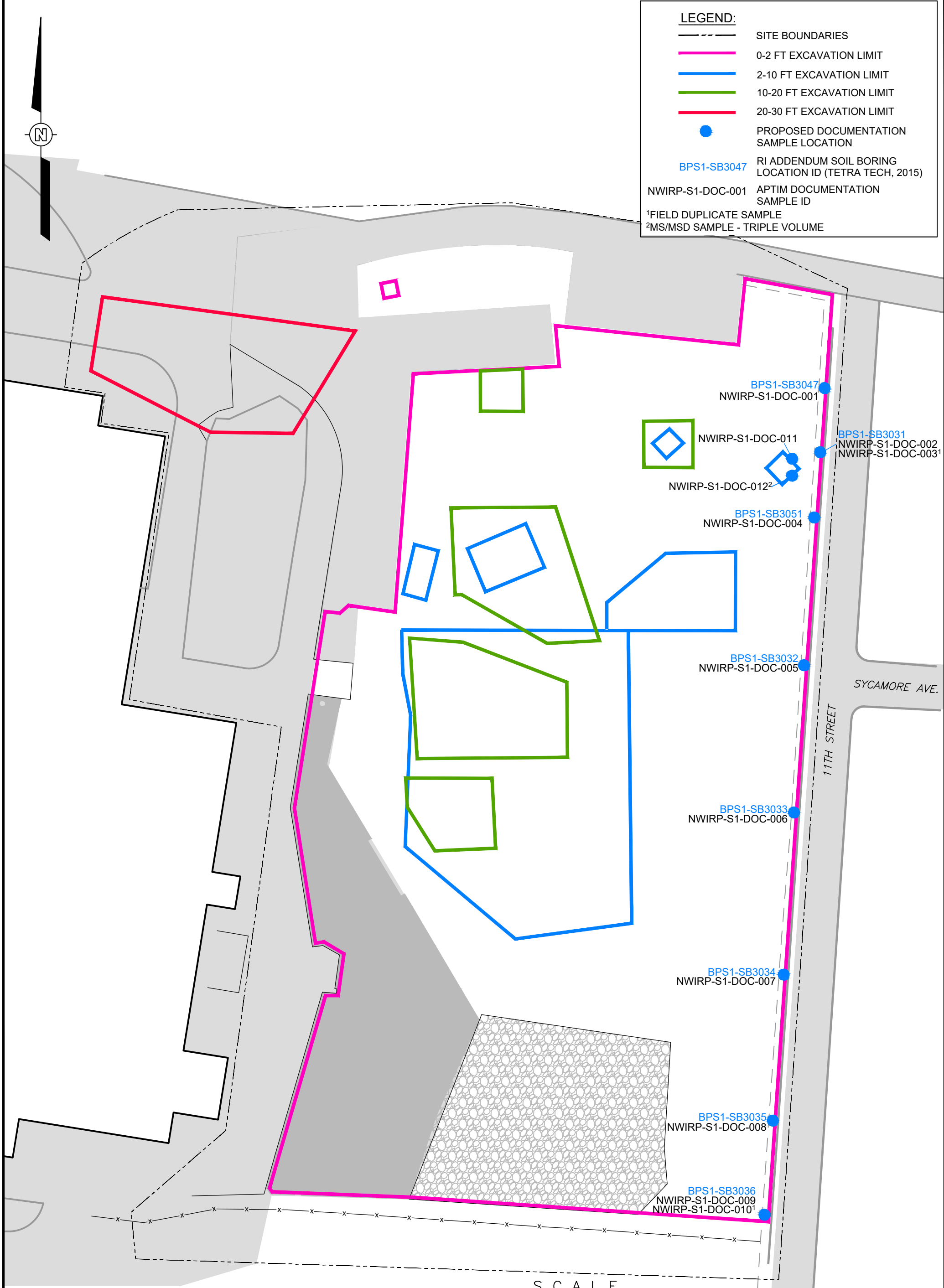

TETRA TECH, INC. 2015. REMEDIAL INVESTIGATION ADDENDUM SOIL, GROUNDWATER, AND SOIL VAPOR, SITE 1 FORMER DRUM MARSHALLING AREA, NWIRP BETHPAGE, NEW YORK.



SHEET ID: FIGURE 1	CONTRACT NO. NAVFAC 16-D-9004	DELIVERY ORDER NO. F6147	SCALE: AS SHOWN	NAVFAC DRAWING NO.			APTIM Federal Services, LLC 150 Boush Street, Suite 701 Norfolk, Virginia 23510					
							DESIGNED BY M. Smith	DATE 4/16/20	CHECKED BY	DATE		
NAVAL WEAPONS INDUSTRIAL RESERVE PLANT SITE 1 - FORMER DRUM MARSHALLING AREA					BETHPAGE, NEW YORK		DRAWN BY B. O'Connor	DATE 4/16/20	APPROVED BY	DATE		
PROPOSED DOCUMENTATION SAMPLE LOCATIONS - 11TH STREET									REVISIONS			
							REV	DATE	BY	CHK'D	APR'VD	DESCRIPTION/ISSUE