

Pelton, Jason M (DEC)

From: Wu, Ernie <Ernie.Wu@tetrattech.com>
Sent: Friday, September 18, 2020 4:53 PM
To: Pelton, Jason M (DEC); Karpinski, Steven (HEALTH); Lovejoy, John (NASSAU); Stein, Carol; Azzam, Nidal; rlenz@oysterbay-ny.gov
Cc: Murray, Brian S CIV NAVFAC MIDLANT, IPTNORTH; Fly, Lora B CIV NAVFAC MIDLANT, IPTNE (lora.fly@navy.mil); Brayack, David; Francisco, Ben; Varricchio, Vin; Walls, Kristen
Subject: Q1, 2020 (March) Validated Data, OU2 Navy groundwater sampling
Attachments: Figure 2_062220.pdf; OU2_TT_Wells_March_2020.pdf

ATTENTION: This email came from an external source. Do not open attachments or click on links from unknown senders or unexpected emails.

All:

As per discussions between the Navy and NYSDEC, NYSDEC requested that the Navy submit the validated data as soon as the information is available. Please find attached, a pdf table of the Q1, 2020 (March) OU2 groundwater sampling data. The data includes VOCs and 1,4-dioxan results. A figure has also been included depicting the locations of groundwater monitoring wells sampled.

Ernie Wu | Project Manager | Environmental Scientist
Main: 757.461.3768 | Direct: 757.466.4901 | Fax: 757.461.4148
ernie.wu@tetrattech.com

Tetra Tech, Inc | Norfolk Office
Twin Oaks I, Suite 102, 5700 Lake Wright Drive | Norfolk, VA 23502 | www.tetrattech.com

PLEASE NOTE: This message, including any attachments, may include privileged, confidential and/or inside information. Any distribution or use of this communication by anyone other than the intended recipient is strictly prohibited and may be unlawful. If you are not the intended recipient, please notify the sender by replying to this message and then delete it from your system.

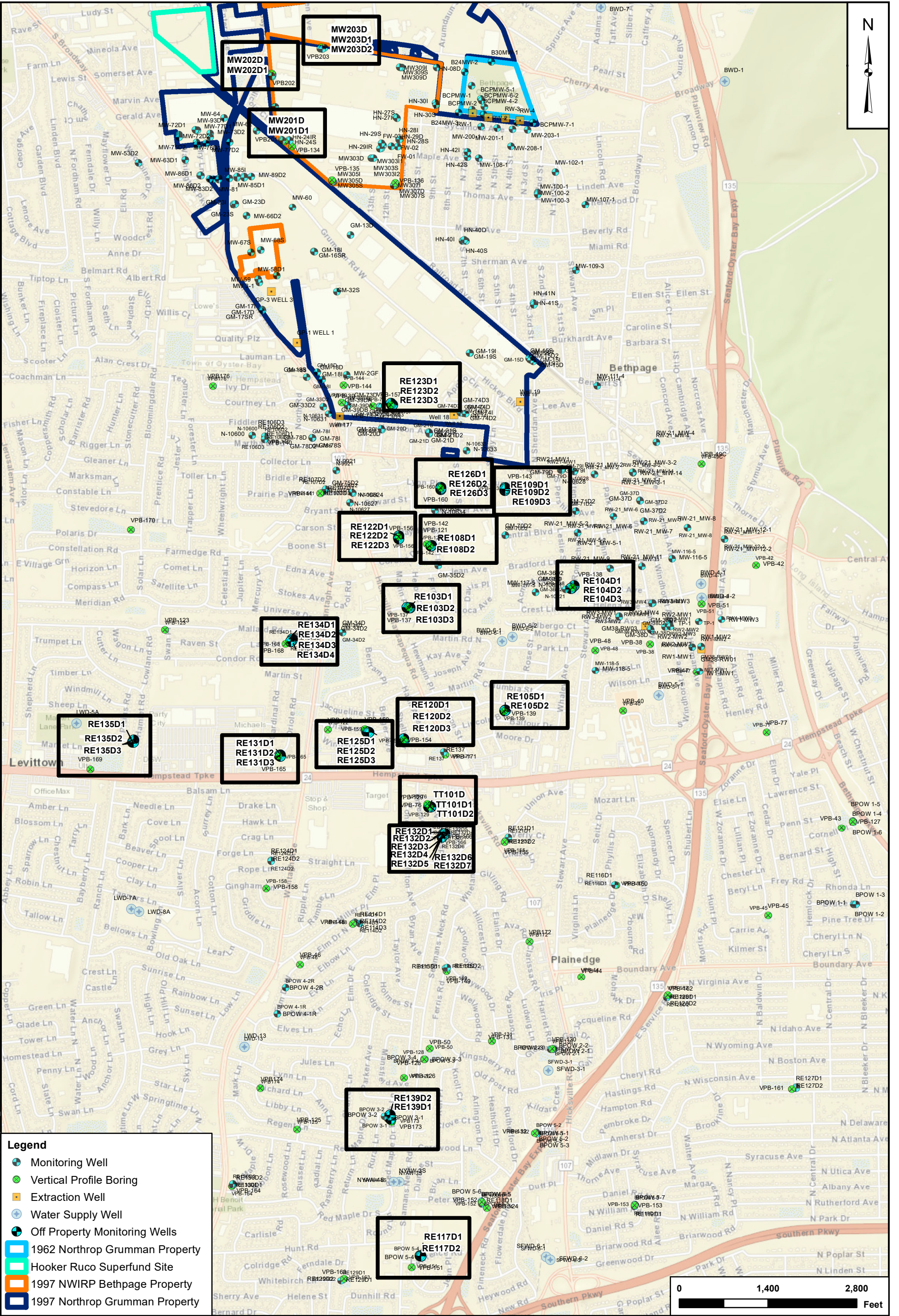

Legend

- Monitoring Well
- Vertical Profile Boring
- Extraction Well
- Water Supply Well
- Off Property Monitoring Wells
- 1962 Northrop Grumman Property
- Hooker Ruco Superfund Site
- 1997 NWIRP Bethpage Property
- 1997 Northrop Grumman Property

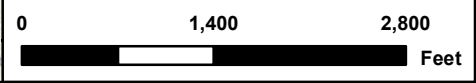

LOCATION MAP OF WELLS
2019 ANNUAL O2 GROUNDWATER INVESTIGATION
NAVAL WEAPONS INDUSTRIAL RESERVE PLANT
BETHPAGE, NEW YORK

CTO	
N62470-16-D-9008 WE13	
DRAWN BY	DATE
MC	06/23/20
CHECKED BY	DATE
RD	06/23/20
FIGURE NUMBER	
2	

NOR-PIGIS_files\Bethpage\MAP-DOCS\MKD\BP_OU2_2020\WP_MM\BP_ownership_2019_062220.mxd.MMC

Q1, 2020 (March) Validated Analytical Data
 Navy OU2 Groundwater Sampling
 Naval Weapons Industrial Reserve Plant Bethpage
 Page 1 of 7

LOCATION SAMPLE ID SAMPLE DATE DUPLICATE	MW201D MW201D-20200307 03/07/2020	MW201D1 MW201D1-20200307 03/07/2020	MW202D MW202D-20200313 03/13/2020	MW202D1 MW202D1-20200317 03/17/2020	MW203D MW203D-20200315 03/15/2020	MW203D1 MW203D1-20200315 03/15/2020	MW203D2 MW203D2-20200315 03/15/2020	RE103D1 RE103D1-20200310 03/10/2020	RE103D2 RE103D2-20200310 03/10/2020	RE103D2 RE103D2-20200310-D 03/10/2020 RE103D2-20200310
VOLATILES (UG/L)										
1,1,1-TRICHLOROETHANE	6.5	0.75 U	0.75 U	0.75 U	0.95 J	3.2 J	0.75 U	0.75 U	0.75 U	0.75 U
1,1,2,2-TETRACHLOROETHANE	0.5 U	0.5 U	0.5 U	0.5 U	0.5 U	0.5 U	0.5 U	0.5 U	0.5 U	0.5 U
1,1,2-TRICHLOROETHANE	0.57 J	0.5 U	0.5 U	0.5 U	0.5 U	0.5 U	0.5 U	0.55 J	0.46 J	0.43 J
1,1,2-TRICHLOROTRIFLUOROETHANE	3.1 J	0.5 U	0.5 U	0.5 U	0.5 U	0.5 U	0.5 U	5.9	2.8 J	2.8 J
1,1-DICHLOROETHANE	3.9 J	0.5 U	2.6 J	2.4 J	2.7 J	19.3	1.9 J	0.5 U	0.5 U	0.5 U
1,1-DICHLOROETHENE	42	0.5 U	1.2 J	0.5 U	1.3 J	6.5	0.5 U	3.5 J	0.5 U	0.5 U
1,2-DICHLOROETHANE	0.5 U	0.5 U	0.5 U	0.5 U	0.5 U	0.5 U	0.5 U	0.5 U	0.5 U	0.5 U
1,2-DICHLOROETHENE	0.75 U	0.75 U	0.48 J	0.92 J	0.75 U	0.75 U	0.75 U	0.75 U	0.75 U	0.75 U
1,2-DICHLOROPROPANE	0.5 U	0.5 U	0.5 U	0.5 U	0.5 U	0.5 U	0.5 U	0.5 U	0.5 U	0.5 U
1,3-DICHLOROETHANE	0.5 U	0.5 U	0.5 U	0.5 U	0.5 U	0.5 U	0.5 U	0.5 U	0.5 U	0.5 U
1,4-DICHLOROETHANE	0.5 U	0.5 U	0.5 U	0.5 U	0.5 U	0.5 U	0.5 U	0.5 U	0.5 U	0.5 U
2-BUTANONE	2.5 U	2.5 U	2.5 U	2.5 U	2.5 U	2.5 U	2.5 U	2.5 U	2.5 U	2.5 U
2-HEXANONE	3.8 U	3.8 U	3.8 U	3.8 U	3.8 U	3.8 U	3.8 U	3.8 U	3.8 U	3.8 U
4-METHYL-2-PENTANONE	2.5 U	2.5 U	2.5 U	2.5 U	2.5 U	2.5 U	2.5 U	2.5 U	2.5 U	2.5 U
ACETONE	2.5 U	2.5 U	2.5 U	1.9 J	2.5 U	2.5 U	2.5 U	2.5 U	2.5 U	2.5 U
BENZENE	0.5 U	0.5 U	0.5 U	0.5 U	0.5 U	0.5 U	0.5 U	0.5 U	0.5 U	0.5 U
BROMODICHLOROMETHANE	0.5 U	0.5 U	0.5 U	0.5 U	0.5 U	0.5 U	0.5 U	0.5 U	0.5 U	0.5 U
BROMOFORM	0.5 U	0.5 U	0.5 U	0.5 U	0.5 U	0.5 U	0.5 U	0.5 U	0.5 U	0.5 U
BROMOMETHANE	3.8 U	3.8 U	3.8 U	3.8 U	3.8 U	3.8 U	3.8 U	3.8 U	3.8 U	3.8 U
CARBON DISULFIDE	0.5 U	0.5 U	0.5 U	0.5 U	0.5 U	0.5 U	0.5 U	0.5 U	0.5 U	0.5 U
CARBON TETRACHLORIDE	0.5 U	0.5 U	0.5 U	0.5 U	0.5 U	0.5 U	0.5 U	0.5 U	0.5 U	0.5 U
CHLOROBENZENE	0.5 U	0.5 U	0.5 U	0.5 U	0.5 U	0.5 U	0.5 U	0.5 U	0.5 U	0.5 U
CHLORODIBROMOMETHANE	0.5 U	0.5 U	0.5 U	0.5 U	0.5 U	0.5 U	0.5 U	0.5 U	0.5 U	0.5 U
CHLOROETHANE	0.5 U	0.5 U	0.5 U	0.5 U	0.5 U	0.5 U	0.5 U	0.5 U	0.5 U	0.5 U
CHLOROFORM	4.4 J	0.5 U	0.5 U	1.2 J	0.55 J	1 J	0.5 U	0.5 U	0.5 U	0.5 U
CHLOROMETHANE	0.5 U	0.5 U	0.5 U	0.5 U	0.5 U	0.5 U	0.5 U	0.5 U	0.5 U	0.5 U
CIS-1,2-DICHLOROETHENE	2.9 J	0.5 U	11.7	24	3.8 J	0.96 J	0.52 J	2 J	0.76 J	0.7 J
CIS-1,3-DICHLOROPROPENE	0.5 U	0.5 U	0.5 U	0.5 U	0.5 U	0.5 U	0.5 U	0.5 U	0.5 U	0.5 U
ETHYLBENZENE	0.5 U	0.5 U	0.5 U	0.5 U	0.5 U	0.5 U	0.5 U	0.5 U	0.5 U	0.5 U
ISOPROPYLBENZENE	0.5 U	0.5 U	0.5 U	0.5 U	0.5 U	0.5 U	0.5 U	0.5 U	0.5 U	0.5 U
M+P-XYLENES	1 U	1 U	1 U	1 U	1 U	1 U	1 U	1 U	1 U	1 U
METHYL CYCLOHEXANE	0.5 U	0.5 U	0.5 U	0.5 U	0.5 U	0.5 U	0.5 U	0.5 U	0.5 U	0.5 U
METHYL TERT-BUTYL ETHER	0.5 U	0.5 U	0.5 U	4.8 J	0.5 U	0.5 U	0.5 U	0.5 U	0.5 U	0.5 U
METHYLENE CHLORIDE	0.5 U	0.5 U	0.5 U	0.5 U	0.5 U	0.5 U	0.5 U	0.5 U	0.5 U	0.5 U
O-XYLENE	0.5 U	0.5 U	0.5 U	0.5 U	0.5 U	0.5 U	0.5 U	0.5 U	0.5 U	0.5 U
STYRENE	0.5 U	0.5 U	0.5 U	0.5 U	0.5 U	0.5 U	0.5 U	0.5 U	0.5 U	0.5 U
TETRACHLOROETHENE	82.9	0.61 J	16.4	12.7	0.68 J	1.1 J	0.5 U	4.3 J	0.79 J	0.71 J
TOLUENE	0.5 U	0.5 U	0.5 U	0.5 U	5 U	0.5 U	0.5 U	0.5 U	0.5 U	0.5 U
TRANS-1,2-DICHLOROETHENE	0.5 U	0.5 U	0.5 U	0.63 J	0.5 U	0.5 U	0.5 U	0.5 U	0.5 U	0.5 U
TRANS-1,3-DICHLOROPROPENE	0.5 U	0.5 U	0.5 U	0.5 U	0.5 U	0.5 U	0.5 U	0.5 U	0.5 U	0.5 U
TRICHLOROETHENE	83.1	3.2 J	66.7	13	17.4	6.5	5 U	690	480	510
TRICHLOROFLUOROMETHANE	140	0.5 U	1.8 J	0.5 U	0.5 U	0.5 U	0.5 U	0.5 U	0.5 U	0.5 U
VINYL CHLORIDE	0.5 U	0.5 U	0.5 U	0.5 U	0.5 U	0.5 U	0.5 U	0.5 U	0.5 U	0.5 U
METHOD 8270D (UG/L)										
1,4-DIOXANE	6.6	0.1 U	0.61	0.28	0.32	1.5	0.46	5.2	0.62	0.6
METHOD 8260 SIM (UG/L)										
1,4-DIOXANE	--	--	--	--	--	--	--	--	--	--
METHOD 522 (UG/L)										
1,4-DIOXANE	--	--	--	--	--	--	--	--	--	--

J = Estimated value.
 U = non-detect

Q1, 2020 (March) Validated Analytical Data
 Navy OU2 Groundwater Sampling
 Naval Weapons Industrial Reserve Plant Bethpage
 Page 2 of 7

LOCATION SAMPLE ID SAMPLE DATE DUPLICATE	RE103D3 RE103D3-20200310 03/10/2020	RE104D1 RE104D1-20200312 03/12/2020	RE104D1 RE104D1-20200312-D 03/12/2020 RE104D1-20200312	RE104D2 RE104D2-20200312 03/12/2020	RE104D3 RE104D3-20200312 03/12/2020	RE105D1 RE105D1-20200305 03/05/2020	RE105D2 RE105D2-20200305 03/05/2020	RE108D1 RE108D1-20200304 03/04/2020	RE108D2 RE108D2-20200304 03/04/2020	RE108D2 RE108D2-20200304-D 03/04/2020 RE108D2-20200304
VOLATILES (UG/L)										
1,1,1-TRICHLOROETHANE	0.75 U	0.75 U	0.75 U	0.75 U	0.75 U	0.75 U	0.75 U	0.75 U	0.75 U	0.75 U
1,1,2,2-TETRACHLOROETHANE	0.5 U	0.5 U	0.5 U	0.5 U	0.5 U	0.5 U	0.5 U	0.5 U	0.5 U	0.5 U
1,1,2-TRICHLOROETHANE	0.5 U	0.5 U	0.5 U	0.5 U	0.5 U	0.5 U	1.2 J	0.5 U	1.3 J	1.4 J
1,1,2-TRICHLOROTRIFLUOROETHANE	3.5 J	1.1 J	0.5 U	0.5 U	0.5 U	5.8	23.7	0.5 U	4.9 J	4.7 J
1,1-DICHLOROETHANE	0.5 U	0.5 U	0.5 U	1.4 J	0.5 U	0.5 U	0.5 U	0.5 U	3.8 J	3.9 J
1,1-DICHLOROETHENE	0.5 U	0.5 U	0.5 U	0.65 J	0.5 U	0.97 J	6	0.5 U	5.2	4.9 J
1,2-DICHLOROETHANE	0.5 U	0.5 U	0.5 U	0.5 U	0.5 U	0.5 U	0.5 U	0.5 U	0.5 U	0.5 U
1,2-DICHLOROETHANE	0.75 U	0.75 U	0.75 U	1.7 J	0.75 U	0.75 U	0.75 U	0.75 U	0.75 U	0.75 U
1,2-DICHLOROPROPANE	0.5 U	0.5 U	0.5 U	0.5 U	0.5 U	0.5 U	0.5 U	0.5 U	0.5 U	0.5 U
1,3-DICHLOROBENZENE	0.5 U	0.5 U	0.5 U	0.5 U	0.5 U	0.5 U	0.5 U	0.5 U	0.5 U	0.5 U
1,4-DICHLOROBENZENE	0.5 U	0.5 U	0.5 U	0.5 U	0.5 U	0.5 U	0.5 U	0.5 U	0.5 U	0.5 U
2-BUTANONE	2.5 U	2.5 U	2.5 U	2.5 U	2.5 U	2.5 U	2.5 U	2.5 U	2.5 U	2.5 U
2-HEXANONE	3.8 U	3.8 U	3.8 U	3.8 U	3.8 U	3.8 U	3.8 U	3.8 U	3.8 U	3.8 U
4-METHYL-2-PENTANONE	2.5 U	2.5 U	2.5 U	2.5 U	2.5 U	2.5 U	2.5 U	2.5 U	2.5 U	2.5 U
ACETONE	2.5 U	2.5 U	2.5 U	2.5 U	2.5 U	2.5 U	2.5 U	25 U	25 U	25 U
BENZENE	0.5 U	0.5 U	0.5 U	0.5 U	0.5 U	0.5 U	0.5 U	0.5 U	0.5 U	0.5 U
BROMODICHLOROMETHANE	0.5 U	0.5 U	0.5 U	0.5 U	0.5 U	0.5 U	0.5 U	0.5 U	0.5 U	0.5 U
BROMOFORM	0.5 U	0.5 U	0.5 U	0.5 U	0.5 U	0.5 U	0.5 U	0.5 U	0.5 U	0.5 U
BROMOMETHANE	3.8 U	3.8 U	3.8 U	3.8 U	3.8 U	3.8 U	3.8 U	3.8 U	3.8 U	3.8 U
CARBON DISULFIDE	0.5 U	0.5 U	0.5 U	0.5 U	0.5 U	0.5 U	0.5 U	0.5 U	0.5 U	0.5 U
CARBON TETRACHLORIDE	0.5 U	0.5 U	0.5 U	0.5 U	0.5 U	0.5 U	3.3 J	0.5 U	1.4 J	1.1 J
CHLOROBENZENE	0.5 U	0.5 U	0.5 U	0.5 U	0.5 U	0.5 U	0.5 U	0.5 U	0.5 U	0.5 U
CHLORODIBROMOMETHANE	0.5 U	0.5 U	0.5 U	0.5 U	0.5 U	0.5 U	0.5 U	0.5 U	0.5 U	0.5 U
CHLOROETHANE	0.5 U	0.5 U	0.5 U	0.5 U	0.5 U	0.5 U	0.5 U	0.5 U	0.5 U	0.5 U
CHLOROFORM	0.5 U	0.5 U	0.5 U	3.8 J	0.5 U	0.5 U	1.8 J	0.5 U	2.6 J	2.7 J
CHLOROMETHANE	0.5 U	0.5 U	0.5 U	0.5 U	0.5 U	0.5 U	0.5 U	0.5 U	0.5 U	0.5 U
CIS-1,2-DICHLOROETHENE	0.86 J	0.5 U	0.65 J	35.2	0.5 U	1.4 J	3.6 J	0.5 U	5.5	5.6
CIS-1,3-DICHLOROPROPENE	0.5 U	0.5 U	0.5 U	0.5 U	0.5 U	0.5 U	0.5 U	0.5 U	0.5 U	0.5 U
ETHYLBENZENE	0.5 U	0.5 U	0.5 U	0.5 U	0.5 U	0.5 U	0.5 U	0.5 U	0.5 U	0.5 U
ISOPROPYLBENZENE	0.5 U	0.5 U	0.5 U	0.5 U	0.5 U	0.5 U	0.5 U	0.5 U	0.5 U	0.5 U
M+P-XYLENES	1 U	1 U	1 U	1 U	1 U	1 U	1 U	1 U	1 U	1 U
METHYL CYCLOHEXANE	0.5 U	0.5 U	0.5 U	0.5 U	0.5 U	0.5 U	0.5 U	0.5 U	0.5 U	0.5 U
METHYL TERT-BUTYL ETHER	0.5 U	0.5 U	0.5 U	0.5 U	0.5 U	0.5 U	0.5 U	0.5 U	0.5 U	0.5 U
METHYLENE CHLORIDE	0.5 U	0.5 U	0.5 U	0.5 U	0.5 U	0.5 U	0.5 U	0.5 U	0.5 U	0.5 U
O-XYLENE	0.5 U	0.5 U	0.5 U	0.5 U	0.5 U	0.5 U	0.5 U	0.5 U	0.5 U	0.5 U
STYRENE	0.5 U	0.5 U	0.5 U	0.5 U	0.5 U	0.5 U	0.5 U	0.5 U	0.5 U	0.5 U
TETRACHLOROETHENE	0.86 J	2.7 J	2.8 J	0.5 U	0.5 U	0.5 U	3 J	1.7 J	2.3 J	2.2 J
TOLUENE	0.5 U	0.5 U	0.5 U	0.5 U	0.5 U	0.5 U	0.5 U	0.5 U	0.26 J	0.5 U
TRANS-1,2-DICHLOROETHENE	0.5 U	0.5 U	0.5 U	1.8 J	0.5 U	0.5 U	0.5 U	0.5 U	0.5 U	0.5 U
TRANS-1,3-DICHLOROPROPENE	0.5 U	0.5 U	0.5 U	0.5 U	0.5 U	0.5 U	0.5 U	0.5 U	0.5 U	0.5 U
TRICHLOROETHENE	480	45.1	46.1	230 J	0.9 J	62.3	1900	30.2	2400	2500
TRICHLOROFLUOROMETHANE	0.5 U	0.5 U	0.5 U	0.5 U	0.5 U	0.5 U	0.5 U	0.5 U	0.5 U	0.5 U
VINYL CHLORIDE	0.5 U	0.5 U	0.5 U	0.5 U	0.5 U	0.5 U	0.5 U	0.5 U	0.5 U	0.5 U
METHOD 8270D (UG/L)										
1,4-DIOXANE	0.51	3.3	3.5	1.8	0.1 U	4.6	4.1	4.6	4.8	4.3
METHOD 8260 SIM (UG/L)										
1,4-DIOXANE	--	--	--	--	--	--	--	--	--	--
METHOD 522 (UG/L)										
1,4-DIOXANE	--	--	--	--	--	--	--	--	--	--

J = Estimated value.
 U = non-detect

Q1, 2020 (March) Validated Analytical Data
 Navy OU2 Groundwater Sampling
 Naval Weapons Industrial Reserve Plant Bethpage
 Page 3 of 7

LOCATION SAMPLE ID SAMPLE DATE DUPLICATE	RE109D1 RE109D1-20200316 03/16/2020	RE109D2 RE109D2-20200316 03/16/2020	RE109D2 RE109D2-20200316-D 03/16/2020 RE109D2-20200316	RE109D3 RE109D3-20200316 03/16/2020	RE117D1 RE117D1-20200303 03/03/2020	RE117D2 RE117D2-20200303 03/03/2020	RE120D1 RE120D1-20200309 03/09/2020	RE120D2 RE120D2-20200309 03/09/2020	RE120D3 RE120D3-20200309 03/09/2020	RE122D1 RE122D1-20200312 03/12/2020
VOLATILES (UG/L)										
1,1,1-TRICHLOROETHANE	0.75 U	0.75 U	0.75 U	0.33 J	0.75 U	0.75 U	0.6 J	0.75 U	0.75 U	0.75 U
1,1,2,2-TETRACHLOROETHANE	0.5 U	0.5 U	0.5 U	0.5 U	0.5 U	0.5 U	0.5 U	0.5 U	0.5 U	0.5 U
1,1,2-TRICHLOROETHANE	0.5 U	0.5 U	0.5 U	0.5 U	0.5 U	0.5 U	0.94 J	0.6 J	0.5 U	0.38 J
1,1,2-TRICHLOROTRIFLUOROETHANE	0.5 U	1.3 J	1.4 J	2.1 J	0.5 U	0.5 U	19.2	21.4	5.1	2.8 J
1,1-DICHLOROETHANE	0.5 U	0.5 U	0.5 U	0.5 U	0.5 U	0.5 U	1.6 J	0.5 U	0.5 U	0.5 U
1,1-DICHLOROETHENE	0.5 U	0.5 U	0.5 U	0.42 J	0.5 U	0.5 U	10.4	2.6 J	1 J	0.5 U
1,2-DICHLOROBENZENE	0.5 U	0.5 U	0.5 U	0.5 U	0.5 U	0.5 U	0.5 U	0.5 U	0.5 U	0.5 U
1,2-DICHLOROETHANE	0.75 U	0.75 U	0.75 U	0.75 U	0.75 U	0.75 U	0.75 U	0.75 U	0.75 U	0.75 U
1,2-DICHLOROPROPANE	0.5 U	0.5 U	0.5 U	0.5 U	0.5 U	0.5 U	0.5 U	0.5 U	0.5 U	0.5 U
1,3-DICHLOROBENZENE	0.5 U	0.5 U	0.5 U	0.5 U	0.5 U	0.5 U	0.5 U	0.5 U	0.5 U	0.5 U
1,4-DICHLOROBENZENE	0.5 U	0.5 U	0.5 U	0.5 U	0.5 U	0.5 U	0.5 U	0.5 U	0.5 U	0.5 U
2-BUTANONE	2.5 U	2.5 U	2.5 U	2.5 U	2.5 U	2.5 U	2.5 U	2.5 U	2.5 U	2.5 U
2-HEXANONE	3.8 U	3.8 U	3.8 U	3.8 U	3.8 U	3.8 U	3.8 U	3.8 U	3.8 U	3.8 U
4-METHYL-2-PENTANONE	2.5 U	2.5 U	2.5 U	2.5 U	2.5 U	2.5 U	2.5 U	2.5 U	2.5 U	2.5 U
ACETONE	2.5 U	2.4 J	2.5 U	2.5 U	25 U	2.5 U	2.5 U	2.5 U	2.5 U	2.5 U
BENZENE	0.5 U	0.5 U	0.5 U	0.5 U	0.5 U	0.5 U	0.5 U	0.5 U	0.5 U	0.5 U
BROMODICHLOROMETHANE	0.5 U	0.5 U	0.5 U	0.5 U	0.5 U	0.5 U	0.5 U	0.5 U	0.5 U	0.5 U
BROMOFORM	0.5 U	0.5 U	0.5 U	0.5 U	0.5 U	0.5 U	0.5 U	0.5 U	0.5 U	0.5 U
BROMOMETHANE	3.8 U	3.8 U	3.8 U	3.8 U	3.8 U	3.8 U	3.8 U	3.8 U	3.8 U	3.8 U
CARBON DISULFIDE	0.5 U	0.5 U	0.5 U	0.5 U	0.5 U	0.5 U	0.5 U	0.5 U	0.5 U	0.5 U
CARBON TETRACHLORIDE	0.5 U	0.5 U	0.3 J	0.59 J	0.5 U	0.5 U	0.52 J	0.5 U	0.5 U	0.5 U
CHLOROBENZENE	0.5 U	0.5 U	0.5 U	0.5 U	0.5 U	0.5 U	0.5 U	0.5 U	0.5 U	0.5 U
CHLORODIBROMOMETHANE	0.5 U	0.5 U	0.5 U	0.5 U	0.5 U	0.5 U	0.5 U	0.5 U	0.5 U	0.5 U
CHLOROETHANE	0.5 U	0.5 U	0.5 U	0.5 U	0.5 U	0.5 U	0.5 U	0.5 U	0.5 U	0.5 U
CHLOROFORM	0.5 U	0.5 U	0.5 U	0.5 U	0.5 U	0.5 U	0.5 U	0.5 U	0.5 U	0.5 U
CHLOROMETHANE	0.5 U	0.5 U	0.5 U	0.5 U	0.5 U	0.5 U	0.5 U	0.5 U	0.5 U	0.5 U
CIS-1,2-DICHLOROETHENE	0.5 U	0.35 J	0.39 J	0.54 J	0.5 U	0.5 U	3.1 J	3.2 J	0.85 J	1.6 J
CIS-1,3-DICHLOROPROPENE	0.5 U	0.5 U	0.5 U	0.5 U	0.5 U	0.5 U	0.5 U	0.5 U	0.5 U	0.5 U
ETHYLBENZENE	0.5 U	0.5 U	0.5 U	0.5 U	0.5 U	0.5 U	0.5 U	0.5 U	0.5 U	0.5 U
ISOPROPYLBENZENE	0.5 U	0.5 U	0.5 U	0.5 U	0.5 U	0.5 U	0.5 U	0.5 U	0.5 U	0.5 U
M+P-XYLENES	1 U	1 U	1 U	1 U	1 U	1 U	1 U	1 U	1 U	1 U
METHYL CYCLOHEXANE	0.5 U	0.5 U	0.5 U	0.5 U	0.5 U	0.5 U	0.5 U	0.5 U	0.5 U	0.5 U
METHYL TERT-BUTYL ETHER	0.5 U	0.5 U	0.5 U	0.5 U	0.5 U	0.5 U	0.5 U	0.5 U	0.5 U	0.5 U
METHYLENE CHLORIDE	0.5 U	0.5 U	0.5 U	0.5 U	0.5 U	0.5 U	0.5 U	0.5 U	0.5 U	0.5 U
O-XYLENE	0.5 U	0.5 U	0.5 U	0.5 U	0.5 U	0.5 U	0.5 U	0.5 U	0.5 U	0.5 U
STYRENE	0.5 U	0.5 U	0.5 U	0.5 U	0.5 U	0.5 U	0.5 U	0.5 U	0.5 U	0.5 U
TETRACHLOROETHENE	0.71 J	0.64 J	0.56 J	0.95 J	0.5 U	0.5 U	4.1 J	5.3	0.92 J	2 J
TOLUENE	0.5 U	0.5 U	0.5 U	5 U	0.5 U	0.5 U	0.5 U	0.5 U	0.5 U	0.5 U
TRANS-1,2-DICHLOROETHENE	0.5 U	0.5 U	0.5 U	0.5 U	0.5 U	0.5 U	0.5 U	0.5 U	0.5 U	0.5 U
TRANS-1,3-DICHLOROPROPENE	0.5 U	0.5 U	0.5 U	0.5 U	0.5 U	0.5 U	0.5 U	0.5 U	0.5 U	0.5 U
TRICHLOROETHENE	20.7	36.3	36.8	63.4	53.6	0.5 U	910	740	190	400
TRICHLOROFLUOROMETHANE	0.5 U	0.5 U	0.5 U	0.5 U	0.5 U	0.5 U	0.4 J	0.5 U	0.5 U	0.5 U
VINYL CHLORIDE	0.5 U	0.5 U	0.5 U	0.5 U	0.5 U	0.5 U	0.5 U	0.5 U	0.5 U	0.5 U
METHOD 8270D (UG/L)										
1,4-DIOXANE	2.4	2.7	2.9	2.8	0.14	0.1 U	7.4	4.9	1	3.7
METHOD 8260 SIM (UG/L)										
1,4-DIOXANE	--	--	--	--	--	--	24	17	4	--
METHOD 522 (UG/L)										
1,4-DIOXANE	--	--	--	--	--	--	26 J	17 J	3.9 J	--

J = Estimated value.
 U = non-detect

Q1, 2020 (March) Validated Analytical Data
 Navy OU2 Groundwater Sampling
 Naval Weapons Industrial Reserve Plant Bethpage
 Page 4 of 7

LOCATION SAMPLE ID SAMPLE DATE DUPLICATE	RE122D2 RE122D2-20200316 03/16/2020	RE122D3 RE122D3-20200316 03/16/2020	RE123D1 RE123D1-20200317 03/17/2020	RE123D2 RE123D2-20200317 03/17/2020	RE123D3 RE123D3-20200317 03/17/2020	RE123D3 RE123D3-20200317-D 03/17/2020 RE123D3-20200317	RE125D1 RE125D1-20200311 03/11/2020	RE125D1 RE125D1-20200319 03/19/2020	RE125D2 RE125D2-20200306 03/06/2020	RE125D3 RE125D3-20200306 03/06/2020
VOLATILES (UG/L)										
1,1,1-TRICHLOROETHANE	75 U	0.75 U	0.75 U	0.75 U	0.75 U	0.75 U	0.75 U	0.75 U	0.75 U	0.75 U
1,1,2,2-TETRACHLOROETHANE	50 U	0.5 U	0.5 U	0.5 U	0.5 U	0.5 U	0.5 U	0.5 U	0.5 U	0.5 U
1,1,2-TRICHLOROETHANE	50 U	0.5 U	0.5 U	0.5 U	0.5 U	0.5 U	0.5 U	0.5 U	0.53 J	0.5 U
1,1,2-TRICHLOROTRIFLUOROETHANE	50 U	0.5 U	0.5 U	0.5 U	0.5 U	0.5 U	11.4	0.5 U	19.1	59.4
1,1-DICHLOROETHANE	50 U	0.5 U	0.5 U	0.5 U	0.5 U	0.5 U	1.6 J	0.5 U	0.5 U	0.5 U
1,1-DICHLOROETHENE	50 U	0.5 U	0.5 U	0.5 U	0.5 U	0.5 U	2.4 J	0.5 U	5.4	0.5 U
1,2-DICHLOROBENZENE	50 U	0.5 U	0.5 U	0.5 U	0.5 U	0.5 U	0.5 U	0.5 U	0.5 U	0.5 U
1,2-DICHLOROETHANE	75 U	0.75 U	0.75 U	0.75 U	0.75 U	0.75 U	0.75 U	0.75 U	0.75 U	0.75 U
1,2-DICHLOROPROPANE	50 U	0.5 U	0.5 U	0.5 U	0.5 U	0.5 U	0.5 U	0.5 U	0.5 U	0.5 U
1,3-DICHLOROBENZENE	50 U	0.5 U	0.5 U	0.5 U	0.5 U	0.5 U	0.5 U	0.5 U	0.5 U	0.5 U
1,4-DICHLOROBENZENE	50 U	0.5 U	0.5 U	0.5 U	0.5 U	0.5 U	0.5 U	0.5 U	0.5 U	0.5 U
2-BUTANONE	250 U	2.5 U	2.5 U	2.5 U	2.5 U	2.5 U	2.5 U	2.5 U	2.5 U	2.5 U
2-HEXANONE	380 U	3.8 U	3.8 U	3.8 U	3.8 U	3.8 U	3.8 U	3.8 U	3.8 U	3.8 U
4-METHYL-2-PENTANONE	250 U	2.5 U	2.5 U	2.5 U	2.5 U	2.5 U	2.5 U	2.5 U	2.5 U	2.5 U
ACETONE	250 U	2.5 U	1.6 J	2.5 U	4.5 J	2.6 J	2.5 U	2.5 U	2.5 U	2.5 U
BENZENE	50 U	0.5 U	0.5 U	0.5 U	0.5 U	0.5 U	0.5 U	0.5 U	0.5 U	0.5 U
BROMODICHLOROMETHANE	50 U	0.5 U	0.5 U	0.5 U	0.5 U	0.5 U	0.5 U	0.5 U	0.5 U	0.5 U
BROMOFORM	50 U	0.5 U	0.5 U	0.5 U	0.5 U	0.5 U	0.5 U	0.5 U	0.5 U	0.5 U
BROMOMETHANE	380 U	3.8 U	3.8 U	3.8 U	3.8 U	3.8 U	3.8 U	3.8 U	3.8 U	3.8 U
CARBON DISULFIDE	50 U	0.5 U	0.5 U	0.5 U	0.5 U	0.5 U	0.5 U	0.5 U	0.5 U	0.5 U
CARBON TETRACHLORIDE	50 U	0.5 U	0.5 U	0.5 U	0.5 U	0.5 U	0.5 U	0.5 U	0.61 J	0.5 U
CHLOROBENZENE	50 U	0.5 U	0.5 U	0.5 U	0.5 U	0.5 U	0.5 U	0.5 U	0.5 U	0.5 U
CHLORODIBROMOMETHANE	50 U	0.5 U	0.5 U	0.5 U	0.5 U	0.5 U	0.5 U	0.5 U	0.5 U	0.5 U
CHLOROETHANE	50 U	0.5 U	0.5 U	0.5 U	0.5 U	0.5 U	0.5 U	0.5 U	0.5 U	0.5 U
CHLOROFORM	50 U	0.5 U	0.5 U	0.5 U	0.5 U	0.5 U	0.5 U	0.5 U	0.5 U	0.5 U
CHLOROMETHANE	50 U	0.5 U	0.5 U	0.5 U	0.5 U	0.5 U	0.5 U	0.5 U	0.5 U	0.5 U
CIS-1,2-DICHLOROETHENE	50 U	0.5 U	0.5 U	0.5 U	0.5 U	0.5 U	4.7 J	0.5 U	4.6 J	2.1 J
CIS-1,3-DICHLOROPROPENE	50 U	0.5 U	0.5 U	0.5 U	0.5 U	0.5 U	0.5 U	0.5 U	0.5 U	0.5 U
ETHYLBENZENE	50 U	0.5 U	0.5 U	0.5 U	0.5 U	0.5 U	0.5 U	0.5 U	0.5 U	0.5 U
ISOPROPYLBENZENE	50 U	0.5 U	0.5 U	0.5 U	0.5 U	0.5 U	0.5 U	0.5 U	0.5 U	0.5 U
M+P-XYLENES	100 U	1 U	1 U	1 U	1 U	1 U	1 U	1 U	1 U	1 U
METHYL CYCLOHEXANE	50 U	0.5 U	0.5 U	0.5 U	0.5 U	0.5 U	0.5 U	0.5 U	0.5 U	0.5 U
METHYL TERT-BUTYL ETHER	50 U	0.5 U	0.5 U	0.5 U	0.5 U	0.5 U	0.5 U	0.5 U	0.5 U	0.5 U
METHYLENE CHLORIDE	50 U	0.5 U	0.5 U	0.5 U	0.5 U	0.5 U	0.5 U	0.5 U	0.5 U	0.5 U
O-XYLENE	50 U	0.5 U	0.5 U	0.5 U	0.5 U	0.5 U	0.5 U	0.5 U	0.5 U	0.5 U
STYRENE	50 U	0.5 U	0.5 U	0.5 U	0.5 U	0.5 U	0.5 U	0.5 U	0.5 U	0.5 U
TETRACHLOROETHENE	50 U	0.5 U	0.5 U	1.7 J	0.5 U	0.5 U	8.6	1.2 J	5	5.7
TOLUENE	50 U	0.5 U	5 U	0.5 U	0.5 U	0.5 U	0.5 U	0.5 U	0.5 U	0.5 U
TRANS-1,2-DICHLOROETHENE	50 U	0.5 U	0.5 U	0.5 U	0.5 U	0.5 U	0.5 U	0.5 U	0.5 U	0.5 U
TRANS-1,3-DICHLOROPROPENE	50 U	0.5 U	0.5 U	0.5 U	0.5 U	0.5 U	0.5 U	0.5 U	0.5 U	0.5 U
TRICHLOROETHENE	5400	5 U	11.1	5 U	0.5 U	0.5 U	250	30.5	350	170
TRICHLOROFLUOROMETHANE	50 U	0.5 U	0.5 U	0.5 U	0.5 U	0.5 U	0.5 U	0.5 U	0.5 U	0.5 U
VINYL CHLORIDE	50 U	0.5 U	0.5 U	0.5 U	0.5 U	0.5 U	0.5 U	0.5 U	0.5 U	0.5 U
METHOD 8270D (UG/L)										
1,4-DIOXANE	4.6	0.1 U	1.6	0.42	0.1 U	0.1 U	1.4	3.1	11.7	3.8
METHOD 8260 SIM (UG/L)										
1,4-DIOXANE	--	--	--	--	--	--	--	--	--	--
METHOD 522 (UG/L)										
1,4-DIOXANE	--	--	--	--	--	--	--	--	--	--

J = Estimated value.
 U = non-detect

Q1, 2020 (March) Validated Analytical Data
 Navy OU2 Groundwater Sampling
 Naval Weapons Industrial Reserve Plant Bethpage
 Page 5 of 7

LOCATION SAMPLE ID SAMPLE DATE DUPLICATE	RE126D2 RE126D2-20200303 03/03/2020	RE126D3 RE126D3-20200303 03/03/2020	RE131D1 RE131D1-20200309 03/09/2020	RE131D2 RE131D2-20200309 03/09/2020	RE131D3 RE131D3-20200309 03/09/2020	RE132D1 RE132D1-20200304 03/04/2020	RE132D2 RE132D2-20200305 03/05/2020	RE132D3 RE132D3-20200305 03/05/2020	RE132D4 RE132D4-20200305 03/05/2020	RE132D5 RE132D5-20200304 03/04/2020
VOLATILES (UG/L)										
1,1,1-TRICHLOROETHANE	0.75 U	0.75 U	0.75 U	0.75 U	0.75 U	0.75 U	0.75 U	0.75 U	0.75 U	0.75 U
1,1,2,2-TETRACHLOROETHANE	0.5 U	0.5 U	0.5 U	0.5 U	0.5 U	0.5 U	0.5 U	0.5 U	0.5 U	0.5 U
1,1,2-TRICHLOROETHANE	0.5 U	0.5 U	0.5 U	0.5 U	0.5 U	0.5 U	0.5 U	0.5 U	0.5 U	0.54 J
1,1,2-TRICHLOROTRIFLUOROETHANE	0.5 U	0.5 U	4 J	190	240	6.4	3.4 J	4.9 J	7.6	9.5
1,1-DICHLOROETHANE	0.5 U	0.5 U	0.5 U	0.5 U	0.5 U	0.5 U	0.5 U	0.5 U	0.5 U	0.5 U
1,1-DICHLOROETHENE	1.1 J	0.5 U	0.5 U	2.1 J	1.5 J	1.1 J	0.5 U	0.5 U	1.4 J	2.2 J
1,2-DICHLOROBENZENE	0.5 U	0.5 U	0.5 U	0.5 U	0.5 U	0.5 U	0.5 U	0.5 U	0.5 U	0.5 U
1,2-DICHLOROETHANE	0.75 U	0.75 U	0.75 U	0.75 U	0.75 U	0.75 U	0.75 U	0.75 U	0.75 U	0.75 U
1,2-DICHLOROPROPANE	0.5 U	0.5 U	0.5 U	0.5 U	0.5 U	0.5 U	0.5 U	0.5 U	0.5 U	0.5 U
1,3-DICHLOROBENZENE	0.5 U	0.5 U	0.5 U	0.5 U	0.5 U	0.5 U	0.5 U	0.5 U	0.5 U	0.5 U
1,4-DICHLOROBENZENE	0.5 U	0.5 U	0.5 U	0.5 U	0.5 U	0.5 U	0.5 U	0.5 U	0.5 U	0.5 U
2-BUTANONE	2.5 U	2.5 U	2.5 U	2.5 U	2.5 U	2.5 U	2.5 U	2.5 U	2.5 U	2.5 U
2-HEXANONE	3.8 U	3.8 U	3.8 U	3.8 U	3.8 U	3.8 U	3.8 U	3.8 U	3.8 U	3.8 U
4-METHYL-2-PENTANONE	2.5 U	2.5 U	2.5 U	2.5 U	2.5 U	2.5 U	2.5 U	2.5 U	2.5 U	2.5 U
ACETONE	2.5 U	2.5 U	2.5 U	2.5 U	2.5 U	2.5 U	2.5 U	2.5 U	2.5 U	2.5 U
BENZENE	0.5 U	0.5 U	0.5 U	0.5 U	0.5 U	0.5 U	0.5 U	0.5 U	0.5 U	0.5 U
BROMODICHLOROMETHANE	0.5 U	0.5 U	0.5 U	0.5 U	0.5 U	0.5 U	0.5 U	0.5 U	0.5 U	0.5 U
BROMOFORM	0.5 U	0.5 U	0.5 U	0.5 U	0.5 U	0.5 U	0.5 U	0.5 U	0.5 U	0.5 U
BROMOMETHANE	3.8 U	3.8 U	3.8 U	3.8 U	3.8 U	3.8 U	3.8 U	3.8 U	3.8 U	3.8 U
CARBON DISULFIDE	0.5 U	0.5 U	0.5 U	0.5 U	0.5 U	0.5 U	0.5 U	0.5 U	0.5 U	0.5 U
CARBON TETRACHLORIDE	0.5 U	0.5 U	0.5 U	0.5 U	0.5 U	0.5 U	0.5 U	0.5 U	0.5 U	0.68 J
CHLOROBENZENE	0.5 U	0.5 U	0.5 U	0.5 U	0.5 U	0.5 U	0.5 U	0.5 U	0.5 U	0.5 U
CHLORODIBROMOMETHANE	0.5 U	0.5 U	0.5 U	0.5 U	0.5 U	0.5 U	0.5 U	0.5 U	0.5 U	0.5 U
CHLOROETHANE	0.5 U	0.5 U	0.5 U	0.5 U	0.5 U	0.5 U	0.5 U	0.5 U	0.5 U	0.5 U
CHLOROFORM	0.5 U	0.5 U	1.7 J	0.5 U	0.5 U	2 J	0.5 U	0.5 U	0.5 U	0.5 U
CHLOROMETHANE	0.5 U	0.5 U	0.5 U	0.5 U	0.5 U	0.5 U	0.5 U	0.5 U	0.5 U	0.5 U
CIS-1,2-DICHLOROETHENE	1.3 J	0.5 U	4.3 J	5.3	0.72 J	2 J	0.5 U	1.3 J	2.8 J	1.7 J
CIS-1,3-DICHLOROPROPENE	0.5 U	0.5 U	0.5 U	0.5 U	0.5 U	0.5 U	0.5 U	0.5 U	0.5 U	0.5 U
ETHYLBENZENE	0.5 U	0.5 U	0.5 U	0.5 U	0.5 U	0.5 U	0.5 U	0.5 U	0.5 U	0.5 U
ISOPROPYLBENZENE	0.5 U	0.5 U	0.5 U	0.5 U	0.5 U	0.5 U	0.5 U	0.5 U	0.5 U	0.5 U
M+P-XYLENES	1 U	1 U	1 U	1 U	1 U	1 U	1 U	1 U	1 U	1 U
METHYL CYCLOHEXANE	0.5 U	0.5 U	0.5 U	0.5 U	0.5 U	0.5 U	0.5 U	0.5 U	0.5 U	0.5 U
METHYL TERT-BUTYL ETHER	0.5 U	0.5 U	0.5 U	0.5 U	0.5 U	1.6 J	0.5 U	0.5 U	0.5 U	0.5 U
METHYLENE CHLORIDE	0.5 U	0.5 U	0.5 U	0.5 U	0.5 U	0.5 U	0.5 U	0.5 U	0.5 U	0.5 U
O-XYLENE	0.5 U	0.5 U	0.5 U	0.5 U	0.5 U	0.5 U	0.5 U	0.5 U	0.5 U	0.5 U
STYRENE	0.5 U	0.5 U	0.5 U	0.5 U	0.5 U	0.5 U	0.5 U	0.5 U	0.5 U	0.5 U
TETRACHLOROETHENE	0.83 J	1.6 J	13.6	14.1	5.6	3.1 J	0.5 U	1.1 J	4.3 J	0.5 U
TOLUENE	0.5 U	0.5 U	0.5 U	0.5 U	0.5 U	0.5 U	0.5 U	0.5 U	0.3 J	0.5 U
TRANS-1,2-DICHLOROETHENE	0.5 U	0.5 U	0.5 U	0.5 U	0.5 U	0.5 U	0.5 U	0.5 U	0.5 U	0.5 U
TRANS-1,3-DICHLOROPROPENE	0.5 U	0.5 U	0.5 U	0.5 U	0.5 U	0.5 U	0.5 U	0.5 U	0.5 U	0.5 U
TRICHLOROETHENE	450	2.5 J	200 J	120	17.7	110	2 J	67	230	89.9
TRICHLOROFLUOROMETHANE	0.5 U	0.5 U	0.5 U	0.5 U	0.5 U	0.5 U	0.5 U	0.5 U	0.5 U	0.5 U
VINYL CHLORIDE	0.5 U	0.5 U	0.5 U	0.5 U	0.5 U	0.5 U	0.5 U	0.5 U	0.5 U	0.5 U
METHOD 8270D (UG/L)										
1,4-DIOXANE	4.3	0.53	7.5	9	1.6	3.2	6.4	5.5	7.1	--
METHOD 8260 SIM (UG/L)										
1,4-DIOXANE	--	--	--	--	--	--	--	--	--	--
METHOD 522 (UG/L)										
1,4-DIOXANE	--	--	--	--	--	--	--	--	--	--

J = Estimated value.
 U = non-detect

Q1, 2020 (March) Validated Analytical Data
 Navy OU2 Groundwater Sampling
 Naval Weapons Industrial Reserve Plant Bethpage
 Page 6 of 7

LOCATION SAMPLE ID SAMPLE DATE DUPLICATE	RE132D6 RE132D6-20200304 03/04/2020	RE132D7 RE132D7-20200304 03/04/2020	RE134D1 RE134D1-20200305 03/05/2020	RE134D2 RE134D2-20200305 03/05/2020	RE134D2 RE134D2-20200305-D 03/05/2020 RE134D2-20200305	RE134D3 RE134D3-20200305 03/05/2020	RE134D4 RE134D4-20200305 03/05/2020	RE135D1 RE135D1-20200311 03/11/2020	RE135D2 RE135D2-20200311 03/11/2020	RE135D3 RE135D3-20200311 03/11/2020
VOLATILES (UG/L)										
1,1,1-TRICHLOROETHANE	0.75 U	0.75 U	0.75 U	0.75 U	0.75 U	0.75 U	0.75 U	0.75 U	0.75 U	0.75 U
1,1,2,2-TETRACHLOROETHANE	0.5 U	0.5 U	0.5 U	0.5 U	0.5 U	0.5 U	0.5 U	0.5 U	0.5 U	0.5 U
1,1,2-TRICHLOROETHANE	1.4 J	0.7 J	0.5 U	0.5 U	0.5 U	0.5 U	0.5 U	0.5 U	0.5 U	0.5 U
1,1,2-TRICHLOROTRIFLUOROETHANE	36.6	18.4	0.5 U	26.4	25	610	170	0.5 U	0.5 U	2.2 J
1,1-DICHLOROETHANE	2.4 J	1.1 J	0.5 U	0.5 U	0.5 U	0.5 U	0.5 U	0.5 U	0.5 U	0.5 U
1,1-DICHLOROETHENE	11.3	4.2 J	0.5 U	0.5 U	0.5 U	4.3 J	0.5 U	0.5 U	0.5 U	0.5 U
1,2-DICHLOROETHANE	0.5 U	0.5 U	0.5 U	0.5 U	0.5 U	0.5 U	0.5 U	0.5 U	0.5 U	0.5 U
1,2-DICHLOROETHANE	0.75 U	0.75 U	0.75 U	0.75 U	0.75 U	0.75 U	0.75 U	0.75 U	0.75 U	0.75 U
1,2-DICHLOROPROPANE	0.5 U	0.5 U	0.5 U	0.5 U	0.5 U	0.5 U	0.5 U	0.5 U	0.5 U	1.8 J
1,3-DICHLOROETHANE	0.5 U	0.5 U	0.5 U	0.5 U	0.5 U	0.5 U	0.5 U	0.5 U	0.5 U	0.5 U
1,4-DICHLOROETHANE	0.5 U	0.5 U	0.5 U	0.5 U	0.5 U	0.5 U	0.5 U	0.5 U	0.5 U	0.5 U
2-BUTANONE	2.5 U	2.5 U	2.5 U	2.5 U	2.5 U	2.5 U	2.5 U	2.5 U	2.5 U	2.5 U
2-HEXANONE	3.8 U	3.8 U	3.8 U	3.8 U	3.8 U	3.8 U	3.8 U	3.8 U	3.8 U	3.8 U
4-METHYL-2-PENTANONE	2.5 U	2.5 U	2.5 U	2.5 U	2.5 U	2.5 U	2.5 U	2.5 U	2.5 U	2.5 U
ACETONE	2.5 U	2.5 U	2.5 U	2.5 U	2.5 U	2.5 U	2.5 U	2.5 U	2.5 U	2.5 U
BENZENE	0.5 U	0.5 U	0.5 U	0.5 U	0.5 U	0.5 U	0.5 U	0.5 U	0.5 U	0.5 U
BROMODICHLOROMETHANE	0.5 U	0.5 U	0.5 U	0.5 U	0.5 U	0.5 U	0.5 U	0.5 U	0.5 U	0.5 U
BROMOFORM	0.5 U	0.5 U	0.5 U	0.5 U	0.5 U	0.5 U	0.5 U	0.5 U	0.5 U	0.5 U
BROMOMETHANE	3.8 U	3.8 U	3.8 U	3.8 U	3.8 U	3.8 U	3.8 U	3.8 U	3.8 U	3.8 U
CARBON DISULFIDE	0.5 U	0.5 U	0.5 U	0.5 U	0.5 U	0.5 U	0.5 U	0.5 U	0.5 U	0.5 U
CARBON TETRACHLORIDE	1.6 J	1.3 J	0.5 U	0.5 U	0.5 U	0.5 U	0.5 U	0.5 U	0.5 U	0.5 U
CHLOROBENZENE	0.5 U	0.5 U	0.5 U	0.5 U	0.5 U	0.5 U	0.5 U	0.5 U	0.5 U	0.5 U
CHLORODIBROMOMETHANE	0.5 U	0.5 U	0.5 U	0.5 U	0.5 U	0.5 U	0.5 U	0.5 U	0.5 U	0.5 U
CHLOROETHANE	0.5 U	0.5 U	0.5 U	0.5 U	0.5 U	0.5 U	0.5 U	0.5 U	0.5 U	0.5 U
CHLOROFORM	1.6 J	1.6 J	0.5 U	0.5 U	0.5 U	0.5 U	0.5 U	1.4 J	0.5 U	0.5 U
CHLOROMETHANE	0.5 U	0.5 U	0.5 U	0.5 U	0.5 U	0.5 U	0.5 U	0.5 U	0.5 U	0.5 U
CIS-1,2-DICHLOROETHENE	4.3 J	2.4 J	0.5 U	2 J	2.2 J	4.2 J	0.88 J	0.5 U	0.5 U	2.6 J
CIS-1,3-DICHLOROPROPENE	0.5 U	0.5 U	0.5 U	0.5 U	0.5 U	0.5 U	0.5 U	0.5 U	0.5 U	0.5 U
ETHYLBENZENE	0.5 U	0.5 U	0.5 U	0.5 U	0.5 U	0.5 U	0.5 U	0.5 U	0.5 U	0.5 U
ISOPROPYLBENZENE	0.5 U	0.5 U	0.5 U	0.5 U	0.5 U	0.5 U	0.5 U	0.5 U	0.5 U	0.5 U
M+P-XYLENES	1 U	1 U	1 U	1 U	1 U	1 U	1 U	1 U	1 U	1 U
METHYL CYCLOHEXANE	0.5 U	0.5 U	0.5 U	0.5 U	0.5 U	0.5 U	0.5 U	0.5 U	0.5 U	0.5 U
METHYL TERT-BUTYL ETHER	0.5 U	0.5 U	0.5 U	0.5 U	0.5 U	0.5 U	0.5 U	0.5 U	0.5 U	0.5 U
METHYLENE CHLORIDE	0.5 U	0.5 U	0.5 U	0.5 U	0.5 U	0.5 U	0.5 U	0.5 U	0.5 U	0.5 U
O-XYLENE	0.5 U	0.5 U	0.5 U	0.5 U	0.5 U	0.5 U	0.5 U	0.5 U	0.5 U	0.5 U
STYRENE	0.5 U	0.5 U	0.5 U	0.5 U	0.5 U	0.5 U	0.5 U	0.5 U	0.5 U	0.5 U
TETRACHLOROETHENE	3.8 J	1.4 J	1 J	15.1	15	60.6	6.4	0.5 U	0.5 U	3.7 J
TOLUENE	0.5 U	0.5 U	0.5 U	0.5 U	0.5 U	0.5 U	0.5 U	0.5 U	0.5 U	0.5 U
TRANS-1,2-DICHLOROETHENE	0.5 U	0.5 U	0.5 U	0.5 U	0.5 U	0.5 U	0.5 U	0.5 U	0.5 U	0.5 U
TRANS-1,3-DICHLOROPROPENE	0.5 U	0.5 U	0.5 U	0.5 U	0.5 U	0.5 U	0.5 U	0.5 U	0.5 U	0.5 U
TRICHLOROETHENE	1800	750	6	120	120	180	22.6	0.59 J	0.5 U	8
TRICHLOROFLUOROMETHANE	0.5 U	0.5 U	0.5 U	0.5 U	0.5 U	0.5 U	0.5 U	0.5 U	0.5 U	0.5 U
VINYL CHLORIDE	0.5 U	0.5 U	0.5 U	0.5 U	0.5 U	0.5 U	0.5 U	0.5 U	0.5 U	0.5 U
METHOD 8270D (UG/L)										
1,4-DIOXANE	5.8	1.5	0.57	10.3	9.7	8.5	1.4	0.3	0.14	0.16
METHOD 8260 SIM (UG/L)										
1,4-DIOXANE	--	--	--	--	--	--	--	--	--	--
METHOD 522 (UG/L)										
1,4-DIOXANE	--	--	--	--	--	--	--	--	--	--

J = Estimated value.
 U = non-detect

Q1, 2020 (March) Validated Analytical Data
 Navy OU2 Groundwater Sampling
 Naval Weapons Industrial Reserve Plant Bethpage
 Page 7 of 7

LOCATION SAMPLE ID SAMPLE DATE DUPLICATE	RE139D1 RE139D1-20200306 03/06/2020	RE139D2 RE139D2-20200306 03/06/2020	TT101D TT101D-20200310 03/10/2020	TT101D1 TT101D1-20200310 03/10/2020	TT101D2 TT101D2-20200310 03/10/2020
VOLATILES (UG/L)					
1,1,1-TRICHLOROETHANE	0.75 U	0.75 U	0.75 U	0.75 U	0.75 U
1,1,2,2-TETRACHLOROETHANE	0.5 U	0.5 U	0.5 U	0.5 U	0.5 U
1,1,2-TRICHLOROETHANE	0.86 J	0.7 J	0.5 U	0.78 J	0.99 J
1,1,2-TRICHLOROTRIFLUOROETHANE	2.9 J	1.9 J	10.7	18.6	28.2
1,1-DICHLOROETHANE	0.5 U	0.5 U	0.5 U	1.3 J	1.5 J
1,1-DICHLOROETHENE	1.9 J	1.8 J	2.2 J	7.1	7.2
1,2-DICHLOROBENZENE	0.5 U	0.5 U	0.5 U	0.5 U	0.5 U
1,2-DICHLOROETHANE	0.75 U	0.75 U	0.75 U	0.75 U	0.75 U
1,2-DICHLOROPROPANE	0.5 U	0.5 U	0.5 U	0.5 U	0.5 U
1,3-DICHLOROBENZENE	0.5 U	0.5 U	0.5 U	0.5 U	0.5 U
1,4-DICHLOROBENZENE	0.5 U	0.5 U	0.5 U	0.5 U	0.5 U
2-BUTANONE	2.5 U	2.5 U	2.5 U	2.5 U	2.5 U
2-HEXANONE	3.8 U	3.8 U	3.8 U	3.8 U	3.8 U
4-METHYL-2-PENTANONE	2.5 U	2.5 U	2.5 U	2.5 U	2.5 U
ACETONE	2.5 U	2.5 U	2.5 U	2.5 U	2.5 U
BENZENE	0.5 U	0.5 U	0.5 U	0.5 U	0.5 U
BROMODICHLOROMETHANE	0.5 U	0.5 U	0.5 U	0.5 U	0.5 U
BROMOFORM	0.5 U	0.5 U	0.5 U	0.5 U	0.5 U
BROMOMETHANE	3.8 U	3.8 U	3.8 U	3.8 U	3.8 U
CARBON DISULFIDE	0.5 U	0.5 U	0.5 U	0.5 U	0.5 U
CARBON TETRACHLORIDE	0.69 J	1.4 J	0.5 U	1.4 J	1.5 J
CHLOROBENZENE	0.5 U	0.5 U	0.5 U	0.5 U	0.5 U
CHLORODIBROMOMETHANE	0.5 U	0.5 U	0.5 U	0.5 U	0.5 U
CHLOROETHANE	0.5 U	0.5 U	0.5 U	0.5 U	0.5 U
CHLOROFORM	0.5 U	0.5 U	0.5 U	0.5 U	1.2 J
CHLOROMETHANE	0.5 U	0.5 U	0.5 U	0.5 U	0.5 U
CIS-1,2-DICHLOROETHENE	1.1 J	1.5 J	3 J	2.4 J	2.7 J
CIS-1,3-DICHLOROPROPENE	0.5 U	0.5 U	0.5 U	0.5 U	0.5 U
ETHYLBENZENE	0.5 U	0.5 U	0.5 U	0.5 U	0.5 U
ISOPROPYLBENZENE	0.5 U	0.5 U	0.5 U	0.5 U	0.5 U
M+P-XYLENES	1 U	1 U	1 U	1 U	1 U
METHYL CYCLOHEXANE	0.5 U	0.5 U	0.5 U	0.5 U	0.5 U
METHYL TERT-BUTYL ETHER	0.5 U	0.5 U	0.5 U	0.5 U	0.5 U
METHYLENE CHLORIDE	0.5 U	0.5 U	0.5 U	0.5 U	0.5 U
O-XYLENE	0.5 U	0.5 U	0.5 U	0.5 U	0.5 U
STYRENE	0.5 U	0.5 U	0.5 U	0.5 U	0.5 U
TETRACHLOROETHENE	0.5 U	0.5 U	0.51 J	0.5 U	3 J
TOLUENE	0.5 U	0.5 U	0.5 U	0.5 U	0.5 U
TRANS-1,2-DICHLOROETHENE	0.5 U	0.5 U	0.5 U	0.5 U	0.5 U
TRANS-1,3-DICHLOROPROPENE	0.5 U	0.5 U	0.5 U	0.5 U	0.5 U
TRICHLOROETHENE	100	150	64.5	240	1100
TRICHLOROFLUOROMETHANE	0.5 U	0.5 U	0.36 J	0.5 U	0.5 U
VINYL CHLORIDE	0.5 U	0.5 U	0.5 U	0.5 U	0.5 U
METHOD 8270D (UG/L)					
1,4-DIOXANE	1.5	1.1	4.6	4.9	2.3
METHOD 8260 SIM (UG/L)					
1,4-DIOXANE	--	--	--	--	--
METHOD 522 (UG/L)					
1,4-DIOXANE	--	--	--	--	--

J = Estimated value.
 U = non-detect