

Pelton, Jason M (DEC)

From: Wu, Ernie <Ernie.Wu@tetrattech.com>
Sent: Friday, January 7, 2022 2:27 PM
To: Pelton, Jason M (DEC); Sullivan, James (HEALTH); Putnam, Robin (NASSAU); Azzam, Nidal; rlenz@oysterbay-ny.gov; Sokolowski, Scott C CIV
USN NAVFAC MIDLANT NOR (USA); Brayack, David; Francisco, Ben; Walls, Kristen; Varricchio, Vin
Subject: Q3, 2021 (Sept) Validated Data, OU2 Navy groundwater sampling
Attachments: Figure_BP_OU2 GW_Q3_2021.pdf; BP OU2 GW_Q3 2021_validated data.pdf

ATTENTION: This email came from an external source. Do not open attachments or click on links from unknown senders or unexpected emails.

All:

As per discussions between the Navy and NYSDEC, NYSDEC requested that the Navy submit the validated data as soon as the information is available. Please find attached, a pdf table of the Q3, 2021 (Sept) OU2 groundwater sampling data. The data includes VOCs and 1,4-dioxane results. A figure has also been included presenting the location of groundwater monitoring wells sampled.

Thanks,
Ernie

Ernie Wu | Project Manager | Environmental Scientist
Main: 757.461.3768 | Direct: 757.466.4901 | Fax: 757.461.4148
ernie.wu@tetrattech.com

Tetra Tech, Inc | Norfolk Office
Twin Oaks I, Suite 102, 5700 Lake Wright Drive | Norfolk, VA 23502 | www.tetrattech.com

PLEASE NOTE: This message, including any attachments, may include privileged, confidential and/or inside information. Any distribution or use of this communication by anyone other than the intended recipient is strictly prohibited and may be unlawful. If you are not the intended recipient, please notify the sender by replying to this message and then delete it from your system.

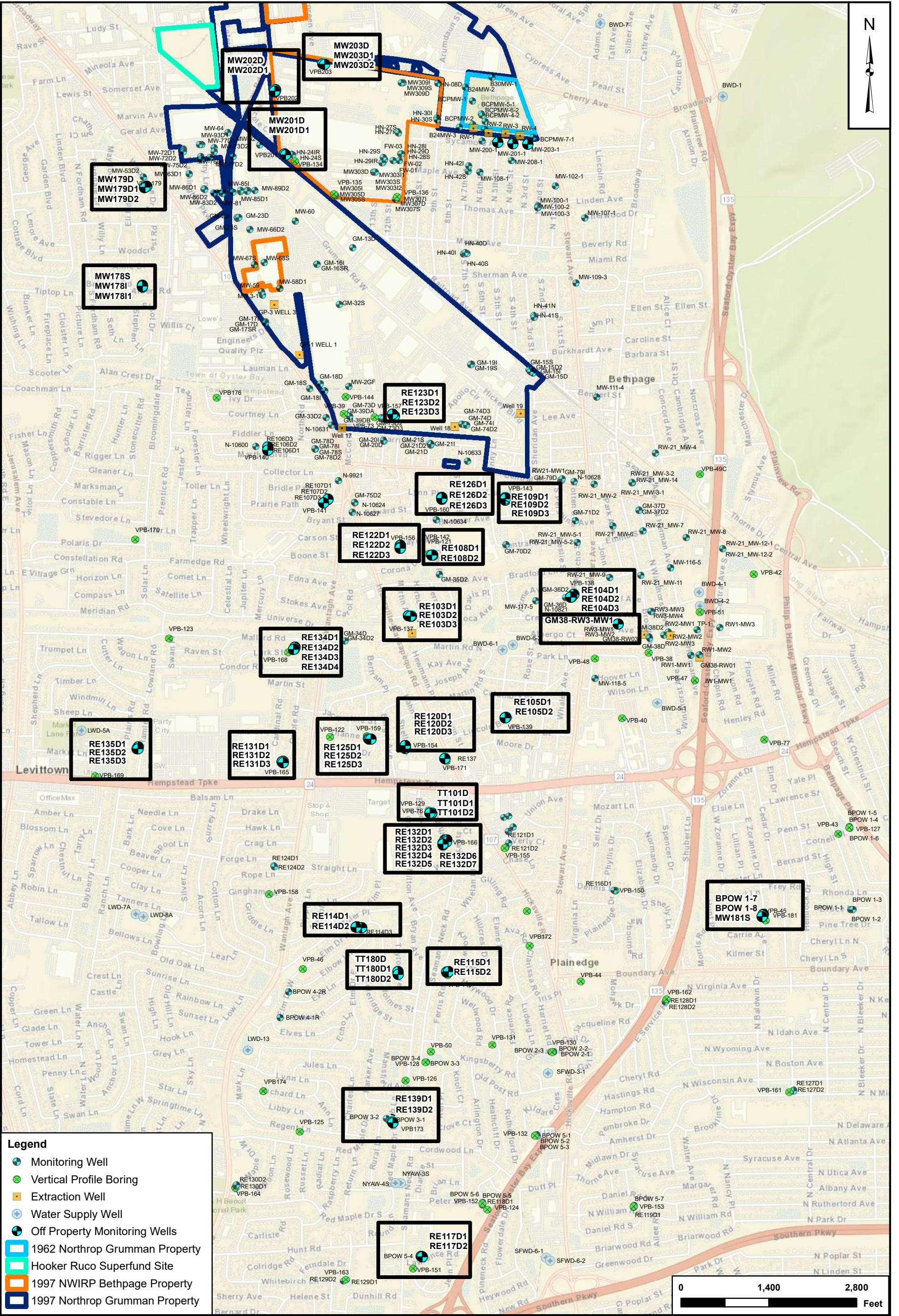

NOR PLGIS files\Bethpage\MAP.DOC\SMXD\BP_OU2_2020\WP_MWBP_ownership_2021_01.mxd\MCC

Legend

- Monitoring Well
- Vertical Profile Boring
- Extraction Well
- Water Supply Well
- Off Property Monitoring Wells
- 1962 Northrop Grumman Property
- Hooker Ruco Superfund Site
- 1997 NWIRP Bethpage Property
- 1997 Northrop Grumman Property

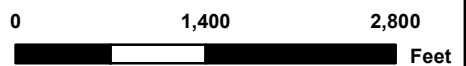

**LOCATION MAP OF WELLS
OU2 GROUNDWATER SAMPLING - SEPTEMBER 2021 EVENT
NAVAL WEAPONS INDUSTRIAL RESERVE PLANT
BETHPAGE, NEW YORK**

CTO	
N62470-16-D-9008 WE13	
DRAWN BY	DATE
MC	12/22/21
CHECKED BY	DATE
NS	12/22/21
FIGURE NUMBER	
2	

Q3, 2021 (September) Validated Analytical Data

Navy OU2 Groundwater Sampling

LOCATION SAMPLE ID SAMPLE DATE	BPOW1-7 BPOW1-7-20210914 09/14/2021	BPOW1-8 BPOW1-8-20210914 09/14/2021	BPS1-TT-MW201D MW201D-20210919 09/19/2021	BPS1-TT-MW201D1 MW201D1-20210919 09/19/2021	BPS1-TT-MW202D MW202D-20210918 09/18/2021	BPS1-TT-MW202D1 MW202D1-20210919 09/19/2021	BPS1-TT-MW203D MW203D-20210918 09/18/2021	BPS1-TT-MW203D1 MW203D1-20210918 09/18/2021
VOLATILES (UG/L)								
1,1,1-TRICHLOROETHANE	0.5 U	0.5 U	8	0.5 U	0.5 U	0.5 U	1.3	3.3
1,1,2,2-TETRACHLOROETHANE	0.75 U	0.75 U	0.75 U	0.75 U	0.75 U	0.75 U	0.75 U	0.75 U
1,1,2-TRICHLOROETHANE	0.5 U	0.5 U	0.47 J	0.5 U	0.5 U	0.5 U	0.5 U	0.5 U
1,1,2-TRICHLOROTRIFLUOROETHANE	0.5 U	0.5 U	4.7	0.5 U	0.5 U	0.5 U	0.5 U	0.5 U
1,1-DICHLOROETHANE	0.5 U	0.5 U	6	0.5 U	2	0.5 U	3.9	22.3
1,1-DICHLOROETHENE	0.75 U	0.75 U	75.1	0.75 U	0.94 J	0.75 U	1.9	8.7
1,2-DICHLOROBENZENE	0.5 U	0.5 U	0.5 U	0.5 U	0.5 U	0.5 U	0.5 U	0.5 U
1,2-DICHLOROETHANE	0.5 U	0.5 U	0.5 U	0.5 U	0.5 U	0.5 U	0.5 U	0.5 U
1,2-DICHLOROPROPANE	0.5 U	0.5 U	0.5 U	0.5 U	0.5 U	0.5 U	0.5 U	0.5 U
1,3-DICHLOROBENZENE	0.5 U	0.5 U	0.5 U	0.5 U	0.5 U	0.5 U	0.5 U	0.5 U
1,4-DICHLOROBENZENE	0.5 U	0.5 U	0.5 U	0.5 U	0.5 U	0.5 U	0.5 U	0.5 U
2-BUTANONE	2.5 U	2.5 U	2.5 U	2.5 U	2.5 U	2.5 U	2.5 U	2.5 U
2-HEXANONE	2.5 U	2.5 U	2.5 U	2.5 U	2.5 U	2.5 U	2.5 U	2.5 U
4-METHYL-2-PENTANONE	2.5 U	2.5 U	2.5 U	2.5 U	2.5 U	2.5 U	2.5 U	2.5 U
ACETONE	2.2 J	3 J	5 U	5 U	3.8 U	5 U	3.8 U	3.8 U
BENZENE	0.5 U	0.5 U	0.5 U	0.5 U	0.5 U	0.5 U	0.5 U	0.5 U
BROMODICHLOROMETHANE	0.25 U	0.25 U	0.25 U	0.25 U	0.25 U	0.25 U	0.25 U	0.25 U
BROMOFORM	0.5 U	0.5 U	0.5 U	0.5 U	0.5 U	0.5 U	0.5 U	0.5 U
BROMOMETHANE	2.5 U	2.5 U	2.5 U	2.5 U	2.5 U	2.5 U	2.5 U	2.5 U
CARBON DISULFIDE	0.75 U	0.75 U	0.75 U	0.75 U	0.75 U	0.75 U	0.75 U	0.75 U
CARBON TETRACHLORIDE	0.75 U	0.75 U	0.75 U	0.75 U	0.75 U	0.75 U	0.75 U	0.75 U
CHLOROBENZENE	0.5 U	0.5 U	0.5 U	0.5 U	0.5 U	0.5 U	0.5 U	0.5 U
CHLORODIBROMOMETHANE	0.5 U	0.5 U	0.5 U	0.5 U	0.5 U	0.5 U	0.5 U	0.5 U
CHLOROETHANE	0.75 U	0.75 U	0.75 U	0.75 U	0.75 UJ	0.75 U	0.75 UJ	0.75 UJ
CHLOROFORM	0.75 U	0.75 U	6.5	0.75 U	0.39 J	0.75 U	0.81 J	1.1
CHLOROMETHANE	0.75 U	0.75 U	0.75 U	0.75 U	0.75 U	0.75 U	0.75 U	0.75 U
CIS-1,2-DICHLOROETHENE	0.75 U	0.75 U	4.2	0.75 U	5.7	0.75 U	3.8	1
CIS-1,3-DICHLOROPROPENE	0.5 U	0.5 U	0.5 U	0.5 U	0.5 U	0.5 U	0.5 U	0.5 U
ETHYLBENZENE	0.5 U	0.5 U	0.5 U	0.5 U	0.5 U	0.5 U	0.5 U	0.5 U
ISOPROPYLBENZENE	0.5 U	0.5 U	0.5 U	0.5 U	0.5 U	0.5 U	0.5 U	0.5 U
M+P-XYLENES	1 U	1 U	1 U	1 U	1 U	1 U	1 U	1 U
METHYL CYCLOHEXANE	0.5 U	0.5 U	0.5 U	0.5 U	0.5 U	0.5 U	0.5 U	0.5 U
METHYL TERT-BUTYL ETHER	0.5 U	0.5 U	0.5 U	0.5 U	0.55 J	0.5 U	0.5 U	0.47 J
METHYLENE CHLORIDE	0.5 U	0.5 U	0.5 U	0.5 U	0.5 U	0.5 U	0.5 U	0.5 U
O-XYLENE	0.5 U	0.5 U	0.5 U	0.5 U	0.5 U	0.5 U	0.5 U	0.5 U
STYRENE	0.5 U	0.5 U	0.5 U	0.5 U	0.5 U	0.5 U	0.5 U	0.5 U
TETRACHLOROETHENE	0.5 U	0.5 U	140	0.45 J	12.3	0.68 J	0.93 J	1.4
TOLUENE	0.5 U	0.5 U	0.5 U	0.5 U	0.5 U	0.5 U	0.5 U	0.5 U
TRANS-1,2-DICHLOROETHENE	0.5 U	0.5 U	0.5 U	0.5 U	0.5 U	0.5 U	0.5 U	0.5 U
TRANS-1,3-DICHLOROPROPENE	0.5 U	0.5 U	0.5 U	0.5 U	0.5 U	0.5 U	0.5 U	0.5 U
TRICHLOROETHENE	0.5 U	0.5 U	120	1.2	31.2	0.56 J	20.7	7.7
TRICHLOROFLUOROMETHANE	0.5 U	0.5 U	190	0.5 U	1.9	0.5 U	0.5 U	0.5 U
VINYL CHLORIDE	0.5 U	0.5 U	0.5 U	0.5 U	0.5 U	0.5 U	0.5 U	0.5 U
METHOD 8270D (UG/L)								
1,4-DIOXANE	0.2 U	0.2 U	5.5	0.2 U	0.36	0.2 U	0.37	1.4
METHOD 8260 SIM (UG/L)								
1,4-DIOXANE	--	--	--	--	--	--	--	--
METHOD 522 (UG/L)								
1,4-DIOXANE	--	--	--	--	--	--	--	--

UG/L - micrograms per liter

J - estimated value

U - non-detect

UJ - non-detect

Q3, 2021 (September) Validated Analytical Data

Navy OU2 Groundwater Sampling

LOCATION SAMPLE ID SAMPLE DATE	BPS1-TT-MW203D2 MW203D2-20210918 09/18/2021	BP-TT-MW178I MW178I-20210921 09/21/2021	BP-TT-MW178I1 MW178I1-20210921 09/21/2021	BP-TT-MW178S MW178S-20210921 09/21/2021	BP-TT-MW179D MW179D-20210915 09/15/2021	BP-TT-MW179D1 MW179D1-20210916 09/16/2021	BP-TT-MW179D2 MW179D2-20210915 09/15/2021	BP-TT-MW180D TT180D-20210915 09/15/2021
VOLATILES (UG/L)								
1,1,1-TRICHLOROETHANE	0.5 U	0.5 U	0.5 U	0.5 U	0.5 U	0.5 U	0.67 J	0.5 U
1,1,2,2-TETRACHLOROETHANE	0.75 U	0.75 U	0.75 U	0.75 U	0.75 U	0.75 U	0.75 U	0.75 U
1,1,2-TRICHLOROETHANE	0.5 U	0.5 U	0.5 U	0.5 U	0.5 U	0.5 U	0.5 U	0.5 U
1,1,2-TRICHLOROTRIFLUOROETHANE	0.5 U	0.5 U	0.5 U	0.5 U	0.5 U	0.5 U	0.5 U	0.46 J
1,1-DICHLOROETHANE	3.8	0.5 U	0.5 U	0.5 U	0.5 U	0.5 U	0.5 U	0.5 U
1,1-DICHLOROETHENE	0.93 J	0.75 U	2.8	0.75 U	0.75 U	0.75 U	2.5	0.75 U
1,2-DICHLOROBENZENE	0.5 U	0.5 U	0.5 U	0.5 U	0.5 U	0.5 U	0.5 U	0.5 U
1,2-DICHLOROETHANE	0.5 U	0.5 U	0.5 U	0.5 U	0.5 U	0.5 U	0.5 U	0.5 U
1,2-DICHLOROPROPANE	0.5 U	0.5 U	23	0.5 U	0.5 U	0.5 U	1.1	0.5 U
1,3-DICHLOROBENZENE	0.5 U	0.5 U	0.5 U	0.5 U	0.5 U	0.5 U	0.5 U	0.5 U
1,4-DICHLOROBENZENE	0.5 U	0.5 U	0.5 U	0.5 U	0.5 U	0.5 U	0.5 U	0.5 U
2-BUTANONE	2.5 U	2.5 U	2.5 U	2.5 U	2.5 U	2.5 U	2.5 U	2.5 U
2-HEXANONE	2.5 U	2.5 U	2.5 U	2.5 U	2.5 UJ	2.5 U	2.5 U	2.5 U
4-METHYL-2-PENTANONE	2.5 U	2.5 U	2.5 U	2.5 U	2.5 U	2.5 U	2.5 U	2.5 U
ACETONE	3.8 U	3.8 U	3.8 U	3.8 U	3.8 U	3.8 U	3.8 U	3.8 U
BENZENE	0.5 U	0.5 U	0.5 U	0.5 U	0.5 U	0.5 U	0.5 U	0.5 U
BROMODICHLOROMETHANE	0.25 U	0.25 U	0.25 U	0.25 U	0.25 U	0.25 U	0.25 U	0.25 U
BROMOFORM	0.5 U	0.5 U	0.5 U	0.5 U	0.5 U	0.5 U	0.5 U	0.5 U
BROMOMETHANE	2.5 U	2.5 U	2.5 U	2.5 U	2.5 U	2.5 U	2.5 U	2.5 U
CARBON DISULFIDE	0.75 U	0.75 U	0.75 U	0.75 U	0.75 U	0.75 U	0.75 U	0.75 U
CARBON TETRACHLORIDE	0.75 U	0.75 U	0.75 U	0.75 U	0.75 U	0.75 U	0.75 U	0.75 U
CHLOROBENZENE	0.5 U	0.5 U	0.5 U	0.5 U	0.5 U	0.5 U	0.5 U	0.5 U
CHLORODIBROMOMETHANE	0.5 U	0.5 U	0.5 U	0.5 U	0.5 U	0.5 U	0.5 U	0.5 U
CHLOROETHANE	0.75 UJ	0.75 U	0.75 U	0.75 U	0.75 U	0.75 UJ	0.75 U	0.75 U
CHLOROFORM	0.35 J	0.75 U	0.75 U	0.75 U	0.75 U	0.75 U	0.75 U	0.75 U
CHLOROMETHANE	0.75 U	0.75 U	0.75 U	0.75 U	0.75 U	0.75 U	0.75 U	0.75 U
CIS-1,2-DICHLOROETHENE	0.75 J	0.75 U	37.5	0.75 U	21.9 J+	11.7	34	0.75 U
CIS-1,3-DICHLOROPROPENE	0.5 U	0.5 U	0.5 U	0.5 U	0.5 U	0.5 U	0.5 U	0.5 U
ETHYLBENZENE	0.5 U	0.5 U	0.5 U	0.5 U	0.5 U	0.5 U	0.5 U	0.5 U
ISOPROPYLBENZENE	0.5 U	0.5 U	0.5 U	0.5 U	0.5 U	0.5 U	0.5 U	0.5 U
M+P-XYLENES	1 U	1 U	1 U	1 U	1 U	1 U	1 U	1 U
METHYL CYCLOHEXANE	0.5 U	0.5 U	0.5 U	0.5 U	0.5 U	0.5 U	0.5 U	0.5 U
METHYL TERT-BUTYL ETHER	0.5 U	0.48 J	0.5 U	0.85 J	0.5 U	0.32 J	0.5 U	0.5 U
METHYLENE CHLORIDE	0.5 U	0.5 U	0.5 U	0.5 U	0.5 U	0.5 U	0.5 U	0.5 U
O-XYLENE	0.5 U	0.5 U	0.5 U	0.5 U	0.5 U	0.5 U	0.5 U	0.5 U
STYRENE	0.5 U	0.5 U	0.5 U	0.5 U	0.5 U	0.5 U	0.5 U	0.5 U
TETRACHLOROETHENE	0.34 J	0.3 J	26.4	0.5 U	15.2	10.5	18.1	0.5 U
TOLUENE	0.5 U	0.5 U	0.5 U	0.5 U	0.5 U	0.5 U	0.5 U	0.5 U
TRANS-1,2-DICHLOROETHENE	0.5 U	0.5 U	0.5 U	0.5 U	0.5 U	0.5 U	0.5 U	0.5 U
TRANS-1,3-DICHLOROPROPENE	0.5 U	0.5 U	0.5 U	0.5 U	0.5 U	0.5 U	0.5 U	0.5 U
TRICHLOROETHENE	0.73 J	0.78 J	420	0.33 J	81.8 J+	110	180 J+	2.4
TRICHLOROFLUOROMETHANE	0.5 U	0.5 U	0.5 U	0.5 U	0.5 U	0.5 U	0.5 U	0.5 U
VINYL CHLORIDE	0.5 U	0.5 U	0.5 U	0.5 U	0.5 U	0.5 U	0.5 U	0.5 U
METHOD 8270D (UG/L)								
1,4-DIOXANE	0.63	0.14 J	1.1	0.18 J	0.12 J	0.21	1.3	0.14 J
METHOD 8260 SIM (UG/L)								
1,4-DIOXANE	--	--	--	--	--	--	--	--
METHOD 522 (UG/L)								
1,4-DIOXANE	--	--	--	--	--	--	--	--

UG/L - micrograms per liter

J - estimated value

U - non-detect

UJ - non-detect

Q3, 2021 (September) Validated Analytical Data
Navy OU2 Groundwater Sampling
 Page 3 of 10

LOCATION SAMPLE ID SAMPLE DATE	BP-TT-MW180D1 TT180D1-20210915 09/15/2021	BP-TT-MW180D2 TT180D2-20210915 09/15/2021	BP-TT-MW181S MW181S-20210914 09/14/2021	GM38-RW3-MW1 GM38-RW3-MW1-20210921 09/21/2021	RE103D1 RE103D1-20210920 09/20/2021	RE103D2 RE103D2-20210920 09/20/2021	RE103D3 RE103D3-20210920 09/20/2021	RE104D1 RE104D1-20210921 09/21/2021
VOLATILES (UG/L)								
1,1,1-TRICHLOROETHANE	0.5 UJ	2	0.52 J	0.5 UJ	0.5 UJ	0.5 U	0.5 U	0.5 U
1,1,2,2-TETRACHLOROETHANE	0.75 UJ	0.75 U	0.75 U	0.75 UJ	0.75 UJ	0.75 U	0.75 U	0.75 U
1,1,2-TRICHLOROETHANE	0.6 J-	1.1	0.5 U	0.5 UJ	0.41 J	0.5 U	0.5 U	0.5 U
1,1,2-TRICHLOROTRIFLUOROETHANE	2 J-	33.3	0.5 U	0.5 UJ	9.5 J	2.7	6.9	0.76 J
1,1-DICHLOROETHANE	0.5 UJ	2	0.88 J	0.5 UJ	0.5 UJ	0.5 U	0.5 U	0.5 U
1,1-DICHLOROETHENE	1.1 J-	20.8	0.69 J	0.75 UJ	3.5 J	0.49 J	0.62 J	0.75 U
1,2-DICHLOROBENZENE	0.5 UJ	0.5 U	0.5 U	0.5 UJ	0.5 UJ	0.5 U	0.5 U	0.5 U
1,2-DICHLOROETHANE	0.5 UJ	0.49 J	0.5 U	0.5 UJ	0.5 UJ	0.5 U	0.5 U	0.5 U
1,2-DICHLOROPROPANE	0.5 UJ	0.5 U	0.5 U	0.5 UJ	0.5 UJ	0.5 U	0.5 U	0.5 U
1,3-DICHLOROBENZENE	0.5 UJ	0.5 U	0.5 U	0.5 UJ	0.5 UJ	0.5 U	0.5 U	0.5 U
1,4-DICHLOROBENZENE	0.5 UJ	0.5 U	0.5 U	0.5 UJ	0.5 UJ	0.5 U	0.5 U	0.5 U
2-BUTANONE	2.5 UJ	2.5 U	2.5 U	2.5 UJ	2.5 UJ	2.5 U	2.5 U	2.5 U
2-HEXANONE	2.5 UJ	2.5 U	2.5 U	2.5 UJ	2.5 UJ	2.5 U	2.5 U	2.5 U
4-METHYL-2-PENTANONE	2.5 UJ	2.5 U	2.5 U	2.5 UJ	2.5 UJ	2.5 U	2.5 U	2.5 U
ACETONE	3.8 UJ	3.8 U	2.4 J	3.8 UJ	3.8 UJ	5 U	5 U	3.8 U
BENZENE	0.5 UJ	0.5 U	0.5 U	0.5 UJ	0.5 UJ	0.5 U	0.5 U	0.5 U
BROMODICHLOROMETHANE	0.25 UJ	0.25 U	0.25 U	0.25 UJ	0.25 UJ	0.25 U	0.25 U	0.25 U
BROMOFORM	0.5 UJ	0.5 U	0.5 U	0.5 UJ	0.5 UJ	0.5 U	0.5 U	0.5 U
BROMOMETHANE	2.5 UJ	2.5 U	2.5 U	2.5 UJ	2.5 UJ	2.5 U	2.5 U	2.5 U
CARBON DISULFIDE	0.75 UJ	0.75 U	0.75 U	0.75 UJ	0.75 UJ	0.75 U	0.75 U	0.75 U
CARBON TETRACHLORIDE	0.75 UJ	1.9	0.75 U	0.75 UJ	0.75 UJ	0.75 U	0.75 U	0.75 U
CHLOROBENZENE	0.5 UJ	0.5 U	0.5 U	0.5 UJ	0.5 UJ	0.5 U	0.5 U	0.5 U
CHLORODIBROMOMETHANE	0.5 UJ	0.5 U	0.5 U	0.5 UJ	0.5 UJ	0.5 U	0.5 U	0.5 U
CHLOROETHANE	0.75 UJ	0.75 U	0.75 U	0.75 UJ	0.75 UJ	0.75 U	0.75 U	0.75 U
CHLOROFORM	0.67 J-	0.79 J	0.78 J	0.75 UJ	0.52 J	0.56 J	0.57 J	0.75 U
CHLOROMETHANE	0.75 UJ	0.75 U	0.4 J	0.75 UJ	0.75 UJ	0.75 U	0.75 U	0.75 U
CIS-1,2-DICHLOROETHENE	0.88 J-	2.6	1.5	0.75 UJ	2.9 J	0.73 J	1.1	0.75 U
CIS-1,3-DICHLOROPROPENE	0.5 UJ	0.5 U	0.5 U	0.5 UJ	0.5 UJ	0.5 U	0.5 U	0.5 U
ETHYLBENZENE	0.5 UJ	0.5 U	0.5 U	0.5 UJ	0.5 UJ	0.5 U	0.5 U	0.5 U
ISOPROPYLBENZENE	0.5 UJ	0.5 U	0.5 U	0.5 UJ	0.5 UJ	0.5 U	0.5 U	0.5 U
M+P-XYLENES	1 UJ	1 U	1 U	1 UJ	1 UJ	1 U	1 U	1 U
METHYL CYCLOHEXANE	0.5 UJ	0.5 U	0.5 U	0.5 UJ	0.5 UJ	0.5 U	0.5 U	0.5 U
METHYL TERT-BUTYL ETHER	0.5 UJ	0.5 U	0.31 J	0.5 UJ	0.5 UJ	0.5 U	0.5 U	0.5 U
METHYLENE CHLORIDE	0.5 UJ	0.5 U	0.5 U	0.5 UJ	0.5 UJ	0.5 U	0.5 U	0.5 U
O-XYLENE	0.5 UJ	0.5 U	0.5 U	0.5 UJ	0.5 UJ	0.5 U	0.5 U	0.5 U
STYRENE	0.5 UJ	0.5 U	0.5 U	0.5 UJ	0.5 UJ	0.5 U	0.5 U	0.5 U
TETRACHLOROETHENE	0.5 UJ	0.26 J	1.8	1.4 J	7.1 J	0.79 J	1.1	1.8
TOLUENE	0.5 UJ	0.5 U	0.5 U	0.5 UJ	0.5 UJ	0.5 U	0.5 U	0.5 U
TRANS-1,2-DICHLOROETHENE	0.5 UJ	0.5 U	0.5 U	0.5 UJ	0.5 UJ	0.5 U	0.5 U	0.5 U
TRANS-1,3-DICHLOROPROPENE	0.5 UJ	0.5 U	0.5 U	0.5 UJ	0.5 UJ	0.5 U	0.5 U	0.5 U
TRICHLOROETHENE	81.7 J-	250 J	1.9	16.9 J	710 J	460 J	520	29.7
TRICHLOROFLUOROMETHANE	0.5 UJ	0.41 J	0.5 U	0.5 UJ	0.38 J	0.5 U	0.5 U	0.5 U
VINYL CHLORIDE	0.5 UJ	0.5 U	0.5 U	0.5 UJ	0.5 UJ	0.5 U	0.5 U	0.5 U
METHOD 8270D (UG/L)								
1,4-DIOXANE	2.3	3.5	0.18 J	2.4	4.5	0.94 J	0.52	3.4
METHOD 8260 SIM (UG/L)								
1,4-DIOXANE	--	--	--	--	--	--	--	--
METHOD 522 (UG/L)								
1,4-DIOXANE	--	--	--	--	--	--	--	--

UG/L - micrograms per liter
 J - estimated value
 U - non-detect
 UJ - non-detect

Q3, 2021 (September) Validated Analytical Data

Navy OU2 Groundwater Sampling

LOCATION SAMPLE ID SAMPLE DATE	RE104D2 RE104D2-20210921 09/21/2021	RE104D3 RE104D3-20210921 09/21/2021	RE105D1 RE105D1-20210917 09/17/2021	RE105D2 RE105D2-20210917 09/17/2021	RE108D1 RE108D1-20210917 09/17/2021	RE108D2 RE108D2-20210917 09/17/2021	RE109D1 RE109D1-20210922 09/22/2021	RE109D2 RE109D2-20210922 09/22/2021
VOLATILES (UG/L)								
1,1,1-TRICHLOROETHANE	0.5 U	0.5 U	0.5 U	5 U	0.5 U	5 U	0.5 U	0.5 U
1,1,2,2-TETRACHLOROETHANE	0.75 U	0.75 U	0.75 U	7.5 U	0.75 U	7.5 U	0.75 U	0.75 U
1,1,2-TRICHLOROETHANE	0.5 U	0.5 U	0.5 U	5 U	0.5 U	5 U	0.5 U	0.5 U
1,1,2-TRICHLOROTRIFLUOROETHANE	0.5 U	0.5 U	4.1	16	0.65 J	4.9 J	0.5 U	0.66 J
1,1-DICHLOROETHANE	0.5 U	0.5 U	0.5 U	5 U	0.5 U	5 U	0.5 U	0.5 U
1,1-DICHLOROETHENE	0.75 U	0.75 U	0.46 J	6.6 J	0.75 U	5.2 J	0.75 U	0.75 U
1,2-DICHLOROBENZENE	0.5 U	0.5 U	0.5 U	5 U	0.5 U	5 U	0.5 U	0.5 U
1,2-DICHLOROETHANE	0.66 J	0.5 U	0.5 U	5 U	0.5 U	5 U	0.5 U	0.5 U
1,2-DICHLOROPROPANE	0.5 U	0.5 U	0.5 U	5 U	0.5 U	5 U	0.5 U	0.5 U
1,3-DICHLOROBENZENE	0.5 U	0.5 U	0.5 U	5 U	0.5 U	5 U	0.5 U	0.5 U
1,4-DICHLOROBENZENE	0.5 U	0.5 U	0.5 U	5 U	0.5 U	5 U	0.5 U	0.5 U
2-BUTANONE	2.5 U	2.5 U	2.5 U	25 U	2.5 U	25 U	2.5 U	2.5 U
2-HEXANONE	2.5 U	2.5 U	2.5 U	25 U	2.5 U	25 U	2.5 U	2.5 U
4-METHYL-2-PENTANONE	2.5 U	2.5 U	2.5 U	25 U	2.5 U	25 U	2.5 U	2.5 U
ACETONE	3.8 U	3.8 U	3.8 U	37.5 U	3.8 U	37.5 U	3.8 U	3.8 U
BENZENE	0.5 U	0.5 U	0.5 U	5 U	0.5 U	5 U	0.5 U	0.5 U
BROMODICHLOROMETHANE	0.25 U	0.25 U	0.25 U	2.5 U	0.25 U	2.5 U	0.25 U	0.25 U
BROMOFORM	0.5 U	0.5 U	0.5 U	5 U	0.5 U	5 U	0.5 U	0.5 U
BROMOMETHANE	2.5 U	2.5 U	2.5 U	25 U	2.5 U	25 U	2.5 U	2.5 U
CARBON DISULFIDE	0.75 U	0.75 U	0.75 U	7.5 U	0.75 U	7.5 U	0.75 U	0.75 U
CARBON TETRACHLORIDE	0.75 U	0.75 U	0.75 U	7.5 U	0.75 U	7.5 U	0.75 U	0.75 U
CHLOROBENZENE	0.5 U	0.5 U	0.5 U	5 U	0.5 U	5 U	0.5 U	0.5 U
CHLORODIBROMOMETHANE	0.5 U	0.5 U	0.5 U	5 U	0.5 U	5 U	0.5 U	0.5 U
CHLOROETHANE	0.75 U	0.75 U	0.75 UJ	7.5 UJ	0.75 UJ	7.5 U	0.75 U	0.75 U
CHLOROFORM	0.98 J	0.75 U	0.75 U	7.5 U	0.75 U	7.5 U	0.75 U	0.75 U
CHLOROMETHANE	0.75 U	0.75 U	0.75 U	7.5 U	0.75 U	7.5 U	0.75 U	0.75 U
CIS-1,2-DICHLOROETHENE	13.4	0.75 U	0.95 J	7.5 U	0.75 U	6.3 J	0.75 U	0.75 U
CIS-1,3-DICHLOROPROPENE	0.5 U	0.5 U	0.5 U	5 U	0.5 U	5 U	0.5 U	0.5 U
ETHYLBENZENE	0.5 U	0.5 U	0.5 U	5 U	0.5 U	5 U	0.5 U	0.5 U
ISOPROPYLBENZENE	0.5 U	0.5 U	0.5 U	5 U	0.5 U	5 U	0.5 U	0.5 U
M+P-XYLENES	1 U	1 U	1 U	10 U	1 U	10 U	1 U	1 U
METHYL CYCLOHEXANE	0.5 U	0.5 U	0.5 U	5 U	0.5 U	5 U	0.5 U	0.5 U
METHYL TERT-BUTYL ETHER	0.5 U	0.5 U	0.5 U	5 U	0.5 U	5 U	0.5 U	0.5 U
METHYLENE CHLORIDE	0.5 U	0.5 U	0.5 U	9.2 J	0.5 U	11.8	0.5 U	0.5 U
O-XYLENE	0.5 U	0.5 U	0.5 U	5 U	0.5 U	5 U	0.5 U	0.5 U
STYRENE	0.5 U	0.5 U	0.5 U	5 U	0.5 U	5 U	0.5 U	0.5 U
TETRACHLOROETHENE	0.5 U	0.5 U	0.92 J	3.5 J	1.7	4.5 J	0.6 J	0.49 J
TOLUENE	0.5 U	0.5 U	0.5 U	5 U	0.5 U	5 U	0.5 U	0.5 U
TRANS-1,2-DICHLOROETHENE	0.88 J	0.5 U	0.5 U	5 U	0.5 U	5 U	0.5 U	0.5 U
TRANS-1,3-DICHLOROPROPENE	0.5 U	0.5 U	0.5 U	5 U	0.5 U	5 U	0.5 U	0.5 U
TRICHLOROETHENE	93.2	0.27 J	120	1100	38.8	2300	11.6	24.1
TRICHLOROFLUOROMETHANE	0.5 U	0.5 U	0.5 U	5 U	0.5 U	5 U	0.5 U	0.5 U
VINYL CHLORIDE	0.5 U	0.5 U	0.5 U	5 U	0.5 U	5 U	0.5 U	0.5 U
METHOD 8270D (UG/L)								
1,4-DIOXANE	1.2	0.21 U	3.7	3.9	3.4	2.9	2.8	3.1
METHOD 8260 SIM (UG/L)								
1,4-DIOXANE	--	--	--	--	--	--	--	--
METHOD 522 (UG/L)								
1,4-DIOXANE	--	--	--	--	--	--	--	--

UG/L - micrograms per liter

J - estimated value

U - non-detect

UJ - non-detect

Q3, 2021 (September) Validated Analytical Data
Navy OU2 Groundwater Sampling
Page 5 of 10

LOCATION SAMPLE ID SAMPLE DATE	RE109D3 RE109D3-20210922 09/22/2021	RE114D1 RE114D1-20210916 09/16/2021	RE114D2 RE114D2-20210916 09/16/2021	RE115D1 RE115D1-20210916 09/16/2021	RE115D2 RE115D2-20210916 09/16/2021	RE117D1 RE117D1-20210914 09/14/2021	RE117D2 RE117D2-20210914 09/14/2021	RE120D1 RE120D1-20210917 09/17/2021
VOLATILES (UG/L)								
1,1,1-TRICHLOROETHANE	0.5 U	0.45 J	0.5 U	0.5 J	2.1 J	0.5 U	0.5 U	0.5 U
1,1,2,2-TETRACHLOROETHANE	0.75 U	0.75 U	0.75 U	0.75 UJ	0.75 UJ	0.75 U	0.75 U	0.75 U
1,1,2-TRICHLOROETHANE	0.5 U	1.2	0.5 U	0.78 J	1.6 J	0.55 J	0.5 U	0.44 J
1,1,2-TRICHLOROTRIFLUOROETHANE	1.1	26.2	14.3	14.9 J	55.9 J	0.64 J	0.5 U	10.7
1,1-DICHLOROETHANE	0.5 U	1.4	0.5 U	0.87 J	3.2 J	0.5 U	0.5 U	0.5 U
1,1-DICHLOROETHENE	0.75 U	4.3	1	5.9 J	27.7 J	0.92 J	0.75 U	5.5
1,2-DICHLOROBENZENE	0.5 U	0.5 U	0.5 U	0.5 UJ	0.5 UJ	0.5 U	0.5 U	0.5 U
1,2-DICHLOROETHANE	0.5 U	0.5 U	0.5 U	0.5 UJ	0.53 J	0.5 U	0.5 U	0.5 U
1,2-DICHLOROPROPANE	0.5 U	0.5 U	0.5 U	0.5 UJ	0.5 UJ	0.5 U	0.5 U	0.5 U
1,3-DICHLOROBENZENE	0.5 U	0.5 U	0.5 U	0.5 UJ	0.5 UJ	0.5 U	0.5 U	0.5 U
1,4-DICHLOROBENZENE	0.5 U	0.5 U	0.5 U	0.5 UJ	0.5 UJ	0.5 U	0.5 U	0.5 U
2-BUTANONE	2.5 U	2.5 U	2.5 U	2.5 UJ	2.5 UJ	2.5 U	2.5 U	2.5 U
2-HEXANONE	2.5 U	2.5 U	2.5 U	2.5 UJ	2.5 UJ	2.5 U	2.5 U	2.5 U
4-METHYL-2-PENTANONE	2.5 U	2.5 U	2.5 U	2.5 UJ	2.5 UJ	2.5 U	2.5 U	2.5 U
ACETONE	3.8 U	3.8 U	3.8 U	3.8 UJ	3.8 UJ	2.9 J	5.1	5 U
BENZENE	0.5 U	0.5 U	0.5 U	0.5 UJ	0.5 UJ	0.5 U	0.5 U	0.5 U
BROMODICHLOROMETHANE	0.25 U	0.25 U	0.25 U	0.25 UJ	0.25 UJ	0.25 U	0.25 U	0.25 U
BROMOFORM	0.5 U	0.5 U	0.5 U	0.5 UJ	0.5 UJ	0.5 U	0.5 U	0.5 U
BROMOMETHANE	2.5 U	2.5 U	2.5 U	2.5 UJ	2.5 UJ	2.5 U	2.5 U	2.5 U
CARBON DISULFIDE	0.75 U	0.75 U	0.75 U	0.75 UJ	0.75 UJ	0.75 U	0.75 U	0.75 U
CARBON TETRACHLORIDE	0.35 J	1.9	0.75 U	2.1 J	2.7 J	1.3	0.75 U	0.75 U
CHLOROBENZENE	0.5 U	0.5 U	0.5 U	0.5 UJ	0.5 UJ	0.5 U	0.5 U	0.5 U
CHLORODIBROMOMETHANE	0.5 U	0.5 U	0.5 U	0.5 UJ	0.5 UJ	0.5 U	0.5 U	0.5 U
CHLOROETHANE	0.75 U	0.75 UJ	0.75 UJ	0.75 UJ	0.75 UJ	0.75 U	0.75 U	0.75 U
CHLOROFORM	0.75 U	2.1	0.51 J	1.8 J	1.4 J	0.36 J	0.75 U	0.33 J
CHLOROMETHANE	0.75 U	0.75 U	0.75 U	0.75 UJ	0.75 UJ	0.75 U	0.75 U	0.75 U
CIS-1,2-DICHLOROETHENE	0.38 J	5.5	1.7	2.1 J	3.9 J	1	0.75 U	2.2
CIS-1,3-DICHLOROPROPENE	0.5 U	0.5 U	0.5 U	0.5 UJ	0.5 UJ	0.5 U	0.5 U	0.5 U
ETHYLBENZENE	0.5 U	0.5 U	0.5 U	0.5 UJ	0.5 UJ	0.5 U	0.5 U	0.5 U
ISOPROPYLBENZENE	0.5 U	0.5 U	0.5 U	0.5 UJ	0.5 UJ	0.5 U	0.5 U	0.5 U
M+P-XYLENES	1 U	1 U	1 U	1 UJ	1 UJ	1 U	1 U	1 U
METHYL CYCLOHEXANE	0.5 U	0.5 U	0.5 U	0.5 UJ	0.5 UJ	0.5 U	0.5 U	0.5 U
METHYL TERT-BUTYL ETHER	0.5 U	0.5 U	0.5 U	0.5 UJ	0.5 UJ	0.5 U	0.5 U	0.5 U
METHYLENE CHLORIDE	0.5 U	0.5 U	0.5 U	0.5 UJ	0.5 UJ	0.5 U	0.5 U	0.5 U
O-XYLENE	0.5 U	0.5 U	0.5 U	0.5 UJ	0.5 UJ	0.5 U	0.5 U	0.5 U
STYRENE	0.5 U	0.5 U	0.5 U	0.5 UJ	0.5 UJ	0.5 U	0.5 U	0.5 U
TETRACHLOROETHENE	0.69 J	0.5 U	0.5 U	0.5 UJ	0.63 J	0.5 U	0.5 U	3.5
TOLUENE	0.5 U	0.5 U	0.5 U	0.5 UJ	0.5 UJ	0.5 U	0.5 U	0.5 U
TRANS-1,2-DICHLOROETHENE	0.5 U	0.5 U	0.5 U	0.5 UJ	0.5 UJ	0.5 U	0.5 U	0.5 U
TRANS-1,3-DICHLOROPROPENE	0.5 U	0.5 U	0.5 U	0.5 UJ	0.5 UJ	0.5 U	0.5 U	0.5 U
TRICHLOROETHENE	42.5	320	88.9	330	930	98	0.44 J	610
TRICHLOROFLUOROMETHANE	0.5 U	0.5 U	0.5 U	0.5 UJ	0.5 UJ	0.5 U	0.5 U	0.5 U
VINYL CHLORIDE	0.5 U	0.5 U	0.5 U	0.5 UJ	0.5 UJ	0.5 U	0.5 U	0.5 U
METHOD 8270D (UG/L)								
1,4-DIOXANE	2.9	3	2.7	4.2	5.1	0.34	0.2 U	4.8
METHOD 8260 SIM (UG/L)								
1,4-DIOXANE	--	--	--	--	--	--	--	24 J
METHOD 522 (UG/L)								
1,4-DIOXANE	--	--	--	--	--	--	--	27 J

UG/L - micrograms per liter
J - estimated value
U - non-detect
UJ - non-detect

Q3, 2021 (September) Validated Analytical Data

Navy OU2 Groundwater Sampling

LOCATION SAMPLE ID SAMPLE DATE	RE120D2 RE120D2-20210917 09/17/2021	RE120D3 RE120D3-20210917 09/17/2021	RE122D1 RE122D1-20210920 09/20/2021	RE122D2 RE122D2-20210920 09/20/2021	RE122D3 RE122D3-20210920 09/20/2021	RE123D1 RE123D1-20210918 09/18/2021	RE123D2 RE123D2-20210918 09/18/2021	RE123D3 RE123D3-20210918 09/18/2021
VOLATILES (UG/L)								
1,1,1-TRICHLOROETHANE	0.5 U	0.5 U	0.5 U	25 U	0.5 U	0.5 U	0.5 U	0.5 U
1,1,2,2-TETRACHLOROETHANE	0.75 U	0.75 U	0.75 U	37.5 U	0.75 U	0.75 U	0.75 U	0.75 U
1,1,2-TRICHLOROETHANE	0.5 U	0.5 U	0.5 U	25 U	0.5 U	0.5 U	0.5 U	0.5 U
1,1,2-TRICHLOROTRIFLUOROETHANE	17.9	0.5 U	4.2	25 U	0.5 U	0.5 U	0.5 U	0.5 U
1,1-DICHLOROETHANE	0.5 U	0.5 U	0.5 U	25 U	0.5 U	0.5 U	0.5 U	0.5 U
1,1-DICHLOROETHENE	2	0.75 U	1.1	37.5 U	0.75 U	0.75 U	0.75 U	0.75 U
1,2-DICHLOROBENZENE	0.5 U	0.5 U	0.5 U	25 U	0.5 U	0.5 U	0.5 U	0.5 U
1,2-DICHLOROETHANE	0.5 U	0.5 U	0.5 U	25 U	0.5 U	0.5 U	0.5 U	0.5 U
1,2-DICHLOROPROPANE	0.5 U	0.5 U	0.5 U	25 U	0.5 U	0.5 U	0.5 U	0.5 U
1,3-DICHLOROBENZENE	0.5 U	0.5 U	0.5 U	25 U	0.5 U	0.5 U	0.5 U	0.5 U
1,4-DICHLOROBENZENE	0.5 U	0.5 U	0.5 U	25 U	0.5 U	0.5 U	0.5 U	0.5 U
2-BUTANONE	2.5 U	2.5 U	2.5 U	130 U	2.5 U	2.5 U	2.5 U	2.5 U
2-HEXANONE	2.5 U	2.5 U	2.5 U	130 U	2.5 U	2.5 U	2.5 U	2.5 U
4-METHYL-2-PENTANONE	2.5 U	2.5 U	2.5 U	130 U	2.5 U	2.5 U	2.5 U	2.5 U
ACETONE	3.8 U	3.8 U	5 U	190 U	5 U	5 U	3.8 U	5 U
BENZENE	0.5 U	0.5 U	0.5 U	25 U	0.5 U	0.5 U	0.5 U	0.5 U
BROMODICHLOROMETHANE	0.25 U	0.25 U	0.25 U	12.5 U	0.25 U	0.25 U	0.25 U	0.25 U
BROMOFORM	0.5 U	0.5 U	0.5 U	25 U	0.5 U	0.5 U	0.5 U	0.5 U
BROMOMETHANE	2.5 U	2.5 U	2.5 U	130 U	2.5 U	2.5 U	2.5 U	2.5 U
CARBON DISULFIDE	0.75 U	0.75 U	0.75 U	37.5 U	0.75 U	0.75 U	0.75 U	0.75 U
CARBON TETRACHLORIDE	0.52 J	0.75 U	0.75 U	37.5 U	0.75 U	0.75 U	0.75 U	0.75 U
CHLOROBENZENE	0.5 U	0.5 U	0.5 U	25 U	0.5 U	0.5 U	0.5 U	0.5 U
CHLORODIBROMOMETHANE	0.5 U	0.5 U	0.5 U	25 U	0.5 U	0.5 U	0.5 U	0.5 U
CHLOROETHANE	0.75 UJ	0.75 UJ	0.75 U	37.5 U	0.75 U	0.75 U	0.75 U	0.75 U
CHLOROFORM	0.42 J	0.75 U	0.42 J	37.5 U	0.75 U	0.75 U	0.75 U	0.75 U
CHLOROMETHANE	0.75 U	0.75 U	0.75 U	37.5 U	0.75 U	0.75 U	0.75 U	0.75 U
CIS-1,2-DICHLOROETHENE	2.4	0.75 U	2.7	37.5 U	0.75 U	0.75 U	0.75 U	0.75 U
CIS-1,3-DICHLOROPROPENE	0.5 U	0.5 U	0.5 U	25 U	0.5 U	0.5 U	0.5 U	0.5 U
ETHYLBENZENE	0.5 U	0.5 U	0.5 U	25 U	0.5 U	0.5 U	0.5 U	0.5 U
ISOPROPYLBENZENE	0.5 U	0.5 U	0.5 U	25 U	0.5 U	0.5 U	0.5 U	0.5 U
M+P-XYLENES	1 U	1 U	1 U	50 U	1 U	1 U	1 U	1 U
METHYL CYCLOHEXANE	0.5 U	0.5 U	0.5 U	25 U	0.5 U	0.5 U	0.5 U	0.5 U
METHYL TERT-BUTYL ETHER	0.5 U	0.5 U	0.5 U	25 U	0.5 U	0.5 U	0.5 U	0.5 U
METHYLENE CHLORIDE	0.5 U	0.5 U	0.5 U	25 U	0.5 U	0.5 U	0.5 U	0.5 U
O-XYLENE	0.5 U	0.5 U	0.5 U	25 U	0.5 U	0.5 U	0.5 U	0.5 U
STYRENE	0.5 U	0.5 U	0.5 U	25 U	0.5 U	0.5 U	0.5 U	0.5 U
TETRACHLOROETHENE	5.9	0.5 U	1.9	25 U	0.5 U	0.5 U	1.4	0.5 U
TOLUENE	0.5 U	0.5 U	0.5 U	25 U	0.5 U	0.5 U	0.5 U	0.5 U
TRANS-1,2-DICHLOROETHENE	0.5 U	0.5 U	0.5 U	25 U	0.5 U	0.5 U	0.5 U	0.5 U
TRANS-1,3-DICHLOROPROPENE	0.5 U	0.5 U	0.5 U	25 U	0.5 U	0.5 U	0.5 U	0.5 U
TRICHLOROETHENE	510	28.3	630	4800	1.7	14.6	1.9	0.5 U
TRICHLOROFLUOROMETHANE	0.5 U	0.5 U	0.5 U	25 U	0.5 U	0.5 U	0.5 U	0.5 U
VINYL CHLORIDE	0.5 U	0.5 U	0.5 U	25 U	0.5 U	0.5 U	0.5 U	0.5 U
METHOD 8270D (UG/L)								
1,4-DIOXANE	4.8	0.13 J	3.7	4.8	0.2 U	1.4	0.54	0.21 U
METHOD 8260 SIM (UG/L)								
1,4-DIOXANE	18	0.54	--	--	--	--	--	--
METHOD 522 (UG/L)								
1,4-DIOXANE	23 J	0.63 J	--	--	--	--	--	--

UG/L - micrograms per liter

J - estimated value

U - non-detect

UJ - non-detect

Q3, 2021 (September) Validated Analytical Data
Navy OU2 Groundwater Sampling
 Page 7 of 10

LOCATION SAMPLE ID SAMPLE DATE	RE125D1 RE125D1-20210917 09/17/2021	RE125D2 RE125D2-20210917 09/17/2021	RE125D3 RE125D3-20210917 09/17/2021	RE126D1 RE126D1-20210920 09/20/2021	RE126D2 RE126D2-20210920 09/20/2021	RE126D3 RE126D3-20210920 09/20/2021	RE131D1 RE131D1-20210915 09/15/2021	RE131D2 RE131D2-20210915 09/15/2021
VOLATILES (UG/L)								
1,1,1-TRICHLOROETHANE	0.5 U	0.5 U	0.5 U	0.5 U	0.39 J	0.5 U	0.5 U	0.28 J
1,1,2,2-TETRACHLOROETHANE	0.75 U	0.75 U	0.75 U	0.75 U	0.75 U	0.75 U	0.75 U	0.75 U
1,1,2-TRICHLOROETHANE	0.5 U	0.31 J	0.5 U	0.5 U	0.5 U	0.5 U	0.5 U	0.5 U
1,1,2-TRICHLOROTRIFLUOROETHANE	8.7 J	14	85.5	0.5 U	0.9 J	0.5 U	4.3	240
1,1-DICHLOROETHANE	0.5 U	0.5 U	0.5 U	0.5 U	1 J	0.5 U	0.5 U	0.5 U
1,1-DICHLOROETHENE	2 J	4	0.75 U	0.75 U	1.5 J	0.75 U	1.1	3.3
1,2-DICHLOROBENZENE	0.5 U	0.5 U	0.5 U	0.5 U	0.5 U	0.5 U	0.5 U	0.5 U
1,2-DICHLOROETHANE	0.5 U	0.5 U	0.5 U	0.5 U	0.5 U	0.5 U	0.5 U	0.5 U
1,2-DICHLOROPROPANE	0.5 U	0.5 U	0.5 U	0.5 U	0.5 U	0.5 U	0.5 U	0.5 U
1,3-DICHLOROBENZENE	0.5 U	0.5 U	0.5 U	0.5 U	0.5 U	0.5 U	0.5 U	0.5 U
1,4-DICHLOROBENZENE	0.5 U	0.5 U	0.5 U	0.5 U	0.5 U	0.5 U	0.5 U	0.5 U
2-BUTANONE	2.5 U	2.5 U	2.5 U	2.5 U	2.5 U	2.5 U	2.5 U	2.5 U
2-HEXANONE	2.5 U	2.5 U	2.5 U	2.5 U	2.5 U	2.5 U	2.5 U	2.5 U
4-METHYL-2-PENTANONE	2.5 U	2.5 U	2.5 U	2.5 U	2.5 U	2.5 U	2.5 U	2.5 U
ACETONE	3.8 U	5 U	3.8 U	3.8 U	5 U	3.8 U	3.8 U	2.9 J
BENZENE	0.5 U	0.5 U	0.5 U	0.5 U	0.5 U	0.5 U	0.5 U	0.5 U
BROMODICHLOROMETHANE	0.25 U	0.25 U	0.25 U	0.25 U	0.25 U	0.25 U	0.25 U	0.25 U
BROMOFORM	0.5 U	0.5 U	0.5 U	0.5 U	0.5 U	0.5 U	0.5 U	0.5 U
BROMOMETHANE	2.5 U	2.5 U	2.5 U	2.5 U	2.5 U	2.5 U	2.5 U	2.5 U
CARBON DISULFIDE	0.75 U	0.75 U	0.75 U	0.75 U	0.75 U	0.75 U	0.75 U	0.75 U
CARBON TETRACHLORIDE	0.75 U	0.36 J	0.75 U	0.75 U	0.59 J	0.75 U	0.75 U	0.3 J
CHLOROBENZENE	0.5 U	0.5 U	0.5 U	0.5 U	0.5 U	0.5 U	0.5 U	0.5 U
CHLORODIBROMOMETHANE	0.5 U	0.5 U	0.5 U	0.5 U	0.5 U	0.5 U	0.5 U	0.5 U
CHLOROETHANE	0.75 UJ	0.75 U	0.75 UJ	0.75 U	0.75 U	0.75 U	0.75 U	0.75 U
CHLOROFORM	0.79 J	0.37 J	0.75 U	0.75 U	0.33 J	0.75 U	1.6	0.46 J
CHLOROMETHANE	0.75 U	0.75 U	0.75 U	0.75 U	0.75 U	0.75 U	0.75 U	0.75 U
CIS-1,2-DICHLOROETHENE	4.4 J	3.6	2.2	0.75 U	1.4 J	0.75 U	4.8	6.1
CIS-1,3-DICHLOROPROPENE	0.5 U	0.5 U	0.5 U	0.5 U	0.5 U	0.5 U	0.5 U	0.5 U
ETHYLBENZENE	0.5 U	0.5 U	0.5 U	0.5 U	0.5 U	0.5 U	0.5 U	0.5 U
ISOPROPYLBENZENE	0.5 U	0.5 U	0.5 U	0.5 U	0.5 U	0.5 U	0.5 U	0.5 U
M+P-XYLENES	1 U	1 U	1 U	1 U	1 U	1 U	1 U	1 U
METHYL CYCLOHEXANE	0.5 U	0.5 U	0.5 U	0.5 U	0.5 U	0.5 U	0.5 U	0.5 U
METHYL TERT-BUTYL ETHER	0.52 J	0.5 U	0.5 U	0.5 U	0.5 U	0.5 U	1.3	0.5 U
METHYLENE CHLORIDE	0.5 U	0.5 U	0.5 U	0.5 U	0.5 U	0.5 U	0.5 U	0.5 U
O-XYLENE	0.5 U	0.5 U	0.5 U	0.5 U	0.5 U	0.5 U	0.5 U	0.5 U
STYRENE	0.5 U	0.5 U	0.5 U	0.5 U	0.5 U	0.5 U	0.5 U	0.5 U
TETRACHLOROETHENE	10.6	5.5	7.7	0.86 J	0.84 J	0.8 J	15.7	13.9
TOLUENE	0.5 U	0.5 U	0.5 U	0.5 U	0.5 U	0.5 U	0.5 U	0.5 U
TRANS-1,2-DICHLOROETHENE	0.5 U	0.5 U	0.5 U	0.5 U	0.5 U	0.5 U	0.5 U	0.5 U
TRANS-1,3-DICHLOROPROPENE	0.5 U	0.5 U	0.5 U	0.5 U	0.5 U	0.5 U	0.5 U	0.5 U
TRICHLOROETHENE	200	250	160	26	470	1.1	250 J	140
TRICHLOROFLUOROMETHANE	0.5 U	0.5 U	0.5 U	0.5 U	0.5 U	0.5 U	0.26 J	0.5 U
VINYL CHLORIDE	0.5 U	0.5 U	0.5 U	0.5 U	0.5 U	0.5 U	0.5 U	0.5 U
METHOD 8270D (UG/L)								
1,4-DIOXANE	4.9	6.4	2.8	3	3.1	0.17 J	6.6	12.9
METHOD 8260 SIM (UG/L)								
1,4-DIOXANE	--	--	--	--	--	--	--	--
METHOD 522 (UG/L)								
1,4-DIOXANE	--	--	--	--	--	--	--	--

UG/L - micrograms per liter
 J - estimated value
 U - non-detect
 UJ - non-detect

Q3, 2021 (September) Validated Analytical Data

Navy OU2 Groundwater Sampling

LOCATION SAMPLE ID SAMPLE DATE	RE131D3 RE131D3-20210915 09/15/2021	RE132D1 RE132D1-20210914 09/14/2021	RE132D2 RE132D2-20210914 09/14/2021	RE132D3 RE132D3-20210914 09/14/2021	RE132D4 RE132D4-20210914 09/14/2021	RE132D5 RE132D5-20210914 09/14/2021	RE132D6 RE132D6-20210914 09/14/2021	RE132D7 RE132D7-20210914 09/14/2021
VOLATILES (UG/L)								
1,1,1-TRICHLOROETHANE	0.5 U	0.5 U	0.5 U	0.5 U	0.5 U	0.5 U	10 U	0.5 U
1,1,2,2-TETRACHLOROETHANE	0.75 U	0.75 U	0.75 U	0.75 U	0.75 U	0.75 U	15 U	0.75 U
1,1,2-TRICHLOROETHANE	0.5 U	0.5 U	0.5 U	0.5 U	0.5 U	0.5 U	10 U	0.82 J
1,1,2-TRICHLOROTRIFLUOROETHANE	420	5.9	4.6	4.1	7.4	11.8	28.2	22.7
1,1-DICHLOROETHANE	0.5 U	0.5 U	0.5 U	0.5 U	0.5 U	0.5 U	10 U	1.7
1,1-DICHLOROETHENE	3.5	1.2	0.4 J	0.75 U	1.5	2.5	13.9 J	7
1,2-DICHLOROBENZENE	0.5 U	0.5 U	0.5 U	0.5 U	0.5 U	0.5 U	10 U	0.5 U
1,2-DICHLOROETHANE	0.5 U	0.5 U	0.5 U	0.5 U	0.5 U	0.5 U	10 U	0.5 U
1,2-DICHLOROPROPANE	0.58 J	0.5 U	0.5 U	0.5 U	0.5 U	0.5 U	10 U	0.5 U
1,3-DICHLOROBENZENE	0.5 U	0.5 U	0.5 U	0.5 U	0.5 U	0.5 U	10 U	0.5 U
1,4-DICHLOROBENZENE	0.5 U	0.5 U	0.5 U	0.5 U	0.5 U	0.5 U	10 U	0.5 U
2-BUTANONE	2.5 U	2.5 U	2.5 U	2.5 U	2.5 U	2.5 U	50 U	2.5 U
2-HEXANONE	2.5 U	2.5 U	2.5 U	2.5 U	2.5 U	2.5 U	50 U	2.5 U
4-METHYL-2-PENTANONE	2.5 U	2.5 U	2.5 U	2.5 U	2.5 U	2.5 U	50 U	2.5 U
ACETONE	2.9 J	2.2 J	3 J	2.8 J	3 J	3.9 J	75 U	3.8 U
BENZENE	0.5 U	0.5 U	0.5 U	0.5 U	0.5 U	0.5 U	10 U	0.5 U
BROMODICHLOROMETHANE	0.25 U	0.25 U	0.25 U	0.25 U	0.25 U	0.25 U	5 U	0.25 U
BROMOFORM	0.5 U	0.5 U	0.5 U	0.5 U	0.5 U	0.5 U	10 U	0.5 U
BROMOMETHANE	2.5 U	2.5 U	2.5 U	2.5 U	2.5 U	2.5 U	50 U	2.5 U
CARBON DISULFIDE	0.75 U	0.75 U	0.75 U	0.75 U	0.75 U	0.75 U	15 U	0.75 U
CARBON TETRACHLORIDE	0.75 U	0.75 U	0.75 U	0.75 U	0.44 J	0.55 J	15 U	1.5
CHLOROBENZENE	0.5 U	0.5 U	0.5 U	0.5 U	0.5 U	0.5 U	10 U	0.5 U
CHLORODIBROMOMETHANE	0.5 U	0.5 U	0.5 U	0.5 U	0.5 U	0.5 U	10 U	0.5 U
CHLOROETHANE	0.75 U	0.75 U	0.75 U	0.75 U	0.75 U	0.75 U	15 U	0.75 U
CHLOROFORM	0.75 U	2.6	0.75 U	0.75 U	0.41 J	1.3	15 U	1.5
CHLOROMETHANE	0.75 U	0.75 U	0.75 U	0.75 U	0.38 J	0.75 U	15 U	0.75 U
CIS-1,2-DICHLOROETHENE	1.2	2.1	0.65 J	1.2	2.6	2.2	15 U	3.6
CIS-1,3-DICHLOROPROPENE	0.5 U	0.5 U	0.5 U	0.5 U	0.5 U	0.5 U	10 U	0.5 U
ETHYLBENZENE	0.5 U	0.5 U	0.5 U	0.5 U	0.5 U	0.5 U	10 U	0.5 U
ISOPROPYLBENZENE	0.5 U	0.5 U	0.5 U	0.5 U	0.5 U	0.5 U	10 U	0.5 U
M+P-XYLENES	1 U	1 U	1 U	1 U	1 U	1 U	20 U	1 U
METHYL CYCLOHEXANE	0.5 U	0.5 U	0.5 U	0.5 U	0.5 U	0.5 U	10 U	0.5 U
METHYL TERT-BUTYL ETHER	0.5 U	0.94 J	0.5 U	0.5 U	0.5 U	0.5 U	10 U	0.5 U
METHYLENE CHLORIDE	0.5 U	0.5 U	0.5 U	0.5 U	0.5 U	0.5 U	26.7	0.5 U
O-XYLENE	0.5 U	0.5 U	0.5 U	0.5 U	0.5 U	0.5 U	10 U	0.5 U
STYRENE	0.5 U	0.5 U	0.5 U	0.5 U	0.5 U	0.5 U	10 U	0.5 U
TETRACHLOROETHENE	11.7	3.5	0.5 U	3	5.5	0.5 U	10 U	2.5
TOLUENE	0.5 U	0.5 U	0.5 U	0.5 U	0.5 U	0.5 U	10 U	0.5 U
TRANS-1,2-DICHLOROETHENE	0.5 U	0.5 U	0.5 U	0.5 U	0.5 U	0.5 U	10 U	0.5 U
TRANS-1,3-DICHLOROPROPENE	0.5 U	0.5 U	0.5 U	0.5 U	0.5 U	0.5 U	10 U	0.5 U
TRICHLOROETHENE	30.8	130	5	100	230 J	140	1800	1500
TRICHLOROFLUOROMETHANE	0.5 U	0.5 U	0.5 U	0.5 U	0.3 J	0.5 U	10 U	0.5 U
VINYL CHLORIDE	0.5 U	0.5 U	0.5 U	0.5 U	0.5 U	0.5 U	10 U	0.5 U
METHOD 8270D (UG/L)								
1,4-DIOXANE	1.9	3.5	5	4	4.2	4.2	3.3	1.7
METHOD 8260 SIM (UG/L)								
1,4-DIOXANE	--	--	--	--	--	--	--	--
METHOD 522 (UG/L)								
1,4-DIOXANE	--	--	--	--	--	--	--	--

UG/L - micrograms per liter

J - estimated value

U - non-detect

UJ - non-detect

Q3, 2021 (September) Validated Analytical Data

Navy OU2 Groundwater Sampling

LOCATION SAMPLE ID SAMPLE DATE	RE134D1 RE134D1-20210916 09/16/2021	RE134D2 RE134D2-20210916 09/16/2021	RE134D3 RE134D3-20210916 09/16/2021	RE134D4 RE134D4-20210916 09/16/2021	RE135D1 RE135D1-20210915 09/15/2021	RE135D2 RE135D2-20210915 09/15/2021	RE135D3 RE135D3-20210915 09/15/2021	RE139D1 RE139D1-20210915 09/15/2021
VOLATILES (UG/L)								
1,1,1-TRICHLOROETHANE	0.5 U	0.5 U	0.5 UJ	0.5 UJ	0.5 U	0.5 U	0.5 U	0.31 J
1,1,2,2-TETRACHLOROETHANE	0.75 U	0.75 U	0.75 UJ	0.75 UJ	0.75 U	0.75 UJ	0.75 U	0.75 U
1,1,2-TRICHLOROETHANE	0.5 U	0.5 U	0.5 UJ	0.5 UJ	0.5 U	0.5 U	0.5 U	1.2
1,1,2-TRICHLOROTRIFLUOROETHANE	0.5 U	11.5 J+	230 J	210	0.5 U	0.5 U	7.1	7
1,1-DICHLOROETHANE	0.5 U	0.5 U	0.5 UJ	0.5 UJ	0.5 U	0.5 U	0.5 U	0.5 U
1,1-DICHLOROETHENE	0.75 U	0.75 U	3.2 J	2 J-	0.75 U	0.75 U	0.52 J	4
1,2-DICHLOROBENZENE	0.5 U	0.5 U	0.5 UJ	0.5 UJ	0.5 U	0.5 UJ	0.5 U	0.5 U
1,2-DICHLOROETHANE	0.5 U	0.5 U	0.5 UJ	0.5 UJ	0.5 U	0.5 U	0.5 U	0.5 UJ
1,2-DICHLOROPROPANE	0.5 U	0.5 U	0.49 J	0.5 UJ	0.5 U	2.7 J+	4.9	0.5 U
1,3-DICHLOROBENZENE	0.5 U	0.5 U	0.5 UJ	0.5 UJ	0.5 U	0.5 UJ	0.5 U	0.5 U
1,4-DICHLOROBENZENE	0.5 U	0.5 U	0.5 UJ	0.5 UJ	0.5 U	0.5 UJ	0.5 U	0.5 U
2-BUTANONE	2.5 U	2.5 U	2.5 UJ	2.5 UJ	2.5 U	2.5 U	2.5 U	2.5 U
2-HEXANONE	2.5 U	2.5 UJ	2.5 UJ	2.5 UJ	2.5 U	2.5 UJ	2.5 U	2.5 UJ
4-METHYL-2-PENTANONE	2.5 U	2.5 U	2.5 UJ	2.5 UJ	2.5 U	2.5 U	2.5 U	2.5 UJ
ACETONE	3.8 U	3.8 U	3.8 UJ	3.8 UJ	3.8 U	3.8 U	3.8 U	3.5 J
BENZENE	0.5 U	0.5 U	0.5 UJ	0.5 UJ	0.5 U	0.5 U	0.5 U	0.5 UJ
BROMODICHLOROMETHANE	0.25 U	0.25 U	0.25 UJ	0.25 UJ	0.25 U	0.25 U	0.25 U	0.25 U
BROMOFORM	0.5 U	0.5 U	0.5 UJ	0.5 UJ	0.5 U	0.5 U	0.5 U	0.5 U
BROMOMETHANE	2.5 U	2.5 U	2.5 UJ	2.5 UJ	2.5 U	2.5 U	2.5 U	2.5 U
CARBON DISULFIDE	0.75 U	0.75 UJ	0.75 UJ	0.75 UJ	0.75 U	0.75 U	0.75 U	0.75 U
CARBON TETRACHLORIDE	0.75 U	0.75 U	0.75 UJ	0.75 UJ	0.75 U	0.75 U	0.75 U	1.3 J
CHLOROBENZENE	0.5 U	0.5 U	0.5 UJ	0.5 UJ	0.5 U	0.5 U	0.5 U	0.5 U
CHLORODIBROMOMETHANE	0.5 U	0.5 U	0.5 UJ	0.5 UJ	0.5 U	0.5 U	0.5 U	0.5 U
CHLOROETHANE	0.75 U	0.75 U	0.75 UJ	0.75 UJ	0.75 U	0.75 U	0.75 U	0.75 U
CHLOROFORM	0.75 U	0.75 U	0.31 J	0.75 UJ	1.8	0.75 U	0.75 U	1
CHLOROMETHANE	0.75 U	0.75 U	0.75 UJ	0.75 UJ	0.75 U	0.75 U	0.75 U	0.75 U
CIS-1,2-DICHLOROETHENE	0.75 U	1.4 J+	1.2 J	0.96 J-	0.75 U	0.75 U	3.7	2.1
CIS-1,3-DICHLOROPROPENE	0.5 U	0.5 U	0.5 UJ	0.5 UJ	0.5 U	0.5 U	0.5 U	0.5 UJ
ETHYLBENZENE	0.5 U	0.5 U	0.5 UJ	0.5 UJ	0.5 U	0.5 U	0.5 U	0.5 U
ISOPROPYLBENZENE	0.5 U	0.5 U	0.5 UJ	0.5 UJ	0.5 U	0.5 UJ	0.5 U	0.5 U
M+P-XYLENES	1 U	1 U	1 UJ	1 UJ	1 U	1 U	1 U	1 U
METHYL CYCLOHEXANE	0.5 U	0.5 U	0.5 UJ	0.5 UJ	0.5 U	0.5 U	0.5 U	0.5 U
METHYL TERT-BUTYL ETHER	0.5 U	0.5 U	0.5 UJ	0.5 UJ	0.5 U	0.5 U	0.5 U	0.5 U
METHYLENE CHLORIDE	0.5 U	0.5 U	0.5 UJ	0.5 UJ	0.5 U	0.5 U	0.5 U	0.5 U
O-XYLENE	0.5 U	0.5 U	0.5 UJ	0.5 UJ	0.5 U	0.5 U	0.5 U	0.5 U
STYRENE	0.5 U	0.5 U	0.5 UJ	0.5 UJ	0.5 U	0.5 U	0.5 U	0.5 U
TETRACHLOROETHENE	0.47 J	6.3 J+	32 J	13.7 J-	0.5 U	0.5 U	22.4	0.5 U
TOLUENE	0.5 U	0.5 U	0.5 UJ	0.5 UJ	0.5 U	0.5 U	0.5 U	0.5 UJ
TRANS-1,2-DICHLOROETHENE	0.5 U	0.5 U	0.5 UJ	0.5 UJ	0.5 U	0.5 U	0.5 U	0.5 U
TRANS-1,3-DICHLOROPROPENE	0.5 U	0.5 U	0.5 UJ	0.5 UJ	0.5 U	0.5 U	0.5 U	0.5 U
TRICHLOROETHENE	4	65.5 J+	130 J	26 J-	0.35 J	0.5 U	18.2	180 J
TRICHLOROFLUOROMETHANE	0.5 U	0.5 U	0.5 UJ	0.5 UJ	0.5 U	0.5 U	0.5 U	0.5 U
VINYL CHLORIDE	0.5 U	0.5 U	0.5 UJ	0.5 UJ	0.5 U	0.5 U	0.5 U	0.5 U
METHOD 8270D (UG/L)								
1,4-DIOXANE	0.6	5.6	7.3	1.8	0.19 J	0.1 J	0.23	1.1 J
METHOD 8260 SIM (UG/L)								
1,4-DIOXANE	--	--	--	--	--	--	--	--
METHOD 522 (UG/L)								
1,4-DIOXANE	--	--	--	--	--	--	--	--

UG/L - micrograms per liter

J - estimated value

U - non-detect

UJ - non-detect

Q3, 2021 (September) Validated Analytical Data
Navy OU2 Groundwater Sampling
Page 10 of 10

LOCATION SAMPLE ID SAMPLE DATE	RE139D2 RE139D2-20210915 09/15/2021	TT101D TT101D-20210921 09/21/2021	TT101D1 TT101D1-20210921 09/21/2021	TT101D2 TT101D2-20210921 09/21/2021
VOLATILES (UG/L)				
1,1,1-TRICHLOROETHANE	0.24 J-	0.5 UJ	0.5 UJ	2.5 U
1,1,2,2-TETRACHLOROETHANE	0.75 UJ	0.75 UJ	0.75 U	3.8 U
1,1,2-TRICHLOROETHANE	0.7 J-	0.5 UJ	0.39 J	2.5 U
1,1,2-TRICHLOROTRIFLUOROETHANE	3.6 J-	9.3 J	10.9 J	14.4
1,1-DICHLOROETHANE	0.47 J-	0.5 UJ	0.5 U	2.5 U
1,1-DICHLOROETHENE	3.6 J-	1.9 J	4.6 J	4.9 J
1,2-DICHLOROBENZENE	0.5 UJ	0.5 UJ	0.5 U	2.5 U
1,2-DICHLOROETHANE	0.5 UJ	0.5 UJ	0.5 U	2.5 U
1,2-DICHLOROPROPANE	0.5 UJ	0.5 UJ	0.5 U	2.5 U
1,3-DICHLOROBENZENE	0.5 UJ	0.5 UJ	0.5 U	2.5 U
1,4-DICHLOROBENZENE	0.5 UJ	0.5 UJ	0.5 U	2.5 U
2-BUTANONE	2.5 UJ	2.5 UJ	2.5 U	12.5 U
2-HEXANONE	2.5 UJ	2.5 UJ	2.5 U	12.5 U
4-METHYL-2-PENTANONE	2.5 UJ	2.5 UJ	2.5 U	12.5 U
ACETONE	3.6 J-	3.8 UJ	3.8 U	18.8 U
BENZENE	0.5 UJ	0.5 UJ	0.5 U	2.5 U
BROMODICHLOROMETHANE	0.25 UJ	0.25 UJ	0.25 U	1.3 U
BROMOFORM	0.5 UJ	0.5 UJ	0.5 U	2.5 U
BROMOMETHANE	2.5 UJ	2.5 UJ	2.5 U	12.5 U
CARBON DISULFIDE	0.75 UJ	0.75 UJ	0.75 U	3.8 U
CARBON TETRACHLORIDE	1.7 J-	0.75 UJ	0.91 J	3.8 U
CHLOROBENZENE	0.5 UJ	0.5 UJ	0.5 U	2.5 U
CHLORODIBROMOMETHANE	0.5 UJ	0.5 UJ	0.5 U	2.5 U
CHLOROETHANE	0.75 UJ	0.75 UJ	0.75 U	3.8 U
CHLOROFORM	0.6 J-	0.35 J	0.76 J	3.8 U
CHLOROMETHANE	0.75 UJ	0.75 UJ	0.75 U	3.8 U
CIS-1,2-DICHLOROETHENE	2.1 J-	2.5 J	1.3 J	1.6 J
CIS-1,3-DICHLOROPROPENE	0.5 UJ	0.5 UJ	0.5 U	2.5 U
ETHYLBENZENE	0.5 UJ	0.5 UJ	0.5 U	2.5 U
ISOPROPYLBENZENE	0.5 UJ	0.5 UJ	0.5 U	2.5 U
M+P-XYLENES	1 UJ	1 UJ	1 U	5 U
METHYL CYCLOHEXANE	0.5 UJ	0.5 UJ	0.5 U	2.5 U
METHYL TERT-BUTYL ETHER	0.5 UJ	0.5 UJ	0.5 U	2.5 U
METHYLENE CHLORIDE	0.5 UJ	0.5 UJ	0.5 U	2.5 U
O-XYLENE	0.5 UJ	0.5 UJ	0.5 U	2.5 U
STYRENE	0.5 UJ	0.5 UJ	0.5 U	2.5 U
TETRACHLOROETHENE	0.5 UJ	0.76 J	0.5 U	2 J
TOLUENE	0.5 UJ	0.5 UJ	0.5 U	2.5 U
TRANS-1,2-DICHLOROETHENE	0.5 UJ	0.5 UJ	0.5 U	2.5 U
TRANS-1,3-DICHLOROPROPENE	0.5 UJ	0.5 UJ	0.5 U	2.5 U
TRICHLOROETHENE	180	87.5 J	160	1000
TRICHLOROFLUOROMETHANE	0.5 UJ	0.5 UJ	0.5 U	2.5 U
VINYL CHLORIDE	0.5 UJ	0.5 UJ	0.5 U	2.5 U
METHOD 8270D (UG/L)				
1,4-DIOXANE	0.88	5.1	4.5	2.7
METHOD 8260 SIM (UG/L)				
1,4-DIOXANE	--	--	--	--
METHOD 522 (UG/L)				
1,4-DIOXANE	--	--	--	--

UG/L - micrograms per liter
J - estimated value
U - non-detect
UJ - non-detect