



To: Lora Fly, DON, NAVFAC MIDLANT

From: Eleanor Vivaudou, P.E., Resolution Consultants

Subject: **Well Inventory Memorandum – Navy Owned Wells, NWIRP Bethpage**

Date: July 2015

Introduction

This memorandum documents the inventory of 92 groundwater monitoring wells for NWIRP Bethpage shown in Figure 1. The purpose of the well inventory was to locate, photograph, evaluate the physical condition of, and measure the groundwater level and depth of each well to assure that data collected from these wells is representative of subsurface conditions, and to evaluate the physical condition of each well.

The field portion of the inventory was conducted between May 20, 2014 and May 24, 2014 and included collecting the following categories of information:

1. Depth of well and depth to groundwater;
2. Physical condition of the well including presence of bolts, locks, well cover, and recommendations for repairs.

During field investigations at each site, depth to water was measured from the inner casing using an interface probe. The well depth was also measured with the interface probe from the ground surface to the well bottom.

Well Condition Log and Maintenance Recommendations

There are currently 92 Navy owned groundwater monitoring wells, as shown in Figure 1. During the inventory, the physical condition and repair recommendations of each monitoring well was noted with the following:

1. Good = no Repairs Needed
2. Fair = may need repair
3. R = need to repair; notes indicate condition needing repair (cracked concrete pad, loose well seal, missing/broken lock, bolts or jplug)
4. S = need to re-sound

Available pictures of the wells are presented in a photolog in Appendix A. Out of the 92 wells, 44 have been found to be physically compromised. Table 1 contains wells catalogued for recommended repairs or for re-sounding based on field observations.

Table 1
Well Inventory Data
NWIRP Bethpage NY

**Table 1
Well Inventory Data
NWIRP Bethpage, NY**

Photo	Well	Sys_loc_code	Installed Well Depth (ft bgs)	Installed Top of Screen (ft bgs)	Installed Bottom of Screen (ft bgs)	Date of Measurement	Measured Depth to Water (ft btoc)	Measured Well Depth (ft bgs)	Condition (as of) May 2014	Need to (R)epair; (S)ound	Notes	X coordinate (Easting)	Y coordinate (Northing)	Location
1	FW-01	BPS1FWMW01	64	NA	NA	5/20/2014	54.98	64.8	Good			1124935.345	213988.7167	NWIRP - South of Plant 3
2	FW-02	BPS1FWMW02	64	NA	NA	5/20/2014	55.61	65.2	Good			1124790	214004	NWIRP - South of Plant 3
3	FW-03	BPS1FWMW03	64	49	64	5/20/2014	59.13	69.1	Good			1124727.094	214030.2964	NWIRP - Site 1-south side
	HN-24I	BPHNMW24I	158	148	158	5/23/2014	50.6	156.8	Fair			1123266.02	214054.42	NWIRP
	HN-24S	BPHNMW24S	58.6	48.6	58.6	5/23/2014	50	57.6	Fair			1123275.862	214096.5348	NWIRP
4	HN-27I	BPHNMW27I	110	100	110	5/20/2014	54.85	114	Good			1124955.039	214484.21	NWIRP - Site 1
5	HN-27S	BPHNMW27S	54	44	54	5/20/2014	54.85	56.5	Good			1124935.344	214484.5667	NWIRP - Site 1
	HN-29I	BPHNMW29I	130	120	130	5/20/2014	44.95	129.6	Fair	R	pad cracked	1124698.062	213999.3849	NWIRP - North of south warehouse buildings
6A	HN-29D	BPHNMW29D	220	210	220	5/20/2014	45.18	225.2	Good			1124717.151	214004.8275	NWIRP - North of south warehouse buildings
6B	HN-40S	BPHNMW40S	NA	49	59	5/22/2014	47.7	58.8	Good			1126042.82	212474.1604	Meade Ct @ N 7th St
7	HN-40I	BPHNMW40I	NA	108	118	5/22/2014	47.6	121.4	Good			1126027.474	212469.4837	Meade Ct @ N 7th St
8	HN-42S	BPHNMW42I	60	50	60	5/22/2014	48.85	61.5	Good			1126067.16	213790.77	Maple Ave @N 7th St
9	HN-42I	BPHNMW42S	110	100	110	5/22/2014	49.21	112.5	Good			1126065.736	213879.1202	Maple Ave @N 7th St
10	TT-309D	BPS1-TT-MW-309D	262	252	262	5/20/2014	59.38	267	Good			1125028.364	215208.337	NWIRP - Site 2 north of former sludge dry beds northwest side
11	TT-309I	BPS1-TT-MW-309I	170	160	170	5/20/2014	59.32	174	Good			1125016.064	215209.976	NWIRP - Site 2 north of former sludge dry beds northwest side
12	TT-309S	BPS1-TT-MW-309S	63	40.5	50.5	5/20/2014	58.19	58.5	Good			1124997.76	215211.896	NWIRP - Site 2 north of former sludge dry beds northwest side
13	TT-313S	BPS1-TT-MW-313S	63	NA	NA	5/20/2014	56.6	65.8	Good			1125592.409	215155.071	NWIRP - Site 2 northeast side
14	TT-312S	BPS1-TT-MW-312S	163	NA	NA	5/23/2014	56.7	167	Good		Felt like interface probe was stuck; covered in silt	1125165.414	215322.487	NWIRP - Site 2 north west of northern recharge basin
	TT-312I	BPS1-TT-MW-312I	170	NA	NA	5/23/2014	56.4	173.5	Good			1125165.88	215327.826	NWIRP - Site 2 north west of northern recharge basin
16	TT-314I	BPS1-TT-MW-314I	154	NA	NA	5/20/2014	57.6	158	Good			1125572.919	214550.204	NWIRP - Site 2 southeast side
17	TT-314S	BPS1-TT-MW-314S	165	NA	NA	5/20/2014	57.15	168	Good			1125571.342	214555.397	NWIRP - Site 2 southeast side
18	TT-308D	BPS1-TT-MW-308D	260	NA	NA	5/20/2014	59.2	266.2	Good			1124935.523	214965.058	NWIRP - Site 2 north of southwestern pond
	TT-308I	BPS1-TT-MW-308I	166	NA	NA	5/20/2014	58.54	170.9	Good			1124925.431	214972.1544	NWIRP - Site 2 north of southwestern pond
	TT-308S	BPS1-TT-MW-308S	64	NA	NA	5/20/2014	58	68.1	Good			1124909.927	214978.217	NWIRP - Site 2 north of southwestern pond
21	TT-306S	BPS1-TT-MW306S	60	50	60	5/22/2014	47.52	64	Good			1124404.914	213381.4409	NWIRP - South of south warehouse buildings
22	TT-306I	BPS1-TT-MW306I	201	189	199	5/22/2014	48.12	203	Good			1124399.469	213381.956	NWIRP - South of south warehouse buildings
23	TT-306D	BPS1-TT-MW306D	294	284	294	5/22/2014	48.9	292.1	Good			1124409.879	213381.032	NWIRP - South of south warehouse buildings
24	TT-307S	BPS1-TT-MW307S	50.5	40.5	50.5	5/22/2014	44.48	50	Fair	R	Pad cracked	1124902.305	213350.889	NWIRP - Southeast of south warehouse buildings
25	TT-307I	BPS1-TT-MW307I	200	188	198	5/22/2014	45.1	200	Fair	R	Pad cracked	1124915.179	213353.948	NWIRP - Southeast of south warehouse buildings
26	TT-307D	BPS1-TT-MW307D	286	276	286	5/22/2014	45.5	285.38	Fair	R	Pad cracked; needs bolts	1124926.585	213357.39	NWIRP - Southeast of south warehouse buildings
27	TT-304D	BPS1-TT-MW304D	191	180	190	5/20/2014	46.9	191	Good			1124994.61	213691.8	NWIRP - East of south warehouse buildings, stick ups cut off

**Table 1
Well Inventory Data
NWIRP Bethpage, NY**

Photo	Well	Sys_loc_code	Installed Well Depth (ft bgs)	Installed Top of Screen (ft bgs)	Installed Bottom of Screen (ft bgs)	Date of Measurement	Measured Depth to Water (ft btoc)	Measured Well Depth (ft bgs)	Condition (as of) May 2014	Need to (R)epair; (S)ound	Notes	X coordinate (Easting)	Y coordinate (Northing)	Location
28	TT-30411	BPS1-TT-MW30411	112	102	112	5/20/2014	46.15	114	Good			1124995.39	213716.91	NWIRP - East of south warehouse buildings, stick ups cut off
29	TT-30412	BPS1-TT-MW30412	150	140	150	5/20/2014	46.6	151	Good			1124990.1	213705.7	NWIRP - East of south warehouse buildings, stick ups cut off
30	TT-304S	BPS1-TT-MW304S	53	43	53	5/20/2014	46.4	52	Good			1124991.39	213728.38	NWIRP - East of south warehouse buildings, stick ups cut off
	TT-305D	BPS1-TT-MW305D	300	286	296	NA	NA	NA	well not found			1123949.047	213406.292	NWIRP - Southeastern side of south warehouse buildings covered by soil pile
	TT-305I	BPS1-TT-MW305I	200	190	200	NA	NA	NA	well not found			1123939.648	213408.673	NWIRP - Southeastern side of south warehouse buildings covered by soil pile
	TT-305S	BPS1-TT-MW305S	50	40	50	NA	NA	NA	well not found			1123930.003	213411.314	NWIRP - Southeastern side of south warehouse buildings covered by soil pile
31	TT-301D	BPS1-TT-MW301D	220	NA	NA	5/20/2014	54.69	223	Good			1124880.908	214562.648	NWIRP - Site 1 northern side
32	TT-301I	BPS1-TT-MW301I	140	NA	NA	5/20/2014	53.4	140.5	Good			1124906.201	214566.279	NWIRP - Site 1 northern side
33	TT-301S	BPS1-TT-MW301S	61	NA	NA	5/20/2014	53.9	62.1	Good			1124865.194	214560.42	NWIRP - Site 1 northern side
34	TT-303D	BPS1-TT-MW303D	218	208	218	5/20/2014	45.75	211.3	Good			1124550.691	213779.29	NWIRP - Between south warehouse buildings on northeast corner
35	TT-30311	BPS1-TT-MW30311	105	95	105	5/20/2014	42.2	121	Good	S	DTB measured deeper	1124572.255	213778.636	NWIRP - Between south warehouse buildings on northeast corner
36	TT-30312	BPS1-TT-MW30312	156	146	156	5/20/2014	45.5	151	Good			1124562.054	213779.054	NWIRP - Between south warehouse buildings on northeast corner
37	TT-303S	BPS1-TT-MW303S	56	46	56	5/20/2014	45.3	51	Fair	R	Pad cracked	1124583.496	213778.188	NWIRP - Between south warehouse buildings on northeast corner
	MW-01	BPTTAOC22MW01	68	48	68	5/20/2014	51.93	57.15	Fair	R, S	OLM; needs bolts, locks, jplug	1123685.101	214049.1047	NWIRP - 39.4' from Al's trailer, 22.4' from fence
	MW-02	BPTTAOC22MW02	66	46	66	5/20/2014	52.6	52.6	Fair	R, S	needs bolts & locks	1123715.055	214058.1533	NWIRP - Site 2, beware OLM
38	MW-03	BPTTAOC22MW03	65.5	45.5	65.5	5/20/2014	59.1	66.4	Good	S		1123680.109	214136.7829	NWIRP - Site 2, northern side
39	MW-04	BPTTAOC22MW04	66	46	66	5/21/2014	51.57	68	Good	S		1123645.162	214018.5265	NWIRP - Site 2 on northwestern corner of office building
	MW-05	BPTTAOC22MW05	67	47	67	5/20/2014	NA	NA	decommissioned			1123702.574	214173.9136	NWIRP decommissioned
40	MW-06	BPTTAOC22MW06	62	52	62	5/20/2014	47.2	63.1	Fair	R	needs bolts	1123745.67	213898.45	NWIRP - In lot behind SVE building
41	MW-07	BPTTAOC22MW07	62	52	62	5/20/2014	47	63.4	Good			1123660.55	213883.97	NWIRP - In lot behind SVE building
42	MW-08	BPTTAOC22MW08	62	52	62	5/20/2014	47	62.9	Fair	R	needs bolts	1123576.06	213932.1	NWIRP - In lot behind SVE building
43	MW-09	BPTTAOC22MW09	62	52	62	5/20/2014	48.27	63.3	Fair	R	needs bolts, pad cracked	1123539.24	214008.07	NWIRP - In lot behind SVE building
44	MW-10	BPTTAOC22MW10	60	49	59	5/20/2014	45.56	60	Fair	R	Pad cracked	1123833.4	213950.8	NWIRP - Northwest corner of south warehouse buildings
45	MW-11	BPTTAOC22MW11	64	53	63	5/20/2014	49.35	65.1	Fair	R	needs bolts	1123547.95	214145.5	NWIRP - In road just west of Site 4
46	BPOW 5-1	BPOW 5-1	527	480	510	5/21/2014	21.6	528	Fair	R	needs bolts & locks	1127145.842	198399.79	Kildare Crescent in cul-de-sac
47	BPOW 5-2	BPOW 5-2	598	540	580	5/21/2014	24.7	599.4	Fair	R	needs bolts & locks	1127152.768	198410.857	Kildare Crescent in cul-de-sac
48	BPOW 5-3	BPOW 5-3	680	620	660	5/21/2014	21.57	683	Fair	R	needs bolts & locks	1127156.801	198389.891	Kildare Crescent in cul-de-sac
49	TT-101D		363	325	345	5/21/2014	31.25	355	Fair	R, S	needs locks	1125462.038	203545.488	Emerson Ave
50	TT-101D1		603	570	590	5/21/2014	33.1	609	Fair	R, S	needs locks	1125484.11	203545.086	Emerson Ave
51	TT-101D2		777	740	760	5/21/2014	33.65	784	Fair	R, S	needs locks	1125454.308	203545.377	Emerson Ave
52	TT-102D		618	560	600	5/21/2014	19.45	623.4	Fair	R	needs locks; ARCADIS on site having bladder pump issues	1127148.911	195341.937	Between Alken Ave & Southern State Pkwy inside sump

**Table 1
Well Inventory Data
NWIRP Bethpage, NY**

Photo	Well	Sys_loc_code	Installed Well Depth (ft bgs)	Installed Top of Screen (ft bgs)	Installed Bottom of Screen (ft bgs)	Date of Measurement	Measured Depth to Water (ft btoc)	Measured Well Depth (ft bgs)	Condition (as of) May 2014	Need to (R)epair; (S)ound	Notes	X coordinate (Easting)	Y coordinate (Northing)	Location
53	TT-102D2		775	740	770	5/21/2014	14.3	787	Fair	R, S	needs locks; ARCADIS on site having bladder pump issues	1127147.811	195325.6826	Between Alken Ave & Southern State Pkwy inside sump
54	RW2-MW1		NA	470	510	5/21/2014	38.75	521.2	Fair	R, S	needs locks	1129257.084	206443.3545	Across from 106 N. Windhorst Ave
55	RW3-MW1		NA	475	495	5/21/2014	36.8	472	Fair	R, S	needs bolts & locks	1128424.485	206582.121	Between Arthur & Helena Avenues
56	RW3-MW2		NA	330	350	5/21/2014	36.25	357	Fair	R, S	needs bolts & locks	1128444.309	206535.8655	Between Arthur & Helena Avenues
57	RW3-MW3		340.5	320	340	5/21/2014	37.72	351	Fair	R, S	needs bolts & locks	1128959.728	206793.5748	Between Broadway and Sophia St
58	RW3-MW4		NA	475	495	5/21/2014	40	511.1	Fair	R, S	needs bolts & locks; riser pipe has no sand pack	1128979.551	206773.751	Between Broadway and Sophia St
59	MW-75D2	MW-75D2	NA	230	240	5/21/2014	NA	NA	Good		Inaccessible; possibly transducers-most likely packer	1121671.241	213996.6831	Mulberry St between Jefry Ln & Washington Pkwy
60	RE-103D1	RE103D1	645	625	640	5/21/2014	38.31	668.5	Fair	R, S	needs locks	1125111.764	206694.59	By Avoca Ave & Martin Pl
61	RE-103D2	RE103D2	673	653	673	5/21/2014	38	691	Fair	R, S	needs locks	1125160.339	206692.993	By Avoca Ave & Martin Pl
62	RE-103D3	RE103D3	735	715	730	5/21/2014	38.81	761	Fair	R, S	needs locks	1125144.905	206693.459	By Avoca Ave & Martin Pl
	RE-104D1	RE104D1	375	350	370	5/21/2014	34.74	387.2	Fair	R, S	needs locks	1127745.611	207036.9997	Turn of Hilltop Ave
63	RE-104D2	RE104D2	735	710	730	5/21/2014	39.43	756.3	Fair	R, S	needs locks	1127708.991	207000.0361	Turn of Hilltop Ave
64	RE-104D3	RE104D3	785	760	780	5/21/2014	40.01	808.3	Fair	R, S	needs locks	1127695.554	206993.5018	Turn of Hilltop Ave
65	RE-105D1	RE105D1	555	530	550	5/21/2014	36.72	572.1	Fair	R, S	needs locks	1126664.427	205072.866	Lincoln Blvd between Roosevelt & Balfour Drives
66	RE-105D2	RE105D2	755	730	730	5/21/2014	38.15	780	Fair	R, S	needs locks	1126652.418	205064.024	Lincoln Blvd between Roosevelt & Balfour Drives
67	TT-302S	BPS1-TT-MW302S	52	41	51	5/22/2014	45.02	52	Good		Something blocking interface probe.	1124261.772	213812.671	NWIRP - Between south warehouse buildings on northern side
68	TT-302I1	BPS1-TT-MW302I1	120	110	120	5/22/2014	45.07	127.3	Good	S		1124251.046	213812.87	NWIRP - Between south warehouse buildings on northern side
	TT-302I2	BPS1-TT-MW302I2	150	140	150	5/22/2014	49.31	151.5	Fair	R, S	pad cracked	1124241.215	213813.43	NWIRP - Between south warehouse buildings on northern side
69	TT-302D	BPS1-TT-MW302D	213	203	213	5/22/2014	49.5	272.2	Good	S		1124230.805	213814.24	NWIRP - Between south warehouse buildings on northern side
	TT-310S	BPS1-TT-MW-310S	167.5	NA	NA	5/20/2014	56.58	69.8	Fair	S	bottom of well very soft, possibly due to silt, so total depth not definitive	1124091.925	215492.7484	NWIRP Site 3 Northwest corner
70	TT-311S	BPS1-TT-MW-311S	165	NA	NA	5/22/2014	57.6	62	Good	S	Felt like interface probe was stuck	1124594.39	215423.331	Road Adjacent to Northside of Site 3
71	TT-311I	BPS1-TT-MW-311I	170	NA	NA	5/22/2014	57.8	173	Good	S		1124598.827	215421.901	Road Adjacent to Northside of Site 3
72	GM-21D		288	278	288	5/22/2014	47.85	298.5	Fair	R, S	need bolts	1125369	209486	Corner of Harrison Ave & N Butehorn St
73	GM-21D2		531	516	526	5/22/2014	46.5	574.1	Good	S		1125369	209486	Corner of Harrison Ave & N Butehorn St
	GM-21I		140	130	140	5/22/2014	37.72	31	Fair	R, S	needs bolts; bottom of well very soft, possibly due to silt, so total depth not definitive	1125402	209485	Corner of Harrison Ave & N Butehorn St
	GM-75D2		NA	505	525	5/23/2014	34.31	546	Fair	R, S	needs bolts & locks	1124151	208616	N Wantagh Ave & U-Turn
	GM-78I		NA	90	110	5/23/2014	39.51	111.5	Fair	S	bottom of well soft, possibly due to silt, remove sand from well box	1123658	209456	Corner of Fiddler Ln & Martha Blvd
	GM-78S		NA	60	70	5/23/2014	39.2	71.1	Fair	S		1123658	209456	Corner of Fiddler Ln & Martha Blvd
	GM-79D		NA	280	290	5/22/2014	40	294.3	Fair	S	bottom of well soft, possibly due to silt, so total depth not definitive	1127639	208948	Inside Central Ave & N Pershing Ave: inside sump
	GM-79I		NA	170	180	5/22/2014	39.3	181.2	Fair	S		1127633	208942	Inside Central Ave & N Pershing Ave: inside sump

Notes: bgs = below ground surface; btoc = below top of casing; NA = Not Available; OLM = oil-like material; R = need to repair; S = need to re-sound

Figures

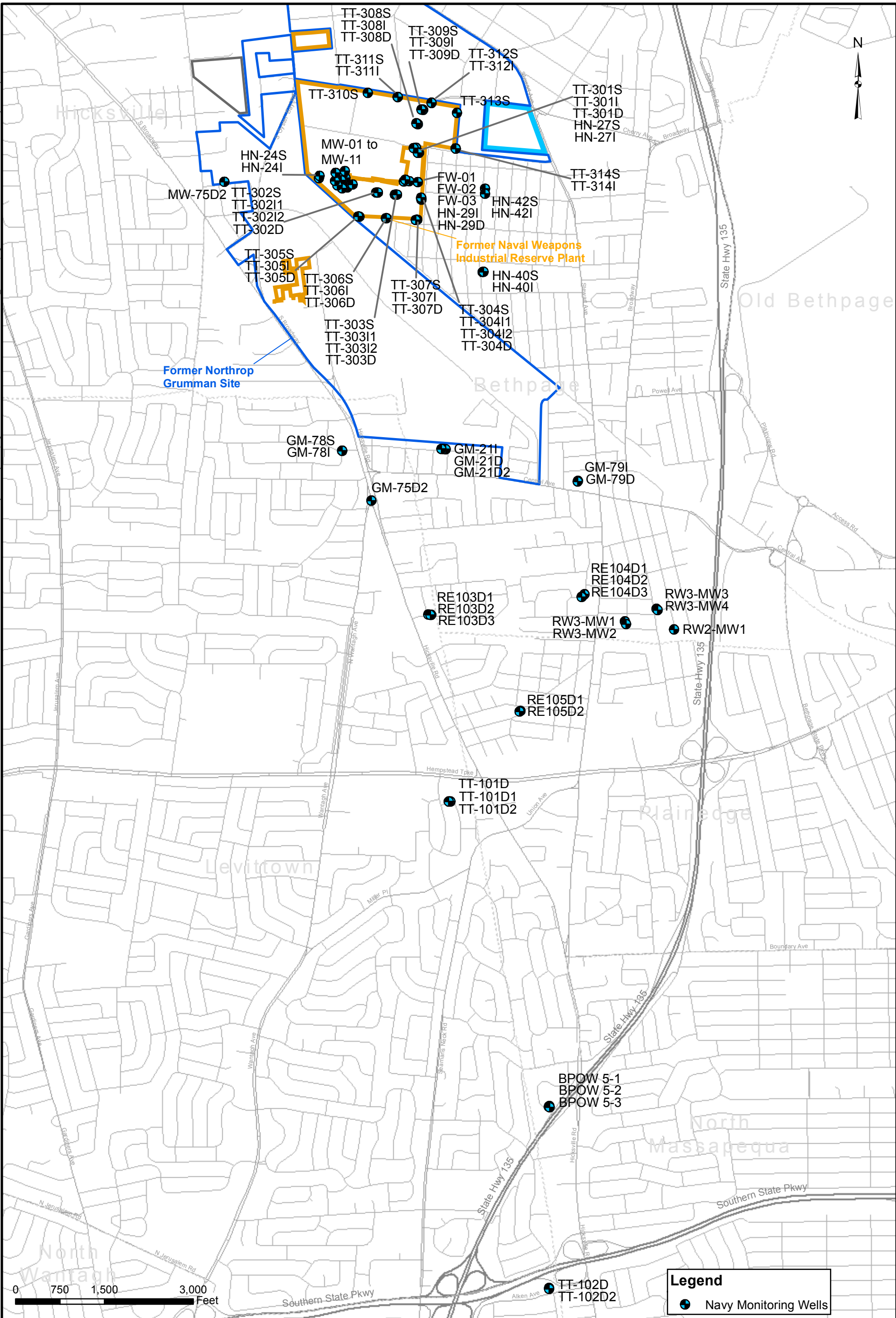

WELL LOCATION MAP

NAVAL WEAPONS INDUSTRIAL RESERVE PLANT
BETHPAGE, NEW YORK



Legend
 Navy Monitoring Wells

CONTRACT NUMBER N62470-11-D8013	CTO NUMBER WE08
APPROVED BY EV	DATE 5/6/2015
APPROVED BY	DATE
FIGURE NO. 1	REV 0



Well	Water elevation May 20-24, 2014 (ft amsl)
FW-01	71.12
FW-02	71.24
FW-03	66.33
GM-21D	57.81
GM-21I	68
GM-78I	65.55
GM-78S	65.74
GM-79D	61.25
GM-79I	61.79
HN-24I	70.94
HN-24S	72.73
HN-27I	70.32
HN-27S	70.65
HN-29D	70.24
HN-29I	72.12
HN-40I	68.91
HN-40S	68.65
HN-42I	70.4
HN-42S	71.47
MW-01	69.07
MW-02	68.4
MW-03	61.9
MW-04	69.43
MW-06	73.8
MW-07	74
MW-08	74
MW-09	72.73
MW-10	75.44
MW-11	71.65
TT-301D	74.21
TT-301I	75.08
TT-301S	74.98
TT-302D	66.58
TT-302I1	70.84
TT-302I2	66.6
TT-302S	70.99
TT-303D	70.19
TT-303I1	73.63
TT-303I2	70.39
TT-303S	70.35
TT-304D	69.31
TT-304I1	70.03
TT-304I2	69.47
TT-304S	69.6
TT-306D	69.16
TT-306I	69.64
TT-306S	70.3
TT-307D	68.92
TT-307I	69.06
TT-307S	69.91
TT-308D	71.78
TT-308I	72.19
TT-308S	73.05
TT-309D	72.14
TT-309I	72.51
TT-309S	73.58
TT-310S	72.92
TT-311I	72.54
TT-311S	72.63
TT-312I	73.55
TT-312S	73.11
TT-313S	73.16
TT-314I	71.09
TT-314S	71.45

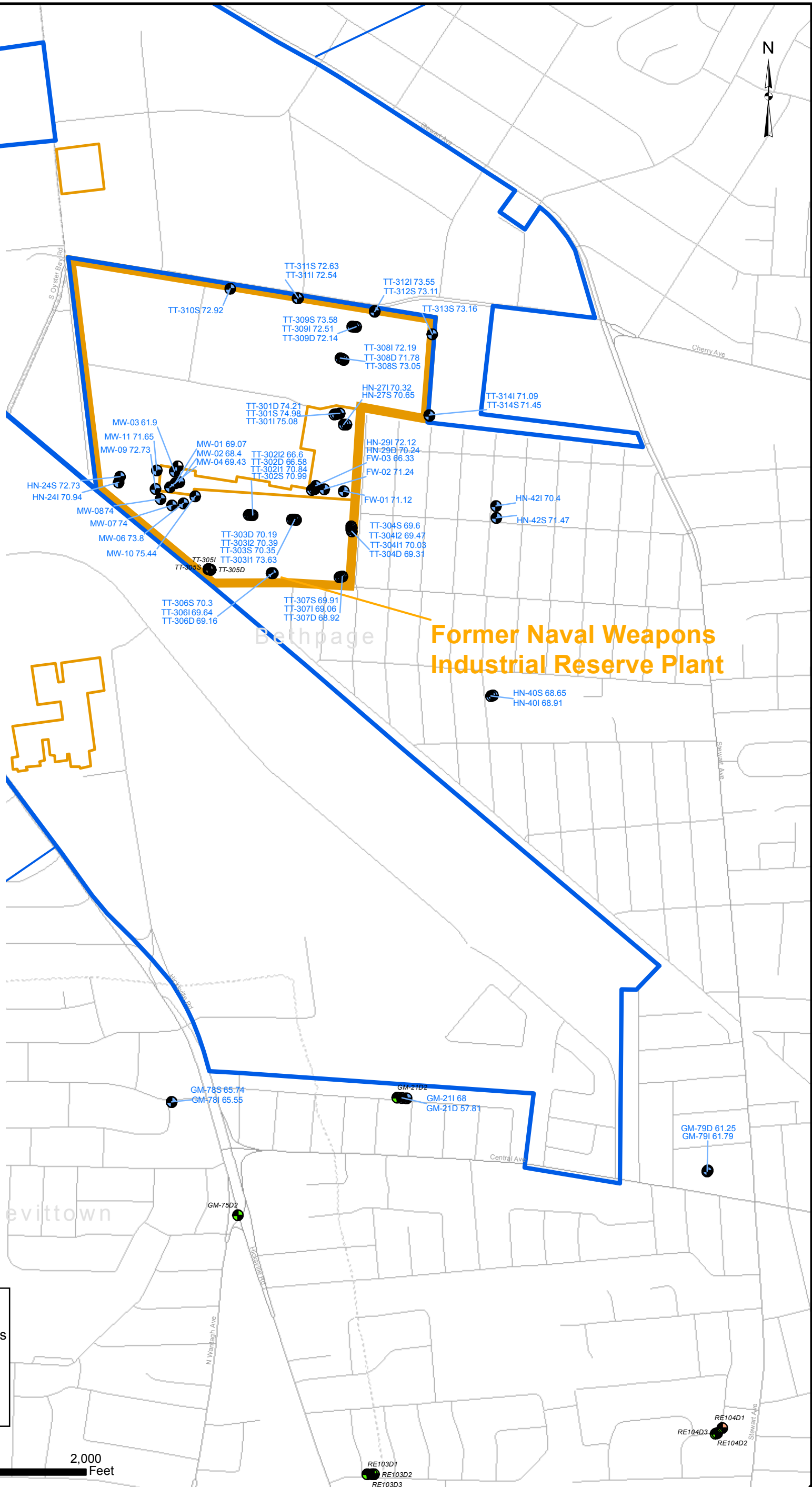

**Former Naval Weapons
Industrial Reserve Plant**

Legend

- Navy Monitoring Wells
- Deep
- Intermediate
- Shallow

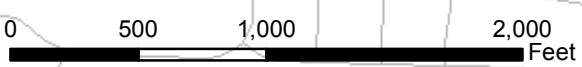

WELLS SCREENED LESS THAN 300 FEET BGS
 NAVAL WEAPONS INDUSTRIAL RESERVE PLANT
 BETHPAGE, NEW YORK

CONTRACT NUMBER N62470-11-D8013	CTO NUMBER WE15
APPROVED BY PS	DATE 5/21/2015
APPROVED BY	DATE
FIGURE NO. 2	REV 0

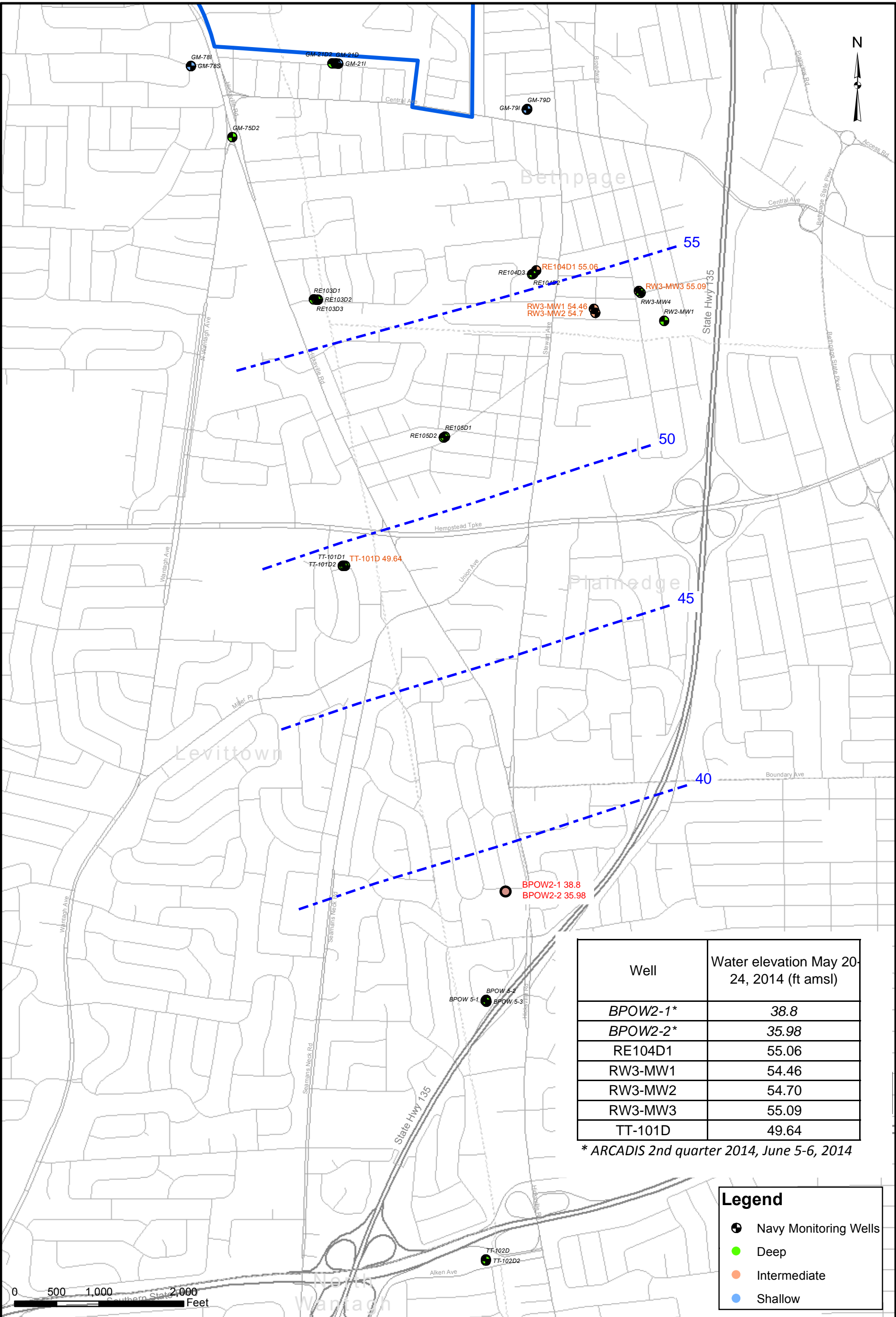

Well	Water elevation May 20-24, 2014 (ft amsl)
BPOW2-1*	38.8
BPOW2-2*	35.98
RE104D1	55.06
RW3-MW1	54.46
RW3-MW2	54.70
RW3-MW3	55.09
TT-101D	49.64

* ARCADIS 2nd quarter 2014, June 5-6, 2014

Legend

- Navy Monitoring Wells
- Deep
- Intermediate
- Shallow



POTENTIOMETRIC CONTOURS – WELLS SCREENED 300 – 500 FEET BGS
 NAVAL WEAPONS INDUSTRIAL RESERVE PLANT
 BETHPAGE, NEW YORK

CONTRACT NUMBER N62470-11-D8013	CTO NUMBER WE15
APPROVED BY PS	DATE 5/21/2015
APPROVED BY	DATE
FIGURE NO. 3	REV 0

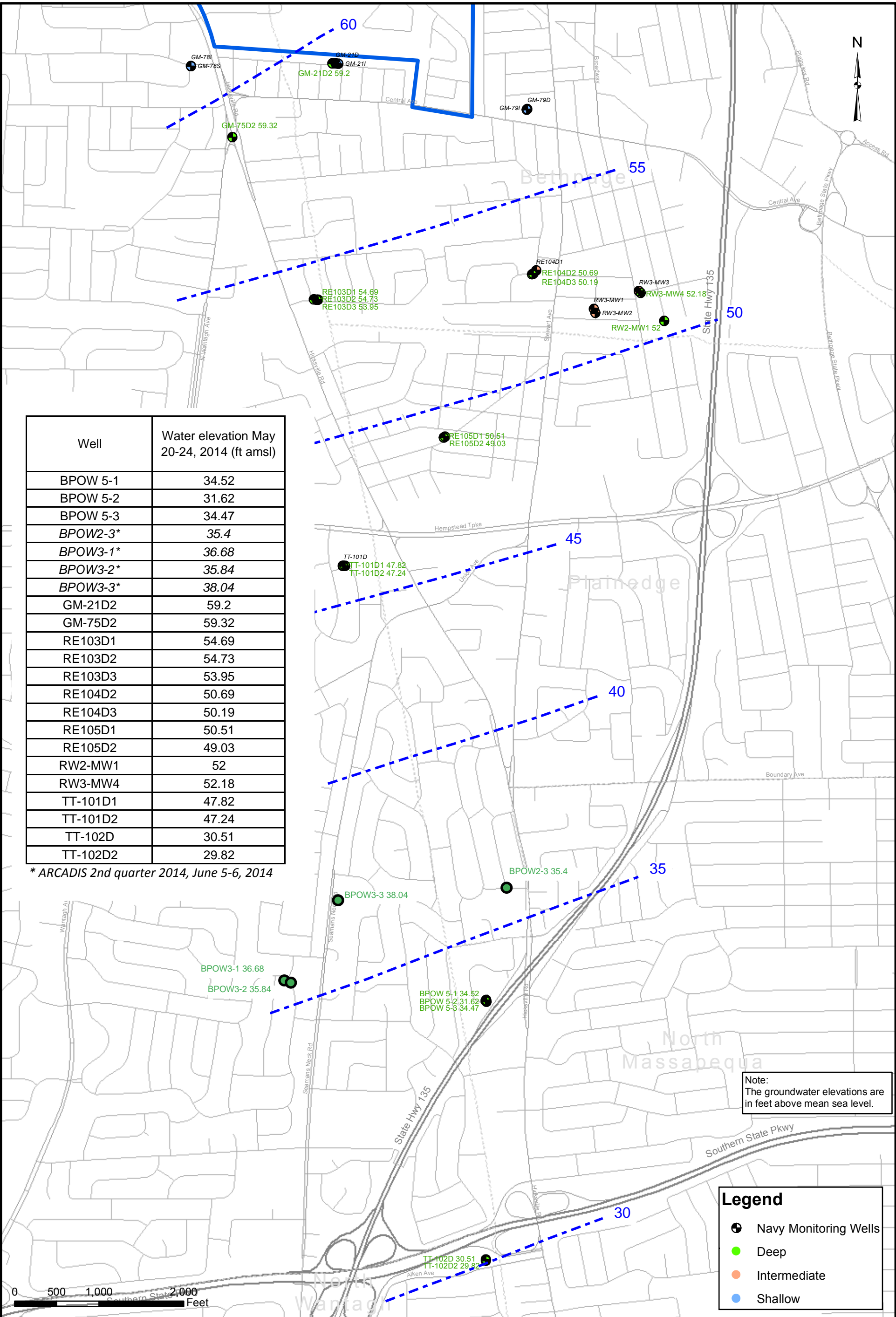

Well	Water elevation May 20-24, 2014 (ft amsl)
BPOW 5-1	34.52
BPOW 5-2	31.62
BPOW 5-3	34.47
BPOW2-3*	35.4
BPOW3-1*	36.68
BPOW3-2*	35.84
BPOW3-3*	38.04
GM-21D2	59.2
GM-75D2	59.32
RE103D1	54.69
RE103D2	54.73
RE103D3	53.95
RE104D2	50.69
RE104D3	50.19
RE105D1	50.51
RE105D2	49.03
RW2-MW1	52
RW3-MW4	52.18
TT-101D1	47.82
TT-101D2	47.24
TT-102D	30.51
TT-102D2	29.82

* ARCADIS 2nd quarter 2014, June 5-6, 2014

Note:
The groundwater elevations are in feet above mean sea level.

Legend

- Navy Monitoring Wells
- Deep
- Intermediate
- Shallow



POTENTIOMETRIC CONTOURS – WELLS SCREENED MORE THAN 500 FEET BGS
 NAVAL WEAPONS INDUSTRIAL RESERVE PLANT
 BETHPAGE, NEW YORK

CONTRACT NUMBER N62470-11-D8013	CTO NUMBER WE15
APPROVED BY PS	DATE 5/21/2015
APPROVED BY	DATE
FIGURE NO. 4	REV 0

**Appendix A
Well Inventory Photolog**



1.DSCN0004-BPS1-FW-MW01



2.DSCN0003-BPS1-FW-MW02



3.DSCN0113-BPS1-FW-MW03



4.DSCN0024-BPS1-HN-MW27I



5.DSCN0026-BPS1-HN-MW27S



6A.DSCN0200-HN-29D



6B.DSCN0191-BPHNMW-40S



7.DSCN0190-BPHNMW-40I



8.DSCN0192-BPHNMW42S



9.DSCN0193-BPHNMW42I



10.DSCN0054-BPS1-TT-MW309D



11.DSCN0100-BPS1-TT-MW309I



12.DSCN0056-BPS1-TT-MW309S



13.DSCN0057-BPS1-TT-MW313S



14.DSCN0058-BPS1-TT-MW-312S-I



16.DSCN0064-BPS1-TT-MW314I



17.DSCN0103-BPS1-TT-MW314S



18.DSCN0066-BPS1-TT-MW-308D-I-S



21.DSCN0168-BPS1-TT-MW306S



22.DSCN0169-BPS1-TT-MW306I



23.DSCN0170-BPS1-TT-MW306D



24.DSCN0171-BPS1-TT-MW307S



25.DSCN0172-BPS1-TT-MW307I



26.DSCN0173-BPS1-TT-MW307D



27.DSCN0087-BPS1-TT-MW304D



28.DSCN0089-BPS1-TT-MW304I1



29.DSCN0088-BPS1-TT-MW304I2



30.DSCN0090-BPS1-TT-MW304S



31.DSCN0111-BPS1-TT-MW301D



32.DSCN0112-BPS1-TT-MW301I



33.DSCN0110-BPS1-TT-MW301S



34.DSCN0122-BPS1-TT-303D



35.DSCN0125-BPS1-TT-MW303I1



36.DSCN0123-BPS1-TT-MW303I2



37.DSCN0124-BPS1-TT-MW303S



38.DSCN0132-BPTTAOC22MW03



39.DSCN0133-BPTTAOC22MW04



40.DSCN0127-BPTTAOC22MW06



41.DSCN0128-BPTTAOC22MW07



42.DSCN0129-BPTTAOC22MW08



43.DSCN0130-BPTTAOC22MW09



44.DSCN0126-BPTTAOC22MW10



45.DSCN0131-BPTTAOC22MW11



46.DSCN0135-BPOW-5-1



47.DSCN0136-BPOW-5-2



48.DSCN0134-BPOW-5-3



49.DSCN0140-TT-101D



50.DSCN0141-TT-101D1



51.DSCN0139-TT-101D2



52.DSCN0137-TT-102D



53.DSCN0138-TT-102D2



54.DSCN0145-RW2-MW1



55.DSCN0148-RW3-MW1



56.DSCN0149-RW3-MW2



57.DSCN0146-RW3-MW3



58.DSCN0147-RW3-MW4



59.DSCN0151-MW-75D2



60.DSCN0160-RE-103D1



61.DSCN0159-RE-103D2



62.DSCN0158-RE-103D3



63.DSCN0163-RE-104D2



64.DSCN0162-RE-104D3



65.DSCN0165-RE-105D1



66.DSCN0164-RE-105D2



67.DSCN0176-BPS1-TT-MW302S



68.DSCN0175-BPS1-TT-MW302I1



69.DSCN0174-BPS1-TT-MW302D



70.DSCN0188-BPS1-TT-MW-311S



71.DSCN0189-BPS1-TT-MW-311I



72.DSCN0195-GM-21D



73.DSCN0196-GM-21D2