

**NEW YORK STATE
DEPARTMENT OF ENVIRONMENTAL CONSERVATION**

GENERAL CONSTRUCTION CONTRACT NO. D007692

**FUMEX SANITATION SITE
GARDEN CITY PARK, NEW YORK
SOIL EXCAVATION AND ASPHALT COVER INSTALLATION**

SITE NO. 1-30-041

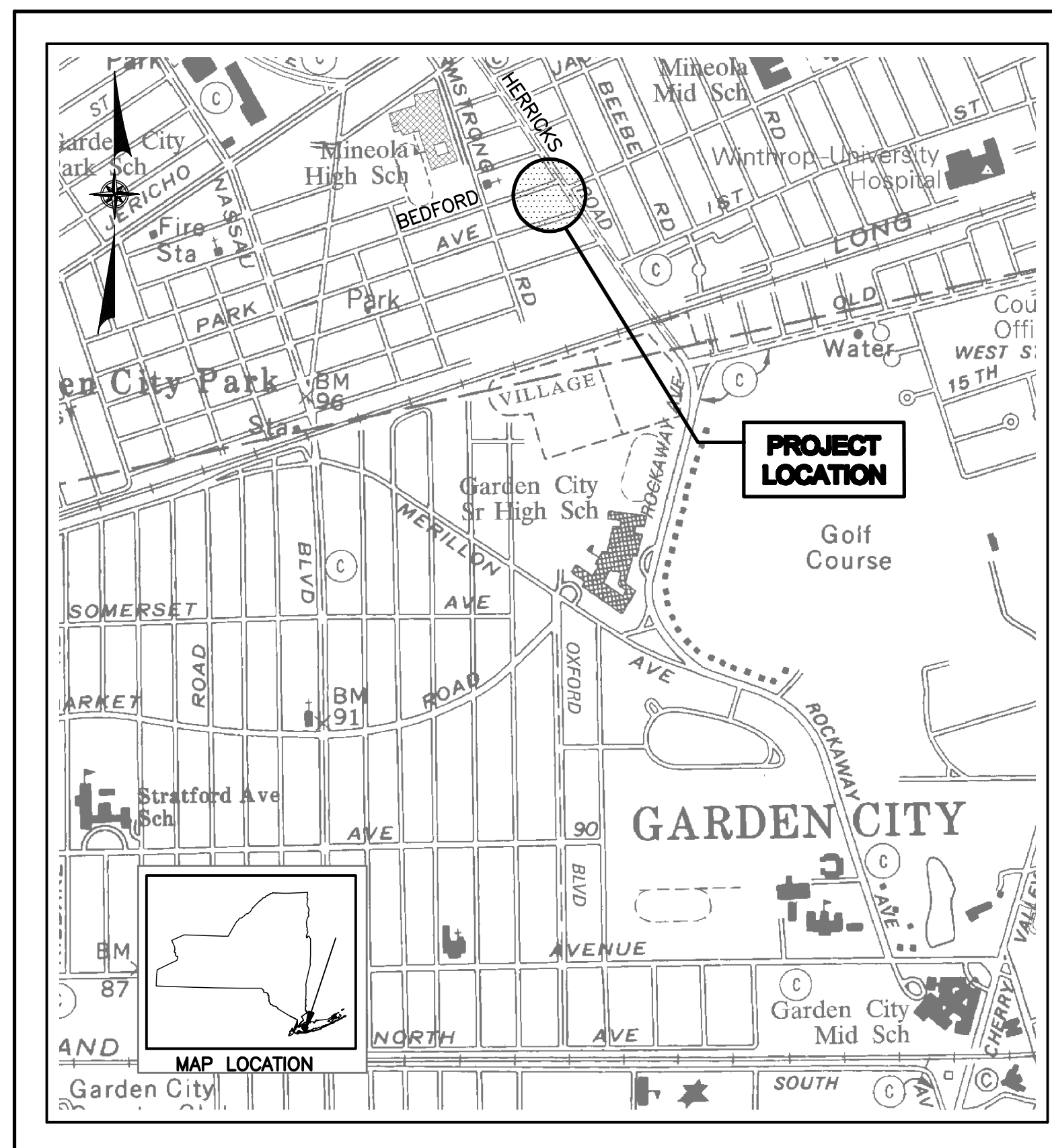

LOCATION MAP

LIST OF DRAWINGS

<u>DRAWING No.</u>	<u>DRAWING TITLE</u>
	TITLE SHEET
1	GENERAL NOTES, SYMBOLS AND ABBREVIATIONS
2	SITE PLAN
3	SITE REMEDIATION PLAN
4	SITE RESTORATION PLAN
5	DETAILS I
6	DETAILS II
7	DETAILS III

OCTOBER 2009

db Dvirka and Bartilucci
CONSULTING ENGINEERS
A DIVISION OF WILLIAM F. COSULICH ASSOCIATES, P.C.



ABBREVIATIONS

ADD'L	ADDITIONAL	ID	INSIDE DIAMETER
AFF	ABOVE FINISHED FLOOR	INF	INFLUENT
ALUM	ALUMINUM	INT	INTERIOR
ASTM	AMERICAN SOCIETY OF TESTING MATERIALS	INV. EL./I.E.	INVERT ELEVATION
⊙	AT	IJ	ISOLATION JOINT
&	AND	LBS, #	POUNDS
B,BOT	BOTTOM	LF	LINEAR FEET
BC	BOTTOM OF CURB	LP	LOW POINT
BLW	BLOWOFF	MAX	MAXIMUM
BM	BEAM	MECH	MECHANICAL
BP	BASE PLATE	MFTR/MFG	MANUFACTURER
C.I.	CAST IRON	MIN	MINIMUM
CJ	CONSTRUCTION JOINT	MH	MANHOLE
CL	CLEARANCE	MO	MASONRY OPENING
Ⓢ	CENTERLINE	MUTCO	MANUAL OF UNIFORM TRAFFIC CONTROL DEVICES
CMU	CONCRETE MASONRY UNIT	MW	MONITORING WELL
C.O.	CLEAN OUT	NAD	NORTH AMERICAN DATUM
COL	COLUMN	NGVD	NATIONAL GEODETIC VERTICAL DATUM
CONC	CONCRETE	NO/#	NUMBER
CONN	CONNECTION	NTS	NOT TO SCALE
CONT	CONTINUE, CONTINUOUS	NYS DOT	NEW YORK STATE DEPARTMENT OF TRANSPORTATION
CU	COPPER	OC	ON CENTER
D	DRAIN	OD	OUTER DIAMETER
DET	DETAIL	OPNG	OPENING
D.I./D.I.P.	DUCTILE IRON/D.I. PIPE	OPP	OPPOSITE
DIS	DISCHARGE	OVR	OVERFLOW
DIA./φ	DIAMETER	ℓ	PLATE/PROPERTY LINE
DWG(S)	DRAWING(S)	PRESS.	PRESSURE
DWLS	DOWELS	PSI	POUND PER SQUARE INCH
EA	EACH	PVC	POLYVINYL CHLORIDE PIPE
EC	ELECTRICAL CONTRACTOR	RCP	REINFORCED CONCRETE PIPE
EE	EACH END	REC	RECIRCULATION
EF	EACH FACE	REINF	REINFORCE, REINFORCING
EJ	EXPANSION JOINT	REQ'D	REQUIRED
EL,ELEV	ELEVATION	RPZ	REDUCED PRESSURE BACKFLOW PREVENTER
ENT	ENTRANCE	S	SANITARY
EQ	EQUAL	SCH	SCHEDULE
EQUIP	EQUIPMENT	SDR	STANDARD DIMENSION RATIO
ES	EACH SIDE	SP	SUMP PUMP DISCHARGE
ETC	ET CETERA	SPECS	SPECIFICATIONS
EW	EACH WAY	SQ.	SQUARE
EXIST	EXISTING	SQ. FT.	SQUARE FEET
EXP	EXPANSION	SQ. IN.	SQUARE INCH
EXT	EXTERIOR	STN. STL./S.S.	STAINLESS STEEL
FBO	FURNISHED BY OTHERS	STD	STANDARD
FDN	FOUNDATION	STRUCT	STRUCTURAL
F.F./FIN. FL.	FINISHED FLOOR	SUC	SUCTION
FL	FLOOR	T	TOP
FRP	FIBERGLASS REINFORCED PLASTIC	TC	TOP OF CURB
FS	FLOW SWITCH	T&B	TOP AND BOTTOM
FT	FEET	TOS	TOP OF STEEL
FTG	FOOTING	TOW	TOP OF WALL
GAL	GALLON	TTD	TOP TRENCH DRAIN
GALV	GALVANIZED	TYP	TYPICAL
GC	GENERAL CONTRACTOR	V	VENT
GS	GALVANIZED STEEL	VERT,V	VERTICAL
HDPE	HIGH DENSITY POLYETHYLENE	W/	WITH
HP	HORSEPOWER	WS	WATER SERVICE
H.P.	HIGH POINT	WWF	WELDED WIRE FABRIC

SYMBOLS

	MONITORING WELL (WITH CASING ELEV)
	UNDERGROUND STORM DRAIN
	DRAINAGE MANHOLE
	PRECAST DRAINAGE MANHOLE
	UNDERGROUND ROOF DRAIN PIPE (AS MARKED)
	GAS VALVE
	UNDERGROUND GAS LINE (AS MARKED)
	WATER VALVE
	HYDRANT
	UNDERGROUND WATER LINE (AS MARKED)
	UNDERGROUND ELECTRIC LINE (AS MARKED)
	TRAFFIC SIGNAL BOX
	TRAFFIC SIGNAL POLE
	UNDERGROUND TRAFFIC SIGNAL LINE
	UTILITY POLE (WITH POLE NUMBER)
	OVERHEAD UTILITY LINE
	SANITARY MANHOLE
	SANITARY SEWER LINE (AS MARKED)
	CONTOUR (0.5 FT INTERVAL)
	TREE
	SECTION NO./ DETAIL LETTER
	DRAWING NO. ON WHICH SECTION / DETAIL IS SHOWN
	DRAWING NO. ON WHICH SECTION / DETAIL IS TAKEN
	PROPOSED ELEVATION CONTOUR
	PROPOSED SPOT ELEVATION
	CHAIN LINK FENCE
	CONTRACT LIMITS
	LIMIT OF TEMPORARY EASEMENT
	LIMIT OF WORK TO BE CONDUCTED WITHIN PUBLIC RIGHT-OF-WAY
	PROPERTY LINE
	TAX LOT LINE
	EXISTING
	PROPOSED

GENERAL NOTES

1. THE "DEPARTMENT" OR "NYSDEC" SHALL BE DEFINED AS THE NEW YORK STATE DEPARTMENT OF ENVIRONMENTAL CONSERVATION.
2. THE CONTRACTOR SHALL FURNISH ALL LABOR, EQUIPMENT, MATERIALS, SUPPLIES, FACILITIES, POWER AND INCIDENTALS NECESSARY TO FULLY COMPLETE THE WORK AS SHOWN, AS SPECIFIED AND AS DIRECTED BY THE DEPARTMENT. THE CONTRACTOR SHALL BE RESPONSIBLE FOR PERFORMING ALL WORK DESCRIBED IN THE CONTRACT DOCUMENTS, INCLUDING ITEMS NOT SPECIFICALLY IDENTIFIED, AS REQUIRED TO COMPLETE THE WORK.
3. ALL WORK SHALL BE PERFORMED IN ACCORDANCE WITH APPLICABLE FEDERAL, STATE AND LOCAL LAWS AND REGULATIONS, AND THE CONTRACTOR'S APPROVED SUBMITTALS. IF ANY LAW, REGULATION AND/OR CONTRACT DOCUMENTS HAVE CONTRADICTING REQUIREMENTS, THEN THE MOST STRINGENT REQUIREMENT SHALL APPLY, AS DETERMINED BY THE DEPARTMENT. LOCAL LAWS SHALL INCLUDE ANY TOWN, VILLAGE, CITY OR OTHER LOCAL REGULATORY AUTHORITY HAVING JURISDICTION.
4. THE CONTRACTOR IS RESTRICTED FROM PERFORMING ANY OPERATIONS OUTSIDE THE DEFINED CONTRACT LIMITS UNLESS OTHERWISE APPROVED BY THE DEPARTMENT. ADDITIONALLY, ALL WORK COMPLETED ON TEMPORARY EASEMENTS SHALL CONFORM WITH APPLICABLE ACCESS AGREEMENTS, INCLUDING TEMPORARY AND PERMANENT EASEMENTS OBTAINED FOR THE PROJECT.
5. THE CONTRACTOR SHALL IDENTIFY, APPLY FOR AND OBTAIN, PAY ALL FEES FOR, AND COMPLY WITH ALL REQUIREMENTS OF ALL ISSUED LICENSES, PERMITS, APPROVALS AND INSURANCE REQUIRED FROM FEDERAL, STATE AND LOCAL GOVERNMENT AND PUBLIC AGENCIES AND AUTHORITIES NECESSARY TO PERFORM THE WORK. THE CONTRACTOR SHALL PROVIDE INDEMNIFICATIONS TO PUBLIC AND PRIVATE AGENCIES AND AUTHORITIES AS NECESSARY TO PERFORM THE WORK.
6. ANY UTILITIES SHOWN ON THE PLANS ARE FOR INFORMATION ONLY AND HAVE BEEN OBTAINED FROM AVAILABLE SOURCES. THE EXISTENCE AND LOCATION OF ANY UTILITIES INDICATED ON THE PLANS ARE NOT GUARANTEED AND SHALL BE INVESTIGATED AND VERIFIED IN THE FIELD BY THE CONTRACTOR BEFORE STARTING WORK. PUBLIC AND PRIVATE UTILITIES SHALL BE LOCATED BY THE CONTRACTOR, AT NO ADDITIONAL COST TO THE DEPARTMENT, IN ACCORDANCE WITH SECTION IX, SUPPLEMENTARY CONDITIONS, OF THE CONTRACT DOCUMENTS. THE CONTRACTOR SHALL NOTIFY THE APPROPRIATE UTILITY COMPANY NO LATER THAN 48 HOURS PRIOR TO ANY EXCAVATION THAT MAY AFFECT THAT UTILITY. EXCAVATION IN THE VICINITY OF UNDERGROUND UTILITIES SHALL BE DUG BY HAND. THE CONTRACTOR WILL BE HELD RESPONSIBLE FOR ANY DAMAGE TO EXISTING UTILITIES.
7. THE CONTRACTOR SHALL NOTIFY THE DEPARTMENT AND THE ENGINEER A MINIMUM OF SEVENTY-TWO (72) HOURS PRIOR TO THE START OF CONSTRUCTION. IN ADDITION, IF WORK SHOULD BE STOPPED AND RESTARTED FOR ANY REASON, THE CONTRACTOR SHALL GIVE THE DEPARTMENT OF A MINIMUM SEVENTY-TWO (72) HOURS NOTICE.
8. THE CONTRACTOR SHALL PERFORM DAILY CLEANUP OPERATIONS WHICH INCLUDE SWEEPING OF THE ROADWAYS, REMOVAL OF DEBRIS (CUPS, PAPER BAGS, CANS, ETC.), REMOVAL OF EXCESS CONSTRUCTION MATERIALS, ALL TO THE SATISFACTION OF THE DEPARTMENT THROUGHOUT THE CONTACT DURATION.
9. DURING CONSTRUCTION, THE CONTRACTOR SHALL MAINTAIN TRAFFIC ON ALL ROADWAYS WHERE WORK IS IN PROGRESS. ALL ROADWAYS SHALL REMAIN OPEN AND ACCESSIBLE TO ALL, EXCEPT AS OTHERWISE SPECIFIED OR APPROVED.

Project: Nassau County, New York, Fumex Sanitation Site, Soil Excavation and Asphalt Cover Installation, Contract No. D007692, Date: October 2009, Drawing No. 1

NO.	DATE	REVISION	INT.



UNAUTHORIZED ALTERATION OR ADDITION TO THIS DOCUMENT IS A VIOLATION OF SECTION 7209 OF THE NEW YORK STATE EDUCATION LAW.

PROJECT ENGINEER: FD	DRAWN BY: LVG
DESIGNED BY: MRF/FPD	CHECKED BY: -



NEW YORK STATE DEPARTMENT OF ENVIRONMENTAL CONSERVATION
FUMEX SANITATION SITE
 NASSAU COUNTY NEW YORK
SOIL EXCAVATION AND ASPHALT COVER INSTALLATION
CONTRACT NO. D007692

GENERAL NOTES, SYMBOLS AND ABBREVIATIONS

PROJECT NO. 2802	DRAWING NO. 1
DATE: OCTOBER 2009	
SCALE: NONE	

NOTES:

1. BASE MAP PREPARED BY YEC, INC. BASED ON FIELD SURVEY CONDUCTED ON JULY 13, 2006.
2. FUMEX SANITATION, INC. PROPERTY TAX LOT: 33-174-58
3. HORIZONTAL DATUM: NAD 1927 FROM GPS OBSERVATIONS
4. VERTICAL DATUM: NGVD 1929 FROM GPS OBSERVATIONS
5. CONTOUR INTERVAL: 0.5 FOOT
6. DO NOT SCALE ANY DRAWINGS. VERIFY THE FIGURES, DIMENSIONS AND DESIGN INTENTION SHOWN ON THE DRAWINGS BEFORE BEGINNING LAYOUT OF THE WORK AND REPORT ANY INACCURACIES, MISSING DIMENSIONAL REQUIREMENTS OR CONFLICTS TO THE ENGINEER IN WRITING PRIOR TO BEGINNING ANY WORK.
7. ALL WORK SHALL COMPLY WITH ALL APPLICABLE CODES, LAWS AND STATUTES.
8. ALL EXISTING STRUCTURES WITHIN THE CONTRACT LIMITS, AS WELL AS LIMITS OF ALL TEMPORARY EASEMENTS, SHALL BE PROTECTED DURING CONSTRUCTION.
9. LOCATION OF THE POTENTIAL UST WAS DETERMINED BASED UPON A GEOPHYSICAL SURVEY CONDUCTED AT THE SITE. THE PRESENCE OF THE UST HAS NOT BEEN CONFIRMED. THE NASSAU COUNTY DEPARTMENT OF HEALTH AND THE NASSAU COUNTY FIRE MARSHAL HAVE BEEN CONTACTED TO DETERMINE WHETHER ANY RECORD OF AN UST EXISTS. NEITHER AGENCY MAINTAINED ANY SUCH RECORD OF THE EXISTENCE OF AN UST AT THE SITE. CONTRACTOR IS TO DETERMINE WHETHER THE UST EXISTS (THROUGH EXPLORATORY EXCAVATION OR OTHER METHOD APPROVED BY THE DEPARTMENT), HAS BEEN EMPTIED AND CLOSED (I.E., FILLED WITH SAND OR CONCRETE), AND IF NECESSARY, REMOVE AND DISPOSE OF SUBJECT TANK IN ACCORDANCE WITH THE SPECIFICATIONS AND ALL APPLICABLE FEDERAL, STATE AND LOCAL LAWS AND REGULATIONS. FOR BIDDING PURPOSES, CONTRACTOR IS TO ASSUME THE TANK IS A 2,000 GALLON TANK.
10. NO MATERIALS OR EQUIPMENT MAY BE STORED WITHIN THE CONTRACT LIMITS, AS WELL AS LIMITS OF ALL TEMPORARY EASEMENTS, UNLESS OTHERWISE APPROVED IN ADVANCE BY THE ENGINEER. STORAGE OF EQUIPMENT AND MATERIALS WITHIN THE PARKING LOT AT THE FUMEX SANITATION PROPERTY SHALL BE ACCEPTABLE WITH THE PRIOR WRITTEN APPROVAL OF THE DEPARTMENT.
11. PRIOR TO CONDUCTING ANY REMEDIAL ACTIVITIES AT THE SITE, THE CONTRACTOR SHALL CONDUCT BASELINE GROUNDWATER SAMPLING OF MONITORING WELLS MW-5, MW-6, MW-9D, MW-10R AND MW-11R IN ACCORDANCE WITH SECTION 01652 - SAMPLING PLAN OF THE CONTRACT DOCUMENTS.

REFERENCES:

- RECORD DEED: LIBER 4993 PAGE 425
- BEING LOTS 44 THRU 48 IN BLOCK 12 AS SHOWN ON A MAP ENTITLED "MAP OF MINEOLA WEST", FILED IN THE NASSAU COUNTY CLERK'S OFFICE ON JUNE 16, 1925 AS MAP NO. 562, CASE No. 544.

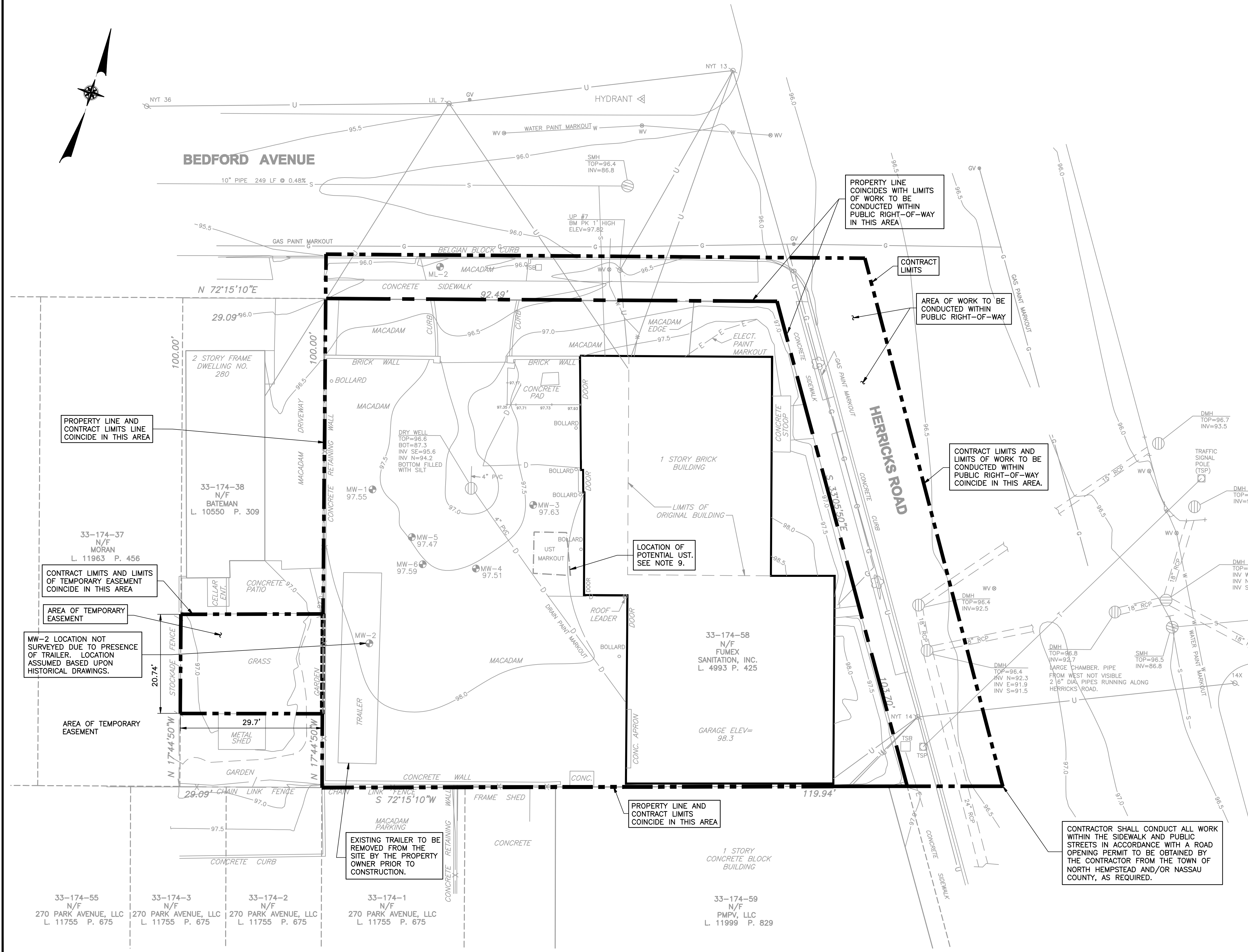

NO.	DATE	REVISION	INT.

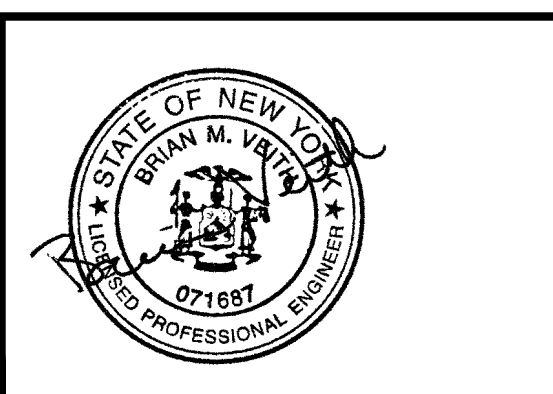

UNAUTHORIZED ALTERATION OR ADDITION TO THIS DOCUMENT IS A VIOLATION OF SECTION 7209 OF THE NEW YORK STATE EDUCATION LAW.

PROJECT ENGINEER: **PD** DRAWN BY: **CM**

DESIGNED BY: **MRO/PD** CHECKED BY: **BMV**

db Dvirka and Bartilucci
CONSULTING ENGINEERS
A DIVISION OF WILLIAM F. COBULICH ASSOCIATES, P.C.

NEW YORK STATE DEPARTMENT OF ENVIRONMENTAL CONSERVATION

NASSAU COUNTY **FUMEX SANITATION SITE** NEW YORK

SOIL EXCAVATION AND ASPHALT COVER INSTALLATION

CONTRACT NO. D007692

SITE PLAN

PROJECT NO.	2002	DRAWING NO.	2
DATE:	OCTOBER 2009		
SCALE:	1"=10'		

F:\2009\Final Contract Drawings\2009-10-09-11-AM-11-EDIST SITE PLAN_10000000 16:10:28 PM.dwg

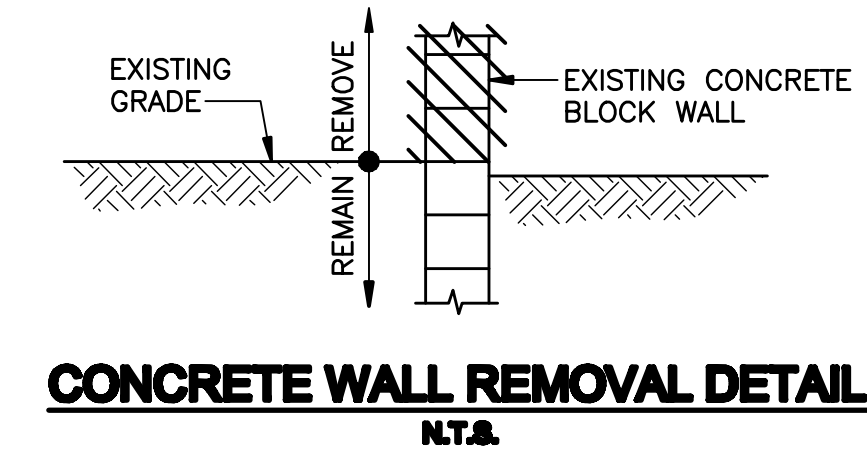
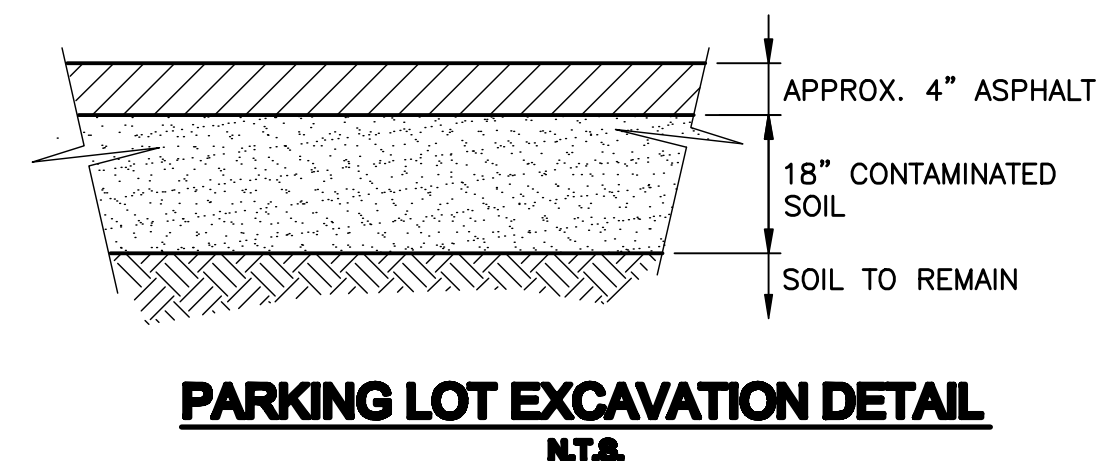

NOTES:

- BEFORE COMMENCEMENT OF ANY REMEDIATION ACTIVITIES, THE CONTRACTOR SHALL APPLY FOR AND OBTAIN ANY APPLICABLE PERMITS FROM FEDERAL, STATE AND LOCAL REGULATORY AGENCIES. THE CONTRACTOR SHALL ALSO BE RESPONSIBLE FOR ENSURING COMPLIANCE WITH ALL CONDITIONS AND NOTIFICATION REQUIREMENTS OF ISSUED PERMITS.
- CONTRACTOR SHALL CONDUCT ALL EXCAVATION AND HANDLING OF CONTAMINATED SOIL IN ACCORDANCE WITH THE REQUIREMENTS OF THE SPECIFICATIONS AND ALL APPLICABLE FEDERAL, STATE AND LOCAL LAWS AND REGULATIONS.
- CONTRACTOR SHALL REMOVE AND PROPERLY DISPOSE OF EXISTING ASPHALT PAVEMENT, CONCRETE PADS, BOLLARDS, ETC. WITHIN THE LIMITS OF THE ASPHALT PARKING LOT, AS NECESSARY TO PERFORM THE WORK, AND IN ACCORDANCE WITH ALL APPLICABLE FEDERAL, STATE AND LOCAL LAWS AND REGULATIONS.
- CONTRACTOR'S WORK WITHIN THE WESTERN TEMPORARY EASEMENT SHALL BE COMPLETED WITHIN 5 DAYS, INCLUDING EXCAVATION OF CONTAMINATED SOIL, ENDPOINT SAMPLING, BACKFILL AND COMPACTION AND SITE RESTORATION. WATERING, PLACEMENT OF SOD OR PLANTING MAY BE COMPLETED AFTER 5 DAYS IN ACCORDANCE WITH THE SPECIFICATIONS.
- ENDPOINT SAMPLING SHALL BE CONDUCTED WITHIN EACH EXCAVATION, AS REQUIRED BY THE SPECIFICATIONS, PRIOR TO BACKFILL AND COMPACTION. NO BACKFILLING SHALL TAKE PLACE UNTIL THE APPROVAL OF EXCAVATION DEPTHS AND ENDPOINT SAMPLING RESULTS BY THE ENGINEER.
- GROUNDWATER MONITORING WELLS MW-1 THROUGH MW-6 SHALL BE PROTECTED DURING CONSTRUCTION. PRIOR TO CONDUCTING EXCAVATION WORK, MW-1 THROUGH MW-6 SHALL BE EXPOSED AND THE RISER PIPE CUT AND CAPPED AT A DEPTH OF 18" BELOW FINAL EXCAVATION DEPTH IN THAT AREA, AND THE EXCAVATION BACKFILLED WITH GENERAL FILL. SUBSEQUENT TO THE INSTALLATION OF THE IMPERMEABLE CAP, THE WELLS SHALL BE RESTORED IN ACCORDANCE WITH THE ON-SITE WELL RESTORATION DETAIL PROVIDED ON DWG. 5. GROUNDWATER MONITORING WELLS THAT ARE DAMAGED AS A RESULT OF CONSTRUCTION SHALL BE ABANDONED AND REPLACED IN KIND, AS DIRECTED BY THE DEPARTMENT AND AT NO ADDITIONAL COST TO THE DEPARTMENT.
- CONTRACTOR SHALL EXECUTE THE WORK TO PREVENT DAMAGE OR INJURY TO EXISTING SITE STRUCTURES, UTILITIES AND EXISTING SITE FEATURES (E.G., RETAINING WALLS, FENCING). ANY DAMAGE RESULTING FROM THE PERFORMANCE OF THE WORK SHALL BE CORRECTED BY THE CONTRACTOR AT NO ADDITIONAL COST TO THE DEPARTMENT.
- CONTRACTOR SHALL EMPLOY A COMMUNITY AIR MONITORING PROGRAM IN ACCORDANCE WITH THE REQUIREMENTS OF THE SPECIFICATIONS THROUGHOUT THE PERFORMANCE OF THE WORK.
- CONTRACTOR SHALL PERFORM ALL POWER WASHING ACTIVITIES IN THE FORMER GARAGE AREA IN ACCORDANCE WITH THE SPECIFICATIONS. REMOVE ALL TILE AND FLOORING IN ACCORDANCE WITH THE SPECIFICATIONS PRIOR TO POWER WASHING CONCRETE FLOOR.
- CONTRACTOR SHALL INSTALL TWO (2) MONITORING WELLS IMMEDIATELY DOWNGRADIENT IN PUBLIC RIGHT-OF-WAYS. REFER TO DRAWING NO. 5 FOR OFF-SITE GROUNDWATER MONITORING WELL INSTALLATION PLAN AND CONSTRUCTION DETAIL. THE AREA OF THIS WORK IS NOT WITHIN THE CONTRACT LIMITS DEPICTED ON THESE DRAWINGS. CONTRACTOR SHALL APPLY FOR, PAY ALL FEES NECESSARY TO OBTAIN, AND COMPLY WITH ALL ISSUED FEDERAL, STATE AND LOCAL PERMITS, INCLUDING ROAD OPENING PERMITS NECESSARY TO INSTALL THE OFF-SITE MONITORING WELLS.

LEGEND:

- EXTENT OF HAZARDOUS WASTE TO BE EXCAVATED TO 1.5' BELOW BOTTOM OF ASPHALT PARKING LOT (SEE PARKING LOT EXCAVATION DETAIL THIS DWG.)
- EXTENT OF NON-HAZARDOUS WASTE TO BE EXCAVATED 1.5' BELOW GROUND SURFACE
- AREA OF BUILDING TO BE POWER WASHED

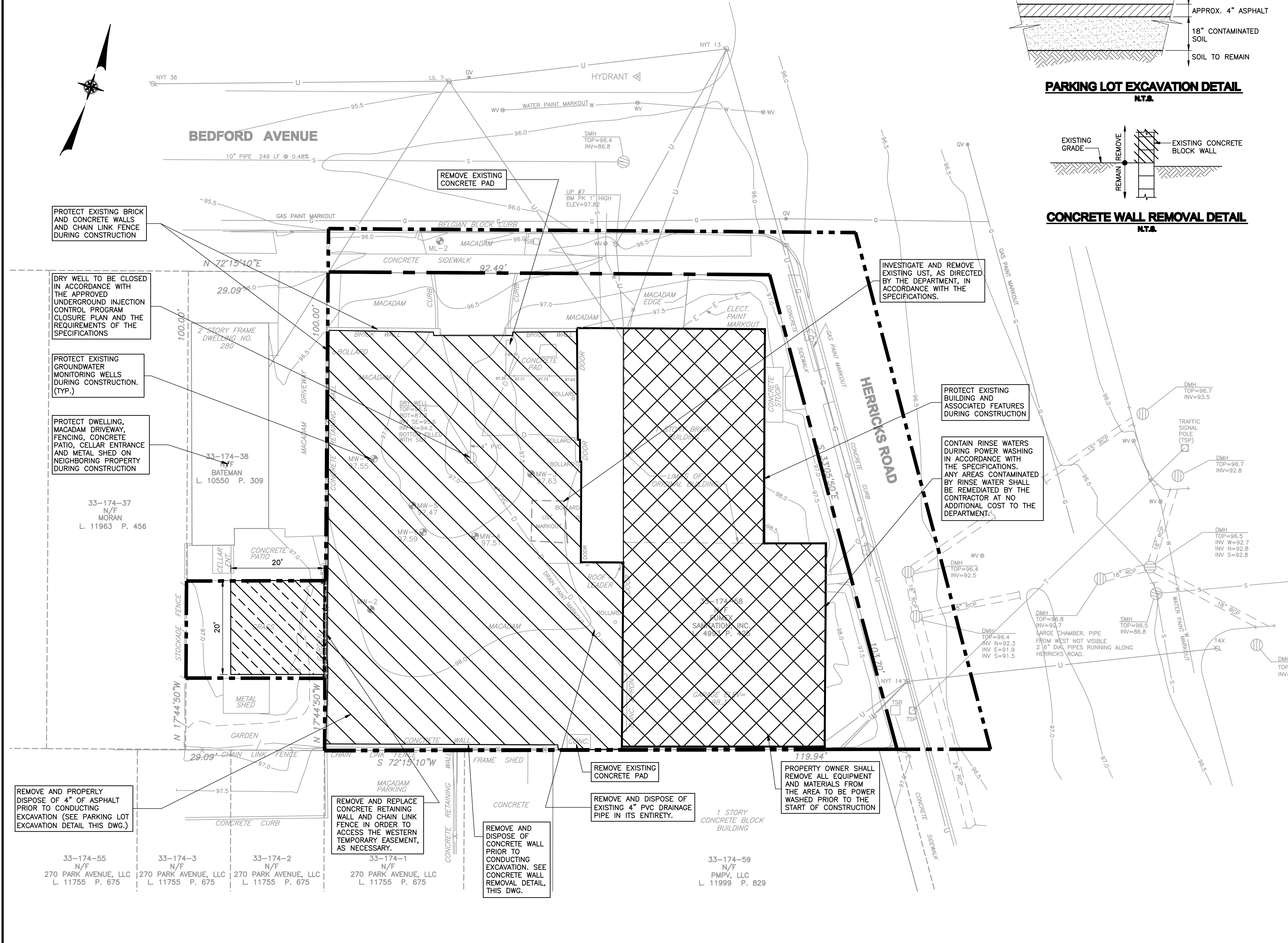

NO.	DATE	REVISION	INT.

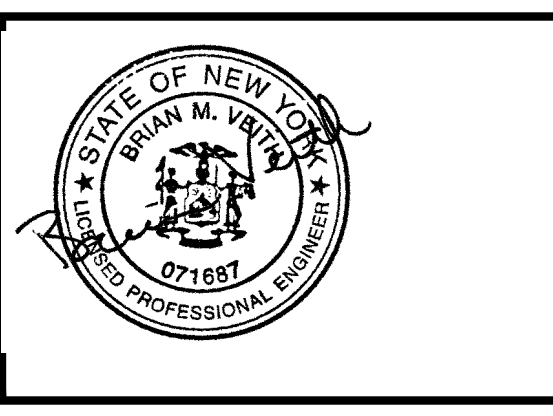

UNAUTHORIZED ALTERATION OR ADDITION TO THIS DOCUMENT IS A VIOLATION OF SECTION 7209 OF THE NEW YORK STATE EDUCATION LAW.

PROJECT ENGINEER: **FD** DRAWN BY: **CM**
 DESIGNED BY: **MRF/DF** CHECKED BY: **BMV**

db **Dvirka and Bartilucci**
 CONSULTING ENGINEERS
 A DIVISION OF WILLIAM F. COSULICH ASSOCIATES, P.C.

NEW YORK STATE DEPARTMENT OF ENVIRONMENTAL CONSERVATION
FUMEX SANITATION SITE NEW YORK
 NASSAU COUNTY
SOIL EXCAVATION AND ASPHALT COVER INSTALLATION
 CONTRACT NO. D007692

SITE REMEDIATION PLAN

PROJECT NO. **2602**
 DATE: **OCTOBER 2009**
 SCALE: **1"=10'**

DRAWING NO. **3**

Final Contract Drawing 2009-10-02 11:14 AM

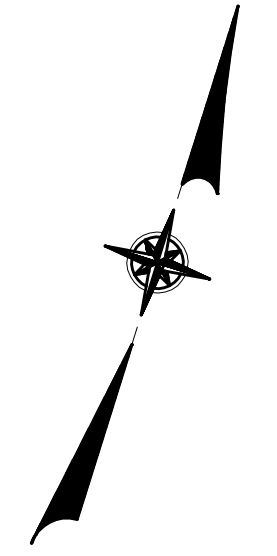

SEE ASPHALT COVER DETAIL DRAWING NO. 5 FOR ASPHALT COVER CONSTRUCTION. INSTALLATION SHALL CONFORM WITH THE REQUIREMENTS OF THE SPECIFICATIONS.

REPLACE BOLLARDS. SEE DRAWING NO. 5 FOR TYPICAL REPLACEMENT DETAIL.

PLACE 14" OF GENERAL FILL, 4" OF TOPSOIL AND SOD IN ACCORDANCE WITH THE SPECIFICATIONS

REPLACE TREES 3'-0" O.C. IN ACCORDANCE WITH THE SPECIFICATIONS. REFER TO DRAWING NO. 5 FOR TREE PLANTING DETAIL.

15± FOOT LONG TRENCH DRAIN (H2O RATED), REFER TO DRAWING NO. 5 FOR CONSTRUCTION DETAIL.

BEDFORD AVENUE

4'-0" PRE-CAST DRAINAGE MANHOLE (TYP.) REFER TO DRAWING NO. 6 FOR TYPICAL CONSTRUCTION DETAIL.

REMOVE AND REPLACE EXISTING ASPHALT. REFER TO DRAWING NO. 5 FOR TYPICAL ON-SITE ASPHALT RESTORATION DETAIL.

RESTORE EXISTING GRASS AREA WITH TOPSOIL AND SOD. REFER TO DRAWING NO. 5 FOR TYPICAL RESTORATION DETAIL.

REPLACE EXISTING HANDICAP RAMP IN KIND. REFER TO DRAWING NO. 6 FOR TYPICAL RESTORATION DETAIL.

PROTECT EXISTING TREE DURING CONSTRUCTION, IF IT IS DETERMINED THAT THE TREE'S ROOT SYSTEM WILL BE DAMAGED AS A RESULT OF CONSTRUCTION, REMOVE AND REPLACE TREE IN KIND IN ACCORDANCE WITH NASSAU COUNTY AND TOWN OF NORTH HEMPSTEAD REQUIREMENTS.

REMOVE AND REPLACE EXISTING CONCRETE SIDEWALK. REFER TO DRAWING NO. 6 FOR TYPICAL RESTORATION DETAIL.

RESTORE EXISTING GRASS AREA WITH TOPSOIL AND SOD. REFER TO DRAWING NO. 5 FOR TYPICAL RESTORATION DETAIL.

GAS SERVICE PIPING REPORTEDLY ABANDONED BY UTILITY COMPANY. PRIOR TO START OF WORK, CONTRACTOR SHALL NOTIFY GAS UTILITY COMPANY TO CONFIRM STATUS OF EXISTING GAS UTILITY IN THIS AREA. CONTRACTOR SHALL LOCATE GAS UTILITY BY HAND AND, IF NECESSARY, CUT AND CAP EXISTING GAS PIPING IN ACCORDANCE WITH UTILITY COMPANY REQUIREMENTS PRIOR TO INSTALLATION OF DRAINAGE MANHOLE AND ASSOCIATED PIPING.

RESTORE EXISTING CONCRETE CURB IN KIND. REFER TO DRAWING NO. 5 FOR TYPICAL RESTORATION DETAIL.

REPLACE EXISTING SHOULDER AND RESTORE STRIPING. REFER TO DRAWING NO. 6 FOR TYPICAL RESTORATION DETAILS.

SAWCUT AND CHIP OUT EXISTING MANHOLE FOR NEW PIPE PENETRATION AS APPROVED BY NASSAU COUNTY. EXISTING RIM/INV. OF DRAINAGE STRUCTURE APPROXIMATE. CONTRACTOR SHALL FIELD VERIFY.

INSTALLATION OF THE EPOXY RESIN FLOOR COATING SHALL BE IN ACCORDANCE WITH THE SPECIFICATIONS AND ALL APPLICABLE MANUFACTURER'S RECOMMENDATIONS

LEGEND:

- EXTENT OF ASPHALT COVER
- AREA OF BUILDING TO BE SEALED WITH EPOXY RESIN COATING
- AREA TO BE RESTORED WITH TOPSOIL AND SOD
- ON-SITE AREA TO BE RESTORED WITH ASPHALT PAVEMENT
- AREA TO BE RESTORED WITH CONCRETE SIDEWALK AND HANDICAP RAMP

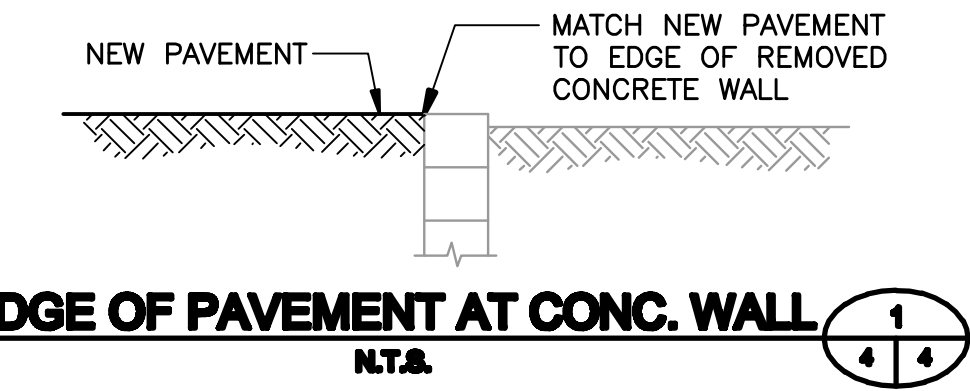

2 STORY FRAME DWELLING NO. 280

33-174-38 N/F BATEMAN L. 10550 P. 309

33-174-37 N/F MORAN L. 11963 P. 456

CONCRETE PATIO 17'

METAL SHED

GARDEN

CHAIN LINK FENCE

CONCRETE CURB

33-174-55 N/F 270 PARK AVENUE, LLC L. 11755 P. 675

33-174-3 N/F 270 PARK AVENUE, LLC L. 11755 P. 675

33-174-2 N/F 270 PARK AVENUE, LLC L. 11755 P. 675

33-174-1 N/F 270 PARK AVENUE, LLC L. 11755 P. 675

33-174-59 N/F PMPV, LLC L. 11999 P. 829

NO.	DATE	REVISION	INT.

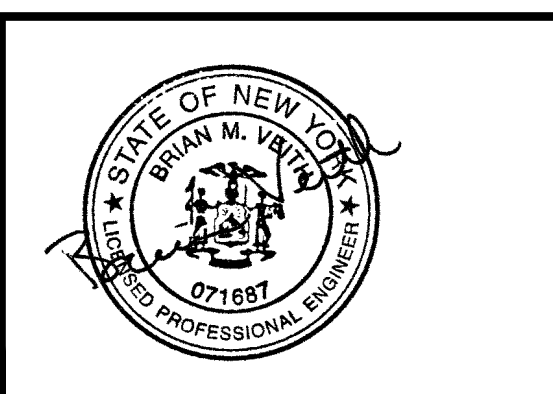

UNAUTHORIZED ALTERATION OR ADDITION TO THIS DOCUMENT IS A VIOLATION OF SECTION 7209 OF THE NEW YORK STATE EDUCATION LAW.

PROJECT ENGINEER: **FD** DRAWN BY: **CM**

DESIGNED BY: **MRD/FD** CHECKED BY: **BMV**

db **Dvirka and Bartilucci**
CONSULTING ENGINEERS
A DIVISION OF WILLIAM F. COBULICH ASSOCIATES, P.C.

NEW YORK STATE DEPARTMENT OF ENVIRONMENTAL CONSERVATION

NASSAU COUNTY **FUMEX SANITATION SITE** NEW YORK

SOIL EXCAVATION AND ASPHALT COVER INSTALLATION

CONTRACT NO. D007692

SITE RESTORATION PLAN

PROJECT NO. **2602**

DATE: **OCTOBER 2009**

SCALE: **1"=10'**

DRAWING NO. **4**

F:\0002\Final Contract Drawings\2009\2602\2602-04.dwg, 4 - RESTORATION PLAN, 10/02/2009 8:11:48 PM, NVA

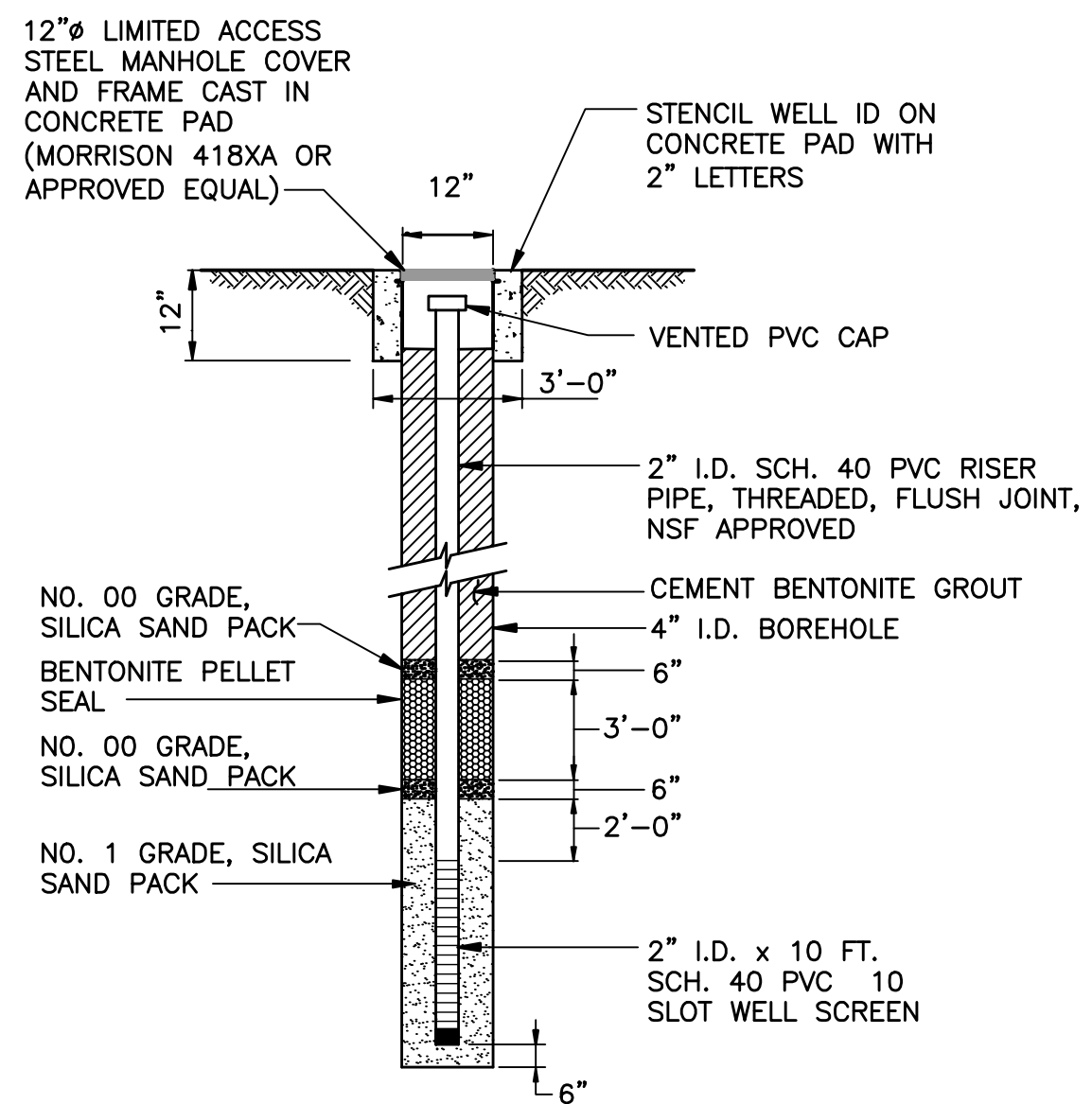

OFF-SITE GROUNDWATER MONITORING WELL DETAIL
N.T.S.

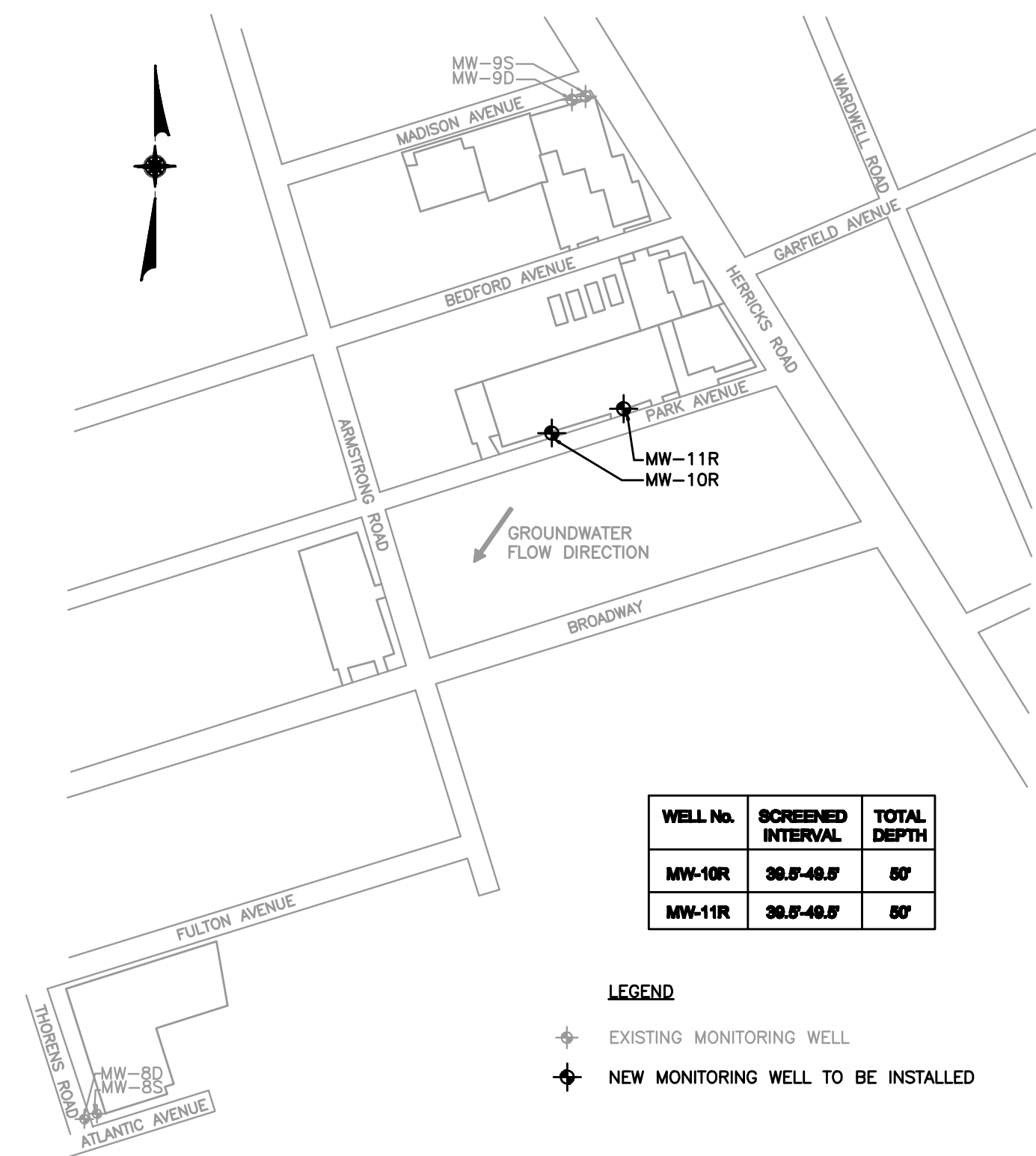

OFF-SITE GROUNDWATER MONITORING WELL INSTALLATION PLAN
APPROXIMATE SCALE: 1"=200'

WELL No.	SCREENED INTERVAL	TOTAL DEPTH
MW-10R	30.0'-40.0'	50'
MW-11R	30.0'-40.0'	50'

LEGEND
 * EXISTING MONITORING WELL
 * NEW MONITORING WELL TO BE INSTALLED

- NOTES:**
- OFF-SITE MONITORING WELL LOCATIONS ARE APPROXIMATE AND SHALL BE LOCATED IN THE FIELD AS DIRECTED BY THE DEPARTMENT. LOCATIONS OF NEW MONITORING WELLS WILL BE WITHIN THE PUBLIC RIGHT-OF-WAY.
 - CONTRACTOR, ENGINEER AND DEPARTMENT SHALL JOINTLY OBSERVE THE LOCATIONS PRIOR TO THE START OF CONSTRUCTION.
 - CONTRACTOR SHALL BE RESPONSIBLE FOR OBTAINING ALL FEDERAL, STATE AND LOCAL PERMITS FOR THE INSTALLATION OF OFF-SITE WELLS, INCLUDING BUT NOT LIMITED TO ROAD OPENING PERMITS.

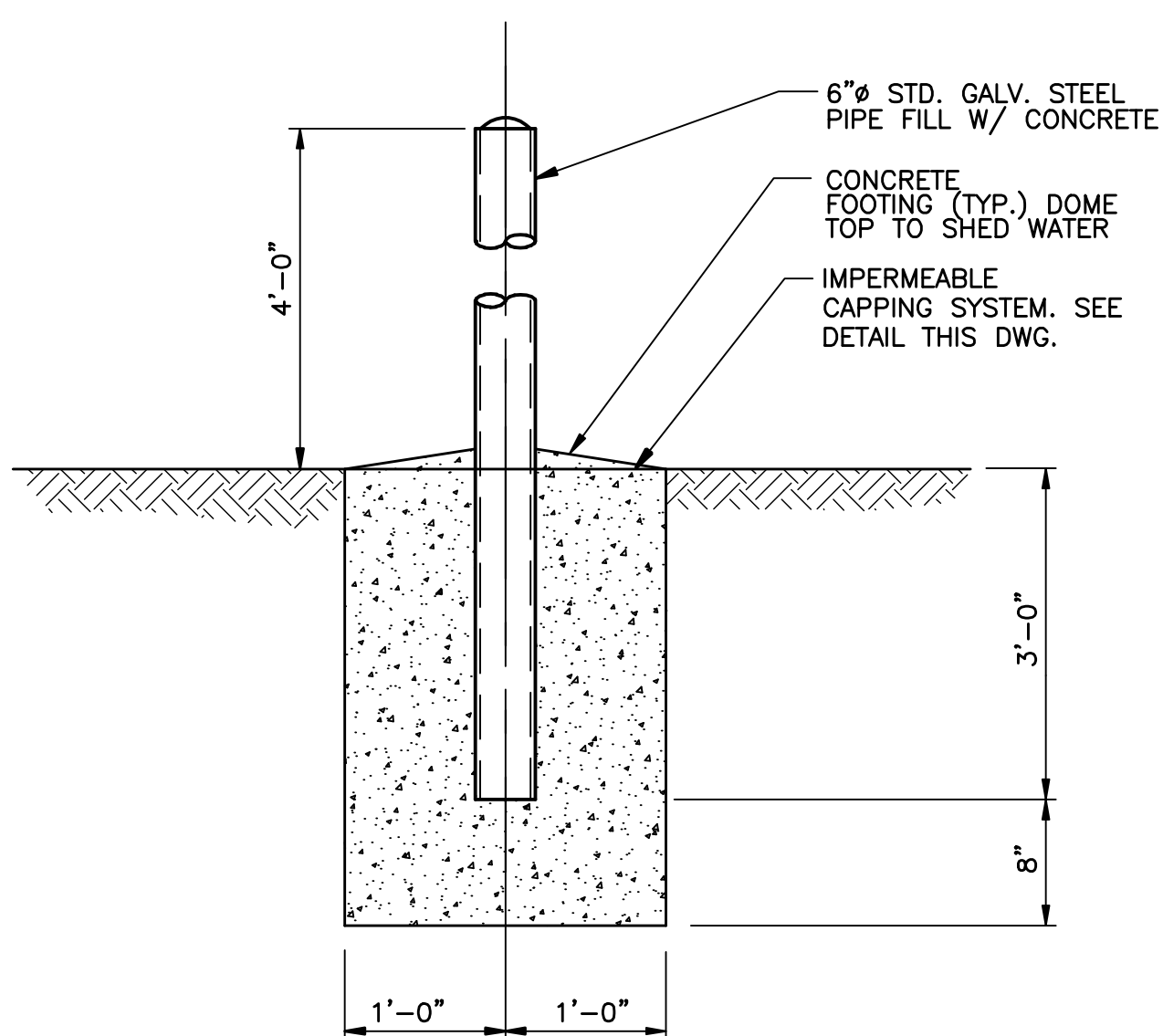

BOLLARD DETAIL
N.T.S.

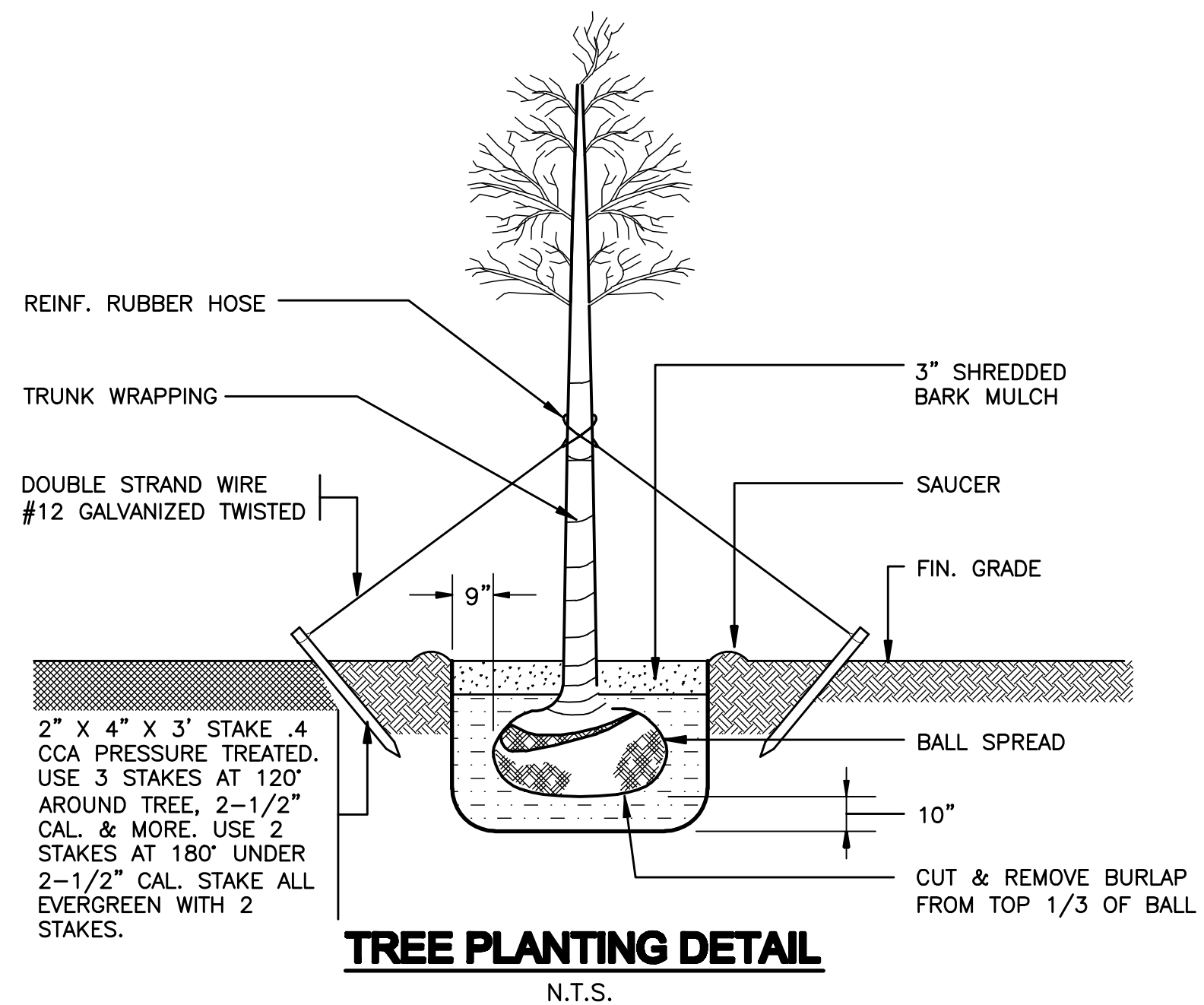

TREE PLANTING DETAIL
N.T.S.

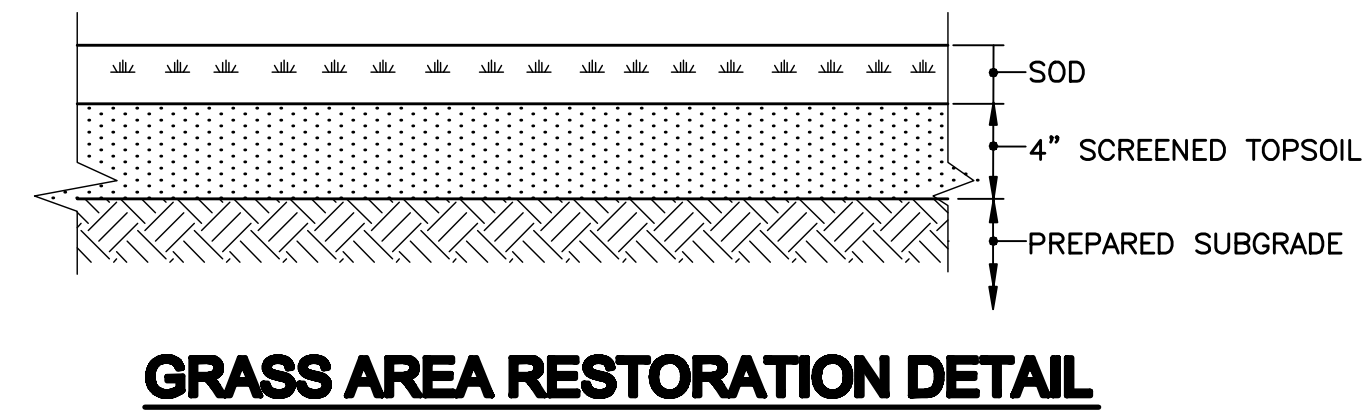

GRASS AREA RESTORATION DETAIL
N.T.S.

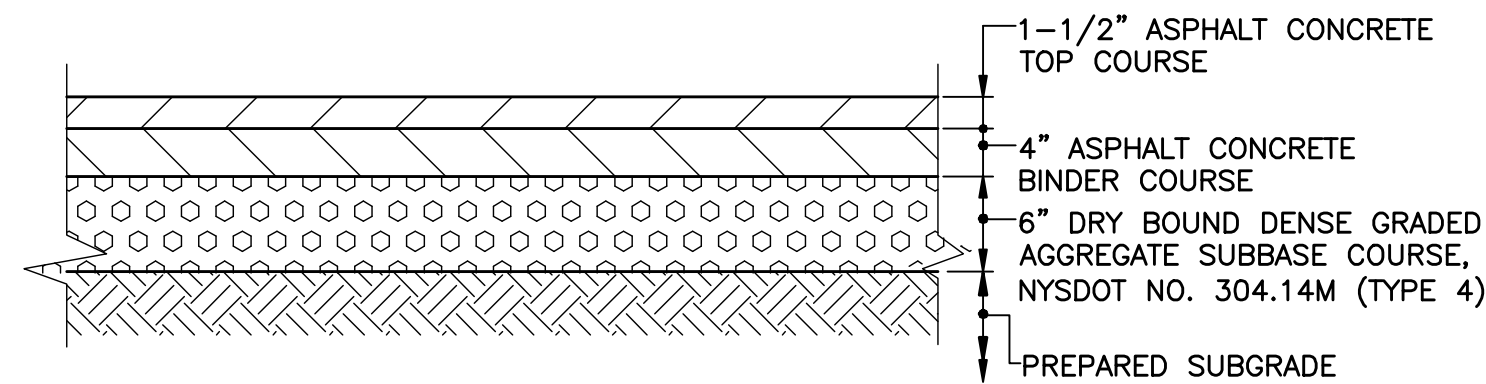

ON-SITE ASPHALT REPLACEMENT DETAIL
N.T.S.

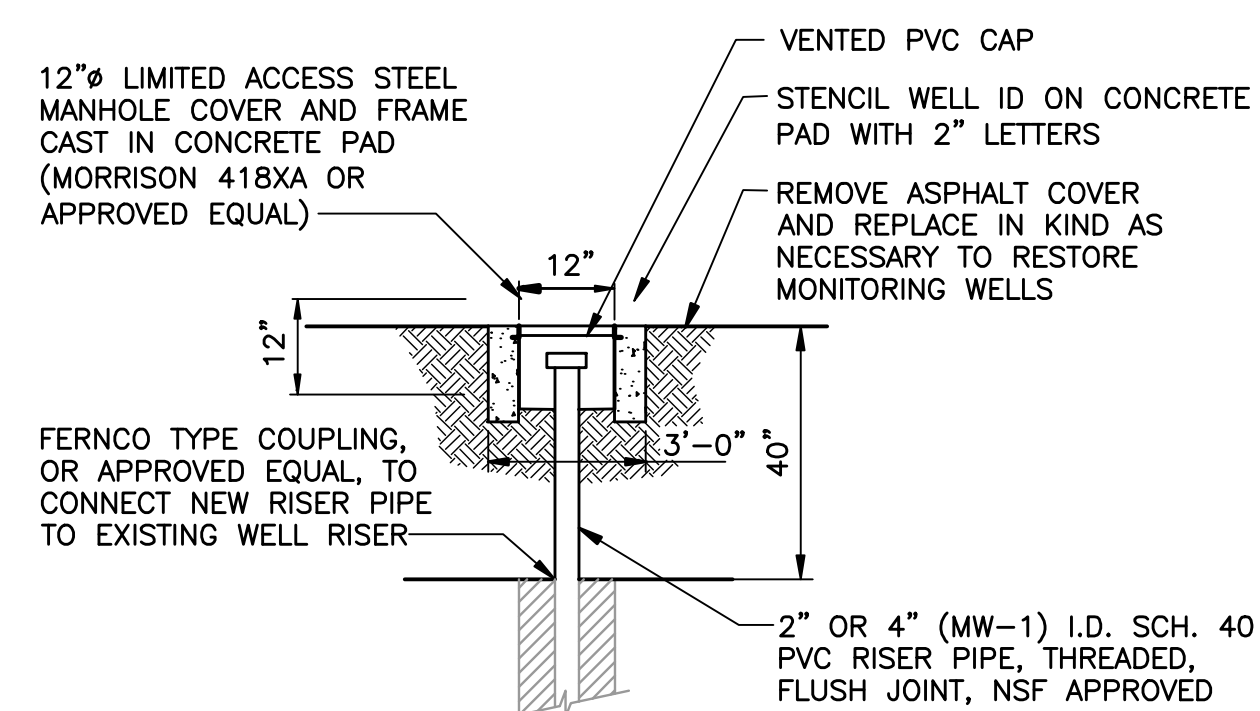

ON-SITE GROUNDWATER MONITORING WELL RESTORATION DETAIL
N.T.S.

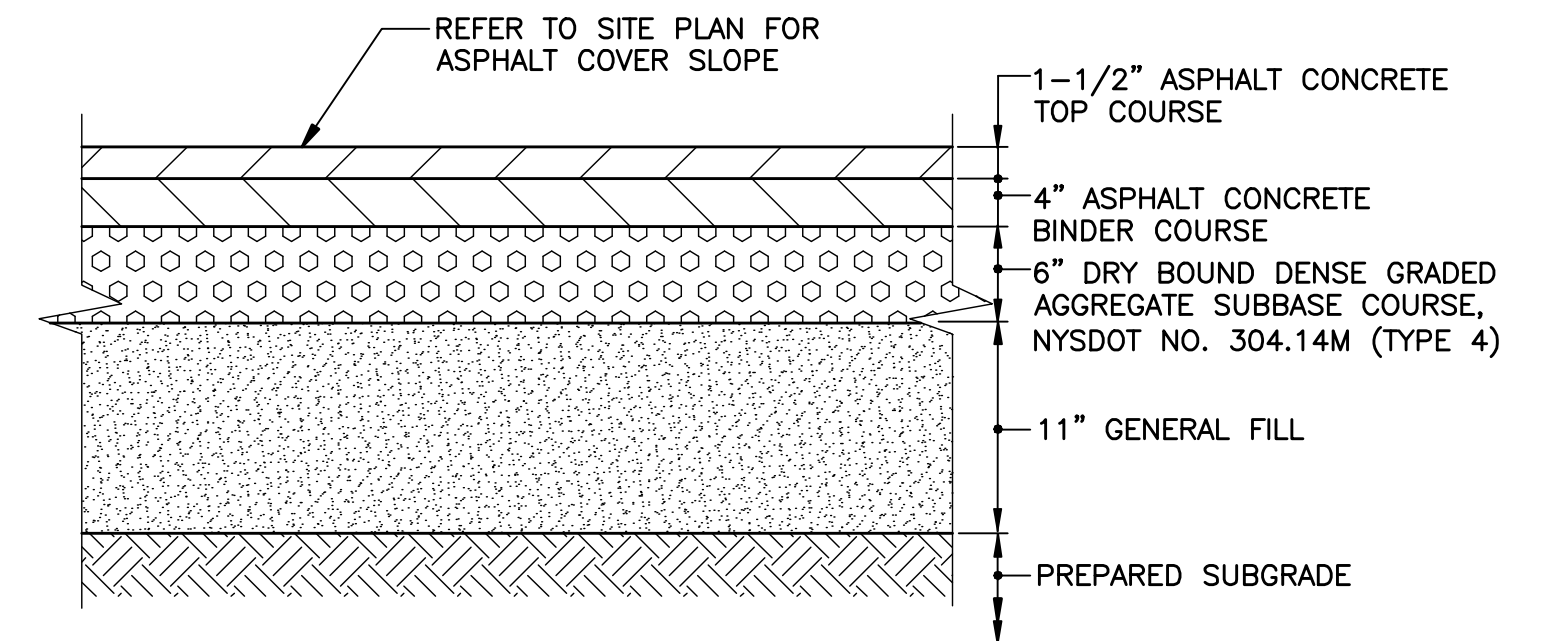

ASPHALT COVER DETAIL
N.T.S.

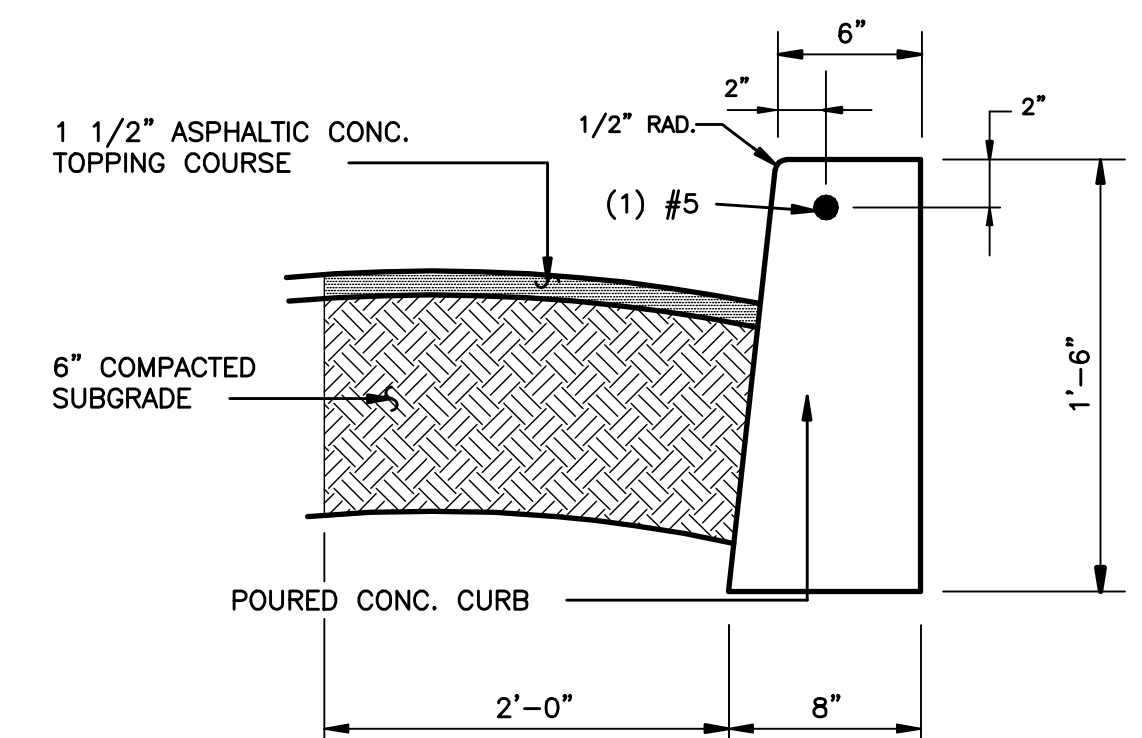

CONCRETE CURB DETAIL
N.T.S.

- NEW CURB SHALL HAVE A SMOOTH TRANSITION WITH EXISTING CURB
- CURB REVEL SHALL BE 6" EXCEPT AT DROP-CURB AND/OR HANDICAP RAMP. (SEE RESPECTIVE DETAILS)
- 1/2" PREMOULDED EXPANSION JOINT FILLER SHALL BE INSTALLED 20' O.C.

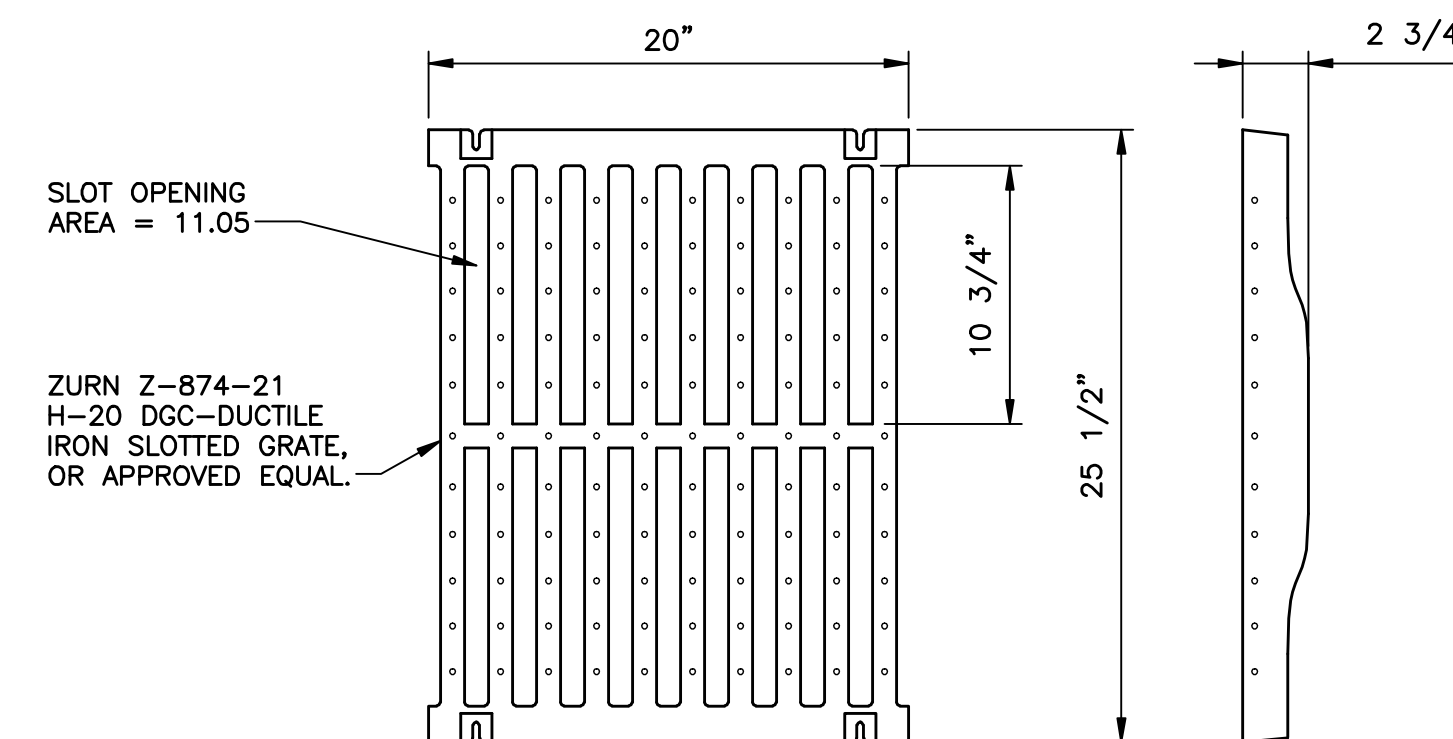

TRENCH DRAIN GRATE DETAIL
N.T.S.

- NOTES:**
 DCT-DUCTILE IRON SLOTTED GRATE
 MATERIAL - DUCTILE IRON
 DIN RATING - CLASS C
 WEIGHT - 89.8 (53.7#PER FT.)
 OPEN AREA - 210.238 SQ. IN. PER FT.

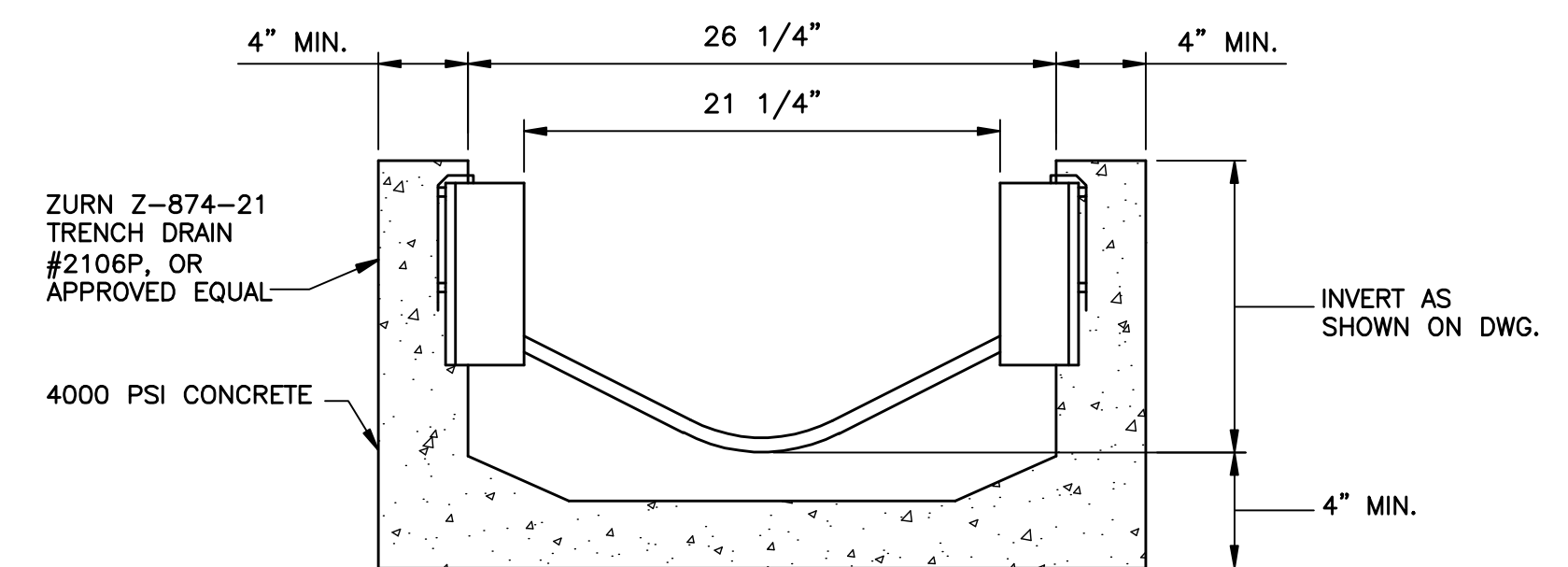

TRENCH DRAIN DETAIL
N.T.S.

NO.	DATE	REVISION	INT.



UNAUTHORIZED ALTERATION OR ADDITION TO THIS DOCUMENT IS A VIOLATION OF SECTION 7209 OF THE NEW YORK STATE EDUCATION LAW.

PROJECT ENGINEER: FD	DRAWN BY: LVG
DESIGNED BY: MRD/FD	CHECKED BY: BMV



NEW YORK STATE DEPARTMENT OF ENVIRONMENTAL CONSERVATION
FUMEX SANITATION SITE
 NASSAU COUNTY NEW YORK
SOIL EXCAVATION AND ASPHALT COVER INSTALLATION
 CONTRACT NO. D007692

DETAILS I

PROJECT NO. 2002	DRAWING NO. 5
DATE: OCTOBER 2008	
SCALE: NONE	

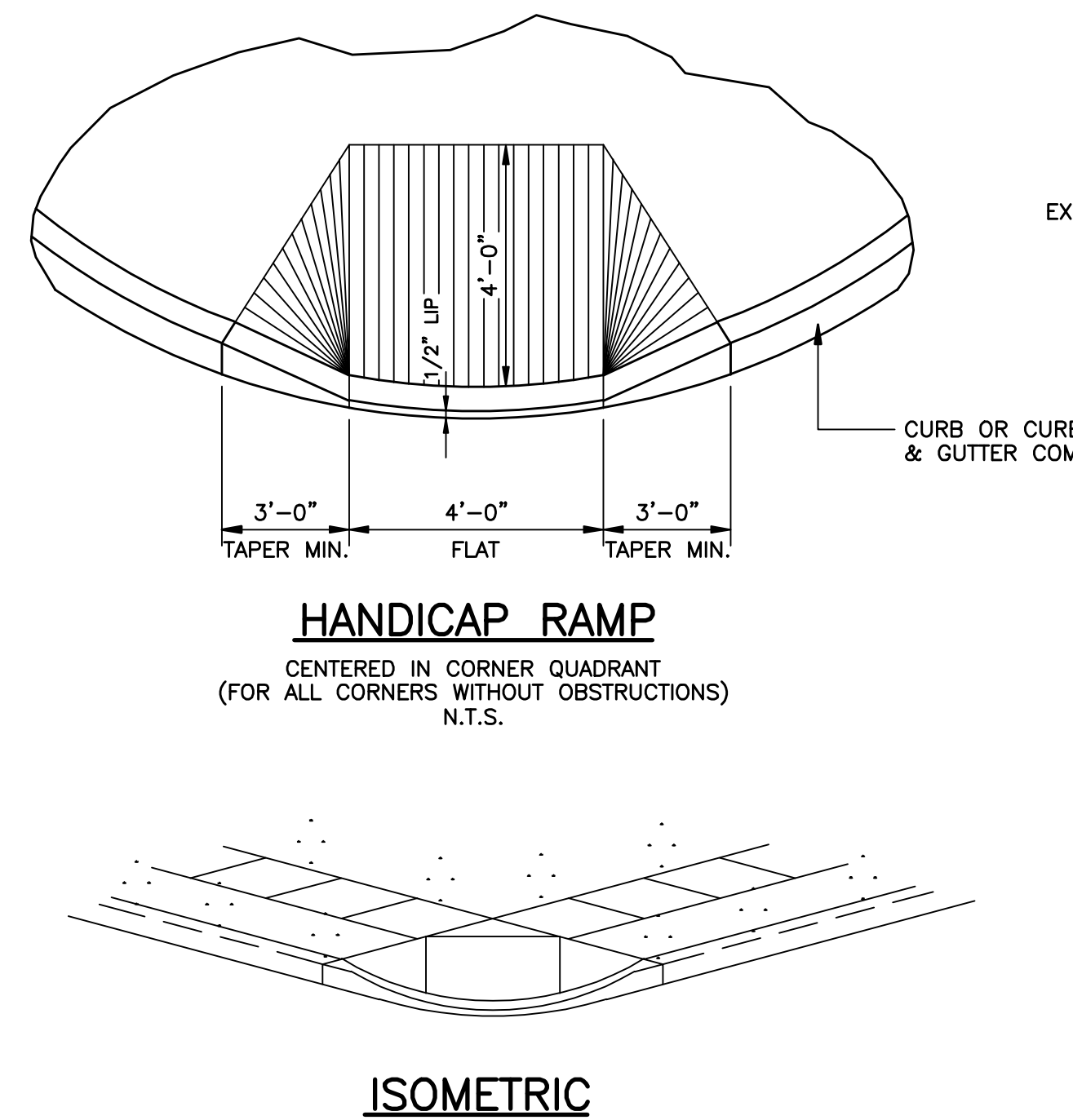
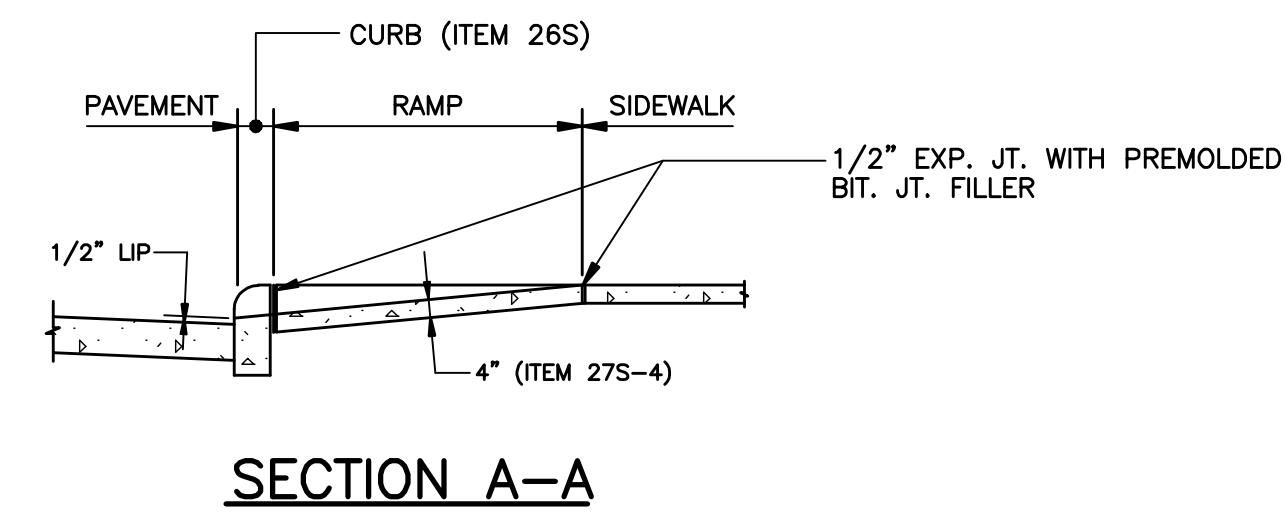
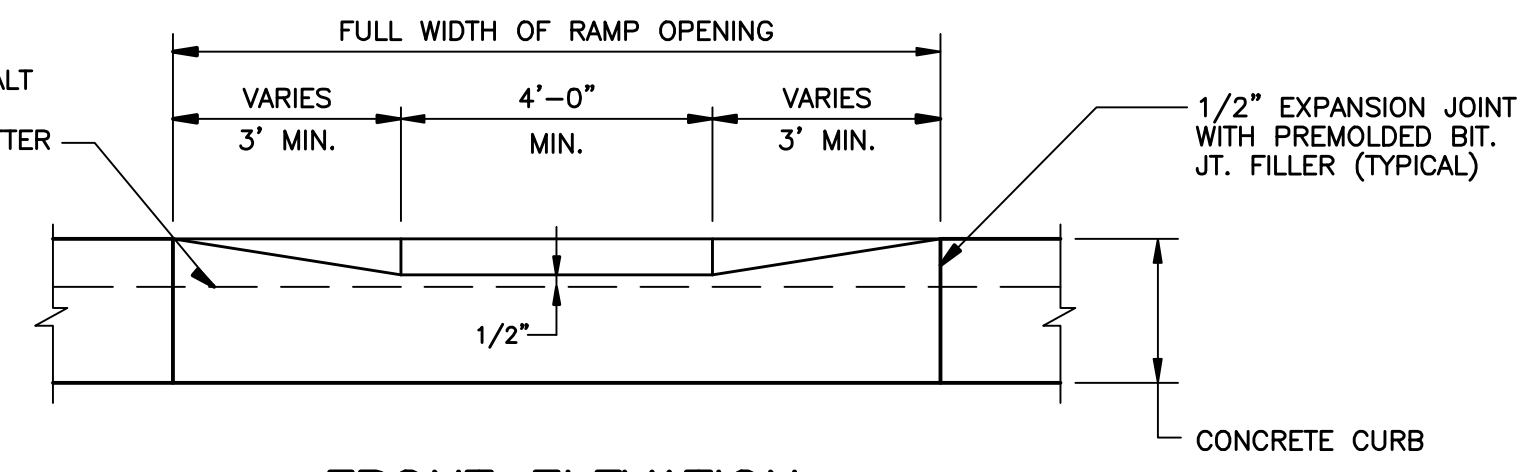
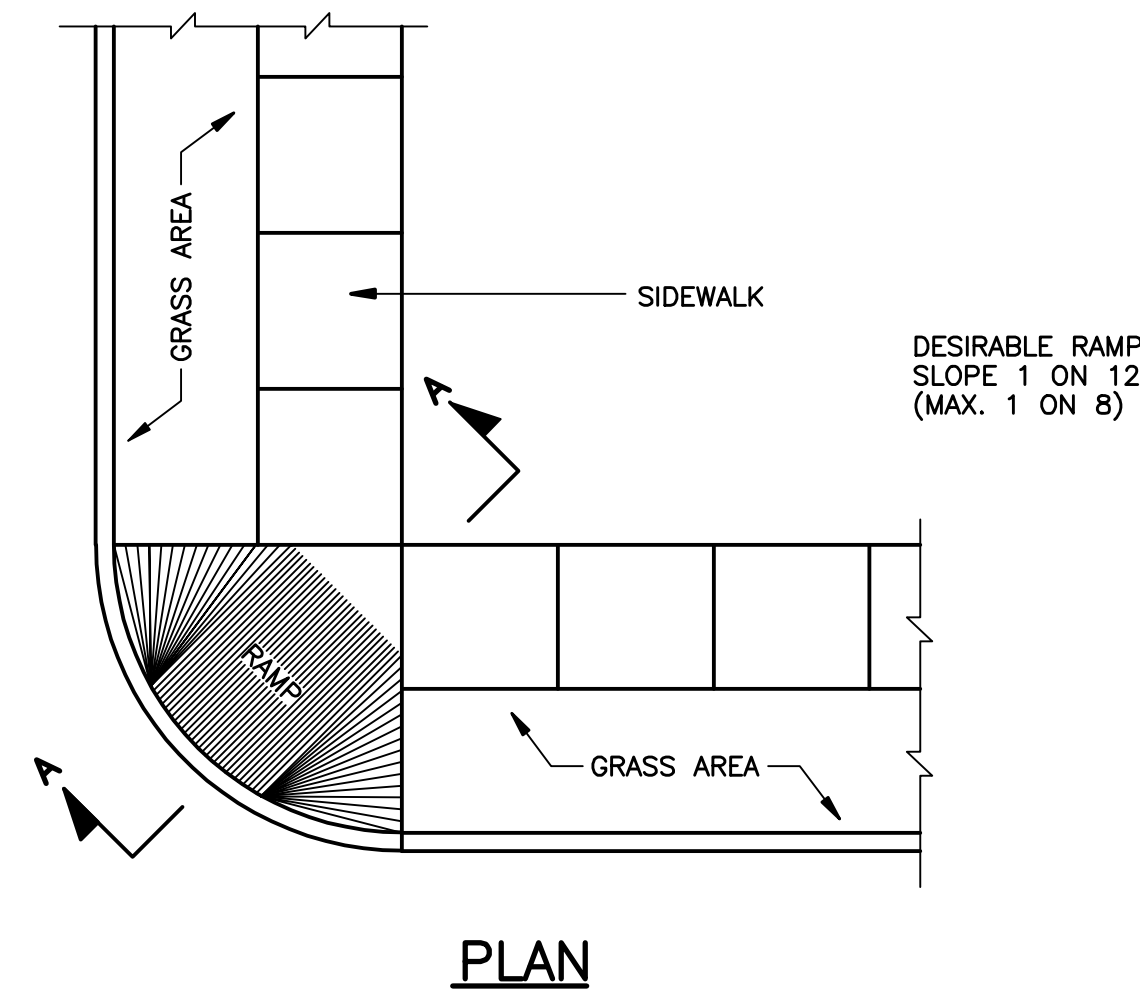
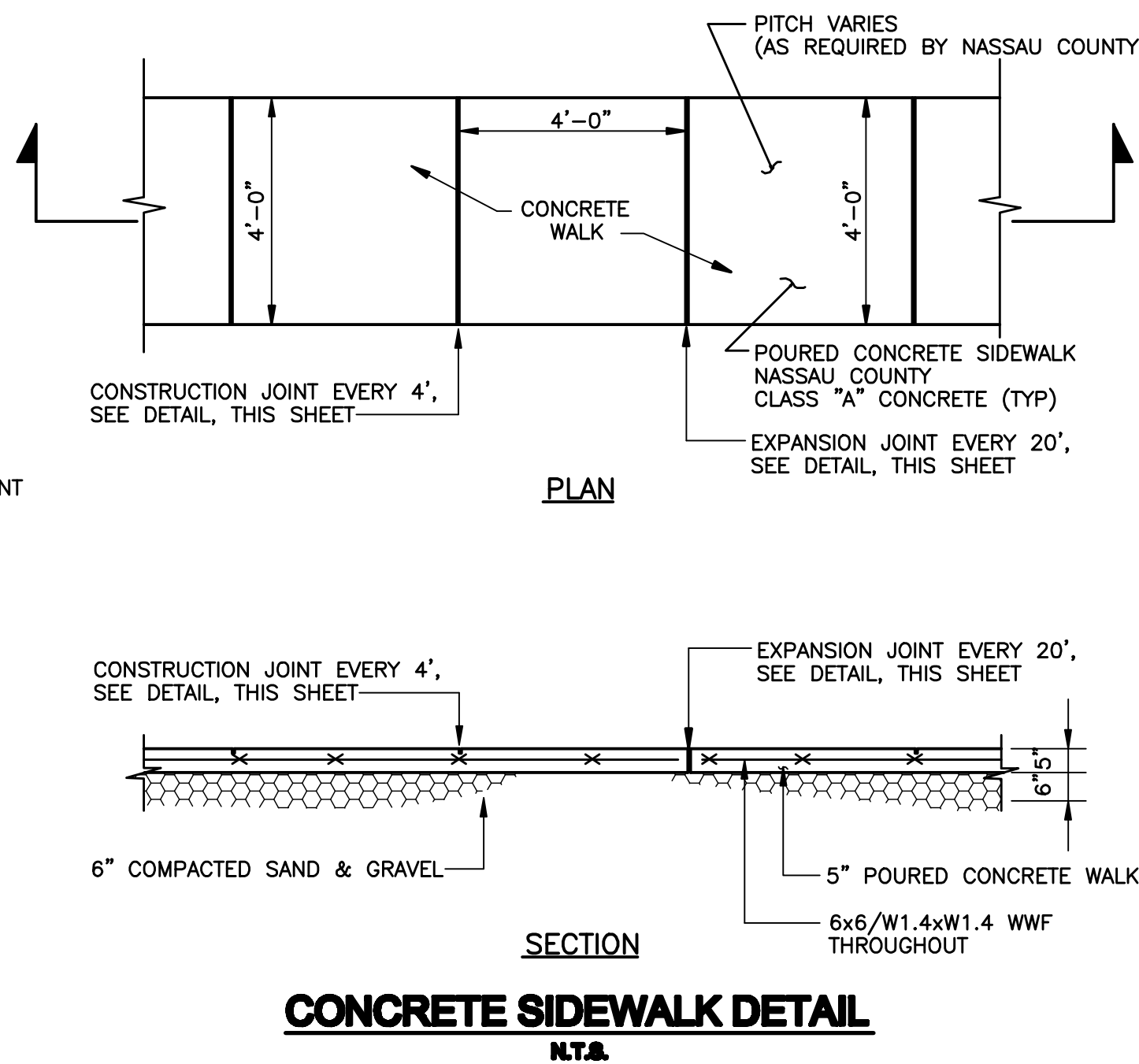
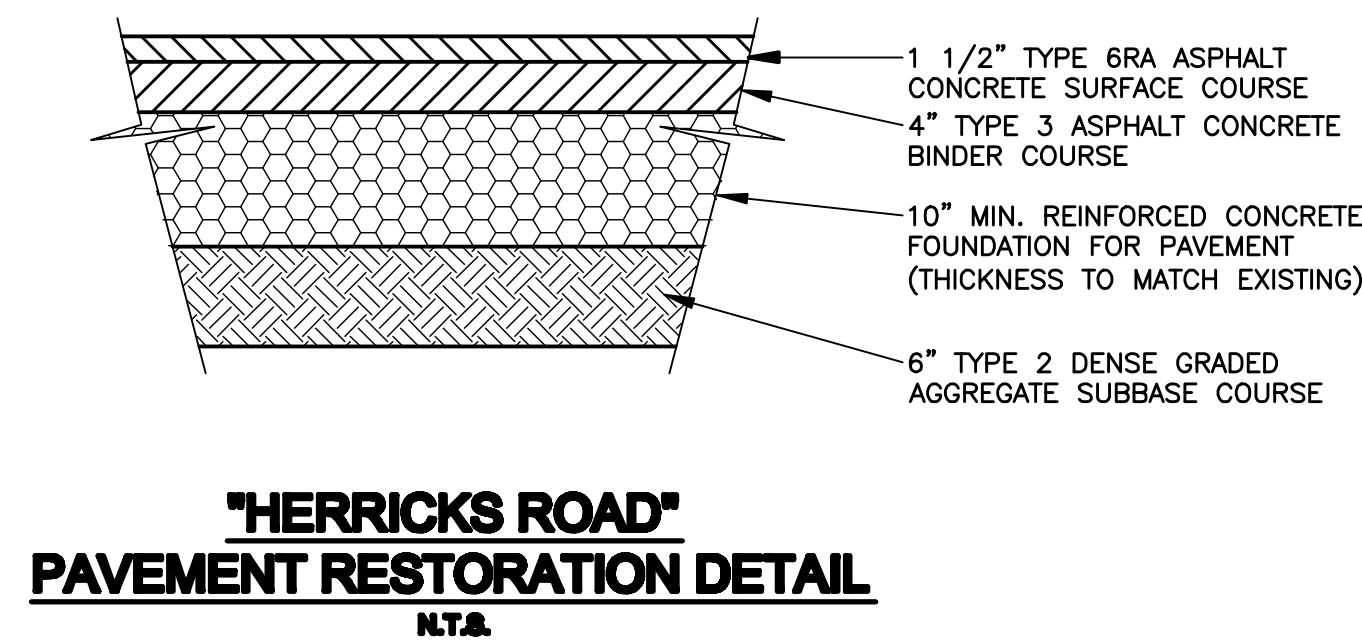
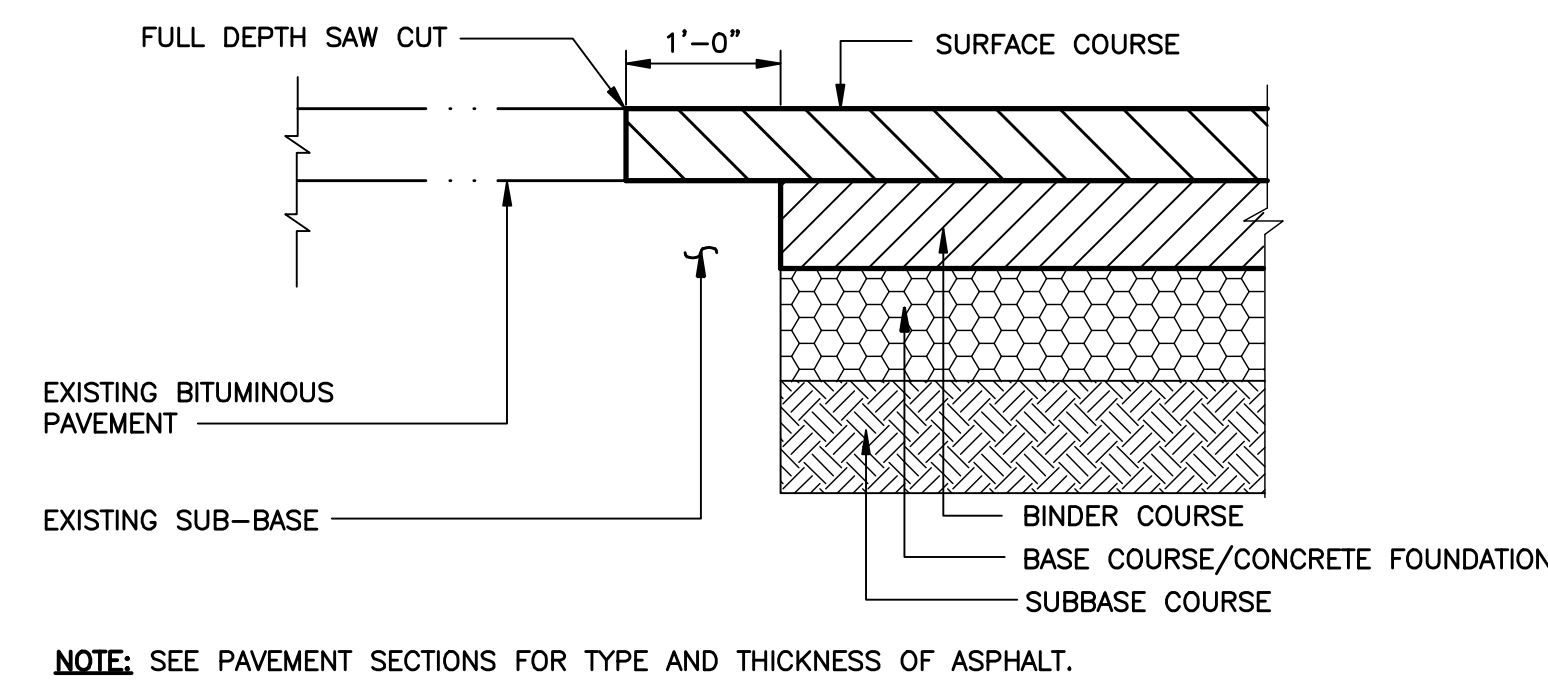
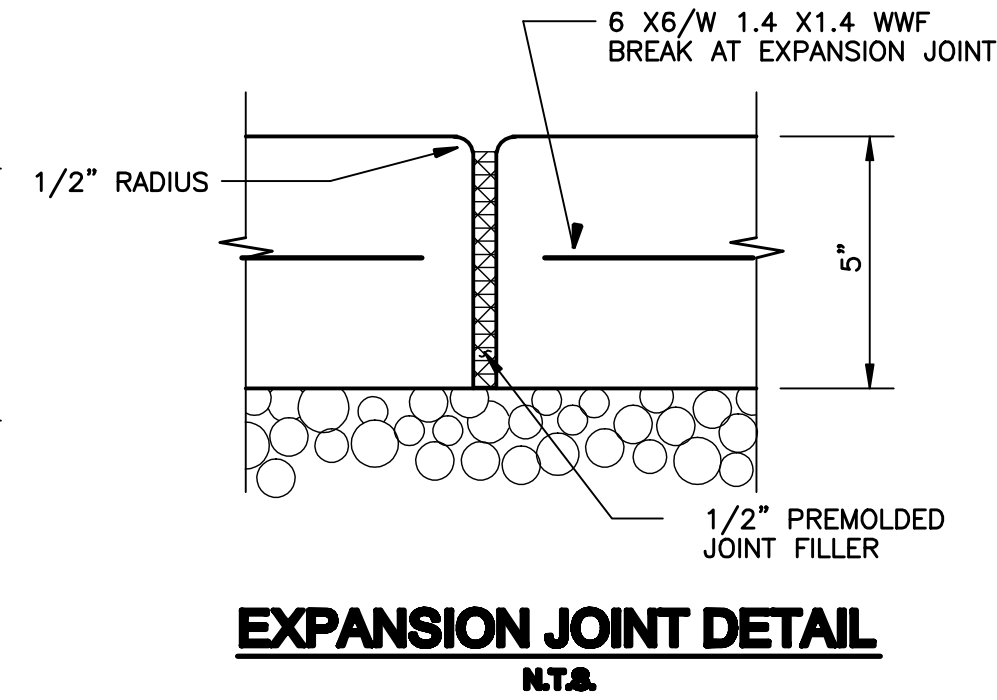
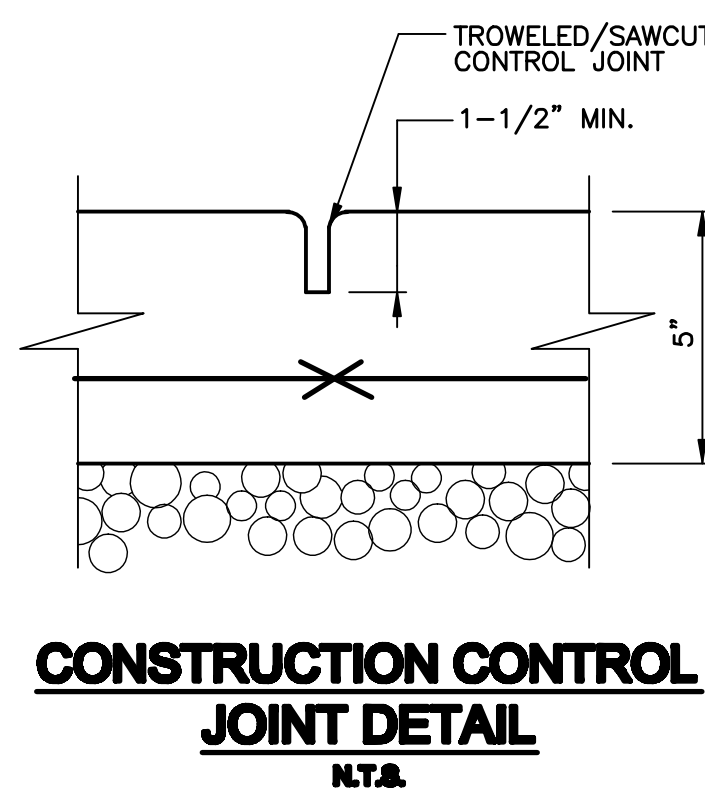
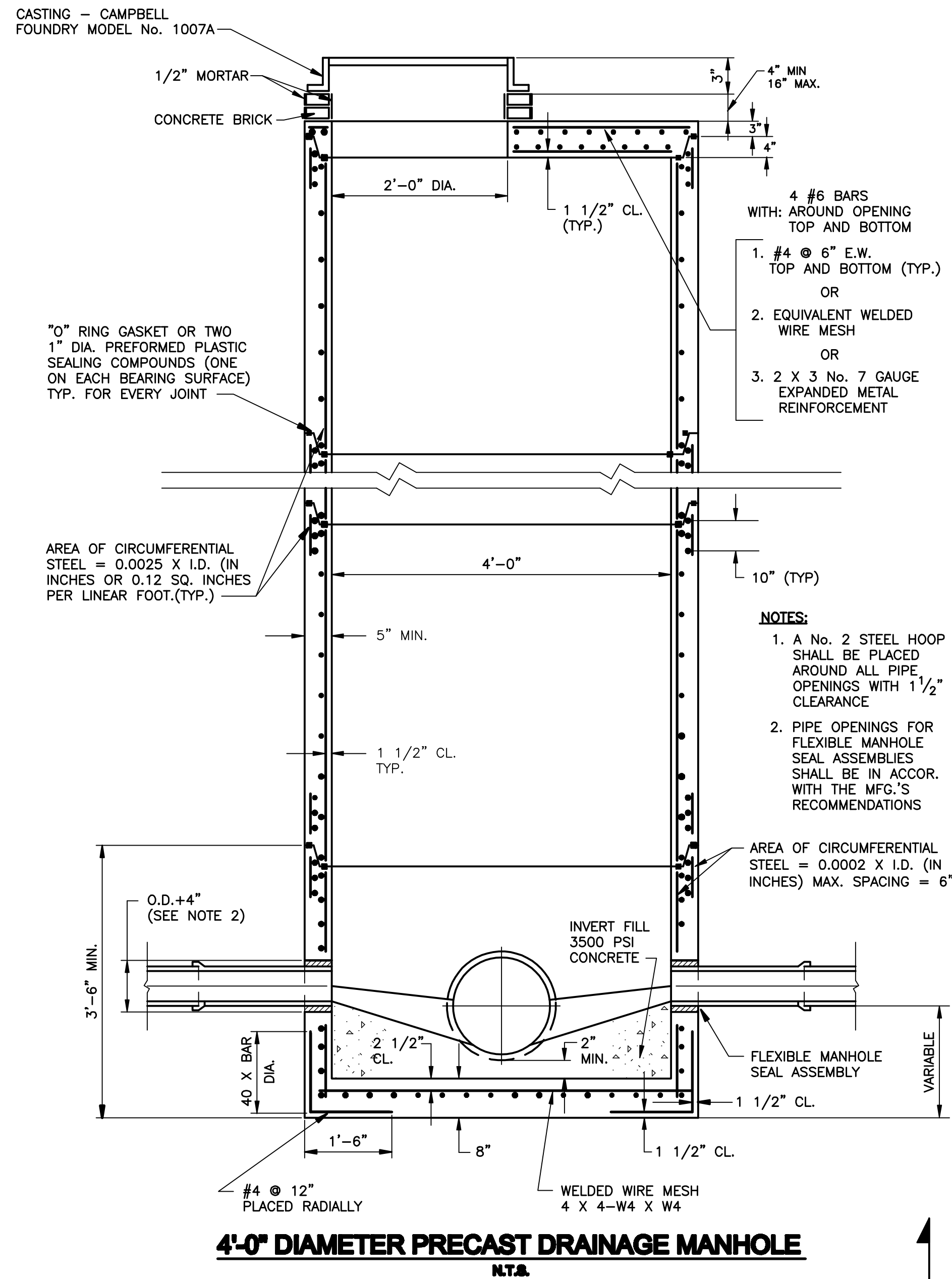

- HANDICAP RAMP NOTES:**
- CURB CUT RAMPS TYPE AND LOCATION ARE TO BE AS SHOWN ON THE PLANS OR AS DIRECTED BY THE ENGINEER
 - SURFACE TEXTURE OF THE RAMP SHALL BE TRANSVERSELY DEEP GROOVED 1/2" WIDE X 1/4" DEEP ON 1" CENTERS.
 - THE NORMAL PAVEMENT EDGE PROFILE SHALL BE MAINTAINED THROUGH THE AREA OF THE RAMP.
 - WHEN AN INTERSECTION CONTAINS PEDESTRIAN ACTIVATED SIGNALS, MAKE PROVISIONS FOR A PERSON IN A WHEELCHAIR TO ACTIVATE THE SIGNAL WITHOUT STOPPING ON RAMP.
 - STOP LINES ARE TO BE PROVIDED IN ADVANCE OF WHEELCHAIR RAMPS.
 - WHERE FEASIBLE PROVIDE FOR DRAINAGE PICK UPS IMMEDIATELY UP STREAM FROM THE RAMP.

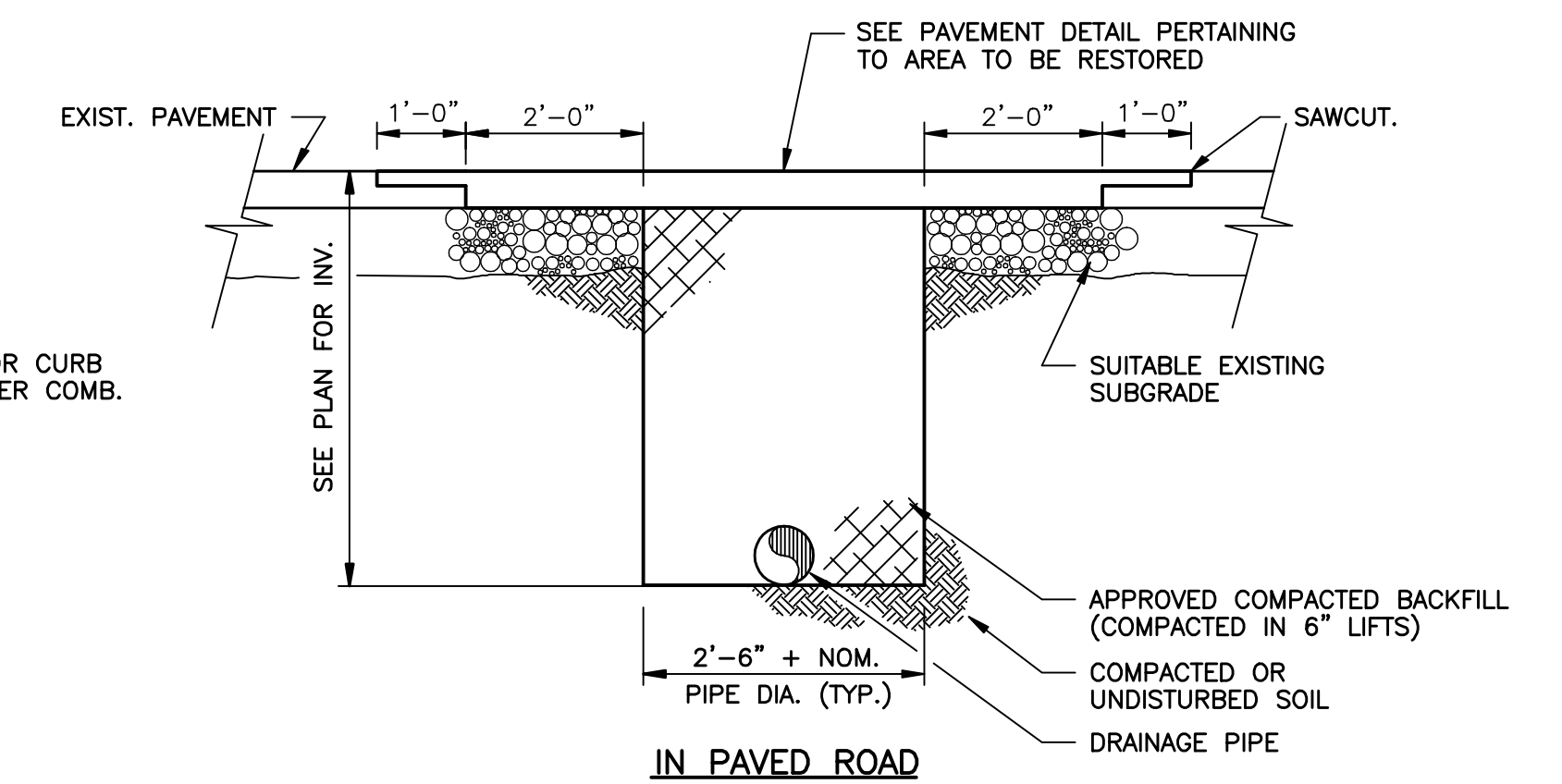
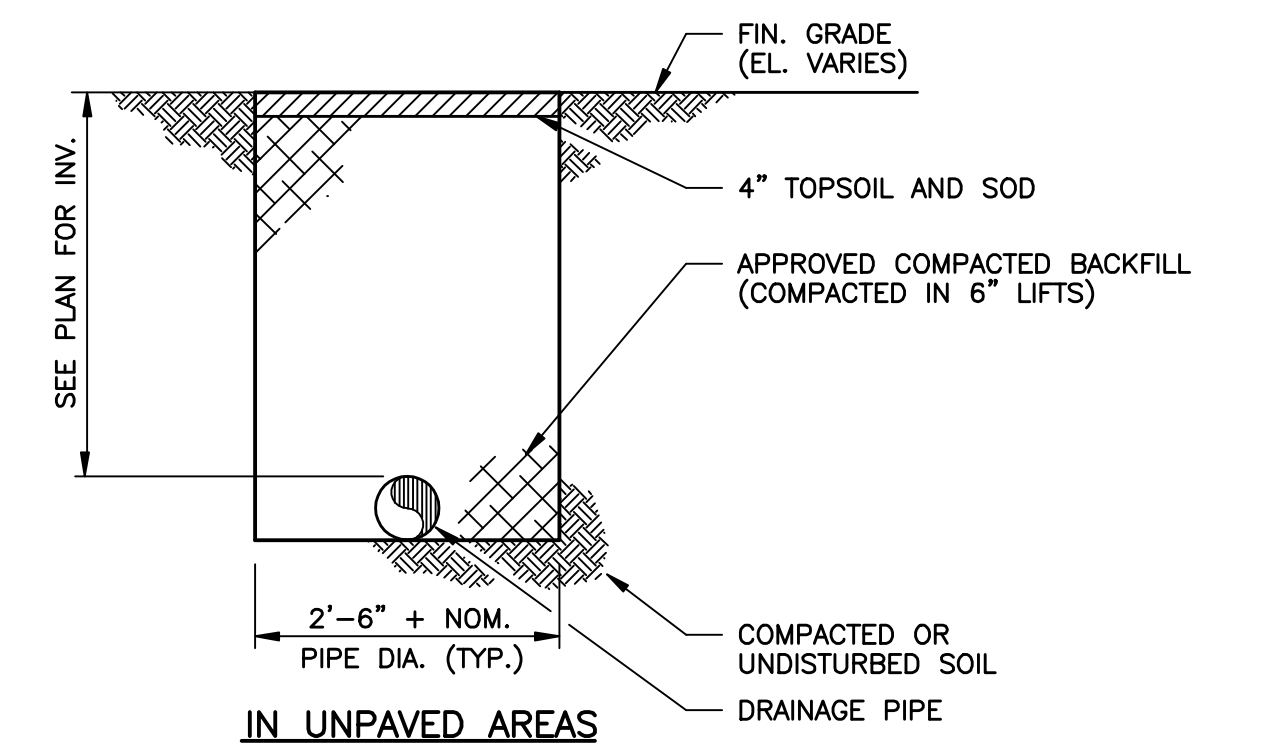
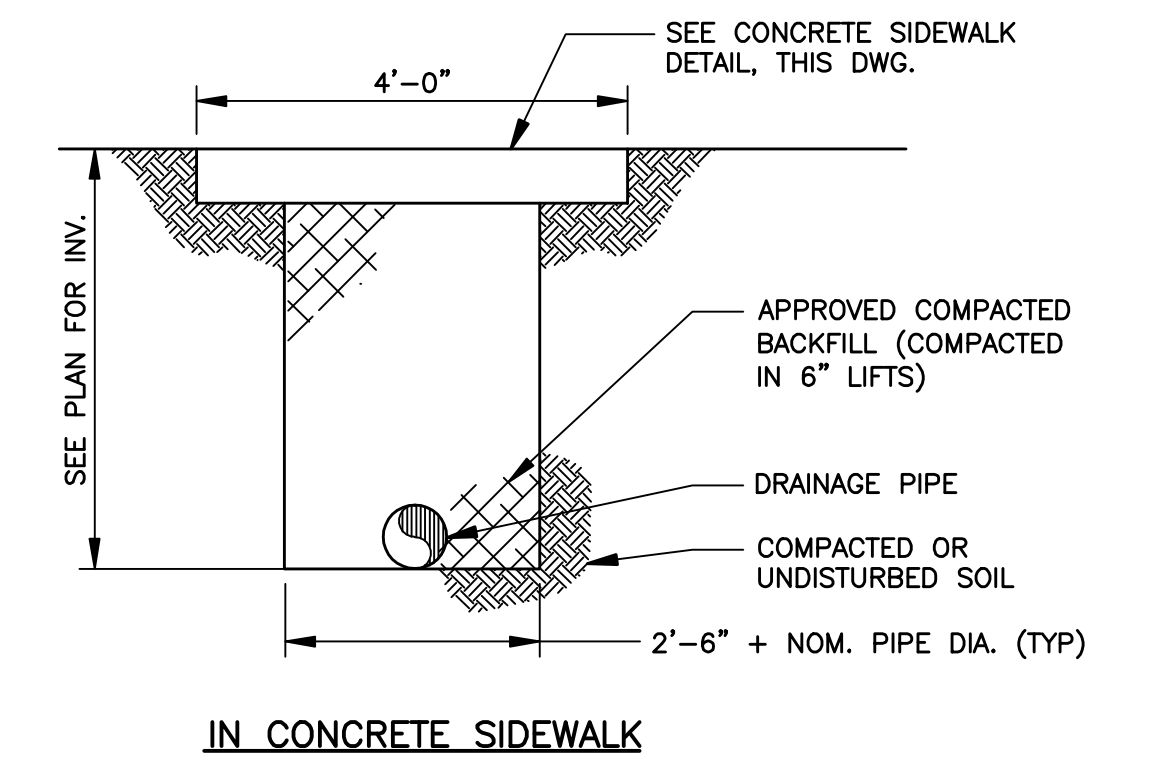

NO.	DATE	REVISION	INT.

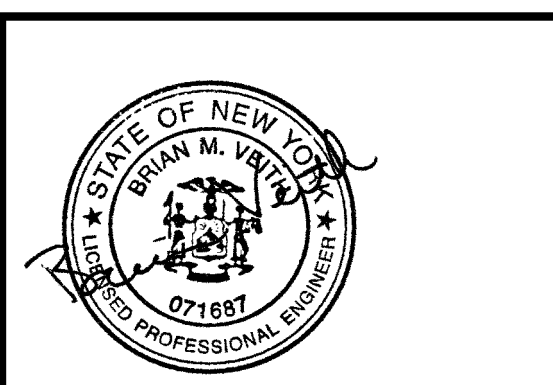

UNAUTHORIZED ALTERATION OR ADDITION TO THIS DOCUMENT IS A VIOLATION OF SECTION 7209 OF THE NEW YORK STATE EDUCATION LAW.

PROJECT ENGINEER: **FD**
DRAWN BY: **LVG**
DESIGNED BY: **MRF/FD**
CHECKED BY: **BMV**

db Dvirka and Bartilucci
CONSULTING ENGINEERS
A DIVISION OF WILLIAM F. COSULICH ASSOCIATES, P.C.

NEW YORK STATE DEPARTMENT OF ENVIRONMENTAL CONSERVATION
NASSAU COUNTY FUMEX SANITATION SITE NEW YORK
SOIL EXCAVATION AND ASPHALT COVER INSTALLATION
CONTRACT NO. D007692

PROJECT NO. **2002**
DATE: **OCTOBER 2009**
SCALE: **AS NOTED**

DETAILS II

DRAWING NO. **6**

COMMONLY USED REGULATORY SIGNS

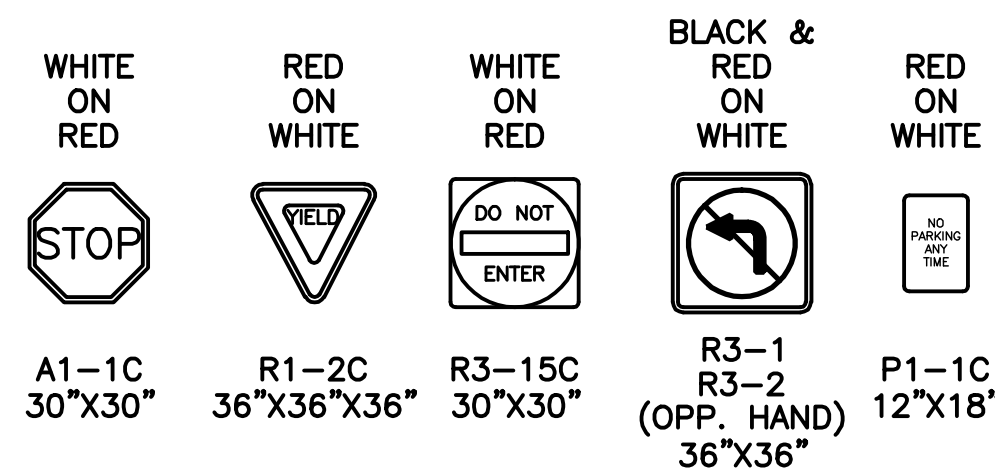

BARRICADE AND BARRICADE DEVICES

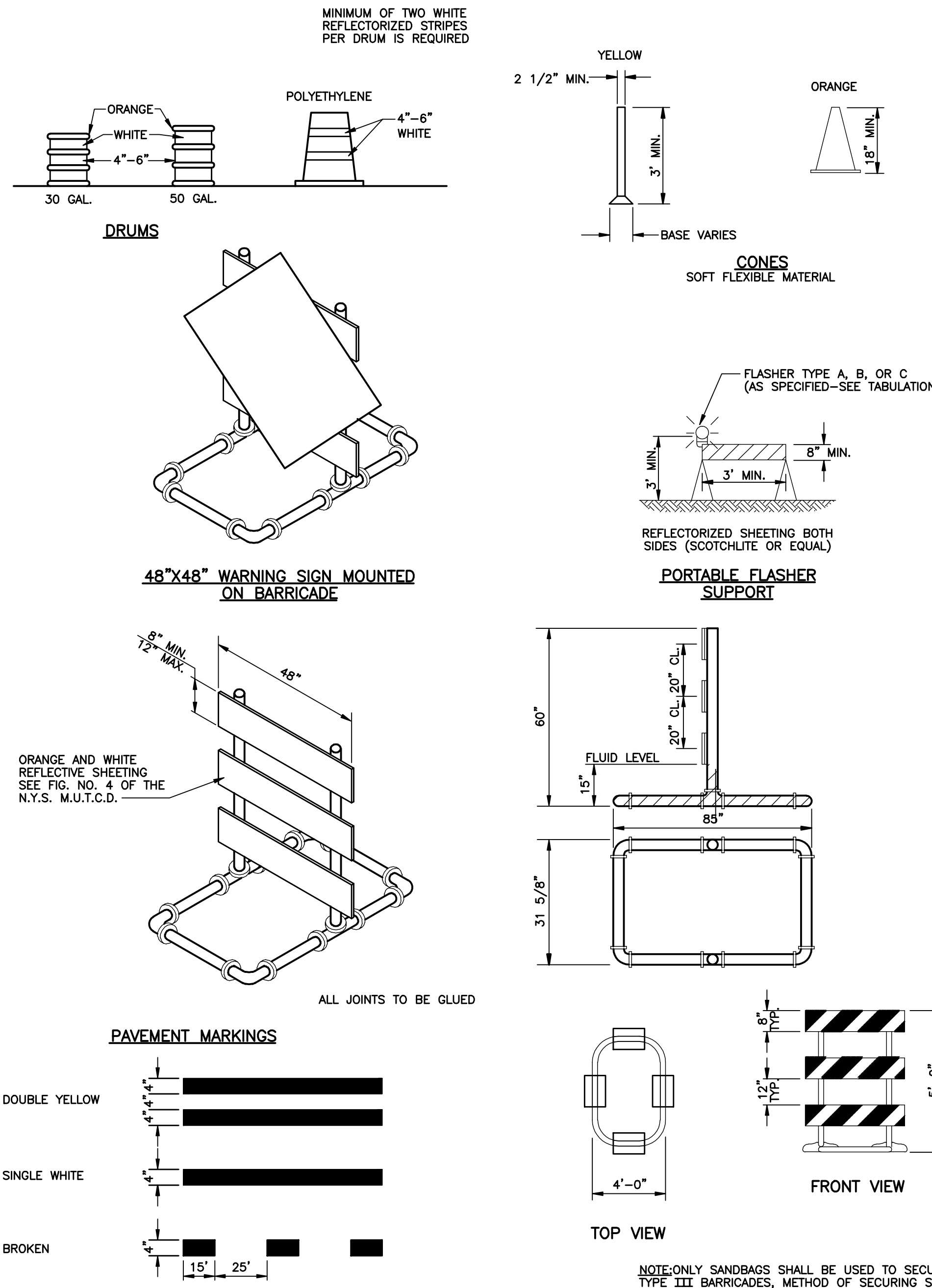

GENERAL NOTES

ALL SIGNS SHALL BE FABRICATED AND ERECTED IN ACCORDANCE WITH THE NEW YORK STATE MANUAL OF UNIFORM TRAFFIC CONTROL DEVICES (LATEST EDITION) OR AS SHOWN IN THE CONTRACT PLANS.

SIGN PANELS—SIGN PANELS MAY BE MADE OF STEEL, ALUMINUM, OR PLYWOOD.

SIGN PANEL SUPPORTS—THE CONTRACTOR SHALL SUPPLY ADEQUATE SUPPORTS SO THAT THE SIGNS ARE IN PROPER POSITION AND ALIGNMENT AS SHOWN ON THE CONTRACT PLANS. TYPE III BREAKAWAY BARRICADES ARE ADEQUATE AS SIGN SUPPORTS.

SIGN FACE—BACKGROUND THE SIGN FACE BACKGROUND SHALL BE MADE OF FLATTOP HIGH INTENSITY REFLECTORIZED SHEETING MATERIAL, N.Y.S. SPECIFICATION No. 730-0502 (CLASS B).

COLOR—COLORS SHALL CONFORM TO THE MANUAL.

UNAUTHORIZED SIGNS—NO SIGNS SHALL BE ERECTED UNLESS AUTHORIZED BY THE ENGINEER OR SHOWN IN THE CONTRACT PLANS.

LOCATION—ALL SIGNS SHALL BE LOCATED SO AS TO GIVE MAXIMUM VISIBILITY FOR THE APPROACHING MOTORIST, BOTH DAY AND NIGHT.

MAINTENANCE—THE CONTRACTOR SHALL KEEP THE SIGNS CLEANED AT ALL TIMES. ALL SIGNS SHALL BE THE PROPERTY OF THE CONTRACTOR AND SHALL BE MAINTAINED IN GOOD CONDITION FOR THE DURATION OF THE CONTRACT AND REMOVED FROM THE WORKSITE WHEN THE CONTRACT IS ACCEPTED.

BARRICADES—ALL TYPE III BARRICADE UNITS SHALL BE MADE OF ONE OF THE FOLLOWING: EITHER POLYVINYL CHLORIDE (P.V.C.) PRESSURE TREATED PIPE SDR 21 OR 28 ASTM# D2241. JOINT FITTINGS SHALL BE P.V.C. ASTM# D2855. ALL PIPE SHALL BE WHITE. WHITE FITTINGS ARE PREFERRED, BLACK MAY BE USED. THE SOLVANT CEMENT SHALL BE ASTM# D2564 TYPE I ALUMINUM FACE PANELS N.Y.S. D.O.T. 730-01. THE SCREWS SHALL BE PAN HEAD METAL N.Y.S. D.O.T. 715.04. REFLECTIVE SHEETING METAL SHALL BE N.Y.S. D.O.T. 730-05-01 OR 730-05-02. TYPE III BARRICADES MAY ALSO BE ROTATIONALLY MOLDED, MEDIUM DENSITY POLYETHYLENE 3 1/2" TUBING, ASTM# D746. THIS TYPE IS SHATTERPROOF. TYPE III BARRICADES USED AT NIGHT SHALL BE LIGHTED, AOB (SEE WARNING LIGHT TABULATION AND NOTES CONCERNING STEADY BURN LIGHTS)

COMMONLY USED CONSTRUCTION WARNING SIGNS

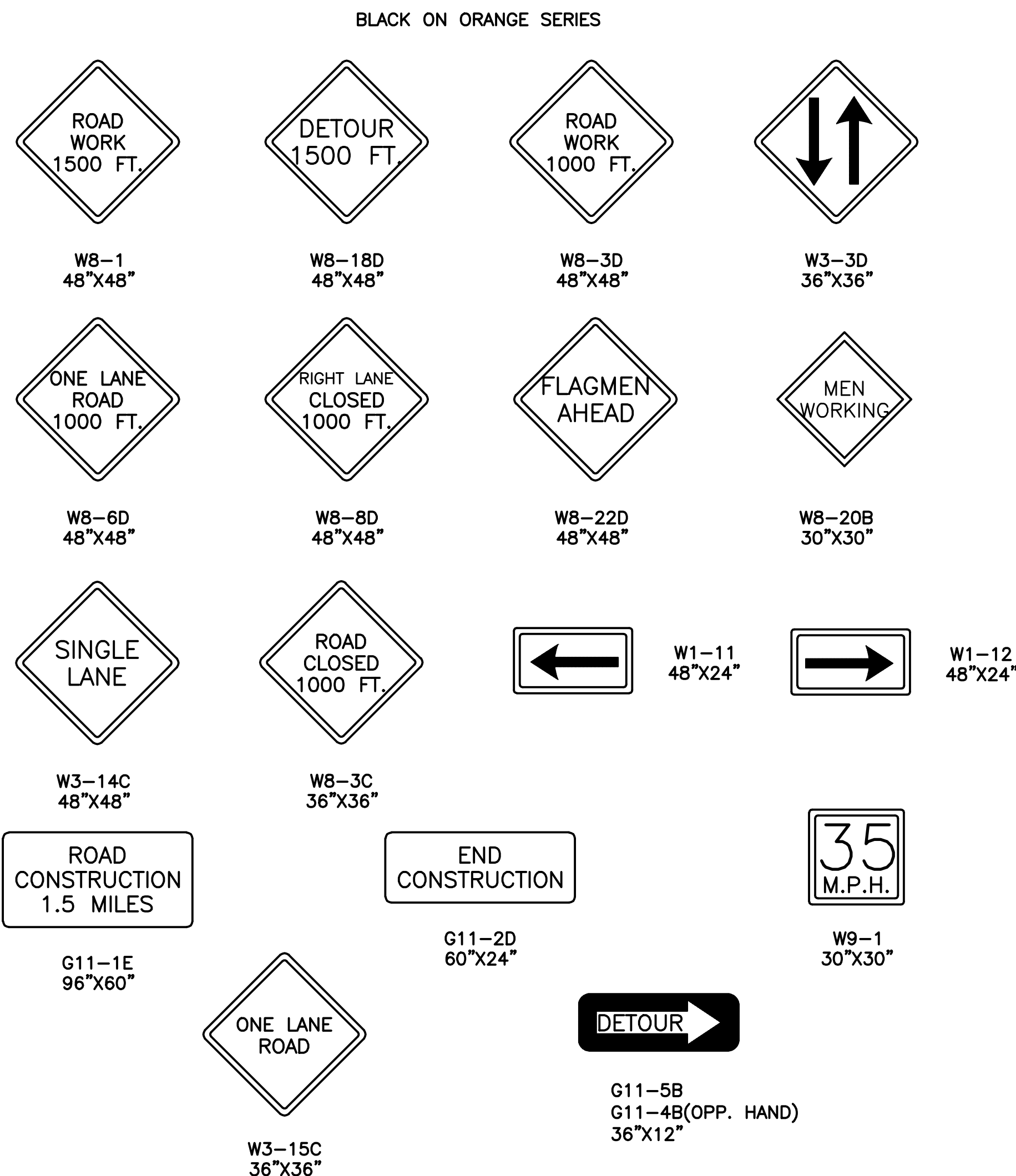

WARNING LIGHTS DETAILS

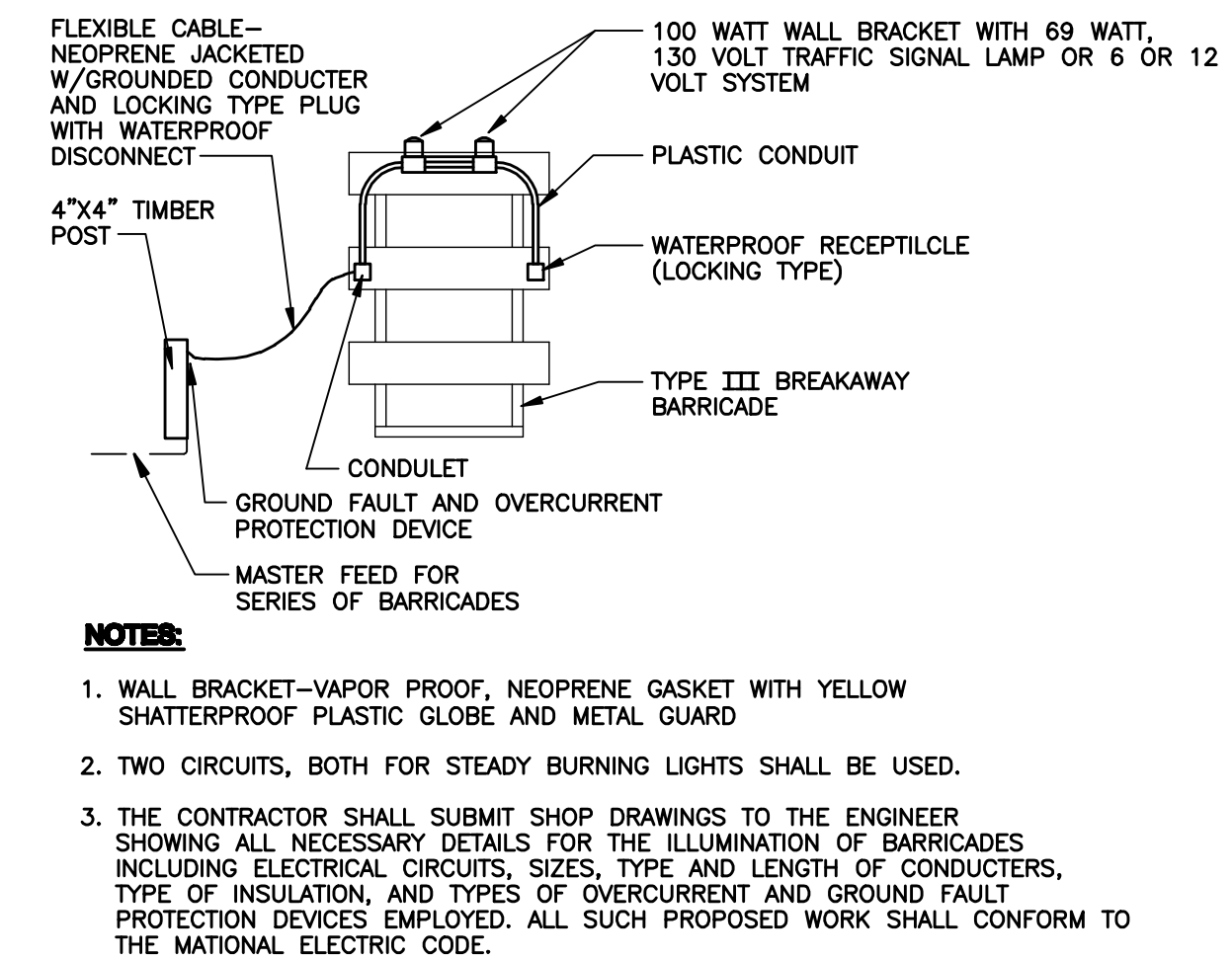

NO.	DATE	REVISION	INT.

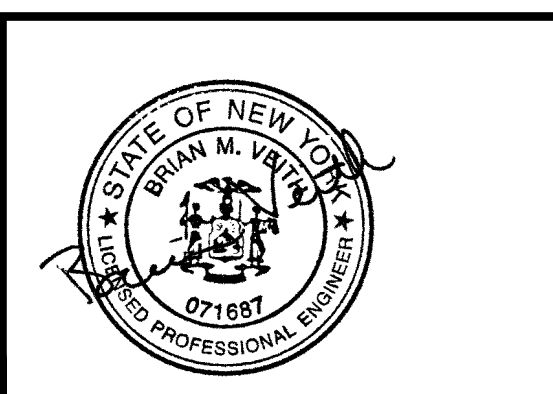

UNAUTHORIZED ALTERATION OR ADDITION TO THIS DOCUMENT IS A VIOLATION OF SECTION 7209 OF THE NEW YORK STATE EDUCATION LAW.

PROJECT ENGINEER: FD
DRAWN BY: LVG
DESIGNED BY: MRF/PD
CHECKED BY: BMV

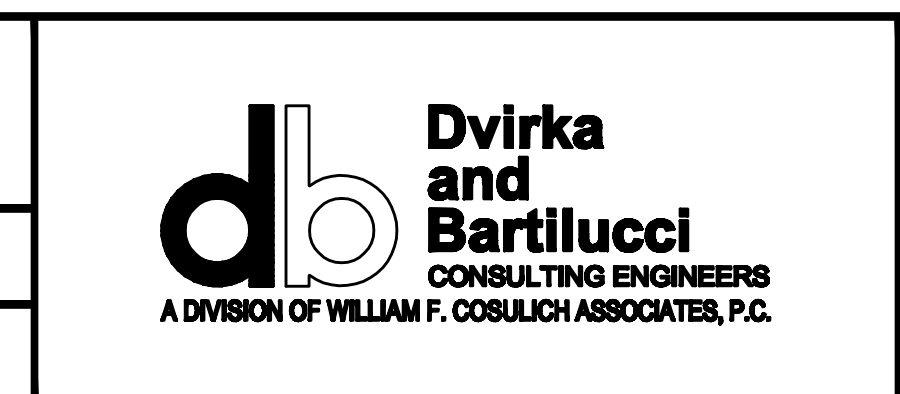

NEW YORK STATE DEPARTMENT OF ENVIRONMENTAL CONSERVATION
NASSAU COUNTY FUMEX SANITATION SITE NEW YORK
SOIL EXCAVATION AND ASPHALT COVER INSTALLATION
CONTRACT NO. D007692

PROJECT NO. 2002
DATE: OCTOBER 2009
SCALE: NONE

DRAWING NO. 7

P:\2009\2009-2010\Drawings\2009-2010\09_DTT_1000000000_01\1708_PMA_10.dwg