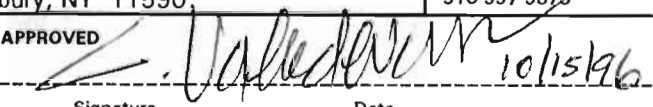

SITE INVESTIGATION INFORMATION

130043F

1. SITE NAME Former Tishcon Site		2. SITE NUMBER 1-30-043F	3. TOWN/CITY/VILLAGE Westbury, New Cassel	4. COUNTY Nassau
5. REGION 1	6. CLASSIFICATION CURRENT 2 PROPOSED D1 MODIFY			
7. LOCATION OF SITE (Attach U.S.G.S. Topographic Map showing site location) a. Quadrangle Hicksville b. Site Latitude <u>40° 45' 23.2"</u> Site Longitude <u>73° 33' 48.6"</u> c. Tax Map Numbers 11, 76, 9-12 (Lot, Block, Parcel) d. Site Street Address 68 Kinkel Street, Westbury, NY 11590				
8. BRIEFLY DESCRIBE THE SITE (Attach site plan showing disposal/sampling locations) The site is in the New Cassel Industrial Area (NCIA). The current occupant uses the site to sort C&D debris. The site is almost entirely covered with a 2 bay garage and concrete pad. The site was listed due to groundwater contamination and past activities at the site. a. Area <u>0.25</u> acres b. EPA ID Number <u>NYP003602109</u> c. Completed ()Phase I ()Phase II ()PSA (x)RI/FS ()PA/SI ()Other				
9. Hazardous Waste Disposed (Include EPA Hazardous Waste Numbers) No documented disposal				
10. ANALYTICAL DATA AVAILABLE a. ()Air (x)Groundwater (x)Surface Water (x)Sediment (x)Soil ()Waste ()Leachate ()EPTox (x)ITCLP b. Contravention of Standards or Guidance Values Only groundwater, see attached table				
11. CONCLUSION This site should be delisted because there are no soils with contaminants over the New York State Standards, Criteria or Guidelines. The sediment with petroleum contamination is scheduled to be removed from the site by the owner, Mr. Garguilo. The groundwater is contaminated, but there are no current sources at the site and this groundwater contamination is similar to that throughout the NCIA. Based on the site conditions, the levels and specific volatile organic compounds found at each sampling point, and other information collected during the investigation, it appears that there are no current sources of groundwater contamination at the site and the groundwater contamination beneath the site appears to be from sources on adjoining and/or upgradient properties.				
12. SITE IMPACT DATA a. Nearest Surface Water: Distance <u>> 4000</u> ft. Direction <u>SSW</u> Classification <u>C East Meadow Brook</u> b. Nearest Groundwater: Depth <u>52</u> ft. Flow Direction <u>SSW</u> (x)Sole Source ()Primary ()Principal c. Nearest Water Supply: Distance <u>1550</u> ft. Direction <u>south</u> Active ()Yes ()No d. Nearest Building: Distance <u>0</u> ft. Direction <u>on top of</u> Use <u>sorting C&D debris</u> e. In State Economic Development Zone? ()Y (x)N i. Controlled Site Access? (x)Y ()N f. Crops or livestock on site? ()Y (x)N j. Exposed hazardous waste? ()Y (x)N g. Documented fish or wildlife mortality? ()Y (x)N k. HRS Score -- h. Impact on special status fish or wildlife resource? ()Y (x)N l. For Class 2: Priority Category 1				
13. SITE OWNER'S NAME Thomas Garguilo		14. ADDRESS 68 Kinkel Street, Westbury, NY 11590		15. TELEPHONE NUMBER 516-997-9373
16. PREPARER  _____ Signature Date John Helmeset, EEL NYSDEC _____ Name, Title, Organization		17. APPROVED  _____ Signature Date 10/15/96 _____ Name, Title, Organization		

NEW YORK STATE DEPARTMENT OF ENVIRONMENTAL CONSERVATION
DIVISION OF ENVIRONMENTAL REMEDIATION
INACTIVE HAZARDOUS WASTE DISPOSAL REPORT

12/16/96

CLASSIFICATION CODE: D1 REGION: 1 SITE CODE: 130043F
EPA ID:

NAME OF SITE : Former Tishcon Corporation
STREET ADDRESS: 68 Kinkel Street
TOWN/CITY: COUNTY: ZIP:
Westbury Nassau 11590

SITE TYPE: Open Dump- Structure-X Lagoon- Landfill- Treatment Pond-
ESTIMATED SIZE: .23 Acres

SITE OWNER/OPERATOR INFORMATION:

CURRENT OWNER NAME....: Mr. Thomas Garguilo, Jr.
CURRENT OWNER ADDRESS.: 68 Kinkel Street, Westbury, NY
OWNER(S) DURING USE...:
OPERATOR DURING USE....: Tishcon Corporation
OPERATOR ADDRESS.....: 29 New York Avenue, Westbury, NY
PERIOD ASSOCIATED WITH HAZARDOUS WASTE: From 1982 To 1983

SITE DESCRIPTION:

Latitude: 40 45'23.2"N Longitude: 73 33'48.6"W
Flat topography: Industrial area
Nearest Surface Water Body: Hempstead Bay, approximately 6 miles northwest
Nearest Water Supply Well: Approximately 1,550 feet south

This property is located on Kinkel Street just south of Main Street in the New Cassel Industrial Area. The former occupant of this site used to manufacture dietary supplements at this location, as well as several other locations in the industrial park. Chemicals such as 1,1,1-trichloroethane (TCA) were used as part of this process. According to Nassau County Department of Health records, Tishcon used 1,650 gallons of TCA per year at this location. A 1994 site inspection conducted by NYSDEC revealed a likely abandoned leachpool location in the alley behind the building. Subsequent downgradient groundwater sampling found TCA and 1,2-dichloroethylene well above standards.

This site has received a State Superfund referral. A standby consultant was authorized to implement a Focused Remedial Investigation and Feasibility Study for the site.

Fieldwork was completed in April 1996 and found no hazardous waste contamination above State Guidance Values at the site. A "No Action PRAP" (proposed remedial action plan) was issued for public review. A Record of Decision (ROD) was signed in December 1996.

HAZARDOUS WASTE DISPOSED:

TYPE

QUANTITY (units)

SITE CODE: 130043F

ANALYTICAL DATA AVAILABLE:

Air- Surface Water-X Groundwater-X Soil-X Sediment-X

CONTRAVENTION OF STANDARDS:

Groundwater-X Drinking Water- Surface Water- Air-

LEGAL ACTION:

TYPE...: State- X Federal-
STATUS: Negotiation in Progress- X Order Signed-

REMEDIAL ACTION:

Proposed- Under design- In Progress-X Completed-
NATURE OF ACTION: cleanup of petroleum spill

GEOTECHNICAL INFORMATION:

SOIL TYPE: medium to fine grained sand and gravel
GROUNDWATER DEPTH: Varies from 50-52 feet

ASSESSMENT OF ENVIRONMENTAL PROBLEMS:

Investigations could find no sources of groundwater contamination at this site. However, there is a storm drain on site that will be cleaned out due to petroleum contamination.

ASSESSMENT OF HEALTH PROBLEMS:

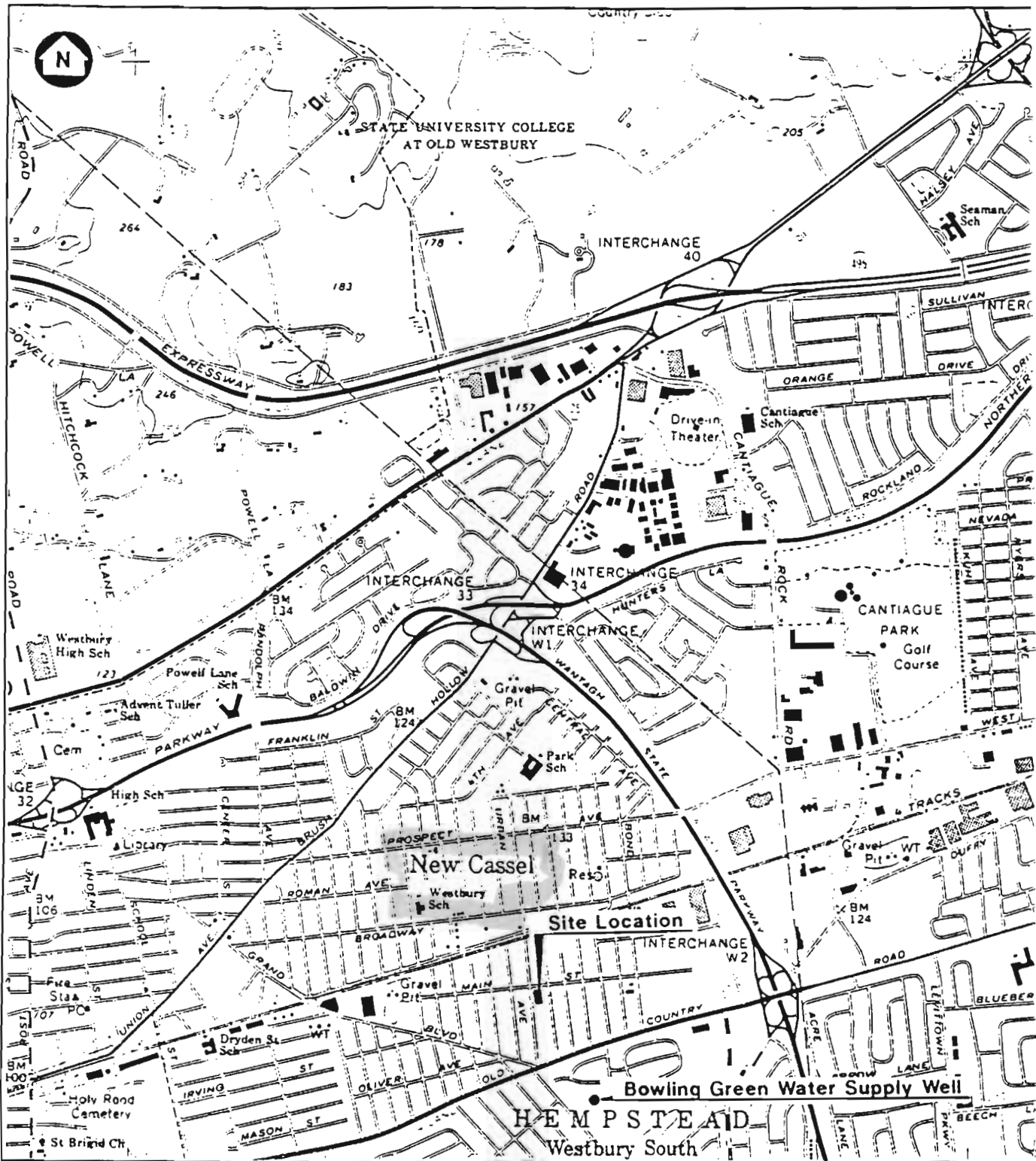

SOURCE: USGS 7.5 MINUTE SERIES QUADRANGLE;
HICKSVILLE, NEW YORK, DATED 1967.

SITE NO.: 1-30-043F
LOCATION: TOWN OF NORTH HEMPSTEAD

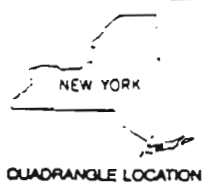
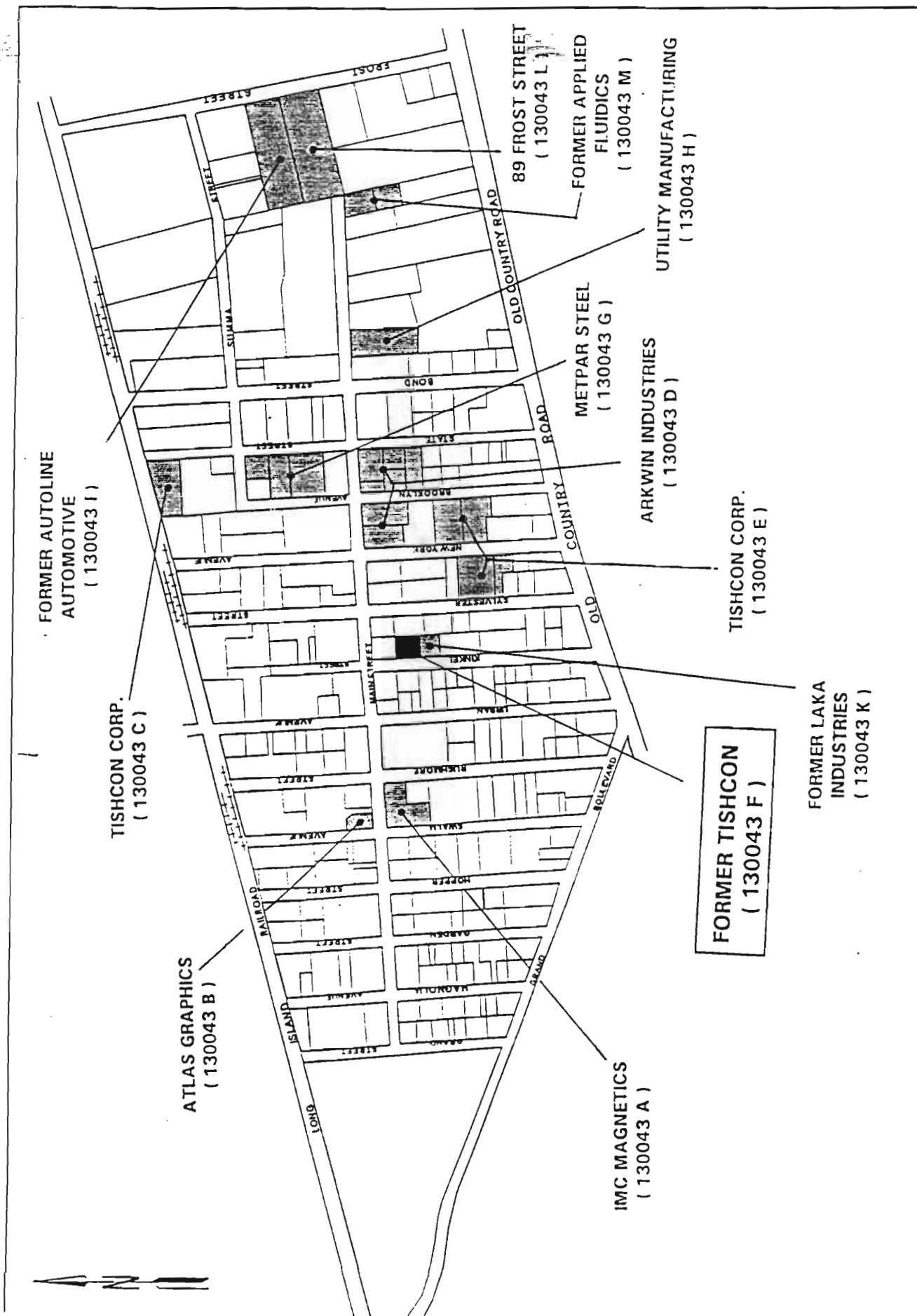

FIGURE 1
SITE LOCATION MAP
68 KINKEL STREET - FORMER TISHCON SITE
FOCUSED REMEDIAL INVESTIGATION
NYSDEC



NEW CASSEL INDUSTRIAL AREA

Figure 2

Class 2 Registry Sites



MA114

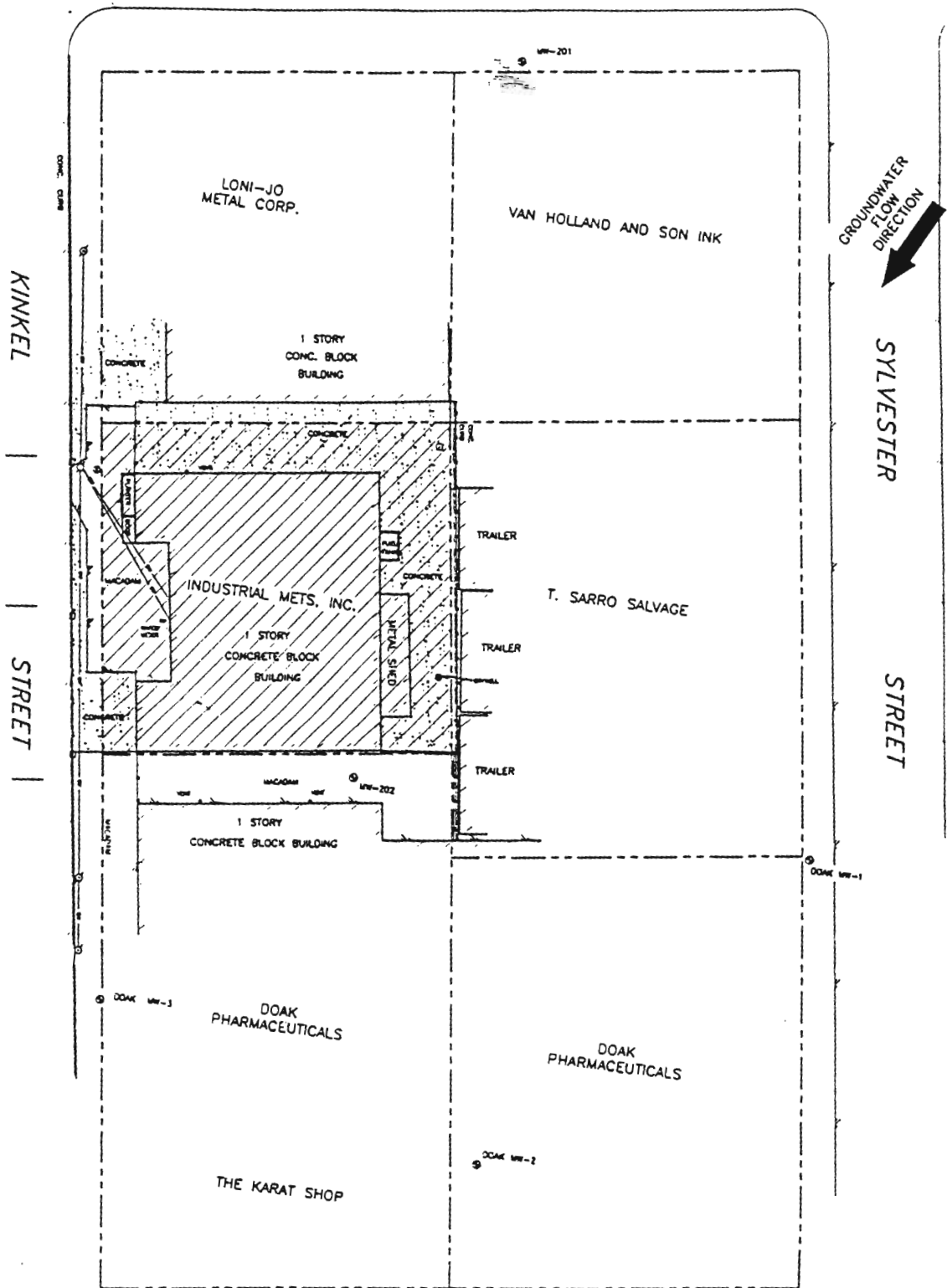

LEGEND



MONITORING WELL

FORMER TISHCON SITE

CHAIN LINK FENCE

PROPERTY LINE

SOURCE:

1. HORIZONTAL DATUM: NEW YORK STATE PLANE COORDINATE SYSTEM, NAD83 1927 FROM MASSAU COUNTY DEPARTMENT OF PUBLIC WORKS MONUMENTS 12E14N AND 12E14NAZ.
2. VERTICAL DATUM: NGVD 1929 FROM MONUMENTS 12E14N AND 12E14NAZ.
3. FIELD SURVEY COMPLETED APRIL 11, 1996.
4. BOUNDARY INFORMATION SHOWN AS SCALED FROM FROM TAX MAPS. LOCATIONS ARE APPROXIMATE ONLY AND NOT CERTIFIED TO.
5. EXPLORATION LOCATIONS BASED ON MAP BY PEC, INC. TITLED "68 KINKEL STREET SURVEY" DATED MAY, 1996.

0 15 30 60 FEET

SCALE: 1"=30'

Figure 3

SITE PLAN
68 KINKEL STREET - FORMER TISHCON SITE
FOCUSED REMEDIAL INVESTIGATION
NYSDEC

FORMER TISHCON SITE 1-30-043F
PROPOSED REMEDIAL ACTION PLAN

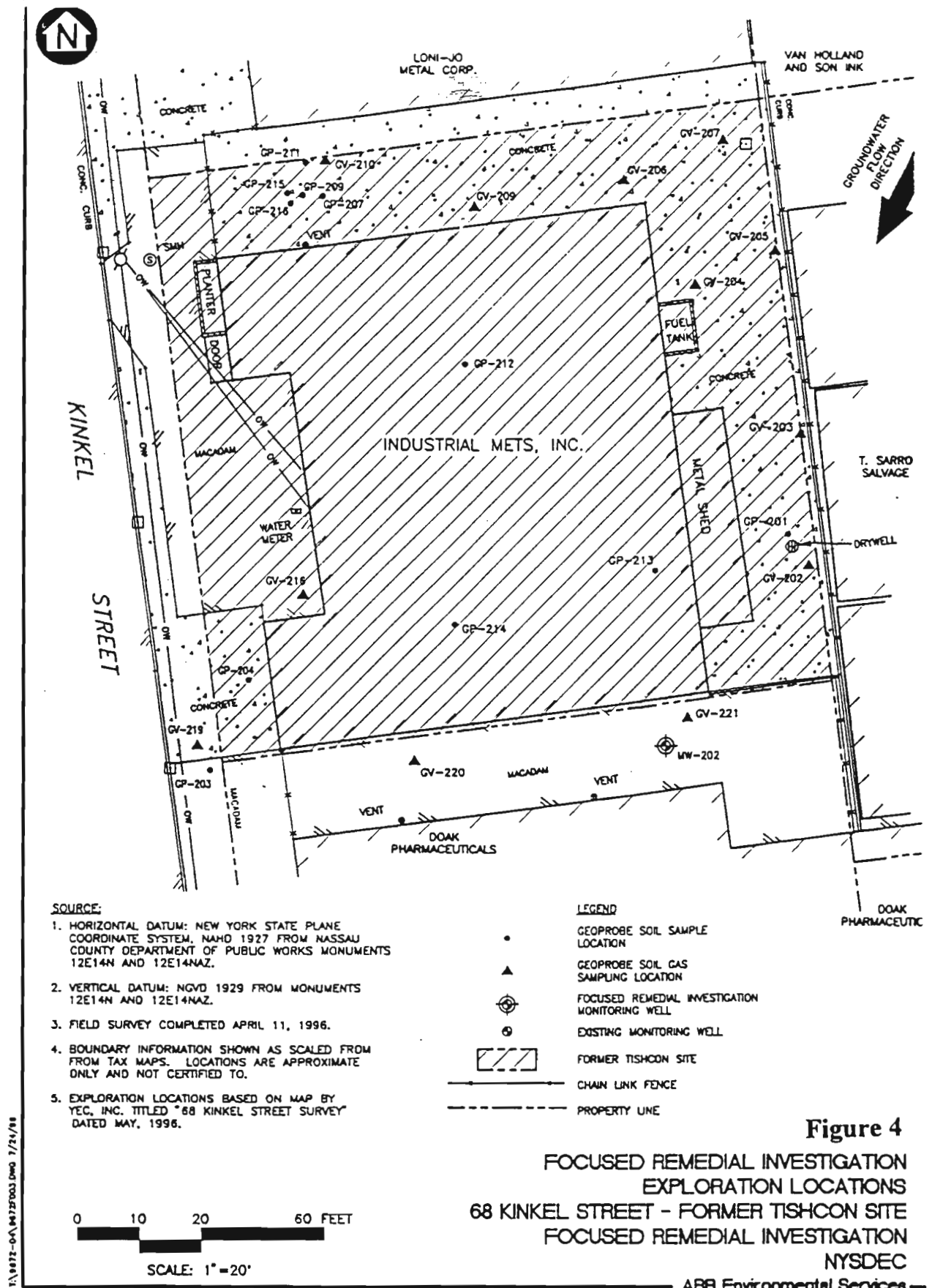

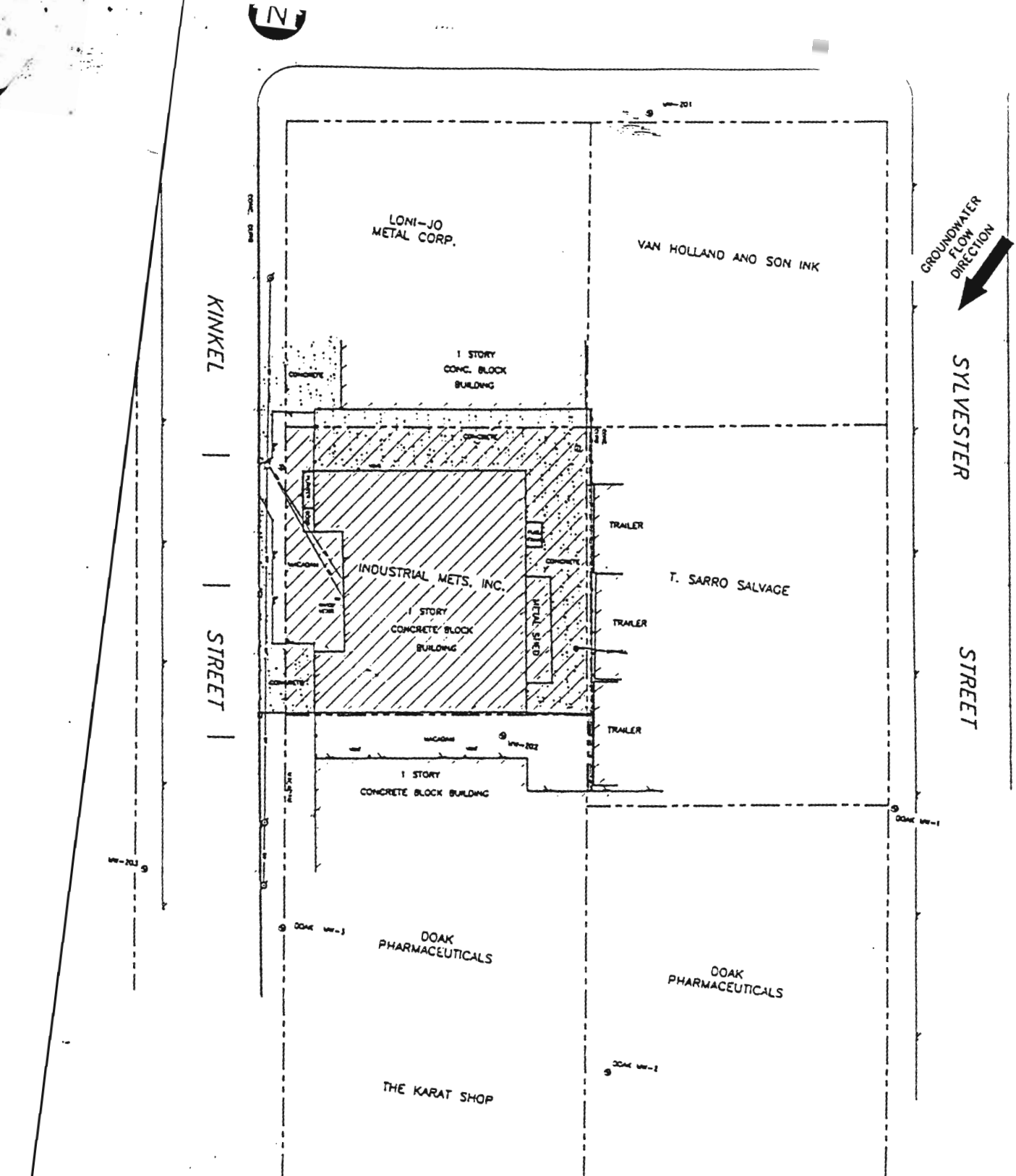

LEGEND

- MONITORING WELL
- FORMER TISHCON SITE
- CHAIN LINK FENCE
- PROPERTY LINE

SOURCE:

1. HORIZONTAL DATUM: NEW YORK STATE PLANE COORDINATE SYSTEM, NAD 1927 FROM NASSAU COUNTY DEPARTMENT OF PUBLIC WORKS MONUMENTS 12E14N AND 12E14NAZ.
2. VERTICAL DATUM: NGVD 1929 FROM MONUMENTS 12E14N AND 12E14NAZ.
3. FIELD SURVEY COMPLETED APRIL 11, 1996.
4. BOUNDARY INFORMATION SHOWN AS SCALED FROM FROM TAX MAPS. LOCATIONS ARE APPROXIMATE ONLY AND NOT CERTIFIED TO.
5. EXPLORATION LOCATIONS BASED ON MAP BY TEG. INC. TITLED "68 KINKEL STREET SURVEY" DATED MAY, 1996.

0 15 30 60 FEET
SCALE: 1"=30'

Figure 3

SITE PLAN
68 KINKEL STREET - FORMER TISHCON SITE
FOCUSED REMEDIAL INVESTIGATION
NYSDEC

FORMER TISHCON SITE 1-30-043F
PROPOSED REMEDIAL ACTION PLAN

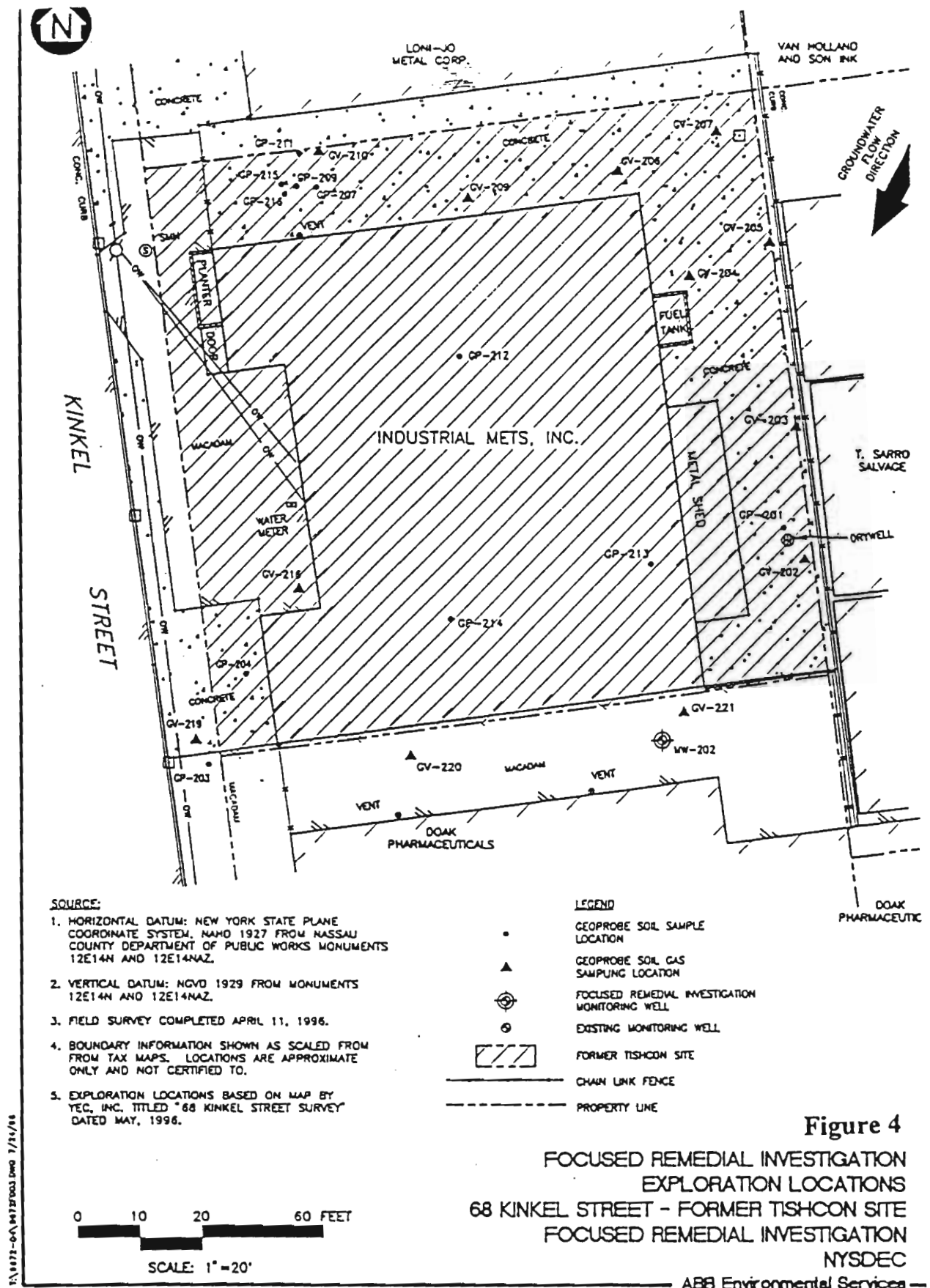

130043F

SITE INVESTIGATION INFORMATION

1. SITE NAME Former Tishcon Corp. (68 Kinkel St.)		2. SITE NUMBER 130043F	3. TOWN/CITY/VILLAGE New Cassel	4. COUNTY Nassau
5. REGION 1 (Long Island)	6. CLASSIFICATION CURRENT PROPOSED: 2 MODIFY			
7. LOCATION OF SITE (Attach U.S.G.S. Topographic Map showing site location) a. Quadrangle: Hicksville b. Site Latitude: 40° 45' 23.2" N Site Longitude: 73° 33' 48.6" W c. Tax Map Numbers: Section 11, Block 76, Lots 9-12. d. Site Street Address: 68 Kinkel Street, Westbury, NY 11590				
8. BRIEFLY DESCRIBE THE SITE (Attach site plan showing disposal/sampling locations) This property is located on Kinkel Street just below Main Street in the New Cassel Industrial Area. The former occupant of this site used to manufacture dietary supplements at this location, as well as several other locations in the industrial park. Chemicals such as 1,1,1 trichloroethane were used as part of this process. According to Nassau County Dept. of Health records, Tishcon used 1,650 gallons of 1,1,1 trichloroethane per year at this location. A 1994 site inspection by NYSDEC revealed a likely abandoned leachpool location in the alley behind the building. Subsequent downgradient groundwater sampling found 1,1,1 trichloroethane and 1,2 dichloroethylene well above standards. a. Area : 0.25 acres b. EPA ID Number _____ c. Completed: () Phase I () Phase II (X) PSA () RI/FS () PA/SI () Other				
9. HAZARDOUS WASTE DISPOSED (Include EPA Hazardous Waste Numbers) - 1,1,1 trichloroethane (EPA ID# F002)				
10. ANALYTICAL DATA AVAILABLE a. () Air (X) Groundwater () Surface Water () Sediment () Soil () Waste () Leachate () EPTox () TCLP b. Contravention of Standards or Guidance Values - 1,1,1 trichloroethane: 450 ppb in groundwater; 5 ppb standard (TOGS 1.1.1) - 1,2 dichloroethylene: 340 ppb in groundwater; 5 ppb standard (TOGS 1.1.1) - 1,1 dichloroethane: 150 ppb in groundwater; 5 ppb standard (TOGS 1.1.1)				
11. CONCLUSION <i>Past site operations have contaminated groundwater beneath the site with 1,1,1 trichloroethane. The contaminated groundwater is located within an EPA-designated sole-source aquifer. The contaminant plume that is partially emanating from the site has migrated approximately 700 feet downgradient. Two public water supply wells are located approximately 1,550 feet downgradient of the site. Thus, this site poses a significant threat to the public health and the environment. Therefore, the site should be listed as a Class 2 in the NYS Registry of Inactive Hazardous Waste Disposal Sites.</i>				
12. SITE DATA a. Nearest Surface Water: Distance: 6 mi. Direction: NW Classification: SB (Hempstead Bay) b. Nearest Groundwater: Depth: 50 ft. Flow Direction: SW (X) Sole Source () Primary () Principal c. Nearest Water Supply: Distance: 1,550 ft. Direction: South Active: (X) Yes () No d. Nearest Building: Distance: --- Direction: Onsite Use: Industrial e. In State Economic Development Zone? () Y (X) N i. Controlled Site Access? () Y (X) N f. Crops or livestock on site? () Y (X) N j. Exposed hazardous waste? () Y (X) N g. Documented fish or wildlife mortality? () Y (X) N k. HRS Score: N/A h. Impact on special status fish or wildlife resource? () Y (X) N l. For Class 2: Priority Category: 2				
13. SITE OWNER'S NAME Mr. Thomas Garguilo, Jr.		14. ADDRESS 65 Kinkel Street, Westbury, NY 11590		15. TELEPHONE NUMBER
16. PREPARER David K. Harrington 3/8/95 Signature Date David K. Harrington, Environmental Engineer 1, EIS, BHSC, DHWR, NYSDEC Name, Title, Organization		17. APPROVED [Signature] 3/8/95 Signature Date [Signature] + Dir Name, Title, Organization		