



Additional Post-Remediation Boring Report

**Citizen Development Company / Flower Fashion Site
47 Northern Boulevard
Great Neck, New York**

NYSDEC Site # 1-30-070

April 2010

Prepared for:

**Citizen Development Company
111-15 Queens Boulevard
P.O. Box 10
Forest Hills, New York 11375**

Prepared by:

**CA Rich Consultants, Inc.
17 Dupont Street
Plainview, New York 11803**



April 2, 2010

NEW YORK STATE DEPARTMENT OF ENVIRONMENTAL CONSERVATION
50 Circle Road
Stony Brook, New York 11794

Attention: Mr. Jamie Ascher

**Re: Additional Post-Remediation Borings Report
The Citizens Development Company / Flower Fashion Site
47 Northern Boulevard, Great Neck, New York**

Dear Mr. Ascher:

In accordance with our Site Management Plan (SMP), attached is a copy of our Additional Post Remediation Boring Report regarding the operation of the on-site Soil Vapor Extraction (SVE) system. The findings presented in this report indicate that the operation of the SVE system has effectively reduced the PCE in the subsurface soils at northeastern portion of the rear yard. We suggest that the NYSDEC Part 375 Commercial soil standard be applied as the cleanup criteria and that the current blower be replaced with a more energy efficient sub-slab depressurization fan.

If there are any questions regarding this report, please do not hesitate to call our office.

Sincerely,

CA RICH CONSULTANTS, INC.

A handwritten signature in black ink that reads "Eric Weinstock".

Eric A. Weinstock
Vice President

cc: Rosalie K. Rusinko, Esq., NYSDEC-Tarrytown
Charlotte Biblow, Esq., Farrell Fritz
Sal Panico, Cord Meyer Development, LLC
Steve Karpinski, NYSDOH

Table of Content

	<u>Page</u>
1.0 Introduction	2
2.0 Description of Boring Installation Sampling Procedures	2
3.0 Summary of Analytical Results	3
4.0 Recommendations	3
5.0 References	3

Figures

- 1. Property Location Map**
- 2. Location of Soil Borings**

Tables

- 1. Summary of March 4, 2010 Soil Results**
- 2. Comparison of June 9, 2009 and March 4, 2010 Soil Results**

Appendices

- A. Soil Laboratory Data**
- B. Boring Log**

**Additional Post-Remediation Boring Report
Citizen Development Company /Flower Fashion Site
47 Northern Boulevard
Great Neck, New York
NYSDEC Site # 1-30-070**

1.0 Introduction

The Citizen Development Corp./Fashion Flower (CDC/FF) Site, located at 47 Northern Boulevard in Great Neck, New York (Figure 1), is currently occupied by an AT&T cellular telephone store. Previous tenants of this property were: a Cingular cellular telephone store; a florist; and a dry cleaner. For the purposes of this document, the contaminant of concern is tetrachloroethene (a.k.a perchloroethene or "PCE") which is a remnant of the operation of the former dry cleaner. The media that were impacted included soil, soil vapor, groundwater and indoor air.

During August of 2004, approximately 77 tons of PCE contaminated soil was excavated from the rear of the building to a depth of approximately three to four feet below grade. End-point samples collected at that time ranged from 53 to 27,000 ug/kg of PCE. The soil was loaded into trucks and transported to a permitted hazardous waste disposal facility (Ref. 2). Clean fill was placed into the excavation followed by concrete pavement. A Soil Vapor Extraction (SVE) system was then installed in the rear of the property as part of a site-wide remediation effort to remove the remaining PCE vapors in the underlying soil. Details of the system are summarized in Reference 3. The system was installed in January 2005 and is currently in operation. A Site Management Plan (SMP) was developed for this property in 2006 (Ref. 4). The SMP included procedures for termination of the SVE system.

During June, 2009 three post-remediation borings were install in accordance with the SMP. The result of the soil samples from two of those borings achieved the termination criteria for the SVE system (Ref. 6) exhibiting PCE concentrations of 61 and 110 ug/kg, which are both below the NYSDEC TAGM (Ref. 1) guidelines. The result of the sample from the third boring was 1,500,000 ug/kg and exceeded the TAGM. Two new SVE wells were added to the system in the area of the third boring during August 2009 (Ref. 7) and operated from that time to the present. On March 4, 2010 an additional post-remediation boring was installed and soil samples were collected.

With respect to termination of the SVE system, the SMP stated that once the levels of total VOCs in the SVE wells decreased to a near constant or asymptotic concentration, operation of the system will be suspended. In addition, it stated that three soil borings will be placed in the rear yard. Soil samples will be collected at a level of three to four feet below grade in the native soil below the imported fill and analyzed for halogenated volatile organics. If the concentration of PCE and its degradation products in these samples do not exceed the TAGM Cleanup Objectives, the SVE blower will be replaced with a smaller Sub-Slab Depressurization (SSD) fan. The redrilling of the third boring and the analysis of the associated soil samples are the subject of this report.

2.0 Description of Boring Installation and Sampling Procedures

On March 4, 2010, one new soil boring, identified as PRB-1A, was installed adjacent to boring PRB-03 (the initial boring from which the exceedance of the TAGM standard was measured). The new boring, located in the rear of the property, was installed using a Geoprobe direct-push sampling device. A map illustrating the location of the borings is included as Figure 2. The new boring was performed by continuously advancing a core sampler into the ground for a total depth

of 16 feet per boring. The cores were retrieved; examined to determine the contact between the clean fill and native soil; and screened for volatile organic compounds (VOCs) using a field photo-ionization detector (PID). Three soil samples were then placed into laboratory-issued bottles and analyzed for VOCs using EPA method 8260. A log for the boring is included in this report as Appendix C.

3.0 Summary of Analytical Results

3.1 Soil Results

The results of the VOC analysis of the soil samples from the new boring indicate that the new SVE wells have been very effective in removing the remaining PCE from the underlying soil. The concentration of PCE in the sample from boring PRB-1A, at four to six feet below grade, was 8,700 ug/kg, [the concentration at this depth in the initial boring (PRB-03) was 1,500,000 ug/kg]. All of the results below the four to six foot interval were below the TAGM. The results of the laboratory analysis are summarized on Table 1, and the boring log with PID readings is included in Appendix C of this report.

4.0 Recommendations

The 8,700 ug/kg result of the soil sample collected from four to six feet in boring PRB-1A indicates that PCE remains in the subsurface soil at a level above the TAGM standard 1,400 ug/kg, but significantly below the NYSDEC Part 375 Commercial standard (Ref. 5) of 150,000 ug/kg. Since the property is zoned commercial and is expected to remain as such in the future, we recommend that the NYSDEC Part 375 Commercial standard be applied as the termination criteria for this project. In accordance with the SMP we suggest that the SVE blower be replaced with a smaller Sub-Slab Depressurization (SSD) fan. Annual inspections and monitoring should then proceed in accordance with the SMP.

5.0 References

1. NYSDEC, (January 24, 1994), Technical and Administrative Guidance Memorandum: Determination of Soil Cleanup Objectives and Cleanup Levels.
2. CA RICH, (January 2005), Interim Remedial Measures Report – Part A, The Citizens Development Company / Flower Fashion Site, 47 Northern Blvd., Great Neck, New York.
3. CA RICH, (April 2005), Interim Remedial Measures Report – Part B, Final Engineering Report and Operations, Maintenance & Monitoring Plan, The Citizens Development Company / Flower Fashion Site, 47 Northern Blvd., Great Neck, New York.
4. CA RICH, (June 2006), Site Management Plan, The Citizens Development Company/ Flower Fashion Site, 47 Northern Blvd., Great Neck, New York.
5. NYSDEC, (December 14, 2006), 6NYCRR Part 375, Environmental Remediation Programs
6. CA RICH, (July, 2009), Post-Remediation Borings Report, The Citizens Development Company / Flower Fashion Site, 47 Northern Blvd., Great Neck, New York.
7. CA RICH, (August, 2009), Additional SVE Well Installation Report, The Citizens Development Company / Flower Fashion Site, 47 Northern Blvd., Great Neck, New York.

Figures

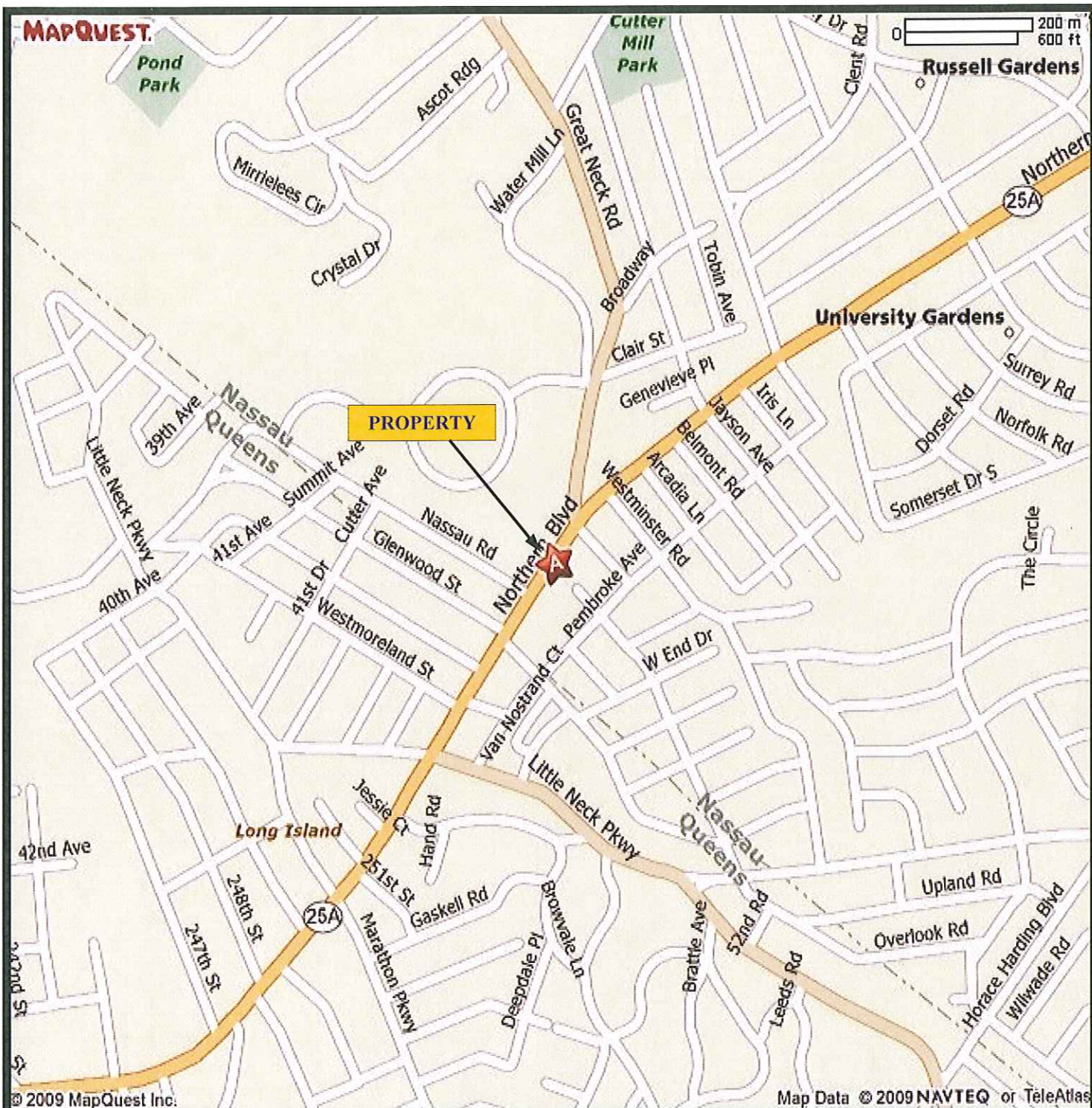

Map Adapted from Mapquest



CA RICH CONSULTANTS, INC.
17 Dupont Street,
Plainview, NY 11803

TITLE:

PROPERTY LOCATION MAP

DATE:

3/19/09

SCALE:

AS SHOWN

FIGURE:

1

**47 Northern Boulevard
Great Neck, New York**

DRAWING:

DRAWN BY:

JTC

APPR. BY:

EAW

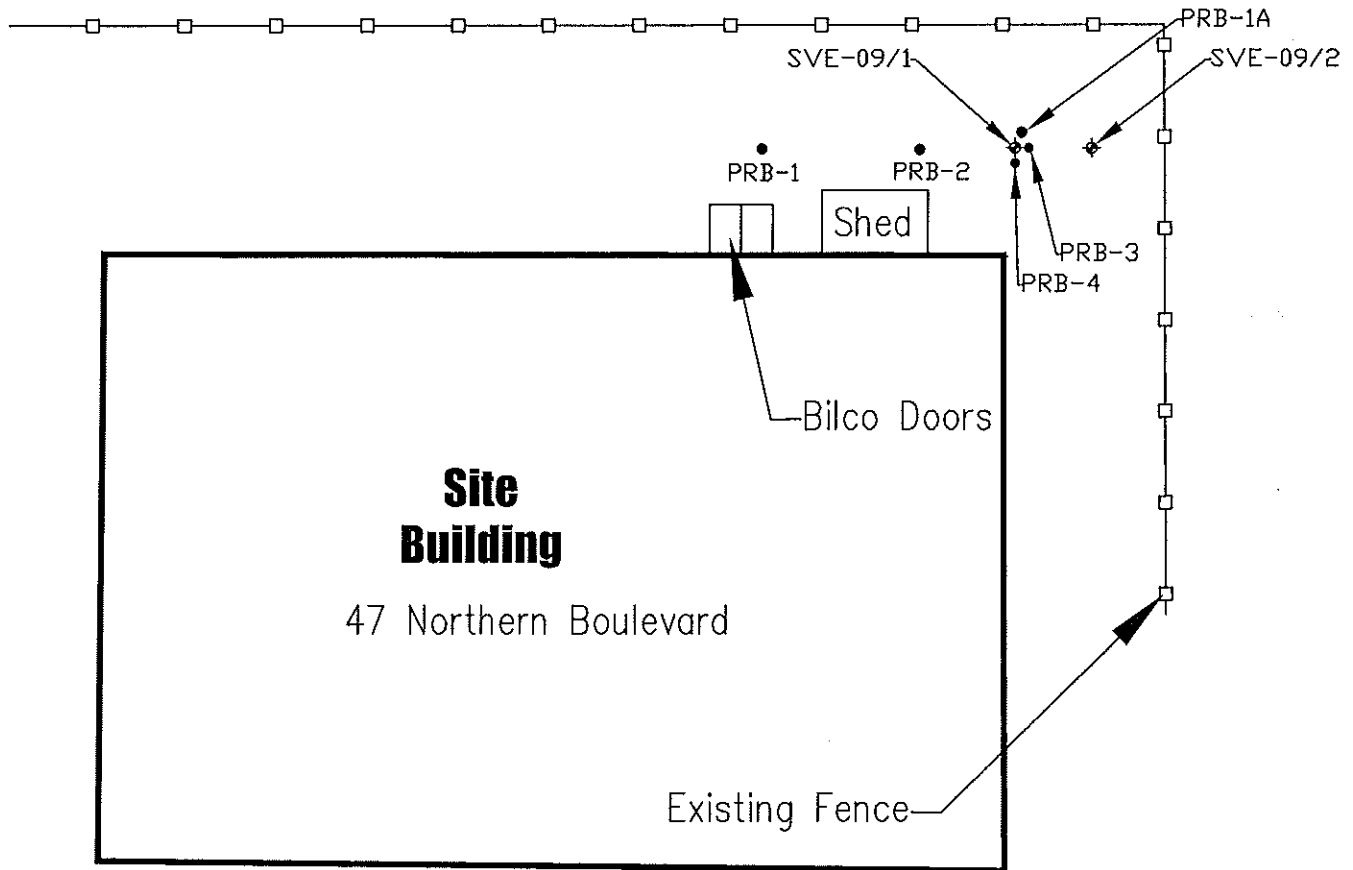
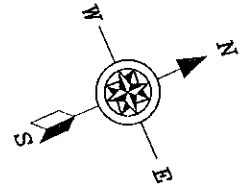

Parking

LEGEND

- ◆ Soil Vapor Extraction Well
- Soil Boring



GRAPHIC SCALE IN FEET

CA RICH CONSULTANTS, INC.

Certified Groundwater and Environmental Specialists
17 Dupont Street, Plainview, New York 11803

Stephen J. Osmundsen, P.E.

Professional Engineer
514 Pantigo Road # 16, East Hampton, New York 11937

TITLE:

Location of Post Remediation Boring
and SVE Wells

DATE:

3/22/2010

SCALE:

As Shown

FIGURE:

2

DRAWING NO:

2009-8

CDC/FLOWER FASHION
47 NORTHERN BLVD.
GREAT NECK, NY 11020

DRAWN BY:

D.S./J.T.C.

APPR. BY:

S.J.O.

Tables

Table 1
Summary of VOCs in Soil Samples
CDG/FF Site, Great Neck, New York

Sample Number	PRB-01A (4-6')	PRB-01A (8-10')	PRB-01A (14-16')	PRB-99*	FB 3/4/10	TB 3/4/10
Depth in Feet	4 to 6	8 to 10	14 to 16	4 to 6	NA	NA
Date	3/24/2010	3/24/2010	3/24/2010	3/24/2010	3/24/2010	3/24/2010
Units	ug/Kg	ug/Kg	ug/Kg	ug/Kg	ug/Kg	ug/Kg
Media	Soil	Soil	Soil	Soil	Water	Water
1,1 Dichloroethane	< 6	< 5.6	< 5.3	< 6	< 1	< 1
1,1 Dichloroethene	< 6	< 5.6	< 5.3	< 6	< 1	< 1
1,1-Dichloropropene	< 6	< 5.6	< 5.3	< 6	< 1	< 1
1,2 Dibromoethane	< 6	< 5.6	< 5.3	< 6	< 1	< 1
1,2 Dichlorobenzene (v)	< 6	< 5.6	< 5.3	< 6	< 1	< 1
1,2 Dichloroethane	< 6	< 5.6	< 5.3	< 6	< 1	< 1
1,2 Dichloropropane	< 6	< 5.6	< 5.3	< 6	< 1	< 1
1,3 Dichlorobenzene (v)	< 6	< 5.6	< 5.3	< 6	< 1	< 1
1,3-Dichloropropane	< 6	< 5.6	< 5.3	< 6	< 1	< 1
1,4 Dichlorobenzene (v)	< 6	< 5.6	< 5.3	< 6	< 1	< 1
111 Trichloroethane	< 6	< 5.6	< 5.3	< 6	< 1	< 1
1112Tetrachloroethane	< 6	< 5.6	< 5.3	< 6	< 1	< 1
112 Trichloroethane	< 6	< 5.6	< 5.3	< 6	< 1	< 1
1122Tetrachloroethane	< 6	< 5.6	< 5.3	< 6	< 1	< 1
123-Trichlorobenzene	< 6	< 5.6	< 5.3	< 6	< 1	< 1
123-Trichloropropane	< 6	< 5.6	< 5.3	< 6	< 1	< 1
124-Trichlorobenzene (v)	< 6	< 5.6	< 5.3	< 6	< 1	< 1
124-Trimethylbenzene	< 6	< 5.6	< 5.3	< 6	< 1	< 1
1245 Tetramethylbenz	< 6	< 5.6	< 5.3	< 6	< 1	< 1
135-Trimethylbenzene	< 6	< 5.6	< 5.3	< 6	< 1	< 1
2,2-Dichloropropane	< 6	< 5.6	< 5.3	< 6	< 1	< 1
2-Chlorotoluene	< 6	< 5.6	< 5.3	< 6	< 1	< 1
4-Chlorotoluene	< 6	< 5.6	< 5.3	< 6	< 1	< 1
Acetone	< 60	< 56	< 53	< 60	< 10	< 10
Benzene	< 6	< 5.6	< 5.3	< 6	< 1	< 1
Bromobenzene	< 6	< 5.6	< 5.3	< 6	< 1	< 1
Bromochloromethane	< 6	< 5.6	< 5.3	< 6	< 1	< 1
Bromodichloromethane	< 6	< 5.6	< 5.3	< 6	< 1	< 1
Bromoform	< 6	< 5.6	< 5.3	< 6	< 1	< 1
Bromomethane	< 6	< 5.6	< 5.3	< 6	< 1	< 1
c-1,2-Dichloroethene	< 6	< 5.6	< 5.3	< 6	< 1	< 1
c-1,3Dichloropropene	< 6	< 5.6	< 5.3	< 6	< 1	< 1
Carbon Tetrachloride	< 6	< 5.6	< 5.3	< 6	< 1	< 1
Chlorobenzene	< 6	< 5.6	< 5.3	< 6	< 1	< 1
Chlorodibromomethane	< 6	< 5.6	< 5.3	< 6	< 1	< 1
Chlorodifluoromethane	< 6	< 5.6	< 5.3	< 6	< 1	< 1
Chloroethane	< 6	< 5.6	< 5.3	< 6	< 1	< 1
Chloroform	< 6	< 5.6	< 5.3	< 6	< 1	< 1
Chloromethane	< 6	< 5.6	< 5.3	< 6	< 1	< 1
Dibromochloropropane	< 6	< 5.6	< 5.3	< 6	< 1	< 1
Dibromomethane	< 6	< 5.6	< 5.3	< 6	< 1	< 1
Dichlorodifluoromethane	< 6	< 5.6	< 5.3	< 6	< 1	< 1
Ethyl Benzene	< 6	< 5.6	< 5.3	< 6	< 1	< 1
Freon 113	< 6	< 5.6	< 5.3	< 6	< 1	< 1
Hexachlorobutadiene	< 6	< 5.6	< 5.3	< 6	< 1	< 1
Isopropylbenzene	< 6	< 5.6	< 5.3	< 6	< 1	< 1
m + p Xylene	< 12	< 11	< 11	< 12	< 2	< 2
Methyl Ethyl Ketone	< 60	< 56	< 53	< 60	< 10	< 10
Methylene Chloride	< 6	< 5.6	< 5.3	< 6	< 1	< 1
Methylisobutylketone	< 60	< 56	< 53	< 60	< 10	< 10
n-Butylbenzene	< 6	< 5.6	< 5.3	< 6	< 1	< 1
n-Propylbenzene	< 6	< 5.6	< 5.3	< 6	< 1	< 1
Naphthalene(v)	< 6	< 5.6	< 5.3	< 6	< 1	< 1
o Xylene	< 6	< 5.6	< 5.3	< 6	< 1	< 1
p Diethylbenzene	< 6	< 5.6	< 5.3	< 6	< 1	< 1
p-Ethyltoluene	< 6	< 5.6	< 5.3	< 6	< 1	< 1
p-Isopropyltoluene	< 6	< 5.6	< 5.3	< 6	< 1	< 1
sec-Butylbenzene	< 6	< 5.6	< 5.3	< 6	< 1	< 1
Styrene	< 6	< 5.6	< 5.3	< 6	< 1	< 1
t-1,2-Dichloroethene	< 6	< 5.6	< 5.3	< 6	< 1	< 1
t-1,3Dichloropropene	< 6	< 5.6	< 5.3	< 6	< 1	< 1
ter-ButylMethylEther	< 6	< 5.6	< 5.3	< 6	< 1	< 1
tert-Butylbenzene	< 6	< 5.6	< 5.3	< 6	< 1	< 1
Tetrachloroethane	8700	< 5.6	< 5.3	1400	< 1	< 1
Toluene	< 6	< 5.6	< 5.3	< 6	< 1	< 1
Trichloroethene	< 6	< 5.6	< 5.3	< 6	< 1	< 1
Trichlorofluoromethane	< 6	< 5.6	< 5.3	< 6	< 1	< 1
Vinyl Chloride	< 6	< 5.6	< 5.3	< 6	< 1	< 1

Notes: < = less than or not detected

NA = Not applicable as constituent is not detected

*PRB-99 is a duplicate of PRB-01A (4-6)

Table 2
Summary of VOCs in Soil Samples
CDC/FF Site, Great Neck, New York

Sample Number Boring Description Depth in Feet Date Units	PRB-03 (4-6) 3rd boring from initial sampling effort 4 to 6 6/9/2009 ug/Kg	PRB-01A Re-sampling adjacent to 3rd boring from initial sampling 4 to 6 3/24/2010 ug/Kg	NYSDEC TAGM* Standard ug/Kg	NYSDEC Part 375** Commercial ug/Kg
1,1 Dichloroethane	< 1,100	< 6	NA	NA
1,1 Dichloroethene	< 1,100	< 6	NA	NA
1,1-Dichloropropene	< 1,100	< 6	NA	NA
1,2 Dibromoethane	< 1,100	< 6	NA	NA
1,2 Dichlorobenzene (v)	< 1,100	< 6	NA	NA
1,2 Dichloroethane	< 1,100	< 6	NA	NA
1,2 Dichloropropane	< 1,100	< 6	NA	NA
1,3 Dichlorobenzene (v)	< 1,100	< 6	NA	NA
1,3-Dichloropropane	< 1,100	< 6	NA	NA
1,4 Dichlorobenzene (v)	< 1,100	< 6	NA	NA
111 Trichloroethane	< 1,100	< 6	NA	NA
1112Tetrachloroethane	< 1,100	< 6	NA	NA
112 Trichloroethane	< 1,100	< 6	NA	NA
1122Tetrachloroethane	< 1,100	< 6	NA	NA
123-Trichlorobenzene	< 1,100	< 6	NA	NA
123-Trichloropropane	< 1,100	< 6	NA	NA
124-Trichlorobenzene (v)	< 1,100	< 6	NA	NA
124-Trimethylbenzene	< 1,100	< 6	NA	NA
135-Trimethylbenzene	< 1,100	< 6	NA	NA
2,2-Dichloropropane	< 1,100	< 6	NA	NA
2-Chlorotoluene	< 1,100	< 6	NA	NA
4-Chlorotoluene	< 1,100	< 6	NA	NA
Acetone	< 11,000	< 60	NA	NA
Benzene	< 1,100	< 6	NA	NA
Bromobenzene	< 1,100	< 6	NA	NA
Bromochloromethane	< 1,100	< 6	NA	NA
Bromodichloromethane	< 1,100	< 6	NA	NA
Bromoform	< 1,100	< 6	NA	NA
c-1,2-Dichloroethene	< 1,100	< 6	NA	NA
c-1,3Dichloropropene	< 1,100	< 6	NA	NA
Carbon Tetrachloride	< 1,100	< 6	NA	NA
Chlorobenzene	< 1,100	< 6	NA	NA
Chlorodibromomethane	< 1,100	< 6	NA	NA
Chloroform	< 1,100	< 6	NA	NA
DBCP	< 1,100	< 6	NA	NA
Dibromomethane	< 1,100	< 6	NA	NA
Ethyl Benzene	< 1,100	< 6	NA	NA
Hexachlorobutadiene	< 1,100	< 6	NA	NA
Isopropylbenzene	< 1,100	< 6	NA	NA
m + p Xylene	< 2,300	< 12	NA	NA
Methylene Chloride	< 1,100	< 6	NA	NA
n-Propylbenzene	< 1,100	< 6	NA	NA
Naphthalene(v)	< 1,100	< 6	NA	NA
o Xylene	< 1,100	< 6	NA	NA
p-Isopropyltoluene	< 1,100	< 6	NA	NA
sec-Butylbenzene	< 1,100	< 6	NA	NA
Styrene	< 1,100	< 6	NA	NA
t-1,2-Dichloroethene	< 1,100	< 6	NA	NA
t-1,3Dichloropropene	< 1,100	< 6	NA	NA
tert-Butylbenzene	< 1,100	< 6	NA	NA
Tetrachloroethene	1,500,000	8,700	1,400	150,000
Toluene	< 1,100	< 6	NA	NA
Trichloroethene	< 1,100	< 6	NA	NA
Trichlorofluoromethane	< 1,100	< 6	NA	NA
Vinyl Chloride	< 1,100	< 6	NA	NA

Notes: < = less than or not detected

NA = Not applicable as constituent is not detected

* = NYSDEC (Jan. 24, 1994), Technical & Administrative Guidance

Memorandum: Determination of Soil Cleanup Objectives and Cleanup Levels.

** = NYSDEC (Dec. 14, 2006) DER Part 375 Table 375-6.8(b) Restricted Use
Soil Cleanup Objectives

Appendix A

Soil Laboratory Data

ECOTEST LABORATORIES, INC.

ENVIRONMENTAL TESTING

377 SHEFFIELD AVE. • N. BABYLON, N.Y. 11703 • (631) 422-5777 • FAX (631) 422-5770

Email: ecotestlab@aol.com Website: www.ecotestlabs.com

LAB NO.100901.01

03/17/10

C.A. Rich Consultants, Incorporated
17 Dupont Street
Plainview, NY 11803

ATTN: Eric Weinstock

PO#:

SOURCE OF SAMPLE: CDC

SOURCE OF SAMPLE:

COLLECTED BY: Client

DATE COL'D:03/04/10 RECEIVED:03/04/10

TIME COL'D:0950

MATRIX:Soil

SAMPLE: PRB-01A (4-6')

Results reported on a dry weight basis

ANALYTICAL PARAMETERS	UNITS	RESULT	DATE TIME	FLAG OF ANALYSIS	LRL	ANALYTICAL METHOD
Dichlorodifluoromethane	ug/Kg	< 6.0	030810		6.024	EPA8260
Chloromethane	ug/Kg	< 6.0	030810		6.024	EPA8260
Vinyl Chloride	ug/Kg	< 6.0	030810		6.024	EPA8260
Bromomethane	ug/Kg	< 6.0	030810		6.024	EPA8260
Chloroethane	ug/Kg	< 6.0	030810		6.024	EPA8260
Trichlorofluoromethane	ug/Kg	< 6.0	030810		6.024	EPA8260
1,1 Dichloroethene	ug/Kg	< 6.0	030810		6.024	EPA8260
Methylene Chloride	ug/Kg	< 6.0	030810		6.024	EPA8260
t-1,2-Dichloroethene	ug/Kg	< 6.0	030810		6.024	EPA8260
1,1 Dichloroethane	ug/Kg	< 6.0	030810		6.024	EPA8260
2,2-Dichloropropane	ug/Kg	< 6.0	030810		6.024	EPA8260
c-1,2-Dichloroethene	ug/Kg	< 6.0	030810		6.024	EPA8260
Bromochloromethane	ug/Kg	< 6.0	030810		6.024	EPA8260
Chloroform	ug/Kg	< 6.0	030810		6.024	EPA8260
111 Trichloroethane	ug/Kg	< 6.0	030810		6.024	EPA8260
Carbon Tetrachloride	ug/Kg	< 6.0	030810		6.024	EPA8260
1,1-Dichloropropene	ug/Kg	< 6.0	030810		6.024	EPA8260
Benzene	ug/Kg	< 6.0	030810		6.024	EPA8260
1,2 Dichloroethane	ug/Kg	< 6.0	030810		6.024	EPA8260
Trichloroethene	ug/Kg	< 6.0	030810		6.024	EPA8260
1,2 Dichloropropane	ug/Kg	< 6.0	030810		6.024	EPA8260
Dibromomethane	ug/Kg	< 6.0	030810		6.024	EPA8260
Bromodichloromethane	ug/Kg	< 6.0	030810		6.024	EPA8260
c-1,3Dichloropropene	ug/Kg	< 6.0	030810		6.024	EPA8260
Toluene	ug/Kg	< 6.0	030810		6.024	EPA8260

cc:

LRL=Laboratory Reporting Limit

REMARKS:

DIRECTOR

ECOTEST LABORATORIES, INC.

ENVIRONMENTAL TESTING

377 SHEFFIELD AVE. • N. BABYLON, N.Y. 11703 • (631) 422-5777 • FAX (631) 422-5770

Email: ecotestlab@aol.com Website: www.ecotestlabs.com

LAB NO.100901.01

03/17/10

C.A. Rich Consultants, Incorporated
17 Dupont Street
Plainview, NY 11803

ATTN: Eric Weinstock

PO#:

SOURCE OF SAMPLE: CDC

SOURCE OF SAMPLE:

COLLECTED BY: Client

DATE COL'D:03/04/10 RECEIVED:03/04/10

TIME COL'D:0950

MATRIX:Soil

SAMPLE: PRB-01A (4-6')

Results reported on a dry weight basis

ANALYTICAL PARAMETERS	UNITS	RESULT	DATE TIME	ANALYTICAL
			FLAG OF ANALYSIS	LRL METHOD
t-1,3Dichloropropene	ug/Kg	< 6.0	030810	6.024 EPA8260
112 Trichloroethane	ug/Kg	< 6.0	030810	6.024 EPA8260
Tetrachloroethene	ug/Kg	8700	030810	240.9 EPA8260
1,3-Dichloropropane	ug/Kg	< 6.0	030810	6.024 EPA8260
Chlorodibromomethane	ug/Kg	< 6.0	030810	6.024 EPA8260
1,2 Dibromoethane	ug/Kg	< 6.0	030810	6.024 EPA8260
Chlorobenzene	ug/Kg	< 6.0	030810	6.024 EPA8260
Ethyl Benzene	ug/Kg	< 6.0	030810	6.024 EPA8260
1112Tetrachloroethane	ug/Kg	< 6.0	030810	6.024 EPA8260
m + p Xylene	ug/Kg	< 12	030810	12.04 EPA8260
o Xylene	ug/Kg	< 6.0	030810	6.024 EPA8260
Styrene	ug/Kg	< 6.0	030810	6.024 EPA8260
Bromoform	ug/Kg	< 6.0	030810	6.024 EPA8260
Isopropylbenzene	ug/Kg	< 6.0	030810	6.024 EPA8260
Bromobenzene	ug/Kg	< 6.0	030810	6.024 EPA8260
1122Tetrachloroethane	ug/Kg	< 6.0	030810	6.024 EPA8260
123-Trichloropropane	ug/Kg	< 6.0	030810	6.024 EPA8260
n-Propylbenzene	ug/Kg	< 6.0	030810	6.024 EPA8260
2-Chlorotoluene	ug/Kg	< 6.0	030810	6.024 EPA8260
135-Trimethylbenzene	ug/Kg	< 6.0	030810	6.024 EPA8260
4-Chlorotoluene	ug/Kg	< 6.0	030810	6.024 EPA8260
tert-Butylbenzene	ug/Kg	< 6.0	030810	6.024 EPA8260
124-Trimethylbenzene	ug/Kg	< 6.0	030810	6.024 EPA8260
sec-Butylbenzene	ug/Kg	< 6.0	030810	6.024 EPA8260
p-Isopropyltoluene	ug/Kg	< 6.0	030810	6.024 EPA8260

cc:

LRL=Laboratory Reporting Limit

REMARKS:

DIRECTOR

rn = 5150

NYSDOH ID # 10320

Page 2 of 3

ECOTEST LABORATORIES, INC.

ENVIRONMENTAL TESTING

377 SHEFFIELD AVE. • N. BABYLON, N.Y. 11703 • (631) 422-5777 • FAX (631) 422-5770

Email: ecotestlab@aol.com Website: www.ecotestlabs.com

LAB NO.100901.01

03/17/10

C.A. Rich Consultants, Incorporated
17 Dupont Street
Plainview, NY 11803

ATTN: Eric Weinstock

PO#:

SOURCE OF SAMPLE: CDC

SOURCE OF SAMPLE:

COLLECTED BY: Client

DATE COL'D:03/04/10 RECEIVED:03/04/10

TIME COL'D:0950

MATRIX:Soil

SAMPLE: PRB-01A (4-6')

Results reported on a dry weight basis

ANALYTICAL PARAMETERS	UNITS	RESULT	FLAG	DATE TIME	ANALYTICAL	
				OF ANALYSIS	LRL	METHOD
1,3 Dichlorobenzene (v)	ug/Kg	< 6.0		030810	6.024	EPA8260
1,4 Dichlorobenzene (v)	ug/Kg	< 6.0		030810	6.024	EPA8260
n-Butylbenzene	ug/Kg	< 6.0		030810	6.024	EPA8260
1,2 Dichlorobenzene (v)	ug/Kg	< 6.0		030810	6.024	EPA8260
Dibromochloropropane	ug/Kg	< 6.0		030810	6.024	EPA8260
124-Trichlorobenzene (v)	ug/Kg	< 6.0		030810	6.024	EPA8260
Hexachlorobutadiene	ug/Kg	< 6.0		030810	6.024	EPA8260
Naphthalene(v)	ug/Kg	< 6.0		030810	6.024	EPA8260
123-Trichlorobenzene	ug/Kg	< 6.0		030810	6.024	EPA8260
ter. ButylMethylEther	ug/Kg	< 6.0		030810	6.024	EPA8260
p-Ethyltoluene	ug/Kg	< 6.0		030810	6.024	EPA8260
Freon 113	ug/Kg	< 6.0		030810	6.024	EPA8260
1245 Tetramethylbenz	ug/Kg	< 6.0		030810	6.024	EPA8260
Acetone	ug/Kg	< 60		030810	60.24	EPA8260
Methyl Ethyl Ketone	ug/Kg	< 60		030810	60.24	EPA8260
Methylisobutylketone	ug/Kg	< 60		030810	60.24	EPA8260
Chlorodifluoromethane	ug/Kg	< 6.0		030810	6.024	EPA8260
p Diethylbenzene	ug/Kg	< 6.0		030810	6.024	EPA8260
% Solids		83		030510	0.1	182540G

cc:

LRL=Laboratory Reporting Limit

REMARKS:

DIRECTOR

rn = 5151

NYSDOH ID # 10320

Page 3 of 3

ECOTEST LABORATORIES, INC.

ENVIRONMENTAL TESTING

377 SHEFFIELD AVE. • N. BABYLON, N.Y. 11703 • (631) 422-5777 • FAX (631) 422-5770

Email: ecotestlab@aol.com Website: www.ecotestlabs.com

LAB NO.100901.02

03/17/10

C.A. Rich Consultants, Incorporated
17 Dupont Street
Plainview, NY 11803

ATTN: Eric Weinstock

PO#:

SOURCE OF SAMPLE: CDC

SOURCE OF SAMPLE:

COLLECTED BY: Client

DATE COL'D:03/04/10 RECEIVED:03/04/10

TIME COL'D:0940

MATRIX:Soil

SAMPLE: PRB-01A (8-10')

Results reported on a dry weight basis

ANALYTICAL PARAMETERS	UNITS	RESULT	DATE TIME	ANALYTICAL
			FLAG OF ANALYSIS	LRL METHOD
Dichlorodifluoromethane	ug/Kg	< 5.6	030810	5.555 EPA8260
Chloromethane	ug/Kg	< 5.6	030810	5.555 EPA8260
Vinyl Chloride	ug/Kg	< 5.6	030810	5.555 EPA8260
Bromomethane	ug/Kg	< 5.6	030810	5.555 EPA8260
Chloroethane	ug/Kg	< 5.6	030810	5.555 EPA8260
Trichlorofluoromethane	ug/Kg	< 5.6	030810	5.555 EPA8260
1,1 Dichloroethene	ug/Kg	< 5.6	030810	5.555 EPA8260
Methylene Chloride	ug/Kg	< 5.6	030810	5.555 EPA8260
t-1,2-Dichloroethene	ug/Kg	< 5.6	030810	5.555 EPA8260
1,1 Dichloroethane	ug/Kg	< 5.6	030810	5.555 EPA8260
2,2-Dichloropropane	ug/Kg	< 5.6	030810	5.555 EPA8260
c-1,2-Dichloroethene	ug/Kg	< 5.6	030810	5.555 EPA8260
Bromochloromethane	ug/Kg	< 5.6	030810	5.555 EPA8260
Chloroform	ug/Kg	< 5.6	030810	5.555 EPA8260
111 Trichloroethane	ug/Kg	< 5.6	030810	5.555 EPA8260
Carbon Tetrachloride	ug/Kg	< 5.6	030810	5.555 EPA8260
1,1-Dichloropropene	ug/Kg	< 5.6	030810	5.555 EPA8260
Benzene	ug/Kg	< 5.6	030810	5.555 EPA8260
1,2 Dichloroethane	ug/Kg	< 5.6	030810	5.555 EPA8260
Trichloroethene	ug/Kg	< 5.6	030810	5.555 EPA8260
1,2 Dichloropropane	ug/Kg	< 5.6	030810	5.555 EPA8260
Dibromomethane	ug/Kg	< 5.6	030810	5.555 EPA8260
Bromodichloromethane	ug/Kg	< 5.6	030810	5.555 EPA8260
c-1,3Dichloropropene	ug/Kg	< 5.6	030810	5.555 EPA8260
Toluene	ug/Kg	< 5.6	030810	5.555 EPA8260

cc:

LRL=Laboratory Reporting Limit

REMARKS:

DIRECTOR

ECOTEST LABORATORIES, INC.

ENVIRONMENTAL TESTING

377 SHEFFIELD AVE. • N. BABYLON, N.Y. 11703 • (631) 422-5777 • FAX (631) 422-5770

Email: ecotestlab@aol.com Website: www.ecotestlabs.com

LAB NO.100901.02

03/17/10

C.A. Rich Consultants, Incorporated
17 Dupont Street
Plainview, NY 11803

ATTN: Eric Weinstock

PO#:

SOURCE OF SAMPLE: CDC

SOURCE OF SAMPLE:

COLLECTED BY: Client

DATE COL'D:03/04/10 RECEIVED:03/04/10

TIME COL'D:0940

MATRIX:Soil

SAMPLE: PRB-01A (8-10')

Results reported on a dry weight basis

ANALYTICAL PARAMETERS	UNITS	RESULT	DATE TIME	FLAG OF ANALYSIS	LRL	ANALYTICAL METHOD
t-1,3Dichloropropene	ug/Kg	< 5.6	030810		5.555	EPA8260
112 Trichloroethane	ug/Kg	< 5.6	030810		5.555	EPA8260
Tetrachloroethene	ug/Kg	< 5.6	030810		5.555	EPA8260
1,3-Dichloropropane	ug/Kg	< 5.6	030810		5.555	EPA8260
Chlorodibromomethane	ug/Kg	< 5.6	030810		5.555	EPA8260
1,2 Dibromoethane	ug/Kg	< 5.6	030810		5.555	EPA8260
Chlorobenzene	ug/Kg	< 5.6	030810		5.555	EPA8260
Ethyl Benzene	ug/Kg	< 5.6	030810		5.555	EPA8260
1112Tetrachloroethane	ug/Kg	< 5.6	030810		5.555	EPA8260
m + p Xylene	ug/Kg	< 11	030810		11.11	EPA8260
o Xylene	ug/Kg	< 5.6	030810		5.555	EPA8260
Styrene	ug/Kg	< 5.6	030810		5.555	EPA8260
Bromoform	ug/Kg	< 5.6	030810		5.555	EPA8260
Isopropylbenzene	ug/Kg	< 5.6	030810		5.555	EPA8260
Bromobenzene	ug/Kg	< 5.6	030810		5.555	EPA8260
1122Tetrachloroethane	ug/Kg	< 5.6	030810		5.555	EPA8260
123-Trichloropropane	ug/Kg	< 5.6	030810		5.555	EPA8260
n-Propylbenzene	ug/Kg	< 5.6	030810		5.555	EPA8260
2-Chlorotoluene	ug/Kg	< 5.6	030810		5.555	EPA8260
135-Trimethylbenzene	ug/Kg	< 5.6	030810		5.555	EPA8260
4-Chlorotoluene	ug/Kg	< 5.6	030810		5.555	EPA8260
tert-Butylbenzene	ug/Kg	< 5.6	030810		5.555	EPA8260
124-Trimethylbenzene	ug/Kg	< 5.6	030810		5.555	EPA8260
sec-Butylbenzene	ug/Kg	< 5.6	030810		5.555	EPA8260
p-Isopropyltoluene	ug/Kg	< 5.6	030810		5.555	EPA8260

cc:

LRL=Laboratory Reporting Limit

REMARKS:

DIRECTOR

rn = 5153

NYSDOH ID # 10320

Page 2 of 3

ECOTEST LABORATORIES, INC.

ENVIRONMENTAL TESTING

377 SHEFFIELD AVE. • N. BABYLON, N.Y. 11703 • (631) 422-5777 • FAX (631) 422-5770

Email: ecotestlab@aol.com Website: www.ecotestlabs.com

LAB NO.100901.02

03/17/10

C.A. Rich Consultants, Incorporated
17 Dupont Street
Plainview, NY 11803

ATTN: Eric Weinstock

PO#:

SOURCE OF SAMPLE: CDC

SOURCE OF SAMPLE:

COLLECTED BY: Client

DATE COL'D:03/04/10 RECEIVED:03/04/10

TIME COL'D:0940

MATRIX:Soil

SAMPLE: PRB-01A (8-10')

Results reported on a dry weight basis

ANALYTICAL PARAMETERS	UNITS	RESULT	DATE TIME	FLAG OF ANALYSIS	LRL	ANALYTICAL METHOD
1,3 Dichlorobenzene (v)	ug/Kg	< 5.6	030810		5.555	EPA8260
1,4 Dichlorobenzene (v)	ug/Kg	< 5.6	030810		5.555	EPA8260
n-Butylbenzene	ug/Kg	< 5.6	030810		5.555	EPA8260
1,2 Dichlorobenzene (v)	ug/Kg	< 5.6	030810		5.555	EPA8260
Dibromochloropropane	ug/Kg	< 5.6	030810		5.555	EPA8260
124-Trichlorobenzene (v)	ug/Kg	< 5.6	030810		5.555	EPA8260
Hexachlorobutadiene	ug/Kg	< 5.6	030810		5.555	EPA8260
Naphthalene(v)	ug/Kg	< 5.6	030810		5.555	EPA8260
123-Trichlorobenzene	ug/Kg	< 5.6	030810		5.555	EPA8260
ter. ButylMethylEther	ug/Kg	< 5.6	030810		5.555	EPA8260
p-Ethyltoluene	ug/Kg	< 5.6	030810		5.555	EPA8260
Freon 113	ug/Kg	< 5.6	030810		5.555	EPA8260
1245 Tetramethylbenz	ug/Kg	< 5.6	030810		5.555	EPA8260
Acetone	ug/Kg	< 56	030810		55.55	EPA8260
Methyl Ethyl Ketone	ug/Kg	< 56	030810		55.55	EPA8260
Methylisobutylketone	ug/Kg	< 56	030810		55.55	EPA8260
Chlorodifluoromethane	ug/Kg	< 5.6	030810		5.555	EPA8260
p Diethylbenzene	ug/Kg	< 5.6	030810		5.555	EPA8260
% Solids		90	030510		0.1	182540G

cc:

LRL=Laboratory Reporting Limit

REMARKS:

DIRECTOR

rn = 5154

NYSDOH ID # 10320

Page 3 of 3

ECOTEST LABORATORIES, INC.

ENVIRONMENTAL TESTING

377 SHEFFIELD AVE. • N. BABYLON, N.Y. 11703 • (631) 422-5777 • FAX (631) 422-5770

Email: ecotestlab@aol.com Website: www.ecotestlabs.com

LAB NO.100901.03

03/17/10

C.A. Rich Consultants, Incorporated
17 Dupont Street
Plainview, NY 11803

ATTN: Eric Weinstock

PO#:

SOURCE OF SAMPLE: CDC

SOURCE OF SAMPLE:

COLLECTED BY: Client

DATE COL'D:03/04/10 RECEIVED:03/04/10

TIME COL'D:0930

MATRIX:Soil

SAMPLE: PRB-01A (14-16')

Results reported on a dry weight basis

ANALYTICAL PARAMETERS	UNITS	RESULT	DATE TIME	FLAG OF ANALYSIS	LRL	ANALYTICAL METHOD
Dichlorodifluoromethane	ug/Kg	< 5.3	030810		5.263	EPA8260
Chloromethane	ug/Kg	< 5.3	030810		5.263	EPA8260
Vinyl Chloride	ug/Kg	< 5.3	030810		5.263	EPA8260
Bromomethane	ug/Kg	< 5.3	030810		5.263	EPA8260
Chloroethane	ug/Kg	< 5.3	030810		5.263	EPA8260
Trichlorofluoromethane	ug/Kg	< 5.3	030810		5.263	EPA8260
1,1 Dichloroethene	ug/Kg	< 5.3	030810		5.263	EPA8260
Methylene Chloride	ug/Kg	< 5.3	030810		5.263	EPA8260
t-1,2-Dichloroethene	ug/Kg	< 5.3	030810		5.263	EPA8260
1,1 Dichloroethane	ug/Kg	< 5.3	030810		5.263	EPA8260
2,2-Dichloropropane	ug/Kg	< 5.3	030810		5.263	EPA8260
c-1,2-Dichloroethene	ug/Kg	< 5.3	030810		5.263	EPA8260
Bromochloromethane	ug/Kg	< 5.3	030810		5.263	EPA8260
Chloroform	ug/Kg	< 5.3	030810		5.263	EPA8260
111 Trichloroethane	ug/Kg	< 5.3	030810		5.263	EPA8260
Carbon Tetrachloride	ug/Kg	< 5.3	030810		5.263	EPA8260
1,1-Dichloropropene	ug/Kg	< 5.3	030810		5.263	EPA8260
Benzene	ug/Kg	< 5.3	030810		5.263	EPA8260
1,2 Dichloroethane	ug/Kg	< 5.3	030810		5.263	EPA8260
Trichloroethene	ug/Kg	< 5.3	030810		5.263	EPA8260
1,2 Dichloropropane	ug/Kg	< 5.3	030810		5.263	EPA8260
Dibromomethane	ug/Kg	< 5.3	030810		5.263	EPA8260
Bromodichloromethane	ug/Kg	< 5.3	030810		5.263	EPA8260
c-1,3Dichloropropene	ug/Kg	< 5.3	030810		5.263	EPA8260
Toluene	ug/Kg	< 5.3	030810		5.263	EPA8260

cc:

LRL=Laboratory Reporting Limit

REMARKS:

DIRECTOR

rn = 5155

NYSDOH ID # 10320

Page 1 of 3

ECOTEST LABORATORIES, INC.

ENVIRONMENTAL TESTING

377 SHEFFIELD AVE. • N. BABYLON, N.Y. 11703 • (631) 422-5777 • FAX (631) 422-5770

Email: ecotestlab@aol.com Website: www.ecotestlabs.com

LAB NO.100901.03

03/17/10

C.A. Rich Consultants, Incorporated
17 Dupont Street
Plainview, NY 11803

ATTN: Eric Weinstock

PO#:

SOURCE OF SAMPLE: CDC

SOURCE OF SAMPLE:

COLLECTED BY: Client

DATE COL'D:03/04/10 RECEIVED:03/04/10

TIME COL'D:0930

MATRIX:Soil

SAMPLE: PRB-01A (14-16')

Results reported on a dry weight basis

ANALYTICAL PARAMETERS	UNITS	RESULT	DATE TIME	FLAG OF ANALYSIS	LRL	ANALYTICAL METHOD
t-1,3Dichloropropene	ug/Kg	< 5.3	030810		5.263	EPA8260
112 Trichloroethane	ug/Kg	< 5.3	030810		5.263	EPA8260
Tetrachloroethene	ug/Kg	< 5.3	030810		5.263	EPA8260
1,3-Dichloropropane	ug/Kg	< 5.3	030810		5.263	EPA8260
Chlorodibromomethane	ug/Kg	< 5.3	030810		5.263	EPA8260
1,2 Dibromoethane	ug/Kg	< 5.3	030810		5.263	EPA8260
Chlorobenzene	ug/Kg	< 5.3	030810		5.263	EPA8260
Ethyl Benzene	ug/Kg	< 5.3	030810		5.263	EPA8260
1112Tetrachloroethane	ug/Kg	< 5.3	030810		5.263	EPA8260
m + p Xylene	ug/Kg	< 11	030810		10.52	EPA8260
o Xylene	ug/Kg	< 5.3	030810		5.263	EPA8260
Styrene	ug/Kg	< 5.3	030810		5.263	EPA8260
Bromoform	ug/Kg	< 5.3	030810		5.263	EPA8260
Isopropylbenzene	ug/Kg	< 5.3	030810		5.263	EPA8260
Bromobenzene	ug/Kg	< 5.3	030810		5.263	EPA8260
1122Tetrachloroethane	ug/Kg	< 5.3	030810		5.263	EPA8260
123-Trichloropropane	ug/Kg	< 5.3	030810		5.263	EPA8260
n-Propylbenzene	ug/Kg	< 5.3	030810		5.263	EPA8260
2-Chlorotoluene	ug/Kg	< 5.3	030810		5.263	EPA8260
135-Trimethylbenzene	ug/Kg	< 5.3	030810		5.263	EPA8260
4-Chlorotoluene	ug/Kg	< 5.3	030810		5.263	EPA8260
tert-Butylbenzene	ug/Kg	< 5.3	030810		5.263	EPA8260
124-Trimethylbenzene	ug/Kg	< 5.3	030810		5.263	EPA8260
sec-Butylbenzene	ug/Kg	< 5.3	030810		5.263	EPA8260
p-Isopropyltoluene	ug/Kg	< 5.3	030810		5.263	EPA8260

cc:

LRL=Laboratory Reporting Limit

REMARKS:

DIRECTOR

rn = 5156

NYSDOH ID # 10320

Page 2 of 3

ECOTEST LABORATORIES, INC.

ENVIRONMENTAL TESTING

377 SHEFFIELD AVE. • N. BABYLON, N.Y. 11703 • (631) 422-5777 • FAX (631) 422-5770

Email: ecotestlab@aol.com Website: www.ecotestlabs.com

LAB NO.100901.03

03/17/10

C.A. Rich Consultants, Incorporated
17 Dupont Street
Plainview, NY 11803

ATTN: Eric Weinstock

PO#:

SOURCE OF SAMPLE: CDC

SOURCE OF SAMPLE:

COLLECTED BY: Client

DATE COL'D:03/04/10 RECEIVED:03/04/10

TIME COL'D:0930

MATRIX:Soil

SAMPLE: PRB-01A (14-16')

Results reported on a dry weight basis

ANALYTICAL PARAMETERS	UNITS	RESULT	DATE TIME	ANALYTICAL	
			FLAG OF ANALYSIS	LRL	METHOD
1,3 Dichlorobenzene (v)	ug/Kg	< 5.3	030810	5.263	EPA8260
1,4 Dichlorobenzene (v)	ug/Kg	< 5.3	030810	5.263	EPA8260
n-Butylbenzene	ug/Kg	< 5.3	030810	5.263	EPA8260
1,2 Dichlorobenzene (v)	ug/Kg	< 5.3	030810	5.263	EPA8260
Dibromochloropropane	ug/Kg	< 5.3	030810	5.263	EPA8260
124-Trichlorobenzene (v)	ug/Kg	< 5.3	030810	5.263	EPA8260
Hexachlorobutadiene	ug/Kg	< 5.3	030810	5.263	EPA8260
Naphthalene(v)	ug/Kg	< 5.3	030810	5.263	EPA8260
123-Trichlorobenzene	ug/Kg	< 5.3	030810	5.263	EPA8260
ter. ButylMethylEther	ug/Kg	< 5.3	030810	5.263	EPA8260
p-Ethyltoluene	ug/Kg	< 5.3	030810	5.263	EPA8260
Freon 113	ug/Kg	< 5.3	030810	5.263	EPA8260
1245 Tetramethylbenz	ug/Kg	< 5.3	030810	5.263	EPA8260
Acetone	ug/Kg	< 53	030810	52.63	EPA8260
Methyl Ethyl Ketone	ug/Kg	< 53	030810	52.63	EPA8260
Methylisobutylketone	ug/Kg	< 53	030810	52.63	EPA8260
Chlorodifluoromethane	ug/Kg	< 5.3	030810	5.263	EPA8260
p Diethylbenzene	ug/Kg	< 5.3	030810	5.263	EPA8260
% Solids		95	030510	0.1	182540G

cc:

LRL=Laboratory Reporting Limit

REMARKS:

DIRECTOR

rn = 5157

NYSDOH ID # 10320

Page 3 of 3

ECOTEST LABORATORIES, INC.

ENVIRONMENTAL TESTING

377 SHEFFIELD AVE. • N. BABYLON, N.Y. 11703 • (631) 422-5777 • FAX (631) 422-5770

Email: ecotestlab@aol.com Website: www.ecotestlabs.com

LAB NO.100901.04

03/17/10

C.A. Rich Consultants, Incorporated
17 Dupont Street
Plainview, NY 11803

ATTN: Eric Weinstock

PO#:

SOURCE OF SAMPLE: GDC

SOURCE OF SAMPLE:

COLLECTED BY: Client

DATE COL'D:03/04/10 RECEIVED:03/04/10

TIME COL'D:0930

MATRIX:Soil

SAMPLE: PRB-01A (14-16') MS

Results reported on a dry weight basis

ANALYTICAL PARAMETERS	UNITS	RESULT	DATE TIME	ANALYTICAL
			FLAG OF ANALYSIS	LRL METHOD
Dichlorodifluoromethane	ug/Kg	22	030810	5.263 EPA8260
Chloromethane	ug/Kg	23	030810	5.263 EPA8260
Vinyl Chloride	ug/Kg	24	030810	5.263 EPA8260
Bromomethane	ug/Kg	21	030810	5.263 EPA8260
Chloroethane	ug/Kg	25	030810	5.263 EPA8260
Trichlorofluoromethane	ug/Kg	24	030810	5.263 EPA8260
1,1 Dichloroethene	ug/Kg	24	030810	5.263 EPA8260
Methylene Chloride	ug/Kg	25	030810	5.263 EPA8260
t-1,2-Dichloroethene	ug/Kg	24	030810	5.263 EPA8260
1,1 Dichloroethane	ug/Kg	24	030810	5.263 EPA8260
2,2-Dichloropropane	ug/Kg	23	030810	5.263 EPA8260
c-1,2-Dichloroethene	ug/Kg	24	030810	5.263 EPA8260
Bromochloromethane	ug/Kg	23	030810	5.263 EPA8260
Chloroform	ug/Kg	22	030810	5.263 EPA8260
111 Trichloroethane	ug/Kg	24	030810	5.263 EPA8260
Carbon Tetrachloride	ug/Kg	23	030810	5.263 EPA8260
1,1-Dichloropropene	ug/Kg	24	030810	5.263 EPA8260
Benzene	ug/Kg	23	030810	5.263 EPA8260
1,2 Dichloroethane	ug/Kg	22	030810	5.263 EPA8260
Trichloroethene	ug/Kg	24	030810	5.263 EPA8260
1,2 Dichloropropane	ug/Kg	23	030810	5.263 EPA8260
Dibromomethane	ug/Kg	23	030810	5.263 EPA8260
Bromodichloromethane	ug/Kg	22	030810	5.263 EPA8260
c-1,3Dichloropropene	ug/Kg	22	030810	5.263 EPA8260
Toluene	ug/Kg	23	030810	5.263 EPA8260

cc:

LRL=Laboratory Reporting Limit

REMARKS: RESULTS REPORTED ON THIS PAGE REPRESENT SAMPLE AFTER
SPIKING FOR (MATRIX SPIKE OR MATRIX SPIKE DUPLICATE) AND
DO NOT REPRESENT ACTUAL CONCENTRATIONS DETECTED IN SAMPLE.

DIRECTOR

rn = 5158

NYSDOH ID # 10320

Page 1 of 3

ECOTEST LABORATORIES, INC.

ENVIRONMENTAL TESTING

377 SHEFFIELD AVE. • N. BABYLON, N.Y. 11703 • (631) 422-5777 • FAX (631) 422-5770

Email: ecotestlab@aol.com Website: www.ecotestlabs.com

LAB NO.100901.04

03/17/10

C.A. Rich Consultants, Incorporated
17 Dupont Street
Plainview, NY 11803

ATTN: Eric Weinstock

PO#:

SOURCE OF SAMPLE: CDC

SOURCE OF SAMPLE:

COLLECTED BY: Client

DATE COL'D:03/04/10 RECEIVED:03/04/10

TIME COL'D:0930

MATRIX:Soil

SAMPLE: PRB-01A (14-16') MS

Results reported on a dry weight basis

ANALYTICAL PARAMETERS	UNITS	RESULT	DATE TIME	FLAG OF ANALYSIS	LRL	ANALYTICAL METHOD
t-1,3Dichloropropene	ug/Kg	22	030810		5.263	EPA8260
112 Trichloroethane	ug/Kg	23	030810		5.263	EPA8260
Tetrachloroethene	ug/Kg	21	030810		5.263	EPA8260
1,3-Dichloropropane	ug/Kg	23	030810		5.263	EPA8260
Chlorodibromomethane	ug/Kg	22	030810		5.263	EPA8260
1,2 Dibromoethane	ug/Kg	23	030810		5.263	EPA8260
Chlorobenzene	ug/Kg	23	030810		5.263	EPA8260
Ethyl Benzene	ug/Kg	23	030810		5.263	EPA8260
1112Tetrachloroethane	ug/Kg	22	030810		5.263	EPA8260
m + p Xylene	ug/Kg	46	030810		10.52	EPA8260
o Xylene	ug/Kg	23	030810		5.263	EPA8260
Styrene	ug/Kg	23	030810		5.263	EPA8260
Bromoform	ug/Kg	22	030810		5.263	EPA8260
Isopropylbenzene	ug/Kg	23	030810		5.263	EPA8260
Bromobenzene	ug/Kg	23	030810		5.263	EPA8260
1122Tetrachloroethane	ug/Kg	23	030810		5.263	EPA8260
123-Trichloropropane	ug/Kg	23	030810		5.263	EPA8260
n-Propylbenzene	ug/Kg	24	030810		5.263	EPA8260
2-Chlorotoluene	ug/Kg	23	030810		5.263	EPA8260
135-Trimethylbenzene	ug/Kg	23	030810		5.263	EPA8260
4-Chlorotoluene	ug/Kg	24	030810		5.263	EPA8260
tert-Butylbenzene	ug/Kg	23	030810		5.263	EPA8260
124-Trimethylbenzene	ug/Kg	24	030810		5.263	EPA8260
sec-Butylbenzene	ug/Kg	24	030810		5.263	EPA8260
p-Isopropyltoluene	ug/Kg	25	030810		5.263	EPA8260

cc:

LRL=Laboratory Reporting Limit

REMARKS: RESULTS REPORTED ON THIS PAGE REPRESENT SAMPLE AFTER
SPIKING FOR (MATRIX SPIKE OR MATRIX SPIKE DUPLICATE) AND
DO NOT REPRESENT ACTUAL CONCENTRATIONS DETECTED IN SAMPLE.

DIRECTOR

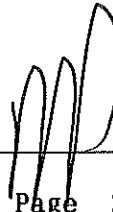

377 SHEFFIELD AVE. • N. BABYLON, N.Y. 11703 • (631) 422-5777 • FAX (631) 422-5770

Email: ecotestlab@aol.com Website: www.ecotestlabs.com

LAB NO.100901.04

03/17/10

C.A. Rich Consultants, Incorporated
17 Dupont Street
Plainview, NY 11803

ATTN: Eric Weinstock

PO#:

SOURCE OF SAMPLE: CDC

SOURCE OF SAMPLE:

COLLECTED BY: Client

DATE COL'D:03/04/10 RECEIVED:03/04/10

TIME COL'D:0930

MATRIX:Soil

SAMPLE: PRB-01A (14-16') MS

Results reported on a dry weight basis

ANALYTICAL PARAMETERS	UNITS	RESULT	FLAG	DATE TIME	ANALYTICAL	
				OF ANALYSIS	LRL	METHOD
1,3 Dichlorobenzene (v)	ug/Kg	23		030810	5.263	EPA8260
1,4 Dichlorobenzene (v)	ug/Kg	23		030810	5.263	EPA8260
n-Butylbenzene	ug/Kg	26		030810	5.263	EPA8260
1,2 Dichlorobenzene (v)	ug/Kg	23		030810	5.263	EPA8260
Dibromochloropropane	ug/Kg	22		030810	5.263	EPA8260
124-Trichlorobenzene (v)	ug/Kg	25		030810	5.263	EPA8260
Hexachlorobutadiene	ug/Kg	26		030810	5.263	EPA8260
Naphthalene(v)	ug/Kg	23		030810	5.263	EPA8260
123-Trichlorobenzene	ug/Kg	25		030810	5.263	EPA8260
ter. ButylMethylEther	ug/Kg	22		030810	5.263	EPA8260
p-Ethyltoluene	ug/Kg	24		030810	5.263	EPA8260
Freon 113	ug/Kg	23		030810	5.263	EPA8260
1245 Tetramethylbenz	ug/Kg	24		030810	5.263	EPA8260
Acetone	ug/Kg	120		030810	52.63	EPA8260
Methyl Ethyl Ketone	ug/Kg	110		030810	52.63	EPA8260
Methylisobutylketone	ug/Kg	110		030810	52.63	EPA8260
Chlorodifluoromethane	ug/Kg	23		030810	5.263	EPA8260
p Diethylbenzene	ug/Kg	25		030810	5.263	EPA8260
% Solids		95		030510	0.1	182540G

cc:

LRL=Laboratory Reporting Limit

REMARKS: RESULTS REPORTED ON THIS PAGE REPRESENT SAMPLE AFTER
SPIKING FOR (MATRIX SPIKE OR MATRIX SPIKE DUPLICATE) AND
DO NOT REPRESENT ACTUAL CONCENTRATIONS DETECTED IN SAMPLE.DIRECTOR 

ECOTEST LABORATORIES, INC.

ENVIRONMENTAL TESTING

377 SHEFFIELD AVE. • N. BABYLON, N.Y. 11703 • (631) 422-5777 • FAX (631) 422-5770

Email: ecotestlab@aol.com Website: www.ecotestlabs.com

LAB NO.100901.05

03/17/10

C.A. Rich Consultants, Incorporated
17 Dupont Street
Plainview, NY 11803

ATTN: Eric Weinstock

PO#:

SOURCE OF SAMPLE: CDC

SOURCE OF SAMPLE:

COLLECTED BY: Client

DATE COL'D:03/04/10 RECEIVED:03/04/10

TIME COL'D:0930

MATRIX:Soil

SAMPLE: PRB-01A (14-16') MSD

Results reported on a dry weight basis

ANALYTICAL PARAMETERS	UNITS	RESULT	DATE TIME	ANALYTICAL
			FLAG OF ANALYSIS	LRL METHOD
Dichlorodifluoromethane	ug/Kg	20	030810	5.263 EPA8260
Chloromethane	ug/Kg	22	030810	5.263 EPA8260
Vinyl Chloride	ug/Kg	22	030810	5.263 EPA8260
Bromomethane	ug/Kg	21	030810	5.263 EPA8260
Chloroethane	ug/Kg	22	030810	5.263 EPA8260
Trichlorofluoromethane	ug/Kg	23	030810	5.263 EPA8260
1,1 Dichloroethene	ug/Kg	23	030810	5.263 EPA8260
Methylene Chloride	ug/Kg	24	030810	5.263 EPA8260
t-1,2-Dichloroethene	ug/Kg	23	030810	5.263 EPA8260
1,1 Dichloroethane	ug/Kg	23	030810	5.263 EPA8260
2,2-Dichloropropane	ug/Kg	23	030810	5.263 EPA8260
c-1,2-Dichloroethene	ug/Kg	24	030810	5.263 EPA8260
Bromochloromethane	ug/Kg	23	030810	5.263 EPA8260
Chloroform	ug/Kg	21	030810	5.263 EPA8260
111 Trichloroethane	ug/Kg	23	030810	5.263 EPA8260
Carbon Tetrachloride	ug/Kg	22	030810	5.263 EPA8260
1,1-Dichloropropene	ug/Kg	22	030810	5.263 EPA8260
Benzene	ug/Kg	23	030810	5.263 EPA8260
1,2 Dichloroethane	ug/Kg	21	030810	5.263 EPA8260
Trichloroethene	ug/Kg	22	030810	5.263 EPA8260
1,2 Dichloropropane	ug/Kg	22	030810	5.263 EPA8260
Dibromomethane	ug/Kg	23	030810	5.263 EPA8260
Bromodichloromethane	ug/Kg	22	030810	5.263 EPA8260
c-1,3Dichloropropene	ug/Kg	22	030810	5.263 EPA8260
Toluene	ug/Kg	23	030810	5.263 EPA8260

cc:

LRL=Laboratory Reporting Limit

REMARKS: RESULTS REPORTED ON THIS PAGE REPRESENT SAMPLE AFTER
SPIKING FOR (MATRIX SPIKE OR MATRIX SPIKE DUPLICATE) AND
DO NOT REPRESENT ACTUAL CONCENTRATIONS DETECTED IN SAMPLE.

DIRECTOR



ECOTEST LABORATORIES, INC.

ENVIRONMENTAL TESTING

377 SHEFFIELD AVE. • N. BABYLON, N.Y. 11703 • (631) 422-5777 • FAX (631) 422-5770

Email: ecotestlab@aol.com Website: www.ecotestlabs.com

LAB NO.100901.05

03/17/10

C.A. Rich Consultants, Incorporated
17 Dupont Street
Plainview, NY 11803

ATTN: Eric Weinstock

PO#:

SOURCE OF SAMPLE: CDC

SOURCE OF SAMPLE:

COLLECTED BY: Client

DATE COL'D:03/04/10 RECEIVED:03/04/10

TIME COL'D:0930

MATRIX:Soil

SAMPLE: PRB-01A (14-16') MSD

Results reported on a dry weight basis

ANALYTICAL PARAMETERS	UNITS	RESULT	DATE TIME	FLAG OF ANALYSIS	LRL	ANALYTICAL METHOD
t-1,3Dichloropropene	ug/Kg	22	030810		5.263	EPA8260
112 Trichloroethane	ug/Kg	23	030810		5.263	EPA8260
Tetrachloroethene	ug/Kg	20	030810		5.263	EPA8260
1,3-Dichloropropane	ug/Kg	23	030810		5.263	EPA8260
Chlorodibromomethane	ug/Kg	22	030810		5.263	EPA8260
1,2 Dibromoethane	ug/Kg	22	030810		5.263	EPA8260
Chlorobenzene	ug/Kg	23	030810		5.263	EPA8260
Ethyl Benzene	ug/Kg	22	030810		5.263	EPA8260
1112Tetrachloroethane	ug/Kg	22	030810		5.263	EPA8260
m + p Xylene	ug/Kg	45	030810		10.52	EPA8260
o Xylene	ug/Kg	23	030810		5.263	EPA8260
Styrene	ug/Kg	22	030810		5.263	EPA8260
Bromoform	ug/Kg	23	030810		5.263	EPA8260
Isopropylbenzene	ug/Kg	23	030810		5.263	EPA8260
Bromobenzene	ug/Kg	22	030810		5.263	EPA8260
1122Tetrachloroethane	ug/Kg	23	030810		5.263	EPA8260
123-Trichloropropane	ug/Kg	23	030810		5.263	EPA8260
n-Propylbenzene	ug/Kg	23	030810		5.263	EPA8260
2-Chlorotoluene	ug/Kg	23	030810		5.263	EPA8260
135-Trimethylbenzene	ug/Kg	23	030810		5.263	EPA8260
4-Chlorotoluene	ug/Kg	22	030810		5.263	EPA8260
tert-Butylbenzene	ug/Kg	23	030810		5.263	EPA8260
124-Trimethylbenzene	ug/Kg	23	030810		5.263	EPA8260
sec-Butylbenzene	ug/Kg	24	030810		5.263	EPA8260
p-Isopropyltoluene	ug/Kg	23	030810		5.263	EPA8260

cc;

LRL=Laboratory Reporting Limit

REMARKS: RESULTS REPORTED ON THIS PAGE REPRESENT SAMPLE AFTER
SPIKING FOR (MATRIX SPIKE OR MATRIX SPIKE DUPLICATE) AND
DO NOT REPRESENT ACTUAL CONCENTRATIONS DETECTED IN SAMPLE.

DIRECTOR

rn = 5162

NYSDOH ID # 10320

Page 2 of 3

ECOTEST LABORATORIES, INC.

ENVIRONMENTAL TESTING

377 SHEFFIELD AVE. • N. BABYLON, N.Y. 11703 • (631) 422-5777 • FAX (631) 422-5770

Email: ecotestlab@aol.com Website: www.ecotestlabs.com

LAB NO.100901.05

03/17/10

C.A. Rich Consultants, Incorporated
17 Dupont Street
Plainview, NY 11803

ATTN: Eric Weinstock

PO#:

SOURCE OF SAMPLE: CDC

SOURCE OF SAMPLE:

COLLECTED BY: Client

DATE COL'D:03/04/10 RECEIVED:03/04/10

TIME COL'D:0930

MATRIX:Soil

SAMPLE: PRB-01A (14-16') MSD

Results reported on a dry weight basis

ANALYTICAL PARAMETERS	UNITS	RESULT	DATE TIME	FLAG OF ANALYSIS	LRL	METHOD
1,3 Dichlorobenzene (v)	ug/Kg	23	030810		5.263	EPA8260
1,4 Dichlorobenzene (v)	ug/Kg	23	030810		5.263	EPA8260
n-Butylbenzene	ug/Kg	25	030810		5.263	EPA8260
1,2 Dichlorobenzene (v)	ug/Kg	23	030810		5.263	EPA8260
Dibromochloropropane	ug/Kg	23	030810		5.263	EPA8260
124-Trichlorobenzene (v)	ug/Kg	25	030810		5.263	EPA8260
Hexachlorobutadiene	ug/Kg	26	030810		5.263	EPA8260
Naphthalene(v)	ug/Kg	24	030810		5.263	EPA8260
123-Trichlorobenzene	ug/Kg	25	030810		5.263	EPA8260
ter-ButylMethylEther	ug/Kg	21	030810		5.263	EPA8260
p-Ethyltoluene	ug/Kg	23	030810		5.263	EPA8260
Freon 113	ug/Kg	23	030810		5.263	EPA8260
1245 Tetramethylbenz	ug/Kg	24	030810		5.263	EPA8260
Acetone	ug/Kg	120	030810		52.63	EPA8260
Methyl Ethyl Ketone	ug/Kg	110	030810		52.63	EPA8260
Methylisobutylketone	ug/Kg	110	030810		52.63	EPA8260
Chlorodifluoromethane	ug/Kg	20	030810		5.263	EPA8260
p Diethylbenzene	ug/Kg	24	030810		5.263	EPA8260
% Solids		95	030510		0.1	182540G

cc:

LRL=Laboratory Reporting Limit

REMARKS: RESULTS REPORTED ON THIS PAGE REPRESENT SAMPLE AFTER
SPIKING FOR (MATRIX SPIKE OR MATRIX SPIKE DUPLICATE) AND
DO NOT REPRESENT ACTUAL CONCENTRATIONS DETECTED IN SAMPLE.

DIRECTOR

rn = 5163

NYSDOH ID # 10320

Page 3 of 3

Analytical results relate to the samples as received by the laboratory.

ECOTEST LABORATORIES, INC.

ENVIRONMENTAL TESTING

377 SHEFFIELD AVE. • N. BABYLON, N.Y. 11703 • (631) 422-5777 • FAX (631) 422-5770

Email: ecotestlab@aol.com Website: www.ecotestlabs.com

LAB NO.100901.06

03/17/10

C.A. Rich Consultants, Incorporated
17 Dupont Street
Plainview, NY 11803

ATTN: Eric Weinstock

PO#:

SOURCE OF SAMPLE: CDC

SOURCE OF SAMPLE:

COLLECTED BY: Client DATE COL'D:03/04/10 RECEIVED:03/04/10

MATRIX:Soil

SAMPLE: PRB-99

Results reported on a dry weight basis

ANALYTICAL PARAMETERS	UNITS	RESULT	DATE TIME	ANALYTICAL
			FLAG OF ANALYSIS	LRL METHOD
Dichlorodifluoromethane	ug/Kg	< 6.0	030810	5.952 EPA8260
Chloromethane	ug/Kg	< 6.0	030810	5.952 EPA8260
Vinyl Chloride	ug/Kg	< 6.0	030810	5.952 EPA8260
Bromomethane	ug/Kg	< 6.0	030810	5.952 EPA8260
Chloroethane	ug/Kg	< 6.0	030810	5.952 EPA8260
Trichlorofluoromethane	ug/Kg	< 6.0	030810	5.952 EPA8260
1,1 Dichloroethene	ug/Kg	< 6.0	030810	5.952 EPA8260
Methylene Chloride	ug/Kg	< 6.0	030810	5.952 EPA8260
t-1,2-Dichloroethene	ug/Kg	< 6.0	030810	5.952 EPA8260
1,1 Dichloroethane	ug/Kg	< 6.0	030810	5.952 EPA8260
2,2-Dichloropropane	ug/Kg	< 6.0	030810	5.952 EPA8260
c-1,2-Dichloroethene	ug/Kg	< 6.0	030810	5.952 EPA8260
Bromochloromethane	ug/Kg	< 6.0	030810	5.952 EPA8260
Chloroform	ug/Kg	< 6.0	030810	5.952 EPA8260
111 Trichloroethane	ug/Kg	< 6.0	030810	5.952 EPA8260
Carbon Tetrachloride	ug/Kg	< 6.0	030810	5.952 EPA8260
1,1-Dichloropropene	ug/Kg	< 6.0	030810	5.952 EPA8260
Benzene	ug/Kg	< 6.0	030810	5.952 EPA8260
1,2 Dichloroethane	ug/Kg	< 6.0	030810	5.952 EPA8260
Trichloroethene	ug/Kg	< 6.0	030810	5.952 EPA8260
1,2 Dichloropropane	ug/Kg	< 6.0	030810	5.952 EPA8260
Dibromomethane	ug/Kg	< 6.0	030810	5.952 EPA8260
Bromodichloromethane	ug/Kg	< 6.0	030810	5.952 EPA8260
c-1,3Dichloropropene	ug/Kg	< 6.0	030810	5.952 EPA8260
Toluene	ug/Kg	< 6.0	030810	5.952 EPA8260

cc:

LRL=Laboratory Reporting Limit

REMARKS:

DIRECTOR



ECOTEST LABORATORIES, INC.

ENVIRONMENTAL TESTING

377 SHEFFIELD AVE. • N. BABYLON, N.Y. 11703 • (631) 422-5777 • FAX (631) 422-5770

Email: ecotestlab@aol.com Website: www.ecotestlabs.com

LAB NO.100901.06

03/17/10

C.A. Rich Consultants, Incorporated
17 Dupont Street
Plainview, NY 11803

ATTN: Eric Weinstock

PO#:

SOURCE OF SAMPLE: CDC

SOURCE OF SAMPLE:

COLLECTED BY: Client

DATE COL'D:03/04/10 RECEIVED:03/04/10

MATRIX:Soil

SAMPLE: PRB-99

Results reported on a dry weight basis

ANALYTICAL PARAMETERS	UNITS	RESULT	DATE TIME	FLAG OF ANALYSIS	LRL	METHOD
t-1,3Dichloropropene	ug/Kg	< 6.0	030810		5.952	EPA8260
112 Trichloroethane	ug/Kg	< 6.0	030810		5.952	EPA8260
Tetrachloroethene	ug/Kg	1400	030810		238.0	EPA8260
1,3-Dichloropropane	ug/Kg	< 6.0	030810		5.952	EPA8260
Chlorodibromomethane	ug/Kg	< 6.0	030810		5.952	EPA8260
1,2 Dibromoethane	ug/Kg	< 6.0	030810		5.952	EPA8260
Chlorobenzene	ug/Kg	< 6.0	030810		5.952	EPA8260
Ethyl Benzene	ug/Kg	< 6.0	030810		5.952	EPA8260
1112Tetrachloroethane	ug/Kg	< 6.0	030810		5.952	EPA8260
m + p Xylene	ug/Kg	< 12	030810		11.90	EPA8260
o Xylene	ug/Kg	< 6.0	030810		5.952	EPA8260
Styrene	ug/Kg	< 6.0	030810		5.952	EPA8260
Bromoform	ug/Kg	< 6.0	030810		5.952	EPA8260
Isopropylbenzene	ug/Kg	< 6.0	030810		5.952	EPA8260
Bromobenzene	ug/Kg	< 6.0	030810		5.952	EPA8260
1122Tetrachloroethane	ug/Kg	< 6.0	030810		5.952	EPA8260
123-Trichloropropane	ug/Kg	< 6.0	030810		5.952	EPA8260
n-Propylbenzene	ug/Kg	< 6.0	030810		5.952	EPA8260
2-Chlorotoluene	ug/Kg	< 6.0	030810		5.952	EPA8260
135-Trimethylbenzene	ug/Kg	< 6.0	030810		5.952	EPA8260
4-Chlorotoluene	ug/Kg	< 6.0	030810		5.952	EPA8260
tert-Butylbenzene	ug/Kg	< 6.0	030810		5.952	EPA8260
124-Trimethylbenzene	ug/Kg	< 6.0	030810		5.952	EPA8260
sec-Butylbenzene	ug/Kg	< 6.0	030810		5.952	EPA8260
p-Isopropyltoluene	ug/Kg	< 6.0	030810		5.952	EPA8260

cc:

LRL=Laboratory Reporting Limit

REMARKS:

DIRECTOR

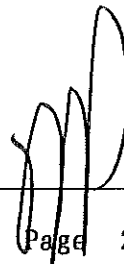

rn = 5165

NYSDOH ID # 10320

Page 2 of 3

ECOTEST LABORATORIES, INC.

ENVIRONMENTAL TESTING

377 SHEFFIELD AVE. • N. BABYLON, N.Y. 11703 • (631) 422-5777 • FAX (631) 422-5770

Email: ecotestlab@aol.com Website: www.ecotestlabs.com

LAB NO.100901.06

03/17/10

C.A. Rich Consultants, Incorporated
17 Dupont Street
Plainview, NY 11803

ATTN: Eric Weinstock

PO#:

SOURCE OF SAMPLE: CDC

SOURCE OF SAMPLE:

COLLECTED BY: Client

DATE COL'D:03/04/10 RECEIVED:03/04/10

MATRIX:Soil

SAMPLE: PRB-99

Results reported on a dry weight basis

ANALYTICAL PARAMETERS	UNITS	RESULT	DATE TIME	FLAG OF ANALYSIS	LRL	ANALYTICAL METHOD
1,3 Dichlorobenzene (v)	ug/Kg	< 6.0	030810		5.952	EPA8260
1,4 Dichlorobenzene (v)	ug/Kg	< 6.0	030810		5.952	EPA8260
n-Butylbenzene	ug/Kg	< 6.0	030810		5.952	EPA8260
1,2 Dichlorobenzene (v)	ug/Kg	< 6.0	030810		5.952	EPA8260
Dibromochloropropane	ug/Kg	< 6.0	030810		5.952	EPA8260
124-Trichlorobenzene (v)	ug/Kg	< 6.0	030810		5.952	EPA8260
Hexachlorobutadiene	ug/Kg	< 6.0	030810		5.952	EPA8260
Naphthalene(v)	ug/Kg	< 6.0	030810		5.952	EPA8260
123-Trichlorobenzene	ug/Kg	< 6.0	030810		5.952	EPA8260
ter. ButylMethylEther	ug/Kg	< 6.0	030810		5.952	EPA8260
p-Ethyltoluene	ug/Kg	< 6.0	030810		5.952	EPA8260
Freon 113	ug/Kg	< 6.0	030810		5.952	EPA8260
1245 Tetramethylbenz	ug/Kg	< 6.0	030810		5.952	EPA8260
Acetone	ug/Kg	< 60	030810		59.52	EPA8260
Methyl Ethyl Ketone	ug/Kg	< 60	030810		59.52	EPA8260
Methylisobutylketone	ug/Kg	< 60	030810		59.52	EPA8260
Chlorodifluoromethane	ug/Kg	< 6.0	030810		5.952	EPA8260
p Diethylbenzene	ug/Kg	< 6.0	030810		5.952	EPA8260
% Solids		84	030510		0.1	182540G

cc:

LRL=Laboratory Reporting Limit

REMARKS:

DIRECTOR

rn = 5166

NYSDOH ID # 10320

Page 3 of 3

ECOTEST LABORATORIES, INC.

ENVIRONMENTAL TESTING

377 SHEFFIELD AVE. • N. BABYLON, N.Y. 11703 • (631) 422-5777 • FAX (631) 422-5770

Email: ecotestlab@aol.com Website: www.ecotestlabs.com

LAB NO.100901.07

03/17/10

C.A. Rich Consultants, Incorporated
17 Dupont Street
Plainview, NY 11803

ATTN: Eric Weinstock

PO#:

SOURCE OF SAMPLE: CDC

SOURCE OF SAMPLE:

COLLECTED BY: Client

DATE COL'D:03/04/10 RECEIVED:03/04/10

MATRIX:Water SAMPLE: FB 3/4/10

ANALYTICAL PARAMETERS	UNITS	RESULT	DATE TIME	FLAG OF ANALYSIS	LRL	ANALYTICAL METHOD
Dichlorodifluoromethane	ug/L	< 1	030810		1	EPA8260
Chloromethane	ug/L	< 1	030810		1	EPA8260
Vinyl Chloride	ug/L	< 1	030810		1	EPA8260
Bromomethane	ug/L	< 1	030810		1	EPA8260
Chloroethane	ug/L	< 1	030810		1	EPA8260
Trichlorofluoromethane	ug/L	< 1	030810		1	EPA8260
1,1 Dichloroethene	ug/L	< 1	030810		1	EPA8260
Methylene Chloride	ug/L	< 1	030810		1	EPA8260
t-1,2-Dichloroethene	ug/L	< 1	030810		1	EPA8260
1,1 Dichloroethane	ug/L	< 1	030810		1	EPA8260
2,2-Dichloropropane	ug/L	< 1	030810		1	EPA8260
c-1,2-Dichloroethene	ug/L	< 1	030810		1	EPA8260
Bromochloromethane	ug/L	< 1	030810		1	EPA8260
Chloroform	ug/L	< 1	030810		1	EPA8260
111 Trichloroethane	ug/L	< 1	030810		1	EPA8260
Carbon Tetrachloride	ug/L	< 1	030810		1	EPA8260
1,1-Dichloropropene	ug/L	< 1	030810		1	EPA8260
Benzene	ug/L	< 1	030810		1	EPA8260
1,2 Dichloroethane	ug/L	< 1	030810		1	EPA8260
Trichloroethene	ug/L	< 1	030810		1	EPA8260
1,2 Dichloropropane	ug/L	< 1	030810		1	EPA8260
Dibromomethane	ug/L	< 1	030810		1	EPA8260
Bromodichloromethane	ug/L	< 1	030810		1	EPA8260
c-1,3Dichloropropene	ug/L	< 1	030810		1	EPA8260
Toluene	ug/L	< 1	030810		1	EPA8260

cc:

LRL=Laboratory Reporting Limit

REMARKS:

DIRECTOR

rn = 5167

NYSDOH ID # 10320

Page 1 of 3

ECOTEST LABORATORIES, INC.

ENVIRONMENTAL TESTING

377 SHEFFIELD AVE. • N. BABYLON, N.Y. 11703 • (631) 422-5777 • FAX (631) 422-5770

Email: ecotestlab@aol.com Website: www.ecotestlabs.com

LAB NO.100901.07

03/17/10

C.A. Rich Consultants, Incorporated
17 Dupont Street
Plainview, NY 11803

ATTN: Eric Weinstock

PO#:

SOURCE OF SAMPLE: CDC

SOURCE OF SAMPLE:

COLLECTED BY: Client

DATE COL'D:03/04/10 RECEIVED:03/04/10

MATRIX:Water SAMPLE: FB 3/4/10

ANALYTICAL PARAMETERS	UNITS	RESULT	DATE TIME FLAG OF ANALYSIS	LRL	ANALYTICAL METHOD
t-1,3Dichloropropene	ug/L	< 1	030810	1	EPA8260
112 Trichloroethane	ug/L	< 1	030810	1	EPA8260
Tetrachloroethene	ug/L	< 1	030810	1	EPA8260
1,3-Dichloropropane	ug/L	< 1	030810	1	EPA8260
Chlorodibromomethane	ug/L	< 1	030810	1	EPA8260
1,2 Dibromoethane	ug/L	< 1	030810	1	EPA8260
Chlorobenzene	ug/L	< 1	030810	1	EPA8260
Ethyl Benzene	ug/L	< 1	030810	1	EPA8260
1112Tetrachloroethane	ug/L	< 1	030810	1	EPA8260
m + p Xylene	ug/L	< 2	030810	2	EPA8260
o Xylene	ug/L	< 1	030810	1	EPA8260
Styrene	ug/L	< 1	030810	1	EPA8260
Bromoform	ug/L	< 1	030810	1	EPA8260
Isopropylbenzene	ug/L	< 1	030810	1	EPA8260
Bromobenzene	ug/L	< 1	030810	1	EPA8260
1122Tetrachloroethane	ug/L	< 1	030810	1	EPA8260
123-Trichloropropane	ug/L	< 1	030810	1	EPA8260
n-Propylbenzene	ug/L	< 1	030810	1	EPA8260
2-Chlorotoluene	ug/L	< 1	030810	1	EPA8260
135-Trimethylbenzene	ug/L	< 1	030810	1	EPA8260
4-Chlorotoluene	ug/L	< 1	030810	1	EPA8260
tert-Butylbenzene	ug/L	< 1	030810	1	EPA8260
124-Trimethylbenzene	ug/L	< 1	030810	1	EPA8260
sec-Butylbenzene	ug/L	< 1	030810	1	EPA8260
p-Isopropyltoluene	ug/L	< 1	030810	1	EPA8260

cc:

LRL=Laboratory Reporting Limit

REMARKS:

DIRECTOR

rn = 5168

NYSDOH ID # 10320

Page 2 of 3

377 SHEFFIELD AVE. • N. BABYLON, N.Y. 11703 • (631) 422-5777 • FAX (631) 422-5770

Email: ecotestlab@aol.com Website: www.ecotestlabs.com

LAB NO.100901.07

03/17/10

C.A. Rich Consultants, Incorporated
17 Dupont Street
Plainview, NY 11803

ATTN: Eric Weinstock

PO#:

SOURCE OF SAMPLE: CDC

SOURCE OF SAMPLE:

COLLECTED BY: Client

DATE COL'D:03/04/10 RECEIVED:03/04/10

MATRIX:Water SAMPLE: FB 3/4/10

ANALYTICAL PARAMETERS	UNITS	RESULT	DATE TIME FLAG OF ANALYSIS	LRL	ANALYTICAL METHOD
1,3 Dichlorobenzene (v)	ug/L	< 1	030810	1	EPA8260
1,4 Dichlorobenzene (v)	ug/L	< 1	030810	1	EPA8260
n-Butylbenzene	ug/L	< 1	030810	1	EPA8260
1,2 Dichlorobenzene (v)	ug/L	< 1	030810	1	EPA8260
Dibromochloropropane	ug/L	< 1	030810	1	EPA8260
124-Trichlorobenzene (v)	ug/L	< 1	030810	1	EPA8260
Hexachlorobutadiene	ug/L	< 1	030810	1	EPA8260
Naphthalene(v)	ug/L	< 1	030810	1	EPA8260
123-Trichlorobenzene	ug/L	< 1	030810	1	EPA8260
ter. ButylMethylEther	ug/L	< 1	030810	1	EPA8260
p-Ethyltoluene	ug/L	< 1	030810	1	EPA8260
Freon 113	ug/L	< 1	030810	1	EPA8260
1245 Tetramethylbenz	ug/L	< 1	030810	1	EPA8260
Acetone	ug/L	< 10	030810	10	EPA8260
Methyl Ethyl Ketone	ug/L	< 10	030810	10	EPA8260
Methylisobutylketone	ug/L	< 10	030810	10	EPA8260
Chlorodifluoromethane	ug/L	< 1	030810	1	EPA8260
p Diethylbenzene	ug/L	< 1	030810	1	EPA8260

cc:

LRL=Laboratory Reporting Limit

REMARKS:

DIRECTOR

ECOTEST LABORATORIES, INC.

ENVIRONMENTAL TESTING

377 SHEFFIELD AVE. • N. BABYLON, N.Y. 11703 • (631) 422-5777 • FAX (631) 422-5770

Email: ecotestlab@aol.com Website: www.ecotestlabs.com

LAB NO.100901.08

03/17/10

C.A. Rich Consultants, Incorporated
17 Dupont Street
Plainview, NY 11803

ATTN: Eric Weinstock

PO#:

SOURCE OF SAMPLE: CDC

SOURCE OF SAMPLE:

COLLECTED BY: Client DATE COL'D:03/04/10 RECEIVED:03/04/10

MATRIX:Water SAMPLE: TB 3/4/10

ANALYTICAL PARAMETERS	UNITS	RESULT	DATE TIME FLAG OF ANALYSIS	LRL	ANALYTICAL METHOD
Dichlorodifluoromethane	ug/L	< 1	030810	1	EPA8260
Chloromethane	ug/L	< 1	030810	1	EPA8260
Vinyl Chloride	ug/L	< 1	030810	1	EPA8260
Bromomethane	ug/L	< 1	030810	1	EPA8260
Chloroethane	ug/L	< 1	030810	1	EPA8260
Trichlorofluoromethane	ug/L	< 1	030810	1	EPA8260
1,1 Dichloroethene	ug/L	< 1	030810	1	EPA8260
Methylene Chloride	ug/L	< 1	030810	1	EPA8260
t-1,2-Dichloroethene	ug/L	< 1	030810	1	EPA8260
1,1 Dichloroethane	ug/L	< 1	030810	1	EPA8260
2,2-Dichloropropane	ug/L	< 1	030810	1	EPA8260
c-1,2-Dichloroethene	ug/L	< 1	030810	1	EPA8260
Bromochloromethane	ug/L	< 1	030810	1	EPA8260
Chloroform	ug/L	< 1	030810	1	EPA8260
111 Trichloroethane	ug/L	< 1	030810	1	EPA8260
Carbon Tetrachloride	ug/L	< 1	030810	1	EPA8260
1,1-Dichloropropene	ug/L	< 1	030810	1	EPA8260
Benzene	ug/L	< 1	030810	1	EPA8260
1,2 Dichloroethane	ug/L	< 1	030810	1	EPA8260
Trichloroethene	ug/L	< 1	030810	1	EPA8260
1,2 Dichloropropane	ug/L	< 1	030810	1	EPA8260
Dibromomethane	ug/L	< 1	030810	1	EPA8260
Bromodichloromethane	ug/L	< 1	030810	1	EPA8260
c-1,3Dichloropropene	ug/L	< 1	030810	1	EPA8260
Toluene	ug/L	< 1	030810	1	EPA8260

cc:

LRL=Laboratory Reporting Limit

REMARKS:

DIRECTOR

rn = 5170

NYSDOH ID # 10320

Page 1 of 3

ECOTEST LABORATORIES, INC.

ENVIRONMENTAL TESTING

377 SHEFFIELD AVE. • N. BABYLON, N.Y. 11703 • (631) 422-5777 • FAX (631) 422-5770

Email: ecotestlab@aol.com Website: www.ecotestlabs.com

LAB NO.100901.08

03/17/10

C.A. Rich Consultants, Incorporated
17 Dupont Street
Plainview, NY 11803

ATTN: Eric Weinstock

PO#:

SOURCE OF SAMPLE: CDC

SOURCE OF SAMPLE:

COLLECTED BY: Client

DATE COL'D:03/04/10 RECEIVED:03/04/10

MATRIX:Water SAMPLE: TB 3/4/10

ANALYTICAL PARAMETERS	UNITS	RESULT	DATE TIME	FLAG OF ANALYSIS	LRL	ANALYTICAL METHOD
t-1,3Dichloropropene	ug/L	< 1	030810		1	EPA8260
112 Trichloroethane	ug/L	< 1	030810		1	EPA8260
Tetrachloroethene	ug/L	< 1	030810		1	EPA8260
1,3-Dichloropropane	ug/L	< 1	030810		1	EPA8260
Chlorodibromomethane	ug/L	< 1	030810		1	EPA8260
1,2 Dibromoethane	ug/L	< 1	030810		1	EPA8260
Chlorobenzene	ug/L	< 1	030810		1	EPA8260
Ethyl Benzene	ug/L	< 1	030810		1	EPA8260
1112Tetrachloroethane	ug/L	< 1	030810		1	EPA8260
m + p Xylene	ug/L	< 2	030810		2	EPA8260
o Xylene	ug/L	< 1	030810		1	EPA8260
Styrene	ug/L	< 1	030810		1	EPA8260
Bromoform	ug/L	< 1	030810		1	EPA8260
Isopropylbenzene	ug/L	< 1	030810		1	EPA8260
Bromobenzene	ug/L	< 1	030810		1	EPA8260
1122Tetrachloroethane	ug/L	< 1	030810		1	EPA8260
123-Trichloropropane	ug/L	< 1	030810		1	EPA8260
n-Propylbenzene	ug/L	< 1	030810		1	EPA8260
2-Chlorotoluene	ug/L	< 1	030810		1	EPA8260
135-Trimethylbenzene	ug/L	< 1	030810		1	EPA8260
4-Chlorotoluene	ug/L	< 1	030810		1	EPA8260
tert-Butylbenzene	ug/L	< 1	030810		1	EPA8260
124-Trimethylbenzene	ug/L	< 1	030810		1	EPA8260
sec-Butylbenzene	ug/L	< 1	030810		1	EPA8260
p-Isopropyltoluene	ug/L	< 1	030810		1	EPA8260

cc:

LRL=Laboratory Reporting Limit

REMARKS:

DIRECTOR

rn = 5171

NYSDOH ID # 10320

Page 2 of 3

Analytical results relate to the samples as received by the laboratory.

ECOTEST LABORATORIES, INC.

ENVIRONMENTAL TESTING

377 SHEFFIELD AVE. • N. BABYLON, N.Y. 11703 • (631) 422-5777 • FAX (631) 422-5770

Email: ecotestlab@aol.com Website: www.ecotestlabs.com

LAB NO.100901.08

03/17/10

C.A. Rich Consultants, Incorporated
17 Dupont Street
Plainview, NY 11803

ATTN: Eric Weinstock

PO#:

SOURCE OF SAMPLE: CDC

SOURCE OF SAMPLE:

COLLECTED BY: Client

DATE COL'D:03/04/10 RECEIVED:03/04/10

MATRIX:Water SAMPLE: TB 3/4/10

ANALYTICAL PARAMETERS	UNITS	RESULT	DATE TIME FLAG OF ANALYSIS	LRL	ANALYTICAL METHOD
1,3 Dichlorobenzene (v)	ug/L	< 1	030810	1	EPA8260
1,4 Dichlorobenzene (v)	ug/L	< 1	030810	1	EPA8260
n-Butylbenzene	ug/L	< 1	030810	1	EPA8260
1,2 Dichlorobenzene (v)	ug/L	< 1	030810	1	EPA8260
Dibromochloropropane	ug/L	< 1	030810	1	EPA8260
124-Trichlorobenzene (v)	ug/L	< 1	030810	1	EPA8260
Hexachlorobutadiene	ug/L	< 1	030810	1	EPA8260
Naphthalene(v)	ug/L	< 1	030810	1	EPA8260
123-Trichlorobenzene	ug/L	< 1	030810	1	EPA8260
ter. ButylMethylEther	ug/L	< 1	030810	1	EPA8260
p-Ethyltoluene	ug/L	< 1	030810	1	EPA8260
Freon 113	ug/L	< 1	030810	1	EPA8260
1245 Tetramethylbenz	ug/L	< 1	030810	1	EPA8260
Acetone	ug/L	< 10	030810	10	EPA8260
Methyl Ethyl Ketone	ug/L	< 10	030810	10	EPA8260
Methylisobutylketone	ug/L	< 10	030810	10	EPA8260
Chlorodifluoromethane	ug/L	< 1	030810	1	EPA8260
p Diethylbenzene	ug/L	< 1	030810	1	EPA8260

cc:

LRL=Laboratory Reporting Limit

REMARKS:

DIRECTOR

rn = 5172

NYSDOH ID # 10320

Page 3 of 3

ECO TEST LABORATORIES, INC. • ENVIRONMENTAL TESTING
377 Sheffield Avenue, North Babylon, New York 11703
(631) 422-5777 • FAX (631) 422-5770 • Email: ecotestlab@aol.com

Client:	CA Rich Consultants Inc
Address:	17 August St
	Plainville NY 11803
Phone:	516 576 8844
FAX:	516 576 0093
Person receiving report:	Epic Weinstock
Sampled by:	M. Yager
Source:	CDC
Job No.:	

[illegible]

109901

[illegible]

Appendix B Boring Log

CA RICH Consultants, Inc.

Environmental Specialists

17 Dupont Street, Plainview, NY 11803

FIELD BORING LOG

BOREHOLE NO.: **PRB-1A**

TOTAL DEPTH: **16'**

PROJECT INFORMATION

PROJECT: **CDC**
SITE LOCATION: **Great Neck, NY**
JOB NO.: **CDC/FF**
LOGGED BY: **Michael Yager**
PROJECT MANAGER: **Eric Weinstock**
DATES DRILLED: **3-04-10**

DRILLING INFORMATION

DRILLING CO.: **Eastern Environmental**
DRILLER: **Eddie Gallo**
RIG TYPE: **Geoprobe 6010**
METHOD OF DRILLING: **Direct Push**
SAMPLING METHODS: **Macrocores**
HAMMER WT./DROP **N/A**

☞ Water level in boring

DEPTH	SOIL TYPE	SOIL DESCRIPTION	COMMENTS	SAMPLE	Blows per ft.	PID ppm
0		Medium/course brown sand				
		Wet fine/medium silty/clayey tan/brown sand			Push	36.6
5		Wet/saturated medium/fine brown sand with some silt and gravel	Core sample was wet/saturated from 4' to 7' below grade	PRB-1A (4-6)		87
		Banded medium/coarse brown sand with some gravel			Push	86
10		Medium brown sand	Core sample was dry from 8' to 16' below grade	PRB-1A (8-10)		0.2
		medium brown/tan sand			Push	0.0
		medium brown/tan sand				0.1
15		Coarse/medium brown/tan sand and gravel		PRB-1A (14-16)	Push	0.2

NOTES: