

SITE # 130073A
SPRAGUE GOODMAN
ELECTRIC



Department of Environmental Conservation
Division of Environmental Remediation

Bureau of Hazardous Site Control

HSO

**Decision Declaration
Suspending Investigation of
Potential Site:**

Sprague Goodman Electronics

North Hempstead, Nassau County

Site Number 1-30-073A

June 2000

Declaration of Decision

**"Sprague Goodman Electronics" Inactive Hazardous Waste Site
North Hempstead, Nassau County, New York
Site No. >130073A<**

Information gathered as the result of the investigation carried out by this Department at the Site to determine if disposal of a consequential amount of hazardous waste or substances has occurred, (as defined by NYCRR Part 371 and CERCLA) has resulted in our concluding that: (checked paragraphs apply)

- ☒ [X] a consequential amount of hazardous waste was not disposed at this site
- ☐ [] the source of the documented environmental contamination was not found
- ☐ [] a consequential amount of hazardous waste was disposed at this site, but future site activities will be administered through the Voluntary Cleanup Program

Based on the results of the site investigations, balanced against the criteria identified for evaluation of sites, we have determined that further investigation is not warranted. The Bureau of Hazardous Site Control will continue to keep track of this site and may rescind this declaration at any time, based upon discovery of new information which would warrant further investigation of the site.

The Bureau's Site Administrative Record shall be converted to microfilm and archived according to New York State Archives and Records Administration State Government Records Program Retention and Disposition Authorization # 19375, "Inactive Hazardous Waste Site Project Files."

June 21, 2000
Date

Hayden Brewster
> Hayden Brewster <
Project Manager

New York State Department of Environmental Conservation
50 Wolf Road, Albany, New York 12233

AUG 26 1996

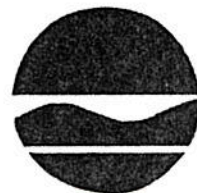

Michael D. Zagata
Commissioner

Jack & Claire Goodman
Sprague Goodman Electronics
1700 Shames Drive
Westbury, New York 11590

Dear Mr. & Mrs. Goodman:

Re: Preliminary Site Assessment (PSA) Report

The New York State Department of Environmental Conservation, as required by Chapter 857 of the Laws of 1982 (commonly known as the "New York Superfund Law"), is conducting field investigations of disposal sites, throughout the State, suspected or known to contain hazardous waste.

Our present records indicate that you are one of the owners and/or operators of property within the following site:

Site Name: Sprague-Goodman Electronics, ID #130073A
Site Address: 134 Fulton Avenue

Enclosed for your records is a copy of the final PSA report for the multi-site investigation in the Garden City Park Industrial Area, which encompasses the above-referenced site.

If you have any questions in connection with this matter, please contact Mr. John Swartwout, of my staff, at (518) 457-0639.

Sincerely,

for Earl H. Barcomb, P.E.
Director
Bureau of Hazardous Site Control
Division of Environmental Remediation

Enclosure

bcc: J. Swartwout to
H. Brewster
File

HB/hb



STATE OF NEW YORK DEPARTMENT OF HEALTH

Office of Public Health

11 University Place Albany, New York 12203-3399

Barbara A. DeBuono, M.D., M.P.H.
Commissioner

Karen Schimke
Executive Deputy Commissioner

March 29, 1996

Mr. Hayden Brewster
Bureau of Hazardous Site Control
NYS Department of Environmental Conservation
50 Wolf Road
Albany, New York 12233

RE: Sprague Goodman and
Related sites
Site I.D.# 130073A to D
Garden City/Nassau County

Dear Mr. Brewster:

I have reviewed the Preliminary Site Assessment Report for the Sprague Goodman, Joseph Struhl Company, Precision Fabricators and Mercury Electric sites in Garden City Park, Nassau County.

Based on the groundwater data collected in April 1994 and September 1995 there appears to be sufficient evidence to suggest that Sprague Goodman and Precision Fabricators (both documented users of 1,1,1-trichloroethane 1,1,1-TCA") have contributed to groundwater contamination of 1,1,1-TCA. There also appears to be a slight indication, based on the data, that Mercury Electric (a documented user of trichloroethene TCE") contributed to the TCE contamination in groundwater downgradient of its facility.

Even though Joseph Struhl used 1,1,1-TCA in its past operations, it is difficult to determine whether the Joseph Struhl Company released 1,1,1-TCA to the groundwater. Geoprobe (GP) locations GP-10, GP-24 and GP-40, all upgradient of Joseph Struhl, had 1,1,1-TCA at 42, 160 and 63 parts per billion respectively. These three locations are directly down gradient of 150 Fulton Avenue - the suspected major contributor to groundwater contamination with perchloroethene (PCE), and TCE. To clarify this, the report should state whether 150 Fulton Avenue used 1,1,1-TCA in the past.

Additionally, I feel that all 4 sites should be subject to further investigation to identify the sources of the groundwater contamination confirmed at each location.



**Dvirka
and
Bartilucci**

CONSULTING ENGINEERS

330 Crossways Park Drive, Woodbury, New York, 11797-2015
516-364-9890 • 718-460-3634 • Fax: 516-364-9045

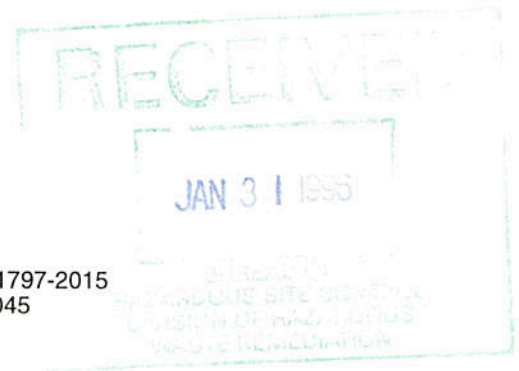

January 29, 1996

Mr. Hayden Brewster
Bureau of Hazardous Site Control
NYSEC
50 Wolf Road
Albany, NY 12233-7010

Re: Precision Fabricators
D&B No. 1339 3C

Dear Mr. Brewster:

As per our telephone conversation on January 24, 1996, you have agreed to our recommendations for the need for the additional work at and just upgradient of the former Precision Fabricators facility. We feel that the following work will be the remaining work required to finalize the preliminary site assessment for the site:

- Collection of one soil/sediment sample from the dry well located at 246 Broadway. The sample will be analyzed for volatile organics by 601.
- Closed circuit television inspection of one or possibly two roof drain lines to locate on-site dry wells.
- If the dry wells are located, construction of up to four geoprobe points with combined soil and groundwater sampling. In addition to the dry wells, one geoprobe point would be constructed in the "pit", allegedly used to collect storm water runoff from the street, located within the loading dock of the building.

The additional work completed to date for the Precision Fabricators Site combined with the additional work discussed above will create an exceedance of the budget provided in the Work Assignment for the Precision Fabricators Site. We do not, however, anticipate an overage for the entire Work Assignment.

Mr. Hayden Brewster
NYSEC
January 29, 1996

Page Two

We recommend not preparing an addendum to the Work Assignment to reallocate costs at this time. Instead, we recommend preparing the addendum at the completion of the project, if necessary.

Please contact me if you have any comments or questions at 516-364-9890.

Very truly yours,

A handwritten signature in blue ink that reads "Maria Wright". The signature is written in a cursive style with a large, stylized "M" and "W".

Maria Wright

MW/pd
▲1339\MW96-03.LTR



**Dvirka
and
Bartilucci**
CONSULTING ENGINEERS

6800 Jericho Turnpike, Syosset, New York 11791
516-364-9892 • Fax: 516-364-9045

December 15, 1995

Mr. John Swartwout
Bureau of Hazardous Site Control
New York State Department of
Environmental Conservation
50 Wolf Road
Albany, NY 12233-7010

Re: Precision Fabricators
D&B No. 1339 3B

Dear Mr. Swartwout :

As you are aware, we recently completed an additional facility inspection of the former Precision Fabricators, Inc. building. During the inspection, we noted the presence of at least one roof drain that had been cut off and capped at the floor level with a screw cap.

Based upon our experience with the 150 Fulton Avenue facility, and the elevated levels of 1,1,1 trichloroethane detected in the vicinity of the building, we recommend that a closed circuit television inspection be conducted on the line in order to locate the dry well previously used for discharge of roof water.

As you are aware, the cost for Pengat Contracting Corp. is approximately \$1,800 per day. We have demonstrated that this cost is reasonable in previous correspondence sent to you for the 150 Fulton Avenue facility, and therefore request your approval to have Pengat perform the inspection in the near future. We estimate that the closed circuit television inspection will likely take one day. However, there may be a second capped drain that we would like to inspect. Therefore a total of two days may be required for a total of \$3,600. Once the dry well has been located, we recommend collecting samples from or immediately adjacent to the dry well using the Geoprobe.

In addition, due to the elevated level of TCA detected in GP-102, located in the southern parking area of 246 Broadway, we recommend that an investigation of this facility be conducted. We have contacted Nassau County Department of Health to inquire if they have any files on the facility and will make any arrangements necessary to review the files. We will also try to utilize the magnetic locator to identify any underground structures that may be a source of the contamination.

use magnetic locator first. Done.

Mr. John Swartwout
Bureau of Hazardous Site Control
New York State Department of
Environmental Conservation
December 15, 1995

Page 2

Based upon the field work we completed to date at the Precision Fabricators facility, the budget for this site is nearly expended. However, there are sufficient funds available in the Mercury Electric task to cover the costs for the additional work. Therefore, we recommend preparing an addendum to the existing Project Management Work Plan in order to reallocate monies for completing the additional work.

If you have any comments or questions, please do not hesitate to contact me at (516) 364-9892.

Very truly yours,

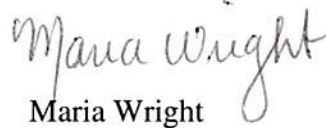

Maria Wright

MW/ss
▲1339/MW12125.JS

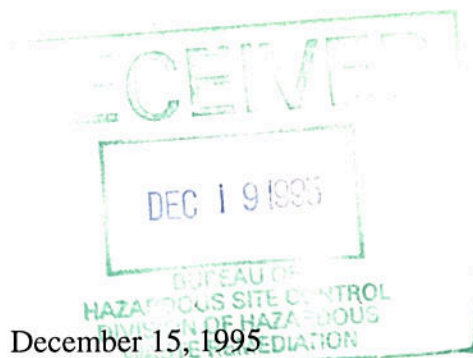

**Dvirka
and
Bartilucci**
CONSULTING ENGINEERS

6800 Jericho Turnpike, Syosset, New York 11791
516-364-9892 • Fax: 516-364-9045



Mr. John Swartwout
Bureau of Hazardous Site Control
New York State Department of
Environmental Conservation
50 Wolf Road
Albany, NY 12233-7010

Re: Sprague Goodman and
Related Sites 1339-1C, 2C, 3C, 4C

130073(A-D)

Dear Mr. Swartwout :

Recently, we have discussed with you our concerns with regard to the results of groundwater analysis on samples collected using the geoprobe as compared to samples collected from monitoring wells. Information obtained from samples collected in the Garden City Park Industrial Area indicated there could possibly be discrepancies between the two sampling techniques, significant enough to warrant further evaluation.

Based upon this concern, we would like to obtain data to assess any potential discrepancies. This would allow us to present the results of the geoprobe and monitoring well groundwater sampling appropriately. We recommend selecting four monitoring wells in the industrial park that have exhibited varying concentrations of volatile organic compounds (i.e. high, medium and low levels) and constructing a geoprobe point immediately adjacent to the well. The groundwater sample would be collected from the center of the screened interval. Once the geoprobe sample is collected, a groundwater sample would then be collected from the monitoring well. Each of the samples would be analyzed for volatile organic compounds in the same laboratory.

The results of this study will aid in interpreting the results of geoprobe versus monitoring well sample results for this project as well as future projects.

Please contact us to discuss this matter further.

Very truly yours,

Maria Wright
Maria Wright

MW/ss
▲1339/MW12135.JS

Informed Maria by phone on 2 Jan 96 that we had discussed this proposal and do not have a level of concern over this issue great enough for us to want to pay for a study as they have suggested JSS

New York State Department of Environmental Conservation
50 Wolf Road, Albany, New York 12233-1010



CERTIFIED MAIL
RETURN RECEIPT REQUESTED

Mr. Cliff Struhl
Joharri Realty Corp.
c/o Joseph Struhl Company
195 Atlantic Avenue
Garden City Park, NY 11040

Dear Mr. Struhl:

Re: Site Access: Sprague-Goodman Electronic & Related
Sites, Site ID #s: 130073 (A-D)

The New York State Department of Environmental Conservation is requesting your assistance. The Department is performing a Preliminary Site Assessment (PSA) at the above-referenced sites located in the Town of North Hempstead. The purpose of the PSA is to determine if the areas in question are part of inactive hazardous waste disposal sites. As requested, I've enclosed a copy of our most recent fact sheet on this investigation.

Our records indicate that you are the owner of property located near these sites identified on the County of Nassau Tax Map as: Garden City Park, Section 33, Block 151, Lot 373. Environmental Conservation Law Section 27-1309.3 and Section 1313.8 authorizes the Department or its authorized agents to enter upon any inactive hazardous waste disposal site and areas near such site for purpose of sampling and testing, remediation and temporary occupancy.

The Department requests your cooperation in entering upon your real property, above specified, at any time after receipt of this letter, for the purpose of conducting the PSA. Our consultant, Dvirka and Bartilucci, will contact you with the exact date and time. This will involve inspecting the premises and taking samples at and near the sites. In order to take such samples, the NYSDEC may use or cause to be used such sampling methods as it determines to be necessary. At this time, we plan to use geoprobes to sample the groundwater. The enclosed map shows the proposed locations.

We also request that you provide in accordance with the Environmental Conservation Law (ECL) Section 27-1307, all currently available information which would help in our investigation work.

This is not a notice that the Department intends to acquire the above-specified property nor is it an offer to acquire it.

The Department will make every reasonable effort to cooperate with you so that any adverse impact of its entry on and occupancy of your property will be minimized. Accordingly, the Department will pay the cost of the work to be conducted on your property.

Any questions or concerns about the Department's operations on your property should be directed to Mr. John Swartwout, P.E., Chief, Eastern Investigation Section at (518) 457-0639.

Sincerely,

A handwritten signature in dark ink, appearing to read "Earl H. Barcomb", is written over a faint, larger signature that also appears to read "Earl H. Barcomb".

Earl H. Barcomb, P.E.
Director
Bureau of Hazardous Site Control
Division of Hazardous Waste Remediation

bcc: R. Dana
A. Shah
J. Swartwout to
H. Brewster
file

HB/ma



NEW YORK STATE DEPARTMENT OF ENVIRONMENTAL CONSERVATION
50 Wolf Road, Albany, New York 12233

SEP 18 1995

Michael D. Zagata
Commissioner

CERTIFIED MAIL
RETURN RECEIPT REQUESTED

Mr. Fred Konigsberg
Feldman Wood Products
1 Herricks Road
Garden City, NY 11530

Dear Mr. Konigsberg:

Re: Site Access: Sprague-Goodman Electronic & Related
Sites, Site ID #s: 130073 (A-D)

The New York State Department of Environmental Conservation is requesting your assistance. The Department is performing a Preliminary Site Assessment (PSA) at the above-referenced sites located in the Town of North Hempstead. The purpose of the PSA is to determine if the areas in question are part of inactive hazardous waste disposal sites.

Our records indicate that you are the owner of property located near these sites identified on the County of Nassau Tax Map as: Garden City Park, Section 33, Block 151, Lots 375-376. Environmental Conservation Law Section 27-1309.3 and Section 1313.8 authorizes the Department or its authorized agents to enter upon any inactive hazardous waste disposal site and areas near such site for purpose of sampling and testing, remediation and temporary occupancy.

The Department requests your cooperation in entering upon your real property, above specified, at any time after receipt of this letter, for the purpose of conducting the PSA. Our consultant, Dvirka and Bartilucci, will contact you with the exact date and time. This will involve inspecting the premises and taking samples at and near the sites. In order to take such samples, the NYSDEC may use or cause to be used such sampling methods as it determines to be necessary. We plan to use geoprobes to sample the groundwater. The enclosed map shows the proposed locations.

We also request that you provide in accordance with the Environmental Conservation Law (ECL) Section 27-1307, all currently available information which would help in our investigation work.

This is not a notice that the Department intends to acquire the above-specified property nor is it an offer to acquire it.

The Department will make every reasonable effort to cooperate with you so that any adverse impact of its entry on and occupancy of your property will be minimized. Accordingly, the Department will pay the cost of the work to be conducted on your property.

Any questions or concerns about the Department's operations on your property should be directed to Mr. John Swartwout, P.E., Chief, Eastern Investigation Section at (518) 457-0639.

Sincerely,

Earl H. Barcomb, P.E.
Director
Bureau of Hazardous Site Control
Division of Hazardous Waste Remediation

bcc: R. Dana
A. Shah
J. Swartwout to
H. Brewster
file

HB/ma

NEW YORK STATE DEPARTMENT OF ENVIRONMENTAL CONSERVATION
50 Wolf Road, Albany, New York 12233



Michael D. Zagata
Commissioner

SEP 12 1995

CERTIFIED MAIL
RETURN RECEIPT REQUESTED

Mr. Jefry Rosmarin
P.O. Box 30
Syosset, New York 11791

Dear Mr. Rosmarin:

Re: Site Access: Sprague-Goodman Electronic & Related
Sites, Site ID #s: 130073 (A-D)

The New York State Department of Environmental Conservation is requesting your assistance. The Department is performing a Preliminary Site Assessment (PSA) at the above-referenced sites located in the Town of North Hempstead. The purpose of the PSA is to determine if the areas in question are part of inactive hazardous waste disposal sites.

Our records indicate that you are the owner of property located near these sites identified on the County of Nassau Tax Map as: Garden City Park, Section 33, Block 151, Lots 375-376. Environmental Conservation Law Section 27-1309.3 and Section 1313.8 authorizes the Department or its authorized agents to enter upon any inactive hazardous waste disposal site and areas near such site for purpose of sampling and testing, remediation and temporary occupancy.

The Department requests your cooperation in entering upon your real property, above specified, at any time after receipt of this letter, for the purpose of conducting the PSA. Our consultant, Dvirka and Bartilucci, will contact you with the exact date and time. This will involve inspecting the premises and taking samples at and near the sites. In order to take such samples, the NYSDEC may use or cause to be used such sampling methods as it determines to be necessary. We plan to use geoprobes to sample the groundwater. The enclosed map shows the proposed locations.

We also request that you provide in accordance with the Environmental Conservation Law (ECL) Section 27-1307, all currently available information which would help in our investigation work.

This is not a notice that the Department intends to acquire the above-specified property nor is it an offer to acquire it.

The Department will make every reasonable effort to cooperate with you so that any adverse impact of its entry on and occupancy of your property will be minimized. Accordingly, the Department will pay the cost of the work to be conducted on your property.

Any questions or concerns about the Department's operations on your property should be directed to Mr. John Swartwout, P.E., Chief, Eastern Investigation Section at (518) 457-0639.

Sincerely,

A handwritten signature in dark ink, appearing to read "Earl H. Barcomb".

Earl H. Barcomb, P.E.

Director

Bureau of Hazardous Site Control

Division of Hazardous Waste Remediation

bcc: R. Dana
A. Shah
J. Swartwout to
H. Brewster
file

HB/ck

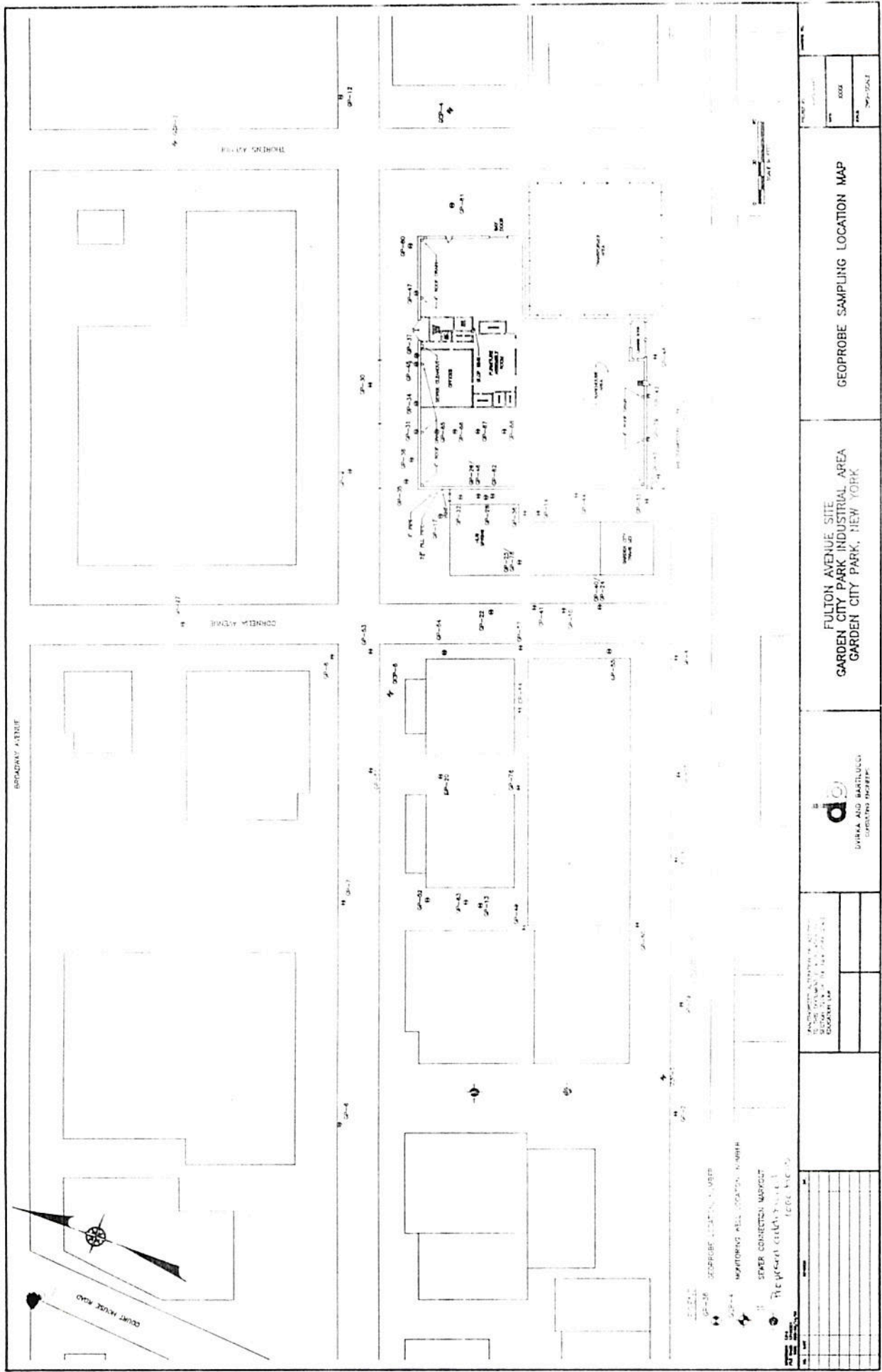

NEW YORK STATE DEPARTMENT OF ENVIRONMENTAL CONSERVATION
50 Wolf Road, Albany, New York 12233



Michael D. Zagata
Commissioner

SEP 12 1995

CERTIFIED MAIL
RETURN RECEIPT REQUESTED

V. Muran
Muran International Corp.
200 Armstrong Road
Garden City Park, NY 11040

Dear Mr. Muran:

Re: Sprague-Goodman Electronic Sites PSA
Site ID's: 130073 (A-D)

The New York State Department of Environmental Conservation is requesting your assistance. The Department is preparing to perform a Preliminary Site Assessment (PSA) at the above-referenced sites located in the Town of North Hempstead. The purpose of the PSA is to determine if the areas in question are part of inactive hazardous waste disposal sites.

Our records indicate that you are the owner of property located near these sites identified on the County of Nassau Tax Map as: Garden City Park, Section 33, Block 167, Lot 419. Environmental Conservation Law Section 27-1309.3 and Section 1313.8 authorizes the Department or its authorized agents to enter upon any inactive hazardous waste disposal site and areas near such site for purpose of sampling and testing, remediation and temporary occupancy.

The Department requests your cooperation in entering upon your real property, above specified at any time after receipt of this letter, for the purpose of conducting the PSA. Our consultant, Dvirka and Bartilucci, will contact you with the exact date and time. This will involve inspecting the premises and taking samples at and near the sites. In order to take such samples, the NYSDEC may use or cause to be used such sampling methods as it determines to be necessary. At this time, we plan to use geoprobes to sample the groundwater. The enclosed map shows the proposed locations.

We also request that you provide, in accordance with the Environmental Conservation Law (ECL) Section 27-1307, all currently available information which would help in our investigation work.

This is not a notice that the Department intends to acquire the above-specified property, nor is it an offer to acquire it.

The Department will make every reasonable effort to cooperate with you so that any adverse impact of its entry on and occupancy of your property will be minimized. Accordingly, the Department will pay the cost of the work to be conducted on your property.

Any questions or concerns about the Department's operations on your property should be directed to Mr. John Swartwout, P.E., Chief, Eastern Investigation Section at (518) 457-0639.

Sincerely,

A handwritten signature in black ink, appearing to read "Earl H. Barcomb", written in a cursive style.

Earl H. Barcomb, P.E.

Director

Bureau of Hazardous Site Control

Division of Hazardous Waste Remediation

bcc: R. Dana
A. Shah
J. Swartwout to
H. Brewster
file

HB/ck

NEW YORK STATE DEPARTMENT OF ENVIRONMENTAL CONSERVATION
50 Wolf Road, Albany, New York 12233



Michael D. Zagata
Commissioner

SEP 12 1995

CERTIFIED MAIL
RETURN RECEIPT REQUESTED

Harold Kaufman
Rose Tulip Realty
PO Box 609
125 Long Avenue
Hillside, NJ 07205

Dear Mr. Kaufman:

Re: Site Access: Sprague-Goodman Electronic & Related
Sites, Site ID #s: 130073 (A-D)

The New York State Department of Environmental Conservation is requesting your assistance. The Department is performing a Preliminary Site Assessment (PSA) at the above-referenced sites located in the Town of North Hempstead. The purpose of the PSA is to determine if the areas in question are part of inactive hazardous waste disposal sites. As requested, I've enclosed a copy of our most recent fact sheet on this investigation.

Our records indicate that you are the owner of property located near these sites identified on the County of Nassau Tax Map as: Garden City Park, Section 33, Block 177, Lots 11-16, 34 & 46. Environmental Conservation Law Section 27-1309.3 and Section 1313.8 authorizes the Department or its authorized agents to enter upon any inactive hazardous waste disposal site and areas near such site for purpose of sampling and testing, remediation and temporary occupancy.

The Department requests your cooperation in entering upon your real property, above specified, at any time after receipt of this letter, for the purpose of conducting the PSA. Our consultant, Dvirka and Bartilucci, will contact you with the exact date and time. This will involve inspecting the premises and taking samples at and near the sites. In order to take such samples, the NYSDEC may use or cause to be used such sampling methods as it determines to be necessary. We plan to use geoprobes to sample the groundwater. The enclosed map shows the proposed locations.

We also request that you provide in accordance with the Environmental Conservation Law (ECL) Section 27-1307, all currently available information which would help in our investigation work.

This is not a notice that the Department intends to acquire the above-specified property nor is it an offer to acquire it.

The Department will make every reasonable effort to cooperate with you so that any adverse impact of its entry on and occupancy of your property will be minimized. Accordingly, the Department will pay the cost of the work to be conducted on your property.

Any questions or concerns about the Department's operations on your property should be directed to Mr. John Swartwout, P.E., Chief, Eastern Investigation Section at (518) 457-0639.

Sincerely,

A handwritten signature in black ink, appearing to read "Earl H. Barcomb", with a stylized flourish at the end.

Earl H. Barcomb, P.E.

Director

Bureau of Hazardous Site Control

Division of Hazardous Waste Remediation

bcc: R. Dana
A. Shah
J. Swartwout to
H. Brewster
file

HB/ck



file

MAY 11 1995

Michael Zagata
Commissioner

Ms. Maria Wright
Dvirka and Bartilucci
6800 Jericho Turnpike
Syosset, New York 11791

Dear Ms. Wright:

Re: State Superfund Standby Contract
WA #D002708-21; Site ID #'s 130073 (A, B, C, D)
Sprague-Goodman Electronics and Related Sites
Draft Work Plan

The above-referenced document was reviewed in conjunction with the Nassau County Department of Health (NCDH), the NYS Department of Health (NYSDOH), our Regional Office, as well as our Quality Assurance Section. We offer the following combined comments:

- The NCDH would like Figure 2-1 to be updated to reflect current information. For example, Winthrop University Hospital has replaced Nassau Hospital. If this is possible, please comply. Otherwise, the date of the map should be inserted.
- Page 2-5 and Section 3.3.2 of the Health and Safety Plan: In correspondence to this Division, Joseph Struhl claims they no longer use 1,1,1-TCA and only used 15-20 gallons/year prior to 1991. If this is so, then most of the 200 gallons of cleaning solvent is another chemical. Please state the source of this information and amend the discussion to account for Joseph Struhl's statement.
- Page 3-4, Table 3-1 etc.: NCDH would like some clarification on the "Subsurface Soil Geoprobe Sampling." Will the soil samples be collected during the Geoprobe Survey or afterwards by new probe installation?
- Page 5-3, Section 5.2.2.1: NCDH is confused about the statement that "approximately 5 surface and/or subsurface soil samples will be collected..." since the title of the section is Subsurface Soil Sampling. Also, if known, the expected sample depth should be stated.

- Both the NYSDOH and our regional office believe there should be more emphasis on investigating the soil quality in attempting to locate the source(s) of contamination. In fact, the region believes we should eliminate any water sampling at this time and in lieu of this begin with a program of shallow soil gas testing, followed by soil analysis. The DOH simply favors more frequent screening of subsurface soils. Although these are valid concerns, it is not clear that this methodology would be any more fruitful, particularly in light of the type of contamination in this area, and our previous inability to find any significant soil contamination. However, we propose that rather than a soil gas survey with a grid pattern, we can undertake biased soil gas testing on a site-specific basis at areas we believe may be near to the origin of the contamination, i.e. by drainage areas such as near loading docks, former storage areas, etc. The soil gas can then be screened rather than analyzed for specific chemicals. If a reading is observed we may assume it is the chemical we are looking for and take a soil sample in this area. Even if the soil screening is unsuccessful we should attempt to obtain at least one on-site soil sample for each potential source. If unfamiliar with the exact nature of each property, the decision about where to sample could be made in the field.
- The regional office states that there are six above-ground storage tanks, approximately 8 feet in diameter and 18 feet tall, at Mercury Electric. The reviewer asked: What do these tanks contain? Did they contain different liquids in the past? Were they tested for leaks? If the answers are unknown, the work plan can be revised without discussing this, but we should attempt to answer these questions.
- The region would like us to sample storm drains in the streets as well as the recharge basins that the drains lead to. This is somewhat related to the previous comment. If we believe there were above-ground spills that could have drained to the street, we can, on a site-specific basis, sample the sediment in a nearby drain. However, I don't believe anything would be gained by sampling the recharge basin.
- The region also believes we should include some nearby properties - such as Alpha Collision Autobody, which is next door to Mercury Electric, and Reflex Offset, which is adjacent to Sprague-Goodman Electronics - in the investigation. To the extent feasible we should consider installing some additional probes around these locations and conduct any other relevant sampling.
- The list in Attachment F of the Health and Safety Plan does not appear complete since it does not state that Zebra and DEC personnel may also be on site.

- Please remember to revise all references about using 55-gallon drums for storage of decontamination and purge water. Also, the sections discussing mobile lab, field analysis, confirmatory analysis, etc. should be amended.
- There are several typographical, grammatical and similar type errors. I've included a copy of the marked up pages.
- Where relevant, these comments should also be applied to the Project Management Plan.

Comments from the QA review include the following:

- Page 5-5, Section 5.2.5: Well development should continue until the turbidity reaches 50 NTU's or less or until the NYSDEC representative agrees to termination of well development.
- Page 6-15 and 6-16, Table 6-3: Specify 1991 NYSDEC ASP Method 91-1 in this table, for volatile organic analysis.
- Page 6-20, Section 6.7.4: Add to item 3 the statement mentioned above regarding well development.
- Page 6-32, Section 6.14: Specify Category B level reporting for work performance by the outside lab.
- Page 6-33, Section 6.15: Specify USEPA Region II Functional Guidelines.
- Page 6-34, Section 6.15: The Project Quality Assurance Officer will be responsible for preparing the Data Usability Report.

Please revise the work plan in light of these comments.

Sincerely,



Hayden Brewster
Environmental Engineer 2
Eastern Investigation Section
Bureau of Hazardous Site Control
Division of Hazardous Waste Remediation

Enclosure

bcc: J. Swartwout to
H. Brewster
File

HB/ck



STATE OF NEW YORK DEPARTMENT OF HEALTH

Office of Public Health

11 University Place Albany, New York 12203-3399

Barbara A. DeBuono, M.D., M.P.H.
Commissioner

Karen Schimke
Executive Deputy Commissioner

MAY - 8 1995

May 4, 1995

BUREAU OF
HAZARDOUS SITE CONTROL
DIVISION OF HAZARDOUS
WASTE REMEDIATION

Mr. Hayden Brewster
Bureau of Hazardous Site Control
NYS Department of Environmental Conservation
50 Wolf Road
Albany, NY 12233

RE: Sprague Goodman and Related Sites
Sites (130073 A, B, C & D)
North Hempstead, Nassau County

Dear Mr. Brewster:

I have reviewed the Preliminary Site Assessment Work Plan for the Sprague Goodman Electronics and related sites in North Hempstead, Nassau County.

The purpose of the investigation is to identify source(s) of groundwater contamination in the Garden City Park Industrial area. However, the current plan calls for only five subsurface soil samples to be collected during the installation of 30 groundwater probes. This indicates an emphasis on groundwater as opposed to contaminated soils. In attempting to locate a source, I feel that more frequent screening of the subsurface soils during the installation of the groundwater probes will be necessary to avoid overlooking potential source areas.

If you have any questions please call me at 458-6305.

Sincerely,

Timothy E. Vickerson
Assistant Sanitary Engineer
Bureau of Environmental Exposure
Investigation

lmw/95117PRO0022

cc: Dr. Carlson
Mr. Bates/Mr. Laccetti
Mr. T. Mulvahill NCHD
Mr. J. Swartwout NYSDEC



New York State Department of Environmental Conservation

MEMORANDUM

TO: Ralph Burger
FROM: Hayden Brewster *HB*
SUBJECT: Request to use Zebra as Subcontractor at Multi-Site (Sprague Goodman & Related Sites) PSA; WA #D002708-21; Site ID #s: 130073 (A-D)
DATE: April 4, 1995

The consultant for the above-work assignment, Dvirka and Bartilucci, wishes to use Zebra Environmental for Geoprobe Services.

This is the same vicinity that Zebra worked on during the Garden City Park Industrial Area PSA, and will be working on for the Fulton Avenue (GCPIA) focused remedial investigation. The type of work required of Zebra would be the same as in the previously mentioned investigations. They would use the same rates agreed to for the Fulton Avenue site. We plan to coordinate geoprobe activities, so that Zebra will only need to mobilize once for both projects.

In the past, we have been very satisfied with Zebra's work output, thus I recommend that they be procured for this assignment.

We hope to begin geoprobe work on this project in May or early June and would, therefore, appreciate a prompt response.

bcc: J. Swartwout to
H. Brewster
File

HB/ck



MAR 29 1995

Michael Zagata
Commissioner

CERTIFIED MAIL - RETURN RECEIPT REQUESTED

Joharri Realty Corp.
195 Atlantic Avenue
P.O. Box N
New Hyde Park, New York 11040

Dear Sir/Madam:

Re: Sprague Goodman Electronics, ID #130073A
134 Fulton Avenue, Garden City Park, NY 11040

The New York State Department of Environmental Conservation is requesting your assistance. The Department is preparing to perform a Preliminary Site Assessment (PSA) at the Sprague Goodman Electronics site located in the Town of North Hempstead. The purpose of the PSA is to determine if the area in question is part of an inactive hazardous waste disposal site.

Our records indicate that you are the owner of property located near the site identified on the County of Nassau Tax Map as: Garden City Park, Section 33, Block 151, Lot 373. Environmental Conservation Law Section 27-1309.3 and Section 1313.8 authorizes the Department or its authorized agents to enter upon any inactive hazardous waste disposal site and areas near such site for purposes of sampling and testing, remediation and temporary occupancy.

The Department requests your cooperation in entering upon your real property, above specified, at any time on or after April 12, 1995, for the purpose of conducting the PSA. This will involve inspecting the premises and taking samples at and near the site. In order to take such samples, the NYSDEC may use or cause to be used such sampling methods as it determines to be necessary, including but not limited to soil sampling, soil borings, test pits, monitoring wells and geophysical studies.

We also request that you provide in accordance with the Environmental Conservation Law (ECL) Section 27-1307, all currently available information which would help in our investigation work.

This is not a notice that the Department intends to acquire the above-specified property nor is it an offer to acquire it.

The Department will make every reasonable effort to cooperate with you so that any adverse impact of its entry on and occupancy of your property will be minimized. Accordingly, the Department will pay the cost of the work to be conducted on your property.

Any questions or concerns about the Department's operations on your property should be directed to Mr. John Swartwout, P.E., Chief, Eastern Investigation Section at (518) 457-0639.

Sincerely,

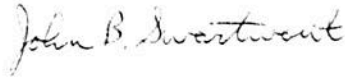

cc - Earl H. Barcomb, P.E.
Director
Bureau of Hazardous Site Control
Division of Hazardous Waste Remediation

bcc: R. Dana
A. Shah
J. Swartwout to
H. Brewster
File

HB/ck

New York State Department of Environmental Conservation
50 Wolf Road, Albany, New York 12233-7010



Michael Zagata
Commissioner

MAR 29 1995

CERTIFIED MAIL - RETURN RECEIPT REQUESTED

Orlando & Amanda Zeppieri
1552 Old Cedar Swamp Road
Brookville, New York 11545

Dear Mr. & Mrs. Zeppieri:

Re: Sprague Goodman Electronics, ID #130073A
134 Fulton Avenue, Garden City Park, NY 11040

The New York State Department of Environmental Conservation is requesting your assistance. The Department is preparing to perform a Preliminary Site Assessment (PSA) at the Sprague-Goodman site located in the Town of North Hempstead. The purpose of the PSA is to determine if the area in question is part of an inactive hazardous waste disposal site.

Our records indicate that you are the owner of property located near these sites identified on the County of Nassau Tax Map as: Garden City Park, Section 33, Block 151, Lots 377. Environmental Conservation Law Section 27-1309.3 and Section 1313.8 authorizes the Department or its authorized agents to enter upon any inactive hazardous waste disposal site and areas near such site for purposes of sampling and testing, remediation and temporary occupancy.

The Department requests your cooperation in entering upon your real property, above specified, at any time on or after April 12, 1995, for the purpose of conducting the PSA. This will involve inspecting the premises and taking samples at and near the site. In order to take such samples, the NYSDEC may use or cause to be used such sampling methods as it determines to be necessary, including but not limited to soil sampling, soil borings, test pits, monitoring wells and geophysical studies.

We also request that you provide in accordance with the Environmental Conservation Law (ECL) Section 27-1307, all currently available information which would help in our investigation work.

This is not a notice that the Department intends to acquire the above-specified property nor is it an offer to acquire it.

The Department will make every reasonable effort to cooperate with you so that any adverse impact of its entry on and occupancy of your property will be minimized. Accordingly, the Department will pay the cost of the work to be conducted on your property.

Any questions or concerns about the Department's operations on your property should be directed to Mr. John Swartwout, P.E., Chief, Eastern Investigation Section at (518) 457-0639.

Sincerely,

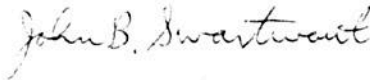

cc: Earl H. Barcomb, P.E.

Director

Bureau of Hazardous Site Control

Division of Hazardous Waste Remediation

bcc: R. Dana
A. Shah
J. Swartwout to
H. Brewster
File

HB/ck

New York State Department of Environmental Conservation
50 Wolf Road, Albany, New York 12233-7010

MAR 29 1995



Michael Zagata
Commissioner

CERTIFIED MAIL - RETURN RECEIPT REQUESTED

Mr. John E. Banks
142 Fulton Avenue
Garden City Park, New York 11040

Dear Mr. Banks:

Re: Sprague Goodman Electronics, ID #130073A
134 Fulton Avenue, Garden City Park, NY 11040
Joseph Struhl Company, Site ID #130073D
195 Atlantic Avenue, Garden City Park, NY

The New York State Department of Environmental Conservation is requesting your assistance. The Department is preparing to perform a Preliminary Site Assessment (PSA) at the above-referenced sites located in the Town of North Hempstead. The purpose of the PSA is to determine if the areas in question are part of inactive hazardous waste disposal sites.

Our records indicate that you are the owner of property located near these sites identified on the County of Nassau Tax Map as: Garden City Park, Section 33, Block 151, Lots 339-342. Environmental Conservation Law Section 27-1309.3 and Section 1313.8 authorizes the Department or its authorized agents to enter upon any inactive hazardous waste disposal site and areas near such site for purposes of sampling and testing, remediation and temporary occupancy.

The Department requests your cooperation in entering upon your real property, above specified, at any time on or after April 12, 1995, for the purpose of conducting the PSA. This will involve inspecting the premises and taking samples at and near the sites. In order to take such samples, the NYSDEC may use or cause to be used such sampling methods as it determines to be necessary, including but not limited to soil sampling, soil borings, test pits, monitoring wells and geophysical studies.

We also request that you provide in accordance with the Environmental Conservation Law (ECL) Section 27-1307, all currently available information which would help in our investigation work.

This is not a notice that the Department intends to acquire the above-specified property nor is it an offer to acquire it.

The Department will make every reasonable effort to cooperate with you so that any adverse impact of its entry on and occupancy of your property will be minimized. Accordingly, the Department will pay the cost of the work to be conducted on your property.

Any questions or concerns about the Department's operations on your property should be directed to Mr. John Swartwout, P.E., Chief, Eastern Investigation Section at (518) 457-0639.

Sincerely,



cc- Earl H. Barcomb, P.E.

Director

Bureau of Hazardous Site Control

Division of Hazardous Waste Remediation

bcc: R. Dana
A. Shah
J. Swartwout to
H. Brewster
File

HB/ck

NEW YORK STATE DEPARTMENT OF ENVIRONMENTAL CONSERVATION
50 Wolf Road, Albany, New York 12233



MAR - 8 1995

To Whom It May Concern:

For the purpose of investigating the following sites: Sprague-Goodman Electronics (ID #130073A), Precision Fabricators (ID #130073B), Mercury Electric (ID #130073C), and the Joseph Struhl Company (ID #130073D), all in the Garden City Park Industrial Area in North Hempstead, Nassau County, pursuant to the Environmental Conservation Law, Article 27, Title 13, this Department has contracted with Dvirka and Bartilucci Consulting Engineers (D&B). D&B is hereby designated as an authorized consultant of the New York State Department of Environmental Conservation (NYSDEC).

As our consultant, D&B is entitled to collect information from all available sources including, but not limited to, all State, federal, county and municipal offices and private concerns. When fulfilling the duties of an authorized consultant of NYSDEC, all requests by the above-mentioned offices to classify information as confidential are to be noted and referred to the Department.

D&B and their subcontractors are also authorized to conduct field activities at these sites and at nearby properties. This may involve a geophysical survey to collect stratigraphic data; a magnetometer study to search for buried drums or tanks; soil gas survey; the installation of groundwater probes; the installation of monitoring wells; and laboratory analysis of samples of groundwater, surface water, on-site waste and soils, and drum contents to determine the sources of contamination. The proposed study for a site may include some or all of the above items.

This status, as an authorized consultant of NYSDEC, is valid from March 1, 1995 to February 29, 1996.

bcc: M. O'Toole (2)
C. Goddard
E. Barcomb
J. Swartwout
H. Brewster
A. Shah
File

Sincerely,

Michael J. O'Toole, Jr.
Director
Division of Hazardous Waste Remediation

HB/ck



New York State Department of Environmental Conservation

M E M O R A N D U M

TO: Dan Eaton
FROM: John Swartwout *JS*
SUBJECT: Confirmation of "P" Site Designations

DATE: October 26, 1994

The 15 day review period has recently ended for the following "P" sites:

#130073A	Sprague-Goodman Electronics
#130073B	Precision Fabricators
#130073C	Mercury Electric
#130073D	Joseph Strohl Company
#224020	Designers Woodcraft

No information has been received, which causes us to change our determinations on these sites. I, therefore, confirm our earlier determination that these sites should be investigated as potential inactive hazardous waste disposal sites. Designers Woodcraft should be added to the list of sites awaiting a State-funded PSA and be considered for inclusion in the next available work assignment. Hayden Brewster will be initiating a work assignment shortly to investigate the 130073A-D sites which are in the Garden City Park Industrial Area.

cc: A. Shah
R. Gardineer
T. Sylvester
H. Brewster

file

NEW YORK STATE DEPARTMENT OF ENVIRONMENTAL CONSERVATION

MEMORANDUM



TO: Bob Marino, Chief, Site Control Section, Albany
FROM: Ajay Shah, RHWRE, Region 1 *Ajay Shah*
SUBJECT: GCP Industrial Area, Potential Sites - 130073 A,B,C
DATE: October 3, 1994

=====

We have reviewed potential site notices for the following sites in the Garden City Park Industrial Area.

Sprague-Goodman Electronics
Precision Fabricators
Mercury Electric

The Region does not have any additional information on these sites. We support the recommendation to conduct additional PSAs at these sites.

Please contact me if you have any questions on this.

cc: J. Swartwout

Hayden

**SPRAGUE
GOODMAN**

SPRAGUE-GOODMAN ELECTRONICS, INC.

134 Fulton Avenue, Garden City Park, N.Y. 11040

Tel. 516/746-1385 • Fax 516/746-1396

334-8708 effective 12/1/94

CERTIFIED MAIL
RETURN RECEIPT REQUESTED

September 22, 1994

New York State Department
of Energy Conservation
Bureau of Hazardous Site Control
Room 220
50 Wolf Road
Albany, NY 12233-7010

Attn: Mr. John Swartwout

Gentlemen:

This is in response to your September 20th letter concerning
DEC Site No. 130073A.

As your report notes, we have used 1,1,1, trichlorethane
for many years, and have duly supplied all necessary reports
to New York State and to Nassau County.

We respectfully disagree with your contention that we are
"a likely contributor to the 1,1,1, trichlorethane
contamination." It seems to me that we are accused solely
on the basis of the reports that we have filed, as we
were legally required to do, and prior to evaluating our method
of disposal. All trichlorethane waste was properly stored, and
disposed of using certified scavengers. We have reports on
file to prove this. Most likely the contamination was caused by
someone else in the area who did not bother to file.

We welcome your investigation and assure you of our complete
cooperation.

In summary, I can categorically state that Sprague-Goodman
has never contaminated our environment. Any and all
hazardous waste was disposed of in accordance with New York
State, DEC, and Nassau County requirements.

Very truly yours,

SPRAGUE-GOODMAN ELECTRONICS, INC.



Jack Goodman
CEO

JG:ed

cc: Dan Brownstein

SITE INVESTIGATION INFORMATION

1. SITE NAME Sprague-Goodman Electronics		2. SITE NUMBER 130073A	3. TOWN/CITY/VILLAGE North Hempstead	4. COUNTY Nassau
5. REGION 1	6. CLASSIFICATION CURRENT PROPOSED P MODIFY			
7. LOCATION OF SITE (Attach U.S.G.S. Topographic Map showing site location) Quadrangle Lynbrook Site Latitude ____° ____' ____" Site Longitude ____° ____' ____" Tax Map Numbers 33,151,343-346 Site Street Address 134 Fulton Avenue, Garden City Park, NY				
8. BRIEFLY DESCRIBE THE SITE (Attach site plan showing disposal/sampling locations) Electronic components have been manufactured at this facility for about 25 years. The site is between Nassau Boulevard and Cornelia Avenue in the Garden City Park Industrial Area. <i>Manufacturers of Capacitors</i>				
9. Area <u>1/2</u> acres b. EPA ID Number _____ Completed <input type="checkbox"/> Phase I <input type="checkbox"/> Phase II <input type="checkbox"/> PSA <input type="checkbox"/> RI/FS <input type="checkbox"/> PA/SI <input checked="" type="checkbox"/> Other Garden City Park Ind. Area PSA				
10. Hazardous Waste Disposed (Include EPA Hazardous Waste Numbers) Use of 1,1,1-Trichloroethane documented; disposal suspected. In the past about 165 gallons per year were used (now 5 gallons per year).				
11. ANALYTICAL DATA AVAILABLE a. <input type="checkbox"/> Air <input checked="" type="checkbox"/> Groundwater <input type="checkbox"/> Surface Water <input type="checkbox"/> Sediment <input type="checkbox"/> Soil <input type="checkbox"/> Waste <input type="checkbox"/> Leachate <input type="checkbox"/> EPTox <input type="checkbox"/> TCLP b. Contravention of Standards or Guidance Values 1,1,1-TCA <u>GP-2(downgradient)*</u> <u>GP-22(upgradient)*</u> <u>Class GA Standard</u> 90ppb ND 5ppb <i>Valid 150?</i> shallow Geoprobe samples				
11. CONCLUSION The Garden City Park Industrial Area PSA report identified this facility as a likely contributor to the 1,1,1-trichloroethane contamination in the sole source aquifer due to its known use of this solvent and its location relative to the plume plume.				
12. SITE IMPACT DATA Nearest Surface Water: Distance <u>5000</u> ft. Direction <u>Southeast</u> Classification <u>D</u> Nearest Groundwater: Depth <u>38</u> ft. Flow/Direction <u>Southwest</u> <input checked="" type="checkbox"/> Sole Source <input type="checkbox"/> Primary <input type="checkbox"/> Principal Nearest Water Supply: Distance <u>800</u> ft. Direction <u>North</u> Active <input checked="" type="checkbox"/> Yes <input type="checkbox"/> No Nearest Building: Distance <u>0</u> ft. Direction <u>Onsite</u> Use <u>Commercial</u> In State Economic Development Zone? <input type="checkbox"/> Y <input checked="" type="checkbox"/> N i. Controlled Site Access? <input type="checkbox"/> Y <input checked="" type="checkbox"/> N Crops or livestock on site? <input type="checkbox"/> Y <input checked="" type="checkbox"/> N j. Exposed hazardous waste? <input type="checkbox"/> Y <input checked="" type="checkbox"/> N Documented fish or wildlife mortality? <input type="checkbox"/> Y <input checked="" type="checkbox"/> N k. HRS Score _____ Impact on special status fish or wildlife resource? <input type="checkbox"/> Y <input checked="" type="checkbox"/> N l. For Class 2: Priority Category _____				
13. SITE OWNER'S NAME Jack & Claire Goodman <i>see page 25</i> <i>aka Kogalistic Realty Corp</i>		14. ADDRESS 134 Fulton Avenue, Garden City Park, NY 11040		15. TELEPHONE NUMBER
16. PREPARER <i>John B. Swartwout</i> Signature Date <u>9-13-94</u> John Swartwout, Chief, Eastern Investigation Section		17. APPROVED Signature Date Name, Title, Organization		

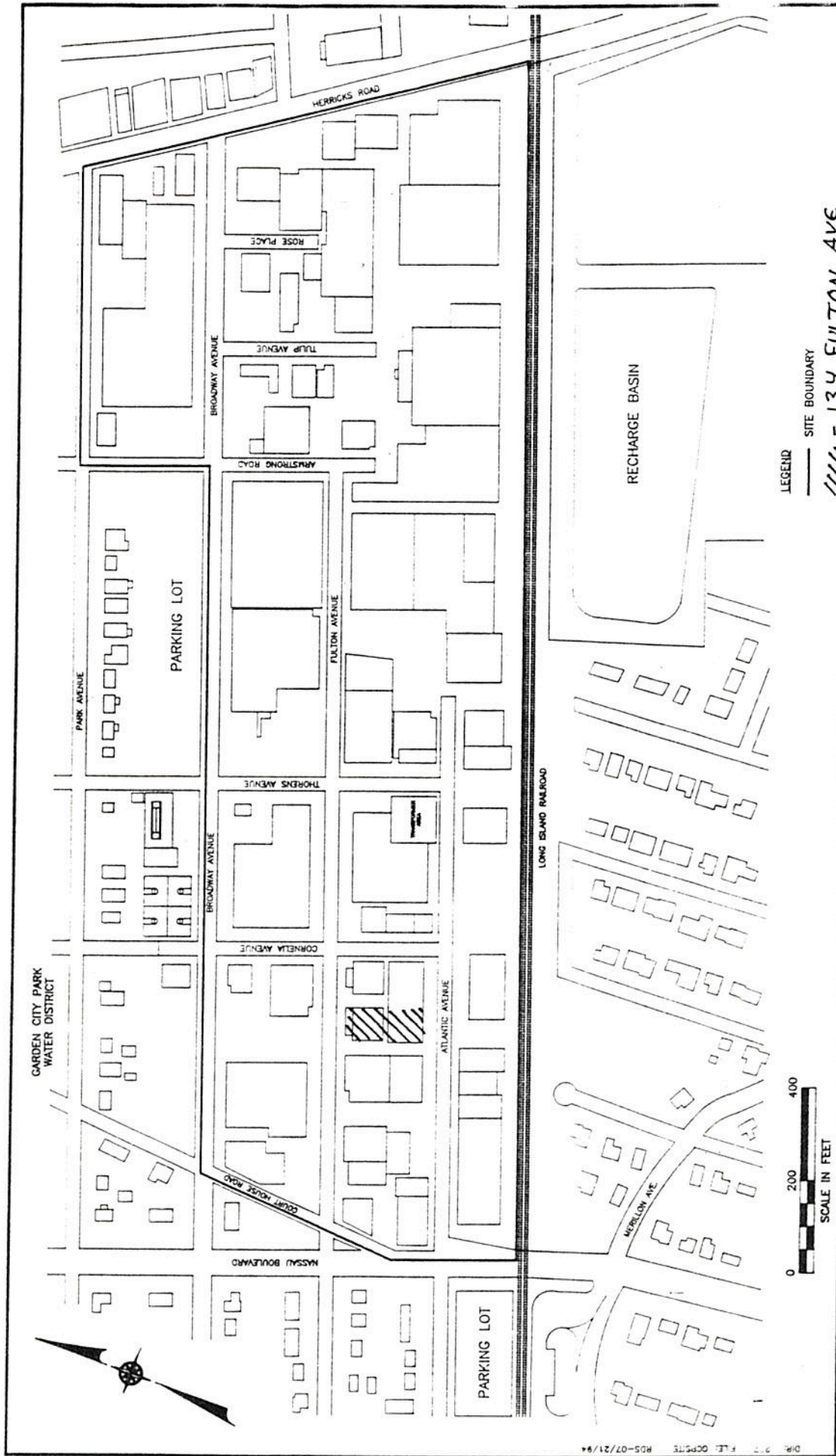

D.P. 3-2 F.L. 00515 R05-07/21/94