



FACT SHEET

State Superfund Program

Receive Site Fact Sheets by **Email**. See “For More Information” to Learn How.

Farmingdale Plaza Cleaners Site Remediation
Site No: 130107, Operable Unit 1
Town of Oyster Bay, NY

September 2011

Remedial System Startup at State Superfund Site

The New York State Department of Environmental Conservation (NYSDEC) has been installing a system to treat contaminated soil vapor and groundwater at the Farmingdale Plaza Cleaners site (“site”), located at 480 Main Street in the Incorporated Village of Farmingdale, Nassau County, New York. (See Figure 1 for site location). The installation includes soil vapor extraction (SVE) wells, vacuum monitoring points and piping to prepare for the start-up and operation of a SVE treatment system. Treatment system startup is currently scheduled for late September 2011.

The site is listed as a Class “2” site in the State Registry of Inactive Hazardous Waste Sites (list of State Superfund sites). A Class 2 site represents a significant threat to public health or the environment; action is required.

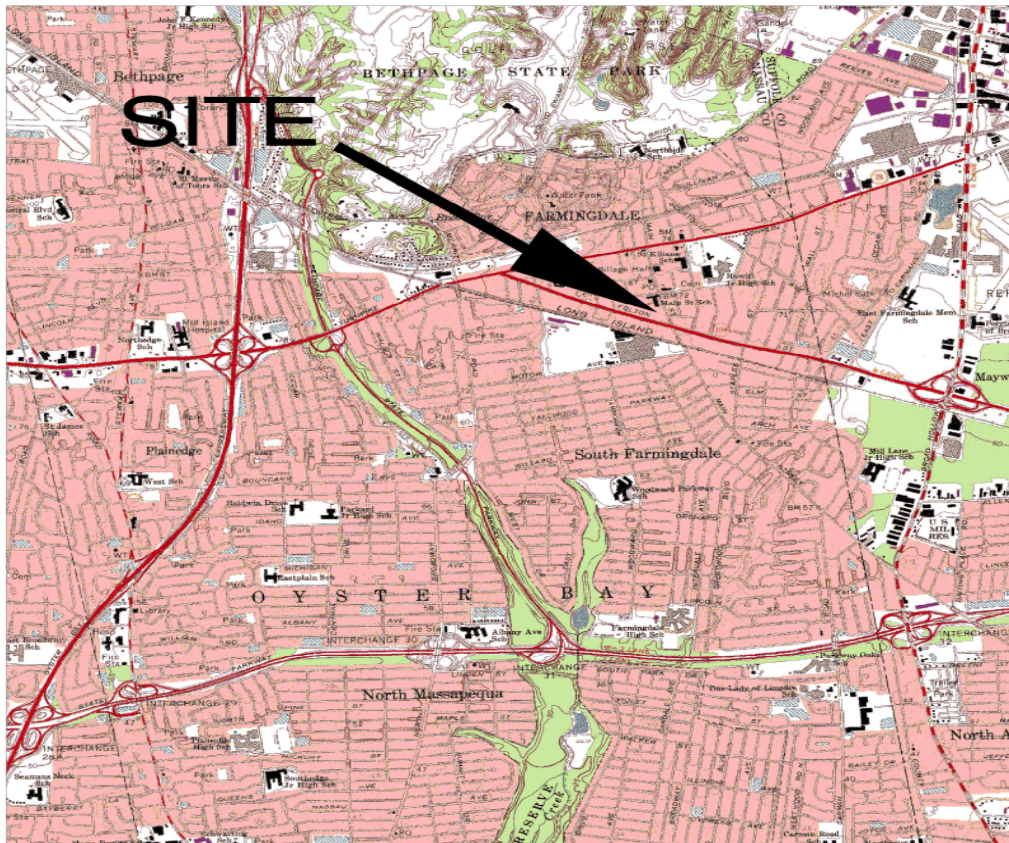

Figure 1 – Farmingdale Plaza Cleaners Site Location Map

Highlights of the Site Remediation

An “Interim Remedial Measure” (IRM) is a discrete set of planned actions for both emergency and non-emergency situations that can be conducted without the extensive investigation and evaluation of a Remedial Investigation/Feasibility Study (RI/FS). Because of their versatility and the relative speed with which they are applied, IRMs accelerate remedial projects. The sooner sites are remediated, the sooner the public and the environment are protected. An IRM is planned for this site to address a source of soil vapor and groundwater contamination at the former Farmingdale Plaza Dry Cleaners. This IRM is being performed by the NYSDEC under the NYS Superfund Program.

The remedial construction and operation scope of work is available for public review at the locations identified below under “Where to Find Information.”

The on-site remediation has the following goals:

- 1) Reduce the volatile organic compounds (VOC) concentrations in the subsurface soil vapors.
- 2) Prevent soil vapor intrusion from impacting the indoor air quality in the buildings in the shopping plaza and adjacent properties.
- 3) Reduce VOC concentrations in unsaturated site soils and groundwater.

The contaminant of concern for this site is tetrachloroethene or perchloroethene (PCE), which is a common dry cleaning solvent. Investigations performed at the site showed that the on-site groundwater and soil vapors have been impacted, and PCE contaminated groundwater is migrating to the south. People are not drinking the contaminated groundwater because the area is served by a public water supply not affected by this contamination. The potential for soil vapor intrusion is currently being investigated by the NYSDEC.

A SVE treatment system extracts vapor from the subsurface using a vacuum blower. Contamination in the extracted vapor is then removed by passing the vapor through activated carbon. The effectiveness of the SVE system is measured by monitoring concentration in the extracted vapor and also in monitoring points installed below the ground in the treatment area. The SVE system has two extraction wells and four vapor monitoring points, but will have the ability to extract vapor from up to three extraction wells, should the need arise. Vapor monitoring points have also been installed

within the plaza and in/adjacent to the surrounding apartments and a commercial building. Figure 2 provides the expected zone of influence of the IRM SVE treatment system.

The SVE well, vacuum monitoring points, and associated piping have been installed in and outside of the Former Farmingdale Plaza Cleaners building. A fenced area is set up in the southern portion of the site where the SVE treatment system enclosure will be placed. The following activities are planned:

Delivery of the prefabricated SVE system to the site, which is expected by the end of September 2011;

State Superfund Program: New York State Superfund Program (SSF) identifies and characterizes suspected inactive hazardous waste disposal sites. Sites that pose a significant threat to public health and the environment go through a process of investigation, evaluation, cleanup and monitoring.

NYSDEC generally attempts to identify parties responsible for site contamination and require cleanup before committing State funds.

For more information about the SSF, visit:
www.dec.ny.gov/chemical/8439.html

Connect SVE piping and electrical service to the treatment system;

Begin operation of the treatment system in late September or early October; and

Monitor the treatment system regularly during the initial two week start up period and then periodically for a minimum of six months as per the operation and monitoring (O&M) plan.

Next Steps

The information collected during O&M and sampling will be summarized in reports and will be used to adjust the system, determine the effectiveness and of the remediation, and to determine the length of treatment system operation. The NYSDEC will keep the public informed throughout the duration of the IRM at the site.

Background

The site is comprised of the former Farmingdale Dry Cleaner tenant space located within a one-story masonry structure of approximately 33,000 square feet situated on a 4 acre commercial parcel. Known contamination includes PCE and its associated breakdown products. On-site investigations were conducted in 2004 and 2007. A separate off-site remedial investigation was initiated in 2009 and continues.

FOR MORE INFORMATION

Where to Find Information

Project documents are available at the following location to help the public stay informed.

Farmingdale Public Library

116 Merritts Road

Farmingdale New York 11735

Phone: (516) 249-9090

For Library Hours Go To:

<http://www.nassaulibrary.org/farmingd/index.htm>

Who to Contact

Comments and questions are always welcome and should be directed as follows:

SVE IRM Project Related Questions

Mr. David Chiusano
New York State Department of
Environmental Conservation
625 Broadway, 12th Floor
Albany NY 12233-7017
Phone: (518) 402-9814
Email: djchiusa@gw.dec.state.ny.us

Site-Related Health Questions

Ms. Sharon P. McLelland
New York State Department of Health
Bureau of Environmental Exposure
Investigation, Room 300
547 River Street
Troy NY 12180-2216
Phone: (518) 402-7880

Offsite Investigation Related Questions

Mr. Chek Ng, P.E.
New York State Department of
Environmental Conservation
625 Broadway, 11th Floor
Albany NY 12233-7015
Phone: (518) 402-9620
Email: cbng@gw.dec.state.ny.us

Citizen Participation Specialists

Bill Fonda/Aphrodite Montalvo
New York State Department of
Environmental Conservation Region 1
50 Circle Road
Stony Brook, NY 11790
Phone: (631) 444-0350
E-Mail: bmfonda@gw.dec.state.ny.us or
axmontal@gw.dec.state.ny.us

For additional general information on the soil cleanup technology that is being used at this site, please visit the United States Environmental Protection Agency's website at: "***A Citizen's Guide to Soil Vapor Extraction and Air Sparging:***" <http://www.epa.gov/tio/download/citizens/citsve.pdf>

We encourage you to share this fact sheet with neighbors and tenants, and/or post this fact sheet in a prominent area of your building for others to see.

Receive Site Fact Sheets by Email

Have site information such as this fact sheet sent right to your email inbox. NYSDEC invites you to sign up with one or more contaminated sites county email listservs available at the following web page: www.dec.ny.gov/chemical/61092.html . It's *quick*, it's *free*, and it will help keep you *better informed*.



As a listserv member, you will periodically receive site-related information/announcements for all contaminated sites in the county(ies) you select.

You may continue also to receive paper copies of site information for a time after you sign up with a county listserv, until the transition to electronic distribution is complete.

Note: Please disregard if you already have signed up and received this fact sheet electronically.

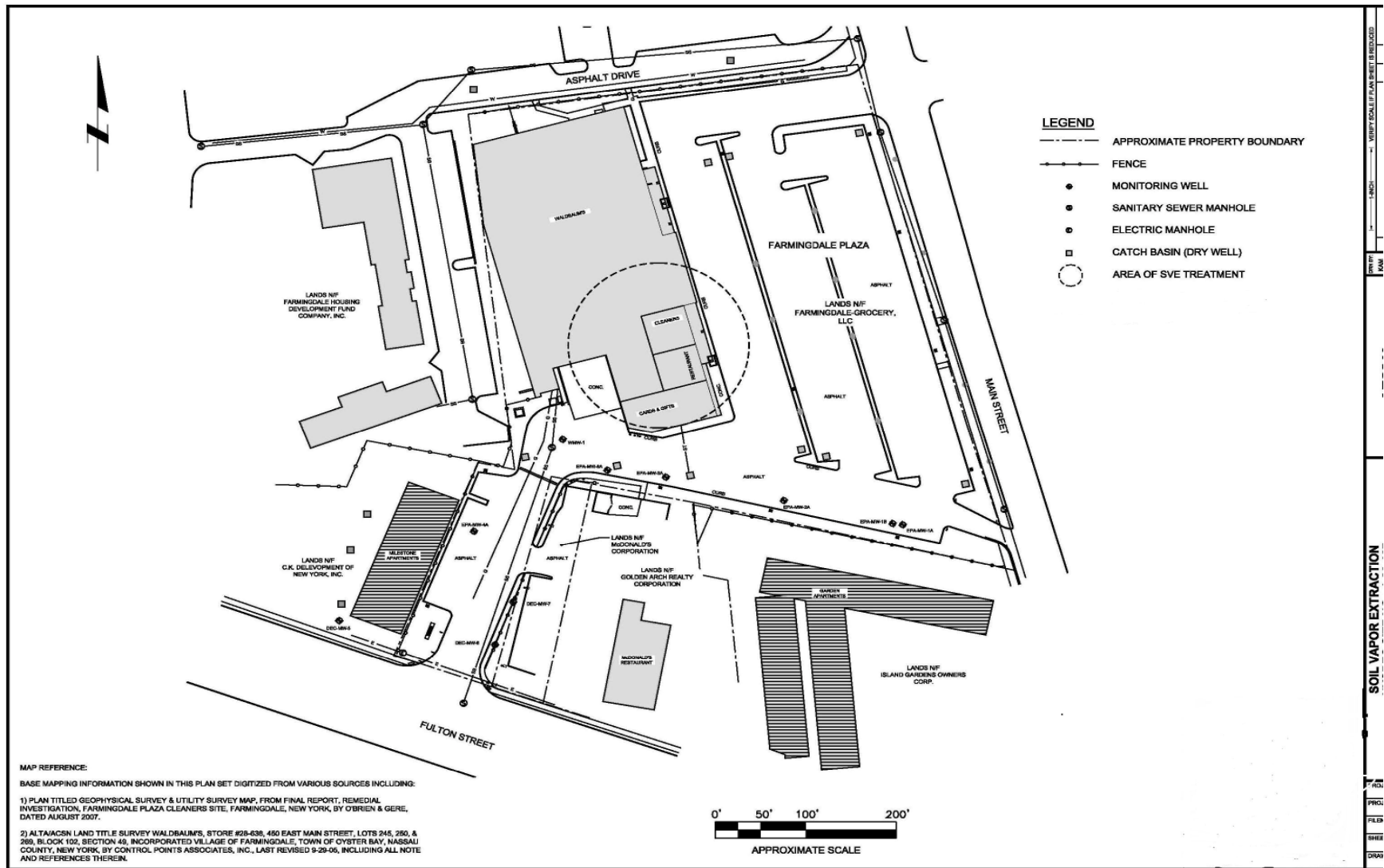

**Figure 2 – Farmingdale Plaza Cleaners Site
Area of SVE Treatment**