

Michael Quinlan  
Senior Program Manager  
Site Investigation & Remediation



November 22, 2022

Mr. R. Scott Deyette  
Chief, Inspection Unit, Remedial Bureau C  
New York State Department of Environmental Conservation  
Division of Environmental Remediation  
625 Broadway  
Albany, New York 12233-7014

**Summary of Intrusive Activities  
East Garden City Former Stewart Avenue Holder Station  
East Garden City, New York  
Site No. 130120  
Order on Consent Index No. A2-0552-0606**

---

Dear Mr. Deyette:

This letter provides a summary to the New York State Department of Environmental Conservation (NYSDEC) of the work conducted at the East Garden City Former Stewart Avenue Holder Station Site (the Site). On October 3, 2022 and October 7, 2022 National Grid conducted ground-intrusive activities in an area located adjacent to the southeast corner of the substation at the Site. **Figure 1** depicts the location of the work area on the Site. **Figure 2** shows the trench and pit locations within the work area.

The intrusive activity included excavating two (2) trenches measuring approximately 40 feet and 13 feet long and approximately 2 feet wide and excavating three (3) pits each measuring 4 feet by 4 feet in length and width for corrosion control inspections. Excavation activities were conducted by National Grid Gas Operations utilizing a vacuum excavation rig and hand digging. The trenches were hand dug to a depth of 18 inches below ground surface; the test pits were excavated using a vacuum truck to a depth of six feet below ground surface.

National Grid's Site Investigation and Remediation (SIR) consultant, GEI Consultants Inc. P.C. (GEI) was on-Site during intrusive activities to perform Site Management Plan (SMP) oversight and perform Community Air Monitoring. No exceedances of particulate matter or volatile compounds were noted during the excavation activities. Excavated soil was field-screened using a photo-ionization detector and inspected for visual and olfactory impacts. No impacts were noted. The excavated material was stockpiled and used as backfill at the completion of the project.

If you have any questions, feel free to contact me at (516) 220-4363 or by email at [michael.quinlan@nationalgrid.com](mailto:michael.quinlan@nationalgrid.com).

Very truly yours,

  
Christopher Morris, P.G.  
On behalf of Michael Quinlan

**Summary of Intrusive Activities  
East Garden City Former Stewart Avenue Holder Station  
East Garden City, New York**

Attachment

cc: J. Mitchell (National Grid)

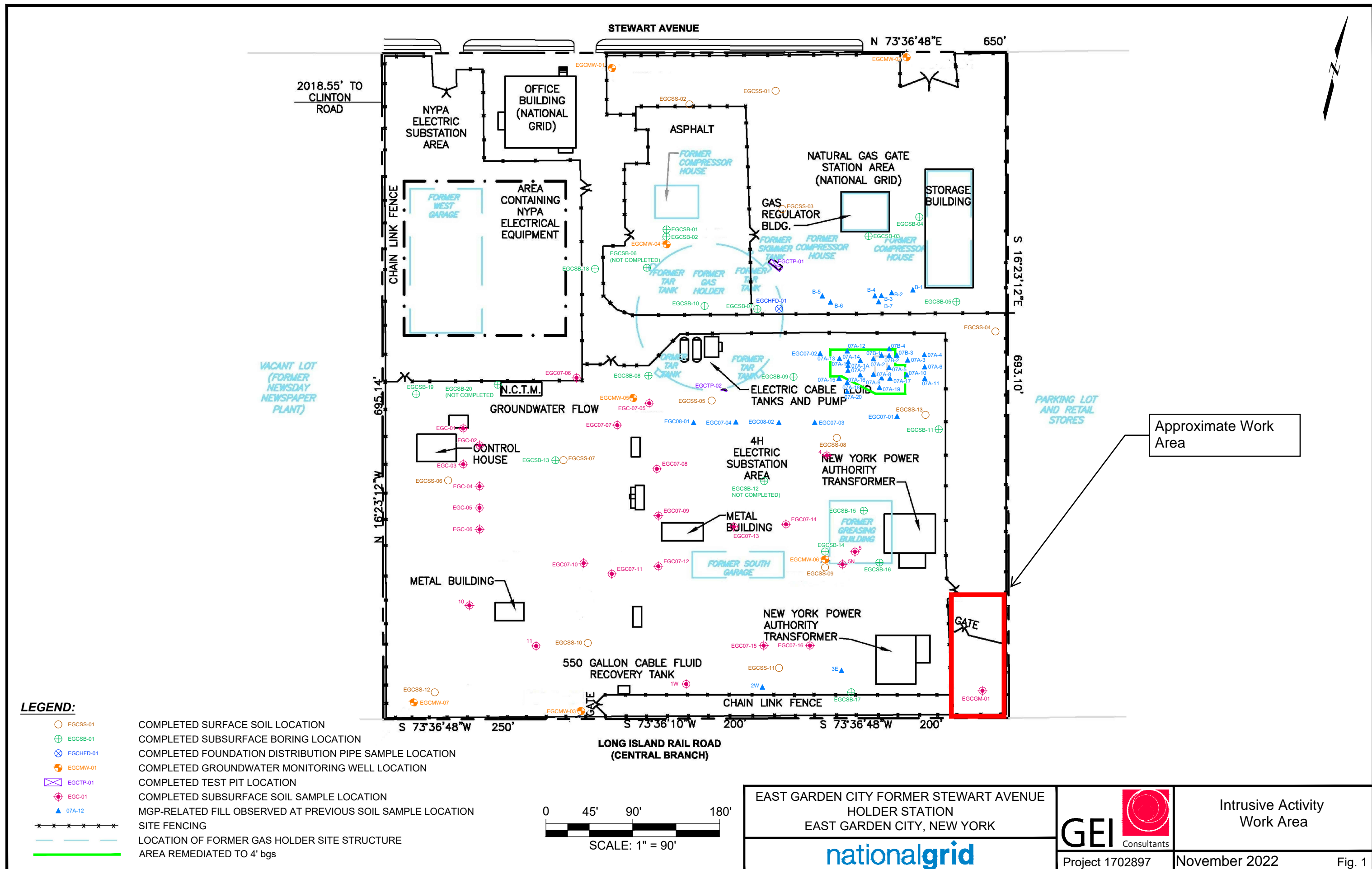

**LEGEND:**

- EGCSS-01 COMPLETED SURFACE SOIL LOCATION
- ⊕ EGCSB-01 COMPLETED SUBSURFACE BORING LOCATION
- ⊗ EGCHFD-01 COMPLETED FOUNDATION DISTRIBUTION PIPE SAMPLE LOCATION
- ⊙ EGCMW-01 COMPLETED GROUNDWATER MONITORING WELL LOCATION
- ⊠ EGCTP-01 COMPLETED TEST PIT LOCATION
- ⊕ EGC-01 COMPLETED SUBSURFACE SOIL SAMPLE LOCATION
- ▲ 07A-12 MGP-RELATED FILL OBSERVED AT PREVIOUS SOIL SAMPLE LOCATION
- SITE FENCING
- LOCATION OF FORMER GAS HOLDER SITE STRUCTURE
- AREA REMEDIATED TO 4' bgs

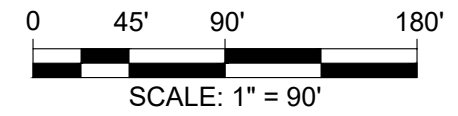

EAST GARDEN CITY FORMER STEWART AVENUE  
 HOLDER STATION  
 EAST GARDEN CITY, NEW YORK

**nationalgrid**



Intrusive Activity  
 Work Area

Project 1702897 November 2022 Fig. 1

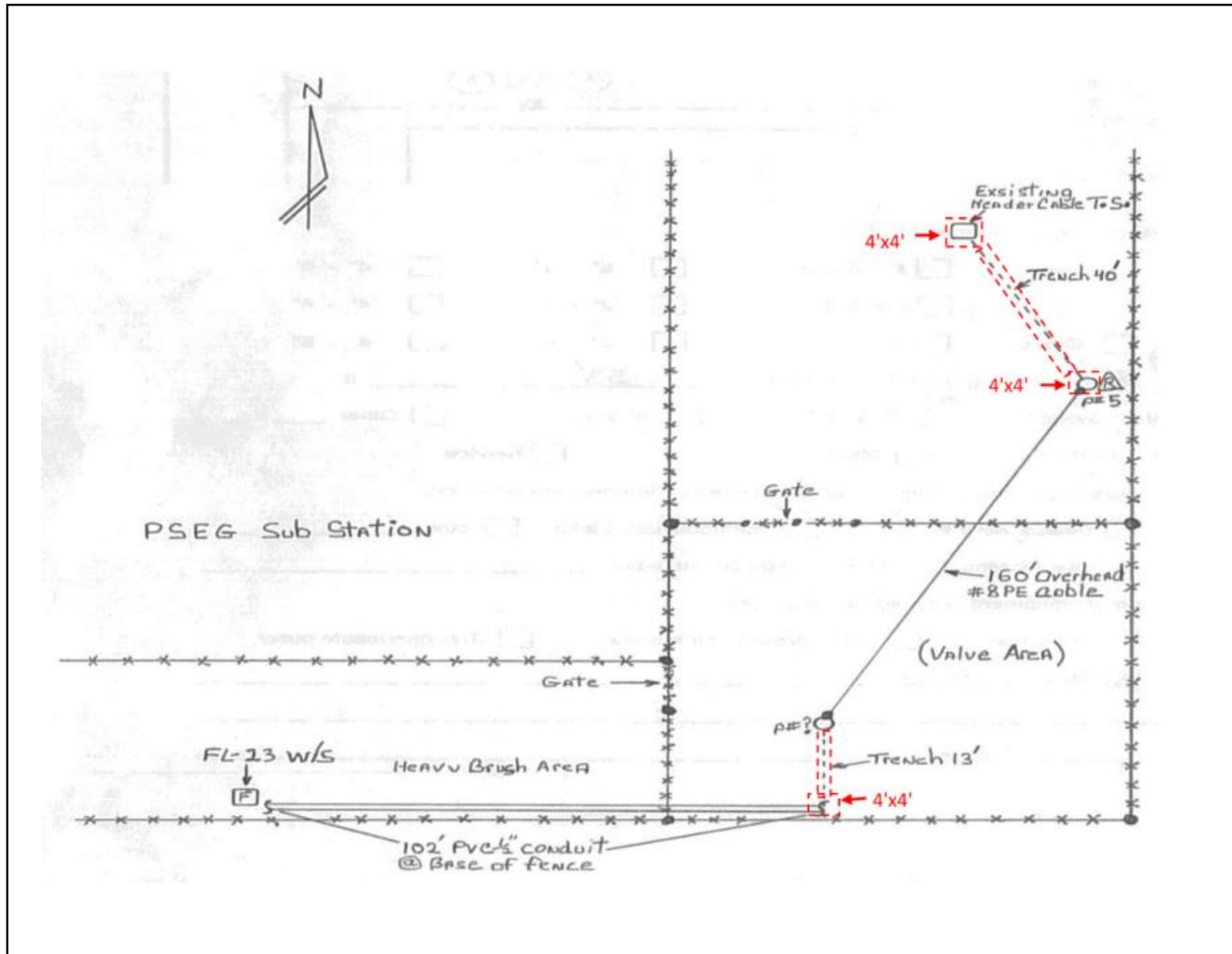

1000 New York Avenue  
Huntington Station, NY 11746

PHONE: 631-759-2973

**FIGURE 2.0**  
TRENCH AND PIT LOCATIONS

600 Stewart Avenue,  
Garden City, NY

PROJECT #: 1702897

DRAWING DATE: 2022-06-10

DRAWN BY: THJ

CHECKED BY: JM

GEI makes no guarantees as to the accuracy of this drawing and it should only be used for informational purposes.