



SITE INVESTIGATION INFORMATION

1. SITE NAME Elks Plaza		2. SITE NUMBER 130193	3. a. TOWNSHIP Hempstead	b. CITY/VILLAGE Freeport	4. COUNTY Nassau
5. REGION 1	6. Program Type Superfund				
7. LOCATION OF SITE (Attach U.S.G.S. Topographic Map showing site location)					
a. Quadrangle Freeport		b. Site Latitude <u>40° 39' 06"</u> Site Longitude <u>73° 35' 17"</u>			
c. Tax Map Numbers 62-114-131		d. Site Street Address 189 W. Merrick Rd, Freeport, NY 11520			
8. BRIEFLY DESCRIBE THE SITE (Attach site plan showing disposal/sampling locations)					
<p>The site is located in a small retail shopping center located at 157-189 W. Merrick Rd in Freeport, NY in Nassau County. The building consists of a commercially-zoned, one-story structure built in 1985, which covers approximately 32,820 square feet and a basement area of 10,056 square feet used for parking. The property is 2.5039 acres, most of which is paved parking area. The property is bounded by Merrick Road to the north and commercial lots to the south, east, and west. Residential properties lay beyond the commercial lots surrounding the Site. Several tenants occupy the building, currently none generate, use or dispose of hazardous materials. There were formerly two dry-cleaning facilities within the shopping center. M&B Cleaners operated at #171 (located near the eastern end of the southern portion of the building) from 1995 to 2001 and King and Queen Valet operated at #181 (southwestern corner tenant space) operated from 1985 to 2001. The Site consists of the area occupied by the former King and Queen Valet and the land to the west and south on the property's parcel.</p> <p>Phase I and II Environmental Site Assessments were been conducted in 2006 prompted by financial transaction for the property. A Preliminary Site Assessment (PSA) was completed in March 2010.</p> <p>a. Area <u>0.2195</u> acres b. Completed: <input type="checkbox"/> Financial Assessment <input checked="" type="checkbox"/> PSA <input type="checkbox"/> IRM <input type="checkbox"/> RI/FS <input type="checkbox"/> Construction <input type="checkbox"/> O&M <input type="checkbox"/> Other:</p>					
9. HAZARDOUS WASTE DISPOSED (Include EPA Hazardous Waste Numbers)					
Tetrachloroethene (PCE) (F002/U210), Trichloroethene (TCE) (F002/U228), and cis-1,2-dichloroethene (U079) were found in the groundwater immediately south of the building on the property and within the indoor air and sub-slab vapor in the building and in soil vapor west and south of the building. Laundromat liquid wastes discharge to the on-site septic and then to the municipal sewer.					
10. ANALYTICAL DATA AVAILABLE <input checked="" type="checkbox"/> Air <input checked="" type="checkbox"/> Groundwater <input type="checkbox"/> Surface Water <input type="checkbox"/> Sediment <input checked="" type="checkbox"/> Soil <input type="checkbox"/> Waste <input type="checkbox"/> Leachate <input type="checkbox"/> EPTox <input type="checkbox"/> TCLP					
<p>The primary contaminant of concern at the site is tetrachloroethene (PCE) and its degradation products. PCE was detected at 26 ppb in soil directly underneath the former dry cleaning equipment location in unit 181. No detections were found to be above the soil cleanup objective (1.3ppm) in soils during the PSA. Investigations have found PCE (up to 180 ppb) in the shallow onsite groundwater (approximately 14 ft below ground surface) above the NYSDEC groundwater standard (5 ppb) south (in the direction of groundwater flow) of unit 181. Investigations indicate a plume of groundwater contamination with PCE and its degradation products that extends towards the south, to the property border. PCE was found in sub-slab vapor below unit 181 at elevated levels (14,900 ug/m3). PCE was detected in soil vapor to the west and south (73.8 ug/m3 at SV-1, 71.3 ug/m3 at SV-2) of unit 181. This site does not present a significant threat to the environment.</p>					
11. CONCLUSION					
Documented exceedances of the SCGs for PCE, TCE, and DCE in groundwater and sub-slab soil vapor/ indoor air and the relative shallow depth to groundwater, present a significant threat to the public health. The site should be listed as Class 2 and an RI/FS investigation begun.					
<i>If Institutional Controls are Required: describe:</i>			<i>If so, are they documented? Y () N ()</i>		
12. SITE DATA					
a. Nearest Surface Water: Distance <u>1000</u> ft.		Direction <u>East</u>		ID & Classification <u>C</u>	
b. Nearest Groundwater: Depth <u>12</u> ft.		Flow Direction <u>South</u>		<input checked="" type="checkbox"/> Sole Source <input type="checkbox"/> Primary <input type="checkbox"/> High Yield <input type="checkbox"/> Low Yield <input type="checkbox"/> Non Yield	
c. Nearest Water Supply: Distance <u>~550</u> ft.		Direction <u>North</u>		Active <input checked="" type="checkbox"/> Yes <input type="checkbox"/> No Character: _____	
d. Nearest Building: Distance <u>0</u> ft.		Direction <u>On-Site</u>		Use <u>Commercial</u>	
e. Documented fish or wildlife mortality?		<input type="checkbox"/> Y <input checked="" type="checkbox"/> N		h. Exposed hazardous waste? <input type="checkbox"/> Y <input checked="" type="checkbox"/> N	
f. Impact on special status fish or wildlife resource?		<input type="checkbox"/> Y <input checked="" type="checkbox"/> N		i. EPA ID # <u>NA</u> HRS Score <u>NA</u>	
g. Controlled Site Access?		<input type="checkbox"/> Y <input checked="" type="checkbox"/> N		j. WEB site address:	
13. SITE OWNER'S NAME Elks Plaza, LLC, George Tsilogiannis		14. ADDRESS 28 Campbell Drive, Dix Hills, NY 11746		15. TELEPHONE NUMBER 631-462-8621	
16. PREPARER			17. APPROVED		
Signature _____ Date _____			Signature _____ Date _____		
Melissa Sweet, Environmental Engineer, NYSDEC- DER, Bureau A			John Swartwout, P.E., Bureau A, Section C Chief, NYSDEC- DER		
Name, Title, Organization			Name, Title, Organization		



— Site Boundary

Figure 1
Site Location and Boundaries Map

Elks Plaza 157-189 W. Merrick Road
Freeport, Nassau County, New York

Source: Preferred Environmental, Site Characterization Report, 2010



Created by: MLS
 Date: 2/17/2011



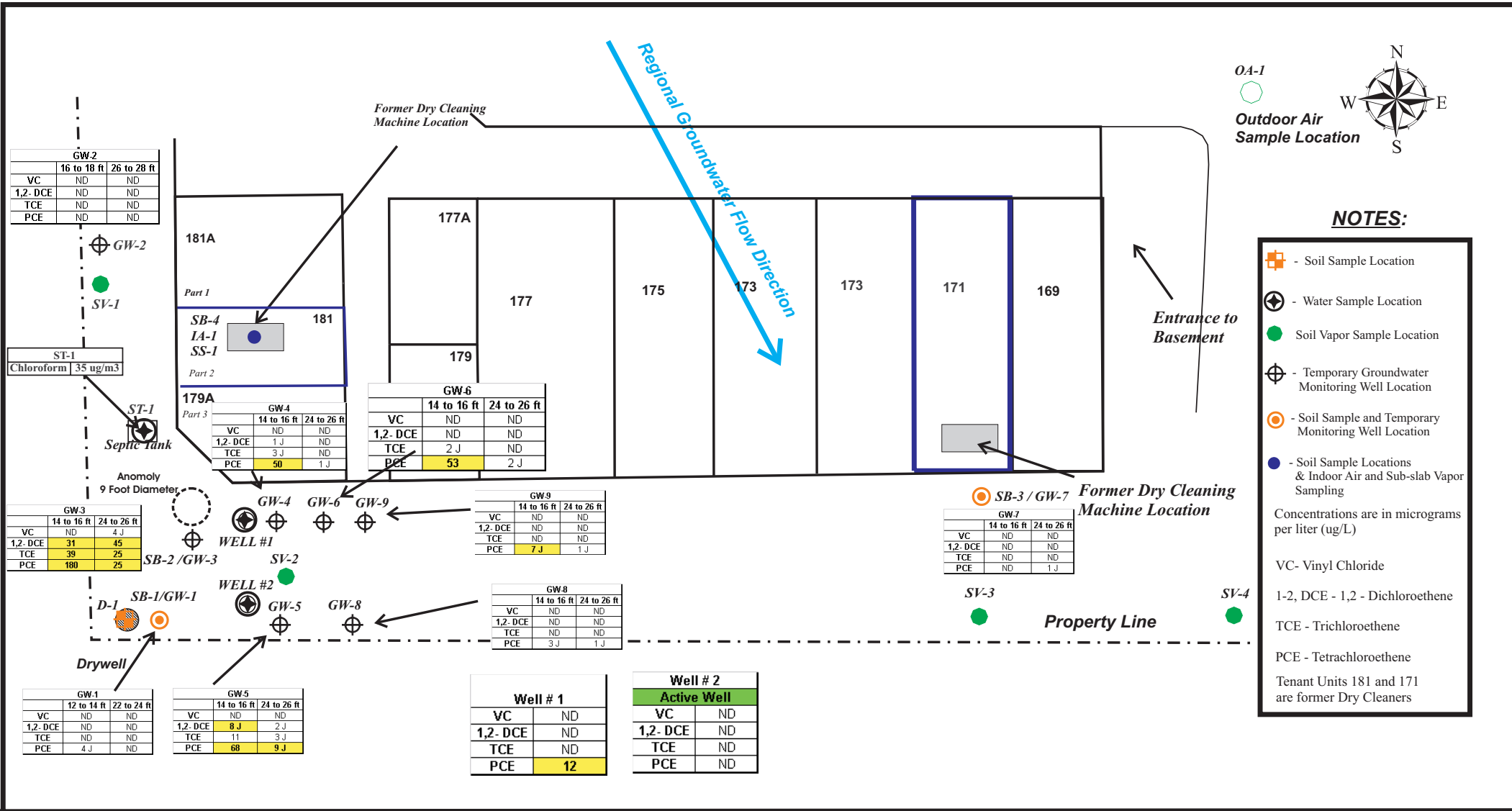

Figure 6- April 2009 - Groundwater, Septic Tank and Private Supply Well Sampling Data



323 Merrick Avenue - North Merrick, New York 11566
 Tel: (516) 546-1100 Fax : (516) 213-8156

Client: Elks Plaza, LLC.

Date: April 2009

Site: 157-189 West Merrick Road
 Freeport, New York

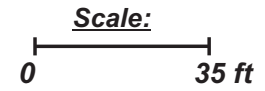

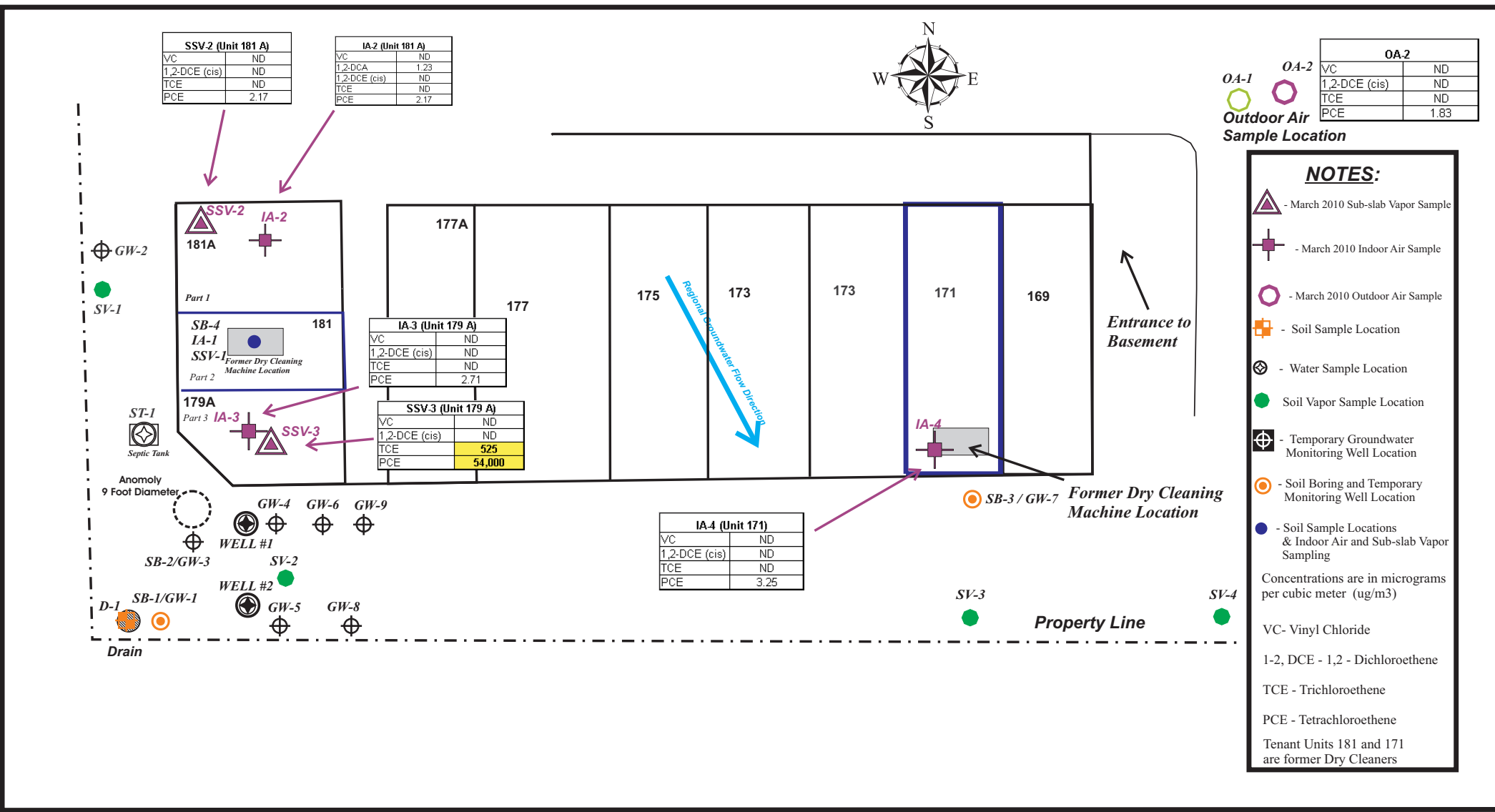

Figure 5 - March 2010 Subslab Vapor, Indoor Air and Outdoor Air Sampling Data



323 Merrick Avenue - North Merrick, New York 11566
 Tel: (516) 546-1100 Fax: (516) 213-8156

Client: Elks Plaza, LLC.

Date: March 16, 2010

Site: 157-189 West Merrick Road
 Freeport, New York

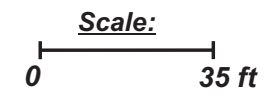

Elks Plaza (Site No. 130193)

Contaminants of Concern- Maximum Detections in Relevant Media

Contaminant	Max Conc	SCG	Sample ID	Sample Date
Groundwater		Class GA		
PCE	180 ug/L	5 ug/L	GW-3 (14-16)	4/2009
TCE	39 ug/L	5 ug/L	GW-3 (14-16)	4/2009
1,2-DCE	45 ug/L	5 ug/L	GW-3 (24-26)	4/2009
Soil		Part 375-6.8a		
PCE	26 ug/kg	1300 ug/kg	SB-4	4/2009
Soil Vapor		NA		
PCE	73.8 ug/m ³	-	SV-1	4/2009
TCE	46.7 ug/m ³	-	SV-2	4/2009
1,2-DCE	22.3 ug/m ³	-	SV-2	4/2009
Sub-Slab Vapor		NYSDOH SS/IA Matricies		
PCE	54000 ug/m ³	Mitigate	SSV-3	5/2010
TCE	525 ug/m ³	Mitigate	SSV-3	5/2010
Indoor Air		NYSDOH SS/IA Matricies		
PCE	3.33 ug/m ³	Mitigate	IA-1	4/2009



APPENDIX 2-1: SSF SITE CLASSIFICATION WORKSHEET



Site Name: Elks Plaza Site ID No. 130193

City/Town: Hempstead County: Nassau

1. Has remediation been completed in accordance with a ROD including properly addressing institutional controls (ICs)?	<input type="checkbox"/> Yes (go to 7)	<input checked="" type="checkbox"/> No (go to 2)	
2. Has hazardous waste as defined in ECL §27-1301.1 been disposed at the Site?	<input checked="" type="checkbox"/> Yes (go to 3)	<input type="checkbox"/> No (stop)	Unsure (go to 11)
3. Does the Site present a current or reasonably foreseeable significant threat to public health or the environment (complete Significant Threat Determination Worksheet)?	<input checked="" type="checkbox"/> Yes (go to 4)	<input type="checkbox"/> No (go to 6)	<input type="checkbox"/> Unsure (go to 11)
4. Is the significant threat causing or presenting an imminent danger of causing irreversible or irreparable damage to public health or the environment?	<input type="checkbox"/> Yes (Class 1)	<input checked="" type="checkbox"/> No (go to 5)	<input type="checkbox"/> Unsure (stop)
5. Is the Site presenting a significant but not imminent threat to public health or the environment?	<input checked="" type="checkbox"/> Yes (Class 2)	<input type="checkbox"/> No (reevaluate)	
6. Has hazardous waste been disposed but it does not present a significant threat to public health or the environment and the site is suitable for placement on the Registry?	<input type="checkbox"/> Yes (Class 3)	<input type="checkbox"/> No (go to 10)	
7. Is the site properly remediated but still requires continued active site management to maintain/achieve protectiveness?	<input type="checkbox"/> Yes (Class 4)	<input type="checkbox"/> No (go to 8)	<input type="checkbox"/> Unsure (stop)
8. Is the site properly remediated, does not require continued active site management, but is not suitable for delisting or a required IC is not yet in place?	<input type="checkbox"/> Yes (Class 5)	<input type="checkbox"/> No (go to 9)	<input type="checkbox"/> Unsure (stop)
9. Is the site properly remediated, required ICs are in place, the site does not require continued active site management, and is suitable for delisting?	<input type="checkbox"/> Yes (Class: C)	<input type="checkbox"/> No (go to 10)	<input type="checkbox"/> Unsure (stop)
10. Based upon investigation, is the degree of contamination such that the Site does not qualify to be placed on the Registry and that additional remedial work is not anticipated at this time?	<input type="checkbox"/> Yes (Class: N)	<input type="checkbox"/> No (reevaluate)	<input type="checkbox"/> Unsure (stop)
11. Does insufficient information exist to properly classify the site?	<input type="checkbox"/> Yes (Class P)	<input type="checkbox"/> No (reevaluate)	<input type="checkbox"/> Unsure (stop)

Current Classification: P

Proposed Classification: 2

Summary of Main Factors Contributing to this Determination: The primary factors supporting the classification should be entered in the UIS under "Basis for Class Change/ Significant Threat Determination." For Class 2 determinations, clearly identify what hazardous waste has been disposed and the basis for the significant threat determination (see Appendix 2-2). For other classifications, explain what criteria have been met that justify the reclassification.

Melissa L. Sweet/Environmental Engineer
Project Manager Name/Title - Print

Melissa Sweet
Project Manager Name - Signature

1/25/2011
Date

Jim Harrington, Bureau Director
Bureau Director/RHWRE Name/Title - Print

[Signature]
Bureau Director/RHWRE Name - Signature

1/26/2011
Date



APPENDIX 2-2: SIGNIFICANT THREAT DETERMINATION WORKSHEET



State Superfund Program
6 NYCRR 375-2.7

Brownfield Cleanup Program
ECL 27-1411.1(c)

Site Name: Elks Plaza Site ID No. 130193

City/Town: Hempstead County: Nassau

1. Has all available and relevant evidence regarding the Site been reviewed and the factors in 375-2.7(a)(3) considered?	<input checked="" type="checkbox"/> Yes (go to 2)	<input type="checkbox"/> No (stop)	<input type="checkbox"/> Unsure (stop)
2. Does Site contamination result in significant adverse impacts (375-2.7(a)(1)) to:			
a. species that are endangered, threatened, or of concern?	<input type="checkbox"/> Yes (go to b)	<input checked="" type="checkbox"/> No (go to b)	<input type="checkbox"/> Unsure (go to b)
b. protected streams, tidal/freshwater wetlands, or significant fish and wildlife habitat?	<input type="checkbox"/> Yes (go to c)	<input checked="" type="checkbox"/> No (go to c)	<input type="checkbox"/> Unsure (go to c)
c. flora or fauna from bioaccumulation or leads to a recommendation to limit consumption?	<input type="checkbox"/> Yes (go to d)	<input checked="" type="checkbox"/> No (go to d)	<input type="checkbox"/> Unsure (go to d)
d. fish, shellfish, crustacea, or wildlife from concentrations that cause adverse/chronic effects?	<input type="checkbox"/> Yes (go to e)	<input checked="" type="checkbox"/> No (go to e)	<input type="checkbox"/> Unsure (go to e)
e. the environment due to a fire, spill, explosion, or reaction that generates toxic gases, vapors, fumes, mists or dusts?	<input type="checkbox"/> Yes (go to f)	<input checked="" type="checkbox"/> No (go to f)	<input type="checkbox"/> Unsure (go to f)
f. areas where individuals or water supplies may be present and NYSDOH has determined there to be a significantly increased risk to public health (including from soil vapor)?	<input checked="" type="checkbox"/> Yes (go to 3)	<input type="checkbox"/> No (go to 3)	<input type="checkbox"/> Unsure (go to 3)
3. Does Site contamination result in significant environmental damage (375-2.7(a)(2))?	<input type="checkbox"/> Yes (go to 4)	<input checked="" type="checkbox"/> No (go to 4)	<input type="checkbox"/> Unsure (stop)
4. If any box in items 2 or 3 have been checked "Yes," the site presents a significant threat to public health or the environment; check here.	Significant threat to: <input checked="" type="checkbox"/> Public Health <input type="checkbox"/> Environment		
5. If no boxes in items 2 or 3 have been checked "Yes," the site does not present a significant threat to public health or the environment; check here.	<input type="checkbox"/> Not a Significant Threat		

Summary of Main Factors Contributing to this Determination: For Class 2 or BCP significant threat determinations, the main factors leading to the positive significant threat determination should be entered into the UIS under "Basis for Class Change/ Significant Threat Determination." Specify the threat(s) and explain what contaminants, pathways, routes, and/or impacts create the threat (e.g., "High levels of PCE contamination in soil (averaging 2700 ppm in the disposal area) has resulted in significant contamination of shallow groundwater in a sole source aquifer (concentrations exceed 1000 ppb in a 2 acre area both on and off-site) creating a significant threat to the environment. Public health exposures due to the potential for groundwater consumption and exposure to contaminated indoor air from vapor intrusion creates a reasonably foreseeable significant threat to public health."

Melissa L. Sweet/Environmental Engineer Melissa L. Sweet 2/17/2011
Project Manager Name/Title (Print) Project Manager Name (Signature) Date

Jim Harrington, Bureau Director Jim Harrington 2/17/2011
Bureau Director/RHWRE Name/Title (Print) Bureau Director/RHWRE Name (Signature) Date

APPENDIX 6-1

UIS CHECKLIST FOR COMPLETING RECLASSIFICATIONS/ISSUING A CoC

SITE NAME: Elks Plaza SITE ID # 130193

Verify/Update Remedial Site Information - Project update guidance for sites descriptions, environmental assessments as well as basis for classification/threat statements may be found at the following internal web address: <http://internal/home/der/comp/update.html>

- Site Description** (on main site page)
- Site Environmental Assessment** (on main site page)
- Site Health Assessment** (on main site page): requested from DOH by the DER PM, entered by SCS
- Site Name, Address, & Size** (on main site page): verify and notify SCS to make adjustments
- Contacts** (on main site page): verify that all affiliation information is accurate, up to date, and complete
- ~~**Easement Identifier** (via Cross Refs link on main site page): enter County Recording Identifier~~
- Agreement/Order Ref. No.** (via Cross Refs link on main site page): W1-1120-08-04
- ~~**BCP Clean Up Track** (on main site page for BCP sites): select track via drop down~~
- ~~**BCP Off-Site Status** (via Extra Details link on main site page) select via drop down~~
- Allowable Use** (on main site page): verify most restrictive use allowed via drop down, entered by SCS
- ~~**Percent Enzone** (via Extra Details link on main site page) verify for BCP sites via drop down~~

IC/EC Module

- Verify that property information is complete and accurate for all parcels (*see also IGP-8, Reference 7*)
- Verify that owner information is complete and accurate for all parcels
- Verify that contact information is complete and accurate (this will be the certifying party)
- Add Control information, as applicable (if none, check "No Controls Needed" box on site property details page)
 - i. ICs - indicate all types used for the site
 - ii. ECs - indicate all types used for the site
 - iii. Dates - enter all applicable dates, especially "Control In Place" date (= date filed with County Clerk)
 - iv. Control Description - provide a summary of restrictions not copy of easement language

UIS Projects (verify start and end dates, status (PLN/ACT) for all projects, especially:

- Remedial Investigation/Design/Action
- ~~Certificate of Completion~~
- ~~Site Management~~
- ~~Periodic Review~~
- ~~Create next OU and projects for BCP off site contamination, if appropriate~~

4. **eDocs** (verify that all applicable documents, or equivalent, are present and properly named in eDocs for the site)

- Agreement/Order/SAC** (e.g., agreement.C231011.2006-01-01.BCA.pdf)
- ~~**Environmental Easement/Deed Restr.** w/County Clerk Certificate (e.g., easement.130058.2006-01-01.pdf)~~
- ~~**Final Engineering Report** (e.g., report.E915182.2006-01-01.FER.pdf)~~
- ~~**Site Management Plan** (e.g., workplan.130058.2006-01-01.SMP.pdf)~~
- ~~**Certificate of Completion/Release Letter** (e.g., coc.C231011.2006-01-01.pdf)~~
- Site Boundaries** - Provide site drawing, tax map, or aerial photograph that clearly indicates the site boundaries and sufficient surrounding features such as waterbodies, roads, and railways needed to locate and define site.

5. **Site Reclassification** (when all of the items listed above are completed as appropriate)

- ~~BCP, VCP, ERP, SRP to be reclassified to "C" by SCS if no off site remediation is required~~
- Supervisory Review Complete checkbox - checked after all updates to enable export to public website
- HW Registry - package prepared per IGP-6 and sent to SCS for processing

Property Owner and Associates

George Tsilogianis	Elks Plaza LLC	28 Campbell Drive	Dix Hills	NY	11746
Suzanne M. Avena	Garfunkel, Wild, & Travis, P.C.	111 Great Neck Road, Suite 503	Great Neck	NY	11021
Jill Haimson	Preferred Environmental	323 Merrick Avenue	North Merrick	NY	11566

Name	Agency	Street	City	State	Zip Code	E-Mail
Public Informtion Specialist	Nassau County Department of Health	106 Charles Lindbergh Blvd.	Uniondale	New York	11553	
Joe DeFranco	Nassau County Department of Health	106 Charles Lindbergh Blvd.	Uniondale	New York	11553	
Honorable Edward P. Mangano	Nassau County Executive	1550 Franklin Avenue	Mineola	New York	11501	
Honorable Joseph Scannell	Nassau County Legislature	1550 Franklin Avenue	Mineola			
Honorable David Denenberg	Nassau County Legislature	1550 Franklin Avenue	Mineola	New York	11501	ddenenberg@nassaucountyny.gov
Honorable Kate Murray	Town of Hempstead Supervisor	Town Hall - 1 Washington Street	Hempstead	New York	11550	
Honorable Dorothy L. Goosby	Town of Hempstead Town Council	Town Hall - 1 Washington Street	Hempstead	New York	11550	
Honorable Charles J. Fuschillo	New York State Senate	5550 Merrick Road - Suite 205	Massapequa	New York	11758	fuschill@senate.state.ny.us
Honorable Dean G. Skelos	New York State Senate	55 Front Street	Rockville Centre	New York	11570	skelos@senate.state.ny.us
Honorable Robert Barra	New York State Assembly	534 Merrick Road	Lynbrook	New York	11563	barrar@assembly.state.ny.us
Honorable Earlene Hooper	New York State Assembly	50 Clinton Street - Suite 214	Hempstead	New York	11550	
Honorable David G. McDonough	New York State Assembly	404 Bedford Avenue	Bellmore	New York	11710	mcdonod@assembly.state.ny.us
Ms. Vicki Metz	WABC-TV	100 Supreme Court Drive	Mineola	New York	11501	
News 12	Assignment Desk	1 Media Crossways	Woodbury	New York	11797	
Ms. Jennifer Smith	Newsday	235 Pinelawn Avenue	Melville	New York	11747	
Newsday	Assignment Desk	235 Pinelawn Avenue	Melville	New York	11747	
Paul Laursen	Freeport Leader	1840 Merrick Avenue	Merrick	New York	11566	lmedit@optonline.net
Mr. Melissa L. Sweet	NYSDEC	625 Broadway - 11th Floor	Albany	New York	12233	
Mr. Bill Fonda	NYSDEC - SUNY at Stony Brook	50 Circle Road	Stony Brook	New York	11790	
Mr. Walter Parish	NYSDEC - SUNY at Stony Brook	50 Circle Road	Stony Brook	New York	11790	
Msl Jacquelyn Nealon	New York State Department of Health	547 River Street - Room 300	Troy	New York	12180	
Ms. Adrienne Esposito	Citizens Campaign for the Environment	225A Main Street	Farmingdale	New York	11743	
Ms. Sarah Lansdale	Sustainable Long Island	45A Seaman Avenue	Bethpage	New York	11714	
Mr. Bill Stegemann	Conservation Chair - Sierra Club					billstegemail@gmail.com
Baldwin Herald	Editor	52 Endo Boulevard	Garden City	New York	11530	
Mayor Andrew Hardwick	Village of Freeport	46 N. Ocean Avenue	Freeport	New York	11520	
Superintendent	Village of Freeport - Water Department	46 N. Ocean Avenue	Freeport	New York	11520	
		West Merrick Road and S. Ocean Ave.				
Director	Freeport Memorial Library		Freeport	New York	11520	
Community Development	Village of Freeport	46 N. Ocean Avenue	Freeport	New York	11520	
Delano H. Stewart	Point of View	P.O. Box 1685	Wyandanch	New York	11798	
Editor	Noticia Hispanoamericana	636 W. Seaman Avenue	Baldwin	New York	11510	
Editor	La Tribuna Hispana USA	P.O. Box 186	Hempstead	New York	11550	
Editor	Enfoque Latino	250 Fulton Avenue	Hempstead	New York	11550	
Mr. Kishore Kuncham, Ed.D. - Superintendent of Schools						
	Freeport Public Schools	58 W. Seaman Avenue	Freeport	New York	11520	
Director	Hi-Hello Child Care Center	212 South Ocean Avenue	Freeport	New York	11520	

Adjacent Properties

Name	Address	City	State	ZIP/Postal
NY Elite Limousine	165 W. Merrick Rd	Freeport	ny	11520
Bank of America	189 W. Merrick Rd	Freeport	NY	11520

Jade Garden Chinese Food	173 W. Merrick Rd	Freeport	NY	11520
99c Super Discount Store	173 W. Merrick Rd	Freeport	NY	11520
Blue Star Restorations Inc	172 S Long Beach Ave	Freeport	NY	11520
Bozza John	172 S Long Beach Ave	Freeport	NY	11520
Carotenuto & Yanover Business Service	140 S Long Beach Ave	Freeport	NY	11520
Cascardi Frank	148 S Long Beach Ave	Freeport	NY	11520
Cheyney J W	171 S Long Beach Ave	Freeport	NY	11520
Christin Hegenister	140 S Long Beach Ave	Freeport	NY	11520
Davidson Steed	163 S Long Beach Ave	Freeport	NY	11520
Healthcare Automation Services	140 S Long Beach Ave	Freeport	NY	11520
Henderson Dolores	163 S Long Beach Ave	Freeport	NY	11520
Martin & Molinari	148 S Long Beach Ave	Freeport	NY	11520
Masters John F	140 S Long Beach Ave	Freeport	NY	11520
Mishke Donald	160 S Long Beach Ave	Freeport	NY	11520
Nassau Police Conference Inc	140 S Long Beach Ave	Freeport	NY	11520
R Elizabeth Urena Urena	148 S Long Beach Ave	Freeport	NY	11520
Aai American Agency Inc	140 S Ocean Ave	Freeport	NY	11520
Abreu Rosa	161 S Ocean Ave	Freeport	NY	11520
American Agency Inc	140 S Ocean Ave	Freeport	NY	11520
Antonio Perla S	131 S Ocean Ave	Freeport	NY	11520
Appelgate Ray D Agency Inc	140 S Ocean Ave	Freeport	NY	11520
Atela Thomas	150 S Ocean Ave	Freeport	NY	11520
Ayroso Crispin Jr	131 S Ocean Ave	Freeport	NY	11520
Barbato Wm G	150 S Ocean Ave	Freeport	NY	11520
Bredehoft R	150 S Ocean Ave	Freeport	NY	11520
Canale & Tellekamp Cpas	140 S Ocean Ave	Freeport	NY	11520
Cannizzaro Lena	150 S Ocean Ave	Freeport	NY	11520
Dominguez	150 S Ocean Ave	Freeport	NY	11520
Donnelly Stephen	150 S Ocean Ave	Freeport	NY	11520
Durham M	150 S Ocean Ave	Freeport	NY	11520
Edwards A	155 S Ocean Ave	Freeport	NY	11520
Gahn Charles Jr	150 S Ocean Ave	Freeport	NY	11520
Hernandez R	150 S Ocean Ave	Freeport	NY	11520
Hernandez Salustina	157 S Ocean Ave	Freeport	NY	11520
Hubbard M	150 S Ocean Ave	Freeport	NY	11520
Ingenito T J	150 S Ocean Ave	Freeport	NY	11520
Jackson Carolyn A	150 S Ocean Ave	Freeport	NY	11520
Ladden Jerome	150 S Ocean Ave	Freeport	NY	11520
Lisowski Michele	150 S Ocean Ave	Freeport	NY	11520
Lovelass V J	150 S Ocean Ave	Freeport	NY	11520
Martinez Jose	157 S Ocean Ave	Freeport	NY	11520
Mc Cormick William	150 S Ocean Ave	Freeport	NY	11520
Mc Elynn	150 S Ocean Ave	Freeport	NY	11520
Mc Elynn T J	150 S Ocean Ave	Freeport	NY	11520
Moore Thomas O Agency	140 S Ocean Ave	Freeport	NY	11520
Offner Glenn	150 S Ocean Ave	Freeport	NY	11520
Parro V	150 S Ocean Ave	Freeport	NY	11520
Paulino Isidra	155 S Ocean Ave	Freeport	NY	11520
Potter Antonia	150 S Ocean Ave	Freeport	NY	11520
Rodriguez Vicente	155 S Ocean Ave	Freeport	NY	11520
Russo A	150 S Ocean Ave	Freeport	NY	11520

Samuel R	150 S Ocean Ave	Freeport	NY	11520
Tejada Maria E	155 S Ocean Ave	Freeport	NY	11520
Wall Marie	150 S Ocean Ave	Freeport	NY	11520
Williams	150 S Ocean Ave	Freeport	NY	11520
Yadda L	150 S Ocean Ave	Freeport	NY	11520
Zwickler Arlen	150 S Ocean Ave	Freeport	NY	11520
Zwolak Michael	150 S Ocean Ave	Freeport	NY	11520
30 Minute Photo	185A W Merrick Rd	Freeport	NY	11520
Alasaas Chona	190 W Merrick Rd	Freeport	NY	11520
Allstate Insurance Companies	149 W Merrick Rd	Freeport	NY	11520
Anywhere A Locksmith Service	187 W Merrick Rd	Freeport	NY	11520
Argueta Maria	200 W Merrick Rd	Freeport	NY	11520
Babu Wine and Liquor	169 W Merrick Rd	Freeport	NY	11520
Barientos Manuel	200 W Merrick Rd	Freeport	NY	11520
Barraza Jose	200 W Merrick Rd	Freeport	NY	11520
Becker Kenneth	155 W Merrick Rd Ste 202	Freeport	NY	11520
Best Idea Incorporated	147 W Merrick Rd	Freeport	NY	11520
Bouknight George	190 W Merrick Rd	Freeport	NY	11520
Builis Leontina	190 W Merrick Rd	Freeport	NY	11520
Canavan F	190 W Merrick Rd	Freeport	NY	11520
Carty Keith	190 W Merrick Rd	Freeport	NY	11520
Casa Global Realty Corp	126 W Merrick Rd	Freeport	NY	11520
Castro Robert	200 W Merrick Rd	Freeport	NY	11520
Cesare Michelle	190 W Merrick Rd	Freeport	NY	11520
Chan Johnson	190 W Merrick Rd	Freeport	NY	11520
Charles Marc Anthony Louis	151 W Merrick Rd	Freeport	NY	11520
Chicaiza Jenny	200 W Merrick Rd	Freeport	NY	11520
Chiu Peter C	190 W Merrick Rd	Freeport	NY	11520
Chumpitaz Jesus	190 W Merrick Rd	Freeport	NY	11520
Citibank	180 W Merrick Rd	Freeport	NY	11520
Corears Jose	200 W Merrick Rd	Freeport	NY	11520
Corrales Francisco	190 W Merrick Rd	Freeport	NY	11520
Delakas Andrea	200 W Merrick Rd	Freeport	NY	11520
Delia John A	149 W Merrick Rd	Freeport	NY	11520
Diaz Faustino	200 W Merrick Rd	Freeport	NY	11520
Donovan Melissa	190 W Merrick Rd	Freeport	NY	11520
Drzewucki L	190 W Merrick Rd	Freeport	NY	11520
Ebony Beauty Supply	171 W Merrick Rd	Freeport	NY	11520
Esperanza Marlene	200 W Merrick Rd	Freeport	NY	11520
Eye World Optical Inc	185 W Merrick Rd	Freeport	NY	11520
Fai Cheung	181 W Merrick Rd	Freeport	NY	11520
Feinman David	190 W Merrick Rd	Freeport	NY	11520
Fields B L	190 W Merrick Rd	Freeport	NY	11520
Fields Dana	190 W Merrick Rd	Freeport	NY	11520
First Residential Mortgage Service	126 W Merrick Rd	Freeport	NY	11520
Fischetto Timothy	200 W Merrick Rd	Freeport	NY	11520
Five Star Nail	183 W Merrick Rd	Freeport	NY	11520
Freeport Gulf Station	131 W Merrick Rd	Freeport	NY	11520
Freeport Memorial Library	144 W Merrick Rd	Freeport	NY	11520
Freeport Novelty Corp	183A W Merrick Rd	Freeport	NY	11520
Friel John	190 W Merrick Rd	Freeport	NY	11520

Gina Lennon Associates Inc	190 W Merrick Rd Apt 4R	Freeport	NY	11520
Gonzalez Gary	190 W Merrick Rd	Freeport	NY	11520
Gottlieb Stephen	190 W Merrick Rd	Freeport	NY	11520
Grenot P	190 W Merrick Rd	Freeport	NY	11520
Gualda Ricardo	190 W Merrick Rd	Freeport	NY	11520
Harrington Richd P	190 W Merrick Rd	Freeport	NY	11520
Harrison Brenda	190 W Merrick Rd	Freeport	NY	11520
Hernandez Miguel	200 W Merrick Rd	Freeport	NY	11520
Iriarte Nohemi	200 W Merrick Rd	Freeport	NY	11520
Joint Healthcare Professional S	201 W Merrick Rd	Freeport	NY	11520
Kane M	190 W Merrick Rd	Freeport	NY	11520
Krull R J	147 W Merrick Rd	Freeport	NY	11520
La Piana M	190 W Merrick Rd	Freeport	NY	11520
Living Natural	177 W Merrick Rd	Freeport	NY	11520
Lyle A	190 W Merrick Rd	Freeport	NY	11520
Malone Tauber & Sohn P C	147 W Merrick Rd	Freeport	NY	11520
Markland Antoinette	190 W Merrick Rd	Freeport	NY	11520
Mc Elhearn Sheila	190 W Merrick Rd	Freeport	NY	11520
McCally Daniel S	155 W Merrick Rd Ste 204	Freeport	NY	11520
McDonald's Restrnt	157 W Merrick Rd	Freeport	NY	11520
McLean Violet	190 W Merrick Rd	Freeport	NY	11520
Mikes William	190 W Merrick Rd	Freeport	NY	11520
Morgan Denis	190 W Merrick Rd	Freeport	NY	11520
Morgan Gabriele	190 W Merrick Rd	Freeport	NY	11520
Morshe Bagles Inc	177 W Merrick Rd	Freeport	NY	11520
Nassau Johren's Registry Agency	147 W Merrick Rd	Freeport	NY	11520
New York Physical Therapy Pc	131 W Merrick Rd	Freeport	NY	11520
Nichols D	190 W Merrick Rd	Freeport	NY	11520
Northeast Atlantic Consulting	147 W Merrick Rd	Freeport	NY	11520
One Food Court The	177 W Merrick Rd	Freeport	NY	11520
Orellana Navi R	200 W Merrick Rd	Freeport	NY	11520
Ostuni John A MD	155 W Merrick Rd	Freeport	NY	11520
Pena Rosario	200 W Merrick Rd	Freeport	NY	11520
Perez Lemuer	200 W Merrick Rd	Freeport	NY	11520
Pinkus D	190 W Merrick Rd	Freeport	NY	11520
Raimo's Pizza & Restaurant	187A W Merrick Rd	Freeport	NY	11520
Ramirez Sara	200 W Merrick Rd	Freeport	NY	11520
Remax Action	147 W Merrick Rd	Freeport	NY	11520
Rivas Jorge	200 W Merrick Rd	Freeport	NY	11520
Rosales Mario C	200 W Merrick Rd	Freeport	NY	11520
Ryan Edw F	190 W Merrick Rd	Freeport	NY	11520
Saft L	190 W Merrick Rd	Freeport	NY	11520
Schlecter Gerald	147 W Merrick Rd	Freeport	NY	11520
Schmidt L	190 W Merrick Rd	Freeport	NY	11520
Singh Merlin	190 W Merrick Rd	Freeport	NY	11520
Smart N	190 W Merrick Rd	Freeport	NY	11520
Solano R	200 W Merrick Rd	Freeport	NY	11520
South Nassau Internal Medicine Assocs	155 W Merrick Rd Ste 101	Freeport	NY	11520
South Shore Medical & Rehabilitation	175 W Merrick Rd	Freeport	NY	11520
Steinberg Robert B	147 W Merrick Rd	Freeport	NY	11520
Summit Dental	147 W Merrick Rd	Freeport	NY	11520

Swartz Louis	155 W Merrick Rd Ste 202	Freeport	NY	11520
Wallace L	190 W Merrick Rd	Freeport	NY	11520
Woodward Mental Health Center	201 W Merrick Rd	Freeport	NY	11520
Xtc Salon Inc	179 W Merrick Rd	Freeport	NY	11520
Zammit Michael	190 W Merrick Rd	Freeport	NY	11520