

**DAILY INSPECTION REPORT - No. 015**  
**(Lawrence Aviation), Site No. 152016**

Page 1 of 8  
 Date: 02/11/2025

NYSDEC Division of Environmental Remediation		 Department of Environmental Conservation		<b>Contract No.</b>  <b>DEC Insp.</b> DEC PM – Payson Long, P.E. GES PM. – Scott McDonald HRP Engineer PM – Tom Battles HRP PM – Derek Roy	
<b>Site Location: NYSDEC Lawrence Aviation, Port Jefferson Station, NY</b>					
<b>Weather Conditions</b>					
<b>General Description</b>	Sunny	AM	Sunny	PM	
<b>Temperature</b>	23 F	AM	33 F	PM	
<b>Wind</b>	0-1 mph NW	AM	0-2 mph	PM	
<b>Health &amp; Safety</b> <b>If any box below is checked “Yes”, provide explanation under “Health &amp; Safety Comments”.</b>					
Were there any changes to the Health & Safety Plan?				*Yes	No NA
Were there any exceedances of the perimeter air monitoring reported on this date?				*Yes	No NA
Were there any nuisance issues reported/observed on this date?				*Yes	No NA
<b>Health &amp; Safety Comments</b> Conducted daily tailgate meeting, conduct drive around to check for trespassers, check for access issues/ icy areas.					
<b>Summary of Work performed</b>		Arrived at site:	<b>0630</b>	Departed Site:	<b>1615</b>
<p>0630 – Pawel Mecinski, Donald Custer (GES) onsite. Unlocked Park Ave Gate. Highground Industrial (HGI) personnel onsite. Held H&amp;S meeting                  0700 – Sarah Boison (HRP) on site.</p> <p>-Set up and run 4 CAMP stations for VOC and dust monitoring. No abnormal readings during work shift duration.                  -HGI excavated concrete domes from DW-1A and DW-1 structures and backfilled with clean sand fill material.                  -HGI excavated concrete dome from Cess-6A and backfilled the structure with clean sand fill.                  -HGI investigated and uncovered Cess-14 septic tank, northwest of Pit-7/8. Cess-14 is 7 ft. long, 11 ft. wide, and 6.5 ft. deep (from top of concrete cover). HRP sampled the contents. Hole on western side of septic tank implies a pipe may have traversed beneath roadway. Planning to explore area west of roadway following utility markout.</p> <p>-Posillico delivered 12 loads of sand fill material throughout the day.                  1545- Take down CAMPS</p> <p>1600- HGI crew offsite.                  1615 – All personnel offsite. Locked gates, system shed.</p>					

[illegible]

**Equipment/Material Tracking Comments:**

None.

**Visitors to Site**

Name	Representing	Entered Exclusion/CRZ Zone	
Fill delivery personnel		Yes	No
		Yes	No
		Yes	No

**Site Representatives**

None	

**Project Schedule Comments**

- Utility markout scheduled for Thursday (2/13). Plan to mark utilities west of Cess-14 and near the Former Propane Building.
- Drilling scheduled for Thursday (2/13).

**Issues Pending**

None.

**Interaction with Public, Property Owners, Media, etc.**

None.

**Include (insert) figures with markups showing location of work and job progress**

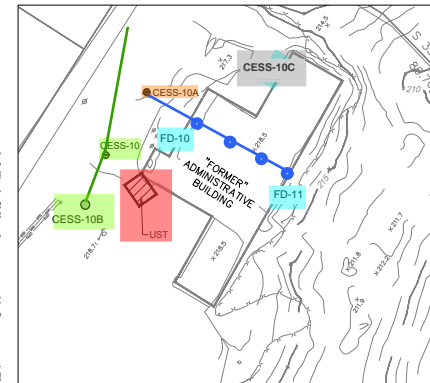
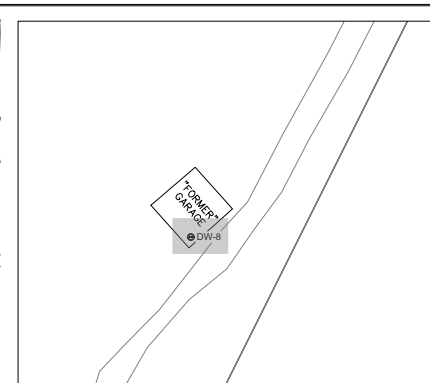
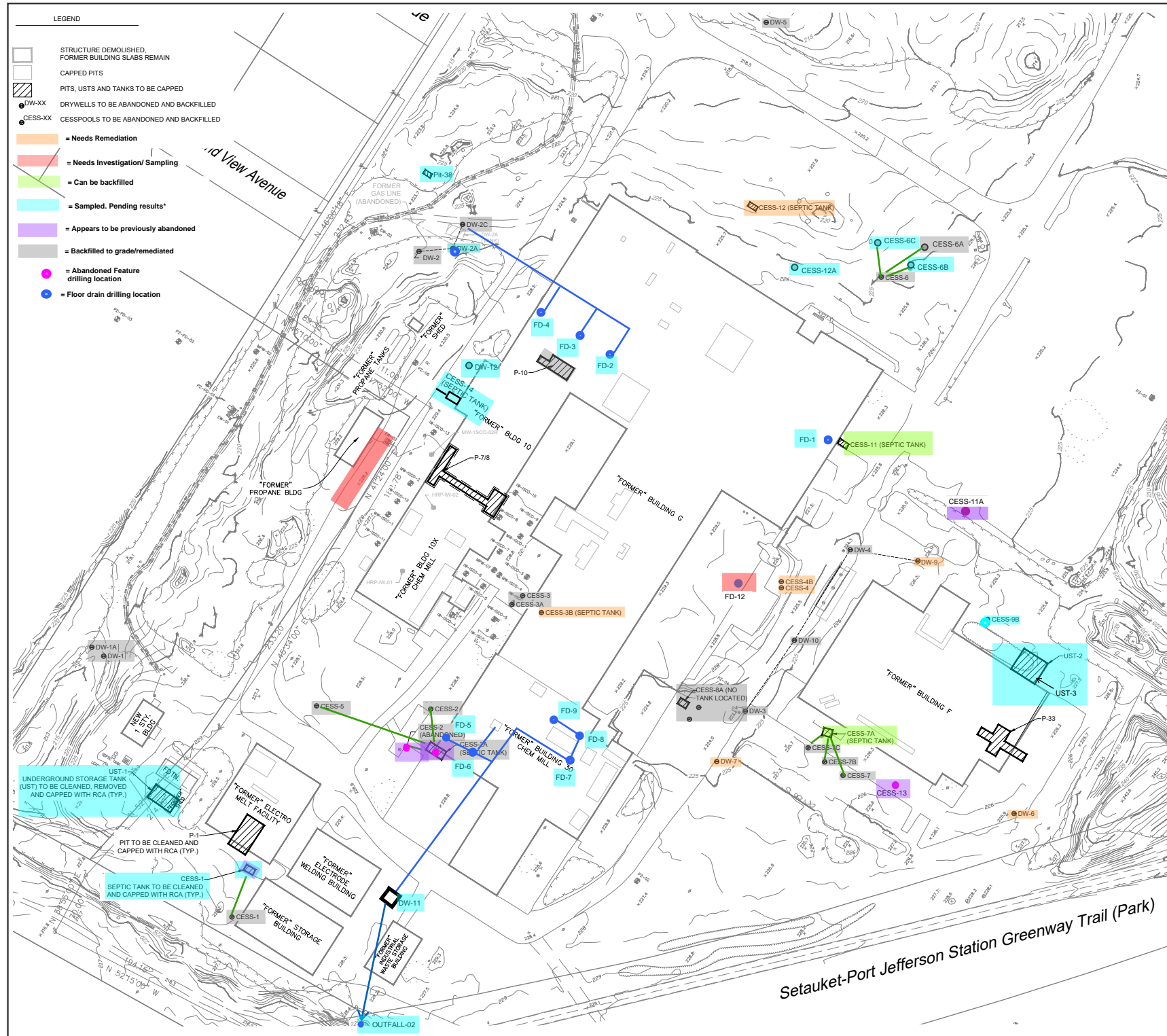

FORMER ADMINISTRATIVE BUILDING LOCATED ON THE  
NORTHWEST CORNER OF THE PROPERTY OFF OF PARK AVENUE

GENERAL NOTES:

1. NOT ALL UTILITIES MAY BE SHOWN. ALL UTILITIES AND STRUCTURES MUST BE VERIFIED BY CONTRACTOR.
2. ALL WELLS WITHIN THE CONSTRUCTION SITE ARE TO BE PROTECTED AND MAINTAINED THROUGHOUT CONSTRUCTION ACTIVITIES.
3. SITE TO BE CLEARED AND GRUBBED AS NECESSARY TO PERFORM THE WORK.

### SUGGESTED CONSTRUCTION SEQUENCE

4. INSTALL STOCKPILE/STAGING AREAS IN ACCORDANCE WITH SHEETS C2.0.
5. INSTALL FENCING IN ACCORDANCE WITH SHEET C2.0.
6. FOLLOWING COORDINATION WITH NYSDEC TO DEWATER AND CLEAN THE VARIOUS PITS, CONTRACTOR SHALL BACKFILL THE PITS, CESS POOLS, DRYWELLS AND USTS TO EXISTING GRADE.
7. REMOVE ALL TEMPORARY EROSION AND SEDIMENT CONTROL MEASURES AND TEMPORARY FENCING AFTER ALL AREAS HAVE BEEN WELL ESTABLISHED AND THE SITE HAS BEEN INSPECTED AND APPROVED BY THE OWNER AND/OR THE OWNER'S REPRESENTATIVE.



SCALE		REVISIONS		
DESIGNED:	1" = 50'	NO	DATE	DESCRIPTION
CVP				
ISSUE DATE	06/26/2024			
PROJECT NUMBER				
REVIEWED	DEC-1027-OM			
DR				
APPROVED				
SHEET SIZE				
TRB	24"x36"			

F SFAI

**LAWRENCE AVIATION  
INDUSTRIES**  
NEW YORK STATE DEPARTMENT OF  
ENVIRONMENTAL CONSERVATION  
100 SHEEP PASTURE ROAD  
PORT JEFFERSON, NEW YORK

## SITE DRAINAGE FEATURES 2025

SHEET NO.

**Fig. 2**



Site Photographs (Descriptions Below)	
	
Photo 1 – Excavation of concrete caps at DW-1 and DW-1A structures.	Photo 2- DW-1 ready for backfill.
	
Photo 3 – DW-1A ready for backfill.	Photo 4 – View of backfilled/graded area near DW-1 and DW-1A.
	
Photo 5- Investigation of additional drywell structures near DW-12.	Photo 6- Uncovered Cess-14 just NW of Pit-7/8

	
Photo 7- Cess-6A ready for backfill.	Photo 8- Backfilled Cess-6A.
<b>Comments</b>	
None.	
<b>Site Inspector(s):</b> Sarah Boison and Pawel Mecinski	<b>Date:</b> 02/11/2025

Videos of discreet operations have been provided to the DEC Project Manager to facilitate understanding of the ongoing work? Yes ☐ No ☒ N/A ☐



**REMEDIAL ACTIVITIES AT OTHER PROPERTIES**  
**[Residential, Adjacent, AWS, non-Site Properties]**  
**(Section may be deleted for ongoing remedial sites)**

1. Does the Department and its Contractor(s) have permission to enter the property or properties for the day's work?	Yes <input checked="" type="checkbox"/>	No <input type="checkbox"/>
2. Does anyone at this location have any symptoms of a respiratory infection (e.g., cough, sore throat, fever, or shortness of breath)?	Yes <input type="checkbox"/>	No <input checked="" type="checkbox"/>
3. Has anyone at this location been tested and confirmed to have COVID-19?	Yes <input type="checkbox"/>	No <input checked="" type="checkbox"/>
4. If Yes to 1, 2 or 3, follow the latest NYSDOH COVID-19 guidance: <a href="https://coronavirus.health.ny.gov/home">https://coronavirus.health.ny.gov/home</a>	Yes <input type="checkbox"/>	No <input type="checkbox"/>
<u>Comments:</u>		

**ON-SITE WASTE STORAGE**

Drums, roll offs and piles are staged in secure areas?	Yes <input checked="" type="checkbox"/>	No <input type="checkbox"/>	N/A <input type="checkbox"/>
Liners and berms have been installed if necessary to prevent cross contamination of clean areas?	Yes <input type="checkbox"/>	No <input type="checkbox"/>	N/A <input checked="" type="checkbox"/>
Containers are in good condition or properly overpacked?	Yes <input type="checkbox"/>	No <input type="checkbox"/>	N/A <input checked="" type="checkbox"/>
Waste materials are scheduled to be properly characterized and disposed of prior to demobilization?	Yes <input checked="" type="checkbox"/>	No <input type="checkbox"/>	N/A <input type="checkbox"/>
Complying with RCRA 90 day storage limitation for hazardous waste?	Yes <input checked="" type="checkbox"/>	No <input type="checkbox"/>	N/A <input type="checkbox"/>
Piles are securely covered when not in use?	Yes <input type="checkbox"/>	No <input type="checkbox"/>	N/A <input checked="" type="checkbox"/>
Containers are closed when not in use?	Yes <input type="checkbox"/>	No <input type="checkbox"/>	N/A <input checked="" type="checkbox"/>
Staging areas should be inspected periodically and any issues addressed immediately?	Yes <input checked="" type="checkbox"/>	No <input type="checkbox"/>	N/A <input type="checkbox"/>
Signage and labeling comply with RCRA requirements for all staging areas and containers?	Yes <input type="checkbox"/>	No <input type="checkbox"/>	N/A <input checked="" type="checkbox"/>
If any issues noted, has Contractor been notified?	Yes <input type="checkbox"/>	No <input type="checkbox"/>	N/A <input checked="" type="checkbox"/>
<u>Comments:</u>			

**NUISANCE CHECKLIST**

Were there any community complaints related to work on this date?	Yes <input type="checkbox"/>	No <input checked="" type="checkbox"/>	N/A <input type="checkbox"/>
Were there any odors detected on this date?	Yes <input type="checkbox"/>	No <input checked="" type="checkbox"/>	N/A <input type="checkbox"/>
Was noise outside specification and/or above background on this date?	Yes <input type="checkbox"/>	No <input checked="" type="checkbox"/>	N/A <input type="checkbox"/>
Were vibration readings outside specification and/or above background on this date?	Yes <input type="checkbox"/>	No <input checked="" type="checkbox"/>	N/A <input type="checkbox"/>
Any visible dust observed beyond the work perimeter on this date?	Yes <input type="checkbox"/>	No <input checked="" type="checkbox"/>	N/A <input type="checkbox"/>
Any visible contrast (turbidity) beyond engineering controls observed on this date?	Yes <input type="checkbox"/>	No <input checked="" type="checkbox"/>	N/A <input type="checkbox"/>
Was turbidity checked at the outfall(s)?	AM <input type="checkbox"/>	PM <input type="checkbox"/>	N/A <input checked="" type="checkbox"/>
Were any property owners NOT provided advance notice for work performed on this property on this date?	Yes <input type="checkbox"/>	No <input checked="" type="checkbox"/>	N/A <input type="checkbox"/>

Was the temporary fabric structure closed at the end of the day?	Yes <input type="checkbox"/>	No <input type="checkbox"/>	N/A <input checked="" type="checkbox"/>
Has Contractor failed to protect all foundations and structures adjacent to and adjoining the site which are affected by the excavations or other operations connected with performance of the Work?	Yes <input type="checkbox"/>	No <input type="checkbox"/>	N/A <input checked="" type="checkbox"/>
If yes, has Contractor been notified?	Yes <input type="checkbox"/>	No <input type="checkbox"/>	N/A <input checked="" type="checkbox"/>
<u>Comments:</u>			

### RESILIENCE/GREEN REMEDIATION CHECKLIST

Is site power procured from renewable energy sources (e.g., solar, wind, geothermal, biomass and biogas)?	Yes <input type="checkbox"/>	No <input type="checkbox"/>	N/A <input checked="" type="checkbox"/>
Is the Contractor employing 2007 or newer or retrofitted (BART*) diesel on-road trucks and non-road equipment?	Yes <input type="checkbox"/>	No <input type="checkbox"/>	N/A <input checked="" type="checkbox"/>
Is vehicle idling adequately reduced per 6NYCRR Part 217-3?	Yes <input type="checkbox"/>	No <input type="checkbox"/>	N/A <input checked="" type="checkbox"/>
Have equipment operators been trained in the idling requirements of 6NYCRR Part 217-3?	Yes <input type="checkbox"/>	No <input type="checkbox"/>	N/A <input checked="" type="checkbox"/>
Is BART-equipped equipment properly maintained and working?	Yes <input type="checkbox"/>	No <input type="checkbox"/>	N/A <input checked="" type="checkbox"/>
Is work being sequenced to avoid double handling?	Yes <input checked="" type="checkbox"/>	No <input type="checkbox"/>	N/A <input type="checkbox"/>
Is there an onsite recycling program for CONTRACTOR-generated wastes and is it complied with?	Yes <input type="checkbox"/>	No <input type="checkbox"/>	N/A <input checked="" type="checkbox"/>
Are office trailer heating and cooling systems maintained at efficient set points, have programable thermostats been installed?	Yes <input type="checkbox"/>	No <input type="checkbox"/>	N/A <input checked="" type="checkbox"/>
Are products and materials used in performance of the work appropriately certified (e.g., LEED, Energy Star, Sustainable Forestry Initiative®, etc.)?	Yes <input type="checkbox"/>	No <input type="checkbox"/>	N/A <input checked="" type="checkbox"/>
Are resiliency features included in the design, or completed remedy properly installed and/or maintained (flood control, storm water controls, erosion measures, etc.)?	Yes <input type="checkbox"/>	No <input type="checkbox"/>	N/A <input checked="" type="checkbox"/>
Are green remediation elements included in the design, or completed remedy properly installed and/or maintained (e.g., porous pavement, geothermal, variable speed drives, native plantings, natural stream bank restoration, etc.)?	Yes <input type="checkbox"/>	No <input type="checkbox"/>	N/A <input checked="" type="checkbox"/>
Has Contractor been notified of any deficiencies?	Yes <input type="checkbox"/>	No <input type="checkbox"/>	N/A <input checked="" type="checkbox"/>
Are remote/call in job meetings being held in lieu of meeting in person where possible?	Yes <input type="checkbox"/>	No <input checked="" type="checkbox"/>	N/A <input type="checkbox"/>
<u>Comments:</u>			

\* BART – Best Available Retrofit Technology