

NYSDEC Division of Environmental Remediation		 Department of Environmental Conservation		<b>Contract No.</b>  <b>DEC Insp.</b> DEC PM – Payson Long, P.E. GES PM. – Scott McDonald HRP Engineer PM – Tom Battles HRP PM – Derek Roy	
<b>Site Location: NYSDEC Lawrence Aviation, Port Jefferson Station, NY</b>					
<b>Weather Conditions</b>					
<b>General Description</b>	Cloudy	AM	Overcast	PM	
<b>Temperature</b>	29 F	AM	32 F	PM	
<b>Wind</b>	0-1 mph	AM	0-2 mph	PM	
<b>Health &amp; Safety</b> <b>If any box below is checked “Yes”, provide explanation under “Health &amp; Safety Comments”.</b>					
Were there any changes to the Health & Safety Plan?				*Yes	No NA
Were there any exceedances of the perimeter air monitoring reported on this date?				*Yes	No NA
Were there any nuisance issues reported/observed on this date?				*Yes	No NA
<b>Health &amp; Safety Comments</b> Conducted daily tailgate meeting, conduct drive around to check for trespassers, check for access issues/ icy areas.					
<b>Summary of Work performed</b>		Arrived at site:	<b>0630</b>	Departed Site:	<b>1630</b>
<p>0630 – Pawel Mecinski, Donald Custer (GES) onsite. Unlocked Park Ave Gate. Highground Industrial (HGI) personnel onsite. Held H&amp;S meeting</p> <p>0715 – Sarah Boison (HRP) on site.</p> <p>-HGI plowed snow on all access roads and parking lots following overnight snow storm.</p> <p>0815 – Call-a-Head on site to service the portable bathroom.</p> <p>-Miller Environmental delivered 10k gallon frack tank. Staged at the former electro-melt building concrete pad.</p> <p>1020-Bang Towing on site with a low-boy trailer. Loaded UST-3 steel shell and transported offsite to a local scrap yard.</p> <p>-HGI cut apart UST-1 and UST-2 tank shells and prep for transport.</p> <p>1350 – Bang Towing on site. Load partial UST-2 tank shell and transport offsite.</p> <p>-HGI cleared areas east of CESS-11 and near suspected location of CESS-11A. Uncovered additional cesspool structure CESS-11A.</p> <p>-Clear and level ground area near septic tank CESS-14, along the eastern side of the former Propane Building, and along the western side of Former Building 10X for future GPR activities.</p> <p>1545- Take down CAMPs</p> <p>1600- HGI crew offsite.</p> <p>1630– All personnel offsite. Locked gates, system shed.</p>					

[illegible]

**Equipment/Material Tracking Comments:**

None.

**Visitors to Site**

Name	Representing	Entered Exclusion/CRZ Zone	
Transport personnel	Miller Environmental	Yes	No
Transport personnel	Bang Towing	Yes	No
		Yes	No

**Site Representatives**

None	

**Project Schedule Comments**

- Utility markout scheduled for Thursday (2/13). Plan to mark utilities/search for subsurface structures west of Cess-14, east of the Former Propane Building, west of Former Building 10X, and near CESS-11A.
- Drilling scheduled for Thursday (2/13).

**Issues Pending**

None.

**Interaction with Public, Property Owners, Media, etc.**

None.

**Include (insert) figures with markups showing location of work and job progress**

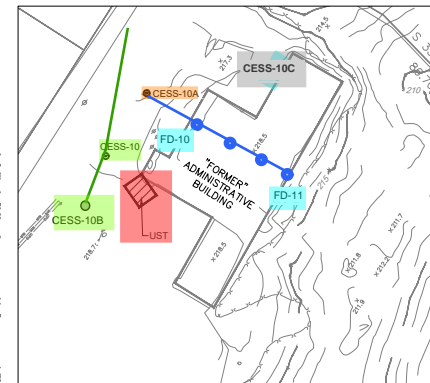
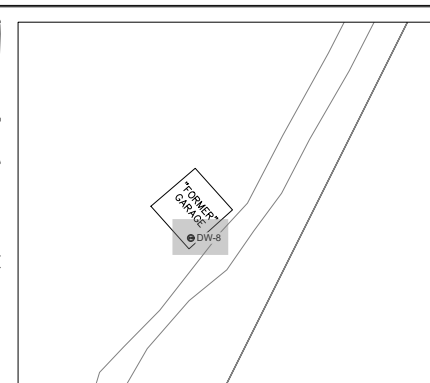
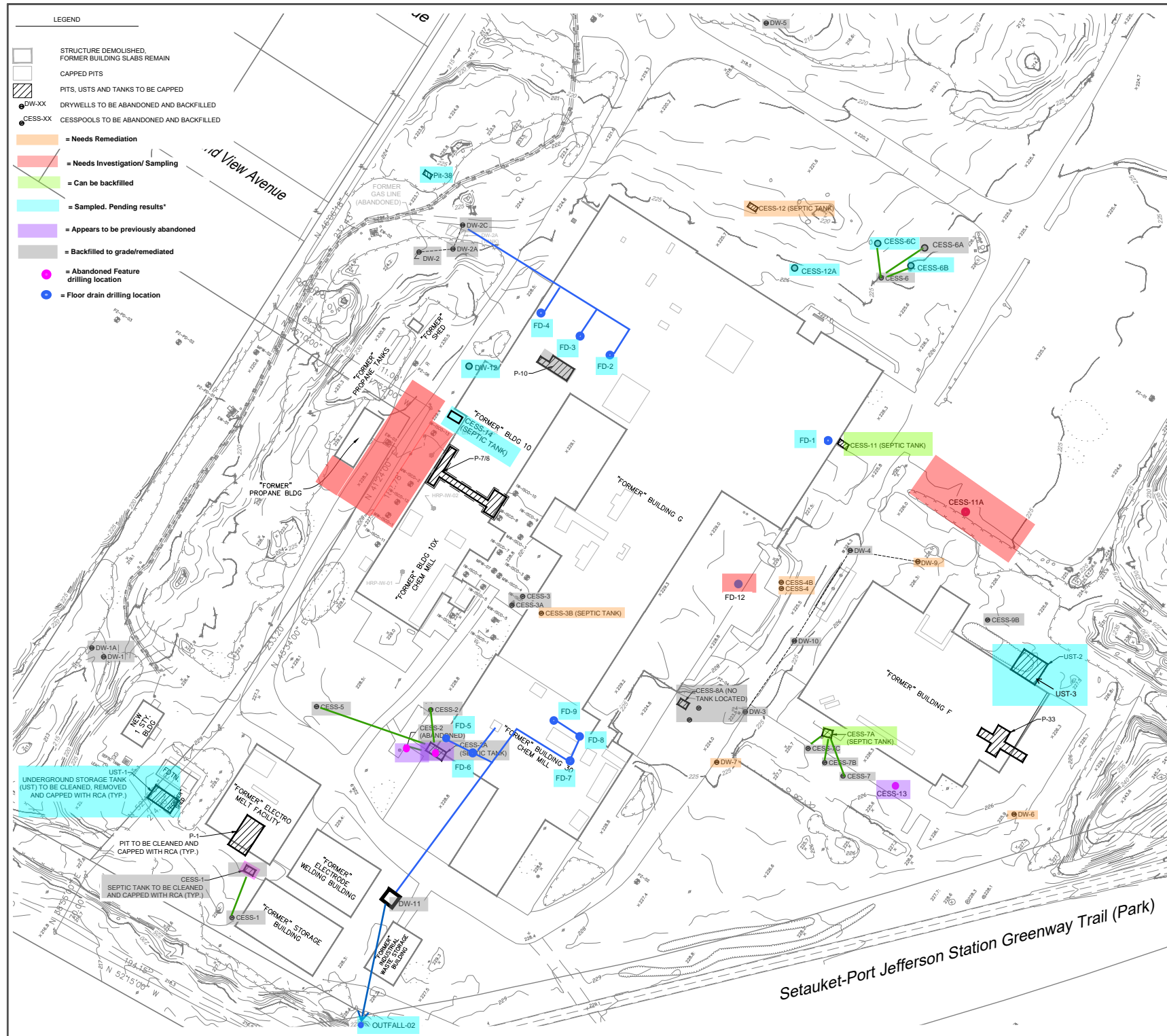

FORMER ADMINISTRATIVE BUILDING LOCATED ON THE  
NORTHWEST CORNER OF THE PROPERTY OFF OF PARK AVENUE

GENERAL NOTES:

1. NOT ALL UTILITIES MAY BE SHOWN. ALL UTILITIES AND STRUCTURES MUST BE VERIFIED BY CONTRACTOR.
2. ALL WELLS WITHIN THE CONSTRUCTION SITE ARE TO BE PROTECTED AND MAINTAINED THROUGHOUT CONSTRUCTION ACTIVITIES.
3. SITE TO BE CLEARED AND GRUBBED AS NECESSARY TO PERFORM THE WORK.

### SUGGESTED CONSTRUCTION SEQUENCE

4. INSTALL STOCKPILE/STAGING AREAS IN ACCORDANCE WITH SHEETS C2.0.
5. INSTALL FENCING IN ACCORDANCE WITH SHEET C2.0.
6. FOLLOWING COORDINATION WITH NYSDEC TO DEWATER AND CLEAN THE VARIOUS PITS, CONTRACTOR SHALL BACKFILL THE PITS, CESS POOLS, DRYWELLS AND USTS TO EXISTING GRADE.
7. REMOVE ALL TEMPORARY EROSION AND SEDIMENT CONTROL MEASURES AND TEMPORARY FENCING AFTER ALL AREAS HAVE BEEN WELL ESTABLISHED AND THE SITE HAS BEEN INSPECTED AND APPROVED BY THE OWNER AND/OR THE OWNER'S REPRESENTATIVE.



0 25' 50'

DESIGNED: SCALE:		NO.		REVISIONS	
APPN.	1" = 50'	DATE	DESCRIPTION		
CVP		06/26/2024			
CVP					
DR					
TRB					

: SFAI

**LAWRENCE AVIATION  
INDUSTRIES**  
NEW YORK STATE DEPARTMENT OF  
ENVIRONMENTAL CONSERVATION  
100 SHEEP PASTURE ROAD  
PORT JEFFERSON, NEW YORK

## SITE DRAINAGE FEATURES 2025

SHEET NO.

**Fig. 2**



**Site Photographs (Descriptions Below)**



Photo 1 – Cutting of UST-2 tank shell.



Photo 2 – View of UST-2 interior.



Photo 3- Loading UST-3 for transport.



Photo 4 – Cut UST-1 tank shell.





Photo 5 – Miller Environmental 10K Frac. Tank near the electro-melt building/Pit-1.



Photo 6 – View of CESS-11A location.



Photo 7 – View of cleared area west of Former Building 10X.



Photo 8 – View of cleared area east of the Former Propane Building.

**Comments**

None.

**Site Inspector(s):** Sarah Boison and Pawel Mecinski

**Date:** 02/12/2025

Videos of discreet operations have been provided to the DEC Project Manager to facilitate understanding of the ongoing work?  
 Yes ☐ No ☒ N/A ☐

REMEDIAL ACTIVITIES AT OTHER PROPERTIES  
[Residential, Adjacent, AWS, non-Site Properties]  
(Section may be deleted for ongoing remedial sites)

1. Does the Department and its Contractor(s) have permission to enter the property or properties for the day's work?	Yes <input checked="" type="checkbox"/>	No <input type="checkbox"/>
2. Does anyone at this location have any symptoms of a respiratory infection (e.g., cough, sore throat, fever, or shortness of breath)?	Yes <input type="checkbox"/>	No <input checked="" type="checkbox"/>
3. Has anyone at this location been tested and confirmed to have COVID-19?	Yes <input type="checkbox"/>	No <input checked="" type="checkbox"/>
4. If Yes to 1, 2 or 3, follow the latest NYSDOH COVID-19 guidance: <a href="https://coronavirus.health.ny.gov/home">https://coronavirus.health.ny.gov/home</a>	Yes <input type="checkbox"/>	No <input type="checkbox"/>
<u>Comments:</u> None.		

ON-SITE WASTE STORAGE

Drums, roll offs and piles are staged in secure areas?	Yes <input checked="" type="checkbox"/>	No <input type="checkbox"/>	N/A <input type="checkbox"/>
Liners and berms have been installed if necessary to prevent cross contamination of clean areas?	Yes <input type="checkbox"/>	No <input type="checkbox"/>	N/A <input checked="" type="checkbox"/>
Containers are in good condition or properly overpacked?	Yes <input checked="" type="checkbox"/>	No <input type="checkbox"/>	N/A <input type="checkbox"/>
Waste materials are scheduled to be properly characterized and disposed of prior to demobilization?	Yes <input checked="" type="checkbox"/>	No <input type="checkbox"/>	N/A <input type="checkbox"/>
Complying with RCRA 90 day storage limitation for hazardous waste?	Yes <input checked="" type="checkbox"/>	No <input type="checkbox"/>	N/A <input type="checkbox"/>
Piles are securely covered when not in use?	Yes <input checked="" type="checkbox"/>	No <input type="checkbox"/>	N/A <input type="checkbox"/>
Containers are closed when not in use?	Yes <input checked="" type="checkbox"/>	No <input type="checkbox"/>	N/A <input type="checkbox"/>
Staging areas should be inspected periodically and any issues addressed immediately?	Yes <input checked="" type="checkbox"/>	No <input type="checkbox"/>	N/A <input type="checkbox"/>
Signage and labeling comply with RCRA requirements for all staging areas and containers?	Yes <input type="checkbox"/>	No <input type="checkbox"/>	N/A <input checked="" type="checkbox"/>
If any issues noted, has Contractor been notified?	Yes <input type="checkbox"/>	No <input type="checkbox"/>	N/A <input checked="" type="checkbox"/>
<u>Comments:</u> None.			

NUISANCE CHECKLIST

Were there any community complaints related to work on this date?	Yes <input type="checkbox"/>	No <input checked="" type="checkbox"/>	N/A <input type="checkbox"/>
Were there any odors detected on this date?	Yes <input type="checkbox"/>	No <input checked="" type="checkbox"/>	N/A <input type="checkbox"/>
Was noise outside specification and/or above background on this date?	Yes <input type="checkbox"/>	No <input checked="" type="checkbox"/>	N/A <input type="checkbox"/>
Were vibration readings outside specification and/or above background on this date?	Yes <input type="checkbox"/>	No <input checked="" type="checkbox"/>	N/A <input type="checkbox"/>
Any visible dust observed beyond the work perimeter on this date?	Yes <input type="checkbox"/>	No <input checked="" type="checkbox"/>	N/A <input type="checkbox"/>
Any visible contrast (turbidity) beyond engineering controls observed on this date?	Yes <input type="checkbox"/>	No <input checked="" type="checkbox"/>	N/A <input type="checkbox"/>
Was turbidity checked at the outfall(s)?	AM <input type="checkbox"/>	PM <input type="checkbox"/>	N/A <input checked="" type="checkbox"/>
Were any property owners NOT provided advance notice for work performed on this property on this date?	Yes <input type="checkbox"/>	No <input checked="" type="checkbox"/>	N/A <input type="checkbox"/>

Was the temporary fabric structure closed at the end of the day?	Yes <input type="checkbox"/>	No <input type="checkbox"/>	N/A <input checked="" type="checkbox"/>
Has Contractor failed to protect all foundations and structures adjacent to and adjoining the site which are affected by the excavations or other operations connected with performance of the Work?	Yes <input type="checkbox"/>	No <input type="checkbox"/>	N/A <input checked="" type="checkbox"/>
If yes, has Contractor been notified?	Yes <input type="checkbox"/>	No <input type="checkbox"/>	N/A <input checked="" type="checkbox"/>
<u>Comments:</u> None.			

### RESILIENCE/GREEN REMEDIATION CHECKLIST

Is site power procured from renewable energy sources (e.g., solar, wind, geothermal, biomass and biogas)?	Yes <input type="checkbox"/>	No <input type="checkbox"/>	N/A <input checked="" type="checkbox"/>
Is the Contractor employing 2007 or newer or retrofitted (BART*) diesel on-road trucks and non-road equipment?	Yes <input type="checkbox"/>	No <input type="checkbox"/>	N/A <input checked="" type="checkbox"/>
Is vehicle idling adequately reduced per 6NYCRR Part 217-3?	Yes <input type="checkbox"/>	No <input type="checkbox"/>	N/A <input checked="" type="checkbox"/>
Have equipment operators been trained in the idling requirements of 6NYCRR Part 217-3?	Yes <input type="checkbox"/>	No <input type="checkbox"/>	N/A <input checked="" type="checkbox"/>
Is BART-equipped equipment properly maintained and working?	Yes <input type="checkbox"/>	No <input type="checkbox"/>	N/A <input checked="" type="checkbox"/>
Is work being sequenced to avoid double handling?	Yes <input checked="" type="checkbox"/>	No <input type="checkbox"/>	N/A <input type="checkbox"/>
Is there an onsite recycling program for CONTRACTOR-generated wastes and is it complied with?	Yes <input type="checkbox"/>	No <input type="checkbox"/>	N/A <input checked="" type="checkbox"/>
Are office trailer heating and cooling systems maintained at efficient set points, have programable thermostats been installed?	Yes <input type="checkbox"/>	No <input type="checkbox"/>	N/A <input checked="" type="checkbox"/>
Are products and materials used in performance of the work appropriately certified (e.g., LEED, Energy Star, Sustainable Forestry Initiative®, etc.)?	Yes <input type="checkbox"/>	No <input type="checkbox"/>	N/A <input checked="" type="checkbox"/>
Are resiliency features included in the design, or completed remedy properly installed and/or maintained (flood control, storm water controls, erosion measures, etc.)?	Yes <input type="checkbox"/>	No <input type="checkbox"/>	N/A <input checked="" type="checkbox"/>
Are green remediation elements included in the design, or completed remedy properly installed and/or maintained (e.g., porous pavement, geothermal, variable speed drives, native plantings, natural stream bank restoration, etc.)?	Yes <input type="checkbox"/>	No <input type="checkbox"/>	N/A <input checked="" type="checkbox"/>
Has Contractor been notified of any deficiencies?	Yes <input type="checkbox"/>	No <input type="checkbox"/>	N/A <input checked="" type="checkbox"/>
Are remote/call in job meetings being held in lieu of meeting in person where possible?	Yes <input type="checkbox"/>	No <input checked="" type="checkbox"/>	N/A <input type="checkbox"/>
<u>Comments:</u> None.			

\* BART – Best Available Retrofit Technology