

DAILY INSPECTION REPORT - No. 223
(Lawrence Aviation), Site No. 152016

Page 1 of 8
Date: 03/07/2025

NYSDEC Division of Environmental Remediation		 Department of Environmental Conservation		Contract No. DEC Insp. DEC PM – Payson Long, P.E. GES PM. – Scott McDonald HRP Engineer PM – Tom Battles HRP PM – Derek Roy	
Site Location: NYSDEC Lawrence Aviation, Port Jefferson Station, NY					
Weather Conditions					
General Description	Sunny	AM	Offsite	PM	
Temperature	31 F	AM	Offsite	PM	
Wind	10-20 mph SE	AM	Offsite	PM	
Health & Safety If any box below is checked “Yes”, provide explanation under “Health & Safety Comments”.					
Were there any changes to the Health & Safety Plan?				*Yes	No NA
Were there any exceedances of the perimeter air monitoring reported on this date?				*Yes	No NA
Were there any nuisance issues reported/observed on this date?				*Yes	No NA
Health & Safety Comments Conducted daily tailgate meeting, conduct drive around to check for trespassers, check for access issues/ icy areas.					
Summary of Work performed		Arrived at site:	0630	Departed Site:	1015
<p>0630 – Pawel Mecinski, Brian Dunn (GES) onsite. Unlocked Park Ave Gate. Highground Industrial (HGI) personnel onsite. Held H&S meeting</p> <p>0715 – Sarah Boison (HRP) on site.</p> <p>-Set up and run CAMP dust and VOC monitors throughout the day. No abnormal readings observed.</p> <p>-Move poly tubing used for frack tank processing out of the way of Pit-7/8 excavation</p> <p>9:55-10:05 – Call-a-head on site to service porta potty.</p> <p>Work Completed by HGI:</p> <p>-Continue Pit-7/8 work.</p> <p>-Clean and organize job trailer</p> <p>-Complete weekly machine maintenance, blow out dust out of engine radiators, fuel up, grease moving parts, etc.</p> <p>Imports/Exports:</p> <p>None today</p> <p>1000- HGI crew offsite.</p> <p>1015 – All personnel offsite. Locked gates, system shed.</p>					

Were there any vehicles which did not display proper D.O.T numbers and placards?								*Yes	No	NA
Were there any vehicles which were not tarped?								* Yes	No	NA
Were there any vehicles which were not decontaminated prior to exiting the work site?								* Yes	No	NA
Personnel and Equipment										
Individual		Company		Trade		Total Hours				
Sarah Boison		HRP		Geologist		3				
Pawel Mecinski		GES		Project Remediation Specialist		3.75				
Brian Dunn		GES		CAMP Field Technician		3.75				
Efrain Chub		HGI		Equipment Operator		3.5				
Christian Mazariegos		HGI		Equipment Operator		3.5				
Moises Pacheco		HGI		Equipment Operator		3.5				
Duane Lynch		HGI		Foreman		3.5				
Equipment Description			Contractor/Vendor			Quantity		Used		
Bucket Excavator SK-350			Highground			1		Yes		
Bucket Excavator SK-350			Highground			1		Yes		
Front Loader			Highground			1		Yes		
Material Description		Imported/ Delivered to Site	Exported off Site	Waste Profile (If Applicable)		Source or Disposal Facility (If Applicable)		Daily Loads	Daily Weight (tons)*	
Sand Fill			No	N/A		Posillico, Holtsville NY		0		
RCA Fill			No	NA		Posillico, Holtsville NY		0		
*On-Site scale for off-site shipment, delivery ticket for material received										
Equipment/Material Tracking Comments:										
None.										
Visitors to Site										
Name		Representing				Entered Exclusion/CRZ Zone				
Call-a-head personnel		Call-a-head				Yes		No		
Site Representatives										
None										
Project Schedule Comments										
None.										
Issues Pending										
Roll off containers near the Former Administrative Building have minor leaks. Roll off containers contain sediment/sludge removed from Pit-38 and septic features. Patched holes with bentonite. Booms and soil used to contain the leaks.										
Interaction with Public, Property Owners, Media, etc.										
None.										

Include (insert) figures with markups showing location of work and job progress

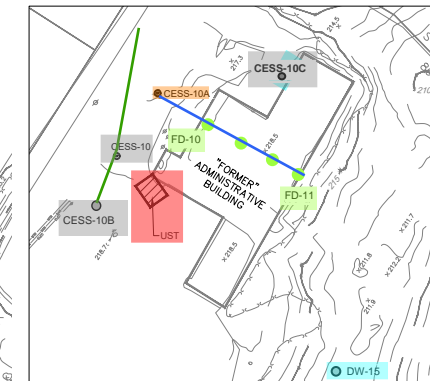
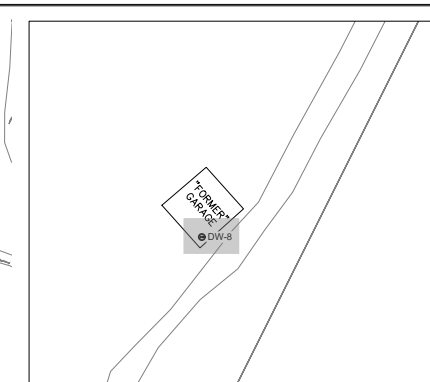
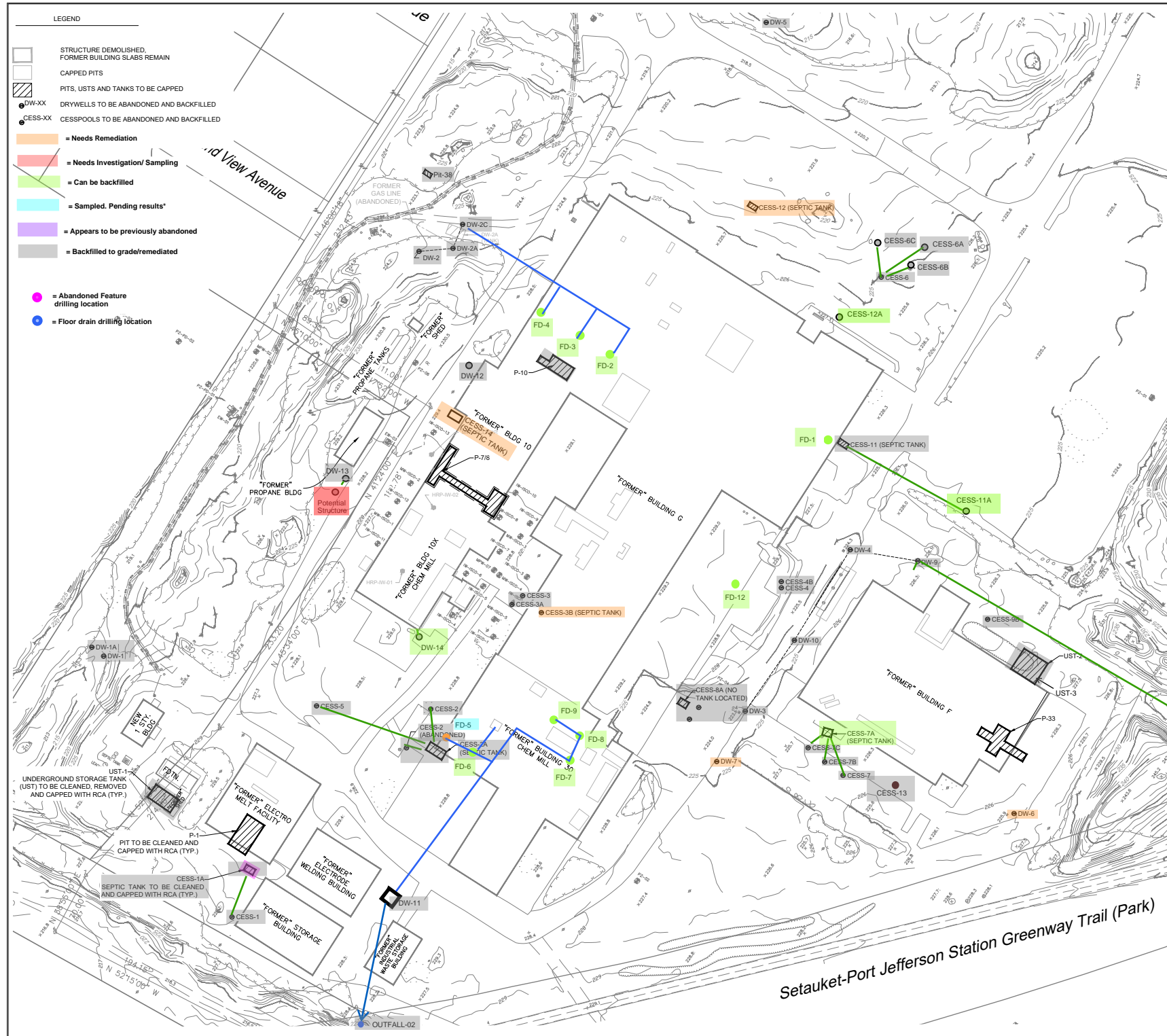

FORMER GARAGE LOCATED ON THE NORTHEAST CORNER OF THE
PROPERTY OFF OF SHEEP PASTURE ROAD

FORMER ADMINISTRATIVE BUILDING LOCATED ON THE
NORTHWEST CORNER OF THE PROPERTY OFF OF PARK AVENUE

GENERAL NOTES:

1. NOT ALL UTILITIES MAY BE SHOWN. ALL UTILITIES AND STRUCTURES MUST BE VERIFIED BY CONTRACTOR.
2. ALL WELLS WITHIN THE CONSTRUCTION SITE ARE TO BE PROTECTED AND MAINTAINED THROUGHOUT CONSTRUCTION ACTIVITIES.
3. SITE TO BE CLEARED AND GRUBBED AS NECESSARY TO PERFORM THE WORK.

SUGGESTED CONSTRUCTION SEQUENCE

4. INSTALL STOCKPILE/STAGING AREAS IN ACCORDANCE WITH SHEETS C2.0.
5. INSTALL FENCING IN ACCORDANCE WITH SHEET C2.0.
6. FOLLOWING COORDINATION WITH NYSDEC TO DEWATER AND CLEAN THE VARIOUS PITS, CONTRACTOR SHALL BACKFILL THE PITS, CESS POOLS, DRYWELLS AND USTS TO EXISTING GRADE.
7. REMOVE ALL TEMPORARY EROSION AND SEDIMENT CONTROL MEASURES AND TEMPORARY FENCING AFTER ALL AREAS HAVE BEEN WELL ESTABLISHED AND THE SITE HAS BEEN INSPECTED AND APPROVED BY THE OWNER AND/OR THE OWNER'S REPRESENTATIVE.



NORT



DESIGNED:	SCALE:	NO. DATE		DESCRIPTION
CVP	1" = 50'			
PROJECT DRAWN				
CVP	06/26/2024			
PROJECT VIEWED				
DR	DEC1027 OM			
APPROVED	SHEET 1526			
TRAC	TRAC 005			



--	--

LAWRENCE AVIATION
INDUSTRIES
NEW YORK STATE DEPARTMENT OF
ENVIRONMENTAL CONSERVATION
100 SHEEP PASTURE ROAD
PO BOX 175000, NEW YORK

SITE DRAINAGE FEATURES 2025

SHEET NO.

Fig. 2

Site Photographs (Descriptions Below)	
	
<p>Photo 1 – Eastern side of Pit-7/8. Some internal divider walls are crushed. Began jackhammering exterior floor slab for excavation of sidewalls.</p>	<p>Photo 2- Eastern sidewall and bottom soil at Pi-7/8. No staining or odor observed on the exterior of the concrete slab wall.</p>
	<p>Intentionally Left Blank</p>
<p>Photo 3 – View of containment booms/soil around the southern roll off bin.</p>	<p>Intentionally Left Blank</p>
<p>Comments</p>	
<p>None.</p>	
<p>Site Inspector(s): Sarah Boison and Pawel Mecinski</p>	<p>Date: 03/07/2025</p>

Videos of discreet operations have been provided to the DEC Project Manager to facilitate understanding of the ongoing work? Yes ☐ No ☒ N/A ☐

REMEDIAL ACTIVITIES AT OTHER PROPERTIES
[Residential, Adjacent, AWS, non-Site Properties]
(Section may be deleted for ongoing remedial sites)

1. Does the Department and its Contractor(s) have permission to enter the property or properties for the day's work?	Yes <input checked="" type="checkbox"/>	No <input type="checkbox"/>
2. Does anyone at this location have any symptoms of a respiratory infection (e.g., cough, sore throat, fever, or shortness of breath)?	Yes <input type="checkbox"/>	No <input checked="" type="checkbox"/>
3. Has anyone at this location been tested and confirmed to have COVID-19?	Yes <input type="checkbox"/>	No <input checked="" type="checkbox"/>
4. If Yes to 1, 2 or 3, follow the latest NYSDOH COVID-19 guidance: https://coronavirus.health.ny.gov/home	Yes <input type="checkbox"/>	No <input type="checkbox"/>
Comments:		

ON-SITE WASTE STORAGE

Drums, roll offs and piles are staged in secure areas?	Yes <input checked="" type="checkbox"/>	No <input type="checkbox"/>	N/A <input type="checkbox"/>
Liners and berms have been installed if necessary to prevent cross contamination of clean areas?	Yes <input checked="" type="checkbox"/>	No <input type="checkbox"/>	N/A <input type="checkbox"/>
Containers are in good condition or properly overpacked?	Yes <input type="checkbox"/>	No <input checked="" type="checkbox"/>	N/A <input type="checkbox"/>
Waste materials are scheduled to be properly characterized and disposed of prior to demobilization?	Yes <input checked="" type="checkbox"/>	No <input type="checkbox"/>	N/A <input type="checkbox"/>
Complying with RCRA 90 day storage limitation for hazardous waste?	Yes <input checked="" type="checkbox"/>	No <input type="checkbox"/>	N/A <input type="checkbox"/>
Piles are securely covered when not in use?	Yes <input checked="" type="checkbox"/>	No <input type="checkbox"/>	N/A <input type="checkbox"/>
Containers are closed when not in use?	Yes <input checked="" type="checkbox"/>	No <input type="checkbox"/>	N/A <input type="checkbox"/>
Staging areas should be inspected periodically and any issues addressed immediately?	Yes <input checked="" type="checkbox"/>	No <input type="checkbox"/>	N/A <input type="checkbox"/>
Signage and labeling comply with RCRA requirements for all staging areas and containers?	Yes <input type="checkbox"/>	No <input type="checkbox"/>	N/A <input checked="" type="checkbox"/>
If any issues noted, has Contractor been notified?	Yes <input type="checkbox"/>	No <input type="checkbox"/>	N/A <input checked="" type="checkbox"/>
Comments: Roll off containers near the Former Administrative Building have minor leaks. Roll off containers contain sediment/sludge removed from Pit-38 and septic features. Patched holes with bentonite. Booms and soil used to contain the leaks.			

NUISANCE CHECKLIST

Were there any community complaints related to work on this date?	Yes <input type="checkbox"/>	No <input checked="" type="checkbox"/>	N/A <input type="checkbox"/>
Were there any odors detected on this date?	Yes <input type="checkbox"/>	No <input checked="" type="checkbox"/>	N/A <input type="checkbox"/>
Was noise outside specification and/or above background on this date?	Yes <input type="checkbox"/>	No <input checked="" type="checkbox"/>	N/A <input type="checkbox"/>
Were vibration readings outside specification and/or above background on this date?	Yes <input type="checkbox"/>	No <input checked="" type="checkbox"/>	N/A <input type="checkbox"/>
Any visible dust observed beyond the work perimeter on this date?	Yes <input type="checkbox"/>	No <input checked="" type="checkbox"/>	N/A <input type="checkbox"/>
Any visible contrast (turbidity) beyond engineering controls observed on this date?	Yes <input type="checkbox"/>	No <input checked="" type="checkbox"/>	N/A <input type="checkbox"/>
Was turbidity checked at the outfall(s)?	AM <input type="checkbox"/>	PM <input type="checkbox"/>	N/A <input checked="" type="checkbox"/>
Were any property owners NOT provided advance notice for work performed on this property on this date?	Yes <input type="checkbox"/>	No <input checked="" type="checkbox"/>	N/A <input type="checkbox"/>

Was the temporary fabric structure closed at the end of the day?	Yes <input type="checkbox"/>	No <input type="checkbox"/>	N/A <input checked="" type="checkbox"/>
Has Contractor failed to protect all foundations and structures adjacent to and adjoining the site which are affected by the excavations or other operations connected with performance of the Work?	Yes <input type="checkbox"/>	No <input type="checkbox"/>	N/A <input checked="" type="checkbox"/>
If yes, has Contractor been notified?	Yes <input type="checkbox"/>	No <input type="checkbox"/>	N/A <input checked="" type="checkbox"/>
<u>Comments:</u>			

RESILIENCE/GREEN REMEDIATION CHECKLIST

Is site power procured from renewable energy sources (e.g., solar, wind, geothermal, biomass and biogas)?	Yes <input type="checkbox"/>	No <input type="checkbox"/>	N/A <input checked="" type="checkbox"/>
Is the Contractor employing 2007 or newer or retrofitted (BART*) diesel on-road trucks and non-road equipment?	Yes <input type="checkbox"/>	No <input type="checkbox"/>	N/A <input checked="" type="checkbox"/>
Is vehicle idling adequately reduced per 6NYCRR Part 217-3?	Yes <input type="checkbox"/>	No <input type="checkbox"/>	N/A <input checked="" type="checkbox"/>
Have equipment operators been trained in the idling requirements of 6NYCRR Part 217-3?	Yes <input type="checkbox"/>	No <input type="checkbox"/>	N/A <input checked="" type="checkbox"/>
Is BART-equipped equipment properly maintained and working?	Yes <input type="checkbox"/>	No <input type="checkbox"/>	N/A <input checked="" type="checkbox"/>
Is work being sequenced to avoid double handling?	Yes <input checked="" type="checkbox"/>	No <input type="checkbox"/>	N/A <input type="checkbox"/>
Is there an onsite recycling program for CONTRACTOR-generated wastes and is it complied with?	Yes <input type="checkbox"/>	No <input type="checkbox"/>	N/A <input checked="" type="checkbox"/>
Are office trailer heating and cooling systems maintained at efficient set points, have programable thermostats been installed?	Yes <input type="checkbox"/>	No <input type="checkbox"/>	N/A <input checked="" type="checkbox"/>
Are products and materials used in performance of the work appropriately certified (e.g., LEED, Energy Star, Sustainable Forestry Initiative®, etc.)?	Yes <input type="checkbox"/>	No <input type="checkbox"/>	N/A <input checked="" type="checkbox"/>
Are resiliency features included in the design, or completed remedy properly installed and/or maintained (flood control, storm water controls, erosion measures, etc.)?	Yes <input type="checkbox"/>	No <input type="checkbox"/>	N/A <input checked="" type="checkbox"/>
Are green remediation elements included in the design, or completed remedy properly installed and/or maintained (e.g., porous pavement, geothermal, variable speed drives, native plantings, natural stream bank restoration, etc.)?	Yes <input type="checkbox"/>	No <input type="checkbox"/>	N/A <input checked="" type="checkbox"/>
Has Contractor been notified of any deficiencies?	Yes <input type="checkbox"/>	No <input type="checkbox"/>	N/A <input checked="" type="checkbox"/>
Are remote/call in job meetings being held in lieu of meeting in person where possible?	Yes <input type="checkbox"/>	No <input checked="" type="checkbox"/>	N/A <input type="checkbox"/>
<u>Comments:</u>			

* BART – Best Available Retrofit Technology