

NYSDEC Division of Environmental Remediation				 Department of Environmental Conservation		<b>Contract No.</b>  <b>DEC Insp.</b> DEC PM – Payson Long, P.E. GES PM. – Scott McDonald HRP Engineer PM – Tom Battles HRP PM – Derek Roy	
<b>Site Location: NYSDEC Lawrence Aviation, Port Jefferson Station, NY</b>							
<b>Weather Conditions</b>							
<b>General Description</b>	Cloudy	AM	Sunny	PM			
<b>Temperature</b>	35 F	AM	60 F	PM			
<b>Wind</b>	0-5 mph SE	AM	0-5 mph SE, S	PM			
<b>Health &amp; Safety</b> <b>If any box below is checked “Yes”, provide explanation under “Health &amp; Safety Comments”.</b>							
Were there any changes to the Health & Safety Plan?					*Yes	No	NA
Were there any exceedances of the perimeter air monitoring reported on this date?					*Yes	No	NA
Were there any nuisance issues reported/observed on this date?					*Yes	No	NA
<b>Health &amp; Safety Comments</b> Conducted daily tailgate meeting, conduct drive around to check for trespassers, check for access issues/ icy areas.							
<b>Summary of Work performed</b>		Arrived at site:	<b>0630</b>		Departed Site:	<b>1630</b>	
0630 – Pawel Mecinski (GES) onsite. Unlocked Park Ave Gate. Highground Industrial (HGI) personnel onsite. Held H&S meeting 0700 – Carly Saindon (HRP), Matt Reppenhagen (GES) on site. -Set up CAMP stations and monitor ambient air for dust and VOCs. No abnormal readings noted during the work shift duration. 0800 – Miller Environmental crew on site. Pump out liquids from Pit-1 and from the 1k gallon UST. Following UST removal, Miller cut open the UST and cleaned the inner steel walls. Drummed all over-excavated soil exhibiting high PID readings (app. 3-5 yds). 0900 – Joel Hara (HRP) onsite. NYSDEC spills team on site to oversee the removal and excavation of the gasoline UST. 1130 – NYSDEC offsite. 1410 – NYSDEC back on site to check the area of the removed tank lines. 1430 – NYSDEC offsite. 1500 – Joel Hara offsite.							
<b>Work Completed by HGI:</b> -Backfill floor drain structure FD-5. -Backfill catch basin structure DW-15. -Continue jackhammering pit-7/8. Excavate concrete and bottom slab from the pit. Excavate the sump pit from the deepest point of the pit. Excavate stained and oily soils and store on poly sheeting. -Excavate and remove 1,000-gallon UST from near the former admin building. Tank was located approx. 4 to 8 feet below grade. Soils on the sides of the tank were not observed to have staining or an odor, and PID readings were non-detect. Soil directly beneath the tank had an odor and PID readings as high as 2,000 ppm. HGI continued to excavate beneath the tank until soils appeared clean and PID was non-detect. HGI excavated an additional 3 feet beneath the tank to a total depth of 10 feet below grade. All contaminated soils were staged on poly sheeting and drummed for removal. The remaining fuel lines (approx. 15 linear feet) were excavated and removed. - HRP collected four sidewall samples and one bottom sample from around the UST, and two samples beneath the tank lines.							
<b>Imports/Exports:</b> None							
1600- HGI crew offsite. 1630 – All personnel offsite. Locked gates, system shed.							

[illegible]

### Interaction with Public, Property Owners, Media, etc.

**Include (insert) figures with markups showing location of work and job progress**

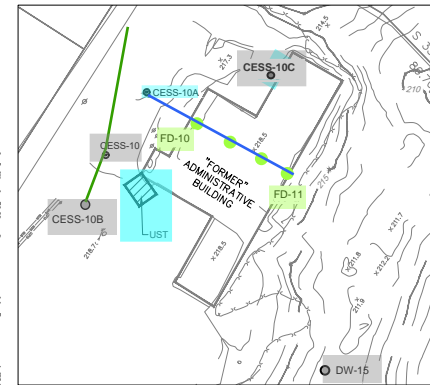
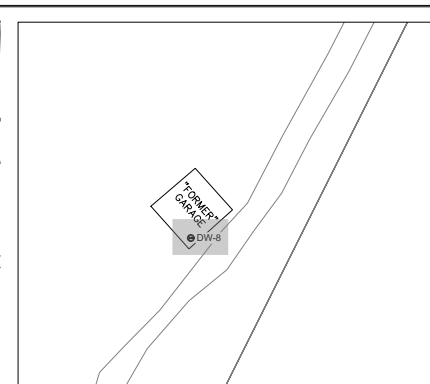
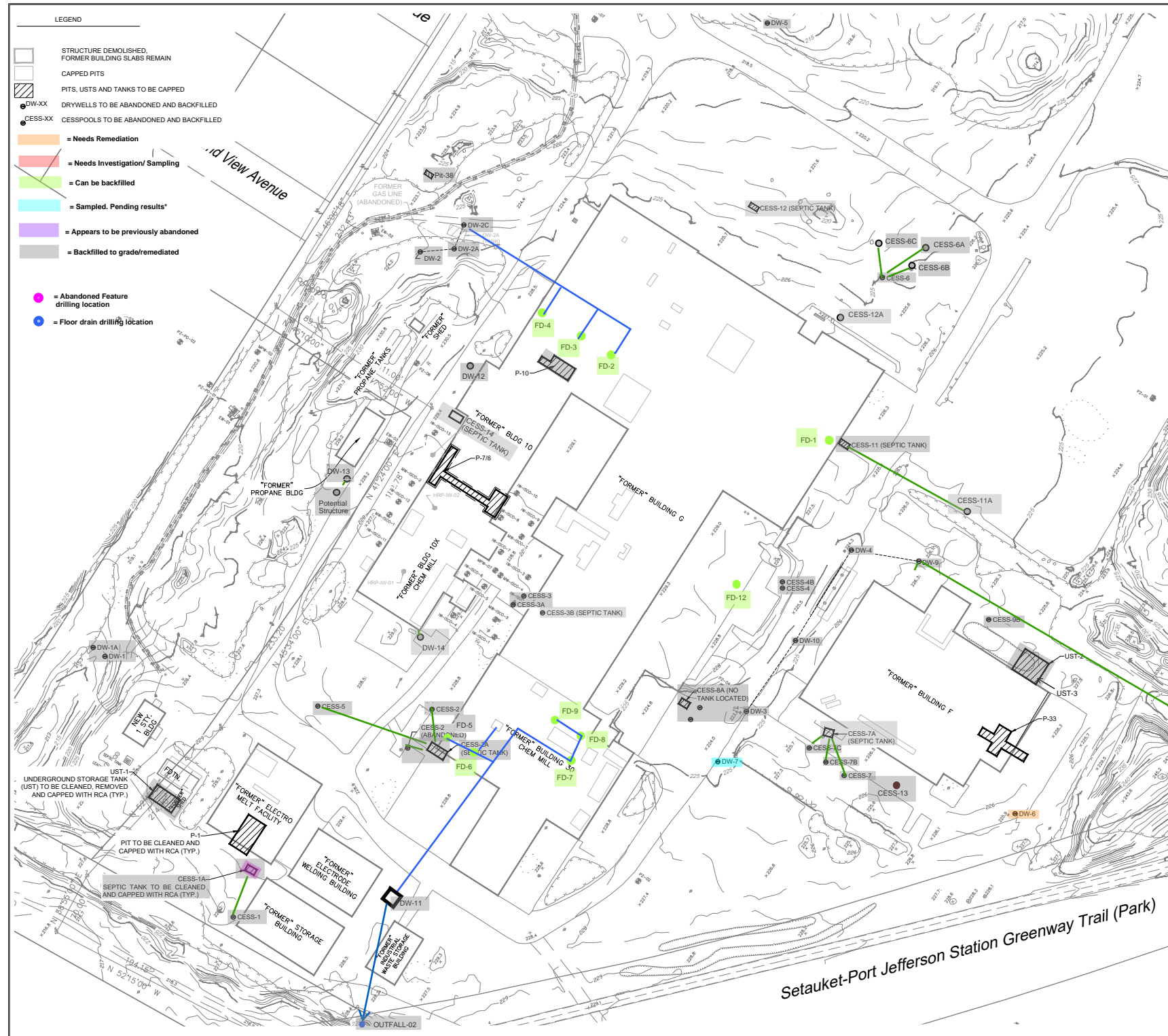



GENERAL NOTES:

1. NOT ALL UTILITIES MAY BE SHOWN. ALL UTILITIES AND STRUCTURES MUST BE VERIFIED BY CONTRACTOR.
2. ALL WELLS WITHIN THE CONSTRUCTION SITE ARE TO BE PROTECTED AND MAINTAINED THROUGHOUT CONSTRUCTION ACTIVITIES.
3. SITE TO BE CLEARED AND GRUBBED AS NECESSARY TO PERFORM THE WORK.

### SUGGESTED CONSTRUCTION SEQUENCE

4. INSTALL STOCKPILE/STAGING AREAS IN ACCORDANCE WITH SHEETS C2.0.
5. INSTALL FENCING IN ACCORDANCE WITH SHEET C2.0.
6. FOLLOWING COORDINATION WITH NYSDEC TO DEWATER AND CLOSE THE VARIOUS PITS, CONTRACTOR SHALL BACKFILL THE PITS, CESS POOLS, DRYWELLS AND USTS TO EXISTING GRADE.
7. REMOVE ALL TEMPORARY EROSION AND SEDIMENT CONTROL MEASURES AND TEMPORARY FENCING AFTER ALL AREAS HAVE BEEN WELL ESTABLISHED AND THE SITE HAS BEEN INSPECTED AND APPROVED BY THE OWNER AND/OR THE OWNER'S REPRESENTATIVE.

Site Photographs (Descriptions Below)	
	
Photo 1 – Excavation of the 1k gallon former gasoline UST.	Photo 2- Removal of the single wall steel gasoline UST
	
Photo 3 – Bottom underneath the UST at around 6ft deep. Due to high PID readings, the bottom was over-excavated to 10ft below ground surface.	Photo 4 – Removal UST tank shell during cutting of manway openings for cleaning purposes.
	
Photo 5 – Endcap of the single wall steel UST.	Photo 6- Western and central portion of Pit-7/8 following removal of concrete debris.
	
Photo 7 – Removed concrete sump from the central portion of Pit-7/8. Sump was removed with sludge oily contents still inside.	Photo 8- Excavated stained soils with strong odors from bottom of pit-7/8.

	
Photo 9 – View of the western side bottom of pit-7/8.	Photo 10 – View of backfilled DW-15.
<b>Comments</b>	
Empty space for comments	
<b>Site Inspector(s):</b> Carly Saindon and Pawel Mecinski	<b>Date:</b> 03/18/2025

Videos of discreet operations have been provided to the DEC Project Manager to facilitate understanding of the ongoing work?  
 Yes ☐ No ☒ N/A ☐

**REMEDIAL ACTIVITIES AT OTHER PROPERTIES**  
**[Residential, Adjacent, AWS, non-Site Properties]**  
**(Section may be deleted for ongoing remedial sites)**

1. Does the Department and its Contractor(s) have permission to enter the property or properties for the day's work?	Yes <input checked="" type="checkbox"/>	No <input type="checkbox"/>
2. Does anyone at this location have any symptoms of a respiratory infection (e.g., cough, sore throat, fever, or shortness of breath)?	Yes <input type="checkbox"/>	No <input checked="" type="checkbox"/>
3. Has anyone at this location been tested and confirmed to have COVID-19?	Yes <input type="checkbox"/>	No <input checked="" type="checkbox"/>
4. If Yes to 1, 2 or 3, follow the latest NYSDOH COVID-19 guidance: <a href="https://coronavirus.health.ny.gov/home">https://coronavirus.health.ny.gov/home</a>	Yes <input type="checkbox"/>	No <input type="checkbox"/>
<u>Comments:</u>		

**ON-SITE WASTE STORAGE**

Drums, roll offs and piles are staged in secure areas?	Yes <input checked="" type="checkbox"/>	No <input type="checkbox"/>	N/A <input type="checkbox"/>
Liners and berms have been installed if necessary to prevent cross contamination of clean areas?	Yes <input type="checkbox"/>	No <input type="checkbox"/>	N/A <input checked="" type="checkbox"/>
Containers are in good condition or properly overpacked?	Yes <input type="checkbox"/>	No <input type="checkbox"/>	N/A <input checked="" type="checkbox"/>
Waste materials are scheduled to be properly characterized and disposed of prior to demobilization?	Yes <input checked="" type="checkbox"/>	No <input type="checkbox"/>	N/A <input type="checkbox"/>
Complying with RCRA 90 day storage limitation for hazardous waste?	Yes <input checked="" type="checkbox"/>	No <input type="checkbox"/>	N/A <input type="checkbox"/>
Piles are securely covered when not in use?	Yes <input checked="" type="checkbox"/>	No <input type="checkbox"/>	N/A <input type="checkbox"/>
Containers are closed when not in use?	Yes <input checked="" type="checkbox"/>	No <input type="checkbox"/>	N/A <input type="checkbox"/>
Staging areas should be inspected periodically and any issues addressed immediately?	Yes <input checked="" type="checkbox"/>	No <input type="checkbox"/>	N/A <input type="checkbox"/>
Signage and labeling comply with RCRA requirements for all staging areas and containers?	Yes <input type="checkbox"/>	No <input type="checkbox"/>	N/A <input checked="" type="checkbox"/>
If any issues noted, has Contractor been notified?	Yes <input type="checkbox"/>	No <input type="checkbox"/>	N/A <input checked="" type="checkbox"/>
<u>Comments:</u>			

**NUISANCE CHECKLIST**

Were there any community complaints related to work on this date?	Yes <input type="checkbox"/>	No <input checked="" type="checkbox"/>	N/A <input type="checkbox"/>
Were there any odors detected on this date?	Yes <input type="checkbox"/>	No <input checked="" type="checkbox"/>	N/A <input type="checkbox"/>
Was noise outside specification and/or above background on this date?	Yes <input type="checkbox"/>	No <input checked="" type="checkbox"/>	N/A <input type="checkbox"/>
Were vibration readings outside specification and/or above background on this date?	Yes <input type="checkbox"/>	No <input checked="" type="checkbox"/>	N/A <input type="checkbox"/>
Any visible dust observed beyond the work perimeter on this date?	Yes <input type="checkbox"/>	No <input checked="" type="checkbox"/>	N/A <input type="checkbox"/>
Any visible contrast (turbidity) beyond engineering controls observed on this date?	Yes <input type="checkbox"/>	No <input checked="" type="checkbox"/>	N/A <input type="checkbox"/>
Was turbidity checked at the outfall(s)?	AM <input type="checkbox"/>	PM <input type="checkbox"/>	N/A <input checked="" type="checkbox"/>
Were any property owners NOT provided advance notice for work performed on this property on this date?	Yes <input type="checkbox"/>	No <input checked="" type="checkbox"/>	N/A <input type="checkbox"/>

Was the temporary fabric structure closed at the end of the day?	Yes <input type="checkbox"/>	No <input type="checkbox"/>	N/A <input checked="" type="checkbox"/>
Has Contractor failed to protect all foundations and structures adjacent to and adjoining the site which are affected by the excavations or other operations connected with performance of the Work?	Yes <input type="checkbox"/>	No <input type="checkbox"/>	N/A <input checked="" type="checkbox"/>
If yes, has Contractor been notified?	Yes <input type="checkbox"/>	No <input type="checkbox"/>	N/A <input checked="" type="checkbox"/>
<u>Comments:</u>			

### RESILIENCE/GREEN REMEDIATION CHECKLIST

Is site power procured from renewable energy sources (e.g., solar, wind, geothermal, biomass and biogas)?	Yes <input type="checkbox"/>	No <input type="checkbox"/>	N/A <input checked="" type="checkbox"/>
Is the Contractor employing 2007 or newer or retrofitted (BART*) diesel on-road trucks and non-road equipment?	Yes <input type="checkbox"/>	No <input type="checkbox"/>	N/A <input checked="" type="checkbox"/>
Is vehicle idling adequately reduced per 6NYCRR Part 217-3?	Yes <input type="checkbox"/>	No <input type="checkbox"/>	N/A <input checked="" type="checkbox"/>
Have equipment operators been trained in the idling requirements of 6NYCRR Part 217-3?	Yes <input type="checkbox"/>	No <input type="checkbox"/>	N/A <input checked="" type="checkbox"/>
Is BART-equipped equipment properly maintained and working?	Yes <input type="checkbox"/>	No <input type="checkbox"/>	N/A <input checked="" type="checkbox"/>
Is work being sequenced to avoid double handling?	Yes <input checked="" type="checkbox"/>	No <input type="checkbox"/>	N/A <input type="checkbox"/>
Is there an onsite recycling program for CONTRACTOR-generated wastes and is it complied with?	Yes <input type="checkbox"/>	No <input type="checkbox"/>	N/A <input checked="" type="checkbox"/>
Are office trailer heating and cooling systems maintained at efficient set points, have programable thermostats been installed?	Yes <input type="checkbox"/>	No <input type="checkbox"/>	N/A <input checked="" type="checkbox"/>
Are products and materials used in performance of the work appropriately certified (e.g., LEED, Energy Star, Sustainable Forestry Initiative®, etc.)?	Yes <input type="checkbox"/>	No <input type="checkbox"/>	N/A <input checked="" type="checkbox"/>
Are resiliency features included in the design, or completed remedy properly installed and/or maintained (flood control, storm water controls, erosion measures, etc.)?	Yes <input type="checkbox"/>	No <input type="checkbox"/>	N/A <input checked="" type="checkbox"/>
Are green remediation elements included in the design, or completed remedy properly installed and/or maintained (e.g., porous pavement, geothermal, variable speed drives, native plantings, natural stream bank restoration, etc.)?	Yes <input type="checkbox"/>	No <input type="checkbox"/>	N/A <input checked="" type="checkbox"/>
Has Contractor been notified of any deficiencies?	Yes <input type="checkbox"/>	No <input type="checkbox"/>	N/A <input checked="" type="checkbox"/>
Are remote/call in job meetings being held in lieu of meeting in person where possible?	Yes <input type="checkbox"/>	No <input checked="" type="checkbox"/>	N/A <input type="checkbox"/>
<u>Comments:</u>			

\* BART – Best Available Retrofit Technology