



LAW

RESOURCES CREATING SOLUTIONS

August 5, 2002

Mr. Mark Soliman
Blue Water Environmental, Inc.
1610 New Highway
Farmingdale, NY 11735

Transmitted Via US Mail

Subject: **Results of Baseline Ground-Water Sampling Program**
 Active Industrial Uniform
 Lindenhurst, New York
 LAW Project Number 22000-0-0019

Dear Mr. Soliman:

Law Engineering and Environmental Services, a Inc. (LAW) MACTEC company is pleased to present this report of the results of the Baseline Ground-Water Sampling Program that was completed at the Active Industrial Uniform (AIU) site in Lindenhurst, New York (Figure 1). The purpose of the sampling event was to assess ground-water quality prior to start-up of the ground-water pump and treat system.

This report provides a summary of the background information, methodologies used during the ground-water sampling, results, and conclusions.

BACKGROUND INFORMATION

The ground-water remediation system at the AIU site is designed to recover and treat ground water impacted with volatile organic compounds (VOCs). The system design is consistent with the remedy stated in the Final Design Contract Documents (Contract Documents) from the New York State Department of Environmental Conservation (NYSDEC) dated March 2000 for the site.

The ground-water remediation system utilizes two recovery wells (wells RW-1 and RW-2) to extract ground water from the subsurface. Recovery well RW-1 is located on-site and well RW-2 is located off-site. Eleven ground-water monitoring wells were installed for monitoring ground-water quality conditions. Eight monitoring wells are located onsite and three monitoring wells are located offsite and downgradient of the site. The discharge pipe for the recovery wells was trenched from the wells to the treatment building. The recovered ground water is treated by an automated air stripping system located at the treatment building. The ground-water treatment system is designed for a flow rate of 250 gallons per minute (gpm). The off-gases from the air stripper are treated with vapor phase carbon and discharged to

LAW Engineering and Environmental Services, Inc.
One Summit Square, Suite 402
Rt. 413 & Doublewoods Road • Langhorne, PA 19047
215-860-1963 • Fax: 215-860-5360

the atmosphere under an air discharge permit equivalency. The treated ground-water is discharged under a State Pollution Discharge Elimination System (SPDES) permit equivalency.

METHODOLOGY

Ground-Water Sampling

On December 13 and 14, 2001, ground-water samples were collected from the eight on-site monitoring wells, and three off-site monitoring wells. Prior to ground-water sampling, a synoptic round of water level measurements were measured in the wells. Depth to water measurements ranged from 0.72 feet from top of casing (TOC) to 7.41 feet TOC. Ground-water measurements and elevations are shown in Table 1.

Each well was purged of three well volumes using a peristaltic pump. Purged water was discharged to the ground surface on-site as directed by State oversight personnel (Environmental Resources Management). After the wells were purged, ground-water samples were collected using a new, disposable Teflon bailer for each well. The following field parameters were measured in the field as the well was purged and recorded on the water sampling logs: pH; specific conductivity; and temperature.

Ground-water samples collected from the 11 wells were analyzed for VOCs using United States Environmental Protection Agency (USEPA) Method 8260B. Samples were submitted to Environmental Testing Laboratories, Inc. (ETL), under proper chain of custody documentation. In addition, a duplicate sample, as well as a field blank and a trip blank were submitted to the laboratory for analysis for (QA/QC) purposes. Table 2 summarizes the December 2001 ground-water analytical data. Copies of the laboratory analytical reports are provided in Appendix A. Copies of ground-water sampling logs are provided in Appendix B.

SUMMARY OF RESULTS

Ground-Water Flow

Figure 2 is a map depicting the configuration of the water table (potentiometric surface) that was prepared using the ground-water elevation data provided in Table 1. As shown on Figure 2, the horizontal component of ground-water flow is in a southerly direction.

Ground-Water Sampling

Analytical results of ground-water samples collected during the December 2001 sampling event indicate that VOCs are present in both on-site and off-site monitoring wells. Concentrations of total VOCs reported in the on-site monitoring wells ranged from 10.1 to 12,104 micrograms per liter (ug/L). As shown in Table 2, vinyl chloride, trans-1,2 dichloroethene, 1,1-dichloroethane, cis-1,2-dichloroethene, 1,1,1-trichloroethane, trichloroethene, tetrachloroethene, o-xylene, 1,2-dichlorobenzene, and 1,2,4,5-tetramethylbenzene were detected at concentrations above NYSDEC ground-water standards. Wells MW-101, MW-102, MW-103, MW-104, MW-105, MW-106, MW-107, and MW-108 had one or more VOCs reported at concentrations above NYSDEC ground-water quality standards. Wells MW-105 and MW-106 had the highest concentrations of total VOCs (12,104 ug/L and 1,245 ug/L respectively). The VOC detected at the highest concentration in these wells was cis-1,2-dichloroethene (11,000 ug/L in well MW-105 and 792 ug/L in well MW-106). Trichloroethene (29.6 ug/L), tetrachloroethene (50.7 ug/L), vinyl chloride (822 ug/L), trans,1,-2-dichloroethene (114 ug/L), 1,1-dichloroethane (50.7 ug/L), 1,1,1-trichloroethane (9.8 ug/L), o-xylene (8.7 ug/L), and 1,2-dichlorobenzene (3.3 ug/L) were also reported at concentrations above NYSDEC ground-water quality standards in well MW-105. Similarly, trichloroethene (222 ug/L), tetrachloroethene (212 ug/L), vinyl chloride (9.2 ug/L), and trans,1,2-dichloroethene (9.8 ug/L) were reported at concentrations above NYSDEC ground-water quality standards in well MW-106.

The concentrations of total VOCs detected in off-site monitoring wells MW-109, MW-110, and MW-111, were 22 ug/L, 13.06 ug/L, and 7.3 ug/L, respectively (Table 2). Well MW-110 had one VOC reported at a concentration above NYSDEC ground-water quality standards for cis-1,2-dichloroethene (8.5 ug/L). In off-site wells MW-109 and MW-111, as shown in Table 2, had no VOCs reported at concentrations above NYSDEC ground-water quality standards.

CONCLUSIONS

- The horizontal component of ground-water flow at the AIU site is in a southerly direction.
- The highest levels of total VOCs were reported in monitoring wells MW-105 (12,104 ug/L), MW-106 (1,245 ug/L), and MW-104 (1014 ug/L).
- The VOCs reported at the highest concentrations in the onsite monitoring wells were cis-1,2-dichloroethene, trichloroethene, tetrachloroethene, and vinyl chloride.

- Cis-1,2-dichloroethene was the only VOC reported at a concentration above NYSDEC ground-water quality standards in the offsite monitoring wells (well MW-110).

CLOSING

We appreciate the opportunity to assist Blue Water Environmental with this project. If you have any questions or need additional information, please do not hesitate to call us.

Sincerely,

LAW ENGINEERING AND ENVIRONMENTAL SERVICES, INC.



Eric Killenbeck
Project Geologist

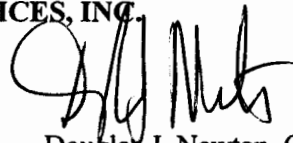

Douglas J. Newton, CPG
Principal Geologist

WEST MERRICK

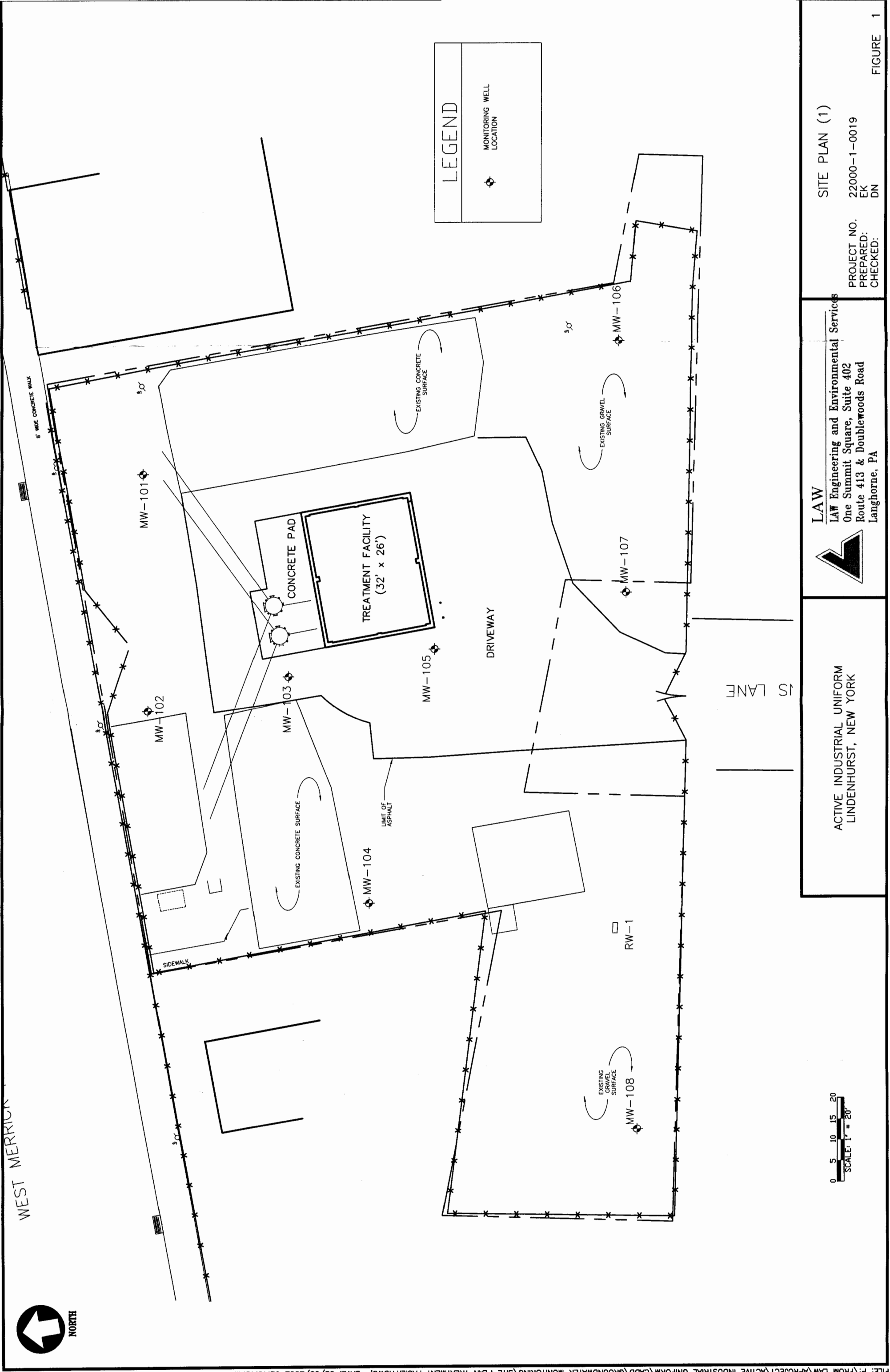

ACTIVE INDUSTRIAL UNIFORM
LINDENHURST, NEW YORK

LAW
 LAW Engineering and Environmental Services
 One Summit Square, Suite 402
 Route 413 & Doublewoods Road
 Langhorne, PA

SITE PLAN (1)
 PROJECT NO. 22000-1-0019
 PREPARED: EK
 CHECKED: DN



WEST MERRICK ROAD (AKA WEST MONTAUK HIGHWAY) SR27A

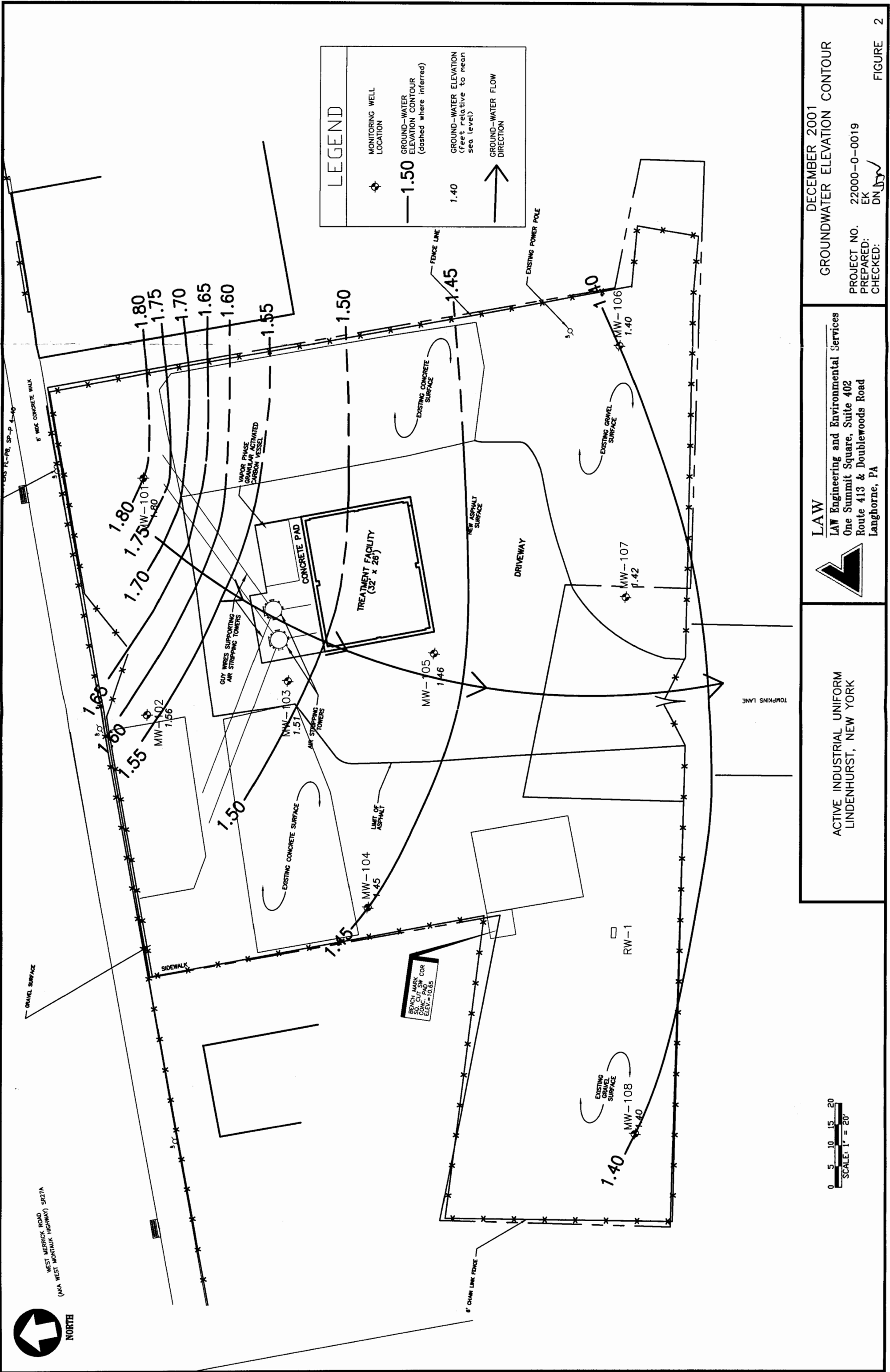

BENCH MARK
SIGN CONCRETE PAD SW COR
ELEV. = 10.85

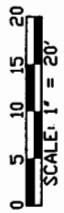

ACTIVE INDUSTRIAL UNIFORM
LINDENHURST, NEW YORK

LAW
LAW Engineering and Environmental Services
One Summit Square, Suite 402
Route 413 & Doublewoods Road
Langhorne, PA

DECEMBER 2001
GROUNDWATER ELEVATION CONTOUR
PROJECT NO. 22000-0-0019
PREPARED BY: EK
CHECKED BY: DNJ
FIGURE 2

TABLE 1
GROUND-WATER ELEVATION DATA AND WELL CONSTRUCTION DETAILS
ACTIVE INDUSTRIAL UNIFORM, LINDENHURST, NEW YORK
LAW PROJECT NO. 22000-0-0019

WELL	DATE DRILLED	LOCATION	TOTAL DEPTH (FT. BGS)	SCREEN INTERVAL (FT. BGS)	CASING WELL DIAMETER (INCHES)	TOP OF CASING ELEVATION (FT. RELATIVE TO MSL)	DEPTH TO GROUND-WATER (FT. BELOW TOC)	12/13/2001 GROUND-WATER LEVEL ELEVATION (FT. RELATIVE TO MSL)
MW-101	06/05/01	On-site	14.22	5-15	2	8.83	7.03	1.80
MW-102	06/05/01	On-site	14.10	5-15	2	8.66	7.10	1.56
MW-103	06/05/01	On-site	13.26	5-15	2	8.57	7.06	1.51
MW-104	06/05/01	On-site	14.24	5-15	2	8.70	7.25	1.45
MW-105	06/05/01	On-site	14.23	5-15	2	8.58	7.12	1.46
MW-106	06/05/01	On-site	14.11	5-15	2	8.50	7.10	1.40
MW-107	06/04/01	On-site	14.30	5-15	2	8.44	7.02	1.42
MW-108	06/04/01	On-site	14.17	5-15	2	8.82	7.41	1.41
MW-109	06/11/01	Off-site	34.60	25-35	2	1.21	0.72	0.49
MW-110	06/12/01	Off-site	34.39	25-35	2	NA	1.34	NA
MW-111	06/12/01	Off-site	34.30	25-35	2	NA	3.25	NA
RW-1	06/06/01	On-site	40.00	10-35	6	NA	7.95	NA
RW-2	06/07/01	Off-site	43.00	12-37	6	NA	NM	NA

Notes:

NM - Not Measured

NA - Not Available

FT. BGS-feet below ground surface

FT. TOC - feet below top of pvc casing

MSL-mean sea level

TABLE 2
 RESULTS OF VOLATILE ORGANIC COMPOUND ANALYSES - DECEMBER 2001
 ACTIVE INDUSTRIAL UNIFORM, LINDENHURST, NEW YORK
 LAW PROJECT NO. 22000-0-0019

Constituent: Units in ug/L	Sample Location: Lab Sample ID: Date Collected:	MW-101 M5723-1 12/14/2001	MW-102 M5724-6 12/13/2001	MW-103 M5724-7 12/13/2001	MW-104 M5724-5 12/13/2001	MW-105 M5723-4 12/14/2001	MW-106 M5723-2 12/14/2001	MW-107 M5723-3 12/14/2001	MW-108 M5724-4 12/13/2001	NYSDEC Standards
Vinyl chloride		< 0.2	< 0.1	< 0.1	6.6	822	9.2	< 0.1	< 0.1	2
Chloroethane		< 1.22	< 0.1	< 0.1	< 0.1	2.2	< 0.61	< 0.61	< 0.61	50
1,1-Dichloroethene		< 0.6	< 0.3	< 0.3	< 0.3	4.8	< 0.3	< 0.3	< 0.3	5
Carbon disulfide		< 0.4	< 0.2	< 0.2	< 0.2	< 0.2	< 0.2	< 0.2	< 0.2	60
t-1,2-Dichloroethene		< 0.4	< 0.2	< 0.2	< 0.2	114	9.8	< 0.2	< 0.2	5
Methyl t-butyl ether		< 0.68	< 0.34	< 0.34	< 0.34	2.7	< 0.34	< 0.34	< 0.34	50
Methylene Chloride		< 0.54	< 0.54	< 0.54	< 0.54	< 0.54	< 0.54	< 0.54	< 0.54	5
1,1-Dichloroethane		< 0.44	< 0.22	< 0.22	< 0.22	50.7	< 0.22	5.6	< 0.22	5
cis-1,2-Dichloroethene		< 0.42	< 0.21	2	9.4	11,000	792	53.3	4.5	5
Chloroform		< 0.4	< 0.2	< 0.2	< 0.2	< 0.2	< 0.2	< 0.2	< 0.2	7
1,1,1-Trichloroethane		< 0.44	< 0.22	< 0.22	< 0.22	9.8	< 0.22	4.3	< 0.22	5
Trichloroethene		< 0.32	1.2	16	40.3	29.6	222	53.4	2.1	5
Bromodichloromethane		< 0.3	< 0.15	< 0.15	< 0.15	< 0.15	< 0.15	< 0.15	< 0.15	50
Tetrachloroethene		< 0.48	8.9	29.1	95.8	50.7	212	75.9	14.9	5
Dibromochloromethane		< 0.22	< 0.11	< 0.11	< 0.11	< 0.11	< 0.11	< 0.11	< 0.11	50
m,p-xylene		< 0.84	< 0.42	< 0.42	< 0.42	1.2	< 0.42	< 0.42	< 0.42	5
o-xylene		< 0.4	< 0.2	< 0.2	< 0.2	8.7	< 0.2	< 0.2	< 0.2	5
p-Ethyltoluene		< 0.48	< 0.24	< 0.24	< 0.24	0.92	< 0.24	< 0.24	< 0.24	NS
1,2,4-Trimethylbenzene		< 0.34	< 0.17	< 0.17	< 0.17	2.2	< 0.17	< 0.17	< 0.17	5
1,2-Dichlorobenzene		< 0.3	< 0.15	< 0.15	< 0.15	3.3	< 0.15	< 0.15	< 0.15	3
p-Diethylbenzene		3	< 0.24	< 0.24	< 0.24	< 0.24	< 0.24	< 0.24	< 0.24	NS
n-Butylbenzene		2.2	< 0.14	< 0.14	< 0.14	< 0.14	< 0.14	< 0.14	< 0.14	5
1,2,4,5-Tetramethylbenzene		16.2	< 0.26	< 0.26	< 0.26	< 0.26	< 0.26	< 0.26	< 0.26	5
Naphthalene		< 0.28	< 0.14	< 0.14	< 0.14	1.7	< 0.14	< 0.14	< 0.14	10
Total VOCs		21.4	10.1	47.1	1,014.3	12,104.52	1,245	192.5	22.7	

ug/L - Micrograms per liter.
 < - Compound less than detection limit listed
 VOCs - Volatile Organic Compounds
 NS - No Standard
Bold Typeface - Concentration above NYSDEC standard.

TABLE 2
 RESULTS OF VOLATILE ORGANIC COMPOUND ANALYSES - DECEMBER 2001
 ACTIVE INDUSTRIAL UNIFORM, LINDENHURST, NEW YORK
 LAW PROJECT NO. 22000-0-0019

Constituent: Units in ug/L	Sample Location:		MW-110		MW-111		Field Blank		Trip Blank		NYSDEC Standards
	Lab Sample ID:	Date Collected:	MW-109	MW-110	MW-111	MW-111	M5724-1	M5724-2	M5724-9	M5724-5	
Vinyl chloride	M5724-5	12/13/2001	< 0.1	< 0.1	< 0.1	< 0.1	< 0.1	< 0.1	< 0.1	< 0.1	2
Chloroethane			< 0.6	< 0.6	< 0.6	< 0.6	< 0.6	< 0.6	< 0.6	< 0.61	50
1,1-Dichloroethene			1.3	< 0.3	< 0.3	< 0.3	< 0.3	< 0.3	< 0.3	< 0.3	5
Carbon disulfide			1.2	1	< 0.2	< 0.2	< 0.2	< 0.2	< 0.2	< 0.2	60
t-1,2-Dichloroethene			< 0.2	< 0.2	< 0.2	< 0.2	< 0.2	< 0.2	< 0.2	< 0.2	5
Methyl t-butyl ether			< 0.3	< 0.3	7.3	< 0.3	< 0.3	< 0.3	< 0.3	< 0.34	50
Methylene Chloride			< 0.5	< 0.5	< 0.5	< 0.5	< 0.5	< 0.5	< 0.5	3.7	5
1,1-Dichloroethane			4.3	< 0.3	< 0.2	< 0.2	< 0.2	< 0.2	< 0.2	< 0.22	5
cis-1,2-Dichloroethene			4.4	8.5	< 0.2	< 0.2	< 0.2	< 0.2	< 0.2	< 0.21	5
Chloroform			< 0.2	1.4	< 0.2	< 0.2	< 0.2	< 0.2	< 0.2	< 0.22	7
1,1,1-Trichloroethane			4.4	< 0.2	< 0.2	< 0.2	< 0.2	< 0.2	< 0.2	< 0.22	5
Trichloroethene			2.9	< 0.2	< 0.2	< 0.2	< 0.2	< 0.2	< 0.2	< 0.16	5
Bromodichloromethane			< 0.2	1	< 0.2	< 0.2	< 0.2	< 0.2	< 0.2	< 0.15	50
Tetrachloroethene			3.5	< 0.2	< 0.2	< 0.2	< 0.2	< 0.2	< 0.2	< 0.24	5
Dibromochloromethane			< 0.1	1.2	< 0.1	< 0.1	< 0.1	< 0.1	< 0.1	< 0.11	50
m,p-xylene			< 0.4	< 0.4	< 0.4	< 0.4	< 0.4	< 0.4	< 0.4	< 0.42	5
o-xylene			< 0.2	< 0.2	< 0.2	< 0.2	< 0.2	< 0.2	< 0.2	< 0.2	5
p-Ethyltoluene			< 0.2	< 0.2	< 0.2	< 0.2	< 0.2	< 0.2	< 0.2	< 0.24	NS
1,2,4-Trimethylbenzene			< 0.2	< 0.2	< 0.2	< 0.2	< 0.2	< 0.2	< 0.2	< 0.17	5
1,2-Dichlorobenzene			< 0.2	< 0.2	< 0.2	< 0.2	< 0.2	< 0.2	< 0.2	< 0.15	3
p-Diethylbenzene			< 0.2	< 0.2	< 0.2	< 0.2	< 0.2	< 0.2	< 0.2	< 0.24	NS
n-Butylbenzene			< 0.1	< 0.1	< 0.1	< 0.1	< 0.1	< 0.1	< 0.1	< 0.14	5
1,2,4,5-Tetramethylbenzene			< 0.3	< 0.3	< 0.3	< 0.3	< 0.3	< 0.3	< 0.3	< 0.26	5
Naphthalene			< 0.1	< 0.1	< 0.1	< 0.1	< 0.1	< 0.1	< 0.1	< 0.14	10
Total VOCs			22	13	7.3	0	0.9	3.7			

ug/L - Micrograms per liter.

< - Compound less than detection limit listed

VOCs - Volatile Organic Compounds

NS - No Standard

Bold Typeface - Concentration above NYSDEC standard.

Environmental Testing Laboratories, Inc.

208 Route 109, Farmingdale NY 11735

Phone - 631-249-1456 Fax - 631-249-8344

12/26/2001

Custody Document: M5724

Received: 12/13/2001 16:20

Sampled by: Eric Killenbeck

Client: Blue Waters (11260)

1610 New Highway
Farmingdale,
NY 11735

Project: Active Industrial

63 West Montauk Hwy
Lindenhurst,
NY

Manager: Mark Soliman

Respectfully submitted,

Laboratory Manager

NYS Lab ID # 10969
NJ Cert. # 73812
CT Cert. # PH0645
MA Cert. # NY061
PA Cert. # 68-535
VA Cert. # 108
NH Cert. # 252592-BA
RI Cert. # 161

Post-it® Fax Note	7671	Date	12/21	# of pages	48
To	Mark Soliman	From			
Co./Dept.		Co.			
Phone #		Phone #			
Fax #		Fax #			



Environmental Testing Laboratories, Inc.

208 Route 109, Farmingdale NY 11735

Phone - 631-249-1456 Fax - 631-249-8344

12/26/2001

Volatiles - EPA 8260B**Sample: M5723-1**

Client Sample ID: MW-101

Collected: 12/14/2001 07:35

Matrix: Liquid

Type: Grab

Remarks: See Case Narrative

Analyzed Date: 12/18/2001

Cas No	Analyte	File ID	MDL	Concentration	Units	Q
75-71-8	Dichlorodifluoromethane	B 657-8686	0.98	0.98	ppb	U
75-45-6	Chlorodifluoromethane	B 657-8686	0.42	0.42	ppb	U
74-87-3	Chloromethane	B 657-8686	0.98	0.98	ppb	U
75-01-4	Vinyl Chloride	B 657-8686	0.20	0.20	ppb	U
74-83-9	Bromomethane	B 657-8686	0.86	0.86	ppb	U
75-00-3	Chloroethane	B 657-8686	1.22	1.22	ppb	U
75-69-4	Trichlorofluoromethane	B 657-8686	0.48	0.48	ppb	U
76-13-1	1,1,2-Trichlorotrifluoroethane	B 657-8686	0.46	0.46	ppb	U
75-35-4	1,1-Dichloroethene	B 657-8686	0.60	0.60	ppb	U
67-64-1	Acetone	B 657-8686	6.24	6.24	ppb	U
75-15-0	Carbon disulfide	B 657-8686	0.40	0.40	ppb	U
75-09-2	Methylene Chloride	B 657-8686	1.08	1.08	ppb	U
156-60-5	t-1,2-Dichloroethene	B 657-8686	0.40	0.40	ppb	U
1634-04-4	Methyl t-butyl ether	B 657-8686	0.68	0.68	ppb	U
75-34-3	1,1-Dichloroethane	B 657-8686	0.44	0.44	ppb	U
590-20-7	2,2-Dichloropropane	B 657-8686	0.36	0.36	ppb	U
156-59-2	c-1,2-Dichloroethene	B 657-8686	0.42	0.42	ppb	U
78-93-3	2-Butanone	B 657-8686	10.0	10.0	ppb	U
74-97-5	Bromochloromethane	B 657-8686	0.54	0.54	ppb	U
67-66-3	Chloroform	B 657-8686	0.40	0.40	ppb	U
71-55-6	1,1,1-Trichloroethane	B 657-8686	0.44	0.44	ppb	U
56-23-5	Carbon Tetrachloride	B 657-8686	0.50	0.50	ppb	U
563-58-6	1,1-Dichloropropene	B 657-8686	1.18	1.18	ppb	U
71-43-2	Benzene	B 657-8686	0.32	0.32	ppb	U
107-06-2	1,2-Dichloroethane	B 657-8686	0.46	0.46	ppb	U
79-01-6	Trichloroethene	B 657-8686	0.32	0.32	ppb	U
78-87-5	1,2-Dichloropropane	B 657-8686	0.72	0.72	ppb	U
74-95-3	Dibromomethane	B 657-8686	0.36	0.36	ppb	U
75-27-4	Bromodichloromethane	B 657-8686	0.30	0.30	ppb	U
110-75-8	2-Chloroethylvinylether	B 657-8686	0.26	0.26	ppb	U
10061-01-5	c-1,3-Dichloropropene	B 657-8686	0.32	0.32	ppb	U
108-10-1	4-Methyl-2-pentanone	B 657-8686	10.0	10.0	ppb	U
108-88-3	Toluene	B 657-8686	0.28	0.28	ppb	U
10061-02-6	t-1,3-Dichloropropene	B 657-8686	0.16	0.16	ppb	U
79-00-5	1,1,2-Trichloroethane	B 657-8686	0.18	0.18	ppb	U
127-18-4	Tetrachloroethene	B 657-8686	0.48	0.48	ppb	U



Environmental Testing Laboratories, Inc.

208 Route 109, Farmingdale NY 11735

Phone - 631-249-1456 Fax - 631-249-8344

12/26/2001

Volatiles - EPA 8260B**Sample: M5723-1...continue**

Client Sample ID: MW-101

Matrix: Liquid

Type: Grab

Collected: 12/14/2001 07:35

Remarks: See Case Narrative

Analyzed Date: 12/18/2001

Gas No	Analyte	File ID	MDL	Concentration	Units	Q
142-28-9	1,3-Dichloropropane	B 657-8686	0.40	0.40	ppb	U
591-78-6	2-Hexanone	B 657-8686	10.0	10.0	ppb	U
124-48-1	Dibromochloromethane	B 657-8686	0.22	0.22	ppb	U
106-93-4	1,2-Dibromoethane	B 657-8686	0.20	0.20	ppb	U
108-90-7	Chlorobenzene	B 657-8686	0.30	0.30	ppb	U
630-20-6	1,1,1,2-Tetrachloroethane	B 657-8686	0.36	0.36	ppb	U
100-41-4	Ethylbenzene	B 657-8686	0.44	0.44	ppb	U
108-38-3	m,p-xylene	B 657-8686	0.84	0.84	ppb	U
95-47-6	o-xylene	B 657-8686	0.40	0.40	ppb	U
100-42-5	Styrene	B 657-8686	0.34	0.34	ppb	U
75-25-2	Bromoform	B 657-8686	0.20	0.20	ppb	U
98-82-8	Isopropylbenzene	B 657-8686	0.50	0.50	ppb	U
108-86-1	Bromobenzene	B 657-8686	0.48	0.48	ppb	U
79-34-5	1,1,2,2-Tetrachloroethane	B 657-8686	0.32	0.32	ppb	U
103-65-1	n-Propylbenzene	B 657-8686	0.42	0.42	ppb	U
96-18-4	1,2,3-Trichloropropane	B 657-8686	0.42	0.42	ppb	U
622-96-8	p-Ethyltoluene	B 657-8686	0.48	0.48	ppb	U
108-67-8	1,3,5-Trimethylbenzene	B 657-8686	0.40	0.40	ppb	U
95-49-8	2-Chlorotoluene	B 657-8686	0.54	0.54	ppb	U
106-43-4	4-Chlorotoluene	B 657-8686	0.70	0.70	ppb	U
98-06-6	tert-Butylbenzene	B 657-8686	0.48	0.48	ppb	U
95-63-6	1,2,4-Trimethylbenzene	B 657-8686	0.34	0.34	ppb	U
135-98-8	sec-Butylbenzene	B 657-8686	0.32	0.32	ppb	U
99-87-6	4-Isopropyltoluene	B 657-8686	0.48	0.48	ppb	U
541-73-1	1,3-Dichlorobenzene	B 657-8686	0.46	0.46	ppb	U
106-46-7	1,4-Dichlorobenzene	B 657-8686	0.46	0.46	ppb	U
95-50-1	1,2-Dichlorobenzene	B 657-8686	0.30	0.30	ppb	U
105-05-5	p-Diethylbenzene	B 657-8686	0.48	3.00	ppb	
104-51-8	n-Butylbenzene	B 657-8686	0.28	2.20	ppb	
95-93-2	1,2,4,5-Tetramethylbenzene	B 657-8686	0.52	16.2	ppb	
96-12-8	1,2-Dibromo-3-chloropropane	B 657-8686	0.66	0.66	ppb	U
120-82-1	1,2,4-Trichlorobenzene	B 657-8686	0.44	0.44	ppb	U
87-68-3	Hexachlorobutadiene	B 657-8686	0.52	0.52	ppb	U
91-20-3	Naphthalene	B 657-8686	0.28	0.28	ppb	U
87-61-6	1,2,3-Trichlorobenzene	B 657-8686	0.34	0.34	ppb	U



Environmental Testing Laboratories, Inc.

208 Route 109, Farmingdale NY 11735

Phone - 631-249-1456 Fax - 631-249-8344

12/26/2001

Volatiles - EPA 8260B**Sample: M5723-1...continue**

Client Sample ID: MW-101

Matrix: Liquid

Remarks: See Case Narrative

Analyzed Date: 12/18/2001

Type: Grab

Collected: 12/14/2001 07:35

Cas No	Surrogate	File ID	% Recovery	QC Limits	0
460-00-4	4-BROMOFLUOROBENZENE	B657-8686	93.0 %	(76 - 112)	
2037-26-5	TOLUENE-D8	B657-8686	106.0 %	(86 - 130)	
4774-33-8	DIBROMOFLUOROMETHANE	B657-8686	109.0 %	(63 - 117)	



Environmental Testing Laboratories, Inc.

208 Route 109, Farmingdale NY 11735

Phone - 631-249-1456 Fax - 631-249-8344

12/26/2001

Volatiles - EPA 8260B**Sample: M5724-6**

Client Sample ID: MW-102

Collected: 12/13/2001 14:20

Matrix: Liquid

Type: Grab

Remarks: See Case Narrative

Analyzed Date: 12/20/2001

Cas No	Analyte	File ID	MDL	Concentration	Units	Q
75-71-8	Dichlorodifluoromethane	B 659-8736	0.49	0.49	ppb	U
75-45-6	Chlorodifluoromethane	B 659-8736	0.21	0.21	ppb	U
74-87-3	Chloromethane	B 659-8736	0.49	0.49	ppb	U
75-01-4	Vinyl Chloride	B 659-8736	0.10	0.10	ppb	U
74-83-9	Bromomethane	B 659-8736	0.43	0.43	ppb	U
75-00-3	Chloroethane	B 659-8736	0.61	0.61	ppb	U
75-69-4	Trichlorofluoromethane	B 659-8736	0.24	0.24	ppb	U
76-13-1	1,1,2-Trichlorotrifluoroethane	B 659-8736	0.23	0.23	ppb	U
75-35-4	1,1-Dichloroethene	B 659-8736	0.30	0.30	ppb	U
67-64-1	Acetone	B 659-8736	3.12	3.12	ppb	U
75-15-0	Carbon disulfide	B 659-8736	0.20	0.20	ppb	U
75-09-2	Methylene Chloride	B 659-8736	0.54	0.54	ppb	U
156-60-5	t-1,2-Dichloroethene	B 659-8736	0.20	0.20	ppb	U
1634-04-4	Methyl t-butyl ether	B 659-8736	0.34	0.34	ppb	U
75-34-3	1,1-Dichloroethane	B 659-8736	0.22	0.22	ppb	U
590-20-7	2,2-Dichloropropane	B 659-8736	0.18	0.18	ppb	U
156-59-2	c-1,2-Dichloroethene	B 659-8736	0.21	0.21	ppb	U
78-93-3	2-Butanone	B 659-8736	5.00	5.00	ppb	U
74-97-5	Bromochloromethane	B 659-8736	0.27	0.27	ppb	U
67-66-3	Chloroform	B 659-8736	0.20	0.20	ppb	U
71-55-6	1,1,1-Trichloroethane	B 659-8736	0.22	0.22	ppb	U
56-23-5	Carbon Tetrachloride	B 659-8736	0.25	0.25	ppb	U
563-58-6	1,1-Dichloropropene	B 659-8736	0.59	0.59	ppb	U
71-43-2	Benzene	B 659-8736	0.16	0.16	ppb	U
107-06-2	1,2-Dichloroethane	B 659-8736	0.23	0.23	ppb	U
79-01-6	Trichloroethene	B 659-8736	0.16	1.20	ppb	
78-87-5	1,2-Dichloropropane	B 659-8736	0.36	0.36	ppb	U
74-95-3	Dibromomethane	B 659-8736	0.18	0.18	ppb	U
75-27-4	Bromodichloromethane	B 659-8736	0.15	0.15	ppb	U
110-75-8	2-Chloroethylvinylether	B 659-8736	0.13	0.13	ppb	U
10061-01-5	c-1,3-Dichloropropene	B 659-8736	0.16	0.16	ppb	U
108-10-1	4-Methyl-2-pentanone	B 659-8736	5.00	5.00	ppb	U
108-88-3	Toluene	B 659-8736	0.14	0.14	ppb	U
10061-02-6	t-1,3-Dichloropropene	B 659-8736	0.080	0.080	ppb	U
79-00-5	1,1,2-Trichloroethane	B 659-8736	0.090	0.090	ppb	U
127-18-4	Tetrachloroethene	B 659-8736	0.24	8.90	ppb	



Environmental Testing Laboratories, Inc.

208 Route 109, Farmingdale NY 11735

Phone - 631-249-1456 Fax - 631-249-8344

12/26/2001

Volatiles - EPA 8260B**Sample: M5724-6...continue**

Client Sample ID: MW-102

Collected: 12/13/2001 14:20

Matrix: Liquid

Type: Grab

Remarks: See Case Narrative

Analyzed Date: 12/20/2001

Cas No	Analyte	File ID	MDL	Concentration	Units	Q
142-28-9	1,3-Dichloropropane	B 659-8736	0.20	0.20	ppb	U
591-78-6	2-Hexanone	B 659-8736	5.00	5.00	ppb	U
124-48-1	Dibromochloromethane	B 659-8736	0.11	0.11	ppb	U
106-93-4	1,2-Dibromoethane	B 659-8736	0.10	0.10	ppb	U
108-90-7	Chlorobenzene	B 659-8736	0.15	0.15	ppb	U
630-20-6	1,1,1,2-Tetrachloroethane	B 659-8736	0.18	0.18	ppb	U
100-41-4	Ethylbenzene	B 659-8736	0.22	0.22	ppb	U
108-38-3	m,p-xylene	B 659-8736	0.42	0.42	ppb	U
95-47-6	o-xylene	B 659-8736	0.20	0.20	ppb	U
100-42-5	Styrene	B 659-8736	0.17	0.17	ppb	U
75-25-2	Bromoform	B 659-8736	0.10	0.10	ppb	U
98-82-8	Isopropylbenzene	B 659-8736	0.25	0.25	ppb	U
108-86-1	Bromobenzene	B 659-8736	0.24	0.24	ppb	U
79-34-5	1,1,2,2-Tetrachloroethane	B 659-8736	0.16	0.16	ppb	U
103-65-1	n-Propylbenzene	B 659-8736	0.21	0.21	ppb	U
96-18-4	1,2,3-Trichloropropane	B 659-8736	0.21	0.21	ppb	U
622-96-8	p-Ethyltoluene	B 659-8736	0.24	0.24	ppb	U
108-67-8	1,3,5-Trimethylbenzene	B 659-8736	0.20	0.20	ppb	U
95-49-8	2-Chlorotoluene	B 659-8736	0.27	0.27	ppb	U
106-43-4	4-Chlorotoluene	B 659-8736	0.35	0.35	ppb	U
98-06-6	tert-Butylbenzene	B 659-8736	0.24	0.24	ppb	U
95-63-6	1,2,4-Trimethylbenzene	B 659-8736	0.17	0.17	ppb	U
135-98-8	sec-Butylbenzene	B 659-8736	0.16	0.16	ppb	U
99-87-6	4-Isopropyltoluene	B 659-8736	0.24	0.24	ppb	U
541-73-1	1,3-Dichlorobenzene	B 659-8736	0.23	0.23	ppb	U
106-46-7	1,4-Dichlorobenzene	B 659-8736	0.23	0.23	ppb	U
95-50-1	1,2-Dichlorobenzene	B 659-8736	0.15	0.15	ppb	U
105-05-5	p-Diethylbenzene	B 659-8736	0.24	0.24	ppb	U
104-51-8	n-Butylbenzene	B 659-8736	0.14	0.14	ppb	U
95-93-2	1,2,4,5-Tetramethylbenzene	B 659-8736	0.26	0.26	ppb	U
96-12-8	1,2-Dibromo-3-chloropropane	B 659-8736	0.33	0.33	ppb	U
120-82-1	1,2,4-Trichlorobenzene	B 659-8736	0.22	0.22	ppb	U
87-68-3	Hexachlorobutadiene	B 659-8736	0.26	0.26	ppb	U
91-20-3	Naphthalene	B 659-8736	0.14	0.14	ppb	U
87-61-6	1,2,3-Trichlorobenzene	B 659-8736	0.17	0.17	ppb	U



Environmental Testing Laboratories, Inc.

208 Route 109, Farmingdale NY 11735

Phone - 631-249-1456 Fax - 631-249-8344

12/26/2001

Volatiles - EPA 8260B**Sample: M5724-6...continue**

Client Sample ID: MW-102

Matrix: Liquid

Remarks: See Case Narrative

Analyzed Date: 12/20/2001

Type: Grab

Collected: 12/13/2001 14:20

Gas No	Surrogate	File ID	% Recovery	QC Limits
460-00-4	4-BROMOFLUOROBENZENE	B659-8736	99.6 %	(78 - 112)
2037-26-5	TOLUENE-D8	B659-8736	103.0 %	(86 - 110)
4774-33-8	DIBROMOFLUOROMETHANE	B659-8736	106.0 %	(65 - 117)



Environmental Testing Laboratories, Inc.

208 Route 109, Farmingdale NY 11735

Phone - 631-249-1456 Fax - 631-249-8344

12/26/2001

Volatiles - EPA 8260B**Sample: M5724-7**

Client Sample ID: MW-103

Collected: 12/13/2001 14:55

Matrix: Liquid

Type: Grab

Remarks: See Case Narrative

Analyzed Date: 12/20/2001

Cas No	Analyte	File ID	MDL	Concentration	Units	Q
75-71-8	Dichlorodifluoromethane	B 659-8737	0.49	0.49	ppb	U
75-45-6	Chlorodifluoromethane	B 659-8737	0.21	0.21	ppb	U
74-87-3	Chloromethane	B 659-8737	0.49	0.49	ppb	U
75-01-4	Vinyl Chloride	B 659-8737	0.10	0.10	ppb	U
74-83-9	Bromomethane	B 659-8737	0.43	0.43	ppb	U
75-00-3	Chloroethane	B 659-8737	0.61	0.61	ppb	U
75-69-4	Trichlorofluoromethane	B 659-8737	0.24	0.24	ppb	U
76-13-1	1,1,2-Trichlorotrifluoroethane	B 659-8737	0.23	0.23	ppb	U
75-35-4	1,1-Dichloroethene	B 659-8737	0.30	0.30	ppb	U
67-64-1	Acetone	B 659-8737	3.12	3.12	ppb	U
75-15-0	Carbon disulfide	B 659-8737	0.20	0.20	ppb	U
75-09-2	Methylene Chloride	B 659-8737	0.54	0.54	ppb	U
156-60-5	t-1,2-Dichloroethene	B 659-8737	0.20	0.20	ppb	U
1634-04-4	Methyl t-butyl ether	B 659-8737	0.34	0.34	ppb	U
75-34-3	1,1-Dichloroethane	B 659-8737	0.22	0.22	ppb	U
590-20-7	2,2-Dichloropropane	B 659-8737	0.18	0.18	ppb	U
156-59-2	c-1,2-Dichloroethene	B 659-8737	0.21	2.00	ppb	
78-93-3	2-Butanone	B 659-8737	5.00	5.00	ppb	U
74-97-5	Bromochloromethane	B 659-8737	0.27	0.27	ppb	U
67-66-3	Chloroform	B 659-8737	0.20	0.20	ppb	U
71-55-6	1,1,1-Trichloroethane	B 659-8737	0.22	0.22	ppb	U
56-23-5	Carbon Tetrachloride	B 659-8737	0.25	0.25	ppb	U
563-58-6	1,1-Dichloropropene	B 659-8737	0.59	0.59	ppb	U
71-43-2	Benzene	B 659-8737	0.16	0.16	ppb	U
107-06-2	1,2-Dichloroethane	B 659-8737	0.23	0.23	ppb	U
79-01-6	Trichloroethene	B 659-8737	0.16	16.0	ppb	
78-87-5	1,2-Dichloropropane	B 659-8737	0.36	0.36	ppb	U
74-95-3	Dibromomethane	B 659-8737	0.18	0.18	ppb	U
75-27-4	Bromodichloromethane	B 659-8737	0.15	0.15	ppb	U
110-75-8	2-Chloroethylvinylether	B 659-8737	0.13	0.13	ppb	U
10061-01-5	c-1,3-Dichloropropene	B 659-8737	0.16	0.16	ppb	U
108-10-1	4-Methyl-2-pentanone	B 659-8737	5.00	5.00	ppb	U
108-88-3	Toluene	B 659-8737	0.14	0.14	ppb	U
10061-02-6	t-1,3-Dichloropropene	B 659-8737	0.080	0.080	ppb	U
79-00-5	1,1,2-Trichloroethane	B 659-8737	0.090	0.090	ppb	U
127-18-4	Tetrachloroethene	B 659-8737	0.24	29.1	ppb	



Environmental Testing Laboratories, Inc.

208 Route 109, Farmingdale NY 11735

Phone - 631-249-1456 Fax - 631-249-8344

12/26/2001

Volatiles - EPA 8260B**Sample: M5724-7...continue**

Client Sample ID: MW-103

Matrix: Liquid

Type: Grab

Collected: 12/13/2001 14:55

Remarks: See Case Narrative

Analyzed Date: 12/20/2001

Cas No	Analyte	File ID	MDL	Concentration	Units	Q
142-28-9	1,3-Dichloropropane	B 659-8737	0.20	0.20	ppb	U
591-78-6	2-Hexanone	B 659-8737	5.00	5.00	ppb	U
124-48-1	Dibromochloromethane	B 659-8737	0.11	0.11	ppb	U
106-93-4	1,2-Dibromoethane	B 659-8737	0.10	0.10	ppb	U
108-90-7	Chlorobenzene	B 659-8737	0.15	0.15	ppb	U
630-20-6	1,1,1,2-Tetrachloroethane	B 659-8737	0.18	0.18	ppb	U
100-41-4	Ethylbenzene	B 659-8737	0.22	0.22	ppb	U
108-38-3	m,p-xylene	B 659-8737	0.42	0.42	ppb	U
95-47-6	o-xylene	B 659-8737	0.20	0.20	ppb	U
100-42-5	Styrene	B 659-8737	0.17	0.17	ppb	U
75-25-2	Bromoform	B 659-8737	0.10	0.10	ppb	U
98-82-8	Isopropylbenzene	B 659-8737	0.25	0.25	ppb	U
108-86-1	Bromobenzene	B 659-8737	0.24	0.24	ppb	U
79-34-5	1,1,2,2-Tetrachloroethane	B 659-8737	0.16	0.16	ppb	U
103-65-1	n-Propylbenzene	B 659-8737	0.21	0.21	ppb	U
96-18-4	1,2,3-Trichloropropane	B 659-8737	0.21	0.21	ppb	U
622-96-8	p-Ethyltoluene	B 659-8737	0.24	0.24	ppb	U
108-67-8	1,3,5-Trimethylbenzene	B 659-8737	0.20	0.20	ppb	U
95-49-8	2-Chlorotoluene	B 659-8737	0.27	0.27	ppb	U
106-43-4	4-Chlorotoluene	B 659-8737	0.35	0.35	ppb	U
98-06-6	tert-Butylbenzene	B 659-8737	0.24	0.24	ppb	U
95-63-6	1,2,4-Trimethylbenzene	B 659-8737	0.17	0.17	ppb	U
135-98-8	sec-Butylbenzene	B 659-8737	0.16	0.16	ppb	U
99-87-6	4-Isopropyltoluene	B 659-8737	0.24	0.24	ppb	U
541-73-1	1,3-Dichlorobenzene	B 659-8737	0.23	0.23	ppb	U
106-46-7	1,4-Dichlorobenzene	B 659-8737	0.23	0.23	ppb	U
95-50-1	1,2-Dichlorobenzene	B 659-8737	0.15	0.15	ppb	U
105-05-5	p-Diethylbenzene	B 659-8737	0.24	0.24	ppb	U
104-51-8	n-Butylbenzene	B 659-8737	0.14	0.14	ppb	U
95-93-2	1,2,4,5-Tetramethylbenzene	B 659-8737	0.26	0.26	ppb	U
96-12-8	1,2-Dibromo-3-chloropropane	B 659-8737	0.33	0.33	ppb	U
120-82-1	1,2,4-Trichlorobenzene	B 659-8737	0.22	0.22	ppb	U
87-68-3	Hexachlorobutadiene	B 659-8737	0.26	0.26	ppb	U
91-20-3	Naphthalene	B 659-8737	0.14	0.14	ppb	U
87-61-6	1,2,3-Trichlorobenzene	B 659-8737	0.17	0.17	ppb	U



Environmental Testing Laboratories, Inc.

208 Route 109, Farmingdale NY 11735

Phone - 631-249-1456 Fax - 631-249-8344

12/26/2001

Volatiles - EPA 8260B**Sample: M5724-7...continue**

Client Sample ID: MW-103

Matrix: Liquid

Remarks: See Case Narrative

Analyzed Date: 12/20/2001

Type: Grab

Collected: 12/13/2001 14:55

Gas No	Surrogate	File ID	% Recovery	QC Limits	Q
460-00-4	4-BROMOFLUOROBENZENE	B659-8737	100.0 %	(78 - 112)	
2037-26-5	TOLUENE-D8	B659-8737	103.0 %	(86 - 130)	
4774-33-8	DIBROMOFLUOROMETHANE	B659-8737	100.0 %	(65 - 117)	



Environmental Testing Laboratories, Inc.

208 Route 109, Farmingdale NY 11735

Phone - 631-249-1456 Fax - 631-249-8344

12/26/2001

Volatiles - EPA 8260B**Sample: M5724-5**

Client Sample ID: MW-104

Collected: 12/13/2001 13:50

Matrix: Liquid

Type: Grab

Remarks: See Case Narrative

Analyzed Date: 12/20/2001

Cas No	Analyte	File ID	MDL	Concentration	Units	Q
75-71-8	Dichlorodifluoromethane	B 659-8735	0.49	0.49	ppb	U
75-45-6	Chlorodifluoromethane	B 659-8735	0.21	0.21	ppb	U
74-87-3	Chloromethane	B 659-8735	0.49	0.49	ppb	U
75-01-4	Vinyl Chloride	B 659-8735	0.10	6.60	ppb	
74-83-9	Bromomethane	B 659-8735	0.43	0.43	ppb	U
75-00-3	Chloroethane	B 659-8735	0.61	0.61	ppb	U
75-69-4	Trichlorofluoromethane	B 659-8735	0.24	0.24	ppb	U
76-13-1	1,1,2-Trichlorotrifluoroethane	B 659-8735	0.23	0.23	ppb	U
75-35-4	1,1-Dichloroethene	B 659-8735	0.30	0.30	ppb	U
67-64-1	Acetone	B 659-8735	3.12	3.12	ppb	U
75-15-0	Carbon disulfide	B 659-8735	0.20	0.20	ppb	U
75-09-2	Methylene Chloride	B 659-8735	0.54	0.54	ppb	U
156-60-5	t-1,2-Dichloroethene	B 659-8735	0.20	0.20	ppb	U
1634-04-4	Methyl t-butyl ether	B 659-8735	0.34	0.34	ppb	U
75-34-3	1,1-Dichloroethane	B 659-8735	0.22	0.22	ppb	U
590-20-7	2,2-Dichloropropane	B 659-8735	0.18	0.18	ppb	U
156-59-2	c-1,2-Dichloroethene	B 659-8735	0.21	9.40	ppb	
78-93-3	2-Butanone	B 659-8735	5.00	5.00	ppb	U
74-97-5	Bromochloromethane	B 659-8735	0.27	0.27	ppb	U
67-66-3	Chloroform	B 659-8735	0.20	0.20	ppb	U
71-55-6	1,1,1-Trichloroethane	B 659-8735	0.22	0.22	ppb	U
56-23-5	Carbon Tetrachloride	B 659-8735	0.25	0.25	ppb	U
563-58-6	1,1-Dichloropropene	B 659-8735	0.59	0.59	ppb	U
71-43-2	Benzene	B 659-8735	0.16	0.16	ppb	U
107-06-2	1,2-Dichloroethane	B 659-8735	0.23	0.23	ppb	U
79-01-6	Trichloroethene	B 659-8735	0.16	40.3	ppb	
78-87-5	1,2-Dichloropropane	B 659-8735	0.36	0.36	ppb	U
74-95-3	Dibromomethane	B 659-8735	0.18	0.18	ppb	U
75-27-4	Bromodichloromethane	B 659-8735	0.15	0.15	ppb	U
110-75-8	2-Chloroethylvinylether	B 659-8735	0.13	0.13	ppb	U
10061-01-5	c-1,3-Dichloropropene	B 659-8735	0.16	0.16	ppb	U
108-10-1	4-Methyl-2-pentanone	B 659-8735	5.00	5.00	ppb	U
108-88-3	Toluene	B 659-8735	0.14	0.14	ppb	U
10061-02-6	t-1,3-Dichloropropene	B 659-8735	0.080	0.080	ppb	U
79-00-5	1,1,2-Trichloroethane	B 659-8735	0.090	0.090	ppb	U
127-18-4	Tetrachloroethene	B 662-8816	4.80	958	ppb	



Environmental Testing Laboratories, Inc.

208 Route 109, Farmingdale NY 11735

Phone - 631-249-1456 Fax - 631-249-8344

12/26/2001

Volatiles - EPA 8260B**Sample: M5724-5...continue**

Client Sample ID: MW-104

Matrix: Liquid

Type: Grab

Collected: 12/13/2001 13:50

Remarks: See Case Narrative

Analyzed Date: 12/20/2001

Cas No	Analyte	File ID	MDL	Concentration	Units	Q
142-28-9	1,3-Dichloropropane	B 659-8735	0.20	0.20	ppb	U
591-78-6	2-Hexanone	B 659-8735	5.00	5.00	ppb	U
124-48-1	Dibromochloromethane	B 659-8735	0.11	0.11	ppb	U
106-93-4	1,2-Dibromoethane	B 659-8735	0.10	0.10	ppb	U
108-90-7	Chlorobenzene	B 659-8735	0.15	0.15	ppb	U
630-20-6	1,1,1,2-Tetrachloroethane	B 659-8735	0.18	0.18	ppb	U
100-41-4	Ethylbenzene	B 659-8735	0.22	0.22	ppb	U
108-38-3	m,p-xylene	B 659-8735	0.42	0.42	ppb	U
95-47-6	o-xylene	B 659-8735	0.20	0.20	ppb	U
100-42-5	Styrene	B 659-8735	0.17	0.17	ppb	U
75-25-2	Bromoform	B 659-8735	0.10	0.10	ppb	U
98-82-8	Isopropylbenzene	B 659-8735	0.25	0.25	ppb	U
108-86-1	Bromobenzene	B 659-8735	0.24	0.24	ppb	U
79-34-5	1,1,2,2-Tetrachloroethane	B 659-8735	0.16	0.16	ppb	U
103-65-1	n-Propylbenzene	B 659-8735	0.21	0.21	ppb	U
96-18-4	1,2,3-Trichloropropane	B 659-8735	0.21	0.21	ppb	U
622-96-8	p-Ethyltoluene	B 659-8735	0.24	0.24	ppb	U
108-67-8	1,3,5-Trimethylbenzene	B 659-8735	0.20	0.20	ppb	U
95-49-8	2-Chlorotoluene	B 659-8735	0.27	0.27	ppb	U
106-43-4	4-Chlorotoluene	B 659-8735	0.35	0.35	ppb	U
98-06-6	tert-Butylbenzene	B 659-8735	0.24	0.24	ppb	U
95-63-6	1,2,4-Trimethylbenzene	B 659-8735	0.17	0.17	ppb	U
135-98-8	sec-Butylbenzene	B 659-8735	0.16	0.16	ppb	U
99-87-6	4-Isopropyltoluene	B 659-8735	0.24	0.24	ppb	U
541-73-1	1,3-Dichlorobenzene	B 659-8735	0.23	0.23	ppb	U
106-46-7	1,4-Dichlorobenzene	B 659-8735	0.23	0.23	ppb	U
95-50-1	1,2-Dichlorobenzene	B 659-8735	0.15	0.15	ppb	U
105-05-5	p-Diethylbenzene	B 659-8735	0.24	0.24	ppb	U
104-51-8	n-Butylbenzene	B 659-8735	0.14	0.14	ppb	U
95-93-2	1,2,4,5-Tetramethylbenzene	B 659-8735	0.26	0.26	ppb	U
96-12-8	1,2-Dibromo-3-chloropropane	B 659-8735	0.33	0.33	ppb	U
120-82-1	1,2,4-Trichlorobenzene	B 659-8735	0.22	0.22	ppb	U
87-68-3	Hexachlorobutadiene	B 659-8735	0.26	0.26	ppb	U
91-20-3	Naphthalene	B 659-8735	0.14	0.14	ppb	U
87-61-6	1,2,3-Trichlorobenzene	B 659-8735	0.17	0.17	ppb	U



Environmental Testing Laboratories, Inc.

208 Route 109, Farmingdale NY 11735

Phone - 631-249-1456 Fax - 631-249-8344

12/27/2001

Volatiles - EPA 8260B**Sample: M5724-5...continue**

Client Sample ID: MW-104

Collected: 12/13/2001 13:50

Matrix: Liquid

Type: Grab

Remarks: See Case Narrative

Analyzed Date: 12/20/2001

Cas No.	Surrogate	File ID	% Recovery	QC Limits	Q
460-00-4	4-BROMOFLUOROBENZENE	B659-8735	99.1 %	(78 - 112)	
2037-26-5	TOLUENE-D8	B659-8735	105.0 %	(86 - 110)	
4774-33-8	DIBROMOFLUOROMETHANE	B659-8735	99.5 %	(65 - 117)	
460-00-4	4-BROMOFLUOROBENZENE	B662-8816	106.0 %	(78 - 112)	
2037-26-5	TOLUENE-D8	B662-8816	98.9 %	(86 - 110)	
4774-33-8	DIBROMOFLUOROMETHANE	B662-8816	95.2 %	(65 - 117)	



Environmental Testing Laboratories, Inc.

208 Route 109, Farmingdale NY 11735

Phone - 631-249-1456 Fax - 631-249-8344

12/26/2001

Volatiles - EPA 8260B**Sample: M5723-4**

Client Sample ID: MW-105

Collected: 12/14/2001 09:15

Matrix: Liquid

Type: Grab

Remarks: See Case Narrative

Analyzed Date: 12/18/2001

Cas No	Analyte	File ID	MDL	Concentration	Units	Q
75-71-8	Dichlorodifluoromethane	B 657-8689	0.49	0.49	ppb	U
75-45-6	Chlorodifluoromethane	B 657-8689	0.21	0.21	ppb	U
74-87-3	Chloromethane	B 657-8689	0.49	0.49	ppb	U
75-01-4	Vinyl Chloride	B 658-8708	10.0	822	ppb	
74-83-9	Bromomethane	B 657-8689	0.43	0.43	ppb	U
75-00-3	Chloroethane	B 657-8689	0.61	2.20	ppb	
75-69-4	Trichlorofluoromethane	B 657-8689	0.24	0.24	ppb	U
76-13-1	1,1,2-Trichlorotrifluoroethane	B 657-8689	0.23	0.23	ppb	U
75-35-4	1,1-Dichloroethene	B 657-8689	0.30	4.80	ppb	
67-64-1	Acetone	B 657-8689	3.12	3.12	ppb	U
75-15-0	Carbon disulfide	B 657-8689	0.20	0.20	ppb	U
75-09-2	Methylene Chloride	B 657-8689	0.54	0.54	ppb	U
156-60-5	t-1,2-Dichloroethene	B 657-8689	0.20	114	ppb	
1634-04-4	Methyl t-butyl ether	B 657-8689	0.34	2.70	ppb	
75-34-3	1,1-Dichloroethane	B 657-8689	0.22	50.7	ppb	
590-20-7	2,2-Dichloropropane	B 657-8689	0.18	0.18	ppb	U
156-59-2	c-1,2-Dichloroethene	B 658-8708	21.0	11000	ppb	
78-93-3	2-Butanone	B 657-8689	5.00	5.00	ppb	U
74-97-5	Bromochloromethane	B 657-8689	0.27	0.27	ppb	U
67-66-3	Chloroform	B 657-8689	0.20	0.20	ppb	U
71-55-6	1,1,1-Trichloroethane	B 657-8689	0.22	9.80	ppb	
56-23-5	Carbon Tetrachloride	B 657-8689	0.25	0.25	ppb	U
563-58-6	1,1-Dichloropropene	B 657-8689	0.59	0.59	ppb	U
71-43-2	Benzene	B 657-8689	0.16	0.16	ppb	U
107-06-2	1,2-Dichloroethane	B 657-8689	0.23	0.23	ppb	U
79-01-6	Trichloroethene	B 657-8689	0.16	29.6	ppb	
78-87-5	1,2-Dichloropropane	B 657-8689	0.36	0.36	ppb	U
74-95-3	Dibromomethane	B 657-8689	0.18	0.18	ppb	U
75-27-4	Bromodichloromethane	B 657-8689	0.15	0.15	ppb	U
110-75-8	2-Chloroethylvinylether	B 657-8689	0.13	0.13	ppb	U
10061-01-5	c-1,3-Dichloropropene	B 657-8689	0.16	0.16	ppb	U
108-10-1	4-Methyl-2-pentanone	B 657-8689	5.00	5.00	ppb	U
108-88-3	Toluene	B 657-8689	0.14	2.20	ppb	
10061-02-6	t-1,3-Dichloropropene	B 657-8689	0.080	0.080	ppb	U
79-00-5	1,1,2-Trichloroethane	B 657-8689	0.090	0.090	ppb	U
127-18-4	Tetrachloroethene	B 657-8689	0.24	50.7	ppb	



Environmental Testing Laboratories, Inc.

208 Route 109, Farmingdale NY 11735

Phone - 631-249-1456 Fax - 631-249-8344

12/26/2001

Volatiles - EPA 8260B**Sample: M5723-4...continue**

Client Sample ID: MW-105

Matrix: Liquid

Type: Grab

Collected: 12/14/2001 09:15

Remarks: See Case Narrative

Analyzed Date: 12/18/2001

Cas No	Analyte	File ID	MDL	Concentration	Units	Q
142-28-9	1,3-Dichloropropane	B 657-8689	0.20	0.20	ppb	U
591-78-6	2-Hexanone	B 657-8689	5.00	5.00	ppb	U
124-48-1	Dibromochloromethane	B 657-8689	0.11	0.11	ppb	U
106-93-4	1,2-Dibromoethane	B 657-8689	0.10	0.10	ppb	U
108-90-7	Chlorobenzene	B 657-8689	0.15	0.15	ppb	U
630-20-6	1,1,1,2-Tetrachloroethane	B 657-8689	0.18	0.18	ppb	U
100-41-4	Ethylbenzene	B 657-8689	0.22	0.22	ppb	U
108-38-3	m,p-xylene	B 657-8689	0.42	1.20	ppb	
95-47-6	o-xylene	B 657-8689	0.20	8.70	ppb	
100-42-5	Styrene	B 657-8689	0.17	0.17	ppb	U
75-25-2	Bromoform	B 657-8689	0.10	0.10	ppb	U
98-82-8	Isopropylbenzene	B 657-8689	0.25	0.25	ppb	U
108-86-1	Bromobenzene	B 657-8689	0.24	0.24	ppb	U
79-34-5	1,1,1,2-Tetrachloroethane	B 657-8689	0.16	0.16	ppb	U
103-65-1	n-Propylbenzene	B 657-8689	0.21	0.21	ppb	U
96-18-4	1,2,3-Trichloropropane	B 657-8689	0.21	0.21	ppb	U
622-96-8	p-Ethyltoluene	B 657-8689	0.24	0.92	ppb	
108-67-8	1,3,5-Trimethylbenzene	B 657-8689	0.20	0.20	ppb	U
95-49-8	2-Chlorotoluene	B 657-8689	0.27	0.27	ppb	U
106-43-4	4-Chlorotoluene	B 657-8689	0.35	0.35	ppb	U
98-06-6	tert-Butylbenzene	B 657-8689	0.24	0.24	ppb	U
95-63-6	1,2,4-Trimethylbenzene	B 657-8689	0.17	2.20	ppb	
135-98-8	sec-Butylbenzene	B 657-8689	0.16	0.16	ppb	U
99-87-6	4-Isopropyltoluene	B 657-8689	0.24	0.24	ppb	U
541-73-1	1,3-Dichlorobenzene	B 657-8689	0.23	0.23	ppb	U
106-46-7	1,4-Dichlorobenzene	B 657-8689	0.23	0.23	ppb	U
95-50-1	1,2-Dichlorobenzene	B 657-8689	0.15	3.30	ppb	
105-05-5	p-Diethylbenzene	B 657-8689	0.24	0.24	ppb	U
104-51-8	n-Butylbenzene	B 657-8689	0.14	0.14	ppb	U
95-93-2	1,2,4,5-Tetramethylbenzene	B 657-8689	0.26	0.26	ppb	U
96-12-8	1,2-Dibromo-3-chloropropane	B 657-8689	0.33	0.33	ppb	U
120-82-1	1,2,4-Trichlorobenzene	B 657-8689	0.22	0.22	ppb	U
87-68-3	Hexachlorobutadiene	B 657-8689	0.26	0.26	ppb	U
91-20-3	Naphthalene	B 657-8689	0.14	1.70	ppb	
87-61-6	1,2,3-Trichlorobenzene	B 657-8689	0.17	0.17	ppb	U



Environmental Testing Laboratories, Inc.

208 Route 109, Farmingdale NY 11735

Phone - 631-249-1456 Fax - 631-249-8344

12/26/2001

Volatiles - EPA 8260B**Sample: M5723-4...continue**

Client Sample ID: MW-105

Collected: 12/14/2001 09:15

Matrix: Liquid

Type: Grab

Remarks: See Case Narrative

Analyzed Date: 12/18/2001

Cas.No.	Surrogate	File ID	% Recovery	QC Limits	Q
460-00-4	4-BROMOFLUOROBENZENE	B657-8689	99.4 %	(78 - 121)	
2037-26-5	TOLUENE-D8	B657-8689	104.0 %	(86 - 110)	
4774-33-8	DIBROMOFLUOROMETHANE	B657-8689	98.3 %	(65 - 110)	
460-00-4	4-BROMOFLUOROBENZENE	B658-8708	96.4 %	(78 - 121)	
2037-26-5	TOLUENE-D8	B658-8708	102.0 %	(86 - 110)	
4774-33-8	DIBROMOFLUOROMETHANE	B658-8708	100.0 %	(65 - 117)	



Environmental Testing Laboratories, Inc.

208 Route 109, Farmingdale NY 11735

Phone - 631-249-1456 Fax - 631-249-8344

12/26/2001

Volatiles - EPA 8260B**Sample: M5723-2**

Client Sample ID: MW-106

Matrix: Liquid

Type: Grab

Collected: 12/14/2001 08:10

Remarks: See Case Narrative

Analyzed Date: 12/18/2001

Gas No	Analyte	File ID	MDL	Concentration	Units	Q
75-71-8	Dichlorodifluoromethane	B 657-8687	0.49	0.49	ppb	U
75-45-6	Chlorodifluoromethane	B 657-8687	0.21	0.21	ppb	U
74-87-3	Chloromethane	B 657-8687	0.49	0.49	ppb	U
75-01-4	Vinyl Chloride	B 657-8687	0.10	9.20	ppb	
74-83-9	Bromomethane	B 657-8687	0.43	0.43	ppb	U
75-00-3	Chloroethane	B 657-8687	0.61	0.61	ppb	U
75-69-4	Trichlorofluoromethane	B 657-8687	0.24	0.24	ppb	U
76-13-1	1,1,2-Trichlorotrifluoroethane	B 657-8687	0.23	0.23	ppb	U
75-35-4	1,1-Dichloroethene	B 657-8687	0.30	0.30	ppb	U
67-64-1	Acetone	B 657-8687	3.12	3.12	ppb	U
75-15-0	Carbon disulfide	B 657-8687	0.20	0.20	ppb	U
75-09-2	Methylene Chloride	B 657-8687	0.54	0.54	ppb	U
156-60-5	t-1,2-Dichloroethene	B 657-8687	0.20	9.80	ppb	
1634-04-4	Methyl t-butyl ether	B 657-8687	0.34	0.34	ppb	U
75-34-3	1,1-Dichloroethane	B 657-8687	0.22	0.22	ppb	U
590-20-7	2,2-Dichloropropane	B 657-8687	0.18	0.18	ppb	U
156-59-2	c-1,2-Dichloroethene	B 662-8815	4.20	792	ppb	
78-93-3	2-Butanone	B 657-8687	5.00	5.00	ppb	U
74-97-5	Bromochloromethane	B 657-8687	0.27	0.27	ppb	U
67-66-3	Chloroform	B 657-8687	0.20	0.20	ppb	U
71-55-6	1,1,1-Trichloroethane	B 657-8687	0.22	0.22	ppb	U
56-23-5	Carbon Tetrachloride	B 657-8687	0.25	0.25	ppb	U
563-58-6	1,1-Dichloropropene	B 657-8687	0.59	0.59	ppb	U
71-43-2	Benzene	B 657-8687	0.16	0.16	ppb	U
107-06-2	1,2-Dichloroethane	B 657-8687	0.23	0.23	ppb	U
79-01-6	Trichloroethene	B 662-8815	3.20	222	ppb	
78-87-5	1,2-Dichloropropane	B 657-8687	0.36	0.36	ppb	U
74-95-3	Dibromomethane	B 657-8687	0.18	0.18	ppb	U
75-27-4	Bromodichloromethane	B 657-8687	0.15	0.15	ppb	U
110-75-8	2-Chloroethylvinylether	B 657-8687	0.13	0.13	ppb	U
10061-01-5	c-1,3-Dichloropropene	B 657-8687	0.16	0.16	ppb	U
108-10-1	4-Methyl-2-pentanone	B 657-8687	5.00	5.00	ppb	U
108-88-3	Toluene	B 657-8687	0.14	0.14	ppb	U
10061-02-6	t-1,3-Dichloropropene	B 657-8687	0.080	0.080	ppb	U
79-00-5	1,1,2-Trichloroethane	B 657-8687	0.090	0.090	ppb	U
127-18-4	Tetrachloroethene	B 662-8815	4.80	212	ppb	



Environmental Testing Laboratories, Inc.

208 Route 109, Farmingdale NY 11735

Phone - 631-249-1456 Fax - 631-249-8344

12/26/2001

Volatiles - EPA 8260B**Sample: M5723-2...continue**

Client Sample ID: MW-106

Collected: 12/14/2001 08:10

Matrix: Liquid

Type: Grab

Remarks: See Case Narrative

Analyzed Date: 12/18/2001

Cas No	Analyte	File ID	MDL	Concentration	Units	Q
142-28-9	1,3-Dichloropropane	B 657-8687	0.20	0.20	ppb	U
591-78-6	2-Hexanone	B 657-8687	5.00	5.00	ppb	U
124-48-1	Dibromochloromethane	B 657-8687	0.11	0.11	ppb	U
106-93-4	1,2-Dibromoethane	B 657-8687	0.10	0.10	ppb	U
108-90-7	Chlorobenzene	B 657-8687	0.15	0.15	ppb	U
630-20-6	1,1,1,2-Tetrachloroethane	B 657-8687	0.18	0.18	ppb	U
100-41-4	Ethylbenzene	B 657-8687	0.22	0.22	ppb	U
108-38-3	m,p-xylene	B 657-8687	0.42	0.42	ppb	U
95-47-6	o-xylene	B 657-8687	0.20	0.20	ppb	U
100-42-5	Styrene	B 657-8687	0.17	0.17	ppb	U
75-25-2	Bromoform	B 657-8687	0.10	0.10	ppb	U
98-82-8	Isopropylbenzene	B 657-8687	0.25	0.25	ppb	U
108-86-1	Bromobenzene	B 657-8687	0.24	0.24	ppb	U
79-34-5	1,1,2,2-Tetrachloroethane	B 657-8687	0.16	0.16	ppb	U
103-65-1	n-Propylbenzene	B 657-8687	0.21	0.21	ppb	U
96-18-4	1,2,3-Trichloropropane	B 657-8687	0.21	0.21	ppb	U
622-96-8	p-Ethyltoluene	B 657-8687	0.24	0.24	ppb	U
108-67-8	1,3,5-Trimethylbenzene	B 657-8687	0.20	0.20	ppb	U
95-49-8	2-Chlorotoluene	B 657-8687	0.27	0.27	ppb	U
106-43-4	4-Chlorotoluene	B 657-8687	0.35	0.35	ppb	U
98-06-6	tert-Butylbenzene	B 657-8687	0.24	0.24	ppb	U
95-63-6	1,2,4-Trimethylbenzene	B 657-8687	0.17	0.17	ppb	U
135-98-8	sec-Butylbenzene	B 657-8687	0.16	0.16	ppb	U
99-87-6	4-Isopropyltoluene	B 657-8687	0.24	0.24	ppb	U
541-73-1	1,3-Dichlorobenzene	B 657-8687	0.23	0.23	ppb	U
106-46-7	1,4-Dichlorobenzene	B 657-8687	0.23	0.23	ppb	U
95-50-1	1,2-Dichlorobenzene	B 657-8687	0.15	0.15	ppb	U
105-05-5	p-Diethylbenzene	B 657-8687	0.24	0.24	ppb	U
104-51-8	n-Butylbenzene	B 657-8687	0.14	0.14	ppb	U
95-93-2	1,2,4,5-Tetramethylbenzene	B 657-8687	0.26	0.26	ppb	U
96-12-8	1,2-Dibromo-3-chloropropane	B 657-8687	0.33	0.33	ppb	U
120-82-1	1,2,4-Trichlorobenzene	B 657-8687	0.22	0.22	ppb	U
87-68-3	Hexachlorobutadiene	B 657-8687	0.26	0.26	ppb	U
91-20-3	Naphthalene	B 657-8687	0.14	0.14	ppb	U
87-61-6	1,2,3-Trichlorobenzene	B 657-8687	0.17	0.17	ppb	U



Environmental Testing Laboratories, Inc.

208 Route 109, Farmingdale NY 11735

Phone - 631-249-1456 Fax - 631-249-8344

12/26/2001

Volatiles - EPA 8260B**Sample: M5723-2...continue**

Client Sample ID: MW-106

Collected: 12/14/2001 08:10

Matrix: Liquid

Type: Grab

Remarks: See Case Narrative

Analyzed Date: 12/18/2001

Cas.No	Surrogate	File ID	% Recovery	QC Limits
460-00-4	4-BROMOFLUOROBENZENE	B652-8687	101.0 %	(75 - 125)
2037-26-5	TOLUENE-D8	B652-8687	103.0 %	(85 - 115)
4774-33-8	DIBROMOFLUOROMETHANE	B652-8687	97.1 %	(65 - 117)
460-00-4	4-BROMOFLUOROBENZENE	B662-8815	104.0 %	(75 - 125)
2037-26-5	TOLUENE-D8	B662-8815	97.5 %	(85 - 115)
4774-33-8	DIBROMOFLUOROMETHANE	B662-8815	97.8 %	(65 - 117)



Environmental Testing Laboratories, Inc.

208 Route 109, Farmingdale NY 11735

Phone - 631-249-1456 Fax - 631-249-8344

12/26/2001

Volatiles - EPA 8260B**Sample: M5723-3**

Client Sample ID: MW-107

Matrix: Liquid

Type: Grab

Collected: 12/14/2001 08:43

Remarks: See Case Narrative

Analyzed Date: 12/18/2001

Cas No	Analyte	File ID	MDL	Concentration	Units	Q
75-71-8	Dichlorodifluoromethane	B 657-8688	0.49	0.49	ppb	U
75-45-6	Chlorodifluoromethane	B 657-8688	0.21	0.21	ppb	U
74-87-3	Chloromethane	B 657-8688	0.49	0.49	ppb	U
75-01-4	Vinyl Chloride	B 657-8688	0.10	0.10	ppb	U
74-83-9	Bromomethane	B 657-8688	0.43	0.43	ppb	U
75-00-3	Chloroethane	B 657-8688	0.61	0.61	ppb	U
75-69-4	Trichlorofluoromethane	B 657-8688	0.24	0.24	ppb	U
76-13-1	1,1,2-Trichlorotrifluoroethane	B 657-8688	0.23	0.23	ppb	U
75-35-4	1,1-Dichloroethene	B 657-8688	0.30	0.30	ppb	U
67-64-1	Acetone	B 657-8688	3.12	3.12	ppb	U
75-15-0	Carbon disulfide	B 657-8688	0.20	0.20	ppb	U
75-09-2	Methylene Chloride	B 657-8688	0.54	0.54	ppb	U
156-60-5	t-1,2-Dichloroethene	B 657-8688	0.20	0.20	ppb	U
1634-04-4	Methyl t-butyl ether	B 657-8688	0.34	0.34	ppb	U
75-34-3	1,1-Dichloroethane	B 657-8688	0.22	5.60	ppb	
590-20-7	2,2-Dichloropropane	B 657-8688	0.18	0.18	ppb	U
156-59-2	c-1,2-Dichloroethene	B 657-8688	0.21	53.3	ppb	
78-93-3	2-Butanone	B 657-8688	5.00	5.00	ppb	U
74-97-5	Bromochloromethane	B 657-8688	0.27	0.27	ppb	U
67-66-3	Chloroform	B 657-8688	0.20	0.20	ppb	U
71-55-6	1,1,1-Trichloroethane	B 657-8688	0.22	4.30	ppb	
56-23-5	Carbon Tetrachloride	B 657-8688	0.25	0.25	ppb	U
563-58-6	1,1-Dichloropropene	B 657-8688	0.59	0.59	ppb	U
71-43-2	Benzene	B 657-8688	0.16	0.16	ppb	U
107-06-2	1,2-Dichloroethane	B 657-8688	0.23	0.23	ppb	U
79-01-6	Trichloroethene	B 657-8688	0.16	53.4	ppb	
78-87-5	1,2-Dichloropropane	B 657-8688	0.36	0.36	ppb	U
74-95-3	Dibromomethane	B 657-8688	0.18	0.18	ppb	U
75-27-4	Bromodichloromethane	B 657-8688	0.15	0.15	ppb	U
110-75-8	2-Chloroethylvinylether	B 657-8688	0.13	0.13	ppb	U
10061-01-5	c-1,3-Dichloropropene	B 657-8688	0.16	0.16	ppb	U
108-10-1	4-Methyl-2-pentanone	B 657-8688	5.00	5.00	ppb	U
108-88-3	Toluene	B 657-8688	0.14	0.14	ppb	U
10061-02-6	t-1,3-Dichloropropene	B 657-8688	0.080	0.080	ppb	U
79-00-5	1,1,2-Trichloroethane	B 657-8688	0.090	0.090	ppb	U
127-18-4	Tetrachloroethene	B 657-8688	0.24	75.9	ppb	



Environmental Testing Laboratories, Inc.

208 Route 109, Farmingdale NY 11735

Phone - 631-249-1456 Fax - 631-249-8344

12/26/2001

Volatiles - EPA 8260B**Sample: M5723-3...continue**

Client Sample ID: MW-107

Collected: 12/14/2001 08:43

Matrix: Liquid

Type: Grab

Remarks: See Case Narrative

Analyzed Date: 12/18/2001

Cas No	Analyte	File ID	MDL	Concentration	Units	Q
142-28-9	1,3-Dichloropropane	B 657-8688	0.20	0.20	ppb	U
591-78-6	2-Hexanone	B 657-8688	5.00	5.00	ppb	U
124-48-1	Dibromochloromethane	B 657-8688	0.11	0.11	ppb	U
106-93-4	1,2-Dibromoethane	B 657-8688	0.10	0.10	ppb	U
108-90-7	Chlorobenzene	B 657-8688	0.15	0.15	ppb	U
630-20-6	1,1,1,2-Tetrachloroethane	B 657-8688	0.18	0.18	ppb	U
100-41-4	Ethylbenzene	B 657-8688	0.22	0.22	ppb	U
108-38-3	m,p-xylene	B 657-8688	0.42	0.42	ppb	U
95-47-6	o-xylene	B 657-8688	0.20	0.20	ppb	U
100-42-5	Styrene	B 657-8688	0.17	0.17	ppb	U
75-25-2	Bromoform	B 657-8688	0.10	0.10	ppb	U
98-82-8	Isopropylbenzene	B 657-8688	0.25	0.25	ppb	U
108-86-1	Bromobenzene	B 657-8688	0.24	0.24	ppb	U
79-34-5	1,1,2,2-Tetrachloroethane	B 657-8688	0.16	0.16	ppb	U
103-65-1	n-Propylbenzene	B 657-8688	0.21	0.21	ppb	U
96-18-4	1,2,3-Trichloropropane	B 657-8688	0.21	0.21	ppb	U
622-96-8	p-Ethyltoluene	B 657-8688	0.24	0.24	ppb	U
108-67-8	1,3,5-Trimethylbenzene	B 657-8688	0.20	0.20	ppb	U
95-49-8	2-Chlorotoluene	B 657-8688	0.27	0.27	ppb	U
106-43-4	4-Chlorotoluene	B 657-8688	0.35	0.35	ppb	U
98-06-6	tert-Butylbenzene	B 657-8688	0.24	0.24	ppb	U
95-63-6	1,2,4-Trimethylbenzene	B 657-8688	0.17	0.17	ppb	U
135-98-8	sec-Butylbenzene	B 657-8688	0.16	0.16	ppb	U
99-87-6	4-Isopropyltoluene	B 657-8688	0.24	0.24	ppb	U
541-73-1	1,3-Dichlorobenzene	B 657-8688	0.23	0.23	ppb	U
106-46-7	1,4-Dichlorobenzene	B 657-8688	0.23	0.23	ppb	U
95-50-1	1,2-Dichlorobenzene	B 657-8688	0.15	0.15	ppb	U
105-05-5	p-Diethylbenzene	B 657-8688	0.24	0.24	ppb	U
104-51-8	n-Butylbenzene	B 657-8688	0.14	0.14	ppb	U
95-93-2	1,2,4,5-Tetramethylbenzene	B 657-8688	0.26	0.26	ppb	U
96-12-8	1,2-Dibromo-3-chloropropane	B 657-8688	0.33	0.33	ppb	U
120-82-1	1,2,4-Trichlorobenzene	B 657-8688	0.22	0.22	ppb	U
87-68-3	Hexachlorobutadiene	B 657-8688	0.26	0.26	ppb	U
91-20-3	Naphthalene	B 657-8688	0.14	0.14	ppb	U
87-61-6	1,2,3-Trichlorobenzene	B 657-8688	0.17	0.17	ppb	U



Environmental Testing Laboratories, Inc.

208 Route 109, Farmingdale NY 11735

Phone - 631-249-1456 Fax - 631-249-8344

12/26/2001

Volatiles - EPA 8260B**Sample: M5723-3...continue**

Client Sample ID: MW-107

Collected: 12/14/2001 08:43

Matrix: Liquid

Type: Grab

Remarks: See Case Narrative

Analyzed Date: 12/18/2001

Cas No	Surrogate	File ID	% Recovery	QC Limits	C
460-00-4	4-BROMOFLUOROBENZENE	B657-8688	100.0 %	(78-112)	
2037-26-5	TOLUENE-D8	B657-8688	102.0 %	(86-110)	
4774-33-8	DIBROMOFLUOROMETHANE	B657-8688	98.4 %	(65-131)	



Environmental Testing Laboratories, Inc.

208 Route 109, Farmingdale NY 11735

Phone - 631-249-1456 Fax - 631-249-8344

12/26/2001

Volatiles - EPA 8260B**Sample: M5724-4**

Client Sample ID: MW-108

Collected: 12/13/2001 13:15

Matrix: Liquid

Type: Grab

Remarks: See Case Narrative

Analyzed Date: 12/20/2001

Cas No	Analyte	File ID	MDL	Concentration	Units	Q
75-71-8	Dichlorodifluoromethane	B 659-8734	0.49	0.49	ppb	U
75-45-6	Chlorodifluoromethane	B 659-8734	0.21	0.21	ppb	U
74-87-3	Chloromethane	B 659-8734	0.49	0.49	ppb	U
75-01-4	Vinyl Chloride	B 659-8734	0.10	0.10	ppb	U
74-83-9	Bromomethane	B 659-8734	0.43	0.43	ppb	U
75-00-3	Chloroethane	B 659-8734	0.61	0.61	ppb	U
75-69-4	Trichlorofluoromethane	B 659-8734	0.24	0.24	ppb	U
76-13-1	1,1,2-Trichlorotrifluoroethane	B 659-8734	0.23	0.23	ppb	U
75-35-4	1,1-Dichloroethene	B 659-8734	0.30	0.30	ppb	U
67-64-1	Acetone	B 659-8734	3.12	3.12	ppb	U
75-15-0	Carbon disulfide	B 659-8734	0.20	0.20	ppb	U
75-09-2	Methylene Chloride	B 659-8734	0.54	0.54	ppb	U
156-60-5	t-1,2-Dichloroethene	B 659-8734	0.20	0.20	ppb	U
1634-04-4	Methyl t-butyl ether	B 659-8734	0.34	1.20	ppb	
75-34-3	1,1-Dichloroethane	B 659-8734	0.22	0.22	ppb	U
590-20-7	2,2-Dichloropropane	B 659-8734	0.18	0.18	ppb	U
156-59-2	c-1,2-Dichloroethene	B 659-8734	0.21	4.50	ppb	
78-93-3	2-Butanone	B 659-8734	5.00	5.00	ppb	U
74-97-5	Bromochloromethane	B 659-8734	0.27	0.27	ppb	U
67-66-3	Chloroform	B 659-8734	0.20	0.20	ppb	U
71-55-6	1,1,1-Trichloroethane	B 659-8734	0.22	0.22	ppb	U
56-23-5	Carbon Tetrachloride	B 659-8734	0.25	0.25	ppb	U
563-58-6	1,1-Dichloropropene	B 659-8734	0.59	0.59	ppb	U
71-43-2	Benzene	B 659-8734	0.16	0.16	ppb	U
107-06-2	1,2-Dichloroethane	B 659-8734	0.23	0.23	ppb	U
79-01-6	Trichloroethene	B 659-8734	0.16	2.10	ppb	
78-87-5	1,2-Dichloropropane	B 659-8734	0.36	0.36	ppb	U
74-95-3	Dibromomethane	B 659-8734	0.18	0.18	ppb	U
75-27-4	Bromodichloromethane	B 659-8734	0.15	0.15	ppb	U
110-75-8	2-Chloroethylvinylether	B 659-8734	0.13	0.13	ppb	U
10061-01-5	c-1,3-Dichloropropene	B 659-8734	0.16	0.16	ppb	U
108-10-1	4-Methyl-2-pentanone	B 659-8734	5.00	5.00	ppb	U
108-88-3	Toluene	B 659-8734	0.14	0.14	ppb	U
10061-02-6	t-1,3-Dichloropropene	B 659-8734	0.080	0.080	ppb	U
79-00-5	1,1,2-Trichloroethane	B 659-8734	0.090	0.090	ppb	U
127-18-4	Tetrachloroethene	B 659-8734	0.24	14.9	ppb	



Environmental Testing Laboratories, Inc.

208 Route 109, Farmingdale NY 11735

Phone - 631-249-1456 Fax - 631-249-8344

12/26/2001

Volatiles - EPA 8260B**Sample: M5724-4...continue**

Client Sample ID: MW-108

Collected: 12/13/2001 13:15

Matrix: Liquid

Type: Grab

Remarks: See Case Narrative

Analyzed Date: 12/20/2001

Cas No	Analyte	File ID	MDL	Concentration	Units	Q
142-28-9	1,3-Dichloropropane	B 659-8734	0.20	0.20	ppb	U
591-78-6	2-Hexanone	B 659-8734	5.00	5.00	ppb	U
124-48-1	Dibromochloromethane	B 659-8734	0.11	0.11	ppb	U
106-93-4	1,2-Dibromoethane	B 659-8734	0.10	0.10	ppb	U
108-90-7	Chlorobenzene	B 659-8734	0.15	0.15	ppb	U
630-20-6	1,1,1,2-Tetrachloroethane	B 659-8734	0.18	0.18	ppb	U
100-41-4	Ethylbenzene	B 659-8734	0.22	0.22	ppb	U
108-38-3	m,p-xylene	B 659-8734	0.42	0.42	ppb	U
95-47-6	o-xylene	B 659-8734	0.20	0.20	ppb	U
100-42-5	Styrene	B 659-8734	0.17	0.17	ppb	U
75-25-2	Bromoform	B 659-8734	0.10	0.10	ppb	U
98-82-8	Isopropylbenzene	B 659-8734	0.25	0.25	ppb	U
108-86-1	Bromobenzene	B 659-8734	0.24	0.24	ppb	U
79-34-5	1,1,2,2-Tetrachloroethane	B 659-8734	0.16	0.16	ppb	U
103-65-1	n-Propylbenzene	B 659-8734	0.21	0.21	ppb	U
96-18-4	1,2,3-Trichloropropane	B 659-8734	0.21	0.21	ppb	U
622-96-8	p-Ethyltoluene	B 659-8734	0.24	0.24	ppb	U
108-67-8	1,3,5-Trimethylbenzene	B 659-8734	0.20	0.20	ppb	U
95-49-8	2-Chlorotoluene	B 659-8734	0.27	0.27	ppb	U
106-43-4	4-Chlorotoluene	B 659-8734	0.35	0.35	ppb	U
98-06-6	tert-Butylbenzene	B 659-8734	0.24	0.24	ppb	U
95-63-6	1,2,4-Trimethylbenzene	B 659-8734	0.17	0.17	ppb	U
135-98-8	sec-Butylbenzene	B 659-8734	0.16	0.16	ppb	U
99-87-6	4-Isopropyltoluene	B 659-8734	0.24	0.24	ppb	U
541-73-1	1,3-Dichlorobenzene	B 659-8734	0.23	0.23	ppb	U
106-46-7	1,4-Dichlorobenzene	B 659-8734	0.23	0.23	ppb	U
95-50-1	1,2-Dichlorobenzene	B 659-8734	0.15	0.15	ppb	U
105-05-5	p-Diethylbenzene	B 659-8734	0.24	0.24	ppb	U
104-51-8	n-Butylbenzene	B 659-8734	0.14	0.14	ppb	U
95-93-2	1,2,4,5-Tetramethylbenzene	B 659-8734	0.26	0.26	ppb	U
96-12-8	1,2-Dibromo-3-chloropropane	B 659-8734	0.33	0.33	ppb	U
120-82-1	1,2,4-Trichlorobenzene	B 659-8734	0.22	0.22	ppb	U
87-68-3	Hexachlorobutadiene	B 659-8734	0.26	0.26	ppb	U
91-20-3	Naphthalene	B 659-8734	0.14	0.14	ppb	U
87-61-6	1,2,3-Trichlorobenzene	B 659-8734	0.17	0.17	ppb	U



Environmental Testing Laboratories, Inc.

208 Route 109, Farmingdale NY 11735

Phone - 631-249-1456 Fax - 631-249-8344

12/26/2001

Volatiles - EPA 8260B**Sample: M5724-4...continue**

Client Sample ID: MW-108

Collected: 12/13/2001 13:15

Matrix: Liquid

Type: Grab

Remarks: See Case Narrative

Analyzed Date: 12/20/2001

Cas No	Surrogate	File ID	% Recovery	QC Limits	Q
460-00-4	4-BROMOFLUOROBENZENE	B659-8734	99.2 %	(75 - 112)	
2037-26-5	TOLUENE-D8	B659-8734	104.0 %	(86 - 110)	
4774-33-8	DIBROMOFLUOROMETHANE	B659-8734	98.1 %	(65 - 110)	



Environmental Testing Laboratories, Inc.

208 Route 109, Farmingdale NY 11735

Phone - 631-249-1456 Fax - 631-249-8344

12/26/2001

Volatiles - EPA 8260B**Sample: M5724-3**

Client Sample ID: MW-109

Collected: 12/13/2001 12:00

Matrix: Liquid

Type: Grab

Remarks: See Case Narrative

Analyzed Date: 12/20/2001

Cas No	Analyte	File ID	MDL	Concentration	Units	Q
75-71-8	Dichlorodifluoromethane	B 659-8733	0.49	0.49	ppb	U
75-45-6	Chlorodifluoromethane	B 659-8733	0.21	0.21	ppb	U
74-87-3	Chloromethane	B 659-8733	0.49	0.49	ppb	U
75-01-4	Vinyl Chloride	B 659-8733	0.10	0.10	ppb	U
74-83-9	Bromomethane	B 659-8733	0.43	0.43	ppb	U
75-00-3	Chloroethane	B 659-8733	0.61	0.61	ppb	U
75-69-4	Trichlorofluoromethane	B 659-8733	0.24	0.24	ppb	U
76-13-1	1,1,2-Trichlorotrifluoroethane	B 659-8733	0.23	0.23	ppb	U
75-35-4	1,1-Dichloroethene	B 659-8733	0.30	1.30	ppb	
67-64-1	Acetone	B 659-8733	3.12	3.12	ppb	U
75-15-0	Carbon disulfide	B 659-8733	0.20	1.20	ppb	
75-09-2	Methylene Chloride	B 659-8733	0.54	0.54	ppb	U
156-60-5	t-1,2-Dichloroethene	B 659-8733	0.20	0.20	ppb	U
1634-04-4	Methyl t-butyl ether	B 659-8733	0.34	0.34	ppb	U
75-34-3	1,1-Dichloroethane	B 659-8733	0.22	4.30	ppb	
590-20-7	2,2-Dichloropropane	B 659-8733	0.18	0.18	ppb	U
156-59-2	c-1,2-Dichloroethene	B 659-8733	0.21	4.40	ppb	
78-93-3	2-Butanone	B 659-8733	5.00	5.00	ppb	U
74-97-5	Bromochloromethane	B 659-8733	0.27	0.27	ppb	U
67-66-3	Chloroform	B 659-8733	0.20	0.20	ppb	U
71-55-6	1,1,1-Trichloroethane	B 659-8733	0.22	4.40	ppb	
56-23-5	Carbon Tetrachloride	B 659-8733	0.25	0.25	ppb	U
563-58-6	1,1-Dichloropropene	B 659-8733	0.59	0.59	ppb	U
71-43-2	Benzene	B 659-8733	0.16	0.16	ppb	U
107-06-2	1,2-Dichloroethane	B 659-8733	0.23	0.23	ppb	U
79-01-6	Trichloroethene	B 659-8733	0.16	2.90	ppb	
78-87-5	1,2-Dichloropropane	B 659-8733	0.36	0.36	ppb	U
74-95-3	Dibromomethane	B 659-8733	0.18	0.18	ppb	U
75-27-4	Bromodichloromethane	B 659-8733	0.15	0.15	ppb	U
110-75-8	2-Chloroethylvinylether	B 659-8733	0.13	0.13	ppb	U
10061-01-5	c-1,3-Dichloropropene	B 659-8733	0.16	0.16	ppb	U
108-10-1	4-Methyl-2-pentanone	B 659-8733	5.00	5.00	ppb	U
108-88-3	Toluene	B 659-8733	0.14	0.14	ppb	U
10061-02-6	t-1,3-Dichloropropene	B 659-8733	0.080	0.080	ppb	U
79-00-5	1,1,2-Trichloroethane	B 659-8733	0.090	0.090	ppb	U
127-18-4	Tetrachloroethene	B 659-8733	0.24	3.50	ppb	



Environmental Testing Laboratories, Inc.

208 Route 109, Farmingdale NY 11735

Phone - 631-249-1456 Fax - 631-249-8344

12/26/2001

Volatiles - EPA 8260B**Sample: M5724-3...continue**

Client Sample ID: MW-109

Collected: 12/13/2001 12:00

Matrix: Liquid

Type: Grab

Remarks: See Case Narrative

Analyzed Date: 12/20/2001

Cas No	Analyte	File ID	MDL	Concentration	Units	Q
142-28-9	1,3-Dichloropropane	B 659-8733	0.20	0.20	ppb	U
591-78-6	2-Hexanone	B 659-8733	5.00	5.00	ppb	U
124-48-1	Dibromochloromethane	B 659-8733	0.11	0.11	ppb	U
106-93-4	1,2-Dibromoethane	B 659-8733	0.10	0.10	ppb	U
108-90-7	Chlorobenzene	B 659-8733	0.15	0.15	ppb	U
630-20-6	1,1,1,2-Tetrachloroethane	B 659-8733	0.18	0.18	ppb	U
100-41-4	Ethylbenzene	B 659-8733	0.22	0.22	ppb	U
108-38-3	m,p-xylene	B 659-8733	0.42	0.42	ppb	U
95-47-6	o-xylene	B 659-8733	0.20	0.20	ppb	U
100-42-5	Styrene	B 659-8733	0.17	0.17	ppb	U
75-25-2	Bromoform	B 659-8733	0.10	0.10	ppb	U
98-82-8	Isopropylbenzene	B 659-8733	0.25	0.25	ppb	U
108-86-1	Bromobenzene	B 659-8733	0.24	0.24	ppb	U
79-34-5	1,1,2,2-Tetrachloroethane	B 659-8733	0.16	0.16	ppb	U
103-65-1	n-Propylbenzene	B 659-8733	0.21	0.21	ppb	U
96-18-4	1,2,3-Trichloropropane	B 659-8733	0.21	0.21	ppb	U
622-96-8	p-Ethyltoluene	B 659-8733	0.24	0.24	ppb	U
108-67-8	1,3,5-Trimethylbenzene	B 659-8733	0.20	0.20	ppb	U
95-49-8	2-Chlorotoluene	B 659-8733	0.27	0.27	ppb	U
106-43-4	4-Chlorotoluene	B 659-8733	0.35	0.35	ppb	U
98-06-6	tert-Butylbenzene	B 659-8733	0.24	0.24	ppb	U
95-63-6	1,2,4-Trimethylbenzene	B 659-8733	0.17	0.17	ppb	U
135-98-8	sec-Butylbenzene	B 659-8733	0.16	0.16	ppb	U
99-87-6	4-Isopropyltoluene	B 659-8733	0.24	0.24	ppb	U
541-73-1	1,3-Dichlorobenzene	B 659-8733	0.23	0.23	ppb	U
106-46-7	1,4-Dichlorobenzene	B 659-8733	0.23	0.23	ppb	U
95-50-1	1,2-Dichlorobenzene	B 659-8733	0.15	0.15	ppb	U
105-05-5	p-Diethylbenzene	B 659-8733	0.24	0.24	ppb	U
104-51-8	n-Butylbenzene	B 659-8733	0.14	0.14	ppb	U
95-93-2	1,2,4,5-Tetramethylbenzene	B 659-8733	0.26	0.26	ppb	U
96-12-8	1,2-Dibromo-3-chloropropane	B 659-8733	0.33	0.33	ppb	U
120-82-1	1,2,4-Trichlorobenzene	B 659-8733	0.22	0.22	ppb	U
87-68-3	Hexachlorobutadiene	B 659-8733	0.26	0.26	ppb	U
91-20-3	Naphthalene	B 659-8733	0.14	0.14	ppb	U
87-61-6	1,2,3-Trichlorobenzene	B 659-8733	0.17	0.17	ppb	U



Environmental Testing Laboratories, Inc.

208 Route 109, Farmingdale NY 11735

Phone - 631-249-1456 Fax - 631-249-8344

12/26/2001

Volatiles - EPA 8260B**Sample: M5724-3...continue**

Client Sample ID: MW-109

Collected: 12/13/2001 12:00

Matrix: Liquid

Type: Grab

Remarks: See Case Narrative

Analyzed Date: 12/20/2001

Cas No	Surrogate	File ID	% Recovery	QC Limits	Q
460-00-4	4-BROMOFLUOROBENZENE	B659-8733	101.0 %	(78 - 112)	
2037-26-5	TOLUENE-D8	B659-8733	104.0 %	(86 - 110)	
4774-33-8	DIBROMOFLUOROMETHANE	B659-8733	99.1 %	(85 - 117)	



Environmental Testing Laboratories, Inc.

208 Route 109, Farmingdale NY 11735

Phone - 631-249-1456 Fax - 631-249-8344

12/26/2001

Volatiles - EPA 8260B**Sample: M5724-2**

Client Sample ID: MW-110

Collected: 12/13/2001 11:13

Matrix: Liquid

Type: Grab

Remarks: See Case Narrative

Analyzed Date: 12/20/2001

Cas No	Analyte	File ID	MDL	Concentration	Units	Q
75-71-8	Dichlorodifluoromethane	B 659-8732	0.49	0.49	ppb	U
75-45-6	Chlorodifluoromethane	B 659-8732	0.21	0.21	ppb	U
74-87-3	Chloromethane	B 659-8732	0.49	0.49	ppb	U
75-01-4	Vinyl Chloride	B 659-8732	0.10	0.10	ppb	U
74-83-9	Bromomethane	B 659-8732	0.43	0.43	ppb	U
75-00-3	Chloroethane	B 659-8732	0.61	0.61	ppb	U
75-69-4	Trichlorofluoromethane	B 659-8732	0.24	0.24	ppb	U
76-13-1	1,1,2-Trichlorotrifluoroethane	B 659-8732	0.23	0.23	ppb	U
75-35-4	1,1-Dichloroethene	B 659-8732	0.30	0.30	ppb	U
67-64-1	Acetone	B 659-8732	3.12	3.12	ppb	U
75-15-0	Carbon disulfide	B 659-8732	0.20	1.00	ppb	
75-09-2	Methylene Chloride	B 659-8732	0.54	0.54	ppb	U
156-60-5	t-1,2-Dichloroethene	B 659-8732	0.20	0.20	ppb	U
1634-04-4	Methyl t-butyl ether	B 659-8732	0.34	0.34	ppb	U
75-34-3	1,1-Dichloroethane	B 659-8732	0.22	0.22	ppb	U
590-20-7	2,2-Dichloropropane	B 659-8732	0.18	0.18	ppb	U
156-59-2	c-1,2-Dichloroethene	B 659-8732	0.21	8.50	ppb	
78-93-3	2-Butanone	B 659-8732	5.00	5.00	ppb	U
74-97-5	Bromochloromethane	B 659-8732	0.27	0.27	ppb	U
67-66-3	Chloroform	B 659-8732	0.20	1.40	ppb	
71-55-6	1,1,1-Trichloroethane	B 659-8732	0.22	0.22	ppb	U
56-23-5	Carbon Tetrachloride	B 659-8732	0.25	0.25	ppb	U
563-58-6	1,1-Dichloropropene	B 659-8732	0.59	0.59	ppb	U
71-43-2	Benzene	B 659-8732	0.16	0.16	ppb	U
107-06-2	1,2-Dichloroethane	B 659-8732	0.23	0.23	ppb	U
79-01-6	Trichloroethene	B 659-8732	0.16	0.16	ppb	U
78-87-5	1,2-Dichloropropane	B 659-8732	0.36	0.36	ppb	U
74-95-3	Dibromomethane	B 659-8732	0.18	0.18	ppb	U
75-27-4	Bromodichloromethane	B 659-8732	0.15	0.96	ppb	
110-75-8	2-Chloroethylvinylether	B 659-8732	0.13	0.13	ppb	U
10061-01-5	c-1,3-Dichloropropene	B 659-8732	0.16	0.16	ppb	U
108-10-1	4-Methyl-2-pentanone	B 659-8732	5.00	5.00	ppb	U
108-88-3	Toluene	B 659-8732	0.14	0.14	ppb	U
10061-02-6	t-1,3-Dichloropropene	B 659-8732	0.080	0.080	ppb	U
79-00-5	1,1,2-Trichloroethane	B 659-8732	0.090	0.090	ppb	U
127-18-4	Tetrachloroethene	B 659-8732	0.24	0.24	ppb	U



Environmental Testing Laboratories, Inc.

208 Route 109, Farmingdale NY 11735

Phone - 631-249-1456 Fax - 631-249-8344

12/26/2001

Volatiles - EPA 8260B**Sample: M5724-2...continue**

Client Sample ID: MW-110

Collected: 12/13/2001 11:13

Matrix: Liquid

Type: Grab

Remarks: See Case Narrative

Analyzed Date: 12/20/2001

Cas No	Analyte	File ID	MDL	Concentration	Units	Q
142-28-9	1,3-Dichloropropane	B 659-8732	0.20	0.20	ppb	U
591-78-6	2-Hexanone	B 659-8732	5.00	5.00	ppb	U
124-48-1	Dibromochloromethane	B 659-8732	0.11	1.20	ppb	
106-93-4	1,2-Dibromoethane	B 659-8732	0.10	0.10	ppb	U
108-90-7	Chlorobenzene	B 659-8732	0.15	0.15	ppb	U
630-20-6	1,1,1,2-Tetrachloroethane	B 659-8732	0.18	0.18	ppb	U
100-41-4	Ethylbenzene	B 659-8732	0.22	0.22	ppb	U
108-38-3	m,p-xylene	B 659-8732	0.42	0.42	ppb	U
95-47-6	o-xylene	B 659-8732	0.20	0.20	ppb	U
100-42-5	Styrene	B 659-8732	0.17	0.17	ppb	U
75-25-2	Bromoform	B 659-8732	0.10	0.10	ppb	U
98-82-8	Isopropylbenzene	B 659-8732	0.25	0.25	ppb	U
108-86-1	Bromobenzene	B 659-8732	0.24	0.24	ppb	U
79-34-5	1,1,2,2-Tetrachloroethane	B 659-8732	0.16	0.16	ppb	U
103-65-1	n-Propylbenzene	B 659-8732	0.21	0.21	ppb	U
96-18-4	1,2,3-Trichloropropane	B 659-8732	0.21	0.21	ppb	U
622-96-8	p-Ethyltoluene	B 659-8732	0.24	0.24	ppb	U
108-67-8	1,3,5-Trimethylbenzene	B 659-8732	0.20	0.20	ppb	U
95-49-8	2-Chlorotoluene	B 659-8732	0.27	0.27	ppb	U
106-43-4	4-Chlorotoluene	B 659-8732	0.35	0.35	ppb	U
98-06-6	tert-Butylbenzene	B 659-8732	0.24	0.24	ppb	U
95-63-6	1,2,4-Trimethylbenzene	B 659-8732	0.17	0.17	ppb	U
135-98-8	sec-Butylbenzene	B 659-8732	0.16	0.16	ppb	U
99-87-6	4-Isopropyltoluene	B 659-8732	0.24	0.24	ppb	U
541-73-1	1,3-Dichlorobenzene	B 659-8732	0.23	0.23	ppb	U
106-46-7	1,4-Dichlorobenzene	B 659-8732	0.23	0.23	ppb	U
95-50-1	1,2-Dichlorobenzene	B 659-8732	0.15	0.15	ppb	U
105-05-5	p-Diethylbenzene	B 659-8732	0.24	0.24	ppb	U
104-51-8	n-Butylbenzene	B 659-8732	0.14	0.14	ppb	U
95-93-2	1,2,4,5-Tetramethylbenzene	B 659-8732	0.26	0.26	ppb	U
96-12-8	1,2-Dibromo-3-chloropropane	B 659-8732	0.33	0.33	ppb	U
120-82-1	1,2,4-Trichlorobenzene	B 659-8732	0.22	0.22	ppb	U
87-68-3	Hexachlorobutadiene	B 659-8732	0.26	0.26	ppb	U
91-20-3	Naphthalene	B 659-8732	0.14	0.14	ppb	U
87-61-6	1,2,3-Trichlorobenzene	B 659-8732	0.17	0.17	ppb	U



Environmental Testing Laboratories, Inc.

208 Route 109, Farmingdale NY 11735

Phone - 631-249-1456 Fax - 631-249-8344

12/26/2001

Volatiles - EPA 8260B**Sample: M5724-2...continue**

Client Sample ID: MW-110

Collected: 12/13/2001 11:13

Matrix: Liquid

Type: Grab

Remarks: See Case Narrative

Analyzed Date: 12/20/2001

Gas No.	Surrogate	File ID	% Recovery	QC Limits	Q
460-00-4	4-BROMOFLUOROBENZENE	B659-8732	89.2 %	(78 - 112)	
2037-26-5	TOLUENE-D8	B659-8732	104.0 %	(86 - 110)	
4774-33-8	DIBROMOFLUOROMETHANE	B659-8732	101.0 %	(63 - 147)	



Environmental Testing Laboratories, Inc.

208 Route 109, Farmingdale NY 11735

Phone - 631-249-1456 Fax - 631-249-8344

12/26/2001

Volatiles - EPA 8260B**Sample: M5724-1**

Client Sample ID: MW-111

Collected: 12/13/2001 10:15

Matrix: Liquid

Type: Grab

Remarks: See Case Narrative

Analyzed Date: 12/20/2001

Cas No	Analyte	File ID	MDL	Concentration	Units	Q
75-71-8	Dichlorodifluoromethane	B 659-8731	0.49	0.49	ppb	U
75-45-6	Chlorodifluoromethane	B 659-8731	0.21	0.21	ppb	U
74-87-3	Chloromethane	B 659-8731	0.49	0.49	ppb	U
75-01-4	Vinyl Chloride	B 659-8731	0.10	0.10	ppb	U
74-83-9	Bromomethane	B 659-8731	0.43	0.43	ppb	U
75-00-3	Chloroethane	B 659-8731	0.61	0.61	ppb	U
75-69-4	Trichlorofluoromethane	B 659-8731	0.24	0.24	ppb	U
76-13-1	1,1,2-Trichlorotrifluoroethane	B 659-8731	0.23	0.23	ppb	U
75-35-4	1,1-Dichloroethene	B 659-8731	0.30	0.30	ppb	U
67-64-1	Acetone	B 659-8731	3.12	3.12	ppb	U
75-15-0	Carbon disulfide	B 659-8731	0.20	0.20	ppb	U
75-09-2	Methylene Chloride	B 659-8731	0.54	0.54	ppb	U
156-60-5	t-1,2-Dichloroethene	B 659-8731	0.20	0.20	ppb	U
1634-04-4	Methyl t-butyl ether	B 659-8731	0.34	7.30	ppb	
75-34-3	1,1-Dichloroethane	B 659-8731	0.22	0.22	ppb	U
590-20-7	2,2-Dichloropropane	B 659-8731	0.18	0.18	ppb	U
156-59-2	c-1,2-Dichloroethene	B 659-8731	0.21	0.21	ppb	U
78-93-3	2-Butanone	B 659-8731	5.00	5.00	ppb	U
74-97-5	Bromochloromethane	B 659-8731	0.27	0.27	ppb	U
67-66-3	Chloroform	B 659-8731	0.20	0.20	ppb	U
71-55-6	1,1,1-Trichloroethane	B 659-8731	0.22	0.22	ppb	U
56-23-5	Carbon Tetrachloride	B 659-8731	0.25	0.25	ppb	U
563-58-6	1,1-Dichloropropene	B 659-8731	0.59	0.59	ppb	U
71-43-2	Benzene	B 659-8731	0.16	0.16	ppb	U
107-06-2	1,2-Dichloroethane	B 659-8731	0.23	0.23	ppb	U
79-01-6	Trichloroethene	B 659-8731	0.16	0.16	ppb	U
78-87-5	1,2-Dichloropropane	B 659-8731	0.36	0.36	ppb	U
74-95-3	Dibromomethane	B 659-8731	0.18	0.18	ppb	U
75-27-4	Bromodichloromethane	B 659-8731	0.15	0.15	ppb	U
110-75-8	2-Chloroethylvinylether	B 659-8731	0.13	0.13	ppb	U
10061-01-5	c-1,3-Dichloropropene	B 659-8731	0.16	0.16	ppb	U
108-10-1	4-Methyl-2-pentanone	B 659-8731	5.00	5.00	ppb	U
108-88-3	Toluene	B 659-8731	0.14	0.14	ppb	U
10061-02-6	t-1,3-Dichloropropene	B 659-8731	0.080	0.080	ppb	U
79-00-5	1,1,2-Trichloroethane	B 659-8731	0.090	0.090	ppb	U
127-18-4	Tetrachloroethene	B 659-8731	0.24	0.24	ppb	U



Environmental Testing Laboratories, Inc.

208 Route 109, Farmingdale NY 11735

Phone - 631-249-1456 Fax - 631-249-8344

12/26/2001

Volatiles - EPA 8260B**Sample: M5724-1...continue**

Client Sample ID: MW-111

Collected: 12/13/2001 10:15

Matrix: Liquid

Type: Grab

Remarks: See Case Narrative

Analyzed Date: 12/20/2001

Cas No	Analyte	File ID	MDL	Concentration	Units	Q
142-28-9	1,3-Dichloropropane	B 659-8731	0.20	0.20	ppb	U
591-78-6	2-Hexanone	B 659-8731	5.00	5.00	ppb	U
124-48-1	Dibromochloromethane	B 659-8731	0.11	0.11	ppb	U
106-93-4	1,2-Dibromoethane	B 659-8731	0.10	0.10	ppb	U
108-90-7	Chlorobenzene	B 659-8731	0.15	0.15	ppb	U
630-20-6	1,1,1,2-Tetrachloroethane	B 659-8731	0.18	0.18	ppb	U
100-41-4	Ethylbenzene	B 659-8731	0.22	0.22	ppb	U
108-38-3	m,p-xylene	B 659-8731	0.42	0.42	ppb	U
95-47-6	o-xylene	B 659-8731	0.20	0.20	ppb	U
100-42-5	Styrene	B 659-8731	0.17	0.17	ppb	U
75-25-2	Bromoform	B 659-8731	0.10	0.10	ppb	U
98-82-8	Isopropylbenzene	B 659-8731	0.25	0.25	ppb	U
108-86-1	Bromobenzene	B 659-8731	0.24	0.24	ppb	U
79-34-5	1,1,2,2-Tetrachloroethane	B 659-8731	0.16	0.16	ppb	U
103-65-1	n-Propylbenzene	B 659-8731	0.21	0.21	ppb	U
96-18-4	1,2,3-Trichloropropane	B 659-8731	0.21	0.21	ppb	U
622-96-8	p-Ethyltoluene	B 659-8731	0.24	0.24	ppb	U
108-67-8	1,3,5-Trimethylbenzene	B 659-8731	0.20	0.20	ppb	U
95-49-8	2-Chlorotoluene	B 659-8731	0.27	0.27	ppb	U
106-43-4	4-Chlorotoluene	B 659-8731	0.35	0.35	ppb	U
98-06-6	tert-Butylbenzene	B 659-8731	0.24	0.24	ppb	U
95-63-6	1,2,4-Trimethylbenzene	B 659-8731	0.17	0.17	ppb	U
135-98-8	sec-Butylbenzene	B 659-8731	0.16	0.16	ppb	U
99-87-6	4-Isopropyltoluene	B 659-8731	0.24	0.24	ppb	U
541-73-1	1,3-Dichlorobenzene	B 659-8731	0.23	0.23	ppb	U
106-46-7	1,4-Dichlorobenzene	B 659-8731	0.23	0.23	ppb	U
95-50-1	1,2-Dichlorobenzene	B 659-8731	0.15	0.15	ppb	U
105-05-5	p-Diethylbenzene	B 659-8731	0.24	0.24	ppb	U
104-51-8	n-Butylbenzene	B 659-8731	0.14	0.14	ppb	U
95-93-2	1,2,4,5-Tetramethylbenzene	B 659-8731	0.26	0.26	ppb	U
96-12-8	1,2-Dibromo-3-chloropropane	B 659-8731	0.33	0.33	ppb	U
120-82-1	1,2,4-Trichlorobenzene	B 659-8731	0.22	0.22	ppb	U
87-68-3	Hexachlorobutadiene	B 659-8731	0.26	0.26	ppb	U
91-20-3	Naphthalene	B 659-8731	0.14	0.14	ppb	U
87-61-6	1,2,3-Trichlorobenzene	B 659-8731	0.17	0.17	ppb	U



Environmental Testing Laboratories, Inc.

208 Route 109, Farmingdale NY 11735

Phone - 631-249-1456 Fax - 631-249-8344

12/26/2001

Volatiles - EPA 8260B**Sample: M5724-1...continue**

Client Sample ID: MW-111

Collected: 12/13/2001 10:15

Matrix: Liquid

Type: Grab

Remarks: See Case Narrative

Analyzed Date: 12/20/2001

Cas.No	Surrogate	File ID	% Recovery	QC Limits	U
460-00-4	4-BROMOFLUOROBENZENE	B659-8731	99.3 %	(78 - 12)	
2037-26-5	TOLUENE-D8	B659-8731	104.0 %	(86 - 10)	
4774-33-8	DIBROMOFLUOROMETHANE	B659-8731	99.5 %	(65 - 17)	



Environmental Testing Laboratories, Inc.

208 Route 109, Farmingdale NY 11735

Phone - 631-249-1456 Fax - 631-249-8344

12/26/2001

Volatiles - EPA 8260B**Sample: M5724-8**

Client Sample ID: Field Blank

Collected: 12/13/2001 14:55

Matrix: Liquid

Type: Blank

Remarks: See Case Narrative

Analyzed Date: 12/20/2001

Cas No	Analyte	File ID	MDL	Concentration	Units	Q
75-71-8	Dichlorodifluoromethane	B 659-8730	0.49	0.49	ppb	U
75-45-6	Chlorodifluoromethane	B 659-8730	0.21	0.21	ppb	U
74-87-3	Chloromethane	B 659-8730	0.49	0.49	ppb	U
75-01-4	Vinyl Chloride	B 659-8730	0.10	0.10	ppb	U
74-83-9	Bromomethane	B 659-8730	0.43	0.43	ppb	U
75-00-3	Chloroethane	B 659-8730	0.61	0.61	ppb	U
75-69-4	Trichlorofluoromethane	B 659-8730	0.24	0.24	ppb	U
76-13-1	1,1,2-Trichlorotrifluoroethane	B 659-8730	0.23	0.23	ppb	U
75-35-4	1,1-Dichloroethene	B 659-8730	0.30	0.30	ppb	U
67-64-1	Acetone	B 659-8730	3.12	3.12	ppb	U
75-15-0	Carbon disulfide	B 659-8730	0.20	0.20	ppb	U
75-09-2	Methylene Chloride	B 659-8730	0.54	0.54	ppb	U
156-60-5	t-1,2-Dichloroethene	B 659-8730	0.20	0.20	ppb	U
1634-04-4	Methyl t-butyl ether	B 659-8730	0.34	0.34	ppb	U
75-34-3	1,1-Dichloroethane	B 659-8730	0.22	0.22	ppb	U
590-20-7	2,2-Dichloropropane	B 659-8730	0.18	0.18	ppb	U
156-59-2	c-1,2-Dichloroethene	B 659-8730	0.21	0.21	ppb	U
78-93-3	2-Butanone	B 659-8730	5.00	5.00	ppb	U
74-97-5	Bromochloromethane	B 659-8730	0.27	0.27	ppb	U
67-66-3	Chloroform	B 659-8730	0.20	0.20	ppb	U
71-55-6	1,1,1-Trichloroethane	B 659-8730	0.22	0.22	ppb	U
56-23-5	Carbon Tetrachloride	B 659-8730	0.25	0.25	ppb	U
563-58-6	1,1-Dichloropropene	B 659-8730	0.59	0.59	ppb	U
71-43-2	Benzene	B 659-8730	0.16	0.16	ppb	U
107-06-2	1,2-Dichloroethane	B 659-8730	0.23	0.23	ppb	U
79-01-6	Trichloroethene	B 659-8730	0.16	0.16	ppb	U
78-87-5	1,2-Dichloropropane	B 659-8730	0.36	0.36	ppb	U
74-95-3	Dibromomethane	B 659-8730	0.18	0.18	ppb	U
75-27-4	Bromodichloromethane	B 659-8730	0.15	0.15	ppb	U
110-75-8	2-Chloroethylvinylether	B 659-8730	0.13	0.13	ppb	U
10061-01-5	c-1,3-Dichloropropene	B 659-8730	0.16	0.16	ppb	U
108-10-1	4-Methyl-2-pentanone	B 659-8730	5.00	5.00	ppb	U
108-88-3	Toluene	B 659-8730	0.14	0.14	ppb	U
10061-02-6	t-1,3-Dichloropropene	B 659-8730	0.080	0.080	ppb	U
79-00-5	1,1,2-Trichloroethane	B 659-8730	0.090	0.090	ppb	U
127-18-4	Tetrachloroethene	B 659-8730	0.24	0.24	ppb	U



Environmental Testing Laboratories, Inc.

208 Route 109, Farmingdale NY 11735

Phone - 631-249-1456 Fax - 631-249-8344

12/26/2001

Volatiles - EPA 8260B**Sample: M5724-8...continue**

Client Sample ID: Field Blank

Collected: 12/13/2001 14:55

Matrix: Liquid

Type: Blank

Remarks: See Case Narrative

Analyzed Date: 12/20/2001

Cas No	Analyte	File ID	MDL	Concentration	Units	Q
142-28-9	1,3-Dichloropropane	B 659-8730	0.20	0.20	ppb	U
591-78-6	2-Hexanone	B 659-8730	5.00	5.00	ppb	U
124-48-1	Dibromochloromethane	B 659-8730	0.11	0.11	ppb	U
106-93-4	1,2-Dibromoethane	B 659-8730	0.10	0.10	ppb	U
108-90-7	Chlorobenzene	B 659-8730	0.15	0.15	ppb	U
630-20-6	1,1,1,2-Tetrachloroethane	B 659-8730	0.18	0.18	ppb	U
100-41-4	Ethylbenzene	B 659-8730	0.22	0.22	ppb	U
108-38-3	m,p-xylene	B 659-8730	0.42	0.42	ppb	U
95-47-6	o-xylene	B 659-8730	0.20	0.20	ppb	U
100-42-5	Styrene	B 659-8730	0.17	0.17	ppb	U
75-25-2	Bromoform	B 659-8730	0.10	0.10	ppb	U
98-82-8	Isopropylbenzene	B 659-8730	0.25	0.25	ppb	U
108-86-1	Bromobenzene	B 659-8730	0.24	0.24	ppb	U
79-34-5	1,1,2,2-Tetrachloroethane	B 659-8730	0.16	0.16	ppb	U
103-65-1	n-Propylbenzene	B 659-8730	0.21	0.21	ppb	U
96-18-4	1,2,3-Trichloropropane	B 659-8730	0.21	0.21	ppb	U
622-96-8	p-Ethyltoluene	B 659-8730	0.24	0.24	ppb	U
108-67-8	1,3,5-Trimethylbenzene	B 659-8730	0.20	0.20	ppb	U
95-49-8	2-Chlorotoluene	B 659-8730	0.27	0.27	ppb	U
106-43-4	4-Chlorotoluene	B 659-8730	0.35	0.35	ppb	U
98-06-6	tert-Butylbenzene	B 659-8730	0.24	0.24	ppb	U
95-63-6	1,2,4-Trimethylbenzene	B 659-8730	0.17	0.17	ppb	U
135-98-8	sec-Butylbenzene	B 659-8730	0.16	0.16	ppb	U
99-87-6	4-Isopropyltoluene	B 659-8730	0.24	0.24	ppb	U
541-73-1	1,3-Dichlorobenzene	B 659-8730	0.23	0.23	ppb	U
106-46-7	1,4-Dichlorobenzene	B 659-8730	0.23	0.23	ppb	U
95-50-1	1,2-Dichlorobenzene	B 659-8730	0.15	0.15	ppb	U
105-05-5	p-Diethylbenzene	B 659-8730	0.24	0.24	ppb	U
104-51-8	n-Butylbenzene	B 659-8730	0.14	0.14	ppb	U
95-93-2	1,2,4,5-Tetramethylbenzene	B 659-8730	0.26	0.26	ppb	U
96-12-8	1,2-Dibromo-3-chloropropane	B 659-8730	0.33	0.33	ppb	U
120-82-1	1,2,4-Trichlorobenzene	B 659-8730	0.22	0.22	ppb	U
87-68-3	Hexachlorobutadiene	B 659-8730	0.26	0.26	ppb	U
91-20-3	Naphthalene	B 659-8730	0.14	0.14	ppb	U
87-61-6	1,2,3-Trichlorobenzene	B 659-8730	0.17	0.17	ppb	U



Environmental Testing Laboratories, Inc.

208 Route 109, Farmingdale NY 11735

Phone - 631-249-1456 Fax - 631-249-8344

12/26/2001

Volatiles - EPA 8260B**Sample: M5724-8...continue**

Client Sample ID: Field Blank

Matrix: Liquid

Remarks: See Case Narrative

Analyzed Date: 12/20/2001

Type: Blank

Collected: 12/13/2001 14:55

Gas No	Surrogate	File ID	% Recovery	QC Limits	C
460-00-4	4-BROMOFLUOROBENZENE	B659-8730	98.3 %	(78 - 102)	
2037-26-5	TOLUENE-D8	B659-8730	103.0 %	(86 - 110)	
4774-33-8	DIBROMOFLUOROMETHANE	B659-8730	101.0 %	(65 - 117)	



Environmental Testing Laboratories, Inc.

208 Route 109, Farmingdale NY 11735

Phone - 631-249-1456 Fax - 631-249-8344

12/26/2001

Volatiles - EPA 8260B**Sample: M5724-9**

Client Sample ID: Trip Blank

Collected: 12/13/2001

Matrix: Liquid

Type: Trip Blank

Remarks: See Case Narrative

Analyzed Date: 12/26/2001

Cas No	Analyte	File ID	MDL	Concentration	Units	Q
75-71-8	Dichlorodifluoromethane	B 662-8813	0.49	0.49	ppb	U
75-45-6	Chlorodifluoromethane	B 662-8813	0.21	0.21	ppb	U
74-87-3	Chloromethane	B 662-8813	0.49	0.49	ppb	U
75-01-4	Vinyl Chloride	B 662-8813	0.10	0.10	ppb	U
74-83-9	Bromomethane	B 662-8813	0.43	0.43	ppb	U
75-00-3	Chloroethane	B 662-8813	0.61	0.61	ppb	U
75-69-4	Trichlorofluoromethane	B 662-8813	0.24	0.24	ppb	U
76-13-1	1,1,2-Trichlorotrifluoroethane	B 662-8813	0.23	0.23	ppb	U
75-35-4	1,1-Dichloroethene	B 662-8813	0.30	0.30	ppb	U
67-64-1	Acetone	B 662-8813	3.12	3.12	ppb	U
75-15-0	Carbon disulfide	B 662-8813	0.20	0.20	ppb	U
75-09-2	Methylene Chloride	B 662-8813	0.54	0.54	ppb	U
156-60-5	t-1,2-Dichloroethene	B 662-8813	0.20	0.20	ppb	U
1634-04-4	Methyl t-butyl ether	B 662-8813	0.34	0.34	ppb	U
75-34-3	1,1-Dichloroethane	B 662-8813	0.22	0.22	ppb	U
590-20-7	2,2-Dichloropropane	B 662-8813	0.18	0.18	ppb	U
156-59-2	c-1,2-Dichloroethene	B 662-8813	0.21	0.21	ppb	U
78-93-3	2-Butanone	B 662-8813	5.00	5.00	ppb	U
74-97-5	Bromochloromethane	B 662-8813	0.27	0.27	ppb	U
67-66-3	Chloroform	B 662-8813	0.20	0.20	ppb	U
71-55-6	1,1,1-Trichloroethane	B 662-8813	0.22	0.22	ppb	U
56-23-5	Carbon Tetrachloride	B 662-8813	0.25	0.25	ppb	U
563-58-6	1,1-Dichloropropene	B 662-8813	0.59	0.59	ppb	U
71-43-2	Benzene	B 662-8813	0.16	0.16	ppb	U
107-06-2	1,2-Dichloroethane	B 662-8813	0.23	0.23	ppb	U
79-01-6	Trichloroethene	B 662-8813	0.16	0.16	ppb	U
78-87-5	1,2-Dichloropropane	B 662-8813	0.36	0.36	ppb	U
74-95-3	Dibromomethane	B 662-8813	0.18	0.18	ppb	U
75-27-4	Bromodichloromethane	B 662-8813	0.15	0.15	ppb	U
110-75-8	2-Chloroethylvinylether	B 662-8813	0.13	0.13	ppb	U
10061-01-5	c-1,3-Dichloropropene	B 662-8813	0.16	0.16	ppb	U
108-10-1	4-Methyl-2-pentanone	B 662-8813	5.00	5.00	ppb	U
108-88-3	Toluene	B 662-8813	0.14	0.14	ppb	U
10061-02-6	t-1,3-Dichloropropene	B 662-8813	0.080	0.080	ppb	U
79-00-5	1,1,2-Trichloroethane	B 662-8813	0.090	0.090	ppb	U
127-18-4	Tetrachloroethene	B 662-8813	0.24	0.93	ppb	



Environmental Testing Laboratories, Inc.

208 Route 109, Farmingdale NY 11735

Phone - 631-249-1456 Fax - 631-249-8344

12/26/2001

Volatiles - EPA 8260B**Sample: M5724-9...continue**

Client Sample ID: Trip Blank

Matrix: Liquid

Type: Trip Blank

Collected: 12/13/2001

Remarks: See Case Narrative

Analyzed Date: 12/26/2001

Cas No	Analyte	File ID	MDL	Concentration	Units	Q
142-28-9	1,3-Dichloropropane	B 662-8813	0.20	0.20	ppb	U
591-78-6	2-Hexanone	B 662-8813	5.00	5.00	ppb	U
124-48-1	Dibromochloromethane	B 662-8813	0.11	0.11	ppb	U
106-93-4	1,2-Dibromoethane	B 662-8813	0.10	0.10	ppb	U
108-90-7	Chlorobenzene	B 662-8813	0.15	0.15	ppb	U
630-20-6	1,1,1,2-Tetrachloroethane	B 662-8813	0.18	0.18	ppb	U
100-41-4	Ethylbenzene	B 662-8813	0.22	0.22	ppb	U
108-38-3	m,p-xylene	B 662-8813	0.42	0.42	ppb	U
95-47-6	o-xylene	B 662-8813	0.20	0.20	ppb	U
100-42-5	Styrene	B 662-8813	0.17	0.17	ppb	U
75-25-2	Bromoform	B 662-8813	0.10	0.10	ppb	U
98-82-8	Isopropylbenzene	B 662-8813	0.25	0.25	ppb	U
108-86-1	Bromobenzene	B 662-8813	0.24	0.24	ppb	U
79-34-5	1,1,2,2-Tetrachloroethane	B 662-8813	0.16	0.16	ppb	U
103-65-1	n-Propylbenzene	B 662-8813	0.21	0.21	ppb	U
96-18-4	1,2,3-Trichloropropane	B 662-8813	0.21	0.21	ppb	U
622-96-8	p-Ethyltoluene	B 662-8813	0.24	0.24	ppb	U
108-67-8	1,3,5-Trimethylbenzene	B 662-8813	0.20	0.20	ppb	U
95-49-8	2-Chlorotoluene	B 662-8813	0.27	0.27	ppb	U
106-43-4	4-Chlorotoluene	B 662-8813	0.35	0.35	ppb	U
98-06-6	tert-Butylbenzene	B 662-8813	0.24	0.24	ppb	U
95-63-6	1,2,4-Trimethylbenzene	B 662-8813	0.17	0.17	ppb	U
135-98-8	sec-Butylbenzene	B 662-8813	0.16	0.16	ppb	U
99-87-6	4-Isopropyltoluene	B 662-8813	0.24	0.24	ppb	U
541-73-1	1,3-Dichlorobenzene	B 662-8813	0.23	0.23	ppb	U
106-46-7	1,4-Dichlorobenzene	B 662-8813	0.23	0.23	ppb	U
95-50-1	1,2-Dichlorobenzene	B 662-8813	0.15	0.15	ppb	U
105-05-5	p-Diethylbenzene	B 662-8813	0.24	0.24	ppb	U
104-51-8	n-Butylbenzene	B 662-8813	0.14	0.14	ppb	U
95-93-2	1,2,4,5-Tetramethylbenzene	B 662-8813	0.26	0.26	ppb	U
96-12-8	1,2-Dibromo-3-chloropropane	B 662-8813	0.33	0.33	ppb	U
120-82-1	1,2,4-Trichlorobenzene	B 662-8813	0.22	0.22	ppb	U
87-68-3	Hexachlorobutadiene	B 662-8813	0.26	0.26	ppb	U
91-20-3	Naphthalene	B 662-8813	0.14	0.14	ppb	U
87-61-6	1,2,3-Trichlorobenzene	B 662-8813	0.17	0.17	ppb	U



Environmental Testing Laboratories, Inc.

208 Route 109, Farmingdale NY 11735

Phone - 631-249-1456 Fax - 631-249-8344

12/26/2001

Volatiles - EPA 8260B**Sample: M5724-9...continue**

Client Sample ID: Trip Blank

Matrix: Liquid

Remarks: See Case Narrative

Analyzed Date: 12/26/2001

Type: Trip Blank

Collected: 12/13/2001

Gas No	Surrogate	File ID	% Recovery	QC Limits	C
460-00-4	4-BROMOFLUOROBENZENE	B662-8813	99.3 %	(78 - 120)	
2037-26-5	TOLUENE-D8	B662-8813	97.8 %	(86 - 113)	
4774-33-8	DIBROMOFLUOROMETHANE	B662-8813	97.2 %	(65 - 117)	



Environmental Testing Laboratories, Inc.

208 Route 109, Farmingdale NY 11735

Phone - 631-249-1456 Fax - 631-249-8344

12/26/2001

Case Narrative

VOLATILES:

The following compounds were calibrated at 25, 50, 100, 150 and 200 ppb levels in the initial calibration curve:

Acetone
2-Butanone
4-Methyl,2-pentanone
2-Hexanone

M&P-Xylenes were calibrated at 10, 40, 100, 200 and 300 ppb levels.

All other compounds were calibrated at 5, 20, 50, 100 and 150 ppb levels.

Samples were quantitated using the continuing calibration standard response factor as opposed to the initial calibration average response factor.

Reviewed by: _____

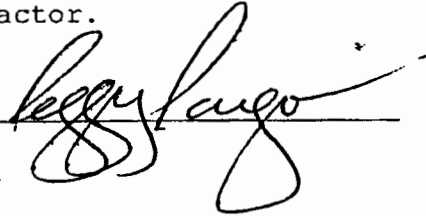

Environmental Testing Laboratories, Inc.

208 Route 109, Farmingdale NY 11735

Phone - 631-249-1456 Fax - 631-249-8344

12/26/2001

ORGANIC METHOD QUALIFIERS

Q - Qualifier - specified entries and their meanings are as follows:

- U - The analytical result is a non-detect.
- J - Indicates an estimated value. The concentration reported was detected below the Method Detection Limit.
- B - The analyte was found in the associated method blank as well as the sample. It indicates possible/probable blank contamination and warns the data user to take appropriate action.
- E - The concentration of the analyte exceeded the calibration range of the instrument.
- D - This flag identifies all compounds identified in an analysis at a secondary dilution. In the case of a surrogate this flag indicates a system monitoring compound diluted out.

INORGANIC METHOD QUALIFIERS

C - (Concentration) qualifiers are as follows:

B - Entered if the reported value was obtained from a reading that was less than the Contract Required Detection Limit (CRDL) but greater than or equal to the Instrument Detection Limit (IDL).

U - Entered when the analyte was analyzed for, but not detected.

J - Indicates an estimated value. The concentration reported was detected below the Method Detection Limit.

Q - Qualifier specific entries and their meanings are as follows:

E - Reported value is estimated because of the presence of interferences.

M - (Method) qualifiers are as follows:

A - Flame AA

AS - Semi-automated Spectrophotometric

AV - Automated Cold Vapor AA

C - Manual Spectrophotometric

F - Furnace AA

NR - when the analyte is not required to be analyzed.

P - ICP

T - Titrimetric

OTHER QUALIFIERS

ND - Not Detected

NA - Not Applicable

* - Outside Expected Range (NYCDEP Table I/II or Surrogate Limits)



Environmental Testing Laboratories, Inc.

208 Route 109, Farmingdale NY 11735

Phone - 631-249-1456 Fax - 631-249-8344

12/26/2001

Custody Document: M5723

Received: 12/14/2001 15:40

Sampled by: Eric Killenbeck

Client: Blue Waters (11260)

1610 New Highway
Farmingdale,
NY 11735

Project: Active Industrial

63 West Montauk Hwy
Lindenhurst,
NY

Manager: Marc Soliman

Respectfully submitted,

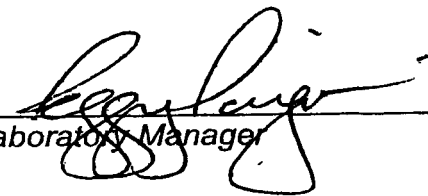
Laboratory Manager

NYS Lab ID # 10969
NJ Cert. # 73812
CT Cert. # PH0645
MA Cert. # NY061
PA Cert. # 68-535
VA Cert. # 108
NH Cert. # 252592-BA
RI Cert. # 161



Environmental Testing Laboratories, Inc.

208 Route 109, Farmingdale NY 11735

Phone - 631-249-1456 Fax - 631-249-8344

12/26/2001

Volatiles - EPA 8260B**Sample: M5723-5**

Client Sample ID: Trip Blank

Matrix: Liquid

Remarks: See Case Narrative

Analyzed Date: 12/18/2001

Type: Trip Blank

Collected: 12/14/2001

Cas No	Analyte	File ID	MDL	Concentration	Units	Q
75-71-8	Dichlorodifluoromethane	B 657-8682	0.49	0.49	ppb	U
75-45-6	Chlorodifluoromethane	B 657-8682	0.21	0.21	ppb	U
74-87-3	Chloromethane	B 657-8682	0.49	0.49	ppb	U
75-01-4	Vinyl Chloride	B 657-8682	0.10	0.10	ppb	U
74-83-9	Bromomethane	B 657-8682	0.43	0.43	ppb	U
75-00-3	Chloroethane	B 657-8682	0.61	0.61	ppb	U
75-69-4	Trichlorofluoromethane	B 657-8682	0.24	0.24	ppb	U
76-13-1	1,1,2-Trichlorotrifluoroethane	B 657-8682	0.23	0.23	ppb	U
75-35-4	1,1-Dichloroethene	B 657-8682	0.30	0.30	ppb	U
67-64-1	Acetone	B 657-8682	3.12	3.12	ppb	U
75-15-0	Carbon disulfide	B 657-8682	0.20	0.20	ppb	U
75-09-2	Methylene Chloride	B 657-8682	0.54	3.70	ppb	B
156-60-5	t-1,2-Dichloroethene	B 657-8682	0.20	0.20	ppb	U
1634-04-4	Methyl t-butyl ether	B 657-8682	0.34	0.34	ppb	U
75-34-3	1,1-Dichloroethane	B 657-8682	0.22	0.22	ppb	U
590-20-7	2,2-Dichloropropane	B 657-8682	0.18	0.18	ppb	U
156-59-2	c-1,2-Dichloroethene	B 657-8682	0.21	0.21	ppb	U
78-93-3	2-Butanone	B 657-8682	5.00	5.00	ppb	U
74-97-5	Bromochloromethane	B 657-8682	0.27	0.27	ppb	U
67-66-3	Chloroform	B 657-8682	0.20	0.20	ppb	U
71-55-6	1,1,1-Trichloroethane	B 657-8682	0.22	0.22	ppb	U
56-23-5	Carbon Tetrachloride	B 657-8682	0.25	0.25	ppb	U
563-58-6	1,1-Dichloropropene	B 657-8682	0.59	0.59	ppb	U
71-43-2	Benzene	B 657-8682	0.16	0.16	ppb	U
107-06-2	1,2-Dichloroethane	B 657-8682	0.23	0.23	ppb	U
79-01-6	Trichloroethene	B 657-8682	0.16	0.16	ppb	U
78-87-5	1,2-Dichloropropane	B 657-8682	0.36	0.36	ppb	U
74-95-3	Dibromomethane	B 657-8682	0.18	0.18	ppb	U
75-27-4	Bromodichloromethane	B 657-8682	0.15	0.15	ppb	U
110-75-8	2-Chloroethylvinylether	B 657-8682	0.13	0.13	ppb	U
10061-01-5	c-1,3-Dichloropropene	B 657-8682	0.16	0.16	ppb	U
108-10-1	4-Methyl-2-pentanone	B 657-8682	5.00	5.00	ppb	U
108-88-3	Toluene	B 657-8682	0.14	0.14	ppb	U
10061-02-6	t-1,3-Dichloropropene	B 657-8682	0.080	0.080	ppb	U
79-00-5	1,1,2-Trichloroethane	B 657-8682	0.090	0.090	ppb	U
127-18-4	Tetrachloroethene	B 657-8682	0.24	0.24	ppb	U



Environmental Testing Laboratories, Inc.

208 Route 109, Farmingdale NY 11735

Phone - 631-249-1456 Fax - 631-249-8344

12/26/2001

Volatiles - EPA 8260B

Sample: M5723-5...continue

Client Sample ID: Trip Blank

Matrix: Liquid

Remarks: See Case Narrative

Analyzed Date: 12/18/2001

Type: Trip Blank

Collected: 12/14/2001

Cas No	Analyte	File ID	MDL	Concentration	Units	Q
142-28-9	1,3-Dichloropropane	B 657-8682	0.20	0.20	ppb	U
591-78-6	2-Hexanone	B 657-8682	5.00	5.00	ppb	U
124-48-1	Dibromochloromethane	B 657-8682	0.11	0.11	ppb	U
106-93-4	1,2-Dibromoethane	B 657-8682	0.10	0.10	ppb	U
108-90-7	Chlorobenzene	B 657-8682	0.15	0.15	ppb	U
630-20-6	1,1,1,2-Tetrachloroethane	B 657-8682	0.18	0.18	ppb	U
100-41-4	Ethylbenzene	B 657-8682	0.22	0.22	ppb	U
108-38-3	m,p-xylene	B 657-8682	0.42	0.42	ppb	U
95-47-6	o-xylene	B 657-8682	0.20	0.20	ppb	U
100-42-5	Styrene	B 657-8682	0.17	0.17	ppb	U
75-25-2	Bromoform	B 657-8682	0.10	0.10	ppb	U
98-82-8	Isopropylbenzene	B 657-8682	0.25	0.25	ppb	U
108-86-1	Bromobenzene	B 657-8682	0.24	0.24	ppb	U
79-34-5	1,1,2,2-Tetrachloroethane	B 657-8682	0.16	0.16	ppb	U
103-65-1	n-Propylbenzene	B 657-8682	0.21	0.21	ppb	U
96-18-4	1,2,3-Trichloropropane	B 657-8682	0.21	0.21	ppb	U
622-96-8	p-Ethyltoluene	B 657-8682	0.24	0.24	ppb	U
108-67-8	1,3,5-Trimethylbenzene	B 657-8682	0.20	0.20	ppb	U
95-49-8	2-Chlorotoluene	B 657-8682	0.27	0.27	ppb	U
106-43-4	4-Chlorotoluene	B 657-8682	0.35	0.35	ppb	U
98-06-6	tert-Butylbenzene	B 657-8682	0.24	0.24	ppb	U
95-63-6	1,2,4-Trimethylbenzene	B 657-8682	0.17	0.17	ppb	U
135-98-8	sec-Butylbenzene	B 657-8682	0.16	0.16	ppb	U
99-87-6	4-Isopropyltoluene	B 657-8682	0.24	0.24	ppb	U
541-73-1	1,3-Dichlorobenzene	B 657-8682	0.23	0.23	ppb	U
106-46-7	1,4-Dichlorobenzene	B 657-8682	0.23	0.23	ppb	U
95-50-1	1,2-Dichlorobenzene	B 657-8682	0.15	0.15	ppb	U
105-05-5	p-Diethylbenzene	B 657-8682	0.24	0.24	ppb	U
104-51-8	n-Butylbenzene	B 657-8682	0.14	0.14	ppb	U
95-93-2	1,2,4,5-Tetramethylbenzene	B 657-8682	0.26	0.26	ppb	U
96-12-8	1,2-Dibromo-3-chloropropane	B 657-8682	0.33	0.33	ppb	U
120-82-1	1,2,4-Trichlorobenzene	B 657-8682	0.22	0.22	ppb	U
87-68-3	Hexachlorobutadiene	B 657-8682	0.26	0.26	ppb	U
91-20-3	Naphthalene	B 657-8682	0.14	0.14	ppb	U
87-61-6	1,2,3-Trichlorobenzene	B 657-8682	0.17	0.17	ppb	U



Environmental Testing Laboratories, Inc.

208 Route 109, Farmingdale NY 11735

Phone - 631-249-1456 Fax - 631-249-8344

12/26/2001

Volatiles - EPA 8260B**Sample: M5723-5...continue**

Client Sample ID: Trip Blank

Matrix: Liquid

Remarks: See Case Narrative

Analyzed Date: 12/18/2001

Type: Trip Blank

Collected: 12/14/2001

Cas No	Surrogate	File ID	% Recovery	QC Limits	Q
460-00-4	4-BROMOFLUOROBENZENE	B657-8682	101.0 %	(78 - 12)	
2037-26-6	TOLUENE D8	B657-8682	103.0 %	(86 - 10)	
4774-33-8	DIBROMOFLUOROMETHANE	B657-8682	97.5 %	(65 - 11)	



Environmental Testing Laboratories, Inc.

208 Route 109, Farmingdale NY 11735

Phone - 631-249-1456 Fax - 631-249-8344

12/26/2001

Case Narrative**VOLATILES:**

The following compounds were calibrated at 25, 50, 100, 150 and 200 ppb levels in the initial calibration curve:

Acetone
2-Butanone
4-Methyl,2-pentanone
2-Hexanone

M&P-Xylenes were calibrated at 10, 40, 100, 200 and 300 ppb levels.

All other compounds were calibrated at 5, 20, 50, 100 and 150 ppb levels.

Samples were quantitated using the continuing calibration standard response factor as opposed to the initial calibration average response factor.

Reviewed by: _____



Environmental Testing Laboratories, Inc.

208 Route 109, Farmingdale NY 11735

Phone - 631-249-1456 Fax - 631-249-8344

12/26/2001

ORGANIC METHOD QUALIFIERS

Q - Qualifier - specified entries and their meanings are as follows:

- U - The analytical result is a non-detect.
- J - Indicates an estimated value. The concentration reported was detected below the Method Detection Limit.
- B - The analyte was found in the associated method blank as well as the sample. It indicates possible/probable blank contamination and warns the data user to take appropriate action.
- E - The concentration of the analyte exceeded the calibration range of the instrument.
- D - This flag identifies all compounds identified in an analysis at a secondary dilution. In the case of a surrogate this flag indicates a system monitoring compound diluted out.

INORGANIC METHOD QUALIFIERS

C - (Concentration) qualifiers are as follows:

- B - Entered if the reported value was obtained from a reading that was less than the Contract Required Detection Limit (CRDL) but greater than or equal to the Instrument Detection Limit (IDL).
- U - Entered when the analyte was analyzed for, but not detected.
- J - Indicates an estimated value. The concentration reported was detected below the Method Detection Limit.

Q - Qualifier specific entries and their meanings are as follows:

- E - Reported value is estimated because of the presence of interferences.

M - (Method) qualifiers are as follows:

- A - Flame AA
- AS - Semi-automated Spectrophotometric
- AV - Automated Cold Vapor AA
- C - Manual Spectrophotometric
- F - Furnace AA
- NR - when the analyte is not required to be analyzed.
- P - ICP
- T - Titrimetric

OTHER QUALIFIERS

- ND - Not Detected
- NA - Not Applicable
- * - Outside Expected Range (NYCDEP Table I/II or Surrogate Limits)



ACTIVE INDUSTRIAL UNIFORM, LINDENHURST, NEW YORK

Well ID: MW-101

Personnel EK, WD

Site Active Bluewater

DTW 7.03 feet

DTB 14.46 feet

Diameter Well 2 inches

Purge Volume Necessary 3.6 gallons

Purged Volume 4 gallons

Date 12/14/2001

Time 715

Time	DO mg/l	pH	Conductivity ms/cm	Temperature Celsius	Turbidity
722	START PURGE				
724	1.41	5.21	0.299	14.8	105
727	0.9	4.66	0.269	15.2	10
729	0.89	4.94	0.271	15.3	10
735	SAMPLE VOCS 8260 WITH BAILER				
POST SAMPLE					
735	0.76	5.34	0.281	14.9	10

Comments: Cloudy initially then cleared (orangish tint)

ACTIVE INDUSTRIAL UNIFORM, LINDENHURST, NEW YORK

Well ID: MW-102

Personnel EK, WD

Site Active Bluewater

DTW 7.10 feet

DTB 14.50 feet

Diameter Well 2 inches

Purge Volume Necessary 3.5 gallons

Purged Volume 3.9 gallons

Date 12/13/2001

Time 1400

Time	DO mg/l	pH	Conductivity ms/cm	Temperature Celsius	Turbidity
1408	START PURGE				
1409	1.8	6.49	0.4	15.6	25
1412	2.92	6.48	0.345	15.8	2
1414	1.00	6.5	0.327	15.9	1
1415	STOP PURGE				
1420	SAMPLE VOCS 8260 WITH BAILER				
POST SAMPLE					
1425	1.18	6.68	0.349	15.5	6

Comments:

ACTIVE INDUSTRIAL UNIFORM, LINDENHURST, NEW YORK

Well ID: MW-103

Personnel EK, WD

Site Active Bluewater

DTW 7.06 feet

DTB 13.53 feet

Diameter Well 2 inches

Purge Volume Necessary 3.2 gallons

Purged Volume 3.5 gallons

Date 12/13/2001

Time 1440

Time	DO mg/l	pH	Conductivity ms/cm	Temperature Celsius	Turbidity
1445	START PURGE				
1446	1.4	6.3	0.287	15.5	190
1448	1.42	6.04	0.302	15.8	37
1451	1.7	6.21	0.311	15.9	42
1455	SAMPLE VOCS 8260 WITH BAILER				
POST SAMPLE					
1455	3.01	6.19	0.364	15.6	42

Comments: Orange initially --- cleared to orangish tint

ACTIVE INDUSTRIAL UNIFORM, LINDENHURST, NEW YORK

Well ID: MW-104

Personnel EK, WD

Site Active Bluewater

DTW 7.25 feet

DTB 14.58 feet

Diameter Well 2 inches

Purge Volume Necessary 3.5 gallons

Purged Volume 3.7 gallons

Date 12/13/2001

Time 1330

Time	DO mg/l	pH	Conductivity ms/cm	Temperature Celsius	Turbidity
1338	START PURGE				
1339	0.77	6.49	0.549	15.9	500
1341	0.88	6.18	0.377	16	46
1343	0.9	6.02	0.353	16	14
1344	STOP PURGE				
1350	SAMPLE VOCS 8260 WITH BAILER				
POST SAMPLE					
1355	1.37	6.05	0.498	15.3	87

Comments: Orange initially --- clearing orangish tint

ACTIVE INDUSTRIAL UNIFORM, LINDENHURST, NEW YORK

Well ID: MW-105

Personnel EK, WD

Site Active Bluewater

DTW 7.12 feet

DTB 14.53 feet

Diameter Well 2 inches

Purge Volume Necessary 3.6 gallons

Purged Volume 4 gallons

Date 12/14/2001

Time 900

Time	DO mg/l	pH	Conductivity ms/cm	Temperatur Celsius	Turbidity
903	START PURGE				
904	1.27	5.64	0.401	15.9	70
907	0.89	5.73	0.391	16.3	10
910	0.39	5.8	0.395	16.3	10
911					
915	SAMPLE VOCS 8260 WITH BAILER				
POST SAMPLE					
915	1.1	5.68	0.419	15.8	300

Comments: Orangish tint
 Odor

ACTIVE INDUSTRIAL UNIFORM, LINDENHURST, NEW YORK

Well ID: MW-106

Personnel EK, WD

Site Active Bluewater

DTW 7.10 feet

DTB 14.40 feet

Diameter Well 2 inches

Purge Volume Necessary 3.5 gallons

Purged Volume 4 gallons

Date 12/14/2001

Time 750

Time	DO mg/l	pH	Conductivity ms/cm	Temperature Celsius	Turbidity
757	START PURGE				
758	1.7	5.43	0.358	15.5	86
802	1.3	5.61	0.358	15.7	10
804	0.43	5.55	0.355	15.8	10
806	STOP PURGE				
810	SAMPLE VOCS 8260 WITH BAILER				
POST SAMPLE					
810	1.02	5.56	0.334	15.4	7

Comments: Cloudy --- cleared immediately to orangish tint

ACTIVE INDUSTRIAL UNIFORM, LINDENHURST, NEW YORK

Well ID: MW-107

Personnel EK, WD

Site Active Bluewater

DTW 7.02 feet

DTB 14.61 feet

Diameter Well 2 inches

Purge Volume Necessary 3.6 gallons

Purged Volume 4 gallons

Date 12/14/2001

Time 825

Time	DO mg/l	pH	Conductivity ms/cm	Temperature Celsius	Turbidity
830	START PURGE				
831	0.86	5.52	0.421	15.1	74
834	0.7	5.82	0.403	15.3	10
836	0.38	5.79	0.383	15.3	10
839	STOP PURGE				
843	SAMPLE VOCS 8260 WITH BAILER				
POST SAMPLE					
843	0.68	5.7	0.311	14.8	66

Comments: Cloudy with flocculates --- orange
Odor

ACTIVE INDUSTRIAL UNIFORM, LINDENHURST, NEW YORK

Well ID: MW-108

Personnel EK, WD

Site Active Bluewater

DTW 7.41 feet

DTB 14.50 feet

Diameter Well 2 inches

Date 12/13/2001

Time 1255

Purge Volume Necessary 3.4 gallons

Purged Volume 3.7 gallons

Time	DO mg/l	pH	Conductivity ms/cm	Temperature Celsius	Turbidity
1303	START PURGE				
1304	2.03	6.2	0.463	15	247
1308	0.84	5.9	0.42	15	47
1313	1.3	5.86	0.414	15.2	11
1315	SAMPLE VOCS 8260 WITH BAILER				
POST SAMPLE					
1323	2	5.88	0.438	14.8	6

Comments: Orange --- orangish tint

ACTIVE INDUSTRIAL UNIFORM, LINDENHURST, NEW YORK

Well ID: MW-109

Personnel EK, WD

Site Active Bluewater

DTW 0.72 feet

DTB 34.60 feet

Date 12/13/2001

Diameter Well 2 inches

Time 1130

Purge Volume Necessary 17 gallons

Purged Volume 17 gallons

Time	DO mg/l	pH	Conductivity ms/cm	Temperature Celsius	Turbidity
1135	START PURGE				
1136	1.06	5.61	36.1	13.7	219
1140	0.3	5.9	32.2	13.8	25
1147	0.6	5.75	31.5	13.9	3
1151	0.89	5.77	31.6	13.9	2
1153	0.9	5.86	31	14	3
POST SAMPLE					
1155	SAMPLE VOCS 8260 WITH BAILER				
1200	1	5.9	3.58	13.5	12

Comments: Little cloudy --- cleared

ACTIVE INDUSTRIAL UNIFORM, LINDENHURST, NEW YORK

Well ID: MW-110

Personnel EK, WD

Site Active Bluewater

DTW 1.34 feet

DTB 34.40 feet

Diameter Well 2 inches

Purge Volume Necessary 16 gallons

Purged Volume 17 gallons

Date 12/13/2001

Time 1035

Time	DO mg/l	pH	Conductivity ms/cm	Temperature Celsius	Turbidity
1047					
1049	1.35	6.43	0.322	14.2	27
1054	1.3	5.62	0.294	14.6	9
1100	0.93	5.34	0.285	14.6	1
1106	0.49	5.33	0.282	14.6	0
1109	1.1	5.34	0.282	14.5	0
POST SAMPLE					
1113	SAMPLE VOCS 8260 WITH BAILER				
1119	3.2	6.2	0.191	14.2	5

Comments: White foam on top disappeared after 5 gallons

ACTIVE INDUSTRIAL UNIFORM, LINDENHURST, NEW YORK

Well ID: MW-111

Personnel EK, WD

Site Active Bluewater

DTW 3.25 feet

DTB 34.61 feet

Diameter Well 2 inches

Purge Volume Necessary 15 gallons

Purged Volume 15 gallons

Date 12/13/2001

Time 941

Time	DO mg/l	pH	Conductivity ms/cm	Temperature Celsius	Turbidity
951	START PURGE				
952	3.15	5.5	0.261	14.2	9
954	2.05	5.36	0.203	14.2	2
959	0.95	5.35	0.199	14.2	1
1004	0.99	4.93	0.197	14.1	1
1007	0.93	4.94	0.197	14.1	0
1010	STOP PURGE				
1015	SAMPLE VOCS 8260 WITH BAILER				
POST SAMPLE					
1027	1.41	5.23	0.211	13.9	5

Comments: Raining slightly