



# LAW

RESOURCES CREATING SOLUTIONS

August 16, 2002

Mr. Mark Soliman  
Blue Water Environmental, Inc.  
1610 New Highway  
Farmingdale, NY 11735

*Transmitted Via US Mail*

Subject: **June 2002 Ground-Water Sampling Program Results  
Active Industrial Uniform  
Lindenhurst, New York  
LAW Project Number 22000-0-0019**

Dear Mr. Soliman:

Law Engineering and Environmental Services PC (LAW), a MACTEC Company, is pleased to present this Quarterly Ground-Water Monitoring Report for the Active Industrial Uniform (AIU) site in Lindenhurst, New York. This report summarizes ground-water conditions for the June 2002 monitoring event.

This report provides a summary of background information, methodologies used during the ground-water sampling, results, and conclusions.

## **BACKGROUND INFORMATION**

The ground-water remediation system at the AIU site is designed to recover and treat ground water impacted with volatile organic compounds (VOCs). The system design is consistent with the remedy stated in the Final Design Contract Documents (Contract Documents) from the New York State Department of Environmental Conservation (NYSDEC) dated March 2000 for the site.

The ground-water remediation system utilizes two recovery wells (wells RW-1 and RW-2) to extract ground water from the subsurface. Recovery well RW-1 is located on-site and well RW-2 is located off-site. Eleven ground-water monitoring wells were installed for monitoring ground-water quality conditions. Eight monitoring wells are located on-site (designated as MW-101 through MW-108) and three monitoring wells are located off-site (designated as MW-109 through MW-111) and downgradient of the site. The discharge pipe for the recovery wells was trenched from the wells to the treatment building. The recovered ground water is treated by an automated air stripping system located in the on-

site treatment building. The ground-water treatment system has a design capacity of 250-gallons per minute (gpm) flow rate. The off-gases from the air stripper are treated with vapor phase carbon and discharged to the atmosphere under an air discharge permit equivalency. The treated ground-water is discharged under a State Pollution Discharge Elimination System (SPDES) permit equivalency. Results of samples for vapors and ground-water discharged are as separate reports.

## METHODOLOGY

### Ground-Water Sampling

On June 24<sup>th</sup> and 25<sup>th</sup>, 2002 ground-water samples were collected from the eight on-site monitoring wells, and three off-site monitoring wells. A site layout is shown on Figure 1. Prior to sampling, ground-water levels were measured in the wells using an electronic water-level measuring device. Depth to ground-water measurements ranged from 1.34 feet below top of casing (TOC) to 7.41 feet below TOC. Ground-water measurements and elevations are shown in Table 1.

Each well was purged utilizing low flow pumping using a peristaltic pump prior to sampling. Geochemical parameters of ground-water were measured until stabilization ( $\pm 10\%$ ) was reached for pH, dissolved oxygen, oxidation-reduction potential, conductivity, temperature, and depth to water. Purged water was discharged to the ground surface on-site as directed by State oversight personnel (Environmental Resources Management). After the specific geochemical parameters stabilized in each well, ground-water samples were collected using a new, disposable Teflon bailer for each well for the VOC analyses; a peristaltic pump was used to collect the samples for dissolved metals analyses. These samples were field-filtered using a 0.45-micron filter.

Ground-water samples collected from the 11 wells were analyzed for VOCs using United States Environmental Protection Agency (USEPA) Method 8260B, and dissolved metals were analyzed for chromium, copper, iron, manganese, and nickel. Samples were submitted to Environmental Testing Laboratories, Inc. (ETL), under proper chain of custody documentation. In addition, duplicate, matrix spike, matrix spike duplicate samples, as well as a field blank and a trip blank were submitted to the laboratory for analysis for QA/QC purposes. Table 2 summarizes the results of the VOCs analyses. Table 3 summarizes the results of the dissolved metals analyses. Copies of the laboratory analytical reports are provided in Appendix A. Copies of ground-water sampling logs are provided in Appendix B.

## SUMMARY OF RESULTS

### Ground-Water Flow

Figure 2 is a map depicting the configuration of the water table (potentiometric surface) that was prepared using the ground-water elevation data provided in Table 1. As shown on Figure 2, the horizontal component of ground-water flow is in a south-southwesterly direction, which is consistent with the direction of the ground-water flow mapped during previous events.

### Ground-Water Sampling

Analytical results of ground-water samples collected during the June 24<sup>th</sup> and 25<sup>th</sup>, 2002 sampling event indicate that VOCs are present in on-site and off-site monitoring wells. Concentrations of total VOCs reported in the on-site monitoring wells ranged from 3.3 to 5,944 micrograms per liter (ug/L). As shown in Table 2, vinyl chloride, trans-1,2 dichloroethene, 1,1-dichloroethane, cis-1,2-dichloroethene, trichloroethene, tetrachloroethene, o-xylene, isopropylbenzene, n-propylbenzene, 1,2,4-trimethylbenzene, 1,2-dichlorobenzene, and naphthalene were detected at concentrations above NYSDEC ground-water standards. Wells MW-103, MW-104, MW-105, MW-106, MW-107, MW-110, and MW-111 had one or more VOCs reported at concentrations above NYSDEC ground-water quality standards. Wells MW-106 and MW-104, which are located on-site, had the highest concentrations of total VOCs (5,964 ug/L and 865 ug/L respectively). The VOC detected at the highest concentration in these wells were cis-1,2-dichloroethene (4,840 ug/L in MW-106) and tetrachloroethene (844 ug/L in MW-104). Trichloroethene (789 ug/L), tetrachloroethene (216 ug/L), vinyl chloride (93.1 ug/L), and trans 1,-2-dichloroethene (25.2 ug/L) were also reported at concentrations above NYSDEC ground-water quality standards in MW-106. In addition to tetrachloroethene in MW-104, trichloroethene (19.3 ug/L) was also reported at a concentration above NYSDEC ground-water quality standard. No VOCs were reported at concentrations above NYSDEC ground-water quality standards in on-site wells MW-101, MW-102, and MW-108.

The concentrations of total VOCs detected in off-site monitoring wells MW-109, MW-110, and MW-111, were 17.7 ug/L, 79.1 ug/L, and 20.4 ug/L, respectively (Table 2). Wells MW-109, MW-110, and MW-111 had VOCs reported at concentrations at or above NYSDEC ground-water quality standards. Methyl t-butyl ether, and cis-1,2-dichloroethene were detected at or above NYSDEC ground-water standards (Table 2) in these wells.

As shown in Table 3, dissolved iron and dissolved manganese were detected at concentrations above NYSDEC ground-water standards. Wells MW-101, MW-103, MW-104, MW-105, MW-106, MW-107, MW-109, MW-110, and MW-111 had one or more dissolved metals reported at concentrations above NYSDEC ground-water quality standards.

### CONCLUSIONS

- The horizontal component of ground-water flow at the AIU site is in a south-southwesterly direction.
- The highest levels of total VOCs were reported in monitoring wells MW-106 (5,964 ug/L), MW-104 (865 ug/L), and MW-107 (504 ug/L) (Table 2).
- The VOCs reported at the highest concentrations above NYSDEC ground-water quality standards were cis-1,2-dichloroethene, trichloroethene, tetrachloroethene, and vinyl chloride.
- Off-site monitoring wells MW-109, MW-110, and MW-111 had one or more VOCs reported at concentrations at or above NYSDEC ground-water quality standards.
- Dissolved iron and manganese were reported above NYSDEC ground-water quality standards in the majority of the monitoring wells.
- Quarterly Sampling will continue during operation of the ground-water remediation system.

### CLOSING

We appreciate the opportunity to assist Blue Water Environmental with this project. If you have any questions or need additional information, please do not hesitate to call us.

Sincerely,

**LAW ENGINEERING AND ENVIRONMENTAL SERVICES, PC.**

Eric Killenbeck<sup>SH</sup>

Eric Killenbeck  
Project Geologist

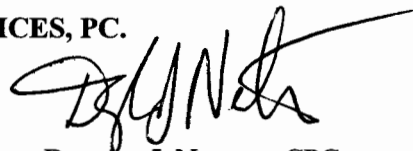

Douglas J. Newton, CPG  
Senior Hydrogeologist

TABLE 1  
GROUND-WATER ELEVATION DATA AND WELL CONSTRUCTION DETAILS  
ACTIVE INDUSTRIAL UNIFORM, LINDENHURST, NEW YORK  
LAW PROJECT NO. 22000-0-0019

WELL	DATE DRILLED	LOCATION	TOTAL DEPTH (FT. BGS)	SCREEN INTERVAL (FT. BGS)	CASING WELL DIAMETER (INCHES)	TOP OF PVC CASING ELEVATION (FT. RELATIVE TO MSL)	12/13/2001			3/7/2002			6/24/2002		
							DEPTH TO GROUND-WATER (FT. BELOW TOP OF PVC CASING)	GROUND-WATER LEVEL ELEVATION (FT. RELATIVE TO MSL)	DEPTH TO GROUND-WATER (FT. BELOW TOP OF PVC CASING)	GROUND-WATER LEVEL ELEVATION (FT. RELATIVE TO MSL)	DEPTH TO GROUND-WATER (FT. BELOW TOP OF PVC CASING)	GROUND-WATER LEVEL ELEVATION (FT. RELATIVE TO MSL)			
MW-101	06/05/01	On-site	14.22	5-15	2	8.83	7.03	1.80	7.78	1.05	7.21	1.62			
MW-102	06/05/01	On-site	14.10	5-15	2	8.66	7.10	1.56	7.65	1.01	7.06	1.60			
MW-103	06/05/01	On-site	13.26	5-15	2	8.57	7.06	1.51	7.62	0.95	7.02	1.55			
MW-104	06/05/01	On-site	14.24	5-15	2	8.70	7.25	1.45	7.87	0.83	7.18	1.52			
MW-105	06/05/01	On-site	14.23	5-15	2	8.58	7.12	1.46	7.73	0.85	7.08	1.50			
MW-106	06/05/01	On-site	14.11	5-15	2	8.50	7.10	1.40	7.61	0.89	7.03	1.47			
MW-107	06/04/01	On-site	14.30	5-15	2	8.44	7.02	1.42	7.66	0.78	7.02	1.42			
MW-108	06/04/01	On-site	14.17	5-15	2	8.82	7.41	1.41	8.13	0.69	7.41	1.41			
MW-109	06/11/01	Off-site	34.60	25-35	2	1.21	0.72	0.49	2.00	-0.79	1.34	-0.13			
MW-110	06/12/01	Off-site	34.39	25-35	2	NA	1.34	NA	2.46	NA	1.76	NA			
MW-111	06/12/01	Off-site	34.30	25-35	2	NA	3.25	NA	4.10	NA	3.67	NA			
RW-1	06/06/01	On-site	40.00	10-35	6	NA	7.95	NA	NM	NA	NM	NA			
RW-2	06/07/01	Off-site	43.00	12-37	6	NA	NM	NA	NM	NA	NM	NA			

Notes:

- NM - Not Measured
- NA - Not Available
- FT. BGS-feet below ground surface
- FT. TOC - feet below top of pvc casing
- MSL-mean sea level

TABLE 2  
 RESULTS OF VOLATILE ORGANIC COMPOUND ANALYSES FOR GROUND WATER SAMPLES COLLECTED AT THE  
 ACTIVE INDUSTRIAL UNIFORM, LINDENHURST, NEW YORK  
 LAW PROJECT NO. 22000-0-0019

Sample Location: Lab Sample ID: Date Collected:	MW-101 J8132-6 6/24/2002	MW-102 J8132-5 6/24/2002	MW-103 J8133-3 6/25/2002	MW-104 J8133-4 6/25/2002	MW-105 J8133-1 6/25/2002	MW-106 J8133-6 6/25/2002	MW-116 J8133-7 6/25/2002	MW-107 J8133-5 6/25/2002	NYSDEC Standards
Constituent:									
Units: in ug/L									
Vinyl chloride	<	<	<	<	<	<	<	<	2
Chloroethane	0.23	0.24	0.51	0.51	0.51	93.1	76.8	126	0.49
1,1-Dichloroethene	<	<	<	<	<	<	<	<	5
Carbon disulfide	0.27	0.27	0.63	0.63	0.63	0.63	0.63	0.63	5
trans-1,2-Dichloroethene	0.19	0.19	0.54	0.54	0.54	0.54	0.54	0.54	60
Methyl t-butyl ether	0.31	0.31	0.46	0.46	0.46	25.2	21.7	3.5	5
Methylene Chloride	3.8	0.18	0.58	0.58	0.58	0.58	0.58	0.58	10
1,1-Dichloroethane	0.21	0.21	0.63	0.63	0.63	0.63	0.63	0.63	5
cis-1,2-Dichloroethene	0.3	0.3	0.43	0.43	0.43	0.43	0.43	7.0	5
Chloroform	0.24	0.24	0.42	2	2.4	48.40	5000	254	5
1,1,1-Trichloroethane	0.26	0.26	0.7	0.7	0.7	0.7	0.7	0.7	7
Trichloroethene	0.26	0.26	0.35	0.35	0.35	0.35	0.35	1.1	5
Bromodichloromethane	0.36	0.36	0.46	19.3	1.4	789	550	47	5
Toluene	0.2	0.2	0.25	<	0.25	<	<	0.25	50
Tetrachloroethene	0.2	0.2	0.38	0.38	0.38	1.1	1.3	4.3	5
Dibromochloromethane	1.1	3.3	21.3	844	37.1	216	117	55.4	5
Ethylbenzene	0.13	0.13	0.25	0.25	0.25	0.25	0.25	0.25	50
m,p-xylene	0.22	0.22	4.5	0.53	0.53	0.53	0.53	0.53	5
o-xylene	0.34	0.34	4.1	0.76	0.76	0.76	0.76	0.76	5
isopropylbenzene	0.25	0.25	6.8	0.33	0.33	0.33	0.33	1.3	5
n-Propylbenzene	0.15	0.15	6.3	0.43	0.43	0.43	0.43	0.43	5
p-Ethyltoluene	0.16	0.16	12.4	0.62	0.62	0.62	0.62	0.62	5
1,3,5-Trimethylbenzene	0.16	0.16	52.2	0.62	0.62	0.62	0.62	0.62	NS
1,2,4-Trimethylbenzene	0.2	0.2	16.8	0.57	0.57	0.57	0.57	0.57	5
sec-Butylbenzene	0.17	0.17	96.9	0.6	0.6	0.6	0.6	0.6	5
4-Isopropyltoluene	0.22	0.22	0.61	0.61	0.61	0.61	0.61	1.5	5
1,4-Dichlorobenzene	0.17	0.17	0.67	0.67	0.67	0.67	0.67	0.67	5
p-Diethylbenzene	0.1	0.1	0.97	0.51	0.51	0.51	0.51	0.51	3
n-Butylbenzene	0.11	0.11	5.8	0.45	0.45	0.45	0.45	0.45	3
1,2,4,5-Tetramethylbenzene	0.22	0.22	0.69	0.69	0.69	0.69	0.69	1.6	NS
Naphthalene	0.17	0.17	0.67	0.73	0.73	0.73	0.73	0.73	5
	0.5	0.5	1.1	0.86	0.86	0.86	0.86	1.8	5
	0.29	0.29	24.9	0.94	0.94	0.94	0.94	0.94	10
Total VOCs	4.9	3.3	254.7	865.3	40.9	5964.4	5766.8	504.5	

Notes:  
 ug/L - Micrograms per liter  
 < - Compound less than detection limit listed  
 VOCs - Volatile Organic Compounds  
 NS - No Standard

TABLE 2  
 RESULTS OF VOLATILE ORGANIC COMPOUND ANALYSES FOR GROUND WATER SAMPLES COLLECTED AT THE  
 ACTIVE INDUSTRIAL UNIFORM, LINDENHURST, NEW YORK  
 LAW PROJECT NO. 22000-0-0019

Constituent: Units in ug/L	Sample Location: Lab Sample ID: Date Collected:	MW-108 J8132-4 6/24/2002	MW-109 J8132-1 6/24/2002	MW-110 J8132-2 6/24/2002	MW-111 J8132-3 6/24/2002	Field Blank J8133-2 6/25/2002	Trip Blank J8133-8 6/25/2002	NYSDEC Standards
Vinyl chloride	<	0.23	<	0.23	<	0.51	<	2
Chloroethane	<	0.24	<	0.24	<	0.49	<	5
1,1-Dichloroethene	<	0.27	<	0.27	<	0.63	<	5
Carbon disulfide	<	0.19	<	0.19	<	0.54	<	60
trans-1,2-Dichloroethene	<	0.31	<	0.31	<	0.46	<	5
Methyl t-butyl ether	<	0.18	10.3	2.1	20.4	0.58	<	10
Methylene Chloride	<	0.21	<	0.21	<	0.63	<	5
1,1-Dichloroethane	<	0.3	<	0.3	<	0.43	<	5
cis-1,2-Dichloroethene	<	0.24	2.3	77	<	0.42	<	5
Chloroform	<	0.26	<	0.26	<	0.7	<	7
1,1,1-Trichloroethane	<	0.26	1.5	0.26	<	0.35	<	5
Trichloroethene	<	0.36	<	0.36	<	0.46	<	5
Bromodichloromethane	<	0.2	<	0.2	<	0.25	<	50
Toluene	<	0.2	<	0.2	<	0.38	<	5
Tetrachloroethene	1.3	1.3	<	0.11	<	0.62	<	5
Dibromochloromethane	<	0.13	<	0.13	<	0.25	<	50
Ethylbenzene	<	0.22	<	0.22	<	0.53	<	5
m,p-xylene	<	0.34	<	0.34	<	0.76	<	5
o-xylene	<	0.25	<	0.25	<	0.33	<	5
Isopropylbenzene	<	0.15	<	0.15	<	0.43	<	5
n-Propylbenzene	<	0.16	<	0.16	<	0.62	<	5
p-Ethyltoluene	<	0.16	<	0.16	<	0.16	<	NS
1,3,5-Trimethylbenzene	<	0.2	<	0.2	<	0.2	<	5
1,2,4-Trimethylbenzene	<	0.17	<	0.17	<	0.60	<	5
sec-Butylbenzene	<	0.22	<	0.22	<	0.61	<	5
4-Isopropyltoluene	<	0.17	<	0.17	<	0.67	<	5
1,4-Dichlorobenzene	<	0.1	<	0.10	<	0.51	<	3
1,2-Dichlorobenzene	<	0.11	<	0.11	<	0.45	<	3
p-Diethylbenzene	<	0.22	<	0.22	<	0.69	<	NS
n-Butylbenzene	<	0.17	<	0.17	<	0.73	<	5
1,2,4,5-Tetramethylbenzene	<	0.5	<	0.5	<	0.86	<	5
Naphthalene	<	0.29	<	0.29	<	0.94	<	10
Total VOCs	1.3	17.7	79.1	20.4	0	0	0	0

Notes:  
 ug/L - Micrograms per liter  
 < - Compound less than detection limit listed  
 VOCs - Volatile Organic Compounds  
 NS - No Standard

TABLE 3  
 RESULTS OF DISSOLVED METALS ANALYSES FOR GROUND WATER SAMPLES COLLECTED AT THE  
 ACTIVE INDUSTRIAL UNIFORM, LINDENHURST, NEW YORK  
 LAW PROJECT NO. 22000-0-0019

Sample Location:	MW-101	MW-102	MW-103	MW-104	MW-105	MW-106	MW-116	NYSDEC
Lab Sample ID:	J8132-6	J8132-5	J8133-3	J8133-4	J8133-1	J8133-6	J8133-7	Ground-Water Standards
Date Collected:	6/24/2002	6/24/2002	6/25/2002	6/25/2002	6/25/2002	6/25/2002	6/25/2002	
Constituent:								
Units in ug/L	< 3.2	< 3.2	< 3.2	< 3.2	< 3.2	< 3.2	< 3.2	
Chromium	<	3.8	3.2	3.7	5.6	3.1	9.3	50
Copper	2.8	9.8	7100	580	9570	4820	4900	200
Iron	10200	200	420	190	1070	270	280	300
Manganese	780	1.7	1.3	3.3	2.3	2.3	2.4	300
Nickel	2.8							100

All samples were field filtered using 0.45 micron  
 ug/L - micrograms per liter; eg. Parts per billion



TABLE 3  
 RESULTS OF DISSOLVED METALS ANALYSES FOR GROUND WATER SAMPLES COLLECTED AT THE  
 ACTIVE INDUSTRIAL UNIFORM, LINDENHURST, NEW YORK  
 LAW PROJECT NO. 22000-0-0019

Sample Location:	MW-107	MW-108	MW-109	MW-110	MW-111	Field Blank	NYSDEC Ground-Water Standards
Lab Sample ID:	J8133-5	J8132-4	J8132-1	J8132-2	J8132-3	J8133-2	
Date Collected:	6/25/2002	6/24/2002	6/24/2002	6/24/2002	6/24/2002	6/25/2002	
Constituent:							
Units in ug/L							
Chromium	< 3.2	< 3.2	5.6	4.7	< 3.2	< 3.2	50
Copper	3.3	2.9	2.8	2.8	3.2	5.5	200
Iron	11300	11	370	38	41	9.8	300
Manganese	920	110	930	8160	3350	2	300
Nickel	2.8	1.1	5.8	1.8	1.3	1	100

All samples were field filtered using 0.45 micron  
 ug/L - micrograms per liter; eg. Parts per billion



WEST MERRICK

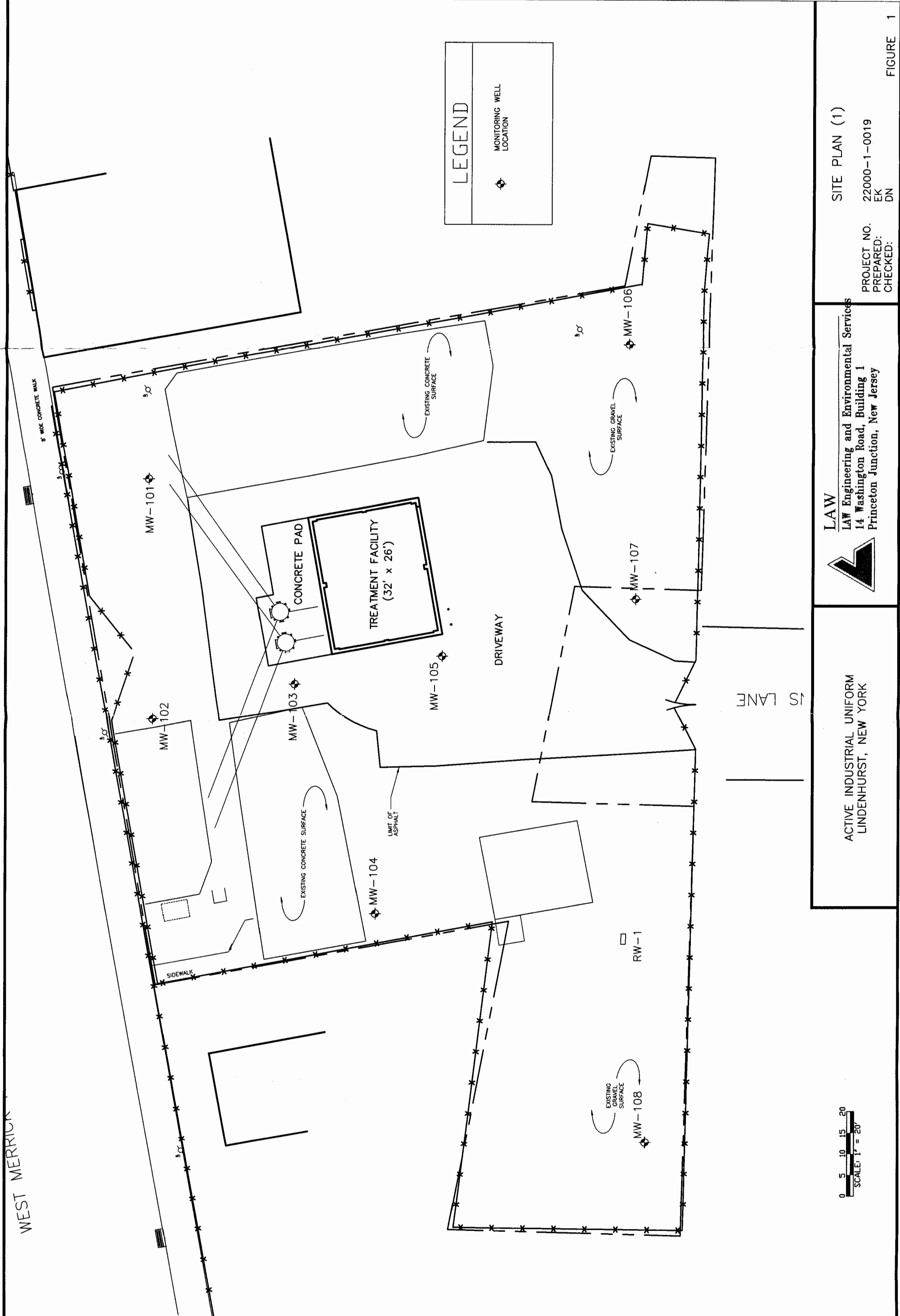

0 5 10 15 20  
SCALE: 1" = 20'

ACTIVE INDUSTRIAL UNIFORM  
LINDENHURST, NEW JERSEY



**LAW**  
LAW Engineering and Environmental Services  
14 Washington Road, Building 1  
Princeton Junction, New Jersey

SITE PLAN (1)

PROJECT NO. 22000-1-0019  
PREPARED: EK  
CHECKED: DN

**APPENDIX A**

# Environmental Testing Laboratories, Inc.

208 Route 109, Farmingdale NY 11735

Phone - 631-249-1456 Fax - 631-249-8344

07/09/2002

**Custody Document: J8132**

Received: 06/24/2002 15:21

Sampled by: Eric Killenbeck

**Client: Blue Waters (11260)**

1610 New Highway  
Farmingdale,  
NY 11735

**Project: Active Industrial**

67 West Montauk Hwy  
Lindenhurst,  
NY

**Manager: Mark Soloman**

Respectfully submitted,

*Patricia Werner-Els*

Quality Assurance Officer

NYS Lab ID # 10969  
NJ Cert. # 73812  
CT Cert. # PH0645  
MA Cert. # NY061  
PA Cert. # 68-535  
NH Cert. # 252592-BA  
RI Cert. # 161

The information contained in this report is confidential and intended only for the use of the client listed above. This report shall not be reproduced, except in full, without the written consent of Environmental Testing Laboratories, Inc.



# Environmental Testing Laboratories, Inc.

208 Route 109, Farmingdale NY 11735  
Phone - 631-249-1456 Fax - 631-249-8344

07/09/2002

## Volatiles - EPA 8260B

### Sample: J8132-1

Client Sample ID: MW-109

Collected: 06/24/2002 09:15

Matrix: Liquid

Type: Grab

Remarks: See Case Narrative

Analyzed Date: 07/01/2002

Cas No	Analyte	File ID	MDL	Concentration	Units	Q
75-71-8	Dichlorodifluoromethane	C 586 -2009	0.38	0.38	ppb	U
75-45-6	Chlorodifluoromethane	C 586 -2009	0.25	0.25	ppb	U
74-87-3	Chloromethane	C 586 -2009	0.32	0.32	ppb	U
75-01-4	Vinyl Chloride	C 586 -2009	0.23	0.23	ppb	U
74-83-9	Bromomethane	C 586 -2009	0.32	0.32	ppb	U
75-00-3	Chloroethane	C 586 -2009	0.24	0.24	ppb	U
75-69-4	Trichlorofluoromethane	C 586 -2009	0.27	0.27	ppb	U
76-13-1	1,1,2-Trichlorotrifluoroethane	C 586 -2009	0.36	0.36	ppb	U
75-35-4	1,1-Dichloroethene	C 586 -2009	0.27	0.27	ppb	U
67-64-1	Acetone	C 586 -2009	1.13	1.13	ppb	U
75-15-0	Carbon disulfide	C 586 -2009	0.19	0.19	ppb	U
75-09-2	Methylene Chloride	C 586 -2009	0.21	0.21	ppb	U
156-60-5	t-1,2-Dichloroethene	C 586 -2009	0.31	0.31	ppb	U
1634-04-4	Methyl t-butyl ether	C 586 -2009	0.18	10.3	ppb	
75-34-3	1,1-Dichloroethane	C 586 -2009	0.30	2.30	ppb	
590-20-7	2,2-Dichloropropane	C 586 -2009	0.27	0.27	ppb	U
156-59-2	c-1,2-Dichloroethene	C 586 -2009	0.24	2.30	ppb	
78-93-3	2-Butanone	C 586 -2009	3.80	3.80	ppb	U
74-97-5	Bromochloromethane	C 586 -2009	0.25	0.25	ppb	U
67-66-3	Chloroform	C 586 -2009	0.26	0.26	ppb	U
71-55-6	1,1,1-Trichloroethane	C 586 -2009	0.26	1.50	ppb	
56-23-5	Carbon Tetrachloride	C 586 -2009	0.22	0.22	ppb	U
563-58-6	1,1-Dichloropropene	C 586 -2009	0.39	0.39	ppb	U
71-43-2	Benzene	C 586 -2009	0.21	0.21	ppb	U
107-06-2	1,2-Dichloroethane	C 586 -2009	0.23	0.23	ppb	U
79-01-6	Trichloroethene	C 586 -2009	0.36	0.36	ppb	U
78-87-5	1,2-Dichloropropane	C 586 -2009	0.31	0.31	ppb	U
74-95-3	Dibromomethane	C 586 -2009	0.24	0.24	ppb	U
75-27-4	Bromodichloromethane	C 586 -2009	0.20	0.20	ppb	U
110-75-8	2-Chloroethylvinylether	C 586 -2009	0.33	0.33	ppb	U
10061-01-5	c-1,3-Dichloropropene	C 586 -2009	0.16	0.16	ppb	U
108-10-1	4-Methyl-2-pentanone	C 586 -2009	0.63	0.63	ppb	U
108-88-3	Toluene	C 586 -2009	0.20	0.20	ppb	U
10061-02-6	t-1,3-Dichloropropene	C 586 -2009	0.16	0.16	ppb	U
79-00-5	1,1,2-Trichloroethane	C 586 -2009	0.16	0.16	ppb	U
127-18-4	Tetrachloroethene	C 586 -2009	0.11	1.30	ppb	



# Environmental Testing Laboratories, Inc.

208 Route 109, Farmingdale NY 11735  
Phone - 631-249-1456 Fax - 631-249-8344

07/09/2002

## Volatiles - EPA 8260B

### Sample: J8132-1...continue

Client Sample ID: MW-109

Collected: 06/24/2002 09:15

Matrix: Liquid

Type: Grab

Remarks: See Case Narrative

Analyzed Date: 07/01/2002

Cas No	Analyte	File ID	MDL	Concentration	Units	Q
142-28-9	1,3-Dichloropropane	C 586 -2009	0.21	0.21	ppb	U
591-78-6	2-Hexanone	C 586 -2009	0.94	0.94	ppb	U
124-48-1	Dibromochloromethane	C 586 -2009	0.13	0.13	ppb	U
106-93-4	1,2-Dibromoethane	C 586 -2009	0.17	0.17	ppb	U
108-90-7	Chlorobenzene	C 586 -2009	0.15	0.15	ppb	U
630-20-6	1,1,1,2-Tetrachloroethane	C 586 -2009	0.20	0.20	ppb	U
100-41-4	Ethylbenzene	C 586 -2009	0.22	0.22	ppb	U
108-38-3	m,p-xylene	C 586 -2009	0.34	0.34	ppb	U
95-47-6	o-xylene	C 586 -2009	0.25	0.25	ppb	U
100-42-5	Styrene	C 586 -2009	0.20	0.20	ppb	U
75-25-2	Bromoform	C 586 -2009	0.21	0.21	ppb	U
98-82-8	Isopropylbenzene	C 586 -2009	0.15	0.15	ppb	U
108-86-1	Bromobenzene	C 586 -2009	0.20	0.20	ppb	U
79-34-5	1,1,2,2-Tetrachloroethane	C 586 -2009	0.23	0.23	ppb	U
103-65-1	n-Propylbenzene	C 586 -2009	0.16	0.16	ppb	U
96-18-4	1,2,3-Trichloropropane	C 586 -2009	0.35	0.35	ppb	U
622-96-8	p-Ethyltoluene	C 586 -2009	0.16	0.16	ppb	U
108-67-8	1,3,5-Trimethylbenzene	C 586 -2009	0.20	0.20	ppb	U
95-49-8	2-Chlorotoluene	C 586 -2009	0.25	0.25	ppb	U
106-43-4	4-Chlorotoluene	C 586 -2009	0.22	0.22	ppb	U
98-06-6	tert-Butylbenzene	C 586 -2009	0.19	0.19	ppb	U
95-63-6	1,2,4-Trimethylbenzene	C 586 -2009	0.17	0.17	ppb	U
135-98-8	sec-Butylbenzene	C 586 -2009	0.22	0.22	ppb	U
99-87-6	4-Isopropyltoluene	C 586 -2009	0.17	0.17	ppb	U
541-73-1	1,3-Dichlorobenzene	C 586 -2009	0.17	0.17	ppb	U
106-46-7	1,4-Dichlorobenzene	C 586 -2009	0.10	0.10	ppb	U
95-50-1	1,2-Dichlorobenzene	C 586 -2009	0.11	0.11	ppb	U
105-05-5	p-Diethylbenzene	C 586 -2009	0.22	0.22	ppb	U
104-51-8	n-Butylbenzene	C 586 -2009	0.17	0.17	ppb	U
95-93-2	1,2,4,5-Tetramethylbenzene	C 586 -2009	0.50	0.50	ppb	U
96-12-8	1,2-Dibromo-3-chloropropane	C 586 -2009	0.42	0.42	ppb	U
120-82-1	1,2,4-Trichlorobenzene	C 586 -2009	0.13	0.13	ppb	U
87-68-3	Hexachlorobutadiene	C 586 -2009	0.45	0.45	ppb	U
91-20-3	Naphthalene	C 586 -2009	0.29	0.29	ppb	U
87-61-6	1,2,3-Trichlorobenzene	C 586 -2009	0.19	0.19	ppb	U



# Environmental Testing Laboratories, Inc.

208 Route 109, Farmingdale NY 11735

Phone - 631-249-1456 Fax - 631-249-8344

07/09/2002

## Volatiles - EPA 8260B

**Sample: J8132-1...continue**

Client Sample ID: MW-109

Collected: 06/24/2002 09:15

Matrix: Liquid

Type: Grab

Remarks: See Case Narrative

Analyzed Date: 07/01/2002

Cas No	Surrogate	File ID	% Recovery	QC Limits
460-00-4	4-BROMOFLUOROBENZENE	C586-2009	98.1 %	(76 - 116)
4774-33-8	DIBROMOFLUOROMETHANE	C586-2009	94.6 %	(83 - 105)
2037-26-5	TOLUENE-D8	C586-2009	101.0 %	(90 - 110)



# Environmental Testing Laboratories, Inc.

208 Route 109, Farmingdale NY 11735

Phone - 631-249-1456 Fax - 631-249-8344

07/09/2002

## Volatiles - EPA 8260B

**Sample: J8132-2**

Client Sample ID: MW-110

Collected: 06/24/2002 10:25

Matrix: Liquid

Type: Grab

Remarks: See Case Narrative

Analyzed Date: 07/01/2002

Cas No	Analyte	File ID	MDL	Concentration	Units	Q
75-71-8	Dichlorodifluoromethane	C 586 -2010	0.38	0.38	ppb	U
75-45-6	Chlorodifluoromethane	C 586 -2010	0.25	0.25	ppb	U
74-87-3	Chloromethane	C 586 -2010	0.32	0.32	ppb	U
75-01-4	Vinyl Chloride	C 586 -2010	0.23	0.23	ppb	U
74-83-9	Bromomethane	C 586 -2010	0.32	0.32	ppb	U
75-00-3	Chloroethane	C 586 -2010	0.24	0.24	ppb	U
75-69-4	Trichlorofluoromethane	C 586 -2010	0.27	0.27	ppb	U
76-13-1	1,1,2-Trichlorotrifluoroethane	C 586 -2010	0.36	0.36	ppb	U
75-35-4	1,1-Dichloroethene	C 586 -2010	0.27	0.27	ppb	U
67-64-1	Acetone	C 586 -2010	1.13	1.13	ppb	U
75-15-0	Carbon disulfide	C 586 -2010	0.19	0.19	ppb	U
75-09-2	Methylene Chloride	C 586 -2010	0.21	0.21	ppb	U
156-60-5	t-1,2-Dichloroethene	C 586 -2010	0.31	0.31	ppb	U
1634-04-4	Methyl t-butyl ether	C 586 -2010	0.18	2.10	ppb	
75-34-3	1,1-Dichloroethane	C 586 -2010	0.30	0.30	ppb	U
590-20-7	2,2-Dichloropropane	C 586 -2010	0.27	0.27	ppb	U
156-59-2	c-1,2-Dichloroethene	C 586 -2010	0.24	77.0	ppb	
78-93-3	2-Butanone	C 586 -2010	3.80	3.80	ppb	U
74-97-5	Bromochloromethane	C 586 -2010	0.25	0.25	ppb	U
67-66-3	Chloroform	C 586 -2010	0.26	0.26	ppb	U
71-55-6	1,1,1-Trichloroethane	C 586 -2010	0.26	0.26	ppb	U
56-23-5	Carbon Tetrachloride	C 586 -2010	0.22	0.22	ppb	U
563-58-6	1,1-Dichloropropene	C 586 -2010	0.39	0.39	ppb	U
71-43-2	Benzene	C 586 -2010	0.21	0.21	ppb	U
107-06-2	1,2-Dichloroethane	C 586 -2010	0.23	0.23	ppb	U
79-01-6	Trichloroethene	C 586 -2010	0.36	0.36	ppb	U
78-87-5	1,2-Dichloropropane	C 586 -2010	0.31	0.31	ppb	U
74-95-3	Dibromomethane	C 586 -2010	0.24	0.24	ppb	U
75-27-4	Bromodichloromethane	C 586 -2010	0.20	0.20	ppb	U
110-75-8	2-Chloroethylvinylether	C 586 -2010	0.33	0.33	ppb	U
10061-01-5	c-1,3-Dichloropropene	C 586 -2010	0.16	0.16	ppb	U
108-10-1	4-Methyl-2-pentanone	C 586 -2010	0.63	0.63	ppb	U
108-88-3	Toluene	C 586 -2010	0.20	0.20	ppb	U
10061-02-6	t-1,3-Dichloropropene	C 586 -2010	0.16	0.16	ppb	U
79-00-5	1,1,2-Trichloroethane	C 586 -2010	0.16	0.16	ppb	U
127-18-4	Tetrachloroethene	C 586 -2010	0.11	0.11	ppb	U





# Environmental Testing Laboratories, Inc.

208 Route 109, Farmingdale NY 11735

Phone - 631-249-1456 Fax - 631-249-8344

07/09/2002

## Volatiles - EPA 8260B

**Sample:** J8132-2...continue

Client Sample ID: MW-110

Matrix: Liquid

Type: Grab

Collected: 06/24/2002 10:25

Remarks: See Case Narrative

Analyzed Date: 07/01/2002

Cas No	Analyte	File ID	MDL	Concentration	Units	Q
142-28-9	1,3-Dichloropropane	C 586 -2010	0.21	0.21	ppb	U
591-78-6	2-Hexanone	C 586 -2010	0.94	0.94	ppb	U
124-48-1	Dibromochloromethane	C 586 -2010	0.13	0.13	ppb	U
106-93-4	1,2-Dibromoethane	C 586 -2010	0.17	0.17	ppb	U
108-90-7	Chlorobenzene	C 586 -2010	0.15	0.15	ppb	U
630-20-6	1,1,1,2-Tetrachloroethane	C 586 -2010	0.20	0.20	ppb	U
100-41-4	Ethylbenzene	C 586 -2010	0.22	0.22	ppb	U
108-38-3	m,p-xylene	C 586 -2010	0.34	0.34	ppb	U
95-47-6	o-xylene	C 586 -2010	0.25	0.25	ppb	U
100-42-5	Styrene	C 586 -2010	0.20	0.20	ppb	U
75-25-2	Bromoform	C 586 -2010	0.21	0.21	ppb	U
98-82-8	Isopropylbenzene	C 586 -2010	0.15	0.15	ppb	U
108-86-1	Bromobenzene	C 586 -2010	0.20	0.20	ppb	U
79-34-5	1,1,2,2-Tetrachloroethane	C 586 -2010	0.23	0.23	ppb	U
103-65-1	n-Propylbenzene	C 586 -2010	0.16	0.16	ppb	U
96-18-4	1,2,3-Trichloropropane	C 586 -2010	0.35	0.35	ppb	U
622-96-8	p-Ethyltoluene	C 586 -2010	0.16	0.16	ppb	U
108-67-8	1,3,5-Trimethylbenzene	C 586 -2010	0.20	0.20	ppb	U
95-49-8	2-Chlorotoluene	C 586 -2010	0.25	0.25	ppb	U
106-43-4	4-Chlorotoluene	C 586 -2010	0.22	0.22	ppb	U
98-06-6	tert-Butylbenzene	C 586 -2010	0.19	0.19	ppb	U
95-63-6	1,2,4-Trimethylbenzene	C 586 -2010	0.17	0.17	ppb	U
135-98-8	sec-Butylbenzene	C 586 -2010	0.22	0.22	ppb	U
99-87-6	4-Isopropyltoluene	C 586 -2010	0.17	0.17	ppb	U
541-73-1	1,3-Dichlorobenzene	C 586 -2010	0.17	0.17	ppb	U
106-46-7	1,4-Dichlorobenzene	C 586 -2010	0.10	0.10	ppb	U
95-50-1	1,2-Dichlorobenzene	C 586 -2010	0.11	0.11	ppb	U
105-05-5	p-Diethylbenzene	C 586 -2010	0.22	0.22	ppb	U
104-51-8	n-Butylbenzene	C 586 -2010	0.17	0.17	ppb	U
95-93-2	1,2,4,5-Tetramethylbenzene	C 586 -2010	0.50	0.50	ppb	U
96-12-8	1,2-Dibromo-3-chloropropane	C 586 -2010	0.42	0.42	ppb	U
120-82-1	1,2,4-Trichlorobenzene	C 586 -2010	0.13	0.13	ppb	U
87-68-3	Hexachlorobutadiene	C 586 -2010	0.45	0.45	ppb	U
91-20-3	Naphthalene	C 586 -2010	0.29	0.29	ppb	U
87-61-6	1,2,3-Trichlorobenzene	C 586 -2010	0.19	0.19	ppb	U



# Environmental Testing Laboratories, Inc.

208 Route 109, Farmingdale NY 11735  
Phone - 631-249-1456 Fax - 631-249-8344

07/09/2002

## Volatiles - EPA 8260B

**Sample: J8132-2...continue**

Client Sample ID: MW-110

Collected: 06/24/2002 10:25

Matrix: Liquid

Type: Grab

Remarks: See Case Narrative

Analyzed Date: 07/01/2002

Cas No	Surrogate	File ID	% Recovery	QC Limits	Q
460-00-4	4-BROMOFLUOROBENZENE	C586-2010	98.8 %	(76 - 118)	
4774-33-8	DIBROMOFLUOROMETHANE	C586-2010	94.5 %	(83 - 113)	
2037-26-5	TOLUENE-D8	C586-2010	101.0 %	(90 - 111)	



# Environmental Testing Laboratories, Inc.

208 Route 109, Farmingdale NY 11735

Phone - 631-249-1456 Fax - 631-249-8344

07/09/2002

## Volatiles - EPA 8260B

**Sample: J8132-3**

Client Sample ID: MW-111

Collected: 06/24/2002 11:40

Matrix: Liquid

Type: Grab

Remarks: See Case Narrative

Analyzed Date: 06/28/2002

Cas No	Analyte	File ID	MDL	Concentration	Units	Q
75-71-8	Dichlorodifluoromethane	C 584 -1963	0.38	0.38	ppb	U
75-45-6	Chlorodifluoromethane	C 584 -1963	0.25	0.25	ppb	U
74-87-3	Chloromethane	C 584 -1963	0.32	0.32	ppb	U
75-01-4	Vinyl Chloride	C 584 -1963	0.23	0.23	ppb	U
74-83-9	Bromomethane	C 584 -1963	0.32	0.32	ppb	U
75-00-3	Chloroethane	C 584 -1963	0.24	0.24	ppb	U
75-69-4	Trichlorofluoromethane	C 584 -1963	0.27	0.27	ppb	U
76-13-1	1,1,2-Trichlorotrifluoroethane	C 584 -1963	0.36	0.36	ppb	U
75-35-4	1,1-Dichloroethene	C 584 -1963	0.27	0.27	ppb	U
67-64-1	Acetone	C 584 -1963	1.13	1.13	ppb	U
75-15-0	Carbon disulfide	C 584 -1963	0.19	0.19	ppb	U
75-09-2	Methylene Chloride	C 584 -1963	0.21	0.21	ppb	U
156-60-5	t-1,2-Dichloroethene	C 584 -1963	0.31	0.31	ppb	U
1634-04-4	Methyl t-butyl ether	C 584 -1963	0.18	20.4	ppb	
75-34-3	1,1-Dichloroethane	C 584 -1963	0.30	0.30	ppb	U
590-20-7	2,2-Dichloropropane	C 584 -1963	0.27	0.27	ppb	U
156-59-2	c-1,2-Dichloroethene	C 584 -1963	0.24	0.24	ppb	U
78-93-3	2-Butanone	C 584 -1963	3.80	3.80	ppb	U
74-97-5	Bromochloromethane	C 584 -1963	0.25	0.25	ppb	U
67-66-3	Chloroform	C 584 -1963	0.26	0.26	ppb	U
71-55-6	1,1,1-Trichloroethane	C 584 -1963	0.26	0.26	ppb	U
56-23-5	Carbon Tetrachloride	C 584 -1963	0.22	0.22	ppb	U
563-58-6	1,1-Dichloropropene	C 584 -1963	0.39	0.39	ppb	U
71-43-2	Benzene	C 584 -1963	0.21	0.21	ppb	U
107-06-2	1,2-Dichloroethane	C 584 -1963	0.23	0.23	ppb	U
79-01-6	Trichloroethene	C 584 -1963	0.36	0.36	ppb	U
78-87-5	1,2-Dichloropropane	C 584 -1963	0.31	0.31	ppb	U
74-95-3	Dibromomethane	C 584 -1963	0.24	0.24	ppb	U
75-27-4	Bromodichloromethane	C 584 -1963	0.20	0.20	ppb	U
110-75-8	2-Chloroethylvinylether	C 584 -1963	0.33	0.33	ppb	U
10061-01-5	c-1,3-Dichloropropene	C 584 -1963	0.16	0.16	ppb	U
108-10-1	4-Methyl-2-pentanone	C 584 -1963	0.63	0.63	ppb	U
108-88-3	Toluene	C 584 -1963	0.20	0.20	ppb	U
10061-02-6	t-1,3-Dichloropropene	C 584 -1963	0.16	0.16	ppb	U
79-00-5	1,1,2-Trichloroethane	C 584 -1963	0.16	0.16	ppb	U
127-18-4	Tetrachloroethene	C 584 -1963	0.11	0.11	ppb	U



# Environmental Testing Laboratories, Inc.

208 Route 109, Farmingdale NY 11735  
Phone - 631-249-1456 Fax - 631-249-8344

07/09/2002

## Volatiles - EPA 8260B

### Sample: J8132-3...continue

Client Sample ID: MW-111

Collected: 06/24/2002 11:40

Matrix: Liquid

Type: Grab

Remarks: See Case Narrative

Analyzed Date: 06/28/2002

Cas No	Analyte	File ID	MDL	Concentration	Units	Q
142-28-9	1,3-Dichloropropane	C 584 -1963	0.21	0.21	ppb	U
591-78-6	2-Hexanone	C 584 -1963	0.94	0.94	ppb	U
124-48-1	Dibromochloromethane	C 584 -1963	0.13	0.13	ppb	U
106-93-4	1,2-Dibromoethane	C 584 -1963	0.17	0.17	ppb	U
108-90-7	Chlorobenzene	C 584 -1963	0.15	0.15	ppb	U
630-20-6	1,1,1,2-Tetrachloroethane	C 584 -1963	0.20	0.20	ppb	U
100-41-4	Ethylbenzene	C 584 -1963	0.22	0.22	ppb	U
108-38-3	m,p-xylene	C 584 -1963	0.34	0.34	ppb	U
95-47-6	o-xylene	C 584 -1963	0.25	0.25	ppb	U
100-42-5	Styrene	C 584 -1963	0.20	0.20	ppb	U
75-25-2	Bromoform	C 584 -1963	0.21	0.21	ppb	U
98-82-8	Isopropylbenzene	C 584 -1963	0.15	0.15	ppb	U
108-86-1	Bromobenzene	C 584 -1963	0.20	0.20	ppb	U
79-34-5	1,1,2,2-Tetrachloroethane	C 584 -1963	0.23	0.23	ppb	U
103-65-1	n-Propylbenzene	C 584 -1963	0.16	0.16	ppb	U
96-18-4	1,2,3-Trichloropropane	C 584 -1963	0.35	0.35	ppb	U
622-96-8	p-Ethyltoluene	C 584 -1963	0.16	0.16	ppb	U
108-67-8	1,3,5-Trimethylbenzene	C 584 -1963	0.20	0.20	ppb	U
95-49-8	2-Chlorotoluene	C 584 -1963	0.25	0.25	ppb	U
106-43-4	4-Chlorotoluene	C 584 -1963	0.22	0.22	ppb	U
98-06-6	tert-Butylbenzene	C 584 -1963	0.19	0.19	ppb	U
95-63-6	1,2,4-Trimethylbenzene	C 584 -1963	0.17	0.17	ppb	U
135-98-8	sec-Butylbenzene	C 584 -1963	0.22	0.22	ppb	U
99-87-6	4-Isopropyltoluene	C 584 -1963	0.17	1.30	ppb	
541-73-1	1,3-Dichlorobenzene	C 584 -1963	0.17	0.17	ppb	U
106-46-7	1,4-Dichlorobenzene	C 584 -1963	0.10	0.10	ppb	U
95-50-1	1,2-Dichlorobenzene	C 584 -1963	0.11	0.11	ppb	U
105-05-5	p-Diethylbenzene	C 584 -1963	0.22	0.22	ppb	U
104-51-8	n-Butylbenzene	C 584 -1963	0.17	0.17	ppb	U
95-93-2	1,2,4,5-Tetramethylbenzene	C 584 -1963	0.50	0.50	ppb	U
96-12-8	1,2-Dibromo-3-chloropropane	C 584 -1963	0.42	0.42	ppb	U
120-82-1	1,2,4-Trichlorobenzene	C 584 -1963	0.13	0.13	ppb	U
87-68-3	Hexachlorobutadiene	C 584 -1963	0.45	0.45	ppb	U
91-20-3	Naphthalene	C 584 -1963	0.29	0.29	ppb	U
87-61-6	1,2,3-Trichlorobenzene	C 584 -1963	0.19	0.19	ppb	U



# Environmental Testing Laboratories, Inc.

208 Route 109, Farmingdale NY 11735  
Phone - 631-249-1456 Fax - 631-249-8344

07/09/2002

## Volatiles - EPA 8260B

**Sample: J8132-3...continue**

Client Sample ID: MW-111

Matrix: Liquid

Remarks: See Case Narrative

Analyzed Date: 06/28/2002

Type: Grab

Collected: 06/24/2002 11:40

Cas No	Surrogate	File ID	% Recovery	GC Limits	SD
460-00-4	4-BROMOFLUOROBENZENE	C584-1963	96.7 %	(75-100)	
4774-33-8	DIBROMOFLUOROMETHANE	C584-1963	93.4 %	(83-100)	
2037-26-5	TOLUENE-D8	C584-1963	99.8 %	(90-100)	



# Environmental Testing Laboratories, Inc.

208 Route 109, Farmingdale NY 11735  
Phone - 631-249-1456 Fax - 631-249-8344

07/09/2002

## Volatiles - EPA 8260B

### Sample: J8132-4

Client Sample ID: MW-108

Collected: 06/24/2002 12:55

Matrix: Liquid

Type: Grab

Remarks: See Case Narrative

Analyzed Date: 06/28/2002

Cas No	Analyte	File ID	MDL	Concentration	Units	Q
75-71-8	Dichlorodifluoromethane	C 584 -1964	0.38	0.38	ppb	U
75-45-6	Chlorodifluoromethane	C 584 -1964	0.25	0.25	ppb	U
74-87-3	Chloromethane	C 584 -1964	0.32	0.32	ppb	U
75-01-4	Vinyl Chloride	C 584 -1964	0.23	0.23	ppb	U
74-83-9	Bromomethane	C 584 -1964	0.32	0.32	ppb	U
75-00-3	Chloroethane	C 584 -1964	0.24	0.24	ppb	U
75-69-4	Trichlorofluoromethane	C 584 -1964	0.27	0.27	ppb	U
76-13-1	1,1,2-Trichlorotrifluoroethane	C 584 -1964	0.36	0.36	ppb	U
75-35-4	1,1-Dichloroethene	C 584 -1964	0.27	0.27	ppb	U
67-64-1	Acetone	C 584 -1964	1.13	1.13	ppb	U
75-15-0	Carbon disulfide	C 584 -1964	0.19	0.19	ppb	U
75-09-2	Methylene Chloride	C 584 -1964	0.21	0.21	ppb	U
156-60-5	t-1,2-Dichloroethene	C 584 -1964	0.31	0.31	ppb	U
1634-04-4	Methyl t-butyl ether	C 584 -1964	0.18	0.18	ppb	U
75-34-3	1,1-Dichloroethane	C 584 -1964	0.30	0.30	ppb	U
590-20-7	2,2-Dichloropropane	C 584 -1964	0.27	0.27	ppb	U
156-59-2	c-1,2-Dichloroethene	C 584 -1964	0.24	0.24	ppb	U
78-93-3	2-Butanone	C 584 -1964	3.80	3.80	ppb	U
74-97-5	Bromochloromethane	C 584 -1964	0.25	0.25	ppb	U
67-66-3	Chloroform	C 584 -1964	0.26	0.26	ppb	U
71-55-6	1,1,1-Trichloroethane	C 584 -1964	0.26	0.26	ppb	U
56-23-5	Carbon Tetrachloride	C 584 -1964	0.22	0.22	ppb	U
563-58-6	1,1-Dichloropropene	C 584 -1964	0.39	0.39	ppb	U
71-43-2	Benzene	C 584 -1964	0.21	0.21	ppb	U
107-06-2	1,2-Dichloroethane	C 584 -1964	0.23	0.23	ppb	U
79-01-6	Trichloroethene	C 584 -1964	0.36	0.36	ppb	U
78-87-5	1,2-Dichloropropane	C 584 -1964	0.31	0.31	ppb	U
74-95-3	Dibromomethane	C 584 -1964	0.24	0.24	ppb	U
75-27-4	Bromodichloromethane	C 584 -1964	0.20	0.20	ppb	U
110-75-8	2-Chloroethylvinylether	C 584 -1964	0.33	0.33	ppb	U
10061-01-5	c-1,3-Dichloropropene	C 584 -1964	0.16	0.16	ppb	U
108-10-1	4-Methyl-2-pentanone	C 584 -1964	0.63	0.63	ppb	U
108-88-3	Toluene	C 584 -1964	0.20	0.20	ppb	U
10061-02-6	t-1,3-Dichloropropene	C 584 -1964	0.16	0.16	ppb	U
79-00-5	1,1,2-Trichloroethane	C 584 -1964	0.16	0.16	ppb	U
127-18-4	Tetrachloroethene	C 584 -1964	0.11	1.30	ppb	



# Environmental Testing Laboratories, Inc.

208 Route 109, Farmingdale NY 11735  
Phone - 631-249-1456 Fax - 631-249-8344

07/09/2002

## Volatiles - EPA 8260B

Sample: J8132-4...continue

Client Sample ID: MW-108

Collected: 06/24/2002 12:55

Matrix: Liquid

Type: Grab

Remarks: See Case Narrative

Analyzed Date: 06/28/2002

Cas No	Analyte	File ID	MDL	Concentration	Units	Q
142-28-9	1,3-Dichloropropane	C 584 -1964	0.21	0.21	ppb	U
591-78-6	2-Hexanone	C 584 -1964	0.94	0.94	ppb	U
124-48-1	Dibromochloromethane	C 584 -1964	0.13	0.13	ppb	U
106-93-4	1,2-Dibromoethane	C 584 -1964	0.17	0.17	ppb	U
108-90-7	Chlorobenzene	C 584 -1964	0.15	0.15	ppb	U
630-20-6	1,1,1,2-Tetrachloroethane	C 584 -1964	0.20	0.20	ppb	U
100-41-4	Ethylbenzene	C 584 -1964	0.22	0.22	ppb	U
108-38-3	m,p-xylene	C 584 -1964	0.34	0.34	ppb	U
95-47-6	o-xylene	C 584 -1964	0.25	0.25	ppb	U
100-42-5	Styrene	C 584 -1964	0.20	0.20	ppb	U
75-25-2	Bromoform	C 584 -1964	0.21	0.21	ppb	U
98-82-8	Isopropylbenzene	C 584 -1964	0.15	0.15	ppb	U
108-86-1	Bromobenzene	C 584 -1964	0.20	0.20	ppb	U
79-34-5	1,1,2,2-Tetrachloroethane	C 584 -1964	0.23	0.23	ppb	U
103-65-1	n-Propylbenzene	C 584 -1964	0.16	0.16	ppb	U
96-18-4	1,2,3-Trichloropropane	C 584 -1964	0.35	0.35	ppb	U
622-96-8	p-Ethyltoluene	C 584 -1964	0.16	0.16	ppb	U
108-67-8	1,3,5-Trimethylbenzene	C 584 -1964	0.20	0.20	ppb	U
95-49-8	2-Chlorotoluene	C 584 -1964	0.25	0.25	ppb	U
106-43-4	4-Chlorotoluene	C 584 -1964	0.22	0.22	ppb	U
98-06-6	tert-Butylbenzene	C 584 -1964	0.19	0.19	ppb	U
95-63-6	1,2,4-Trimethylbenzene	C 584 -1964	0.17	0.17	ppb	U
135-98-8	sec-Butylbenzene	C 584 -1964	0.22	0.22	ppb	U
99-87-6	4-Isopropyltoluene	C 584 -1964	0.17	0.17	ppb	U
541-73-1	1,3-Dichlorobenzene	C 584 -1964	0.17	0.17	ppb	U
106-46-7	1,4-Dichlorobenzene	C 584 -1964	0.10	0.10	ppb	U
95-50-1	1,2-Dichlorobenzene	C 584 -1964	0.11	0.11	ppb	U
105-05-5	p-Diethylbenzene	C 584 -1964	0.22	0.22	ppb	U
104-51-8	n-Butylbenzene	C 584 -1964	0.17	0.17	ppb	U
95-93-2	1,2,4,5-Tetramethylbenzene	C 584 -1964	0.50	0.50	ppb	U
96-12-8	1,2-Dibromo-3-chloropropane	C 584 -1964	0.42	0.42	ppb	U
120-82-1	1,2,4-Trichlorobenzene	C 584 -1964	0.13	0.13	ppb	U
87-68-3	Hexachlorobutadiene	C 584 -1964	0.45	0.45	ppb	U
91-20-3	Naphthalene	C 584 -1964	0.29	0.29	ppb	U
87-61-6	1,2,3-Trichlorobenzene	C 584 -1964	0.19	0.19	ppb	U



# Environmental Testing Laboratories, Inc.

208 Route 109, Farmingdale NY 11735  
Phone - 631-249-1456 Fax - 631-249-8344

07/09/2002

## Volatiles - EPA 8260B

**Sample: J8132-4...continue**

Client Sample ID: MW-108

Collected: 06/24/2002 12:55

Matrix: Liquid

Type: Grab

Remarks: See Case Narrative

Analyzed Date: 06/28/2002

Cas No	Surrogate	File ID	% Recovery	QC Limits	0
460-00-4	4-BROMOFLUOROBENZENE	C584-1964	96.2 %	(76 - 110)	
4774-33-8	DIBROMOFLUOROMETHANE	C584-1964	94.3 %	(83 - 110)	
2037-26-5	TOLUENE-D8	C584-1964	101.0 %	(90 - 110)	





# Environmental Testing Laboratories, Inc.

208 Route 109, Farmingdale NY 11735  
Phone - 631-249-1456 Fax - 631-249-8344

07/09/2002

## Volatiles - EPA 8260B

### Sample: J8132-5

Client Sample ID: MW-102

Collected: 06/24/2002 14:55

Matrix: Liquid

Type: Grab

Remarks: See Case Narrative

Analyzed Date: 06/28/2002

Cas No	Analyte	File ID	MDL	Concentration	Units	Q
75-71-8	Dichlorodifluoromethane	C 584 -1965	0.38	0.38	ppb	U
75-45-6	Chlorodifluoromethane	C 584 -1965	0.25	0.25	ppb	U
74-87-3	Chloromethane	C 584 -1965	0.32	0.32	ppb	U
75-01-4	Vinyl Chloride	C 584 -1965	0.23	0.23	ppb	U
74-83-9	Bromomethane	C 584 -1965	0.32	0.32	ppb	U
75-00-3	Chloroethane	C 584 -1965	0.24	0.24	ppb	U
75-69-4	Trichlorofluoromethane	C 584 -1965	0.27	0.27	ppb	U
76-13-1	1,1,2-Trichlorotrifluoroethane	C 584 -1965	0.36	0.36	ppb	U
75-35-4	1,1-Dichloroethene	C 584 -1965	0.27	0.27	ppb	U
67-64-1	Acetone	C 584 -1965	1.13	1.13	ppb	U
75-15-0	Carbon disulfide	C 584 -1965	0.19	0.19	ppb	U
75-09-2	Methylene Chloride	C 584 -1965	0.21	0.21	ppb	U
156-60-5	t-1,2-Dichloroethene	C 584 -1965	0.31	0.31	ppb	U
1634-04-4	Methyl t-butyl ether	C 584 -1965	0.18	0.18	ppb	U
75-34-3	1,1-Dichloroethane	C 584 -1965	0.30	0.30	ppb	U
590-20-7	2,2-Dichloropropane	C 584 -1965	0.27	0.27	ppb	U
156-59-2	c-1,2-Dichloroethene	C 584 -1965	0.24	0.24	ppb	U
78-93-3	2-Butanone	C 584 -1965	3.80	3.80	ppb	U
74-97-5	Bromochloromethane	C 584 -1965	0.25	0.25	ppb	U
67-66-3	Chloroform	C 584 -1965	0.26	0.26	ppb	U
71-55-6	1,1,1-Trichloroethane	C 584 -1965	0.26	0.26	ppb	U
56-23-5	Carbon Tetrachloride	C 584 -1965	0.22	0.22	ppb	U
563-58-6	1,1-Dichloropropene	C 584 -1965	0.39	0.39	ppb	U
71-43-2	Benzene	C 584 -1965	0.21	0.21	ppb	U
107-06-2	1,2-Dichloroethane	C 584 -1965	0.23	0.23	ppb	U
79-01-6	Trichloroethene	C 584 -1965	0.36	0.36	ppb	U
78-87-5	1,2-Dichloropropane	C 584 -1965	0.31	0.31	ppb	U
74-95-3	Dibromomethane	C 584 -1965	0.24	0.24	ppb	U
75-27-4	Bromodichloromethane	C 584 -1965	0.20	0.20	ppb	U
110-75-8	2-Chloroethylvinylether	C 584 -1965	0.33	0.33	ppb	U
10061-01-5	c-1,3-Dichloropropene	C 584 -1965	0.16	0.16	ppb	U
108-10-1	4-Methyl-2-pentanone	C 584 -1965	0.63	0.63	ppb	U
108-88-3	Toluene	C 584 -1965	0.20	0.20	ppb	U
10061-02-6	t-1,3-Dichloropropene	C 584 -1965	0.16	0.16	ppb	U
79-00-5	1,1,2-Trichloroethane	C 584 -1965	0.16	0.16	ppb	U
127-18-4	Tetrachloroethene	C 584 -1965	0.11	3.30	ppb	



# Environmental Testing Laboratories, Inc.

208 Route 109, Farmingdale NY 11735  
Phone - 631-249-1456 Fax - 631-249-8344

07/09/2002

## Volatiles - EPA 8260B

Sample: J8132-5...continue

Client Sample ID: MW-102

Collected: 06/24/2002 14:55

Matrix: Liquid

Type: Grab

Remarks: See Case Narrative

Analyzed Date: 06/28/2002

Cas No	Analyte	File ID	MDL	Concentration	Units	Q
142-28-9	1,3-Dichloropropane	C 584 -1965	0.21	0.21	ppb	U
591-78-6	2-Hexanone	C 584 -1965	0.94	0.94	ppb	U
124-48-1	Dibromochloromethane	C 584 -1965	0.13	0.13	ppb	U
106-93-4	1,2-Dibromoethane	C 584 -1965	0.17	0.17	ppb	U
108-90-7	Chlorobenzene	C 584 -1965	0.15	0.15	ppb	U
630-20-6	1,1,1,2-Tetrachloroethane	C 584 -1965	0.20	0.20	ppb	U
100-41-4	Ethylbenzene	C 584 -1965	0.22	0.22	ppb	U
108-38-3	m,p-xylene	C 584 -1965	0.34	0.34	ppb	U
95-47-6	o-xylene	C 584 -1965	0.25	0.25	ppb	U
100-42-5	Styrene	C 584 -1965	0.20	0.20	ppb	U
75-25-2	Bromoform	C 584 -1965	0.21	0.21	ppb	U
98-82-8	Isopropylbenzene	C 584 -1965	0.15	0.15	ppb	U
108-86-1	Bromobenzene	C 584 -1965	0.20	0.20	ppb	U
79-34-5	1,1,2,2-Tetrachloroethane	C 584 -1965	0.23	0.23	ppb	U
103-65-1	n-Propylbenzene	C 584 -1965	0.16	0.16	ppb	U
96-18-4	1,2,3-Trichloropropane	C 584 -1965	0.35	0.35	ppb	U
622-96-8	p-Ethyltoluene	C 584 -1965	0.16	0.16	ppb	U
108-67-8	1,3,5-Trimethylbenzene	C 584 -1965	0.20	0.20	ppb	U
95-49-8	2-Chlorotoluene	C 584 -1965	0.25	0.25	ppb	U
106-43-4	4-Chlorotoluene	C 584 -1965	0.22	0.22	ppb	U
98-06-6	tert-Butylbenzene	C 584 -1965	0.19	0.19	ppb	U
95-63-6	1,2,4-Trimethylbenzene	C 584 -1965	0.17	0.17	ppb	U
135-98-8	sec-Butylbenzene	C 584 -1965	0.22	0.22	ppb	U
99-87-6	4-Isopropyltoluene	C 584 -1965	0.17	0.17	ppb	U
541-73-1	1,3-Dichlorobenzene	C 584 -1965	0.17	0.17	ppb	U
106-46-7	1,4-Dichlorobenzene	C 584 -1965	0.10	0.10	ppb	U
95-50-1	1,2-Dichlorobenzene	C 584 -1965	0.11	0.11	ppb	U
105-05-5	p-Diethylbenzene	C 584 -1965	0.22	0.22	ppb	U
104-51-8	n-Butylbenzene	C 584 -1965	0.17	0.17	ppb	U
95-93-2	1,2,4,5-Tetramethylbenzene	C 584 -1965	0.50	0.50	ppb	U
96-12-8	1,2-Dibromo-3-chloropropane	C 584 -1965	0.42	0.42	ppb	U
120-82-1	1,2,4-Trichlorobenzene	C 584 -1965	0.13	0.13	ppb	U
87-68-3	Hexachlorobutadiene	C 584 -1965	0.45	0.45	ppb	U
91-20-3	Naphthalene	C 584 -1965	0.29	0.29	ppb	U
87-61-6	1,2,3-Trichlorobenzene	C 584 -1965	0.19	0.19	ppb	U



# Environmental Testing Laboratories, Inc.

208 Route 109, Farmingdale NY 11735  
Phone - 631-249-1456 Fax - 631-249-8344

07/09/2002

## Volatiles - EPA 8260B

**Sample: J8132-5...continue**

Client Sample ID: MW-102

Matrix: Liquid

Remarks: See Case Narrative

Analyzed Date: 06/28/2002

Type: Grab

Collected: 06/24/2002 14:55

Cas No	Surrogate	File ID	% Recovery	QC Limits
460-00-4	4-BROMOFLUOROBENZENE	C584-1965	96.9 %	(76 - 119)
4774-33-8	DIBROMOFLUOROMETHANE	C584-1965	94.4 %	(83 - 119)
2037-26-5	TOLUENE-D8	C584-1965	101.0 %	(90 - 111)



# Environmental Testing Laboratories, Inc.

208 Route 109, Farmingdale NY 11735  
Phone - 631-249-1456 Fax - 631-249-8344

07/09/2002

## Volatiles - EPA 8260B

**Sample: J8132-6**

Client Sample ID: MW-101

Collected: 06/24/2002 16:05

Matrix: Liquid

Type: Grab

Remarks: See Case Narrative

Analyzed Date: 06/28/2002

Cas No	Analyte	File ID	MDL	Concentration	Units	Q
75-71-8	Dichlorodifluoromethane	C 584 -1966	0.38	0.38	ppb	U
75-45-6	Chlorodifluoromethane	C 584 -1966	0.25	0.25	ppb	U
74-87-3	Chloromethane	C 584 -1966	0.32	0.32	ppb	U
75-01-4	Vinyl Chloride	C 584 -1966	0.23	0.23	ppb	U
74-83-9	Bromomethane	C 584 -1966	0.32	0.32	ppb	U
75-00-3	Chloroethane	C 584 -1966	0.24	0.24	ppb	U
75-69-4	Trichlorofluoromethane	C 584 -1966	0.27	0.27	ppb	U
76-13-1	1,1,2-Trichlorotrifluoroethane	C 584 -1966	0.36	0.36	ppb	U
75-35-4	1,1-Dichloroethene	C 584 -1966	0.27	0.27	ppb	U
67-64-1	Acetone	C 584 -1966	1.13	1.13	ppb	U
75-15-0	Carbon disulfide	C 584 -1966	0.19	0.19	ppb	U
75-09-2	Methylene Chloride	C 584 -1966	0.21	0.21	ppb	U
156-60-5	t-1,2-Dichloroethene	C 584 -1966	0.31	0.31	ppb	U
1634-04-4	Methyl t-butyl ether	C 584 -1966	0.18	3.80	ppb	
75-34-3	1,1-Dichloroethane	C 584 -1966	0.30	0.30	ppb	U
590-20-7	2,2-Dichloropropane	C 584 -1966	0.27	0.27	ppb	U
156-59-2	c-1,2-Dichloroethene	C 584 -1966	0.24	0.24	ppb	U
78-93-3	2-Butanone	C 584 -1966	3.80	3.80	ppb	U
74-97-5	Bromochloromethane	C 584 -1966	0.25	0.25	ppb	U
67-66-3	Chloroform	C 584 -1966	0.26	0.26	ppb	U
71-55-6	1,1,1-Trichloroethane	C 584 -1966	0.26	0.26	ppb	U
56-23-5	Carbon Tetrachloride	C 584 -1966	0.22	0.22	ppb	U
563-58-6	1,1-Dichloropropene	C 584 -1966	0.39	0.39	ppb	U
71-43-2	Benzene	C 584 -1966	0.21	0.21	ppb	U
107-06-2	1,2-Dichloroethane	C 584 -1966	0.23	0.23	ppb	U
79-01-6	Trichloroethene	C 584 -1966	0.36	0.36	ppb	U
78-87-5	1,2-Dichloropropane	C 584 -1966	0.31	0.31	ppb	U
74-95-3	Dibromomethane	C 584 -1966	0.24	0.24	ppb	U
75-27-4	Bromodichloromethane	C 584 -1966	0.20	0.20	ppb	U
110-75-8	2-Chloroethylvinylether	C 584 -1966	0.33	0.33	ppb	U
10061-01-5	c-1,3-Dichloropropene	C 584 -1966	0.16	0.16	ppb	U
108-10-1	4-Methyl-2-pentanone	C 584 -1966	0.63	0.63	ppb	U
108-88-3	Toluene	C 584 -1966	0.20	0.20	ppb	U
10061-02-6	t-1,3-Dichloropropene	C 584 -1966	0.16	0.16	ppb	U
79-00-5	1,1,2-Trichloroethane	C 584 -1966	0.16	0.16	ppb	U
127-18-4	Tetrachloroethene	C 584 -1966	0.11	1.10	ppb	



# Environmental Testing Laboratories, Inc.

208 Route 109, Farmingdale NY 11735

Phone - 631-249-1456 Fax - 631-249-8344

07/09/2002

## Volatiles - EPA 8260B

### Sample: J8132-6...continue

Client Sample ID: MW-101

Matrix: Liquid

Remarks: See Case Narrative

Analyzed Date: 06/28/2002

Type: Grab

Collected: 06/24/2002 16:05

Cas No	Analyte	File ID	MDL	Concentration	Units	Q
142-28-9	1,3-Dichloropropane	C 584 -1966	0.21	0.21	ppb	U
591-78-6	2-Hexanone	C 584 -1966	0.94	0.94	ppb	U
124-48-1	Dibromochloromethane	C 584 -1966	0.13	0.13	ppb	U
106-93-4	1,2-Dibromoethane	C 584 -1966	0.17	0.17	ppb	U
108-90-7	Chlorobenzene	C 584 -1966	0.15	0.15	ppb	U
630-20-6	1,1,1,2-Tetrachloroethane	C 584 -1966	0.20	0.20	ppb	U
100-41-4	Ethylbenzene	C 584 -1966	0.22	0.22	ppb	U
108-38-3	m,p-xylene	C 584 -1966	0.34	0.34	ppb	U
95-47-6	o-xylene	C 584 -1966	0.25	0.25	ppb	U
100-42-5	Styrene	C 584 -1966	0.20	0.20	ppb	U
75-25-2	Bromoform	C 584 -1966	0.21	0.21	ppb	U
98-82-8	Isopropylbenzene	C 584 -1966	0.15	0.15	ppb	U
108-86-1	Bromobenzene	C 584 -1966	0.20	0.20	ppb	U
79-34-5	1,1,2,2-Tetrachloroethane	C 584 -1966	0.23	0.23	ppb	U
103-65-1	n-Propylbenzene	C 584 -1966	0.16	0.16	ppb	U
96-18-4	1,2,3-Trichloropropane	C 584 -1966	0.35	0.35	ppb	U
622-96-8	p-Ethyltoluene	C 584 -1966	0.16	0.16	ppb	U
108-67-8	1,3,5-Trimethylbenzene	C 584 -1966	0.20	0.20	ppb	U
95-49-8	2-Chlorotoluene	C 584 -1966	0.25	0.25	ppb	U
106-43-4	4-Chlorotoluene	C 584 -1966	0.22	0.22	ppb	U
98-06-6	tert-Butylbenzene	C 584 -1966	0.19	0.19	ppb	U
95-63-6	1,2,4-Trimethylbenzene	C 584 -1966	0.17	0.17	ppb	U
135-98-8	sec-Butylbenzene	C 584 -1966	0.22	0.22	ppb	U
99-87-6	4-Isopropyltoluene	C 584 -1966	0.17	0.17	ppb	U
541-73-1	1,3-Dichlorobenzene	C 584 -1966	0.17	0.17	ppb	U
106-46-7	1,4-Dichlorobenzene	C 584 -1966	0.10	0.10	ppb	U
95-50-1	1,2-Dichlorobenzene	C 584 -1966	0.11	0.11	ppb	U
105-05-5	p-Diethylbenzene	C 584 -1966	0.22	0.22	ppb	U
104-51-8	n-Butylbenzene	C 584 -1966	0.17	0.17	ppb	U
95-93-2	1,2,4,5-Tetramethylbenzene	C 584 -1966	0.50	0.50	ppb	U
96-12-8	1,2-Dibromo-3-chloropropane	C 584 -1966	0.42	0.42	ppb	U
120-82-1	1,2,4-Trichlorobenzene	C 584 -1966	0.13	0.13	ppb	U
87-68-3	Hexachlorobutadiene	C 584 -1966	0.45	0.45	ppb	U
91-20-3	Naphthalene	C 584 -1966	0.29	0.29	ppb	U
87-61-6	1,2,3-Trichlorobenzene	C 584 -1966	0.19	0.19	ppb	U



# Environmental Testing Laboratories, Inc.

208 Route 109, Farmingdale NY 11735  
Phone - 631-249-1456 Fax - 631-249-8344

07/09/2002

## Volatiles - EPA 8260B

**Sample: J8132-6...continue**

Client Sample ID: MW-101

Collected: 06/24/2002 16:05

Matrix: Liquid

Type: Grab

Remarks: See Case Narrative

Analyzed Date: 06/28/2002

Cas No	Surrogate	File ID	% Recovery	QC Limits	QC
460-00-4	4-BROMOFLUOROBENZENE	C584-1966	96.7 %	(76 - 110)	
4774-33-8	DIBROMOFLUOROMETHANE	C584-1966	94.2 %	(83 - 110)	
2037-26-5	TOLUENE-D8	C584-1966	101.0 %	(90 - 110)	



# Environmental Testing Laboratories, Inc.

208 Route 109, Farmingdale NY 11735

Phone - 631-249-1456 Fax - 631-249-8344

07/09/2002

## Volatiles - EPA 8260B

### Sample: J8132-7

Client Sample ID: Trip Blank

Matrix: Liquid

Remarks: See Case Narrative

Analyzed Date: 06/28/2002

Type: Blank

Collected: 06/24/2002

Cas No	Analyte	File ID	MDL	Concentration	Units	Q
75-71-8	Dichlorodifluoromethane	C 584 -1967	0.38	0.38	ppb	U
75-45-6	Chlorodifluoromethane	C 584 -1967	0.25	0.25	ppb	U
74-87-3	Chloromethane	C 584 -1967	0.32	0.32	ppb	U
75-01-4	Vinyl Chloride	C 584 -1967	0.23	0.23	ppb	U
74-83-9	Bromomethane	C 584 -1967	0.32	0.32	ppb	U
75-00-3	Chloroethane	C 584 -1967	0.24	0.24	ppb	U
75-69-4	Trichlorofluoromethane	C 584 -1967	0.27	0.27	ppb	U
76-13-1	1,1,2-Trichlorotrifluoroethane	C 584 -1967	0.36	0.36	ppb	U
75-35-4	1,1-Dichloroethene	C 584 -1967	0.27	0.27	ppb	U
67-64-1	Acetone	C 584 -1967	1.13	1.13	ppb	U
75-15-0	Carbon disulfide	C 584 -1967	0.19	0.19	ppb	U
75-09-2	Methylene Chloride	C 584 -1967	0.21	0.21	ppb	U
156-60-5	t-1,2-Dichloroethene	C 584 -1967	0.31	0.31	ppb	U
1634-04-4	Methyl t-butyl ether	C 584 -1967	0.18	0.18	ppb	U
75-34-3	1,1-Dichloroethane	C 584 -1967	0.30	0.30	ppb	U
590-20-7	2,2-Dichloropropane	C 584 -1967	0.27	0.27	ppb	U
156-59-2	c-1,2-Dichloroethene	C 584 -1967	0.24	0.24	ppb	U
78-93-3	2-Butanone	C 584 -1967	3.80	3.80	ppb	U
74-97-5	Bromochloromethane	C 584 -1967	0.25	0.25	ppb	U
67-66-3	Chloroform	C 584 -1967	0.26	0.26	ppb	U
71-55-6	1,1,1-Trichloroethane	C 584 -1967	0.26	0.26	ppb	U
56-23-5	Carbon Tetrachloride	C 584 -1967	0.22	0.22	ppb	U
563-58-6	1,1-Dichloropropene	C 584 -1967	0.39	0.39	ppb	U
71-43-2	Benzene	C 584 -1967	0.21	0.21	ppb	U
107-06-2	1,2-Dichloroethane	C 584 -1967	0.23	0.23	ppb	U
79-01-6	Trichloroethene	C 584 -1967	0.36	0.36	ppb	U
78-87-5	1,2-Dichloropropane	C 584 -1967	0.31	0.31	ppb	U
74-95-3	Dibromomethane	C 584 -1967	0.24	0.24	ppb	U
75-27-4	Bromodichloromethane	C 584 -1967	0.20	0.20	ppb	U
110-75-8	2-Chloroethylvinylether	C 584 -1967	0.33	0.33	ppb	U
10061-01-5	c-1,3-Dichloropropene	C 584 -1967	0.16	0.16	ppb	U
108-10-1	4-Methyl-2-pentanone	C 584 -1967	0.63	0.63	ppb	U
108-88-3	Toluene	C 584 -1967	0.20	0.20	ppb	U
10061-02-6	t-1,3-Dichloropropene	C 584 -1967	0.16	0.16	ppb	U
79-00-5	1,1,2-Trichloroethane	C 584 -1967	0.16	0.16	ppb	U
127-18-4	Tetrachloroethene	C 584 -1967	0.11	0.11	ppb	U





# Environmental Testing Laboratories, Inc.

208 Route 109, Farmingdale NY 11735

Phone - 631-249-1456 Fax - 631-249-8344

07/09/2002

## Volatiles - EPA 8260B

**Sample: J8132-7...continue**

Client Sample ID: Trip Blank

Matrix: Liquid

Remarks: See Case Narrative

Analyzed Date: 06/28/2002

Collected: 06/24/2002

Type: Blank

Cas No	Analyte	File ID	MDL	Concentration	Units	Q
142-28-9	1,3-Dichloropropane	C 584 -1967	0.21	0.21	ppb	U
591-78-6	2-Hexanone	C 584 -1967	0.94	0.94	ppb	U
124-48-1	Dibromochloromethane	C 584 -1967	0.13	0.13	ppb	U
106-93-4	1,2-Dibromoethane	C 584 -1967	0.17	0.17	ppb	U
108-90-7	Chlorobenzene	C 584 -1967	0.15	0.15	ppb	U
630-20-6	1,1,1,2-Tetrachloroethane	C 584 -1967	0.20	0.20	ppb	U
100-41-4	Ethylbenzene	C 584 -1967	0.22	0.22	ppb	U
108-38-3	m,p-xylene	C 584 -1967	0.34	0.34	ppb	U
95-47-6	o-xylene	C 584 -1967	0.25	0.25	ppb	U
100-42-5	Styrene	C 584 -1967	0.20	0.20	ppb	U
75-25-2	Bromoform	C 584 -1967	0.21	0.21	ppb	U
98-82-8	Isopropylbenzene	C 584 -1967	0.15	0.15	ppb	U
108-86-1	Bromobenzene	C 584 -1967	0.20	0.20	ppb	U
79-34-5	1,1,1,2-Tetrachloroethane	C 584 -1967	0.23	0.23	ppb	U
103-65-1	n-Propylbenzene	C 584 -1967	0.16	0.16	ppb	U
96-18-4	1,2,3-Trichloropropane	C 584 -1967	0.35	0.35	ppb	U
622-96-8	p-Ethyltoluene	C 584 -1967	0.16	0.16	ppb	U
108-67-8	1,3,5-Trimethylbenzene	C 584 -1967	0.20	0.20	ppb	U
95-49-8	2-Chlorotoluene	C 584 -1967	0.25	0.25	ppb	U
106-43-4	4-Chlorotoluene	C 584 -1967	0.22	0.22	ppb	U
98-06-6	tert-Butylbenzene	C 584 -1967	0.19	0.19	ppb	U
95-63-6	1,2,4-Trimethylbenzene	C 584 -1967	0.17	0.17	ppb	U
135-98-8	sec-Butylbenzene	C 584 -1967	0.22	0.22	ppb	U
99-87-6	4-Isopropyltoluene	C 584 -1967	0.17	0.17	ppb	U
541-73-1	1,3-Dichlorobenzene	C 584 -1967	0.17	0.17	ppb	U
106-46-7	1,4-Dichlorobenzene	C 584 -1967	0.10	0.10	ppb	U
95-50-1	1,2-Dichlorobenzene	C 584 -1967	0.11	0.11	ppb	U
105-05-5	p-Diethylbenzene	C 584 -1967	0.22	0.22	ppb	U
104-51-8	n-Butylbenzene	C 584 -1967	0.17	0.17	ppb	U
95-93-2	1,2,4,5-Tetramethylbenzene	C 584 -1967	0.50	0.50	ppb	U
96-12-8	1,2-Dibromo-3-chloropropane	C 584 -1967	0.42	0.42	ppb	U
120-82-1	1,2,4-Trichlorobenzene	C 584 -1967	0.13	0.13	ppb	U
87-68-3	Hexachlorobutadiene	C 584 -1967	0.45	0.45	ppb	U
91-20-3	Naphthalene	C 584 -1967	0.29	0.29	ppb	U
87-61-6	1,2,3-Trichlorobenzene	C 584 -1967	0.19	0.19	ppb	U





# Environmental Testing Laboratories, Inc.

208 Route 109, Farmingdale NY 11735  
Phone - 631-249-1456 Fax - 631-249-8344

07/09/2002

## Volatiles - EPA 8260B

**Sample: J8132-7...continue**

Client Sample ID: Trip Blank

Collected: 06/24/2002

Matrix: Liquid

Type: Blank

Remarks: See Case Narrative

Analyzed Date: 06/28/2002

Cas No	Surrogate	File ID	% Recovery	QC Limits
460-00-4	4-BROMOFLUOROBENZENE	C584-1967	97.1 %	(76 - 113)
4774-33-8	DIBROMOFLUOROMETHANE	C584-1967	93.5 %	(83 - 113)
2037-26-5	TOLUENE-D8	C584-1967	101.0 %	(90 - 110)



# Environmental Testing Laboratories, Inc.

208 Route 109, Farmingdale NY 11735

Phone - 631-249-1456 Fax - 631-249-8344

07/09/2002

## Dissolved Metals

### Sample: J8132-1

Client Sample ID: MW-109

Collected: 06/24/2002 09:15

Matrix: Liquid

Type: Grab

Remarks:

Analyzed Date: 06/27/2002

Cas No	Analyte	MDL	Concentration	Units	Q
7440-47-3	Chromium	0.0032	0.0056	ppm	
7440-50-8	Copper	0.0028	0.0028	ppm	U
7439-89-6	Iron	0.0098	0.37	ppm	
7439-96-5	Manganese	0.0020	0.93	ppm	
7440-02-0	Nickel	0.0010	0.0058	ppm	

### Sample: J8132-2

Client Sample ID: MW-110

Collected: 06/24/2002 10:25

Matrix: Liquid

Type: Grab

Remarks:

Analyzed Date: 06/27/2002

Cas No	Analyte	MDL	Concentration	Units	Q
7440-47-3	Chromium	0.0032	0.0047	ppm	
7440-50-8	Copper	0.0028	0.0028	ppm	U
7439-89-6	Iron	0.0098	0.038	ppm	
7439-96-5	Manganese	0.0020	8.16	ppm	
7440-02-0	Nickel	0.0010	0.0018	ppm	

### Sample: J8132-3

Client Sample ID: MW-111

Collected: 06/24/2002 11:40

Matrix: Liquid

Type: Grab

Remarks:

Analyzed Date: 06/27/2002

Cas No	Analyte	MDL	Concentration	Units	Q
7440-47-3	Chromium	0.0032	0.0032	ppm	U
7440-50-8	Copper	0.0028	0.0032	ppm	
7439-89-6	Iron	0.0098	0.041	ppm	
7439-96-5	Manganese	0.0020	3.35	ppm	
7440-02-0	Nickel	0.0010	0.0013	ppm	



# Environmental Testing Laboratories, Inc.

208 Route 109, Farmingdale NY 11735

Phone - 631-249-1456 Fax - 631-249-8344

07/09/2002

## Dissolved Metals

### Sample: J8132-4

Client Sample ID: MW-108

Collected: 06/24/2002 12:55

Matrix: Liquid

Type: Grab

Remarks:

Analyzed Date: 06/27/2002

Cas No	Analyte	MDL	Concentration	Units	Q
7440-47-3	Chromium	0.0032	0.0032	ppm	U
7440-50-8	Copper	0.0028	0.0029	ppm	
7439-89-6	Iron	0.0098	0.011	ppm	
7439-96-5	Manganese	0.0020	0.11	ppm	
7440-02-0	Nickel	0.0010	0.0011	ppm	

### Sample: J8132-5

Client Sample ID: MW-102

Collected: 06/24/2002 14:55

Matrix: Liquid

Type: Grab

Remarks:

Analyzed Date: 06/27/2002

Cas No	Analyte	MDL	Concentration	Units	Q
7440-47-3	Chromium	0.0032	0.0032	ppm	U
7440-50-8	Copper	0.0028	0.0038	ppm	
7439-89-6	Iron	0.0098	0.0098	ppm	U
7439-96-5	Manganese	0.0020	0.20	ppm	
7440-02-0	Nickel	0.0010	0.0017	ppm	

### Sample: J8132-6

Client Sample ID: MW-101

Collected: 06/24/2002 16:05

Matrix: Liquid

Type: Grab

Remarks:

Analyzed Date: 06/27/2002

Cas No	Analyte	MDL	Concentration	Units	Q
7440-47-3	Chromium	0.0032	0.0032	ppm	U
7440-50-8	Copper	0.0028	0.0028	ppm	U
7439-89-6	Iron	0.0098	10.2	ppm	
7439-96-5	Manganese	0.0020	0.78	ppm	
7440-02-0	Nickel	0.0010	0.0028	ppm	



# Environmental Testing Laboratories, Inc.

208 Route 109, Farmingdale NY 11735

Phone - 631-249-1456 Fax - 631-249-8344

07/09/2002

## Case Narrative

### VOLATILES:

The following compounds were calibrated at 25, 50, 100, 150 and 200 ppb levels in the initial calibration curve:

Acetone  
2-Butanone  
4-Methyl,2-pentanone  
2-Hexanone

M&P-Xylenes and 2-Chloro ethyl vinyl ether were calibrated at 10, 40, 100, 200 and 300 ppb levels.

All other compounds were calibrated at 5, 20, 50, 100 and 150 ppb levels.

Reviewed by: Patricia Werner-Els ✓



# Environmental Testing Laboratories, Inc.

208 Route 109, Farmingdale NY 11735

Phone - 631-249-1456 Fax - 631-249-8344

07/09/2002

## ORGANIC METHOD QUALIFIERS

Q - Qualifier - specified entries and their meanings are as follows:

- U - The analytical result is a non-detect.
- J - Indicates an estimated value. The concentration reported was detected below the Method Detection Limit.
- B - The analyte was found in the associated method blank as well as the sample. It indicates possible/probable blank contamination and warns the data user to take appropriate action.
- E - The concentration of the analyte exceeded the calibration range of the instrument.
- D - This flag identifies all compounds identified in an analysis at a secondary dilution. In the case of a surrogate this flag indicates a system monitoring compound diluted out.

## INORGANIC METHOD QUALIFIERS

C - (Concentration) qualifiers are as follows:

B - Entered if the reported value was obtained from a reading that was less than the Contract Required Detection Limit (CRDL) but greater than or equal to the Instrument Detection Limit (IDL).

U - Entered when the analyte was analyzed for, but not detected.

Q - Qualifier specific entries and their meanings are as follows:

E - Reported value is estimated because of the presence of interferences.

M - (Method) qualifiers are as follows:

- A - Flame AA
- AS - Semi-automated Spectrophotometric
- AV - Automated Cold Vapor AA
- C - Manual Spectrophotometric
- F - Furnace AA
- P - ICP
- T - Titrimetric

## OTHER QUALIFIERS

ND - Not Detected

NA - Not Applicable

NR - Not Required

\* - Outside Expected Range (NYCDEP Table I/II or Surrogate Limits)

## OTHER

- All soil and sediment samples are reported on a dry weight basis.



Environmental Testing Laboratories, Inc.  
 208 Route 109 • Farmingdale • New York 11735  
 516-249-1456 • Fax: 516-249-8344

J 8132

Project Name: <i>Active Industrial</i>		Project Manager: <i>W. K. ...</i>																	
Project Address: <i>Union Square, NY</i>		Sampler (Signature): <i>E. K. ...</i> (Print): <i>E. K. ...</i>																	
Client: <i>...</i> J/N: <i>...</i>		Rush by: <i>1/1</i>																	
SAMPLE INFO Type: SS = Soil Spoon, G = Grab, C = Composite, B = Blank Matrix: L = Liquid, S = Soil, SL = Sludge, A = Air, W = Wipe *Air - Vol (Liters) Include Flow (CFM)																			
ID	Date	Time	Type	Matrix	Sample Location	Total # Cont.	601/602	BTX/BTEX	MTBE	624/8260/8021	625/8270/BN	PCB/Pesticides	Pet. Prods./B100M	RCRA Metals	pH/Flash/React	418.1 - TRPH	Asbestos	Lead	Mercury
1		115	E	L	MW-109	3			2						1	*			
2		1025			MW-110	3			2						1	*			
3		1140			MW-111	3			2						1	*			
4		1255			MW-108	3			2						1	*			
5		1455			MW-102	3			2						1	*			
6		1605			MW-101	3			2						1	*			
7			-	-	TRIP BLANK	2			2										
8																			
9																			
10																			
11																			
12																			
13																			
14																			
15																			
Relinquished by (Signature): <i>[Signature]</i>		Date	Printed Name & Agent:		Received by (Signature): <i>[Signature]</i>		Date	Printed Name & Agent:											
Relinquished by (Signature): <i>[Signature]</i>		Date	Printed Name & Agent:		Received for Lab by (Signature): <i>[Signature]</i>		Date	Printed Name & Agent:											
Comments & Special Instructions		QA/QC Type:	Number & Type of Containers:		Preservatives:	Temp:													

# Environmental Testing Laboratories, Inc.

208 Route 109, Farmingdale NY 11735  
Phone - 631-249-1456 Fax - 631-249-8344

07/11/2002

**Custody Document: J8133**

Received: 06/26/2002 15:46  
Sampled by: Eric Killenbeck

**Client: Blue Waters (11260)**

1610 New Highway  
Farmingdale,  
NY 11735

**Project: Active Industrial**

67 West Montauk Hwy  
Lindenhurst,  
NY

**Manager: Mark Soliman**

Respectfully submitted,

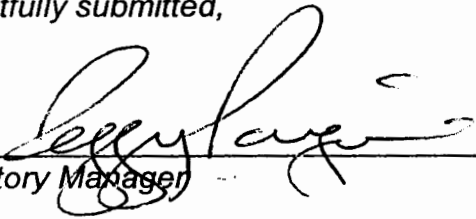
  
\_\_\_\_\_  
Laboratory Manager

NYS Lab ID # 10969  
NJ Cert. # 73812  
CT Cert. # PH0645  
MA Cert. # NY061  
PA Cert. # 68-535  
NH Cert. # 252592-BA  
RI Cert. # 161

The information contained in this report is confidential and intended only for the use of the client listed above. This report shall not be reproduced, except in full, without the written consent of Environmental Testing Laboratories, Inc.



# Environmental Testing Laboratories, Inc.

208 Route 109, Farmingdale NY 11735  
Phone - 631-249-1456 Fax - 631-249-8344

07/09/2002

## Volatiles - EPA 8260B

**Sample: J8133-1**

Client Sample ID: MW-105

Collected: 06/25/2002 07:40

Matrix: Liquid

Type: Grab

Remarks: See Case Narrative

Analyzed Date: 07/01/2002

Cas No	Analyte	File ID	MDL	Concentration	Units	Q
75-71-8	Dichlorodifluoromethane	B 824 -3479	0.94	0.94	ppb	U
75-45-6	Chlorodifluoromethane	B 824 -3479	0.50	0.50	ppb	U
74-87-3	Chloromethane	B 824 -3479	0.56	0.56	ppb	U
75-01-4	Vinyl Chloride	B 824 -3479	0.51	0.51	ppb	U
74-83-9	Bromomethane	B 824 -3479	0.93	0.93	ppb	U
75-00-3	Chloroethane	B 824 -3479	0.49	0.49	ppb	U
75-69-4	Trichlorofluoromethane	B 824 -3479	0.59	0.59	ppb	U
76-13-1	1,1,2-Trichlorotrifluoroethane	B 824 -3479	0.52	0.52	ppb	U
75-35-4	1,1-Dichloroethene	B 824 -3479	0.63	0.63	ppb	U
67-64-1	Acetone	B 824 -3479	11.3	11.3	ppb	U
75-15-0	Carbon disulfide	B 824 -3479	0.54	0.54	ppb	U
75-09-2	Methylene Chloride	B 824 -3479	0.63	0.63	ppb	U
156-60-5	t-1,2-Dichloroethene	B 824 -3479	0.46	0.46	ppb	U
1634-04-4	Methyl t-butyl ether	B 824 -3479	0.58	0.58	ppb	U
75-34-3	1,1-Dichloroethane	B 824 -3479	0.43	0.43	ppb	U
590-20-7	2,2-Dichloropropane	B 824 -3479	0.82	0.82	ppb	U
156-59-2	c-1,2-Dichloroethene	B 824 -3479	0.42	2.40	ppb	
78-93-3	2-Butanone	B 824 -3479	16.5	16.5	ppb	U
74-97-5	Bromochloromethane	B 824 -3479	0.50	0.50	ppb	U
67-66-3	Chloroform	B 824 -3479	0.70	0.70	ppb	U
71-55-6	1,1,1-Trichloroethane	B 824 -3479	0.35	0.35	ppb	U
56-23-5	Carbon Tetrachloride	B 824 -3479	0.52	0.52	ppb	U
563-58-6	1,1-Dichloropropene	B 824 -3479	0.47	0.47	ppb	U
71-43-2	Benzene	B 824 -3479	0.40	0.40	ppb	U
107-06-2	1,2-Dichloroethane	B 824 -3479	0.23	0.23	ppb	U
79-01-6	Trichloroethene	B 824 -3479	0.46	1.40	ppb	
78-87-5	1,2-Dichloropropane	B 824 -3479	0.27	0.27	ppb	U
74-95-3	Dibromomethane	B 824 -3479	0.20	0.20	ppb	U
75-27-4	Bromodichloromethane	B 824 -3479	0.25	0.25	ppb	U
110-75-8	2-Chloroethylvinylether	B 824 -3479	1.04	1.04	ppb	U
10061-01-5	c-1,3-Dichloropropene	B 824 -3479	0.40	0.40	ppb	U
108-10-1	4-Methyl-2-pentanone	B 824 -3479	3.08	3.08	ppb	U
108-88-3	Toluene	B 824 -3479	0.38	0.38	ppb	U
10061-02-6	t-1,3-Dichloropropene	B 824 -3479	0.28	0.28	ppb	U
79-00-5	1,1,2-Trichloroethane	B 824 -3479	0.51	0.51	ppb	U
127-18-4	Tetrachloroethene	B 824 -3479	0.62	37.1	ppb	





# Environmental Testing Laboratories, Inc.

208 Route 109, Farmingdale NY 11735

Phone - 631-249-1456 Fax - 631-249-8344

07/09/2002

## Volatiles - EPA 8260B

**Sample:** J8133-1...continue

Client Sample ID: MW-105

Collected: 06/25/2002 07:40

Matrix: Liquid

Type: Grab

Remarks: See Case Narrative

Analyzed Date: 07/01/2002

Cas No	Analyte	File ID	MDL	Concentration	Units	Q
142-28-9	1,3-Dichloropropane	B 824 -3479	0.26	0.26	ppb	U
591-78-6	2-Hexanone	B 824 -3479	1.65	1.65	ppb	U
124-48-1	Dibromochloromethane	B 824 -3479	0.25	0.25	ppb	U
106-93-4	1,2-Dibromoethane	B 824 -3479	0.23	0.23	ppb	U
108-90-7	Chlorobenzene	B 824 -3479	0.42	0.42	ppb	U
630-20-6	1,1,1,2-Tetrachloroethane	B 824 -3479	0.34	0.34	ppb	U
100-41-4	Ethylbenzene	B 824 -3479	0.53	0.53	ppb	U
108-38-3	m,p-xylene	B 824 -3479	0.76	0.76	ppb	U
95-47-6	o-xylene	B 824 -3479	0.33	0.33	ppb	U
100-42-5	Styrene	B 824 -3479	0.40	0.40	ppb	U
75-25-2	Bromoform	B 824 -3479	0.26	0.26	ppb	U
98-82-8	Isopropylbenzene	B 824 -3479	0.43	0.43	ppb	U
108-86-1	Bromobenzene	B 824 -3479	0.47	0.47	ppb	U
79-34-5	1,1,2,2-Tetrachloroethane	B 824 -3479	0.58	0.58	ppb	U
103-65-1	n-Propylbenzene	B 824 -3479	0.62	0.62	ppb	U
96-18-4	1,2,3-Trichloropropane	B 824 -3479	0.47	0.47	ppb	U
622-96-8	p-Ethyltoluene	B 824 -3479	0.62	0.62	ppb	U
108-67-8	1,3,5-Trimethylbenzene	B 824 -3479	0.57	0.57	ppb	U
95-49-8	2-Chlorotoluene	B 824 -3479	0.38	0.38	ppb	U
106-43-4	4-Chlorotoluene	B 824 -3479	0.55	0.55	ppb	U
98-06-6	tert-Butylbenzene	B 824 -3479	0.55	0.55	ppb	U
95-63-6	1,2,4-Trimethylbenzene	B 824 -3479	0.60	0.60	ppb	U
135-98-8	sec-Butylbenzene	B 824 -3479	0.61	0.61	ppb	U
99-87-6	4-Isopropyltoluene	B 824 -3479	0.67	0.67	ppb	U
541-73-1	1,3-Dichlorobenzene	B 824 -3479	0.53	0.53	ppb	U
106-46-7	1,4-Dichlorobenzene	B 824 -3479	0.51	0.51	ppb	U
95-50-1	1,2-Dichlorobenzene	B 824 -3479	0.45	0.45	ppb	U
105-05-5	p-Diethylbenzene	B 824 -3479	0.69	0.69	ppb	U
104-51-8	n-Butylbenzene	B 824 -3479	0.73	0.73	ppb	U
95-93-2	1,2,4,5-Tetramethylbenzene	B 824 -3479	0.86	0.86	ppb	U
96-12-8	1,2-Dibromo-3-chloropropane	B 824 -3479	0.46	0.46	ppb	U
120-82-1	1,2,4-Trichlorobenzene	B 824 -3479	0.70	0.70	ppb	U
87-68-3	Hexachlorobutadiene	B 824 -3479	2.95	2.95	ppb	U
91-20-3	Naphthalene	B 824 -3479	0.94	0.94	ppb	U
87-61-6	1,2,3-Trichlorobenzene	B 824 -3479	0.61	0.61	ppb	U



# Environmental Testing Laboratories, Inc.

208 Route 109, Farmingdale NY 11735

Phone - 631-249-1456 Fax - 631-249-8344

07/09/2002

## Volatiles - EPA 8260B

**Sample:** J8133-1...continue

Client Sample ID: MW-105

Matrix: Liquid

Remarks: See Case Narrative

Analyzed Date: 07/01/2002

Type: Grab

Collected: 06/25/2002 07:40

Cas No	Surrogate	File ID	% Recovery	QC Limits
460-00-4	4-BROMOFLUOROBENZENE	B824-3479	102.0 %	(78-112)
4774-33-8	DIBROMOFLUOROMETHANE	B824-3479	96.0 %	(65-112)
2037-26-5	TOLUENE-D8	B824-3479	99.2 %	(86-110)



# Environmental Testing Laboratories, Inc.

208 Route 109, Farmingdale NY 11735  
Phone - 631-249-1456 Fax - 631-249-8344

07/09/2002

## Volatiles - EPA 8260B

**Sample: J8133-2**

Client Sample ID: Field Blank

Collected: 06/25/2002 07:50

Matrix: Liquid

Type: Blank

Remarks: See Case Narrative

Analyzed Date: 07/01/2002

Cas No	Analyte	File ID	MDL	Concentration	Units	Q
75-71-8	Dichlorodifluoromethane	B 824 -3481	0.94	0.94	ppb	U
75-45-6	Chlorodifluoromethane	B 824 -3481	0.50	0.50	ppb	U
74-87-3	Chloromethane	B 824 -3481	0.56	0.56	ppb	U
75-01-4	Vinyl Chloride	B 824 -3481	0.51	0.51	ppb	U
74-83-9	Bromomethane	B 824 -3481	0.93	0.93	ppb	U
75-00-3	Chloroethane	B 824 -3481	0.49	0.49	ppb	U
75-69-4	Trichlorofluoromethane	B 824 -3481	0.59	0.59	ppb	U
76-13-1	1,1,2-Trichlorotrifluoroethane	B 824 -3481	0.52	0.52	ppb	U
75-35-4	1,1-Dichloroethene	B 824 -3481	0.63	0.63	ppb	U
67-64-1	Acetone	B 824 -3481	11.3	11.3	ppb	U
75-15-0	Carbon disulfide	B 824 -3481	0.54	0.54	ppb	U
75-09-2	Methylene Chloride	B 824 -3481	0.63	0.63	ppb	U
156-60-5	t-1,2-Dichloroethene	B 824 -3481	0.46	0.46	ppb	U
1634-04-4	Methyl t-butyl ether	B 824 -3481	0.58	0.58	ppb	U
75-34-3	1,1-Dichloroethane	B 824 -3481	0.43	0.43	ppb	U
590-20-7	2,2-Dichloropropane	B 824 -3481	0.82	0.82	ppb	U
156-59-2	c-1,2-Dichloroethene	B 824 -3481	0.42	0.42	ppb	U
78-93-3	2-Butanone	B 824 -3481	16.5	16.5	ppb	U
74-97-5	Bromochloromethane	B 824 -3481	0.50	0.50	ppb	U
67-66-3	Chloroform	B 824 -3481	0.70	0.70	ppb	U
71-55-6	1,1,1-Trichloroethane	B 824 -3481	0.35	0.35	ppb	U
56-23-5	Carbon Tetrachloride	B 824 -3481	0.52	0.52	ppb	U
563-58-6	1,1-Dichloropropene	B 824 -3481	0.47	0.47	ppb	U
71-43-2	Benzene	B 824 -3481	0.40	0.40	ppb	U
107-06-2	1,2-Dichloroethane	B 824 -3481	0.23	0.23	ppb	U
79-01-6	Trichloroethene	B 824 -3481	0.46	0.46	ppb	U
78-87-5	1,2-Dichloropropane	B 824 -3481	0.27	0.27	ppb	U
74-95-3	Dibromomethane	B 824 -3481	0.20	0.20	ppb	U
75-27-4	Bromodichloromethane	B 824 -3481	0.25	0.25	ppb	U
110-75-8	2-Chloroethylvinylether	B 824 -3481	1.04	1.04	ppb	U
10061-01-5	c-1,3-Dichloropropene	B 824 -3481	0.40	0.40	ppb	U
108-10-1	4-Methyl-2-pentanone	B 824 -3481	3.08	3.08	ppb	U
108-88-3	Toluene	B 824 -3481	0.38	0.38	ppb	U
10061-02-6	t-1,3-Dichloropropene	B 824 -3481	0.28	0.28	ppb	U
79-00-5	1,1,2-Trichloroethane	B 824 -3481	0.51	0.51	ppb	U
127-18-4	Tetrachloroethene	B 824 -3481	0.62	0.62	ppb	U



# Environmental Testing Laboratories, Inc.

208 Route 109, Farmingdale NY 11735  
Phone - 631-249-1456 Fax - 631-249-8344

07/09/2002

## Volatiles - EPA 8260B

Sample: J8133-2...continue

Client Sample ID: Field Blank

Matrix: Liquid

Type: Blank

Collected: 06/25/2002 07:50

Remarks: See Case Narrative

Analyzed Date: 07/01/2002

Cas No	Analyte	File ID	MDL	Concentration	Units	Q
142-28-9	1,3-Dichloropropane	B 824 -3481	0.26	0.26	ppb	U
591-78-6	2-Hexanone	B 824 -3481	1.65	1.65	ppb	U
124-48-1	Dibromochloromethane	B 824 -3481	0.25	0.25	ppb	U
106-93-4	1,2-Dibromoethane	B 824 -3481	0.23	0.23	ppb	U
108-90-7	Chlorobenzene	B 824 -3481	0.42	0.42	ppb	U
630-20-6	1,1,1,2-Tetrachloroethane	B 824 -3481	0.34	0.34	ppb	U
100-41-4	Ethylbenzene	B 824 -3481	0.53	0.53	ppb	U
108-38-3	m,p-xylene	B 824 -3481	0.76	0.76	ppb	U
95-47-6	o-xylene	B 824 -3481	0.33	0.33	ppb	U
100-42-5	Styrene	B 824 -3481	0.40	0.40	ppb	U
75-25-2	Bromoform	B 824 -3481	0.26	0.26	ppb	U
98-82-8	Isopropylbenzene	B 824 -3481	0.43	0.43	ppb	U
108-86-1	Bromobenzene	B 824 -3481	0.47	0.47	ppb	U
79-34-5	1,1,2,2-Tetrachloroethane	B 824 -3481	0.58	0.58	ppb	U
103-65-1	n-Propylbenzene	B 824 -3481	0.62	0.62	ppb	U
96-18-4	1,2,3-Trichloropropane	B 824 -3481	0.47	0.47	ppb	U
622-96-8	p-Ethyltoluene	B 824 -3481	0.62	0.62	ppb	U
108-67-8	1,3,5-Trimethylbenzene	B 824 -3481	0.57	0.57	ppb	U
95-49-8	2-Chlorotoluene	B 824 -3481	0.38	0.38	ppb	U
106-43-4	4-Chlorotoluene	B 824 -3481	0.55	0.55	ppb	U
98-06-6	tert-Butylbenzene	B 824 -3481	0.55	0.55	ppb	U
95-63-6	1,2,4-Trimethylbenzene	B 824 -3481	0.60	0.60	ppb	U
135-98-8	sec-Butylbenzene	B 824 -3481	0.61	0.61	ppb	U
99-87-6	4-Isopropyltoluene	B 824 -3481	0.67	0.67	ppb	U
541-73-1	1,3-Dichlorobenzene	B 824 -3481	0.53	0.53	ppb	U
106-46-7	1,4-Dichlorobenzene	B 824 -3481	0.51	0.51	ppb	U
95-50-1	1,2-Dichlorobenzene	B 824 -3481	0.45	0.45	ppb	U
105-05-5	p-Diethylbenzene	B 824 -3481	0.69	0.69	ppb	U
104-51-8	n-Butylbenzene	B 824 -3481	0.73	0.73	ppb	U
95-93-2	1,2,4,5-Tetramethylbenzene	B 824 -3481	0.86	0.86	ppb	U
96-12-8	1,2-Dibromo-3-chloropropane	B 824 -3481	0.46	0.46	ppb	U
120-82-1	1,2,4-Trichlorobenzene	B 824 -3481	0.70	0.70	ppb	U
87-68-3	Hexachlorobutadiene	B 824 -3481	2.95	2.95	ppb	U
91-20-3	Naphthalene	B 824 -3481	0.94	0.94	ppb	U
87-61-6	1,2,3-Trichlorobenzene	B 824 -3481	0.61	0.61	ppb	U



# Environmental Testing Laboratories, Inc.

208 Route 109, Farmingdale NY 11735

Phone - 631-249-1456 Fax - 631-249-8344

07/09/2002

## Volatiles - EPA 8260B

**Sample: J8133-2...continue**

Client Sample ID: Field Blank

Matrix: Liquid

Remarks: See Case Narrative

Analyzed Date: 07/01/2002

Type: Blank

Collected: 06/25/2002 07:50

Cas No	Surrogate	File ID	% Recovery	QC Limits	Q
460-00-4	4-BROMOFLUOROBENZENE	B824-3481	102.0 %	( 78 - 12 )	
4774-33-8	DIBROMOFLUOROMETHANE	B824-3481	96.9 %	( 65 - 17 )	
2037-26-5	TOLUENE-D8	B824-3481	99.6 %	( 86 - 10 )	



# Environmental Testing Laboratories, Inc.

208 Route 109, Farmingdale NY 11735

Phone - 631-249-1456 Fax - 631-249-8344

07/09/2002

## Volatiles - EPA 8260B

### Sample: J8133-3

Client Sample ID: MW-103

Collected: 06/25/2002 08:50

Matrix: Liquid

Type: Grab

Remarks: See Case Narrative

Analyzed Date: 07/01/2002

Cas No	Analyte	File ID	MDL	Concentration	Units	Q
75-71-8	Dichlorodifluoromethane	B 824 -3482	0.94	0.94	ppb	U
75-45-6	Chlorodifluoromethane	B 824 -3482	0.50	0.50	ppb	U
74-87-3	Chloromethane	B 824 -3482	0.56	0.56	ppb	U
75-01-4	Vinyl Chloride	B 824 -3482	0.51	0.51	ppb	U
74-83-9	Bromomethane	B 824 -3482	0.93	0.93	ppb	U
75-00-3	Chloroethane	B 824 -3482	0.49	0.49	ppb	U
75-69-4	Trichlorofluoromethane	B 824 -3482	0.59	0.59	ppb	U
76-13-1	1,1,2-Trichlorotrifluoroethane	B 824 -3482	0.52	0.52	ppb	U
75-35-4	1,1-Dichloroethene	B 824 -3482	0.63	0.63	ppb	U
67-64-1	Acetone	B 824 -3482	11.3	11.3	ppb	U
75-15-0	Carbon disulfide	B 824 -3482	0.54	0.54	ppb	U
75-09-2	Methylene Chloride	B 824 -3482	0.63	0.63	ppb	U
156-60-5	t-1,2-Dichloroethene	B 824 -3482	0.46	0.46	ppb	U
1634-04-4	Methyl t-butyl ether	B 824 -3482	0.58	0.58	ppb	U
75-34-3	1,1-Dichloroethane	B 824 -3482	0.43	0.43	ppb	U
590-20-7	2,2-Dichloropropane	B 824 -3482	0.82	0.82	ppb	U
156-59-2	c-1,2-Dichloroethene	B 824 -3482	0.42	0.42	ppb	U
78-93-3	2-Butanone	B 824 -3482	16.5	16.5	ppb	U
74-97-5	Bromochloromethane	B 824 -3482	0.50	0.50	ppb	U
67-66-3	Chloroform	B 824 -3482	0.70	0.70	ppb	U
71-55-6	1,1,1-Trichloroethane	B 824 -3482	0.35	0.35	ppb	U
56-23-5	Carbon Tetrachloride	B 824 -3482	0.52	0.52	ppb	U
563-58-6	1,1-Dichloropropene	B 824 -3482	0.47	0.47	ppb	U
71-43-2	Benzene	B 824 -3482	0.40	0.40	ppb	U
107-06-2	1,2-Dichloroethane	B 824 -3482	0.23	0.23	ppb	U
79-01-6	Trichloroethene	B 824 -3482	0.46	0.46	ppb	U
78-87-5	1,2-Dichloropropane	B 824 -3482	0.27	0.27	ppb	U
74-95-3	Dibromomethane	B 824 -3482	0.20	0.20	ppb	U
75-27-4	Bromodichloromethane	B 824 -3482	0.25	0.25	ppb	U
110-75-8	2-Chloroethylvinylether	B 824 -3482	1.04	1.04	ppb	U
10061-01-5	c-1,3-Dichloropropene	B 824 -3482	0.40	0.40	ppb	U
108-10-1	4-Methyl-2-pentanone	B 824 -3482	3.08	3.08	ppb	U
108-88-3	Toluene	B 824 -3482	0.38	0.38	ppb	U
10061-02-6	t-1,3-Dichloropropene	B 824 -3482	0.28	0.28	ppb	U
79-00-5	1,1,2-Trichloroethane	B 824 -3482	0.51	0.51	ppb	U
127-18-4	Tetrachloroethene	B 824 -3482	0.62	21.3	ppb	



# Environmental Testing Laboratories, Inc.

208 Route 109, Farmingdale NY 11735

Phone - 631-249-1456 Fax - 631-249-8344

07/09/2002

## Volatiles - EPA 8260B

**Sample: J8133-3...continue**

Client Sample ID: MW-103

Collected: 06/25/2002 08:50

Matrix: Liquid

Type: Grab

Remarks: See Case Narrative

Analyzed Date: 07/01/2002

Cas No	Analyte	File ID	MDL	Concentration	Units	Q
142-28-9	1,3-Dichloropropane	B 824 -3482	0.26	0.26	ppb	U
591-78-6	2-Hexanone	B 824 -3482	1.65	1.65	ppb	U
124-48-1	Dibromochloromethane	B 824 -3482	0.25	0.25	ppb	U
106-93-4	1,2-Dibromoethane	B 824 -3482	0.23	0.23	ppb	U
108-90-7	Chlorobenzene	B 824 -3482	0.42	0.42	ppb	U
630-20-6	1,1,1,2-Tetrachloroethane	B 824 -3482	0.34	0.34	ppb	U
100-41-4	Ethylbenzene	B 824 -3482	0.53	4.50	ppb	
108-38-3	m,p-xylene	B 824 -3482	0.76	4.10	ppb	
95-47-6	o-xylene	B 824 -3482	0.33	6.80	ppb	
100-42-5	Styrene	B 824 -3482	0.40	0.40	ppb	U
75-25-2	Bromoform	B 824 -3482	0.26	0.26	ppb	U
98-82-8	Isopropylbenzene	B 824 -3482	0.43	6.30	ppb	
108-86-1	Bromobenzene	B 824 -3482	0.47	0.47	ppb	U
79-34-5	1,1,2,2-Tetrachloroethane	B 824 -3482	0.58	0.58	ppb	U
103-65-1	n-Propylbenzene	B 824 -3482	0.62	12.4	ppb	
96-18-4	1,2,3-Trichloropropane	B 824 -3482	0.47	0.47	ppb	U
622-96-8	p-Ethyltoluene	B 824 -3482	0.62	52.2	ppb	
108-67-8	1,3,5-Trimethylbenzene	B 824 -3482	0.57	16.8	ppb	
95-49-8	2-Chlorotoluene	B 824 -3482	0.38	0.38	ppb	U
106-43-4	4-Chlorotoluene	B 824 -3482	0.55	0.55	ppb	U
98-06-6	tert-Butylbenzene	B 824 -3482	0.55	0.55	ppb	U
95-63-6	1,2,4-Trimethylbenzene	B 824 -3482	0.60	96.9	ppb	
135-98-8	sec-Butylbenzene	B 824 -3482	0.61	0.61	ppb	U
99-87-6	4-Isopropyltoluene	B 824 -3482	0.67	0.67	ppb	U
541-73-1	1,3-Dichlorobenzene	B 824 -3482	0.53	0.53	ppb	U
106-46-7	1,4-Dichlorobenzene	B 824 -3482	0.51	0.97	ppb	
95-50-1	1,2-Dichlorobenzene	B 824 -3482	0.45	5.80	ppb	
105-05-5	p-Diethylbenzene	B 824 -3482	0.69	0.69	ppb	U
104-51-8	n-Butylbenzene	B 824 -3482	0.73	0.67	ppb	J
95-93-2	1,2,4,5-Tetramethylbenzene	B 824 -3482	0.86	1.10	ppb	
96-12-8	1,2-Dibromo-3-chloropropane	B 824 -3482	0.46	0.46	ppb	U
120-82-1	1,2,4-Trichlorobenzene	B 824 -3482	0.70	0.70	ppb	U
87-68-3	Hexachlorobutadiene	B 824 -3482	2.95	2.95	ppb	U
91-20-3	Naphthalene	B 824 -3482	0.94	24.9	ppb	
87-61-6	1,2,3-Trichlorobenzene	B 824 -3482	0.61	0.61	ppb	U



# Environmental Testing Laboratories, Inc.

208 Route 109, Farmingdale NY 11735  
Phone - 631-249-1456 Fax - 631-249-8344

07/09/2002

## Volatiles - EPA 8260B

**Sample: J8133-3...continue**

Client Sample ID: MW-103

Collected: 06/25/2002 08:50

Matrix: Liquid

Type: Grab

Remarks: See Case Narrative

Analyzed Date: 07/01/2002

Cas No	Surrogate	File ID	% Recovery	QC Limits	Q
460-00-4	4-BROMOFLUOROBENZENE	B824-3482	102.0 %	(78 - 12)	
4774-33-8	DIBROMOFLUOROMETHANE	B824-3482	96.2 %	(65 - 10)	
2037-26-5	TOLUENE-D8	B824-3482	99.4 %	(86 - 10)	





# Environmental Testing Laboratories, Inc.

208 Route 109, Farmingdale NY 11735  
Phone - 631-249-1456 Fax - 631-249-8344

07/09/2002

## Volatiles - EPA 8260B

**Sample: J8133-4**

Client Sample ID: MW-104

Collected: 06/25/2002 10:20

Matrix: Liquid

Type: Grab

Remarks: See Case Narrative

Analyzed Date: 07/01/2002

Cas No	Analyte	File ID	MDL	Concentration	Units	Q
75-71-8	Dichlorodifluoromethane	B 824 -3483	0.94	0.94	ppb	U
75-45-6	Chlorodifluoromethane	B 824 -3483	0.50	0.50	ppb	U
74-87-3	Chloromethane	B 824 -3483	0.56	0.56	ppb	U
75-01-4	Vinyl Chloride	B 824 -3483	0.51	0.51	ppb	U
74-83-9	Bromomethane	B 824 -3483	0.93	0.93	ppb	U
75-00-3	Chloroethane	B 824 -3483	0.49	0.49	ppb	U
75-69-4	Trichlorofluoromethane	B 824 -3483	0.59	0.59	ppb	U
76-13-1	1,1,2-Trichlorotrifluoroethane	B 824 -3483	0.52	0.52	ppb	U
75-35-4	1,1-Dichloroethene	B 824 -3483	0.63	0.63	ppb	U
67-64-1	Acetone	B 824 -3483	11.3	11.3	ppb	U
75-15-0	Carbon disulfide	B 824 -3483	0.54	0.54	ppb	U
75-09-2	Methylene Chloride	B 824 -3483	0.63	0.63	ppb	U
156-60-5	t-1,2-Dichloroethene	B 824 -3483	0.46	0.46	ppb	U
1634-04-4	Methyl t-butyl ether	B 824 -3483	0.58	0.58	ppb	U
75-34-3	1,1-Dichloroethane	B 824 -3483	0.43	0.43	ppb	U
590-20-7	2,2-Dichloropropane	B 824 -3483	0.82	0.82	ppb	U
156-59-2	c-1,2-Dichloroethene	B 824 -3483	0.42	2.00	ppb	
78-93-3	2-Butanone	B 824 -3483	16.5	16.5	ppb	U
74-97-5	Bromochloromethane	B 824 -3483	0.50	0.50	ppb	U
67-66-3	Chloroform	B 824 -3483	0.70	0.70	ppb	U
71-55-6	1,1,1-Trichloroethane	B 824 -3483	0.35	0.35	ppb	U
56-23-5	Carbon Tetrachloride	B 824 -3483	0.52	0.52	ppb	U
563-58-6	1,1-Dichloropropene	B 824 -3483	0.47	0.47	ppb	U
71-43-2	Benzene	B 824 -3483	0.40	0.40	ppb	U
107-06-2	1,2-Dichloroethane	B 824 -3483	0.23	0.23	ppb	U
79-01-6	Trichloroethene	B 824 -3483	0.46	19.3	ppb	
78-87-5	1,2-Dichloropropane	B 824 -3483	0.27	0.27	ppb	U
74-95-3	Dibromomethane	B 824 -3483	0.20	0.20	ppb	U
75-27-4	Bromodichloromethane	B 824 -3483	0.25	0.25	ppb	U
110-75-8	2-Chloroethylvinylether	B 824 -3483	1.04	1.04	ppb	U
10061-01-5	c-1,3-Dichloropropene	B 824 -3483	0.40	0.40	ppb	U
108-10-1	4-Methyl-2-pentanone	B 824 -3483	3.08	3.08	ppb	U
108-88-3	Toluene	B 824 -3483	0.38	0.38	ppb	U
10061-02-6	t-1,3-Dichloropropene	B 824 -3483	0.28	0.28	ppb	U
79-00-5	1,1,2-Trichloroethane	B 824 -3483	0.51	0.51	ppb	U
127-18-4	Tetrachloroethene	B 826 -3519	12.4	844	ppb	



# Environmental Testing Laboratories, Inc.

208 Route 109, Farmingdale NY 11735  
Phone - 631-249-1456 Fax - 631-249-8344

07/09/2002

## Volatiles - EPA 8260B

**Sample: J8133-4...continue**

Client Sample ID: MW-104

Collected: 06/25/2002 10:20

Matrix: Liquid

Type: Grab

Remarks: See Case Narrative

Analyzed Date: 07/01/2002

Cas No	Analyte	File ID	MDL	Concentration	Units	Q
142-28-9	1,3-Dichloropropane	B 824 -3483	0.26	0.26	ppb	U
591-78-6	2-Hexanone	B 824 -3483	1.65	1.65	ppb	U
124-48-1	Dibromochloromethane	B 824 -3483	0.25	0.25	ppb	U
106-93-4	1,2-Dibromoethane	B 824 -3483	0.23	0.23	ppb	U
108-90-7	Chlorobenzene	B 824 -3483	0.42	0.42	ppb	U
630-20-6	1,1,1,2-Tetrachloroethane	B 824 -3483	0.34	0.34	ppb	U
100-41-4	Ethylbenzene	B 824 -3483	0.53	0.53	ppb	U
108-38-3	m,p-xylene	B 824 -3483	0.76	0.76	ppb	U
95-47-6	o-xylene	B 824 -3483	0.33	0.33	ppb	U
100-42-5	Styrene	B 824 -3483	0.40	0.40	ppb	U
75-25-2	Bromoform	B 824 -3483	0.26	0.26	ppb	U
98-82-8	Isopropylbenzene	B 824 -3483	0.43	0.43	ppb	U
108-86-1	Bromobenzene	B 824 -3483	0.47	0.47	ppb	U
79-34-5	1,1,2,2-Tetrachloroethane	B 824 -3483	0.58	0.58	ppb	U
103-65-1	n-Propylbenzene	B 824 -3483	0.62	0.62	ppb	U
96-18-4	1,2,3-Trichloropropane	B 824 -3483	0.47	0.47	ppb	U
622-96-8	p-Ethyltoluene	B 824 -3483	0.62	0.62	ppb	U
108-67-8	1,3,5-Trimethylbenzene	B 824 -3483	0.57	0.57	ppb	U
95-49-8	2-Chlorotoluene	B 824 -3483	0.38	0.38	ppb	U
106-43-4	4-Chlorotoluene	B 824 -3483	0.55	0.55	ppb	U
98-06-6	tert-Butylbenzene	B 824 -3483	0.55	0.55	ppb	U
95-63-6	1,2,4-Trimethylbenzene	B 824 -3483	0.60	0.60	ppb	U
135-98-8	sec-Butylbenzene	B 824 -3483	0.61	0.61	ppb	U
99-87-6	4-Isopropyltoluene	B 824 -3483	0.67	0.67	ppb	U
541-73-1	1,3-Dichlorobenzene	B 824 -3483	0.53	0.53	ppb	U
106-46-7	1,4-Dichlorobenzene	B 824 -3483	0.51	0.51	ppb	U
95-50-1	1,2-Dichlorobenzene	B 824 -3483	0.45	0.45	ppb	U
105-05-5	p-Diethylbenzene	B 824 -3483	0.69	0.69	ppb	U
104-51-8	n-Butylbenzene	B 824 -3483	0.73	0.73	ppb	U
95-93-2	1,2,4,5-Tetramethylbenzene	B 824 -3483	0.86	0.86	ppb	U
96-12-8	1,2-Dibromo-3-chloropropane	B 824 -3483	0.46	0.46	ppb	U
120-82-1	1,2,4-Trichlorobenzene	B 824 -3483	0.70	0.70	ppb	U
87-68-3	Hexachlorobutadiene	B 824 -3483	2.95	2.95	ppb	U
91-20-3	Naphthalene	B 824 -3483	0.94	0.94	ppb	U
87-61-6	1,2,3-Trichlorobenzene	B 824 -3483	0.61	0.61	ppb	U



# Environmental Testing Laboratories, Inc.

208 Route 109, Farmingdale NY 11735  
Phone - 631-249-1456 Fax - 631-249-8344

07/09/2002

## Volatiles - EPA 8260B

**Sample: J8133-4...continue**

Client Sample ID: MW-104

Collected: 06/25/2002 10:20

Matrix: Liquid

Type: Grab

Remarks: See Case Narrative

Analyzed Date: 07/01/2002

Cas No	Surrogate	File ID	% Recovery	QC Limits
460-00-4	4-BROMOFLUOROBENZENE	B824-3483	102.0 %	(78-112)
4774-33-8	DIBROMOFLUOROMETHANE	B824-3483	95.7 %	(65-117)
2037-26-5	TOLUENE-D8	B824-3483	99.9 %	(86-110)
460-00-4	4-BROMOFLUOROBENZENE	B826-3519	99.8 %	(78-112)
4774-33-8	DIBROMOFLUOROMETHANE	B826-3519	96.7 %	(65-117)
2037-26-5	TOLUENE-D8	B826-3519	100.0 %	(86-110)



# Environmental Testing Laboratories, Inc.

208 Route 109, Farmingdale NY 11735  
Phone - 631-249-1456 Fax - 631-249-8344

07/09/2002

## Volatiles - EPA 8260B

**Sample: J8133-5**

Client Sample ID: MW-107

Collected: 06/25/2002 11:25

Matrix: Liquid

Type: Grab

Remarks: See Case Narrative

Analyzed Date: 07/01/2002

Cas No	Analyte	File ID	MDL	Concentration	Units	Q
75-71-8	Dichlorodifluoromethane	B 824 -3484	0.94	0.94	ppb	U
75-45-6	Chlorodifluoromethane	B 824 -3484	0.50	0.50	ppb	U
74-87-3	Chloromethane	B 824 -3484	0.56	0.56	ppb	U
75-01-4	Vinyl Chloride	B 824 -3484	0.51	126	ppb	
74-83-9	Bromomethane	B 824 -3484	0.93	0.93	ppb	U
75-00-3	Chloroethane	B 824 -3484	0.49	0.49	ppb	U
75-69-4	Trichlorofluoromethane	B 824 -3484	0.59	0.59	ppb	U
76-13-1	1,1,2-Trichlorotrifluoroethane	B 824 -3484	0.52	0.52	ppb	U
75-35-4	1,1-Dichloroethene	B 824 -3484	0.63	0.63	ppb	U
67-64-1	Acetone	B 824 -3484	11.3	11.3	ppb	U
75-15-0	Carbon disulfide	B 824 -3484	0.54	0.54	ppb	U
75-09-2	Methylene Chloride	B 824 -3484	0.63	0.63	ppb	U
156-60-5	t-1,2-Dichloroethene	B 824 -3484	0.46	3.50	ppb	
1634-04-4	Methyl t-butyl ether	B 824 -3484	0.58	0.58	ppb	U
75-34-3	1,1-Dichloroethane	B 824 -3484	0.43	7.00	ppb	
590-20-7	2,2-Dichloropropane	B 824 -3484	0.82	0.82	ppb	U
156-59-2	c-1,2-Dichloroethene	B 826 -3520	4.20	254	ppb	
78-93-3	2-Butanone	B 824 -3484	16.5	16.5	ppb	U
74-97-5	Bromochloromethane	B 824 -3484	0.50	0.50	ppb	U
67-66-3	Chloroform	B 824 -3484	0.70	0.70	ppb	U
71-55-6	1,1,1-Trichloroethane	B 824 -3484	0.35	1.10	ppb	
56-23-5	Carbon Tetrachloride	B 824 -3484	0.52	0.52	ppb	U
563-58-6	1,1-Dichloropropene	B 824 -3484	0.47	0.47	ppb	U
71-43-2	Benzene	B 824 -3484	0.40	0.40	ppb	U
107-06-2	1,2-Dichloroethane	B 824 -3484	0.23	0.23	ppb	U
79-01-6	Trichloroethene	B 824 -3484	0.46	47.0	ppb	
78-87-5	1,2-Dichloropropane	B 824 -3484	0.27	0.27	ppb	U
74-95-3	Dibromomethane	B 824 -3484	0.20	0.20	ppb	U
75-27-4	Bromodichloromethane	B 824 -3484	0.25	0.25	ppb	U
110-75-8	2-Chloroethylvinylether	B 824 -3484	1.04	1.04	ppb	U
10061-01-5	c-1,3-Dichloropropene	B 824 -3484	0.40	0.40	ppb	U
108-10-1	4-Methyl-2-pentanone	B 824 -3484	3.08	3.08	ppb	U
108-88-3	Toluene	B 824 -3484	0.38	4.30	ppb	
10061-02-6	t-1,3-Dichloropropene	B 824 -3484	0.28	0.28	ppb	U
79-00-5	1,1,2-Trichloroethane	B 824 -3484	0.51	0.51	ppb	U
127-18-4	Tetrachloroethene	B 824 -3484	0.62	55.4	ppb	



# Environmental Testing Laboratories, Inc.

208 Route 109, Farmingdale NY 11735

Phone - 631-249-1456 Fax - 631-249-8344

07/09/2002

## Volatiles - EPA 8260B

**Sample: J8133-5...continue**

Client Sample ID: MW-107

Collected: 06/25/2002 11:25

Matrix: Liquid

Type: Grab

Remarks: See Case Narrative

Analyzed Date: 07/01/2002

Cas No	Analyte	File ID	MDL	Concentration	Units	Q
142-28-9	1,3-Dichloropropane	B 824 -3484	0.26	0.26	ppb	U
591-78-6	2-Hexanone	B 824 -3484	1.65	1.65	ppb	U
124-48-1	Dibromochloromethane	B 824 -3484	0.25	0.25	ppb	U
106-93-4	1,2-Dibromoethane	B 824 -3484	0.23	0.23	ppb	U
108-90-7	Chlorobenzene	B 824 -3484	0.42	0.42	ppb	U
630-20-6	1,1,1,2-Tetrachloroethane	B 824 -3484	0.34	0.34	ppb	U
100-41-4	Ethylbenzene	B 824 -3484	0.53	0.53	ppb	U
108-38-3	m,p-xylene	B 824 -3484	0.76	0.76	ppb	U
95-47-6	o-xylene	B 824 -3484	0.33	1.30	ppb	
100-42-5	Styrene	B 824 -3484	0.40	0.40	ppb	U
75-25-2	Bromoform	B 824 -3484	0.26	0.26	ppb	U
98-82-8	Isopropylbenzene	B 824 -3484	0.43	0.43	ppb	U
108-86-1	Bromobenzene	B 824 -3484	0.47	0.47	ppb	U
79-34-5	1,1,2,2-Tetrachloroethane	B 824 -3484	0.58	0.58	ppb	U
103-65-1	n-Propylbenzene	B 824 -3484	0.62	0.62	ppb	U
96-18-4	1,2,3-Trichloropropane	B 824 -3484	0.47	0.47	ppb	U
622-96-8	p-Ethyltoluene	B 824 -3484	0.62	0.62	ppb	U
108-67-8	1,3,5-Trimethylbenzene	B 824 -3484	0.57	0.57	ppb	U
95-49-8	2-Chlorotoluene	B 824 -3484	0.38	0.38	ppb	U
106-43-4	4-Chlorotoluene	B 824 -3484	0.55	0.55	ppb	U
98-06-6	tert-Butylbenzene	B 824 -3484	0.55	0.55	ppb	U
95-63-6	1,2,4-Trimethylbenzene	B 824 -3484	0.60	0.60	ppb	U
135-98-8	sec-Butylbenzene	B 824 -3484	0.61	1.50	ppb	
99-87-6	4-Isopropyltoluene	B 824 -3484	0.67	0.67	ppb	U
541-73-1	1,3-Dichlorobenzene	B 824 -3484	0.53	0.53	ppb	U
106-46-7	1,4-Dichlorobenzene	B 824 -3484	0.51	0.51	ppb	U
95-50-1	1,2-Dichlorobenzene	B 824 -3484	0.45	0.45	ppb	U
105-05-5	p-Diethylbenzene	B 824 -3484	0.69	1.60	ppb	
104-51-8	n-Butylbenzene	B 824 -3484	0.73	0.73	ppb	U
95-93-2	1,2,4,5-Tetramethylbenzene	B 824 -3484	0.86	1.80	ppb	
96-12-8	1,2-Dibromo-3-chloropropane	B 824 -3484	0.46	0.46	ppb	U
120-82-1	1,2,4-Trichlorobenzene	B 824 -3484	0.70	0.70	ppb	U
87-68-3	Hexachlorobutadiene	B 824 -3484	2.95	2.95	ppb	U
91-20-3	Naphthalene	B 824 -3484	0.94	0.94	ppb	U
87-61-6	1,2,3-Trichlorobenzene	B 824 -3484	0.61	0.61	ppb	U



# Environmental Testing Laboratories, Inc.

208 Route 109, Farmingdale NY 11735

Phone - 631-249-1456 Fax - 631-249-8344

07/09/2002

## Volatiles - EPA 8260B

**Sample: J8133-5...continue**

Client Sample ID: MW-107

Matrix: Liquid

Remarks: See Case Narrative

Analyzed Date: 07/01/2002

Type: Grab

Collected: 06/25/2002 11:25

Cas No	Surrogate	File ID	% Recovery	QC Limits	Q
460-00-4	4-BROMOFLUOROBENZENE	B824-3484	103.0 %	(78-110)	
4774-33-8	DIBROMOFLUOROMETHANE	B824-3484	99.0 %	(65-110)	
2037-26-5	TOLUENE-D8	B824-3484	99.9 %	(86-110)	
460-00-4	4-BROMOFLUOROBENZENE	B826-3520	99.3 %	(78-110)	
4774-33-8	DIBROMOFLUOROMETHANE	B826-3520	97.0 %	(65-110)	
2037-26-5	TOLUENE-D8	B826-3520	104.0 %	(86-110)	



# Environmental Testing Laboratories, Inc.

208 Route 109, Farmingdale NY 11735  
Phone - 631-249-1456 Fax - 631-249-8344

07/09/2002

## Volatiles - EPA 8260B

### Sample: J8133-6

Client Sample ID: MW-106

Collected: 06/25/2002 13:15

Matrix: Liquid

Type: Grab

Remarks: See Case Narrative

Analyzed Date: 07/01/2002

Cas No	Analyte	File ID	MDL	Concentration	Units	Q
75-71-8	Dichlorodifluoromethane	B 824 -3485	0.94	0.94	ppb	U
75-45-6	Chlorodifluoromethane	B 824 -3485	0.50	0.50	ppb	U
74-87-3	Chloromethane	B 824 -3485	0.56	0.56	ppb	U
75-01-4	Vinyl Chloride	B 824 -3485	0.51	93.1	ppb	
74-83-9	Bromomethane	B 824 -3485	0.93	0.93	ppb	U
75-00-3	Chloroethane	B 824 -3485	0.49	0.49	ppb	U
75-69-4	Trichlorofluoromethane	B 824 -3485	0.59	0.59	ppb	U
76-13-1	1,1,2-Trichlorotrifluoroethane	B 824 -3485	0.52	0.52	ppb	U
75-35-4	1,1-Dichloroethene	B 824 -3485	0.63	0.63	ppb	U
67-64-1	Acetone	B 824 -3485	11.3	11.3	ppb	U
75-15-0	Carbon disulfide	B 824 -3485	0.54	0.54	ppb	U
75-09-2	Methylene Chloride	B 824 -3485	0.63	0.63	ppb	U
156-60-5	t-1,2-Dichloroethene	B 824 -3485	0.46	25.2	ppb	
1634-04-4	Methyl t-butyl ether	B 824 -3485	0.58	0.58	ppb	U
75-34-3	1,1-Dichloroethane	B 824 -3485	0.43	0.43	ppb	U
590-20-7	2,2-Dichloropropane	B 824 -3485	0.82	0.82	ppb	U
156-59-2	c-1,2-Dichloroethene	B 826 -3521	42.0	4840	ppb	
78-93-3	2-Butanone	B 824 -3485	16.5	16.5	ppb	U
74-97-5	Bromochloromethane	B 824 -3485	0.50	0.50	ppb	U
67-66-3	Chloroform	B 824 -3485	0.70	0.70	ppb	U
71-55-6	1,1,1-Trichloroethane	B 824 -3485	0.35	0.35	ppb	U
56-23-5	Carbon Tetrachloride	B 824 -3485	0.52	0.52	ppb	U
563-58-6	1,1-Dichloropropene	B 824 -3485	0.47	0.47	ppb	U
71-43-2	Benzene	B 824 -3485	0.40	0.40	ppb	U
107-06-2	1,2-Dichloroethane	B 824 -3485	0.23	0.23	ppb	U
79-01-6	Trichloroethene	B 826 -3521	46.0	789	ppb	
78-87-5	1,2-Dichloropropane	B 824 -3485	0.27	0.27	ppb	U
74-95-3	Dibromomethane	B 824 -3485	0.20	0.20	ppb	U
75-27-4	Bromodichloromethane	B 824 -3485	0.25	0.25	ppb	U
110-75-8	2-Chloroethylvinylether	B 824 -3485	1.04	1.04	ppb	U
10061-01-5	c-1,3-Dichloropropene	B 824 -3485	0.40	0.40	ppb	U
108-10-1	4-Methyl-2-pentanone	B 824 -3485	3.08	3.08	ppb	U
108-88-3	Toluene	B 824 -3485	0.38	1.10	ppb	
10061-02-6	t-1,3-Dichloropropene	B 824 -3485	0.28	0.28	ppb	U
79-00-5	1,1,2-Trichloroethane	B 824 -3485	0.51	0.51	ppb	U
127-18-4	Tetrachloroethene	B 826 -3521	62.0	216	ppb	





# Environmental Testing Laboratories, Inc.

208 Route 109, Farmingdale NY 11735

Phone - 631-249-1456 Fax - 631-249-8344

07/09/2002

## Volatiles - EPA 8260B

**Sample: J8133-6...continue**

Client Sample ID: MW-106

Collected: 06/25/2002 13:15

Matrix: Liquid

Type: Grab

Remarks: See Case Narrative

Analyzed Date: 07/01/2002

Cas No	Analyte	File ID	MDL	Concentration	Units	Q
142-28-9	1,3-Dichloropropane	B 824 -3485	0.26	0.26	ppb	U
591-78-6	2-Hexanone	B 824 -3485	1.65	1.65	ppb	U
124-48-1	Dibromochloromethane	B 824 -3485	0.25	0.25	ppb	U
106-93-4	1,2-Dibromoethane	B 824 -3485	0.23	0.23	ppb	U
108-90-7	Chlorobenzene	B 824 -3485	0.42	0.42	ppb	U
630-20-6	1,1,1,2-Tetrachloroethane	B 824 -3485	0.34	0.34	ppb	U
100-41-4	Ethylbenzene	B 824 -3485	0.53	0.53	ppb	U
108-38-3	m,p-xylene	B 824 -3485	0.76	0.76	ppb	U
95-47-6	o-xylene	B 824 -3485	0.33	0.33	ppb	U
100-42-5	Styrene	B 824 -3485	0.40	0.40	ppb	U
75-25-2	Bromoform	B 824 -3485	0.26	0.26	ppb	U
98-82-8	Isopropylbenzene	B 824 -3485	0.43	0.43	ppb	U
108-86-1	Bromobenzene	B 824 -3485	0.47	0.47	ppb	U
79-34-5	1,1,2,2-Tetrachloroethane	B 824 -3485	0.58	0.58	ppb	U
103-65-1	n-Propylbenzene	B 824 -3485	0.62	0.62	ppb	U
96-18-4	1,2,3-Trichloropropane	B 824 -3485	0.47	0.47	ppb	U
622-96-8	p-Ethyltoluene	B 824 -3485	0.62	0.62	ppb	U
108-67-8	1,3,5-Trimethylbenzene	B 824 -3485	0.57	0.57	ppb	U
95-49-8	2-Chlorotoluene	B 824 -3485	0.38	0.38	ppb	U
106-43-4	4-Chlorotoluene	B 824 -3485	0.55	0.55	ppb	U
98-06-6	tert-Butylbenzene	B 824 -3485	0.55	0.55	ppb	U
95-63-6	1,2,4-Trimethylbenzene	B 824 -3485	0.60	0.60	ppb	U
135-98-8	sec-Butylbenzene	B 824 -3485	0.61	0.61	ppb	U
99-87-6	4-Isopropyltoluene	B 824 -3485	0.67	0.67	ppb	U
541-73-1	1,3-Dichlorobenzene	B 824 -3485	0.53	0.53	ppb	U
106-46-7	1,4-Dichlorobenzene	B 824 -3485	0.51	0.51	ppb	U
95-50-1	1,2-Dichlorobenzene	B 824 -3485	0.45	0.45	ppb	U
105-05-5	p-Diethylbenzene	B 824 -3485	0.69	0.69	ppb	U
104-51-8	n-Butylbenzene	B 824 -3485	0.73	0.73	ppb	U
95-93-2	1,2,4,5-Tetramethylbenzene	B 824 -3485	0.86	0.86	ppb	U
96-12-8	1,2-Dibromo-3-chloropropane	B 824 -3485	0.46	0.46	ppb	U
120-82-1	1,2,4-Trichlorobenzene	B 824 -3485	0.70	0.70	ppb	U
87-68-3	Hexachlorobutadiene	B 824 -3485	2.95	2.95	ppb	U
91-20-3	Naphthalene	B 824 -3485	0.94	0.94	ppb	U
87-61-6	1,2,3-Trichlorobenzene	B 824 -3485	0.61	0.61	ppb	U





# Environmental Testing Laboratories, Inc.

208 Route 109, Farmingdale NY 11735  
Phone - 631-249-1456 Fax - 631-249-8344

07/09/2002

## Volatiles - EPA 8260B

**Sample: J8133-6...continue**

Client Sample ID: MW-106

Collected: 06/25/2002 13:15

Matrix: Liquid

Type: Grab

Remarks: See Case Narrative

Analyzed Date: 07/01/2002

Cas No	Surrogate	File ID	% Recovery	QC Limits
460-00-4	4-BROMOFLUOROBENZENE	B824-3485	102.0 %	(78-112)
4774-33-8	DIBROMOFLUOROMETHANE	B824-3485	99.3 %	(65-110)
2037-26-5	TOLUENE-D8	B824-3485	99.1 %	(86-110)
460-00-4	4-BROMOFLUOROBENZENE	B826-3521	99.1 %	(78-112)
4774-33-8	DIBROMOFLUOROMETHANE	B826-3521	97.6 %	(65-110)
2037-26-5	TOLUENE-D8	B826-3521	103.0 %	(86-110)



# Environmental Testing Laboratories, Inc.

208 Route 109, Farmingdale NY 11735

Phone - 631-249-1456 Fax - 631-249-8344

07/09/2002

## Volatiles - EPA 8260B

### Sample: J8133-6MS

Client Sample ID: MW-106 MS

Collected: 06/25/2002 13:15

Matrix: Liquid

Type: Matrix Spike

Remarks:

Analyzed Date: 07/08/2002

Cas No	Analyte	File ID	MDL	Concentration	Units	Q
75-71-8	Dichlorodifluoromethane	B 828 -3562	94.0	94.0	ppb	U
75-45-6	Chlorodifluoromethane	B 828 -3562	0.50	0.50	ppb	U
74-87-3	Chloromethane	B 828 -3562	0.56	0.56	ppb	U
75-01-4	Vinyl Chloride	B 828 -3562	0.51	0.51	ppb	U
74-83-9	Bromomethane	B 828 -3562	0.93	0.93	ppb	U
75-00-3	Chloroethane	B 828 -3562	0.49	0.49	ppb	U
75-69-4	Trichlorofluoromethane	B 828 -3562	0.59	0.59	ppb	U
76-13-1	1,1,2-Trichlorotrifluoroethane	B 828 -3562	0.52	0.52	ppb	U
75-35-4	1,1-Dichloroethene	B 828 -3562	0.63	42.0	ppb	
67-64-1	Acetone	B 828 -3562	11.3	11.3	ppb	U
75-15-0	Carbon disulfide	B 828 -3562	0.54	0.54	ppb	U
75-09-2	Methylene Chloride	B 828 -3562	0.63	0.63	ppb	U
156-60-5	t-1,2-Dichloroethene	B 828 -3562	0.46	0.46	ppb	U
1634-04-4	Methyl t-butyl ether	B 828 -3562	0.58	0.58	ppb	U
75-34-3	1,1-Dichloroethane	B 828 -3562	0.43	0.43	ppb	U
590-20-7	2,2-Dichloropropane	B 828 -3562	0.82	0.82	ppb	U
156-59-2	c-1,2-Dichloroethene	B 828 -3562	0.42	45.1	ppb	
78-93-3	2-Butanone	B 828 -3562	16.5	16.5	ppb	U
74-97-5	Bromochloromethane	B 828 -3562	0.50	0.50	ppb	U
67-66-3	Chloroform	B 828 -3562	0.70	0.70	ppb	U
71-55-6	1,1,1-Trichloroethane	B 828 -3562	0.35	0.35	ppb	U
56-23-5	Carbon Tetrachloride	B 828 -3562	0.52	0.52	ppb	U
563-58-6	1,1-Dichloropropene	B 828 -3562	0.47	0.47	ppb	U
71-43-2	Benzene	B 828 -3562	0.40	45.5	ppb	
107-06-2	1,2-Dichloroethane	B 828 -3562	0.23	0.23	ppb	U
79-01-6	Trichloroethene	B 828 -3562	0.46	51.9	ppb	
78-87-5	1,2-Dichloropropane	B 828 -3562	0.27	0.27	ppb	U
74-95-3	Dibromomethane	B 828 -3562	0.20	0.20	ppb	U
75-27-4	Bromodichloromethane	B 828 -3562	0.25	0.25	ppb	U
110-75-8	2-Chloroethylvinylether	B 828 -3562	1.04	1.04	ppb	U
10061-01-5	c-1,3-Dichloropropene	B 828 -3562	0.40	0.40	ppb	U
108-10-1	4-Methyl-2-pentanone	B 828 -3562	3.08	3.08	ppb	U
108-88-3	Toluene	B 828 -3562	0.38	46.0	ppb	
10061-02-6	t-1,3-Dichloropropene	B 828 -3562	0.28	0.28	ppb	U
79-00-5	1,1,2-Trichloroethane	B 828 -3562	0.51	0.51	ppb	U
127-18-4	Tetrachloroethene	B 828 -3562	0.62	0.62	ppb	U



# Environmental Testing Laboratories, Inc.

208 Route 109, Farmingdale NY 11735

Phone - 631-249-1456 Fax - 631-249-8344

07/09/2002

## Volatiles - EPA 8260B

**Sample: J8133-6MS...continue**

Client Sample ID: MW-106 MS

Collected: 06/25/2002 13:15

Matrix: Liquid

Type: Matrix Spike

Remarks:

Analyzed Date: 07/08/2002

Cas No	Analyte	File ID	MDL	Concentration	Units	Q
142-28-9	1,3-Dichloropropane	B 828 -3562	0.26	0.26	ppb	U
591-78-6	2-Hexanone	B 828 -3562	1.65	1.65	ppb	U
124-48-1	Dibromochloromethane	B 828 -3562	0.25	0.25	ppb	U
106-93-4	1,2-Dibromoethane	B 828 -3562	0.23	0.23	ppb	U
108-90-7	Chlorobenzene	B 828 -3562	0.42	45.5	ppb	
630-20-6	1,1,1,2-Tetrachloroethane	B 828 -3562	0.34	0.34	ppb	U
100-41-4	Ethylbenzene	B 828 -3562	0.53	0.53	ppb	U
108-38-3	m,p-xylene	B 828 -3562	0.76	0.76	ppb	U
95-47-6	o-xylene	B 828 -3562	0.33	0.33	ppb	U
100-42-5	Styrene	B 828 -3562	0.40	0.40	ppb	U
75-25-2	Bromoform	B 828 -3562	0.26	0.26	ppb	U
98-82-8	Isopropylbenzene	B 828 -3562	0.43	0.43	ppb	U
108-86-1	Bromobenzene	B 828 -3562	0.47	0.47	ppb	U
79-34-5	1,1,2,2-Tetrachloroethane	B 828 -3562	0.58	0.58	ppb	U
103-65-1	n-Propylbenzene	B 828 -3562	0.62	0.62	ppb	U
96-18-4	1,2,3-Trichloropropane	B 828 -3562	0.47	0.47	ppb	U
622-96-8	p-Ethyltoluene	B 828 -3562	0.62	0.62	ppb	U
108-67-8	1,3,5-Trimethylbenzene	B 828 -3562	0.57	0.57	ppb	U
95-49-8	2-Chlorotoluene	B 828 -3562	0.38	0.38	ppb	U
106-43-4	4-Chlorotoluene	B 828 -3562	0.55	0.55	ppb	U
98-06-6	tert-Butylbenzene	B 828 -3562	0.55	0.55	ppb	U
95-63-6	1,2,4-Trimethylbenzene	B 828 -3562	0.60	0.60	ppb	U
135-98-8	sec-Butylbenzene	B 828 -3562	0.61	0.61	ppb	U
99-87-6	4-Isopropyltoluene	B 828 -3562	0.67	0.67	ppb	U
541-73-1	1,3-Dichlorobenzene	B 828 -3562	0.53	0.53	ppb	U
106-46-7	1,4-Dichlorobenzene	B 828 -3562	0.51	0.51	ppb	U
95-50-1	1,2-Dichlorobenzene	B 828 -3562	0.45	0.45	ppb	U
105-05-5	p-Diethylbenzene	B 828 -3562	0.69	0.69	ppb	U
104-51-8	n-Butylbenzene	B 828 -3562	0.73	0.73	ppb	U
95-93-2	1,2,4,5-Tetramethylbenzene	B 828 -3562	0.86	0.86	ppb	U
96-12-8	1,2-Dibromo-3-chloropropane	B 828 -3562	0.46	0.46	ppb	U
120-82-1	1,2,4-Trichlorobenzene	B 828 -3562	0.70	0.70	ppb	U
87-68-3	Hexachlorobutadiene	B 828 -3562	2.95	2.95	ppb	U
91-20-3	Naphthalene	B 828 -3562	0.94	0.94	ppb	U
87-61-6	1,2,3-Trichlorobenzene	B 828 -3562	0.61	0.61	ppb	U



# Environmental Testing Laboratories, Inc.

208 Route 109, Farmingdale NY 11735

Phone - 631-249-1456 Fax - 631-249-8344

07/09/2002

## Volatiles - EPA 8260B

### Sample: J8133-6MS...continue

Client Sample ID: MW-106 MS

Collected: 06/25/2002 13:15

Matrix: Liquid

Type: Matrix Spike

Remarks:

Analyzed Date: 07/08/2002

Cas No	Surrogate	File ID	% Recovery	QC Limit
460-00-4	4-BROMOFLUOROBENZENE	B828-3562	98.6 %	(78-112)
4774-33-8	DIBROMOFLUOROMETHANE	B828-3562	95.4 %	(65-110)
2037-26-5	TOLUENE-D8	B828-3562	101.0 %	(86-110)



# Environmental Testing Laboratories, Inc.

208 Route 109, Farmingdale NY 11735  
Phone - 631-249-1456 Fax - 631-249-8344

07/09/2002

## Volatiles - EPA 8260B

### Sample: J8133-6MSD

Client Sample ID: MW-106 MSD

Collected: 06/25/2002 12:15

Matrix: Liquid

Type: Matrix Spike Dup

Remarks:

Analyzed Date: 07/08/2002

Cas No	Analyte	File ID	MDL	Concentration	Units	Q
75-71-8	Dichlorodifluoromethane	B 828 -3563	94.0	94.0	ppb	U
75-45-6	Chlorodifluoromethane	B 828 -3563	50.0	50.0	ppb	U
74-87-3	Chloromethane	B 828 -3563	56.0	56.0	ppb	U
75-01-4	Vinyl Chloride	B 828 -3563	51.0	51.0	ppb	U
74-83-9	Bromomethane	B 828 -3563	93.0	93.0	ppb	U
75-00-3	Chloroethane	B 828 -3563	49.0	49.0	ppb	U
75-69-4	Trichlorofluoromethane	B 828 -3563	59.0	59.0	ppb	U
76-13-1	1,1,2-Trichlorotrifluoroethane	B 828 -3563	52.0	52.0	ppb	U
75-35-4	1,1-Dichloroethene	B 828 -3563	63.0	44.1	ppb	J
67-64-1	Acetone	B 828 -3563	1130	1130	ppb	U
75-15-0	Carbon disulfide	B 828 -3563	54.0	54.0	ppb	U
75-09-2	Methylene Chloride	B 828 -3563	63.0	63.0	ppb	U
156-60-5	t-1,2-Dichloroethene	B 828 -3563	46.0	46.0	ppb	U
1634-04-4	Methyl t-butyl ether	B 828 -3563	58.0	58.0	ppb	U
75-34-3	1,1-Dichloroethane	B 828 -3563	43.0	43.0	ppb	U
590-20-7	2,2-Dichloropropane	B 828 -3563	82.0	82.0	ppb	U
156-59-2	c-1,2-Dichloroethene	B 828 -3563	42.0	50.6	ppb	
78-93-3	2-Butanone	B 828 -3563	1650	1650	ppb	U
74-97-5	Bromochloromethane	B 828 -3563	50.0	50.0	ppb	U
67-66-3	Chloroform	B 828 -3563	70.0	70.0	ppb	U
71-55-6	1,1,1-Trichloroethane	B 828 -3563	35.0	35.0	ppb	U
56-23-5	Carbon Tetrachloride	B 828 -3563	52.0	52.0	ppb	U
563-58-6	1,1-Dichloropropene	B 828 -3563	47.0	47.0	ppb	U
71-43-2	Benzene	B 828 -3563	40.0	47.7	ppb	
107-06-2	1,2-Dichloroethane	B 828 -3563	23.0	23.0	ppb	U
79-01-6	Trichloroethene	B 828 -3563	46.0	51.2	ppb	
78-87-5	1,2-Dichloropropane	B 828 -3563	27.0	27.0	ppb	U
74-95-3	Dibromomethane	B 828 -3563	20.0	20.0	ppb	U
75-27-4	Bromodichloromethane	B 828 -3563	25.0	25.0	ppb	U
110-75-8	2-Chloroethylvinylether	B 828 -3563	104	104	ppb	U
10061-01-5	c-1,3-Dichloropropene	B 828 -3563	40.0	40.0	ppb	U
108-10-1	4-Methyl-2-pentanone	B 828 -3563	308	308	ppb	U
108-88-3	Toluene	B 828 -3563	38.0	47.3	ppb	
10061-02-6	t-1,3-Dichloropropene	B 828 -3563	28.0	28.0	ppb	U
79-00-5	1,1,2-Trichloroethane	B 828 -3563	51.0	51.0	ppb	U
127-18-4	Tetrachloroethene	B 828 -3563	62.0	62.0	ppb	U



# Environmental Testing Laboratories, Inc.

208 Route 109, Farmingdale NY 11735  
Phone - 631-249-1456 Fax - 631-249-8344

07/09/2002

## Volatiles - EPA 8260B

**Sample: J8133-6MSD...continue**

Client Sample ID: MW-106 MSD

Collected: 06/25/2002 12:15

Matrix: Liquid

Type: Matrix Spike Dup

Remarks:

Analyzed Date: 07/08/2002

Cas No	Analyte	File ID	MDL	Concentration	Units	Q
142-28-9	1,3-Dichloropropane	B 828 -3563	26.0	26.0	ppb	U
591-78-6	2-Hexanone	B 828 -3563	165	165	ppb	U
124-48-1	Dibromochloromethane	B 828 -3563	25.0	25.0	ppb	U
106-93-4	1,2-Dibromoethane	B 828 -3563	23.0	23.0	ppb	U
108-90-7	Chlorobenzene	B 828 -3563	42.0	47.6	ppb	
630-20-6	1,1,1,2-Tetrachloroethane	B 828 -3563	34.0	34.0	ppb	U
100-41-4	Ethylbenzene	B 828 -3563	53.0	53.0	ppb	U
108-38-3	m,p-xylene	B 828 -3563	76.0	76.0	ppb	U
95-47-6	o-xylene	B 828 -3563	33.0	33.0	ppb	U
100-42-5	Styrene	B 828 -3563	40.0	40.0	ppb	U
75-25-2	Bromoform	B 828 -3563	26.0	26.0	ppb	U
98-82-8	Isopropylbenzene	B 828 -3563	43.0	43.0	ppb	U
108-86-1	Bromobenzene	B 828 -3563	47.0	47.0	ppb	U
79-34-5	1,1,2,2-Tetrachloroethane	B 828 -3563	58.0	58.0	ppb	U
103-65-1	n-Propylbenzene	B 828 -3563	62.0	62.0	ppb	U
96-18-4	1,2,3-Trichloropropane	B 828 -3563	47.0	47.0	ppb	U
622-96-8	p-Ethyltoluene	B 828 -3563	62.0	62.0	ppb	U
108-67-8	1,3,5-Trimethylbenzene	B 828 -3563	57.0	57.0	ppb	U
95-49-8	2-Chlorotoluene	B 828 -3563	38.0	38.0	ppb	U
106-43-4	4-Chlorotoluene	B 828 -3563	55.0	55.0	ppb	U
98-06-6	tert-Butylbenzene	B 828 -3563	55.0	55.0	ppb	U
95-63-6	1,2,4-Trimethylbenzene	B 828 -3563	60.0	60.0	ppb	U
135-98-8	sec-Butylbenzene	B 828 -3563	61.0	61.0	ppb	U
99-87-6	4-Isopropyltoluene	B 828 -3563	67.0	67.0	ppb	U
541-73-1	1,3-Dichlorobenzene	B 828 -3563	53.0	53.0	ppb	U
106-46-7	1,4-Dichlorobenzene	B 828 -3563	51.0	51.0	ppb	U
95-50-1	1,2-Dichlorobenzene	B 828 -3563	45.0	45.0	ppb	U
105-05-5	p-Diethylbenzene	B 828 -3563	69.0	69.0	ppb	U
104-51-8	n-Butylbenzene	B 828 -3563	73.0	73.0	ppb	U
95-93-2	1,2,4,5-Tetramethylbenzene	B 828 -3563	86.0	86.0	ppb	U
96-12-8	1,2-Dibromo-3-chloropropane	B 828 -3563	46.0	46.0	ppb	U
120-82-1	1,2,4-Trichlorobenzene	B 828 -3563	70.0	70.0	ppb	U
87-68-3	Hexachlorobutadiene	B 828 -3563	295	295	ppb	U
91-20-3	Naphthalene	B 828 -3563	94.0	94.0	ppb	U
87-61-6	1,2,3-Trichlorobenzene	B 828 -3563	61.0	61.0	ppb	U



# Environmental Testing Laboratories, Inc.

208 Route 109, Farmingdale NY 11735  
Phone - 631-249-1456 Fax - 631-249-8344

07/09/2002

## Volatiles - EPA 8260B

### Sample: J8133-6MSD...continue

Client Sample ID: MW-106 MSD

Collected: 06/25/2002 12:15

Matrix: Liquid

Type: Matrix Spike Dup

Remarks:

Analyzed Date: 07/08/2002

Cas No	Surrogate	File ID	% Recovery	QC Limits	Q
460-00-4	4-BROMOFLUOROBENZENE	B828-3563	99.3 %	(78 - 112)	
4774-33-8	DIBROMOFLUOROMETHANE	B828-3563	96.5 %	(65 - 112)	
2037-26-5	TOLUENE-D8	B828-3563	101.0 %	(86 - 110)	





# Environmental Testing Laboratories, Inc.

208 Route 109, Farmingdale NY 11735  
Phone - 631-249-1456 Fax - 631-249-8344

07/09/2002

## Volatiles - EPA 8260B

### Sample: J8133-7

Client Sample ID: MW-116

Collected: 06/25/2002 12:40

Matrix: Liquid

Type: Grab

Remarks: See Case Narrative

Analyzed Date: 07/01/2002

Cas No	Analyte	File ID	MDL	Concentration	Units	Q
75-71-8	Dichlorodifluoromethane	B 824 -3486	0.94	0.94	ppb	U
75-45-6	Chlorodifluoromethane	B 824 -3486	0.50	0.50	ppb	U
74-87-3	Chloromethane	B 824 -3486	0.56	0.56	ppb	U
75-01-4	Vinyl Chloride	B 824 -3486	0.51	76.8	ppb	
74-83-9	Bromomethane	B 824 -3486	0.93	0.93	ppb	U
75-00-3	Chloroethane	B 824 -3486	0.49	0.49	ppb	U
75-69-4	Trichlorofluoromethane	B 824 -3486	0.59	0.59	ppb	U
76-13-1	1,1,2-Trichlorotrifluoroethane	B 824 -3486	0.52	0.52	ppb	U
75-35-4	1,1-Dichloroethene	B 824 -3486	0.63	0.63	ppb	U
67-64-1	Acetone	B 824 -3486	11.3	11.3	ppb	U
75-15-0	Carbon disulfide	B 824 -3486	0.54	0.54	ppb	U
75-09-2	Methylene Chloride	B 824 -3486	0.63	0.63	ppb	U
156-60-5	t-1,2-Dichloroethene	B 824 -3486	0.46	21.7	ppb	
1634-04-4	Methyl t-butyl ether	B 824 -3486	0.58	0.58	ppb	U
75-34-3	1,1-Dichloroethane	B 824 -3486	0.43	0.43	ppb	U
590-20-7	2,2-Dichloropropane	B 824 -3486	0.82	0.82	ppb	U
156-59-2	c-1,2-Dichloroethene	B 826 -3523	42.0	5000	ppb	
78-93-3	2-Butanone	B 824 -3486	16.5	16.5	ppb	U
74-97-5	Bromochloromethane	B 824 -3486	0.50	0.50	ppb	U
67-66-3	Chloroform	B 824 -3486	0.70	0.70	ppb	U
71-55-6	1,1,1-Trichloroethane	B 824 -3486	0.35	0.35	ppb	U
56-23-5	Carbon Tetrachloride	B 824 -3486	0.52	0.52	ppb	U
563-58-6	1,1-Dichloropropene	B 824 -3486	0.47	0.47	ppb	U
71-43-2	Benzene	B 824 -3486	0.40	0.40	ppb	U
107-06-2	1,2-Dichloroethane	B 824 -3486	0.23	0.23	ppb	U
79-01-6	Trichloroethene	B 826 -3523	46.0	550	ppb	
78-87-5	1,2-Dichloropropane	B 824 -3486	0.27	0.27	ppb	U
74-95-3	Dibromomethane	B 824 -3486	0.20	0.20	ppb	U
75-27-4	Bromodichloromethane	B 824 -3486	0.25	0.25	ppb	U
110-75-8	2-Chloroethylvinylether	B 824 -3486	1.04	1.04	ppb	U
10061-01-5	c-1,3-Dichloropropene	B 824 -3486	0.40	0.40	ppb	U
108-10-1	4-Methyl-2-pentanone	B 824 -3486	3.08	3.08	ppb	U
108-88-3	Toluene	B 824 -3486	0.38	1.30	ppb	
10061-02-6	t-1,3-Dichloropropene	B 824 -3486	0.28	0.28	ppb	U
79-00-5	1,1,2-Trichloroethane	B 824 -3486	0.51	0.51	ppb	U
127-18-4	Tetrachloroethene	B 824 -3486	0.62	117	ppb	





# Environmental Testing Laboratories, Inc.

208 Route 109, Farmingdale NY 11735  
Phone - 631-249-1456 Fax - 631-249-8344

07/09/2002

## Volatiles - EPA 8260B

**Sample: J8133-7...continue**

Client Sample ID: MW-116

Collected: 06/25/2002 12:40

Matrix: Liquid

Type: Grab

Remarks: See Case Narrative

Analyzed Date: 07/01/2002

Cas No	Analyte	File ID	MDL	Concentration	Units	Q
142-28-9	1,3-Dichloropropane	B 824 -3486	0.26	0.26	ppb	U
591-78-6	2-Hexanone	B 824 -3486	1.65	1.65	ppb	U
124-48-1	Dibromochloromethane	B 824 -3486	0.25	0.25	ppb	U
106-93-4	1,2-Dibromoethane	B 824 -3486	0.23	0.23	ppb	U
108-90-7	Chlorobenzene	B 824 -3486	0.42	0.42	ppb	U
630-20-6	1,1,1,2-Tetrachloroethane	B 824 -3486	0.34	0.34	ppb	U
100-41-4	Ethylbenzene	B 824 -3486	0.53	0.53	ppb	U
108-38-3	m,p-xylene	B 824 -3486	0.76	0.76	ppb	U
95-47-6	o-xylene	B 824 -3486	0.33	0.33	ppb	U
100-42-5	Styrene	B 824 -3486	0.40	0.40	ppb	U
75-25-2	Bromoform	B 824 -3486	0.26	0.26	ppb	U
98-82-8	Isopropylbenzene	B 824 -3486	0.43	0.43	ppb	U
108-86-1	Bromobenzene	B 824 -3486	0.47	0.47	ppb	U
79-34-5	1,1,2,2-Tetrachloroethane	B 824 -3486	0.58	0.58	ppb	U
103-65-1	n-Propylbenzene	B 824 -3486	0.62	0.62	ppb	U
96-18-4	1,2,3-Trichloropropane	B 824 -3486	0.47	0.47	ppb	U
622-96-8	p-Ethyltoluene	B 824 -3486	0.62	0.62	ppb	U
108-67-8	1,3,5-Trimethylbenzene	B 824 -3486	0.57	0.57	ppb	U
95-49-8	2-Chlorotoluene	B 824 -3486	0.38	0.38	ppb	U
106-43-4	4-Chlorotoluene	B 824 -3486	0.55	0.55	ppb	U
98-06-6	tert-Butylbenzene	B 824 -3486	0.55	0.55	ppb	U
95-63-6	1,2,4-Trimethylbenzene	B 824 -3486	0.60	0.60	ppb	U
135-98-8	sec-Butylbenzene	B 824 -3486	0.61	0.61	ppb	U
99-87-6	4-Isopropyltoluene	B 824 -3486	0.67	0.67	ppb	U
541-73-1	1,3-Dichlorobenzene	B 824 -3486	0.53	0.53	ppb	U
106-46-7	1,4-Dichlorobenzene	B 824 -3486	0.51	0.51	ppb	U
95-50-1	1,2-Dichlorobenzene	B 824 -3486	0.45	0.45	ppb	U
105-05-5	p-Diethylbenzene	B 824 -3486	0.69	0.69	ppb	U
104-51-8	n-Butylbenzene	B 824 -3486	0.73	0.73	ppb	U
95-93-2	1,2,4,5-Tetramethylbenzene	B 824 -3486	0.86	0.86	ppb	U
96-12-8	1,2-Dibromo-3-chloropropane	B 824 -3486	0.46	0.46	ppb	U
120-82-1	1,2,4-Trichlorobenzene	B 824 -3486	0.70	0.70	ppb	U
87-68-3	Hexachlorobutadiene	B 824 -3486	2.95	2.95	ppb	U
91-20-3	Naphthalene	B 824 -3486	0.94	0.94	ppb	U
87-61-6	1,2,3-Trichlorobenzene	B 824 -3486	0.61	0.61	ppb	U



# Environmental Testing Laboratories, Inc.

208 Route 109, Farmingdale NY 11735

Phone - 631-249-1456 Fax - 631-249-8344

07/09/2002

## Volatiles - EPA 8260B

### Sample: J8133-7...continue

Client Sample ID: MW-116

Collected: 06/25/2002 12:40

Matrix: Liquid

Type: Grab

Remarks: See Case Narrative

Analyzed Date: 07/01/2002

Cas No	Surrogate	File ID	% Recovery	QG Limits	Q
460-00-4	4-BROMOFLUOROBENZENE	B824-3486	102.0 %	(78)	
4774-33-8	DIBROMOFLUOROMETHANE	B824-3486	97.7 %	(65)	
2037-26-5	TOLUENE-D8	B824-3486	99.4 %	(86)	
460-00-4	4-BROMOFLUOROBENZENE	B826-3523	98.3 %	(78)	
4774-33-8	DIBROMOFLUOROMETHANE	B826-3523	97.6 %	(65)	
2037-26-5	TOLUENE-D8	B826-3523	101.0 %	(86)	



# Environmental Testing Laboratories, Inc.

208 Route 109, Farmingdale NY 11735  
Phone - 631-249-1456 Fax - 631-249-8344

07/09/2002

## Volatiles - EPA 8260B

**Sample: J8133-8**

Client Sample ID: Trip Blank

Collected: 06/25/2002

Matrix: Liquid

Type: Trip Blank

Remarks: See Case Narrative

Analyzed Date: 07/01/2002

Cas No	Analyte	File ID	MDL	Concentration	Units	Q
75-71-8	Dichlorodifluoromethane	B 824 -3480	0.94	0.94	ppb	U
75-45-6	Chlorodifluoromethane	B 824 -3480	0.50	0.50	ppb	U
74-87-3	Chloromethane	B 824 -3480	0.56	0.56	ppb	U
75-01-4	Vinyl Chloride	B 824 -3480	0.51	0.51	ppb	U
74-83-9	Bromomethane	B 824 -3480	0.93	0.93	ppb	U
75-00-3	Chloroethane	B 824 -3480	0.49	0.49	ppb	U
75-69-4	Trichlorofluoromethane	B 824 -3480	0.59	0.59	ppb	U
76-13-1	1,1,2-Trichlorotrifluoroethane	B 824 -3480	0.52	0.52	ppb	U
75-35-4	1,1-Dichloroethene	B 824 -3480	0.63	0.63	ppb	U
67-64-1	Acetone	B 824 -3480	11.3	11.3	ppb	U
75-15-0	Carbon disulfide	B 824 -3480	0.54	0.54	ppb	U
75-09-2	Methylene Chloride	B 824 -3480	0.63	0.63	ppb	U
156-60-5	t-1,2-Dichloroethene	B 824 -3480	0.46	0.46	ppb	U
1634-04-4	Methyl t-butyl ether	B 824 -3480	0.58	0.58	ppb	U
75-34-3	1,1-Dichloroethane	B 824 -3480	0.43	0.43	ppb	U
590-20-7	2,2-Dichloropropane	B 824 -3480	0.82	0.82	ppb	U
156-59-2	c-1,2-Dichloroethene	B 824 -3480	0.42	0.42	ppb	U
78-93-3	2-Butanone	B 824 -3480	16.5	16.5	ppb	U
74-97-5	Bromochloromethane	B 824 -3480	0.50	0.50	ppb	U
67-66-3	Chloroform	B 824 -3480	0.70	0.70	ppb	U
71-55-6	1,1,1-Trichloroethane	B 824 -3480	0.35	0.35	ppb	U
56-23-5	Carbon Tetrachloride	B 824 -3480	0.52	0.52	ppb	U
563-58-6	1,1-Dichloropropene	B 824 -3480	0.47	0.47	ppb	U
71-43-2	Benzene	B 824 -3480	0.40	0.40	ppb	U
107-06-2	1,2-Dichloroethane	B 824 -3480	0.23	0.23	ppb	U
79-01-6	Trichloroethene	B 824 -3480	0.46	0.46	ppb	U
78-87-5	1,2-Dichloropropane	B 824 -3480	0.27	0.27	ppb	U
74-95-3	Dibromomethane	B 824 -3480	0.20	0.20	ppb	U
75-27-4	Bromodichloromethane	B 824 -3480	0.25	0.25	ppb	U
110-75-8	2-Chloroethylvinylether	B 824 -3480	1.04	1.04	ppb	U
10061-01-5	c-1,3-Dichloropropene	B 824 -3480	0.40	0.40	ppb	U
108-10-1	4-Methyl-2-pentanone	B 824 -3480	3.08	3.08	ppb	U
108-88-3	Toluene	B 824 -3480	0.38	0.38	ppb	U
10061-02-6	t-1,3-Dichloropropene	B 824 -3480	0.28	0.28	ppb	U
79-00-5	1,1,2-Trichloroethane	B 824 -3480	0.51	0.51	ppb	U
127-18-4	Tetrachloroethene	B 824 -3480	0.62	0.62	ppb	U



# Environmental Testing Laboratories, Inc.

208 Route 109, Farmingdale NY 11735  
Phone - 631-249-1456 Fax - 631-249-8344

07/09/2002

## Volatiles - EPA 8260B

**Sample: J8133-8...continue**

Client Sample ID: Trip Blank

Collected: 06/25/2002

Matrix: Liquid

Type: Trip Blank

Remarks: See Case Narrative

Analyzed Date: 07/01/2002

Cas No	Analyte	File ID	MDL	Concentration	Units	Q
142-28-9	1,3-Dichloropropane	B 824 -3480	0.26	0.26	ppb	U
591-78-6	2-Hexanone	B 824 -3480	1.65	1.65	ppb	U
124-48-1	Dibromochloromethane	B 824 -3480	0.25	0.25	ppb	U
106-93-4	1,2-Dibromoethane	B 824 -3480	0.23	0.23	ppb	U
108-90-7	Chlorobenzene	B 824 -3480	0.42	0.42	ppb	U
630-20-6	1,1,1,2-Tetrachloroethane	B 824 -3480	0.34	0.34	ppb	U
100-41-4	Ethylbenzene	B 824 -3480	0.53	0.53	ppb	U
108-38-3	m,p-xylene	B 824 -3480	0.76	0.76	ppb	U
95-47-6	o-xylene	B 824 -3480	0.33	0.33	ppb	U
100-42-5	Styrene	B 824 -3480	0.40	0.40	ppb	U
75-25-2	Bromoform	B 824 -3480	0.26	0.26	ppb	U
98-82-8	Isopropylbenzene	B 824 -3480	0.43	0.43	ppb	U
108-86-1	Bromobenzene	B 824 -3480	0.47	0.47	ppb	U
79-34-5	1,1,2,2-Tetrachloroethane	B 824 -3480	0.58	0.58	ppb	U
103-65-1	n-Propylbenzene	B 824 -3480	0.62	0.62	ppb	U
96-18-4	1,2,3-Trichloropropane	B 824 -3480	0.47	0.47	ppb	U
622-96-8	p-Ethyltoluene	B 824 -3480	0.62	0.62	ppb	U
108-67-8	1,3,5-Trimethylbenzene	B 824 -3480	0.57	0.57	ppb	U
95-49-8	2-Chlorotoluene	B 824 -3480	0.38	0.38	ppb	U
106-43-4	4-Chlorotoluene	B 824 -3480	0.55	0.55	ppb	U
98-06-6	tert-Butylbenzene	B 824 -3480	0.55	0.55	ppb	U
95-63-6	1,2,4-Trimethylbenzene	B 824 -3480	0.60	0.60	ppb	U
135-98-8	sec-Butylbenzene	B 824 -3480	0.61	0.61	ppb	U
99-87-6	4-Isopropyltoluene	B 824 -3480	0.67	0.67	ppb	U
541-73-1	1,3-Dichlorobenzene	B 824 -3480	0.53	0.53	ppb	U
106-46-7	1,4-Dichlorobenzene	B 824 -3480	0.51	0.51	ppb	U
95-50-1	1,2-Dichlorobenzene	B 824 -3480	0.45	0.45	ppb	U
105-05-5	p-Diethylbenzene	B 824 -3480	0.69	0.69	ppb	U
104-51-8	n-Butylbenzene	B 824 -3480	0.73	0.73	ppb	U
95-93-2	1,2,4,5-Tetramethylbenzene	B 824 -3480	0.86	0.86	ppb	U
96-12-8	1,2-Dibromo-3-chloropropane	B 824 -3480	0.46	0.46	ppb	U
120-82-1	1,2,4-Trichlorobenzene	B 824 -3480	0.70	0.70	ppb	U
87-68-3	Hexachlorobutadiene	B 824 -3480	2.95	2.95	ppb	U
91-20-3	Naphthalene	B 824 -3480	0.94	0.94	ppb	U
87-61-6	1,2,3-Trichlorobenzene	B 824 -3480	0.61	0.61	ppb	U



# Environmental Testing Laboratories, Inc.

208 Route 109, Farmingdale NY 11735  
Phone - 631-249-1456 Fax - 631-249-8344

07/09/2002

## Volatiles - EPA 8260B

**Sample:** J8133-8...continue

Client Sample ID: Trip Blank

Collected: 06/25/2002

Matrix: Liquid

Type: Trip Blank

Remarks: See Case Narrative

Analyzed Date: 07/01/2002

Cas No	Surrogate	File ID	% Recovery	QC Limits	Q
460-00-4	4-BROMOFLUOROBENZENE	B824-3480	102.0 %	(78 - 112)	
4774-33-8	DIBROMOFLUOROMETHANE	B824-3480	95.3 %	(65 - 112)	
2037-26-5	TOLUENE-D8	B824-3480	99.8 %	(86 - 110)	



# Environmental Testing Laboratories, Inc.

208 Route 109, Farmingdale NY 11735  
Phone - 631-249-1456 Fax - 631-249-8344

07/09/2002

## Dissolved Metals

### Sample: J8133-1

Client Sample ID: MW-105

Collected: 06/25/2002 07:40

Matrix: Liquid

Type: Grab

Remarks:

Analyzed Date: 07/01/2002

Cas No	Analyte	MDL	Concentration	Units	Q
7440-47-3	Chromium	0.0032	0.0032	ppm	U
7440-50-8	Copper	0.0028	0.0056	ppm	
7439-89-6	Iron	0.0098	9.57	ppm	
7439-96-5	Manganese	0.0020	1.07	ppm	
7440-02-0	Nickel	0.0010	0.0023	ppm	

### Sample: J8133-2

Client Sample ID: Field Blank

Collected: 06/25/2002 07:50

Matrix: Liquid

Type: Blank

Remarks:

Analyzed Date: 07/01/2002

Cas No	Analyte	MDL	Concentration	Units	Q
7440-47-3	Chromium	0.0032	0.0032	ppm	U
7440-50-8	Copper	0.0028	0.0055	ppm	
7439-89-6	Iron	0.0098	0.0098	ppm	U
7439-96-5	Manganese	0.0020	0.0020	ppm	U
7440-02-0	Nickel	0.0010	0.0010	ppm	U

### Sample: J8133-3

Client Sample ID: MW-103

Collected: 06/25/2002 08:50

Matrix: Liquid

Type: Grab

Remarks:

Analyzed Date: 07/01/2002

Cas No	Analyte	MDL	Concentration	Units	Q
7440-47-3	Chromium	0.0032	0.0032	ppm	U
7440-50-8	Copper	0.0028	0.0032	ppm	
7439-89-6	Iron	0.0098	7.10	ppm	
7439-96-5	Manganese	0.0020	0.42	ppm	
7440-02-0	Nickel	0.0010	0.0013	ppm	



# Environmental Testing Laboratories, Inc.

208 Route 109, Farmingdale NY 11735  
Phone - 631-249-1456 Fax - 631-249-8344

07/09/2002

## Dissolved Metals

### Sample: J8133-4

Client Sample ID: MW-104

Collected: 06/25/2002 10:20

Matrix: Liquid

Type: Grab

Remarks:

Analyzed Date: 07/01/2002

Cas No	Analyte	MDL	Concentration	Units	Q
7440-47-3	Chromium	0.0032	0.0032	ppm	U
7440-50-8	Copper	0.0028	0.0037	ppm	
7439-89-6	Iron	0.0098	0.58	ppm	
7439-96-5	Manganese	0.0020	0.19	ppm	
7440-02-0	Nickel	0.0010	0.0033	ppm	

### Sample: J8133-5

Client Sample ID: MW-107

Collected: 06/25/2002 11:25

Matrix: Liquid

Type: Grab

Remarks:

Analyzed Date: 07/01/2002

Cas No	Analyte	MDL	Concentration	Units	Q
7440-47-3	Chromium	0.0032	0.0032	ppm	U
7440-50-8	Copper	0.0028	0.0033	ppm	
7439-89-6	Iron	0.0098	11.3	ppm	
7439-96-5	Manganese	0.0020	0.92	ppm	
7440-02-0	Nickel	0.0010	0.0028	ppm	

### Sample: J8133-6

Client Sample ID: MW-106

Collected: 06/25/2002 13:15

Matrix: Liquid

Type: Grab

Remarks:

Analyzed Date: 07/01/2002

Cas No	Analyte	MDL	Concentration	Units	Q
7440-47-3	Chromium	0.0032	0.0032	ppm	U
7440-50-8	Copper	0.0028	0.0031	ppm	
7439-89-6	Iron	0.0098	4.82	ppm	
7439-96-5	Manganese	0.0020	0.27	ppm	
7440-02-0	Nickel	0.0010	0.0023	ppm	



# Environmental Testing Laboratories, Inc.

208 Route 109, Farmingdale NY 11735  
Phone - 631-249-1456 Fax - 631-249-8344

07/09/2002

## Dissolved Metals

### Sample: J8133-6MS

Client Sample ID: MW-106 MS

Collected: 06/25/2002 13:15

Matrix: Liquid

Type: Matrix Spike

Remarks:

Analyzed Date: 07/01/2002

Cas No	Analyte	MDL	Concentration	Units	Q
7440-47-3	Chromium	0.0032	0.19	ppm	
7440-50-8	Copper	0.0028	0.26	ppm	
7439-89-6	Iron	0.0098	4.81	ppm	
7439-96-5	Manganese	0.0020	0.72	ppm	
7440-02-0	Nickel	0.0010	0.47	ppm	

### Sample: J8133-6MSD

Client Sample ID: MW-106 MSD

Collected: 06/25/2002 12:15

Matrix: Liquid

Type: Matrix Spike Dup

Remarks:

Analyzed Date: 07/01/2002

Cas No	Analyte	MDL	Concentration	Units	Q
7440-47-3	Chromium	0.0032	0.20	ppm	
7440-50-8	Copper	0.0028	0.26	ppm	
7439-89-6	Iron	0.0098	5.10	ppm	
7439-96-5	Manganese	0.0020	0.74	ppm	
7440-02-0	Nickel	0.0010	0.48	ppm	

### Sample: J8133-7

Client Sample ID: MW-116

Collected: 06/25/2002 12:40

Matrix: Liquid

Type: Grab

Remarks:

Analyzed Date: 07/01/2002

Cas No	Analyte	MDL	Concentration	Units	Q
7440-47-3	Chromium	0.0032	0.0032	ppm	U
7440-50-8	Copper	0.0028	0.0093	ppm	
7439-89-6	Iron	0.0098	4.90	ppm	
7439-96-5	Manganese	0.0020	0.28	ppm	
7440-02-0	Nickel	0.0010	0.0024	ppm	





# Environmental Testing Laboratories, Inc.

208 Route 109, Farmingdale NY 11735

Phone - 631-249-1456 Fax - 631-249-8344

07/09/2002

## Case Narrative

8260:

The following compounds were calibrated at 25, 50, 100, 150 and 200 ppb levels in the initial calibration curve:

Acetone  
2-Butanone  
4-Methyl-2-pentanone  
2-Hexanone

M&P-Xylenes and 2-Chloro ethyl vinyl ether were calibrated at 10, 40, 100, 200 and 300 ppb levels.

All other compounds were calibrated at 5, 20, 50, 100 and 150 ppb levels.

Reviewed by:

A handwritten signature in black ink, appearing to read "K. J. ...", is written over a horizontal line.

# Environmental Testing Laboratories, Inc.

208 Route 109, Farmingdale NY 11735

Phone - 631-249-1456 Fax - 631-249-8344

07/09/2002

## ORGANIC METHOD QUALIFIERS

Q - Qualifier - specified entries and their meanings are as follows:

- U - The analytical result is a non-detect.
- J - Indicates an estimated value. The concentration reported was detected below the Method Detection Limit.
- B - The analyte was found in the associated method blank as well as the sample. It indicates possible/probable blank contamination and warns the data user to take appropriate action.
- E - The concentration of the analyte exceeded the calibration range of the instrument.
- D - This flag identifies all compounds identified in an analysis at a secondary dilution. In the case of a surrogate this flag indicates a system monitoring compound diluted out.

## INORGANIC METHOD QUALIFIERS

C - (Concentration) qualifiers are as follows:

- B - Entered if the reported value was obtained from a reading that was less than the Contract Required Detection Limit (CRDL) but greater than or equal to the Instrument Detection Limit (IDL).
- U - Entered when the analyte was analyzed for, but not detected.

Q - Qualifier specific entries and their meanings are as follows:

- E - Reported value is estimated because of the presence of interferences.

M - (Method) qualifiers are as follows:

- A - Flame AA
- AS - Semi-automated Spectrophotometric
- AV - Automated Cold Vapor AA
- C - Manual Spectrophotometric
- F - Furnace AA
- P - ICP
- T - Titrimetric

## OTHER QUALIFIERS

- ND - Not Detected
- NA - Not Applicable
- NR - Not Required
- \* - Outside Expected Range (NYCDEP Table I/II or Surrogate Limits)

## OTHER

- All soil and sediment samples are reported on a dry weight basis.



# ETL

Environmental Testing Laboratories, Inc.  
 208 Route 109 • Farmingdale • New York 11735  
 516-249-1456 • Fax: 516-249-8344

## CHAIN OF CUSTODY DOCUMENT

J-8133

Project Name: <u>Active 7</u>		Project Manager: <u>M. S. J.</u>		Sampler (Signature): <u>E. S. J.</u>		Sampler (Print): <u>E. S. J.</u>	
Project Address:		Client: <u>Bluewater J/N:</u>		Rush by: <u>1/1</u>		601/602	
SAMPLE INFO		Type: <u>SS = Spill Spoon, G = Grab, C = Composite, B = Blank</u>		Air - Vol. (Liters)		BTX/BTEX	
ID	Date	Time	Type	Matrix	Sample Location	Total # Cont.	624/8260/8021
1	7/1	7:40	G	L	MW-105	3	MTBE
2	7/1	7:50	L	L	FIELD BLANK	3	624/8260/8021
3	7/1	8:50	L	L	MW-103	3	825/8270/BN
4	7/1	10:30	L	L	MW-104	3	PCB/Pesticides
5	7/1	11:25	L	L	MW-107	3	Pet. Prods./8100M
6	7/1	12:15	L	L	MW-108 MS/MSD	3	RCRA Metals
7	7/1	12:40	L	L	MW-109	3	pH/Flash/React
8	7/1	12:50	L	L	MW-116	3	418.1 - TRPH
9	7/1	1:15	L	L	TRIP BLANK	2	MS/MSD
10							MS/MSD
11							MS/MSD
12							MS/MSD
13							MS/MSD
14							MS/MSD
15							MS/MSD

Relinquished by (Signature): [Signature] Date: 6/15/20 Printed Name & Agent: LAID

Relinquished by (Signature): [Signature] Date: 6/15/20 Printed Name & Agent: B.W.D.

Received for Lab by (Signature): [Signature] Date: 6/15/20 Printed Name: [Signature]

Comments & Special Instructions: MS/MSD on MW-106 as per file folder 6/10/20 [Signature]

Number & Type of Containers: 2 250P 2 250M

Preservatives: 141 (V) Temp: 19°C

ETL-2107171009

**APPENDIX B**

## Groundwater Sampling Form

Active Industrial - Lindenhurst, NY

Project Number: 22000-0-0019 Phase/Task: 800 Well ID: MW101  
 Date: 6-24-02 Sampled By: EK  
 Sampling Time: 1605 Recorded By: EK  
 Weather: Sunny Coded Replicate No.: \_\_\_\_\_

Instrument Identification  
 Water Quality Meter(s): YSZ 600 XL Serial #: SN02A0274

Purging Information  
 Casing Material: PVC Purge Method: Peristaltic  
 Casing Diameter: 2" Screen Interval (ft bmp): 5-15'  
 Total Depth (ft bmp): 14.22 Pump Intake Depth (ft bmp): 11'  
 Depth to Water (ft bmp): 7.21 Purge time Start: 1510

**Field Parameter Measurements Taken During Purging**

Time	Minutes Elapsed	Rate (mL/min)	Volume Purged	Temp (°C)	pH (SI Units)	Conductivity (mS/cm)	REDOX (mV)	DO (mg/L)	Water Table (ft bmp)	Comments
1515	5	400		18.16	6.64	0.431	124.2	1.23	7.21	
1520	10	400		18.26	6.64	0.424	120.7	1.25	7.21	
1525	15	400		18.66	6.63	0.412	92.5	1.48	7.21	
1530	20	400		19.84	6.62	0.415	39.5	1.51	7.21	Air Bubble
1535	25	400		16.83	6.64	0.398	27.5	1.35	7.21	cleared
1540	30	400		16.85	6.62	0.380	25.2	1.09	7.31	
1545	35	400		17.01	6.61	0.380	23.2	1.08	7.21	
1550	40	400		16.97	6.61	0.377	8.7	1.02	7.21	
1555	45	400		16.99	6.62	0.367	-1.5	1.03	7.21	
1600	50	400		17.09	6.62	0.367	-4.6	1.03	7.21	
1605	55	400		17.16	6.62	0.367	-4.6	1.03	7.21	
1605	- sample									

Sample Condition Color: clear Odor: none Appearance: non-turbid  
 Sample Collection Parameter: VOCs 8260B Container: 40 ml glass No. 2 Preservative: HCl  
Dissolved Metals 250 ml plastic 1 none

Comments  
\* VOCs by bailer  
\* Dissolved metals by peristaltic and field filtered



# Groundwater Sampling Form

Active Industrial - Lindenhurst, NY

Project Number: 22000-0-0019 Phase/Task: 800 Well ID: MW-103  
 Date: 6-25 Sampled By: EK  
 Sampling Time: 850 Recorded By: EK  
 Weather: Cloudy - 70° F Coded Replicate No.: \_\_\_\_\_

Instrument Identification  
 Water Quality Meter(s): YSI 600XL Serial #: SNO2A0874

Purging Information  
 Casing Material: PVC Purge Method: peristaltic  
 Casing Diameter: 2 Screen Interval (ft bmp): 5-15'  
 Total Depth (ft bmp): 13.26' Pump Intake Depth (ft bmp): 10'  
 Depth to Water (ft bmp): 7.02 Purge time Start: 805

**Field Parameter Measurements Taken During Purging**

Time	Minutes Elapsed	Rate (mL/min)	Volume Purged	Temp (°C)	pH (SI Units)	Conductivity (mS/cm)	REDOX (mV)	DO (mg/L)	Water Table (ft bmp)	Comments
810	5	500		16.48	6.38	0.222	28.0	0.70	7.03	
815	10	500		16.58	6.40	0.241	17.0	0.82	7.03	
820	15	500		16.69	6.42	0.258	6.4	0.78	7.03	
825	20	500		16.59	6.45	0.256	5.1	0.74	7.03	
830	25	500		16.71	6.45	0.254	1.3	0.84	7.03	
835	30	500		16.72	6.47	0.259	-0.9	0.80	7.03	
840	35	500		16.73	6.48	0.262	-1.2	0.79	7.03	
845	40	500		16.45	6.48	0.259	-2.9	0.74	7.03	
850	- sample									

Sample Condition Color: clear Odor: none Appearance: not turbid  
 Sample Collection Parameter: VOCs by 8/2013 Container: 40 ml glass No. 2 Preservative: HCL  
Dissolved metals 250 ml plastic 1 None

Comments: odor, - VOCs collected by bailer  
de-gassing - Dissolved metals by peristaltic  
+ field filtered

### Groundwater Sampling Form

Active Industrial - Lindenhurst, NY

Project Number: 22000-0-0019 Phase/Task: 800 Well ID: MW-104  
 Date: 6-25-02 Sampled By: EK  
 Sampling Time: 1020 Recorded By: EK  
 Weather: Sunny Coded Replicate No.: \_\_\_\_\_

Instrument Identification  
 Water Quality Meter(s): YSE 6054E-B-M Serial #: SNO2A0874

Purging Information  
 Casing Material: PVC Purge Method: peristaltic  
 Casing Diameter: 2" Screen Interval (ft bmp): 5-15  
 Total Depth (ft bmp): 14.24 Pump Intake Depth (ft bmp): \_\_\_\_\_  
 Depth to Water (ft bmp): 7.19' Purge time Start: 920

**Field Parameter Measurements Taken During Purging**

Time	Minutes Elapsed	Rate (mL/min)	Volume Purged	Temp (°C)	pH (SI Units)	Conductivity (mS/cm)	REDOX (mV)	DO (mg/L)	Water Table (ft bmp)	Comments
925	5	500		16.63	6.41	0.174	176.4	5.20	7.19	
930	10	500		16.44	6.35	0.201	171.3	3.51	7.19	
935	15	500		16.78	6.35	0.206	169.0	3.09	7.19	
940	20	500		16.92	6.33	0.214	164.8	2.46	7.19	
945	25	500		16.76	6.37	0.218	159.5	1.82	7.19	
950	30	500		16.58	6.38	0.214	156.3	1.50	7.19	
955	35	500		16.59	6.39	0.211	154.2	1.30	7.19	
1000	40	500		16.59	6.39	0.216	150.0	1.12	7.19	
1005	45	500		16.62	6.40	0.213	153.2	0.66	7.19	
1010	50	500		16.59	6.39	0.212	150.2	0.64	7.19	
1015	55	500		16.59	6.39	0.214	150.2	0.66	7.19	

Sample Condition Color: none Odor: slight Appearance: neutral  
 Sample Collection Parameter: VOCs by 8260B Container: 40 ml glass No.: 2 Preservative: HCl  
Dissolved Metals 250 ml plastic 1 None

Comments: slight odor, No color - VOCs collected by bailer  
Degassing - Dissolved Metals by peristaltic  
field filtered















