

**ENVIRONMENTAL EASEMENT GRANTED PURSUANT TO ARTICLE 71, TITLE 36
OF THE NEW YORK STATE ENVIRONMENTAL CONSERVATION LAW**

THIS INDENTURE made this 8th day of APRIL, 2015, between Owner(s) KEYSpan GAS EAST CORPORATION, as successor-in-interest by name change to MARKETSPAN GAS CORPORATION, having an office at 175 East Old Country Road, Hicksville, County of Suffolk, State of New York (the "Grantor"), and The People of the State of New York (the "Grantee."), acting through their Commissioner of the Department of Environmental Conservation (the "Commissioner", or "NYSDEC" or "Department" as the context requires) with its headquarters located at 625 Broadway, Albany, New York 12233.

WHEREAS, the Legislature of the State of New York has declared that it is in the public interest to encourage the remediation of abandoned and likely contaminated properties ("sites") that threaten the health and vitality of the communities they burden while at the same time ensuring the protection of public health and the environment; and

WHEREAS, the Legislature of the State of New York has declared that it is in the public interest to establish within the Department a statutory environmental remediation program that includes the use of Environmental Easements as an enforceable means of ensuring the performance of operation, maintenance, and/or monitoring requirements and the restriction of future uses of the land, when an environmental remediation project leaves residual contamination at levels that have been determined to be safe for a specific use, but not all uses, or which includes engineered structures that must be maintained or protected against damage to perform properly and be effective, or which requires groundwater use or soil management restrictions; and

WHEREAS, the Legislature of the State of New York has declared that Environmental Easement shall mean an interest in real property, created under and subject to the provisions of Article 71, Title 36 of the New York State Environmental Conservation Law ("ECL") which contains a use restriction and/or a prohibition on the use of land in a manner inconsistent with engineering controls which are intended to ensure the long term effectiveness of a site remedial program or eliminate potential exposure pathways to hazardous waste or petroleum; and

WHEREAS, Grantor, is the owner of real property located at the address of 5 Bridge Street in the Village of Sag Harbor, Town of Southampton, County of Suffolk and State of New York, known and designated on the tax map of the County Clerk of Suffolk as tax map parcel numbers: District: 903 Section: 02 Block: 02 Lot: 10, being the same as that property conveyed to grantor by deed dated May 27, 1998 and recorded in the Suffolk County Clerk's Office in Liber 11902 at page 810. The property subject to this Environmental Easement (the "Controlled Property") comprises approximately 0.8 +/- acres, and is hereinafter more fully described in the Land Title Survey dated April 05, 2013, signed and certified on September 13, 2013 prepared by Kennon Surveying Services Inc., which will be attached to the Site Management Plan. The Controlled Property description is set forth in and attached hereto as Schedule A; and

WHEREAS, the Department accepts this Environmental Easement in order to ensure the protection of public health and the environment and to achieve the requirements for remediation established for the Controlled Property until such time as this Environmental Easement is extinguished pursuant to ECL Article 71, Title 36; and

NOW THEREFORE, in consideration of the mutual covenants contained herein and the terms and conditions of Order on Consent Index Number: D1-0002-98-11, Grantor conveys to Grantee a permanent Environmental Easement pursuant to ECL Article 71, Title 36 in, on, over, under, and upon the Controlled Property as more fully described herein ("Environmental Easement")

1. Purposes. Grantor and Grantee acknowledge that the Purposes of this Environmental Easement are: to convey to Grantee real property rights and interests that will run with the land in perpetuity in order to provide an effective and enforceable means of encouraging the reuse and redevelopment of this Controlled Property at a level that has been determined to be safe for a specific use while ensuring the performance of operation, maintenance, and/or monitoring requirements; and to ensure the restriction of future uses of the land that are inconsistent with the above-stated purpose.

2. Institutional and Engineering Controls. The controls and requirements listed in the Department approved Site Management Plan ("SMP") including any and all Department approved amendments to the SMP are incorporated into and made part of this Environmental Easement. These controls and requirements apply to the use of the Controlled Property, run with the land, are binding on the Grantor and the Grantor's successors and assigns, and are enforceable in law or equity against any owner of the Controlled Property, any lessees and any person using the Controlled Property.

A. (1) The Controlled Property may be used for:

**Restricted Residential as described in 6 NYCRR Part 375-1.8(g)(2)(ii),
Commercial as described in 6 NYCRR Part 375-1.8(g)(2)(iii) and Industrial
as described in 6 NYCRR Part 375-1.8(g)(2)(iv)**

(2) All Engineering Controls must be operated and maintained as specified in the Site Management Plan (SMP);

(3) All Engineering Controls must be inspected at a frequency and in a manner defined in the SMP;

(4) The use of groundwater underlying the property is prohibited without necessary water quality treatment as determined by the NYSDOH or the Suffolk County Department of Health to render it safe for use as drinking water or for industrial purposes, and the user must first notify and obtain written approval to do so from the Department;

(5) Groundwater and other environmental or public health monitoring must be performed as defined in the SMP;

(6) Data and information pertinent to Site Management of the Controlled Property must be reported at the frequency and in a manner defined in the SMP;

(7) All future activities on the property that will disturb remaining contaminated material must be conducted in accordance with the SMP;

[10/12]

(8) Monitoring to assess the performance and effectiveness of the remedy must be performed as defined in the SMP;

(9) Operation, maintenance, monitoring, inspection, and reporting of any mechanical or physical components of the remedy shall be performed as defined in the SMP;

(10) Access to the site must be provided to agents, employees or other representatives of the State of New York with reasonable prior notice to the property owner to assure compliance with the restrictions identified by this Environmental Easement.

B. The Controlled Property shall not be used for Residential purposes as defined in 6NYCRR 375-1.8(g)(2)(i), and the above-stated engineering controls may not be discontinued without an amendment or extinguishment of this Environmental Easement.

C. The SMP describes obligations that the Grantor assumes on behalf of Grantor, its successors and assigns. The Grantor's assumption of the obligations contained in the SMP which may include sampling, monitoring, and/or operating a treatment system, and providing certified reports to the NYSDEC, is and remains a fundamental element of the Department's determination that the Controlled Property is safe for a specific use, but not all uses. The SMP may be modified in accordance with the Department's statutory and regulatory authority. The Grantor and all successors and assigns, assume the burden of complying with the SMP and obtaining an up-to-date version of the SMP from:

Site Control Section
Division of Environmental Remediation
NYSDEC
625 Broadway
Albany, New York 12233
Phone: (518) 402-9553

D. Grantor must provide all persons who acquire any interest in the Controlled Property a true and complete copy of the SMP that the Department approves for the Controlled Property and all Department-approved amendments to that SMP.

E. Grantor covenants and agrees that until such time as the Environmental Easement is extinguished in accordance with the requirements of ECL Article 71, Title 36 of the ECL, the property deed and all subsequent instruments of conveyance relating to the Controlled Property shall state in at least fifteen-point bold-faced type:

This property is subject to an Environmental Easement held by the New York State Department of Environmental Conservation pursuant to Title 36 of Article 71 of the Environmental Conservation Law.

F. Grantor covenants and agrees that this Environmental Easement shall be incorporated in full or by reference in any leases, licenses, or other instruments granting a right to [10/12]

use the Controlled Property.

G. Grantor covenants and agrees that it shall, at such time as NYSDEC may require, submit to NYSDEC a written statement by an expert the NYSDEC may find acceptable certifying under penalty of perjury, in such form and manner as the Department may require, that:

(1) the inspection of the site to confirm the effectiveness of the institutional and engineering controls required by the remedial program was performed under the direction of the individual set forth at 6 NYCRR Part 375-1.8(h)(3).

(2) the institutional controls and/or engineering controls employed at such site:

- (i) are in-place;
- (ii) are unchanged from the previous certification, or that any identified changes to the controls employed were approved by the NYSDEC and that all controls are in the Department-approved format; and

(iii) that nothing has occurred that would impair the ability of such control to protect the public health and environment;

(3) the owner will continue to allow access to such real property to evaluate the continued maintenance of such controls;

(4) nothing has occurred that would constitute a violation or failure to comply with any site management plan for such controls;

(5) the report and all attachments were prepared under the direction of, and reviewed by, the party making the certification;

(6) to the best of his/her knowledge and belief, the work and conclusions described in this certification are in accordance with the requirements of the site remedial program, and generally accepted engineering practices; and

(7) the information presented is accurate and complete.

3. Right to Enter and Inspect. Grantee, its agents, employees, or other representatives of the State may enter and inspect the Controlled Property in a reasonable manner and at reasonable times to assure compliance with the above-stated restrictions.

4. Reserved Grantor's Rights. Grantor reserves for itself, its assigns, representatives, and successors in interest with respect to the Property, all rights as fee owner of the Property, including:

A. Use of the Controlled Property for all purposes not inconsistent with, or limited by the terms of this Environmental Easement;

B. The right to give, sell, assign, or otherwise transfer part or all of the underlying fee interest to the Controlled Property, subject and subordinate to this Environmental Easement;

5. Enforcement

A. This Environmental Easement is enforceable in law or equity in perpetuity by Grantor, Grantee, or any affected local government, as defined in ECL Section 71-3603, against the owner of the Property, any lessees, and any person using the land. Enforcement shall not be defeated because of any subsequent adverse possession, laches, estoppel, or waiver. It is not a defense in any action to enforce this Environmental Easement that: it is not appurtenant to an interest in real property; it is not of a character that has been recognized traditionally at common law; it imposes a negative burden; it imposes affirmative obligations upon the owner of any

[10/12]

interest in the burdened property; the benefit does not touch or concern real property; there is no privity of estate or of contract; or it imposes an unreasonable restraint on alienation.

B. If any person violates this Environmental Easement, the Grantee may revoke the Certificate of Completion with respect to the Controlled Property.

C. Grantee shall notify Grantor of a breach or suspected breach of any of the terms of this Environmental Easement. Such notice shall set forth how Grantor can cure such breach or suspected breach and give Grantor a reasonable amount of time from the date of receipt of notice in which to cure. At the expiration of such period of time to cure, or any extensions granted by Grantee, the Grantee shall notify Grantor of any failure to adequately cure the breach or suspected breach, and Grantee may take any other appropriate action reasonably necessary to remedy any breach of this Environmental Easement, including the commencement of any proceedings in accordance with applicable law.

D. The failure of Grantee to enforce any of the terms contained herein shall not be deemed a waiver of any such term nor bar any enforcement rights.

6. Notice. Whenever notice to the Grantee (other than the annual certification) or approval from the Grantee is required, the Party providing such notice or seeking such approval shall identify the Controlled Property by referencing the following information:

County, NYSDEC Site Number, NYSDEC Brownfield Cleanup Agreement, State Assistance Contract or Order Number, and the County tax map number or the Liber and Page or computerized system identification number.

Parties shall address correspondence to: Site Number: 152159
Office of General Counsel
NYSDEC
625 Broadway
Albany New York 12233-5500

With a copy to: Site Control Section
Division of Environmental Remediation
NYSDEC
625 Broadway
Albany, NY 12233

All notices and correspondence shall be delivered by hand, by registered mail or by Certified mail and return receipt requested. The Parties may provide for other means of receiving and communicating notices and responses to requests for approval.

7. Recordation. Grantor shall record this instrument, within thirty (30) days of execution of this instrument by the Commissioner or her/his authorized representative in the office of the recording officer for the county or counties where the Property is situated in the manner prescribed by Article 9 of the Real Property Law.

8. Amendment. Any amendment to this Environmental Easement may only be executed by
[10/12]

the Commissioner of the New York State Department of Environmental Conservation or the Commissioner's Designee, and filed with the office of the recording officer for the county or counties where the Property is situated in the manner prescribed by Article 9 of the Real Property Law.

9. Extinguishment. This Environmental Easement may be extinguished only by a release by the Commissioner of the New York State Department of Environmental Conservation, or the Commissioner's Designee, and filed with the office of the recording officer for the county or counties where the Property is situated in the manner prescribed by Article 9 of the Real Property Law.

10. Joint Obligation. If there are two or more parties identified as Grantor herein, the obligations imposed by this instrument upon them shall be joint and several.

IN WITNESS WHEREOF, Grantor has caused this instrument to be signed in its name.

Grantor: KEYSPAN GAS EAST CORPORATION

By:  

Print Name: Charles Willard

Title: Director, Site Inv + Perm Date: 4/14/2014

Grantor's Acknowledgment

STATE OF NEW YORK)

) ss:

COUNTY OF Onondaga)

On the 14th day of April, in the year 20 14, before me, the undersigned, personally appeared Charles Willard, personally known to me or proved to me on the basis of satisfactory evidence to be the individual(s) whose name is (~~are~~) subscribed to the within instrument and acknowledged to me that he/~~she/they~~ executed the same in his/~~her/their~~ capacity(~~ies~~), and that by his/~~her/their~~ signature(~~s~~) on the instrument, the individual(~~s~~), or the person upon behalf of which the individual(~~s~~) acted, executed the instrument.

Notary Public - State of New York

GAYL LYNN FRANSSEN
Notary Public, State of New York
No. 01FR6220451
Qualified in Onondaga County
Commission Expires Apr. 12, 2018

THIS ENVIRONMENTAL EASEMENT IS HEREBY ACCEPTED BY THE PEOPLE OF THE STATE OF NEW YORK, Acting By and Through the Department of Environmental Conservation as Designee of the Commissioner,

By:

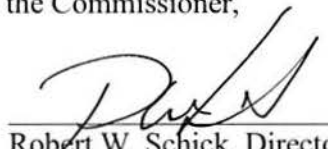
Robert W. Schick, Director
Division of Environmental Remediation

Grantee's Acknowledgment

STATE OF NEW YORK)
) ss:
COUNTY OF ALBANY)

On the 8th day of April, in the year 2015 before me, the undersigned, personally appeared Robert W. Schick, personally known to me or proved to me on the basis of satisfactory evidence to be the individual(s) whose name is (are) subscribed to the within instrument and acknowledged to me that he/she/ executed the same in his/her/ capacity as Designee of the Commissioner of the State of New York Department of Environmental Conservation, and that by his/her/ signature on the instrument, the individual, or the person upon behalf of which the individual acted, executed the instrument.

Notary Public - State of New York

David J. Chiusano
Notary Public, State of New York
No. 01CH5032146
Qualified in Schenectady County
Commission Expires August 22, 2016

SCHEDULE "A"
ENVIRONMENTAL EASEMENT
PROPERTY DESCRIPTION

PROPERTY DESCRIPTION

DISTRICT 903 - SECTION 02 - BLOCK 02 - LOT 10
5 BRIDGE STREET
VILLAGE OF SAG HARBOR, TOWN OF SOUTHAMPTON
SUFFOLK COUNTY, NEW YORK

ALL THAT CERTAIN PLOT, PIECE OR PARCEL OF LAND WITH THE BUILDINGS AND IMPROVEMENTS THEREON ERECTED, SITUATE, LYING AND BEING AT VILLAGE OF SAG HARBOR, TOWN OF SOUTHAMPTON, COUNTY OF SUFFOLK, AND STATE OF NEW YORK, BOUNDED AND DESCRIBED AS FOLLOWS:

BEGINNING AT A POINT MARKING THE INTERSECTION OF THE SOUTHERLY SIDE OF LONG ISLAND AVENUE AND THE EASTERLY SIDE OF BRIDGE STREET;

RUNNING THENCE FROM SAID POINT OF BEGINNING ALONG LAND NOW OR FORMERLY VAC'S ENTERPRISES, LLC THE FOLLOWING TWO (2) COURSES AND DISTANCES:

1. NORTH 61° 52' 03" EAST 161.03 FEET,
2. NORTH 67° 25' 53" EAST 90.09 FEET TO LAND NOW OR FORMERLY UNITED STATES POSTAL SERVICE;

RUNNING THENCE SOUTH 20° 52' 27" EAST ALONG LAND NOW OR FORMERLY UNITED STATES POSTAL SERVICE AND ALONG LAND NOW OR FORMERLY VILLAGE OF SAG HARBOR 112.31 FEET TO A POINT;

RUNNING THENCE ALONG LAND NOW OR FORMERLY VILLAGE OF SAG HARBOR THE FOLLOWING THREE (3) COURSES AND DISTANCES:

1. NORTH 68° 53' 53" EAST 2.19 FEET,
2. SOUTH 22° 11' 47" EAST 35.00 FEET,
3. SOUTH 69° 12' 13" WEST 50.23 FEET TO A MONUMENT FOUND AND LAND NOW OR FORMERLY FRB 1, LLC;

RUNNING THENCE SOUTH 69° 12' 13" WEST ALONG LAND NOW OR FORMERLY FBR 1, LLC 198.00 FEET TO THE EASTERLY SIDE OF BRIDGE STREET;

RUNNING THENCE NORTH 23° 00' 57" WEST ALONG THE EASTERLY SIDE OF BRIDGE STREET 124.03 FEET TO THE POINT OR PLACE OF BEGINNING.

CONTAINING AN AREA OF 0.7925 ACRES.

ENVIRONMENTAL EASEMENT

ALL THAT CERTAIN PLOT, PIECE OR PARCEL OF LAND WITH THE BUILDINGS AND IMPROVEMENTS THEREON ERECTED, SITUATE, LYING AND BEING AT VILLAGE OF SAG HARBOR, TOWN OF SOUTHAMPTON, COUNTY OF SUFFOLK, AND STATE OF NEW YORK, BOUNDED AND DESCRIBED AS FOLLOWS:

BEGINNING AT A POINT MARKING THE INTERSECTION OF THE SOUTHERLY SIDE OF LONG ISLAND AVENUE AND THE EASTERLY SIDE OF BRIDGE STREET;

RUNNING THENCE FROM SAID POINT OF BEGINNING ALONG LAND NOW OR FORMERLY VAC'S ENTERPRISES, LLC THE FOLLOWING TWO (2) COURSES AND DISTANCES:

1. NORTH 61° 52' 03" EAST 161.03 FEET,
2. NORTH 67° 25' 53" EAST 90.09 FEET TO LAND NOW OR FORMERLY UNITED STATES POSTAL SERVICE;

RUNNING THENCE SOUTH 20DEG. 52MIN. 27SEC. EAST ALONG LAND NOW OR FORMERLY UNITED STATES POSTAL SERVICE AND ALONG LAND NOW OR FORMERLY VILLAGE OF SAG HARBOR 112.31 FEET TO A POINT;

RUNNING THENCE ALONG LAND NOW OR FORMERLY VILLAGE OF SAG HARBOR THE FOLLOWING THREE (3) COURSES AND DISTANCES:

1. NORTH 68° 53' 53" EAST 2.19FEET,
2. SOUTH 22° 11' 47" EAST 35.00FEET,
3. SOUTH 69° 12' 13" WEST 50.23 FEET TO A MONUMENT FOUND AND LAND NOW OR FORMERLY FRB 1, LLC;

RUNNING THENCE SOUTH 69° 12' 13" WEST ALONG LAND NOW OR FORMERLY FBR 1, LLC 198.00 FEET TO THE EASTERLY SIDE OF BRIDGE STREET;

RUNNING THENCE NORTH 23° 00' 57" WEST ALONG THE EASTERLY SIDE OF BRIDGE STREET 124.03 FEET TO THE POINT OR PLACE OF BEGINNING.

CONTAINING AN AREA OF 0.7925 ACRES.

Date

Kenny L. Kennon, P.L.S.
N.Y. License No. 50171

SURVEY (Attached)

RECOVERING AT A POINT MARKING THE INTERSECTION OF THE SOUTHERLY SIDE OF LONG ISLAND AVENUE AND THE EASTERLY SIDE OF 138TH STREET.

PLANNED IMPROVEMENTS FROM EAST POINT OF RECOVERING ALONG LAND NOW ON FORTMYER TRACT DEVELOPMENTS, LLC THE FOLLOWING TWO (2) CORNERS AND DISTANCES:

BEARING BEING SOUTH 20° 54' 27" EAST ALONG LAND NOW ON FOWLER'S UNITED STATES PATENT, SEVENTH AND EIGHTH LOTS NOW ON FOWLER'S ALLIANCE OF THE NATION 11.31 FEET TO A POINT PLACING BEARING ALONG LAND NOW ON FOWLER'S ALLIANCE OF THE NATION THE FOLLOWING BEING (2) COURSES AND DISTANCES.

1. NORTH 66° 55' EAST 2.18 FEET,
2. SOUTH 27° 11' EAST 35.00 FEET,
3. SOUTH 69° 12' 13" WEST 50.15 FEET TO A WORKMAN FOUNDED AND LARGELY NOW ON "CONCRETE" PILING,
LOC.

MEASURED THECE SOUTH 44° 12' 12" WEST ALONG LAND NOW OF FORDNEY FIRM 1, LLC 118.00 FEET TO THE EASTERN SIDE OF BRIDGE STREET.

MEASURING INCECE NORTH 22° 05' 31" WEST ALONG THE EASTERN SIDE OF BRIDGE STREET 124.03 FEET TO THE POINT OF PLATE OF RECORD.

CONTAINING AN AREA OF 0.7925 ACRES

ALL TRAIL CRIMINAL PACE ON PARCEL OF LAND WITH THE BUILDING AND IMPROVEMENTS DESCRIBED HEREIN, SITUATE, LYING AND BEING IN VILLAGE OF SAG HARBOR, TOWN OF SOUTHARD, COUNTY OF SOUTHERN, AND STATE OF NEW YORK, BOUND AND DESCRIBED AS FOLLOWS:

BEINGING AT A POINT SHOWING THE INTERSECTION OF THE SOUTHERLY SIDE OF LONG ISLAND AVENUE AND THE EASTERLY SIDE OF CROFT STREET;

MEASURING THENCE FROM SAID POINT OF BEGINNING ALONG LAND NOW ON FORSAKEN VACU ENTIRELY, LLC THE FOLLOWING TWO (2) SIDES AND DISTANCES:

L. NORTH 81° 32' 03" EAST 161.03 FEET,
S. NORTH 87° 25' 57" EAST 96.98 FEET TO LAND NOW ON FOWLER'S UNITED STATES POSTAL SERVICE.
MEASURED THENCE SOUTH 20°05' 27"EAST 279.1C EAST ALONG LAND NOW ON FOWLER'S UNITED STATES
POSTAL SERVICE AND ALONG LAND NOW ON FOWLER'S WILDER OF S&W HARBOR 112.31 FEET TO A POINT;
THENCE INDEED ALONG LAND NOW ON FOWLER'S WILDER OF S&W HARBOR THE FOLLOWING SHIEL (3)
POUNDS AND DISTANCES

1 NORTH 68 S3 S3 EAST 2.10 AC.
2.50/76 22' 17" EAST 25.00 FT.
3.50/76 89' 12' 15" WEST 30.33 FEET TO A WIRELESS FENCE AND LAND NOW ON PAPER + TRG C.
LLC

BOUNDARY BEGINS AT 88° 12' 12" WEST ALONG LAND NOW OWNED BY FISH & LUG, 194.00 FEET TO
 THE EASTERN CORNER OF BROOK STREET.
 BOUNDARY BEGINS AT 15 OF 31" WEST ALONG THE EASTERN SIDE OF BROOK STREET 124.00 FEET TO
 THE POINT ON PLAT OF BROWN.
 CONTAINING AN AREA OF 0.7113 ACRES.

MINING AND BEING THE SAME PROPERTY AS THAT DESCRIBED IN DEED DATED MAY 27, 1928 FROM LONG ISLAND LIGHTING COMPANY TO MANHATTAN GAS CORPORATION, RECORDED IN BOOK 11922 AT PAGE 810 RECORDED IN THE SUFFOLK COUNTY CLERK'S OFFICE ON JULY 6, 1926

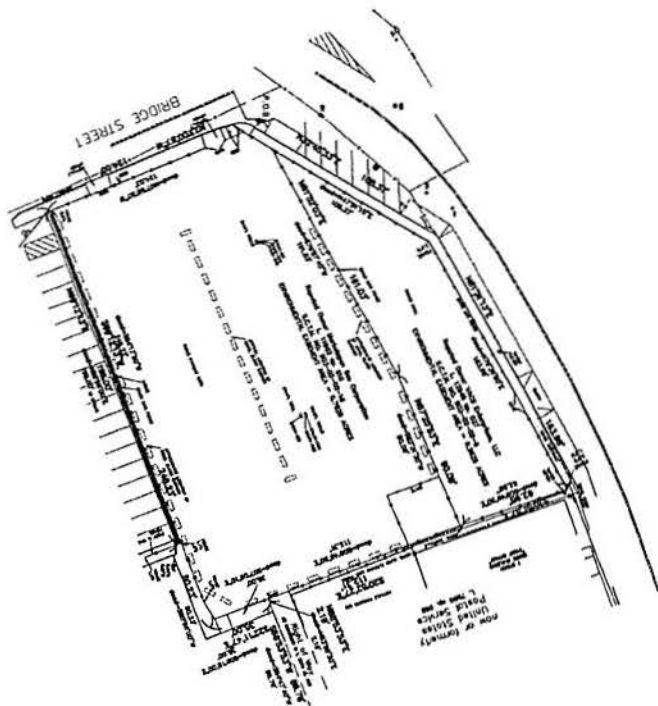

- [illegible]

[illegible]

REC- 12-29-13 PER REVIEW COMMENTS
REV- 08-13-13 PER REVIEW COMMENTS
SOURCES: WELLS, COMPLETE TO
CORRELATION OF THIS MAP.

P FOR
 CRD
 - BLOCK 02 - LOT 10
 TRACT
 COUNTY OF SOUTHAMPTON
 , NEW YORK
 HARBOR WOP

THE ENGINEERING AND MATERIALS CONTROLS FOR THIS EXISTING AIR SELECTION IN MORE DETAIL IN THE SUE BE DAMMANN PUMP (SPN). A COPY OF THE SUP MUST BE OBTAINED FROM THE NEW YORK STATE DEPARTMENT OF ENVIRONMENTAL CONSERVATION, DIVISION OF ENVIRONMENTAL REDEMPTION, SITE CONTROL SECTION, 610 BROADWAY, ALBANY, N.Y. 12242 OR AT enviroinfo@state.ny.us

ONLINE JOURNAL OF INSTITUTIONAL CONTROLS

- [illegible]

ADDITIONAL EASTWENT AREA ACCESS

THE DEC OR THEIR AGENT MAY ACCESS THE ENVIRONMENTAL
EASEMENT AREA AS SHOWN HEREON THROUGH ANY EXISTING
STREET ACCESS OR BUILDING WALKWAYS/CROSS ACCESS POINT

THE PUBLISHER OF THIS MAP WANTS TO PREPARE AN INDIVIDUAL MAP OF LOT 10, BASED ON ORIENTAL SURVEY DATED 1867, FOR NATIONAL GRID A11. SELECT OF SMC HARPER - CLERKED SURVEY, PREPARED BY HOWARD W. YOUNG, M.T.S.L.S. NO. 45, DATED 04-17-2012, AND WAS PREPARED TO ASSIST REGULATORY AGENCY REVIEW. NO RESEARCH OR SURVEYS WERE CONDUCTED TO ASSIST IN THE PREPARATION OF THIS MAP.

SURETY MAP FOR
NATIONAL CRD
DISTRICT 903 - SECTION 02 - BLOCK 02 - LOT 10
5 BROAD STREET
VILLAGE OF SAG HARBOR, TOWN OF SOUTHAMPTON
SUFFOLK COUNTY, NEW YORK

KSS
KENNON SURVEYING SERVICES INC.
3 PRINCE'S ROAD, SUITE
410, BIRCH MOUNTAIN, N.C. 28701
919/286-4444
WWW.KSSURVEYING.COM

04-05-13	$t^{\circ} = 30^{\circ}$	$t_{\text{exp}} = 2 \text{ h}$	$t_{\text{off}} = 1 \text{ h}$
----------	--------------------------	--------------------------------	--------------------------------