

ADDITIONS/CHANGES TO REGISTRY: SUMMARY OF APPROVALS

Current Classification NEW SITE Volunteer Yes _____ No _____
Sign (7) below

Approvals:

Completion Checklist for Registry Sites

OWNER NOTIFICATION LETTER?	<input checked="" type="checkbox"/>	_____	<u>10-6-03</u>
ADJACENT PROPERTY OWNER NOTIFICATION LETTER?	<input checked="" type="checkbox"/>	_____	<u>10-24-03</u>
ENB / LEGAL NOTICE SENT? (For Deletion Only)	<input type="checkbox"/>	_____	<u>Corrected Ltr. 11-6-03</u>
COMMENTS SUMMARIZED / PLACE IN REPOSITORY?	<input type="checkbox"/>	_____	_____
FINAL NOTIFICATION SENT TO OWNER? (For Deletion Only)	<input type="checkbox"/>	_____	_____



STATE OF NEW YORK DEPARTMENT OF HEALTH

Flanigan Square, 547 River Street, Troy, New York 12180-2216

Antonia C. Novello, M.D., M.P.H., Dr.P.H.
Commissioner

Dennis P. Whalen
Executive Deputy Commissioner

June 23, 2003

Mr. Dennis Farrar, Acting Chief
Site Control Section
New York State Department of Environmental Conservation
Division of Environmental Remediation
Bureau of Hazardous Site Control, Room 252
50 Wolf Road
Albany, New York 12233-7010

Re: Registry Site Classification Decision
Country Cleaners/Pamper Cleaners
Site No. 152531
Huntington, Suffolk County

Dear Mr. Farrar,

Staff reviewed the Classification Package for Country Cleaners (Site No. 152531) in Huntington, Suffolk County. According to the information presented in the package, the site soil and groundwater is contaminated with tetrachloroethylene (PCE) and PCE degradation products. On-site soil to the rear of the dry cleaning facility contained 1.6 parts per million (ppm) PCE and sediments collected from an on-site storm drain contained 12,000 ppm PCE. Groundwater samples collected from on-site and off-site monitoring wells contained a maximum concentration of 3.5 ppm PCE. Remedial activities conducted in December 2001 did not successfully mitigate on-site soil contamination. The site requires additional investigation to determine the location and extent of site-related contamination and to evaluate potential human exposures.

Based on the information provided, I concur with listing the site as a Class 2 site. The signed Site Investigation Information form and a list of the water suppliers in the area are enclosed. Please notify these water suppliers of this addition to the Registry. If you have any questions or concerns, please contact Rich Fedigan at (518) 402-7880.

Sincerely,

Gary A. Litwin
Director

Bureau of Environmental Exposure Investigation

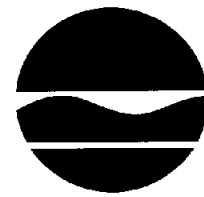

Erin M. Crotty
Commissioner

MEMORANDUM

TO: C. Vasudeavan Remedial Bureau A
Regional Hazardous Waste Remediation Engineer
D. Dana, DEE
G. Litwin, DOH, Bureau of Environmental Exposure Investigation

FROM: Dennis Farrar, Chief, Site Control Section, BHSC, DER

SUBJECT: Review of Classification Package for Site # 152531
Country Cleaners aka Pampers Cleaners

DATE: April 25, 2003

The attached new "Registry Site Investigation Information Form" with supporting documentation is attached for your review and approval.

If acceptable, sign at the bottom of the form (Box #17) and return within 30 calendar days.

If unacceptable, please return with an explanation of your position in a separate memo or letter.

An important part of your review should include modifying, if necessary, the statement in Block 11 (Conclusion) for Classification Decision of the Investigation Form so that it can be used in all appropriate notification documentation (i.e., ENB, owner and adjacent property owner notification letter, and newspaper legal notice.

Please keep the supporting documentation for your records.

Attachment(s)



MEMORANDUM

TO: Dennis Farrar, Chief Site Control Section

FROM: Walter Parish, Region 1

SUBJECT: Country Cleaners, Huntigton, Suffolk County

DATE: March 13, 2003

Attached for your review is proposed Class 2 listing package for the above referenced facility. If you have any questions, please contact Girish Desai at 631-444-0243.



INTER-OFFICE SPEED MEMO

To: Ray Cowen & Rob Schneck

Date: 3-4-03

From: Walter Parish

Subject: Country cleaners, Huntington
Proposed class 2 listing Package

Proposal: The disposal of tetrachloroethene during the
dry cleaning operations at the site led to the
contamination of on-site soils and on-site and off-site
groundwater, above NYS Standards.

AGREE WITH PROPOSAL?			INITIAL, DATE & REMARKS
	YES	NO	
W. Parish	<input checked="" type="checkbox"/>	<input type="checkbox"/>	<u>W/P 3/4/03 I concur with the</u> <u>recommendation to list this</u> <u>site.</u>
R. Schneck	<input checked="" type="checkbox"/>	<input type="checkbox"/>	<u>RS 3/6/03</u>
R. Cowen	<input checked="" type="checkbox"/>	<input type="checkbox"/>	<u>RC 3/10/03</u>



RECEIVED

SITE INVESTIGATION INFORMATION

SEP 18 2003

1. SITE NAME Country Cleaner		2. SITE NUMBER 1-52-531	3. TOWN/CITY/VILLAGE Huntington	4. COUNTY Suffolk
5. REGION 1		6. CLASSIFICATION CURRENT [] PROPOSED [2] MODIFICATION		
7. LOCATION OF SITE (Attach U.S.G.S. Topographic Map showing site location)				
a. Quadrangle Huntington		b. Site Latitude 40 52 26"		Site Longitude 73 27'32"
c. Tax Map Number(s) District: 400 Section:69 Block 3 Lot:1			d. Site Street Address 410 West Main Street, Huntington, NY 11743	
8. BRIEFLY DESCRIBE THE SITE (Attach site map showing disposal/sampling locations)				
<p>This site is located at the south east (SE) corner of the intersection of West Main Street and Hillside Avenue, Huntington. The site contains a single occupancy building and is used for a dry cleaning operation. The source of contamination is located in a narrow yard at the rear (southside) of the property. The east side of the yard is unpaved. Tetrachloroethylene (PCE) contamination was found in the soil beneath a condensate pipe at the SE corner of the building and in a nearby storm drain. Under the order and oversight from the Suffolk County Department of Health services (SCDHS), the owner conducted remediation of the storm drain and removal of 2' of soil from the unpaved area. Approximately 1000 gallons of oily water and 36 tons of contaminated soils were removed to a depth of 26' below grade from the storm drain in December 2001. Although the results of latest sampling indicate PCE contamination remaining in the location near the SE corner of the building. An old floor drain was found in the boiler room during the course of remediation and an investigation of this floor drain and associated piping was not possible due to the fact that a new boiler was placed directly over it. This floor drain represents a possible point of past discharges that may have contributed to the groundwater contamination believed to be originating from the site. The ground water samples from the on-site and off-site monitoring wells show the presence of PCE and its degradation products.</p>				
a. Area 0.2 acres b. Completed: () Env. Property Assessment () PSA (x) SI () ESI () IRM () RI/FS () Construction () O&M () Other				
9. HAZARDOUS WASTE DISPOSED (Include EPA Hazardous Waste Numbers)				
Tetrachloroethylene (PCE) (F002)				
10. ANALYTICAL DATA AVAILABLE				
a. () Air (x) Groundwater () Surface Water (x) Sediment (X) Soil () Waste () Leachate () EPTox () TCLP				
b. Contravention of Standards or Guidance Values				
	Soils/Sludge	(Maximum Concentration detected in ppb)	Groundwater on-site (in ppb)	Groundwater off-site (in ppb)
Tetrachloroethene (PCE)	12,000,000		1,888	3,500
Cis-1,2-Dichloroethene	37,000		17.7	583
Trichloroethene	210		97.5	398
11. CONCLUSION				
<p>Results of soils and groundwater samples indicate the presence of PCE and degradation products in on-site soils and on-site and and off-site groundwater. The groundwater contamination from this facility appears to have spread to the Getty Service station as early as 1996. This site is a significant threat to the environment. Groundwater contamination has affected a sole source aquifer.</p>				
a. Institutional Controls (IC) Required? () Y () N b. If yes, identify c. Are these ICs in place and verified? () Y () N				
12. SITE IMPACT DATA				
a. Nearest Surface Water: Distance 6800 ft.		Direction North	Class SA	
b. Groundwater: Depth 48 ft.		Flow Direction North-Northeast	(x) Sole Source () Primary () Other High-Yield Aquifer	
c. Water Supply: Distance 4000ft.(S71533)		Direction North	Active () Yes (X) No	
d. Nearest Building: Distance On-site		Direction N/A	Use Dry Cleaning Facility	
e. Documented fish or wildlife mortality?		() Y (x) N	h. Exposed hazardous waste? () Y (x) N	
f. Impact on special status fish or wildlife resource?		() Y (x) N	i. If proposed Classification is 2, Priority? () 1 () 2 (x) 3	
g. Controlled Site Access?		() Y (x) N	j. EPA ID# NYD077516979 Impact Score 185	
13. SITE OWNER'S NAME Steven Birchell, KBK Huntington Corp.		14. ADDRESS P O Box 676, Ruckersville, VA 22968		15. TELEPHONE NUMBER
16. PREPARER Girish Desai Signature Date Girish Desai, EE-2, DER, Region One Name, Title, Organization		17. APPROVER Robert L. Marino Signature Date ROBERT L. MARINO, Director, DTS Name, Title, Organization		

NEW YORK STATE DEPARTMENT OF ENVIRONMENTAL CONSERVATION
Division of Environmental Remediation
Inactive Hazardous Waste Disposal Report

Site Name: Country Cleaners	Site Code: 1-52-0
Class Code: Class 2	EPA ID: NYD 077516979
Region: 1	
County: Suffolk	City: Huntigton
Address: 410 West Main Street	Zip: 11743
Latitude: 40 52' 26"	Longitude: 73 27' 32"
Site Type: Structure	Estimated Size: 0.2 Acres

Site Owner / Operator Information:	
Current Owner(s)	Name: Steven Birchell
Current Owner(s)	Address: P O Box 676 / Ruckersville / VA 22968
Owner(s)	During Disposal: KBK Huntigton Corp.
Operator(s)	During Disposal: Country Cleaners
Stated Operator(s)	Address: 410 West Main Street / Huntigton / NY 11743
Hazardous Waste Disposal Period:	From: Unknown To: Unknown

Site Description:
This site is located at the southeast (SE) corner of the intersection of west Main Street and Hillside Avenue, Huntigton. The site contains a single occupancy building and housing a dry cleaning store. The source of contamination is located in a narrow yard at the rear (southside) of the property. The east side of the yard is unpaved. Tetrachloroethylene (PCE) contamination was found in the soil beneath a condensate pipe at the SE corner of the building and in a nearby storm drain. Under the order and oversight from the Suffolk County Department of Health services (SCDHS), the owner conducted remediation of the storm drain and removal of 2' of soil from the unpaved area. Approximately 1000 gallons of oily water and 36 tons of contaminated soils/sedimnents were removed to a depth of 26' below grade from the storm drain in December 2001. Although the results of latest sampling indicate PCE contamination remaining in the location near the SE corner of the building. An old floor drain was found in the floor of the boiler room during the course of remediation and an investigation of this floor drain and associated piping was not possible due to the fact that a new boiler was placed directly over it. This floor drain represents a possible point of past discharges that may have contributed to the groundwater contamination believed to be originating from the site. The ground water samples from the on-site and off-site monitoring wells show the presence of PCE and its degradation products.

Confirmed Hazardous Waste Disposal: tetrachloroethene (F002 Waste)	Quantity: unknown
--	-----------------------------

Analytical Data Available for: Soil Sediment Groundwater	
Applicable Standards Exceeded in: Groundwater Drinking Water	
<i>Geotechnical Information:</i>	
Soil/Rock Type: Sand and gravel	Depth to Groundwater: 48 feet

Legal Action:	Type:	Status:
Remedial Action:		Nature of Action:

Assessment of Environmental Problems:
Soil and groundwater data suggest that PCE was disposed or spilled at this facility. Some remediation of soils was conducted. Further investigation is needed for the site and off-site groundwater plume.

Assessment of Health Problems:

[Internal DER](#)

Site Priority Ranking

[Priority Ranking Home Page](#)

[Search for Site Ranking](#)

Please Update the form fields or revise the answers to the questions given your current knowledge of the site.

(Note:For assistance in answering the questions please put your mouse pointer over the Question Number on the left hand side of the table. If you need to review the General Instructions click [HERE](#) and a separate window will pop up. DO NOT go back to the the Priority Ranking Home Page you may lose data or any changes you've made.)

Division of Environmental Remediation - Priority Ranking Scoresheet			
Scored By:	<div>blpine</div>	(Novell username)	Scoring Date: 09/10/2003
Site Number:(EXAMPLES)	<div>152531</div>		
Lead Bur./Reg.:	<div>Region 1</div>	Lead Sect.:	<div>Select A Lead Section</div>
Project Type:	<div>Site Characterization</div>		
Program Type(Check all that apply)	<div>Site Located in Reg.: 1 (Not Necessary if Region Lead)<div><input type="checkbox"/> VCP <input type="checkbox"/> BF <input checked="" type="checkbox"/> HW <input type="checkbox"/> SP</div></div>		

FUND SOURCE(Check all that Apply)		<input checked="" type="checkbox"/> PRP <input type="checkbox"/> EPA <input type="checkbox"/> Loc. Gov. <input checked="" type="checkbox"/> SSF <input type="checkbox"/> OPA 90 <input type="checkbox"/> T3 <input type="checkbox"/> VC <input type="checkbox"/> BF <input type="checkbox"/> OSF	
SITE SETTING(select all that may apply)		<input checked="" type="checkbox"/> URBAN <input type="checkbox"/> RURAL <input type="checkbox"/> SUBURBAN <input checked="" type="checkbox"/> COMMERCIAL <input type="checkbox"/> INDUSTRIAL <input type="checkbox"/> RESIDENTIAL	

Site Priority Scoring				
Prioritization Factors		Yes/No	Impact FACTOR Value	Cummulative SCORE
1	Public or Community Water Supply Impact detected?	<input type="radio"/> Yes <input checked="" type="radio"/> No	100	<input type="text" value="0"/>
2	Private Water Supply Impact detected?	<input type="radio"/> Yes <input checked="" type="radio"/> No	100	<input type="text" value="0"/>
3	Dermal or Ingestion Impact detected?	<input type="radio"/> Yes <input checked="" type="radio"/> No	100	<input type="text" value="0"/>
4	Vapor/Inhalation Impact detected?	<input type="radio"/> Yes <input checked="" type="radio"/> No	100	<input type="text" value="0"/>
5	Ecosystem impacted?	<input type="radio"/> Yes <input checked="" type="radio"/> No	90	<input type="text" value="0"/>
6	Surface water or utilities impacted?	<input type="radio"/> Yes <input checked="" type="radio"/> No	75	<input type="text" value="0"/>
7	Public or Community Water Supply threatened?	<input checked="" type="radio"/> Yes <input type="radio"/> No	75	<input type="text" value="75"/>
8	Private Water Supply threatened?	<input type="radio"/> Yes <input checked="" type="radio"/> No	60	<input type="text" value="75"/>
9	Dermal or Ingestion impact threatened?	<input type="radio"/> Yes <input checked="" type="radio"/> No	60	<input type="text" value="75"/>

10	Vapor/Inhalation impacts threatened?	<input type="radio"/> Yes	<input checked="" type="radio"/> No	60	<input type="radio"/> 0	<input type="radio"/> 75
11	Ecosystem threatened?	<input type="radio"/> Yes	<input checked="" type="radio"/> No	50	<input type="radio"/> 0	<input type="radio"/> 75
12	Surface water or utilities threatened?	<input type="radio"/> Yes	<input checked="" type="radio"/> No	50	<input type="radio"/> 0	<input type="radio"/> 75
13	Highly Persistent or Mobile Material?	<input type="radio"/> Yes	<input checked="" type="radio"/> No	50	<input type="radio"/> 0	<input type="radio"/> 75
14	Primary or High Yield Aquifer impacted?	<input checked="" type="radio"/> Yes	<input type="radio"/> No	50	<input type="radio"/> 50	<input type="radio"/> 125
15	Material Acutely Toxic or Significant Potential Human Health Threat?	<input type="radio"/> Yes	<input checked="" type="radio"/> No	40	<input type="radio"/> 0	<input type="radio"/> 125
16	Extensive Areal Extent?	<input type="radio"/> Yes	<input checked="" type="radio"/> No	30	<input type="radio"/> 0	<input type="radio"/> 125
17	Groundwater impacted?	<input checked="" type="radio"/> Yes	<input type="radio"/> No	20	<input type="radio"/> 20	<input type="radio"/> 145
18	Contaminated soils?	<input checked="" type="radio"/> Yes	<input type="radio"/> No	20	<input type="radio"/> 20	<input type="radio"/> 165
19	Significant Volume/Concentration of Contaminant?	<input checked="" type="radio"/> Yes	<input type="radio"/> No	20	<input type="radio"/> 20	<input type="radio"/> 185
IMPACT SCORE						
UPDATE		Cancel				

Note: To update the Ranking score sheet click on the button labeled UPDATE.

[Return to Search Results](#) If you have problems or questions please contact Eric Obrecht (518.402.9756) or email: erobrech@gw.dec.state.ny.us

CLASSIFICATION WORKSHEET

site: Country Cleaners County: Suffolk Region One

1. Hazardous waste disposed? ☒ Y (to 2) ☐ N (Stop) ☐ U (Stop)
2. Consequential amount of hazardous waste? ☒ Y (to 3) ☐ N (Stop) ☐ U (Stop)
3. Part 375-1.4(a)(1) applies? ☐ N (to 4) ☐ U (to 4)
☒ Y (as checked below; Class 2; to 5)

- | | |
|---|--|
| <input type="checkbox"/> a. endangered or threatened species | <input type="checkbox"/> d. fish, shellfish, crustacea or wildlife |
| <input type="checkbox"/> b. streams, wetlands or coastal zone | <input type="checkbox"/> e. fire, spill, explosion or toxic reaction |
| <input type="checkbox"/> c. bioaccumulation | <input checked="" type="checkbox"/> f. proximity to people or water supplies |

4. Part 375-1.4(a)(2) applies? ☐ N (Cl 3; Stop) ☐ U (Cl 2a; Stop)
☒ Y (Class 2; to 5)

5. Factor(s) considered in making this determination: Hazardous waste disposal has caused groundwater contamination in excess of NYS standards in a sole source drinking water aquifer. The groundwater contamination from this facility appears to have spread off-site. Investigation of source areas on the site and groundwater must be undertaken

SUMMARY

Consequential Hazardous Waste	<input checked="" type="checkbox"/> Yes	<input type="checkbox"/> No	<input type="checkbox"/> Unknown
Significant Threat	<input checked="" type="checkbox"/> Yes	<input type="checkbox"/> No	<input type="checkbox"/> Unknown
Proposed Classification	<u>2</u>		
Site Number	<u> </u>		

4/8/03
Date

Girish Dasai, EE-2
Signature and Title

West main St.

Country Cleaners

Chiller

Water cooling tank
Asphalt

Fence

Fence

2

1-W3/10-20
2-W3/10-20-10

4W3/10-20
50'1
P/E tested 10/20/96
Store Drain 50'1

NORTH

Boiler room

Boiler room

Sturdy 10'10-10-20

Country Cleaners
410 W. Main St.
Huntington

ORGANIC & FLASHPOINT ANALYSIS OF INDUSTRIAL & HAZARDOUS MATERIALS

Lab. No. IW 1097069 Date Completed 10/30/97
Field No. 1-WS-10-20 EPA Method 8260/1010/
Name Country Cleaners, 410 W. Main St. Huntington Storm Drain
Remarks

Compound	ppb	Compound	ppb
*Indicates 597 Compounds			
[X] Purgeable Halocarbons 2/Aromatics			
*1,1 - Dichloroethene.....		tert-Butyl methyl ether.....	
*Methylene Chloride.....		*Benzene.....	
*Freon 113.....		*Toluene.....	
(Trichlorotrifluoroethane)		*Chlorobenzene.....	
*trans-1,2-Dichloroethene....		*Ethylbenzene.....	
*1,1-Dichloroethane.....		*Xylene(s).....	
*cis-1,2 Dichloroethene.....	510	*Styrene.....	
*Bromochloromethane.....		*Isopropylbenzene.....	
*Chloroform.....		Bromobenzene.....	
2,2-Dichloropropane.....		Chlorotoluene(s).....	
*1,2-Dichloroethane.....		n-Propylbenzene.....	
*1,1,1-Trichloroethane.....		p-Ethyltoluene.....	
1,1-Dichloropropene.....		1,3,5-Trimethylbenzene.....	
*Carbon Tetrachloride.....		tert-Butylbenzene.....	
*Dibromomethane.....		1,2,4-Trimethylbenzene.....	
*1,2-Dichloropropane.....		*1,3-Dichlorobenzene.....	
*Bromodichloromethane.....		*1,4-Dichlorobenzene.....	
(Dichlorobromomethane)		sec-Butylbenzene.....	
*Trichloroethene.....	170	p-Isopropyltoluene.....	
*cis-1,3-Dichloropropene....		*1,2-Dichlorobenzene.....	
*trans-1,3-Dichloropropene...		n-Butylbenzene.....	
*1,1,2-Trichloroethane.....		p-Diethylbenzene.....	
*1,3-Dichloropropane.....		1,2,4,5-Tetramethylbenzene...	
*Dibromochloromethane.....		*1,2,4-Trichlorobenzene.....	
(Chlorodibromomethane)		*Naphthalene.....	
*1,2-Dibromoethane.....		1,2,3-Trichlorobenzene.....	
*Tetrachloroethene.....		[] Purgeable Halocarbons 1	
*1,1,1,2-Tetrachloroethane...		*Chlorodifluoromethane.....	
*Bromoform.....		*Dichlorodifluoromethane.....	
*1,1,2,2-Tetrachloroethane...		*Trichlorofluoromethane.....	
1,2,3-Trichloropropane.....		*Vinyl Chloride.....	
*1,2-Dibromo-3-chloropropane.	<100	*Chloromethane.....	
*Hexachlorobutadiene.....		(Methyl Chloride)	
*Acetone.....	<500	Bromomethane.....	
*Methyl ethyl ketone.....	<500	(Methyl Bromide)	
*Methyl isobutyl ketone.....	<500	Chloroethane.....	
		[] Miscellaneous	
		*Vinyl acetate.....	
		*2-Chloroethyl vinyl ether	

RESULTS ARE <40ppb FOR PURGEABLE
HALOCARBONS 2/AROMATICS
EXCEPT WHERE NOTED.

Analyst

[] Flash Point

Pensky-Martens Closed Cup Flash Point °C- °F

Analyst

Field Number: 2-WS-10-20 Laboratory Number I W 1097 070
Collected By: W. Skeath Assisted By: B. Cook
Affiliation: SLDH Date: 10/20/97 Time: 2:50
Facility/Name: County Clearing
Location: 410 W. Main St. Huntington
Point of Collection: Storm Drain
Remarks: Sludge

Analysis Requested (By Department)

Air Pollution

- ☐ Volatile Organic Hydrocarbons
☐ Asbestos (Bulk)

Hazardous Materials (Organics)

- ☐ Purgeable Halocarbons 1 (EPA 8260)
☒ Purgeable Halocarbons 2/ Aromatic Hydrocarbons (EPA 8260)
Preservation ☐ HCl ☒ Cooled to 4°C
Level of Detection ☒ 140 ppb ☐ 4 ppb
☐ Flash Point (EPA 1010)
☐ Pesticides
Specify Type: _____
☐ TCLP
☐ Other _____

Industrial Waste (Inorganics)

- ☒ Metals ☐ Preserved
☐ Chromium (Hexavalent)
☐ E P Toxicity
☐ TCLP
☐ Phenols
☐ Cyanide ☐ Preserved
☐ Chloride, Sulfate
☐ Fluoride
☐ Ammonia, Nitrate, Nitrite
☐ T K N
☐ Solids (SS, DS, TS)
☐ M B A S, C O D
☐ T O C
☐ Oil & Grease
☐ pH Indicate Field pH: _____

Total Number of Sample Containers Submitted 2

Custody Section

Relinquished By: Received By:
Name W. Skeath Date 10/20/97 Name Scott M. M... Date 10/20/97
Signature [Signature] Time [Time] Signature [Signature] Time 4:00
Name _____ Date _____ Name _____ Date _____
Signature _____ Time _____ Signature _____ Time _____
Name _____ Date _____ Name _____ Date _____
Signature _____ Time _____ Signature _____ Time _____

Suffolk County Department of Health Services
Division of Medical-Legal Investigations & Forensic Sciences
Public & Environmental Health Laboratory
(Industrial Waste Solid Samples)

Date NOV 05 1997
Received from Lab
E. Curcio, P.H. San.

FIELD

Field No. 2 WS 10-20

Laboratory

Lab No. Iw 1097070

Name of Firm

County Cleaner

Date Completed

10/27/97

Address or Location

Remarks/ Instructions

TEST	RESULT	TEST	RESULT ug/g (PPM)	TEST	RESULT ug/g (PPM)
pH (Field)		COD		Potassium	600.
pH (Lab)		Cyanide		>Selenium	<10.
TEST	RESULT	Phenols		>Silver	<2.
	ug/g (PPM)	METALS		Sodium	190.
Chloride		Aluminum	2900.	Thallium	<25.
Fluoride		Antimony	<10.	Vanadium	25.
Sulfate		>Arsenic	<10.	Zinc	760.
Sulfite		>Barium	30.		
Sulfide		Beryllium	<1.	EP Toxicity	
MBAS		>Cadmium	2.	TCLP	
TOC		Calcium	19000.		
Nitrate - N		>Chromium	20.		
Nitrite - N		Cobalt	<10.		
Ammonia - N		Copper	90.		
TKN		Iron	7700.		
Total Solids		>Lead	75.		
Susp. Solids		Magnesium	11000.		
Diss. Solids		Manganese	60.		
TPH		Molybdenum	<10.		
Oil & Grease		Nickel	20.		

EP Toxicity and TCLP includes all metals marked with >

INDSOIL.SAM

ORGANIC & FLASHPOINT ANALYSIS OF INDUSTRIAL & HAZARDOUS MATERIALS

Lab. No. IW 1097070 Date Completed 10/31/97
Field No. 2 WS-10-20 EPA Method 8260/1010/
Name Country Cleaners, Huntington Storm drain-shed
Remarks _____

Compound	ppb	Compound	ppb
*Indicates 597 Compounds			
<input checked="" type="checkbox"/> Purgeable Halocarbons 2/Aromatics			
*1,1 - Dichloroethene.....	110	tert-Butyl methyl ether.....	
*Methylene Chloride.....		*Benzene.....	
*Freon 113.....		*Toluene.....	
(Trichlorotrifluoroethane)		*Chlorobenzene.....	
*trans-1,2-Dichloroethene....	340	*Ethylbenzene.....	
*1,1-Dichloroethane.....		*Xylene(s).....	
*cis-1,2 Dichloroethene.....	37000	*Styrene.....	
*Bromochloromethane.....		*Isopropylbenzene.....	
*Chloroform.....		Bromobenzene.....	
2,2-Dichloropropane.....		Chlorotoluene(s).....	
*1,2-Dichloroethane.....		n-Propylbenzene.....	250
*1,1,1-Trichloroethane.....		p-Ethyltoluene.....	1000
1,1-Dichloropropene.....		1,3,5-Trimethylbenzene.....	280
*Carbon Tetrachloride.....		tert-Butylbenzene.....	
*Dibromomethane.....		1,2,4-Trimethylbenzene.....	970
*1,2-Dichloropropane.....		*1,3-Dichlorobenzene.....	
*Bromodichloromethane.....		*1,4-Dichlorobenzene.....	
(Dichlorobromomethane)		sec-Butylbenzene.....	
*Trichloroethene.....	210	p-Isopropyltoluene.....	
*cis-1,3-Dichloropropene.....		*1,2-Dichlorobenzene.....	
*trans-1,3-Dichloropropene...		n-Butylbenzene.....	
*1,1,2-Trichloroethane.....		p-Diethylbenzene.....	
*1,3-Dichloropropane.....		1,2,4,5-Tetramethylbenzene...	
*Dibromochloromethane.....		*1,2,4-Trichlorobenzene.....	
(Chlorodibromomethane)		*Naphthalene.....	
*1,2-Dibromoethane.....		1,2,3-Trichlorobenzene.....	
*Tetrachloroethene.....	1000	[] Purgeable Halocarbons 1	
*1,1,1,2-Tetrachloroethane...		*Chlorodifluoromethane.....	
*Bromoform.....		*Dichlorodifluoromethane.....	
*1,1,2,2-Tetrachloroethane...		*Trichlorofluoromethane.....	
1,2,3-Trichloropropane.....		*Vinyl Chloride.....	
*1,2-Dibromo-3-chloropropane.		*Chloromethane.....	
*Hexachlorobutadiene.....		(Methyl Chloride)	
*Acetone.....	<1300	Bromomethane.....	
*Methyl ethyl ketone.....	<1300	(Methyl Bromide)	
*Methyl isobutyl ketone.....	<1300	Chloroethane.....	
		[] Miscellaneous	
		*Vinyl acetate.....	
		*2-Chloroethyl vinyl ether...	

RESULTS ARE <100ppb FOR PURGEABLE
HALOCARBONS 2/AROMATICS
EXCEPT WHERE NOTED

Analyst CCR

[] Flash Point

Pensky-Martens Closed Cup Flash Point _____ °C= _____ °F

Analyst _____

ORGANIC & FLASHPOINT ANALYSIS OF INDUSTRIAL & HAZARDOUS MATERIALS

Lab. No. IW 1097072
Field No. 4 WS 10-20
Name Country Cleaners
Remarks

Date Completed 11-7-97
EPA Method 8260/1010/
Soil under curbs, pipe

Compound	ppb	Compound	ppb
*Indicates 597 Compounds			
<input checked="" type="checkbox"/> Purgeable Halocarbons 2/Aromatics			
*1,1 - Dichloroethene.....		tert-Butyl methyl ether.....	
*Methylene Chloride.....	<250	*Benzene.....	
*Freon 113.....	<250	*Toluene.....	
(Trichlorotrifluoroethane)		*Chlorobenzene.....	
*trans-1,2-Dichloroethene....		*Ethylbenzene.....	
*1,1-Dichloroethane.....		*Xylene(s).....	
*cis-1,2 Dichloroethene.....		*Styrene.....	
*Bromochloromethane.....		*Isopropylbenzene.....	
*Chloroform.....		Bromobenzene.....	
2,2-Dichloropropane.....	<250	Chlorotoluene(s).....	
*1,2-Dichloroethane.....	<250	n-Propylbenzene.....	
*1,1,1-Trichloroethane.....		p-Ethyltoluene.....	330
1,1-Dichloropropene.....		1,3,5-Trimethylbenzene.....	180
*Carbon Tetrachloride.....	<250	tert-Butylbenzene.....	
*Dibromomethane.....		1,2,4-Trimethylbenzene.....	350
*1,2-Dichloropropane.....		*1,3-Dichlorobenzene.....	
*Bromodichloromethane.....		*1,4-Dichlorobenzene.....	
(Dichlorobromomethane)		sec-Butylbenzene.....	
*Trichloroethene.....		p-Isopropyltoluene.....	
*cis-1,3-Dichloropropene....		*1,2-Dichlorobenzene.....	
*trans-1,3-Dichloropropene...		n-Butylbenzene.....	
*1,1,2-Trichloroethane.....		p-Diethylbenzene.....	
*1,3-Dichloropropane.....		1,2,4,5-Tetramethylbenzene...	
*Dibromochloromethane.....		*1,2,4-Trichlorobenzene.....	
(Chlorodibromomethane)		*Naphthalene.....	470
*1,2-Dibromoethane.....		1,2,3-Trichlorobenzene.....	
*Tetrachloroethene.....	12000000	[] Purgeable Halocarbons 1	
*1,1,1,2-Tetrachloroethane...		*Chlorodifluoromethane.....	
*Bromoform.....		*Dichlorodifluoromethane.....	
*1,1,2,2-Tetrachloroethane...		*Trichlorofluoromethane.....	
1,2,3-Trichloropropane.....		*Vinyl Chloride.....	
*1,2-Dibromo-3-chloropropane.		*Chloromethane.....	
*Hexachlorobutadiene.....		(Methyl Chloride)	
*Acetone.....	5200	Bromomethane.....	
*Methyl ethyl ketone.....	<1300	(Methyl Bromide)	
*Methyl isobutyl ketone.....	<1300	Chloroethane.....	
RESULTS ARE <100ppb FOR PURGEABLE			
HALOCARBONS 2/AROMATICS --			
EXCEPT WHERE NOTED.			
[] Miscellaneous			
*Vinyl acetate.....			
*2-Chloroethyl vinyl ether...			

Analyst g/a

[] Flash Point

Pensky-Martens Closed Cup Flash Point °C= °F

Analyst

New York State Department of Environmental Conservation
Building 40 - SUNY, Stony Brook, New York 11790-2356



C O V E R

FAX

S H E E T

To: SCDH-WALTER PETRULE
Fax #: 516-884-2505

Date: 10/24/97
Page: 1 of 10

RE: Spill #91-02132 Getty S/S 406 W. Main St. Huntington.

COMMENTS: See attached report.

Any questions call me.

From: Walter Petrule
Division of Spills Management
Telephone: (516) 444-0320
FAX: (516) 444-0373

Berninger Environmental, Inc.*groundwater consultants, engineers, geologists*1615 Ninth Avenue
Bohemia • New York • 11716

Phone: 516 • 588 • 2251

Fax: 516 • 588 • 2926

January 6, 1997

Mr. Walter Parish, P.E.
New York State Department of
Environmental Conservation, Region I
SUNY, Building 40
Stony Brook, New York 11790**JAN 08 1997**RE: Getty Service Station
406 West Main Street, Huntington, NY
Spill #91-02132

Dear Mr. Parish:

Lou Halperin Properties, Inc. contracted Berninger Environmental, Inc. (BEI) to perform a limited subsurface investigation at the above referenced site. The NYSDEC required the installation of groundwater monitoring wells to investigate the remaining contamination which could not be removed during a tank replacement project.

The scope of work proposed was the installation of three (3) groundwater monitoring wells around the existing tanks, one located up-gradient and two down gradient. During the installation of the wells, soil samples are collected and tested with a portable PID for the detection of hydrocarbons. Groundwater samples from each well are collected by EPA protocol and analyzed at a State certified laboratory for EPA Method 602 + MTBE.

On October 28, 1996, BEI arrived on site with a drill rig, work crew, and geologist to perform the necessary field activities. MW-1 was located up-gradient of the existing tanks, along the north property line (see enclosed site sketch). Drilling advanced through medium to fine silty sand and clay. Depth to water was originally estimated at approximately 20 - 30 feet below grade. After 50 feet BEI installed a 2" PVC well with 20' of 0.020" slotted screen, expecting groundwater to slowly enter the well. BEI returned to the site the following day to monitor and collect a groundwater sample from MW-1. The well was dry, however, a very strong odor of Perchloroethylene was detected emanating from the well. A dry cleaner is located adjacent to the site.

BEI returned to the site on November 5, 1996 and installed MW-2, down-gradient of the existing tanks. The well was installed to a final depth of 60 feet with 20' of 0.020" slotted screen. Soil samples were field screened for total volatile organic compounds (VOC's) using an HNU portable photo ionization detector. The results of the field screening is recorded on the boring logs attached.

Berninger Environmental, Inc.

groundwater consultants, engineers, geologists
1615 Ninth Avenue
Bohemia • New York • 11716

Phone: 516 • 588 • 2251
Fax: 516 • 588 • 2926

Mr. Walter Parish
January 6, 1997
Page 2

Groundwater was monitored at 52 feet below grade. On November 18, 1996, BEI obtained a groundwater sample from MW-2 and had the sample analyzed for EPA Method 602 + MTBE. Due to the detection of Perchloroethylene in MW-1, the groundwater from MW-2 was tested.

LABORATORY RESULTS

The laboratory received the samples on November 18, 1996 and analyzed the samples on November 27, 1996. The results are tabulated below:

Groundwater Analysis

MW-2		
Parameters	Results	Units
Benzene	6.5	ug/l
Toluene	31	ug/l
Ethylbenzene	<10	ug/l
Xylene	<10	ug/l
MTBE	960	ug/l
Trichloroethylene	398	ug/l
Perchloroethylene	2170	ug/l

Berninger Environmental, Inc.*groundwater consultants, engineers, geologists*

1615 Ninth Avenue

Bohemia • New York • 11716

Phone: 516 • 588 • 2251

Fax: 516 • 588 • 2926

Mr. Walter Parish

January 6, 1997

Page 3

CONCLUSIONS

The up gradient groundwater monitoring well did not reach groundwater, however, a very strong odor of Perchloroethylene is venting from the well. No petroleum hydrocarbons were detected in the soil column during the installation of the well.

The down gradient water sample (MW-2) indicates detectable but low levels of benzene and toluene, 6.5 ppb and 31 ppb respectively. MTBE was detected at 960 ppb. Perchloroethylene and trichloroethylene was detected in MW-2 at 2,170 ppb and 398 ppb respectively.

The soil samples collected during the installation of MW-2 indicated total volatile organic compounds of 3 ppm to 17 ppm from 5 feet below grade to 40 feet below grade, with 6 ppm to 1 ppm at and below the water table.

The results of the investigation indicate that minimal residual hydrocarbon contamination is present in the soil column, however, the elevated MTBE detected in the groundwater is over the NYSDEC action level of 50 ppb. The detection and analysis of elevated levels of Perc. and Trichloroethylene in MW-1 and MW-2 is of serious concern and requires the NYSDEC to further investigate the possible source of groundwater contamination from the up-gradient dry cleaning facility.

Enclosed is a site sketch with the approximate well locations, laboratory data, and boring logs.

If you have any questions or comments regarding the sampling procedure or results obtained, please do not hesitate to contact us.

Sincerely,



Steven Muller

Geologist

Contaminated Soil Found?	Yes/No	Yes/No	Yes/No	Yes/No	Yes/No
Amount Removed	Yes/No	15 yds			
• S--Steel F--Fiberglass S/F--Composite					

Site Sketch (Diagram not to scale)

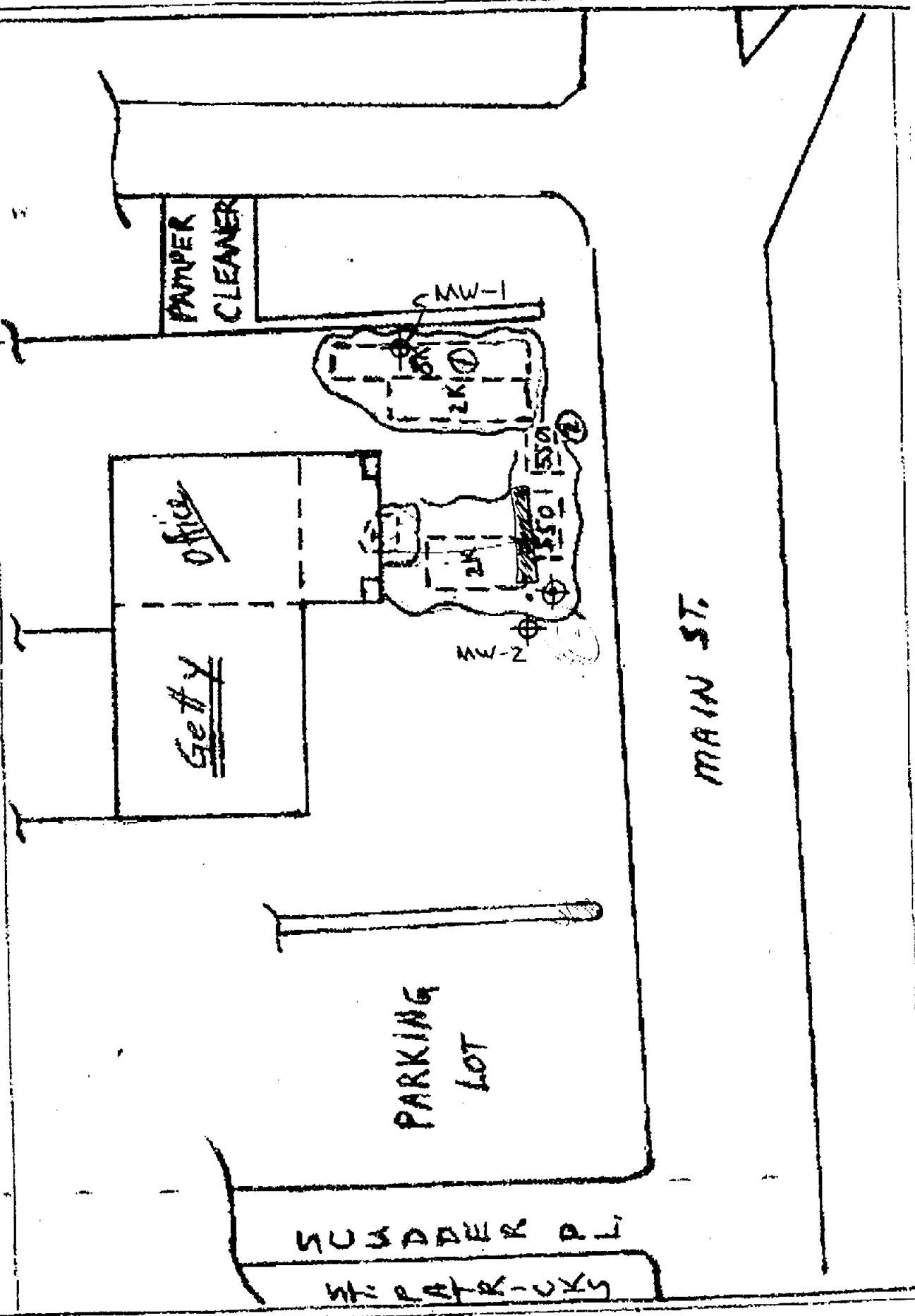



PEDNEAULT ASSOCIATES, INC. TESTING LABORATORIES

1615 NINTH AVENUE • P.O. BOX 205 • BOHEMIA, N.Y. 11716 • (516) 467-8477
FAX: (516) 467-6905 After 5pm: (516) 567-5579

BERNINGER ENVIRONMENTAL

1615 NINTH AVENUE-P.O. BOX 205
BOHEMIA, NY 11716-0000 (516)588-2251

PROJECT ID: GETTY S/S, HUNTINGTON, NY

LAB NUMBER: 116770	MATRIX: LIQUID
SAMPLE ORIGIN: MW-2	
COLLECTION	RECEIPT
DATE: 11/18/96	DATE: 11/18/96
	ANALYSIS
	DATE: 11/25/96
	REPORT
	DATE: 11/27/96

**PURGEABLE AROMATICS + MTBE
EPA602MTBE**

<u>PARAMETER</u>	<u>RESULTS</u>	<u>UNIT</u>
BENZENE	6.5	ug/l
TOLUENE	31	ug/l
XYLENE	<10	ug/l
ETHYLBENZENE	<10	ug/l
CHLOROBENZENE	<10	ug/l
DICHLOROBENZENE	<10	ug/l
METHYL TERT-BUTYL ETHER	960	ug/l

REMARKS:
ELAP# 10224

JOHN PEDNEAULT

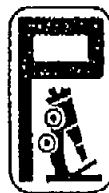
**PEDNEAULT ASSOCIATES, INC. TESTING LABORATORIES**1615 NINTH AVENUE • P.O. BOX 205 • BOHEMIA, N.Y. 11716 • (516) 467-8477
FAX: (516) 467-6905 After 5pm: (516) 567-5579**BERNINGER ENVIRONMENTAL**1615 NINTH AVENUE-P.O. BOX 205
BOHEMIA, NY 11716-0000

(516)588-2251

PROJECT ID: GETTY S/S, HUNTINGTON, NY

LAB NUMBER: 116770
SAMPLE ORIGIN: MW-2

MATRIX: LIQUID

COLLECTION

RECEIPT

ANALYSIS

REPORT

DATE: 11/18/96

DATE: 11/18/96

DATE: 11/25/96

DATE: 11/27/96

**TRICHLOROETHYLENE
TRI**PARAMETERRESULTSUNITTRICHLOROETHYLENE
PERCHLOROETHYLENE
DICHLOROETHYLENE398
2170
<10
ug/l
ug/l
ug/lREMARKS:
ELAP# 10224JOHN PEDNEAULT
LABORATORY DIRECTOR

SAMPLE COLLECTION / CHAIN OF CUSTODY RECORD

Pedernault Associates, Inc. 1015 NINTH AVENUE BOHEMIA, NEW YORK 11710 PHONE: (516) 487-8477 / FAX: (516) 487-8805		CLIENT: ADDRESS: CITY, STATE, ZIP: PHONE / FAX:		PAGE 1 OF 1																																																																																																																														
PROJECT NAME AND/OR LOCATION: <div>Duty 815 Huntington, N.Y.</div>		LAB NUMBER (Bottle): LAB NUMBER: 116770		P.O. #: 86-0340 JOB #:																																																																																																																														
<table><thead><tr><th rowspan="2">#</th><th rowspan="2">TIME</th><th colspan="3">SAMPLE</th><th rowspan="2">MATRIX</th><th rowspan="2">SAMPLE ORIGIN</th><th rowspan="2">SAMPLE CONTAINERS</th><th rowspan="2">ANALYSIS</th><th rowspan="2">#</th></tr><tr><th>COMP</th><th>GRAB</th><th>S</th><th>L</th><th>G</th></tr></thead><tbody><tr><td>1</td><td>8:11:30</td><td></td><td>Y</td><td></td><td>X</td><td></td><td>MW-2</td><td>2-40 mls.</td><td>602 + MTBE</td><td>1</td></tr><tr><td>2</td><td></td><td></td><td></td><td></td><td></td><td></td><td></td><td></td><td>(Priority)</td><td>2</td></tr><tr><td>3</td><td></td><td></td><td></td><td></td><td></td><td></td><td></td><td></td><td>Perchloroethylene</td><td>3</td></tr><tr><td>4</td><td></td><td></td><td></td><td></td><td></td><td></td><td></td><td></td><td>Trichloroethylene</td><td>4</td></tr><tr><td>5</td><td></td><td></td><td></td><td></td><td></td><td></td><td></td><td></td><td></td><td>5</td></tr><tr><td>6</td><td></td><td></td><td></td><td></td><td></td><td></td><td></td><td>Dichloro + Trichloro results</td><td></td><td>6</td></tr><tr><td>7</td><td></td><td></td><td></td><td></td><td></td><td></td><td></td><td></td><td></td><td>7</td></tr><tr><td>8</td><td></td><td></td><td></td><td></td><td></td><td></td><td></td><td></td><td></td><td>8</td></tr><tr><td>9</td><td></td><td></td><td></td><td></td><td></td><td></td><td></td><td></td><td></td><td>9</td></tr><tr><td>10</td><td></td><td></td><td></td><td></td><td></td><td></td><td></td><td></td><td></td><td>10</td></tr></tbody></table>						#	TIME	SAMPLE			MATRIX	SAMPLE ORIGIN	SAMPLE CONTAINERS	ANALYSIS	#	COMP	GRAB	S	L	G	1	8:11:30		Y		X		MW-2	2-40 mls.	602 + MTBE	1	2									(Priority)	2	3									Perchloroethylene	3	4									Trichloroethylene	4	5										5	6								Dichloro + Trichloro results		6	7										7	8										8	9										9	10										10
#	TIME	SAMPLE			MATRIX			SAMPLE ORIGIN	SAMPLE CONTAINERS	ANALYSIS						#																																																																																																																		
		COMP	GRAB	S		L	G																																																																																																																											
1	8:11:30		Y		X		MW-2	2-40 mls.	602 + MTBE	1																																																																																																																								
2									(Priority)	2																																																																																																																								
3									Perchloroethylene	3																																																																																																																								
4									Trichloroethylene	4																																																																																																																								
5										5																																																																																																																								
6								Dichloro + Trichloro results		6																																																																																																																								
7										7																																																																																																																								
8										8																																																																																																																								
9										9																																																																																																																								
10										10																																																																																																																								
SPECIAL INSTRUCTIONS: Bill: BEI																																																																																																																																		
RECEIVED BY: Walter Berninger		RECEIVED BY: D. Berninger		RECEIVED AT LAB BY: Monica Savage																																																																																																																														
DATE: 11-18-96		DATE: 11-18-96		DATE: 11/18/96																																																																																																																														
TIME: 3:30 p.m.		TIME: 11-18-96		TIME: 4:00																																																																																																																														
SHIPING CONTAINER CONDITION		GOOD		PACKED IN CASE																																																																																																																														
				YES NO																																																																																																																														

BORING LOG

PROJECT: <u>Getly Service Station</u>		DATE: <u>Oct. 28, 1996</u>	
CLIENT: <u>CPG Distributors, Inc., 1144 Atlantic Ave., Baldwin, NY 11510</u>		BH JOB NO: <u>60038</u>	
LOCATION: <u>Huntington, 406 Main Street</u>		DRILLER: <u>Berninger Environmental, Inc</u>	
WELL NO: <u>MW-1</u>	USE: <u>Sampling</u>	BORE HOLE DIA.: <u>6"</u>	
DRILLING METHOD: <u>Hollow Stem Augers</u>		SAMPLE METHOD: <u>Cuttings</u>	
CASING Type: <u>PVC - BJT</u>	CASING Dia: <u>2"</u>	CASING Length: <u>30'</u>	DEPTH TO WATER: <u>52'</u>
SCREEN Type: <u>PVC - FJT</u>	SCREEN Dia: <u>2"</u>	SCREEN Length: <u>20'</u>	TOTAL DEPTH: <u>50'</u>
SCREEN Slot: <u>0.020"</u>		GRAVEL PACK: <u>Formation</u>	
CASING SEAL: <u>None</u>		FINISH: <u>To Grade</u>	SECURITY: <u>Bolt Down Manhole</u>

Depth Below Grade	Sample Information	Well Design	IDENTIFICATION / REMARKS
1: <u>0 - 4"</u>			<u>Asphalt and base.</u>
2: <u>4" - 5'</u>			<u>Dark brown medium to fine silty SAND.</u>
3: <u>5' - 7'</u>			<u>Brown medium to fine SAND.</u>
4: <u>7' - 15'</u>			<u>Dark brown medium to fine sandy CLAY.</u>
5: <u>15' - 30'</u>			<u>Brown medium to fine SAND.</u>
6: _____			
7: _____			
8: _____			
9: _____			
10: _____			
11: _____			
12: _____			
13: _____			

Date FEB 05 1998
Received from Lab
E. Curcio, P.H. San.

FILE REF. NO. : 4-12016

C. ID. NO.

Field Number: 1-25-1-17

Collected By: W. J. KRAFT

Affiliation: SCDF/S

Facility/Name Ce H V S / 1

Location: 406 W. MAIN ST

Point of Collection: BL 2

Remarks: 51 ft to groundwater

Industrial Waste (Inorganics)

```

[ ] Metals [ ] Preserved
[ ] Chromium (Hexavalent)
[ ] E P Toxicity
[ ] TCLP
[ ] Phenols
[ ] Cyanide [ ] Preserved
[ ] Chloride, Sulfate
[ ] Fluoride
[ ] Ammonia, Nitrate, Nitrite
[ ] T K N
[ ] Solids (SS, DS, TS)
[ ] M B A S, C O D
[ ] T O C
[ ] Oil & Grease
[ ] pH Indicate Field pH:

```

☐ Metals ☐ Preserved

[] Chromium (Hexavalent)

[] E P Toxicity

[] TCLP

- [] Phenols
- [] Guanido

☐ Cyanide ☐ Preserved
☐ Chloride Sulfate

[1] Chloride, sulfate
[1] Fluoride

[] Ammonia,

[[T K N

[[Solids (SS, DS, TS)

[] M B A S, C O D

[] T O C

Oil & Grease
pH Indicate Field pH: _____

Custody Section

Received By:

Name Cootner Date 1/14/92

Signature Bruce Cochran Time 4:00 PM

Name _____ Date _____

Signature _____ Time _____

Name _____ Date _____

Signature _____ Time _____

SUFFOLK COUNTY DEPARTMENT OF HEALTH & SERVICES
CENTER FOR FORENSIC SCIENCES
PUBLIC & ENVIRONMENTAL HEALTH LABORATORY
NYSDOH LAB ID. NUMBER 10528

Date FEB 05 1998
Revised 10/1/97
E. Quirk, P.H. San.
Results Over Limits

ORGANIC & FLASHPOINT ANALYSIS OF INDUSTRIAL & HAZARDOUS MATERIALS

Lab. No. IW 198071
Field No. 1451-14
Name Betty 5/5 406 W Main H-1
Remarks 4ppb MW 2 grnd H₂O
Date Completed 1-29-98
EPA Method 8260/1010/

Compound	ppb	Compound	ppb
*Indicates 597 Compounds			
[X] Purgeable Halocarbons 2/Aromatics			
*1,1 - Dichloroethene.....		tert-Butyl methyl ether.....	410
*Methylene Chloride.....		*Benzene.....	
*Freon 113.....		*Toluene.....	
(Trichlorotrifluoroethane)		*Chlorobenzene.....	
*trans-1,2-Dichloroethene....	6	*Ethylbenzene.....	
*1,1-Dichloroethene.....		*Xylene(s).....	
*cis-1,2 Dichloroethene.....	450	*Styrene.....	
*Bromochloromethane.....		*Isopropylbenzene.....	
*Chloroform.....		Bromobenzene.....	
2,2-Dichloropropane.....		Chlorotoluene(s).....	
*1,2-Dichloroethane.....	<10	n-Propylbenzene.....	
*1,1,1-Trichloroethane.....		p-Ethyltoluene.....	
1,1-Dichloropropene.....		1,3,5-Trimethylbenzene.....	
*Carbon Tetrachloride.....		tert-Butylbenzene.....	
*Dibromomethane.....	<10	1,2,4-Trimethylbenzene.....	
*1,2-Dichloropropane.....		*1,3-Dichlorobenzene.....	
*Bromodichloromethane.....		*1,4-Dichlorobenzene.....	
(Dichlorobromomethane)		sec-Butylbenzene.....	
*Trichloroethene.....	65	p-Isopropyltoluene.....	
*cis-1,3-Dichloropropene....		*1,2-Dichlorobenzene.....	
*trans-1,3-Dichloropropene...		n-Butylbenzene.....	
*1,1,2-Trichloroethane.....		p-Diethylbenzene.....	
*1,3-Dichloropropane.....		1,2,4,5-Tetramethylbenzene...	
*Dibromochloromethane.....		*1,2,4-Trichlorobenzene.....	
(Chlorodibromomethane)		*Naphthalene.....	
*1,2-Dibromoethane.....	<10	1,2,3-Trichlorobenzene.....	
*Tetrachloroethene.....	3500	[] Purgeable Halocarbons 1	
*1,1,1,2-Tetrachloroethane...		*Chlorodifluoromethane.....	
*Bromoform.....		*Dichlorodifluoromethane.....	
*1,1,2,2-Tetrachloroethane...		*Trichlorofluoromethane.....	
1,2,3-Trichloropropane.....		*Vinyl Chloride.....	
*1,2-Dibromo-3-chloropropane.	<10	*Chloromethane.....	
*Hexachlorobutadiene.....		(Methyl Chloride)	
*Acetone.....	<50	Bromomethane.....	
*Methyl ethyl ketone.....	<50	(Methyl Bromide)	
*Methyl isobutyl ketone.....	<50	Chloroethane.....	
[] Miscellaneous			
RESULTS ARE 4ppb FOR PURGEABLE			
HALOCARBONS 2/AROMATICS -			
EXCEPT WHERE NOTED.			
*Vinyl acetate.....			
*2-Chloroethyl vinyl ether...			

Analyst Gya

[] Flash Point

Pensky-Martens Closed Cup Flash Point ____°C-____°F

Analyst

West Main St.

Washington
D.C.
70001
Court
Records

Pr. 1

A hand-drawn sketch map. At the top, a horizontal line is labeled "Asphalt". Below it, another horizontal line is labeled "56' 8\"". These two lines intersect a vertical line labeled "DIST". To the right of the intersection, there is a rectangular area containing the word "COWARD" above the word "Asphalt". Below the intersection, there is a circular feature with a dot in the center, labeled "205324".

Dist

Diet

Country Cleaners

Country	Cleaners
03-65	3-24

Depth	Remarks
720 ft	1 - 9 inches below surface
9300	2 - surface sample
1100	3 - 9 inches below surface
940	4 - surface sample

148-3-24

1

410 W. Major St
Huntington

ORGANIC & FLASHPOINT ANALYSIS OF INDUSTRIAL & HAZARDOUS MATERIALS

Lab. No. IW 398119 Date Completed 3/27/97
Field No. 1WS3-24 EPA Method 8260/1010/
Name Country Cleaners 410 W. Main St. Huntington
Remarks west of storm drain - surface soil

Compound	ppb	Compound	ppb
*Indicates 597 Compounds			
1 Purgeable Halocarbons 2/Aromatics			
*1,1 - Dichloroethene.....		tert-Butyl methyl ether.....	
*Methylene Chloride.....		*Benzene.....	
*Freon 113.....	2250	*Toluene.....	
(Trichlorotrifluoroethane)		*Chlorobenzene.....	
*trans-1,2-Dichloroethene....		*Ethylbenzene.....	
*1,1-Dichloroethane.....		*Xylene(s).....	
*cis-1,2 Dichloroethene.....		*Styrene.....	
*Bromochloromethane.....		*Isopropylbenzene.....	
*Chloroform.....		Bromobenzene.....	
2,2-Dichloropropane.....	2250	Chlorotoluene(s).....	
*1,2-Dichloroethane.....		n-Propylbenzene.....	
*1,1,1-Trichloroethane.....		p-Ethyltoluene.....	
1,1-Dichloropropene.....		1,3,5-Trimethylbenzene.....	
*Carbon Tetrachloride.....		tert-Butylbenzene.....	
*Dibromomethane.....		1,2,4-Trimethylbenzene.....	
*1,2-Dichloropropane.....		*1,3-Dichlorobenzene.....	
*Bromodichloromethane.....		*1,4-Dichlorobenzene.....	
(Dichlorobromomethane)		sec-Butylbenzene.....	
*Trichloroethene.....		p-Isopropyltoluene.....	
*cis-1,3-Dichloropropene....		*1,2-Dichlorobenzene.....	
*trans-1,3-Dichloropropene...	2250	n-Butylbenzene.....	
*1,1,2-Trichloroethane.....		p-Diethylbenzene.....	
*1,3-Dichloropropane.....		1,2,4,5-Tetramethylbenzene...	
*Dibromochloromethane.....		*1,2,4-Trichlorobenzene.....	
(Chlorodibromomethane)		*Naphthalene.....	
*1,2-Dibromoethane.....		1,2,3-Trichlorobenzene.....	
*Tetrachloroethene.....	720	[] Purgeable Halocarbons 1	
*1,1,1,2-Tetrachloroethane...		*Chlorodifluoromethane.....	
*Bromoform.....		*Dichlorodifluoromethane.....	
*1,1,2,2-Tetrachloroethane...		*Trichlorofluoromethane.....	
1,2,3-Trichloropropane.....		*Vinyl Chloride.....	
*1,2-Dibromo-3-chloropropane.	2150	*Chloromethane.....	
*Hexachlorobutadiene.....		(Methyl Chloride)	
*Acetone.....	21300	Bromomethane.....	
*Methyl ethyl ketone.....	21300	(Methyl Bromide)	
*Methyl isobutyl ketone.....	21300	Chloroethane.....	
		[] Miscellaneous	
		*Vinyl acetate.....	
		*2-Chloroethyl vinyl ether...	

RESULTS ARE <100ppb FOR PURGEABLE
HALOCARBONS 2/AROMATICS
EXCEPT WHERE NOTED.

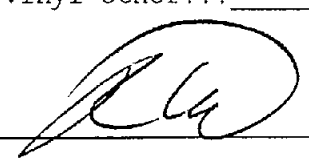
Analyst 

[] Flash Point
Pensky-Martens Closed Cup Flash Point _____ °C= _____ °F

Analyst _____

SUFFOLK COUNTY DEPARTMENT OF HEALTH SERVICES
DIVISION OF MEDICAL-LEGAL INVESTIGATIONS & FORENSIC SCIENCES
PUBLIC & ENVIRONMENTAL HEALTH LABORATORY
NYSDOH LAB ID. NUMBER 10528

FILE REF. NO. : 4-02186

FAC. ID. NO. :

SAMPLING ANALYSIS REQUEST/CHAIN OF CUSTODY

Date MAR 30 1998
Received from Lab
E. Curcio, P.H. San.

Field Number: 3-WS-3-24 Laboratory Number I W 358121
Collected By: W. Skeats Assisted By: B. Cook
Affiliation: SCDHS Date: 3/24/98 Time: 2:30
Facility/Name: Country Cleaners
Location: 410 West Main St Hunt
Point of Collection: mound of dirt 2ft off
Remarks: Asphalt Soil
3-16-B 9 inches below surface

Analysis Requested (By Department)

Air Pollution

- ☐ Volatile Organic Hydrocarbons
☐ Asbestos (Bulk)

Hazardous Materials (Organics)

- ☐ Purgeable Halocarbons 1 (EPA 8260)
☒ Purgeable Halocarbons 2/ Aromatic Hydrocarbons (EPA 8260)
Preservation ☐ HCl ☒ Cooled to 4°C
Level of Detection ☒ 40 ppb ☐ 4 ppb
☐ Flash Point (EPA 1010)
☐ Pesticides
Specify Type: _____
☐ TCLP
☐ Other _____

Industrial Waste (Inorganics)

- ☐ Metals ☐ Preserved
☐ Chromium (Hexavalent)
☐ E P Toxicity
☐ TCLP
☐ Phenols
☐ Cyanide ☐ Preserved
☐ Chloride, Sulfate
☐ Fluoride
☐ Ammonia, Nitrate, Nitrite
☐ T K N
☐ Solids (SS, DS, TS)
☐ M B A S, C O D
☐ T O C
☐ Oil & Grease
☐ pH Indicate Field pH: _____

Total Number of Sample Containers Submitted 1

Custody Section

Relinquished By: Received By:
Name WILLIAM J. SKEATS Date 3/24/98 Name SCOTT MURPHY Date 3/24/98
Signature [Signature] Time 3:15 Signature [Signature] Time 3:15
Name _____ Date _____ Name _____ Date _____
Signature _____ Time _____ Signature _____ Time _____
Name _____ Date _____ Name _____ Date _____
Signature _____ Time _____ Signature _____ Time _____

ORGANIC & FLASHPOINT ANALYSIS OF INDUSTRIAL & HAZARDOUS MATERIALS

Lab. No. IW 398121 Date Completed 3/26/97
Field No. 3WS3-24 EPA Method 8260/1010/
Name Country Cleaners 410 West Main St. Huntington
Remarks mound of dirt 2 ft off asphalt - Soil

Compound	ppb	Compound	ppb
*Indicates 597 Compounds			
<input checked="" type="checkbox"/> Purgeable Halocarbons 2/Aromatics			
*1,1 - Dichloroethene.....		tert-Butyl methyl ether.....	
*Methylene Chloride.....		*Benzene.....	
*Freon 113.....	<150	*Toluene.....	
(Trichlorotrifluoroethane)		*Chlorobenzene.....	
*trans-1,2-Dichloroethene....		*Ethylbenzene.....	
*1,1-Dichloroethene.....		*Xylene(s).....	
*cis-1,2 Dichloroethene.....		*Styrene.....	
*Bromochloromethane.....		*Isopropylbenzene.....	
*Chloroform.....		Bromobenzene.....	
2,2-Dichloropropane.....	<250	Chlorotoluene(s).....	
*1,2-Dichloroethane.....		n-Propylbenzene.....	
*1,1,1-Trichloroethane.....		p-Ethyltoluene.....	
1,1-Dichloropropene.....		1,3,5-Trimethylbenzene.....	
*Carbon Tetrachloride.....		tert-Butylbenzene.....	
*Dibromomethane.....		1,2,4-Trimethylbenzene.....	
*1,2-Dichloropropane.....		*1,3-Dichlorobenzene.....	
*Bromodichloromethane.....		*1,4-Dichlorobenzene.....	
(Dichlorobromomethane)		sec-Butylbenzene.....	
*Trichloroethene.....		p-Isopropyltoluene.....	
*cis-1,3-Dichloropropene.....		*1,2-Dichlorobenzene.....	
*trans-1,3-Dichloropropene...		n-Butylbenzene.....	
*1,1,2-Trichloroethane.....		p-Diethylbenzene.....	
*1,3-Dichloropropane.....		1,2,4,5-Tetramethylbenzene...	
*Dibromochloromethane.....		*1,2,4-Trichlorobenzene.....	
(Chlorodibromomethane)		*Naphthalene.....	
*1,2-Dibromoethane.....		1,2,3-Trichlorobenzene.....	
*Tetrachloroethene.....	1600	[] Purgeable Halocarbons 1	
*1,1,1,2-Tetrachloroethane...		*Chlorodifluoromethane.....	
*Bromoform.....		*Dichlorodifluoromethane.....	
*1,1,2,2-Tetrachloroethane...		*Trichlorofluoromethane.....	
1,2,3-Trichloropropane.....		*Vinyl Chloride.....	
*1,2-Dibromo-3-chloropropane.	<250	*Chloromethane.....	
*Hexachlorobutadiene.....		(Methyl Chloride)	
*Acetone.....	<1300	Bromomethane.....	
*Methyl ethyl ketone.....	<1300	(Methyl Bromide)	
*Methyl isobutyl ketone.....	<1300	Chloroethane.....	
		[] Miscellaneous	
		*Vinyl acetate.....	
		*2-Chloroethyl vinyl ether...	

RESULTS ARE <100ppb FOR PURGEABLE
HALOCARBONS 2/AROMATICS --
EXCEPT WHERE NOTED.

Analyst 

[] Flash Point

Pensky-Martens Closed Cup Flash Point ____ °C= ____ °F

Analyst _____



IMPACT ENVIRONMENTAL

❖ a division of *impact environmental consulting, inc.*

1 VILLAGE PLAZA
KINGS PARK, NEW YORK 11754
631.269.8800 TELEPHONE
631.269.1599 FACSIMILE
www.impactenvironmental.com

September 14, 2000



Mr. Walter Petruele
Suffolk County Department of Health Services
Bureau of Inspection Services
Office of Pollution Control
15 Horseblock Place
Farmingville, New York 11738

*Re: Country Cleaners
410 Main Street
Huntington, New York*

Dear Mr. Petruele:

Enclosed are summary tables for the results obtained from the sampling investigation of the above referenced property. The tables include all data obtained to date, including groundwater quality results from the most recently installed monitoring well at the subject property.

Please call with any questions or comments.

Sincerely,
**Impact Environmental
Consulting, Inc.**

Kevin Kleaka
Environmental Scientist

Attachments

Table 1: Field Headspace Analysis Results
Huntington, New York

Sample ID	SP-1	SP-2	SP-3	UIW
Unit	ppm	ppm	ppm	ppm
Depth Interval BEG:				
0'-2'	NA	NA	2.6	NA
2'-4'	NA	NA	2.4	NA
4'-6'	NA	NA	7.3	NA
6'-8'	NA	NA	0.0	NA
5'-7'	0.0	NA	NA	NA
10'-12'	0.0	NA	NA	NA
13'-16'	NA	NA	NA	2000+
15'-17'	0.0	4.6	NA	NA
20'-22'	0.0	2.2	NA	9.0
25'-27'	0.0	0.0	NA	15.2
30'-32'	0.0	0.0	NA	NA

Bold values represent concentrations detected above ambient levels (<1 ppm).
NA: Not Available.
Note: Instrument calibration was performed before sample measurements were secured.

Table 2: Detected Analytes
Huntington, New York

Sample ID	SP-2 (25'-27')	SP-3 (4'-6')	SCDHS Article 12-SOP 9-95
Unit	ug/Kg	ug/Kg	ug/Kg
Volatile Organics:			
Tetrachloroethene	10	31	2,800

Sample ID	Cnty	Cnty County	NYSDEC Ambient Water Quality Standards and Guidance Values
Unit	MW-2	MW-1	ug/Kg
Volatile Organics:	ug/Kg	ug/Kg	
Tetrachloroethene	2853	1888	5
Trichloroethene	184	97.5	5
cis-1,2-Dichloroethene	583	17.7	5

Bold values represent concentrations above guidance values
ND: Not Detected.
NA: Not Available.



Hillside Avenue

Lawrence Hill Road (Rte 25A)

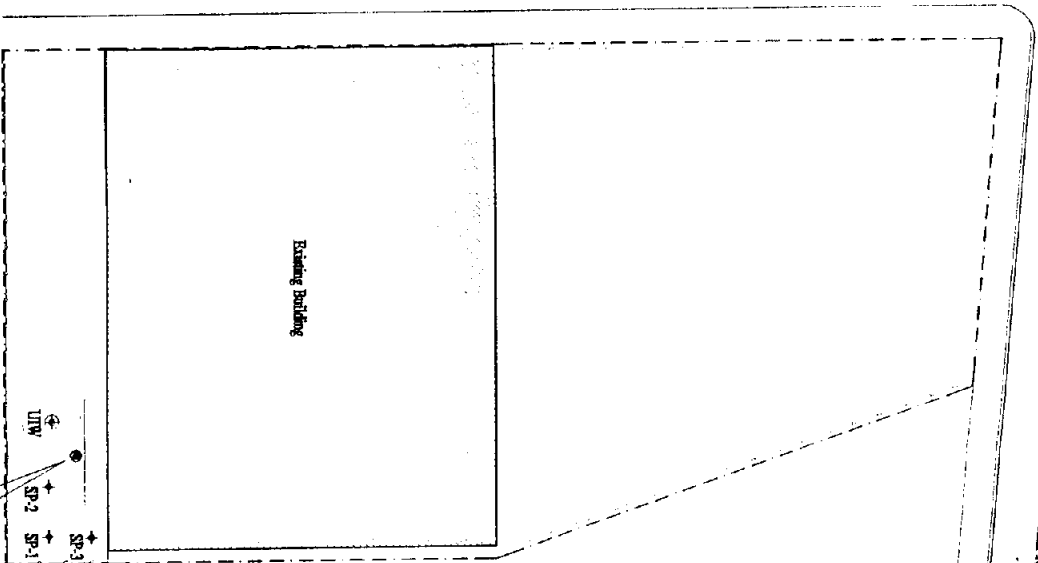

MW-1
100' x 100'
100' x 100'
100' x 100'

MW-2
100' x 100'
100' x 100'
100' x 100'

gasoline filling and automotive service station

November 6, 2003

This letter was sent to the people on the attached list.

Dear :

The New York State Department of Environmental Conservation (Department) maintains a Registry of sites where hazardous waste disposal has occurred. Property located at 410 West Main Street, in the Town of Huntington, County of Suffolk and designated as Tax Map Number 400-69-3-1 was recently added as a Class 2 in the Registry. The name and site I.D. number of this property as listed in the Registry is Country Cleaners, Site ID 152187.

The Classification Code 2 indicates that a significant threat to the public health or the environment exists -- action required.

We are sending this letter to you and others who own property near the site listed above, as well as the county and town clerks. We are notifying you about these activities at this site because we believe it is important to keep you informed.

If you currently are renting or leasing your property to someone else, please share this information with them. If you no longer own the property to which this letter was sent, please provide this information to the new owner and provide this office with the name and address of the new owner so that we can correct our records.

The reason for this recent classification decision is as follows:

- Results of soils and groundwater samples indicate the presence of tetrachloroethene (PCE) and degradation products in on-site soils and on-site and off-site groundwater. The groundwater contamination from this facility appears to have spread to the Getty Service station as early as 1996. This site is a significant threat to the environment. Groundwater contamination has affected a sole source aquifer.

If you have any questions or seek additional information, please contact me at (518) 402-9553, or in writing using the address given above.

Sincerely,

Kelly A. Bologna

Kelly A. Bologna
Chief
Site Control Section

cc: D. Desnoyers
C. Vasudevan
W. Parish, R/1
J. Pavacic, R/1
B. Fonda, R/1
G. Litwin
L. Ennist
V. Minei, SCHD
A. Sylvester

AS/srh

New York State Department of Environmental Conservation
Division of Environmental Remediation
Bureau of Technical Support, 11th Floor
625 Broadway, Albany, New York 12233-7020
Phone: (518) 402-9553 • FAX: (518) 402-9577
Website: www.dec.state.ny.us



OCT - 6 2008

CERTIFIED MAIL
RETURN RECEIPT REQUESTED

Steven Birchell
KBK Huntington Corp.
P.O. Box 676
Ruckersville, VA 22968

Dear Mr. Birchell:

As mandated by Section 27-1305 of the Environmental Conservation Law (ECL), copy enclosed, the New York State Department of Environmental Conservation (Department) must maintain a registry of all inactive disposal sites suspected or known to contain hazardous wastes. The ECL also mandates that this Department notify, by certified mail, the owner of all or any part of each site or area included in the Registry of Inactive Hazardous Waste Disposal Sites.

Our records indicate that you are the owner or part owner of the site listed below. Therefore, this letter constitutes notification of the inclusion of such site in the Registry of Inactive Hazardous Waste Disposal Sites in New York State. Once listed in the Registry, the site becomes subject to certain restrictions prescribed by provisions of 6NYCRR Part 375 (see enclosure).

DEC Site No.: 152187
Site Name: Country Cleaners
Site Address: 410 West Main Street, Huntington, NY 11743
Site Classification: 2

Enclosed is a copy of the Department's Inactive Hazardous Waste Disposal Site Report form as it appears in the Registry and Annual Report together with an explanation of the site classifications. The Law allows the owner and/or operator of a site listed in the Registry to petition the Commissioner of the New York State Department of Environmental Conservation

for deletion of such site, modification of site classification, or modification of any information regarding such site, by submitting a written statement setting forth the grounds of the petition. Such petition may be addressed to:

Ms. Erin M. Crotty
Commissioner
New York State Department of Environmental Conservation
625 Broadway
Albany, New York 12233-1010

For additional information, please contact me at (518) 402-9553.

Sincerely,



Kelly A. Bologna
Chief
Site Control Section

Enclosures

cc: w/o Enc.
D. Desnoyers
D. Weigel
R. Marino
K. Bologna
A. Sylvester
M. Spath

bc: w/Enc. (Copy of Site Report form only)
R. Dana
G. Litwin, NYSDOH
K. Murphy, R/1
W. Parish, R/1
J. Pavacic, R/1
C. Vasudevan
V. Minei, SCDH

AS/srh

NEW YORK STATE DEPARTMENT OF ENVIRONMENTAL CONSERVATION
Division of Environmental Remediation
Inactive Hazardous Waste Disposal Report

Site Name: Country Cleaners		Site Code: 152187	
Class Code: 2	Region: 1	County: Suffolk	EPA Id:
Address: 410 West Main Street / Huntington, NY 11743 (Locality: Huntington (T))			
Latitude: 40° 52' 26"		Longitude: 73° 27' 32"	
Site Type: Structure		Estimated Size: 0.2 Acres	

Site Owner / Operator Information:
Current Owner(s) Name: KBK Huntington Corp.
Current Owner(s) Address: P. O. Box 676 / Ruckersville, VA 22968
Owner(s) during disposal: KBK Huntington Corp.
Operator(s) during disposal: Country Cleaners
Stated Operator(s) Address: 410 West Main Street / Huntington, NY 11743
Hazardous Waste Disposal Period: From: Unknown To: Unknown

Site Description:
This site is located on the southeast (SE) corner of the intersection of West Main Street and Hillside Avenue, Huntington. The site contains a single occupancy building housing a dry cleaning store. The source of contamination is located in a narrow yard at the rear (south side) of the property. The east side of the yard is unpaved. Tetrachloroethene (PCE) contamination was found in the soil beneath a condensate pipe at the SE corner of the building and in a nearby storm drain. Under the order and oversight of the Suffolk County Department of Health Services (SCDHS), the owner conducted remediation of the storm drain and the removal of 2 inches of soil from the unpaved area. Approximately 1000 gallons of oily water and 36 tons of contaminated soils/sediments were removed to a depth of 26 feet below grade from the storm drain in December 2001. The results of the latest sampling indicate PCE contamination still remaining in the location near the SE corner of the building. An old floor drain was found in the floor of the boiler room during the course of the investigations. A thorough evaluation of this floor drain and associated piping was not possible due to the fact that the new boiler was placed directly over the drain. The floor drain represents a possible point of past discharges that may have contributed to the groundwater contamination believed to be originating from this site. The groundwater samples collected from the on-site and off-site monitoring wells show the presence of PCE and its degradation products.

Confirmed Hazardous Waste Disposal:
tetrachloroethene (PCE) (F002 Waste)

Quantity:
Unknown

Analytical Data Available for:	Groundwater	Soil	Sediment
Applicable Standards Exceeded in:	Groundwater	Drinking Water	
Geotechnical Information:		Depth to	
Soil/Rock Type: Sand and gravel		Groundwater:	Range:45 to 50 feet

Legal Action: Type:	Status:
Remedial Action:	Nature of action:

Assessment of Environmental Problems:
Soil and groundwater data suggest that PCE was disposed or spilled at this facility. Some remediation of soils was conducted. Further investigation and evaluation is needed for the site and the off-site groundwater plume.

Assessment of Health Problems: