

| | |
|---------------------|---|
| PROJECT: | Former Fulton MGP – Parcels III and IV (Site No.: 224051) |
| ADDRESS: | 545 Sackett St., Brooklyn, NY |
| PREPARED BY: | Roux Environmental Engineering and Geology, D.P.C. |
| DATE: | January 27, 2023 |
| WEATHER: | Temp: 37 - 42°F, Sunny, RH: 71% Pressure: 30.09" Hg Wind: W @ 5 mph |
| TIME: | 07:00 – 15:30 |

Project Team

General Contractor and Subcontractors:

- Mega Contracting Group, LLC
- Creamer Environmental, Inc.

Engineers/Consultants

- Roux Environmental Engineering and Geology, D.P.C.
- Mueser Rutledge Consulting Engineers, PLLC
- GZA GeoEnvironmental, Inc.

Remedial Action Work Summary

Work Activities Performed Onsite:

- Phase I excavation inside the tension fabric structure (TFS) and soil export continued from waste characterization grids WC-10(5-8') and WC-8(5-8');
- Dewatering pumping test continued, and;
- Installation of support of excavation elements continued.

Contractor Work Performed Onsite:

Creamer Environmental, Inc (CEI), continued excavation along the east and south portion of the TFS to an approximate depth of 8 feet below grade for the installation of support of excavation elements. CEI continued with installation of chairs and walers along the east boundary walls of grid WC-10.

CEI loaded 11 truckloads of soil, approximately 242 tons of MGP soil with TCE > 25 ppm from waste characterization grids WC-10 (5-8') and WC-8(5-8') for export to Clean Earth ESMI facility. Four (4) trucks were loaded with impacted concrete from excavation area WC-10/WC-11 for off-site disposal to Waste Management Fairless. And CEI imported 25.69 tons of 1 ½" Gravel (ASTM #3) from Vulcan Hamburg facility for use inside the TFS. All transport trucks were cleaned and inspected before leaving the site, to ensure no material was tracked offsite. Vapor management system (VMS) was in continuous operation during the workday. Measures to control dust (tarping and limiting vehicle speed) were applied throughout the day, as needed.

CEI continued with the dewatering pumping test. Approximately 72,240 gallons of groundwater was pumped from dewatering well DW5 and processed through the water treatment system for discharged to the New York City combined sewer system.

Air Monitoring:

- No community air monitoring program (CAMP) exceedances were observed during the day.
- GZA GeoEnvironmental, Inc. will provide a summary report for CAMP activities.

Erosion and Sediment Control

- Erosion and sediment controls were inspected to ensure that silt fence and filter sock were undamaged and operational.

Sampling Conducted:

- None

Other Items of Note:

- None

| | |
|---------------------|---|
| PROJECT: | Former Fulton MGP – Parcels III and IV (Site No.: 224051) |
| ADDRESS: | 545 Sackett St., Brooklyn, NY |
| PREPARED BY: | Roux Environmental Engineering and Geology, D.P.C. |
| DATE: | January 27, 2023 |
| WEATHER: | Temp: 37 - 42°F, Sunny, RH: 71% Pressure: 30.09" Hg Wind: W @ 5 mph |
| TIME: | 07:00 – 15:30 |

Imported Material

| Name - Location | Source | During This Reporting Period | | Total | |
|-----------------------------|-----------------------|------------------------------|-------|-------|----------|
| | | Loads | Tons | Loads | Tons |
| Vulcan ASTM #3 (1 ½" Stone) | Vulcan Hamburg Quarry | 1 | 25.69 | 5 | 127.83 |
| Vulcan General Fill | Vulcan Wantage Quarry | | | 71 | 1,800.42 |

Exported Material

| Material | Facility | During This Reporting Period | | Total | |
|---|------------------|------------------------------|------|-------|---------|
| | | Loads | Tons | Loads | Tons |
| Concrete for Recycling | Bayshore | | | 20 | 421.87 |
| TCE Impacted Haz Hot Spot | CWM Emelle | | | 7 | 161.72 |
| Cd Impacted Haz Material from WC-5 | CWM Emelle | | | 3 | 49.45 |
| Cd Impacted Haz Material from WC-5 | Clean Earth NJ | | | 16 | 397.75 |
| Impacted concrete | WM Fairless | 4 | ~88 | 30 | ~718.59 |
| Non-Haz Contaminated Urban Fill (orange zone) | WM Fairless | | | 13 | ~286 |
| Non-Haz Contaminated Urban Fill | WM Fairless | | | 48 | ~1056 |
| MGP soil with TCE>25 ppm | Clean Earth ESMI | 11 | ~242 | 50 | ~1108 |

Truck Log

| Number | Excavation Grid | Disposal Facility | Disposal Profile | Manifest Number | Trucking Company | Truck License Plate |
|--------|-----------------|-------------------|--------------------------|-----------------|------------------|---------------------|
| 1 | Concrete | WM Fairless | Impacted concrete | 12154480 | V&E | AY260E |
| 2 | concrete | WM Fairless | Impacted concrete | 12154481 | V&E | AY259E |
| 3 | WC-10(5-8) | ESMI-TCE >25 | MGP soil with TCE>25 ppm | BUG000040 | V&E | AW259D |
| 4 | WC-10(5-8) | ESMI-TCE >25 | MGP soil with TCE>25 ppm | BUG000041 | V&E | AW358B |
| 5 | WC-10(5-8) | ESMI-TCE >25 | MGP soil with TCE>25 ppm | BUG000042 | V&E | AT774E |
| 6 | WC-8(5-8) | ESMI-TCE >25 | MGP soil with TCE>25 ppm | BUG000043 | V&E | AW641V |
| 7 | WC-8(5-8) | ESMI-TCE >25 | MGP soil with TCE>25 ppm | BUG000044 | KHL | 33634NA |
| 8 | WC-8(5-8) | ESMI-TCE >25 | MGP soil with TCE>25 ppm | BUG000045 | KHL | 26288NB |
| 9 | WC-8(5-8) | ESMI-TCE >25 | MGP soil with TCE>25 ppm | BUG000046 | KHL | 65035NP |
| 10 | WC-8(5-8) | ESMI-TCE >25 | MGP soil with TCE>25 ppm | BUG000047 | V&E | AX709B |
| 11 | WC-8(5-8) | ESMI-TCE >25 | MGP soil with TCE>25 ppm | BUG000048 | KHL | 81119ML |
| 12 | WC-8(5-8) | ESMI-TCE >25 | MGP soil with TCE>25 ppm | BUG000049 | KHL | 60182PC |
| 13 | WC-8(5-8) | ESMI-TCE >25 | MGP soil with TCE>25 ppm | BUG000050 | Frick Farm | 15741PF |
| 14 | Concrete | WM Fairless | MGP soil with TCE>25 ppm | 12154482 | V&E | AY260E |
| 15 | Concrete | WM Fairless | Impacted concrete | 12154483 | V&E | AY259E |

Dewatering

| Time | Totalizer Volume (gallons)* |
|---------|-----------------------------|
| 7:15 AM | 305,072 |
| 2:30 PM | 323,235 |
| 3:30 PM | 326,582 |

Water treated since last report: 72,240 gallons

*Totalizer started at approximately 217,600 gallons of water measured at the beginning of the pumping test.

| | |
|---------------------|---|
| PROJECT: | Former Fulton MGP – Parcels III and IV (Site No.: 224051) |
| ADDRESS: | 545 Sackett St., Brooklyn, NY |
| PREPARED BY: | Roux Environmental Engineering and Geology, D.P.C. |
| DATE: | January 27, 2023 |
| WEATHER: | Temp: 37 - 42°F, Sunny, RH: 71% Pressure: 30.09" Hg Wind: W @ 5 mph |
| TIME: | 07:00 – 15:30 |

Anticipated Upcoming Work Activities

Load out and disposal of impacted concrete at Waste Management Fairless of Morrisville, PA, install of SOE and continue dewatering pumping test.

Site Layout

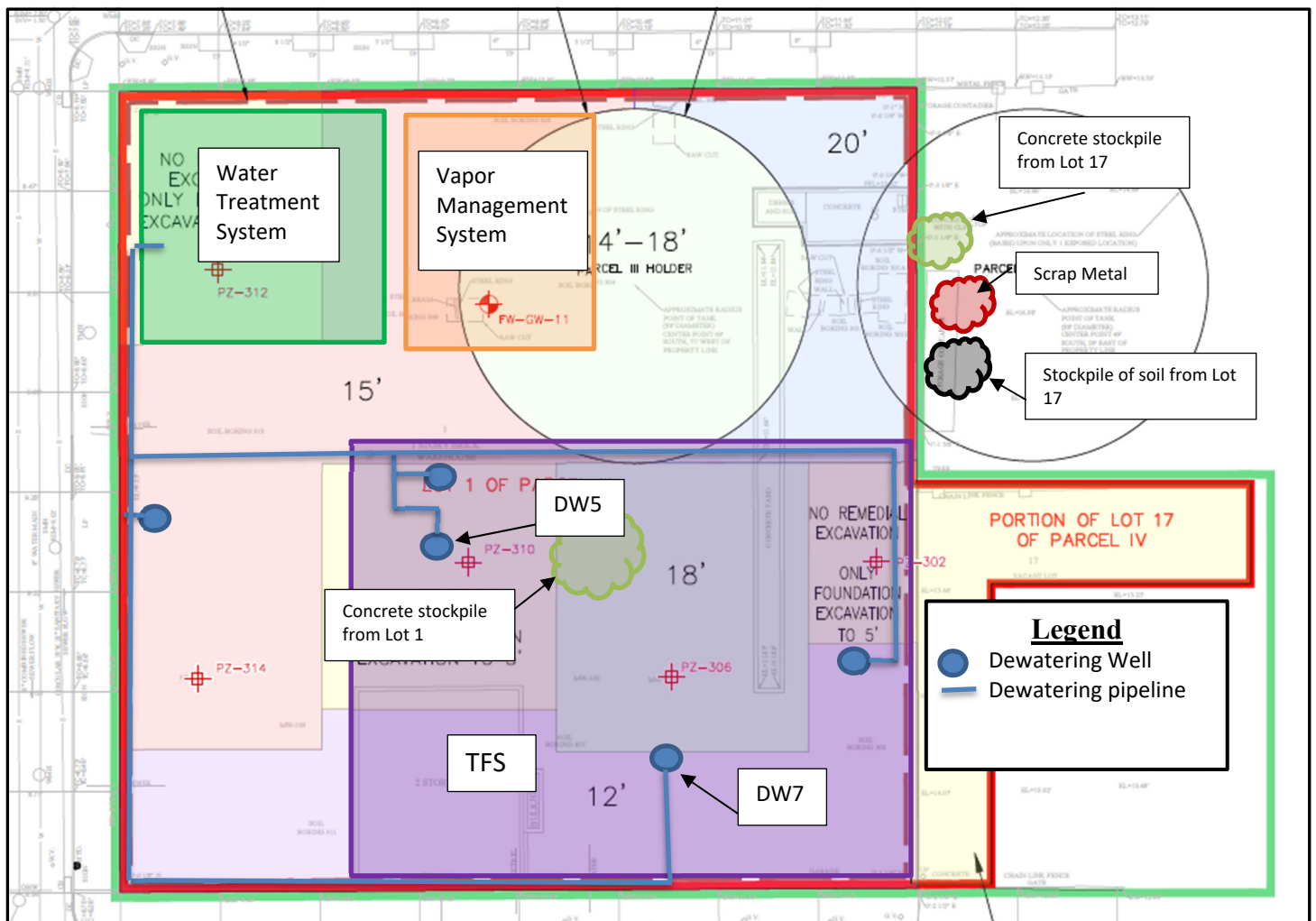

| | |
|---------------------|---|
| PROJECT: | Former Fulton MGP – Parcels III and IV (Site No.: 224051) |
| ADDRESS: | 545 Sackett St., Brooklyn, NY |
| PREPARED BY: | Roux Environmental Engineering and Geology, D.P.C. |
| DATE: | January 27, 2023 |
| WEATHER: | Temp: 37 - 42°F, Sunny, RH: 71% Pressure: 30.09" Hg Wind: W @ 5 mph |
| TIME: | 07:00 – 15:30 |

Excavation Diagram

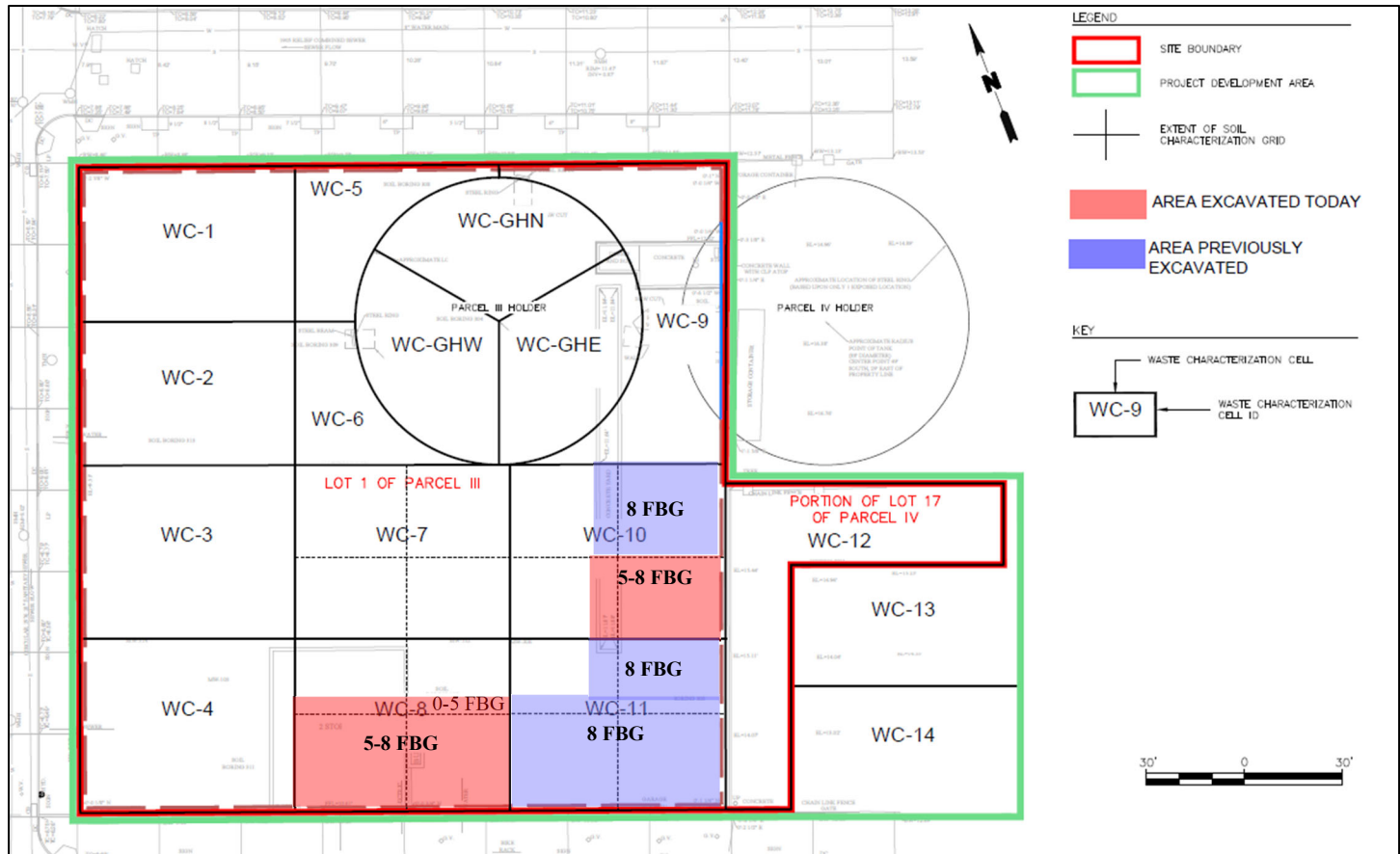

| | |
|--------------|---|
| PROJECT: | Former Fulton MGP – Parcels III and IV (Site No.: 224051) |
| ADDRESS: | 545 Sackett St., Brooklyn, NY |
| PREPARED BY: | Roux Environmental Engineering and Geology, D.P.C. |
| DATE: | January 27, 2023 |
| WEATHER: | Temp: 37 - 42°F, Sunny, RH: 71% Pressure: 30.09" Hg Wind: W @ 5 mph |
| TIME: | 07:00 – 15:30 |

Photographs of Onsite Work



Photo 1:

CEI loading soil from WC-10 (5-8)' for disposal to Clean Earth ESMI facility.



Photo 2:

Excavation along the south sides of WC-8 and WC-11.