

|                     |   |
|---------------------|---|
| <b>PROJECT:</b>     | Former Fulton MGP – Parcels III and IV (Site No.: 224051)           |
| <b>ADDRESS:</b>     | 545 Sackett St., Brooklyn, NY                                       |
| <b>PREPARED BY:</b> | Roux Environmental Engineering and Geology, D.P.C.                  |
| <b>DATE:</b>        | January 30, 2023  |
| <b>WEATHER:</b>     | Temp: 43 - 51°F, Sunny, RH: 75% Pressure: 30.20" Hg Wind: S @ 2 mph |
| <b>TIME:</b>        | 07:00 – 15:30   |

### Project Team

#### *General Contractor and Subcontractors:*

- Mega Contracting Group, LLC
- Creamer Environmental, Inc.

#### *Engineers/Consultants*

- Roux Environmental Engineering and Geology, D.P.C.
- Mueser Rutledge Consulting Engineers, PLLC
- GZA GeoEnvironmental, Inc.

### Remedial Action Work Summary

#### Work Activities Performed Onsite:

- Load out of impacted concrete previously stockpiled inside the tension fabric structure (TFS);
- Dewatering pumping test continued, and;
- Installation of support of excavation (SOE) elements continued.

#### Contractor Work Performed Onsite:

Creamer Environmental, Inc (CEI), continued loadout of impacted concrete that was previously excavated from WC-10 and WC-11 and stockpiled inside the TFS. Four loads of impacted concrete were shipped to Waste Management Fairless for disposal. All transport trucks were cleaned and inspected before leaving the site, to ensure no material was tracked offsite. Vapor management system (VMS) was in continuous operation during the workday. Measures to control dust (tarping and limiting vehicle speed) were applied throughout the day, as needed.

CEI continued with the dewatering pumping test. CEI pumped Approximately 34,407 gallons of groundwater from dewatering well DW4. All recovered water was processed through the water treatment system and discharged to the New York City combined sewer system. Installation of the SOE elements also continued with installation of chairs and walers along the east and south sides of grid WC-10.

#### Air Monitoring:

- No community air monitoring program (CAMP) exceedances were observed during the day.
- GZA GeoEnvironmental, Inc. will provide a summary report for CAMP activities.

#### Erosion and Sediment Control

- Erosion and sediment controls were inspected to ensure that silt fence and filter sock were undamaged and operational.

#### Sampling Conducted:

- None

#### Other Items of Note:

- None

|                     |   |
|---------------------|---|
| <b>PROJECT:</b>     | Former Fulton MGP – Parcels III and IV (Site No.: 224051)           |
| <b>ADDRESS:</b>     | 545 Sackett St., Brooklyn, NY                                       |
| <b>PREPARED BY:</b> | Roux Environmental Engineering and Geology, D.P.C.                  |
| <b>DATE:</b>        | January 30, 2023  |
| <b>WEATHER:</b>     | Temp: 43 - 51°F, Sunny, RH: 75% Pressure: 30.20" Hg Wind: S @ 2 mph |
| <b>TIME:</b>        | 07:00 – 15:30   |

**Imported Material**

| Name - Location             | Source                | During This Reporting Period |      | Total |          |
|-----------------------------|-----------------------|------------------------------|------|-------|----------|
|                             |                       | Loads                        | Tons | Loads | Tons     |
| Vulcan ASTM #3 (1 ½" Stone) | Vulcan Hamburg Quarry |                              |      | 5     | 127.83   |
| Vulcan General Fill         | Vulcan Wantage Quarry |                              |      | 71    | 1,800.42 |
|                             |                       |                              |      |       |          |

**Exported Material**

| Material                                      | Facility         | During This Reporting Period |      | Total |         |
|---|------------------|------------------------------|------|-------|---------|
|   |                  | Loads                        | Tons | Loads | Tons    |
| Concrete for Recycling                        | Bayshore         |                              |      | 20    | 421.87  |
| TCE Impacted Haz Hot Spot                     | CWM Emelle       |                              |      | 7     | 161.72  |
| Cd Impacted Haz Material from WC-5            | CWM Emelle       |                              |      | 3     | 49.45   |
| Cd Impacted Haz Material from WC-5            | Clean Earth NJ   |                              |      | 16    | 397.75  |
| Impacted concrete                             | WM Fairless      | 4                            | ~88  | 34    | ~806.59 |
| Non-Haz Contaminated Urban Fill (orange zone) | WM Fairless      |                              |      | 13    | ~286    |
| Non-Haz Contaminated Urban Fill               | WM Fairless      |                              |      | 48    | ~1056   |
| MGP soil with TCE>25 ppm                      | Clean Earth ESMI |                              |      | 50    | ~1108   |

**Truck Log**

| Number | Excavation Grid | Disposal Facility | Disposal Profile  | Manifest Number | Trucking Company | Truck License Plate |
|--------|-----------------|-------------------|-------------------|-----------------|------------------|---------------------|
| 1      | Concrete        | WM Fairless       | Impacted concrete | 12154484        | V&E              | AY259E              |
| 2      | Concrete        | WM Fairless       | Impacted concrete | 12154485        | V&E              | AT774E              |
| 3      | Concrete        | WM Fairless       | Impacted concrete | 12154486        | V&E              | AY259E              |
| 4      | Concrete        | WM Fairless       | Impacted concrete | 12154487        | V&E              | AT774E              |

**Dewatering**

| Time   | Totalizer Volume (gallons)* |
|--|-----------------------------|
| 7:11 AM  | 326,582                     |
| 4:28 PM  | 360,989                     |
|  |                             |
| Water treated and discharged since last report: 34,407 gallons |                             |

**Anticipated Upcoming Work Activities**

Load out and disposal of impacted concrete at Waste Management Fairless of Morrisville, PA, continued installation of SOE and operation of dewatering system.

|                     |   |
|---------------------|---|
| <b>PROJECT:</b>     | Former Fulton MGP – Parcels III and IV (Site No.: 224051)           |
| <b>ADDRESS:</b>     | 545 Sackett St., Brooklyn, NY                                       |
| <b>PREPARED BY:</b> | Roux Environmental Engineering and Geology, D.P.C.                  |
| <b>DATE:</b>        | January 30, 2023  |
| <b>WEATHER:</b>     | Temp: 43 - 51°F, Sunny, RH: 75% Pressure: 30.20" Hg Wind: S @ 2 mph |
| <b>TIME:</b>        | 07:00 – 15:30   |

### Site Layout

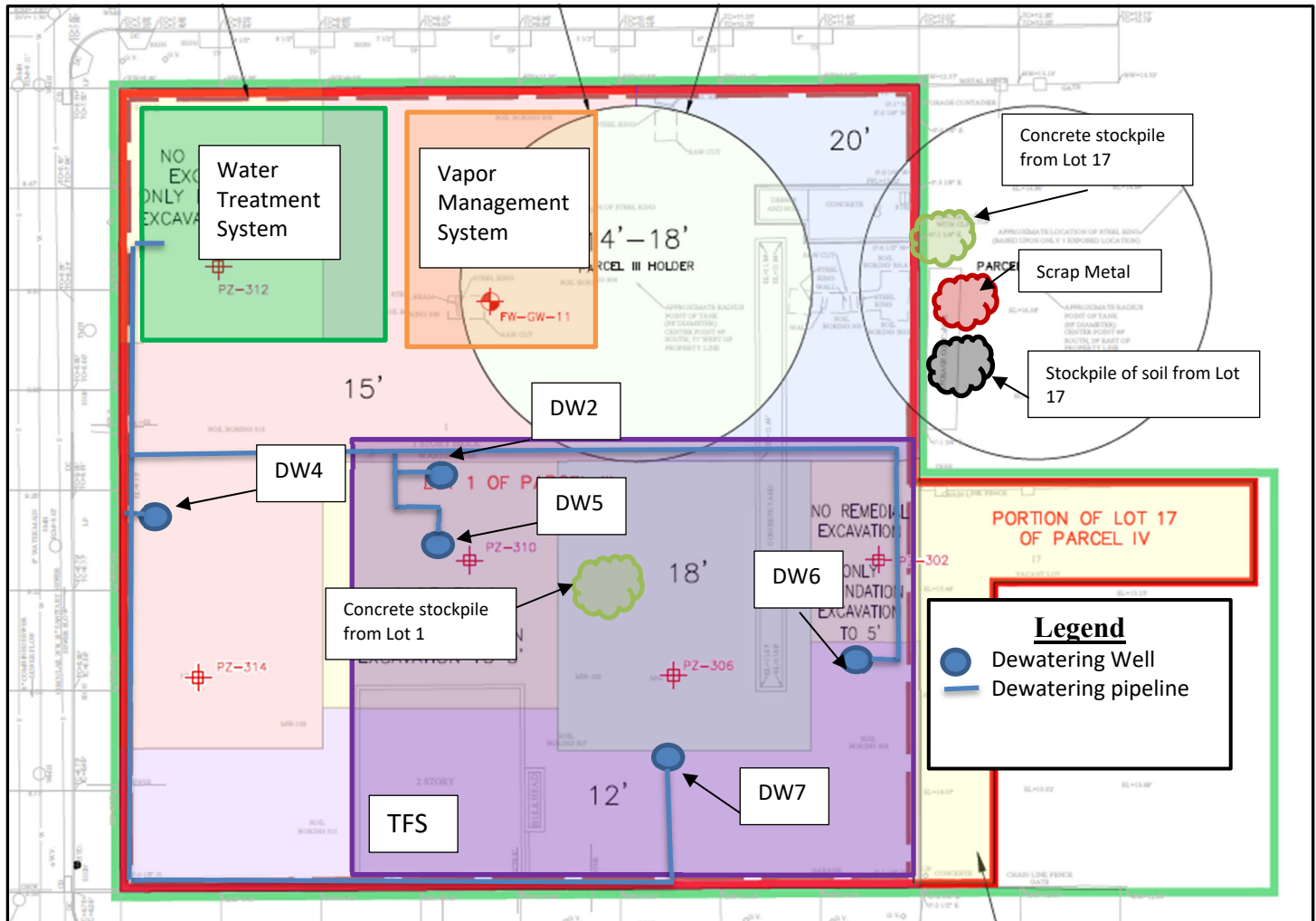

|                     |   |
|---------------------|---|
| <b>PROJECT:</b>     | Former Fulton MGP – Parcels III and IV (Site No.: 224051)           |
| <b>ADDRESS:</b>     | 545 Sackett St., Brooklyn, NY                                       |
| <b>PREPARED BY:</b> | Roux Environmental Engineering and Geology, D.P.C.                  |
| <b>DATE:</b>        | January 30, 2023  |
| <b>WEATHER:</b>     | Temp: 43 - 51°F, Sunny, RH: 75% Pressure: 30.20" Hg Wind: S @ 2 mph |
| <b>TIME:</b>        | 07:00 – 15:30   |

### Excavation Diagram

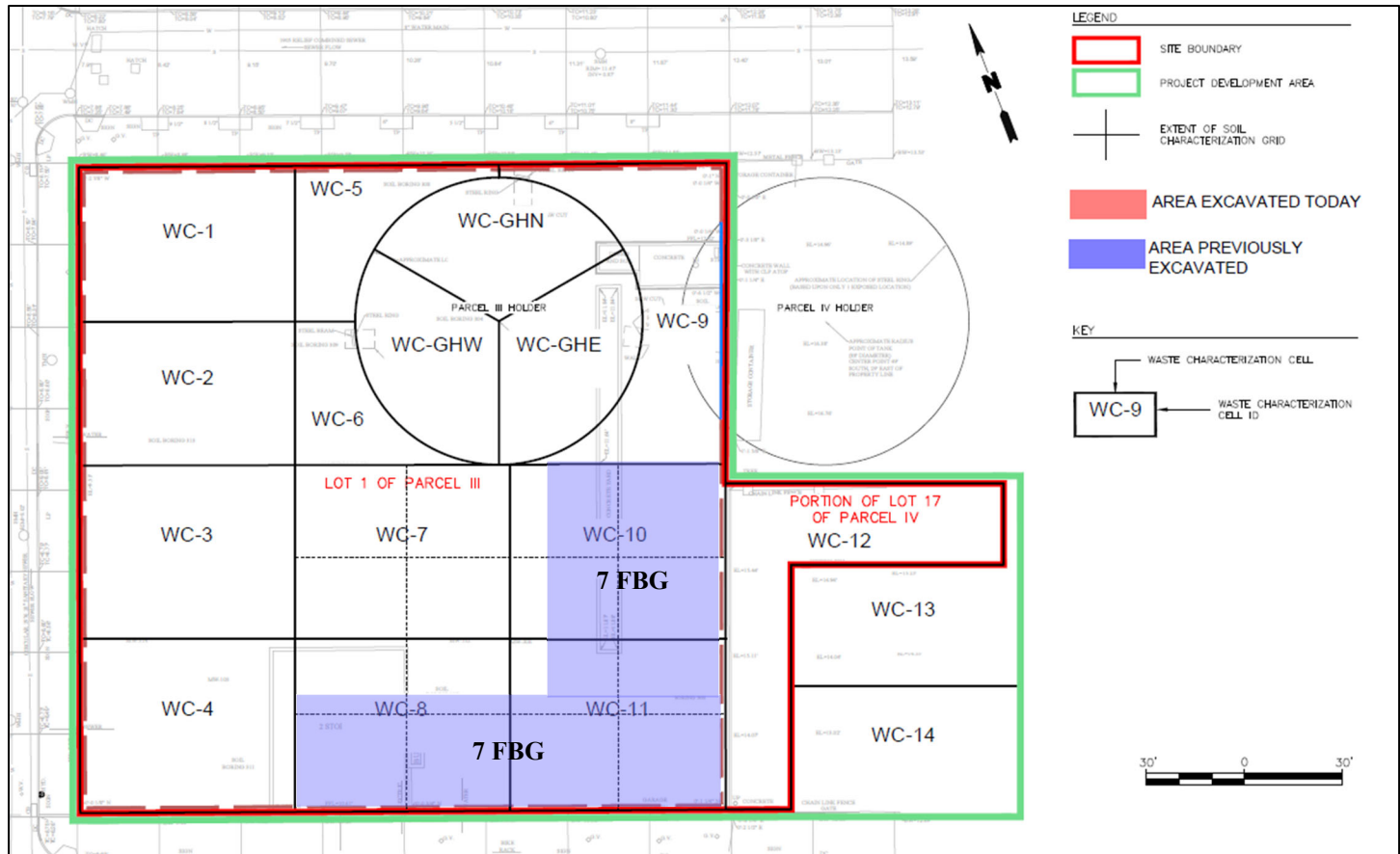

|                     |   |
|---------------------|---|
| <b>PROJECT:</b>     | Former Fulton MGP – Parcels III and IV (Site No.: 224051)           |
| <b>ADDRESS:</b>     | 545 Sackett St., Brooklyn, NY                                       |
| <b>PREPARED BY:</b> | Roux Environmental Engineering and Geology, D.P.C.                  |
| <b>DATE:</b>        | January 30, 2023  |
| <b>WEATHER:</b>     | Temp: 43 - 51°F, Sunny, RH: 75% Pressure: 30.20" Hg Wind: S @ 2 mph |
| <b>TIME:</b>        | 07:00 – 15:30   |

**Photographs of Onsite Work**



**Photo 1:**

CEI removing soil from along the steel sheeting in WC-11 in preparation of future loadout and installation of SOE.



**Photo 2:**

Installing SOE along the south sides of WC-8 and WC-11.