

PROJECT:	Former Fulton MGP – Parcels III and IV (Site No.: 224051)
ADDRESS:	545 Sackett St., Brooklyn, NY
PREPARED BY:	Roux Environmental Engineering and Geology, D.P.C.
DATE:	February 16, 2023
WEATHER:	Temp: 54 - 61°F, Mostly Cloudy, RH: 60% Pressure: 30.05" Hg Wind: S @ 5 mph
TIME:	07:00 – 15:30

Project Team

General Contractor and Subcontractors:

- Mega Contracting Group, LLC
- Creamer Environmental, Inc. (CEI)
- Keller Group PLC (Keller)

Engineers/Consultants

- Roux Environmental Engineering and Geology, D.P.C.
- Mueser Rutledge Consulting Engineers, PLLC
- GZA GeoEnvironmental, Inc.

Remedial Action Work Summary

Work Activities Performed Onsite:

- Export of soil from waste characterization grids WC-9 (0-5') and WC-6(0-5') for off-site disposal at Clean Earth ESMI; and
- Continued installation of support of excavation (SOE) elements inside the tension fabric structure (TFS).

Contractor Work Performed Onsite:

Creamer Environmental, Inc (CEI) loaded out three (3) truckloads (approximately 66 tons) of previously excavated and stockpiled MGP impacted material with trichloroethylene > 25 ppm from waste characterization grids WC-6 (0-5') and WC-9 (0-5') for off-site disposal at Clean Earth ESMI facility. All transport trucks were cleaned and inspected before leaving the site to ensure no fill material was tracked off-site.

CEI continued installation of SOE elements (walers, bracing, etc.) along the south wall of waste characterization grid WC-8. Keller continued tieback installation along the south walls of grid WC-11. All water generated during tieback installation was recovered and sent to the water treatment system for storage and future processing.

CEI relocated construction materials (scrap metal, concrete, and stockpiled soil) stockpiled at Lot 49 to accommodate future lead delineation sampling in the vicinity of former Gas Holder 4. CEI minimized generating dust during the relocation of material by applying water, as needed. CEI prepared to swap out one of the blowers associated with the Vapor Management System (VMS). The remaining three blowers were operated continuously during all work activities inside the TFS to limit odor and dust impacts from the work.

Air Monitoring:

- No community air monitoring program (CAMP) exceedances were observed during the day.
- GZA GeoEnvironmental, Inc. will provide a summary report for CAMP activities.

Erosion and Sediment Control

- Erosion and sediment controls were inspected to ensure that silt fence and filter sock were undamaged and operational.

Sampling Conducted:

- None

Other Items of Note:

- None
-

PROJECT:	Former Fulton MGP – Parcels III and IV (Site No.: 224051)
ADDRESS:	545 Sackett St., Brooklyn, NY
PREPARED BY:	Roux Environmental Engineering and Geology, D.P.C.
DATE:	February 16, 2023
WEATHER:	Temp: 54 - 61°F, Mostly Cloudy, RH: 60% Pressure: 30.05" Hg Wind: S @ 5 mph
TIME:	07:00 – 15:30

Imported Material

Name - Location	Source	During This Reporting Period		Total	
		Loads	Tons	Loads	Tons
Vulcan ASTM #3 (1 ½" Stone)	Vulcan Hamburg Quarry			5	127.83
Vulcan General Fill	Vulcan Wantage Quarry			71	1,800.42

Exported Material

Material	Facility	During This Reporting Period		Total	
		Loads	Tons	Loads	Tons
Concrete for Recycling	Bayshore			20	421.87
Concrete for Landfill	WM Fairless			37	~872.59
TCE Impacted Haz Hot Spot	CWM Emelle			7	161.72
Cd Impacted Haz Material from WC-5	CWM Emelle			3	49.45
Cd Impacted Haz Material from WC-5	Clean Earth NJ			16	397.75
Non-Haz Contaminated Urban Fill	WM Fairless			75	~1,650
MGP soil with TCE>25 ppm	Clean Earth ESMI	3	66	56	~1,240

Truck Log

Number	Excavation Grid	Disposal Facility	Disposal Profile	Manifest Number	Trucking Company	Truck License Plate
1	WC-9(0-5')	ESMI-TCE >25	MGP soil with TCE>25 ppm	BUG000054	Frick Farm	15741PF
2	WC-6(0-5')	ESMI-TCE >25	MGP soil with TCE>25 ppm	BUG000055	V&E	AY774E
3	WC-6(0-5')	ESMI-TCE >25	MGP soil with TCE>25 ppm	BUG000056	V&E	AX709B

Dewatering

Time	Totalizer Volume (gallons)*
7:10 AM	434,497
15:00 PM	434,497
Water treated and discharged since last report: 0.0 gallons	

Anticipated Upcoming Work Activities

Load out material from grids WC-6 and WC-11 for off-site disposal at Clean Earth ESMI and WM Fairless facilities, respectively. Continued installation of SOE and tiebacks inside the TFS.

PROJECT:	Former Fulton MGP – Parcels III and IV (Site No.: 224051)
ADDRESS:	545 Sackett St., Brooklyn, NY
PREPARED BY:	Roux Environmental Engineering and Geology, D.P.C.
DATE:	February 16, 2023
WEATHER:	Temp: 54 - 61°F, Mostly Cloudy, RH: 60% Pressure: 30.05" Hg Wind: S @ 5 mph
TIME:	07:00 – 15:30

Site Layout

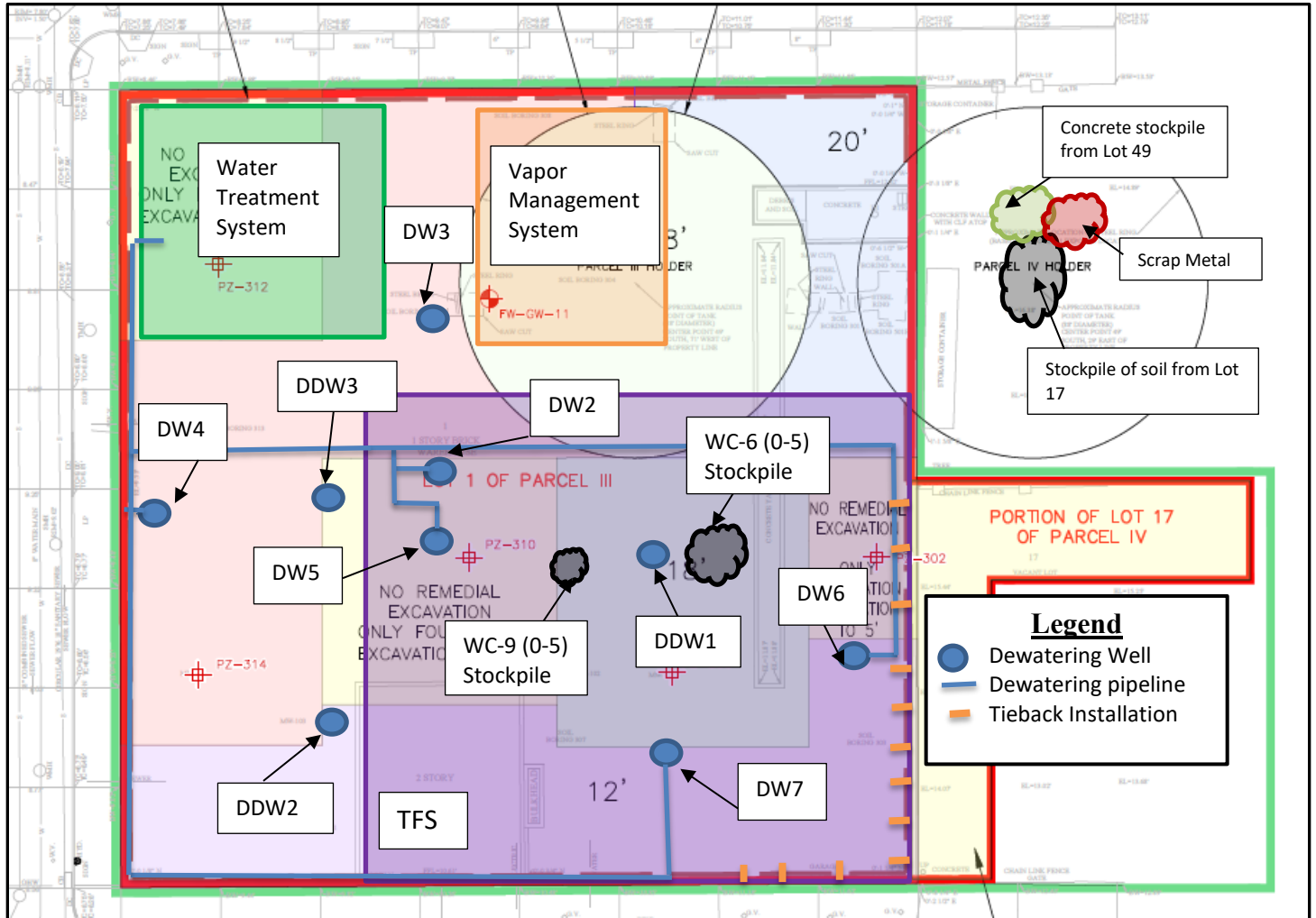

PROJECT:	Former Fulton MGP – Parcels III and IV (Site No.: 224051)
ADDRESS:	545 Sackett St., Brooklyn, NY
PREPARED BY:	Roux Environmental Engineering and Geology, D.P.C.
DATE:	February 16, 2023
WEATHER:	Temp: 54 - 61°F, Mostly Cloudy, RH: 60% Pressure: 30.05" Hg Wind: S @ 5 mph
TIME:	07:00 – 15:30

Excavation Diagram

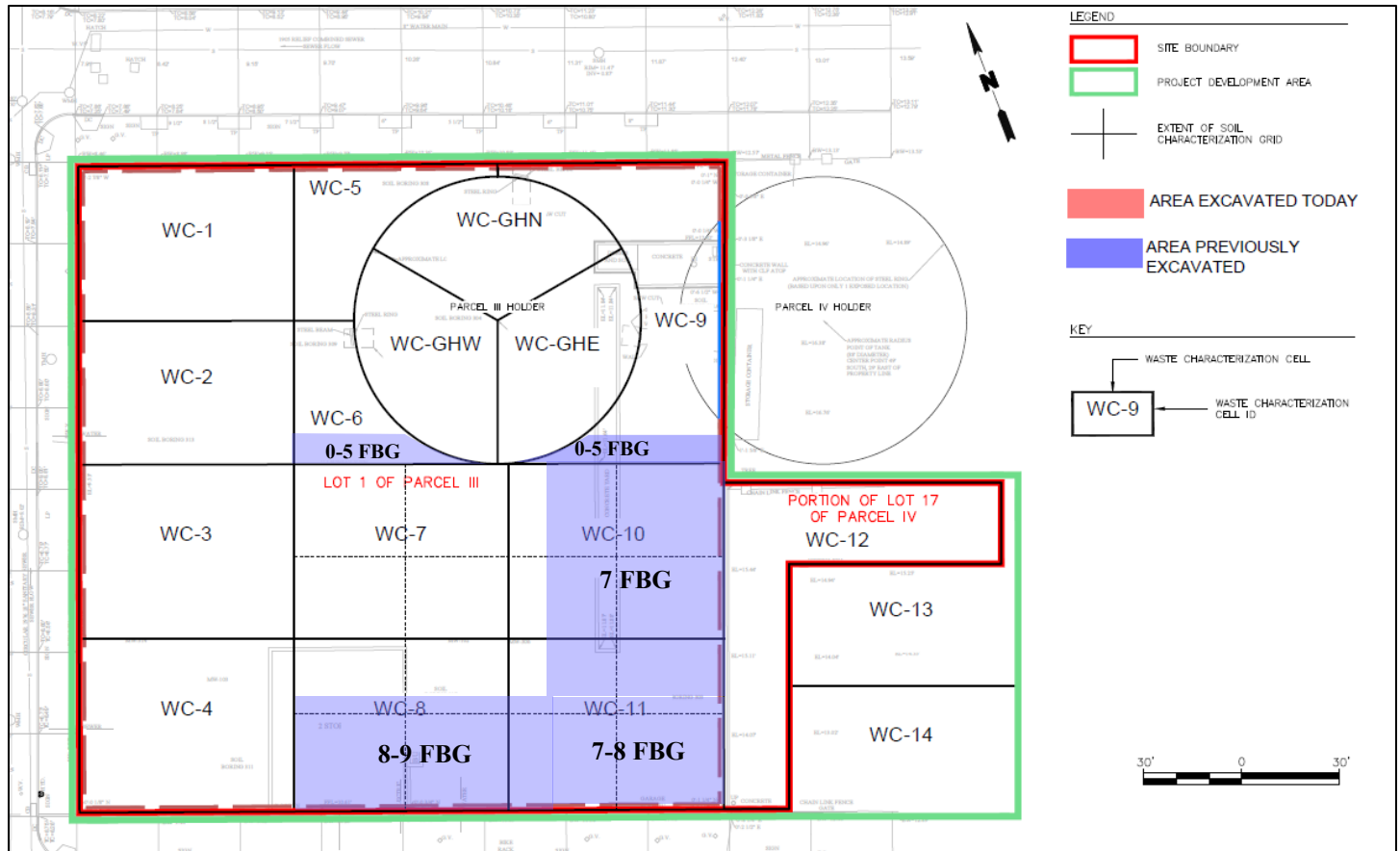

PROJECT:	Former Fulton MGP – Parcels III and IV (Site No.: 224051)
ADDRESS:	545 Sackett St., Brooklyn, NY
PREPARED BY:	Roux Environmental Engineering and Geology, D.P.C.
DATE:	February 16, 2023
WEATHER:	Temp: 54 - 61°F, Mostly Cloudy, RH: 60% Pressure: 30.05" Hg Wind: S @ 5 mph
TIME:	07:00 – 15:30

Photographs of Onsite Work



Photo 1:

Keller performing tieback installation along south perimeter wall in grid WC-11.



Photo 2:

CEI loading soil into trucks for soil export to Clean Earth ESMI facility.