

PROJECT:	Former Fulton MGP – Parcels III and IV (Site No.: 224051)
ADDRESS:	545 Sackett St., Brooklyn, NY
PREPARED BY:	Roux Environmental Engineering and Geology, D.P.C.
DATE:	February 17, 2023
WEATHER:	Temp: 54 - 61°F, Overcast/Rain, RH: 91% Pressure: 29.24" Hg Wind: SW @ 7 mph
TIME:	07:00 – 15:30

Project Team

General Contractor and Subcontractors:

- Mega Contracting Group, LLC
- Creamer Environmental, Inc. (CEI)
- Keller Group PLC (Keller)

Engineers/Consultants

- Roux Environmental Engineering and Geology, D.P.C.
- Mueser Rutledge Consulting Engineers, PLLC
- GZA GeoEnvironmental. Inc.

Remedial Action Work Summary

Work Activities Performed Onsite:

- Loaded out soil from waste characterization grids WC-6 (0-5') and WC-11 (5-8') for off-site disposal at Clean Earth ESMI and at WM Fairless facilities;
- Excavation and stockpile of material from waste characterization grid WC-8 (3-8') for future off-site disposal.
- Continued installation of support of excavation (SOE) elements inside the tension fabric structure (TFS).

Contractor Work Performed Onsite:

Creamer Environmental, Inc (CEI) loaded out a total of (3) three truckloads. One truckload of manufactured gas plant impacted soil with trichloroethylene > 25 ppm from waste characterization grid WC-6(0-5') was sent for disposal at Clean Earth ESMI facility. The remaining two truckloads, approximately 44 tons of non-hazardous urban fill from waste characterization grid WC-11(5-8') was sent to Waste Management Fairless for disposal. All transport trucks were cleaned and inspected before leaving the site to ensure no fill material was tracked off-site.

In addition, CEI excavated and temporarily stockpiled material from waste characterization grid WC-8(3-5') and WC-8(5-8') for future off-site disposal to Clean Earth ESMI and Waste Management Fairless facility inside the tension fabric structure (TFS). CEI swapped out blower # 3 associated with Vapor Management System (VMS). The remaining blowers (3 units) were operated during all work activities inside the TFS to limit the odors and dust impacts from work. CEI conducted dust control measurements (wetting, tarping, limiting vehicle speeds, etc.) as needed.

CEI continued installation of SOE elements (walers, bracing, etc.) along the south wall of waste characterization grid WC-8. CEI relocated crane mats along the south boundary wall of grid wc-11 to continue with SOE installation. Keller continued tieback installation along the south walls of grids WC-8 and WC-11. All water generated during tieback installation was recovered and sent to the water treatment system for storage and future processing.

Air Monitoring:

- No community air monitoring program (CAMP) exceedances were observed during the day.
- GZA GeoEnvironmental. Inc. will provide a summary report for CAMP activities.

Erosion and Sediment Control

- Erosion and sediment controls were inspected to ensure that silt fence and filter sock were undamaged and operational.

Sampling Conducted:

- None

PROJECT:	Former Fulton MGP – Parcels III and IV (Site No.: 224051)
ADDRESS:	545 Sackett St., Brooklyn, NY
PREPARED BY:	Roux Environmental Engineering and Geology, D.P.C.
DATE:	February 17, 2023
WEATHER:	Temp: 54 - 61°F, Overcast/Rain, RH: 91% Pressure: 29.24" Hg Wind: SW @ 7 mph
TIME:	07:00 – 15:30

Other Items of Note:

- None

Imported Material

Name - Location	Source	During This Reporting Period		Total	
		Loads	Tons	Loads	Tons
Vulcan ASTM #3 (1 ½" Stone)	Vulcan Hamburg Quarry			5	127.83
Vulcan General Fill	Vulcan Wantage Quarry			71	1,800.42

Exported Material

Material	Facility	During This Reporting Period		Total	
		Loads	Tons	Loads	Tons
Concrete for Recycling	Bayshore			20	421.87
Concrete for Landfill	WM Fairless			37	~872.59
TCE Impacted Haz Hot Spot	CWM Emelle			7	161.72
Cd Impacted Haz Material from WC-5	CWM Emelle			3	49.45
Cd Impacted Haz Material from WC-5	Clean Earth NJ			16	397.75
Non-Haz Contaminated Urban Fill	WM Fairless	2	44	77	~1,694
MGP soil with TCE>25 ppm	Clean Earth ESMI	1	22	56	~1,262

Truck Log

Number	Excavation Grid	Disposal Facility	Disposal Profile	Manifest Number	Trucking Company	Truck License Plate
1	WC-6(0-5')	ESMI-TCE >25	MGP soil with TCE>25 ppm	BUG000057	Frick Farm	15741PF
2	WC-11(5-8')	WM Fairless	Non-haz urban fill	12228227	V&E	AX709B
3	WC-11(5-8')	WM Fairless	Non-haz urban fill	12228228	V&E	AX709B

Dewatering

Time	Totalizer Volume (gallons)*
7:10 AM	434,497
15:00 PM	434,497
Water treated and discharged since last report:	0.0 gallons

Anticipated Upcoming Work Activities

Continued installation of SOE and tiebacks inside the TFS. Load out material from grids WC-8 for off-site disposal at Clean Earth ESMI and WM Fairless facilities, respectively. Sample collection for lead delineation at the former gas holder IV property.

PROJECT:	Former Fulton MGP – Parcels III and IV (Site No.: 224051)
ADDRESS:	545 Sackett St., Brooklyn, NY
PREPARED BY:	Roux Environmental Engineering and Geology, D.P.C.
DATE:	February 17, 2023
WEATHER:	Temp: 54 - 61°F, Overcast/Rain, RH: 91% Pressure: 29.24" Hg Wind: SW @ 7 mph
TIME:	07:00 – 15:30

Site Layout

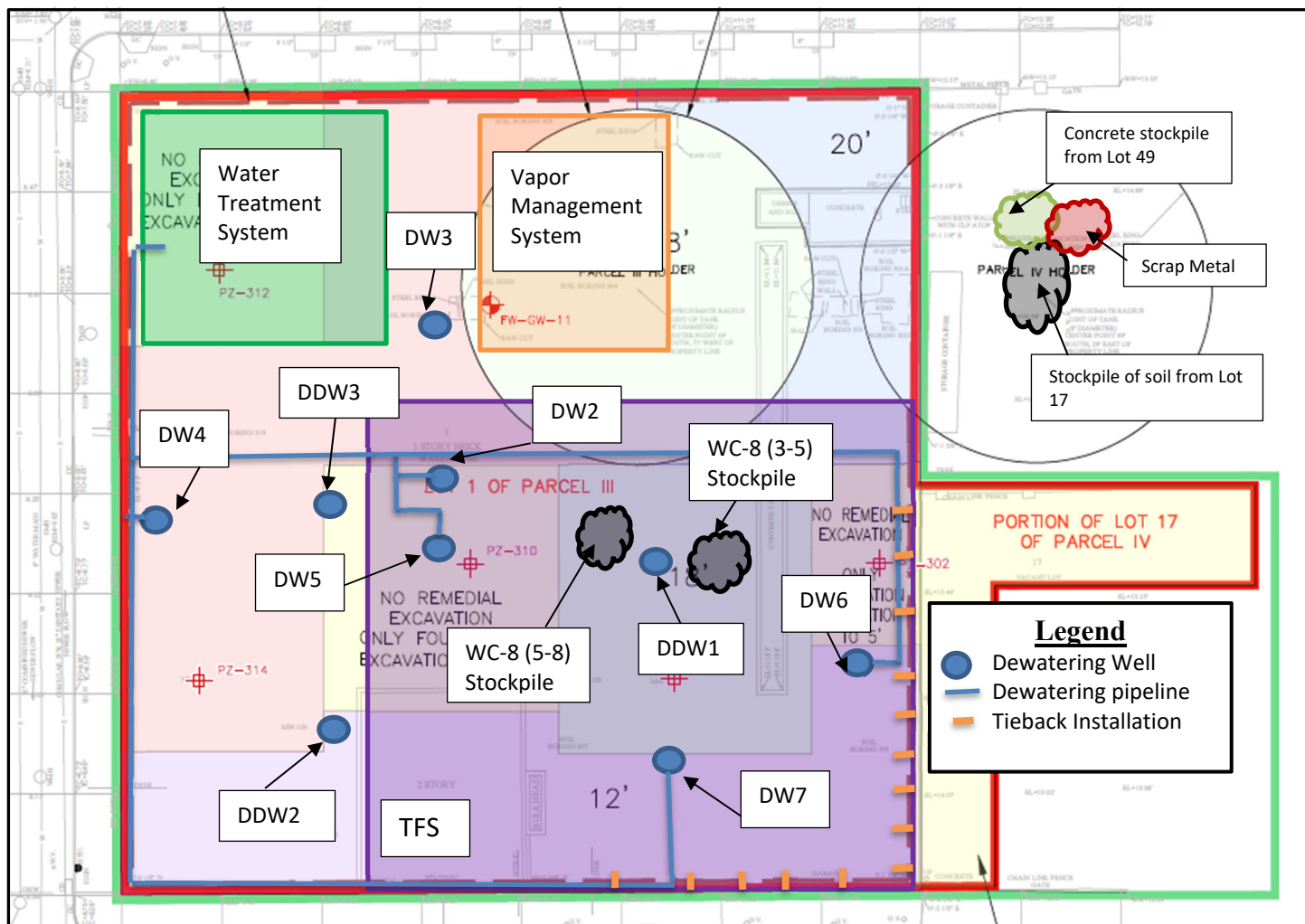

PROJECT:	Former Fulton MGP – Parcels III and IV (Site No.: 224051)
ADDRESS:	545 Sackett St., Brooklyn, NY
PREPARED BY:	Roux Environmental Engineering and Geology, D.P.C.
DATE:	February 17, 2023
WEATHER:	Temp: 54 - 61°F, Overcast/Rain, RH: 91% Pressure: 29.24" Hg Wind: SW @ 7 mph
TIME:	07:00 – 15:30

Excavation Diagram

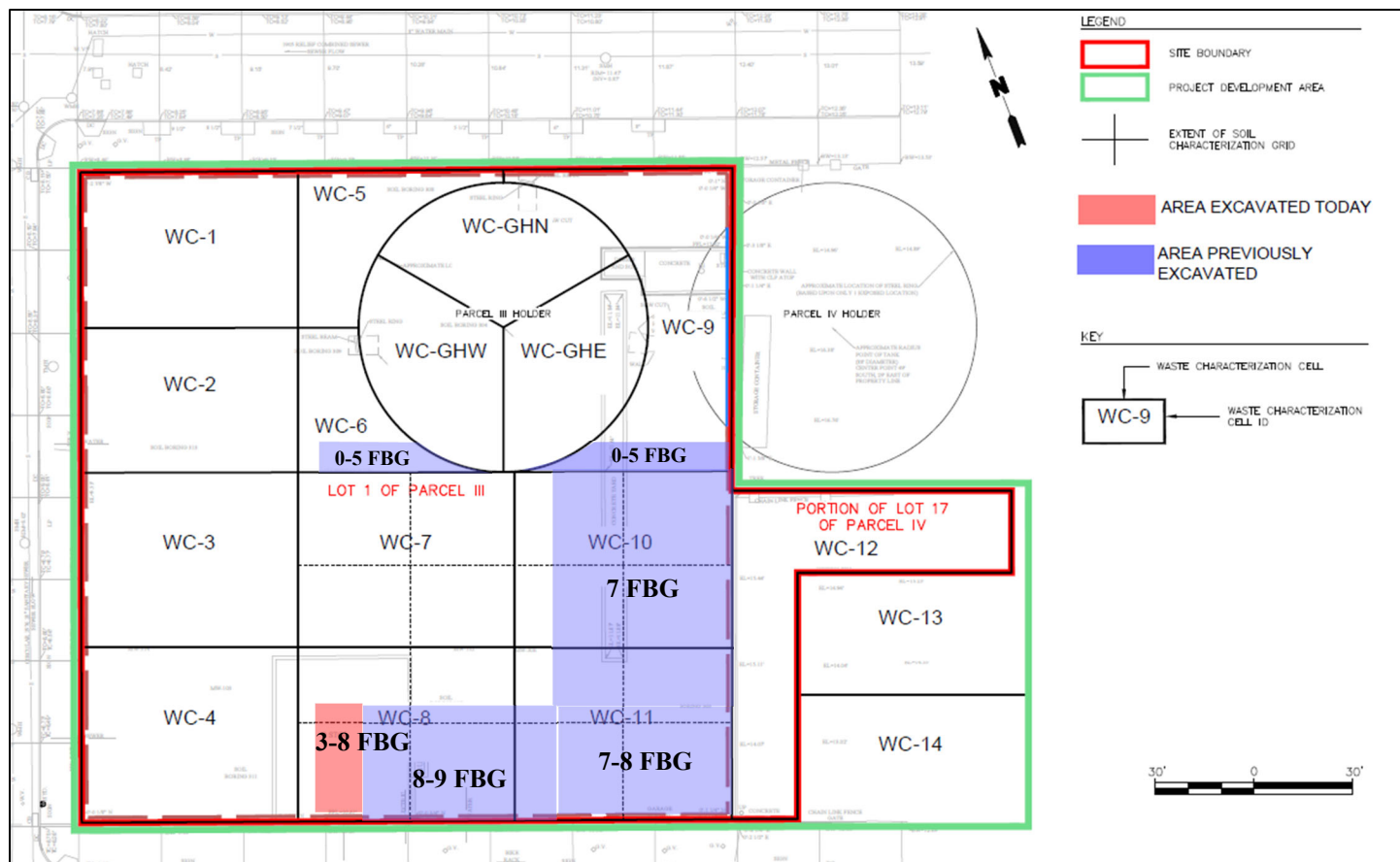

PROJECT:	Former Fulton MGP – Parcels III and IV (Site No.: 224051)
ADDRESS:	545 Sackett St., Brooklyn, NY
PREPARED BY:	Roux Environmental Engineering and Geology, D.P.C.
DATE:	February 17, 2023
WEATHER:	Temp: 54 - 61°F, Overcast/Rain, RH: 91% Pressure: 29.24" Hg Wind: SW @ 7 mph
TIME:	07:00 – 15:30

Photographs of Onsite Work



Photo 1:

CEI Loading soil into trucks for soil export to Clean Earth ESMI facility.



Photo 2:

CEI relocating crane mats to continue tieback installation.