

<b>PROJECT:</b>	Former Fulton MGP – Parcels III and IV (Site No.: 224051)
<b>ADDRESS:</b>	545 Sackett St., Brooklyn, NY
<b>PREPARED BY:</b>	Roux Environmental Engineering and Geology, D.P.C.
<b>DATE:</b>	February 27, 2023
<b>WEATHER:</b>	Temp: 35-42°F, Cloudy, RH: 55% Pressure: 30.01" Hg Wind: N @ 4 mph
<b>TIME:</b>	07:00 – 15:30

### Project Team

#### *General Contractor and Subcontractors:*

- Mega Contracting Group, LLC
- Creamer Environmental, Inc. (CEI)
- Keller Group PLC (Keller)

#### *Engineers/Consultants*

- Roux Environmental Engineering and Geology, D.P.C.
- Mueser Rutledge Consulting Engineers, PLLC
- GZA GeoEnvironmental. Inc.

### Remedial Action Work Summary

#### Work Activities Performed Onsite:

- Loaded out soil for off-site disposal from waste characterization grid WC-11(8-10') to Waste Management Fairless;
- Excavated and stockpiled of soil from waste characterization Grids WC-10 and WC-11 for future soil disposal to Clean Earth ESMI and Waste Management Fairless;
- Completed of support of excavation (SOE) elements for Phase 1 excavation work inside the tension fabric structure (TFS);
- Began dewatering and pumping test from dewatering wells DW5, DW6 and DW7.

#### Contractor Work Performed Onsite:

Creamer Environmental, Inc (CEI) loaded out 9 truckloads, approximately 198 tons of non-hazardous urban fill from waste characterization grid WC-11(8-10') for off-site disposal to Waste Management Fairless. All transport trucks were cleaned and inspected before leaving the site to ensure no fill material was tracked off-site. CEI excavated and stockpiled material from waste characterization grids WC-10(0-3') and WC-11(8-10') for future soil disposal to Clean Earth ESMI and Waste Management Fairless, respectively. CEI operated the vapor management system (VMS) while work was being conducted inside the TFS. Dust control measures (wetting, tarping, limiting vehicle speeds, etc.) were conducted as needed.

The SOE elements for Phase 1 of the excavation work inside the TFS was completed and equipment was demobilized. CEI began dewatering and pumping test from dewatering wells DW5, DW6 and DW7. The pump from DW6 was turned off based on limited recovery in that well. All recovered water was collected and sent to the water treatment system (WTS) for processing and discharge to the New York City combined sewer system. Since the last report, approximately 27,690 gallons of treated water were discharged. CEI completed the backfill on test pits along Nevins Street and Keller completed SOE installation and testing of tiebacks. SOE installation equipment was demobilized from the site.

#### Air Monitoring:

- No community air monitoring program (CAMP) exceedances were observed during the day.
- GZA GeoEnvironmental. Inc. will provide a summary report for CAMP activities.

#### Erosion and Sediment Control

- Erosion and sediment controls were inspected to ensure that silt fence and filter sock were undamaged and operational.

#### Sampling Conducted:

- None.

<b>PROJECT:</b>	Former Fulton MGP – Parcels III and IV (Site No.: 224051)
<b>ADDRESS:</b>	545 Sackett St., Brooklyn, NY
<b>PREPARED BY:</b>	Roux Environmental Engineering and Geology, D.P.C.
<b>DATE:</b>	February 27, 2023
<b>WEATHER:</b>	Temp: 35-42°F, Cloudy, RH: 55% Pressure: 30.01" Hg Wind: N @ 4 mph
<b>TIME:</b>	07:00 – 15:30

**Other Items of Note:**

- None.

**Imported Material**

Name - Location	Source	During This Reporting Period		Total	
		Loads	Tons	Loads	Tons
Vulcan ASTM #3 (1 ½" Stone)	Vulcan Hamburg Quarry			5	127.83
Vulcan General Fill	Vulcan Wantage Quarry			71	1,800.42

**Exported Material**

Material	Facility	During This Reporting Period		Total	
		Loads	Tons	Loads	Tons
Concrete for Recycling	Bayshore			20	421.87
Concrete for Landfill	WM Fairless			37	~872.59
TCE Impacted Haz Hot Spot	CWM Emelle			7	161.72
Cd Impacted Haz Material from WC-5	CWM Emelle			3	49.45
Cd Impacted Haz Material from WC-5	Clean Earth NJ			16	397.75
Non-Haz Contaminated Urban Fill	WM Fairless	9	~198	88	~1,936
MGP soil with TCE>25 ppm	Clean Earth ESMI			57	~1,284

**Truck Log**

Number	Excavation Grid	Disposal Facility	Disposal Profile	Manifest Number	Trucking Company	Truck License Plate
1	WC-11 (8-10)	WM Fairless	Non-haz urban fill	12228231	V&E	AY259E
2	WC-11 (8-10)	WM Fairless	Non-haz urban fill	12228232	V&E	AW641V
3	WC-11 (8-10)	WM Fairless	Non-haz urban fill	12228233	V&E	AW358B
4	WC-11 (8-10)	WM Fairless	Non-haz urban fill	12228234	V&E	AX709B
5	WC-11 (8-10)	WM Fairless	Non-haz urban fill	12228235	V&E	AX774E
6	WC-11 (8-10)	WM Fairless	Non-haz urban fill	12228236	V&E	AY259E
7	WC-11 (8-10)	WM Fairless	Non-haz urban fill	12228237	V&E	AW641V
8	WC-11 (8-10)	WM Fairless	Non-haz urban fill	12228238	V&E	AX774E
9	WC-11 (8-10)	WM Fairless	Non-haz urban fill	12228239	V&E	AX709B

**Dewatering**

Time	Totalizer Volume (gallons)*
7:11 AM	450,905
11:37 AM	460,545
15:20 PM	478,595
Water treated and discharged since last report: 27,690 gallons	

**Anticipated Upcoming Work Activities**

Soil excavation and export to Clean Earth ESMI and Waste Management Fairless facilities. Continue operation of pumping test abd dewatering system.

<b>PROJECT:</b>	Former Fulton MGP – Parcels III and IV (Site No.: 224051)
<b>ADDRESS:</b>	545 Sackett St., Brooklyn, NY
<b>PREPARED BY:</b>	Roux Environmental Engineering and Geology, D.P.C.
<b>DATE:</b>	February 27, 2023
<b>WEATHER:</b>	Temp: 35-42°F, Cloudy, RH: 55% Pressure: 30.01" Hg Wind: N @ 4 mph
<b>TIME:</b>	07:00 – 15:30

### Site Layout

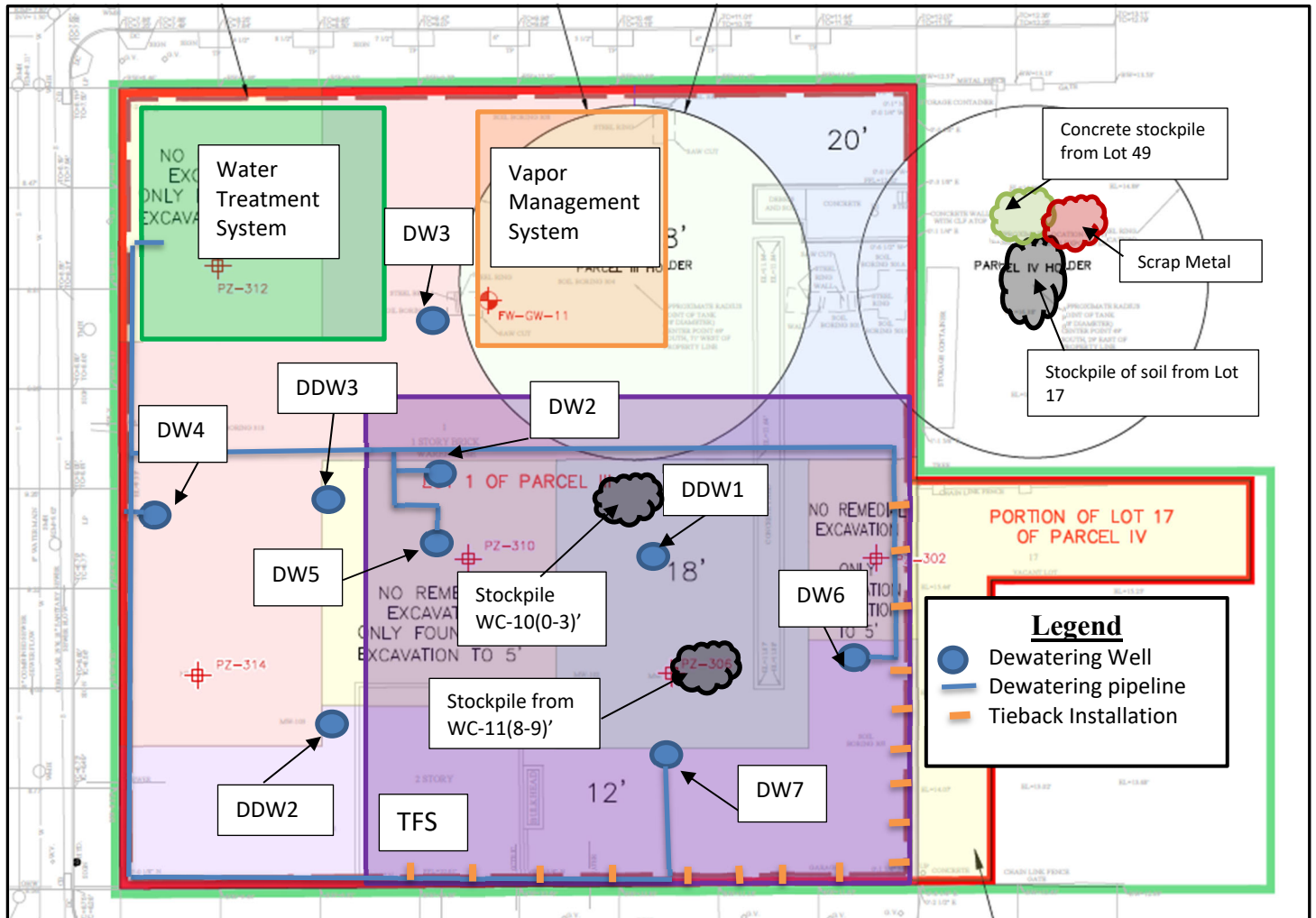

<b>PROJECT:</b>	Former Fulton MGP – Parcels III and IV (Site No.: 224051)
<b>ADDRESS:</b>	545 Sackett St., Brooklyn, NY
<b>PREPARED BY:</b>	Roux Environmental Engineering and Geology, D.P.C.
<b>DATE:</b>	February 27, 2023
<b>WEATHER:</b>	Temp: 35-42°F, Cloudy, RH: 55% Pressure: 30.01" Hg Wind: N @ 4 mph
<b>TIME:</b>	07:00 – 15:30

### Excavation Diagram

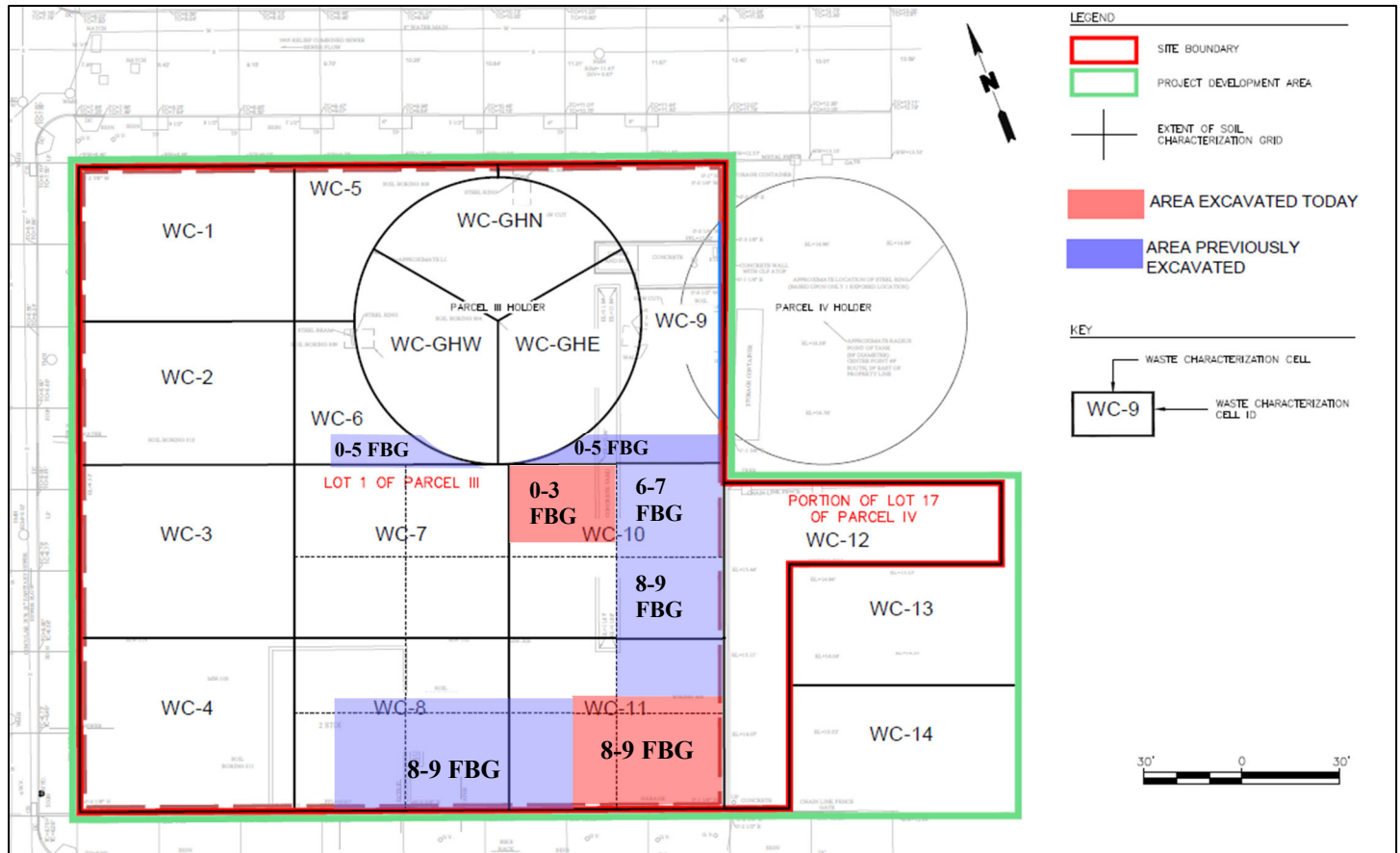

<b>PROJECT:</b>	Former Fulton MGP – Parcels III and IV (Site No.: 224051)
<b>ADDRESS:</b>	545 Sackett St., Brooklyn, NY
<b>PREPARED BY:</b>	Roux Environmental Engineering and Geology, D.P.C.
<b>DATE:</b>	February 27, 2023
<b>WEATHER:</b>	Temp: 35-42°F, Cloudy, RH: 55% Pressure: 30.01" Hg Wind: N @ 4 mph
<b>TIME:</b>	07:00 – 15:30

### Photographs of Onsite Work



#### **Photo 1:**

CEI loading soil into trucks for soil disposal to Waste Management Fairless.



#### **Photo 2:**

CEI excavating and stockpiling soil from waste characterization grid WC-10(0-3)' for soil disposal to Clean Earth ESMI facility.