



DAILY STATUS REPORT

PROJECT:	Former Fulton MGP – Parcels III and IV (Site No.: 224051)
ADDRESS:	545 Sackett St., Brooklyn, NY
PREPARED BY:	Roux Environmental Engineering and Geology, D.P.C.
DATE:	March 2, 2023
WEATHER:	Temp: 40-56°F, Mostly Cloudy, RH: 95% Pressure: 29.68" Hg Wind: W @ 4 mph
TIME:	07:00 – 15:30

Project Team

General Contractor and Subcontractors:

- Mega Contracting Group, LLC
- Creamer Environmental, Inc. (CEI)

Engineers/Consultants

- Roux Environmental Engineering and Geology, D.P.C.
- GZA GeoEnvironmental, Inc.

Remedial Action Work Summary

Work Activities Performed Onsite:

- Loaded out soil from waste characterization Grids WC-10 (0-8') and WC-8 (0-8') for disposal at Clean Earth ESMI;
- Excavated and stockpiled soil from waste characterization grid WC-8 (0-8') for future soil disposal to Clean Earth ESMI;
- Continued dewatering and pumping test from dewatering well DDW1.

Contractor Work Performed Onsite:

Creamer Environmental, Inc (CEI) loaded out thirteen (13) trucks of manufactured gas plant impacted soil with trichloroethylene >25 ppm from waste characterization grids WC-8(0-8') and WC-10 (0-8'). Approximately 286 tons were sent to Clean Earth ESMI for disposal. All transport trucks were cleaned and inspected before leaving the site to ensure no material was tracked off-site. CEI excavated and stockpiled waste characterization grid WC-8(0-8') for future soil disposal to Clean Earth ESMI and completed loading of scrap metal into a roll off container for future disposal.

Two blowers associated with the Vapor Management System (VMS) presented electrical issues during the morning hours. Additional ventilation (fans) was used during the soil disturbance activities until issues were resolved midday. Dust control measures (wetting, tarping, limiting vehicle speeds, etc.) were conducted as needed.

CEI continued dewatering and pumping test from deep dewatering well DDW1 and installed a sump in the southeast corner of grid WC-11 to assist with water removal. All recovered water was collected and sent to the water treatment system (WTS) for processing and discharge to the New York City combined sewer system. Since the last report, approximately 224,546 gallons of treated water was discharged.

Air Monitoring:

- No community air monitoring program (CAMP) exceedances were observed during the day.
- GZA GeoEnvironmental, Inc. will provide a summary report for CAMP activities.

Erosion and Sediment Control

- Erosion and sediment controls were inspected to ensure that silt fence and filter sock were undamaged and operational.
- Sediment was removed from the filter bags located in the catch basins on the corner of Nevins and Degraw streets.

Sampling Conducted:

- None.

Other Items of Note:

- None.

**DAILY STATUS REPORT**

PROJECT:	Former Fulton MGP – Parcels III and IV (Site No.: 224051)
ADDRESS:	545 Sackett St., Brooklyn, NY
PREPARED BY:	Roux Environmental Engineering and Geology, D.P.C.
DATE:	March 2, 2023
WEATHER:	Temp: 40-56°F, Mostly Cloudy, RH: 95% Pressure: 29.68" Hg Wind: W @ 4 mph
TIME:	07:00 – 15:30

Imported Material

Name - Location	Source	During This Reporting Period		Total	
		Loads	Tons	Loads	Tons
Vulcan ASTM #3 (1 ½" Stone)	Vulcan Hamburg Quarry			5	127.83
Vulcan General Fill	Vulcan Wantage Quarry			71	1,800.42

Exported Material

Material	Facility	During This Reporting Period		Total	
		Loads	Tons	Loads	Tons
Concrete for Recycling	Bayshore			20	421.87
Concrete for Landfill	WM Fairless			37	~872.59
TCE Impacted Haz Hot Spot	CWM Emelle			7	161.72
Cd Impacted Haz Material from WC-5	CWM Emelle			3	49.45
Cd Impacted Haz Material from WC-5	Clean Earth NJ			16	397.75
Non-Haz Contaminated Urban Fill	WM Fairless			93	~1,958
MGP soil with TCE>25 ppm	Clean Earth ESMI	13	~286	89	~1,988

Truck Log

Number	Excavation Grid	Disposal Facility	Disposal Profile	Manifest Number	Trucking Company	Truck License Plate
1	WC-10(0-5)'	ESMI-TCE >25	MGP soil with TCE>25 ppm	BUG000078	Frick Farm	15741PF
2	WC-10(0-5)'	ESMI-TCE >25	MGP soil with TCE>25 ppm	BUG000079	Frick Farm	17738PF
3	WC-10(0-5)'	ESMI-TCE >25	MGP soil with TCE>25 ppm	BUG000080	V&E	AY774E
4	WC-10(0-5)'	ESMI-TCE >25	MGP soil with TCE>25 ppm	BUG000081	V&E	AW259D
5	WC-8(0-8)'	ESMI-TCE >25	MGP soil with TCE>25 ppm	BUG000082	V&E	AY260E
6	WC-8(0-8)'	ESMI-TCE >25	MGP soil with TCE>25 ppm	BUG000083	KHF	60182PC
7	WC-10(5-8)'	ESMI-TCE >25	MGP soil with TCE>25 ppm	BUG000084	Cedar Hill	16010BR
8	WC-10(0-5)'	ESMI-TCE >25	MGP soil with TCE>25 ppm	BUG000085	V&E	AW358B
9	WC-10(0-5)'	ESMI-TCE >25	MGP soil with TCE>25 ppm	BUG000086	V&E	AX709B
10	WC-10(0-5)'	ESMI-TCE >25	MGP soil with TCE>25 ppm	BUG000087	KHF	81119ML
11	WC-8(0-8)'	ESMI-TCE >25	MGP soil with TCE>25 ppm	BUG000088	KHF	33634NA
12	WC-8(0-8)'	ESMI-TCE >25	MGP soil with TCE>25 ppm	BUG000089	KHF	65035NB
13	WC-8(0-8)'	ESMI-TCE >25	MGP soil with TCE>25 ppm	BUG000090	V&E	AW641V

Dewatering

Time	Totalizer Volume (gallons)*
7:19 AM	779,149
11:58 PM	846,069
14:56 PM	884,217
Water treated and discharged since last report:	224,546 gallons

Anticipated Upcoming Work Activities

Soil excavation and export to Clean Earth ESMI and Waste Management Fairless facilities. Dewatering pumping test to continue.

PROJECT:	Former Fulton MGP – Parcels III and IV (Site No.: 224051)
ADDRESS:	545 Sackett St., Brooklyn, NY
PREPARED BY:	Roux Environmental Engineering and Geology, D.P.C.
DATE:	March 2, 2023
WEATHER:	Temp: 40-56°F, Mostly Cloudy, RH: 95% Pressure: 29.68" Hg Wind: W @ 4 mph
TIME:	07:00 – 15:30

Site Layout

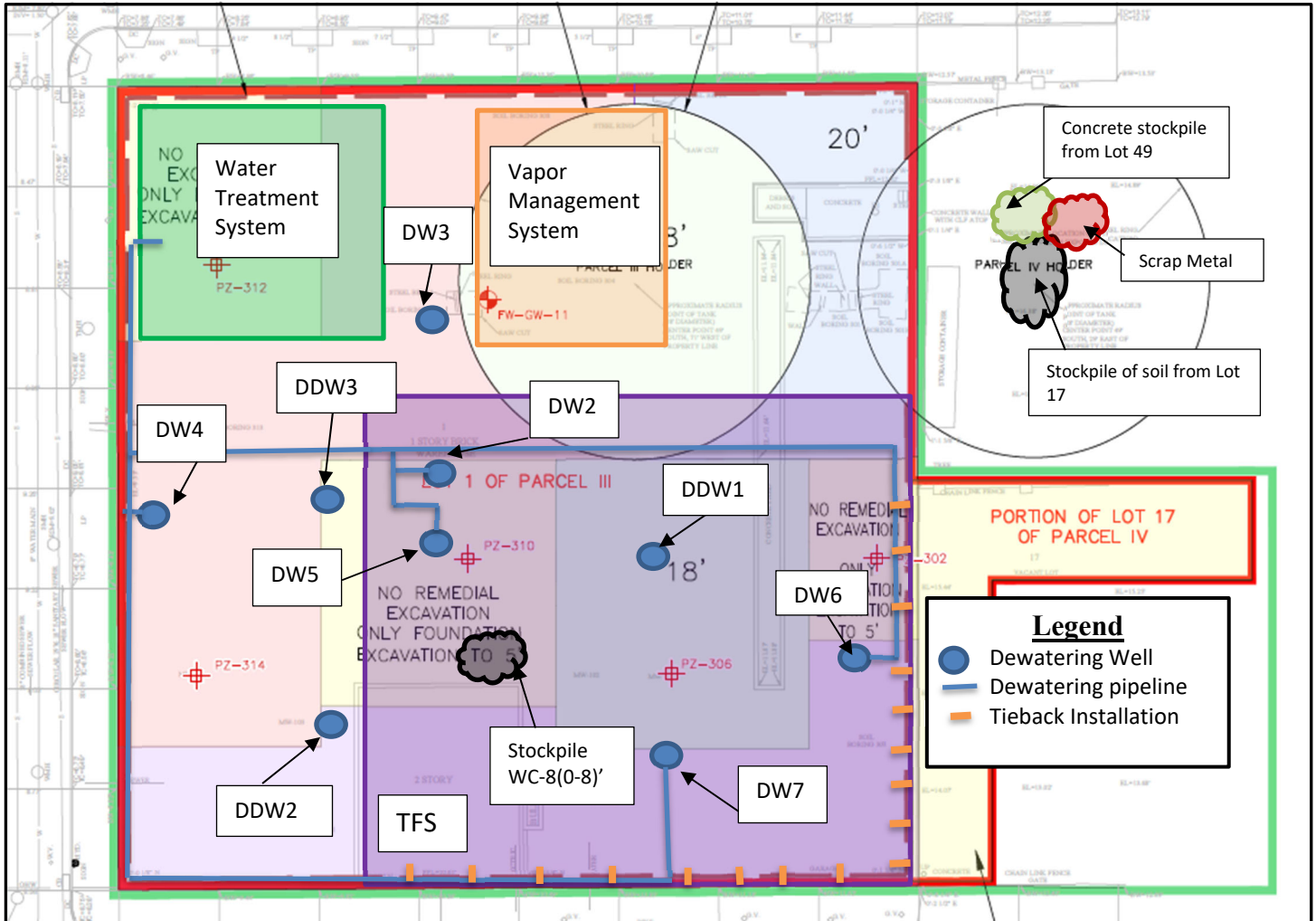

PROJECT:	Former Fulton MGP – Parcels III and IV (Site No.: 224051)
ADDRESS:	545 Sackett St., Brooklyn, NY
PREPARED BY:	Roux Environmental Engineering and Geology, D.P.C.
DATE:	March 2, 2023
WEATHER:	Temp: 40-56°F, Mostly Cloudy, RH: 95% Pressure: 29.68" Hg Wind: W @ 4 mph
TIME:	07:00 – 15:30

Excavation Diagram

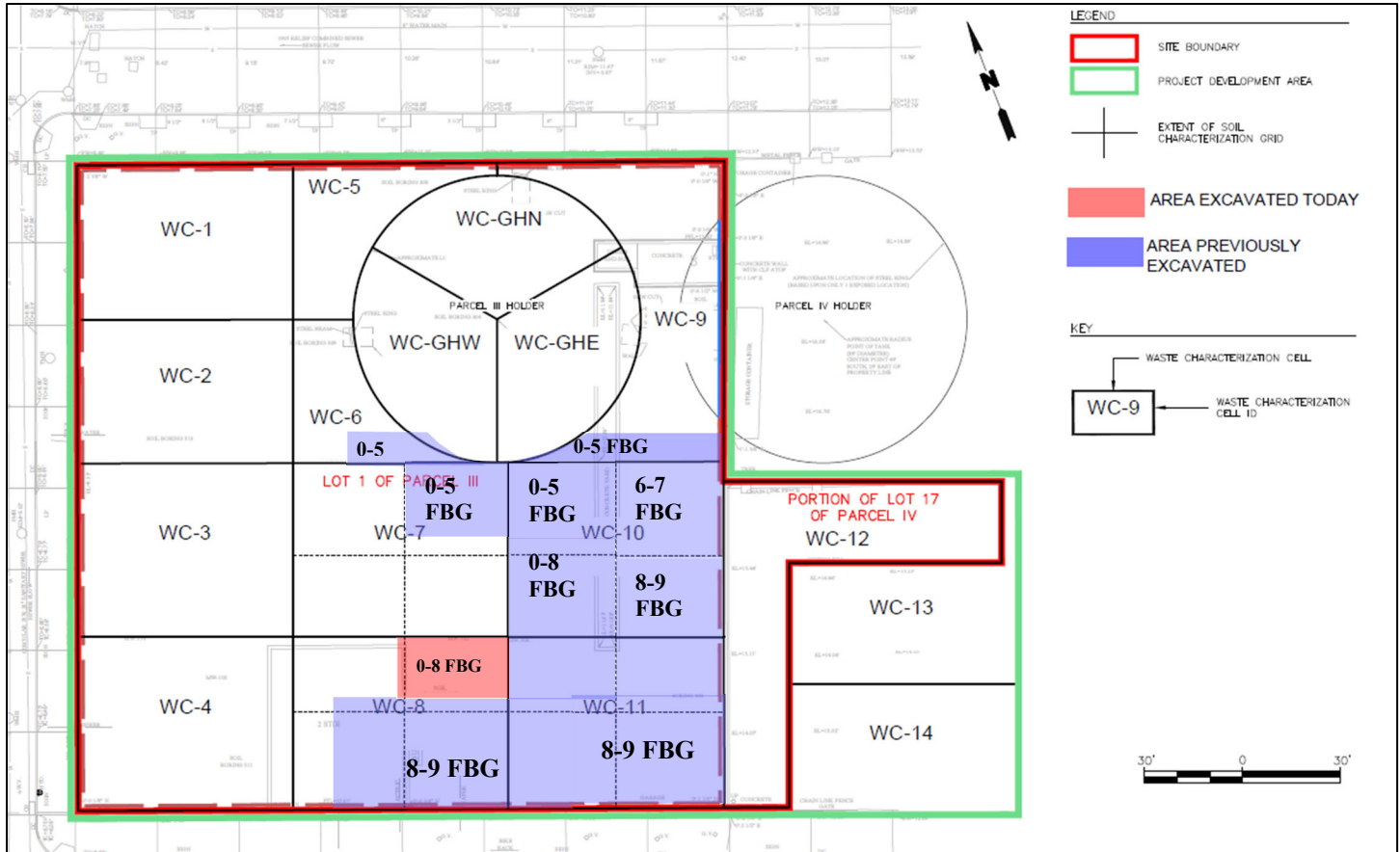

PROJECT:	Former Fulton MGP – Parcels III and IV (Site No.: 224051)
ADDRESS:	545 Sackett St., Brooklyn, NY
PREPARED BY:	Roux Environmental Engineering and Geology, D.P.C.
DATE:	March 2, 2023
WEATHER:	Temp: 40-56°F, Mostly Cloudy, RH: 95% Pressure: 29.68" Hg Wind: W @ 4 mph
TIME:	07:00 – 15:30

Photographs of Onsite Work



Photo 1:

CEI loading out soil for disposal to Clean Earth ESMI.



Photo 2:

Removing sediment from the filter bags located in the catch basins on the corner of Nevins and Degraw streets.