

PROJECT:	Former Fulton MGP – Parcels III and IV (Site No.: 224051)
ADDRESS:	545 Sackett St., Brooklyn, NY
PREPARED BY:	Roux Environmental Engineering and Geology, D.P.C.
DATE:	May 2nd, 2023
WEATHER:	Temp: 50 – 56°F Overcast, RH: 48% Pressure: 29.40" Hg Wind: W @ 14 mph
TIME:	07:00 – 15:30

Project Team

General Contractor and Subcontractors:

- Mega Contracting Group, LLC (Mega)
- Creamer Environmental, Inc. (CEI)
- New York State Department of Environmental Conservation (NYSDEC)

Engineers and Consultants:

- Roux Environmental Engineering and Geology, D.P.C. (Roux)
- GZA GeoEnvironmental Inc. (GZA)
- Mueser Rutledge Consulting Engineers, PLLC (MRCE)
- WSP USA (WSP)

Remedial Action Work Summary

Work Activities Performed Onsite:

- Site preparation for upcoming activities.
- SOE sheet pile installation between Gas Holder 3 and Gas Holder 4.
- Import of general fill from Vulcan Wantage Quarry.
- Excavation and stockpiled of soil from waste characterization grid WC-11 (8-12)' for future soil disposal to Waste Management Fairless facility;

Contractor Work Performed Onsite:

Creamer Environmental, Inc (CEI) imported 177.67 tons of general fill from Vulcan Wantage Quarry. Import material was added to the stockpile in waste characterization WC- 12. All transport trucks were cleaned and inspected before leaving the site to ensure no material was tracked off-site.

CEI commenced SOE sheeting installation from structural detail 3 towards detail 9. Approximately 30 linear feet of SOE sheeting were installed between Gas Holder 3 and 4. CEI continued SOE site preparation, including grading the work area, crane mats placement and preparation of SOE sheet piles.

Site preparation on the neighboring property east of lot 49 continued. CEI soil graded the area and removed trees, shrubs, and any other surface obstruction for the H-piles installation, associated with the SOE design in lot 49.

CEI excavated and stockpiled soil from waste characterization grid WC-11(8-12)' for future soil disposal to Waste Management Fairless. Concrete obstructions were encountered at the bottom of the excavation in grid WC-11. CEI jack hammered concrete obstruction to facilitate the concrete removal on 05/03/2023.

CEI intermittently operated two previously installed sump pumps to remove surface water inside the tension fabric structure (TFS). All recovered water was collected and sent to the water treatment system (WTS) for future processing and discharge. Since the last report no treated water was discharged to the New York City combined sewer system.

CEI operated Vapor Management System (VMS) during all work activities inside the TFS, additionally, odor suppression foam was applied on stockpiles inside the TFS. CEI conducted dust control measures (wetting, tarping, limiting vehicle speeds, etc.) as needed.

Air Monitoring:

- No VOC or dust exceedances were observed from the community air monitoring program (CAMP).
- GZA will provide a summary report of CAMP activities.

PROJECT:	Former Fulton MGP – Parcels III and IV (Site No.: 224051)
ADDRESS:	545 Sackett St., Brooklyn, NY
PREPARED BY:	Roux Environmental Engineering and Geology, D.P.C.
DATE:	May 2nd, 2023
WEATHER:	Temp: 50 – 56°F Overcast, RH: 48% Pressure: 29.40" Hg Wind: W @ 14 mph
TIME:	07:00 – 15:30

Erosion and Sediment Control

- Erosion and sediments controls were inspected to confirm all elements are operational and functional.

Sampling Conducted:

- None.

Other Items of Note:

- Construction and drilling activities were observed as part of the ongoing CSO project west of Nevins Street.

Imported Material

Name - Location	Source	During This Reporting Period		Total	
		Loads	Tons	Loads	Tons
Vulcan ASTM #3 (1 ½" Stone)	Vulcan Hamburg Quarry			7	179.3
Vulcan General Fill	Vulcan Wantage Quarry	7	177.67	107	2723.76

Exported Material

Material	Facility	During This Reporting Period		Total	
		Loads	Tons	Loads	Tons
Concrete for Recycling	Bayshore			20	421.87
Concrete for Landfill	WM Fairless			57	~1,312.59
TCE Impacted Haz Hot Spots	CWM Emelle			7	161.72
Cd Impacted Haz Material from WC-5	CWM Emelle			3	49.45
Pb impacted Haz from Parcel IV Hot Spot	CMW Emelle			25	~550
Cd Impacted Haz Material from WC-5	Clean Earth NJ			16	397.75
Non-Haz Contaminated Urban Fill	WM Fairless			99	~2,090
MGP soil with TCE>25 ppm	Clean Earth ESMI			113	~2,494
Non-Haz MGP Impacted	Clean Earth New Castle			34	~748
Non-Haz MGP Impacted	CESP			7	~154

Exported Material Truck Log

Number	Excavation Grid	Disposal Facility	Disposal Profile	Manifest Number	Trucking Company	Truck License Plate
--------	-----------------	-------------------	------------------	-----------------	------------------	---------------------

Dewatering

Time	Totalizer Volume (gallons)*
7:00	2,400,011
15:30	2,400,011
Water treated and discharged since last report:	0 gallons

Anticipated Upcoming Work Activities

Continued SOE sheet piles installation along between Gas Holder III and IV. Documentation sample collection at the bottom of excavation in waste characterization grid WC-11.

PROJECT:	Former Fulton MGP – Parcels III and IV (Site No.: 224051)
ADDRESS:	545 Sackett St., Brooklyn, NY
PREPARED BY:	Roux Environmental Engineering and Geology, D.P.C.
DATE:	May 2nd, 2023
WEATHER:	Temp: 50 – 56°F Overcast, RH: 48% Pressure: 29.40" Hg Wind: W @ 14 mph
TIME:	07:00 – 15:30

Site Layout

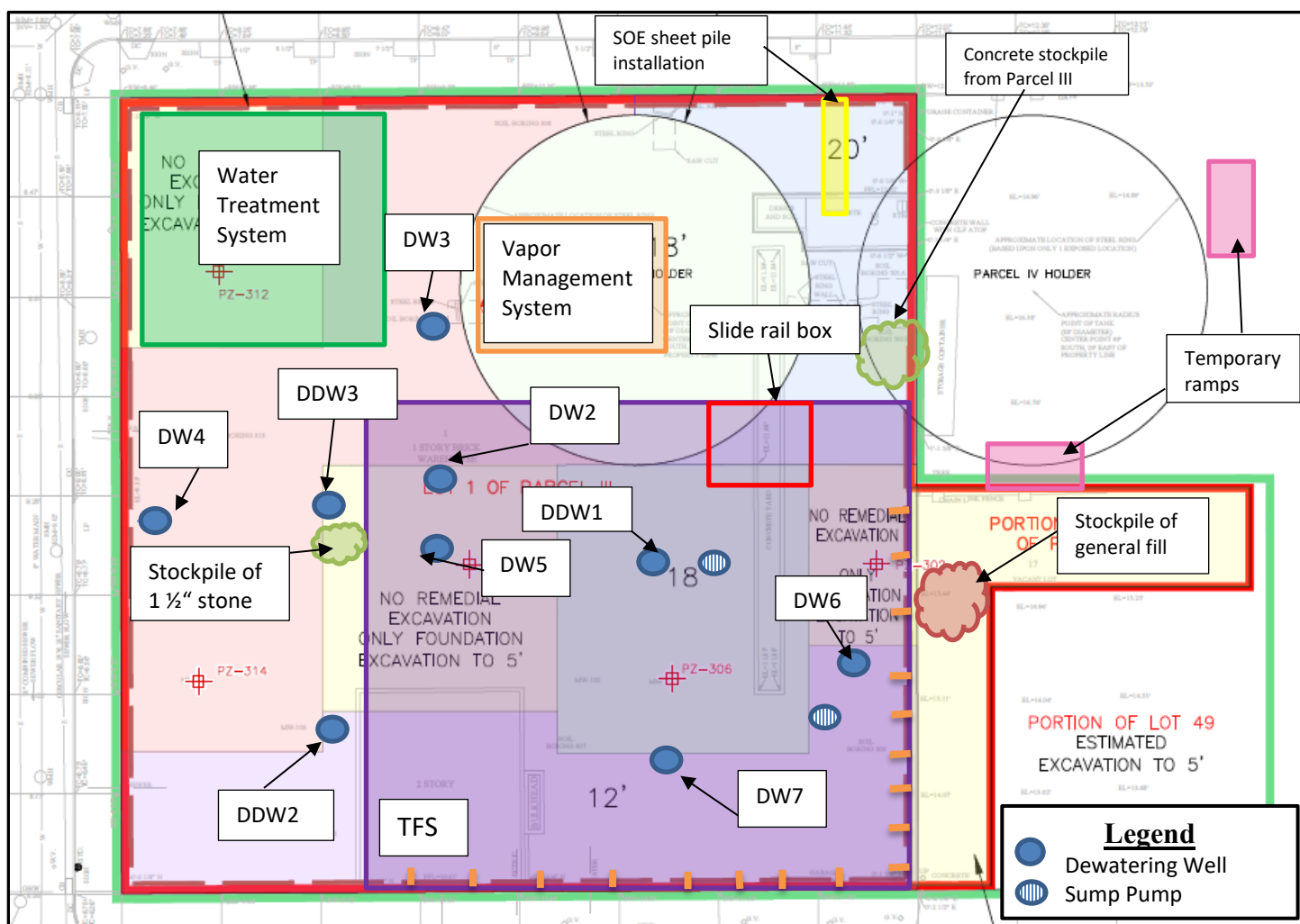

PROJECT:	Former Fulton MGP – Parcels III and IV (Site No.: 224051)
ADDRESS:	545 Sackett St., Brooklyn, NY
PREPARED BY:	Roux Environmental Engineering and Geology, D.P.C.
DATE:	May 2nd, 2023
WEATHER:	Temp: 50 – 56°F Overcast, RH: 48% Pressure: 29.40" Hg Wind: W @ 14 mph
TIME:	07:00 – 15:30

Excavation Diagram

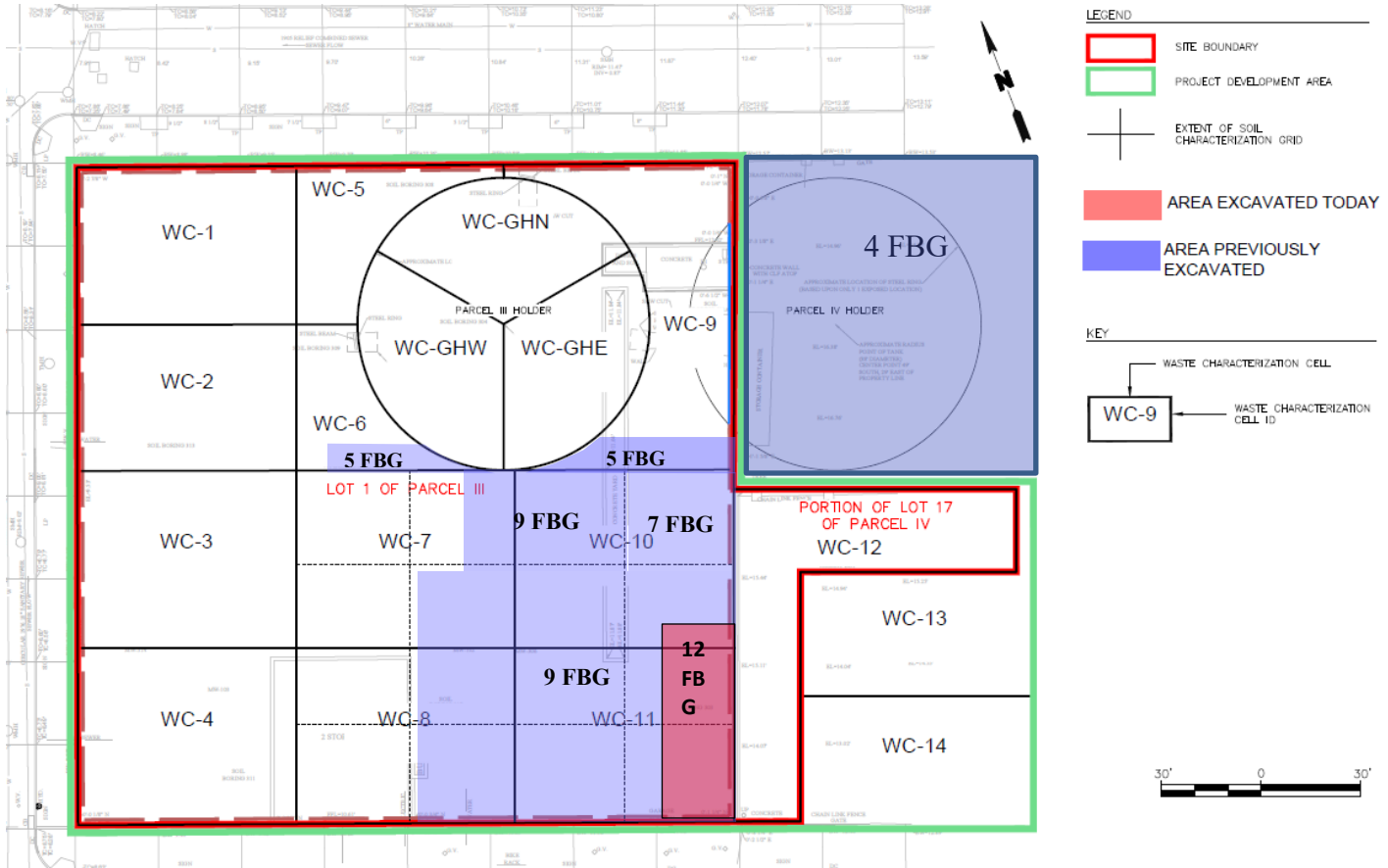

PROJECT:	Former Fulton MGP – Parcels III and IV (Site No.: 224051)
ADDRESS:	545 Sackett St., Brooklyn, NY
PREPARED BY:	Roux Environmental Engineering and Geology, D.P.C.
DATE:	May 2nd, 2023
WEATHER:	Temp: 50 – 56°F Overcast, RH: 48% Pressure: 29.40" Hg Wind: W @ 14 mph
TIME:	07:00 – 15:30

Photographs of Onsite Work



Photo 1:

Excavation, stockpiled of soil material from waste characterization grids WC-11. CEI applying odor suppression foam inside the TFS.



Photo 2:

CEI soil grading in the neighboring property east of lot 49.