

<b>PROJECT:</b>	Former Fulton MGP – Parcels III and IV (Site No.: 224051)
<b>ADDRESS:</b>	545 Sackett St., Brooklyn, NY
<b>PREPARED BY:</b>	Roux Environmental Engineering and Geology, D.P.C.
<b>DATE:</b>	May 3rd, 2023
<b>WEATHER:</b>	Temp: 48 – 59°F Cloudy, RH: 49% Pressure: 29.50" Hg Wind: W @ 6 mph
<b>TIME:</b>	07:00 – 15:30

**Project Team***General Contractor and Subcontractors:*

- Mega Contracting Group, LLC (Mega)
- Creamer Environmental, Inc. (CEI)
- New York State Department of Environmental Conservation (NYSDEC)

*Engineers and Consultants:*

- Roux Environmental Engineering and Geology, D.P.C. (Roux)
- GZA GeoEnvironmental Inc. (GZA)
- Mueser Rutledge Consulting Engineers, PLLC (MRCE)
- WSP USA (WSP)

**Remedial Action Work Summary**Work Activities Performed Onsite:

- Site preparation for upcoming activities.
- SOE sheet pile installation between Gas Holder 3 and Gas Holder 4.
- Import of general fill from Vulcan Wantage Quarry.
- Excavation and stockpiled inside the tension fabric structure (TFS) for future disposal to Waste Management Fairless facility.
- Loaded out soil for disposal to Waste Management Fairless
- Collection of documentation sample in waste characterization grid WC-11.

Contractor Work Performed Onsite:

Creamer Environmental, Inc (CEI) loaded out nine (9) trucks, approximately 198 tons of non-hazardous urban fill from waste characterization grids WC-10 (8-10)' and WC-11 (8-12') for off-site disposal to the Waste Management Fairless facility.

CEI imported eight (8) trucks, approximately 199.30 tons of general fill from Vulcan Wantage Quarry. Import material was added to the stockpile in waste characterization WC- 12. All transport trucks were cleaned and inspected before leaving the site to ensure no material was tracked off-site.

CEI continued SOE sheeting installation from structural detail 3 towards detail 9. Approximately 15 linear feet of SOE sheeting were installed between Gas Holder 3 and 4. CEI continued SOE site preparation, including grading the work area, crane mats placement and preparation of SOE sheet piles.

CEI intermittently operated sump pumps to remove surface water inside the tension fabric structure (TFS). All recovered water was collected and sent to the water treatment system (WTS) for future processing and discharge. Since the last report no treated water was discharged to the New York City combined sewer system.

Based on field observations, NYSDEC, GZA, WSP and Roux confirmed the absence of DNAPL at the bottom of the excavation. Thus, reaching the bottom of the remediation excavation at approximately 15 feet below grade in an area of approximately 25'x30' in the southeast corner of waste characterization grid WC-11. After collection of documentation sample, CEI backfilled with imported general fill. Plastic liner was installed at the north and west boundary of the remediated area to avoid any soil mixing.

CEI operated Vapor Management System (VMS) during all work activities inside the TFS, additionally, odor suppression foam was applied on stockpiles inside the TFS. CEI conducted dust control measures (wetting, tarping, limiting vehicle speeds, etc.) as needed.

Air Monitoring:

<b>PROJECT:</b>	Former Fulton MGP – Parcels III and IV (Site No.: 224051)
<b>ADDRESS:</b>	545 Sackett St., Brooklyn, NY
<b>PREPARED BY:</b>	Roux Environmental Engineering and Geology, D.P.C.
<b>DATE:</b>	May 3rd, 2023
<b>WEATHER:</b>	Temp: 48 – 59°F Cloudy, RH: 49% Pressure: 29.50" Hg Wind: W @ 6 mph
<b>TIME:</b>	07:00 – 15:30

- No VOC or dust exceedances were observed from the community air monitoring program (CAMP).
- GZA will provide a summary report of CAMP activities.

Erosion and Sediment Control

- Erosion and sediments controls were inspected to confirm all elements are operational and functional.

Sampling Conducted:

- Documentation sample, DOC-28\_20230503 collected for TCL/TAL plus cyanide analysis.

Other Items of Note:

- Construction and drilling activities were observed as part of the ongoing CSO project west of Nevins Street.

**Imported Material**

Name - Location	Source	During This Reporting Period		Total	
		Loads	Tons	Loads	Tons
Vulcan ASTM #3 (1 ½" Stone)	Vulcan Hamburg Quarry			7	179.3
Vulcan General Fill	Vulcan Wantage Quarry	8	199.30	115	2923.06

**Exported Material**

Material	Facility	During This Reporting Period		Total	
		Loads	Tons	Loads	Tons
Concrete for Recycling	Bayshore			20	421.87
Concrete for Landfill	WM Fairless			57	~1,312.59
TCE Impacted Haz Hot Spots	CWM Emelle			7	161.72
Cd Impacted Haz Material from WC-5	CWM Emelle			3	49.45
Pb impacted Haz from Parcel IV Hot Spot	CMW Emelle			25	~550
Cd Impacted Haz Material from WC-5	Clean Earth NJ			16	397.75
Non-Haz Contaminated Urban Fill	WM Fairless	9	198	107	~2,288
MGP soil with TCE>25 ppm	Clean Earth ESMI			113	~2,494
Non-Haz MGP Impacted	Clean Earth New Castle			34	~748
Non-Haz MGP Impacted	CESP			7	~154

**Exported Material Truck Log**

Number	Excavation Grid	Disposal Facility	Disposal Profile	Manifest Number	Trucking Company	Truck License Plate
1	WC-10(8-10)', WC-11(8-12)'	WM Fairless	Non-haz urban fill	1222851	V&E	AX709B
2	WC-10(8-10)', WC-11(8-12)'	WM Fairless	Non-haz urban fill	1222852	V&E	AY260E
3	WC-10(8-10)', WC-11(8-12)'	WM Fairless	Non-haz urban fill	1222853	V&E	AW259D
4	WC-10(8-10)', WC-11(8-12)'	WM Fairless	Non-haz urban fill	1222854	V&E	AY259E
5	WC-10(8-10)', WC-11(8-12)'	WM Fairless	Non-haz urban fill	1222855	V&E	AW690L

**DAILY STATUS REPORT**

<b>PROJECT:</b>	Former Fulton MGP – Parcels III and IV (Site No.: 224051)
<b>ADDRESS:</b>	545 Sackett St., Brooklyn, NY
<b>PREPARED BY:</b>	Roux Environmental Engineering and Geology, D.P.C.
<b>DATE:</b>	May 3rd, 2023
<b>WEATHER:</b>	Temp: 48 – 59°F Cloudy, RH: 49% Pressure: 29.50" Hg Wind: W @ 6 mph
<b>TIME:</b>	07:00 – 15:30

6	WC-10(8-10)', WC-11(8-12)'	WM Fairless	Non-haz urban fill	1222856	V&E	AW358B
7	WC-10(8-10)', WC-11(8-12)'	WM Fairless	Non-haz urban fill	1222857	V&E	AW641V
8	WC-10(8-10)', WC-11(8-12)'	WM Fairless	Non-haz urban fill	1222858	V&E	AY260E
9	WC-10(8-10)', WC-11(8-12)'	WM Fairless	Non-haz urban fill	1222859	V&E	AX709B

**Dewatering**

Time	Totalizer Volume (gallons)*
7:00	2,400,011
15:30	2,400,011
Water treated and discharged since last report:	0 gallons

**Anticipated Upcoming Work Activities**

Continued SOE sheet piles installation along between Gas Holder III and IV. Continued documentation sample collection at the bottom of excavation in waste characterization grid WC-11.

<b>PROJECT:</b>	Former Fulton MGP – Parcels III and IV (Site No.: 224051)
<b>ADDRESS:</b>	545 Sackett St., Brooklyn, NY
<b>PREPARED BY:</b>	Roux Environmental Engineering and Geology, D.P.C.
<b>DATE:</b>	May 3rd, 2023
<b>WEATHER:</b>	Temp: 48 – 59°F Cloudy, RH: 49% Pressure: 29.50" Hg Wind: W @ 6 mph
<b>TIME:</b>	07:00 – 15:30

### Site Layout

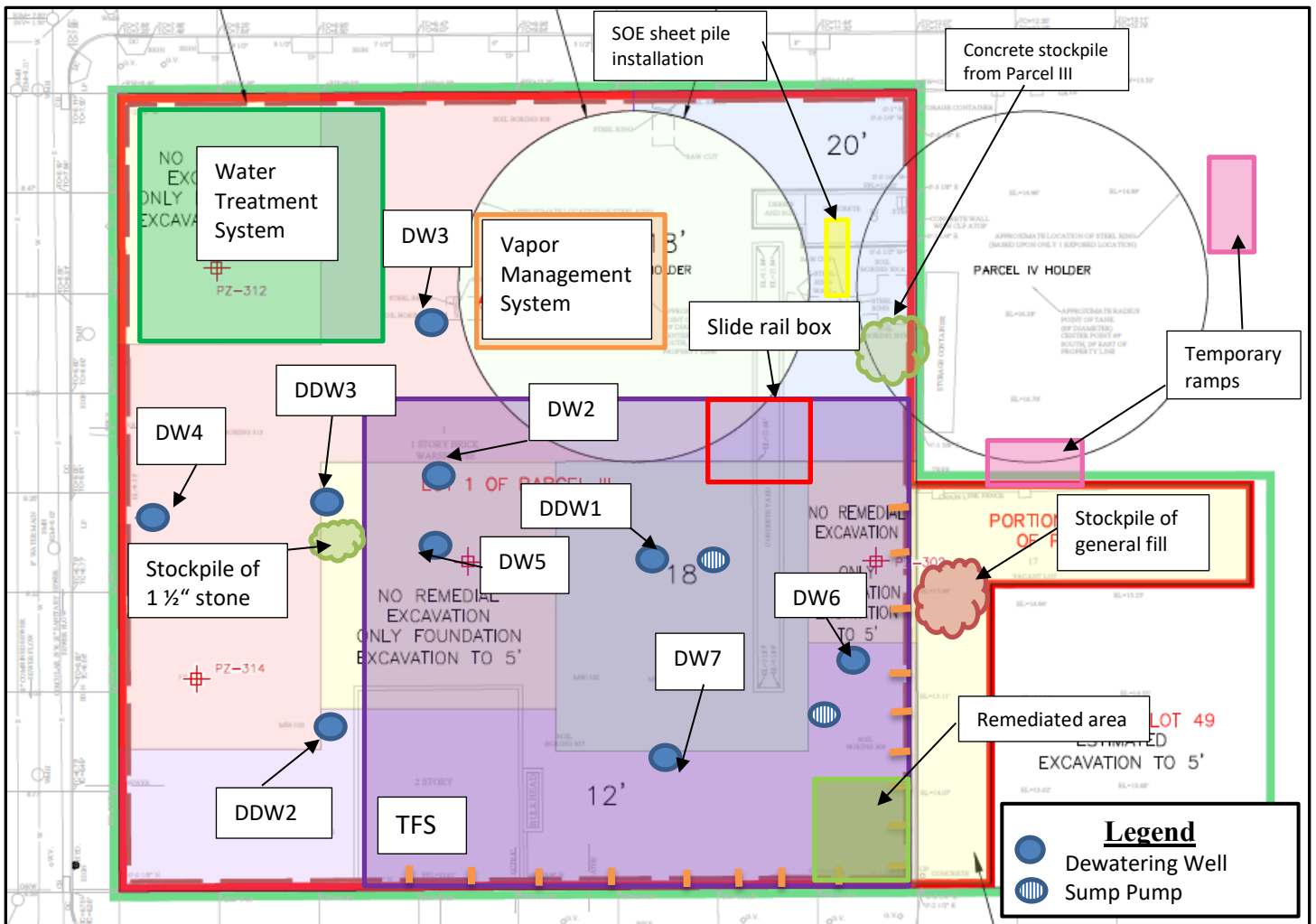

<b>PROJECT:</b>	Former Fulton MGP – Parcels III and IV (Site No.: 224051)
<b>ADDRESS:</b>	545 Sackett St., Brooklyn, NY
<b>PREPARED BY:</b>	Roux Environmental Engineering and Geology, D.P.C.
<b>DATE:</b>	May 3rd, 2023
<b>WEATHER:</b>	Temp: 48 – 59°F Cloudy, RH: 49% Pressure: 29.50" Hg Wind: W @ 6 mph
<b>TIME:</b>	07:00 – 15:30

### Excavation Diagram

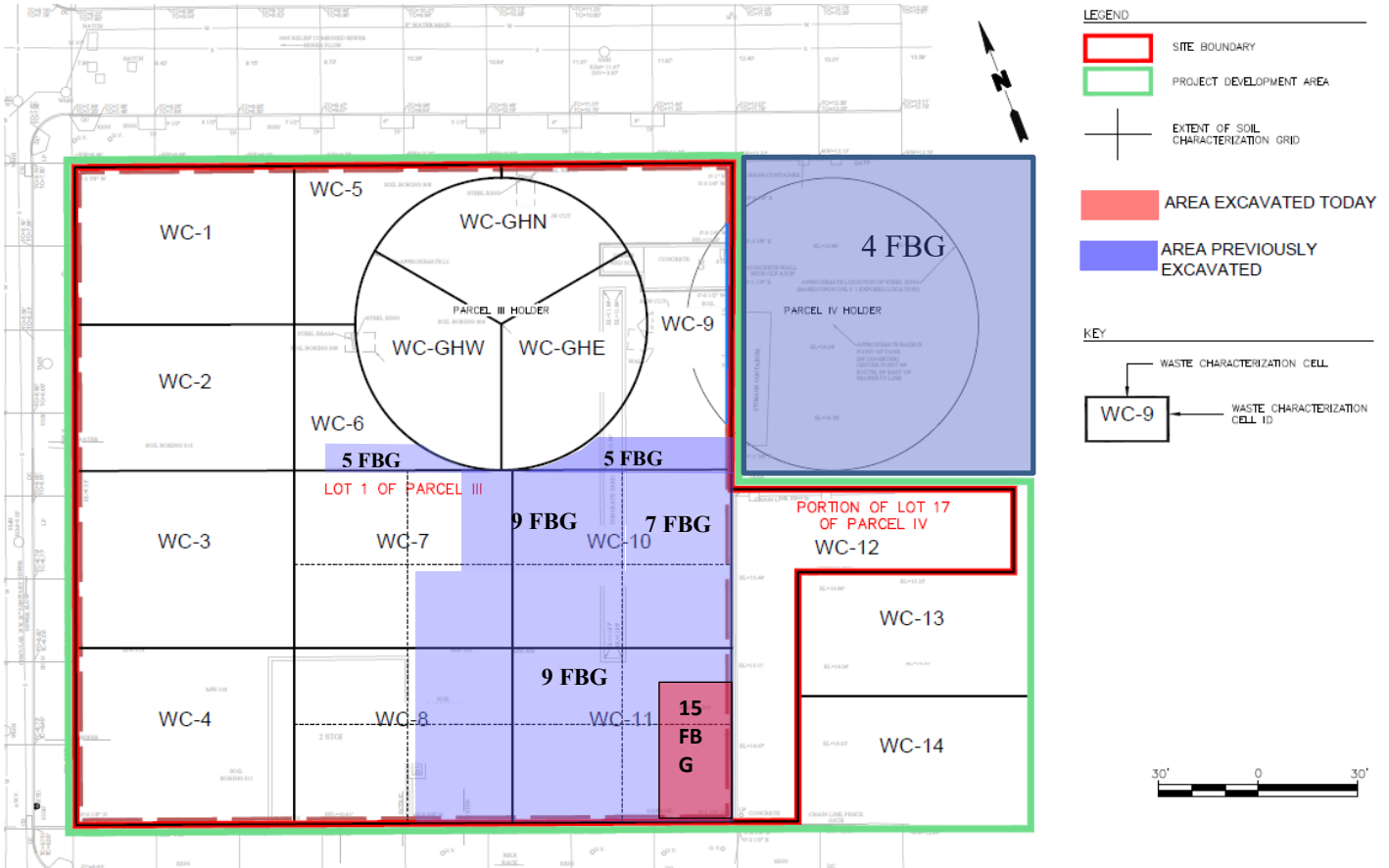

<b>PROJECT:</b>	Former Fulton MGP – Parcels III and IV (Site No.: 224051)
<b>ADDRESS:</b>	545 Sackett St., Brooklyn, NY
<b>PREPARED BY:</b>	Roux Environmental Engineering and Geology, D.P.C.
<b>DATE:</b>	May 3rd, 2023
<b>WEATHER:</b>	Temp: 48 – 59°F Cloudy, RH: 49% Pressure: 29.50" Hg Wind: W @ 6 mph
<b>TIME:</b>	07:00 – 15:30

**Photographs of Onsite Work**



**Photo 1:**

Excavation at the southeast corner of grid WC-11 to reach the bottom of the remediation excavation.



**Photo 2:**

CEI backfilling with imported general fill at the southeast corner of grid wc-11.