

<b>PROJECT:</b>	Former Fulton MGP – Parcels III and IV (Site No.: 224051)
<b>ADDRESS:</b>	545 Sackett St., Brooklyn, NY
<b>PREPARED BY:</b>	Roux Environmental Engineering and Geology, D.P.C.
<b>DATE:</b>	May 4th, 2023
<b>WEATHER:</b>	Temp: 48 – 54°F Mostly Cloudy, RH: 50% Pressure: 30.24" Hg Wind: N @ 6 mph
<b>TIME:</b>	07:00 – 15:30

### Project Team

#### *General Contractor and Subcontractors:*

- Mega Contracting Group, LLC (Mega)
- Creamer Environmental, Inc. (CEI)

#### *Engineers and Consultants:*

- Roux Environmental Engineering and Geology, D.P.C. (Roux)
- GZA GeoEnvironmental Inc. (GZA)
- Mueser Rutledge Consulting Engineers, PLLC (MRCE)
- WSP USA (WSP)
- Intertek MT Group (Intertek)

### Remedial Action Work Summary

#### Work Activities Performed Onsite:

- Site preparation for upcoming activities.
- SOE sheet pile installation between Gas Holder 3 and Gas Holder 4.
- Excavation and stockpiled inside the tension fabric structure (TFS) for future disposal to Waste Management Fairless facility.
- Loaded out soil for disposal to Waste Management Fairless
- Collection of documentation sample in waste characterization grids WC-11/WC-10.

#### Contractor Work Performed Onsite:

Creamer Environmental, Inc (CEI) loaded out ten (10) trucks, approximately 220 tons of non-hazardous urban fill from waste characterization grids WC-11 (8-15') for off-site disposal to the Waste Management Fairless facility. All transport trucks were cleaned and inspected before leaving the site to ensure no material was tracked off-site.

CEI completed SOE sheet pile installation from structural detail 3 towards detail 9. Approximately 17 linear feet of SOE sheeting were installed between Gas Holder 3 and 4. CEI continued SOE site preparation, including grading the work area, crane mats placement and preparation of SOE sheet piles.

CEI intermittently operated sump pumps to remove surface water inside the tension fabric structure (TFS). All recovered water was collected and sent to the water treatment system (WTS) for future processing and discharge. No treated water was discharged to the New York City combined sewer system.

Based on field observations, WSP and Roux confirmed the absence of DNAPL at the bottom of the excavation. Thus, reaching the bottom of the remediation excavation at approximately 15 feet below grade in area of approximately 25'x25' southeast of waste characterization grids WC-11/WC-10. After collection of documentation sample, CEI backfilled with imported general fill. Plastic liner was installed at the north and west sidewalls of the remediated area. Intertek performed compaction testing in the backfilled area to confirmed geotechnical requirements.

CEI applied odor suppression foam on stockpiles inside the TFS and operated Vapor Management System (VMS) during all work activities inside the TFS. CEI also conducted dust control measures (wetting, tarping, limiting vehicle speeds, etc.) as needed.

#### Air Monitoring:

- No VOC or dust exceedances were observed from the community air monitoring program (CAMP).
- GZA will provide a summary report of CAMP activities.

#### Erosion and Sediment Control

<b>PROJECT:</b>	Former Fulton MGP – Parcels III and IV (Site No.: 224051)
<b>ADDRESS:</b>	545 Sackett St., Brooklyn, NY
<b>PREPARED BY:</b>	Roux Environmental Engineering and Geology, D.P.C.
<b>DATE:</b>	May 4th, 2023
<b>WEATHER:</b>	Temp: 48 – 54°F Mostly Cloudy, RH: 50% Pressure: 30.24" Hg Wind: N @ 6 mph
<b>TIME:</b>	07:00 – 15:30

- Erosion and sediments controls were inspected to confirm all elements are operational and functional.

**Sampling Conducted:**

- Documentation sample, DOC-29\_20230504 collected for TCL/TAL plus cyanide analysis.

**Other Items of Note:**

- Construction and drilling activities were observed as part of the ongoing CSO project west of Nevins Street.

**Imported Material**

Name - Location	Source	During This Reporting Period		Total	
		Loads	Tons	Loads	Tons
Vulcan ASTM #3 (1 ½" Stone)	Vulcan Hamburg Quarry			7	179.3
Vulcan General Fill	Vulcan Wantage Quarry			115	2923.06

**Exported Material**

Material	Facility	During This Reporting Period		Total	
		Loads	Tons	Loads	Tons
Concrete for Recycling	Bayshore			20	421.87
Concrete for Landfill	WM Fairless			57	~1,312.59
TCE Impacted Haz Hot Spots	CWM Emelle			7	161.72
Cd Impacted Haz Material from WC-5	CWM Emelle			3	49.45
Pb impacted Haz from Parcel IV Hot Spot	CMW Emelle			25	~550
Cd Impacted Haz Material from WC-5	Clean Earth NJ			16	397.75
Non-Haz Contaminated Urban Fill	WM Fairless	10	220	117	~2,508
MGP soil with TCE>25 ppm	Clean Earth ESMI			113	~2,494
Non-Haz MGP Impacted	Clean Earth New Castle			34	~748
Non-Haz MGP Impacted	CESP			7	~154

**Exported Material Truck Log**

Number	Excavation Grid	Disposal Facility	Disposal Profile	Manifest Number	Trucking Company	Truck License Plate
1	WC-11(8-15)'	WM Fairless	Non-haz urban fill	1222860	V&E	AX709B
2	WC-11(8-15)'	WM Fairless	Non-haz urban fill	1222861	V&E	AW641V
3	WC-11(8-15)'	WM Fairless	Non-haz urban fill	1222862	V&E	AW259D
4	WC-11(8-15)'	WM Fairless	Non-haz urban fill	1222863	V&E	AY260E
5	WC-11(8-15)'	WM Fairless	Non-haz urban fill	1222864	V&E	AW690L
6	WC-11(8-15)'	WM Fairless	Non-haz urban fill	12455193	V&E	AW358B
7	WC-11(8-15)'	WM Fairless	Non-haz urban fill	12455194	V&E	AY259E
8	WC-11(8-15)'	WM Fairless	Non-haz urban fill	12455195	V&E	AW259D
9	WC-11(8-15)'	WM Fairless	Non-haz urban fill	12455196	V&E	AX709B
10	WC-11(8-15)'	WM Fairless	Non-haz urban fill	12455197	V&E	AW641V

**Dewatering**

Time	Totalizer Volume (gallons)*
------	-----------------------------

**DAILY STATUS REPORT**

<b>PROJECT:</b>	Former Fulton MGP – Parcels III and IV (Site No.: 224051)
<b>ADDRESS:</b>	545 Sackett St., Brooklyn, NY
<b>PREPARED BY:</b>	Roux Environmental Engineering and Geology, D.P.C.
<b>DATE:</b>	May 4th, 2023
<b>WEATHER:</b>	Temp: 48 – 54°F Mostly Cloudy, RH: 50% Pressure: 30.24" Hg Wind: N @ 6 mph
<b>TIME:</b>	07:00 – 15:30

7:00	2,400,011
15:30	2,400,011
Water treated and discharged since last report:	0 gallons

**Anticipated Upcoming Work Activities**

Continued SOE sheet piles installation along between Gas Holder 3 and 4. Continued backfilled at the bottom of excavation in waste characterization grid WC-11.

**Site Layout**

<b>PROJECT:</b>	Former Fulton MGP – Parcels III and IV (Site No.: 224051)
<b>ADDRESS:</b>	545 Sackett St., Brooklyn, NY
<b>PREPARED BY:</b>	Roux Environmental Engineering and Geology, D.P.C.
<b>DATE:</b>	May 4th, 2023
<b>WEATHER:</b>	Temp: 48 – 54°F Mostly Cloudy, RH: 50% Pressure: 30.24" Hg Wind: N @ 6 mph
<b>TIME:</b>	07:00 – 15:30

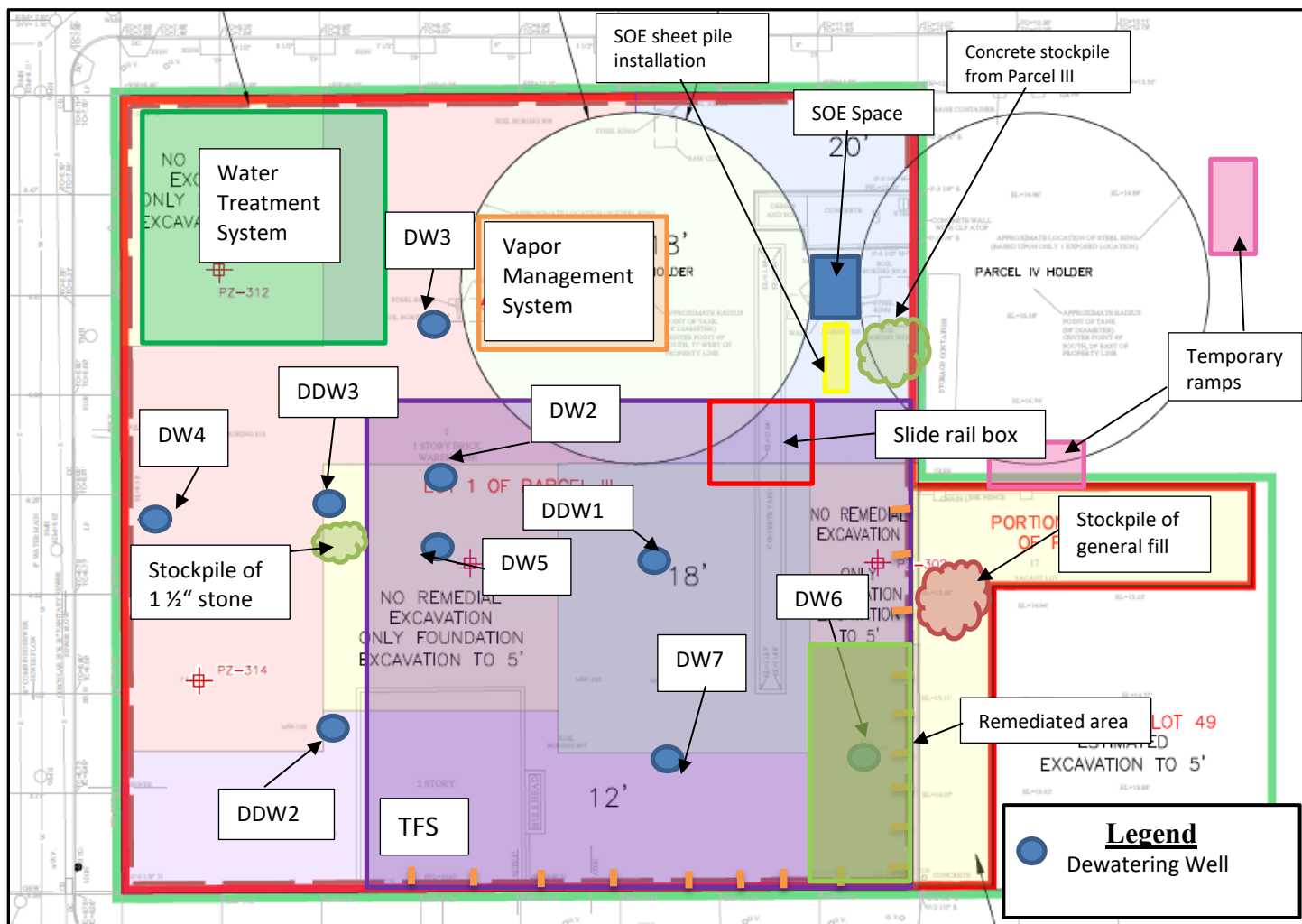

<b>PROJECT:</b>	Former Fulton MGP – Parcels III and IV (Site No.: 224051)
<b>ADDRESS:</b>	545 Sackett St., Brooklyn, NY
<b>PREPARED BY:</b>	Roux Environmental Engineering and Geology, D.P.C.
<b>DATE:</b>	May 4th, 2023
<b>WEATHER:</b>	Temp: 48 – 54°F Mostly Cloudy, RH: 50% Pressure: 30.24" Hg Wind: N @ 6 mph
<b>TIME:</b>	07:00 – 15:30

### Excavation Diagram

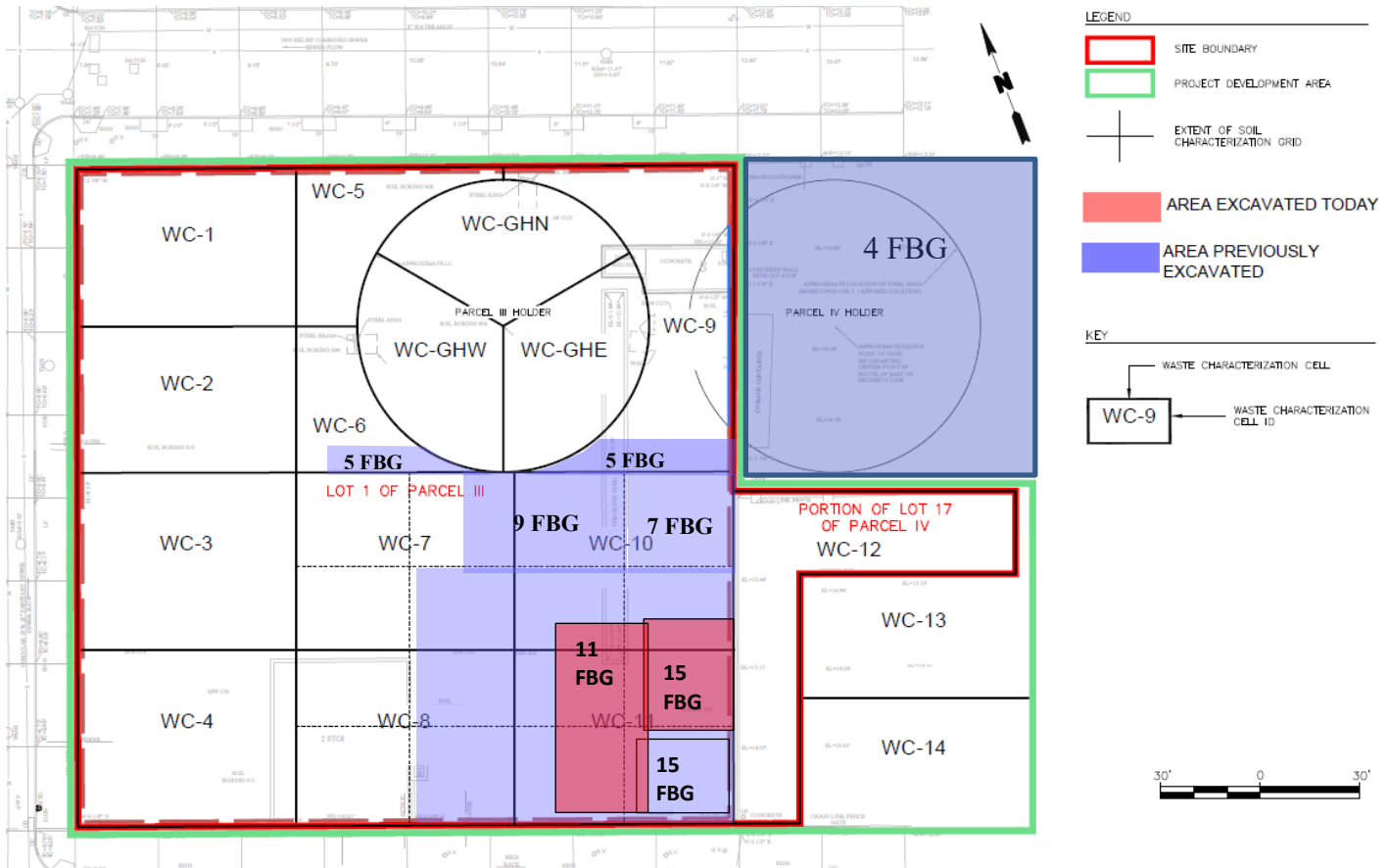

<b>PROJECT:</b>	Former Fulton MGP – Parcels III and IV (Site No.: 224051)
<b>ADDRESS:</b>	545 Sackett St., Brooklyn, NY
<b>PREPARED BY:</b>	Roux Environmental Engineering and Geology, D.P.C.
<b>DATE:</b>	May 4th, 2023
<b>WEATHER:</b>	Temp: 48 – 54°F Mostly Cloudy, RH: 50% Pressure: 30.24" Hg Wind: N @ 6 mph
<b>TIME:</b>	07:00 – 15:30

**Photographs of Onsite Work**



**Photo 1:**

CEI loading soil from grid WC-11 for disposal to WM Fairless facility.



**Photo 2:**

CEI backfilling with imported general fill at the east of grid WC-10 and WC-11. CEI applied odor suppression foam on stockpiles.