

<b>PROJECT:</b>	Former Fulton MGP – Parcels III and IV (Site No.: 224051)
<b>ADDRESS:</b>	545 Sackett St., Brooklyn, NY
<b>PREPARED BY:</b>	Roux Environmental Engineering and Geology, D.P.C.
<b>DATE:</b>	May 5th, 2023
<b>WEATHER:</b>	Temp: 55 – 60°F Cloudy, RH: 53% Pressure: 30.20" Hg Wind: W @ 9 mph
<b>TIME:</b>	07:00 – 15:30

### Project Team

#### *General Contractor and Subcontractors:*

- Mega Contracting Group, LLC (Mega)
- Creamer Environmental, Inc. (CEI)

#### *Engineers and Consultants:*

- Roux Environmental Engineering and Geology, D.P.C. (Roux)
- GZA GeoEnvironmental Inc. (GZA)
- Mueser Rutledge Consulting Engineers, PLLC (MRCE)
- WSP USA (WSP)
- Intertek MT Group (Intertek)

### Remedial Action Work Summary

#### Work Activities Performed Onsite:

- SOE sheet pile installation along Degraw Street.
- Excavation inside the tension fabric structure (TFS) for future disposal to Waste Management Fairless facility.
- Loaded out soil for disposal to Waste Management Fairless
- Import of general fill from approved Vulcan Wantage Quarry.

#### Contractor Work Performed Onsite:

Creamer Environmental, Inc (CEI) loaded out ten (10) trucks, approximately 220 tons of non-hazardous urban fill from waste characterization grid WC-11 (8-15') for off-site disposal to the Waste Management Fairless facility.

CEI imported ten (10) trucks, approximately 257.19 tons of general fill from Vulcan Wantage Quarry. Import material was added to the stockpile in waste characterization WC- 12. All transport trucks were cleaned and inspected before leaving the site to ensure no material was tracked off-site.

CEI continued SOE sheet pile installation along north site boundary, from structural detail 3 towards detail 4. Approximately 18 linear feet of SOE sheeting were installed along Degraw street. CEI continued SOE site preparation, including grading the work area, crane mats placement and preparation of SOE sheet piles.

CEI intermittently operated sump pumps to remove surface water inside the tension fabric structure (TFS). All recovered water was collected and sent to the water treatment system (WTS) for future processing and discharge. No treated water was discharged to the New York City combined sewer system.

CEI excavated within waste characterization grid WC-10 to complete the installation of the slide rail box. CEI continued to backfill with imported general fill the remediated area up to an approximate elevation of 10 feet below grade. Intertek continued to perform compaction testing in the backfilled area to confirmed geotechnical requirements.

CEI applied odor suppression foam on stockpiles inside the TFS and operated Vapor Management System (VMS) during all work activities inside the TFS. CEI also conducted dust control measures (wetting, tarping, limiting vehicle speeds, etc.) as needed.

#### Air Monitoring:

- No VOC or dust exceedances were observed from the community air monitoring program (CAMP).
- GZA will provide a summary report of CAMP activities.

#### Erosion and Sediment Control



## DAILY STATUS REPORT

<b>PROJECT:</b>	Former Fulton MGP – Parcels III and IV (Site No.: 224051)
<b>ADDRESS:</b>	545 Sackett St., Brooklyn, NY
<b>PREPARED BY:</b>	Roux Environmental Engineering and Geology, D.P.C.
<b>DATE:</b>	May 5th, 2023
<b>WEATHER:</b>	Temp: 55 – 60°F Cloudy, RH: 53% Pressure: 30.20" Hg Wind: W @ 9 mph
<b>TIME:</b>	07:00 – 15:30

- Erosion and sediments controls were inspected to confirm all elements are operational and functional.

Sampling Conducted:

- None

Other Items of Note:

- Construction and drilling activities were observed as part of the ongoing CSO project west of Nevins Street.

**Imported Material**

Name - Location	Source	During This Reporting Period		Total	
		Loads	Tons	Loads	Tons
Vulcan ASTM #3 (1 ½" Stone)	Vulcan Hamburg Quarry			7	179.3
Vulcan General Fill	Vulcan Wantage Quarry	10	257.19	125	3180.25

**Exported Material**

Material	Facility	During This Reporting Period		Total	
		Loads	Tons	Loads	Tons
Concrete for Recycling	Bayshore			20	421.87
Concrete for Landfill	WM Fairless			57	~1,312.59
TCE Impacted Haz Hot Spots	CWM Emelle			7	161.72
Cd Impacted Haz Material from WC-5	CWM Emelle			3	49.45
Pb impacted Haz from Parcel IV Hot Spot	CMW Emelle			25	~550
Cd Impacted Haz Material from WC-5	Clean Earth NJ			16	397.75
Non-Haz Contaminated Urban Fill	WM Fairless	10	220	127	~2,728
MGP soil with TCE>25 ppm	Clean Earth ESMI			113	~2,494
Non-Haz MGP Impacted	Clean Earth New Castle			34	~748
Non-Haz MGP Impacted	CESP			7	~154

**Exported Material Truck Log**

Number	Excavation Grid	Disposal Facility	Disposal Profile	Manifest Number	Trucking Company	Truck License Plate
1	WC-11(8-15)'	WM Fairless	Non-haz urban fill	12455198	V&E	AY259E
2	WC-11(8-15)'	WM Fairless	Non-haz urban fill	12455199	V&E	AY260E
3	WC-11(8-15)'	WM Fairless	Non-haz urban fill	12455200	V&E	AX709B
4	WC-11(8-15)'	WM Fairless	Non-haz urban fill	12455201	V&E	AW641V
5	WC-11(8-15)'	WM Fairless	Non-haz urban fill	12455202	V&E	AW259D
6	WC-11(8-15)'	WM Fairless	Non-haz urban fill	12455203	V&E	AY774E
7	WC-11(8-15)'	WM Fairless	Non-haz urban fill	12455204	V&E	AW358B
8	WC-11(8-15)'	WM Fairless	Non-haz urban fill	12455205	V&E	AX709B
9	WC-11(8-15)'	WM Fairless	Non-haz urban fill	12455206	V&E	AW259D
10	WC-11(8-15)'	WM Fairless	Non-haz urban fill	12455207	V&E	AY259E

**Dewatering**

Time	Totalizer Volume (gallons)*
7:00	2,400,011

**DAILY STATUS REPORT**

<b>PROJECT:</b>	Former Fulton MGP – Parcels III and IV (Site No.: 224051)
<b>ADDRESS:</b>	545 Sackett St., Brooklyn, NY
<b>PREPARED BY:</b>	Roux Environmental Engineering and Geology, D.P.C.
<b>DATE:</b>	May 5th, 2023
<b>WEATHER:</b>	Temp: 55 – 60°F Cloudy, RH: 53% Pressure: 30.20" Hg Wind: W @ 9 mph
<b>TIME:</b>	07:00 – 15:30

15:30	2,400,011
Water treated and discharged since last report:	0 gallons

<b>Anticipated Upcoming Work Activities</b>
Continued SOE sheet piles installation along Degraw Street. Continued backfilled at the bottom of excavation in waste characterization grid WC-11.

**Site Layout**

<b>PROJECT:</b>	Former Fulton MGP – Parcels III and IV (Site No.: 224051)
<b>ADDRESS:</b>	545 Sackett St., Brooklyn, NY
<b>PREPARED BY:</b>	Roux Environmental Engineering and Geology, D.P.C.
<b>DATE:</b>	May 5th, 2023
<b>WEATHER:</b>	Temp: 55 – 60°F Cloudy, RH: 53% Pressure: 30.20" Hg Wind: W @ 9 mph
<b>TIME:</b>	07:00 – 15:30

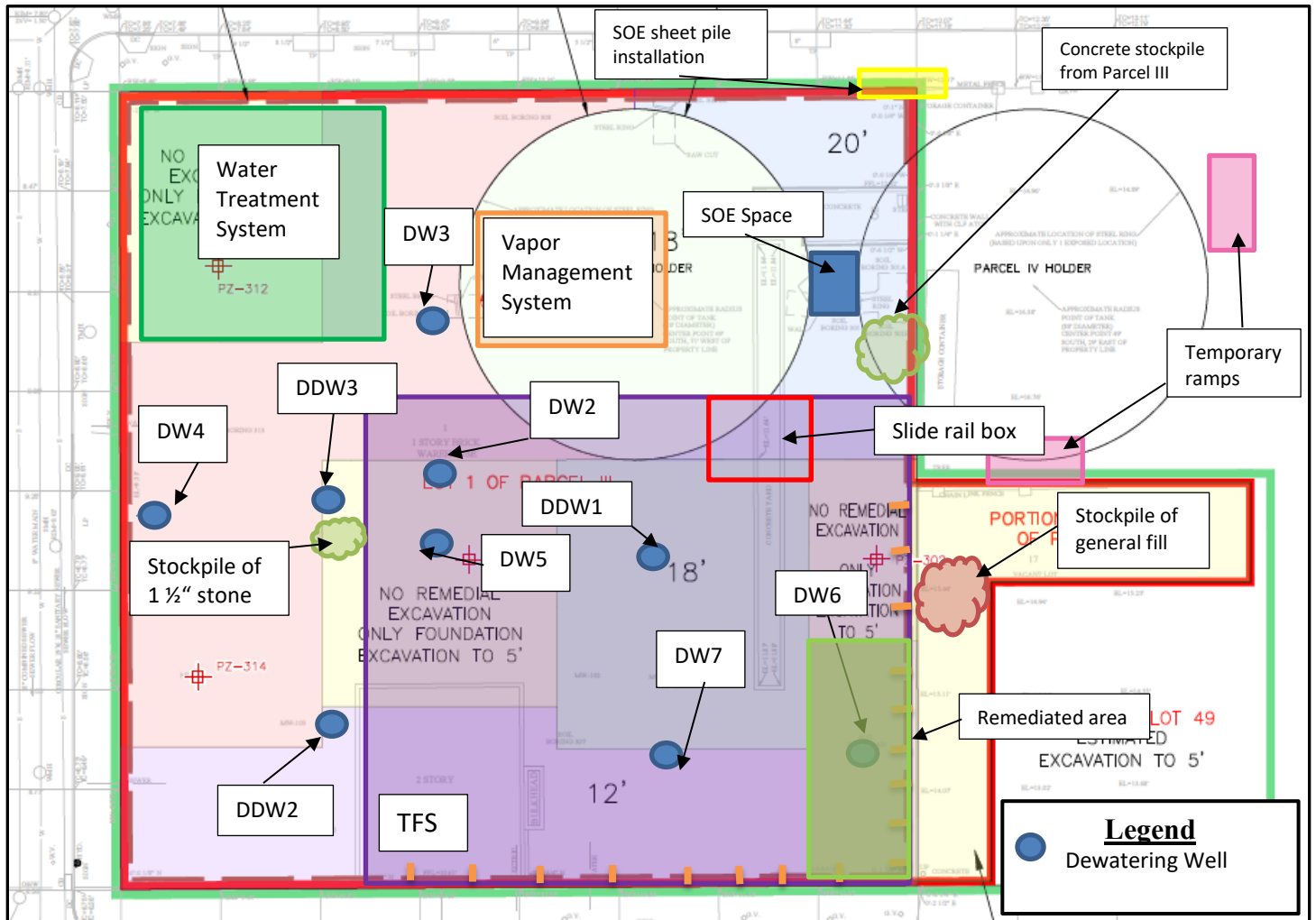

<b>PROJECT:</b>	Former Fulton MGP – Parcels III and IV (Site No.: 224051)
<b>ADDRESS:</b>	545 Sackett St., Brooklyn, NY
<b>PREPARED BY:</b>	Roux Environmental Engineering and Geology, D.P.C.
<b>DATE:</b>	May 5th, 2023
<b>WEATHER:</b>	Temp: 55 – 60°F Cloudy, RH: 53% Pressure: 30.20" Hg Wind: W @ 9 mph
<b>TIME:</b>	07:00 – 15:30

### Excavation Diagram

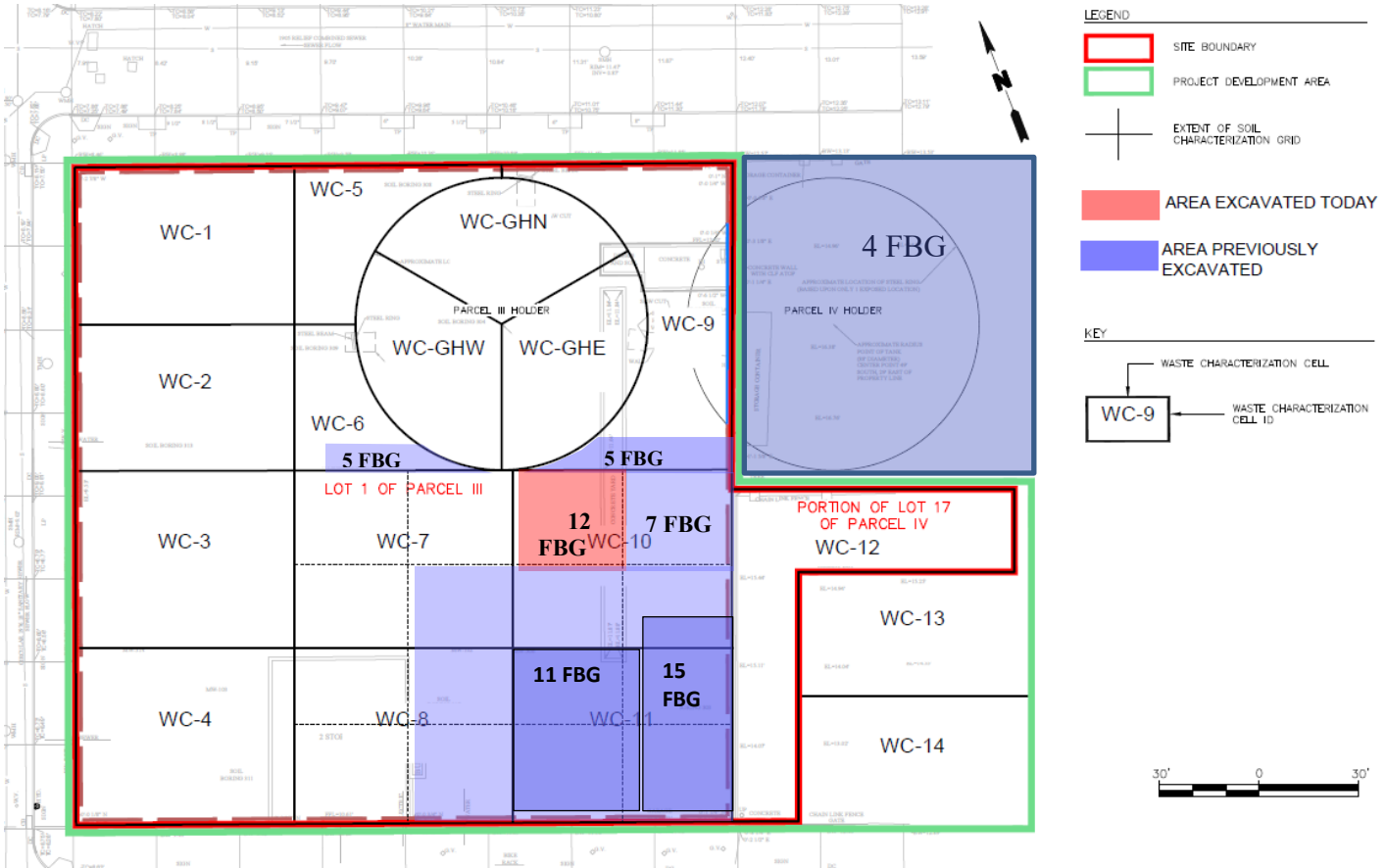

<b>PROJECT:</b>	Former Fulton MGP – Parcels III and IV (Site No.: 224051)
<b>ADDRESS:</b>	545 Sackett St., Brooklyn, NY
<b>PREPARED BY:</b>	Roux Environmental Engineering and Geology, D.P.C.
<b>DATE:</b>	May 5th, 2023
<b>WEATHER:</b>	Temp: 55 – 60°F Cloudy, RH: 53% Pressure: 30.20" Hg Wind: W @ 9 mph
<b>TIME:</b>	07:00 – 15:30

### Photographs of Onsite Work



#### **Photo 1:**

CEI compacting general fill within the remediated area at the east of grid WC-11 and a portion of grid WC-10.



#### **Photo 2:**

CEI installed south side panel of the slide rail box installation, inside the TFS.