

| | |
|---------------------|--|
| PROJECT: | Former Fulton MGP – Parcels III and IV (Site No.: 224051) |
| ADDRESS: | 545 Sackett St., Brooklyn, NY |
| PREPARED BY: | Roux Environmental Engineering and Geology, D.P.C. |
| DATE: | May 9th, 2023 |
| WEATHER: | Temp: 59 – 75°F Cloudy, RH: 73% Pressure: 29.79" Hg Wind: NW @ 6 mph |
| TIME: | 07:00 – 15:30 |

Project Team

General Contractor and Subcontractors:

- Mega Contracting Group, LLC (Mega)
- Creamer Environmental, Inc. (CEI)

Engineers and Consultants:

- Roux Environmental Engineering and Geology, D.P.C. (Roux)
- GZA GeoEnvironmental Inc. (GZA)
- Mueser Rutledge Consulting Engineers, PLLC (MRCE)
- WSP USA (WSP)

Remedial Action Work Summary

Work Activities Performed Onsite:

- SOE sheet pile installation along Degraw Street.
- Excavation inside the tension fabric structure (TFS) for future disposal to Waste Management Fairless facility.
- Loaded out soil for disposal to Clean Earth Carteret
- Import of general fill and ¾ crushed stone from approved Vulcan Wantage Quarry.

Contractor Work Performed Onsite:

Creamer Environmental, Inc (CEI) loaded four (4) trucks, approximately 88 tons of non-hazardous urban fill from waste characterization grids WC-10 (8-10) for off-site disposal to the Clean Earth Carteret facility.

CEI imported nine (9) trucks, approximately 229.37 tons of general fill and four (4) trucks, approximately 100.99 tons of crushed stone from Vulcan Wantage Quarry. Import general fill material was added to the stockpile in waste characterization grid WC- 12. Imported stone was added to the stockpile in grid WC-3. All transport trucks were cleaned and inspected before leaving the site to ensure no material was tracked off-site.

CEI continued SOE sheet pile installation along north site boundary, from structural detail 3 towards detail 4. Approximately 12 linear feet of SOE sheeting were installed along Degraw street. CEI continued SOE site preparation, including grading the work area, crane mats placement and preparation of SOE sheet piles.

CEI excavated within waste characterization grid WC-10, in the northeast corner of the phase I excavation area in the 5-foot deep area defined in the RAWP. CEI excavated up to approximately 10 feet below grade with completion of excavation planned for the next day.

CEI applied odor suppression foam on stockpiles inside the TFS and operated Vapor Management System (VMS) during all work activities inside the TFS. CEI also conducted dust control measures (wetting, tarping, limiting vehicle speeds, etc.) as needed.

Air Monitoring:

- No VOC or dust exceedances were observed from the community air monitoring program (CAMP).
- GZA will provide a summary report of CAMP activities.

Erosion and Sediment Control

- Erosion and sediments controls were inspected to confirm all elements are operational and functional.

Sampling Conducted:

**DAILY STATUS REPORT**

| | |
|---------------------|--|
| PROJECT: | Former Fulton MGP – Parcels III and IV (Site No.: 224051) |
| ADDRESS: | 545 Sackett St., Brooklyn, NY |
| PREPARED BY: | Roux Environmental Engineering and Geology, D.P.C. |
| DATE: | May 9th, 2023 |
| WEATHER: | Temp: 59 – 75°F Cloudy, RH: 73% Pressure: 29.79" Hg Wind: NW @ 6 mph |
| TIME: | 07:00 – 15:30 |

- None

Other Items of Note:

- None

Imported Material

| Name - Location | Source | During This Reporting Period | | Total | |
|-----------------------------|-----------------------|------------------------------|--------|-------|---------|
| | | Loads | Tons | Loads | Tons |
| Vulcan ASTM #3 (1 ½" Stone) | Vulcan Hamburg Quarry | | | 7 | 179.3 |
| Vulcan ASTM #57 (¾" Stone) | Vulcan Hamburg Quarry | 4 | 100.99 | 4 | 100.99 |
| Vulcan General Fill | Vulcan Wantage Quarry | 9 | 229.37 | 154 | 3923.48 |

Exported Material

| Material | Facility | During This Reporting Period | | Total | |
|---|------------------------|------------------------------|------|-------|-----------|
| | | Loads | Tons | Loads | Tons |
| Concrete for Recycling | Bayshore | | | 20 | 421.87 |
| Concrete for Landfill | WM Fairless | | | 57 | ~1,312.59 |
| TCE Impacted Haz Hot Spots | CWM Emelle | | | 7 | 161.72 |
| Cd Impacted Haz Material from WC-5 | CWM Emelle | | | 3 | 49.45 |
| Pb impacted Haz from Parcel IV Hot Spot | CMW Emelle | | | 25 | ~550 |
| Cd Impacted Haz Material from WC-5 | Clean Earth NJ | | | 16 | 397.75 |
| Non-Haz Contaminated Urban Fill | WM Fairless | | | 135 | ~2,904 |
| MGP soil with TCE>25 ppm | Clean Earth ESMI | | | 113 | ~2,494 |
| Non-Haz MGP Impacted | Clean Earth New Castle | | | 34 | ~748 |
| Non-Haz MGP Impacted | CESP | | | 7 | ~154 |
| Non-Haz Urban Fill | CEC | 4 | 88 | 4 | ~88 |

Exported Material Truck Log

| Number | Excavation Grid | Disposal Facility | Disposal Profile | Manifest Number | Trucking Company | Truck License Plate |
|--------|-----------------|-------------------|--------------------|-----------------|------------------|---------------------|
| 1 | WC-10(10-15)' | CEC | Non-haz urban fill | 2624112 | V&E | AX745D |
| 2 | WC-10(10-15)' | CEC | Non-haz urban fill | 2624113 | V&E | AU750G |
| 3 | WC-10(10-15)' | CEC | Non-haz urban fill | 2624114 | V&E | AY609A |
| 4 | WC-10(10-15)' | CEC | Non-haz urban fill | 2624115 | V&E | AW636F |
| | | | | | | |
| | | | | | | |
| | | | | | | |
| | | | | | | |
| | | | | | | |
| | | | | | | |

Dewatering

| Time | Totalizer Volume (gallons)* |
|-------|-----------------------------|
| 7:00 | 2,400,011 |
| 15:30 | 2,400,011 |

**DAILY STATUS REPORT**

| | |
|---------------------|--|
| PROJECT: | Former Fulton MGP – Parcels III and IV (Site No.: 224051) |
| ADDRESS: | 545 Sackett St., Brooklyn, NY |
| PREPARED BY: | Roux Environmental Engineering and Geology, D.P.C. |
| DATE: | May 9th, 2023 |
| WEATHER: | Temp: 59 – 75°F Cloudy, RH: 73% Pressure: 29.79" Hg Wind: NW @ 6 mph |
| TIME: | 07:00 – 15:30 |

| | |
|---|-----------|
| Water treated and discharged since last report: | 0 gallons |
|---|-----------|

Anticipated Upcoming Work Activities

Continued SOE sheet piles installation along Degraw Street. Continued excavation in waste characterization grid WC-10.

Site Layout

| | |
|---------------------|--|
| PROJECT: | Former Fulton MGP – Parcels III and IV (Site No.: 224051) |
| ADDRESS: | 545 Sackett St., Brooklyn, NY |
| PREPARED BY: | Roux Environmental Engineering and Geology, D.P.C. |
| DATE: | May 9th, 2023 |
| WEATHER: | Temp: 59 – 75°F Cloudy, RH: 73% Pressure: 29.79" Hg Wind: NW @ 6 mph |
| TIME: | 07:00 – 15:30 |

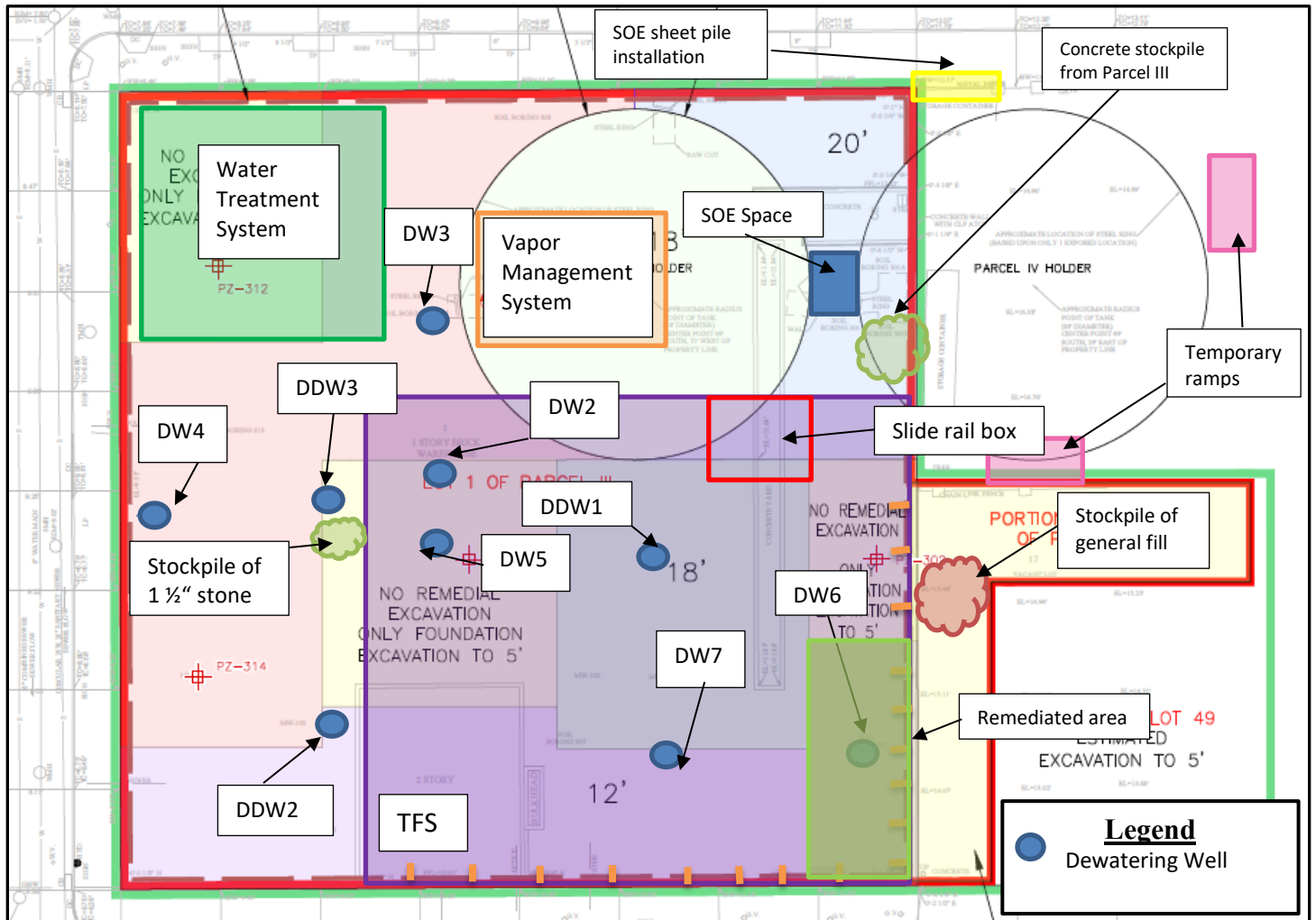

| | |
|---------------------|--|
| PROJECT: | Former Fulton MGP – Parcels III and IV (Site No.: 224051) |
| ADDRESS: | 545 Sackett St., Brooklyn, NY |
| PREPARED BY: | Roux Environmental Engineering and Geology, D.P.C. |
| DATE: | May 9th, 2023 |
| WEATHER: | Temp: 59 – 75°F Cloudy, RH: 73% Pressure: 29.79" Hg Wind: NW @ 6 mph |
| TIME: | 07:00 – 15:30 |

Excavation Diagram

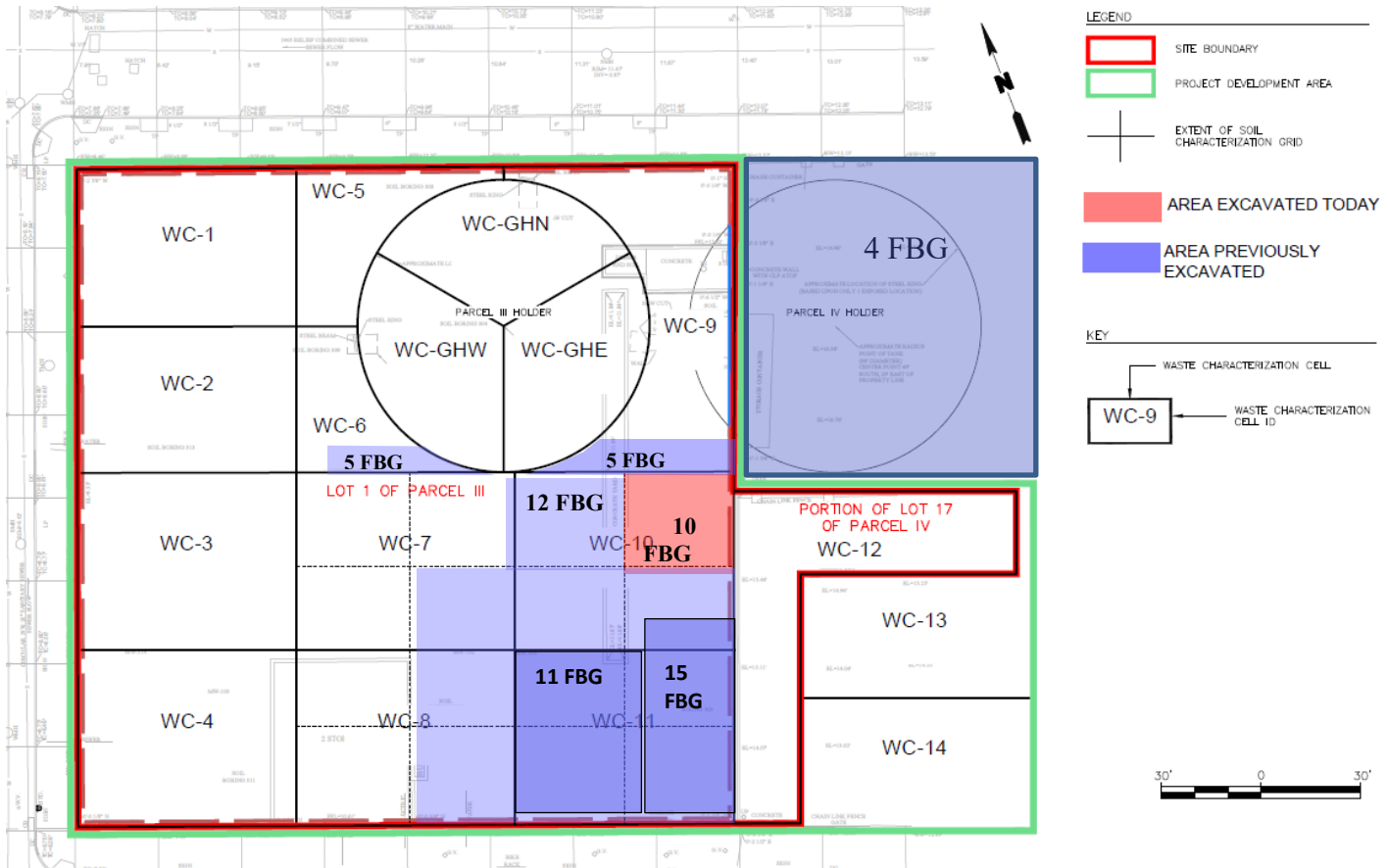

| | |
|---------------------|--|
| PROJECT: | Former Fulton MGP – Parcels III and IV (Site No.: 224051) |
| ADDRESS: | 545 Sackett St., Brooklyn, NY |
| PREPARED BY: | Roux Environmental Engineering and Geology, D.P.C. |
| DATE: | May 9th, 2023 |
| WEATHER: | Temp: 59 – 75°F Cloudy, RH: 73% Pressure: 29.79" Hg Wind: NW @ 6 mph |
| TIME: | 07:00 – 15:30 |

Photographs of Onsite Work



Photo 1:

UST secured and covered located on the eastern side of the Lot 49 property line. Clean Fill stockpile behind.

| | |
|--------------|--|
| PROJECT: | Former Fulton MGP – Parcels III and IV (Site No.: 224051) |
| ADDRESS: | 545 Sackett St., Brooklyn, NY |
| PREPARED BY: | Roux Environmental Engineering and Geology, D.P.C. |
| DATE: | May 9th, 2023 |
| WEATHER: | Temp: 59 – 75°F Cloudy, RH: 73% Pressure: 29.79" Hg Wind: NW @ 6 mph |
| TIME: | 07:00 – 15:30 |



Photo 2:
Sheet piling installation on north side of
Holder IV