

PROJECT:	Former Fulton MGP – Parcels III and IV (Site No.: 224051)
ADDRESS:	545 Sackett St., Brooklyn, NY
PREPARED BY:	Roux Environmental Engineering and Geology, D.P.C.
DATE:	May 10th, 2023
WEATHER:	Temp: 60 – 79°F Sunny, RH: 36% Pressure: 29.85" Hg Wind: NW @ 9 mph
TIME:	08:00 – 18:00

Project Team*General Contractor and Subcontractors:*

- Mega Contracting Group, LLC (Mega)
- Creamer Environmental, Inc. (CEI)

Engineers and Consultants:

- Roux Environmental Engineering and Geology, D.P.C. (Roux)
- GZA GeoEnvironmental Inc. (GZA)
- Mueser Rutledge Consulting Engineers, PLLC (MRCE)
- WSP USA (WSP)

Remedial Action Work SummaryWork Activities Performed Onsite:

- SOE sheet pile installation along Degraw Street.
- Excavation inside the tension fabric structure (TFS) for future disposal to Carteret facility.
- Complete excavation to depth of ~14ft in WC-10 (C/D)
- Collected documentation endpoint samples DOC-35 and DOC-36
- Collected baseline groundwater samples from sentinel wells
- Begin backfill operations in excavation area
- Import of general fill from approved Vulcan Wantage Quarry.

Contractor Work Performed Onsite:

CEI imported ten (10) trucks, approximately 225.03 tons of general fill from Vulcan Wantage Quarry. Import material was added to the stockpile in waste characterization area WC- 12. All transport trucks were cleaned and inspected before leaving the site to ensure no material was tracked off-site.

CEI continued SOE sheet pile installation along north site boundary, from structural detail 3 towards detail 4. Approximately 30 linear feet of SOE sheeting were installed along Degraw street. CEI continued SOE site preparation, including grading the work area, crane mats placement and preparation of SOE sheet piles.

CEI excavated within waste characterization grid WC-10, inside sections C and D to meet the bottom of the remedial excavation. CEI excavated up to approximately 15 feet below grade. Due to water infiltration inside the slide rail box, Confirmation of the bottom of excavation was approved by WSP before sampling. Roux collected endpoint samples DOC-35 and DOC-36. CEI began backfilling the excavation with imported general fill up to an approximate elevation of 10 feet below grade.

CEI applied odor suppression foam on stockpiles inside the TFS and operated Vapor Management System (VMS) during all work activities inside the TFS. CEI also conducted dust control measures (wetting, tarping, limiting vehicle speeds, etc.) as needed.

Air Monitoring:

- No VOC or dust exceedances were observed from the community air monitoring program (CAMP).
- GZA will provide a summary report of CAMP activities.

Erosion and Sediment Control

- Erosion and sediments controls were inspected to confirm all elements are operational and functional.

**DAILY STATUS REPORT**

PROJECT:	Former Fulton MGP – Parcels III and IV (Site No.: 224051)
ADDRESS:	545 Sackett St., Brooklyn, NY
PREPARED BY:	Roux Environmental Engineering and Geology, D.P.C.
DATE:	May 10th, 2023
WEATHER:	Temp: 60 – 79°F Sunny, RH: 36% Pressure: 29.85" Hg Wind: NW @ 9 mph
TIME:	08:00 – 18:00

Sampling Conducted:

- Collected endpoint samples at DOC-35 and DOC-36
- Separate Roux crew sampled sentinel wells SW-01S, SW-01D, SW-02S, SW-02D, SW-03S, SW-03D as part of baseline sampling program

Other Items of Note:

- None

Imported Material

Name - Location	Source	During This Reporting Period		Total	
		Loads	Tons	Loads	Tons
Vulcan ASTM #3 (1 ½" Stone)	Vulcan Hamburg Quarry			7	179.3
Vulcan ASTM #57 (3/4" Stone)	Vulcan Hamburg Quarry			4	100.99
Vulcan General Fill	Vulcan Wantage Quarry	10	255.03	164	4,178.51

Exported Material

Material	Facility	During This Reporting Period		Total	
		Loads	Tons	Loads	Tons
Concrete for Recycling	Bayshore			20	421.87
Concrete for Landfill	WM Fairless			57	~1,312.59
TCE Impacted Haz Hot Spots	CWM Emelle			7	161.72
Cd Impacted Haz Material from WC-5	CWM Emelle			3	49.45
Pb impacted Haz from Parcel IV Hot Spot	CMW Emelle			25	~550
Cd Impacted Haz Material from WC-5	Clean Earth NJ			16	397.75
Non-Haz Contaminated Urban Fill	WM Fairless			135	~2,904
MGP soil with TCE>25 ppm	Clean Earth ESMI			113	~2,494
Non-Haz MGP Impacted	Clean Earth New Castle			34	~748
Non-Haz MGP Impacted	CESP			7	~154
Non-Haz Urban Fill	CEC			4	~88

Exported Material Truck Log

Number	Excavation Grid	Disposal Facility	Disposal Profile	Manifest Number	Trucking Company	Truck License Plate



DAILY STATUS REPORT

PROJECT:	Former Fulton MGP – Parcels III and IV (Site No.: 224051)
ADDRESS:	545 Sackett St., Brooklyn, NY
PREPARED BY:	Roux Environmental Engineering and Geology, D.P.C.
DATE:	May 10th, 2023
WEATHER:	Temp: 60 – 79°F Sunny, RH: 36% Pressure: 29.85" Hg Wind: NW @ 9 mph
TIME:	08:00 – 18:00

Dewatering

Time	Totalizer Volume (gallons)*
7:00	2,400,011
18:30	2,400,011
Water treated and discharged since last report:	0 gallons

Anticipated Upcoming Work Activities

Continued SOE sheet piles installation along Degraw Street then moving to detail areas 10 to 5. Continued backfilled at the bottom of excavation in waste characterization grid WC-10. Export trucking of material from WC-10 (C/D)

PROJECT:	Former Fulton MGP – Parcels III and IV (Site No.: 224051)
ADDRESS:	545 Sackett St., Brooklyn, NY
PREPARED BY:	Roux Environmental Engineering and Geology, D.P.C.
DATE:	May 10th, 2023
WEATHER:	Temp: 60 – 79°F Sunny, RH: 36% Pressure: 29.85" Hg Wind: NW @ 9 mph
TIME:	08:00 – 18:00

Site Layout

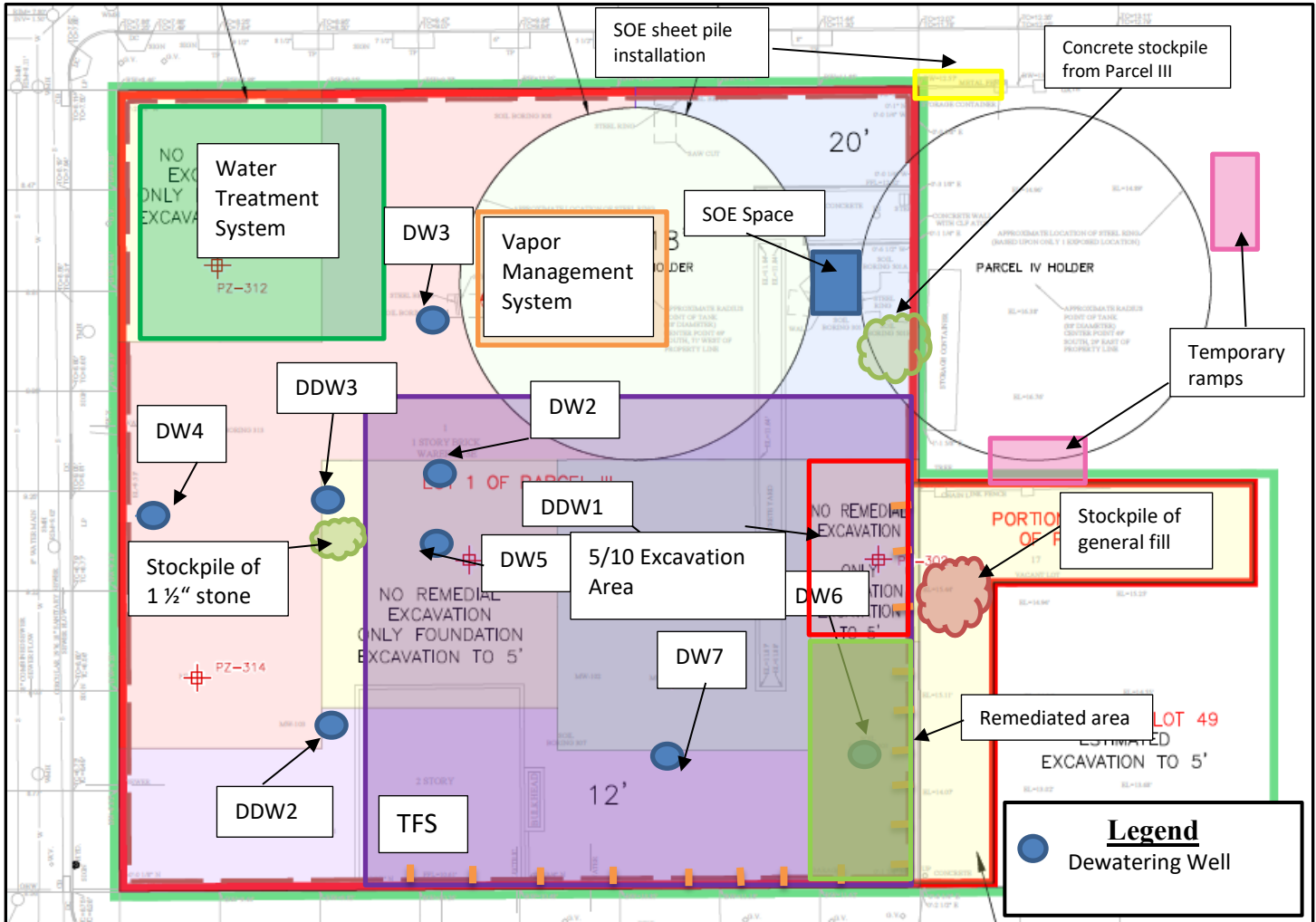

PROJECT:	Former Fulton MGP – Parcels III and IV (Site No.: 224051)
ADDRESS:	545 Sackett St., Brooklyn, NY
PREPARED BY:	Roux Environmental Engineering and Geology, D.P.C.
DATE:	May 10th, 2023
WEATHER:	Temp: 60 – 79°F Sunny, RH: 36% Pressure: 29.85" Hg Wind: NW @ 9 mph
TIME:	08:00 – 18:00

Excavation Diagram

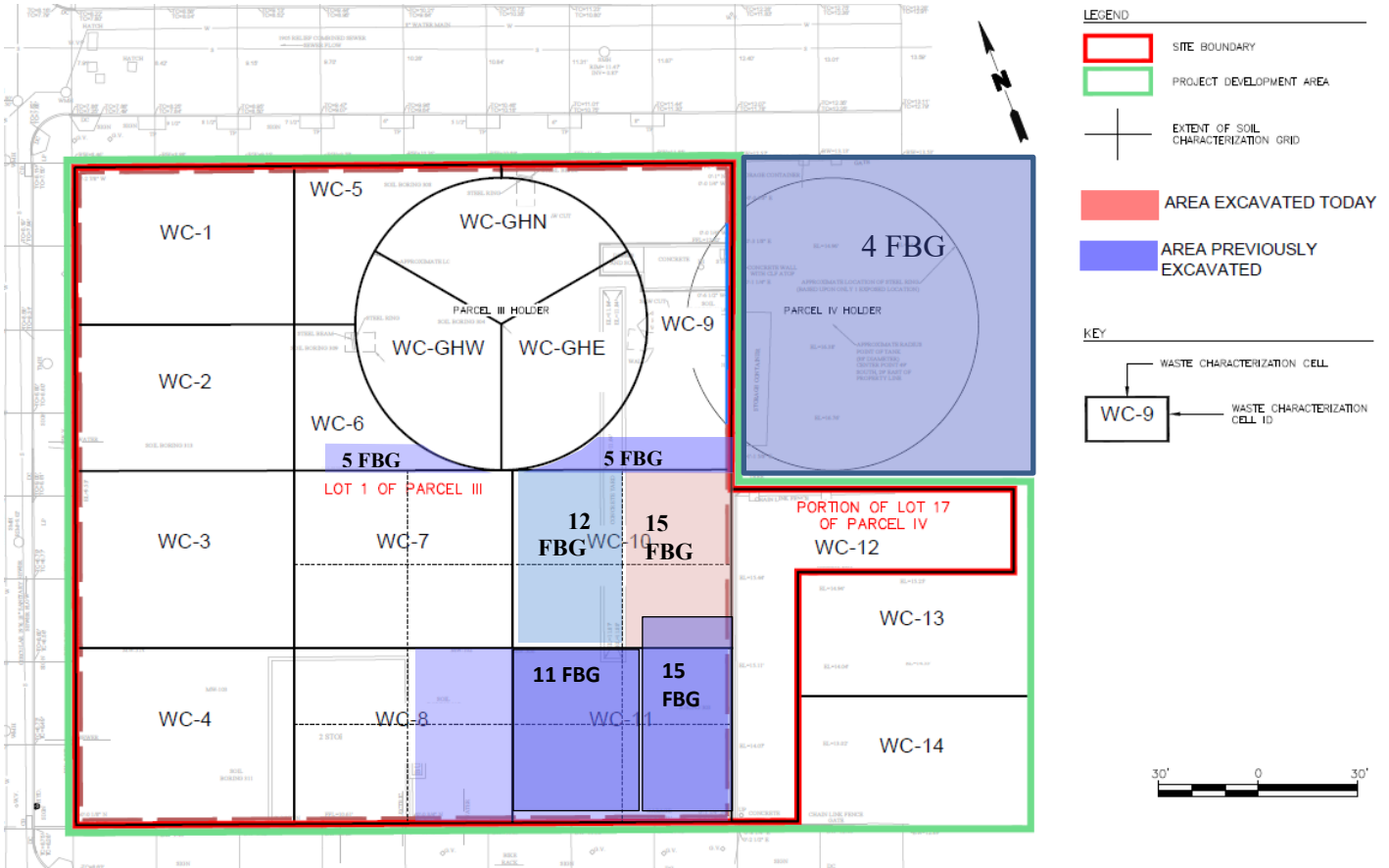

PROJECT:	Former Fulton MGP – Parcels III and IV (Site No.: 224051)
ADDRESS:	545 Sackett St., Brooklyn, NY
PREPARED BY:	Roux Environmental Engineering and Geology, D.P.C.
DATE:	May 10th, 2023
WEATHER:	Temp: 60 – 79°F Sunny, RH: 36% Pressure: 29.85" Hg Wind: NW @ 9 mph
TIME:	08:00 – 18:00

Photographs of Onsite Work



Photo 1:

WC-10 (C/D) Inspection of bottom of bottom of excavation area. Approved by WSP and allowed to collect endpoint samples DOC-35 and DOC-36 before backfilling

PROJECT:	Former Fulton MGP – Parcels III and IV (Site No.: 224051)
ADDRESS:	545 Sackett St., Brooklyn, NY
PREPARED BY:	Roux Environmental Engineering and Geology, D.P.C.
DATE:	May 10th, 2023
WEATHER:	Temp: 60 – 79°F Sunny, RH: 36% Pressure: 29.85" Hg Wind: NW @ 9 mph
TIME:	08:00 – 18:00

**Photo 2:**

General backfill delivery at WC-12



DAILY STATUS REPORT

PROJECT:	Former Fulton MGP – Parcels III and IV (Site No.: 224051)
ADDRESS:	545 Sackett St., Brooklyn, NY
PREPARED BY:	Roux Environmental Engineering and Geology, D.P.C.
DATE:	May 10th, 2023
WEATHER:	Temp: 60 – 79°F Sunny, RH: 36% Pressure: 29.85" Hg Wind: NW @ 9 mph
TIME:	08:00 – 18:00

--	--