

<b>PROJECT:</b>	Former Fulton MGP – Parcels III and IV (Site No.: 224051)
<b>ADDRESS:</b>	545 Sackett St., Brooklyn, NY
<b>PREPARED BY:</b>	Roux Environmental Engineering and Geology, D.P.C.
<b>DATE:</b>	February 1, 2024
<b>WEATHER:</b>	Temp: 32-45°F, Cloudy, RH: 79% Pressure: 30.05" in Hg Wind: SW @ 8 mph
<b>TIME:</b>	07:00 – 15:30

### Project Team

#### General Contractor and Subcontractors:

- Mega Contracting Group, LLC (Mega)
- Creamer Environmental, Inc. (CEI)

#### Engineers and Consultants:

- Roux Environmental Engineering and Geology, D.P.C. (Roux)
- GZA GeoEnvironmental Inc. of New York (GZANY)
- WSP USA (WSP)

### Remedial Action Work Summary

#### Work Activities Performed Onsite:

- Load out and disposal of material from waste characterization grid WC-3.
- Installation of support of excavation (SOE) in Gas Holder 3 excavation area.

#### Contractor Work Performed Onsite:

Creamer Environmental, Inc. (CEI) excavated exported 18 trucks (~396 tons) of urban fill with CVOCs from waste characterization grid WC-3 (0-5 and 5-10) for disposal at Waste Management Fairless, 5 trucks (~110 tons) of urban fill from waste characterization grid WC-4 (0-5) for disposal at Clean Earth of Carteret, and 2 trucks (~44 tons) of concrete for disposal at Bayshore Recycling. CEI continued breaking surface concrete and downsizing material for future load out and disposal in grid WC-4. CEI completed installation and welding the SOE walers/ bracing in the Gas Holder 3 excavation area and completed installing the lagging wall between Gas Holder 3 and 4. CEI continued to spread the general fill material and compact in WC-2.

The vapor management system (VMS) associated with the tension fabric structure (TFS) was operated throughout the day. Dust and odor control measures (wetting, tarping, limiting vehicle speeds, etc.) were performed as needed, to ensure there were no impacts to the neighborhood. All truck tires were cleaned before leaving the Site, to ensure no material was tracked onto the surrounding streets. Exposed soils were covered with Atmos odor suppressing foam and/or poly sheeting at the end of the day.

#### Air Monitoring:

- No VOC or dust exceedances were observed from the community air monitoring program (CAMP).
- GZANY to provide a summary report of CAMP activities separately.

#### Erosion and Sediment Control:

- Weekly SWPPP inspection was performed.

#### Sampling Conducted:

- None.

#### Other Items of Note:

- Construction activities were observed as part of the ongoing combined sewer overflow (CSO) project west of Nevins Street.

<b>PROJECT:</b>	Former Fulton MGP – Parcels III and IV (Site No.: 224051)
<b>ADDRESS:</b>	545 Sackett St., Brooklyn, NY
<b>PREPARED BY:</b>	Roux Environmental Engineering and Geology, D.P.C.
<b>DATE:</b>	February 1, 2024
<b>WEATHER:</b>	Temp: 32-45°F, Cloudy, RH: 79% Pressure: 30.05" in Hg Wind: SW @ 8 mph
<b>TIME:</b>	07:00 – 15:30

**Imported Material**

Name - Location	Source	During This Reporting Period		Total	
		Loads	Tons	Loads	Tons
Vulcan ASTM #3 (1 ½" Stone)	Vulcan Hamburg Quarry			10	255.36
Vulcan ASTM #57 (3/4" Stone)	Vulcan Hamburg Quarry			5	126.76
Vulcan General Fill	Vulcan Wantage Quarry			639	16,112.13

**Exported Material**

Material	Facility	During This Reporting Period		Total	
		Loads	Tons	Loads	Tons
TCE Impacted Haz Hot Spots	CWM Emelle			7	161.72
Cd Impacted Haz Material from WC-5	CWM Emelle			3	49.45
Pb Impacted Haz from Parcel IV Hot Spot	CWM Emelle			25	536.72
Cd Impacted Haz Material from WC-5	Clean Earth NJ			16	397.75
Concrete for Recycling	Bayshore	2	~44	25	~465.87
Concrete for Landfill	WM Fairless			63	~1,415.93
Urban Fill for CVOC Orange Zone (Lot 17)	WM Fairless Urban Fill-OZ			47	~1034
Urban Fill for CVOC Orange Zone (Lot 49)	WM Fairless Urban Fill-OZ			24	~528
Non-Haz Urban Fill (Lot 17)	Clean Earth Carteret			42	~924
Non-Haz Urban Fill (Lot 49)	Clean Earth Carteret			73	~1,606
MGP soil with TCE>25 ppm	Clean Earth ESMI			181	~3,906
	CE Southeast Pennsylvania			8	~176
Non-Haz MGP Impacted (TCLP Benzene > 0.5)	CE Southeast Pennsylvania			8	~237.97
Non-Haz MGP Impacted (TCLP Benzene < 0.5)	CE Southeast Pennsylvania			58	~1,276
Non-Haz Contaminated Urban Fill	WM Fairless	18	~396	323	~6,946.69
Non-Haz Urban Fill	Clean Earth Carteret -BZ	5	~110	45	~967
Non-Haz MGP Impacted	Clean Earth of New Castle			35	~770
MGP Impacted (TCLP Benzene 0.2<x<0.5 mg/l)	CE Southeast Pennsylvania			5	~110

**Exported Material Truck Log**

Number	Excavation Grid	Disposal Facility	Disposal Profile	Manifest Number	Trucking Company	Truck License Plate
1	WC-3(0-5)	WM Fairless	Urban Fill with CVOCs	13270105	V&E	AW259D
2	WC-3(0-5)	WM Fairless	Urban Fill with CVOCs	13270106	V&E	AW641V
3	WC-3(0-5)	WM Fairless	Urban Fill with CVOCs	13270107	Valiant	AY561J
4	WC-3(0-5)	WM Fairless	Urban Fill with CVOCs	13270108	Valiant	AW387K
5	WC-3(0-5)	WM Fairless	Urban Fill with CVOCs	13270109	V&E	AY436A
6	WC-3(0-5)	WM Fairless	Urban Fill with CVOCs	13270110	V&E	AY259E
7	WC-3(0-5)	WM Fairless	Urban Fill with CVOCs	13270111	V&E	AY260E
8	WC-3(0-5)	WM Fairless	Urban Fill with CVOCs	13270112	V&E	AY698R
9	WC-3(0-5)	WM Fairless	Urban Fill with CVOCs	13270113	Logitech	AW690L
10	WC-3(5-10)	WM Fairless	Urban Fill with CVOCs	13270114	Valiant	AY560J
11	WC-3(5-10)	WM Fairless	Urban Fill with CVOCs	13270115	Valiant	AY190P

**DAILY STATUS REPORT**

<b>PROJECT:</b>	Former Fulton MGP – Parcels III and IV (Site No.: 224051)
<b>ADDRESS:</b>	545 Sackett St., Brooklyn, NY
<b>PREPARED BY:</b>	Roux Environmental Engineering and Geology, D.P.C.
<b>DATE:</b>	February 1, 2024
<b>WEATHER:</b>	Temp: 32-45°F, Cloudy, RH: 79% Pressure: 30.05" in Hg Wind: SW @ 8 mph
<b>TIME:</b>	07:00 – 15:30

12	WC-3(5-10)	WM Fairless	Urban Fill with CVOCs	13270116	Valiant	AY912F
13	WC-3(5-10)	WM Fairless	Urban Fill with CVOCs	13270117	Valiant	AY559J
14	WC-3(5-10)	WM Fairless	Urban Fill with CVOCs	13270118	Valiant	AY399C
15	WC-3(5-10)	WM Fairless	Urban Fill with CVOCs	13270119	Valiant	AY191P
16	WC-3(5-10)	WM Fairless	Urban Fill with CVOCs	13270120	Valiant	AY192P
17	WC-3(5-10)	WM Fairless	Urban Fill with CVOCs	13270121	Valiant	AY903C
18	WC-3(5-10)	WM Fairless	Urban Fill with CVOCs	13270122	Valiant	AY189P
19	Concrete	Bayshore	Concrete for Recycling	E0665950	V&E	AW259D
20	Concrete	Bayshore	Concrete for Recycling	E0665951	V&E	AY260E
21	WC-4(0-5)	Clean Earth Carteret	Urban Fill	2624152	V&E	AY698R
22	WC-4(0-5)	Clean Earth Carteret	Urban Fill	2624153	V&E	AW641V
23	WC-4(0-5)	Clean Earth Carteret	Urban Fill	2624154	V&E	AY436A
24	WC-4(0-5)	Clean Earth Carteret	Urban Fill	2624155	V&E	AY259E
25	WC-4(0-5)	Clean Earth Carteret	Urban Fill	2624156	Logitech	AW690L

**Dewatering**

<b>Time</b>	<b>Totalizer Reading</b>
7:00	40,131,200
15:30	40,131,200
Water treated and discharged since last report:	0 gallons

**Anticipated Upcoming Work Activities**

Import of clean fill and backfill completed excavation areas in WC-2 and WC-3. Prepare for future material load out from Gas Holder 3 excavation area.

<b>PROJECT:</b>	Former Fulton MGP – Parcels III and IV (Site No.: 224051)
<b>ADDRESS:</b>	545 Sackett St., Brooklyn, NY
<b>PREPARED BY:</b>	Roux Environmental Engineering and Geology, D.P.C.
<b>DATE:</b>	February 1, 2024
<b>WEATHER:</b>	Temp: 32-45°F, Cloudy, RH: 79% Pressure: 30.05" in Hg Wind: SW @ 8 mph
<b>TIME:</b>	07:00 – 15:30

### Site Layout

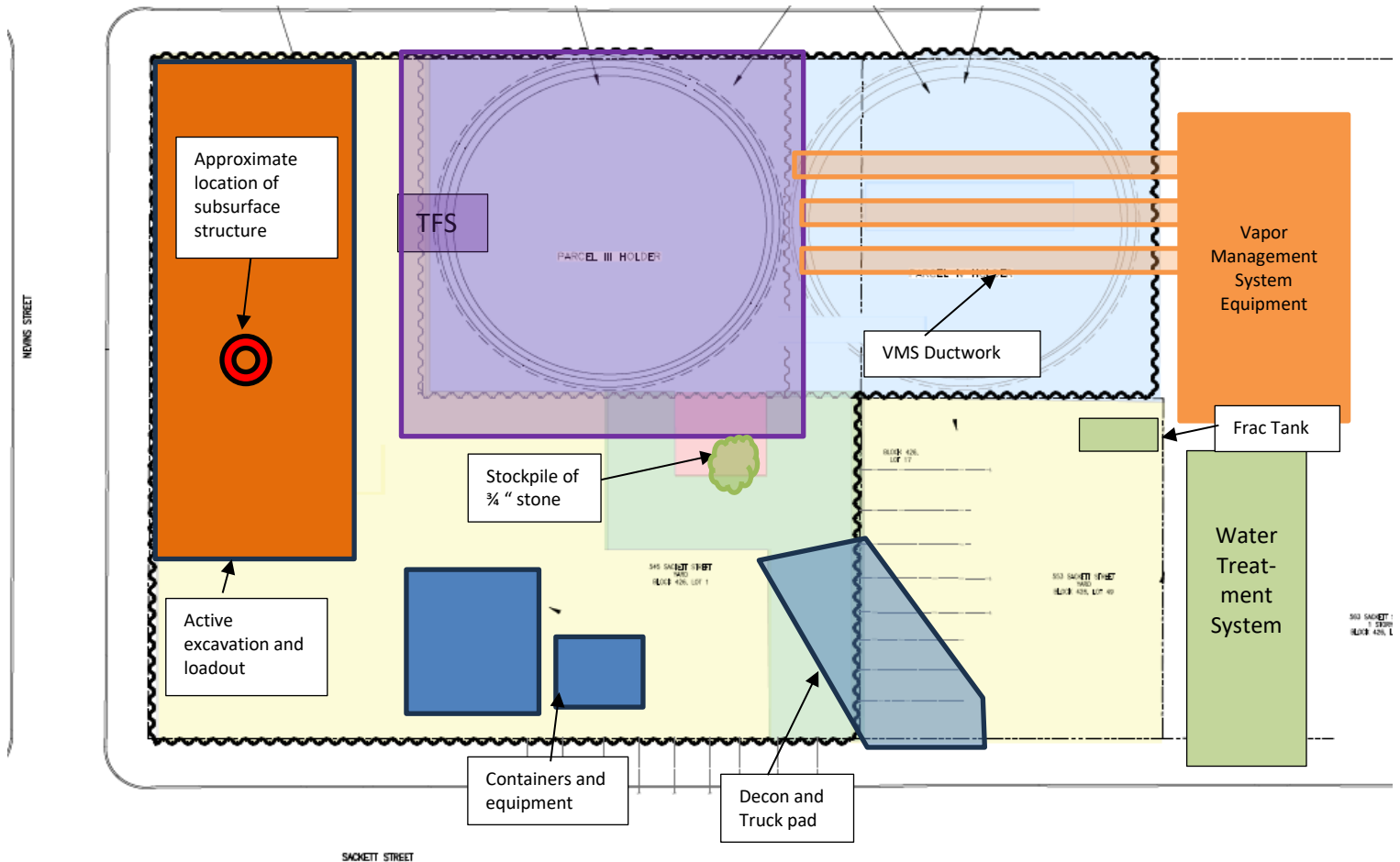

<b>PROJECT:</b>	Former Fulton MGP – Parcels III and IV (Site No.: 224051)
<b>ADDRESS:</b>	545 Sackett St., Brooklyn, NY
<b>PREPARED BY:</b>	Roux Environmental Engineering and Geology, D.P.C.
<b>DATE:</b>	February 1, 2024
<b>WEATHER:</b>	Temp: 32-45°F, Cloudy, RH: 79% Pressure: 30.05" in Hg Wind: SW @ 8 mph
<b>TIME:</b>	07:00 – 15:30

### Excavation Diagram

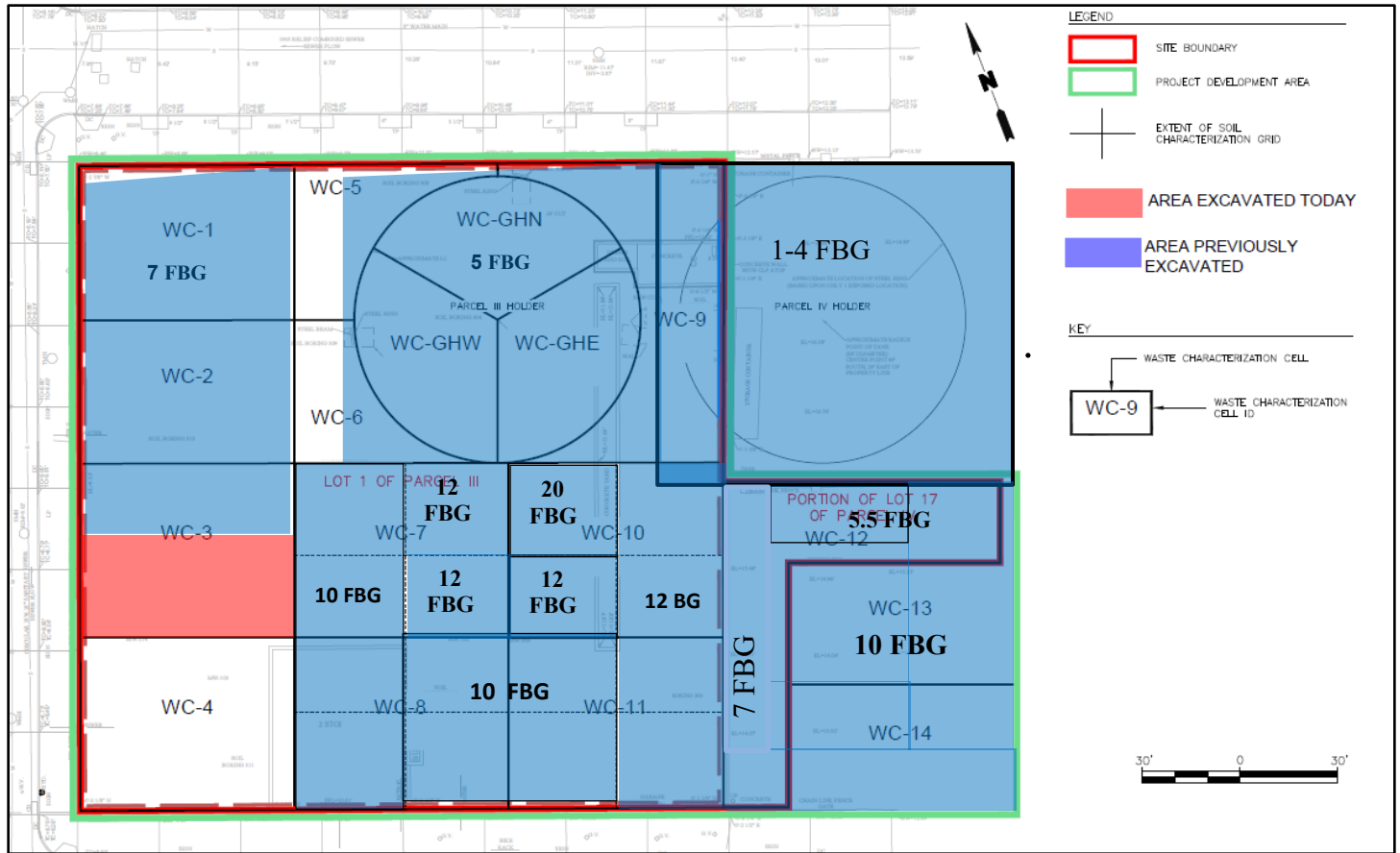



<b>PROJECT:</b>	Former Fulton MGP – Parcels III and IV (Site No.: 224051)
<b>ADDRESS:</b>	545 Sackett St., Brooklyn, NY
<b>PREPARED BY:</b>	Roux Environmental Engineering and Geology, D.P.C.
<b>DATE:</b>	February 1, 2024
<b>WEATHER:</b>	Temp: 32-45°F, Cloudy, RH: 79% Pressure: 30.05" in Hg Wind: SW @ 8 mph
<b>TIME:</b>	07:00 – 15:30



**Photo 1:**

Looking southwest, view of CEI loading out material from waste characterization grid WC-3 (0-5) for disposal at WM Fairless.



**Photo 2:**

Looking west, view of CEI placing 1' cap of clean backfill material in characterization grid WC-2.