

PROJECT:	Former Fulton MGP – Parcels III and IV (Site No.: 224051)
ADDRESS:	545 Sackett St., Brooklyn, NY
PREPARED BY:	Roux Environmental Engineering and Geology, D.P.C.
DATE:	February 26, 2024
WEATHER:	Temp: 32-51°F, Cloudy, RH: 57% Pressure: 30.01" in Hg Wind: S @ 6 mph
TIME:	07:00 – 15:30

Project Team

General Contractor and Subcontractors:

- Mega Contracting Group, LLC (Mega)
- Creamer Environmental, Inc. (CEI)
- ECS Environmental Solutions (ECS)

Engineers and Consultants:

- Roux Environmental Engineering and Geology, D.P.C. (Roux)
- GZA GeoEnvironmental Inc. of New York (GZANY)
- WSP USA (WSP)
-

Remedial Action Work Summary

Work Activities Performed Onsite:

- Excavated and exported material from waste characterization grids WC-7 (0-3), WC-7(3-5), and WC-8 (5-8) for offsite disposal.
- Began full scale dewatering in Gas Holder 3 excavation area.

Contractor Work Performed Onsite:

Creamer Environmental Inc. (CEI) excavated material and loaded out 19 trucks of MGP impacted urban fill from waste characterization grids WC-7 (0-3), WC-7 (3-5) and WC-8 (5-8) for disposal at Chemical Waste Management (CMW) Emelle. ECS Environmental Solutions (ECS) finished installation of the dewatering system in Gas Holder 3 excavation area and began 24-hour operation of the dewatering system inside of Gas Holder 3 excavation area. CEI treated approximately 111,600 gallons of recovered construction wastewater through the water treatment system (WTS) and discharged the treated water to the New York City Department of Environmental Protection (NYCDEP) combined sewer system during onsite working hours.

The vapor management system (VMS) associated with the tension fabric structure (TFS) was operated throughout the day. Dust and odor control measures (wetting, tarping, limiting vehicle speeds, etc.) were performed to ensure there were no impacts to the neighborhood. All truck tires were cleaned before leaving the Site, so that material was not tracked onto the surrounding streets. Exposed soils were covered with Atmos odor suppressing foam and/or poly sheeting as needed during the work and at the end of the day.

Air Monitoring:

- No VOC or dust exceedances were observed from the community air monitoring program (CAMP).
- GZANY to provide a summary report of CAMP activities separately.

Erosion and Sediment Control:

- None.

Sampling Conducted:

- Groundwater samples were collected from sentinel wells SW-01S, SW-01D, SW-02S, SW-02D, SW-03S, SW-03D, SW-05S, SW-05D, SW-07S, and SW-07D to be analyzed for the following parameters:
 - TCL VOCs USEPA 8260,
 - TCL SVOCs USEPA 8270,
 - TCL Pesticides USEPA 8081,
 - TAL Metals USEPA 6020,

PROJECT:	Former Fulton MGP – Parcels III and IV (Site No.: 224051)
ADDRESS:	545 Sackett St., Brooklyn, NY
PREPARED BY:	Roux Environmental Engineering and Geology, D.P.C.
DATE:	February 26, 2024
WEATHER:	Temp: 32-51°F, Cloudy, RH: 57% Pressure: 30.01" in Hg Wind: S @ 6 mph
TIME:	07:00 – 15:30

- TCL PCB USEPA 8082A,
- Hex Chrom USEPA 7196,
- Total Cyanide USEPA 7196, and
- PFAS.

Other Items of Note:

- Construction activities were observed as part of the ongoing combined sewer overflow (CSO) project west of Nevins Street.

Imported Material

Name - Location	Source	During This Reporting Period		Total	
		Loads	Tons	Loads	Tons
Vulcan ASTM #3 (1 ½" Stone)	Vulcan Hamburg Quarry			10	255.36
Vulcan ASTM #57 (3/4" Stone)	Vulcan Hamburg Quarry			5	126.76
Vulcan General Fill	Vulcan Wantage Quarry			680	16,146.26

Exported Material

Material	Facility	During This Reporting Period		Total	
		Loads	Tons	Loads	Tons
TCE Impacted Haz Hot Spots	CWM Emelle			7	161.72
Cd Impacted Haz Material from WC-5	CWM Emelle			3	49.45
Pb Impacted Haz from Parcel IV Hot Spot	CWM Emelle			25	536.72
Cd Impacted Haz Material from WC-5	Clean Earth (CE) NJ			16	397.75
Concrete for Recycling	Bayshore			27	~509.87
Concrete for Landfill	WM Fairless			63	~1,415.93
Urban Fill for CVOC Orange Zone (Lot 17)	WM Fairless Urban Fill-OZ			47	~1034
Urban Fill for CVOC Orange Zone (Lot 49)	WM Fairless Urban Fill-OZ			24	~528
Non-Haz Urban Fill (Lot 17)	CE Carteret			42	~924
Non-Haz Urban Fill (Lot 49)	CE Carteret			73	~1,606
MGP soil with TCE>25 ppm	CE ESMI			181	~3,906
	CE Southeast Pennsylvania			10	~220
	CMW Emelle	19	418	19	~418
Non-Haz MGP Impacted (TCLP Benzene > 0.5)	CE Southeast Pennsylvania			8	~237.97
Non-Haz MGP Impacted (TCLP Benzene < 0.5)	CE Southeast Pennsylvania			109	~2,394
Non-Haz Contaminated Urban Fill	WM Fairless			378	~7,936.69
Non-Haz Urban Fill	CE Carteret -BZ			69	~1,491
Non-Haz MGP Impacted	CE of New Castle			35	~770
MGP Impacted (TCLP Benzene 0.2<x<0.5 mg/l)	CE Southeast Pennsylvania			5	~110

PROJECT:	Former Fulton MGP – Parcels III and IV (Site No.: 224051)
ADDRESS:	545 Sackett St., Brooklyn, NY
PREPARED BY:	Roux Environmental Engineering and Geology, D.P.C.
DATE:	February 26, 2024
WEATHER:	Temp: 32-51°F, Cloudy, RH: 57% Pressure: 30.01" in Hg Wind: S @ 6 mph
TIME:	07:00 – 15:30

Exported Material Truck Log

Number	Excavation Grid	Disposal Facility	Disposal Profile	Manifest Number	Trucking Company	Truck License Plate
1	WC-7(0-3)	CMW Emelle	MGP soil with TCE>25 ppm	00738030 GBF	Harwith	AF28588
2	WC-7(0-3)	CMW Emelle	MGP soil with TCE>25 ppm	00738035 GBF	Harwith	AH32699
3	WC-7(0-3)	CMW Emelle	MGP soil with TCE>25 ppm	00738036 GBF	Harwith	AH31897
4	WC-7(0-3)	CMW Emelle	MGP soil with TCE>25 ppm	00738037 GBF	Harwith	AH15529
5	WC-7(0-3)	CMW Emelle	MGP soil with TCE>25 ppm	00738038 GBF	Harwith	AH65122
6	WC-7(0-3)	CMW Emelle	MGP soil with TCE>25 ppm	00738039 GBF	Harwith	AH15528
7	WC-7(0-3)	CMW Emelle	MGP soil with TCE>25 ppm	00738040 GBF	Harwith	AH15531
8	WC-7(0-3)	CMW Emelle	MGP soil with TCE>25 ppm	00738041 GBF	LV Co	AG62406
9	WC-7(3-5)	CMW Emelle	MGP soil with TCE>25 ppm	00738042 GBF	LV Co	AG66450
10	WC-7(3-5)	CMW Emelle	MGP soil with TCE>25 ppm	00738043 GBF	LV Co	AG36421
11	WC-7(3-5)	CMW Emelle	MGP soil with TCE>25 ppm	00738044 GBF	Harwith	AH32699
12	WC-7(3-5)	CMW Emelle	MGP soil with TCE>25 ppm	00738045 GBF	Harwith	AH31897
13	WC-7(3-5)	CMW Emelle	MGP soil with TCE>25 ppm	00738046 GBF	Harwith	AF28588
14	WC-7(3-5)	CMW Emelle	MGP soil with TCE>25 ppm	00738047 GBF	Harwith	AH65122
15	WC-8(5-8)	CMW Emelle	MGP soil with TCE>25 ppm	00738048 GBF	Harwith	AH15529
16	WC-8(5-8)	CMW Emelle	MGP soil with TCE>25 ppm	00738049 GBF	Harwith	AH15528
17	WC-8(5-8)	CMW Emelle	MGP soil with TCE>25 ppm	00738050 GBF	Harwith	AH15531
18	WC-8(5-8)	CMW Emelle	MGP soil with TCE>25 ppm	00738051 GBF	LV Co	AG62406
19	WC-8(5-8)	CMW Emelle	MGP soil with TCE>25 ppm	00738052 GBF	LV Co	AG66450

Dewatering

Date	Time	Totalizer Reading
2/26/2024	8:25	40,367,300
2/26/2024	9:45	40,355,300
2/26/2024	10:35	40,374,100
2/26/2024	15:10	40,450,100
2/26/2024	16:05	40,478,900
Water treated and discharged to NYCDEP sewer since last report:		111,600 gallons*

Anticipated Upcoming Work Activities

- Resume excavation in Gas Holder 3 excavation area.
- Place one foot thick clean fill cap in waste characterization grid WC-8 and WC-7.
- Continue dewatering in Gas Holder 3 excavation area and operation of water treatment system.

PROJECT:	Former Fulton MGP – Parcels III and IV (Site No.: 224051)
ADDRESS:	545 Sackett St., Brooklyn, NY
PREPARED BY:	Roux Environmental Engineering and Geology, D.P.C.
DATE:	February 26, 2024
WEATHER:	Temp: 32-51°F, Cloudy, RH: 57% Pressure: 30.01" in Hg Wind: S @ 6 mph
TIME:	07:00 – 15:30

Site Layout

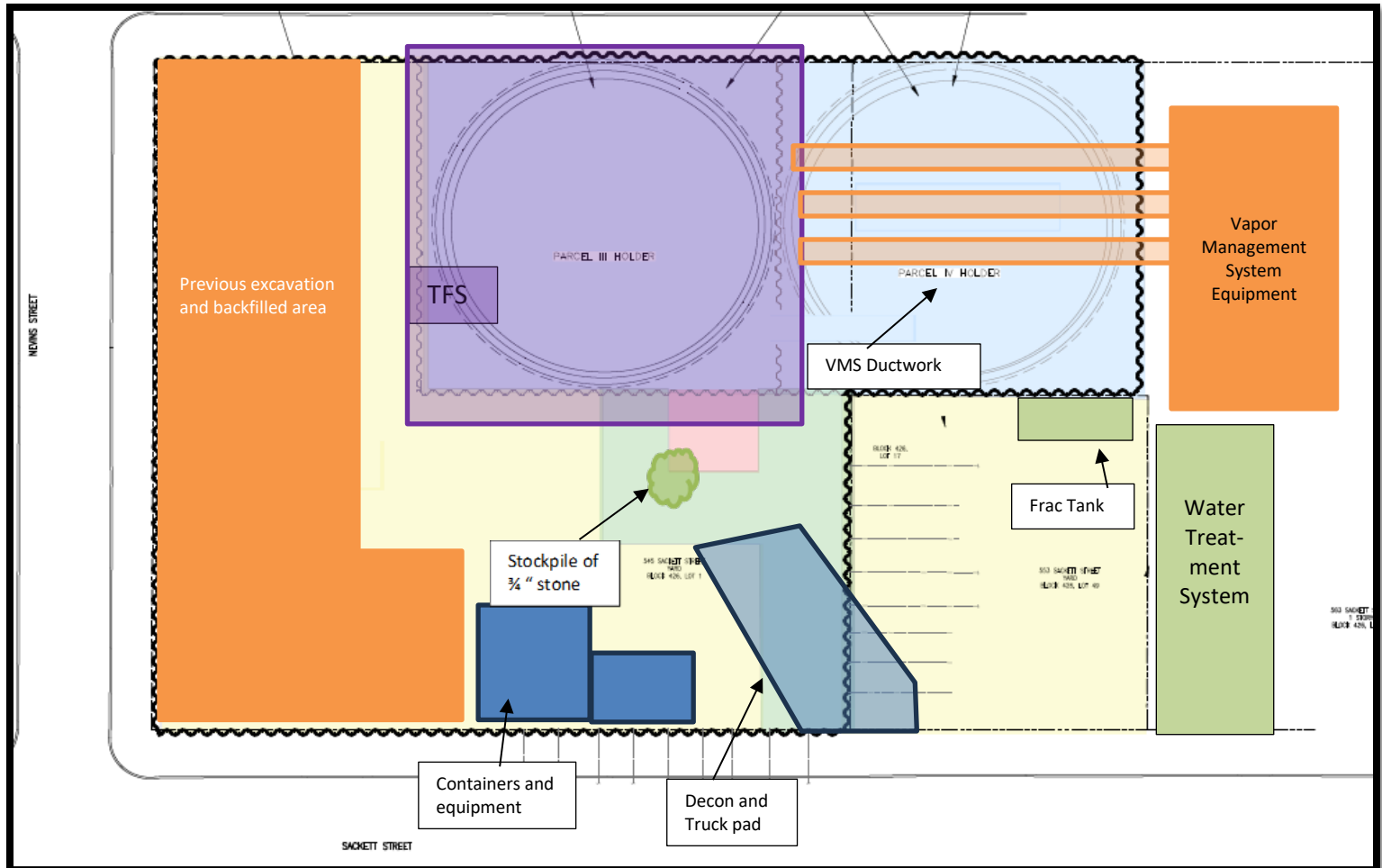

PROJECT:	Former Fulton MGP – Parcels III and IV (Site No.: 224051)
ADDRESS:	545 Sackett St., Brooklyn, NY
PREPARED BY:	Roux Environmental Engineering and Geology, D.P.C.
DATE:	February 26, 2024
WEATHER:	Temp: 32-51°F, Cloudy, RH: 57% Pressure: 30.01" in Hg Wind: S @ 6 mph
TIME:	07:00 – 15:30

Excavation Diagram

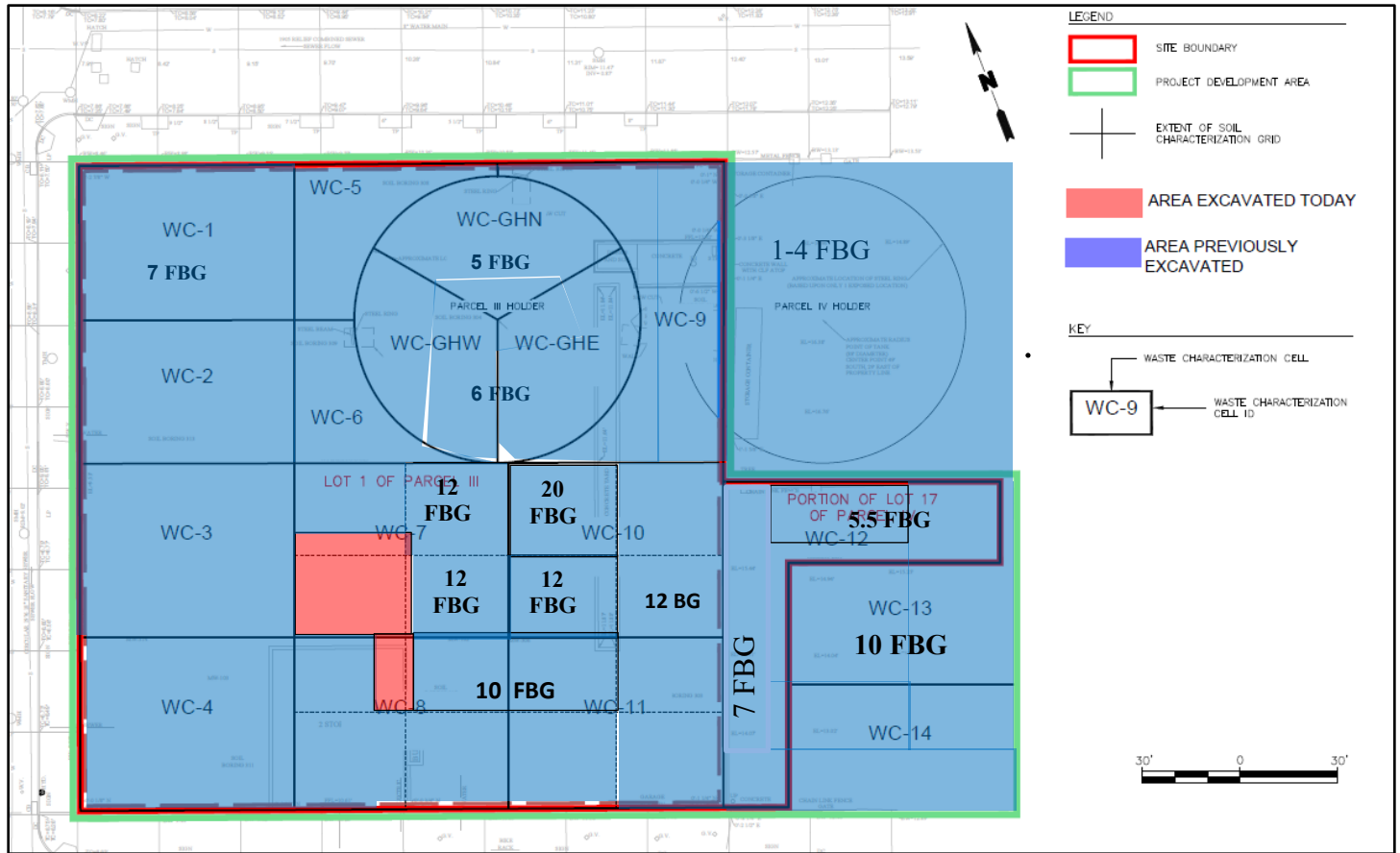

PROJECT:	Former Fulton MGP – Parcels III and IV (Site No.: 224051)
ADDRESS:	545 Sackett St., Brooklyn, NY
PREPARED BY:	Roux Environmental Engineering and Geology, D.P.C.
DATE:	February 26, 2024
WEATHER:	Temp: 32-51°F, Cloudy, RH: 57% Pressure: 30.01" in Hg Wind: S @ 6 mph
TIME:	07:00 – 15:30



Photo 1:

Looking northwest, view of CEI excavating and loading a truck from WC-GH7 (3-5) for offsite disposal.



Photo 2:

View of Roux collecting groundwater samples from sentinel well SW-03D.