

<b>PROJECT:</b>	Former Fulton MGP – Parcels III and IV (Site No.: 224051)
<b>ADDRESS:</b>	545 Sackett St., Brooklyn, NY
<b>PREPARED BY:</b>	Roux Environmental Engineering and Geology, D.P.C.
<b>DATE:</b>	February 28, 2024
<b>WEATHER:</b>	Temp: 40-60°F, Rain, RH: 96% Pressure: 29.61" in Hg Wind: S @ 14 mph
<b>TIME:</b>	07:00 – 15:30

**Project Team**General Contractor and Subcontractors:

- Mega Contracting Group, LLC (Mega)
- Creamer Environmental, Inc. (CEI)
- ECS Environmental Solutions (ECS)

Engineers and Consultants:

- Roux Environmental Engineering and Geology, D.P.C. (Roux)
- GZA GeoEnvironmental Inc. of New York (GZANY)
- WSP USA (WSP)
- Mueser Rutledge Consulting Engineers (MCRE)

**Remedial Action Work Summary**Work Activities Performed Onsite:

- Import general fill material for 1 foot thick of cap in waste characterization grids WC-7 and WC-8.
- Continue dewatering operations in Gas Holder 3 excavation area.
- Excavation and prep for future load out of material Gas Holder 3 excavation area.

Contractor Work Performed Onsite:

Creamer Environmental Inc. (CEI) imported 20 trucks of clean general fill from Vulcan, Wantage Quarry for one-foot-thick cap in waste characterization grids WC-7 and WC-8 where excavation activities have been completed. CEI began breaking concrete and staging material for loadout inside of Gas Holder 3.

ECS Environmental Solutions (ECS) continued 24-hour operation of the dewatering system inside of Gas Holder 3 excavation area. Since the last reporting period, CEI treated approximately 508,400 gallons of recovered construction wastewater through the water treatment system (WTS) and discharged the treated water to the New York City Department of Environmental Protection (NYCDEP) combined sewer system. A representative from Mueser Rutledge Consulting Engineers (MCRE) was onsite to inspect dewatering operations.

The vapor management system (VMS) associated with the tension fabric structure (TFS) was operated throughout the day. CEI added fabric to cargo door of the TFS to improve seal above the trucks during loadout activities. Dust and odor control measures (wetting, tarping, limiting vehicle speeds, etc.) were performed to ensure there were no impacts to the neighborhood. All truck tires were cleaned before leaving the Site, so that material was not tracked onto the surrounding streets. While working in Gas Holder 3 excavation area, boulder sized pieces of concrete were encountered 10 to 13 feet below grade along with oil impacted water that will be characterized and disposed of offsite. Exposed soils were covered with Atmos odor suppressing foam and/or poly sheeting as needed during the work and at the end of the day.

Air Monitoring:

- No VOC or dust exceedances were observed from the community air monitoring program (CAMP).
- GZANY to provide a summary report of CAMP activities separately.

Erosion and Sediment Control:

- None.



## DAILY STATUS REPORT

<b>PROJECT:</b>	Former Fulton MGP – Parcels III and IV (Site No.: 224051)
<b>ADDRESS:</b>	545 Sackett St., Brooklyn, NY
<b>PREPARED BY:</b>	Roux Environmental Engineering and Geology, D.P.C.
<b>DATE:</b>	February 28, 2024
<b>WEATHER:</b>	Temp: 40-60°F, Rain, RH: 96% Pressure: 29.61" in Hg Wind: S @ 14 mph
<b>TIME:</b>	07:00 – 15:30

### Sampling Conducted:

- None.

### Other Items of Note:

- Construction activities were observed as part of the ongoing combined sewer overflow (CSO) project west of Nevins Street.

### Imported Material

Name - Location	Source	During This Reporting Period		Total	
		Loads	Tons	Loads	Tons
Vulcan ASTM #3 (1 ½" Stone)	Vulcan Hamburg Quarry			10	255.36
Vulcan ASTM #57 (3/4" Stone)	Vulcan Hamburg Quarry			5	126.76
Vulcan General Fill	Vulcan Wantage Quarry	20	497.56	700	17,643.82

### Exported Material

Material	Facility	During This Reporting Period		Total	
		Loads	Tons	Loads	Tons
TCE Impacted Haz Hot Spots	CWM Emelle			7	161.72
Cd Impacted Haz Material from WC-5	CWM Emelle			3	49.45
Pb Impacted Haz from Parcel IV Hot Spot	CWM Emelle			25	536.72
Cd Impacted Haz Material from WC-5	Clean Earth (CE) NJ			16	397.75
Concrete for Recycling	Bayshore			27	~509.87
Concrete for Landfill	WM Fairless			63	~1,415.93
Urban Fill for CVOC Orange Zone (Lot 17)	WM Fairless Urban Fill-OZ			47	~1034
Urban Fill for CVOC Orange Zone (Lot 49)	WM Fairless Urban Fill-OZ			24	~528
Non-Haz Urban Fill (Lot 17)	CE Carteret			42	~924
Non-Haz Urban Fill (Lot 49)	CE Carteret			73	~1,606
MGP soil with TCE>25 ppm	CE ESMI			181	~3,906
	CE Southeast Pennsylvania			10	~220
	CMW Emelle			20	~440
Non-Haz MGP Impacted (TCLP Benzene > 0.5)	CE Southeast Pennsylvania			8	~237.97
Non-Haz MGP Impacted (TCLP Benzene < 0.5)	CE Southeast Pennsylvania			109	~2,394
Non-Haz Contaminated Urban Fill	WM Fairless			383	~8,046.69
Non-Haz Urban Fill	CE Carteret -BZ			69	~1,491
Non-Haz MGP Impacted	CE of New Castle			35	~770
MGP Impacted (TCLP Benzene 0.2<x<0.5 mg/l)	CE Southeast Pennsylvania			5	~110

### Exported Material Truck Log

Number	Excavation Grid	Disposal Facility	Disposal Profile	Manifest Number	Trucking Company	Truck License Plate

**DAILY STATUS REPORT**

<b>PROJECT:</b>	Former Fulton MGP – Parcels III and IV (Site No.: 224051)
<b>ADDRESS:</b>	545 Sackett St., Brooklyn, NY
<b>PREPARED BY:</b>	Roux Environmental Engineering and Geology, D.P.C.
<b>DATE:</b>	February 28, 2024
<b>WEATHER:</b>	Temp: 40-60°F, Rain, RH: 96% Pressure: 29.61" in Hg Wind: S @ 14 mph
<b>TIME:</b>	07:00 – 15:30

**Dewatering**

<b>Date</b>	<b>Time</b>	<b>Totalizer Reading</b>
2/27/2024	15:10	41,015,700
2/28/2024	7:10	41,381,800
2/28/2024	8:55	41,422,200
2/28/2024	13:10	41,487,700
2/28/2024	15:00	41,524,100
<b>Water treated and discharged to NYCDEP sewer since last report:</b>		<b>508,400 gallons</b>

**Anticipated Upcoming Work Activities**

- Continue excavation and load out in Gas Holder 3 excavation area.
- Continue dewatering in Gas Holder 3 excavation area and operation of water treatment system.

<b>PROJECT:</b>	Former Fulton MGP – Parcels III and IV (Site No.: 224051)
<b>ADDRESS:</b>	545 Sackett St., Brooklyn, NY
<b>PREPARED BY:</b>	Roux Environmental Engineering and Geology, D.P.C.
<b>DATE:</b>	February 28, 2024
<b>WEATHER:</b>	Temp: 40-60°F, Rain, RH: 96% Pressure: 29.61" in Hg Wind: S @ 14 mph
<b>TIME:</b>	07:00 – 15:30

### Site Layout

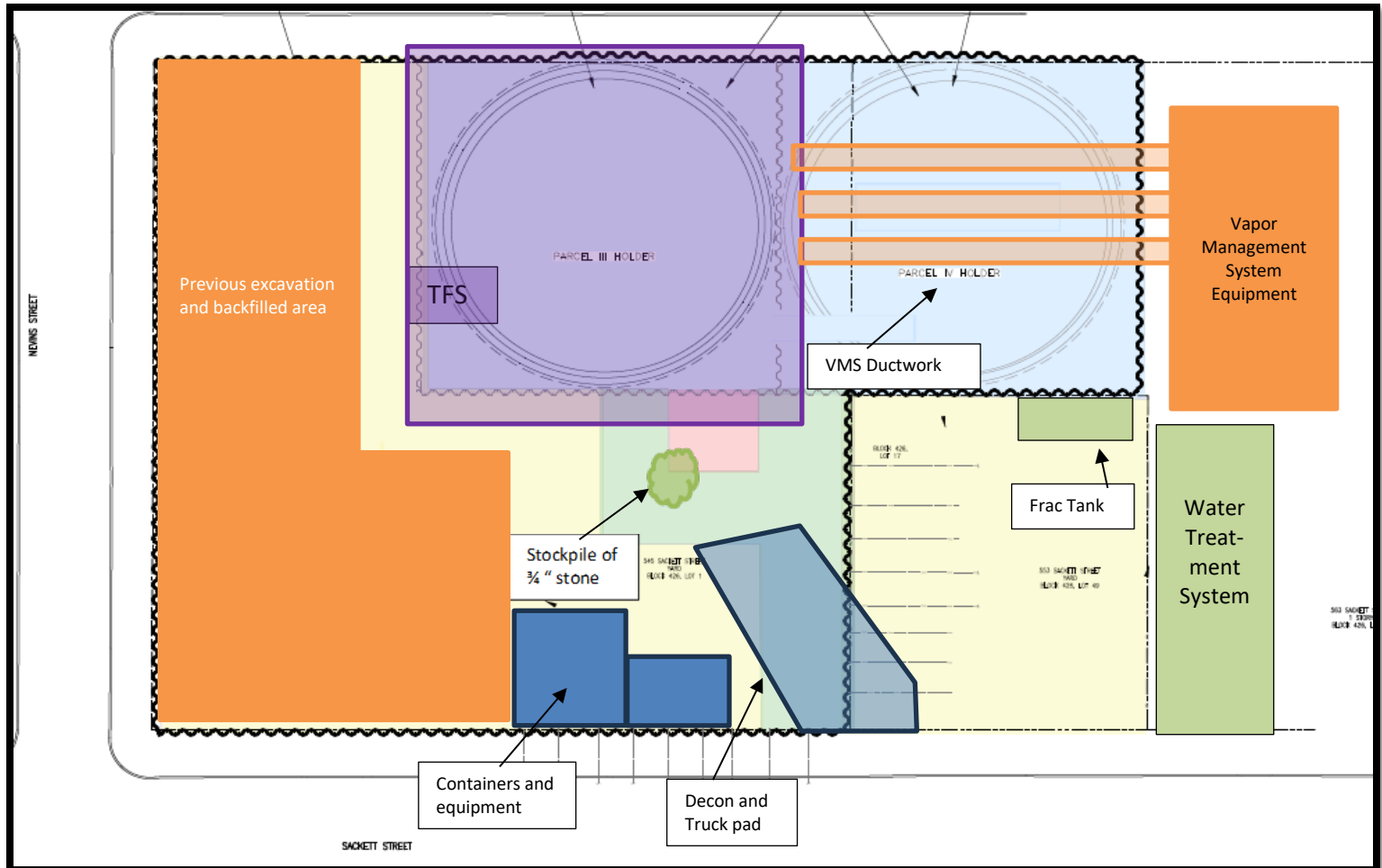

<b>PROJECT:</b>	Former Fulton MGP – Parcels III and IV (Site No.: 224051)
<b>ADDRESS:</b>	545 Sackett St., Brooklyn, NY
<b>PREPARED BY:</b>	Roux Environmental Engineering and Geology, D.P.C.
<b>DATE:</b>	February 28, 2024
<b>WEATHER:</b>	Temp: 40-60°F, Rain, RH: 96% Pressure: 29.61" in Hg Wind: S @ 14 mph
<b>TIME:</b>	07:00 – 15:30

### Excavation Diagram

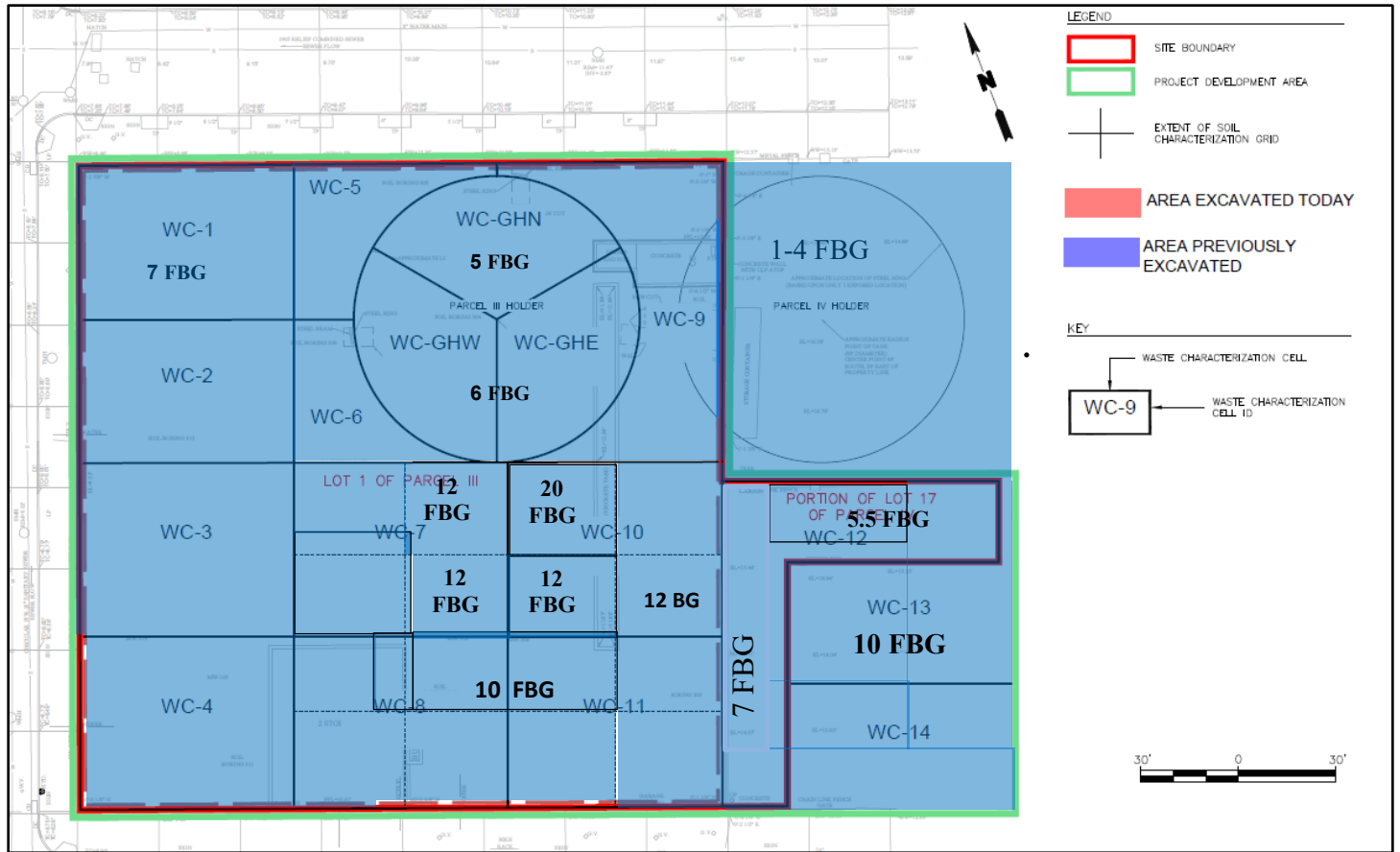



<b>PROJECT:</b>	Former Fulton MGP – Parcels III and IV (Site No.: 224051)
<b>ADDRESS:</b>	545 Sackett St., Brooklyn, NY
<b>PREPARED BY:</b>	Roux Environmental Engineering and Geology, D.P.C.
<b>DATE:</b>	February 28, 2024
<b>WEATHER:</b>	Temp: 40-60°F, Rain, RH: 96% Pressure: 29.61" in Hg Wind: S @ 14 mph
<b>TIME:</b>	07:00 – 15:30



**Photo 1:**

Looking south, view of CEI importing general fill in waste characterization grid WC-7.



**Photo 2:**

Looking north, view of CEI placing general fill in waste characterization grids WC-7 and WC-8 to install one foot thick cap.