

<b>PROJECT:</b>	Former Fulton MGP – Parcels III and IV (Site No.: 224051)
<b>ADDRESS:</b>	545 Sackett St., Brooklyn, NY
<b>PREPARED BY:</b>	Roux Environmental Engineering and Geology, D.P.C.
<b>DATE:</b>	March 14, 2024
<b>WEATHER:</b>	Temp: 43-68°F, Cloudy, RH: 61% Pressure: 30.07" in Hg Wind: NNW @ 2 mph
<b>TIME:</b>	07:00 – 15:30

### Project Team

#### General Contractor and Subcontractors:

- Mega Contracting Group, LLC (Mega)
- Creamer Environmental, Inc. (CEI)
- ECS Environmental Solutions (ECS)

#### Engineers and Consultants:

- Roux Environmental Engineering and Geology, D.P.C. (Roux)
- GZA GeoEnvironmental Inc. of New York (GZANY)
- WSP USA (WSP)

### Remedial Action Work Summary

#### Work Activities Performed Onsite:

- Excavation and loadout of material from waste characterization grids WC-GHN (6-13) for offsite disposal at Chemical Waste Management (CMW) Emelle.
- Excavation and prep for future loadout of material from Gas Holder 3 excavation area.
- Continue dewatering operations for Gas Holder 3 excavation area.

#### Contractor Work Performed Onsite:

Creamer Environmental Inc. (CEI) excavated material and loaded out 10 trucks of MGP impacted material with TCE >25 ppm from waste characterization grid WC-GHN (6-13) for disposal at Chemical Waste Management (CMW) Emelle. CEI continued reducing in size concrete and brick sections from both the former Gas Holder 3 foundation and backfilled material found inside the gas holder foundation. This material was stabilized and staged for future loadout.

ECS Environmental Solutions (ECS) continued 24-hour operation of the dewatering system for the Gas Holder 3 excavation area. Since the last reporting period, CEI treated approximately 891,100 gallons of recovered construction wastewater through the water treatment system (WTS) and discharged the treated water to the New York City Department of Environmental Protection (NYCDEP) combined sewer system.

The vapor management system (VMS) associated with the tension fabric structure (TFS) was operated throughout the day. Other dust and odor control measures (wetting, tarping, limiting vehicle speeds, covering trucks inside TFS, spraying loaded material with odor suppressant, etc.) continued to be performed to ensure there were no impacts to the neighborhood. All truck tires were cleaned before leaving the Site, so that material was not tracked onto the surrounding streets. Exposed soils were covered with Atmos odor suppressing foam during the work and at the end of the day. Aaron Fischer of NYSDEC visited the Site today.

#### Air Monitoring:

- No VOC or dust exceedances were observed from the community air monitoring program (CAMP).
- GZANY to provide a summary report of CAMP activities separately.

#### Erosion and Sediment Control:

- Weekly SWPPP inspection was performed.

#### Sampling Conducted:

- None.

<b>PROJECT:</b>	Former Fulton MGP – Parcels III and IV (Site No.: 224051)
<b>ADDRESS:</b>	545 Sackett St., Brooklyn, NY
<b>PREPARED BY:</b>	Roux Environmental Engineering and Geology, D.P.C.
<b>DATE:</b>	March 14, 2024
<b>WEATHER:</b>	Temp: 43-68°F, Cloudy, RH: 61% Pressure: 30.07" in Hg Wind: NNW @ 2 mph
<b>TIME:</b>	07:00 – 15:30

**Other Items of Note:**

- Construction activities were observed as part of the ongoing combined sewer overflow (CSO) project west of Nevins Street.

**Imported Material**

Name - Location	Source	During This Reporting Period		Total	
		Loads	Tons	Loads	Tons
Vulcan ASTM #3 (1 ½" Stone)	Vulcan Hamburg Quarry			11	279.71
Vulcan ASTM #57 (3/4" Stone)	Vulcan Hamburg Quarry			5	126.76
Vulcan General Fill	Vulcan Wantage Quarry			720	18,150.88

**Exported Material**

Material	Facility	During This Reporting Period		Total	
		Loads	Tons	Loads	Tons
TCE Impacted Haz Hot Spots	CWM Emelle			7	161.72
Cd Impacted Haz Material from WC-5	CWM Emelle			3	49.45
Pb Impacted Haz from Parcel IV Hot Spot	CWM Emelle			25	536.72
Cd Impacted Haz Material from WC-5	Clean Earth (CE) NJ			16	397.75
Concrete for Recycling	Bayshore			27	~509.87
Concrete for Landfill	WM Fairless			63	~1,415.93
Urban Fill for CVOC Orange Zone (Lot 17)	WM Fairless Urban Fill-OZ			47	~1034
Urban Fill for CVOC Orange Zone (Lot 49)	WM Fairless Urban Fill-OZ			24	~528
Non-Haz Urban Fill (Lot 17)	CE Carteret			42	~924
Non-Haz Urban Fill (Lot 49)	CE Carteret			73	~1,606
MGP soil with TCE>25 ppm	CE ESMI			181	~3,906
	CE Southeast Pennsylvania			10	~220
	CMW Emelle	10	200	105	~2,100
Non-Haz MGP Impacted (TCLP Benzene > 0.5)	CE Southeast Pennsylvania			8	~237.97
Non-Haz MGP Impacted (TCLP Benzene < 0.5)	CE Southeast Pennsylvania			109	~2,394
Non-Haz Contaminated Urban Fill	WM Fairless			383	~8,046.69
Non-Haz Urban Fill	CE Carteret -BZ			69	~1,491
Non-Haz MGP Impacted	CE of New Castle			35	~770
MGP Impacted (TCLP Benzene 0.2<x<0.5 mg/l)	CE Southeast Pennsylvania			5	~110

**Exported Material Truck Log**

Number	Excavation Grid	Disposal Facility	Disposal Profile	Manifest4 Number5	Trucking Company	Truck License Plate
1	WC-GHN(6-13)	CWM Emelle	MGP soil with TCE>25 ppm	007411816 GBF	Horwith	AH15527
2	WC-GHN(6-13)	CWM Emelle	MGP soil with TCE>25 ppm	007411817 GBF	Horwith	AH32699
3	WC-GHN(6-13)	CWM Emelle	MGP soil with TCE>25 ppm	007411818 GBF	Horwith	AH31897
4	WC-GHN(6-13)	CWM Emelle	MGP soil with TCE>25 ppm	007411819 GBF	Horwith	AH65122
5	WC-GHN(6-13)	CWM Emelle	MGP soil with TCE>25 ppm	007411820 GBF	Horwith	AH15527

**DAILY STATUS REPORT**

<b>PROJECT:</b>	Former Fulton MGP – Parcels III and IV (Site No.: 224051)
<b>ADDRESS:</b>	545 Sackett St., Brooklyn, NY
<b>PREPARED BY:</b>	Roux Environmental Engineering and Geology, D.P.C.
<b>DATE:</b>	March 14, 2024
<b>WEATHER:</b>	Temp: 43-68°F, Cloudy, RH: 61% Pressure: 30.07" in Hg Wind: NNW @ 2 mph
<b>TIME:</b>	07:00 – 15:30

**Exported Material Truck Log (con't)**

6	WC-GHN(6-13)	CWM Emelle	MGP soil with TCE>25 ppm	007411821 GBF	Horwith	AH15527
7	WC-GHN(6-13)	CWM Emelle	MGP soil with TCE>25 ppm	007411822 GBF	Horwith	AH32699
8	WC-GHN(6-13)	CWM Emelle	MGP soil with TCE>25 ppm	007411823 GBF	Horwith	AH31897
9	WC-GHN(6-13)	CWM Emelle	MGP soil with TCE>25 ppm	007411824 GBF	Horwith	AH65122
10	WC-GHN(6-13)	CWM Emelle	MGP soil with TCE>25 ppm	007411825 GBF	Horwith	AH15527

**Dewatering**

Date	Time	Totalizer Reading
3/12/2024	15:00	50,915,200
3/13/2024	7:15	51,527,500
3/13/2024	12:05	51,628,400
3/13/2024	14:55	51,806,300
Water treated and discharged to NYCDEP sewer since last report:		891,100 gallons

**Anticipated Upcoming Work Activities**

- Continue excavation and load out in Gas Holder 3 excavation area.
- Continue dewatering for Gas Holder 3 excavation area and operation of water treatment system.

<b>PROJECT:</b>	Former Fulton MGP – Parcels III and IV (Site No.: 224051)
<b>ADDRESS:</b>	545 Sackett St., Brooklyn, NY
<b>PREPARED BY:</b>	Roux Environmental Engineering and Geology, D.P.C.
<b>DATE:</b>	March 14, 2024
<b>WEATHER:</b>	Temp: 43-68°F, Cloudy, RH: 61% Pressure: 30.07" in Hg Wind: NNW @ 2 mph
<b>TIME:</b>	07:00 – 15:30

### Site Layout

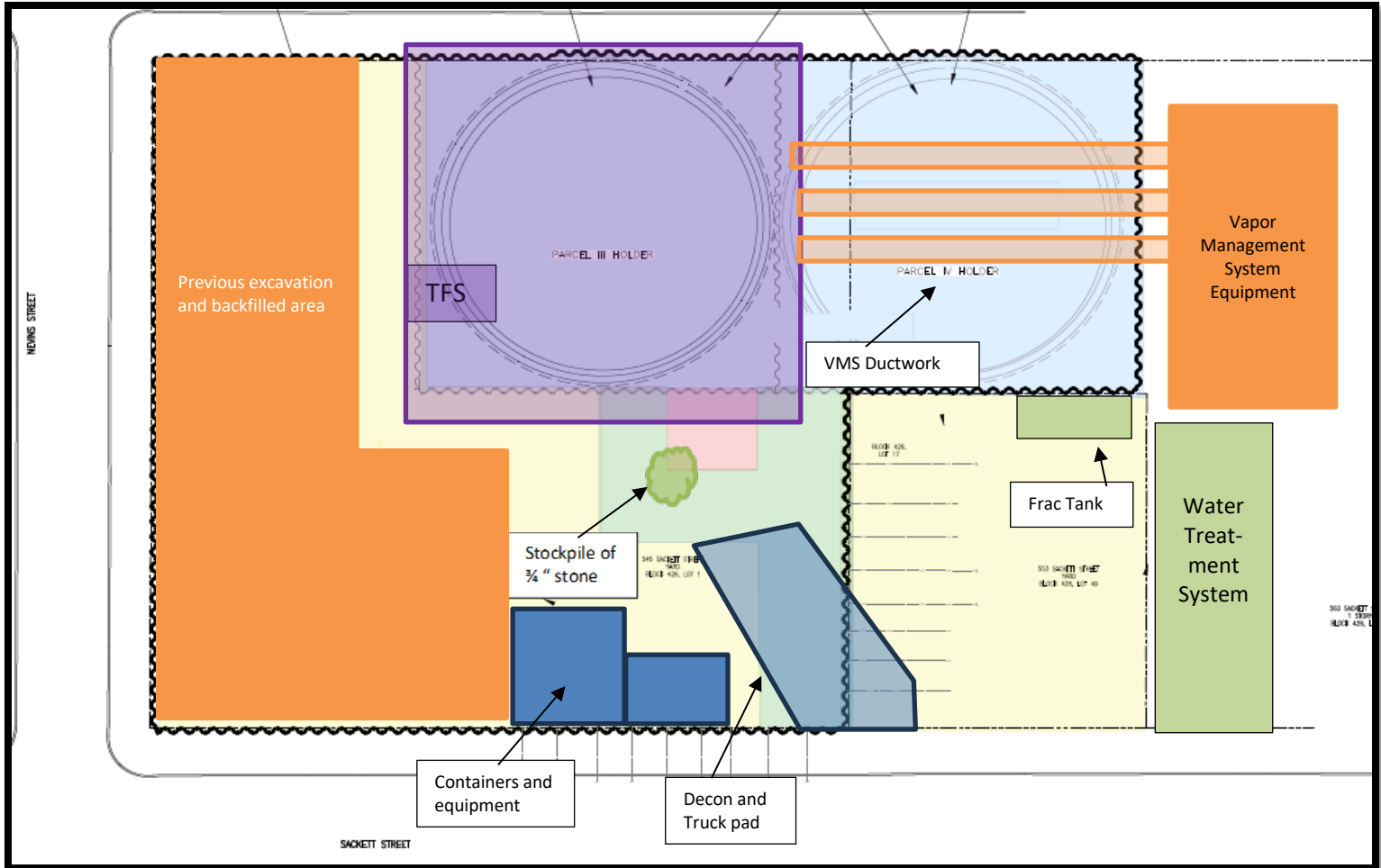

<b>PROJECT:</b>	Former Fulton MGP – Parcels III and IV (Site No.: 224051)
<b>ADDRESS:</b>	545 Sackett St., Brooklyn, NY
<b>PREPARED BY:</b>	Roux Environmental Engineering and Geology, D.P.C.
<b>DATE:</b>	March 14, 2024
<b>WEATHER:</b>	Temp: 43-68°F, Cloudy, RH: 61% Pressure: 30.07" in Hg Wind: NNW @ 2 mph
<b>TIME:</b>	07:00 – 15:30

### Excavation Diagram

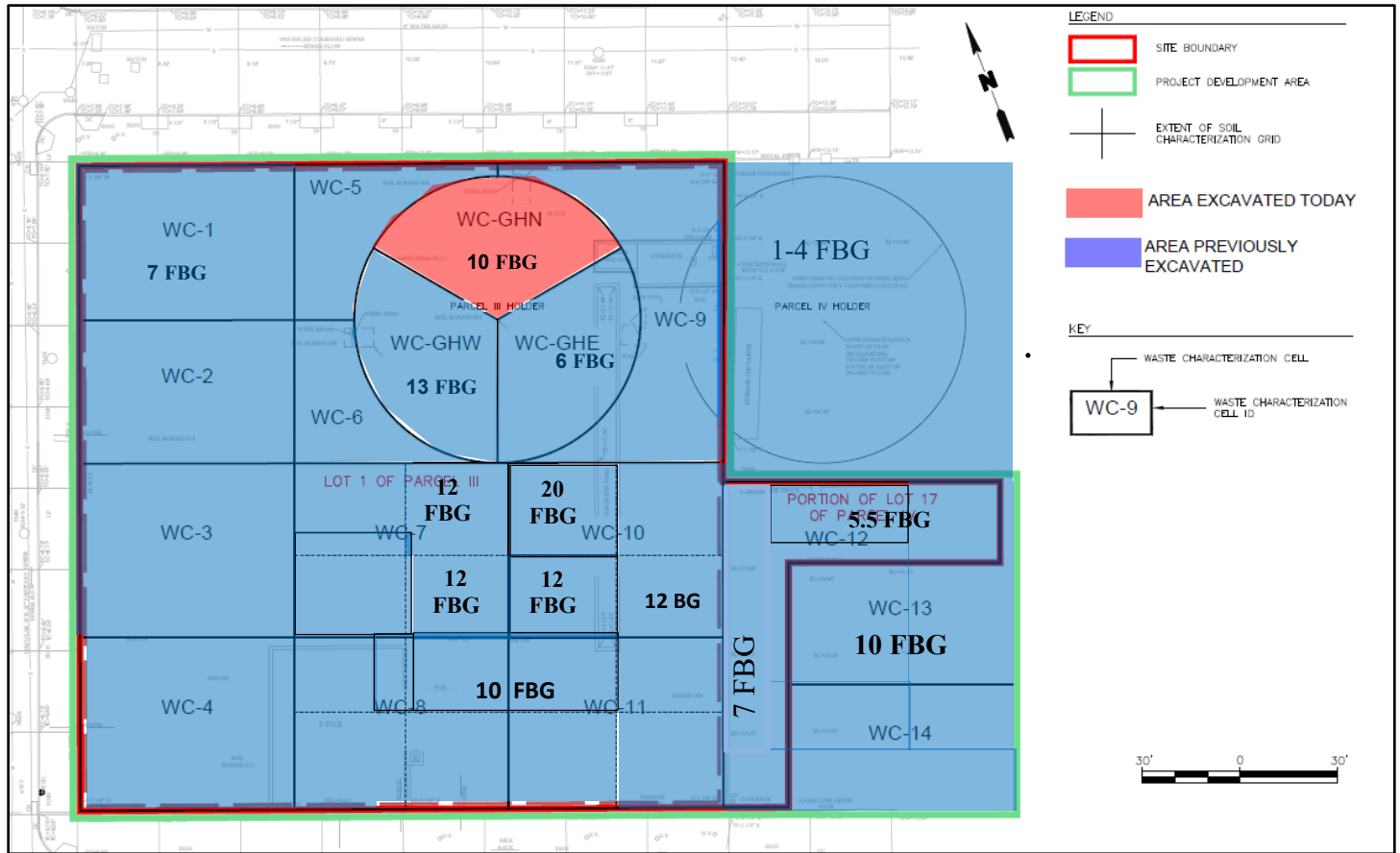



<b>PROJECT:</b>	Former Fulton MGP – Parcels III and IV (Site No.: 224051)
<b>ADDRESS:</b>	545 Sackett St., Brooklyn, NY
<b>PREPARED BY:</b>	Roux Environmental Engineering and Geology, D.P.C.
<b>DATE:</b>	March 14, 2024
<b>WEATHER:</b>	Temp: 43-68°F, Cloudy, RH: 61% Pressure: 30.07" in Hg Wind: NNW @ 2 mph
<b>TIME:</b>	07:00 – 15:30



**Photo 1:**

Looking west, CEI loading a truck with material from Gas Holder 3.



**Photo 2:**

Looking east, view of CEI securing opaque tarp to the top of the truck after loading with impacted material for offsite transport.