

PROJECT:	Former Fulton MGP – Parcels III and IV (Site No.: 224051)
ADDRESS:	545 Sackett St., Brooklyn, NY
PREPARED BY:	Roux Environmental Engineering and Geology, D.P.C.
DATE:	April 1, 2024
WEATHER:	Temp: 47-55°F, Cloudy/Rain, RH: 66% Pressure: 29.99" in Hg Wind: ENE @ 5 mph
TIME:	07:00 – 15:30

Project Team

General Contractor and Subcontractors:

- Mega Contracting Group, LLC (Mega)
- Creamer Environmental, Inc. (CEI)
- Earth Construction Services, LLC (ECS)

Engineers and Consultants:

- Roux Environmental Engineering and Geology, D.P.C. (Roux)
- GZA GeoEnvironmental Inc. of New York (GZANY)
- WSP USA (WSP)

Remedial Action Work Summary

Work Activities Performed Onsite:

- Excavation and loadout of material from waste characterization grids WC-5 (10-15) and WC-9 (10-15) for offsite disposal at Chemical Waste Management (CMW) Emelle.
- Excavation and prep for future loadout of material from Gas Holder 3 excavation area.
- Continue dewatering operations for Gas Holder 3 excavation area.

Contractor Work Performed Onsite:

Creamer Environmental Inc. (CEI) excavated material and loaded out ten (10) trucks of MGP impacted material with TCE >25 ppm from waste characterization grids WC-5 (10-15) and WC-9 (10-15) for disposal at Chemical Waste Management (CMW) Emelle. CEI continued reducing oversized material from both the former Gas Holder 3 foundation and backfilled material found inside the gas holder foundation. This material was stabilized and staged for future loadout.

Earth Construction Services, LLC (ECS) continued 24-hour operation of the dewatering system for the Gas Holder 3 excavation area. Since the last reporting period, CEI treated approximately 940,700 gallons of recovered construction wastewater through the water treatment system (WTS) and discharged the treated water to the New York City Department of Environmental Protection (NYCDEP) combined sewer system.

The vapor management system (VMS) associated with the tension fabric structure (TFS) was operated throughout the day. Other dust and odor control measures (wetting, tarping, limiting vehicle speeds, covering trucks inside TFS, spraying loaded material with odor suppressant, etc.) continued to be performed to ensure there were no impacts to the neighborhood. All truck tires were cleaned before leaving the Site, so that material was not tracked onto the surrounding streets. Exposed soils were covered with Atmos odor suppressing foam during the work and at the end of the day.

Air Monitoring:

- No VOC or dust exceedances were observed from the community air monitoring program (CAMP).
- GZANY to provide a summary report of CAMP activities separately.

Erosion and Sediment Control:

- None.

Sampling Conducted:

- None.

PROJECT:	Former Fulton MGP – Parcels III and IV (Site No.: 224051)
ADDRESS:	545 Sackett St., Brooklyn, NY
PREPARED BY:	Roux Environmental Engineering and Geology, D.P.C.
DATE:	April 1, 2024
WEATHER:	Temp: 47-55°F, Cloudy/Rain, RH: 66% Pressure: 29.99" in Hg Wind: ENE @ 5 mph
TIME:	07:00 – 15:30

Other Items of Note:

- Construction activities were observed as part of the ongoing combined sewer overflow (CSO) project west of Nevins Street.

Imported Material

Name - Location	Source	During This Reporting Period		Total	
		Loads	Tons	Loads	Tons
Vulcan ASTM #3 (1 ½" Stone)	Vulcan Hamburg Quarry			11	279.71
Vulcan ASTM #57 (3/4" Stone)	Vulcan Hamburg Quarry			5	126.76
Vulcan General Fill	Vulcan Wantage Quarry			720	18,150.88

Exported Material

Material	Facility	During This Reporting Period		Total	
		Loads	Tons	Loads	Tons
TCE Impacted Haz Hot Spots	CWM Emelle			7	161.72
Cd Impacted Haz Material from WC-5	CWM Emelle			3	49.45
Pb Impacted Haz from Parcel IV Hot Spot	CWM Emelle			25	536.72
Cd Impacted Haz Material from WC-5	Clean Earth (CE) NJ			16	397.75
Concrete for Recycling	Bayshore			27	~509.87
Concrete for Landfill	WM Fairless			63	~1,415.93
Urban Fill for CVOC Orange Zone (Lot 17)	WM Fairless Urban Fill-OZ			47	~1034
Urban Fill for CVOC Orange Zone (Lot 49)	WM Fairless Urban Fill-OZ			24	~528
Non-Haz Urban Fill (Lot 17)	CE Carteret			42	~924
Non-Haz Urban Fill (Lot 49)	CE Carteret			73	~1,606
MGP soil with TCE>25 ppm	CE ESMI			181	~3,906
	CE Southeast Pennsylvania			10	~220
	CMW Emelle	10	200	195	~3,900
Non-Haz MGP Impacted (TCLP Benzene > 0.5)	CE Southeast Pennsylvania			8	~237.97
Non-Haz MGP Impacted (TCLP Benzene < 0.5)	CE Southeast Pennsylvania			112	~2,460
Non-Haz Contaminated Urban Fill	WM Fairless			387	~8,134.69
Non-Haz Urban Fill	CE Carteret -BZ			69	~1,491
Non-Haz MGP Impacted	CE of New Castle			35	~770
MGP Impacted (TCLP Benzene 0.2<x<0.5 mg/l)	CE Southeast Pennsylvania			5	~110

Exported Material Truck Log

Number	Excavation Grid	Disposal Facility	Disposal Profile	Manifest Number	Trucking Company	Truck License Plate
1	WC-5 (10-15)	CWM Emelle	MGP soil with TCE>25 ppm	007411907 GBF	Horwith	AH32629
2	WC-5 (10-15)	CWM Emelle	MGP soil with TCE>25 ppm	007411908 GBF	Horwith	AH31897
3	WC-5 (10-15)	CWM Emelle	MGP soil with TCE>25 ppm	007411909 GBF	Horwith	AG61522
4	WC-5 (10-15)	CWM Emelle	MGP soil with TCE>25 ppm	007411910 GBF	Horwith	AH15529
5	WC-5 (10-15)	CWM Emelle	MGP soil with TCE>25 ppm	007411911 GBF	Horwith	AH15528
6	WC-5 (10-15)	CWM Emelle	MGP soil with TCE>25 ppm	007411912 GBF	Horwith	AH32629

**DAILY STATUS REPORT**

PROJECT:	Former Fulton MGP – Parcels III and IV (Site No.: 224051)
ADDRESS:	545 Sackett St., Brooklyn, NY
PREPARED BY:	Roux Environmental Engineering and Geology, D.P.C.
DATE:	April 1, 2024
WEATHER:	Temp: 47-55°F, Cloudy/Rain, RH: 66% Pressure: 29.99" in Hg Wind: ENE @ 5 mph
TIME:	07:00 – 15:30

Exported Material Truck Log (con't)

7	WC-5 (10-15)	CWM Emelle	MGP soil with TCE>25 ppm	007411913 GBF	Horwith	AH31897
8	WC-9 (10-15)	CWM Emelle	MGP soil with TCE>25 ppm	007411914 GBF	Horwith	AG61522
9	WC-9 (10-15)	CWM Emelle	MGP soil with TCE>25 ppm	007411915 GBF	Horwith	AH15529
10	WC-9 (10-15)	CWM Emelle	MGP soil with TCE>25 ppm	007411916 GBF	Horwith	AH15528

Dewatering

Date	Time	Totalizer Reading
3/29/2024	15:00	59,440,000
4/1/2024	7:05	60,278,300
4/1/2024	13:20	60,319,200
4/1/2024	15:00	60,380,700
Water treated and discharged to NYCDEP sewer since last report:		940,700 gallons

Anticipated Upcoming Work Activities

- Continue excavation and load out in Gas Holder 3 excavation area.
- Continue dewatering for Gas Holder 3 excavation area and operation of water treatment system.

PROJECT:	Former Fulton MGP – Parcels III and IV (Site No.: 224051)
ADDRESS:	545 Sackett St., Brooklyn, NY
PREPARED BY:	Roux Environmental Engineering and Geology, D.P.C.
DATE:	April 1, 2024
WEATHER:	Temp: 47-55°F, Cloudy/Rain, RH: 66% Pressure: 29.99" in Hg Wind: ENE @ 5 mph
TIME:	07:00 – 15:30

Site Layout

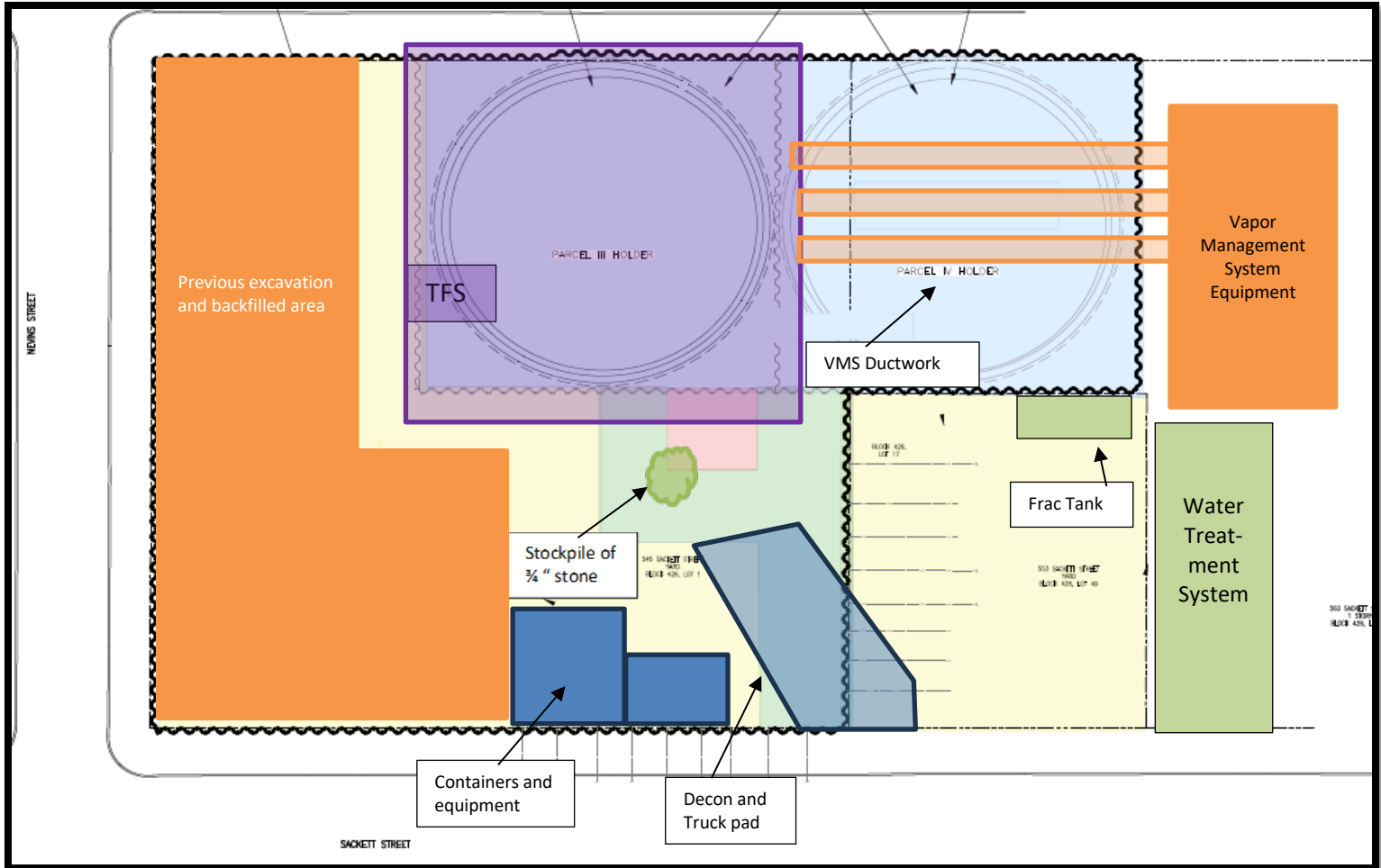

PROJECT:	Former Fulton MGP – Parcels III and IV (Site No.: 224051)
ADDRESS:	545 Sackett St., Brooklyn, NY
PREPARED BY:	Roux Environmental Engineering and Geology, D.P.C.
DATE:	April 1, 2024
WEATHER:	Temp: 47-55°F, Cloudy/Rain, RH: 66% Pressure: 29.99" in Hg Wind: ENE @ 5 mph
TIME:	07:00 – 15:30

Excavation Diagram

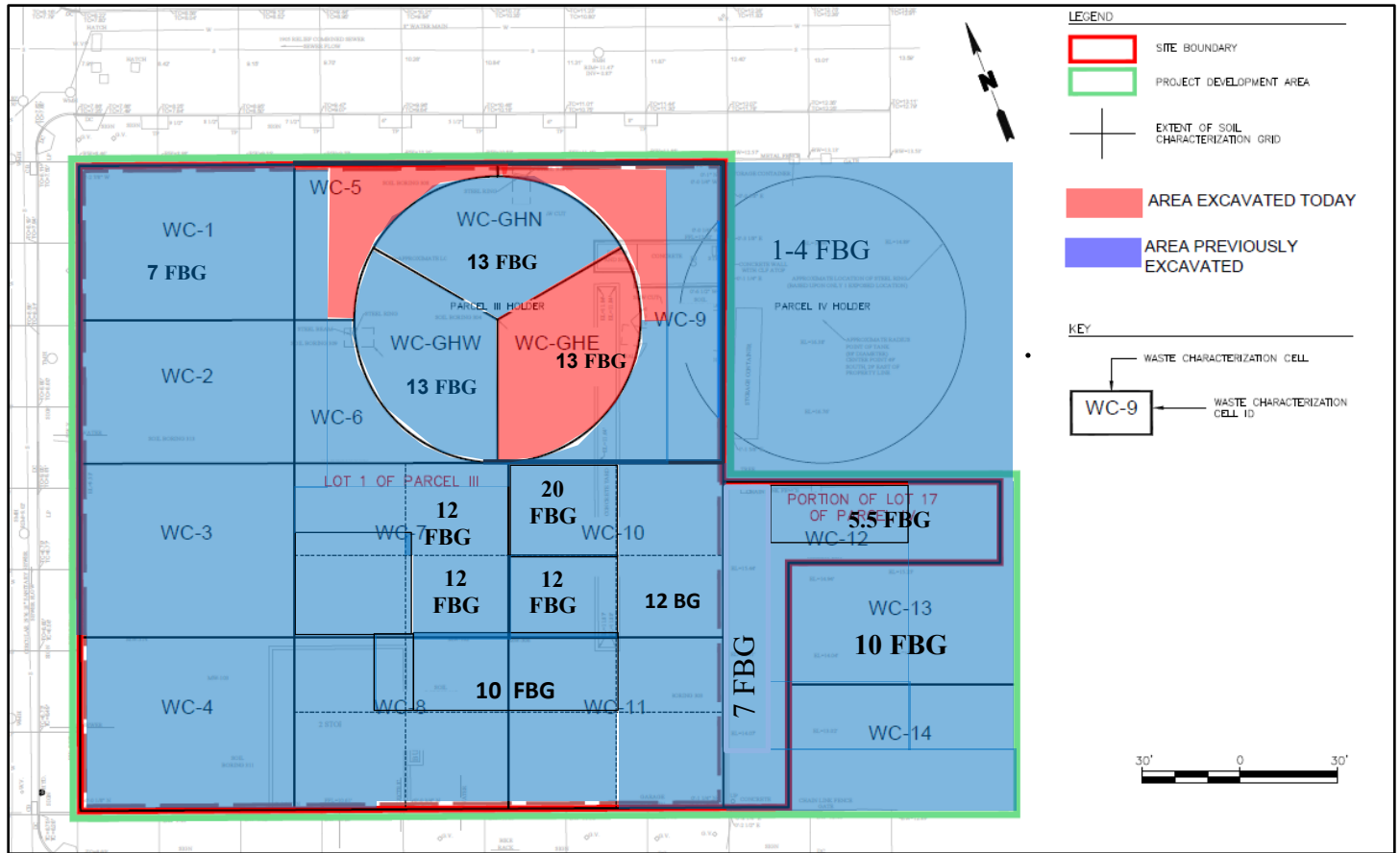

PROJECT:	Former Fulton MGP – Parcels III and IV (Site No.: 224051)
ADDRESS:	545 Sackett St., Brooklyn, NY
PREPARED BY:	Roux Environmental Engineering and Geology, D.P.C.
DATE:	April 1, 2024
WEATHER:	Temp: 47-55°F, Cloudy/Rain, RH: 66% Pressure: 29.99" in Hg Wind: ENE @ 5 mph
TIME:	07:00 – 15:30



Photo 1:

Looking east, CEI loading a truck with excavated material from waste characterization grid WC-5 (10-15) for offsite disposal.



Photo 2:

Looking south, view CEI removing material from waste characterization grid WC-5 with the mini-excavator.

PROJECT:	Former Fulton MGP – Parcels III and IV (Site No.: 224051)
ADDRESS:	545 Sackett St., Brooklyn, NY
PREPARED BY:	Roux Environmental Engineering and Geology, D.P.C.
DATE:	April 1, 2024
WEATHER:	Temp: 47-55°F, Cloudy/Rain, RH: 66% Pressure: 29.99" in Hg Wind: ENE @ 5 mph
TIME:	07:00 – 15:30



Photo 3:

Looking north, CEI secured TFS around truck before loading with material.