

PROJECT:	Former Fulton MGP – Parcels III and IV (Site No.: 224051)
ADDRESS:	545 Sackett St., Brooklyn, NY
PREPARED BY:	Roux Environmental Engineering and Geology, D.P.C.
DATE:	April 22, 2024
WEATHER:	Temp: 41 -62°F, Sunny, RH: 59% Pressure: 30.06" in Hg Wind: NW @ 6 mph
TIME:	07:00 – 15:30

Project Team

General Contractor and Subcontractors:

- Mega Contracting Group, LLC (Mega)
- Creamer Environmental, Inc. (CEI)
- Earth Construction Services, LLC (ECS)

Engineers and Consultants:

- Roux Environmental Engineering and Geology, D.P.C. (Roux)
- GZA GeoEnvironmental Inc. of New York (GZANY)
- WSP USA (WSP)

Remedial Action Work Summary

Work Activities Performed Onsite:

- Excavation and prep for future loadout of material from Gas Holder 3 excavation area.
- Excavation and loadout of material for offsite disposal at CMW Emelle.
- Continue dewatering operations for Gas Holder 3 excavation area.
- Water treatment system maintenance.

Contractor Work Performed Onsite:

Creamer Environmental Inc. (CEI) excavated material and loaded out 15 trucks of MGP impacted material with TCE >25 ppm from waste characterization grid WC-GHE (13-20) for disposal at Chemical Waste Management (CMW) Emelle. CEI continued demolition of the former Gas Holder 3 foundation and reducing oversized material from both the foundation structure and backfilled material found inside the gas holder foundation. This material was stabilized and staged for future loadout.

Earth Construction Services, LLC (ECS) continued 24-hour operation of the dewatering system for the Gas Holder 3 excavation area. Since the last reporting period, CEI treated approximately 910,000 gallons of recovered construction wastewater through the water treatment system (WTS) and discharged the treated water to the New York City Department of Environmental Protection (NYCDEP) combined sewer system. Improvements and adjustments to the dewatering and WTS piping continued.

The vapor management system (VMS) associated with the tension fabric structure (TFS) was operated throughout the day. Other dust and odor control measures (wetting, tarping, limiting vehicle speeds, covering trucks inside TFS, spraying loaded material with odor suppressant, etc.) continued to be performed to ensure there were no impacts to the neighborhood. Exposed soils were covered with Atmos odor suppressing foam during the operations and at the conclusion of the workday.

Air Monitoring:

- No VOC or dust exceedances were observed from the community air monitoring program (CAMP).
- GZANY to provide a summary report of CAMP activities separately.

Erosion and Sediment Control:

- None.

Sampling Conducted:

- Groundwater samples were collected from sentinel wells SW-01S, SW-01D, SW-02S, SW-02D, SW-03S, SW-03D, SW-05S, SW-07S, and SW-07D to be analyzed for the following parameters:

PROJECT:	Former Fulton MGP – Parcels III and IV (Site No.: 224051)
ADDRESS:	545 Sackett St., Brooklyn, NY
PREPARED BY:	Roux Environmental Engineering and Geology, D.P.C.
DATE:	April 22, 2024
WEATHER:	Temp: 41 -62°F, Sunny, RH: 59% Pressure: 30.06" in Hg Wind: NW @ 6 mph
TIME:	07:00 – 15:30

- TCL VOCs USEPA 8260,
- TCL SVOCs USEPA 8270,
- TCL Pesticides USEPA 8081,
- TAL Metals USEPA 6020,
- TCL PCB USEPA 8082A,
- Hex Chrom USEPA 7196,
- Total Cyanide USEPA 7196, and
- PFAS.

Other Items of Note:

- Construction activities were observed as part of the ongoing combined sewer overflow (CSO) project west of Nevins Street.

Imported Material

Name - Location	Source	During This Reporting Period		Total	
		Loads	Tons	Loads	Tons
None.					

Exported Material

Material	Facility	During This Reporting Period		Total	
		Loads	Tons	Loads	Tons
TCE Impacted Haz Hot Spots	CWM Emelle			7	161.72
Cd Impacted Haz Material from WC-5	CWM Emelle			3	49.45
Pb Impacted Haz from Parcel IV Hot Spot	CWM Emelle			25	536.72
Cd Impacted Haz Material from WC-5	Clean Earth (CE) NJ			16	397.75
Concrete for Recycling	Bayshore			27	~509.87
Concrete for Landfill	WM Fairless			63	~1,415.93
Urban Fill for CVOC Orange Zone (Lot 17)	WM Fairless Urban Fill-OZ			47	~1034
Urban Fill for CVOC Orange Zone (Lot 49)	WM Fairless Urban Fill-OZ			24	~528
Non-Haz Urban Fill (Lot 17)	CE Carteret			42	~924
Non-Haz Urban Fill (Lot 49)	CE Carteret			73	~1,606
MGP soil with TCE>25 ppm	CE ESMI			181	~3,906
	CE Southeast Pennsylvania			10	~220
	CMW Emelle	15	300	240	~4,800
Non-Haz MGP Impacted (TCLP Benzene > 0.5)	CE Southeast Pennsylvania			8	~237.97
Non-Haz MGP Impacted (TCLP Benzene < 0.5)	CE Southeast Pennsylvania			119	~2,614
Non-Haz Contaminated Urban Fill	WM Fairless			387	~8,134.69
Non-Haz Urban Fill	CE Carteret -BZ			71	~1,562
Non-Haz MGP Impacted	CE of New Castle			35	~770
MGP Impacted (TCLP Benzene 0.2<x<0.5 mg/l)	CE Southeast Pennsylvania			5	~110

**DAILY STATUS REPORT**

PROJECT:	Former Fulton MGP – Parcels III and IV (Site No.: 224051)
ADDRESS:	545 Sackett St., Brooklyn, NY
PREPARED BY:	Roux Environmental Engineering and Geology, D.P.C.
DATE:	April 22, 2024
WEATHER:	Temp: 41 -62°F, Sunny, RH: 59% Pressure: 30.06" in Hg Wind: NW @ 6 mph
TIME:	07:00 – 15:30

Exported Material Truck Log

Number	Excavation Grid	Disposal Facility	Disposal Profile	Manifest Number	Trucking Company	Truck License Plate
1	WC-GHE (13-20)	Emelle > 25 TCE	MGP soil with TCE >25 ppm	007412456 GBF	Horwith	AH15528
2	WC-GHE (13-20)	Emelle > 25 TCE	MGP soil with TCE >25 ppm	007412457 GBF	Horwith	AH15527
3	WC-GHE (13-20)	Emelle > 25 TCE	MGP soil with TCE >25 ppm	007412458 GBF	Horwith	AH15531
4	WC-GHE (13-20)	Emelle > 25 TCE	MGP soil with TCE >25 ppm	007412459 GBF	Horwith	AH31897
5	WC-GHE (13-20)	Emelle > 25 TCE	MGP soil with TCE >25 ppm	007412460 GBF	Horwith	AG61522
6	WC-GHE (13-20)	Emelle > 25 TCE	MGP soil with TCE >25 ppm	007412461 GBF	Horwith	AH15529
7	WC-GHE (13-20)	Emelle > 25 TCE	MGP soil with TCE >25 ppm	007412462 GBF	Horwith	AG92027
8	WC-GHE (13-20)	Emelle > 25 TCE	MGP soil with TCE >25 ppm	007412463 GBF	Horwith	AH15528
9	WC-GHE (13-20)	Emelle > 25 TCE	MGP soil with TCE >25 ppm	007412464 GBF	Horwith	AH15527
10	WC-GHE (13-20)	Emelle > 25 TCE	MGP soil with TCE >25 ppm	007412465 GBF	Horwith	AH15531
11	WC-GHE (13-20)	Emelle > 25 TCE	MGP soil with TCE >25 ppm	007412466 GBF	Horwith	AH31897
12	WC-GHE (13-20)	Emelle > 25 TCE	MGP soil with TCE >25 ppm	007412467 GBF	Horwith	AG61522
13	WC-GHE (13-20)	Emelle > 25 TCE	MGP soil with TCE >25 ppm	007412468 GBF	Horwith	AH15529
14	WC-GHE (13-20)	Emelle > 25 TCE	MGP soil with TCE >25 ppm	007412469 GBF	Horwith	AG92027
15	WC-GHE (13-20)	Emelle > 25 TCE	MGP soil with TCE >25 ppm	007412470 GBF	Horwith	AH15528

Dewatering

Date	Time	Totalizer Reading
4/19/2024	15:00	65,718,900
4/22/2024	7:05	66,546,900
4/22/2024	13:00	66,628,900
Water treated and discharged to NYCDEP sewer since last report:		910,000

Anticipated Upcoming Work Activities

- Continue excavation and load out in Gas Holder 3 excavation area.
- Continue dewatering for Gas Holder 3 excavation area and operation of water treatment system.

PROJECT:	Former Fulton MGP – Parcels III and IV (Site No.: 224051)
ADDRESS:	545 Sackett St., Brooklyn, NY
PREPARED BY:	Roux Environmental Engineering and Geology, D.P.C.
DATE:	April 22, 2024
WEATHER:	Temp: 41 -62°F, Sunny, RH: 59% Pressure: 30.06" in Hg Wind: NW @ 6 mph
TIME:	07:00 – 15:30

Site Layout

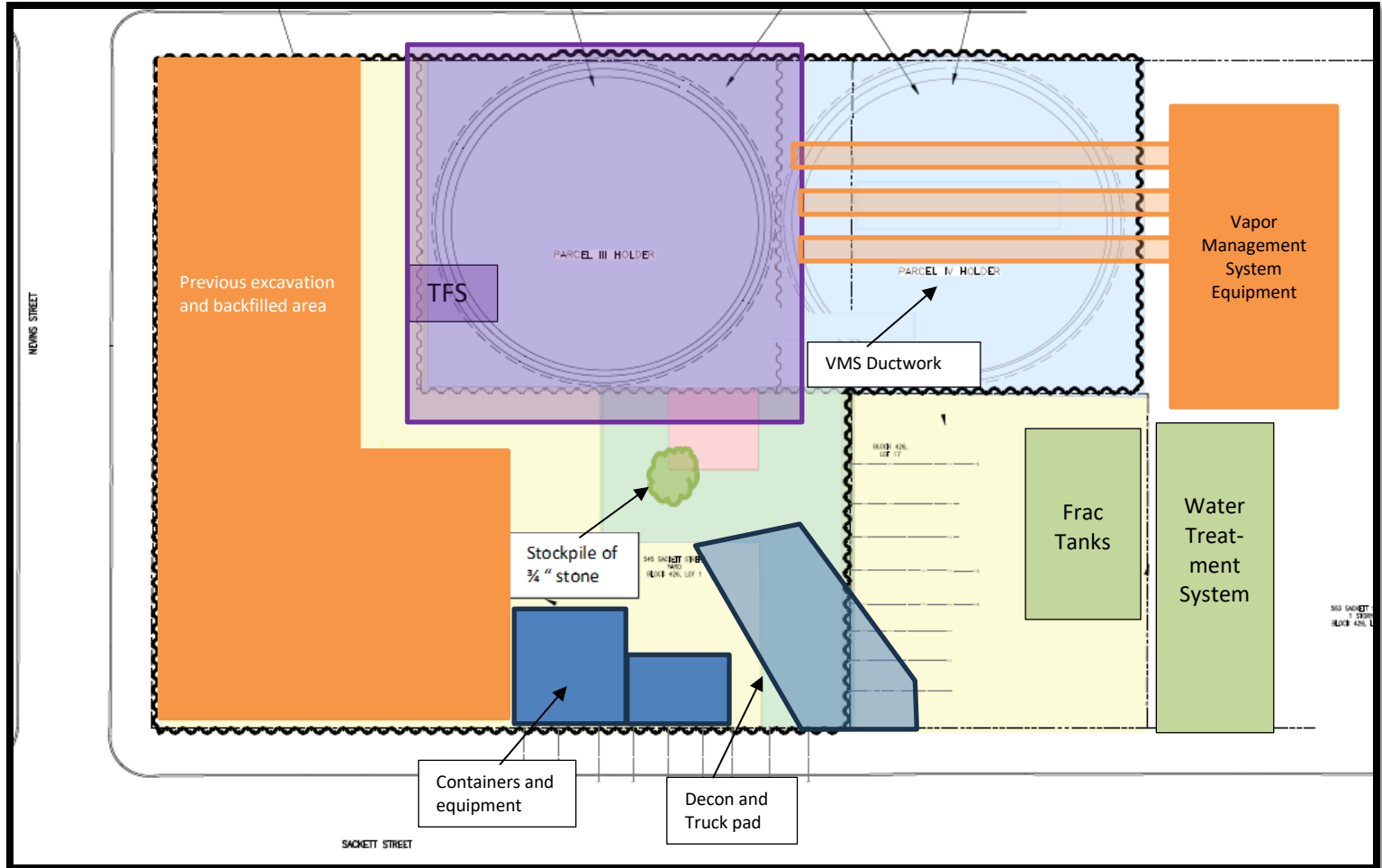

PROJECT:	Former Fulton MGP – Parcels III and IV (Site No.: 224051)
ADDRESS:	545 Sackett St., Brooklyn, NY
PREPARED BY:	Roux Environmental Engineering and Geology, D.P.C.
DATE:	April 22, 2024
WEATHER:	Temp: 41 -62°F, Sunny, RH: 59% Pressure: 30.06" in Hg Wind: NW @ 6 mph
TIME:	07:00 – 15:30

Excavation Diagram

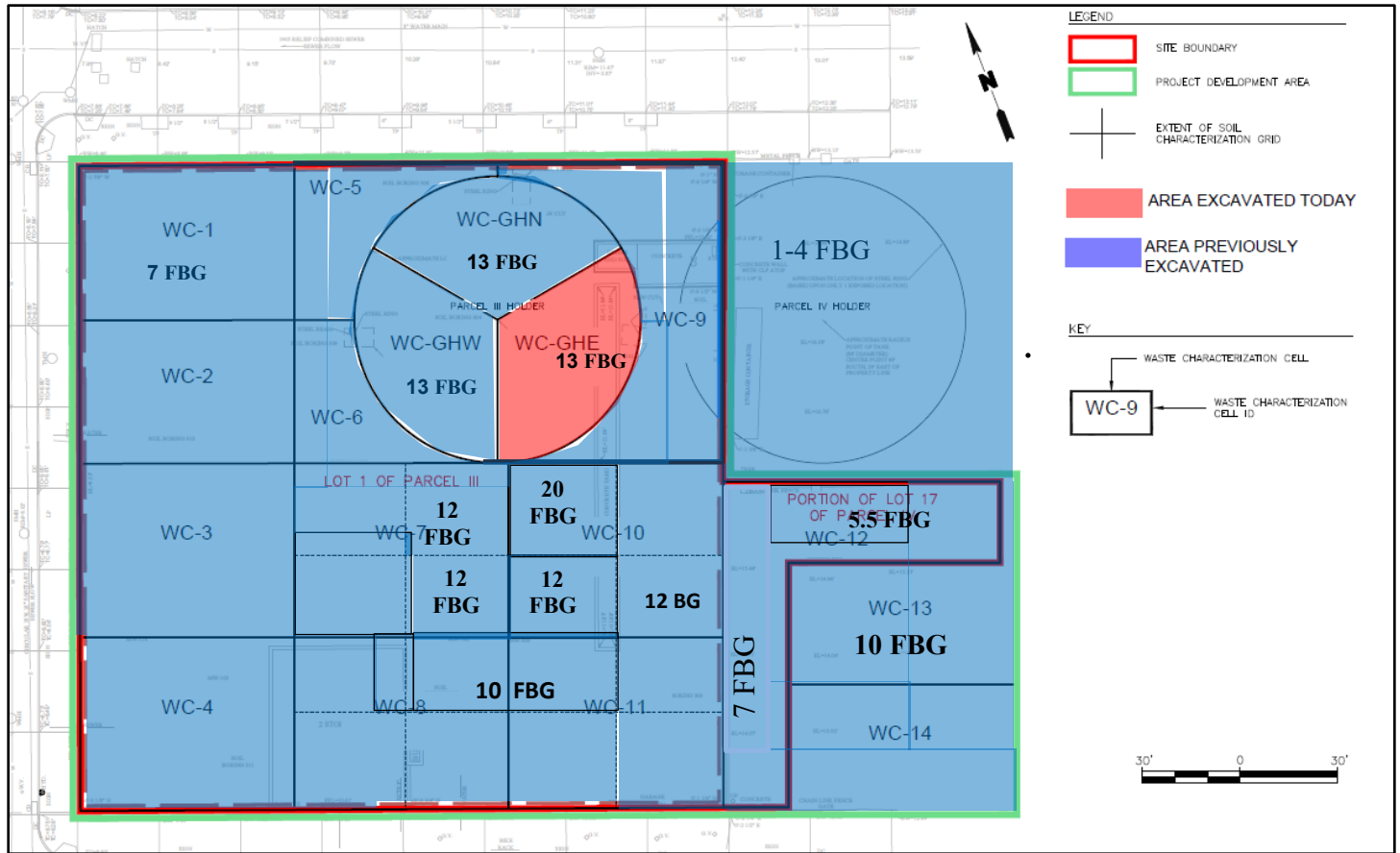

PROJECT:	Former Fulton MGP – Parcels III and IV (Site No.: 224051)
ADDRESS:	545 Sackett St., Brooklyn, NY
PREPARED BY:	Roux Environmental Engineering and Geology, D.P.C.
DATE:	April 22, 2024
WEATHER:	Temp: 41 -62°F, Sunny, RH: 59% Pressure: 30.06" in Hg Wind: NW @ 6 mph
TIME:	07:00 – 15:30



Photo 1:

Looking northeast, Roux performs sentinel groundwater sampling.



Photo 2:

Looking north, CEI secures the TFS around the truck as material is loaded for disposal offsite.

PROJECT:	Former Fulton MGP – Parcels III and IV (Site No.: 224051)
ADDRESS:	545 Sackett St., Brooklyn, NY
PREPARED BY:	Roux Environmental Engineering and Geology, D.P.C.
DATE:	April 22, 2024
WEATHER:	Temp: 41 -62°F, Sunny, RH: 59% Pressure: 30.06" in Hg Wind: NW @ 6 mph
TIME:	07:00 – 15:30



Photo 3:

Looking northeast, CEI applied eight bags of soil stabilizer in preparation for material load out.