

<b>PROJECT:</b>	Former Fulton MGP – Parcels III and IV (Site No.: 224051)
<b>ADDRESS:</b>	545 Sackett St., Brooklyn, NY
<b>PREPARED BY:</b>	Roux Environmental Engineering and Geology, D.P.C.
<b>DATE:</b>	May 28, 2024
<b>WEATHER:</b>	Temp: 65-81°F, Sunny, RH: 47% Pressure: 29.74" inHg Wind: West @15 mph
<b>TIME:</b>	07:00 – 15:15

### Project Team

#### General Contractor and Subcontractors:

- Mega Contracting Group, LLC (Mega)
- Creamer Environmental, Inc. (CEI)
- Earth Construction Services, LLC (ECS)

#### Engineers and Consultants:

- Roux Environmental Engineering and Geology, D.P.C. (Roux)
- GZA GeoEnvironmental Inc. of New York (GZANY)
- WSP USA (WSP)

### Remedial Action Work Summary

#### Work Activities Performed Onsite:

- Excavation and loadout of material for offsite disposal at CMW Emelle.
- Demolition of Gas Holder 3 foundation and structure.
- Backfill of completed excavation sections in Gas Holder 3.
- Dewatering operations for Gas Holder 3 excavation area.

#### Contractor Work Performed Onsite:

Creamer Environmental Inc. (CEI) excavated material and loaded out 10 trucks (approximately 200 tons) of MGP impacted material with TCE >25 ppm from waste characterization grid WC-GHE (13-20), WC-GHN (13-20) and WC-GHW (13-20) for disposal at Chemical Waste Management (CMW) Emelle. CEI continued the demolition and removal of the former Gas Holder 3 bottom slab and stabilized that material in preparation of load out for disposal. CEI imported 20 trucks (507.17 tons) of general fill from Vulcan Wantage Quarry of New Jersey. Imported general fill was used as backfilling in the completed sections in the Gas Holder 3 excavation. CEI relocated 20 x 55-gallon drums of material generated during the Pre-Design Investigation to inside the Tension Fabric Structure (TFS), emptied the contents of the drums into the stockpile for CWM Emelle offsite export and crushed the drums for future disposal. Previously identified wood piles were removed from the northeast and southeast corners of Gas Holder 3 excavation area.

Earth Construction Services, LLC (ECS) continued 24-hour operation of the dewatering system for the Gas Holder 3 excavation area and CEI operated the WTS. Since the last reporting period, CEI treated approximately 2,176,200 gallons of recovered construction wastewater through the WTS and discharged the treated water to the New York City Department of Environmental Protection (NYCDEP) combined sewer system. Routine maintenance to onsite dewatering and water treatment systems was performed.

The vapor management system (VMS) associated with the TFS was operated throughout the day. Other dust and odor control measures (wetting, tarping, limiting vehicle speeds, covering trucks inside TFS, spraying loaded material with odor suppressant, etc.) continued to be performed to ensure there were no impacts to the neighborhood. Truck tires were washed to ensure material was not being tracked offsite. Exposed soils were covered with Atmos odor suppressing foam during the operations and at the conclusion of the workday.

#### Air Monitoring:

- No VOC or dust exceedances were observed from the community air monitoring program (CAMP).
- GZANY to provide a summary report of CAMP activities separately.

#### Erosion and Sediment Control:

- None.

**DAILY STATUS REPORT**

<b>PROJECT:</b>	Former Fulton MGP – Parcels III and IV (Site No.: 224051)
<b>ADDRESS:</b>	545 Sackett St., Brooklyn, NY
<b>PREPARED BY:</b>	Roux Environmental Engineering and Geology, D.P.C.
<b>DATE:</b>	May 28, 2024
<b>WEATHER:</b>	Temp: 65-81°F, Sunny, RH: 47% Pressure: 29.74" inHg Wind: West @15 mph
<b>TIME:</b>	07:00 – 15:15

**Sampling Conducted:**

None

**Other Items of Note:**

- Construction activities were observed as part of the ongoing combined sewer overflow (CSO) project west of Nevins Street.

**Imported Material**

Name - Location	Source	During This Reporting Period		Total	
		Loads	Tons	Loads	Tons
Vulcan ASTM #3 (1 ½" Stone)	Vulcan Hamburg Quarry			10	255.36
Vulcan ASTM #57 (3/4" Stone)	Vulcan Hamburg Quarry			6	152.05
Vulcan General Fill	Vulcan Wantage Quarry	20	507.17	833	21,483.96

**Exported Material**

Material	Facility	During This Reporting Period		Total	
		Loads	Tons	Loads	Tons
TCE Impacted Haz Hot Spots	CWM Emelle			7	161.72
Cd Impacted Haz Material from WC-5	CWM Emelle			3	49.45
Pb Impacted Haz from Parcel IV Hot Spot	CWM Emelle			25	536.72
Cd Impacted Haz Material from WC-5	Clean Earth (CE) NJ			16	397.75
Concrete for Recycling	Bayshore			27	~509.87
Concrete for Landfill	WM Fairless			63	~1,415.93
Urban Fill for CVOC Orange Zone (Lot 17)	WM Fairless Urban Fill-OZ			47	~1034
Urban Fill for CVOC Orange Zone (Lot 49)	WM Fairless Urban Fill-OZ			24	~528
Non-Haz Urban Fill (Lot 17)	CE Carteret			42	~924
Non-Haz Urban Fill (Lot 49)	CE Carteret			73	~1,606
MGP soil with TCE>25 ppm	CE ESMI			181	~3,906
	CE Southeast Pennsylvania			10	~220
	CMW Emelle	10	~200	379	~7,380
Non-Haz MGP Impacted (TCLP Benzene > 0.5)	CE Southeast Pennsylvania			8	~237.97
Non-Haz MGP Impacted (TCLP Benzene < 0.5)	CE Southeast Pennsylvania			119	~2,614
Non-Haz Contaminated Urban Fill	WM Fairless			387	~8,134.69
Non-Haz Urban Fill	CE Carteret -BZ			71	~1,562
Non-Haz MGP Impacted	CE of New Castle			35	~770
MGP Impacted (TCLP Benzene 0.2<x<0.5 mg/l)	CE Southeast Pennsylvania			5	~110

**Exported Material Truck Log**

Number	Excavation Grid	Disposal Facility	Disposal Profile	Manifest Number	Trucking Company	Truck License Plate
1	WC-GHN(13-20)	CMW Emelle	MGP soil with TCE >25 ppm	007413458 GBF	Horwith	AH31897
2	WC-GHN(13-20)	CMW Emelle	MGP soil with TCE >25 ppm	007413459 GBF	Horwith	AG61522
3	WC-GHN(13-20)	CMW Emelle	MGP soil with TCE >25 ppm	007413460 GBF	Horwith	AH15529
4	WC-GHN(13-20)	CMW Emelle	MGP soil with TCE >25 ppm	007413461 GBF	Horwith	AG91382

<b>PROJECT:</b>	Former Fulton MGP – Parcels III and IV (Site No.: 224051)
<b>ADDRESS:</b>	545 Sackett St., Brooklyn, NY
<b>PREPARED BY:</b>	Roux Environmental Engineering and Geology, D.P.C.
<b>DATE:</b>	May 28, 2024
<b>WEATHER:</b>	Temp: 65-81°F, Sunny, RH: 47% Pressure: 29.74" inHg Wind: West @15 mph
<b>TIME:</b>	07:00 – 15:15

**Exported Material Truck Log (continued)**

5	WC-GHE(13-20)	CMW Emelle	MGP soil with TCE >25 ppm	007413462 GBF	Horwith	AH15530
6	WC-GHE(13-20)	CMW Emelle	MGP soil with TCE >25 ppm	007413463 GBF	Horwith	AH31897
7	WC-GHE(13-20)	CMW Emelle	MGP soil with TCE >25 ppm	007413464 GBF	Horwith	AG61522
8	WC-GHW(13-20)	CMW Emelle	MGP soil with TCE >25 ppm	007413465 GBF	Horwith	AH15529
9	WC-GHW(13-20)	CMW Emelle	MGP soil with TCE >25 ppm	007413466 GBF	Horwith	AG91382
10	WC-GHW(13-20)	CMW Emelle	MGP soil with TCE >25 ppm	007413467 GBF	Horwith	AH15530

**Dewatering**

Date	Time	Totalizer Reading
5/24/2024	15:15	93,723,000
5/28/2024	7:07	95,709,600
5/28/2024	13:44	95,856,500
5/28/2024	15:28	95,899,200
<b>Water treated and discharged to NYCDEP sewer since last report:</b>		<b>2,176,200</b>

**Anticipated Upcoming Work Activities**

- Continue demolition, excavation, load out and backfill in Gas Holder 3 excavation area.
- Continue dewatering for Gas Holder 3 excavation area and operation of water treatment system.

<b>PROJECT:</b>	Former Fulton MGP – Parcels III and IV (Site No.: 224051)
<b>ADDRESS:</b>	545 Sackett St., Brooklyn, NY
<b>PREPARED BY:</b>	Roux Environmental Engineering and Geology, D.P.C.
<b>DATE:</b>	May 28, 2024
<b>WEATHER:</b>	Temp: 65-81°F, Sunny, RH: 47% Pressure: 29.74" inHg Wind: West @15 mph
<b>TIME:</b>	07:00 – 15:15

### Site Layout

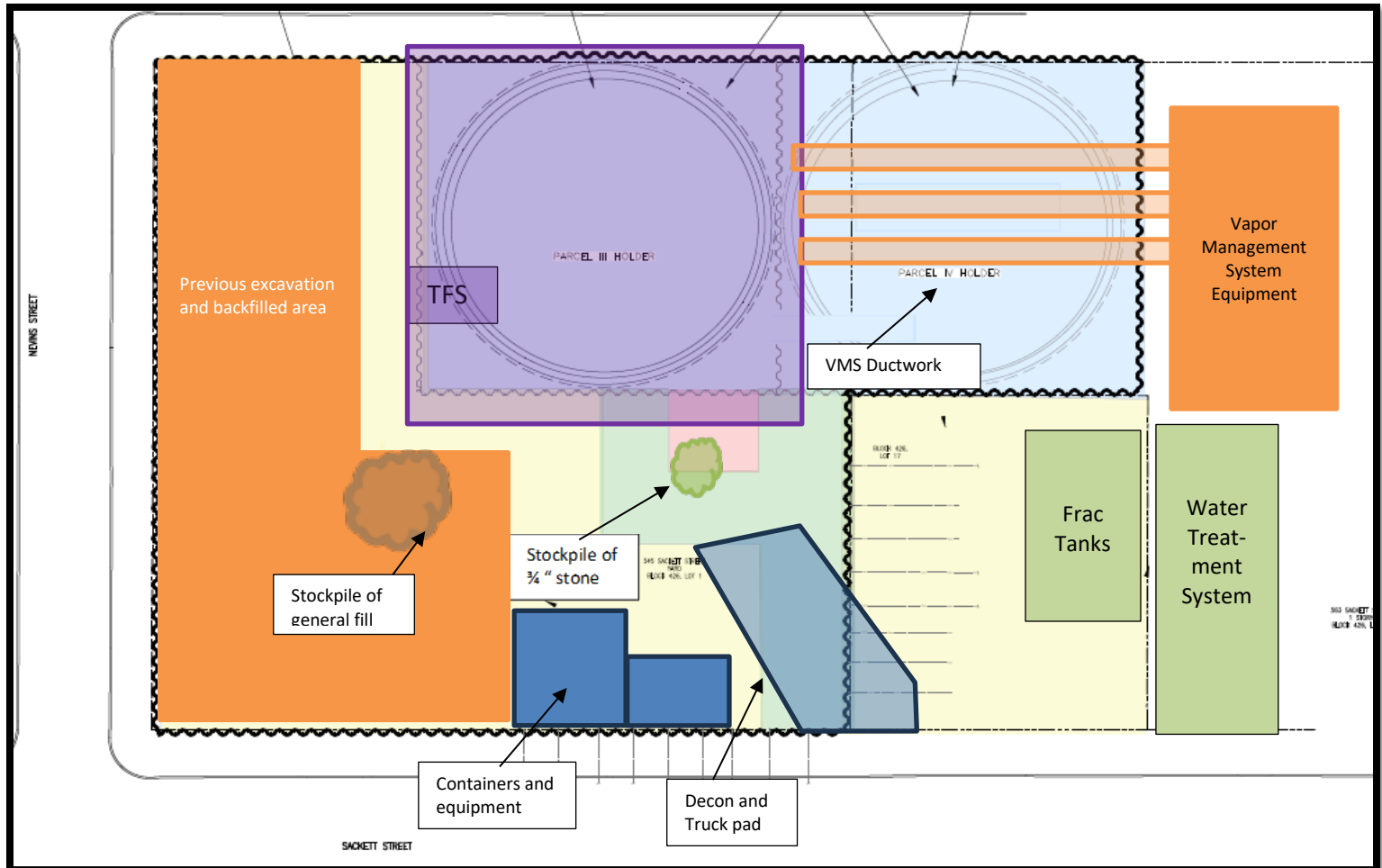

<b>PROJECT:</b>	Former Fulton MGP – Parcels III and IV (Site No.: 224051)
<b>ADDRESS:</b>	545 Sackett St., Brooklyn, NY
<b>PREPARED BY:</b>	Roux Environmental Engineering and Geology, D.P.C.
<b>DATE:</b>	May 28, 2024
<b>WEATHER:</b>	Temp: 65-81°F, Sunny, RH: 47% Pressure: 29.74" inHg Wind: West @15 mph
<b>TIME:</b>	07:00 – 15:15

### Excavation Diagram

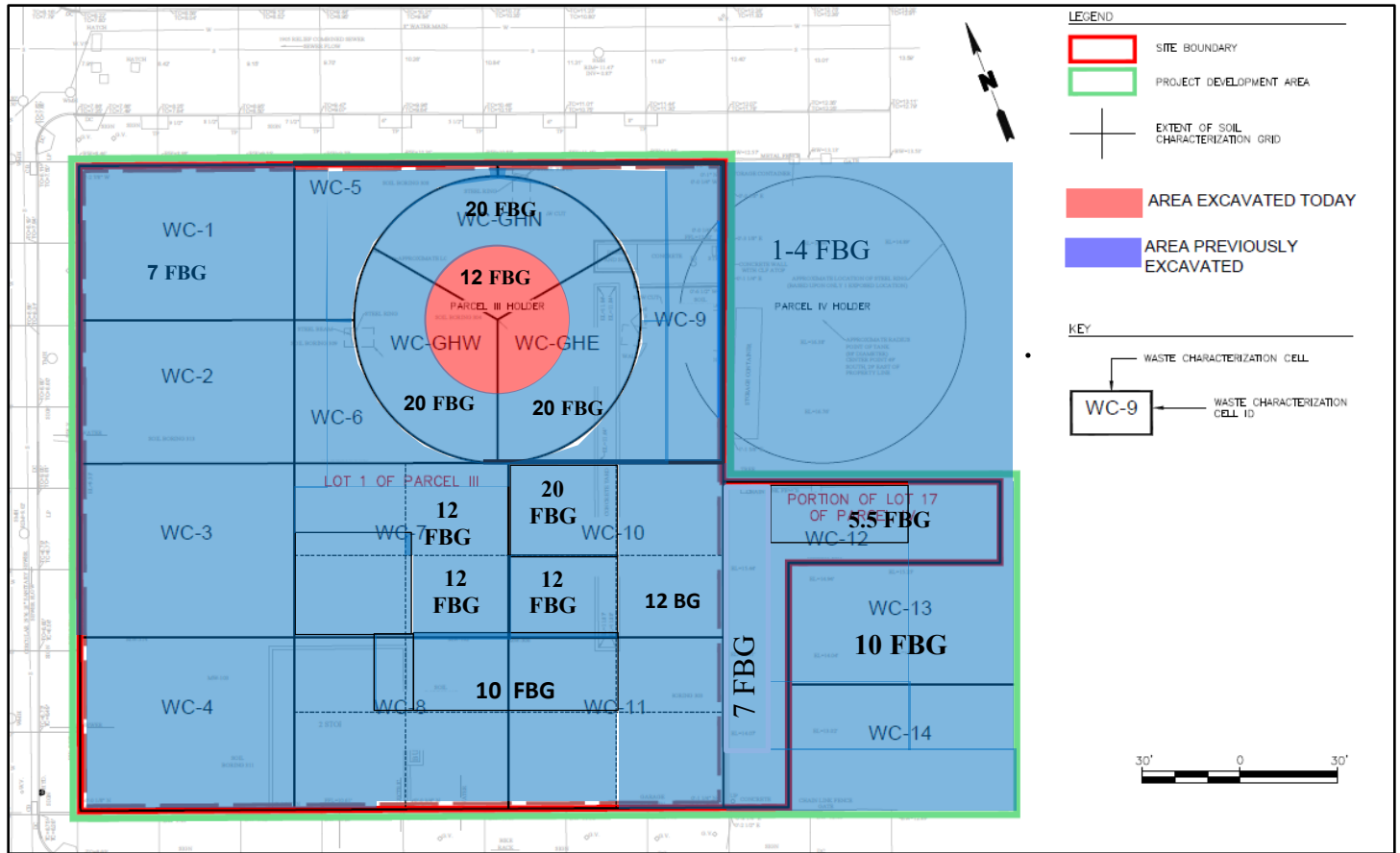



PROJECT:	Former Fulton MGP – Parcels III and IV (Site No.: 224051)
ADDRESS:	545 Sackett St., Brooklyn, NY
PREPARED BY:	Roux Environmental Engineering and Geology, D.P.C.
DATE:	May 28, 2024
WEATHER:	Temp: 65-81°F, Sunny, RH: 47% Pressure: 29.74" inHg Wind: West @15 mph
TIME:	07:00 – 15:15



**Photo 1:**

Looking north-northeast, view of the TFS secured around the triaxle truck while being loaded with soil material for offsite disposal.



**Photo 2:**

Looking southeast, view of CEI moving imported material with a wheel loader inside the TFS to use as backfill in waste characterization grid WC-9.



PROJECT:	Former Fulton MGP – Parcels III and IV (Site No.: 224051)
ADDRESS:	545 Sackett St., Brooklyn, NY
PREPARED BY:	Roux Environmental Engineering and Geology, D.P.C.
DATE:	May 28, 2024
WEATHER:	Temp: 65-81°F, Sunny, RH: 47% Pressure: 29.74" inHg Wind: West @15 mph
TIME:	07:00 – 15:15



**Photo 3:**

Looking east-southeast, view of CEI applying Atmos odor suppressant foam on exposed soil inside the TFS before the end of the workday.