

<b>PROJECT:</b>	Former Fulton MGP – Parcels III and IV (Site No.: 224051)
<b>ADDRESS:</b>	545 Sackett St., Brooklyn, NY
<b>PREPARED BY:</b>	Roux Environmental Engineering and Geology, D.P.C.
<b>DATE:</b>	July 08, 2024
<b>WEATHER:</b>	Temp: 74-91°F, Sunny, RH: 85% Pressure: 30.04 in Hg Wind: NNE @ 4 mph
<b>TIME:</b>	07:00 – 15:15

### Project Team

#### General Contractor and Subcontractors:

- Mega Contracting Group, LLC (Mega)
- Creamer Environmental, Inc. (CEI)
- McVAC Environmental (McVAC)
- Ground/Water Treatment and Technologies (GWTT)
- AARCO Environmental Services (AARCO)

#### Engineers and Consultants:

- Roux Environmental Engineering and Geology, D.P.C. (Roux)
- GZA GeoEnvironmental Inc. of New York (GZANY)
- WSP USA (WSP)

### Remedial Action Work Summary

#### Work Activities Performed Onsite:

- Change out of water treatment system filter media.
- Waste characterization sampling within Gas Holder 4 footprint.

#### Contractor Work Performed Onsite:

Creamer Environmental, Inc (CEI), McVAC Environmental (McVAC) and Gound/Water Treatment and Technologies (GWTT) removed spent filter media from the water treatment system (WTS) with a vacuum truck and staged the material for future disposal. A temporary sound barrier was installed prior to vacuum truck operations and Biosolve was sprayed to neutralize any odors being emitted from the vacuum truck exhaust. CEI also applied Atmos odor suppressant foam and at the end of the day, covered the staged filter media with poly sheeting to prevent odors.

AARCO Environmental Services (AARCO) and Roux Environmental Engineering and Geology, D.P.C. (Roux) performed drilling activities utilizing a sonic drill rig Geoprobe 8140LC within waste characterization grids WC-GH4-1 and WC-GH4-3 to collect waste classification samples for compliance with disposal facilities. Dust and odor control measures (wetting, tarping, limiting vehicle speeds, etc.) continued to be performed to ensure there were no impacts to the neighborhood.

#### Air Monitoring:

- No VOC or dust exceedances were observed from the community air monitoring program (CAMP).
- GZANY to provide a summary report of CAMP activities separately.

#### Erosion and Sediment Control:

- None.

#### Sampling Conducted:

Grab (30) and composite (6) soil samples were collected as part of additional waste classification for grids WC-GH4-1 and WC-GH4-3. These samples were submitted for analysis of the following parameters:

- *Grab Soil Samples:*
  - TPH (DRO) via EPA method 8015B
  - Total Organic Halides (TOX) via EPA method 9020/9023
  - Toxicity Characteristic Leaching Procedure (TCLP) VOCs via EPA method 8260B

<b>PROJECT:</b>	Former Fulton MGP – Parcels III and IV (Site No.: 224051)
<b>ADDRESS:</b>	545 Sackett St., Brooklyn, NY
<b>PREPARED BY:</b>	Roux Environmental Engineering and Geology, D.P.C.
<b>DATE:</b>	July 08, 2024
<b>WEATHER:</b>	Temp: 74-91°F, Sunny, RH: 85% Pressure: 30.04 in Hg Wind: NNE @ 4 mph
<b>TIME:</b>	07:00 – 15:15

- *Composite Soil Samples:*
  - Total VOCs via EPA method 8260B
  - Total SVOCs via EPA method 8270C
  - Total PCBs via EPA method 8082
  - Total Metals via EPA method 6012B (including Aluminum, Antimony, Arsenic, Barium, Beryllium, Boron, Cadmium, Cobalt, Copper, Trivalent Chromium, Total Chromium, Iron, Lead, Manganese, Mercury, Nickel, Selenium, Silver, Thallium, Tin, Vanadium and Zinc)
  - TPH (DRO) via EPA method 8015B
  - TCLP VOCs via EPA method 8260B
  - TCLP SVOCs via EPA method 8270D
  - PAHs via EPA method 8270D
  - TCLP Herbicides via EPA method 8151A
  - TCLP Pesticides via EPA method 8081B
  - TCLP Metals RCRA 8 via EPA method 6010
  - Total Cyanide via EPA method 9012B
  - Percent Sulfur via method ASTM D4239
  - Ignitability via EPA method 1030A
  - Corrosivity (pH) via EPA method 9045C
  - Reactivity - Sulfide and Cyanide via SW 846 Chapter 7.3
  - TOX via EPA method 9020/9023
  - Hex Chrom via Method 7196
  - Percent Moisture via SM20-2540G

Other Items of Note:

- Construction activities were observed as part of the ongoing combined sewer overflow (CSO) project west of Nevins Street.
- Trucking activities were performed at an empty lot south of Sackett Street.

### Imported Material

Name - Location	Source	During This Reporting Period		Total	
		Loads	Tons	Loads	Tons
Vulcan ASTM #3 (1 ½" Stone)	Vulcan Hamburg Quarry			11	279.71
Vulcan ASTM #57 (3/4" Stone)	Vulcan Hamburg Quarry			6	152.05
Vulcan General Fill	Vulcan Wantage Quarry			1,200	29,913.85

### Exported Material

Material	Facility	During This Reporting Period		Total	
		Loads	Tons	Loads	Tons
TCE Impacted Haz Hot Spots	CWM Emelle			7	161.72
Cd Impacted Haz Material from WC-5	CWM Emelle			3	49.45
Pb Impacted Haz from Parcel IV Hot Spot	CWM Emelle			25	536.72
Cd Impacted Haz Material from WC-5	Clean Earth (CE) NJ			16	397.75
Concrete for Recycling	Bayshore			27	~509.87
Concrete for Landfill	WM Fairless			63	~1,415.93

**DAILY STATUS REPORT**

<b>PROJECT:</b>	Former Fulton MGP – Parcels III and IV (Site No.: 224051)
<b>ADDRESS:</b>	545 Sackett St., Brooklyn, NY
<b>PREPARED BY:</b>	Roux Environmental Engineering and Geology, D.P.C.
<b>DATE:</b>	July 08, 2024
<b>WEATHER:</b>	Temp: 74-91°F, Sunny, RH: 85% Pressure: 30.04 in Hg Wind: NNE @ 4 mph
<b>TIME:</b>	07:00 – 15:15

**Exported Material (continued)**

Urban Fill for CVOC Orange Zone (Lot 17)	WM Fairless Urban Fill-OZ			47	~1034
Urban Fill for CVOC Orange Zone (Lot 49)	WM Fairless Urban Fill-OZ			24	~528
Non-Haz Urban Fill (Lot 17)	CE Carteret			42	~924
Non-Haz Urban Fill (Lot 49)	CE Carteret			73	~1,606
MGP soil with TCE>25 ppm	CE ESMI			181	~3,906
	CE Southeast Pennsylvania			10	~220
	CMW Emelle			404	~7,880
Non-Haz MGP Impacted (TCLP Benzene > 0.5)	CE Southeast Pennsylvania			8	~237.97
Non-Haz MGP Impacted (TCLP Benzene < 0.5)	CE Southeast Pennsylvania			119	~2,614
Non-Haz Contaminated Urban Fill	WM Fairless			387	~8,134.69
Non-Haz Urban Fill	CE Carteret -BZ			71	~1,562
Non-Haz MGP Impacted	CE of New Castle			35	~770
MGP Impacted (TCLP Benzene 0.2<x<0.5 mg/l)	CE Southeast Pennsylvania			5	~110

**Exported Material Truck Log**

Number	Excavation Grid	Disposal Facility	Disposal Profile	Manifest Number	Trucking Company	Truck License Plate
None						

**Dewatering**

Date	Time	Totalizer Reading
7/08/24	15:15	100,823,700
Water treated and discharged to NYCDEP sewer since last report:		0

**Anticipated Upcoming Work Activities**

- Roux to perform additional waste characterization sampling associated with former Gas Holder 4.
- Continue carbon media change out activities in the Water Treatment System.

**Site Layout**

<b>PROJECT:</b>	Former Fulton MGP – Parcels III and IV (Site No.: 224051)
<b>ADDRESS:</b>	545 Sackett St., Brooklyn, NY
<b>PREPARED BY:</b>	Roux Environmental Engineering and Geology, D.P.C.
<b>DATE:</b>	July 08, 2024
<b>WEATHER:</b>	Temp: 74-91°F, Sunny, RH: 85% Pressure: 30.04 in Hg Wind: NNE @ 4 mph
<b>TIME:</b>	07:00 – 15:15

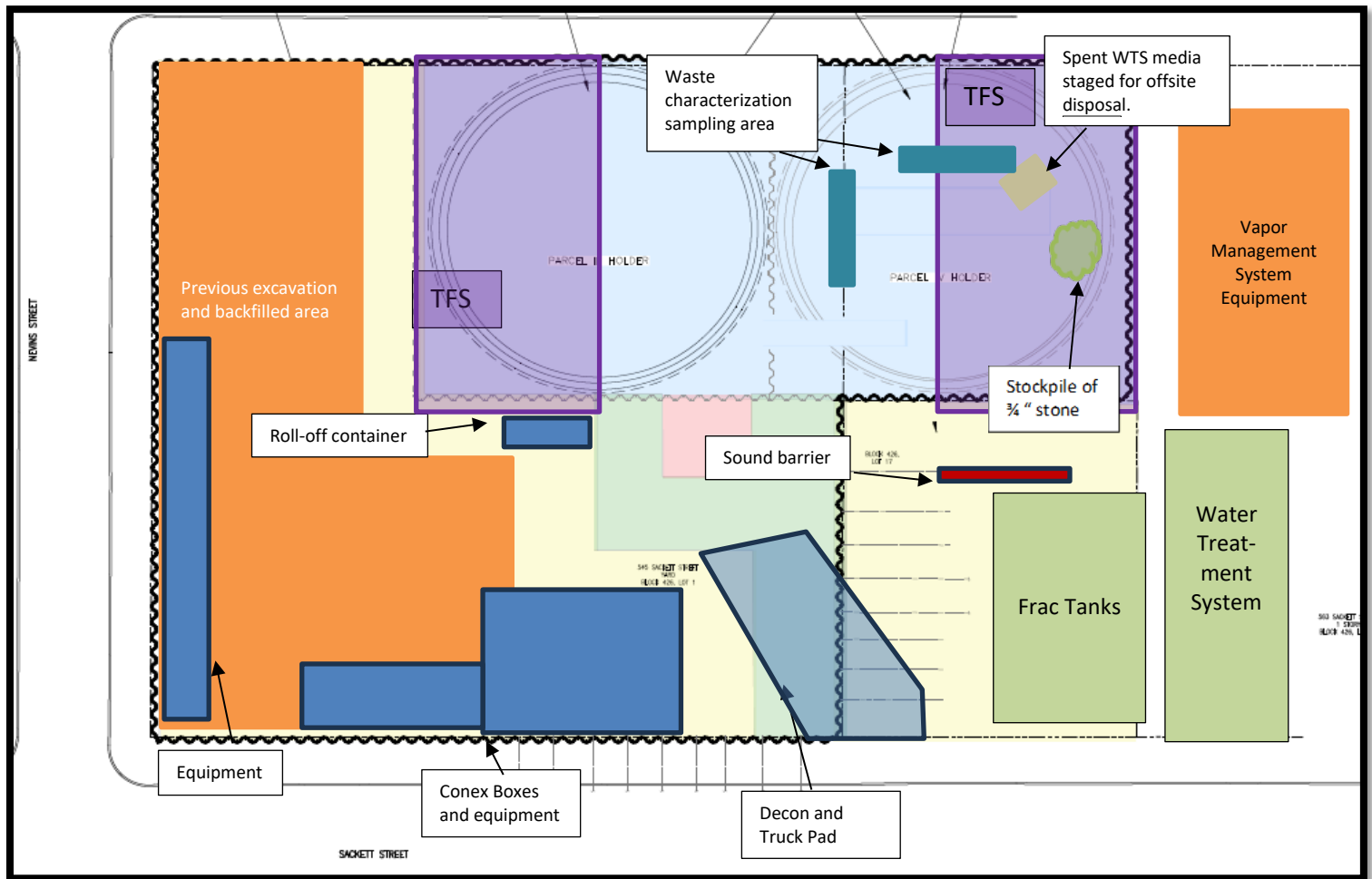

<b>PROJECT:</b>	Former Fulton MGP – Parcels III and IV (Site No.: 224051)
<b>ADDRESS:</b>	545 Sackett St., Brooklyn, NY
<b>PREPARED BY:</b>	Roux Environmental Engineering and Geology, D.P.C.
<b>DATE:</b>	July 08, 2024
<b>WEATHER:</b>	Temp: 74-91°F, Sunny, RH: 85% Pressure: 30.04 in Hg Wind: NNE @ 4 mph
<b>TIME:</b>	07:00 – 15:15

### Excavation Diagram

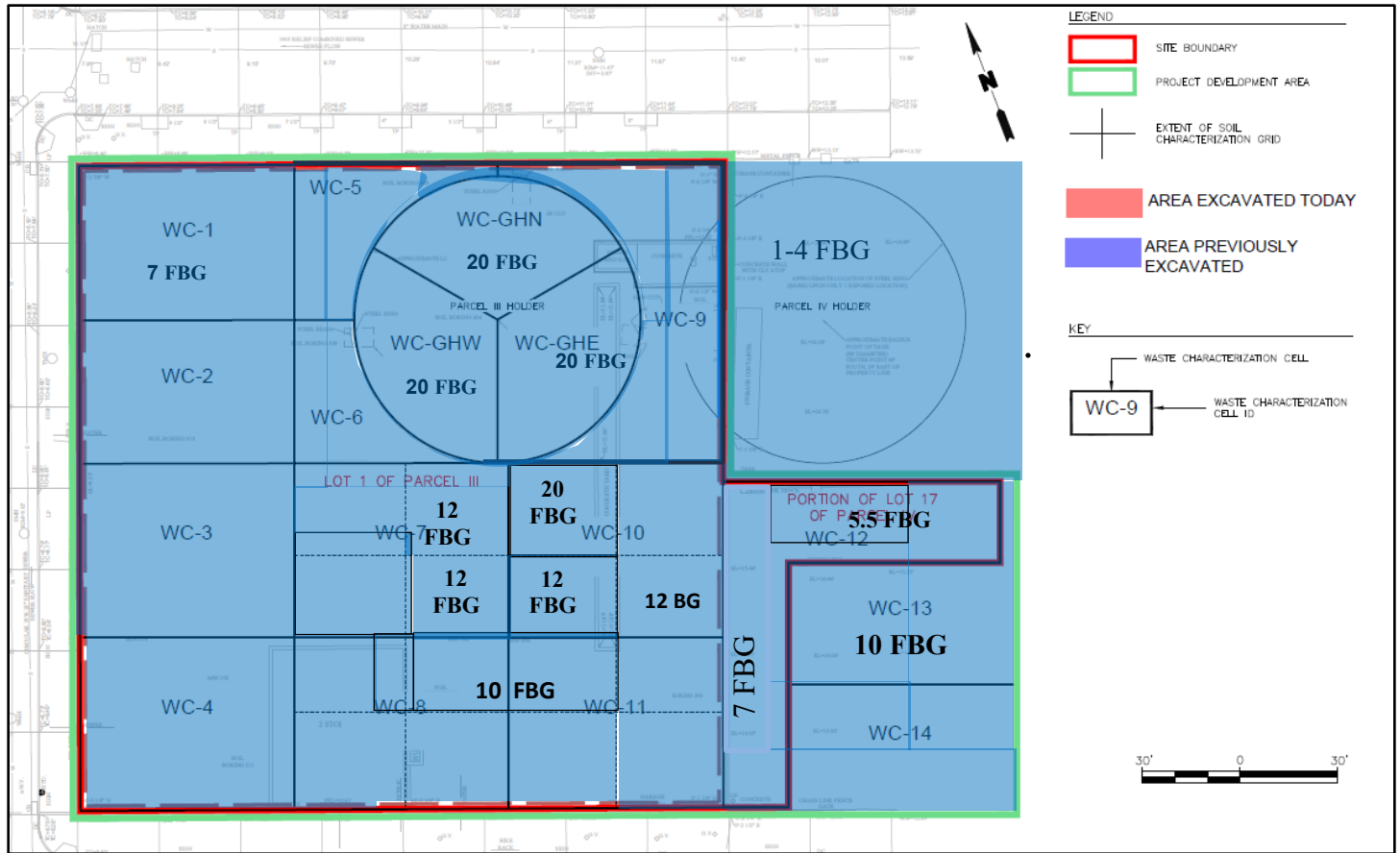



<b>PROJECT:</b>	Former Fulton MGP – Parcels III and IV (Site No.: 224051)
<b>ADDRESS:</b>	545 Sackett St., Brooklyn, NY
<b>PREPARED BY:</b>	Roux Environmental Engineering and Geology, D.P.C.
<b>DATE:</b>	July 08, 2024
<b>WEATHER:</b>	Temp: 74-91°F, Sunny, RH: 85% Pressure: 30.04 in Hg Wind: NNE @ 4 mph
<b>TIME:</b>	07:00 – 15:15



**Photo 1:**

Looking northwest, view of AARCO performing drilling activities in waste characterization grid WC-GH4-3.



**Photo 2:**

Looking southeast, view of McVAC vacuum truck removing spend filter media from WTS, application of Biosolve and sound barrier position.

PROJECT:	Former Fulton MGP – Parcels III and IV (Site No.: 224051)
ADDRESS:	545 Sackett St., Brooklyn, NY
PREPARED BY:	Roux Environmental Engineering and Geology, D.P.C.
DATE:	July 08, 2024
WEATHER:	Temp: 74-91°F, Sunny, RH: 85% Pressure: 30.04 in Hg Wind: NNE @ 4 mph
TIME:	07:00 – 15:15



**Photo 3:**  
Looking east, view of CEI removing spent filter media from the WTS via a vacuum truck.