



DAILY STATUS REPORT

PROJECT:	Former Fulton MGP – Parcels III and IV (Site No.: 224051)
ADDRESS:	545 Sackett St., Brooklyn, NY
PREPARED BY:	Roux Environmental Engineering and Geology, D.P.C.
DATE:	July 15, 2024
WEATHER:	Temp: 74-94°F, Cloudy, RH: 81% Pressure: 29.91 in Hg Wind: SSW @ 6 mph
TIME:	07:00 – 15:15

Project Team

General Contractor and Subcontractors:

- Mega Contracting Group, LLC (Mega)
- Creamer Environmental, Inc. (CEI)
- Ground/Water Treatment and Technologies (GWTT)

Engineers and Consultants:

- Roux Environmental Engineering and Geology, D.P.C. (Roux)
- GZA GeoEnvironmental Inc. of New York (GZANY)
- WSP USA (WSP)

Remedial Action Work Summary

Work Activities Performed Onsite:

- Change out of water treatment system filter media.
- Continued preparation work to relocate the temporary fabric structure (TFS) within former Gas Holder 4 excavation area.

Contractor Work Performed Onsite:

Creamer Environmental, Inc (CEI), Bay Crane and Gound/Water Treatment and Technologies (GWTT) continued placing new filter media (carbon and organoclay) in the Water Treatment System (WTS). Repairs to the damaged pipe screens in the vessels continued. Previously removed media from the WTS was staged within the proposed Gas Holder 4 excavation area for future disposal. CEI started to remove steel pins from the temporary fabric structure (TFS) previously located on the east and west areas of the site in preparation of relocation of the TFS within the upcoming Gas Holder 4 excavation area.

CEI cut walers and fabricated chairs for upcoming work associated with support of excavation installation for Gas Holder 4. Sunbelt demobilized a telescopic boom lift JLG 600S and mobilized a telescopic boom lift JLG 800S and one articulating boom lift JLG 1250AJP to the site. Dust and odor control measures (application of Atmos foam, wetting, tarping, limiting vehicle speeds, etc.) continued to be performed to ensure there were no impacts to the neighborhood.

Air Monitoring:

- No VOC or dust exceedances were observed from the community air monitoring program (CAMP).
- GZANY to provide a summary report of CAMP activities separately.

Erosion and Sediment Control:

- None.

Sampling Conducted:

- None.

Other Items of Note:

- Construction activities were observed as part of the ongoing combined sewer overflow (CSO) project west of Nevins Street.
- Construction activities were performed at an empty lot south of Sackett Street.

**DAILY STATUS REPORT**

PROJECT:	Former Fulton MGP – Parcels III and IV (Site No.: 224051)
ADDRESS:	545 Sackett St., Brooklyn, NY
PREPARED BY:	Roux Environmental Engineering and Geology, D.P.C.
DATE:	July 15, 2024
WEATHER:	Temp: 74-94°F, Cloudy, RH: 81% Pressure: 29.91 in Hg Wind: SSW @ 6 mph
TIME:	07:00 – 15:15

Imported Material

Name - Location	Source	During This Reporting Period		Total	
		Loads	Tons	Loads	Tons
Vulcan ASTM #3 (1 ½" Stone)	Vulcan Hamburg Quarry			11	279.71
Vulcan ASTM #57 (3/4" Stone)	Vulcan Hamburg Quarry			6	152.05
Vulcan General Fill	Vulcan Wantage Quarry			1,200	29,913.85

Exported Material

Material	Facility	During This Reporting Period		Total	
		Loads	Tons	Loads	Tons
TCE Impacted Haz Hot Spots	CWM Emelle			7	161.72
Cd Impacted Haz Material from WC-5	CWM Emelle			3	49.45
Pb Impacted Haz from Parcel IV Hot Spot	CWM Emelle			25	536.72
Cd Impacted Haz Material from WC-5	Clean Earth (CE) NJ			16	397.75
Concrete for Recycling	Bayshore			27	~509.87
Concrete for Landfill	WM Fairless			63	~1,415.93
Urban Fill for CVOC Orange Zone (Lot 17)	WM Fairless Urban Fill-OZ			47	~1034
Urban Fill for CVOC Orange Zone (Lot 49)	WM Fairless Urban Fill-OZ			24	~528
Non-Haz Urban Fill (Lot 17)	CE Carteret			42	~924
Non-Haz Urban Fill (Lot 49)	CE Carteret			73	~1,606
MGP soil with TCE>25 ppm	CE ESMI			181	~3,906
	CE Southeast Pennsylvania			10	~220
	CMW Emelle			404	~7,880
Non-Haz MGP Impacted (TCLP Benzene > 0.5)	CE Southeast Pennsylvania			8	~237.97
Non-Haz MGP Impacted (TCLP Benzene < 0.5)	CE Southeast Pennsylvania			119	~2,614
Non-Haz Contaminated Urban Fill	WM Fairless			387	~8,134.69
Non-Haz Urban Fill	CE Carteret -BZ			71	~1,562
Non-Haz MGP Impacted	CE of New Castle			35	~770
MGP Impacted (TCLP Benzene 0.2<x<0.5 mg/l)	CE Southeast Pennsylvania			5	~110

Exported Material Truck Log

Number	Excavation Grid	Disposal Facility	Disposal Profile	Manifest Number	Trucking Company	Truck License Plate
None						

Dewatering

Date	Time	Totalizer Reading
7/15/24	15:15	100,823,700
Water treated and discharged to NYCDEP sewer since last report:		0

PROJECT:	Former Fulton MGP – Parcels III and IV (Site No.: 224051)
ADDRESS:	545 Sackett St., Brooklyn, NY
PREPARED BY:	Roux Environmental Engineering and Geology, D.P.C.
DATE:	July 15, 2024
WEATHER:	Temp: 74-94°F, Cloudy, RH: 81% Pressure: 29.91 in Hg Wind: SSW @ 6 mph
TIME:	07:00 – 15:15

Anticipated Upcoming Work Activities

- Continue carbon media change out activities in the Water Treatment System.
- Continue Site preparation for future onsite work and relocation of the TFS.

Site Layout

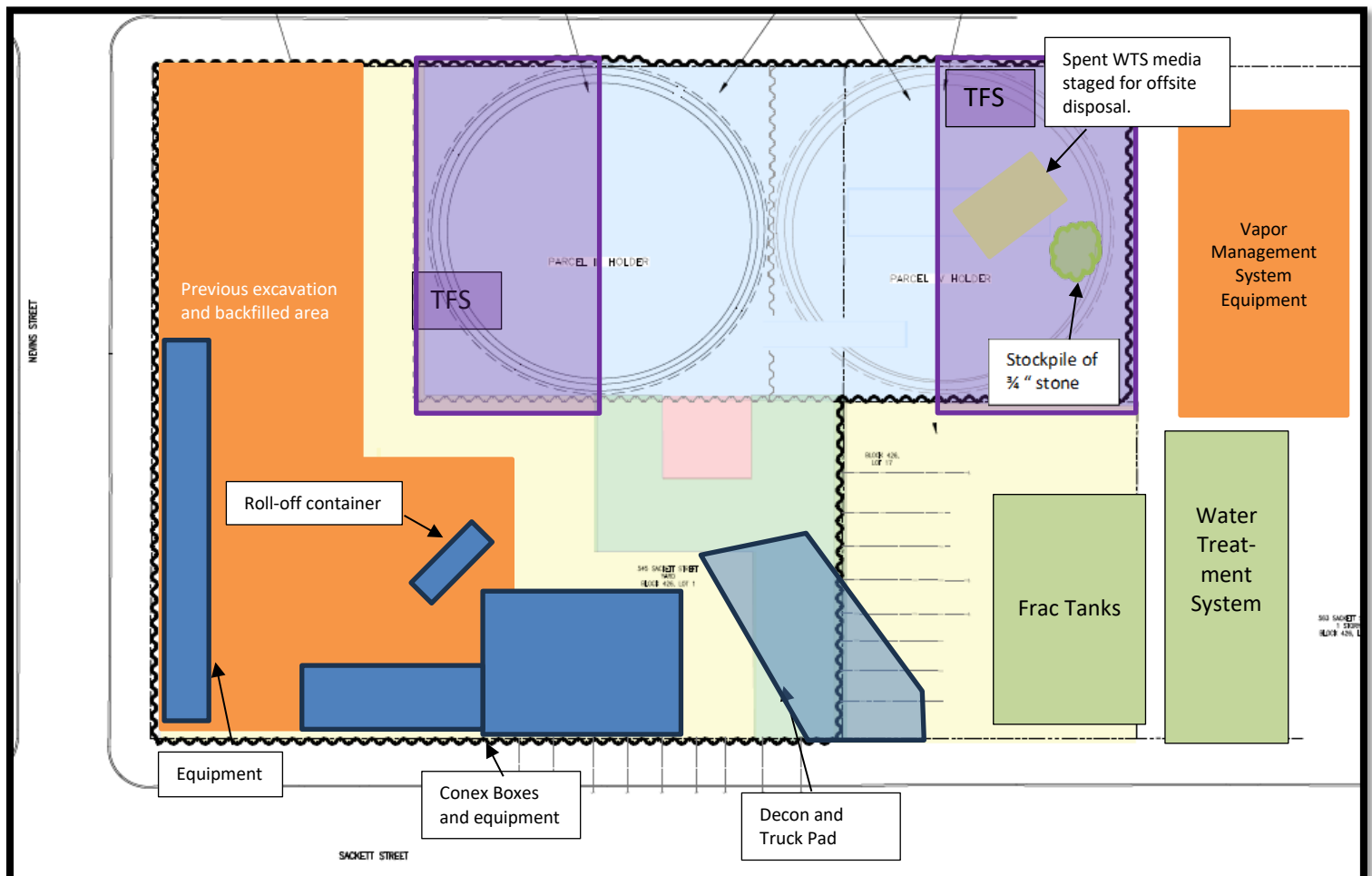

PROJECT:	Former Fulton MGP – Parcels III and IV (Site No.: 224051)
ADDRESS:	545 Sackett St., Brooklyn, NY
PREPARED BY:	Roux Environmental Engineering and Geology, D.P.C.
DATE:	July 15, 2024
WEATHER:	Temp: 74-94°F, Cloudy, RH: 81% Pressure: 29.91 in Hg Wind: SSW @ 6 mph
TIME:	07:00 – 15:15

Excavation Diagram

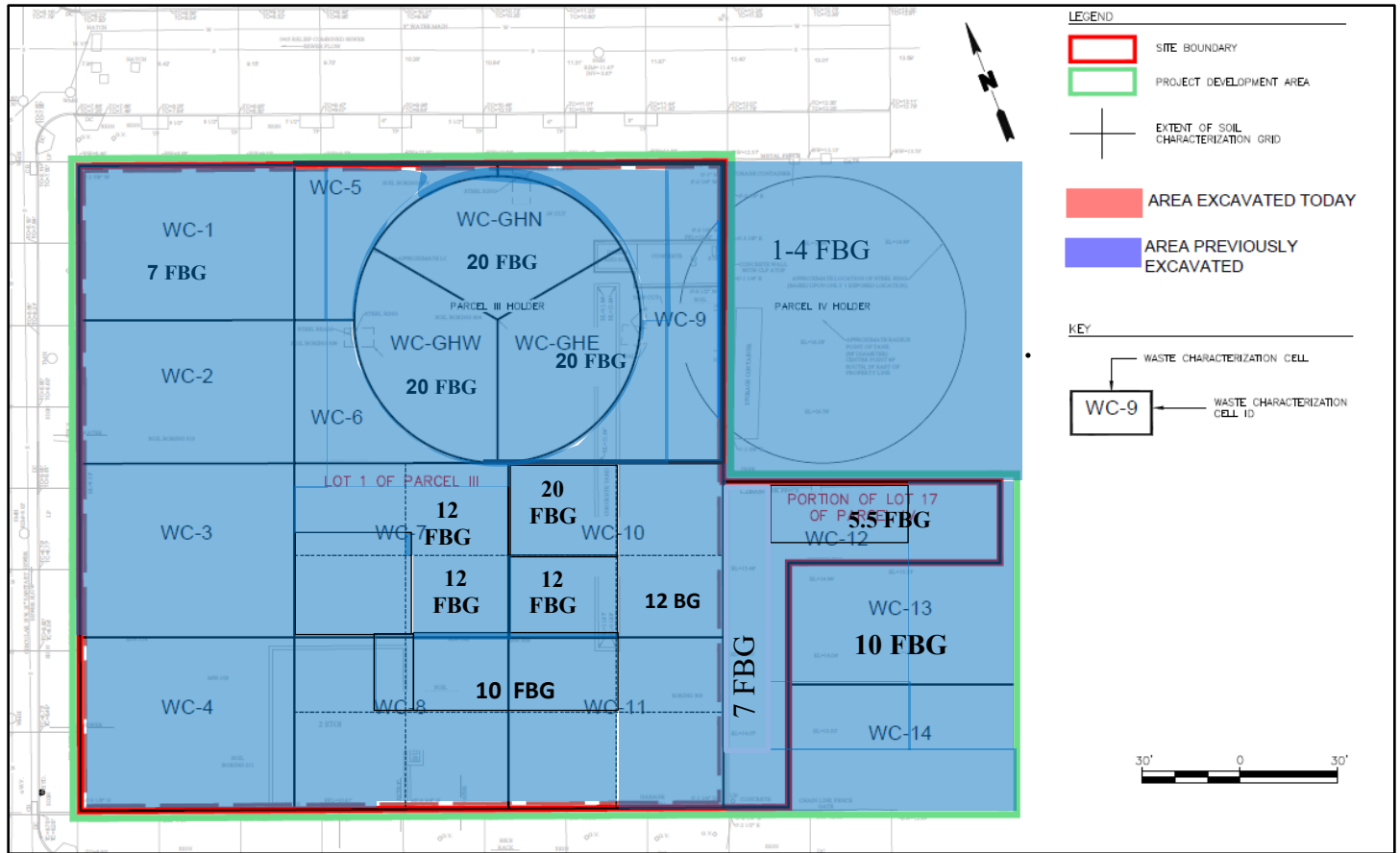

PROJECT:	Former Fulton MGP – Parcels III and IV (Site No.: 224051)
ADDRESS:	545 Sackett St., Brooklyn, NY
PREPARED BY:	Roux Environmental Engineering and Geology, D.P.C.
DATE:	July 15, 2024
WEATHER:	Temp: 74-94°F, Cloudy, RH: 81% Pressure: 29.91 in Hg Wind: SSW @ 6 mph
TIME:	07:00 – 15:15



Photo 1:

Looking south, view of CEI staging new filter media material to be placed in the WTS.



Photo 2:

Looking southeast, view of Bay Crane assisting CEI fill the WTS vessels with new filter media.

PROJECT:	Former Fulton MGP – Parcels III and IV (Site No.: 224051)
ADDRESS:	545 Sackett St., Brooklyn, NY
PREPARED BY:	Roux Environmental Engineering and Geology, D.P.C.
DATE:	July 15, 2024
WEATHER:	Temp: 74-94°F, Cloudy, RH: 81% Pressure: 29.91 in Hg Wind: SSW @ 6 mph
TIME:	07:00 – 15:15



Photo 3:
Looking southwest, view of CEI removing steel pins from the base plates in preparation of relocation of the TFS.