

APPROXIMATE LOCATION OF SMP SITE

- CS-1 LOCATION AND DESIGNATION OF PREVIOUS SOIL BORING
- TSB-9 LOCATION AND DESIGNATION OF SOIL BORING AND TEMPORARY GEOPROBE GROUNDWATER SAMPLING POINT
- HD-1 LOCATION AND DESIGNATION OF SUPPLEMENTAL RI SOIL BORING
- MW-50 LOCATION AND DESIGNATION OF SPH SAMPLE

- MHS-3 LOCATION AND DESIGNATION OF SEWER SEDIMENT ("S") AND WATER ("W") SAMPLE
- MHW-3 LOCATION AND DESIGNATION OF SEWER WATER SAMPLE
- CB-4 LOCATION AND DESIGNATION OF CATCH BASIN WATER SAMPLE
- MW-16 LOCATION AND DESIGNATION OF MONITORING WELL
- MW-54 LOCATION AND DESIGNATION OF FORMER MONITORING WELL INSTALLED BY ROUX ASSOCIATES, INC.

- RT-1 LOCATION AND DESIGNATION OF PHASE I IRM RECOVERY TRENCH
- RW-1 LOCATION AND DESIGNATION OF PHASE II IRM RECOVERY WELLS
- PHASE III IRM INTERCEPTOR TRENCH

- APPROXIMATE BOUNDARY OF HISTORIC SPH PLUME (ZERO CONTOUR)
- AREA REMEDIATED TO 0.5 FT BELOW HISTORIC GRADE (1985-1986)
- AREA REMEDIATED TO 2 FT BELOW HISTORIC GRADE (1998)
- AREA REMEDIATED TO BETWEEN 3 AND 8 FT BELOW HISTORIC GRADE (1999)

- OU-3 BOUNDARY
- LIMIT OF AREA PREVIOUSLY ADDRESSED DURING HST CONSTRUCTION
- LOCATION AND DESIGNATION OF TEST PIT
- SEWER LINE (DASHED WHERE INFERRED), WITH MANHOLE DESIGNATION (OU-5)
- APPROXIMATE EXTENT OF VISUAL HYDROCARBON-IMPACTED SURFACE SOIL

- NOTES**
- IRM - INTERIM REMEDIAL MEASURE
  - SPH - SEPARATE-PHASE HYDROCARBON
  - OU-3 - OPERABLE UNIT 3
  - RI - REMEDIAL INVESTIGATION
  - HST - HIGH SPEED TRAINSET
  - SMP - STANDARD MOTOR PRODUCTS
  - LIRR - LONG ISLAND RAIL ROAD

**SAMPLE LOCATIONS**

PROPOSED REMEDIAL ACTION PLAN  
SUNNYSIDE YARD, QUEENS, NEW YORK

Prepared For: **AMTRAK**

	Completed by RSK Prepared by RSK Project No. 105	Date: 11/20/05 Scale: AS SHOWN Office: NY	PLATE <b>2</b>
--	--------------------------------------------------------	-------------------------------------------------	-------------------

Roux Associates Inc. Environmental Consulting & Management File No. AMR51982 Project 0545111

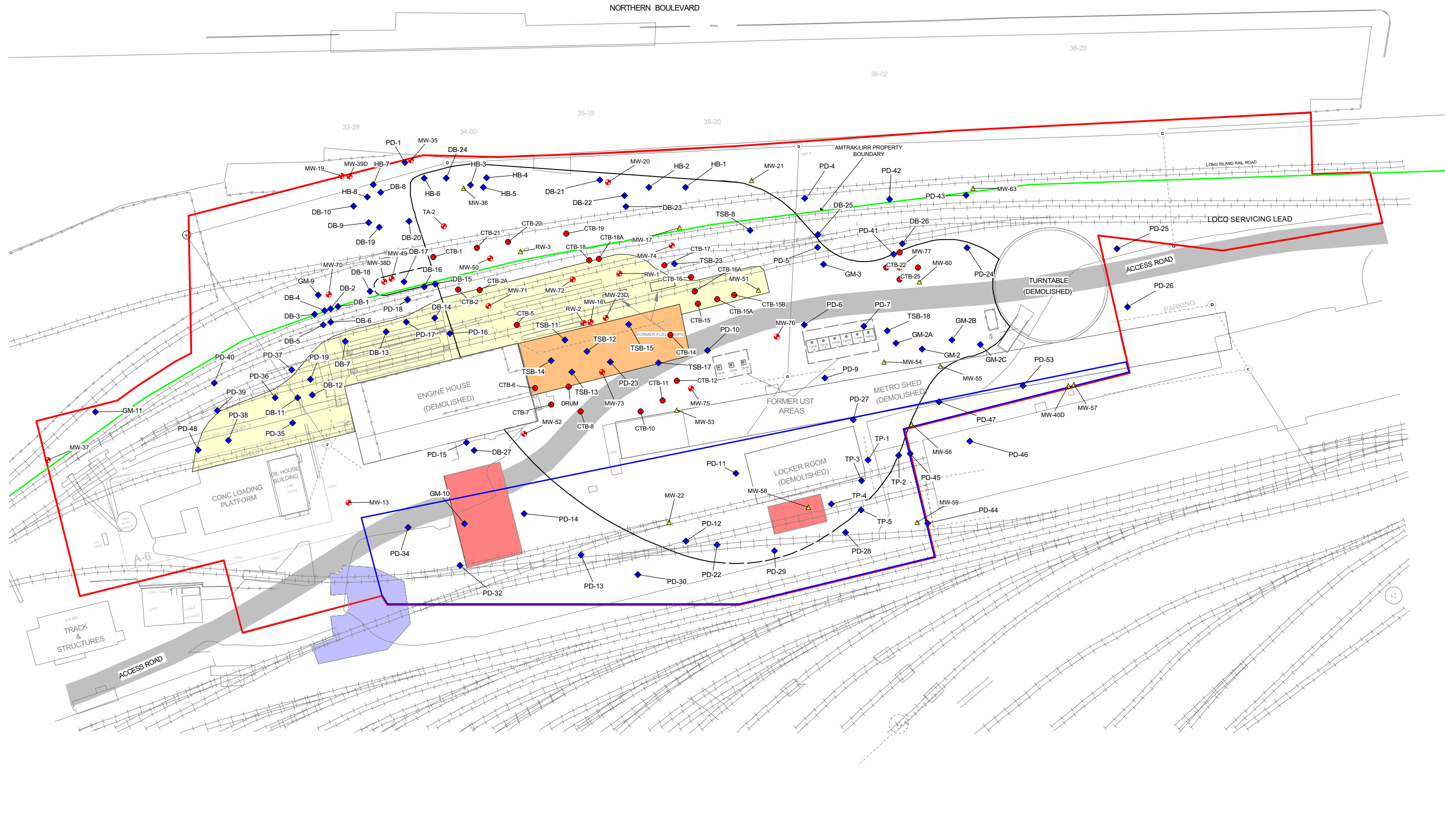

- CTB-1 ● LOCATION AND DESIGNATION OF PRE-DELINEATION OBSERVATION BORING
- DB-18 ◆ LOCATION AND DESIGNATION OF HAND BORING COMPLETED FOR SPH DELINEATION PURPOSES
- MW-16 ● LOCATION AND DESIGNATION OF MONITORING WELL
- MW-54 ▲ LOCATION AND DESIGNATION OF FORMER MONITORING WELL INSTALLED BY ROUX ASSOCIATES, INC.

- AREA REMEDIATED TO 0.5 FT BELOW HISTORIC GRADE (1985-1986)
- AREA REMEDIATED TO 2 FT BELOW HISTORIC GRADE (1998)
- AREA REMEDIATED TO BETWEEN 3 AND 8 FT BELOW HISTORIC GRADE (1999)

- OU-3 BOUNDARY
- LIMIT OF AREA PREVIOUSLY ADDRESSED DURING HST CONSTRUCTION
- APPROXIMATE EXTENT OF VISUAL HYDROCARBON-IMPACTED SURFACE SOIL
- APPROXIMATE BOUNDARY OF HISTORIC SPH PLUME (ZERO CONTOUR)

- NOTES**
- HB - HAND BORINGS COMPLETED IN 1991
  - PD - HAND BORINGS COMPLETED IN 1993
  - GM - HAND BORINGS COMPLETED IN 1993
  - TP - HAND BORINGS COMPLETED IN 1996
  - DB - HAND BORINGS COMPLETED IN 1999
  - TSB - BORINGS COMPLETED IN 2000

- OU-3 - OPERABLE UNIT 3
- RI - REMEDIAL INVESTIGATION
- HST - HIGH SPEED TRAINSET
- LIRR - LONG ISLAND RAIL ROAD

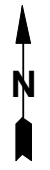
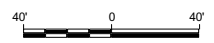

**SPH OBSERVATION BORINGS**

PROPOSED REMEDIAL ACTION PLAN  
SUNNYSIDE YARD, QUEENS, NEW YORK



Prepared by: RSK  
Date: 11/20/06  
Scale: AS SHOWN  
Project Mgr: HG  
Office: NY  
Project: 05449111

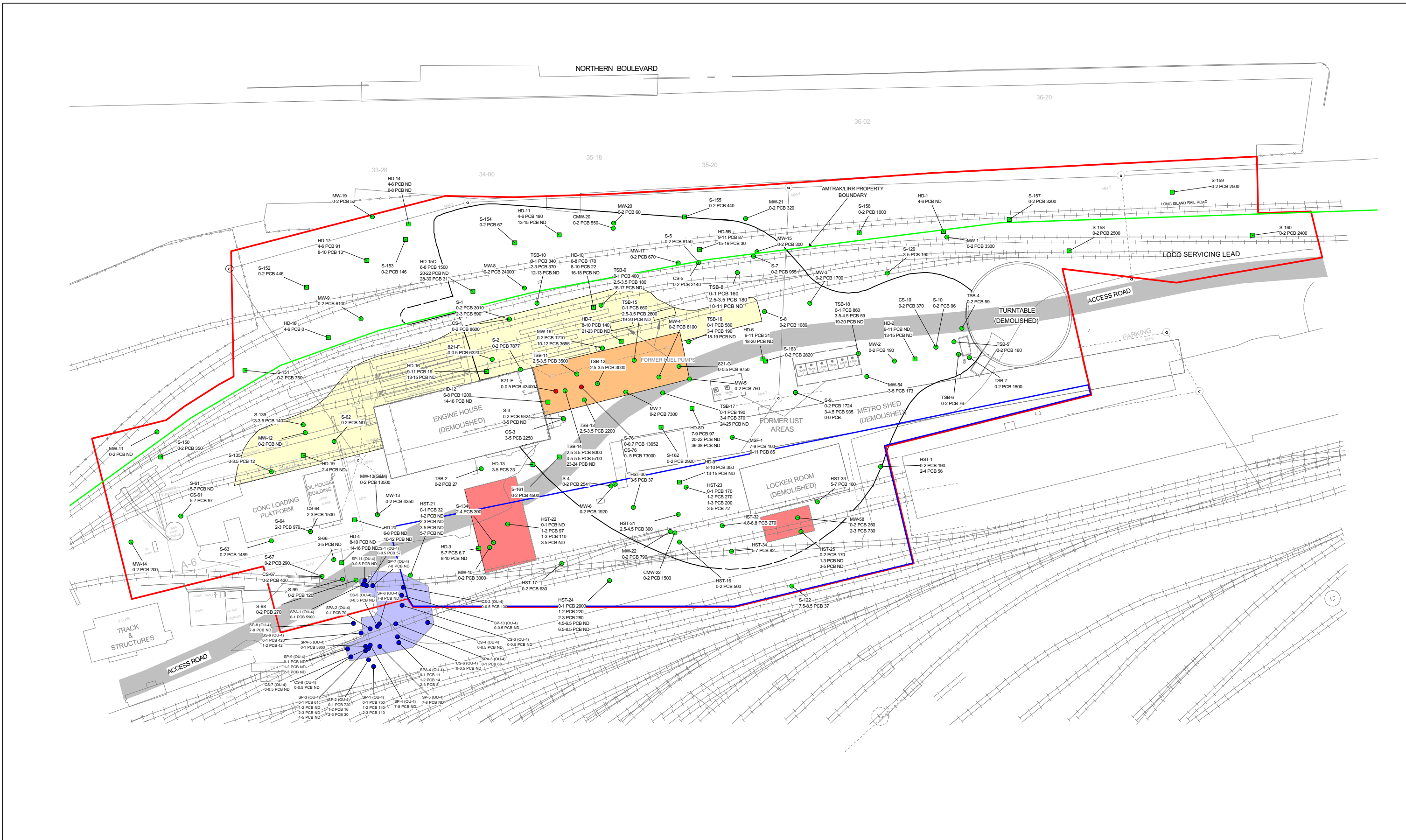

**SOIL SAMPLE EXPLANATION**

DESIGNATION	PCB CONCENTRATION IN SOIL (UG/KG)
HD-10	6-8 PCB 170
	8-10 PCB 22
	16-18 PCB 0

TOTAL PCB CONCENTRATION IN SOIL (UG/KG)

SAMPLE DEPTH (FT BLS)

- HD-1 LOCATION AND DESIGNATION OF SUPPLEMENTAL RI SOIL BORING WITH ALL COLLECTED SAMPLE INTERVALS LESS THAN THE NYSDEC APPROVED SOIL CLEANUP LEVEL FOR PCBs
- S-61 LOCATION AND DESIGNATION OF PREVIOUS SOIL BORING WITH ALL COLLECTED SAMPLE INTERVALS LESS THAN THE NYSDEC APPROVED SOIL CLEANUP LEVEL FOR PCBs
- 821-E LOCATION AND DESIGNATION OF PREVIOUS SOIL BORING WITH ONE SAMPLE INTERVAL EXCEEDING THE NYSDEC APPROVED SOIL CLEANUP LEVEL FOR PCBs
- SP-1 (OU-4) LOCATION AND DESIGNATION OF PREVIOUS SOIL BORING COLLECTED IN ASSOCIATION WITH THE AREA 7 SOIL EXCAVATION WITH ALL SAMPLE INTERVALS LESS THAN THE NYSDEC APPROVED SOIL CLEANUP LEVEL FOR PCBs

- EXPLANATION**
- APPROXIMATE BOUNDARY OF HISTORIC SPH PLUME (ZERO CONTOUR)
  - AREA REMEDIATED TO 0.5 FT BELOW HISTORIC GRADE (1985-1986)
  - AREA REMEDIATED TO 2 FT BELOW HISTORIC GRADE (1998)
  - AREA REMEDIATED TO BETWEEN 3 AND 8 FT BELOW HISTORIC GRADE (1999)

- OU-3 BOUNDARY
- LIMIT OF AREA PREVIOUSLY ADDRESSED DURING HST CONSTRUCTION
- SEWER LINE (DASHED WHERE INFERRED), WITH MANHOLE DESIGNATION
- APPROXIMATE EXTENT OF VISUAL HYDROCARBON-IMPACTED SURFACE SOIL

**NOTES**

NYSDEC RECOMMENDED CLEANUP LEVEL FOR PCBs - 25,000 UG/KG

NYSDEC - NEW YORK STATE DEPARTMENT OF ENVIRONMENTAL CONSERVATION

SPH - SEPARATE-PHASE HYDROCARBON

OU-3 - OPERABLE UNIT 3

PCB - POLYCHLORINATED BIPHENYL

UG/KG - MICROGRAM PER KILOGRAM

FT BLS - FEET BELOW LAND SURFACE

RI - REMEDIAL INVESTIGATION

LIRR - LONG ISLAND RAIL ROAD

HST - HIGH SPEED TRAINSET

ND - NOT DETECTED

Scale: AS SHOWN

Office: NY

**TOTAL PCB CONCENTRATIONS IN SOIL**

PROPOSED REMEDIAL ACTION PLAN

SUNNYSIDE YARD, QUEENS, NEW YORK

Prepared For: **AMTRAK**

Prepared by: **ROUX**

Scale: AS SHOWN

Office: NY

PLATE 4

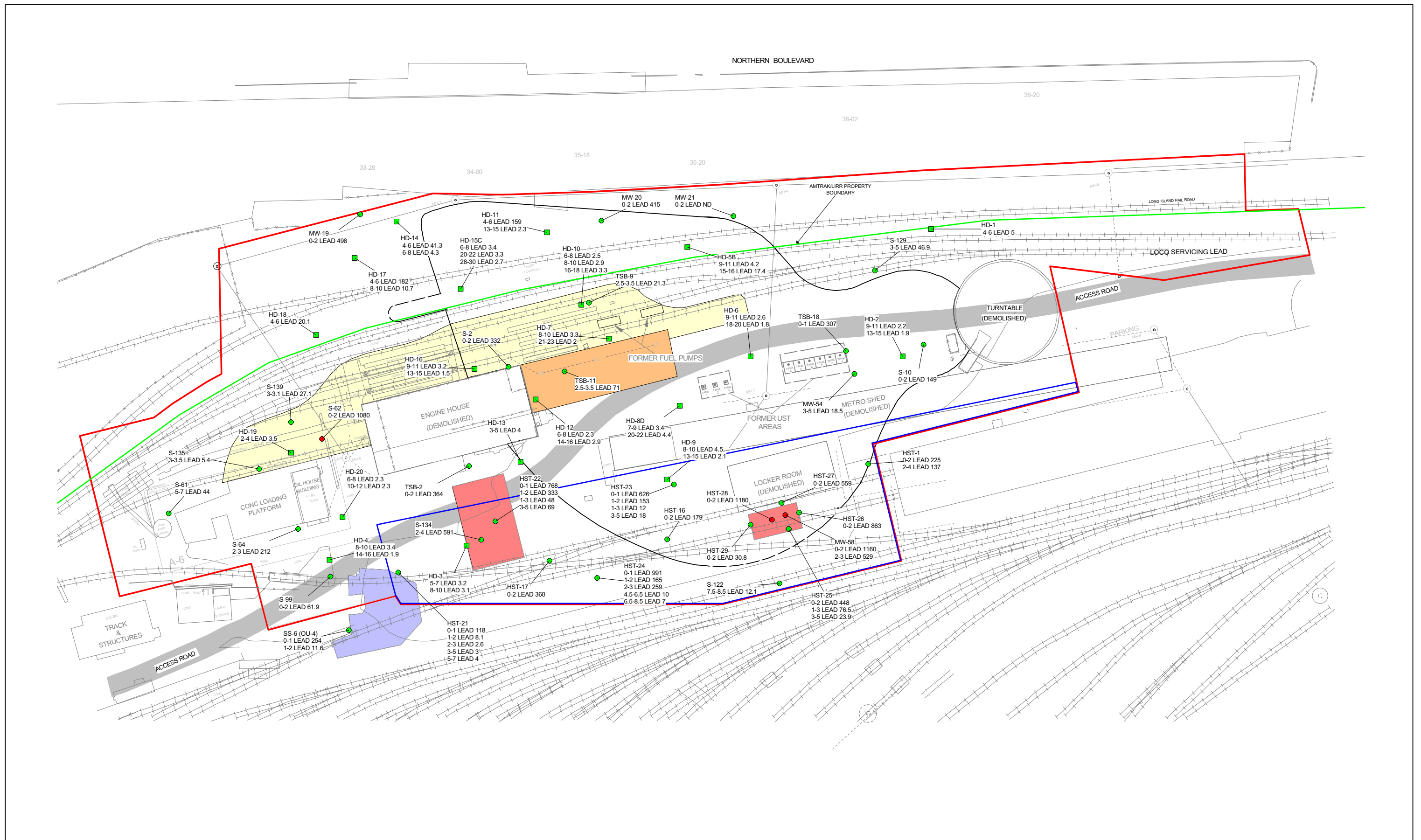

<p><b>SOIL SAMPLE EXPLANATION</b></p> <p>DESIGNATION</p> <p>HD-10</p> <p>6-8 LEAD 2.5</p> <p>8-10 LEAD 2.9</p> <p>16-18 LEAD 3.3</p> <p>LEAD CONCENTRATION IN SOIL (MG/KG)</p> <p>SAMPLE DEPTH (FT BLS)</p>	<p>HD-1 LOCATION AND DESIGNATION OF SUPPLEMENTAL RI SOIL BORING WITH ALL COLLECTED SAMPLE INTERVALS LESS THAN THE NYSDEC APPROVED SOIL CLEANUP LEVEL FOR LEAD</p> <p>S-61 LOCATION AND DESIGNATION OF PREVIOUS SOIL BORING WITH ALL COLLECTED SAMPLE INTERVALS LESS THAN THE NYSDEC APPROVED SOIL CLEANUP LEVEL FOR LEAD</p> <p>HST-28 LOCATION AND DESIGNATION OF PREVIOUS SOIL BORING WITH ONE SAMPLE INTERVAL EXCEEDING THE NYSDEC APPROVED SOIL CLEANUP LEVEL FOR LEAD</p>	<p><b>EXPLANATION</b></p> <p>APPROXIMATE BOUNDARY OF HISTORIC SPH PLUME (ZERO CONTOUR)</p> <p>AREA REMEDIATED TO 0.5 FT BELOW HISTORIC GRADE (1985-1986)</p> <p>AREA REMEDIATED TO 2 FT BELOW HISTORIC GRADE (1998)</p> <p>AREA REMEDIATED TO BETWEEN 3 AND 8 FT BELOW HISTORIC GRADE (1999)</p>	<p><b>EXPLANATION</b></p> <p>OU-3 BOUNDARY</p> <p>LIMIT OF AREA PREVIOUSLY ADDRESSED DURING HST CONSTRUCTION</p> <p>SEWER LINE (DASHED WHERE INFERRED), WITH MANHOLE DESIGNATION</p> <p>APPROXIMATE EXTENT OF VISUAL HYDROCARBON-IMPACTED SURFACE SOIL</p>	<p><b>NOTES</b></p> <p>NYSDEC RECOMMENDED CLEANUP LEVEL FOR LEAD - 1,000 MG/KG</p> <p>NYSDEC - NEW YORK STATE DEPARTMENT OF ENVIRONMENTAL CONSERVATION</p> <p>OU-3 - OPERABLE UNIT 3</p> <p>MG/KG - MICROGRAM PER KILOGRAM</p> <p>FT BLS - FEET BELOW LAND SURFACE</p>	<p>SPH - SEPARATE-PHASE HYDROCARBON</p> <p>RI - REMEDIAL INVESTIGATION</p> <p>LIRR - LONG ISLAND RAIL ROAD</p> <p>ND - NOT DETECTED</p> <p>HST - HIGH SPEED TRAINSET</p> <p>0 40 40</p>	<p><b>TOTAL LEAD CONCENTRATIONS IN SOIL</b></p> <p>PROPOSED REMEDIAL ACTION PLAN</p> <p>SUNNYSIDE YARD, QUEENS, NEW YORK</p> <p>AMTRAK</p> <p>ROUX ASSOCIATES INC.</p> <p>Completed by RSK Date: 11/4/2005</p> <p>Prepared by RSK Scale: AS SHOWN</p> <p>Project No. 05549111</p> <p>PLATE 5</p>
-------------------------------------------------------------------------------------------------------------------------------------------------------------------------------------------------------------	--------------------------------------------------------------------------------------------------------------------------------------------------------------------------------------------------------------------------------------------------------------------------------------------------------------------------------------------------------------------------------------------------------------------------------------------------------------------------------	--------------------------------------------------------------------------------------------------------------------------------------------------------------------------------------------------------------------------------------------------------------------------------------------------	------------------------------------------------------------------------------------------------------------------------------------------------------------------------------------------------------------------------------------------------------------	------------------------------------------------------------------------------------------------------------------------------------------------------------------------------------------------------------------------------------------------------------------------	-----------------------------------------------------------------------------------------------------------------------------------------------------------------------------------------	--------------------------------------------------------------------------------------------------------------------------------------------------------------------------------------------------------------------------------------------------------------------------------------------------

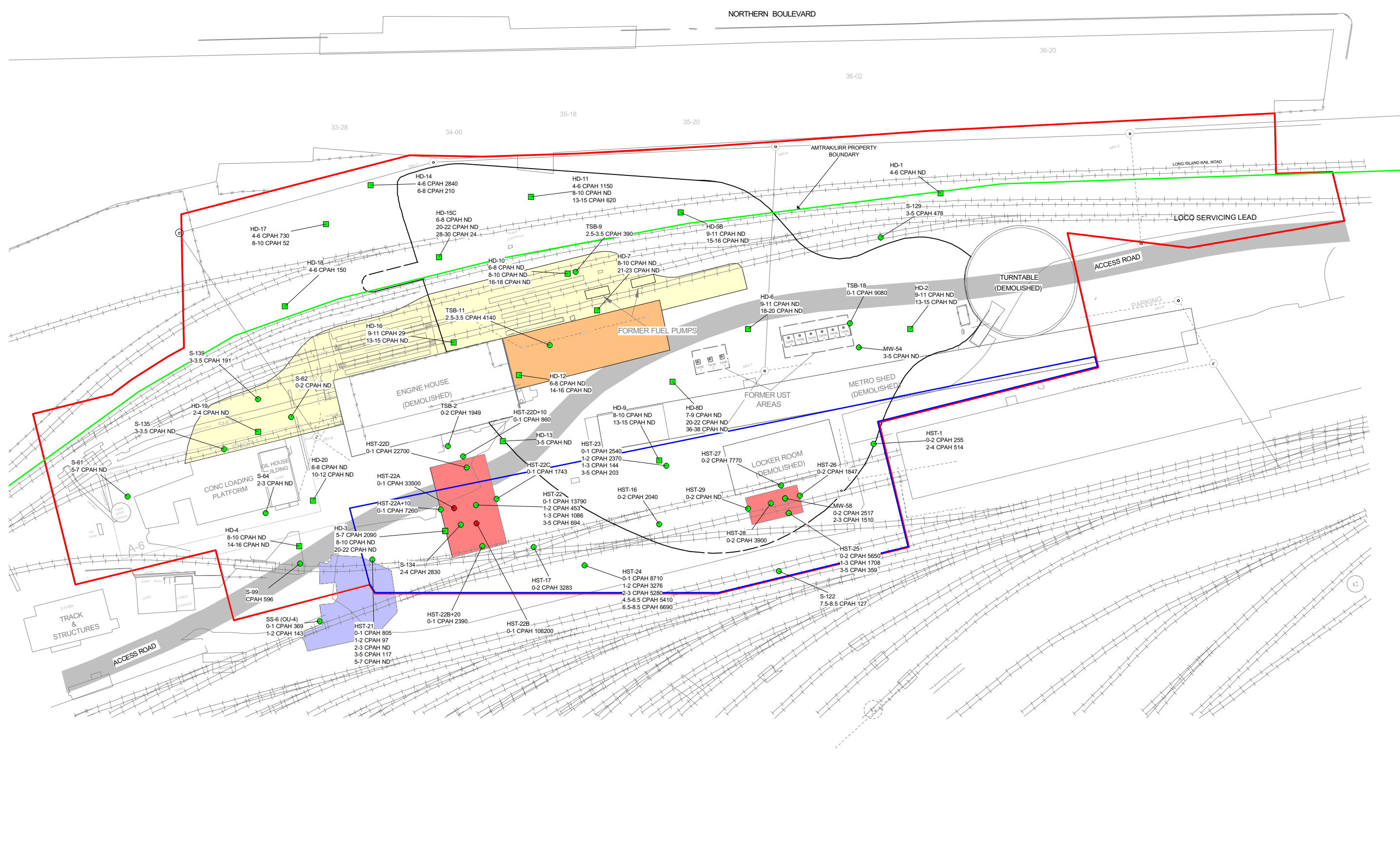

SOIL SAMPLE EXPLANATION

DESIGNATION	HD-10	TOTAL CPAH CONCENTRATION IN SOIL (UG/KG)
SAMPLE DEPTH (FT BLS)	6-8 CPAH ND 8-10 CPAH ND 16-18 CPAH ND	

- HD-1 LOCATION AND DESIGNATION OF SUPPLEMENTAL RI SOIL BORING WITH ALL COLLECTED SAMPLE INTERVALS LESS THAN THE NYSDEC APPROVED SOIL CLEANUP LEVEL FOR CPAHS
- S-61 LOCATION AND DESIGNATION OF PREVIOUS SOIL BORING WITH ALL COLLECTED SAMPLE INTERVALS LESS THAN THE NYSDEC APPROVED SOIL CLEANUP LEVEL FOR CPAHS
- HST-22A LOCATION AND DESIGNATION OF PREVIOUS SOIL BORING WITH ONE SAMPLE INTERVAL EXCEEDING THE NYSDEC APPROVED SOIL CLEANUP LEVEL FOR CPAHS

EXPLANATION

- APPROXIMATE BOUNDARY OF HISTORIC SPH PLUME (ZERO CONTOUR)
- AREA REMEDIATED TO 0.5 FT BELOW HISTORIC GRADE (1985-1986)
- AREA REMEDIATED TO 2 FT BELOW HISTORIC GRADE (1998)
- AREA REMEDIATED TO BETWEEN 3 AND 8 FT BELOW HISTORIC GRADE (1999)
- OU-3 BOUNDARY
- LIMIT OF AREA PREVIOUSLY ADDRESSED DURING HST CONSTRUCTION
- SEWER LINE (DASHED WHERE INFERRED), WITH MANHOLE DESIGNATION
- APPROXIMATE EXTENT OF VISUAL HYDROCARBON-IMPACTED SURFACE SOIL

NOTES

- NYSDEC RECOMMENDED CLEANUP LEVEL FOR CPAHS - 25,000 UG/KG
- SPH - SEPARATE-PHASE HYDROCARBON
- NYSDEC - NEW YORK STATE DEPARTMENT OF ENVIRONMENTAL CONSERVATION
- OU-3 - OPERABLE UNIT 3
- CPAH - SEVEN SPECIFIC POLYCYCLIC AROMATIC HYDROCARBONS CONSIDERED BY THE NYSDEC TO BE CARCINOGENIC

- HST - HIGH SPEED TRAINSET
- UG/KG - MICROGRAM PER KILOGRAM
- FT BLS - FEET BELOW LAND SURFACE
- RI - REMEDIAL INVESTIGATION
- LIRR - LONG ISLAND RAIL ROAD
- ND - NOT DETECTED

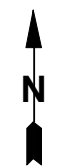

**TOTAL CPAH CONCENTRATIONS IN SOIL**

PROPOSED REMEDIAL ACTION PLAN  
SUNNYSIDE YARD, QUEENS, NEW YORK

Prepared For: **AMTRAK**

ROUX ASSOCIATES INC. Environmental Sciences & Management

Prepared by: RSK  
Date: 11/4/2008  
Scale: AS SHOWN  
Project Mgr: JEC  
Office: NY  
Project: 0545111

PLATE 6

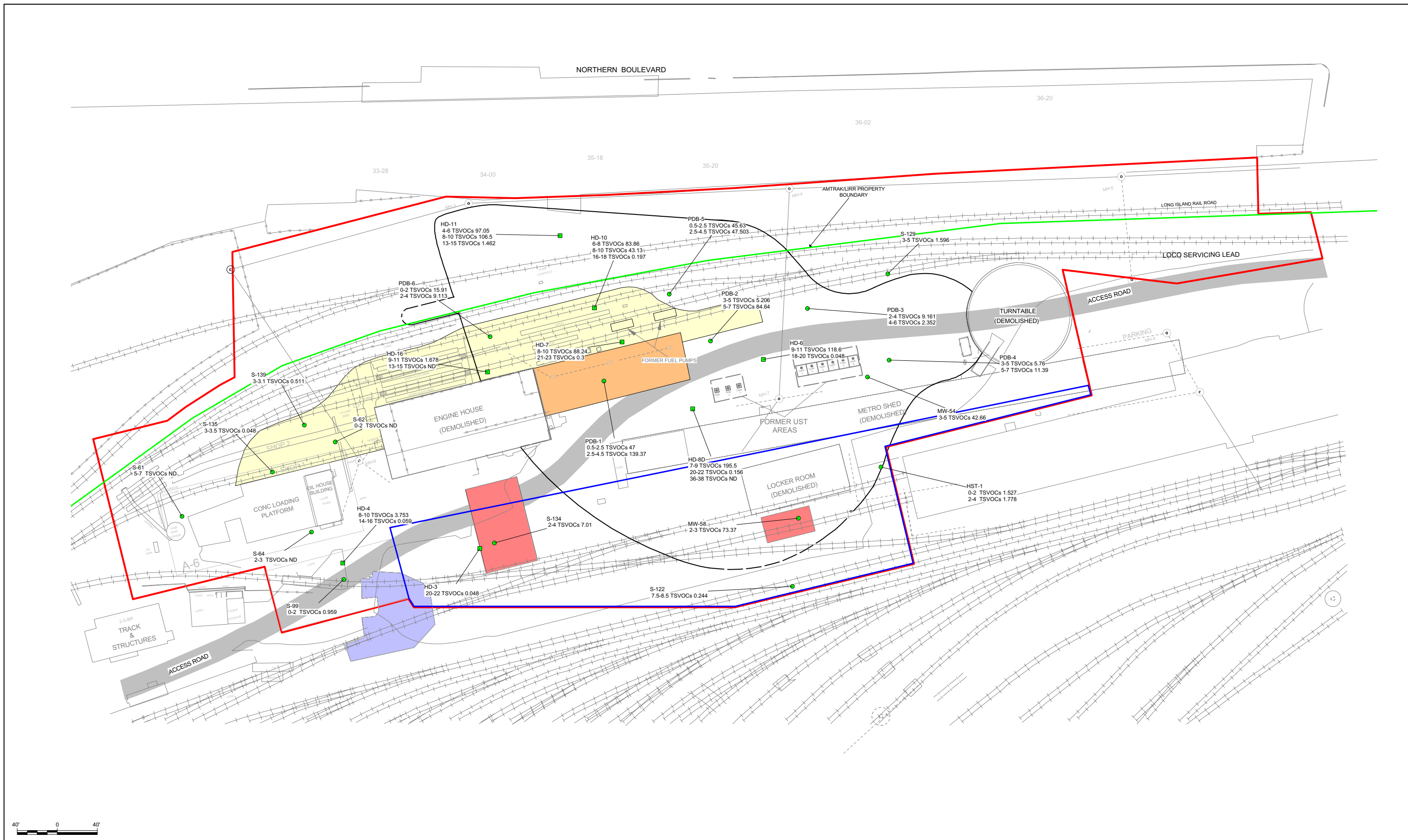

**SOIL SAMPLE EXPLANATION**

DESIGNATION	CONCENTRATION	TOTAL SVOC CONCENTRATION IN SOIL (MG/KG)
HD-8D	7-9 TSVOCs 195.5 20-22 TSVOCs 0.156 36-38 TSVOCs ND	

SAMPLE DEPTH (FT BLS)

- HD-3 LOCATION AND DESIGNATION OF SUPPLEMENTAL RI SOIL BORING WITH SOIL SAMPLE(S) COLLECTED AND SUBMITTED FOR TSVOC ANALYSIS
- S-61 LOCATION AND DESIGNATION OF PREVIOUS SOIL BORING WITH SOIL SAMPLE(S) COLLECTED AND SUBMITTED FOR TSVOC ANALYSIS

- EXPLANATION**
- APPROXIMATE BOUNDARY OF HISTORIC SPH PLUME (ZERO CONTOUR)
  - AREA REMEDIATED TO 0.5 FT BELOW HISTORIC GRADE (1985-1986)
  - AREA REMEDIATED TO 2 FT BELOW HISTORIC GRADE (1998)
  - AREA REMEDIATED TO BETWEEN 3 AND 8 FT BELOW HISTORIC GRADE (1999)

- OU-3 BOUNDARY
- LIMIT OF AREA PREVIOUSLY ADDRESSED DURING HST CONSTRUCTION
- SEWER LINE (DASHED WHERE INFERRED), WITH MANHOLE DESIGNATION
- APPROXIMATE EXTENT OF VISUAL HYDROCARBON-IMPACTED SURFACE SOIL

**NOTES**

NYSDEC - NEW YORK STATE DEPARTMENT OF ENVIRONMENTAL CONSERVATION  
 SPH - SEPARATE-PHASE HYDROCARBON  
 OU-3 - OPERABLE UNIT 3  
 TSVOC - TOTAL SEMIVOLATILE ORGANIC COMPOUND

FT BLS - FEET BELOW LAND SURFACE  
 RI - REMEDIAL INVESTIGATION  
 LIRR - LONG ISLAND RAIL ROAD  
 HST - HIGH SPEED TRAINSET  
 ND - NOT DETECTED  
 MG/KG - MILLIGRAM PER KILOGRAM

THE TSVOC CONCENTRATION PRESENTED ON THIS FIGURE FOR EACH SAMPLE IS THE SUM OF ALL SVOCs DETECTED AS PART OF THE SVOC TARGET COMPOUND LIST (TCL) OF ANALYTES

**TOTAL SVOC CONCENTRATIONS IN SOIL**

PROPOSED REMEDIAL ACTION PLAN  
 SUNNYSIDE YARD, QUEENS, NEW YORK

AMTRAK

ROUX ASSOCIATES INC.  
 Environmental Consulting & Management

Prepared by: RSK Date: 01/20/08  
 Project Mgr.: HG Scale: AS SHOWN  
 Office: NY

PLATE 7

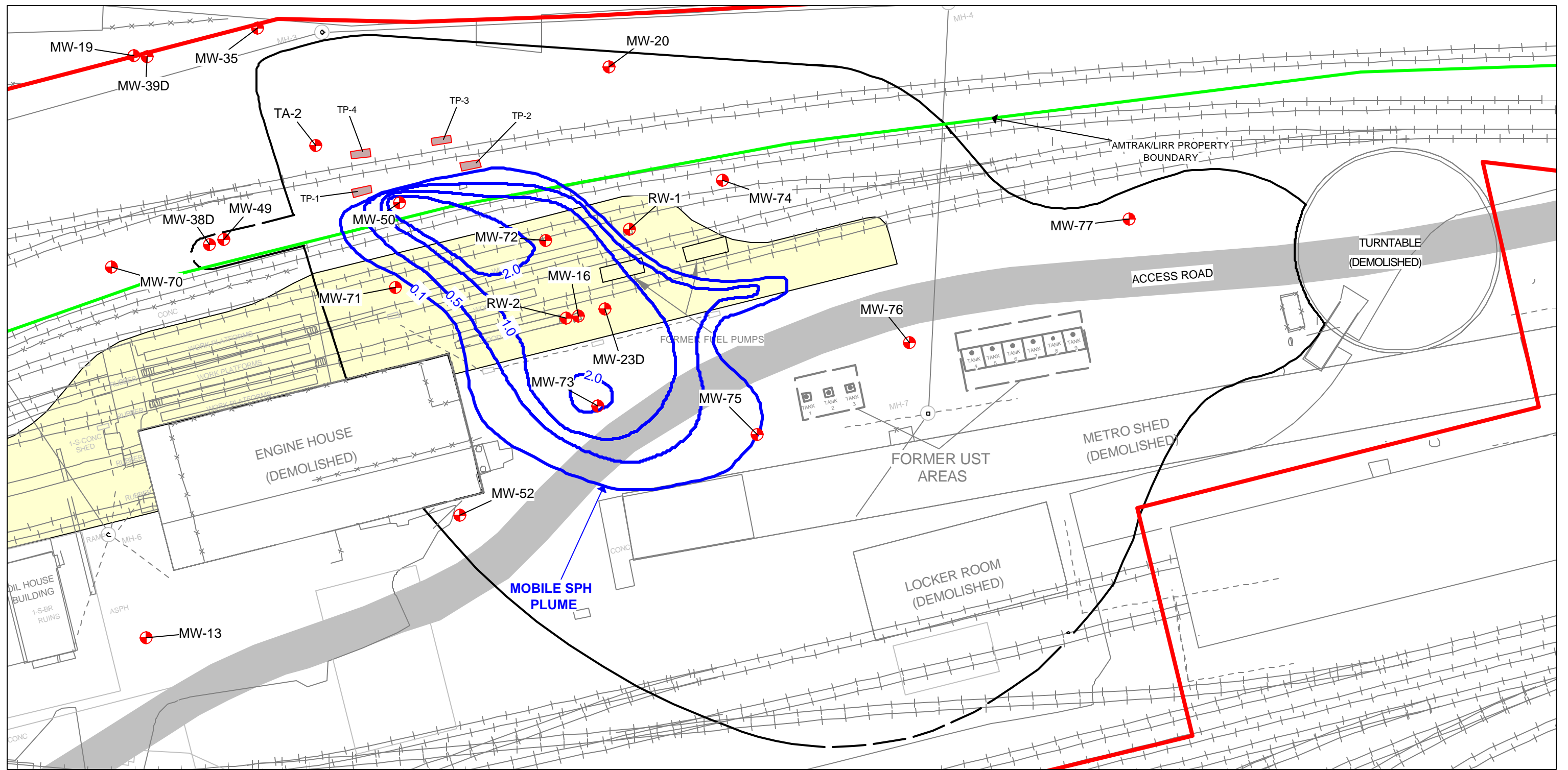

MW-16 LOCATION AND DESIGNATION OF MONITORING WELL

TP-1 LOCATION AND DESIGNATION OF TEST PIT NEAR FORMER HUMP TRACK

OU-3 BOUNDARY

2 CURRENT LINE OF EQUAL APPARENT SEPARATE-PHASE HYDROCARBON THICKNESS (MOBILE SPH PLUME)

APPROXIMATE BOUNDARY OF HISTORIC SPH PLUME (ZERO CONTOUR)

APPROXIMATE EXTENT OF VISUAL HYDROCARBON-IMPACTED SURFACE SOIL

**NOTES**

APPARENT SEPARATE-PHASE HYDROCARBON THICKNESS CONTOURS REPRESENT MONITORING DATA COLLECTED ON JUNE 8, 2005

SPH - SEPARATE-PHASE HYDROCARBON

OU-3 - OPERABLE UNIT 3

LIRR - LONG ISLAND RAIL ROAD

RI - REMEDIAL INVESTIGATION

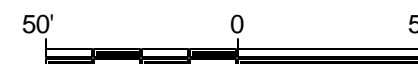

Title:

**CONFIGURATION OF MOBILE SPH PLUME**

PROPOSED REMEDIAL ACTION PLAN  
SUNNYSIDE YARD, QUEENS, NEW YORK

Prepared For:



**ROUX**  
Environmental Consulting  
& Management

Compiled by: RSK	Date: 11/4/2005
Prepared by: RSK	Scale: SHOWN
Project Mgr: HG	Office: NY
File No: AM4519807.WOR	Project: 05545Y11

FIGURE

8

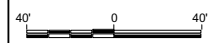
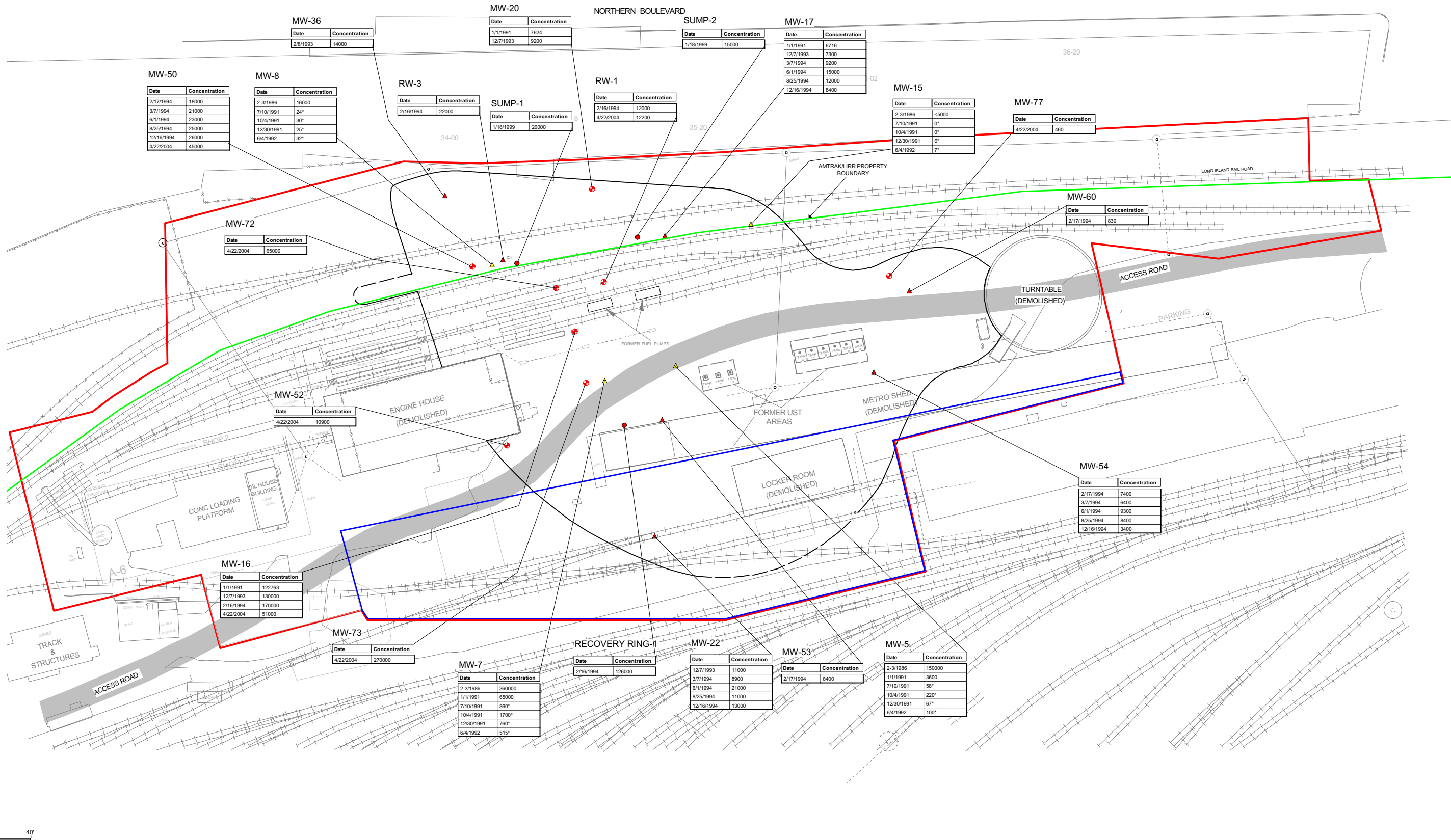

- LOCATION OF EXISTING MONITORING WELL WHERE SPH SAMPLE WAS COLLECTED FOR PCB ANALYSIS
- LOCATION OF SUMP ASSOCIATED WITH EITHER A FORMER OR EXISTING IRM SYSTEM WHERE SPH SAMPLE WAS COLLECTED FOR PCB ANALYSIS
- ▲ LOCATION OF FORMER ROUX MONITORING WELL WHERE SPH SAMPLE WAS COLLECTED FOR PCB ANALYSIS
- ▲ LOCATION OF FORMER GERAGHTY & MILLER MONITORING WELL WHERE SPH SAMPLE WAS COLLECTED FOR PCB ANALYSIS

**SPH SAMPLE EXPLANATION**

SPH SAMPLE DESIGNATION	DATE OF SAMPLE COLLECTION	CONCENTRATION
MW-73	4/22/2004	270000

SAMPLE CONCENTRATION IN UG/KG UNLESS NOTED WITH AN "\*" (SEE NOTE)



APPROXIMATE BOUNDARY OF HISTORIC SPH PLUME (ZERO CONTOUR)

- OPERABLE UNIT 3 BOUNDARY
- LIMIT OF AREA PREVIOUSLY ADDRESSED DURING HST CONSTRUCTION
- SEWER LINE (DASHED WHERE INFERRED), WITH MAN-HOLE DESIGNATION (OU-5)

**NOTES**  
 ALL CONCENTRATIONS ARE REPORTED IN UG/KG, UNLESS MARKED WITH AN "\*", WHICH INDICATES SAMPLE RESULT WAS REPORTED IN UGL  
 FOR REFERENCE, 1 UG/KG = 1 PART PER BILLION (PPB)  
 UG/KG - MICROGRAMS PER KILOGRAM  
 UGL - MICROGRAMS PER LITER  
 SPH - SEPARATE-PHASE HYDROCARBON

**TOTAL PCBs IN SPH**

PROPOSED REMEDIAL ACTION PLAN  
 SUNNYSIDE YARD, QUEENS, NEW YORK

Prepared For: **AMTRAK**

Prepared by: RSK  
 Date: 1/17/2005

Checked by: RSK  
 Date: 03/01/2005

Project Manager: RSK  
 Project: 05449111

PLATE 9



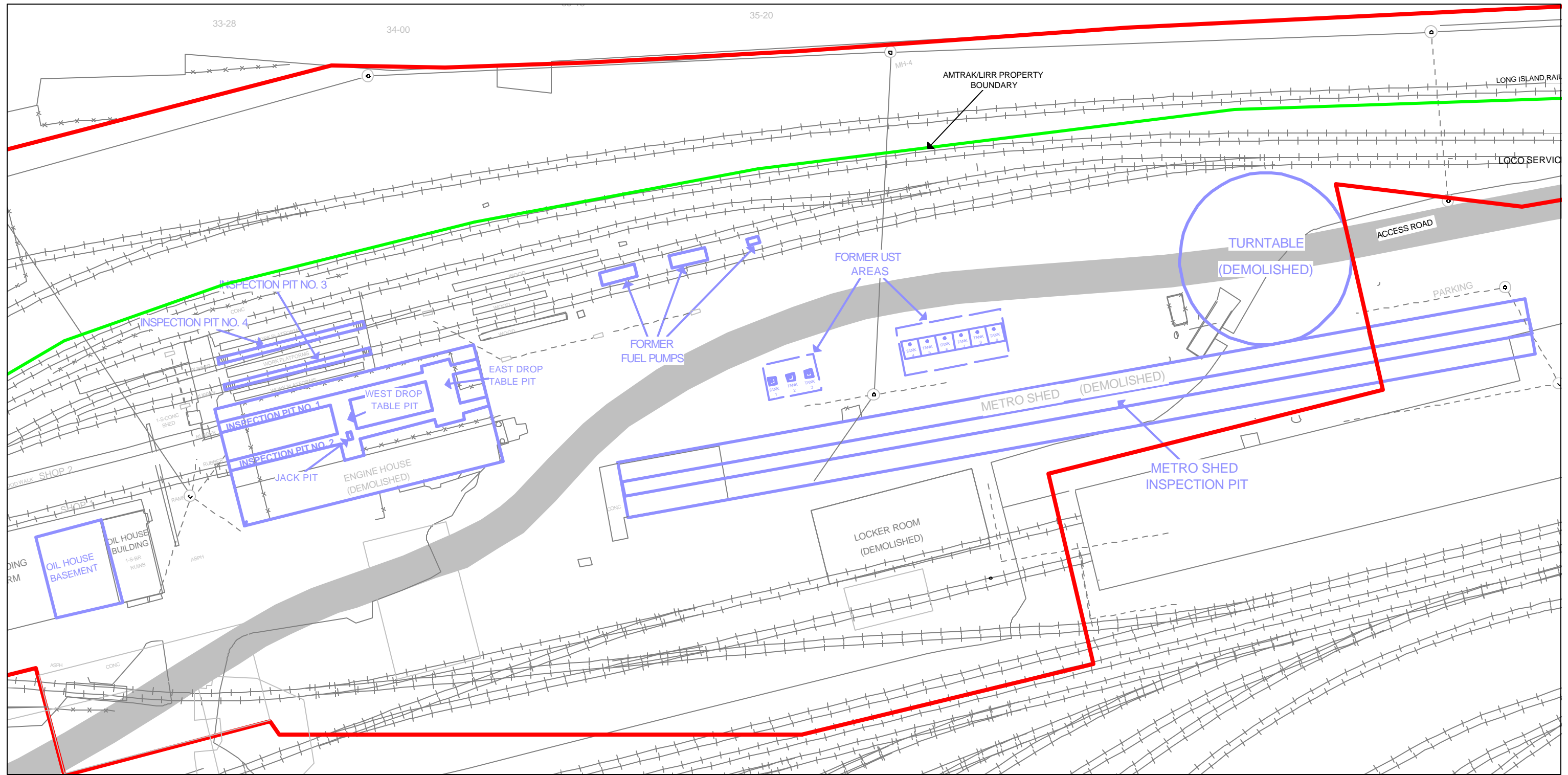

EXPLANATION



EXTENT OF SUBSURFACE STRUCTURE



OU-3 BOUNDARY

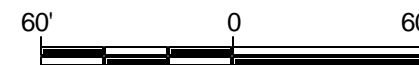

NOTE:  
THE LOCATIONS OF THE ENGINE HOUSE AND METRO SHED PITS, AND THE OIL HOUSE BASEMENT WERE DETERMINED BASED ON DRAWINGS SUPPLIED BY AMTRAK

Title:  
**LOCATIONS OF SUBSURFACE STRUCTURES**

PROPOSED REMEDIAL ACTION PLAN  
SUNNYSIDE YARD, QUEENS, NEW YORK

Prepared For:

 <b>ROUX</b> ASSOCIATES INC. <i>Environmental Consulting &amp; Management</i>	Compiled by: RSK	Date: 11/4/2005	FIGURE <b>10</b>
	Prepared by: JEP	Scale: SHOWN	
	Project Mgr: HG	Office: NY	
	File No: AM4519809.WOR	Project: 05545Y11	

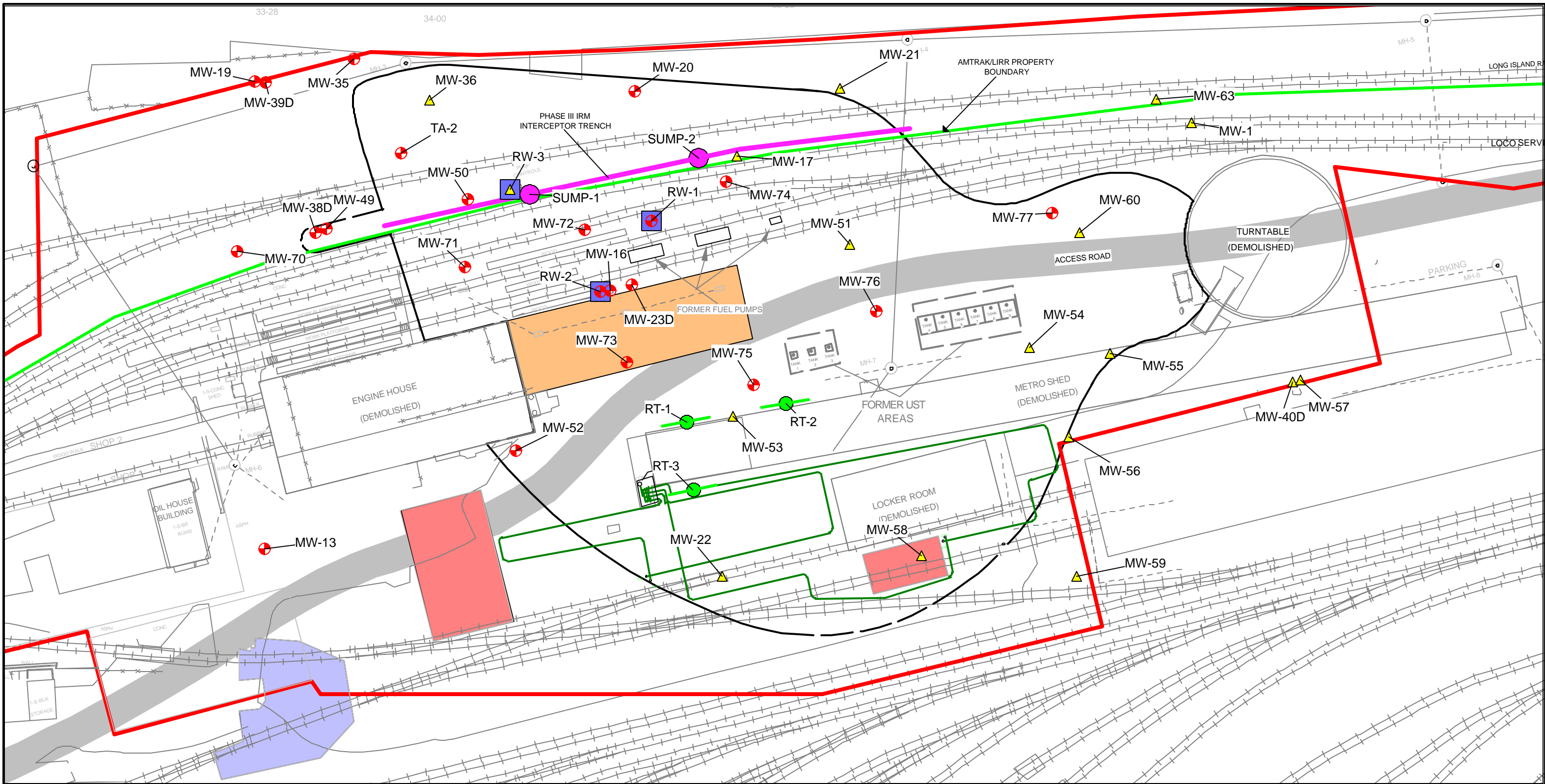

RT-1		LOCATION AND DESIGNATION OF PHASE I IRM RECOVERY TRENCH (SUMPS SHOWN)	MW-16		LOCATION AND DESIGNATION OF MONITORING WELL		APPROXIMATE BOUNDARY OF HISTORIC SPH PLUME (ZERO CONTOUR)	
RW-1		LOCATION AND DESIGNATION OF PHASE II IRM RECOVERY WELLS		AREA REMEDIATED TO 0.5 FT BELOW HISTORIC GRADE (1985-1986)		AREA REMEDIATED TO 2 FT BELOW HISTORIC GRADE (1998)		OU-3 BOUNDARY
		LOCATION OF PHASE III IRM INTERCEPTOR TRENCH (SUMPS SHOWN)		AREA REMEDIATED TO 2 FT BELOW HISTORIC GRADE (1998)		AREA REMEDIATED TO BETWEEN 3 AND 8 FT BELOW HISTORIC GRADE (1999)		BIOFILTRATION PIPING
MW-54		LOCATION AND DESIGNATION OF FORMER (ABANDONED OR DESTROYED) MONITORING WELL INSTALLED BY ROUX ASSOCIATES, INC.						

**NOTES**

- IRM - INTERIM REMEDIAL MEASURE
- SPH - SEPARATE-PHASE HYDROCARBON
- OU-3 - OPERABLE UNIT 3
- RI - REMEDIAL INVESTIGATION
- LIRR - LONG ISLAND RAIL ROAD

60' 0 60'

Title: **LOCATIONS OF PREVIOUS AND EXISTING SPH IRMs AND SOIL IRMs**

PROPOSED REMEDIAL ACTION PLAN  
SUNNYSIDE YARD, QUEENS, NEW YORK

Prepared For:

 ROUX ASSOCIATES INC Environmental Consulting & Management	Compiled by: RSK	Date: 11/4/2005	FIGURE <b>11</b>
	Prepared by: RSK	Scale: SHOWN	
	Project Mgr: HG	Office: NY	
	File No: AM4519810.WOR	Project: 05545Y11	

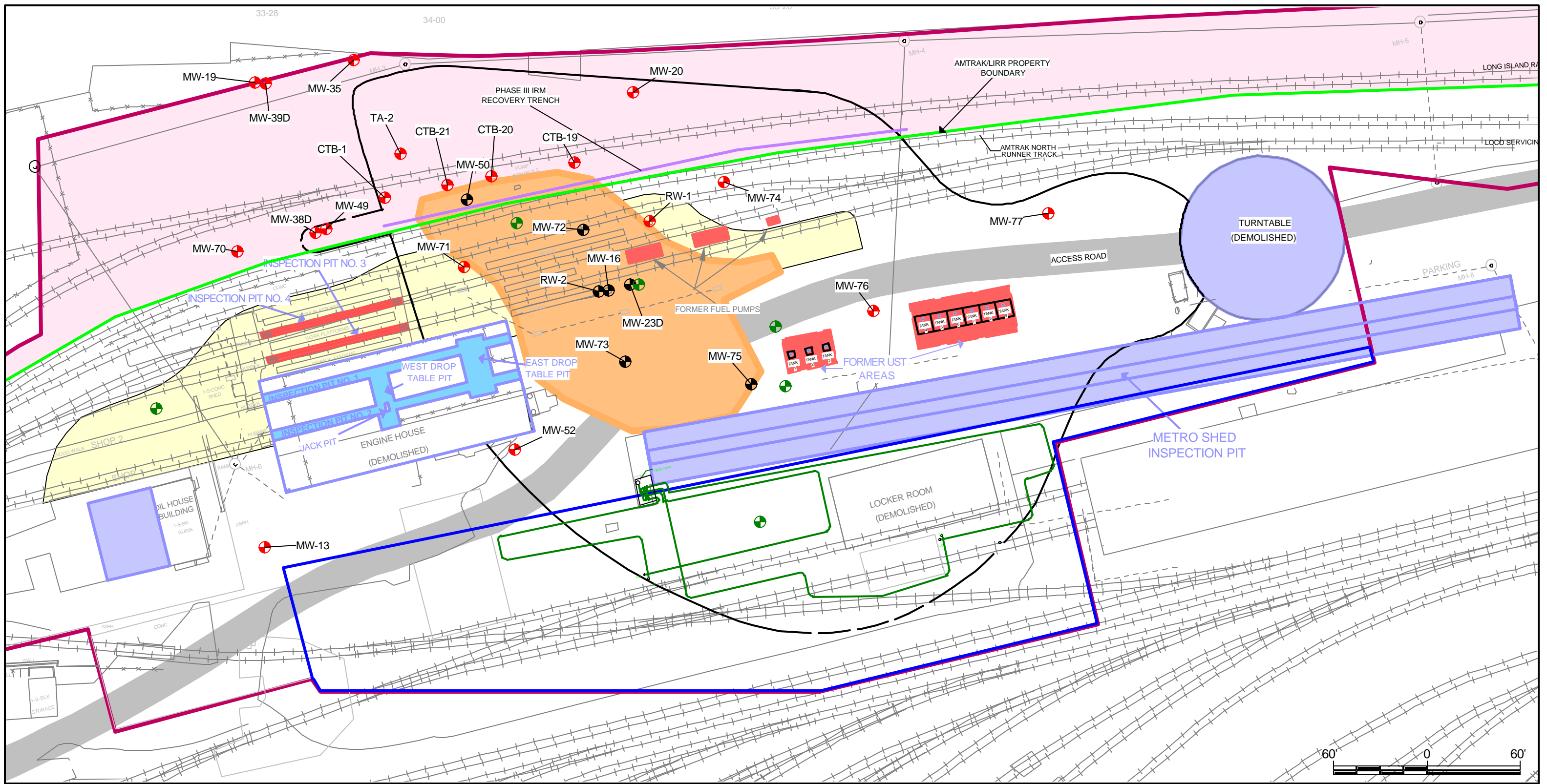

- MW-76 LOCATION AND DESIGNATION OF MONITORING WELL
- LOCATION OF PROPOSED MONITORING WELL
- MW-16 LOCATION AND DESIGNATION OF MONITORING WELL TO BE REMOVED BY EXCAVATION
- APPROXIMATE EXTENT OF MOBILE SPH EXCAVATION AREA/ENHANCED BIODEGRADATION OF SOIL UNDERLYING THE EXCAVATION
- SUBSURFACE STRUCTURES TO BE CLEANED/CLOSED IN PLACE

- EXTENT OF LIRR PROPERTY UNDER ENVIRONMENTAL EASEMENT
- SUBSURFACE STRUCTURES THAT DO NOT REQUIRE FURTHER REMEDIATION (DOWNGRAIDENT MONITORING ONLY)
- SUBSURFACE STRUCTURE TO BE REMOVED
- APPROXIMATE EXTENT OF HYDROCARBON IMPACTED SURFACE SOIL EXCAVATION

- APPROXIMATE BOUNDARY OF HISTORIC SPH PLUME (ZERO CONTOUR)
- OU-3 BOUNDARY
- LIMIT OF AREA PREVIOUSLY ADDRESSED DURING HST CONSTRUCTION
- BIOINFILTRATION PIPING
- PHASE III IRM INTERCEPTOR TRENCH

**NOTES**

- IRM - INTERIM REMEDIAL MEASURE
- SPH - SEPARATE-PHASE HYDROCARBON
- OU-3 - OPERABLE UNIT 3
- LIRR - LONG ISLAND RAIL ROAD

Title: **REMEDIAL ALTERNATIVE II**

PROPOSED REMEDIAL ACTION PLAN  
SUNNYSIDE YARD, QUEENS, NEW YORK

Prepared For:

 ROUX ASSOCIATES INC Environmental Consulting & Management	Compiled by: JEP	Date: 7/21/2006	<b>FIGURE</b>  <b>12</b>
	Prepared by: JEP	Scale: SHOWN	
	Project Mgr: HG	Office: NY	
	File No: AM4519811.WOR	Project: 05545Y11	

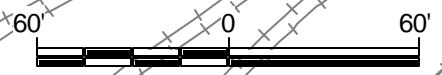

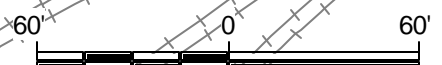
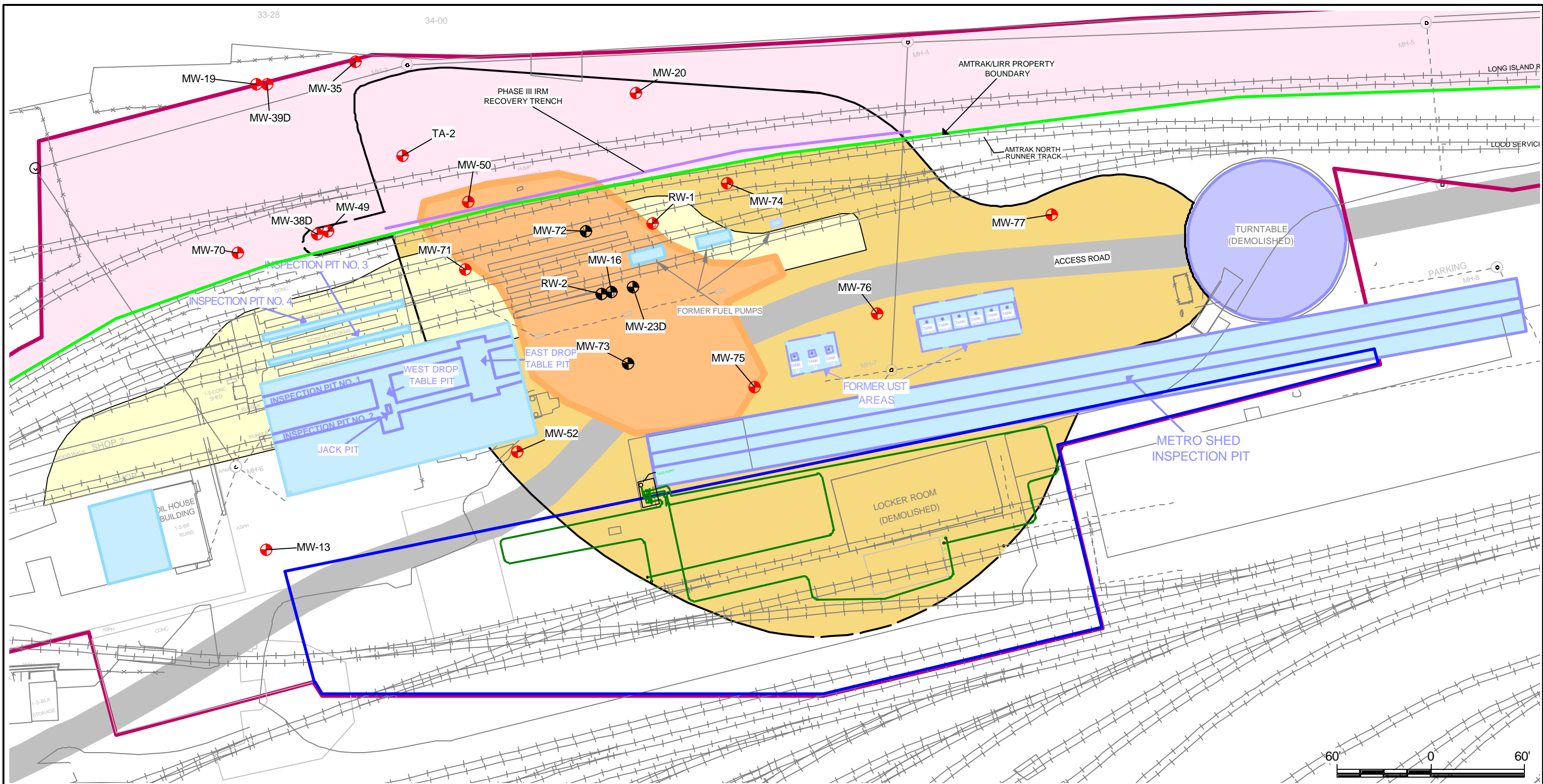

- MW-76 LOCATION AND DESIGNATION OF MONITORING WELL
- MW-16 LOCATION AND DESIGNATION OF MONITORING WELL TO BE REMOVED BY MOBILE SPH EXCAVATION
- EXTENT OF RESIDUAL SPH EXCAVATION AREA
- SUBSURFACE STRUCTURE TO BE REMOVED

- EXTENT OF LIRR PROPERTY UNDER ENVIRONMENTAL EASEMENT
- SUBSURFACE STRUCTURES THAT DO NOT REQUIRE FURTHER REMEDIATION
- APPROXIMATE EXTENT OF MOBILE SPH EXCAVATION AREA
- APPROXIMATE EXTENT OF HYDROCARBON IMPACTED SURFACE SOIL EXCAVATION

- APPROXIMATE BOUNDARY OF HISTORIC SPH PLUME (ZERO CONTOUR)
- OU-3 BOUNDARY
- LIMIT OF AREA PREVIOUSLY ADDRESSED DURING HST CONSTRUCTION
- BIOINFILTRATION PIPING
- PHASE III IRM INTERCEPTOR TRENCH

- NOTES**
- IRM - INTERIM REMEDIAL MEASURE
  - SPH - SEPARATE-PHASE HYDROCARBON
  - OU-3 - OPERABLE UNIT 3
  - RI - REMEDIAL INVESTIGATION
  - LIRR - LONG ISLAND RAIL ROAD



<b>REMEDIAL ALTERNATIVE III</b>			
PROPOSED REMEDIAL ACTION PLAN SUNNYSIDE YARD, QUEENS, NEW YORK			
Prepared For:			
		Compiled by: JEP	Date: 11/4/2005
ROUX ASSOCIATES INC <i>Environmental Consulting &amp; Management</i>		Prepared by: JEP	Scale: SHOWN
		Project Mgr: HG	Office: NY
		File No: AM4519812.WOR	Project: 05545Y11
			FIGURE <b>13</b>