

EXPLANATION

- MH-42 ◊ SEDIMENT INVESTIGATION LOCATION AND DESIGNATION
- CB-4 ◊ CATCH BASIN SEDIMENT INVESTIGATION LOCATION AND DESIGNATION
- CB-1 ◻ GRAPE COVER CATCH BASIN LOCATION AND DESIGNATION
- MH-1 ◉ SOLID COVER MANHOLE LOCATION AND DESIGNATION
- MH-22 ◉ GRAPE COVER MANHOLE LOCATION AND DESIGNATION
- A-2 ◻ LOCATION AND DESIGNATION OF PREVIOUSLY DETERMINED AREA OF CONCERN
- +— DIRECTION OF SEWER FLOW
- - - - - APPROXIMATE LOCATION AND DIAMETER OF SEWER
- - - - - APPROXIMATE PROPERTY BOUNDARY
- — — — — SEWER LINE WITH PCB-CONTAINING SEDIMENT
- — — — — SEWER WITH NO KNOWN SEDIMENT ACCUMULATIONS

NOTES:
 LOCATIONS AND DIAMETERS OF SEWER COMPONENTS BASED UPON A REVIEW OF ANTRAK SUPPLIED ENGINEERING DIAGRAMS AND LIMITED FIELD SURVEY. SEWER LINE CONNECTING MH-14 THROUGH MH-17 PREVIOUSLY IDENTIFIED ON ENGINEERING DIAGRAMS WAS NOT LOCATED DURING FIELD SURVEY AND IS PRESUMED NOT TO HAVE BEEN CONSTRUCTED. THEREFORE, IT DOES NOT APPEAR ON THIS PLAN.



EXPANDED SEWER SYSTEM INVESTIGATION

OPERABLE UNIT 5
 SUNNYSIDE YARD, QUEENS, NEW YORK

Prepared For:	AMTRAK
Compiled by:	D.L.
Date:	5/97
Prepared by:	R.K.
Scale:	SHOWN
Sheet:	FINAL
Project:	50113001
Project:	05580702
Sheet No.:	1

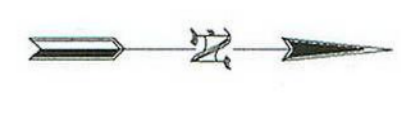
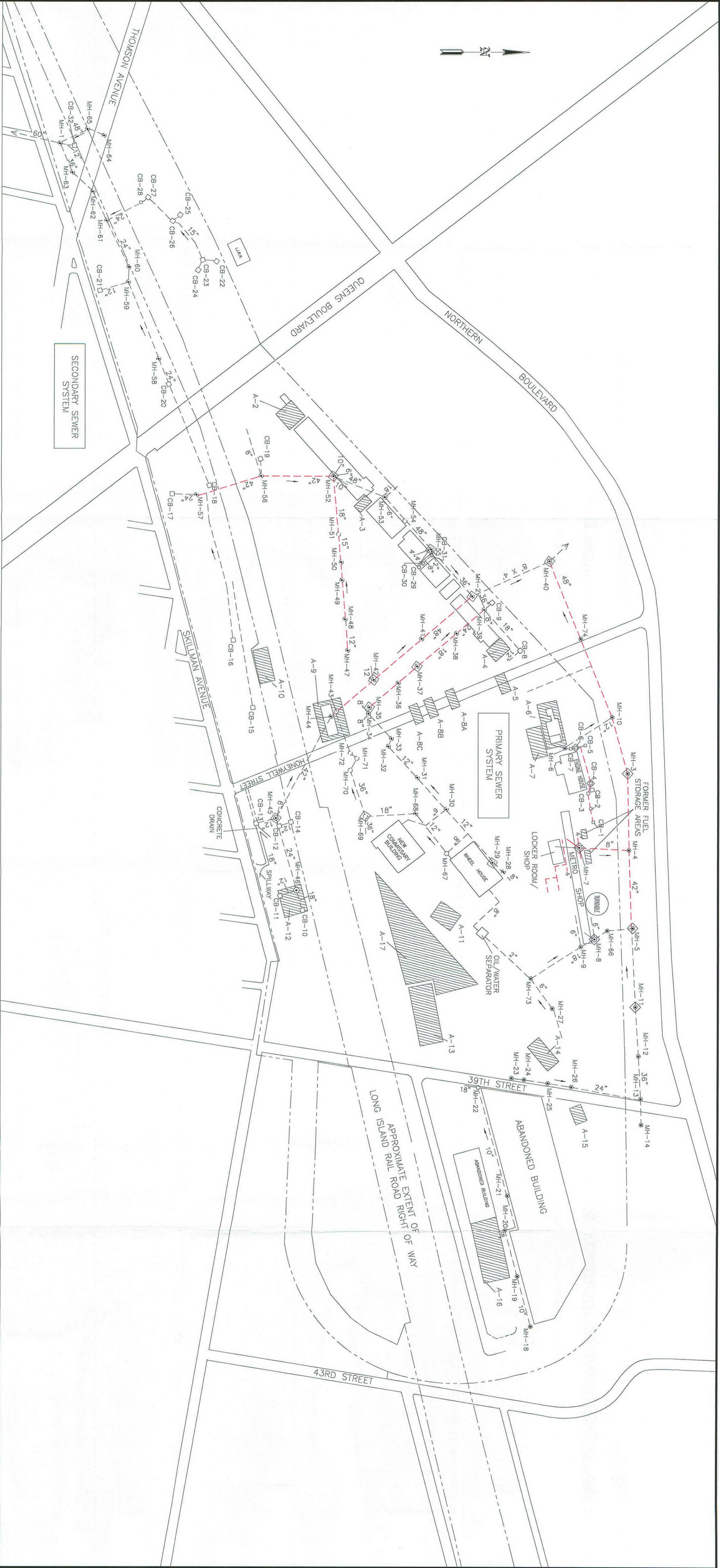

EXPLANATION

- MH-42 ◊ SEDIMENT INVESTIGATION LOCATION AND DESIGNATION
- CB-4 ◊ CATCH BASIN SEDIMENT INVESTIGATION LOCATION AND DESIGNATION
- CB-1 □ GRAPE COVER CATCH BASIN LOCATION AND DESIGNATION
- MH-1 ⊙ SOLID COVER MANHOLE LOCATION AND DESIGNATION
- MH-22 ⊙ GRAPE COVER MANHOLE LOCATION AND DESIGNATION
- A-2 ▨ LOCATION AND DESIGNATION OF PREVIOUSLY DETERMINED AREA OF CONCERN
- DIRECTION OF SEWER FLOW
- - - - - APPROXIMATE LOCATION AND DIAMETER OF SEWER
- - - - - APPROXIMATE PROPERTY BOUNDARY

--- PROPOSED TELEVISION INSPECTION SEWERS

NOTES:
 LOCATIONS AND DIAMETERS OF SEWER COMPONENTS BASED UPON A REVIEW OF ATRAK SUPPLIED ENGINEERING DIAGRAMS AND LIMITED FIELD SURVEY.
 SEWER LINE CONNECTING MH-14 THROUGH MH-17 PREVIOUSLY IDENTIFIED ON ENGINEERING DIAGRAMS WAS NOT LOCATED DURING FIELD SURVEY AND IS PRESUMED NOT TO HAVE BEEN CONSTRUCTED. THEREFORE, IT DOES NOT APPEAR ON THIS PLAN.



PROPOSED TELEVISION INSPECTION LOCATIONS

OPERABLE UNIT 5
 SUNNYSIDE YARD, QUEENS, NEW YORK

Prepared For:	AMTRAK
Compiled By:	D.L.
Date:	5/97
Prepared By:	G.S.
Scale:	SHOWN
Project Mgr.:	J.D.D.
Status:	FINAL
File No.:	SD11.30061
Project:	05550702
PLATE	2