

<b>Project</b>	Former Port Mobil Terminal – IRM #1	<b>Report No.</b>	20
<b>NYSDEC Site</b>	#243016	<b>Date</b>	10/18/2024
<b>Location</b>	4101 Arthur Kill Road Staten Island, NY	<b>File No.</b>	0208988
<b>Client</b>	NP Staten Island Industrial, LLC	<b>Temperature</b>	44-65°F
<b>Contractor</b>	Entact, Haley & Aldrich	<b>Wind Direction</b>	NE to SW up to 10 mph
<b>Weather</b>	Partly Sunny	<b>Personnel on Site</b>	S. Sotomayor, K. O'Connor
<b>Humidity</b>	76%	<b>Time on Site</b>	6:45 am to 5:00 pm

H&A of New York Engineering and Geology, LLP (Haley & Aldrich) was present to document the implementation of the August 2024 NYSDEC-approved Interim Remedial Measures 1 Work Plan (IRM 1 Work Plan) prepared by Haley & Aldrich for the Former Port Mobil Terminal, located at 4101 Arthur Kill Road, Staten Island, NY. Site Observations are summarized below.

**Daily Observations:**

- Haley & Aldrich field personnel performed community air monitoring during the implementation of the activities in the approved IRM 1 Work Plan.
- Entact loaded tri-axle trucks with soil from Excavations 1 and 5 for off-Site transport and waste disposal.
- Entact continued excavation and stockpiling of soil in Excavations 1 and 5, stockpiled soil staged on tarp pad and covered.
- Entact continued pot holing inspections for utilities in Excavation 9 using the Hydro Vac Truck.
- Background PID Reading for Excavation 5: 0.0 ppm
- Stockpile PID Reading for Excavation 5: 43.6 ppm
- Background PID Reading for Excavation 1: 0.0 ppm
- Stockpile PID Reading for Excavation 1: 21.8

**Waste Disposal/Backfill Import Tracking:**

**Material Export:**

- Soil/Fill disposal is summarized below:

Facility	Pure Soil Technologies Jackson, NJ						Total	
	Loads	Tons	Loads	Tons	Loads	Tons	Loads	Tons
<i>Today:</i>	8	160	0	0	0	0	8	160
<i>Total:</i>	<u>43</u>	<u>860</u>	<u>0</u>	<u>0</u>	<u>0</u>	<u>0</u>	<u>43</u>	<u>860</u>

Note: Tonnage is approximate, executed tonnages to be included in the Construction Completion Report.

**Material Import:**

- Fill import is summarized below:

Facility	Mount Hope Quarry ASTM #57 – ¾" Stone		Total	
	Loads	CY	Loads	CY
Today:	12	350.38	12	350.38
<u>Total:</u>	<u>14</u>	<u>401.5</u>	<u>14</u>	<u>401.5</u>

*Note: 1 truckload estimated at 20 cubic yards. Quantities to be included in the Construction Completion Report.*

**Samples Collected:**

- None.

**CAMP Activities:**

- Background air monitoring was performed at three locations, one at the western boundary of the IRM 1 work area, one at the central location of the IRM 1 work area, and one at the eastern boundary of the IRM 1 work area, from 6:45 AM to 4:15 PM.
- No 15-minute average concentrations of VOCs or particulate matter smaller than 10 microns in diameter (PM10) exceeded the action levels. No visible dust was observed leaving the site perimeter.

**Activities Planned for Coming Week:**

- Entact will begin support of excavation (SOE) installation.
- Entact will continue excavating and stockpiling C&D debris for disposal.
- Entact will continue excavating soil for off-site transport and disposal.

<b>Site Staff</b>		
<b>Company</b>	<b>Individual</b>	<b>Title</b>
Haley & Aldrich	Sebastian Sotomayor	Field Manager
Haley & Aldrich	Kassidy O'Connor	Field Staff
Entact	Wyatt Seel	Field Engineer
Entact	Austin Farmerie	Field Engineer
Entact	Brent Hayes	Field Project Manager
Entact	Tariq Smith	SSHO
Entact	Jeramy Leibrant	Operator
Entact	Ross Deambrogo	Field Manager
EA Engineering	Thomas Irvine	Site Inspector
EA Engineering	Joe Kowalski	Site Inspector
<b>Site Equipment</b>		
<b>Name</b>	<b>Contractor</b>	<b>Quantity</b>
Komatsu WA 380	Entact	1
Caterpillar 289D Skid Steer	Entact	1
Chicago Pneumatic Generator (CPG)	Entact	1
Caterpillar 336E Excavator	Entact	2
Pavement Saw	Entact	1
Light Tower	Entact	1
Godwin Pumps	Entact	2
Water Truck	Entact	1
Long Stick Caterpillar Excavator 336E	Entact	1
Hydro Vac Truck	Entact	1
Caterpillar Dozer D6	Entact	1
Caterpillar Rock Truck 740	Entact	1
Caterpillar Excavator 314	Entact	1
United Rental Frac Tank	United Rental	1
Rusmar Foam Machine	Entact	1

**Site Photographs:**



*Photo 1: View of rock truck being loaded with soil to be stockpiled and prepped for disposal, in IRM 1 Western Area, Excavation 1, facing west*



*Photo 2: View of pot holing activities using the Hydro-Vac Truck in Excavation 9, IRM 1 Central Area, facing north.*

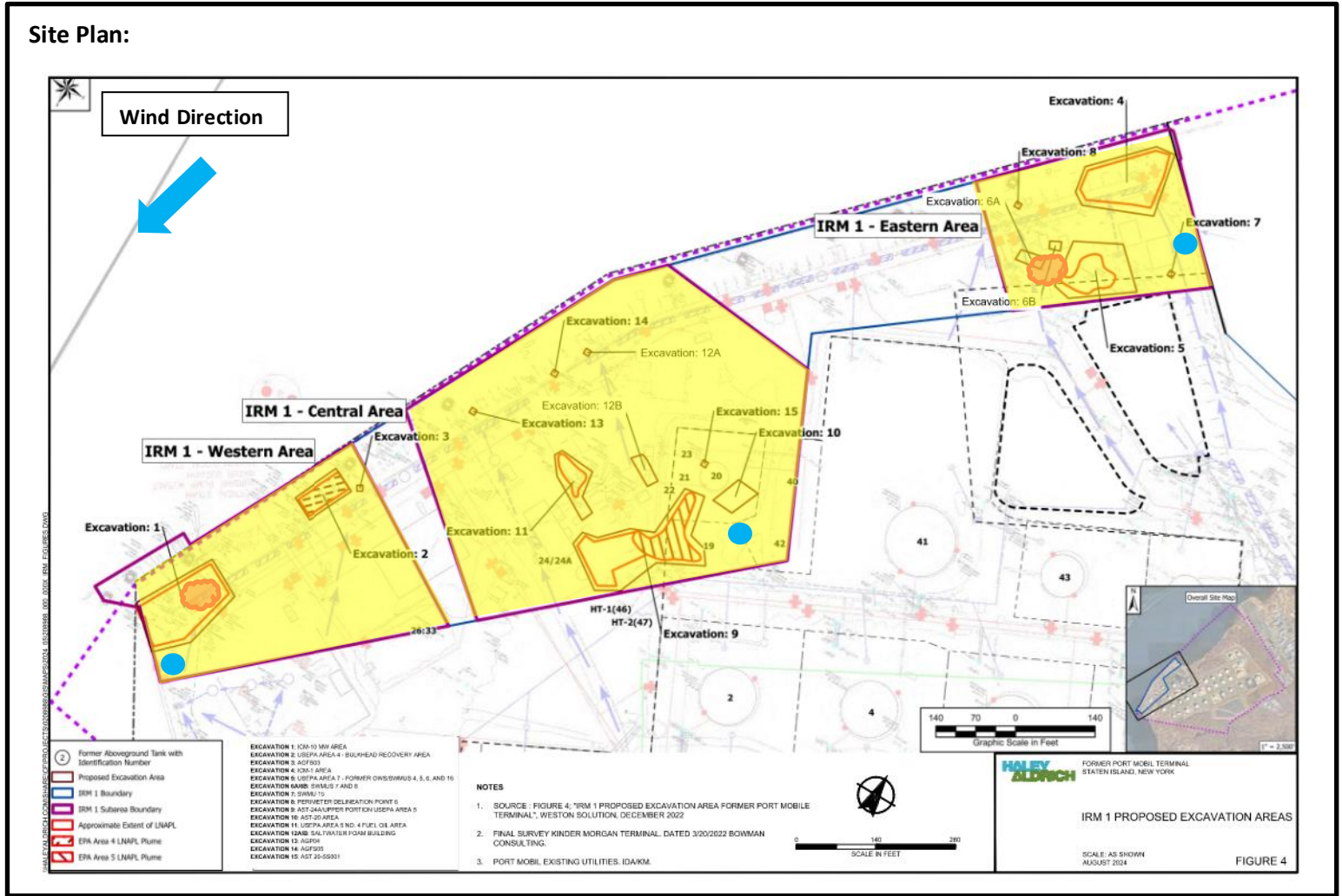

Reference: Interim Remedial Measures 1 Work Plan Figure 7B IRM-1 Central Area Proposed Excavation Area, prepared by Haley & Aldrich of New York, dated May 2024

4101 Arthur Kill Rd, Staten Island, New York, 10309

### Air Monitoring Log

Date : 2024-10-18

Personnel : S. Sotomayor  
Weather : Partly Sunny, 44-65°F  
Humidity : 76%  
Wind Direction : NE to SW, 10 mph

Particulate Background (ug/m3) : 5.462  
PID Background (ppm) : 0.0

Action Levels : Downwind perimeter of work area above background levels

PID (ppm) : > 5 ppm for the 15-min average

Dust (ug/m3) : > 150 for the 15-min average

Minute of Time	Avg. PM10 (Station1)	Avg. PM10 (Station2)	Avg. PM10 (Station3)	Avg. VOC(Station1)	Avg. VOC(Station2)	Avg. VOC(Station3)	Odors	Notes Activities/ Additional Monitoring
06:45	2.810	5.462			0.0			
07:00	2.395	3.001	4.210	0.1	0.0	0.1		
07:15	2.272	2.544	3.907	0.1	0.0	0.2		
07:30	2.179	2.651	3.894	0.2	0.0	0.2		
07:45	2.405	2.461	3.511	0.1	0.1	0.1		
08:00	3.159	3.479	3.793	0.1	0.1	0.1		
08:15	2.329	3.464	3.132	0.0	0.0	0.1		
08:30	2.379	3.457	3.242	0.0	0.0	0.0		
08:45	2.422	3.350	3.112	0.0	0.0	0.0		
09:00	3.026	5.701	4.033	0.1	0.0	0.1		
09:15	2.455	5.292	3.015	0.0	0.1	0.1		
09:30	2.601	5.085	2.847	0.0	0.0	0.0		
09:45	1.952	3.959	2.606	0.0	0.0	0.0		
10:00	1.705	17.837	2.493	0.0	0.0	0.0		
10:15	1.793	3.205	2.633	0.0	0.0	0.0		
10:30	1.645	2.213	2.383	0.0	0.0	0.0		
10:45	1.575	2.586	2.599	0.0	0.0	0.0		

4101 Arthur Kill Rd, Staten Island, New York, 10309

Air Monitoring Log

Minute of Time	Avg. PM10 (Station1)	Avg. PM10 (Station2)	Avg. PM10 (Station3)	Avg. VOC(Station1)	Avg. VOC(Station2)	Avg. VOC(Station3)	Odors	Notes Activities/ Additional Monitoring
11:00	1.585	4.085	2.562	0.0	0.0	0.0		
11:15	1.513	2.347	2.740	0.0	0.0	0.0		
11:30	1.508	2.392	3.319	0.0	0.0	0.0		
11:45	1.303	2.727	2.447	0.0	0.0	0.0		
12:00	1.204	2.531	2.347	0.0	0.0	0.0		
12:15	1.119	2.972	2.253	0.0	0.0	0.0		
12:30	1.164	2.456	2.167	0.0	0.0	0.0		
12:45	1.090	1.960	2.152	0.0	0.0	0.0		
13:00	0.915	2.130	2.509	0.0	0.0	0.0		
13:15	0.995	2.415	2.183	0.0	0.0	0.0		
13:30	0.969	2.736	2.481	0.0	0.0	0.0		
13:45	0.929	3.828	2.291	0.0	0.0	0.0		
14:00	1.002	2.587	2.108	0.0	0.0	0.0		
14:15	1.003	5.186	2.115	0.0	0.0	0.0		
14:30	1.033	3.149	2.166	0.0	0.0	0.0		
14:45	1.125	1.995	2.584	0.0	0.0	0.0		
15:00	1.039	1.613	1.872	0.0	0.0	0.0		
15:15	1.015	1.776	2.080	0.0	0.0	0.0		
15:30	1.015	2.199	2.191	0.0	0.0	0.0		
15:45	1.127	1.917	2.723	0.0	0.0	0.0		
16:00	1.145	1.880	2.350	0.0	0.0	0.0		
16:15	1.194	1.195	2.102	0.0	0.0	0.0		